

ELECTRONICS SERVICE MANUAL

X-06 Receiver

TABLE OF CONTENTS

Specifications.....	1
FM IF, RF Alignment and FM MPX Alignment...	2
AM IF and RF Alignment.....	2
Bias Adjustment.....	2
Disassembly Diagram.....	3
Schematic Diagram.....	4
Wiring Diagram.....	6
Repair Parts List.....	8

 **TELEDYNE ACOUSTIC RESEARCH**

330 Turnpike Street, Canton,
Massachusetts 02021, USA

High Street, Houghton Regis, Dunstable,
Bedfordshire LU5 5QJ, England

AR
**ACOUSTIC
RESEARCH**

RePair Parts List

Schematic Location	Parts No.	Description
TRANSISTORS, DIODES AND IC'S		
Q101	TR50000140	3SK107-F. FM RF Amp.
Q102, 103	TR30000133	2SC1674, FM MIX. OSC
Q104	TR50000139	2SK168-F. Buffer Amp.
Q141	TR30000108	2SC1571 (E, F) Buffer Amp.
Q160 - 167	TR30000248	2SC945 For Switch
Q201	TR50000097	2SK49 (F, H) AM RF Amp.
Q251	TR30000327	2SC536G For Switch
Q301	TR10000126	2SA608K (F, G) For Switch
Q302	TR30000248	2SC945 For Switch
Q303, 304	TR10000126	2SA608K (F, G) For Switch
Q305, Q306	TR10000140	2SA984K (E, F) For Switch
Q307, Q308	TR30000248	2SC945 For Switch
Q309	TR50000127	2SK246-Y. FET
Q310 - 312	TR30000431	2SC1570 (E, F) Tuning Voltage Control Circuit
Q401, 402	TR30000248	2SC945 For Switching
Q441 - 448	TR30000248	2SC945 For Switching
Q449 - 456	TR10000126	2SA608K (F, G) For Switching
Q457	TR30000248	2SC945 For Switching
Q458	TR10000126	2SA608K (F, G) For Switching
Q501 - 504	TR30000467	2SC2602 (G) Differential Amp.
Q505	TR30000248	2SC945 Stabilizer
Q506	TR10000126	2SA608K (F, G) Stabilizer
Q551	TR30000248	2SC945 Stabilizer
Q552	TR10000126	2SA608K (F, G) For Switching
Q553, 554	TR30000248	2SC945 For Switching
Q555	TR10000126	2SA608K (F, G) For Switching
Q556, 557	TR50000127	2SK246-Y For Switching
Q651 - 654	TR10000102	2SA929 (G, F, H), Flat Tone Amp
Q655, 656	TR30000327	2SC536G For Switch
Q701 - 706	TR10000023	2SA1016 (G, H) Differential Amp. Constant Current
Q707 - 710	TR30000212	2SC2362 (G, H) Pre. Driver
Q711 - 714	TR10000047	2SB631K (E, F) Driver
Q715 - 718	TR40000069	2SD600K (E, F) Bias Compensator. Driver
Q719, 720	TR10000047	2SB631K (E, F) Driver
Q721, 722	TR40000045	2SD1047 (D, E) Power Amp.
Q723, 724	TR20000040	2SB817 (D, E) Power Amp.
Q725, 726	TR40000045	2SD1047 (D, E) Power Amp.
Q727, 728	TR20000040	2SB817 (D, E) Power Amp.
Q801 - 811	TR30000248	2SC945 For Switch
Q812 - 815	TR30000121	2SC2274 (E, F) For Switch
Q851	TR10000126	2SA608K (F, G) Buffer Amp
Q901	TR30000029	2SD313 Regulator
Q902	TR10000047	2SB631K (E, F) Regulator
Q903	TR30000029	2SD313 Regulator
Q904	TR40000069	2SD600K (E, F) Regulator
Q951	TR30000121	2SC2274 (E, F) For Switch
D101 - 104	DD50000055	SVC211, Vari-Cap FM Tuning
D141 - 144	DD10000100	1N4148 Diode
D161 - 167	DD10000100	1N4148 Diode
D231, 232	DD10000100	1N4148 Diode
D251, 252	DD10000100	1N4148 Diode
D201, 202	DD50000092	SVC333 (B2), Vari-Cap AM Tuning
D301 - 316	DD10000100	1N4148 Diode
D317	DD20000090	UZ-15B(L) Zener Regulator
D318	DD10000100	1N4148 Diode
D401	DD10000100	1N4148 Diode
D441 - 453	DD10000100	1N4148 Diode
D551, 552	DD20000041	UZ-18B (M, H), Zener Regulator
D553 - 559	DD10000100	1N4148 Diode
D701 - 708	DD10000100	1N4148 Diode
D803 - 818	DD10000100	1N4148 Diode
D831	DD10000100	1N4148 Diode
D851 - 865	DD40000812	SE65224T-D, L.E.D
D866 - 873	DD40000824	SE6521DK, L.E.D
D901, 902	DD10000020	KBL-02/PBL403, Rectifier
D903, 904	DD20000028	UZ-20 (M, H), Zener Regulator
D905 - 908	DD10000068	IN4003/DS135C, Diode
D909	DD20000090	UZ-15B (L), Zener Regulator
D910	DD20000065	UZ-6.8B (M, H), Zener Regulator
IC131, 132	IC00001656	UPP-1163H FM IF Amp.
IC141	IC00001103	LA1235 FM IF Amp.
IC142	IC00001620	LB1450 Tuning LED Driver

Schematic Location	Parts No.	Description
IC201	IC00001322	LA1245 AM IF Amp.
IC251	IC00001450	LA3400 FM MPX Decoder
IC301	IC00001346	TC9157AP PLL Synthesizer
IC302	IC00000482	TD6104P Prescaler
IC303	IC00001528	LC4013 D. Type Flip Flop
IC401	IC00000573	TD6301AP Driver For Frequency Display
IC441	IC00001632	HD74HC541 Inverting Octal 3 State Buffer
IC442	IC00001644	M54832P 8 Channel Selector
IC501	IC00001279	NE5532N Pre. Amp.
IC551	IC00001541	LC7818 For Func. Switch
IC601	IC00001292	NJM2041DD F/AT Amp
IC801	IC00001498	TC9150P Switch For Remote Control Receiver
IC802	IC00001528	LC4013 D. Type Flip-Flop
IC851	IC00000925	LB1403 Signal LED Driver
IC852	IC00001589	CX20106A Remote Control Receiver Amp
IC951	IC00000512	μPC78L05 Regulator
COILS VARIABLE RESISTORS, SWITCHES AND OTHERS		
L101	LC02370009	RL237T, FM ANT Coil
L102	LC22200006	TRL-220, FM RF Coil
L103	LC22210000	TRL-221, FM RF Coil
L104	LC02330000	RL-233T, FM IF Coil
L105	LM00000073	TRL-239, Micro Inductor
L106	LC31120000	RLV112T, FM OSC Coil
L141	LC31090007	RLV109T, IF Coil
L201	LC31050009	RLV105T, AM OSC Coil
L202	LC31070008	RLV107A00, AM ANT Coil
L203	LC23230006	TRL-323, AM IF Coil
L251, 252	LC21940006	TRL-194, FM MPX Filter
L701, 702	LC23320007	TRL-332, Anti-Parasitic Coil
CT101 - 103	CF00000238	CVSSA1001 10PF Film Trimmer Cap.
CT104	CF00000240	CVSSA0701 7PF Film Trimmer Cap.
CT201	CF00000238	CVSSA1001 10PF Film Trimmer Cap.
CT202	CF00000238	CVSSA1001 10PF Film Trimmer Cap.
VR141	RV20000235	08-301 50KB, FM Meter Adj.
VR142	RV20000193	08-301 10KB, FM Muteing Adj.
VR231, 232	RV20000235	08-301 50KB, AM Meter AM Auto Adj.
VR251	RV20000235	08-301 50KB, Separation Adj.
VR601	RV10001073	C-4170A08 50KBX2, Volume Control
VR651 - 653	RV10000433	4TR-1742 20KBX2, Bass, Mid, Treble Control
VR654	RV10000378	4TR-1572 20KW, Balance Control
RY951	LY00000137	VS-24MB-NR, Relay
	SH14000184	4TR-2312, 4 Key Push Switch for Speaker A, B, Mon. Loudness
	SH13000310	4TR-2311, 3 Key Push Switch for Auto/Man Up, Down
	SH12000326	4TR-2276, 2 Key Push Switch for Tape 1/2, VCR 1/2
	SH11000227	4TR-2306, 1 Key Push Switch for Power
	SH60000239	4TR-2301, Key board Switch for Tape, VCR, Tuner, CD/AUX, Phono, AM/FM, Memory, Mute
T001	PT21006044	Power Transformer, TT-241-AF (for A Version)
	PT21006299	Power Transformer, TT-241-GF (for B/C Version)
T002	PT21006340	Power Transformer, TT-230-AF-1 (for A Version)
	PT21006491	Power Transformer, TT-230-GF-1 (for B/C Version)
F701, 702	FU12000136	Fuse, 125V Long 6A UL
	FU23000086	Fuse, 250V 6.3A S
F901 - 904	FU12000045	Fuse, 250V 4A UL
	FU23000049	Fuse, 250V 4A S
F905	FU12000070	Fuse, 250V 1A UL
	FU23000025	Fuse, 250V 1A S

Specification

Continuous Power Output.....	60 watts per channel, min RMS both channels into 8 ohms from 20 to 10,000 Hz with no more than 0.03% total harmonic distortion	
DIN Power Output.....	100watts per channel(1 kHz, 4 ohms, 1% THD)	
Music Power.....	200 watts total (50 w/ch)	
Total Harmonic Distortion (20 to 20,000 Hz).....	No more than 0.03%	
Intermodulation Distortion (60 Hz; 7 kHz = 4:1).....	0.03%	
Output		
Speaker	8 ohms nominal	
Headphone.....	8 ohms nominal	
Damping Factor.....	120 (1 kHz, 8 ohms)	
Input Sensitivity/Impedance		
Phono (MM)	2.5 mV/47 kohms	
(MC)	200 μ V/100 ohms	
CD, Video Tape	150 mV/20 kohms	
Overload Level (THD 0.5%, 1 kHz)		
Phono.....	180 mV	
Tape, CD Video.....	5V	
Frequency Response		
Phono.....	20 to 20 kHz \pm 0.3 dB (RIAA Std)	
Tape, CD Video.....	20 to 20 kHz \pm 0.5 dB	
Tone Control		
Bass.....	\pm 8 dB (100 Hz)	
Mid.....	\pm 8 dB (1 kHz)	
Treble.....	\pm 8 dB (10 KHz)	
Loudness Control (Volume Control Set at 30 dB Position)		+ 5 dB (100 Hz), + 3 dB (10 kHz)
Signal to Noise Ratio (IHF, A-Network)		
Phono (MM).....	80 dB	
(MC)	70 dB	
Tape, CD, Video.....	90 dB	
FM Tuner Section		
Usable Sensitivity.....	11.2 dBf/2.0 μ V (mono)	
DIN Sensitivity.....	1.2 μ V (26 dB S/N 75 ohms)	
50 dB Quieting Sensitivity		
Mono.....	17.2 dBf/4.0 μ V	
Stereo.....	37.2 dBf/4.0 μ V	
Signal to Noise Ratio (at 65 dBf) IHF A Weighted		
Mono.....	72 dB	
Stereo.....	70 dB	
Harmonic Distortion (at 65 dBf) 30 Hz ~ 7.5 kHz		
Mono.....	0.2%	
Stereo.....	0.3%	
Frequency Response.....	\pm 0.5dB (50Hz ~ 10KHz)	
Capture Ratio.....	1.5dB	
Alternate Channel Selectivity.....	70 dB (\pm 400 kHz)	
Spurious Response Ratio.....	85 dB	
Image Response Ratio.....	70 dB	
IF Response Ratio.....	90 dB	
AM Suppression Ratio.....	60 dB	
Stereo Separation.....	40 dB (100 Hz ~ 10 kHz)	
AM Tuner Section		
Selectivity	40 dB	
Sensitivity (Loop Antenna).....	300 μ V	
Signal to Noise Ratio.....	50 dB	
Image Response Ratio.....	40 dB	
IF Response Ratio.....	40 dB	
Power Consumption.....	300 Watts	
Dimension (Overall).....	430(W) \times 88(H) \times 422(D) 16 ¹⁵ / ₁₆ " \times 3 ¹⁵ / ₃₂ " \times 16 ³ / ₈ "	
Weight (net).....	11.1 kgs/24.42 lbs	

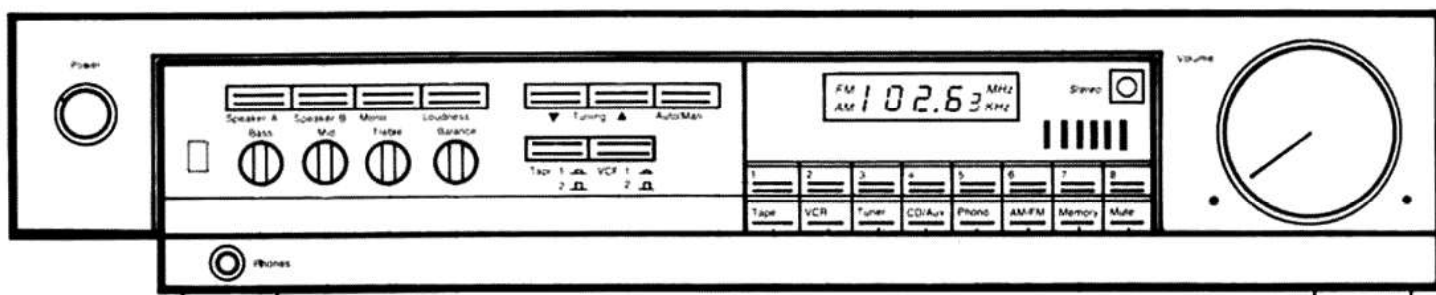

FM IF, RF Alignment and FM MPX Alignment

Instruments: FM Signal Generator, (400Hz, 100% Modulated) T.H.D. analyzer, Oscilloscope, AC VTVM, DC Voltmeter, Tuning Meter

FM Stereo Generator, AC VTVM, Oscilloscope, Frequency Counter and THD Analyzer

Terminated : DC Voltmeter...Between 4 and E5 On TH-IF-153 P.C.B. (Step 1.2)
Tuning Meter...Between TP1 and TP2 On TH-IF-153 P.C.B. (Step 8)

Step	Generator		Tuning Dial Setting	Adjust	Adjust for
	Coupling	Frequency			
1	No use.		87.5 MHz	L106	3V reading on DC Voltmeter
2			108 MHz	CT104	23V reading on DC Voltmeter
3	Repeat steps 1 and 2 unit no further improvement is noticed.				
4	Antenna terminal	90 MHz	90 MHz	L101, L102 L103	Maximum reading on AC VTVM.
5				L104	Adjust balance of wave form
6		105 MHz	105 MHz	CT101, CT102 CT103	Maximum reading on AC VTVM.
7	Repeat steps 4.5 and 6 unit on further improvement is noticed				
8	Antenna terminal	90 MHz	90 MHz	L141(A)	Adjusting center on Tuning Meter
9	1mV input			L141(B)	Minimum reading on T.H.D. Analyzer
10	Repeat steps 8 and 9 unit no further improvement is noticed				
11	Antenna terminal 15 μ V input 10 μ V input (Europe)	90 MHz	90 MHz	VR142	Muting Level (Auto Position)
12	Antenna terminal 1mV input	90 MHz	90 MHz	VR141	Signal Indicator Level 5th LED light on
13	Antenna terminal 1mV input	98 MHz Pilot...10% 1 KHz...90% Mod.	98 MHz	VR251	Best separation No need to Adjust VCO

AM IF and RF Alignment

Instruments: AM signal Generator (400Hz 30% Modulated), AC VTVM, Oscilloscope, DC Voltmeter

Terminated : DC Voltmeter "Between 4 and E5 ON TH-IF-153 and TX-474 P.C.B.

Step	Generator		Tuning Dial Setting	Adjust	Adjust for
	Coupling	Frequency			
1	No use.		530 KHz (531 KHz) Europe	L201	3V reading on DC Volt meter
2			1600 KHz (1602 KHz) Europe	CT201	25V reading on DC Volt meter
3	Repeat steps 1 and 2 unit no further improvement is noticed.				
4	Test Loop Radiate signal into loop antenna	450 KHz	530 KHz	L203	Maximum reading on AC VTVM.
5		600 KHz	600 KHz	L202	
6		1400 KHz	1400 KHz	CT202	
7	Repeat steps 5 and 6 unit no further improvement is noticed.				
8	Test Loop Radiate signal into loop ANT. 10mV input	1000 KHz	1000 KHz	VR231	Signal Indicator Lever 5th LED light on
9	Test Loop Radiate signal into loop ANT. 1mV input	1000 KHz	Auto Scanning	VR232	Stop Position

Bias Adjustment

Instruments: DC milli-voltmeter

Notes: Prior to Bias Adjustment, run about 5 minutes with rated output (8 ohm) and warm up Power Transistor and Heat Sink.
Set Volume Control to Minimum.

Step	Coupling		Adjust	Adjust for
	Plus Lead	Minus Lead		
1	TP1	TP3	VR701	DC milli-voltmeter reads 4 mV
2	TP2	TP4	VR702	

Disassembly Diagram

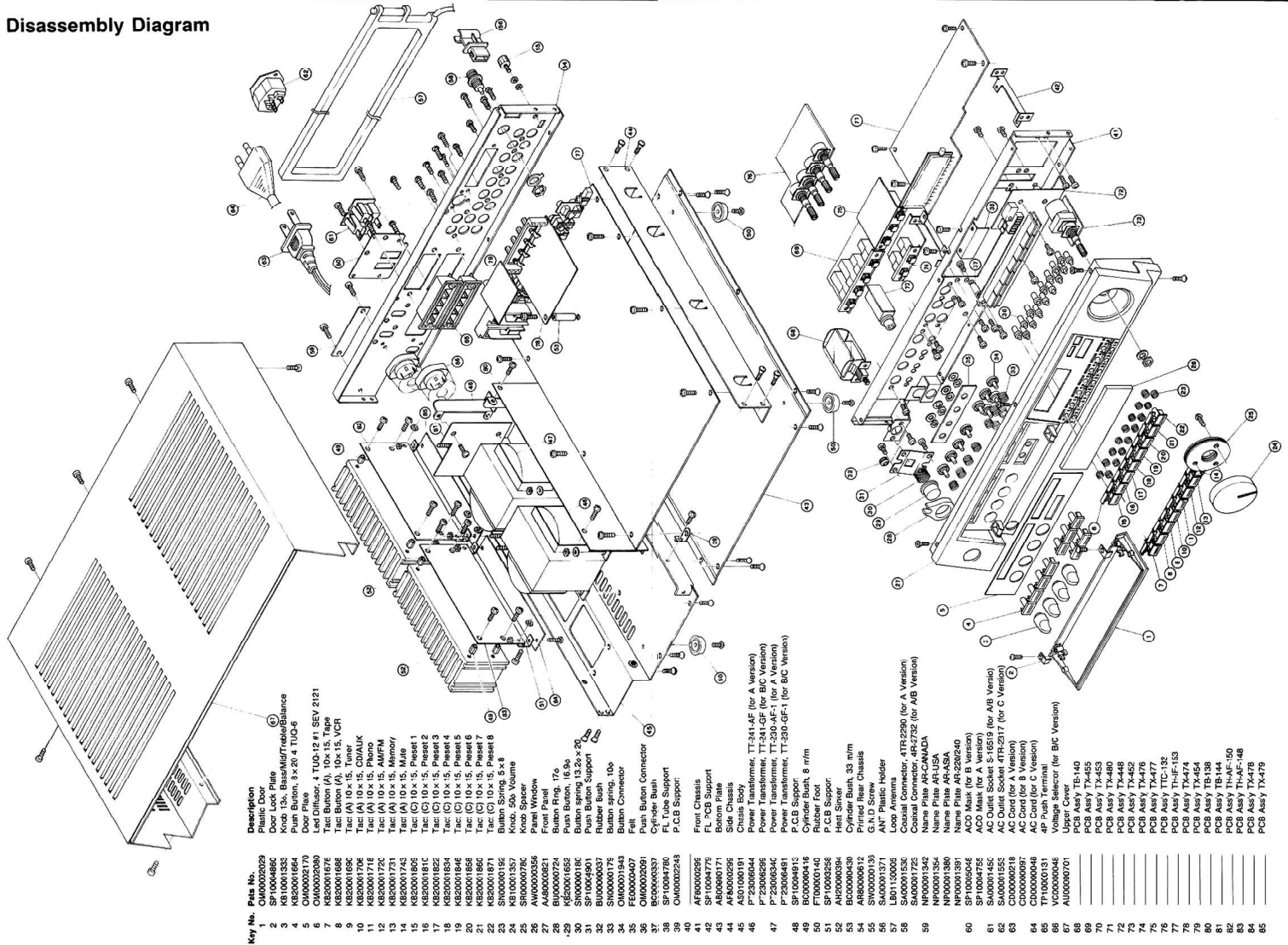

Key No.	Part No.	Description
1	OM0005029	Plastic Door
2	OM0005030	Door Hinge
3	KS10001833	Knob 13x, Base/MT/Red/Balance
4	KS20001864	Push Button, 3 x 20 4 TU/G-6
5	OM0005099	Door Plate
6	OM00052170	LED Diffuser, 4 TU/G-12 n, SEV 2121
7	KS20001865	Tac Button (A), 10x 15, VCR
8	KS20001866	Tac Button (A), 10x 15, VCR
9	KS20001867	Tac (A) 10 x 15, Tuner
10	KS20001706	Tac (A) 10 x 15, CD/ALK
11	KS20001716	Tac (A) 10 x 15, Phono
12	KS20001717	Tac (A) 10 x 15, Phono
13	KS20001721	Tac (A) 10 x 15, Memory
14	KS20001745	Tac (A) 10 x 15, Mute
15	KS20001805	Tac (C) 10 x 15, Preset 1
16	KS20001810	Tac (C) 10 x 15, Preset 2
17	KS20001815	Tac (C) 10 x 15, Preset 3
18	KS20001824	Tac (C) 10 x 15, Preset 4
19	KS20001848	Tac (C) 10 x 15, Preset 5
20	KS20001858	Tac (C) 10 x 15, Preset 6
21	KS20001860	Tac (C) 10 x 15, Preset 7
22	KS20001871	Tac (C) 10 x 15, Preset 8
23	KS20001872	Tac (C) 10 x 15, Preset 8
24	KS10001857	Knob, 50x Volume
25	SR0000078C	Knob Spacer
26	AV00000356	Panel Window
27	AB00000821	Front Panel
28	AB00000822	Front Panel, 17x
29	KS20001652	Push Button, 16.9x
30	SH0000018C	Button Spring 13.2x x 20
31	SP10004901	Push Button Support
32	BU00000057	Rubber Bush
33	BU00000058	Rubber Bush
34	OM00011843	Button Connector
35	FE00000407	Felt
36	OM00020091	Push Button Connector
37	BC00000637	Cylinder Bush
38	SP10004902	Push Button Support
39	OM00020243	P.C.B. Support
40	OM00020243	P.C.B. Support
41	AF00000296	Front Chassis
42	SP10004775	FL PCB Support
43	SP10004776	SL PCB Support
44	AF00000296	Slide Chassis
45	AS01000191	Chassis Body
46	P23006044	Power Transformer, TT-241-AF (for A Version)
47	P23006056	Power Transformer, TT-241-GF (for B/C Version)
48	P23006057	Power Transformer, TT-241-DF (for A/B Version)
49	P23006481	Power Transformer, TT-200-GE1 (for B/C Version)
50	SP10004815	P.C.B. Support
51	BC00000418	Cylinder Bush, 8 n/m
52	F000001140	Rubber Foot
53	SP10004816	Push Button Support
54	AR00000612	Heat Sink
55	BC00000439	Cylinder Bush, 33 n/m
56	SP10004817	Printed Rear Chassis
57	S000000139	G.N.D. Screw
58	LB01130005	Load Resistor
59	SA00001536	Coaxial Connector, 4TR-2290 (for A Version)
60	SA00001725	Coaxial Connector, 4R-2732 (for A/B Version)
61	NP00001942	Name Plate APC/CANADA
62	NP00001943	Name Plate APC/CANADA
63	NP00001944	Name Plate APC/CANADA
64	NP00001945	Name Plate APC/CANADA
65	NP00001946	Name Plate APC/CANADA
66	NP00001947	Name Plate APC/CANADA
67	NP00001948	Name Plate APC/CANADA
68	NP00001949	Name Plate APC/CANADA
69	NP00001950	Name Plate APC/CANADA
70	NP00001951	Name Plate APC/CANADA
71	NP00001952	Name Plate APC/CANADA
72	NP00001953	Name Plate APC/CANADA
73	NP00001954	Name Plate APC/CANADA
74	NP00001955	Name Plate APC/CANADA
75	NP00001956	Name Plate APC/CANADA
76	NP00001957	Name Plate APC/CANADA
77	NP00001958	Name Plate APC/CANADA
78	NP00001959	Name Plate APC/CANADA
79	NP00001960	Name Plate APC/CANADA
80	NP00001961	Name Plate APC/CANADA
81	NP00001962	Name Plate APC/CANADA
82	NP00001963	Name Plate APC/CANADA
83	NP00001964	Name Plate APC/CANADA
84	NP00001965	Name Plate APC/CANADA
85	NP00001966	Name Plate APC/CANADA

Schematic Diagram (1/2)

REF: PARTS AND CIRCUIT VALUES LISTED IN THE SUBSEQUENT SECTIONS APPLY

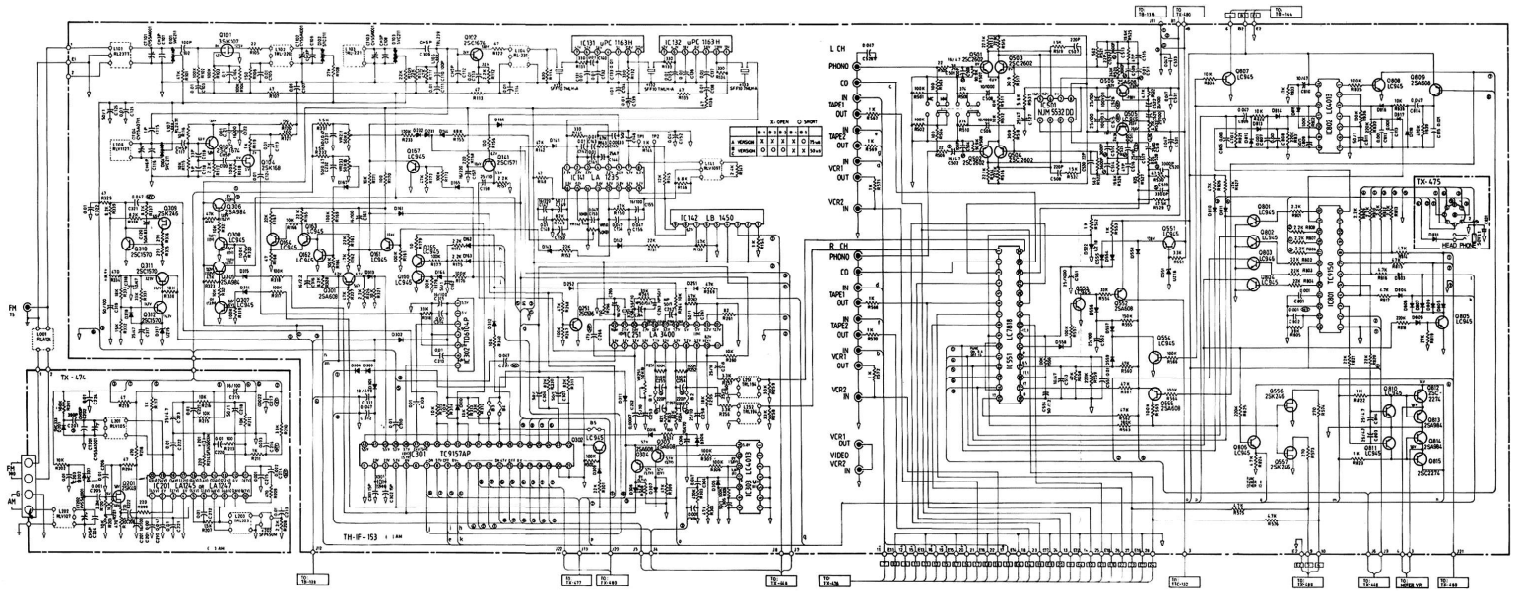

Schematic Diagram (2/2)

