

aiwa



NSX-KT9

COMPACT DISC STEREO
CASSETTE RECEIVER

• TYPE: HR

SIMPLE MANUAL

• Replace this Service Manual with "Revision Publishing" when it is issued.

S/M Code No. 09-991-407-3T1

MANUAL
SERVICE

ELECTRICAL MAIN PARTS LIST - 1/9

NOTE: The characters in the suffix column indicate the part usage.

| HR | REF.NO | PARTS NO. | XX KANRI NO. | DESCRIPTION | A SUFFIX |
|----|--------|----------------|--------------------|------------------------------|-------------|
| C | 603 | 87-010-112-040 | | CAP,E 100-16 | A..... |
| C | 602 | 87-010-186-080 | | CAP,CHIP 4700P | A..... |
| C | 601 | 87-010-196-080 | | CHIP CAPACITOR,0.1-25 | A..... |
| C | 607 | 87-010-197-080 | | CAP, CHIP 0.01 DM | A..... |
| C | 606 | 87-010-320-080 | | CHIP CAP 68P | A..... |
| C | 604 | 87-010-405-040 | | CAP,E 10-50 | A..... |
| C | 605 | 87-010-546-040 | | CAP,E 0.33-50 | A..... |
| J | 602 | 87-A60-651-010 | | JACK,3.5MONO | A..... |
| J | 601 | 87-A60-651-010 | | JACK,3.5MONO | A..... |
| Q | 604 | 87-A30-075-080 | | C-TR,2SA1235F | A..... |
| Q | 603 | 87-A30-076-080 | | C-TR,2SC3052F | A..... |
| Q | 602 | 87-A30-076-080 | | C-TR,2SC3052F | A..... |
| Q | 601 | 87-A30-087-080 | | C-FET,2SK2158 | A..... |
| Q | 101 | 87-010-387-080 | | CAP,E 470-25 SME | A..... |
| C | 107 | 87-A11-148-080 | | CAP,TC U 0.1-50 Z F | A..... |
| C | 108 | 87-A11-148-080 | | CAP,TC U 0.1-50 Z F | A..... |
| C | 104 | 87-A11-148-080 | | CAP,TC U 0.1-50 Z F | A..... |
| C | 109 | 87-A11-148-080 | | CAP,TC U 0.1-50 Z F | A..... |
| C | 106 | 87-A11-148-080 | | CAP,TC U 0.1-50 Z F | A..... |
| C | 105 | 87-A11-148-080 | | CAP,TC U 0.1-50 Z F | A..... |
| C | 103 | 87-A11-148-080 | | CAP,TC U 0.1-50 Z F | A..... |
| C | 116 | 87-010-403-080 | | CAP, ELECT 3.3-50V | A..... |
| C | 112 | 87-010-917-090 | | CAP,E 3300-50 M SMG | A..... |
| C | 111 | 87-010-917-090 | | CAP,E 3300-50 M SMG | A..... |
| C | 114 | 87-A10-231-090 | | CAP,E 3300-80 | A..... |
| C | 113 | 87-A10-231-090 | | CAP,E 3300-80 | A..... |
| C | 110 | 87-A11-148-080 | | CAP,TC U 0.1-50 Z F | A..... |
| CN | 1 | 87-A60-851-010 | | CONN,9P V VH | A..... |
| CN | 103 | 87-099-043-010 | | CONN 2P EH | A..... |
| D | 101 | 87-017-447-010 | | DIODE,GBU4DL | A..... |
| D | 102 | 87-017-654-060 | | DIODE,GBU6J | A..... |
| D | 104 | 87-020-465-080 | | DIODE,1SS133 (110MA) | A..... |
| D | 109 | 87-020-465-080 | | DIODE,1SS133 (110MA) | A..... |
| D | 108 | 87-020-465-080 | | DIODE,1SS133 (110MA) | A..... |
| D | 105 | 87-020-465-080 | | DIODE,1SS133 (110MA) | A..... |
| D | 107 | 87-020-465-080 | | DIODE,1SS133 (110MA) | A..... |
| D | 106 | 87-020-465-080 | | DIODE,1SS133 (110MA) | A..... |
| D | 103 | 87-020-465-080 | | DIODE,1SS133 (110MA) | A..... |
| FC | 100 | 87-A90-505-080 | | FUSE CLAMP,TP00351-51 | A..... |
| FC | 101 | 87-A90-505-080 | | FUSE CLAMP,TP00351-51 | A..... |
| FC | 102 | 87-A90-505-080 | | FUSE CLAMP,TP00351-51 | A..... |
| FC | 103 | 87-A90-505-080 | | FUSE CLAMP,TP00351-51 | A..... |
| PR | 102 | 87-026-682-080 | | PROTECTOR,10A 60V491 | A..... |
| PR | 101 | 87-026-682-080 | | PROTECTOR,10A 60V491 | A..... |
| PR | 103 | 87-026-682-080 | | PROTECTOR,10A 60V491 | A..... |
| PR | 104 | 87-026-682-080 | | PROTECTOR,10A 60V491 | A..... |
| PR | 105 | 87-A90-195-080 | | PROTECTOR 7A 125V 49 | A..... |
| PR | 106 | 87-A90-195-080 | | PROTECTOR 7A 125V 49 | A..... |
| PR | 107 | 87-A90-757-080 | | PROTECTOR,0.75A 60V 491 | A..... |
| PT | 2 | 8Z-NF8-663-010 | | PT,SUB ZNF-8(H) | A..... |
| Q | 101 | 87-026-245-080 | | TR,DTC114ES | A..... |
| Q | 102 | 87-A30-198-080 | | TR,KTC3199GR | A..... |
| RY | 101 | 87-A91-281-010 | | RELAY,AC DC12V OSA-SS-212DM5 | A..... |
| SW | 101 | 87-A90-165-010 | | SW,SL 1-2-3 SWS2301 | A..... |
| T | 102 | 87-A60-317-010 | | TERMINAL, 1P MSC | A..... |
| T | 101 | 87-A60-317-010 | | TERMINAL, 1P MSC | A..... |
| * | | 8Z-NF3-210-010 | | GUIDE,FL | A..... |
| * | | 8Z-NF3-211-010 | | GUIDE,LED FUN | A..... |
| * | | 8Z-NF3-212-010 | | GUIDE,LED OPE | A..... |
| C | 104 | 87-010-313-080 | | CAP, CHIP 18P | A..... |
| C | 105 | 87-010-322-080 | | C-CAP,S 100P-50 CH | A..... |
| C | 106 | 87-012-145-080 | | CAP, CHIP S 270P CH | A..... |
| C | 107 | 87-012-157-080 | | C-CAP,S 330P-50 CH | A..... |
| C | 108 | 87-015-681-040 | | E/CAP 10-16 | A..... |
| C | 110 | 87-010-180-080 | | C-CER 1500P | A..... |
| C | 118 | 87-010-194-080 | | CAP, CHIP 0.047 | A..... |
| C | 114 | 87-010-196-080 | | CHIP CAPACITOR,0.1-25 | A..... |
| C | 112 | 87-010-196-080 | | CHIP CAPACITOR,0.1-25 | A..... |
| C | 115 | 87-010-198-080 | | CAP, CHIP 0.022 | A..... |
| C | 116 | 87-010-493-040 | | CAP,E 0.47-50 GAS | A..... |
| C | 117 | 87-010-498-040 | | CAP,E 10-16 GAS | A..... |
| C | 113 | 87-A10-189-040 | | CAP,E 220-10 | A..... |
| C | 119 | 87-A10-586-040 | | CAP,E 47-35 7L SR | A..... |
| C | 128 | 87-010-178-080 | | CHIP CAP 1000P | A..... |
| C | 129 | 87-010-194-080 | | CAP, CHIP 0.047 | A..... |
| C | 125 | 87-010-196-080 | | CHIP CAPACITOR,0.1-25 | A..... |
| C | 123 | 87-010-196-080 | | CHIP CAPACITOR,0.1-25 | A..... |
| C | 122 | 87-010-197-080 | | CAP, CHIP 0.01 DM | A..... |
| C | 121 | 87-015-699-040 | | CAP,E 10-50 7L | A..... |
| C | 120 | 87-015-699-040 | | CAP,E 10-50 7L | A..... |
| C | 130 | 87-010-264-040 | | CAP,E 100-10 5L | A..... |
| C | 150 | 87-010-194-080 | | CAP, CHIP 0.047 | A..... |
| C | 151 | 87-010-194-080 | | CAP, CHIP 0.047 | A..... |
| C | 162 | 87-010-182-080 | | C-CAP,S 2200P-50 B | A..... |
| C | 161 | 87-010-197-080 | | CAP, CHIP 0.01 DM | A..... |
| C | 171 | 87-010-196-080 | | CHIP CAPACITOR,0.1-25 | A..... |

ELECTRICAL MAIN PARTS LIST - 2/9

| | | | | |
|-----|-----|----------------|-------------------------|--------|
| C | 196 | 87-010-194-080 | CAP, CHIP 0.047 | A..... |
| C | 197 | 87-010-194-080 | CAP, CHIP 0.047 | A..... |
| C | 213 | 87-A10-189-040 | CAP, E 220-10 | A..... |
| C | 357 | 87-010-196-080 | CHIP CAPACITOR, 0.1-25 | A..... |
| C | 355 | 87-010-196-080 | CHIP CAPACITOR, 0.1-25 | A..... |
| C | 356 | 87-010-196-080 | CHIP CAPACITOR, 0.1-25 | A..... |
| C | 353 | 87-010-196-080 | CHIP CAPACITOR, 0.1-25 | A..... |
| C | 352 | 87-010-196-080 | CHIP CAPACITOR, 0.1-25 | A..... |
| C | 354 | 87-010-196-080 | CHIP CAPACITOR, 0.1-25 | A..... |
| C | 351 | 87-012-158-080 | C-CAP, S 390P-50 CH | A..... |
| C | 401 | 87-010-196-080 | CHIP CAPACITOR, 0.1-25 | A..... |
| C | 407 | 87-010-322-080 | C-CAP, S 100P-50 CH | A..... |
| C | 410 | 87-010-196-080 | CHIP CAPACITOR, 0.1-25 | A..... |
| C | 417 | 87-010-322-080 | C-CAP, S 100P-50 CH | A..... |
| C | 502 | 87-010-182-080 | C-CAP, S 2200P-50 B | A..... |
| C | 501 | 87-010-197-080 | CAP, CHIP 0.01 DM | A..... |
| C | 531 | 87-010-196-080 | CHIP CAPACITOR, 0.1-25 | A..... |
| C | 532 | 87-010-196-080 | CHIP CAPACITOR, 0.1-25 | A..... |
| C | 701 | 87-010-981-040 | CAP, E 22-35 5L SRE | A..... |
| C | 904 | 87-010-176-080 | C-CAP, S 680P-50 SL | A..... |
| C | 906 | 87-010-176-080 | C-CAP, S 680P-50 SL | A..... |
| C | 902 | 87-010-176-080 | C-CAP, S 680P-50 SL | A..... |
| C | 907 | 87-010-176-080 | C-CAP, S 680P-50 SL | A..... |
| C | 909 | 87-010-176-080 | C-CAP, S 680P-50 SL | A..... |
| C | 903 | 87-010-176-080 | C-CAP, S 680P-50 SL | A..... |
| C | 905 | 87-010-176-080 | C-CAP, S 680P-50 SL | A..... |
| C | 908 | 87-010-176-080 | C-CAP, S 680P-50 SL | A..... |
| C | 901 | 87-012-157-080 | C-CAP, S 330P-50 CH | A..... |
| C | 913 | 87-010-176-080 | C-CAP, S 680P-50 SL | A..... |
| C | 910 | 87-010-176-080 | C-CAP, S 680P-50 SL | A..... |
| C | 912 | 87-010-176-080 | C-CAP, S 680P-50 SL | A..... |
| C | 911 | 87-010-176-080 | C-CAP, S 680P-50 SL | A..... |
| CN | 102 | 87-099-029-010 | CONN, 12P 6216H | A..... |
| CN | 101 | 87-099-720-010 | CONN, 30P TYK-B(P) | A..... |
| CN | 301 | 87-099-202-010 | CONN, 9P 6216 H | A..... |
| CN | 302 | 87-A60-078-010 | CONN, 09P H 9604S-09F | A..... |
| CN | 501 | 87-099-201-010 | CONN, 8P 6216 H | A..... |
| CN | 502 | 87-A60-059-010 | CONN, 08P V 9604S-08C | A..... |
| CN | 701 | 87-099-750-010 | CONN, 15P V 9604SC | A..... |
| D | 102 | 87-020-465-080 | DIODE, 1SS133 (110MA) | A..... |
| D | 106 | 87-020-465-080 | DIODE, 1SS133 (110MA) | A..... |
| D | 108 | 87-020-465-080 | DIODE, 1SS133 (110MA) | A..... |
| D | 104 | 87-020-465-080 | DIODE, 1SS133 (110MA) | A..... |
| D | 103 | 87-020-465-080 | DIODE, 1SS133 (110MA) | A..... |
| D | 101 | 87-020-465-080 | DIODE, 1SS133 (110MA) | A..... |
| D | 107 | 87-A40-270-080 | C-DIODE, MC2838 | A..... |
| D | 109 | 87-A40-440-080 | ZENER, MTZJ7.5A | A..... |
| D | 114 | 87-020-465-080 | DIODE, 1SS133 (110MA) | A..... |
| D | 115 | 87-020-465-080 | DIODE, 1SS133 (110MA) | A..... |
| D | 110 | 87-020-465-080 | DIODE, 1SS133 (110MA) | A..... |
| D | 113 | 87-020-465-080 | DIODE, 1SS133 (110MA) | A..... |
| D | 251 | 87-020-465-080 | DIODE, 1SS133 (110MA) | A..... |
| D | 308 | 87-020-465-080 | DIODE, 1SS133 (110MA) | A..... |
| D | 307 | 87-020-465-080 | DIODE, 1SS133 (110MA) | A..... |
| D | 301 | 87-020-465-080 | DIODE, 1SS133 (110MA) | A..... |
| D | 303 | 87-020-465-080 | DIODE, 1SS133 (110MA) | A..... |
| D | 302 | 87-020-465-080 | DIODE, 1SS133 (110MA) | A..... |
| D | 306 | 87-020-465-080 | DIODE, 1SS133 (110MA) | A..... |
| D | 305 | 87-020-465-080 | DIODE, 1SS133 (110MA) | A..... |
| D | 304 | 87-020-465-080 | DIODE, 1SS133 (110MA) | A..... |
| D | 310 | 87-017-932-080 | ZENER, MTJ6.2B | A..... |
| D | 313 | 87-020-465-080 | DIODE, 1SS133 (110MA) | A..... |
| D | 316 | 87-020-465-080 | DIODE, 1SS133 (110MA) | A..... |
| D | 336 | 87-020-465-080 | DIODE, 1SS133 (110MA) | A..... |
| D | 331 | 87-020-465-080 | DIODE, 1SS133 (110MA) | A..... |
| D | 332 | 87-020-465-080 | DIODE, 1SS133 (110MA) | A..... |
| D | 337 | 87-020-465-080 | DIODE, 1SS133 (110MA) | A..... |
| D | 334 | 87-020-465-080 | DIODE, 1SS133 (110MA) | A..... |
| D | 333 | 87-020-465-080 | DIODE, 1SS133 (110MA) | A..... |
| D | 335 | 87-020-465-080 | DIODE, 1SS133 (110MA) | A..... |
| D | 338 | 87-020-465-080 | DIODE, 1SS133 (110MA) | A..... |
| D | 354 | 87-020-465-080 | DIODE, 1SS133 (110MA) | A..... |
| D | 352 | 87-020-465-080 | DIODE, 1SS133 (110MA) | A..... |
| D | 353 | 87-020-465-080 | DIODE, 1SS133 (110MA) | A..... |
| D | 351 | 87-020-465-080 | DIODE, 1SS133 (110MA) | A..... |
| D | 701 | 87-A40-269-080 | C-DIODE, MC2836 | A..... |
| FL | 101 | 8Z-NF3-611-010 | FL, BJ680GK-ZNF3 | A..... |
| IC | 102 | 87-A20-914-010 | IC, SPS-442-1-F | A..... |
| IC | 101 | 8Z-NH3-605-010 | C-IC, LC876580W-ZNH3 | A..... |
| IC | 380 | 87-A21-023-040 | C-IC, BA3835F | A..... |
| IC | 402 | 87-A21-021-040 | C-IC, BU2099FV | A..... |
| IC | 401 | 87-A21-021-040 | C-IC, BU2099FV | A..... |
| JR | 120 | 83-XM1-617-080 | C-COIL, BK2125HM601 | A..... |
| JW | 101 | 82-226-689-080 | COIL, 2.2MH J | A..... |
| L | 101 | 87-A50-333-010 | COIL, OSC 9.43MHZ | A..... |
| LED | 101 | 87-A40-589-040 | LED, SLR-56VCT31 RED | A..... |
| LED | 313 | 87-A40-317-080 | LED, SLR-342VCT31 RED | A..... |
| LED | 314 | 87-A40-317-080 | LED, SLR-342VCT31 RED | A..... |
| LED | 311 | 87-A40-317-080 | LED, SLR-342VCT31 RED | A..... |
| LED | 312 | 87-A40-317-080 | LED, SLR-342VCT31 RED | A..... |
| LED | 315 | 87-A40-317-080 | LED, SLR-342VCT31 RED | A..... |
| LED | 331 | 87-A40-563-010 | LED, SEL6515C-LF62 PGRN | A..... |

ELECTRICAL MAIN PARTS LIST - 3/9

| | | | | | |
|-----|-----|----------------|-------------------------|---------|--------|
| LED | 332 | 87-A40-563-010 | LED,SEL6515C-LF62 | PGRN | A..... |
| LED | 333 | 87-A40-563-010 | LED,SEL6515C-LF62 | PGRN | A..... |
| LED | 353 | 87-A40-563-010 | LED,SEL6515C-LF62 | PGRN | A..... |
| LED | 352 | 87-A40-563-010 | LED,SEL6515C-LF62 | PGRN | A..... |
| LED | 351 | 87-A40-563-010 | LED,SEL6515C-LF62 | PGRN | A..... |
| LED | 423 | 87-070-278-010 | LED,SLZ-738A-24-S | | A..... |
| LED | 426 | 87-070-278-010 | LED,SLZ-738A-24-S | | A..... |
| LED | 421 | 87-070-278-010 | LED,SLZ-738A-24-S | | A..... |
| LED | 424 | 87-070-278-010 | LED,SLZ-738A-24-S | | A..... |
| LED | 425 | 87-070-290-010 | LED,SLZ 936-30-S | | A..... |
| LED | 422 | 87-070-290-010 | LED,SLZ 936-30-S | | A..... |
| LED | 444 | 87-A40-619-040 | LED,SLR-56PT-T31-W | GRN | A..... |
| LED | 449 | 87-A40-619-040 | LED,SLR-56PT-T31-W | GRN | A..... |
| LED | 441 | 87-A40-619-040 | LED,SLR-56PT-T31-W | GRN | A..... |
| LED | 447 | 87-A40-619-040 | LED,SLR-56PT-T31-W | GRN | A..... |
| LED | 443 | 87-A40-619-040 | LED,SLR-56PT-T31-W | GRN | A..... |
| LED | 448 | 87-A40-619-040 | LED,SLR-56PT-T31-W | GRN | A..... |
| LED | 445 | 87-A40-619-040 | LED,SLR-56PT-T31-W | GRN | A..... |
| LED | 440 | 87-A40-619-040 | LED,SLR-56PT-T31-W | GRN | A..... |
| LED | 446 | 87-A40-619-040 | LED,SLR-56PT-T31-W | GRN | A..... |
| LED | 442 | 87-A40-619-040 | LED,SLR-56PT-T31-W | GRN | A..... |
| LED | 451 | 87-A40-619-040 | LED,SLR-56PT-T31-W | GRN | A..... |
| LED | 455 | 87-A40-619-040 | LED,SLR-56PT-T31-W | GRN | A..... |
| LED | 452 | 87-A40-619-040 | LED,SLR-56PT-T31-W | GRN | A..... |
| LED | 454 | 87-A40-619-040 | LED,SLR-56PT-T31-W | GRN | A..... |
| LED | 453 | 87-A40-619-040 | LED,SLR-56PT-T31-W | GRN | A..... |
| LED | 456 | 87-A40-619-040 | LED,SLR-56PT-T31-W | GRN | A..... |
| LED | 462 | 87-A40-317-080 | LED,SLR-342VCT31 | RED | A..... |
| LED | 464 | 87-A40-317-080 | LED,SLR-342VCT31 | RED | A..... |
| LED | 463 | 87-A40-317-080 | LED,SLR-342VCT31 | RED | A..... |
| LED | 461 | 87-A40-317-080 | LED,SLR-342VCT31 | RED | A..... |
| LED | 465 | 87-A40-317-080 | LED,SLR-342VCT31 | RED | A..... |
| LED | 521 | 87-A40-640-010 | LED,SELU1E10CXM | BLUE-EF | A..... |
| LED | 522 | 87-A40-640-010 | LED,SELU1E10CXM | BLUE-EF | A..... |
| Q | 104 | 87-026-610-080 | TR,KTC3198GR | | A..... |
| Q | 108 | 87-A30-073-080 | C-TR,RT1N 141C | | A..... |
| Q | 102 | 87-A30-087-080 | C-FET,2SK2158 | | A..... |
| Q | 101 | 87-A30-087-080 | C-FET,2SK2158 | | A..... |
| Q | 109 | 87-A30-087-080 | C-FET,2SK2158 | | A..... |
| Q | 301 | 87-A30-276-040 | C-TR,DTA143EKA | | A..... |
| Q | 311 | 87-A30-075-080 | C-TR,2SA1235F | | A..... |
| Q | 401 | 87-A30-075-080 | C-TR,2SA1235F | | A..... |
| Q | 703 | 87-A30-159-080 | C-TR,KTA1298Y | | A..... |
| Q | 702 | 87-A30-159-080 | C-TR,KTA1298Y | | A..... |
| Q | 701 | 87-A30-240-080 | TR,CSA1585BC | | A..... |
| S | 201 | 87-A90-095-080 | SW,TACT EVQ11G04M | | A..... |
| S | 214 | 87-A90-095-080 | SW,TACT EVQ11G04M | | A..... |
| S | 216 | 87-A90-095-080 | SW,TACT EVQ11G04M | | A..... |
| S | 217 | 87-A90-095-080 | SW,TACT EVQ11G04M | | A..... |
| S | 213 | 87-A90-095-080 | SW,TACT EVQ11G04M | | A..... |
| S | 218 | 87-A90-095-080 | SW,TACT EVQ11G04M | | A..... |
| S | 215 | 87-A90-095-080 | SW,TACT EVQ11G04M | | A..... |
| S | 211 | 87-A90-095-080 | SW,TACT EVQ11G04M | | A..... |
| S | 212 | 87-A90-095-080 | SW,TACT EVQ11G04M | | A..... |
| S | 219 | 87-A90-095-080 | SW,TACT EVQ11G04M | | A..... |
| S | 221 | 87-A90-095-080 | SW,TACT EVQ11G04M | | A..... |
| S | 224 | 87-A90-095-080 | SW,TACT EVQ11G04M | | A..... |
| S | 220 | 87-A90-095-080 | SW,TACT EVQ11G04M | | A..... |
| S | 223 | 87-A90-095-080 | SW,TACT EVQ11G04M | | A..... |
| S | 222 | 87-A90-095-080 | SW,TACT EVQ11G04M | | A..... |
| S | 225 | 87-A90-095-080 | SW,TACT EVQ11G04M | | A..... |
| S | 231 | 87-A90-095-080 | SW,TACT EVQ11G04M | | A..... |
| S | 232 | 87-A90-095-080 | SW,TACT EVQ11G04M | | A..... |
| S | 233 | 87-A90-095-080 | SW,TACT EVQ11G04M | | A..... |
| S | 234 | 87-A90-095-080 | SW,TACT EVQ11G04M | | A..... |
| S | 252 | 87-A90-095-080 | SW,TACT EVQ11G04M | | A..... |
| S | 258 | 87-A90-095-080 | SW,TACT EVQ11G04M | | A..... |
| S | 259 | 87-A90-095-080 | SW,TACT EVQ11G04M | | A..... |
| S | 253 | 87-A90-095-080 | SW,TACT EVQ11G04M | | A..... |
| S | 251 | 87-A90-095-080 | SW,TACT EVQ11G04M | | A..... |
| S | 255 | 87-A90-095-080 | SW,TACT EVQ11G04M | | A..... |
| S | 257 | 87-A90-095-080 | SW,TACT EVQ11G04M | | A..... |
| S | 256 | 87-A90-095-080 | SW,TACT EVQ11G04M | | A..... |
| S | 254 | 87-A90-095-080 | SW,TACT EVQ11G04M | | A..... |
| S | 260 | 87-A90-095-080 | SW,TACT EVQ11G04M | | A..... |
| S | 261 | 87-A90-095-080 | SW,TACT EVQ11G04M | | A..... |
| S | 262 | 87-A90-095-080 | SW,TACT EVQ11G04M | | A..... |
| S | 263 | 87-A90-095-080 | SW,TACT EVQ11G04M | | A..... |
| S | 310 | 87-A90-095-080 | SW,TACT EVQ11G04M | | A..... |
| S | 317 | 87-A90-095-080 | SW,TACT EVQ11G04M | | A..... |
| S | 311 | 87-A90-095-080 | SW,TACT EVQ11G04M | | A..... |
| S | 318 | 87-A90-095-080 | SW,TACT EVQ11G04M | | A..... |
| S | 313 | 87-A90-095-080 | SW,TACT EVQ11G04M | | A..... |
| S | 319 | 87-A90-095-080 | SW,TACT EVQ11G04M | | A..... |
| S | 315 | 87-A90-095-080 | SW,TACT EVQ11G04M | | A..... |
| S | 312 | 87-A90-095-080 | SW,TACT EVQ11G04M | | A..... |
| S | 314 | 87-A90-095-080 | SW,TACT EVQ11G04M | | A..... |
| S | 316 | 87-A90-095-080 | SW,TACT EVQ11G04M | | A..... |
| S | 320 | 87-A90-095-080 | SW,TACT EVQ11G04M | | A..... |
| S | 501 | 87-A91-111-010 | SW,RTRY EC12E12404-20MM | | A..... |
| S | 514 | 87-A90-095-080 | SW,TACT EVQ11G04M | | A..... |
| S | 519 | 87-A90-095-080 | SW,TACT EVQ11G04M | | A..... |

ELECTRICAL MAIN PARTS LIST - 4/9

| | | | | |
|----|-----|----------------|-------------------------|--------|
| S | 517 | 87-A90-095-080 | SW,TACT EVQ11G04M | A..... |
| S | 513 | 87-A90-095-080 | SW,TACT EVQ11G04M | A..... |
| S | 518 | 87-A90-095-080 | SW,TACT EVQ11G04M | A..... |
| S | 515 | 87-A90-095-080 | SW,TACT EVQ11G04M | A..... |
| S | 511 | 87-A90-095-080 | SW,TACT EVQ11G04M | A..... |
| S | 516 | 87-A90-095-080 | SW,TACT EVQ11G04M | A..... |
| S | 512 | 87-A90-095-080 | SW,TACT EVQ11G04M | A..... |
| S | 520 | 87-A90-095-080 | SW,TACT EVQ11G04M | A..... |
| SW | 101 | 87-A90-535-010 | SW,RTRY EC16B24304 | A..... |
| C | 806 | 87-010-071-040 | CAP,E 1-50 M 5L SRE | A..... |
| C | 802 | 87-010-176-080 | C-CAP,S 680P-50 SL | A..... |
| C | 803 | 87-010-187-080 | CAP CHIP S5600P | A..... |
| C | 807 | 87-010-196-080 | CHIP CAPACITOR,0.1-25 | A..... |
| C | 805 | 87-010-197-080 | CAP, CHIP 0.01 DM | A..... |
| C | 804 | 87-010-213-080 | C-CAP,S 0.015-50 B | A..... |
| C | 809 | 87-012-155-080 | C-CAP 180P-50CH | A..... |
| C | 801 | 87-012-156-080 | C-CAP,S 220P-50 CH | A..... |
| C | 812 | 87-010-060-040 | CAP,E 100-16 | A..... |
| C | 810 | 87-010-561-040 | CAP,E 100-16 GAS | A..... |
| C | 811 | 87-015-682-040 | CAP,E 22-16 7L | A..... |
| C | 821 | 87-010-197-080 | CAP, CHIP 0.01 DM | A..... |
| C | 823 | 87-010-197-080 | CAP, CHIP 0.01 DM | A..... |
| C | 822 | 87-015-819-080 | CAPACITOR,0.01 | A..... |
| C | 833 | 87-010-322-080 | C-CAP,S 100P-50 CH | A..... |
| D | 801 | 87-017-931-080 | ZENER,MTZJ5.6B | A..... |
| IC | 801 | 87-A21-051-040 | C-IC,BU9990-03FS | A..... |
| L | 801 | 87-A50-093-010 | COIL,CLOCK 5.76MHZ | A..... |
| C | 307 | 87-010-196-080 | CHIP CAPACITOR,0.1-25 | A..... |
| C | 302 | 87-010-318-080 | C-CAP,S 47P-50 CH | A..... |
| C | 301 | 87-010-318-080 | C-CAP,S 47P-50 CH | A..... |
| C | 306 | 87-012-145-080 | CAP, CHIP S 270P CH | A..... |
| C | 305 | 87-012-145-080 | CAP, CHIP S 270P CH | A..... |
| C | 303 | 87-012-157-080 | C-CAP,S 330P-50 CH | A..... |
| C | 304 | 87-012-157-080 | C-CAP,S 330P-50 CH | A..... |
| C | 316 | 87-010-179-080 | CAP,CHIP S B1200P | A..... |
| C | 315 | 87-010-179-080 | CAP,CHIP S B1200P | A..... |
| C | 314 | 87-010-180-080 | C-CER 1500P | A..... |
| C | 313 | 87-010-180-080 | C-CER 1500P | A..... |
| C | 311 | 87-010-198-080 | CAP, CHIP 0.022 | A..... |
| C | 312 | 87-010-198-080 | CAP, CHIP 0.022 | A..... |
| C | 319 | 87-012-141-080 | CHIP-CAPACITOR,0.22-16F | A..... |
| C | 318 | 87-012-142-080 | CAP, S 0.33-16 | A..... |
| C | 317 | 87-012-142-080 | CAP, S 0.33-16 | A..... |
| C | 324 | 87-010-260-080 | CAP, ELECT 47-25V | A..... |
| C | 325 | 87-010-370-080 | CAP,E 330-6.3 SME | A..... |
| C | 327 | 87-010-404-080 | CAP, ELECT 4.7-50V | A..... |
| C | 328 | 87-010-404-080 | CAP, ELECT 4.7-50V | A..... |
| C | 320 | 87-012-141-080 | CHIP-CAPACITOR,0.22-16F | A..... |
| C | 322 | 87-012-142-080 | CAP, S 0.33-16 | A..... |
| C | 321 | 87-012-142-080 | CAP, S 0.33-16 | A..... |
| C | 339 | 87-010-196-080 | CHIP CAPACITOR,0.1-25 | A..... |
| C | 332 | 87-010-196-080 | CHIP CAPACITOR,0.1-25 | A..... |
| C | 337 | 87-010-196-080 | CHIP CAPACITOR,0.1-25 | A..... |
| C | 336 | 87-010-401-080 | CAP, ELECT 1-50V | A..... |
| C | 335 | 87-010-401-080 | CAP, ELECT 1-50V | A..... |
| C | 340 | 87-010-196-080 | CHIP CAPACITOR,0.1-25 | A..... |
| C | 354 | 87-010-175-080 | CAP 560P | A..... |
| C | 358 | 87-010-183-080 | C-CAP,S 2700P-50 B | A..... |
| C | 359 | 87-010-183-080 | C-CAP,S 2700P-50 B | A..... |
| C | 357 | 87-010-197-080 | CAP, CHIP 0.01 DM | A..... |
| C | 356 | 87-010-260-080 | CAP, ELECT 47-25V | A..... |
| C | 352 | 87-012-140-080 | CAP 470P | A..... |
| C | 351 | 87-012-140-080 | CAP 470P | A..... |
| C | 355 | 87-012-349-080 | C-CAP,S 1000P-50 CH | A..... |
| C | 360 | 87-010-183-080 | C-CAP,S 2700P-50 B | A..... |
| C | 363 | 87-A10-772-080 | CAP,M 5600P-50 J | A..... |
| C | 372 | 87-010-175-080 | CAP 560P | A..... |
| C | 371 | 87-010-175-080 | CAP 560P | A..... |
| C | 374 | 87-010-179-080 | CAP,CHIP S B1200P | A..... |
| C | 373 | 87-010-179-080 | CAP,CHIP S B1200P | A..... |
| C | 378 | 87-010-196-080 | CHIP CAPACITOR,0.1-25 | A..... |
| C | 370 | 87-010-196-080 | CHIP CAPACITOR,0.1-25 | A..... |
| C | 376 | 87-010-545-080 | CAP, ELECT 0.22-50V | A..... |
| C | 375 | 87-010-545-080 | CAP, ELECT 0.22-50V | A..... |
| C | 385 | 87-010-184-080 | CHIP CAPACITOR 3300P(K) | A..... |
| C | 386 | 87-010-196-080 | CHIP CAPACITOR,0.1-25 | A..... |
| C | 381 | 87-010-197-080 | CAP, CHIP 0.01 DM | A..... |
| C | 383 | 87-010-197-080 | CAP, CHIP 0.01 DM | A..... |
| C | 382 | 87-010-318-080 | C-CAP,S 47P-50 CH | A..... |
| C | 384 | 87-010-402-080 | CAP, ELECT 2.2-50V | A..... |
| C | 388 | 87-012-156-080 | C-CAP,S 220P-50 CH | A..... |
| CN | 301 | 87-099-827-010 | CONN,3P S2M-3W | A..... |
| CN | 351 | 87-099-832-010 | CONN,8P S2M-3W | A..... |
| D | 352 | 87-A40-269-080 | C-DIODE,MC2836 | A..... |
| IC | 302 | 87-A20-355-010 | IC,CXA1553P | A..... |
| IC | 303 | 87-A20-783-040 | C-IC,BA7762AFS | A..... |
| L | 301 | 87-A50-049-010 | COIL,TRAP 85K(COI) | A..... |
| L | 302 | 87-A50-049-010 | COIL,TRAP 85K(COI) | A..... |
| L | 351 | 87-007-342-010 | COIL,OSC 85K BIAS | A..... |
| Q | 359 | 87-026-610-080 | TR,KTC3198GR | A..... |
| Q | 358 | 87-026-610-080 | TR,KTC3198GR | A..... |
| Q | 357 | 87-026-610-080 | TR,KTC3198GR | A..... |

ELECTRICAL MAIN PARTS LIST - 5/9

| | | | | |
|-----|-----|----------------|---------------------------|--------|
| Q | 354 | 87-A30-087-080 | C-FET,2SK2158 | A..... |
| Q | 351 | 87-A30-087-080 | C-FET,2SK2158 | A..... |
| Q | 353 | 87-A30-087-080 | C-FET,2SK2158 | A..... |
| Q | 355 | 87-A30-105-080 | C-TR,RT1P 441C | A..... |
| Q | 381 | 87-A30-076-080 | C-TR,2SC3052F | A..... |
| Q | 382 | 87-A30-076-080 | C-TR,2SC3052F | A..... |
| SFR | 304 | 87-024-355-080 | SFR,33K DIA6 H | A..... |
| SFR | 302 | 87-024-355-080 | SFR,33K DIA6 H | A..... |
| SFR | 303 | 87-024-355-080 | SFR,33K DIA6 H | A..... |
| SFR | 301 | 87-024-355-080 | SFR,33K DIA6 H | A..... |
| SFR | 305 | 87-024-356-080 | SFR,47K DIA6 H | A..... |
| SFR | 306 | 87-024-356-080 | SFR,47K DIA6 H | A..... |
| SFR | 352 | 87-024-356-080 | SFR,47K DIA6 H | A..... |
| SFR | 351 | 87-024-356-080 | SFR,47K DIA6 H | A..... |
| C | 407 | 87-010-188-080 | CAP,CHIP 6800P | A..... |
| C | 408 | 87-010-188-080 | CAP,CHIP 6800P | A..... |
| C | 401 | 87-010-196-080 | CHIP CAPACITOR,0.1-25 | A..... |
| C | 402 | 87-010-260-080 | CAP, ELECT 47-25V | A..... |
| C | 406 | 87-010-404-080 | CAP, ELECT 4.7-50V | A..... |
| C | 403 | 87-010-404-080 | CAP, ELECT 4.7-50V | A..... |
| C | 405 | 87-010-404-080 | CAP, ELECT 4.7-50V | A..... |
| C | 404 | 87-010-404-080 | CAP, ELECT 4.7-50V | A..... |
| C | 409 | 87-012-140-080 | CAP 470P | A..... |
| C | 415 | 87-010-197-080 | CAP, CHIP 0.01 DM | A..... |
| C | 416 | 87-010-197-080 | CAP, CHIP 0.01 DM | A..... |
| C | 419 | 87-010-260-080 | CAP, ELECT 47-25V | A..... |
| C | 412 | 87-010-404-080 | CAP, ELECT 4.7-50V | A..... |
| C | 414 | 87-010-404-080 | CAP, ELECT 4.7-50V | A..... |
| C | 413 | 87-010-404-080 | CAP, ELECT 4.7-50V | A..... |
| C | 411 | 87-010-404-080 | CAP, ELECT 4.7-50V | A..... |
| C | 417 | 87-010-956-080 | CHIP-CAP,S 0.068-25B | A..... |
| C | 418 | 87-010-956-080 | CHIP-CAP,S 0.068-25B | A..... |
| C | 410 | 87-012-140-080 | CAP 470P | A..... |
| D | 402 | 87-020-465-080 | DIODE,1SS133 (110MA) | A..... |
| D | 401 | 87-A40-269-080 | C-DIODE,MC2836 | A..... |
| IC | 401 | 87-A21-022-040 | C-IC,BA3880FS | A..... |
| C | 507 | 87-010-183-080 | C-CAP,S 2700P-50 B | A..... |
| C | 509 | 87-010-196-080 | CHIP CAPACITOR,0.1-25 | A..... |
| C | 505 | 87-012-145-080 | CAP, CHIP S 270P CH | A..... |
| C | 506 | 87-012-145-080 | CAP, CHIP S 270P CH | A..... |
| C | 503 | 87-012-154-080 | C-CAP,S 150P-50 CH | A..... |
| C | 504 | 87-012-154-080 | C-CAP,S 150P-50 CH | A..... |
| C | 502 | 87-A10-060-080 | C-CAP,S 0.18-16 K B | A..... |
| C | 501 | 87-A10-060-080 | C-CAP,S 0.18-16 K B | A..... |
| C | 511 | 87-010-177-080 | C-CAP,S 820P-50 SL | A..... |
| C | 510 | 87-010-177-080 | C-CAP,S 820P-50 SL | A..... |
| C | 517 | 87-010-183-080 | C-CAP,S 2700P-50 B | A..... |
| C | 512 | 87-010-196-080 | CHIP CAPACITOR,0.1-25 | A..... |
| C | 514 | 87-010-196-080 | CHIP CAPACITOR,0.1-25 | A..... |
| C | 515 | 87-010-263-080 | CAP, ELECT 100-10V | A..... |
| C | 513 | 87-010-380-080 | CAP, ELECT 47-16V | A..... |
| C | 527 | 87-010-196-080 | CHIP CAPACITOR,0.1-25 | A..... |
| C | 523 | 87-016-460-080 | C-CAP,S 0.22-16 B | A..... |
| C | 522 | 87-016-460-080 | C-CAP,S 0.22-16 B | A..... |
| C | 521 | 87-016-460-080 | C-CAP,S 0.22-16 B | A..... |
| CN | 502 | 87-099-566-010 | CONN,7P TUC-P7P-B1 | A..... |
| CN | 501 | 87-A60-689-010 | CONN,7P H GRY TUC-P07X-C1 | A..... |
| D | 501 | 87-070-136-080 | ZENER,MTZJ5.1B | A..... |
| IC | 501 | 87-A20-561-040 | C-IC,M65847AFP | A..... |
| C | 457 | 87-010-196-080 | CHIP CAPACITOR,0.1-25 | A..... |
| C | 458 | 87-010-196-080 | CHIP CAPACITOR,0.1-25 | A..... |
| C | 454 | 87-010-400-080 | CAP, ELECT 0.47-50V | A..... |
| C | 453 | 87-010-400-080 | CAP, ELECT 0.47-50V | A..... |
| C | 451 | 87-010-404-080 | CAP, ELECT 4.7-50V | A..... |
| C | 452 | 87-010-404-080 | CAP, ELECT 4.7-50V | A..... |
| C | 461 | 87-010-067-080 | CAP,E 0.1-50 5L | A..... |
| C | 463 | 87-010-546-080 | CAP, ELECT 0.33-50V | A..... |
| C | 464 | 87-010-546-080 | CAP, ELECT 0.33-50V | A..... |
| C | 465 | 87-A11-006-080 | CAP,M 0.033-50 J DE | A..... |
| C | 466 | 87-A11-006-080 | CAP,M 0.033-50 J DE | A..... |
| IC | 451 | 87-A21-031-040 | C-IC,BU4551BF | A..... |
| C | 6 | 87-012-368-080 | C-CAP,S 0.1-50 F | A..... |
| C | 5 | 87-012-368-080 | C-CAP,S 0.1-50 F | A..... |
| C | 3 | 87-012-368-080 | C-CAP,S 0.1-50 F | A..... |
| C | 4 | 87-012-368-080 | C-CAP,S 0.1-50 F | A..... |
| C | 1 | 87-012-369-080 | C-CAP,S 0.047-50F | A..... |
| C | 2 | 87-012-369-080 | C-CAP,S 0.047-50F | A..... |
| C | 9 | 87-016-658-090 | CAP,E 4700-35 SMG | A..... |
| C | 10 | 87-016-658-090 | CAP,E 4700-35 SMG | A..... |
| C | 29 | 87-010-247-080 | CAP, ELECT 100-50V | A..... |
| C | 24 | 87-010-247-080 | CAP, ELECT 100-50V | A..... |
| C | 23 | 87-010-247-080 | CAP, ELECT 100-50V | A..... |
| C | 26 | 87-010-263-080 | CAP, ELECT 100-10V | A..... |
| C | 21 | 87-010-385-080 | CAP, ELECT 220-25V | A..... |
| C | 22 | 87-010-385-080 | CAP, ELECT 220-25V | A..... |
| C | 25 | 87-010-430-080 | CAP, ELECT 100-63 | A..... |
| C | 27 | 87-012-140-080 | CAP 470P | A..... |
| C | 30 | 87-010-112-080 | CAP, ELECT 100-16V | A..... |
| C | 31 | 87-010-235-080 | CAP,E 470-16 SME | A..... |
| C | 61 | 87-010-234-080 | CAP 47-16 | A..... |
| C | 62 | 87-010-415-080 | CAP ELE SRE 10-50V | A..... |
| C | 92 | 87-010-263-080 | CAP, ELECT 100-10V | A..... |

ELECTRICAL MAIN PARTS LIST - 6/9

| | | | | |
|-----|-----|----------------|---------------------------|--------|
| C | 93 | 87-010-380-080 | CAP, ELECT 47-16V | A..... |
| C | 91 | 87-010-401-080 | CAP, ELECT 1-50V | A..... |
| CN | 1 | 87-A60-739-010 | CONN,13P JL-BT | A..... |
| CN | 92 | 87-A60-109-010 | CONN,2P V S2M-2W | A..... |
| CN | 91 | 87-A60-109-010 | CONN,2P V S2M-2W | A..... |
| CNA | 1 | 8Z-NF3-645-010 | CONN ASSY,9P VH | A..... |
| D | 9 | 87-020-465-080 | DIODE,1SS133 (110MA) | A..... |
| D | 8 | 87-020-465-080 | DIODE,1SS133 (110MA) | A..... |
| D | 1 | 87-A40-224-010 | DIODE,GBU8D | A..... |
| D | 7 | 87-A40-503-080 | ZENER,MTZJ39B | A..... |
| D | 6 | 87-A40-553-080 | DIODE,1N4003 LES | A..... |
| D | 5 | 87-A40-553-080 | DIODE,1N4003 LES | A..... |
| D | 4 | 87-A40-553-080 | DIODE,1N4003 LES | A..... |
| D | 3 | 87-A40-553-080 | DIODE,1N4003 LES | A..... |
| D | 10 | 87-A40-345-080 | ZENER,MTZJ10C | A..... |
| D | 64 | 87-070-274-080 | DIODE,1N4003 SEM | A..... |
| D | 63 | 87-A40-004-080 | ZENER,MTZJ16A | A..... |
| D | 62 | 87-A40-269-080 | C-DIODE,MC2836 | A..... |
| D | 61 | 87-A40-270-080 | C-DIODE,MC2838 | A..... |
| D | 91 | 87-020-465-080 | DIODE,1SS133 (110MA) | A..... |
| D | 92 | 87-020-465-080 | DIODE,1SS133 (110MA) | A..... |
| Q | 2 | 87-026-609-080 | TR,KTA1266GR | A..... |
| Q | 1 | 87-026-609-080 | TR,KTA1266GR | A..... |
| Q | 2 | 87-026-609-080 | TR,KTA1266GR | A..... |
| Q | 1 | 87-026-609-080 | TR,KTA1266GR | A..... |
| Q | 5 | 87-026-610-080 | TR,KTC3198GR | A..... |
| Q | 8 | 87-A30-075-080 | C-TR,2SA1235F | A..... |
| Q | 6 | 87-A30-076-080 | C-TR,2SC3052F | A..... |
| Q | 9 | 87-A30-196-080 | TR,2SC4115SRS | A..... |
| Q | 66 | 87-A30-075-080 | C-TR,2SA1235F | A..... |
| Q | 64 | 87-A30-075-080 | C-TR,2SA1235F | A..... |
| Q | 67 | 87-A30-076-080 | C-TR,2SC3052F | A..... |
| Q | 65 | 87-A30-076-080 | C-TR,2SC3052F | A..... |
| Q | 63 | 87-A30-076-080 | C-TR,2SC3052F | A..... |
| Q | 91 | 87-A30-076-080 | C-TR,2SC3052F | A..... |
| Q | 92 | 87-A30-240-080 | TR,CSA1585BC | A..... |
| WH | 1 | 87-A90-510-010 | HLLDR,WIRE 2.5-9P | A..... |
| C | 101 | 87-010-182-080 | C-CAP,S 2200P-50 B | A..... |
| C | 102 | 87-010-182-080 | C-CAP,S 2200P-50 B | A..... |
| C | 127 | 87-012-368-080 | C-CAP,S 0.1-50 F | A..... |
| C | 126 | 87-012-368-080 | C-CAP,S 0.1-50 F | A..... |
| C | 125 | 87-012-368-080 | C-CAP,S 0.1-50 F | A..... |
| C | 128 | 87-012-368-080 | C-CAP,S 0.1-50 F | A..... |
| C | 134 | 87-010-498-080 | CAP,E 10-16 GAS | A..... |
| J | 203 | 87-A60-238-010 | TERMINAL,SP 4P (MSC) | A..... |
| J | 201 | 87-A60-483-010 | JACK,DIA6.3 BLK ST W/S KM | A..... |
| JW | 112 | 87-A90-896-080 | F-BEAD,035600STY7 | A..... |
| L | 102 | 87-003-383-010 | COIL,1UH-S | A..... |
| L | 101 | 87-003-383-010 | COIL,1UH-S | A..... |
| Q | 101 | 87-A30-257-080 | C-TR,2SD1306E | A..... |
| Q | 102 | 87-A30-257-080 | C-TR,2SD1306E | A..... |
| Q | 127 | 87-A30-075-080 | C-TR,2SA1235F | A..... |
| R | 144 | 87-A00-443-050 | RES,390-1/2W J RP | A..... |
| R | 146 | 87-A00-443-050 | RES,390-1/2W J RP | A..... |
| R | 145 | 87-A00-443-050 | RES,390-1/2W J RP | A..... |
| R | 143 | 87-A00-443-050 | RES,390-1/2W J RP | A..... |
| C | 203 | 87-010-178-080 | CHIP CAP 1000P | A..... |
| C | 204 | 87-010-178-080 | CHIP CAP 1000P | A..... |
| C | 229 | 87-010-993-080 | C-CAP,S 0.056-25 B | A..... |
| C | 239 | 87-010-196-080 | CHIP CAPACITOR,0.1-25 | A..... |
| C | 231 | 87-010-196-080 | CHIP CAPACITOR,0.1-25 | A..... |
| C | 232 | 87-010-196-080 | CHIP CAPACITOR,0.1-25 | A..... |
| C | 230 | 87-010-993-080 | C-CAP,S 0.056-25 B | A..... |
| C | 236 | 87-016-285-080 | CAP,E 47-100SME | A..... |
| C | 235 | 87-016-285-080 | CAP,E 47-100SME | A..... |
| CN | 201 | 87-A60-739-010 | CONN,13P JL-BT | A..... |
| D | 212 | 87-020-465-080 | DIODE,1SS133 (110MA) | A..... |
| J | 206 | 87-A60-750-010 | JACK,PIN 4P R/W BLUE | A..... |
| L | 201 | 87-003-383-010 | COIL,1UH-S | A..... |
| L | 202 | 87-003-383-010 | COIL,1UH-S | A..... |
| Q | 202 | 87-A30-257-080 | C-TR,2SD1306E | A..... |
| Q | 201 | 87-A30-257-080 | C-TR,2SD1306E | A..... |
| Q | 221 | 87-A30-073-080 | C-TR,RT1N 141C | A..... |
| RY | 201 | 87-045-382-010 | RELAY,OUAZ-SH-112L | A..... |
| C | 601 | 87-010-183-080 | C-CAP,S 2700P-50 B | A..... |
| C | 602 | 87-010-183-080 | C-CAP,S 2700P-50 B | A..... |
| C | 607 | 87-010-318-080 | C-CAP,S 47P-50 CH | A..... |
| C | 606 | 87-010-318-080 | C-CAP,S 47P-50 CH | A..... |
| C | 605 | 87-010-318-080 | C-CAP,S 47P-50 CH | A..... |
| C | 608 | 87-010-318-080 | C-CAP,S 47P-50 CH | A..... |
| C | 619 | 87-010-185-080 | C-CAP,S 3900P-50 B | A..... |
| C | 614 | 87-016-081-080 | C-CAP,S 0.1-16 RK | A..... |
| C | 613 | 87-016-081-080 | C-CAP,S 0.1-16 RK | A..... |
| C | 618 | 87-A11-009-080 | CAP,M 0.068-50 J DE | A..... |
| C | 617 | 87-A11-009-080 | CAP,M 0.068-50 J DE | A..... |
| C | 615 | 87-A11-011-080 | CAP,M 0.12-50 J DE | A..... |
| C | 616 | 87-A11-011-080 | CAP,M 0.12-50 J DE | A..... |
| C | 620 | 87-010-185-080 | C-CAP,S 3900P-50 B | A..... |
| C | 621 | 87-010-401-080 | CAP, ELECT 1-50V | A..... |
| C | 622 | 87-010-401-080 | CAP, ELECT 1-50V | A..... |
| C | 625 | 87-010-405-080 | CAP, ELECT 10-50V | A..... |
| C | 626 | 87-010-405-080 | CAP, ELECT 10-50V | A..... |

ELECTRICAL MAIN PARTS LIST - 7/9

| | | | | |
|----|-----|----------------|----------------------------|--------|
| C | 629 | 87-010-405-080 | CAP, ELECT 10-50V | A..... |
| C | 623 | 87-A10-773-080 | CAP,M 0.10-50 J | A..... |
| C | 624 | 87-A10-773-080 | CAP,M 0.10-50 J | A..... |
| C | 637 | 87-010-183-080 | C-CAP,S 2700P-50 B | A..... |
| C | 635 | 87-010-196-080 | CHIP CAPACITOR,0.1-25 | A..... |
| C | 634 | 87-010-196-080 | CHIP CAPACITOR,0.1-25 | A..... |
| C | 630 | 87-010-213-080 | C-CAP,S 0.015-50 B | A..... |
| C | 633 | 87-010-263-080 | CAP, ELECT 100-10V | A..... |
| C | 632 | 87-010-263-080 | CAP, ELECT 100-10V | A..... |
| C | 631 | 87-010-992-080 | C-CAP,S 0.047-25 B | A..... |
| C | 636 | 87-010-992-080 | C-CAP,S 0.047-25 B | A..... |
| C | 641 | 87-010-196-080 | CHIP CAPACITOR,0.1-25 | A..... |
| C | 640 | 87-010-314-080 | C-CAP,S 22P-50V | A..... |
| C | 653 | 87-010-322-080 | C-CAP,S 100P-50 CH | A..... |
| C | 654 | 87-010-322-080 | C-CAP,S 100P-50 CH | A..... |
| C | 677 | 87-010-196-080 | CHIP CAPACITOR,0.1-25 | A..... |
| CN | 604 | 87-099-570-010 | CONN,13P TUC-P13P-B1 | A..... |
| CN | 601 | 87-099-719-010 | CONN,30P TYK-B(X) | A..... |
| CN | 602 | 87-A60-061-010 | CONN,06P V 9604S-06C | A..... |
| D | 601 | 87-A40-002-080 | ZENER,MTZJ5.1C | A..... |
| D | 603 | 87-A40-234-080 | ZENER,MTZJ5.6A | A..... |
| D | 602 | 87-A40-438-080 | ZENER,MTZJ4.7A | A..... |
| IC | 601 | 87-A21-202-040 | C-IC,M62445AFP | A..... |
| J | 601 | 87-A60-426-010 | JACK,PIN 6P YKC21-3835 | A..... |
| Q | 604 | 87-026-444-080 | C-TR,DTA123EK | A..... |
| Q | 601 | 87-026-609-080 | TR,KTA1266GR | A..... |
| Q | 707 | 87-010-180-080 | C-CER 1500P | A..... |
| C | 702 | 87-010-196-080 | CHIP CAPACITOR,0.1-25 | A..... |
| C | 706 | 87-010-197-080 | CAP, CHIP 0.01 DM | A..... |
| C | 709 | 87-010-213-080 | C-CAP,S 0.015-50 B | A..... |
| C | 708 | 87-010-213-080 | C-CAP,S 0.015-50 B | A..... |
| C | 701 | 87-010-263-080 | CAP, ELECT 100-10V | A..... |
| C | 703 | 87-010-319-080 | C-CAP,S 56P-50 CH | A..... |
| C | 704 | 87-010-319-080 | C-CAP,S 56P-50 CH | A..... |
| C | 705 | 87-012-393-080 | C-CAP,S 0.22-16 R K | A..... |
| C | 715 | 87-010-071-080 | CAP, ELECT 1-50 M 5L SRE | A..... |
| C | 716 | 87-010-071-080 | CAP, ELECT 1-50 M 5L SRE | A..... |
| C | 711 | 87-010-181-080 | CAP,CHIP S 1800P | A..... |
| C | 717 | 87-010-183-080 | C-CAP,S 2700P-50 B | A..... |
| C | 718 | 87-010-183-080 | C-CAP,S 2700P-50 B | A..... |
| C | 712 | 87-010-196-080 | CHIP CAPACITOR,0.1-25 | A..... |
| C | 710 | 87-010-197-080 | CAP, CHIP 0.01 DM | A..... |
| C | 714 | 87-010-374-080 | CAP, ELECT 47-10V | A..... |
| C | 713 | 87-010-544-080 | CAP, ELECT 0.1-50V | A..... |
| C | 719 | 87-A11-014-080 | CAP,M 0.22-50 J DE | A..... |
| C | 735 | 87-010-178-080 | CHIP CAP 1000P | A..... |
| C | 732 | 87-010-196-080 | CHIP CAPACITOR,0.1-25 | A..... |
| C | 736 | 87-010-196-080 | CHIP CAPACITOR,0.1-25 | A..... |
| C | 731 | 87-010-560-080 | CAP,E 10-50 GAS | A..... |
| C | 733 | 87-010-958-080 | CHIP -CAP,S 0.01-25BJ | A..... |
| C | 734 | 87-012-156-080 | C-CAP,S 220P-50 CH | A..... |
| C | 741 | 87-010-178-080 | CHIP CAP 1000P | A..... |
| D | 701 | 87-017-931-080 | ZENER,MTZJ5.6B | A..... |
| IC | 701 | 87-A20-613-040 | C-IC,BU9262AFS | A..... |
| L | 701 | 87-005-448-080 | COIL 220UH,K | A..... |
| Q | 732 | 87-A30-075-080 | C-TR,2SA1235F | A..... |
| Q | 731 | 87-A30-076-080 | C-TR,2SC3052F | A..... |
| C | 901 | 87-010-402-080 | CAP, ELECT 2.2-50V | A..... |
| C | 902 | 87-010-402-080 | CAP, ELECT 2.2-50V | A..... |
| C | 905 | 87-010-404-080 | CAP, ELECT 4.7-50V | A..... |
| C | 904 | 87-010-404-080 | CAP, ELECT 4.7-50V | A..... |
| C | 903 | 87-010-404-080 | CAP, ELECT 4.7-50V | A..... |
| C | 909 | 87-016-460-080 | C-CAP,S 0.22-16 B | A..... |
| C | 907 | 87-016-669-080 | C-CAP,S 0.1-25 K B | A..... |
| C | 908 | 87-016-669-080 | C-CAP,S 0.1-25 K B | A..... |
| C | 919 | 87-010-183-080 | C-CAP,S 2700P-50 B | A..... |
| C | 916 | 87-010-197-080 | CAP, CHIP 0.01 DM | A..... |
| C | 915 | 87-010-197-080 | CAP, CHIP 0.01 DM | A..... |
| C | 918 | 87-010-198-080 | CAP, CHIP 0.022 | A..... |
| C | 917 | 87-010-198-080 | CAP, CHIP 0.022 | A..... |
| C | 914 | 87-010-956-080 | CHIP-CAP,S 0.068-25B | A..... |
| C | 913 | 87-010-956-080 | CHIP-CAP,S 0.068-25B | A..... |
| C | 911 | 87-012-365-080 | C-CAP,S 0.027-25VBK | A..... |
| C | 912 | 87-012-365-080 | C-CAP,S 0.027-25VBK | A..... |
| C | 910 | 87-016-460-080 | C-CAP,S 0.22-16 B | A..... |
| C | 927 | 87-010-112-080 | CAP, ELECT 100-16V | A..... |
| C | 924 | 87-010-178-080 | CHIP CAP 1000P | A..... |
| C | 923 | 87-010-178-080 | CHIP CAP 1000P | A..... |
| C | 925 | 87-010-182-080 | C-CAP,S 2200P-50 B | A..... |
| C | 926 | 87-010-182-080 | C-CAP,S 2200P-50 B | A..... |
| C | 920 | 87-010-183-080 | C-CAP,S 2700P-50 B | A..... |
| C | 922 | 87-010-188-080 | CAP,CHIP 6800P | A..... |
| C | 921 | 87-010-188-080 | CAP,CHIP 6800P | A..... |
| C | 928 | 87-010-196-080 | CHIP CAPACITOR,0.1-25 | A..... |
| C | 929 | 87-010-322-080 | C-CAP,S 100P-50 CH | A..... |
| C | 930 | 87-010-322-080 | C-CAP,S 100P-50 CH | A..... |
| C | 931 | 87-010-322-080 | C-CAP,S 100P-50 CH | A..... |
| CN | 901 | 87-099-568-010 | CONN,11P TUC-P11P-B1 | A..... |
| IC | 901 | 87-A20-869-040 | C-IC,M62449FP | A..... |
| PN | 901 | 87-A60-546-010 | CONN,11P H GRY TUC-P11X-C1 | A..... |
| C | 101 | 87-010-544-080 | CAP, ELECT 0.1-50V | A..... |
| C | 102 | 87-010-544-080 | CAP, ELECT 0.1-50V | A..... |

ELECTRICAL MAIN PARTS LIST - 8/9

| | | | | |
|----|-----|----------------|-------------------------|--------|
| C | 206 | 87-010-186-080 | CAP,CHIP 4700P | A..... |
| C | 205 | 87-010-186-080 | CAP,CHIP 4700P | A..... |
| C | 209 | 87-010-322-080 | C-CAP,S 100P-50 CH | A..... |
| C | 208 | 87-010-404-080 | CAP, ELECT 4.7-50V | A..... |
| C | 207 | 87-010-404-080 | CAP, ELECT 4.7-50V | A..... |
| C | 204 | 87-010-544-080 | CAP, ELECT 0.1-50V | A..... |
| C | 203 | 87-010-544-080 | CAP, ELECT 0.1-50V | A..... |
| C | 212 | 87-010-260-080 | CAP, ELECT 47-25V | A..... |
| C | 211 | 87-010-260-080 | CAP, ELECT 47-25V | A..... |
| C | 210 | 87-010-322-080 | C-CAP,S 100P-50 CH | A..... |
| C | 219 | 87-012-368-080 | C-CAP,S 0.1-50 F | A..... |
| C | 213 | 87-A10-516-080 | C-CAP,S 100P-200 J CH | A..... |
| C | 214 | 87-A10-516-080 | C-CAP,S 100P-200 J CH | A..... |
| C | 221 | 87-010-186-080 | CAP,CHIP 4700P | A..... |
| C | 222 | 87-010-186-080 | CAP,CHIP 4700P | A..... |
| C | 220 | 87-012-368-080 | C-CAP,S 0.1-50 F | A..... |
| C | 299 | 87-010-197-080 | CAP, CHIP 0.01 DM | A..... |
| C | 306 | 87-010-184-080 | CHIP CAPACITOR 3300P(K) | A..... |
| C | 305 | 87-010-184-080 | CHIP CAPACITOR 3300P(K) | A..... |
| C | 309 | 87-010-322-080 | C-CAP,S 100P-50 CH | A..... |
| C | 307 | 87-010-403-080 | CAP, ELECT 3.3-50V | A..... |
| C | 308 | 87-010-403-080 | CAP, ELECT 3.3-50V | A..... |
| C | 304 | 87-010-404-080 | CAP, ELECT 4.7-50V | A..... |
| C | 303 | 87-010-404-080 | CAP, ELECT 4.7-50V | A..... |
| C | 314 | 87-010-260-080 | CAP, ELECT 47-25V | A..... |
| C | 313 | 87-010-260-080 | CAP, ELECT 47-25V | A..... |
| C | 310 | 87-010-322-080 | C-CAP,S 100P-50 CH | A..... |
| C | 319 | 87-012-368-080 | C-CAP,S 0.1-50 F | A..... |
| C | 312 | 87-A10-946-080 | C-CAP,S 220P-100 J CH | A..... |
| C | 311 | 87-A10-946-080 | C-CAP,S 220P-100 J CH | A..... |
| C | 321 | 87-010-186-080 | CAP,CHIP 4700P | A..... |
| C | 322 | 87-010-186-080 | CAP,CHIP 4700P | A..... |
| C | 320 | 87-012-368-080 | C-CAP,S 0.1-50 F | A..... |
| C | 502 | 87-012-368-080 | C-CAP,S 0.1-50 F | A..... |
| C | 501 | 87-016-299-080 | CAP,E 10-100 SME | A..... |
| C | 503 | 87-016-299-080 | CAP,E 10-100 SME | A..... |
| CN | 101 | 87-A60-727-010 | CONN,13P JL-R | A..... |
| CN | 102 | 87-A60-727-010 | CONN,13P JL-R | A..... |
| D | 206 | 87-020-465-080 | DIODE,1SS133 (110MA) | A..... |
| D | 201 | 87-020-465-080 | DIODE,1SS133 (110MA) | A..... |
| D | 205 | 87-020-465-080 | DIODE,1SS133 (110MA) | A..... |
| D | 202 | 87-020-465-080 | DIODE,1SS133 (110MA) | A..... |
| D | 209 | 87-020-465-080 | DIODE,1SS133 (110MA) | A..... |
| D | 208 | 87-A40-488-080 | DIODE,1SS244 | A..... |
| D | 207 | 87-A40-488-080 | DIODE,1SS244 | A..... |
| D | 212 | 87-020-331-080 | CHIP-DIODE,DAN202K | A..... |
| D | 210 | 87-020-465-080 | DIODE,1SS133 (110MA) | A..... |
| D | 298 | 87-020-465-080 | DIODE,1SS133 (110MA) | A..... |
| D | 297 | 87-020-465-080 | DIODE,1SS133 (110MA) | A..... |
| D | 293 | 87-020-465-080 | DIODE,1SS133 (110MA) | A..... |
| D | 295 | 87-020-465-080 | DIODE,1SS133 (110MA) | A..... |
| D | 294 | 87-020-465-080 | DIODE,1SS133 (110MA) | A..... |
| D | 296 | 87-020-465-080 | DIODE,1SS133 (110MA) | A..... |
| D | 299 | 87-020-465-080 | DIODE,1SS133 (110MA) | A..... |
| D | 305 | 87-020-465-080 | DIODE,1SS133 (110MA) | A..... |
| D | 306 | 87-020-465-080 | DIODE,1SS133 (110MA) | A..... |
| D | 301 | 87-020-465-080 | DIODE,1SS133 (110MA) | A..... |
| D | 302 | 87-020-465-080 | DIODE,1SS133 (110MA) | A..... |
| D | 309 | 87-A40-488-080 | DIODE,1SS244 | A..... |
| D | 312 | 87-A40-270-080 | C-DIODE,MC2838 | A..... |
| D | 310 | 87-A40-488-080 | DIODE,1SS244 | A..... |
| D | 409 | 87-020-465-080 | DIODE,1SS133 (110MA) | A..... |
| D | 501 | 87-070-136-080 | ZENER,MTZJ5.1B | A..... |
| D | 503 | 87-A40-345-080 | ZENER,MTZJ10C | A..... |
| D | 509 | 87-A40-345-080 | ZENER,MTZJ10C | A..... |
| D | 502 | 87-A40-620-080 | ZENER,MTZJ6.2A | A..... |
| D | 504 | 87-A40-646-010 | DIODE,FMB-G16L | A..... |
| D | 507 | 87-A40-646-010 | DIODE,FMB-G16L | A..... |
| D | 511 | 87-020-465-080 | DIODE,1SS133 (110MA) | A..... |
| D | 514 | 87-020-465-080 | DIODE,1SS133 (110MA) | A..... |
| D | 512 | 87-020-465-080 | DIODE,1SS133 (110MA) | A..... |
| D | 513 | 87-020-465-080 | DIODE,1SS133 (110MA) | A..... |
| D | 510 | 87-020-465-080 | DIODE,1SS133 (110MA) | A..... |
| Q | 206 | 87-A30-076-080 | C-TR,2SC3052F | A..... |
| Q | 205 | 87-A30-076-080 | C-TR,2SC3052F | A..... |
| Q | 203 | 87-A30-076-080 | C-TR,2SC3052F | A..... |
| Q | 204 | 87-A30-076-080 | C-TR,2SC3052F | A..... |
| Q | 209 | 87-A30-190-080 | TR,CC5551 | A..... |
| Q | 201 | 87-A30-268-040 | C-TR,2SA1514K(S) | A..... |
| Q | 202 | 87-A30-268-040 | C-TR,2SA1514K(S) | A..... |
| Q | 208 | 87-A30-268-040 | C-TR,2SA1514K(S) | A..... |
| Q | 207 | 87-A30-268-040 | C-TR,2SA1514K(S) | A..... |
| Q | 210 | 87-A30-190-080 | TR,CC5551 | A..... |
| Q | 225 | 87-A30-076-080 | C-TR,2SC3052F | A..... |
| Q | 226 | 87-A30-076-080 | C-TR,2SC3052F | A..... |
| Q | 223 | 87-A30-076-080 | C-TR,2SC3052F | A..... |
| Q | 224 | 87-A30-076-080 | C-TR,2SC3052F | A..... |
| Q | 221 | 87-A30-106-070 | C-TR,CMBT5551 | A..... |
| Q | 222 | 87-A30-106-070 | C-TR,CMBT5551 | A..... |
| Q | 298 | 87-A30-268-040 | C-TR,2SA1514K(S) | A..... |
| Q | 308 | 87-A30-075-080 | C-TR,2SA1235F | A..... |
| Q | 307 | 87-A30-075-080 | C-TR,2SA1235F | A..... |

ELECTRICAL MAIN PARTS LIST - 9/9

| | | | | |
|----|-----|----------------|-------------------|--------|
| Q | 302 | 87-A30-075-080 | C-TR,2SA1235F | A..... |
| Q | 301 | 87-A30-075-080 | C-TR,2SA1235F | A..... |
| Q | 306 | 87-A30-076-080 | C-TR,2SC3052F | A..... |
| Q | 305 | 87-A30-076-080 | C-TR,2SC3052F | A..... |
| Q | 303 | 87-A30-076-080 | C-TR,2SC3052F | A..... |
| Q | 304 | 87-A30-076-080 | C-TR,2SC3052F | A..... |
| Q | 317 | 87-A30-106-070 | C-TR,CMBT5551 | A..... |
| Q | 318 | 87-A30-106-070 | C-TR,CMBT5551 | A..... |
| Q | 312 | 87-A30-190-080 | TR,CC5551 | A..... |
| Q | 311 | 87-A30-190-080 | TR,CC5551 | A..... |
| Q | 325 | 87-A30-076-080 | C-TR,2SC3052F | A..... |
| Q | 324 | 87-A30-076-080 | C-TR,2SC3052F | A..... |
| Q | 323 | 87-A30-076-080 | C-TR,2SC3052F | A..... |
| Q | 326 | 87-A30-076-080 | C-TR,2SC3052F | A..... |
| Q | 503 | 87-A30-072-080 | C-TR,RT1P 144C | A..... |
| Q | 506 | 87-A30-074-080 | C-TR,RT1P 141C | A..... |
| Q | 505 | 87-A30-075-080 | C-TR,2SA1235F | A..... |
| Q | 504 | 87-A30-076-080 | C-TR,2SC3052F | A..... |
| Q | 501 | 87-A30-186-010 | FET,2SK3053 | A..... |
| Q | 502 | 87-A30-186-010 | FET,2SK3053 | A..... |
| Q | 507 | 87-A30-268-040 | C-TR,2SA1514K(S) | A..... |
| Q | 601 | 87-A30-074-080 | C-TR,RT1P 141C | A..... |
| Q | 602 | 87-A30-268-040 | C-TR,2SA1514K(S) | A..... |
| R | 226 | 87-A00-262-080 | RES,M/F 0.15-2W J | A..... |
| R | 225 | 87-A00-262-080 | RES,M/F 0.15-2W J | A..... |
| R | 228 | 87-A00-262-080 | RES,M/F 0.15-2W J | A..... |
| R | 227 | 87-A00-262-080 | RES,M/F 0.15-2W J | A..... |
| R | 239 | 87-A00-262-080 | RES,M/F 0.15-2W J | A..... |
| R | 242 | 87-A00-262-080 | RES,M/F 0.15-2W J | A..... |
| R | 328 | 87-A00-258-080 | RES,M/F 0.22-1W J | A..... |
| R | 325 | 87-A00-258-080 | RES,M/F 0.22-1W J | A..... |
| R | 327 | 87-A00-258-080 | RES,M/F 0.22-1W J | A..... |
| R | 326 | 87-A00-258-080 | RES,M/F 0.22-1W J | A..... |
| R | 339 | 87-A00-258-080 | RES,M/F 0.22-1W J | A..... |
| R | 340 | 87-A00-258-080 | RES,M/F 0.22-1W J | A..... |
| TH | 202 | 87-A91-042-080 | C-THMS,100K 55001 | A..... |
| TH | 201 | 87-A91-042-080 | C-THMS,100K 55001 | A..... |
| TH | 301 | 87-A91-042-080 | C-THMS,100K 55001 | A..... |
| TH | 302 | 87-A91-042-080 | C-THMS,100K 55001 | A..... |

MECHANICAL PARTS LIST - 1/2

NOTE: The characters in the suffix column indicate the part usage.

| HR | REF.NO | PARTS NO. | XX KANRI NO. | DESCRIPTION | A SUFFIX |
|----|--------|----------------|--------------------|------------------------------|-------------|
| | | 88-NF3-090-010 | | RING, FOOT | A..... |
| | | 8Z-NF3-001-010 | | CABI, FR H | A..... |
| | | 8Z-NF3-009-010 | | CABI, STEEL | A..... |
| | | 8Z-NF3-025-010 | | BOX, CASS L | A..... |
| | | 8Z-NF3-026-010 | | BOX, CASS R | A..... |
| | | 8Z-NF3-029-010 | | PANEL, REAR | A..... |
| | | 8Z-NF3-038-010 | | PANEL, CD | A..... |
| | | 8Z-NF3-039-010 | | PANEL, JOG | A..... |
| | | 8Z-NF3-040-010 | | PANEL ASSY, TRAY | |
| | | 8Z-NF3-042-010 | | COVER, TRAY L | A..... |
| | | 8Z-NF3-042-010 | | COVER, TRAY L | |
| | | 8Z-NF3-043-010 | | COVER, TRAY R | A..... |
| | | 8Z-NF3-043-010 | | COVER, TRAY R | |
| | | 8Z-NF3-046-010 | | COVER, CD H | A..... |
| | | 8Z-NF3-048-010 | | COVER, BOTTOM | A..... |
| | | 8Z-NF3-050-010 | | WINDOW, DISP | A..... |
| | | 8Z-NF3-055-010 | | WINDOW, CASS L | A..... |
| | | 8Z-NF3-056-010 | | WINDOW, CASS R | A..... |
| | | 8Z-NH3-010-010 | | CABI, REAR HRJSTNM | A..... |
| | | 8Z-NH3-024-010 | | CABI, BOTTOM VCD | A..... |
| | | 8Z-NH3-030-010 | | PANEL, FR VCD | A..... |
| | | 8Z-NH3-040-010 | | PANEL ASSY, TRAY VCD | A..... |
| | | 8Z-NF3-060-010 | | KEY, GEO | A..... |
| | | 8Z-NF3-061-010 | | KEY, DSP | A..... |
| | | 8Z-NF3-062-010 | | KEY, FUN | A..... |
| | | 8Z-NF3-063-010 | | KEY ASSY, OPE | A..... |
| | | 8Z-NF3-064-010 | | KEY, OPE | A..... |
| | | 8Z-NF3-073-010 | | KEY, BBE | A..... |
| | | 8Z-NF3-074-010 | | KEY, JOG | A..... |
| | | 8Z-NF3-075-010 | | KEY, TIMER | A..... |
| | | 8Z-NF3-076-010 | | KEY, CLOCK | A..... |
| | | 8Z-NF3-077-010 | | KEY, ENTER | A..... |
| | | 8Z-NF3-078-010 | | KEY, CD | A..... |
| | | 8Z-NF3-079-010 | | KEY, DIRECT | A..... |
| | | 8Z-NF3-080-010 | | KEY, OPEN | A..... |
| | | 8Z-NF3-090-010 | | KNOB, RTRY MAIN | A..... |
| | | 8Z-NF3-091-010 | | KNOB, RTRY JOG | A..... |
| | | 8Z-NF3-095-010 | | RING, MAIN | A..... |
| | | 8Z-NF3-096-010 | | RING, JOG | A..... |
| | | 8Z-NF3-100-010 | | REFLECTOR, PAUSE | A..... |
| | | 8Z-NF3-101-010 | | REFLECTOR, FF | A..... |
| | | 8Z-NH3-070-010 | | KEY, KARAOKE VCD | A..... |
| | | 81-532-080-010 | | LABEL, CASS. COMPT | A..... |
| | | 8Z-NF3-105-010 | | REFLECTOR, CASS | A..... |
| | | 8Z-NF3-106-010 | | REFLECTOR, FUN | A..... |
| | | 8Z-NF3-107-010 | | REFLECTOR, JOG | A..... |
| | | 8Z-NF3-108-010 | | REFLECTOR, ECO | A..... |
| | | 8Z-NF3-644-010 | | CONN ASSY, 8P RPB | A..... |
| | | 82-NF5-218-010 | | SPR-T, EJECT 1 (SIN) | A..... |
| | | 82-NF5-219-010 | | SPR-T, EJECT 2 (SIN) | A..... |
| | | 82-NF5-229-010 | | PLATE, LOCK | A..... |
| | | 86-NF9-224-010 | | SPR-C, LOCK | A..... |
| | | 87-064-185-010 | | HLDR, WIRE | A..... |
| | | 87-NF4-216-010 | | HLDR, LOCK 1 | A..... |
| | | 87-NF4-217-010 | | HLDR, LOCK 2 | A..... |
| | | 87-NF4-221-010 | | HLDR, CABLE | A..... |
| | | 87-NF8-220-010 | | DMPR, 150 | A..... |
| | | 88-NF5-208-010 | | HLDR, PWB-M N | A..... |
| | | 8Z-NF3-224-010 | | HLDR, HT-SINK 1 | A..... |
| | | 8Z-NF3-227-010 | | HLDR, PWB PT | A..... |
| | | 8Z-NF3-228-010 | | HLDR, HT-SINK R | A..... |
| | | 8Z-NF3-229-010 | | HLDR, FAN 4CH | A..... |
| | | 8Z-NF5-215-010 | | HLDR, HT R | |
| * | | 8Z-NF3-213-010 | | GUIDE, LED DIRECT | A..... |
| | | 87-067-584-010 | | TAPPING SCREW, BVT2+3-6 | A..... |
| | | 87-067-641-010 | | UTT2+3-8(W/O SLOT)BL | A..... |
| | | 87-067-680-010 | | BVI T3+3-10 | A..... |
| | | 87-067-688-010 | | BVTT+3-6 | A..... |
| | | 87-067-703-010 | | TAPPING SCREW, BVT2+3-10 | A..... |
| | | 87-067-873-010 | | BVT2+3-25 W/O SLOT | A..... |
| | | 87-067-975-010 | | S-SCREW, IT+4-8 | A..... |
| | | 87-591-095-410 | | TAPPING SCREW, QIT+3-8 (GLD) | A..... |
| | | 87-721-097-410 | | QT2+3-12 GLD | A..... |
| | | 87-NF4-224-010 | | S-SCREW, IT3B+3-8 CU | A..... |
| | | 87-085-185-010 | | BUSHING, AC CORD (E) | A..... |
| | | 87-A91-080-010 | | FAN, F614R-12MC-19-400MM | A..... |
| | | 88-906-481-110 | | FF-CABLE, 6P 1.25 480MM | A..... |
| | | 88-908-181-110 | | FF-CABLE, 8P 1.25 180MM | A..... |
| | | 88-909-381-110 | | FF-CABLE, 9P 1.25 | A..... |
| | | 88-912-481-110 | | FF-CABLE, 12P 1.25 48 | A..... |
| | | 88-915-161-110 | | FF-CABLE, 15P 1.25 | A..... |
| | | 87-A40-392-010 | | DIODE, 1N5818 | A..... |
| D | 702 | 87-A40-392-010 | | DIODE, 1N5818 | A..... |
| F | 101 | 87-035-458-010 | | FUSE, 4A 250V T W/C | A..... |
| F | 102 | 87-035-458-010 | | FUSE, 4A 250V T W/C | A..... |
| PT | 1 | 8Z-NF3-603-010 | | PT, HE ZNF-3 | A..... |

MECHANICAL PARTS LIST - 2/2

| | | | | |
|----|-----|----------------|-----------------------------|--------|
| Q | 101 | 89-213-702-010 | TR, 2SB1370 (1.8W) | A..... |
| Q | 102 | 89-213-702-010 | TR, 2SB1370 (1.8W) | A..... |
| Q | 217 | 87-A30-204-010 | TR, 2SD2439 | A..... |
| Q | 218 | 87-A30-204-010 | TR, 2SD2439 | A..... |
| Q | 216 | 87-A30-205-010 | TR, 2SB1588 | A..... |
| Q | 215 | 87-A30-205-010 | TR, 2SB1588 | A..... |
| Q | 314 | 87-A30-214-010 | TR, 2SB1344 | A..... |
| Q | 313 | 87-A30-214-010 | TR, 2SB1344 | A..... |
| Q | 316 | 87-A30-215-010 | TR, 2SD2025 | A..... |
| Q | 315 | 87-A30-215-010 | TR, 2SD2025 | A..... |
| W | 101 | 87-A80-092-010 | AC CORD ASSY, E BLK SUN FAI | A..... |
| WH | 1 | 87-A90-510-010 | HLDR, WIRE 2.5-9P | A..... |

ACCESSORIES / PACKAGE LIST - 1/1

NOTE: The characters in the suffix column indicate the part usage.

| REF.NO | PARTS NO. | NO. | DESCRIPTION | SUFFIX |
|--------|----------------|------------------|-------------|--------|
| | 8Z-NH3-901-010 | IB,H (EC-H)M | | A..... |
| | 87-006-269-010 | AM LOOP ANT (UN) | | A..... |
| | 87-043-095-010 | WIRE ANTENNA | | A..... |
| | 87-043-115-010 | ANT,FEEDER FM | | A..... |
| | 87-050-103-010 | CORD,PIN 1PY1.5M | | A..... |
| | 87-099-789-010 | PLUG,ADPTR IR44 | | A..... |
| | 8Z-NH8-702-010 | RC UNIT,RC-ZAS07 | | A..... |

SCHEMATIC DIAGRAM - 1 (MAIN 1/3)

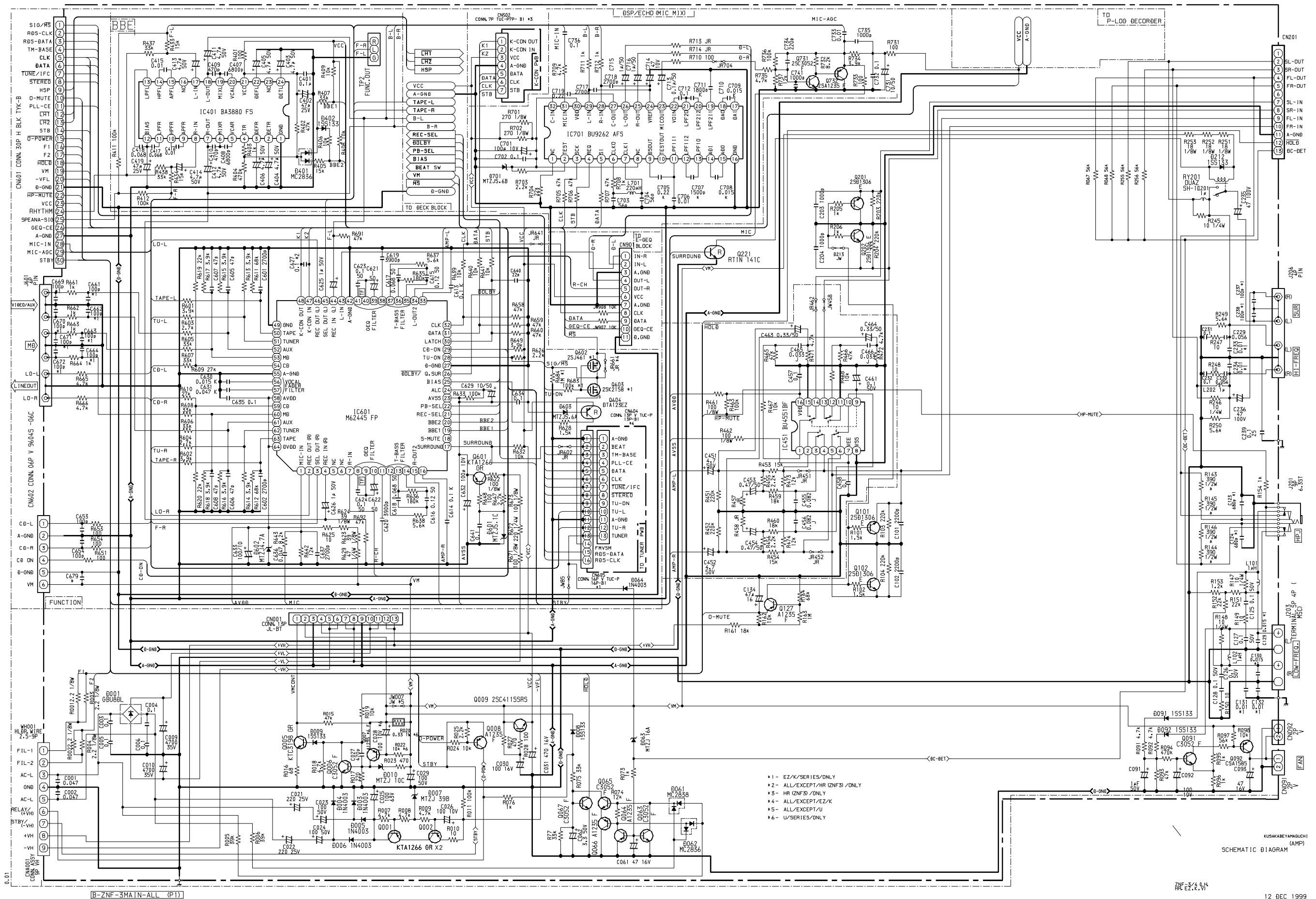

ZNF-EZ-K-V

KUSAKABEYAMAGUCHI (AMP) SCHEMATIC DIAGRAM

SCHEMATIC DIAGRAM - 2 (MAIN 2/3)

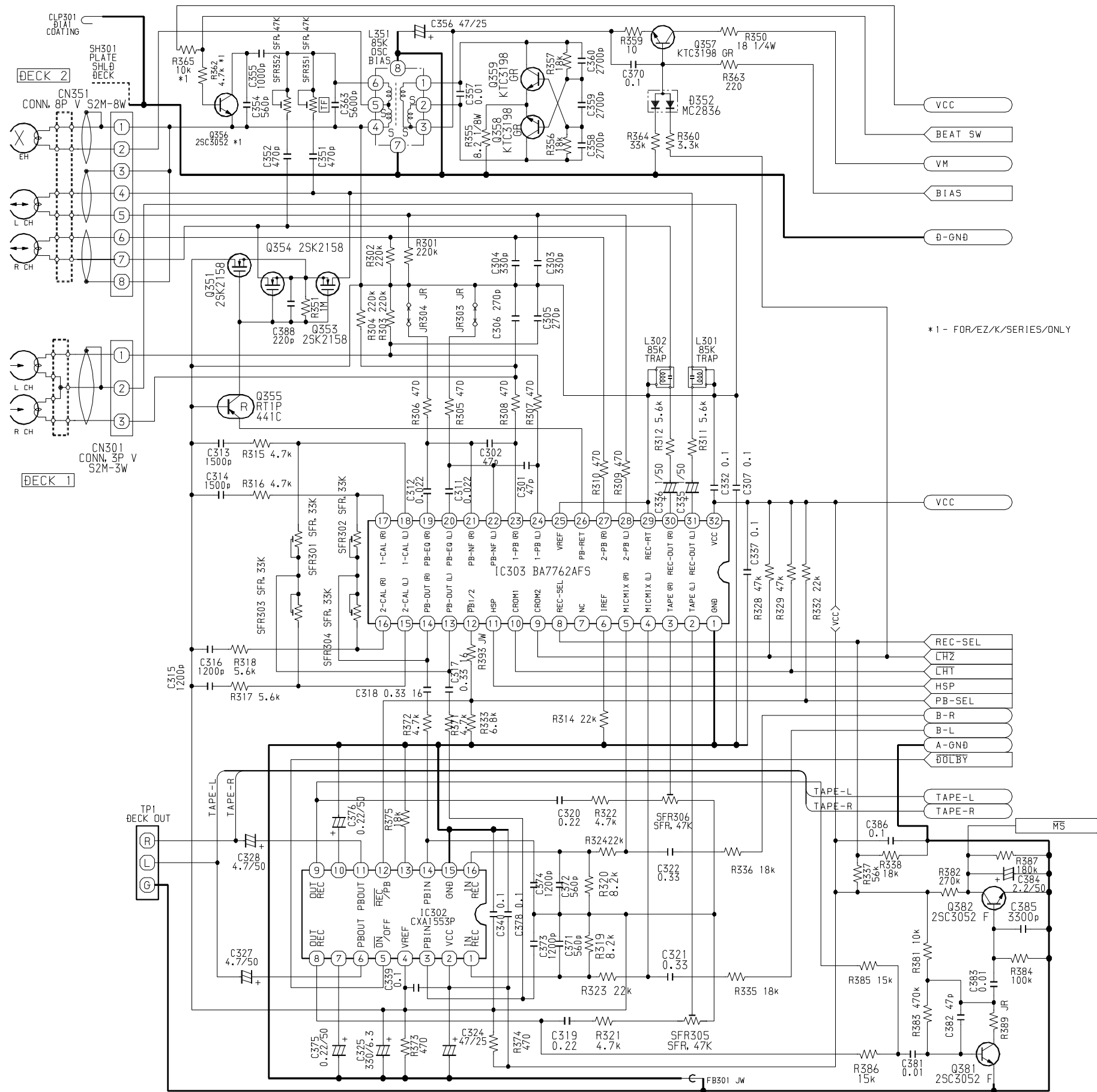

*1 - FOR/EZ/K/SERIES/ONLY

| | WITH DOLBY | W/O_DOLBY (R+R) | W/O_DOLBY (R+1_1+1) |
|--------|------------|-----------------|---------------------|
| JR303 | C-JR | X | X |
| JR304 | C-JR | X | X |
| C379 | X | 22/25 | 22/50 |
| C380 | X | 22/50 | 22/50 |
| C313 | 1200P | 1000P | 1500P |
| C314 | 1200P | 1000P | 1500P |
| R315 | 4.7K | 5.6K | 5.6K |
| R316 | 4.7K | 5.6K | 5.6K |
| C315 | 1000P | 1000P | 2200P |
| C316 | 1000P | 1000P | 2200P |
| R317 | 5.6K | 5.6K | 5.6K |
| R318 | 5.6K | 5.6K | 5.6K |
| C391 | 270P | 56P | 56P |
| C392 | 270P | 56P | 56P |
| C393 | 270P | 56P | 56P |
| C394 | 270P | 56P | 56P |
| R395 | X | 100K | 100K |
| R396 | X | 100K | 100K |
| R397 | X | 100K | 100K |
| R398 | X | 100K | 100K |
| SFR301 | 33K | X | X |
| SFR302 | 33K | X | X |
| SFR303 | 33K | X | X |
| SFR304 | 33K | X | X |
| C317 | 0.33 BK | C-JR | C-JR |
| C318 | 0.33 BK | C-JR | C-JR |
| R371 | 4.7K | 39 | 39 |
| R372 | 4.7K | 39 | 39 |
| C375 | 0.22/50 | X | X |
| C376 | 0.22/50 | X | X |
| R375 | 18K | X | X |
| JR301 | X | C-JR | C-JR |
| JR302 | X | C-JR | C-JR |

| | USE BA7762AFS | USE HA12211 |
|-------|---------------|-------------|
| Q360 | X | 2SK2158 |
| R330 | X | C-JR |
| R331 | X | 33K |
| JR336 | X | C-JR |

| | WITH DOLBY | W/O_DOLBY (R+R+1_1+1) |
|--------|------------|-----------------------|
| IC302 | CXA1553P | X |
| C309 | X | 0.1 |
| C310 | X | 0.1 |
| C319 | 0.22 | X |
| C320 | 0.22 | X |
| R321 | 4.7K | X |
| R322 | 4.7K | X |
| SFR305 | 50K | X |
| SFR306 | 50K | X |
| C371 | 820P | X |
| C372 | 820P | X |
| C373 | 1200P | 0.15 |
| C374 | 1200P | 0.15 |
| R319 | 4.7K | 18K |
| R320 | 4.7K | 18K |
| R323 | 22K | C-JR |
| R324 | 22K | C-JR |
| C321 | 0.22 | 0.33 |
| C322 | 0.22 | 0.33 |
| R335 | 27K | 22K |
| R336 | 27K | 22K |
| R391 | X | 15K |
| R392 | X | 15K |
| R385 | 15K | X |
| R386 | 15K | X |
| R383 | 470K | 820K |
| C387 | X | 270P |
| C382 | 47P | 15P |
| R389 | C-JR | 6.8K |
| Q383 | X | 2SA1235 |
| C385 | 3300P | X |

| | EZ K MODEL | EXCEPT EZ K |
|------|------------|-------------|
| Q356 | 2SC3052F | X |
| R362 | 4.7K | X |
| R365 | 10K | X |

| | EZ K MODEL | EXCEPT EZ |
|-------|------------|-----------|
| FB301 | EM1BL01RN1 | JW |

K. KOMATSU

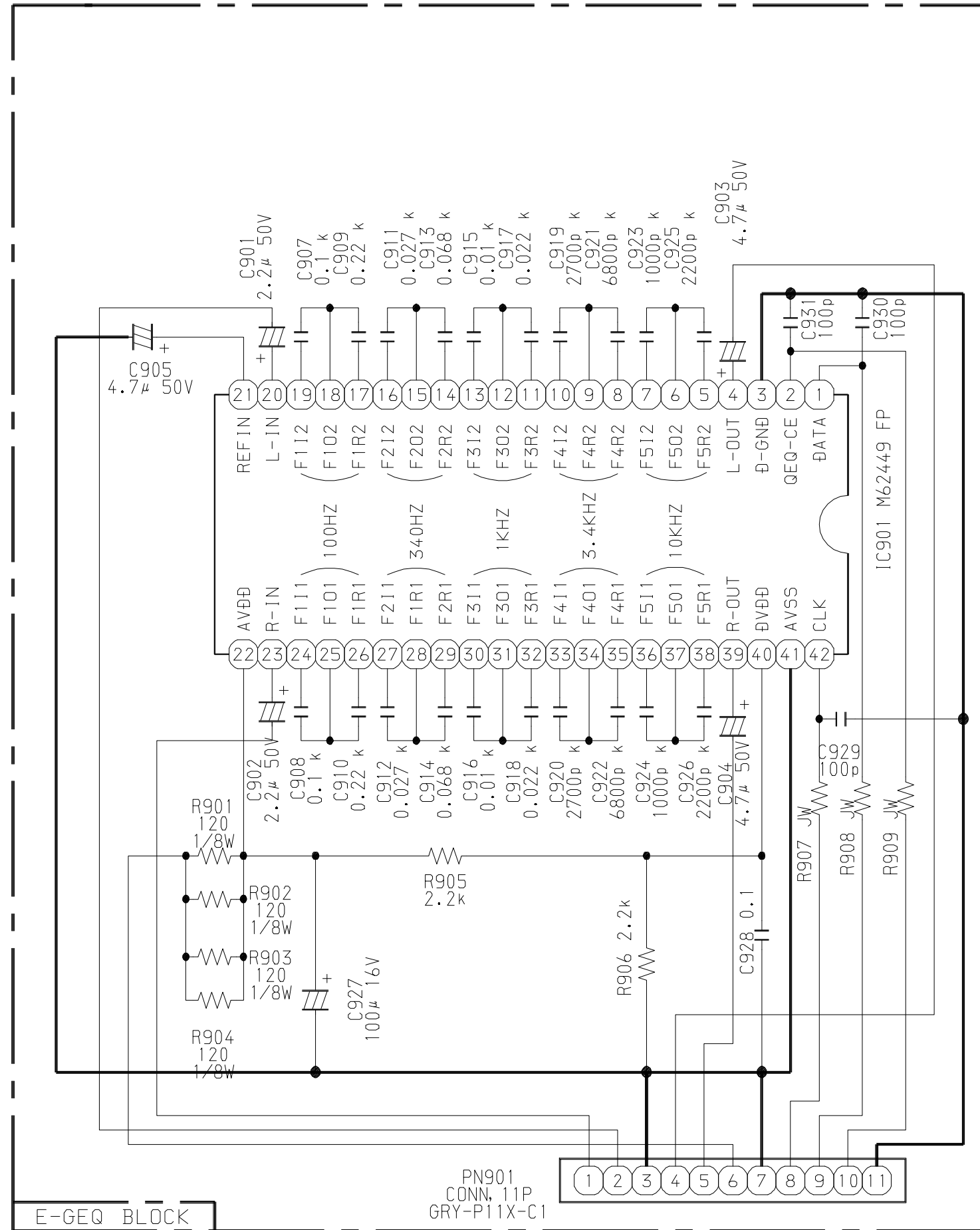

SCHEMATIC DIAGRAM - 4 (FRONT)

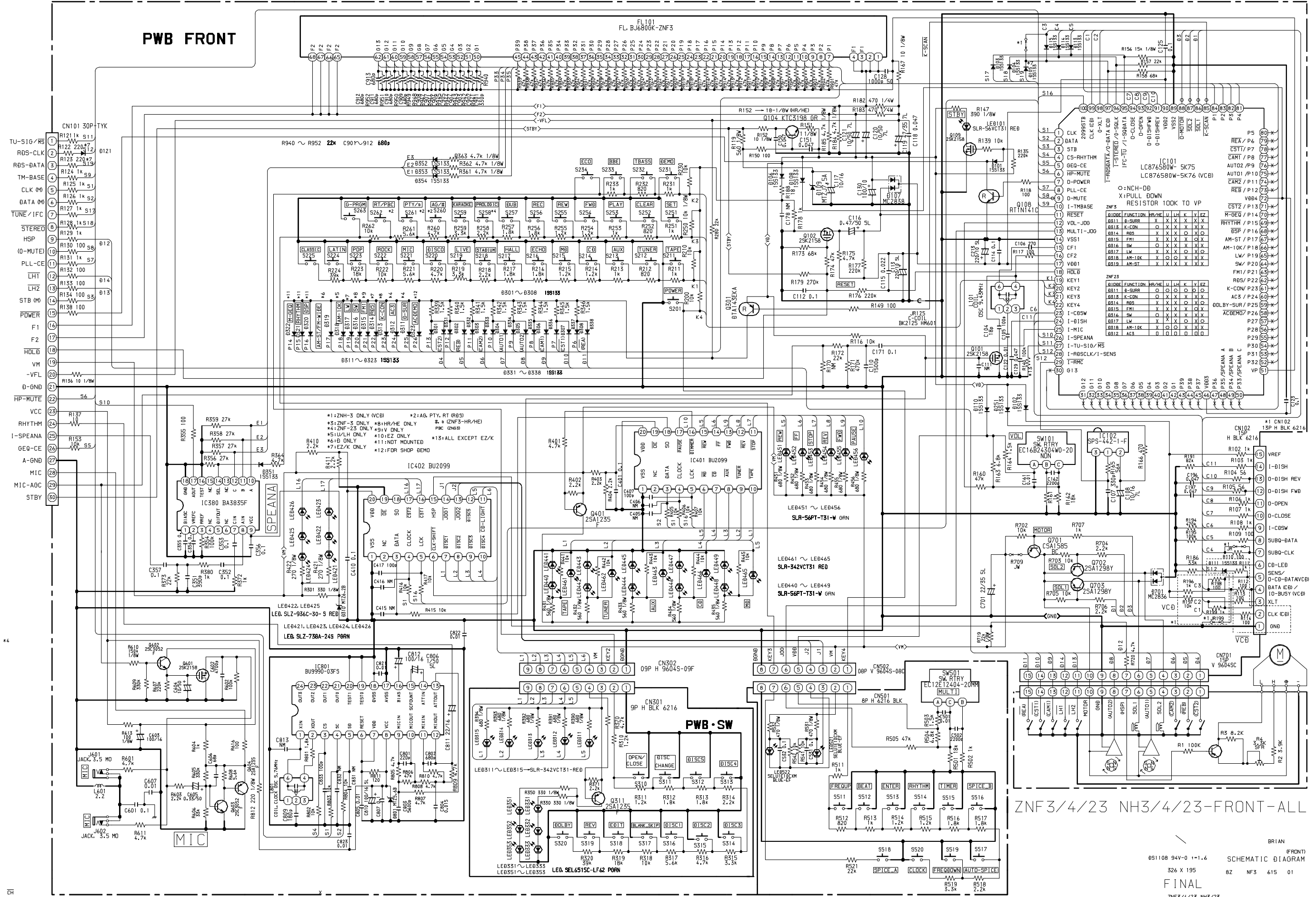

ZNF 3/4/23 NH3/4/23-FRONT-ALL

BRIAN
 851108 94V-0 1-1.6 SCHEMATIC DIAGRAM (FRONT)
 326 X 195 82 NF3 615 01
 FINAL
 ZNF5/4/23 NH5/23 11 01 1999

SCHEMATIC DIAGRAM – 5 (PRO)

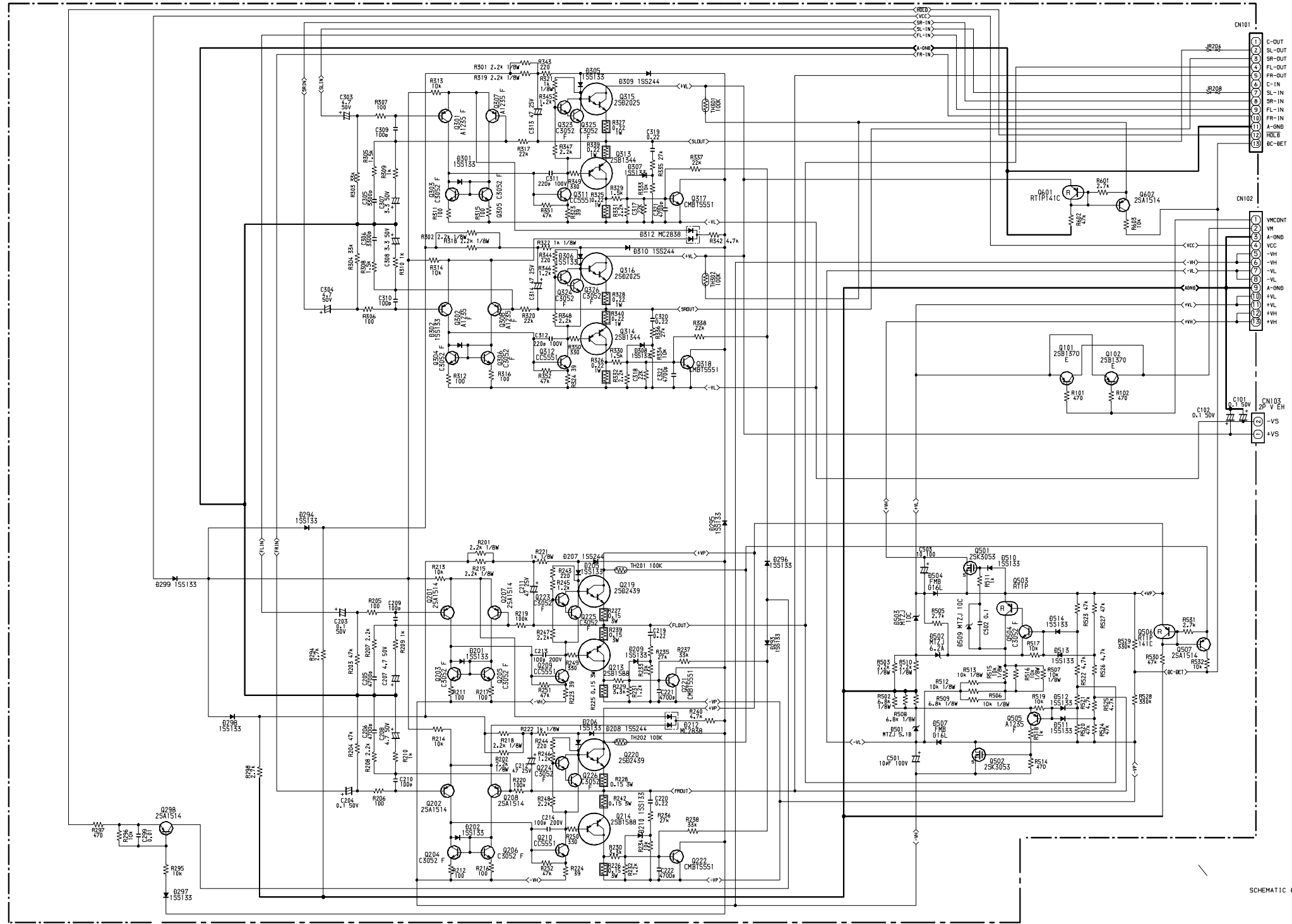

SCHEMATIC DIAGRAM (AMP)

B-ZNF-3PRD-RND.P1

4CHANNEL AMP

08 DEC 1998

SCHEMATIC DIAGRAM - 6 (AC)

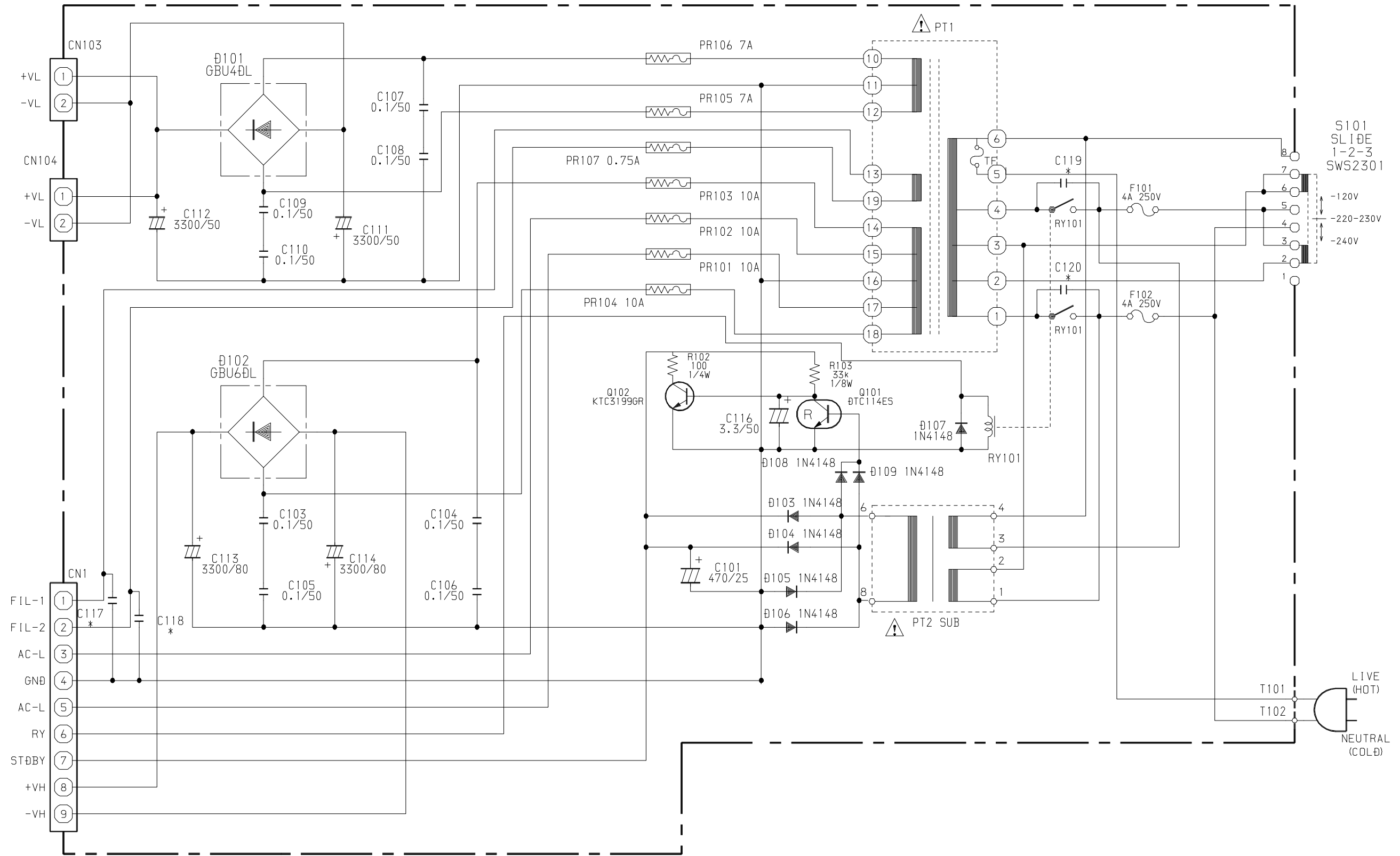

SCHEMATIC - PT

SCHEMATIC DIAGRAM - 7 (KEYCON)

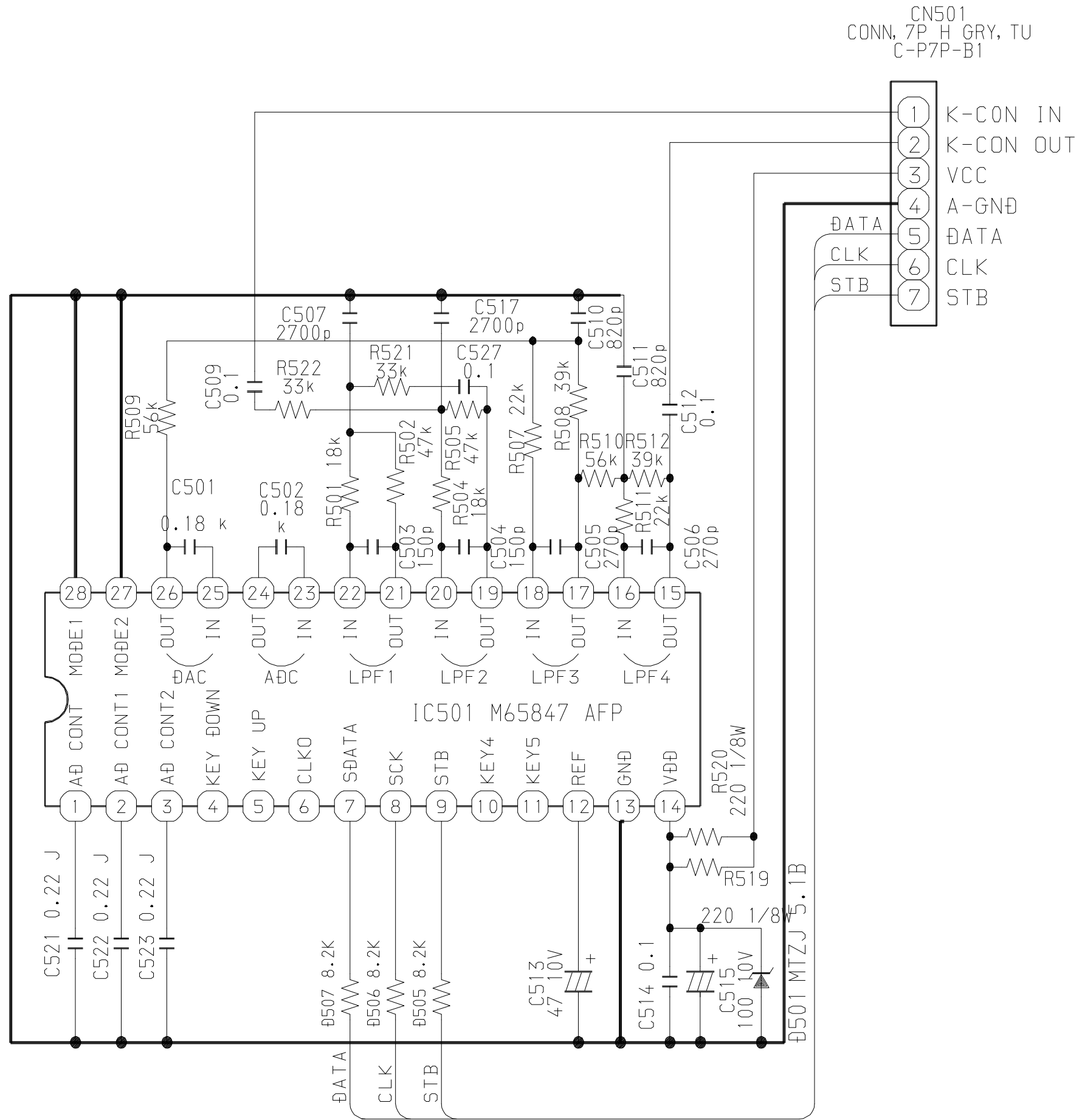

| サービス技術ニュース | |
|------------|------|
| 番号 | 連絡内容 |
| G- - | |
| G- - | |
| G- - | |

アイワ株式会社
AIWA CO.,LTD.

9620450

Tokyo Japan

〒110-8710 東京都台東区池之端1-2-11 ☎03(3827)3111 (代表)

Printed in Singapore