

# aiwa

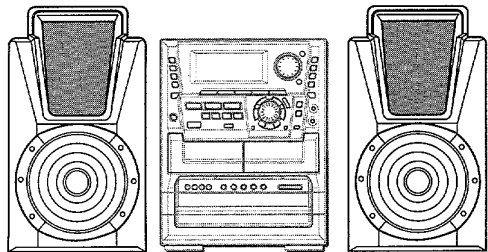

## NSX-T7



COMPACT DISC STEREO  
CASSETTE RECEIVER

- BASIC TAPE MECHANISM: 2ZM-3MK2 PR4NM
- BASIC CD MECHANISM: 6ZG-1 SDFNSHM
- TYPE: K

### SUPPLEMENT

SYSTEM	CD CASSEIVER	SPEAKER	REMOTE CONTROLLER
NSX-T7	CX-NT7	SX-WNT7	RC-ZAS04

- This Service Manual is the "Revision Publishing" and replaces "Simple Manual" (S/M Code No. 09-995-407-0T2).
- This Service Manual contains information about the difference between NSX-T7<K> and NSX-T9<EZ>. If requiring the other information, see Service Manual of NSX-T9 (S/M Code No. 09-996-407-1R2).
- If requiring information about the CD mechanism, see Service Manual of 6ZG-1 (S/M Code No.09-994-326-2N2).

# SPECIFICATIONS

## <FM Tuner section>

**Tuning range** 87.5 MHz to 108 MHz  
**Usable sensitivity(IHF)** 13.2 dBf  
**Antenna terminals** 75 ohms (unbalanced)

## <MW Tuner section>

**Tuning range** 531 kHz to 1602 kHz (9 kHz step)  
 530 kHz to 1710 kHz (10 kHz step)  
**Usable sensitivity** 350 uV/m  
**Antenna** Loop antenna

## <LW Tuner section>

**Tuning range** 144 kHz to 290 kHz  
**Usable sensitivity** 1400 uV/m  
**Antenna** Loop antenna

## <Amplifier section>

### Mid-high frequency amplifier

**Power output\*** Rated: 30 W + 30 W  
 (6 ohms, THD 1 %, 1 kHz/  
 DIN 45500)  
 Reference: 37 W + 37 W  
 (6 ohms, THD 10 %, 1 kHz/  
 DIN 45324)  
 DIN MUSIC POWER:  
 70 W + 70 W  
**Total harmonic distortion** 0.1 % (17 W, 1 kHz, 6 ohms,  
 DIN AUDIO)

### Low frequency amplifier

**Power output\*** Rated: 120 W + 120 W  
 (6 ohms, THD 1 %, 75 Hz/  
 DIN 45500)  
 Reference: 150 W + 150 W  
 (6 ohms, THD 10 %, 75 Hz/  
 DIN 45324)  
 DIN MUSIC POWER:  
 240 W + 240 W  
**Total harmonic distortion** 0.1 % (100 W, 75 Hz, 6 ohms,  
 DIN AUDIO)

## Inputs

\* without connecting to surround speakers  
**VIDEO/AUX** : 300 mV (adjustable)  
**MD** : 300 mV (adjustable)  
**MIC1, MIC2** : 1.0 mV (10 kohms)  
**LINE OUT** : 150 mV  
**SPEAKERS HIGH FREQ** :  
 accept speakers of 6 ohms or  
 more  
**SPEAKERS LOW FREQ** :  
 accept speakers of 6 ohms or  
 more  
**SURROUND SPEAKERS** :  
 accept speakers of 8 to 16 ohms  
**PHONES** (stereo jack) : accepts  
 headphones of 32 ohms or more

## Outputs

## <Cassette deck section>

**Track format** 4 tracks, 2 channels stereo  
**Frequency response** CrO2 tape: 50 Hz – 16000 Hz  
 Normal tape: 50 Hz – 15000 Hz  
**Signal to noise ratio** 60dB (Dolby B NR ON, CrO2 tape  
 peak level)  
**Recording system** AC bias  
**Heads** Deck 1: Playback head x 1  
 Deck 2: Recording/Playback head  
 x 1, erase head x 1

## <Compact disc player section>

**Laser** Semiconductor laser ( $\lambda = 780 \text{ nm}$ )  
**D-A converter** 1 bit dual  
**Signal-to-noise ratio** 83 dB (1 kHz, 0 dB)  
**Harmonic distortion** 0.05 % (1 kHz, 0 dB)  
**Wow and flutter** Unmeasurable

## <Speaker system SX-WNT7>

**Cabinet type** 4 way, built-in subwoofer  
 (magnetic shielded type)  
**Speakers** Subwoofer :  
 200 mm ( 7<sup>7</sup>/<sub>8</sub> in.) cone type  
 Woofer:  
 120 mm (4<sup>3</sup>/<sub>4</sub> in.) cone type  
 Tweeter :  
 60 mm ( 2<sup>3</sup>/<sub>8</sub> in.) cone type  
 Super Tweeter :  
 20 mm ( <sup>13</sup>/<sub>16</sub> in.) ceramic type  
**Impedance** 6 ohms / 6 ohms  
**Output sound pressure level** 87 dB/W/m  
**Dimensions (W x H x D)** 250 x 383 x 310 mm  
 (9<sup>7</sup>/<sub>8</sub> x 15<sup>1</sup>/<sub>8</sub> x 12<sup>1</sup>/<sub>4</sub> in.)  
**Weight** 7.0 kg (15 lbs 7 oz)

## <General>

**Power requirements** 230 V AC, 50 Hz  
**Power consumption** 240 W  
**Dimensions of main unit** 300 x 383.5 x 380 mm  
 (11<sup>7</sup>/<sub>8</sub> x 15<sup>1</sup>/<sub>8</sub> x 15 in.)  
**Weight of main unit** 13 kg (28 lbs 11 oz)

## Standby power consumption

If the power-economizing mode is OFF: 35 W  
 If the power-economizing mode is ON: 1.5 W

- Design and specifications are subject to change without notice.
- Dolby noise reduction manufactured under license from Dolby Laboratories Licensing Corporation.  
 "DOLBY" and the double-D symbol  are trademarks of Dolby Laboratories Licensing Corporation.
- The word "BBE" and the "BBE symbol" are trademarks of BBE Sound, Inc.  
 Under license from BBE Sound, Inc.

# ELECTRICAL MAIN PARTS LIST

If can't understand for Description please kindly refer to "REFERENCE NAME LIST".

REF. NO.	PART NO.	KANRI NO.	DESCRIPTION
MAIN C.B			
C27	87-010-197-080		C-CAP,S 0.01-25 KB
R143	87-A00-442-050		RES,330-1/2W J RP
R144	87-A00-442-050		RES,330-1/2W J RP
R145	87-A00-442-050		RES,330-1/2W J RP
R146	87-A00-442-050		RES,330-1/2W J RP

## PT C.B

△ PT1	8Z-NF4-604-010		PT,EZ ZNF-4
-------	----------------	--	-------------

## ACCESSORIES / PACKAGE LIST

If can't understand for Description please kindly refer to "REFERENCE NAME LIST".

REF. NO.	PART NO.	KANRI NO.	DESCRIPTION
1	8Z-NF4-904-010	IB,K (E)M	
2	8Z-NF5-703-010	RC UNIT,RC-ZAS04 (MITSTUM)	

## SX-WNT7 (YSTL) SPEAKER PARTS LIST

If can't understand for Description please kindly refer to "REFERENCE NAME LIST".

REF. NO.	PART NO.	KANRI NO.	DESCRIPTION	REF. NO.	PART NO.	KANRI NO.	DESCRIPTION
1	88-NS3-602-110	SPKR, W 200		11	8Z-NS4-008-010	PANEL, DUCT	
2	88-NS5-610-010	CORD, SPKR		12	8Z-NS4-009-010	PANEL, DUCT RING	
3	88-NS5-611-010	CORD, SPKR B/L		13	8Z-NS5-604-010	SPKR, M 120	
4	8Z-NS4-604-010	SPKR, TW 60		14	8Z-NSY-608-010	SPKR, CERAMIC ASSY (SWNH33)	
5	8Z-NS4-001-010	PANEL, FR					
6	8Z-NS4-003-010	HLD, TW L					
7	8Z-NS4-004-010	HLD, TW R					
8	8Z-NS4-005-010	PANEL, TW L					
9	8Z-NS4-006-010	PANEL, TW R					
10	8Z-NS4-007-010	PROTECTOR,					

MECHANICAL EXPLODED VIEW 1 / 1

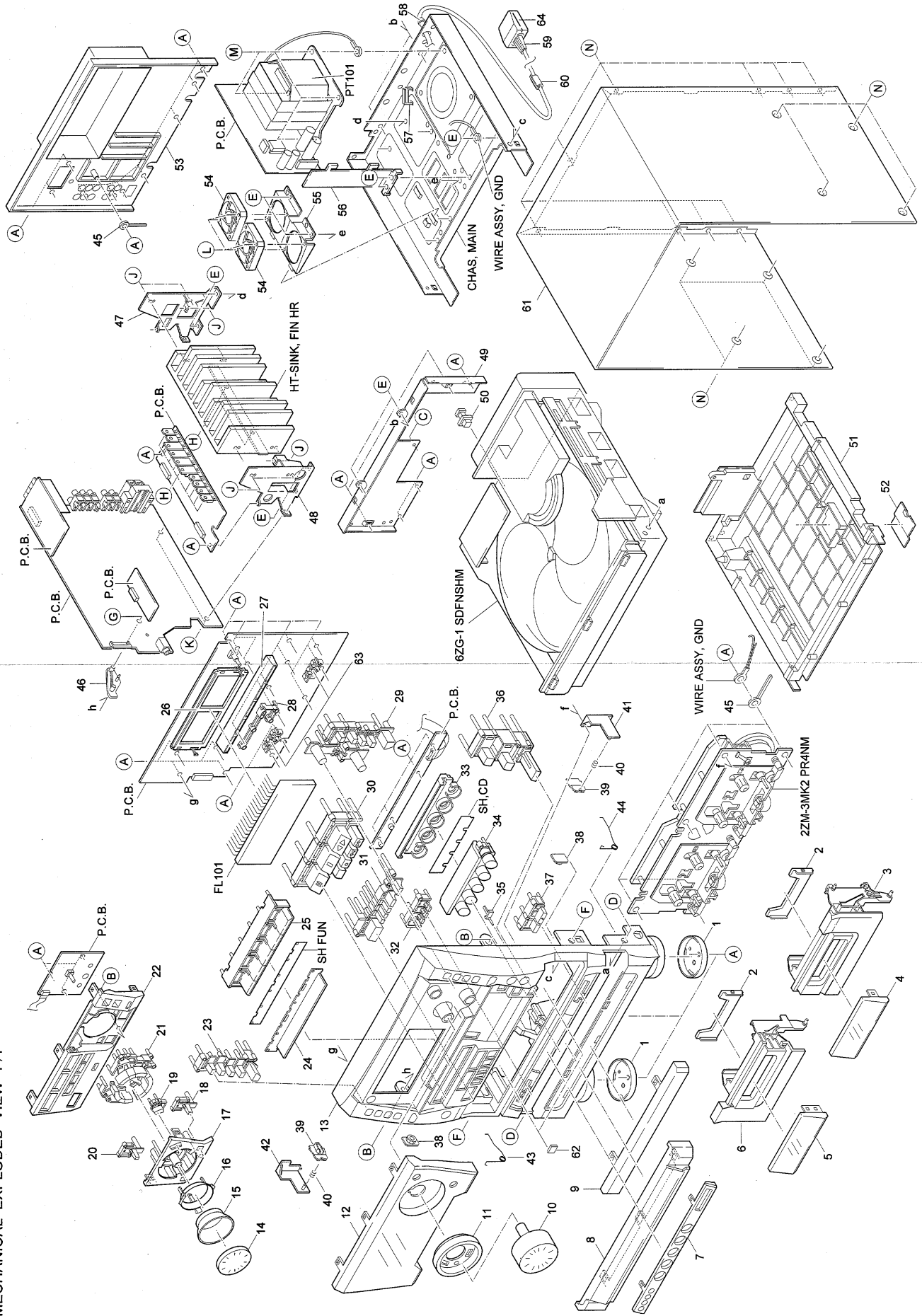

# MECHANICAL PARTS LIST 1 / 1

If can't understand for Description please kindly refer to "REFERENCE NAME LIST".

REF. NO	PART NO.	KANRI NO.	DESCRIPTION	REF. NO	PART NO.	KANRI NO.	DESCRIPTION
1	88-NF3-090-010		RING, FOOT	41	87-NF4-217-110		HLDR, LOCK 2
2	8Z-NF3-105-010		REFLECTOR, CASS	42	87-NF4-216-010		HLDR, LOCK 1
3	8Z-NF3-026-010		BOX, CASS R	43	82-NF5-219-010		SPR-T, EJECT 2 (SIN)
4	8Z-NF3-056-110		WINDOW, CASS R	44	82-NF5-218-010		SPR-T, EJECT 1 (SIN)
5	8Z-NF3-055-110		WINDOW, CASS L	45	87-064-185-010		HLDR, WIRE
6	8Z-NF3-025-010		BOX, CASS L	46	88-NF5-208-010		HLDR, PWB-M N
7	8Z-NF3-038-010		PANEL, CD	47	8Z-NF3-224-110		HLDR, HT-SINK 1
8	8Z-NF4-040-010		PANEL ASSY, TRAY	48	8Z-NF3-228-010		HLDR, HT-SINK R
9	8Z-NF3-046-010		COVER, CD H	49	8Z-NF3-029-010		PANEL, REAR
10	8Z-NF3-090-010		KNOB, RTRY MAIN	50	84-ZG1-245-210		CAP, OPTICAL
11	8Z-NF3-095-010		RING, MAIN	51	8Z-NF3-024-010		CABI, BOTTOM
12	8Z-NF3-051-010		WINDOW, DISP RDS	52	8Z-NF3-048-010		COVER, BOTTOM
13	8Z-NF3-001-010		CABI, FR H	53	8Z-NF4-014-010		CABI, REAR KSTNM
14	8Z-NF3-091-010		KNOB, RTRY JOG	54	87-A91-080-010		FAN, F614R-12MC-19-400MM
15	8Z-NF3-096-010		RING, JOG	55	8Z-NF3-229-110		HLDR, FAN 4CH
16	8Z-NF3-107-010		REFLECTOR, JOG	56	8Z-NF3-227-110		HLDR, PWB PT
17	8Z-NF3-039-010		PANEL, JOG	57	87-NF4-221-010		HLDR, CABLE
18	8Z-NF3-075-010		KEY, TIMER	58	87-085-185-010		BUSHING, AC CORD (E)
19	8Z-NF3-077-010		KEY, ENTER	59	87-A80-092-010		AC CORD ASSY, E BLK SUN FAI
20	8Z-NF3-076-010		KEY, CLOCK	60	87-A90-562-010		F-BEAD, 9.5-17.5-28.5 BRH
21	8Z-NF3-074-010		KEY, JOG	61	8Z-NF3-009-010		CABI, STEEL
22	8Z-NF4-035-010		PANEL, FR K	62	81-532-080-010		LABEL, CASS. COMPT
23	8Z-NF3-060-010		KEY, GEQ	63	87-NB6-212-010		GUIDE, LED L IND
24	8Z-NF3-106-010		REFLECTOR, FUN	64	87-099-811-010		PLUG, ADPTR CONV(K)
25	8Z-NF3-062-010		KEY, FUN	A	87-067-703-010		TAPPING SCREW, BVT2+3-10
26	8Z-NF3-210-010		GUIDE, FL	B	87-721-096-410		QT2+3-10 GLD
27	8Z-NF3-211-010		GUIDE, LED FUN	C	87-067-581-010		TAPPING SCREW, BVT2+3-15
28	8Z-NF3-212-010		GUIDE, LED OPE	D	87-721-097-410		QT2+3-12 GLD
29	8Z-NF3-061-010		KEY, DSP	E	87-067-688-010		BVTT+3-6
30	8Z-NF3-063-010		KEY ASSY, OPE	F	87-591-095-410		TAPPING SCREW, QIT+3-8 (GLD)
31	8Z-NF3-070-010		KEY, KARAOKE RDS	G	87-067-579-010		TAPPING SCREW, BVT2+3-8
32	8Z-NF3-078-010		KEY, CD	H	87-067-680-010		BVI T3+3-10
33	8Z-NF3-213-010		GUIDE, LED DIRECT	J	87-067-584-010		TAPPING SCREW, BVT2+3-6
34	8Z-NF3-079-210		KEY, DIRECT	K	87-NF4-224-010		S-SCREW, IT3B+3-8 CU
35	8Z-NF3-108-010		REFLECTOR, ECO	L	87-067-698-010		BVT2+3-18 (W/O, SLOT)
36	8Z-NF3-073-010		KEY, BBE	M	87-067-975-010		S-SCREW, IT+4-8
37	8Z-NF3-080-010		KEY, OPEN	N	87-067-641-010		UTT2+3-8 (W/O SLOT)BL
38	87-NF8-220-010		DMPR, 150				
39	82-NF5-229-010		PLATE, LOCK				
40	86-NF9-224-010		SPR-C, LOCK				

COLOR NAME TABLE

Basic color symbol	Color	Basic color symbol	Color	Basic color symbol	Color
B	Black	C	Cream	D	Orange
G	Green	H	Gray	L	Blue
LT	Transparent Blue	N	Gold	P	Pink
R	Red	S	Sliver	ST	Titan Silver
T	Brown	V	Violet	W	White
WT	Transparent White	Y	Yellow	YT	Transparent Yellow
LM	Metallic Blue	LL	Light Blue	GT	Transparent Green
LD	Dark Blue	DT	Transparent Orange		

# REFERENCE NAME LIST

## ELECTRICAL SECTION

DESCRIPTION	REFERENCE NAME
ANT	ANTENNAS
C-	CHIP
C-CAP	CAP, CHIP
C-CAP TN	CAP, CHIP TANTALUM
C-COIL	COIL, CHIP
C-DI	DIODE, CHIP
C-DIODE	DIODE, CHIP
C-FET	FET, CHIP
C-FOTR	FILTER, CHIP
C-JACK	JACK, CHIP
C-LED	LED, CHIP
C-RES	RES, CHIP
C-SFR	SFR, CHIP
C-SLIDE SW	SLIDE SWITCH, CHIP
C-SW	SWITCH, CHIP
C-TR	TRANSISTOR, CHIP
C-VR	VOLUME, CHIP
C-ZENER	ZENER, CHIP
CAP, CER	CAP, CERA-SOL
CAP, E	CAP, ELECT
CAP, M/F	CAP, FILM
CAP, TC	CAP, CERA-SOL
CAP, TC-U	CAP, CERA-SOL SS
CAP, TN	CAP, TANTALUM
CERA FIL	FILTER, CERAMIC
CF	FILTER, CERAMIC
DL	DELAY LINE
E/CAP	CAP, ELECT
FILT	FILTER
FLTR	FILTER
FUSE RES	RES, FUSE
MOT	MOTOR
P-DIODE	PHOTO DIODE
P-SNSR	PHOTO SENSER
P-TR	PHOTO TRANSISTOR
POLY VARI	VARIABLE CAPACITOR
PPCAP	CAP, PP
PT	POWER TRANSFORMER
PTR, RES	PTR, MELF
RC	REMOTE CONTROLLER
RES NF	RES, NON-FLAMMABLE
RESO	RESONATOR
SHLD	SHIELD
SOL	SOLENOID
SPKR	SPEAKER
SW, LVR	SWITCH, LEVER
SW, RTRY	SWITCH, ROTARY
SW, SL	SWITCH, SLIDE
TC CAP	CAP, CERA-SOL
THMS	THERMISTOR
TR	TRANSISTOR
TRIMER	CAP, TRIMMER
TUN-CAP	VARIABLE CAPACITOR
VIB, CER	RESONATOR, CERAMIC
VIB, XTAL	RESONATOR, CRYSTAL
VR	VOLUME
ZENER	DIODE, ZENER

## MECHANICAL SECTION

DESCRIPTION	REFERENCE NAME
ADHESHIVE	SHEET ADHESHIVE
AZ	AZIMUTH
BAR-ANT	BAR-ANTENNA
BAT	BATTERY
BATT	BATTERY
BRG	BEARING
BTN	BUTTON
CAB	CABINET
CASS	CASSETTE
CHAS	CHASSIS
CLR	COLLAR
CONT	CONTROL
CRSR	CURSOR
CU	CUSHION
CUSH	CUSHION
DIR	DIRECTION
DUBB	DUBBING
FL	FRONT LOADING
FLY-WHL	FLYWHEEL
FR	FRONT
FUN	FUNCTION
G-CU	G-CUSHION
HDL	HANDOL
HIMERON	CLOTH
HINGE, BAT	HINGE, BATTERY
HLDR	HOLDER
HT-SINK	HEAT SINK
IB	INSTRUCTION BOOKLET
IDLE	IDLER
IND, L-R	INDICATOR, L-R
KEY, CONT	KEY, CONTROL
KEY, PRGM	KEY, PROGRAM
KNOB, SL	KNOB, SLIDE
LBL	LABEL
LID, BATT	LID, BATTERY
LID, CASS	LID, CASSETTE
LVR	LEVER
P-SP	P-SPRING
PANEL, CONT	PANEL, CONTROL
PANEL, FR	PANEL, FRONT
PRGM	PROGRAM
PULLY, LOAD MO	PULLY, LOAD MOTOR
RBN	RIBBON
S-	SPECIAL
SEG	SEGMENT
SH	SHEET
SHLD-SH	SHIELD-SHEET
SL	SLIDE
SP	SPRING
SP-SCREW	SPECIAL-SCREW
SPACER, BAT	SPACER, BATTERY
SPR	SPRING
SPR-P	P-SPRING
SPR-PC-PUSH	P-SPRING, C-PUSH
T-SP	T-SPRING
TERM	TERMINAL
TRIG	TRIGGER
TUN	TUNING
VOL	VOLUME
W	WASHER
WHL	WHEEL
WORM-WHL	WORM-WHEEL

サービス技術ニュース	
番号	連絡内容
G-	-
G-	-
G-	-

**アイワ株式会社**  
**AIWA CO., LTD.**

9620450, 9630472

Tokyo Japan