

3-BAND STEREO RADIO CASSETTE RECORDER

MODEL **TPR-900** LEE, SEE, UK

AIWA®

[SERVICE MANUAL]



Set using ISO screws

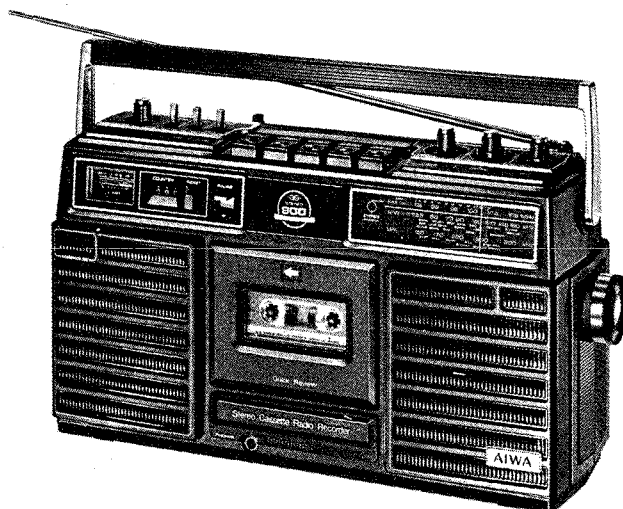

DATE OF ISSUE 25/7/1975

SPECIFICATIONS

Type: Stereo cassette recorder/radio
Circuit: 5 IC, 23 transistors, 16 diodes
Power source: Dry cell, 7.5V (UM-1 x 5)
House current, AC 110-120/220-240V (changeable)
Car battery, (thru car battery adaptor).

Frequency response: 50-10,000 Hz
Output: Max., 3.4 W (1.7 W + 1.7 W)
Power consumption: 12 W
Speaker: 100 mm ϕ 8 Ω type x 2

Tape Recorder Section

Built-in microphone: Electret condenser microphone (ECM) x 2
Tape speed: 4.8 cm/sec
Recording system: AC bias
Erasing system: AC erase
S/N ratio: 55dB
Wow & flutter: 0.18% (WRMS)
Fast forward time: 120 sec (w/C-60 cassette)
Rewinding time: 120 sec (w/C-60 cassette)

Radio Section

Circuitry: Superheterodyne

Frequency range: TPR-900LEE, UK
FM, 87.5-108 MHz
MW, 525-1605 kHz
LW, 150-300 kHz
TPR-900SEE
FM, 87.5-108 MHz
SW, 5.9-18 MHz
MW, 525-1,605 kHz
TPR-900LEE, UK
Antennas: Whip antenna for FM
Ferrite bar antenna for MW and LW
TPR-900SEE
Whip antenna for SW and FM
Ferrite bar antenna for MW and SW
Dimensions: 362(W) x 198(H) x 101(D) mm
Weight: 3.5 kg (w/o batteries)
Accessories: Battery (UM-1) x 5
Cassette tape x 1
Shorting Plug x 1
AC power cord x 1
Cleaning stick x 1

The specifications and external appearance of this set are subject to change without notice.

DISASSEMBLY INSTRUCTIONS

1. To Remove Back Cover

- 1) Remove the battery room lid.
- 2) Remove six screws, (1) through (6).
(Refer to Fig. 1)

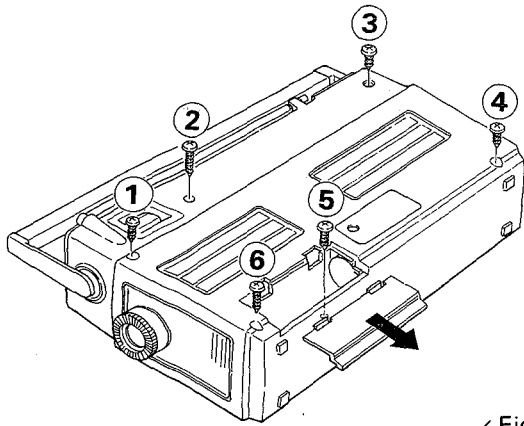

< Fig. 1 >

4. To Remove Tuner Circuit Board

- 1) Pull off the 4 knobs. (band selector, volume, tone and tuning).
- 2) Remove five screws, (1) through (5).
(Refer to Fig. 4)

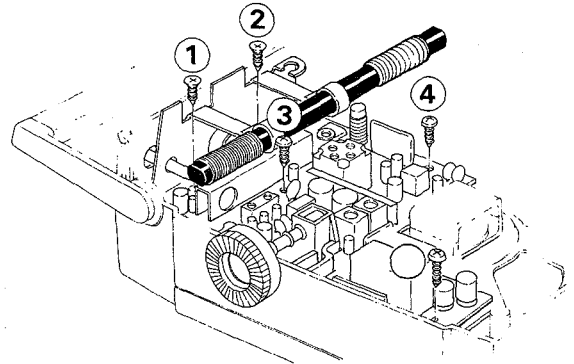

< Fig. 4 >

2. To Remove REC/PB Circuit Board

- 1) Remove three screws, (1) through (3).
(Refer to Fig. 2)

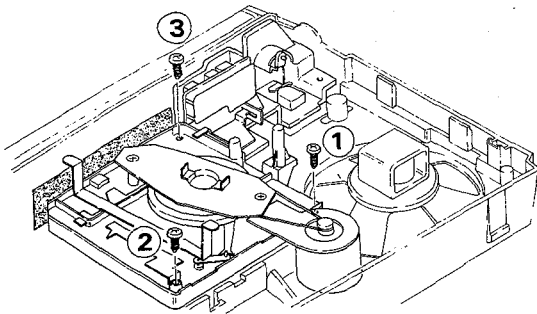

< Fig. 2 >

5. To Remove Switch Circuit Board

- 1) Remove six screws, (1) through (6).
(Refer to Fig. 5)

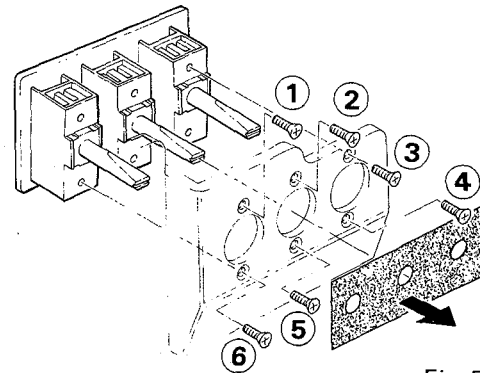

< Fig. 5 >

3. To Remove Chassis

- 1) Pull off the FUNCTION knob.
- 2) Remove three screws, (1)~(3)
(Refer to Fig. 3)

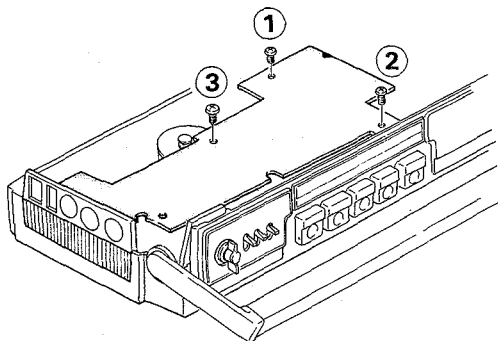

< Fig. 3 >

6. To Remove Power Circuit Board

- 1) Remove one screw (1).
(Refer to Fig. 6)

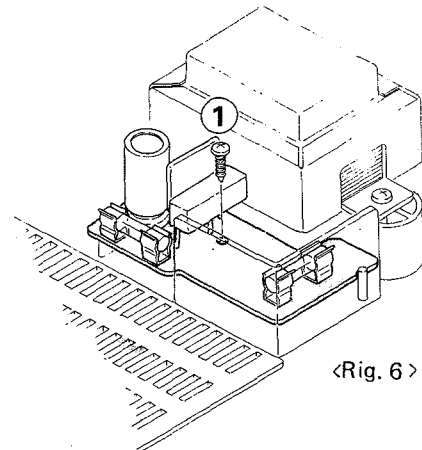

< Fig. 6 >

MECHANICAL ADJUSTMENTS

1. To Adjust Stopper Nozzle Pressure

Operate the set in FWD and apply a tension gauge to the tip of the stopper nozzle. Now, pull the gauge slowly in the arrow direction and read the value indicated on the gauge when the Auto (automatic stop) mechanism becomes activated. Adjust the nozzle pressure for 50-65 g.

How to Adjust:

When the nozzle pressure is found improper, adjust it by bending the stopper spring in either A or B direction. (Refer to Fig. 7)

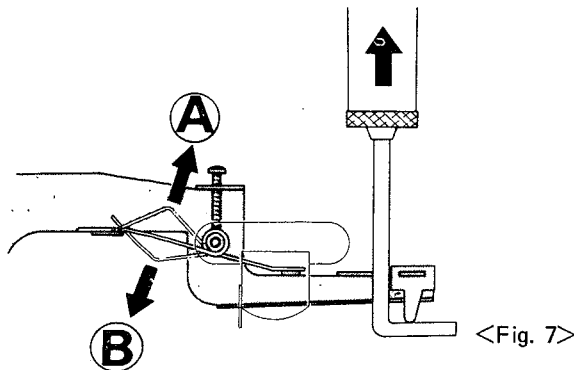

2. To Adjust Position of Brake Lever B

Operate the set in FWD and fasten the screws while pulling the stopper levers A and B fully in the respective arrow directions. Next, confirm that the brake shoe becomes disengaged from the reel platform when the set is operating in FF or REW. (Refer to Fig. 8)

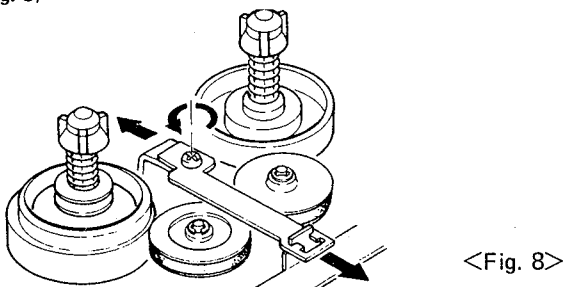

3. Stopper Lever B Position Adjustment

With the set at play condition, turn the adjusting screw in either A or B direction so that spacing between stopper lever B and stopper lever C becomes 0.1 - 0.3 mm. (Apply locking compound to screw after adjusting). (Refer to Fig. 9)

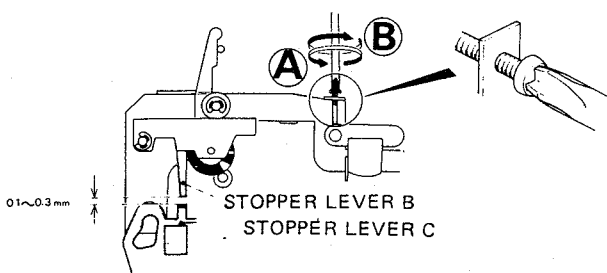

4. Pinch Roller Pressure

350 ~ 450g

5. Take-up Torque

50 ~ 70g/cm.

6. Rewind Torque

80g/cm or higher

7. Fast Forward Torque

50 ~ 80g/cm.

8. Tape Speed Variation

±3%

Use a standard test tape, TTA-111 (3kHz) or equivalent.

9. Wow & Flutter

0.24 ± 0.08% RMS. (at PB)

Use a standard test tape, TTA-111 (3kHz) or equivalent.

10. Rewind Time

105 ± 6 sec. with C-60 cassette.

11. Fast Forward Time

108 ± 6 sec. with C-60 cassette.

12. Current Consumption

FWD: 160 ± 25mA

FF: 220 ± 40mA

REW: 180 ± 40mA

(mechanism only)

DIAL STRINGING

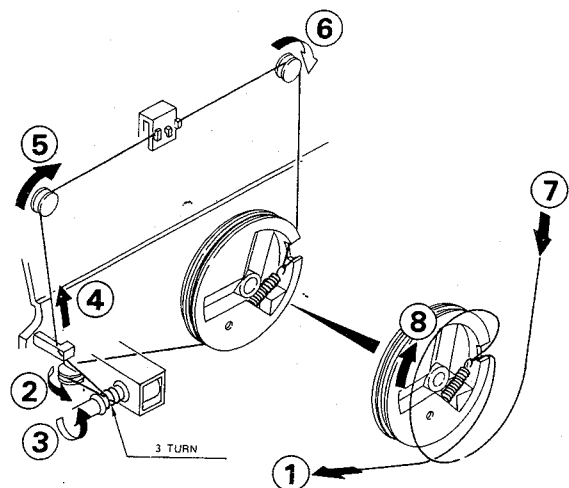

◀ TUNER SECTION ▶

■ Locations of Main Parts (For LEE UK Model)

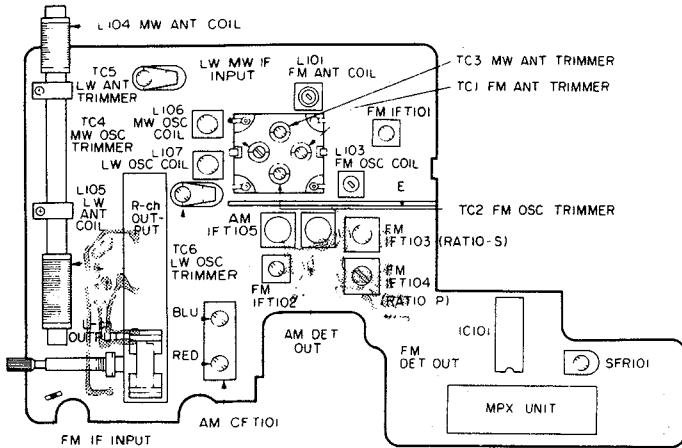

1. Instruments Required

Signal Source

1. RF Signal generator (AM, FM). 455 kHz/468 kHz.
2. IF sweep generator (Centered for AM and 10.7 MHz for FM).

Output Indicator

1. V.T.V.M.
2. Oscilloscope

Regulator Adjusting Steps (For LEE UK Model)

For band	For stages on each band
1. AM (MW)	1st: IF 2nd: RF frequency range 3rd: RF tracking
2. LW	1st: RF frequency range 2nd: RF tracking
3. FM	1st: IF 2nd: RF frequency range 3rd: RF tracking

■ Locations of Main Parts (For SEE Model)

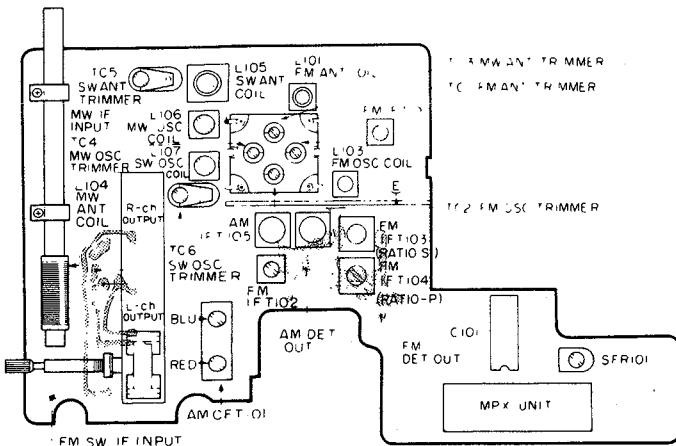

Regulator Adjusting Steps (For SEE Model)

For band	For stages on each band
1. AM (MW)	1st: IF 2nd: RF frequency range 3rd: RF tracking
2. SW	1st: RF frequency range 2nd: RF tracking
3. FM	1st: IF 2nd: RF frequency range 3rd: RF tracking

AM-IF Alignment

Step	Signal source	Set signal to	Alignment indicator	Set radio dial to	Adjust	Adjust for
	Connect to		Connect to			
1	AM IF sweep gen.	Sweep centered 455kHz-LEE, SEE Model 468kHz-UK Model	Oscilloscope	Min. Freq.	CFT101 (AM)	Maximum
	Antenna terminal		AM det. output tab			

MW-RF Alignment

Step	Signal source	Set signal to	Alignment indicator	Set radio dial to	Adjust	Adjust for
	Connect to		Connect to			
1	AM signal gen.	MW 515 kHz (Modulated)	V.T.V.M.	515 kHz (Low end)	L106 (OSC coil)	Maximum
	Antenna terminal		AM det. output tab			
2	Antenna terminal	1650 kHz (Modulated)	AM det. output tab	1650 kHz (High end)	TC-4 (OSC trim.)	Maximum
3	(Repeat steps 1 and 2 to obtain frequency range.)					
4	Antenna terminal	600 kHz (Modulated)	AM det. output tab	600 kHz	L104 (ANT coil)	Maximum
5	Antenna terminal	1400 kHz (Modulated)	AM det. output tab	1400 kHz	TC-3 (ANT trim.)	Maximum
6	(Repeat steps 4 and 5 to minimize tracking error, and also step 3 if necessary.)					

SW-RF Alignment (SEE model only)

Step	Signal source	Set signal to	Alignment indicator	Set radio dial to	Adjust	Adjust for
	Connect to		Connect to			
1	AM signal gen.	SW 5.8MHz (Modulated)	V.T.V.M.	5.8 MHz (Low end)	L107 (OSC coil)	Maximum
	Antenna terminal		AM det. output tab			
2	Antenna terminal	18.5 MHz (Modulated)	AM det. output tab	18.5 MHz (High end)	TC-6 (OSC trim.)	Maximum
3	(Repeat steps 1 and 2 to obtain frequency range.)					
4	Antenna terminal	6.5MHz (Modulated)	AM det. output tab	6.5 MHz	L105 (ANT coil)	Maximum
5	Antenna terminal	18.0MHz (Modulated)	AM det. output tab	18.0 MHz	TC-5 (ANT trim.)	Maximum
6	(Repeat steps 4 and 5 to minimize tracking error, and also step 3 if necessary.)					

LW-RF Alignment (LEE, UK model only)

Step	Signal source	Set signal to	Alignment indicator	Set radio dial to	Adjust	Adjust for
	Connect to		Connect to			
1	AM signal gen.	LW 145 kHz (Modulated)	V.T.V.M.	145 kHz (Low end)	L107 (OSC coil)	Maximum
	Antenna terminal		AM det. output tab			
2	Antenna terminal	310kHz (Modulated)	AM det. output tab	310kHz (High end)	TC-6 (OSC trim.)	Maximum
3	(Repeat steps 1 and 2 to obtain frequency range.)					
4	Antenna terminal	145 kHz (Modulated)	AM det. output tab	145 kHz	L105 (ANT coil)	Maximum
5	Antenna terminal	310kHz (Modulated)	AM det. output tab	310 kHz	TC-5 (ANT trim.)	Maximum
6	(Repeat steps 4 and 5 to minimize tracking error, and also step 3 if necessary.)					

FM-IF Alignment

Step	Signal source	Set signal to	Alignment indicator	Set radio dial to	Adjust	Adjust for
	Connect to		Connect to			
1	FM IF sweep gen.	Sweep centered 10.7 MHz	Oscilloscope	Max. Freq.	IFT101 IFT102	Max. Symmetrical response, equal heights
	Antenna terminal		FM det. output tab			
2	Antenna terminal	Sweep centered 10.7 MHz	FM det. output tab	Max. Freq.	IFT103 IFT104	Symmetrical response, centered 10.7 MHz
3	(Repeat 1 and 2 to obtain a balanced "S" curve linearity.)					

FM-RF Alignment

Step	Signal source	Set signal to	Alignment indicator	Set radio dial to	Adjust	Adjust for
	Connect to		Connect to			
1	FM signal gen.	88 MHz (Modulated)	V.T.V.M.	88 MHz	L103 (OSC coil)	Maximum
	Antenna terminal		FM det. output tab			
2	Antenna terminal	107 MHz (Modulated)	FM det. output tab	107 MHz	TC-2 (OSC trim.)	Maximum
3	(Repeat steps 1 and 2 to obtain frequency range.)					
4	Antenna terminal	88 MHz (Modulated)	FM det. output tab	88 MHz	L101 (ANT coil) L102 (RF coil)	Maximum
5	Antenna terminal	107 MHz (Modulated)	FM det. output tab	107 MHz	TC-1 (ANT trim) TC-2 (RF trim)	Maximum
6	(Repeat steps 4 and 5 to minimize tracking error, and step 3 if necessary.)					

How to change the upper limit of FM frequency range from 107MHz to 103MHz.

Symbol No.	Description	107 MHz		103 MHz	
L103	FM Coil	1½ t	87-006-016-01	1½t	87-006-015-01
C102	Ceramic Capacitor	10PF	88-212-100-01	14PF	88-212-140-01
C110	Ceramic Capacitor	6PF	88-212-060-01	14PF	88-212-140-01

MPX Adjustment

Adjustment Conditions

Carrier frequency	96MHz
Input Signal	54dB
Modulation frequency	1kHz
Modulation	100%

MODE switch to STEREO; input applied to FM ANT INPUT; LINE OUT output employed.

Adjustment:

Adjust separation trimmer resistor SFR-101 for optimum separation. After adjustment, confirm that stereo indicator lights.

TAPE RECORDER ADJUSTMENTS

ELECTRICAL SECTION

■ Location of Main Part

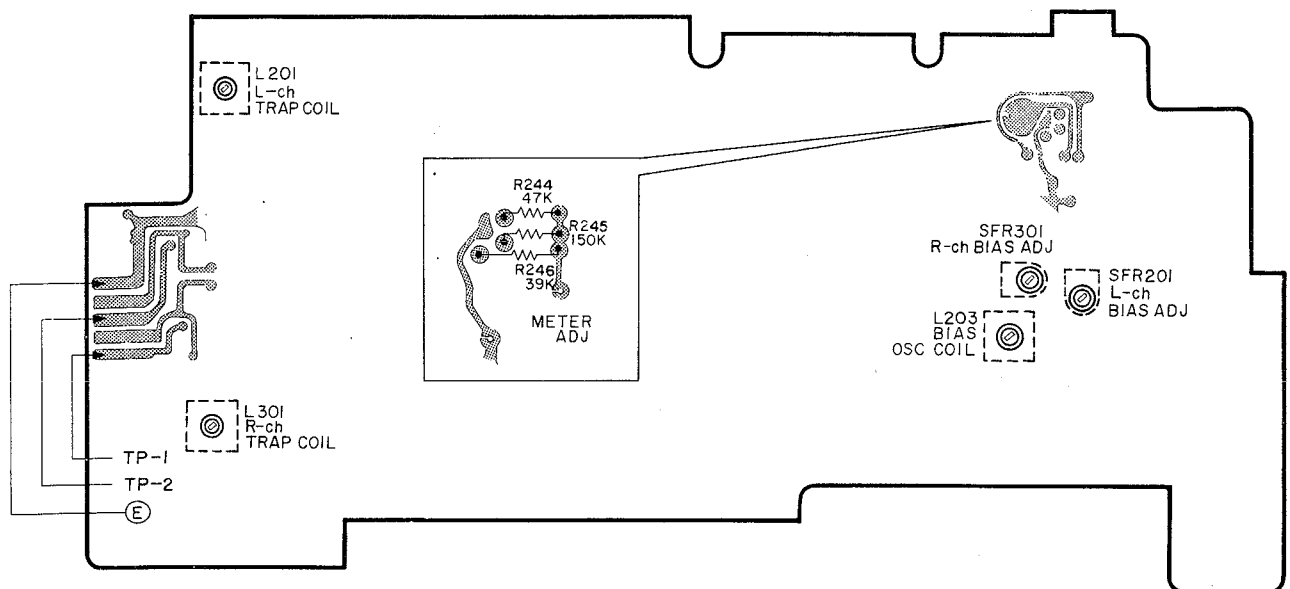

1. Azimuth Adjustment

- 1) Position MODE switch to STEREO and FUNCTION switch to TAPE.
- 2) Connect headphone jack output to the H & V terminals of an oscilloscope.
- 3) Play test tape TTA-117D (8kHz) and turn azimuth adjusting screw to obtain equal phase resurge waveforms at maximum.

2. Bias Frequency Adjustment

- 1) Position FUNCTION switch to TAPE, TAPE switch to NORMAL, and OSC switch to "· ·"
- 2) Connect VTVM and frequency counter between test points and ground. Connect left channel between TP-1 and E, and right channel between TP-2 and E.
- 3) With set at record condition, turn the BIAS OSC coil (L203) and adjust oscillating frequency to 48.0kHz
- 4) Confirm that the frequency changes as below when the OSC switch is operated.
 - "· ·" 48.8kHz ± 200kHz
 - "1" 45.6kHz ± 200kHz

3. Bias Current Adjustment

- 1) Connect VTVM between test point TP-1 and E. Adjust trap coil (L301) for maximum voltage indication.
- 2) Next turn the BIAS ADJ resistor (SFR301) and adjust for 32 ± 3mV indication on the VTVM.
- 3) In the same manner, connect the VTVM between TP-2 and E, and adjust L201 and SFR201.

4. Meter Voltage Indication Adjustment

- 1) Adjust regulated DC power supply to 5.6V and apply to the DC jack of the set.
- 2) With pattern connection, adjust for indication within the yellow and red limits inside the meter during playback.

BLOCK DIAGRAM

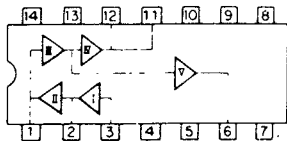
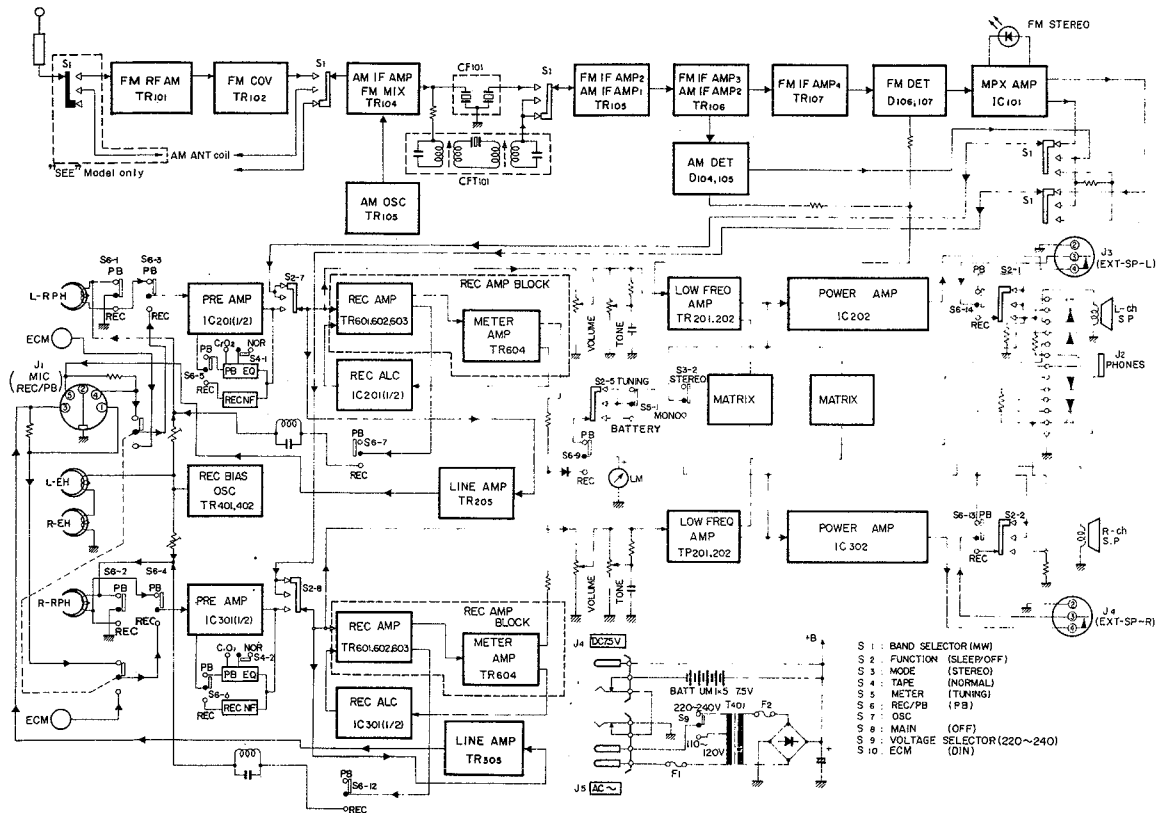

LA-3301

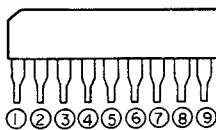

TA-3137P

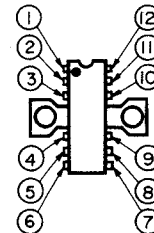

HA-1329

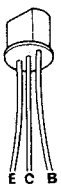

2SC784
2SC380
2SC732



2SB56



1S188
1N60



M85BA-0



WZ061

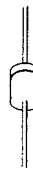

1S553

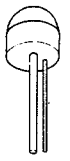

S8169

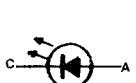
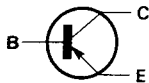
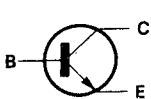

SCHEMATIC DIAGRAM - TPR-900LEE,UK

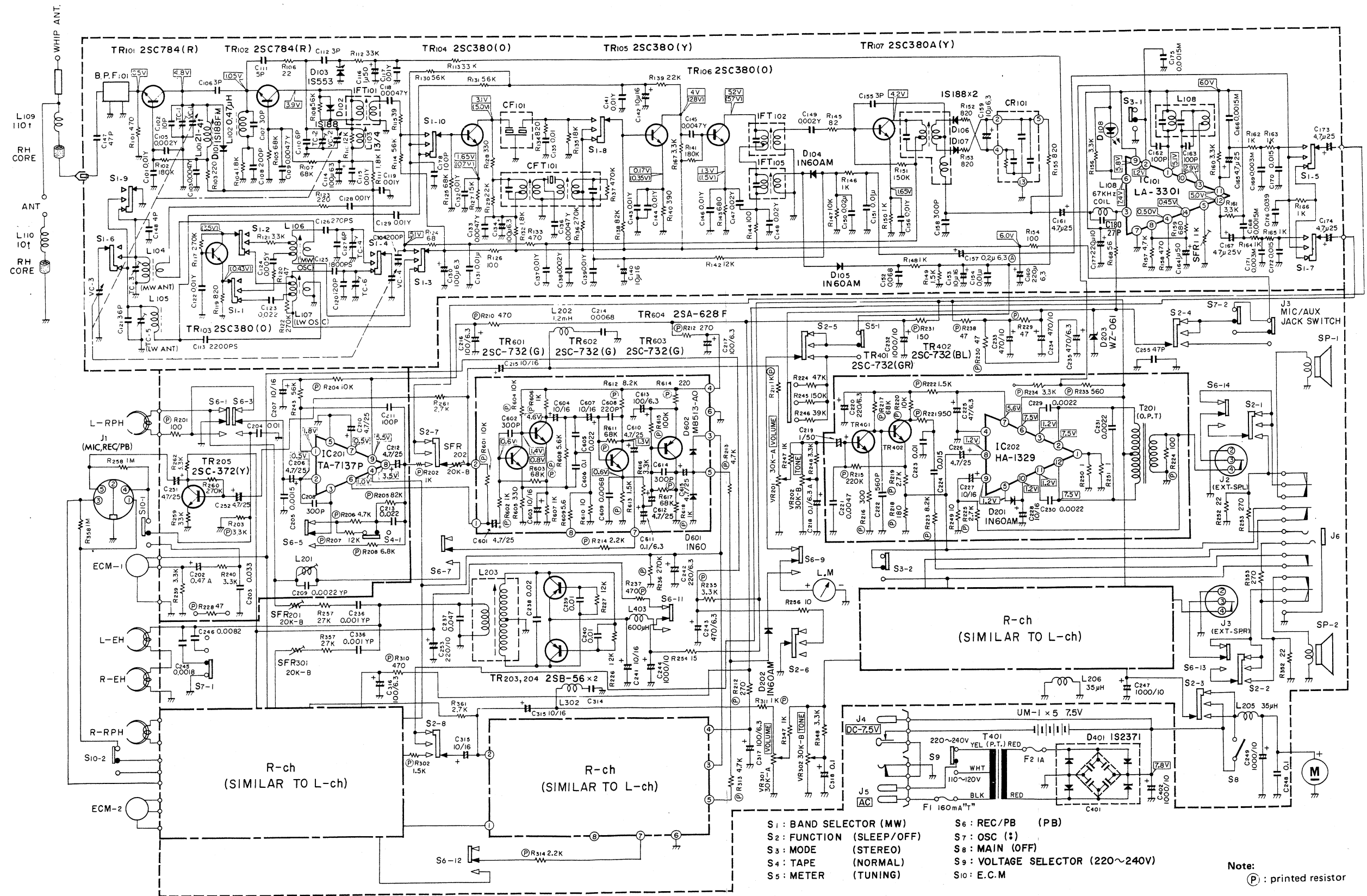

WIRING — TPR-900LEE,UK

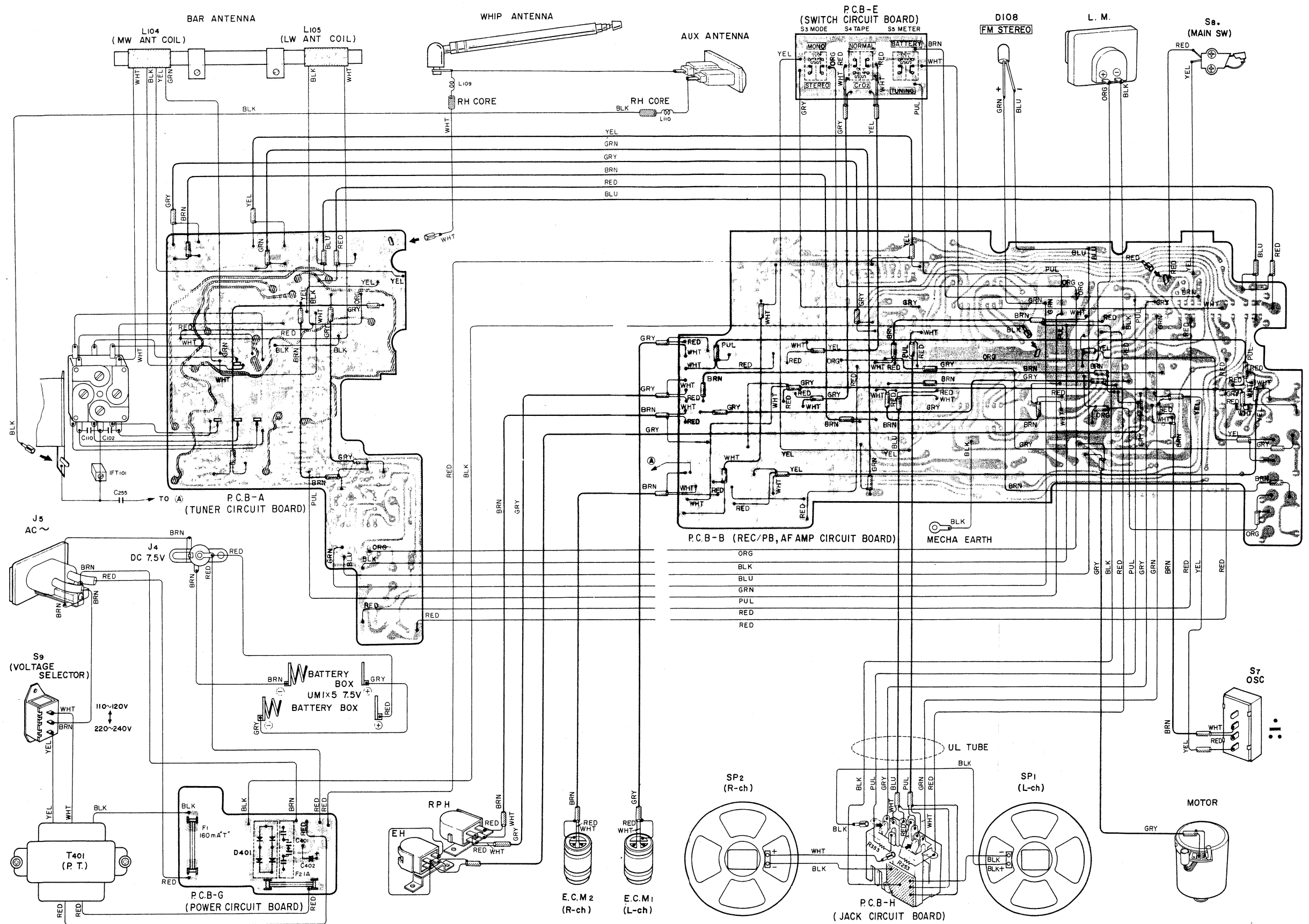

WIRING - TPR-900SEE

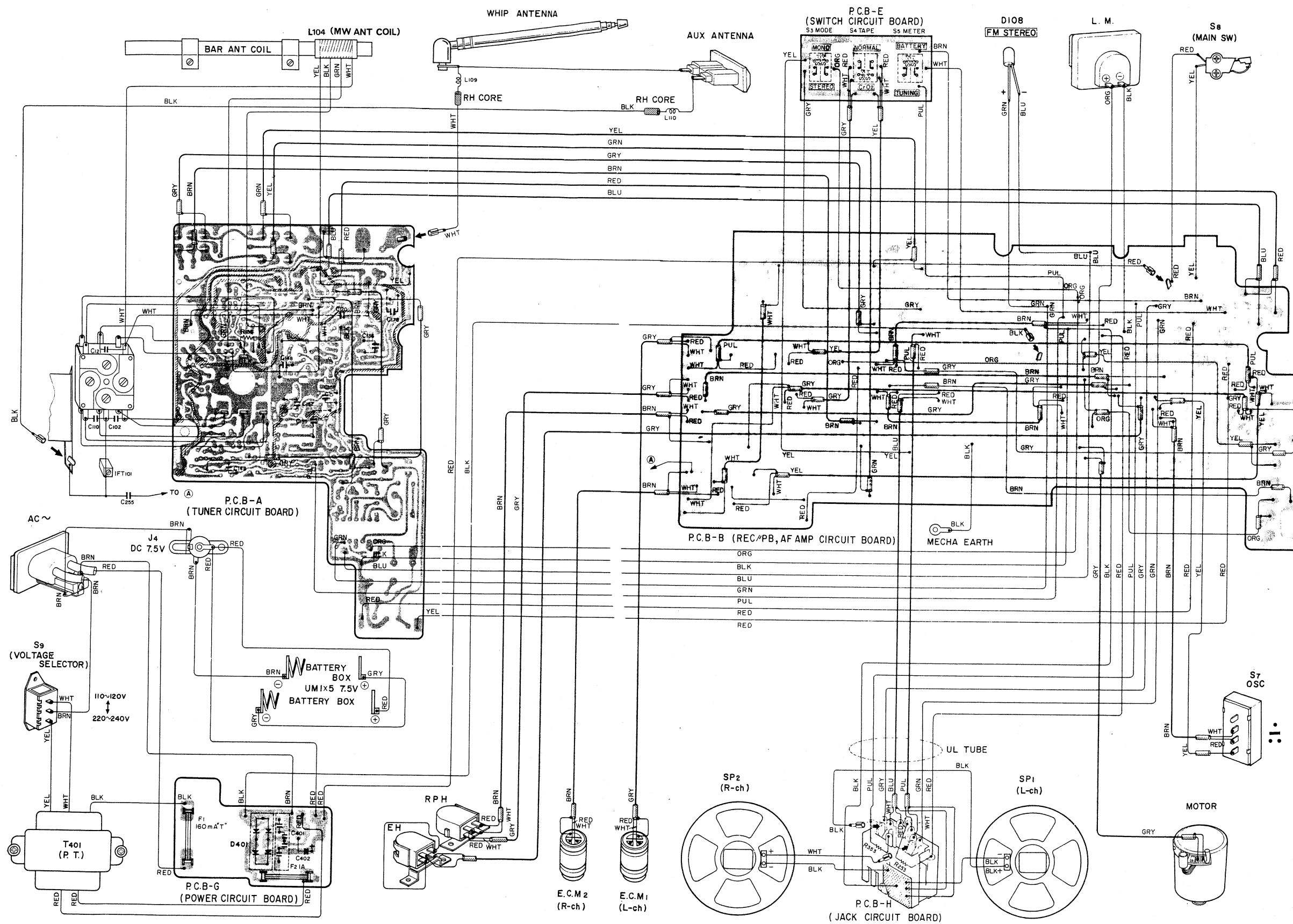

TUNER CIRCUIT BOARD – TPR-900LEE,U K

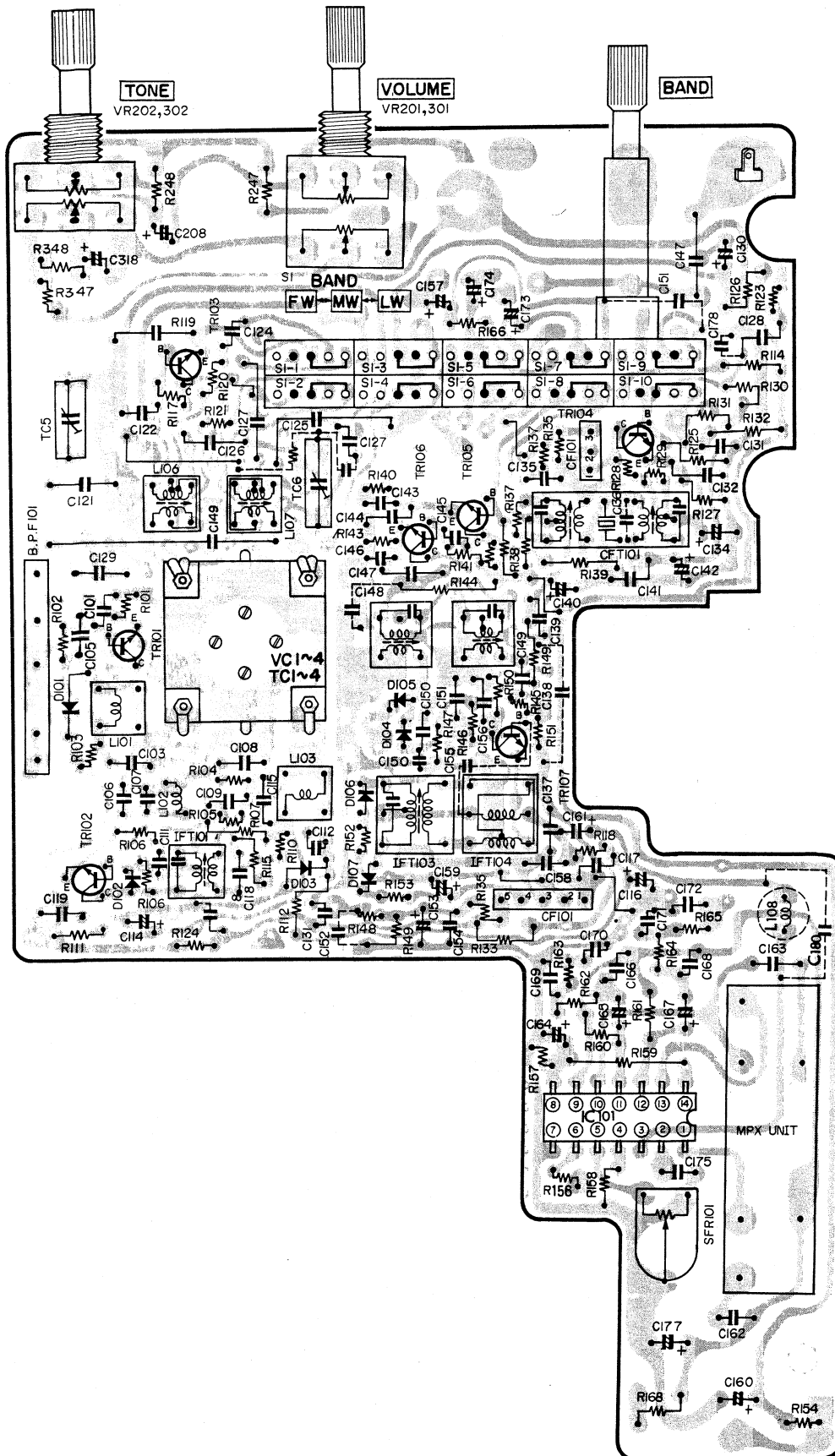

TUNER CIRCUIT BOARD – TPR-900SEE

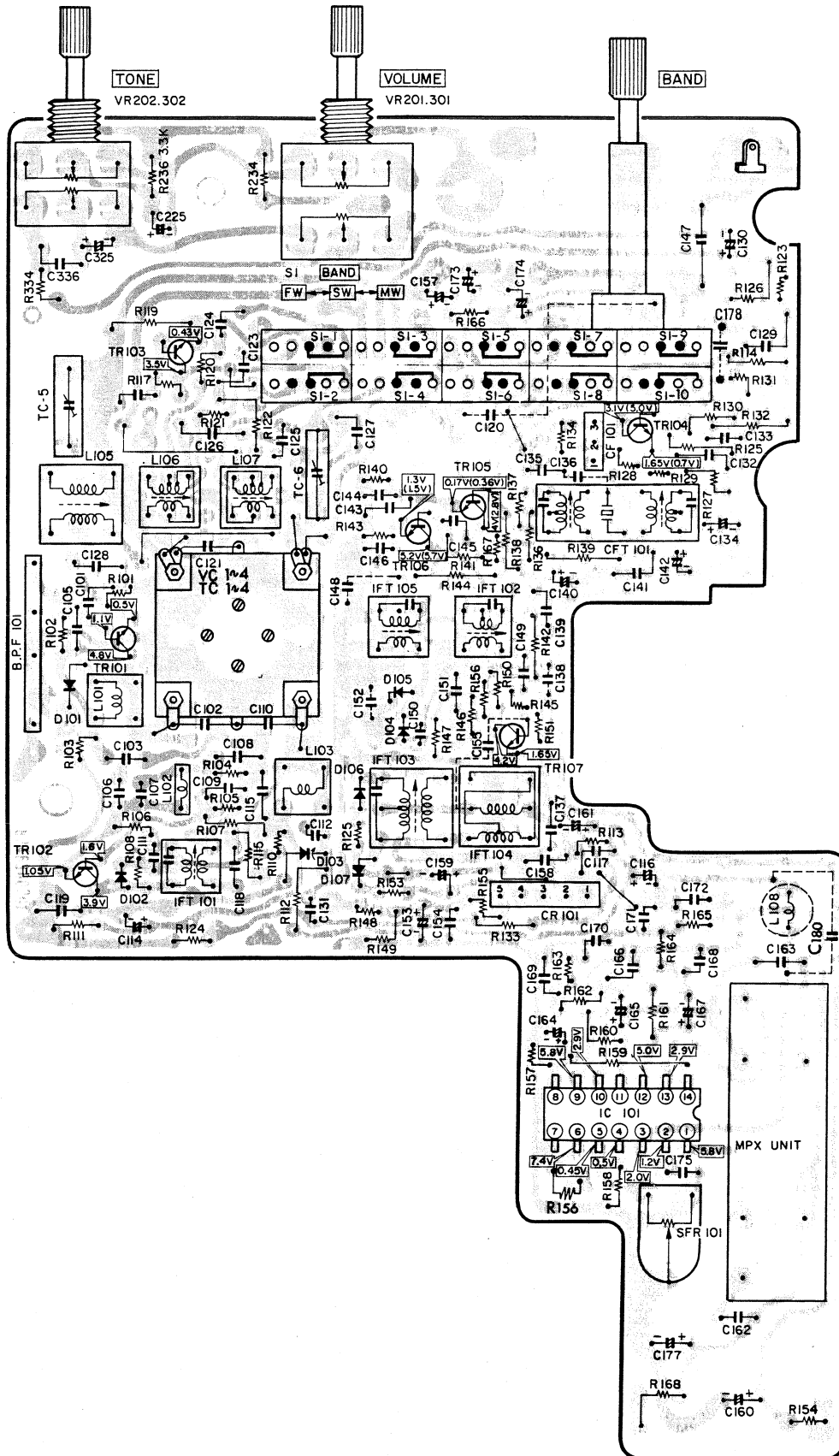

REC/PB & REC BLOCK CIRCUIT BOARD

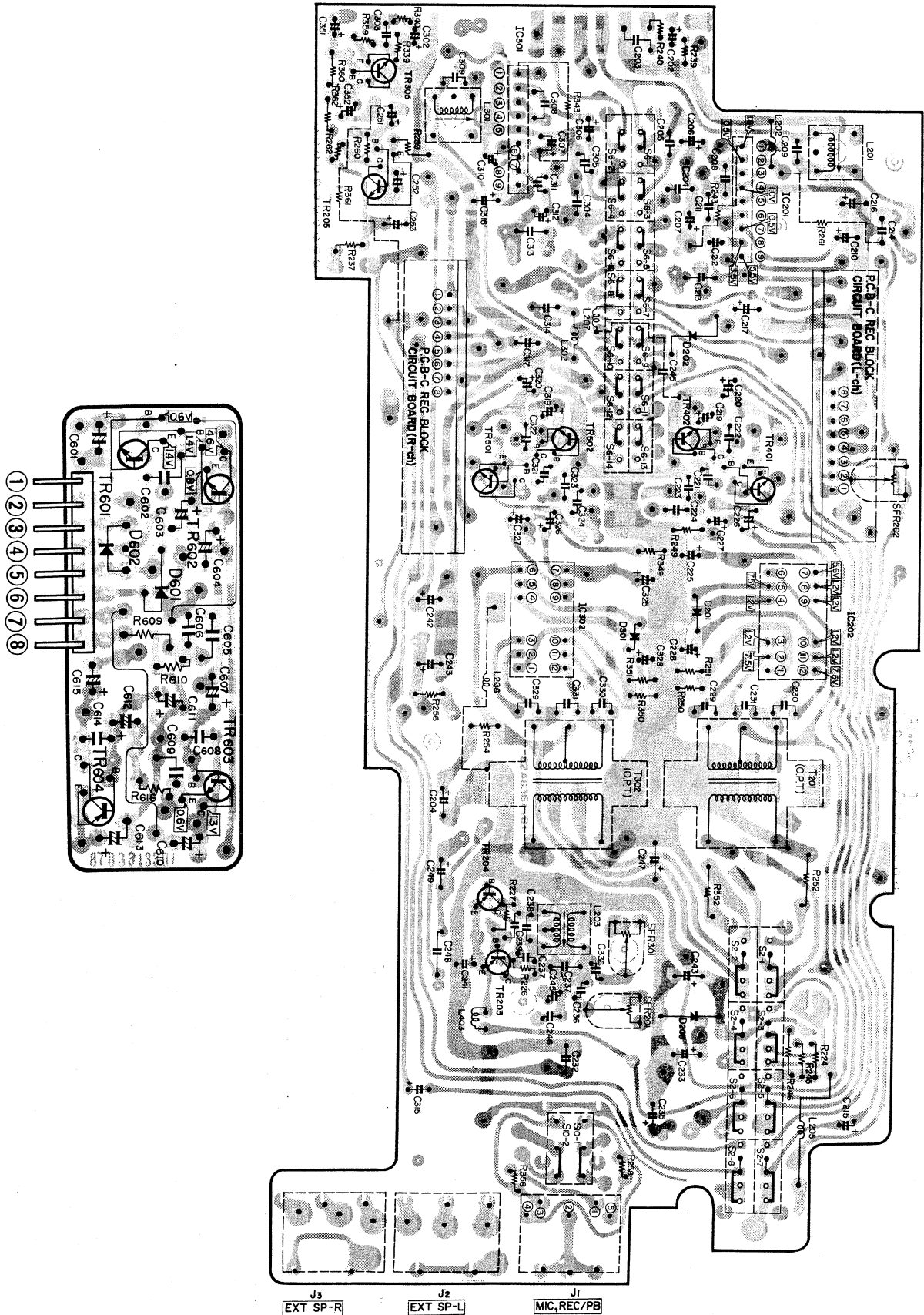

EXPLODED VIEW-1

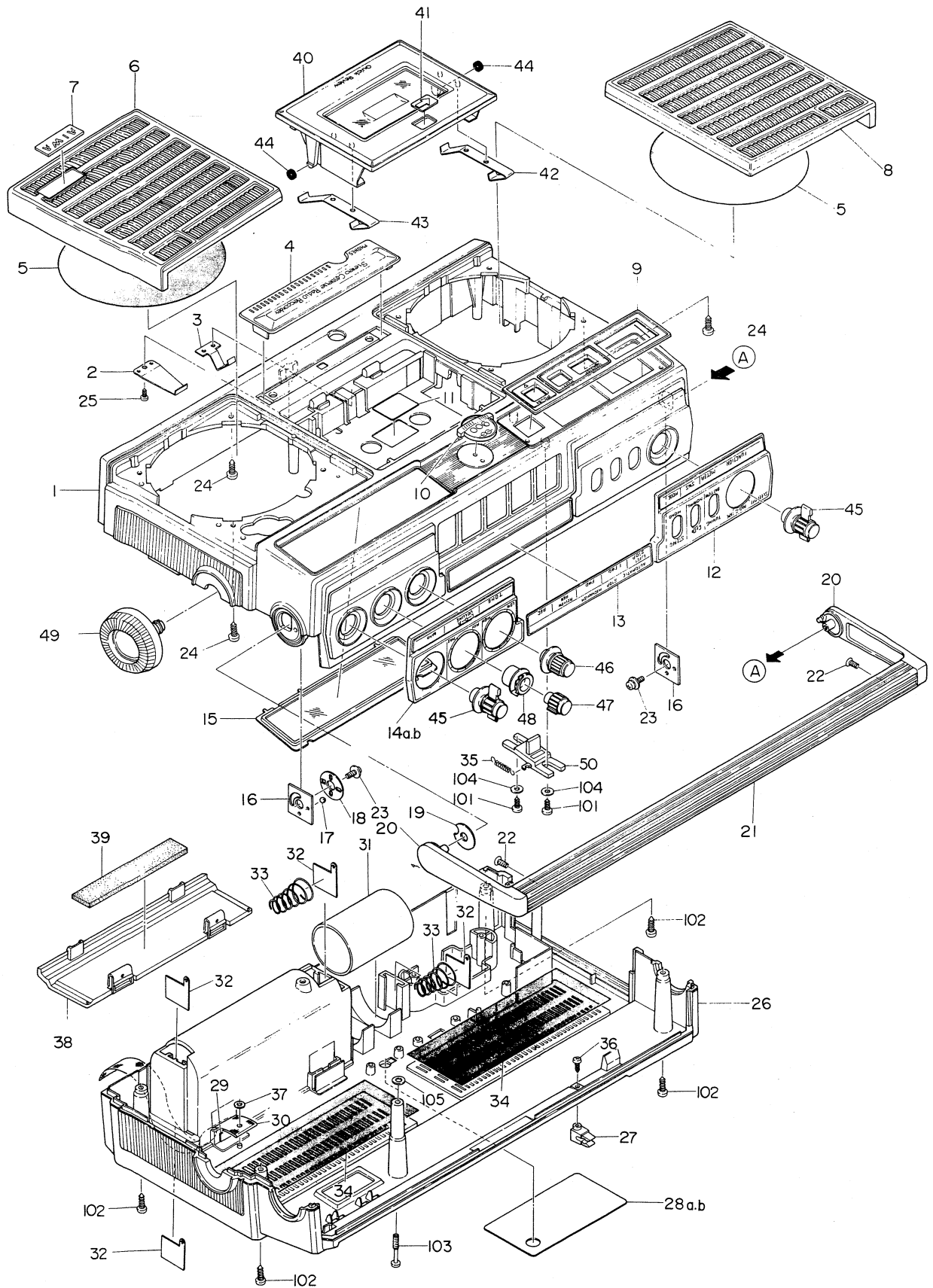

PARTS LIST

MECHANICAL PARTS

* mark in this part list shows exclusive part (which is used) for only Model TPR-900.

Ref. No.	Part No.	Part No. Changed to	Description	Common Model	Q'ty
1~39	80-004-630-4L		Cabinet Assembly --"LEE" model (Main case ass'y + Back cover ass'y + Battery room lid ass'y)		
1~39	80-004-630-4S		Cabinet Assembly --"SEE" model (Main case ass'y + Back cover ass'y + Battery room lid ass'y)		
1~39	80-004-630-01		Cabinet Assembly --"UK" model (Main case + Back cover ass'y + Battery room lid ass'y)		
1~25	80-004-631-4L		Main case ass'y -- LEE model only		
1~25	80-004-631-4S		Main case ass'y -- SEE model only		
1~25	80-004-631-01		Main case ass'y -- UK model only		
1-1	82-463-001-01		Case proper	*	1
1-2	82-463-217-01		Plate spring, Cassette-up	*	1
1-3	82-416-224-01		Pressure spring, Cassette	TPR-601	1
1-4	82-463-042-01		Name plate, Front	*	1
1-5	82-283-310-01		Dust screen cloth, Speaker	TP-770	2
1-6	82-463-065-01		Grill, Right; Speaker	*	1
1-7	87-054-066-01		Badge, AIWA	*	1
1-8	82-463-066-01		Grill, Left; Speaker	*	1
1-9	82-463-039-01		Window, Tape counter	*	1
1-10	82-463-078-01		Badge, STEREO	*	1
1-11	82-277-024-01		Label, Tape indicator	TP-743	1
1-12	82-463-061-01		Name plate H, Upper	*	1
1-13	82-463-012-01		Name plate A, Upper	*	1
1-14a	82-463-086-01		Name plate, Upper ("LEE", "UK" only)	*	1
1-14b	82-463-047-01		Name plate, Upper ("SEE" only)	*	1
1-15	82-463-011-01		Window, Tuning dial	*	1
1-16	82-429-225-01		Click plate	TPR-107	2
1-17	82-073-006-01		Steel ball, 3mmφ		1
1-18	82-429-257-01		Washer, Click	TPR-107	1
1-19	82-428-365-01		Washer, Poly-slider (6mmφ diam.)		1
1-20	82-429-014-01		Metal fitting, Carrying handle	TPR-107	2
1-21	82-463-026-01		Carrying handle	*	1
1-22	87-233-095-01		Q ⊕ 3-8		4
1-23	87-490-094-01		VWS ⊕ 3-6		2
1-24	87-341-096-01		UT ₁ ⊕ 3-10		4
1-25	87-341-095-01		UT ₁ ⊕ 3-8		1
26~37	80-004-632-4L		Back cover ass'y -- LEE model only		
26~37	80-004-632-4S		Back cover ass'y -- SEE model only		
26~37	80-004-632-01		Back cover ass'y -- UK model only		
1-26	82-463-002-01		Back cover	*	1
1-27	81-403-212-21		Holder, Rod Antenna	*	1
1-28a	82-463-085-01		Name plate, Spec. -- LEE, SEE model only	*	1
1-28b	82-463-090-01		Name plate, Spec. -- UK model only	*	1
1-29	82-409-206-01		Stopper B, Carrying handle	TPR-201	1
1-30	82-412-243-01		Ribbon, Battery	TPR-401	1
1-31	82-463-215-01		Battery case	*	1
1-32	87-038-032-01		Terminal plate, Battery		4
1-33	82-222-036-01		Terminal spring, Battery		2
1-34	82-463-029-01		Dust screen cloth, Back cover	*	2
1-35	82-458-333-01		Plate spring, Pause lever	TPR-4001	1
1-36	87-352-074-01		VT ₂ ⊕ 2.6-8		1
1-37	87-081-015-01		FW 3mmφ diam.		1
38~39	80-004-633-4L		Battery room lid ass'y -- LEE model only		
38~39	80-004-633-4S		Battery room lid ass'y -- SEE model only		
38~39	80-004-633-01		Battery room lid ass'y -- UK model only		
1-38	82-463-003-01		Battery room lid	*	1
1-39	82-416-260-01		Cushion, Battery room lid	TPR-601	1
40~44	80-004-637-4L		Cassette box ass'y -- LEE model only		
40~44	80-004-637-4S		Cassette box ass'y -- SEE model only		
40~44	80-004-637-01		Cassette box ass'y -- UK model only		
1-40	82-463-064-01		Cassette box	*	1
1-41	82-282-009-01		Name plate, Indicator	TP-747	1
1-42	82-463-231-01		Pressure spring left, Cassette	*	1
1-43	82-463-230-01		Pressure spring right, Cassette	*	1
1-44	82-461-319-01		Cushion, Cassette lid	TPR-930	2
1-45	82-463-058-01		Selector knob ass'y	*	2
1-46	82-463-053-01		Volume knob A ass'y	*	1
1-47	82-463-055-01		Volume knob B ass'y	*	1
1-48	82-463-057-01		Volume knob C	*	1
1-49	82-463-067-01		Tuning knob ass'y	*	1
1-50	82-463-040-01		Button, Pause	*	1

EXPLODED VIEW-2

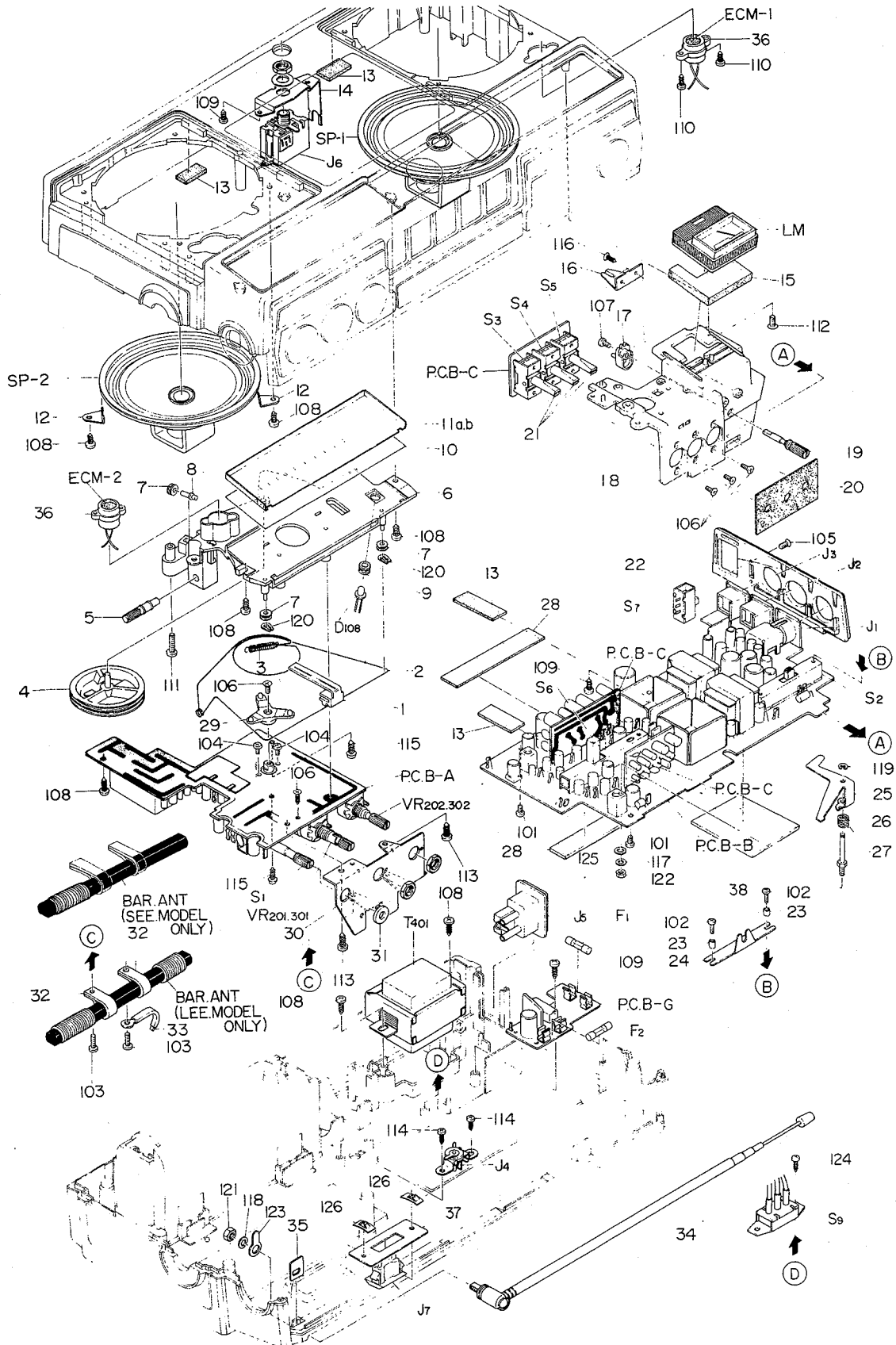

Ref. No.	Part No.	Part No. Changed to	Description	Common Model	Q'ty
2-1	82-463-016-01		Pointer, Tuning dial	*	1
2-2	87-096-048-01		Drive string, Tuning dial		700 mm
2-3	82-422-294-01		Spring, Dial drum	TPR-203	1
2-4	82-422-203-01		Dial drum	TPR-203	1
2-5	82-463-248-01		Shaft, Tuning	*	1
2-6	82-463-201-01		Chassis R	*	1
2-7	81-385-014-01		Roller		3
2-8	82-463-227-01		Shaft, Tuning roller	*	1
2-9	82-463-216-01		Rubber bushing	*	1
2-10	82-463-038-01		Adhesive paper, Dial plate	*	1
2-11a	82-463-087-01		Dial plate -- ("LEE", "UK" only)	*	1
2-11b	82-463-089-01		Dial plate -- ("SEE" only)	*	1
2-12	82-274-222-01		Metal fitting, Speaker		4
2-13	93-464-154-03		Cushion		4
2-14	82-463-212-01		Metal fitting, Jack	*	1
2-15	82-463-261-01		Cushion, Meter	*	1
2-16	82-463-210-01		Plate spring, Click	*	1
2-17	82-463-208-01		Cam, Selector	*	1
2-18	82-463-240-01		Switch bracket ass'y	*	1
2-19	82-463-209-01		Shaft, Selector	*	1
2-20	82-463-247-01		Himeron cloth, Switch	*	1
2-21	82-374-034-01		Knob, Selector	AD-1200	3
2-22	82-463-083-01		Jack plate	*	1
2-23	82-429-246-01		B collar	TPR-107	2
2-24	82-463-223-01		Slide plate, Switch	*	1
2-25	82-463-214-01		Record changeable lever	*	1
2-26	82-463-220-01		Spring, Record changeable lever	*	1
2-27	82-463-213-01		Shaft, Record changeable lever	*	1
2-28	82-416-260-01		M cushion	TPR-601	2
2-29	82-422-231-01		Dial joint	TPR-203	1
2-30	82-463-203-01		Mount metal fitting	*	1
2-31	82-463-232-01		Switch supporter	*	1
2-32	81-175-008-01		Holder, Core		2
2-33	87-038-039-01		Wire binder		2
2-34	82-412-013-01		Whip antenna	TPR-401	1
2-35	82-463-076-01		Holder, Antenna	*	1
2-36	87-064-058-01		ECM holder		2
2-37	82-463-088-01		Terminal plate	*	1
2-38	82-422-281-01		M cushion B	TPR-203	1

EXPLODED VIEW-3

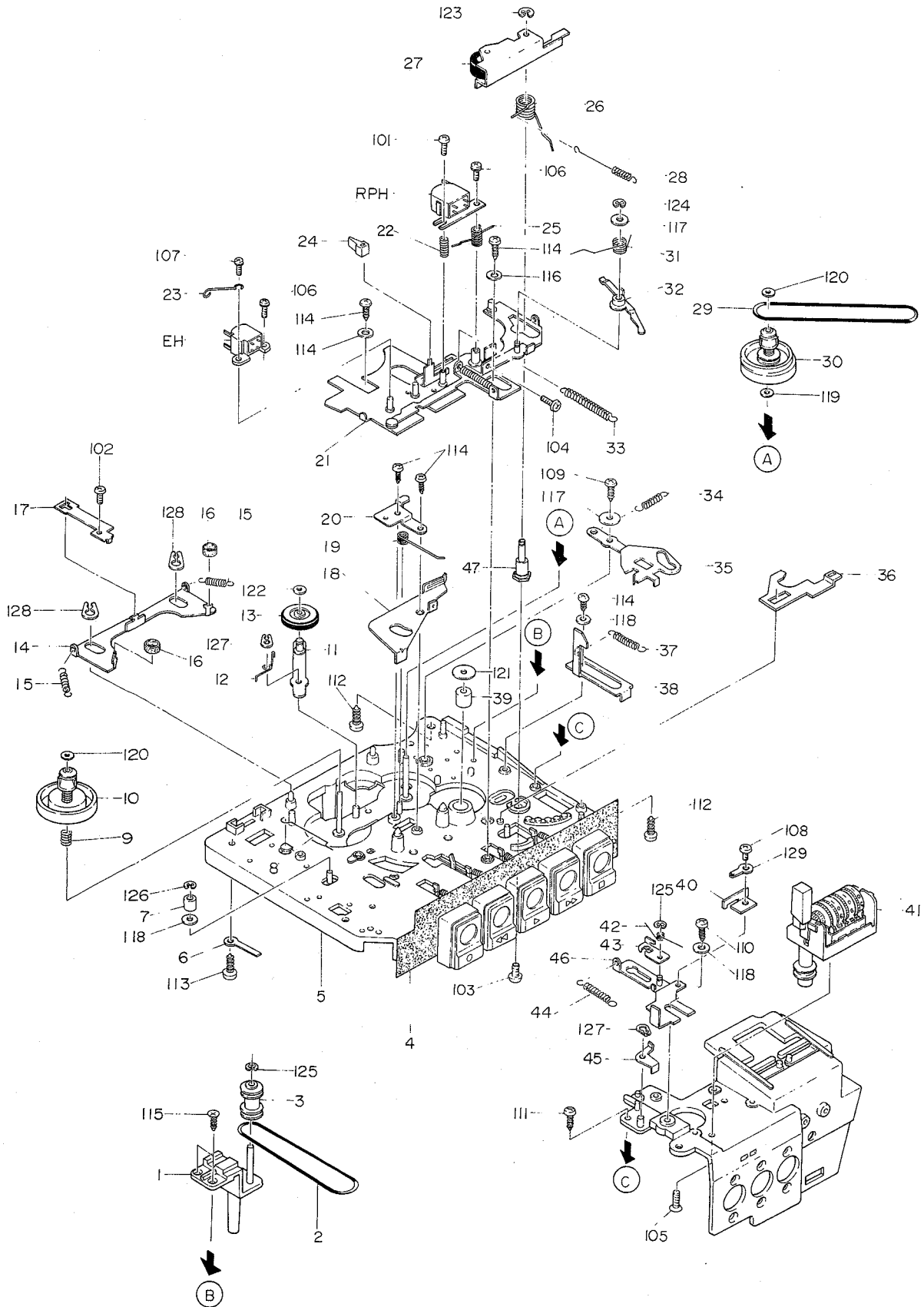

Ref. No.	Part No.	Part No. Changed to	Description	Common Model	Q'ty
3-1	82-463-221-01		Relay pulley bracket ass'y	*	1
3-2	82-463-211-01		Belt, Relay	*	1
3-3	82-422-230-01		Pulley, Relay	TPR-203	1
3-4	82-429-045-01		Brind himeron		1
3-5	82-463-264-01		Chassis ass'y	*	1
3-6	87-038-039-01		Wire binder		1
3-7	82-416-306-01		Collar, Guide shaft	TPR-601	1
3-8	82-432-232-01		Spring, Record lock	TPR-212	1
3-9	82-450-405-01		Spring, Back tension		1
3-10	82-432-243-01		Supply reel platform ass'y	TPR-212	1
3-11	82-278-236-01		FF lever ass'y	TP-752	1
3-12	82-278-319-01		Spring, FF idler	TP-752	1
3-13	82-278-260-01		FF idler ass'y	TP-752	1
3-14	82-278-343-01		Plate, Brake	TP-752	1
3-15	82-412-331-01		Spring, Brake	TPR-401	2
3-16	82-278-345-01		Brake shoe	TP-752	2
3-17	82-278-342-01		Brake lever B	TP-752	1
3-18	82-416-313-01		REV. lever B	TPR-601	1
3-19	82-422-296-01		Spring, Release	TPR-203	1
3-20	82-423-291-01		Plate spring, Moving chassis		1
3-21	82-463-263-01		Moving chassis ass'y	*	1
3-22	82-422-293-01		Spring, Head adjuster	TPR-203	1
3-23	82-958-298-01		Spring, Wire holder	TM-405	1
3-24	82-416-252-01		Stopper nozzle	TPR-601	1
3-25	82-416-256-01		Spring, Stopper	TPR-601	1
3-26	82-432-231-01		Spring, Pinch lever	TPR-212	1
3-27	82-423-307-01		Pinch lever ass'y		1
3-28	82-285-254-01		Spring, Play idler		2
3-29	82-463-219-01		Belt, Tape counter	*	1
3-30	82-422-249-01		Take-up reel platform ass'y	TPR-203	1
3-31	82-416-318-01		Spring A, Stopper lever	TPR-601	1
3-32	82-416-314-01		Stopper lever B ass'y	TPR-601	1
3-33	82-423-300-01		Spring, Moving chassis		1
3-34	82-278-330-01		Spring, Release lever	TP-752	1
3-35	82-432-242-01		Stopper lever C		1
3-36	82-432-227-01		Kick lever		1
3-37	82-412-319-01		Spring, Lock lever	TPR-401A	1
3-38	82-422-259-01		Cassette lock lever	TPR-203	1
3-39	82-416-365-01		Shaft bearing, Flywheel	TPR-601	1
3-40	82-463-238-01		Metal fitting, Adjuster	*	1
3-41	87-040-072-01		Tape counter		1
3-42	82-463-241-01		Spring, Lock plate	*	1
3-43	82-422-225-01		Lock plate	TPR-203	1
3-44	82-463-243-01		Spring, Pause lever	*	1
3-45	82-463-239-01		Changeable arm	*	1
3-46	82-463-234-01		Pause lever ass'y	*	1
3-47	82-432-228-01		Shaft, Pinch lever	TPR-212	1

EXPLODED VIEW-4

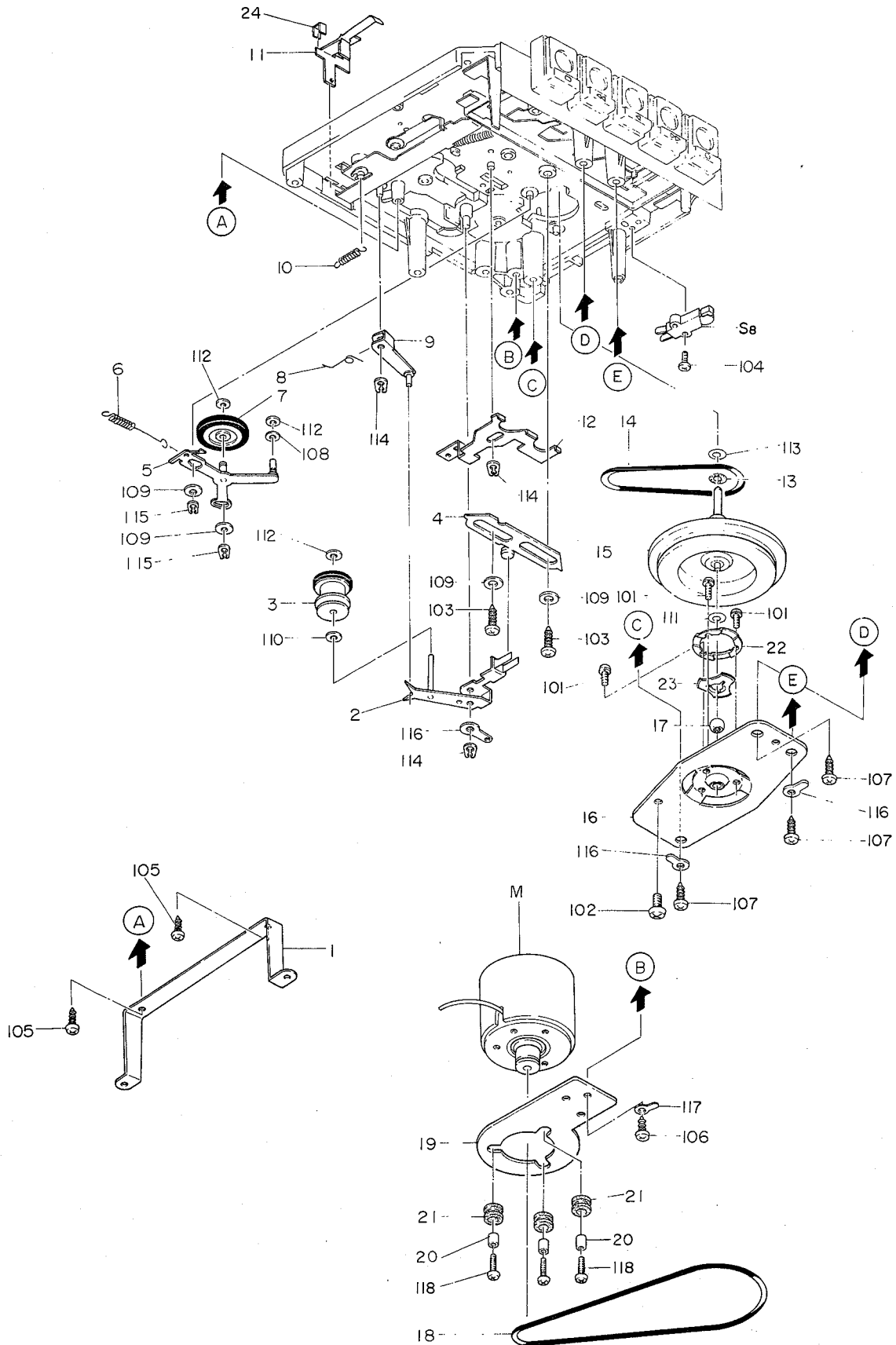

Ref. No.	Part No.	Part No. Changed to	Description	Common Model	Q'ty
4-1	82-463-218-01		Metal fitting, Circuit board	*	1
4-2	82-278-385-01		FR lever ass'y	TP-752	1
4-3	82-432-240-01		FR pulley ass'y	TPR-203	1
4-4	82-431-211-01		RF slide lever	*	1
4-5	82-416-348-01		Play idler lever ass'y	TPR-601	1
4-6	82-285-254-01		Spring, Play idler		2
4-7	82-416-387-01		Play idler ass'y	TPR-601	1
4-8	82-278-297-01		Spring, Center shifter	TP-752	1
4-9	82-416-322-01		Center shifter plate ass'y	TPR-601	1
4-10	82-416-281-01		Spring, Record blocking lever	TPR-601	1
4-11	82-440-237-01		Record blocking lever ass'y		1
4-12	82-278-341-01		Brake lever A	TP-752	1
4-13	87-081-229-01		H washer A		1
4-14	82-276-258-01		Belt, FR		1
4-15	82-412-203-01		Flywheel ass'y	TPR-401	1
4-16	82-432-226-01		Lower shaft bearing plate	TPR-212	1
4-17	82-432-229-01		Shaft bearing A	TPR-212	1
4-18	82-416-220-01		Belt, Main	TPR-601	1
4-19	82-423-301-01		Holder, Motor		1
4-20	82-461-361-01		Collar, Motor	TPR-930	3
4-21	82-416-299-01		Rubber cushion	TPR-212	3
4-22	82-432-233-01		Holder, A, Plate spring A	TPR-212	1
4-23	82-432-230-01		Plate spring, Shaft bearing	TPR-212	1
4-24	82-432-245-01		Pressure, Record blocking lever	TPR-212	1

Ref. No.	Part No.	Description	Q'ty
1-101	87-341-073-01	UT ₁ ⌀ 2.6-6	2
1-102	87-351-097-01	VT ₁ ⌀ 3-12	5

Ref. No.	Part No.	Description	Q'ty
1-103	87-081-276-01	VT ₂ ⌀ 3-38	1
1-104	87-081-242-01	W 2.6mmϕ diam.	1

Ref. No.	Part No.	Description	Q'ty
2-101	87-253-092-11	U ⌀ 3-4	2
2-102	87-253-071-01	U ⌀ 2.6-4	2
2-103	87-253-075-01	U ⌀ 2.6-10	2
2-104	87-263-071-01	V ⌀ 2.6-4	2
2-105	87-081-215-01	P ⌀ 2-4	2
2-106	87-233-072-01	Q ⌀ 2.6-5	8
2-107	87-253-032-01	U ⌀ 2-3	1
2-108	87-341-096-01	UT ₁ ⌀ 3-10	15
2-109	87-341-095-01	UT ₁ ⌀ 3-8	4
2-110	87-341-036-01	UT ₁ ⌀ 2-8	2
2-111	87-351-103-01	VT ₁ ⌀ 3-25	1
2-112	87-351-097-01	VT ₁ ⌀ 3-12	1
2-113	87-321-097-01	QT ₁ ⌀ 3-10	2

Ref. No.	Part No.	Description	Q'ty
2-114	87-351-073-01	VT ₁ ⌀ 2.6-6	2
2-115	87-351-096-01	VT ₁ ⌀ 3-10	2
2-116	87-321-074-01	QT ₁ ⌀ 2.6-8	2
2-117	87-410-317-01	W 3.8-0.5	1
2-118	87-422-309-01	SW-5	1
2-119	87-441-009-01	STE-3	1
2-120	87-422-003-01	STP-3	2
2-121	87-391-036-11	N 5mmϕ diam.	1
2-122	87-391-017-11	N 3mmϕ diam.	1
2-123	87-450-417-01	LB 7mmϕ diam.	1
2-124	87-351-093-01	VT ₁ ⌀ 3-5	2
2-125	87-081-487-01	FW 4mmϕ diam.	1
2-126	87-392-003-01	NSP-3	2

Ref. No.	Part No.	Description	Q'ty
3-101	82-253-033-01	U ⌀ 2-4	1
3-102	87-253-032-01	U ⌀ 2-3	1
3-103	87-253-095-11	U ⌀ 3-8	1
3-104	87-263-034-01	V ⌀ 2-5	1
3-105	87-233-095-11	Q ⌀ 3-8	2
3-106	87-480-033-01	VS ⌀ 2-4	1
3-107	87-480-035-01	VS ⌀ 2-6	2
3-108	87-480-071-01	VS ⌀ 2.6-4	1
3-109	87-341-073-01	UT ₁ ⌀ 2.6-6	1
3-110	87-341-075-01	UT ₁ ⌀ 2.6-10	1
3-111	87-341-074-01	UT ₁ ⌀ 2.6-8	1
3-112	87-351-097-01	VT ₁ ⌀ 3-12	2
3-113	87-351-103-01	VT ₁ ⌀ 3-25	1
3-114	87-341-072-01	UT ₁ ⌀ 2.6-5	5
3-115	87-322-074-01	QT ₂ ⌀ 2.6-8	2

Ref. No.	Part No.	Description	Q'ty
3-116	87-081-242-01	W 2.6mmϕ diam.	2
3-117	87-081-242-01	W 2.6mmϕ diam.	1
3-118	87-410-314-01	W 3mmϕ diam.	2
3-119	82-215-207-01	TW 1.6mmϕ diam.	1
3-120	87-081-473-01	PW 1.3mmϕ diam.	2
3-121	82-416-358-01	PW 1.6mmϕ diam.	1
3-122	87-081-464-01	PW 1.8mmϕ diam.	1
3-123	87-441-005-01	STE-2	1
3-124	87-441-006-01	STE-2.3	1
3-125	87-441-003-01	STE-1.5	2
3-126	87-441-008-01	STE-2.5	1
3-127	87-442-003-01	STP-3	2
3-128	87-442-005-01	STP-5	2
3-129	87-450-412-01	LB-2mmϕ diam.	1

Ref. No.	Part No.	Description	Q'ty
4-101	87-263-070-01	V ⌀ 2.6-3	3
4-102	87-480-093-11	VS ⌀ 3-5	1
4-103	87-341-072-01	UT ₁ ⌀ 2.6-5	2
4-104	87-341-037-01	UT ₁ ⌀ 2-10	1
4-105	87-341-073-01	UT ₁ ⌀ 2.6-6	2
4-106	87-351-095-01	VT ₁ ⌀ 3-8	3
4-107	87-242-095-01	UT ₂ ⌀ 3-8	3
4-108	87-410-305-01	W 2.6mmϕ diam.	1
4-109	87-410-311-01	W 2.6mmϕ diam.	4

Ref. No.	Part No.	Description	Q'ty
4-110	87-081-036-01	TW 2mmϕ diam.	1
4-111	87-082-005-01	NW 2.5mmϕ diam.	1
4-112	87-081-464-01	PW 1.8mmϕ diam.	3
4-113	82-416-358-01	PW 1.6mmϕ diam.	1
4-114	87-442-003-01	STP-3	3
4-115	87-081-190-01	STP-2.5	2
4-116	87-450-414-01	LB 4mmϕ diam.	1
4-117	87-450-413-01	LB-3mmϕ diam.	1
4-118	87-480-074-01	VS + 2.6-8	3

HARDWARE NOMENCLATURE

V:	Pan head screw	
U:	Binding head screw	
Q:	Flat countersunk head screw	
P:	Oval countersunk head screw	
VT₁:	Pan head tapping screw	
VT₂:	Pan head tapping screw	
UT₁:	Binding head tapping screw	
UT₂:	Binding head tapping screw	
QT₁:	Flat countersunk head tapping screw	
QT₂:	Flat countersunk head tapping screw	
VS:	Pan head screw with spring washer	
VWS:	Pan head screw with spring washer and washer	

NSP:	Speed nut	
STE:	E ring (washer)	
STP:	Powerful stop ring	
W:	Washer	
FW:	Fibre washer	
TW:	Tefron washer	
NW:	Nylon washer	
PW:	Poly-slider washer	
SW:	Spring washer	
LB:	Lug terminal plate	
N:	Nut	

Example:

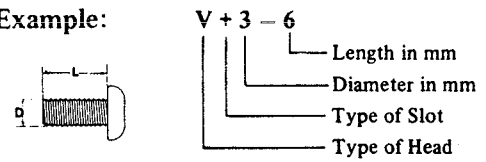

ELECTRICAL PARTS

Symbol No.	Part No.	Part No. Changed to	Description	Common Model	Q'ty
« TUNER CIRCUIT BOARD SECTION » = "LEE", "UK" Model only					
PCB-A	82-463-646-01		Tuner circuit board	*	1
TR101,102	89-307-842-01		Transistor, 2SC-784(R)		2
TR103,106	89-303-803-01		Transistor, 2SC-380(O)		2
TR104,105	89-303-804-01		Transistor, 2SC-380(Y)		2
TR107	87-026-046-01		Transistor, 2SC-380A (Y)		1
IC101	87-027-126-01		IC LA-3301		1
D101,102,106, 107	88-052-188-01		Diode, IS-188		4
D103	88-052-553-01		Diode IS-553		1
D104,105	88-051-060-91		Diode 1N-60(AM)		2
L101	87-006-017-01		FM coil (2- $\frac{1}{2}$ t)		1
L102	81-245-319-01		FM choke coil (0.47 μ H)		1
L103	87-006-016-01		FM coil (1- $\frac{3}{4}$ t)		1
L104,105	82-463-637-01		MW LW bar antenna coil	*	1
L106	82-425-603-01		MW OSC coil		1
L107	87-007-050-11		LW OSC coil		1
L108	87-008-139-01		Coil (67kHz)		1
IFT101	81-436-305-01		FM IFT		1
IFT102	87-008-110-01		FM IFT		1
IFT103	87-008-135-01		FM IFT (ratio S)		1
IFT104	87-008-078-01		FM IFT (ratio P)		1
IFT105	87-008-117-01		AM IFT		1
CF101	87-008-158-11		Ceramic filter (10.7MHz)		1
CFT101	87-008-118-01		Ceramic filter trans (455kHz) – LEE Model only		1
CFT101	87-008-152-01		Ceramic filter trans (468kHz) – UK Model only		1
VC1 ~ 4	87-011-081-01		PVC		1
TC1 ~ 4					
TC5,6	87-011-021-01		Trimmer AT ₁ -54		2
CR101	87-028-019-01		CR block		1
BPF101	87-030-032-01		FM band pass filter		1
MPX UNIT	87-030-025-01		MPX UNIT		1
VR201,301	87-021-430-01		Volume 30k Ω -Ax2 (VOLUME)		1
VR202,302	82-461-612-01		Volume 20k Ω -Dx2 (TONE)		1
S1	82-463-601-01		Rotary slide switch (Band selector)	*	1
SFR1	87-021-237-01		Semi-fixed resistor 1k Ω -B		1
	87-038-031-01		IFT shield case		2
	82-463-603-11		Shield plate (A)	*	1
	82-463-604-01		Shield plate (B)	*	1
	82-461-693-01		Shield case(L108)		1
	87-033-092-01		PCB tab (A)		1
			<Resistors>		
R106	88-182-220-01		22 Ω 1/4W \pm 10% ELR		1
R115	88-182-390-01		39 Ω 1/4W \pm 10% ELR		1
R120	88-182-470-01		47 Ω 1/4W \pm 10% ELR		1
R168	88-182-560-01		56 Ω 1/4W \pm 10% ELR		1
R124	88-182-680-01		68 Ω 1/4W \pm 10% ELR		1
R126,154	88-182-101-01		100 Ω 1/4W \pm 10% ELR		2
R103,123	88-182-221-01		220 Ω 1/4W \pm 10% ELR		2
R101,133,158	88-182-471-01		470 Ω 1/4W \pm 10% ELR		3
R143	88-182-681-01		680 Ω 1/4W \pm 10% ELR		1
R119,134,152, 153,155	88-182-831-01		820 Ω 1/4W \pm 10% ELR		5
R148,150,162, 163,164,165, 166,247,347	88-182-102-01		1k Ω 1/4W \pm 10% ELR		9
R149	88-182-152-01		1.5k Ω 1/4W \pm 10% ELR		1
R104,111,132	88-182-182-01		1.8k Ω 1/4W \pm 10% ELR		3
R121,160,161 248,348	88-182-332-01		3.3k Ω 1/4W \pm 10% ELR		5
R157	88-182-472-01		4.7k Ω 1/4W \pm 10% ELR		1
R110,142	88-182-123-01		12k Ω 1/4W \pm 10% ELR		2
R135	88-182-183-01		18k Ω 1/4W \pm 10% ELR		1
R139	88-182-223-01		22k Ω 1/4W \pm 10% ELR		1
R112,113	88-182-333-01		33k Ω 1/4W \pm 10% ELR		2

Symbol No.	Part No.	Part No. Changed to	Description	Common Model	Q'ty
R108,130,131, 114	88-182-563-01		56kΩ 1/4W ±10% ELR		4
R105,107,125	88-182-683-01		68kΩ 1/4W ±10% ELR		3
R151	88-182-154-01		150kΩ 1/4W ±10% ELR		1
R102,141	88-182-184-01		180kΩ 1/4W ±10% ELR		2
R117	88-182-274-01		270kΩ 1/4W ±10% ELR		1
R137	88-182-474-01		470kΩ 1/4W ±10% ELR		1
R145	88-188-820-01		82Ω 1/4W ±5% ELR		1
R128	88-188-331-11		330Ω 1/4W ±5% ELR		1
R140	88-188-391-11		390Ω 1/4W ±5% ELR		1
R127	88-188-152-11		1.5kΩ 1/4W ±5% ELR		1
R167,156	88-188-332-11		3.3kΩ 1/4W ±5% ELR		2
R129	88-188-223-11		22kΩ 1/4W ±5% ELR		1
R138	88-188-823-11		82kΩ 1/4W ±5% ELR		1
R136,122	88-188-274-11		270kΩ 1/4W ±5% ELR		2
R144	88-132-101-01		100Ω 1/4W ±10%		1
R159	88-132-681-01		680Ω 1/4W ±10%		1
R146	88-132-102-01		1kΩ 1/4W ±10%		1
R147	88-134-103-01		10kΩ 1/4W ±10%		1
			<Capacitors>		
C116,164	88-337-100-01		1μF 50V Electrolytic		2
C161,165,167, 173,174	88-336-500-01		4.7μF 25V Electrolytic		5
C140,142,153, 159	88-335-110-01		10μF 16V Electrolytic		4
C177	88-333-220-01		220μF 10V Electrolytic		1
C114,130,134	88-332-120-01		100μF 6.3V Electrolytic		3
C160	88-332-220-01		220μF 6.3V Electrolytic		1
C218,318	87-015-092-01		0.1μF 6.3V Alox		2
C157	87-015-093-01		0.22μF 6.3V Alox		1
C126	88-617-500-01		270μF Styrol		1
C125	88-617-460-01		180pF Styrol		1
C113	88-617-660-01		2200pF Styrol		1
C150,168	88-727-630-01		0.0015μF Mylar		2
C169,171	88-727-700-01		0.003μF Mylar		2
C166,170,172, 175	88-727-820-01		0.015μF Mylar		4
C152,176	88-727-860-01		0.068μF Mylar		2
C155,106,112	88-213-030-01		3pF Ceramic		3
C111	88-213-050-01		5pF Ceramic		1
C110,127	88-212-060-01		6pF Ceramic		2
C102	88-212-100-01		10pF Ceramic		1
C180	88-212-230-01		27pF Ceramic		1
C107	88-212-240-01		30pF Ceramic		1
C121	88-212-260-01		36pF Ceramic		1
C162,163,178	88-212-410-01		100pF Ceramic		3
C120	88-212-420-01		120pF Ceramic		1
C108,104	88-212-480-01		220pF Ceramic		2
C158	88-212-510-01		300pF Ceramic		1
C105,149	88-214-650-01		0.002μF Ceramic		2
C103,109,118, 124,133,136, 145	88-214-720-01		0.0047μF Ceramic		7
C101,115,117, 119,122,128, 129,137,138, 139,141,143, 144,146,156	88-214-810-01		0.01μF Ceramic		15
C148,147	88-214-830-01		0.022μF Ceramic		2
C131,135,151, 154	88-205-810-01		0.01μF Ceramic		4
C132	88-205-830-01		0.022μF Ceramic		1

Symbol No.	Part No.	Part No. Changed to	Description	Common Model	Q'ty
◀ TUNER CIRCUIT BOARD SECTION ▶ = "SEE" Model only					
PCB-A	82-463-602-31		Tuner circuit board	*	1
TR101,102	89-307-842-01		Transistor, 2SC-784(R)		2
TR103,106	89-303-803-01		Transistor, 2SC-380(O)		2
TR104,105	89-303-804-01		Transistor, 2SC-380(Y)		2
TR107	87-026-046-01		Transistor, 2SC-380(AY)		1
IC101	87-027-126-01		IC LA-3301		1
D101,102,106 107	88-052-188-01		Diode, IS-188		4
D103	88-052-553-01		Diode IS-553		1
D104,105	88-051-060-91		Diode IN-60(AM)		2
L101	87-006-017-01		FM coil (2-½t)		1
L102	81-245-319-01		FM choke coil (0.47μH)		1
L103	87-006-016-01		FM coil (1-¾t)		1
L104	82-463-609-01		MW bar antenna coil	*	1
L105	87-006-044-01		SW antenna coil		1
L106	87-007-070-01		MW OSC coil		1
L107	82-425-603-01		SW OSC coil		1
L108	87-008-139-01		Coil (67kHz)		1
IFT101	81-436-305-01		FM IFT		1
IFT102	87-008-110-01		FM IFT		1
IFT103	87-008-135-01		FM IFT (ratio S)		1
IFT104	87-008-078-01		FM IFT (ratio P)		1
IFT105	87-008-117-01		AM IFT		1
CF101	87-008-158-01		Ceramic filter (10.7MHz)		1
CFT101	87-008-118-01		Ceramic filter trans (455kHz)		1
VC1 ~ 4					
TC1 ~ 4	87-011-081-01		PVC		1
TC5	87-011-024-01		Trimmer AT ₁ -53		1
TC6	87-011-021-01		Trimmer AT ₁ -54		1
CR101	87-028-019-01		CR block		1
BPF101	87-030-032-01		FM band pass filter		1
MPX UNIT	87-030-025-01		MPX UNIT		1
VR201,301	87-021-430-01		Volume 30kΩ-Ax2 (VOLUME)		1
VR202,302	82-461-612-01		Volume 20kΩ-Dx2 (TONE)		1
S1	82-463-601-01		Rotary slide switch (Band selector)	*	1
SFR1	87-021-237-01		Semi-fixed resistor 1kΩ-B		1
	87-038-031-01		IFT shield case		1
	82-463-603-01		Shield plate (A)	*	1
	82-463-604-01		Shield plate (B)	*	1
	82-461-693-01		Shield case (L108)		1
	87-033-092-01		PCB tab (A)		1
			<Resistors>		
R106	88-182-220-01		22Ω 1/4W ±10% ELR		1
R115	88-182-390-01		39Ω 1/4W ±10% ELR		1
R120	88-182-470-01		47Ω 1/4W ±10% ELR		1
R168	88-182-560-01		56Ω 1/4W ±10% ELR		1
R124	88-182-680-01		68Ω 1/4W ±10% ELR		1
R119,134,152, 153,155	88-182-820-01		82Ω 1/4W ±10% ELR		2
R126,154	88-182-101-01		100Ω 1/4W ±10% ELR		3
R136	88-182-151-01		150Ω 1/4W ±10% ELR		1
R103,123	88-182-221-01		220Ω 1/4W ±10% ELR		1
R101,133,158	88-182-471-01		470Ω 1/4W ±10% ELR		1
R156	88-182-561-01		560Ω 1/4W ±10% ELR		5
R143	88-182-681-01		680Ω 1/4W ±10% ELR		
R148,150,162, 163,164,165, 166,234,334	88-182-102-01		1kΩ 1/4W ±10% ELR		9
R149	88-182-152-01		1.5kΩ 1/4W ±10% ELR		1
R104,111,132	88-182-182-01		1.8kΩ 1/4W ±10% ELR		3
R121,160,161 236,336	88-182-332-01		3.3kΩ 1/4W ±10% ELR		5
R157	88-182-472-01		4.7kΩ 1/4W ±10% ELR		1
R110,142	88-182-123-01		12kΩ 1/4W ±10% ELR		2
R135	88-182-183-01		18kΩ 1/4W ±10% ELR		1

Sumbol No.	Part No.	Part No. Changed to	Description	Common Model	Q'ty
R139	88-182-223-01		22kΩ 1/4W ±10% ELR		1
R130	88-182-273-01		27kΩ 1/4W ±10% ELR		1
R112,113,131	88-182-333-01		33kΩ 1/4W ±10% ELR		3
R108	88-182-563-01		56kΩ 1/4W ±10% ELR		1
R105,107,114, 125	88-182-683-01		68kΩ 1/4W ±10% ELR		4
R151	88-182-154-01		150kΩ 1/4W ±10% ELR		1
R102,141	88-182-184-01		180kΩ 1/4W ±10% ELR		2
R117	88-182-274-01		270kΩ 1/4W ±10% ELR		1
R137	88-182-474-01		470kΩ 1/4W ±10% ELR		1
R145	88-188-820-01		82Ω 1/4W ±5% ELR		1
R128	88-188-331-11		330Ω 1/4W ±5% ELR		1
R140	88-188-391-11		390Ω 1/4W ±5% ELR		1
R127	88-188-152-11		1.5kΩ 1/4W ±5% ELR		1
R167,137	88-188-332-11		3.3kΩ 1/4W ±5% ELR		2
R129	88-188-223-11		22kΩ 1/4W ±5% ELR		1
R138	88-188-823-11		82kΩ 1/4W ±5% ELR		1
R136	88-188-274-11		270kΩ 1/4W ±5% ELR		1
R144	88-132-101-01		100Ω 1/4W ±10%		1
R159	88-132-681-01		680Ω 1/4W ±10%		1
R146	88-132-102-01		1kΩ 1/4W ±10%		1
R147	88-134-103-01		10kΩ 1/4W ±10%		1
			<Capacitors>		
C116	88-337-100-01		1μF 50V Electrolytic		1
C161,165,167, 173,174	88-336-500-01		4.7μF 25V Electrolytic		5
C140,142,153, 159,164	88-335-110-01		10μF 16V Electrolytic		5
C177	88-333-220-01		220μF 10V Electrolytic		1
C114,130,134	88-332-120-01		100μF 6.3V Electrolytic		3
C160	88-332-220-01		220μF 6.3V Electrolytic		1
C225,325	87-015-092-01		0.1μF 6.3V Alox		2
C157	87-015-093-01		0.22μF 6.3V Alox		1
C126	88-617-500-01		270μF Styrol		1
C125	88-617-710-01		3900pF Styrol		1
C166,168,175	88-727-630-01		0.0015μF Mylar		3
C169,171	88-727-700-01		0.003μF Mylar		2
C170,172	88-727-810-01		0.01μF Mylar		2
C155,106	88-213-030-01		3pF Ceramic		2
C121	88-213-020-01		2pF Ceramic		1
C111	88-213-050-01		5pF Ceramic		1
C110,127	88-212-060-01		6pF Ceramic		2
C112	88-212-080-01		8pF Ceramic		1
C120	88-212-200-01		20pF Ceramic		1
C102	88-212-100-01		10pF Ceramic		1
C180	88-212-230-01		27PF Ceramic		1
C147	88-232-290-01		47pF Ceramic		1
C107	88-212-240-01		30pF Ceramic		1
C162,163	88-212-410-01		100pF Ceramic		2
C108	88-212-480-01		220pF Ceramic		1
C158	88-212-510-01		300pF Ceramic		1
C105,123,138, 149	88-214-650-01		0.002μF Ceramic		4
C103,109,118, 124,133,136, 145	88-214-720-01		0.0047μF Ceramic		7
C101,115,117, 119,122,128, 129,132,137, 139,141,143, 144,146,156	88-214-810-01		0.01μF Ceramic		15
C148,147	88-214-830-01		0.022μF Ceramic		2
C131,135,151, 152,154	88-205-810-01		0.01μF Ceramic		5
C150	88-205-830-01		0.022μF Ceramic		1

Symbol No.	Part No.	Part No. Changed to	Description	Common Model	Q'ty
◀ REC/PB CIRCUIT BOARD SECTION ▶					
PCB-B	82-463-643-01		REC/PB circuit board	*	1
TR201,301	89-307-326-01		Transistor, 2SC-732 (BL)		2
TR202,302	89-307-325-01		Transistor, 2SC-732 (G)		2
TR203,204	89-200-562-01		Transistor, 2SB-56 (B)		2
TR205,206	89-303-724-01		Transistor, 2SC-372 (Y)		2
IC201,301	87-027-141-01		IC TA-7137P		2
IC202,302	87-027-136-01		IC HA-1329		2
D201,301,202	88-051-060-91		Diode, 1N-60 (AM)		3
D203	82-415-637-01		Zener diode, WZ-061		1
L201,301	87-003-034-01		Trape coil		2
L202,302	87-005-072-01		Micro inductor (1.2mH)		2
L203	82-418-612-01		Bias OSC coil		1
L204	82-401-661-01		Choke coil (600 μ H)		1
L205,206	82-401-624-01		Choke coil (35 μ H)		2
T201,301	87-002-099-01		Output transformer		2
J1	87-032-679-01		5p DIN jack (MIC, REC/PB)		1
J2,3	87-032-681-01		2p DIN jack (EXT-SP R,L)		2
S2	87-031-335-01		Slide switch (FUNCTION)		1
S6	87-031-322-01		Slide switch (REC/PB)		1
S10	87-032-680-01		DIN jack switch (ECM)		1
SFR201,301, 202	87-021-358-01		Semi-fixed resistor 20k Ω -B		3
	87-038-020-01		Radiation plate (TR203,204)		1
	82-431-618-01		Radiation plate (IC201,301)		2
			<Resistors>		
R250,350,251, 351	88-182-109-01		1 Ω 1/4W \pm 10% ELR		4
R249,349,256	88-182-100-01		10 Ω 1/4W \pm 10% ELR		3
R254	88-182-150-01		15 Ω 1/4W \pm 10% ELR		1
R259,359	88-182-680-01		68 Ω 1/4W \pm 10% ELR		2
R261,361	88-182-272-01		2.7k Ω 1/4W \pm 10% ELR		2
R239,339,240, 340,262,362	88-182-332-01		3.3k Ω 1/4W \pm 10% ELR		6
R226,227	88-182-123-01		12k Ω 1/4W \pm 10% ELR		2
R246	88-182-393-01		39k Ω 1/4W \pm 10% ELR		1
R244	88-182-473-01		47k Ω 1/4W \pm 10% ELR		1
R243,343	88-182-563-01		56k Ω 1/4W \pm 10% ELR		2
R245	88-182-154-01		150k Ω 1/4W \pm 10% ELR		1
R260,360	88-182-274-01		270k Ω 1/4W \pm 10% ELR		2
R258,358	88-182-105-01		1M Ω 1/4W \pm 10% ELR		2
R252,352	88-154-220-01		22 Ω 1W \pm 10%		1
			<Capacitors>		
C219,319	88-337-100-01		1 μ F 50V Electrolytic		2
C206,306,210, 310,212,312, 226,326,251, 351,252,352	88-336-500-01		4.7 μ F 25V Electrolytic		12
C207,307,215, 315,227,327, 228,328,241, 341	88-335-110-01		10 μ F 16V Electrolytic		10
C253	88-333-220-01		220 μ F 10V Electrolytic		1
C233,234,235	88-333-520-01		470 μ F 10V Electrolytic		3
C232,244,247, 249	88-333-130-01		1000 μ F 10V Electrolytic		4
C225,325	88-332-510-01		47 μ F 6.3V Electrolytic		2
C216,316,217, 317	88-332-120-01		100 μ F 6.3V Electrolytic		4
C242,220,320	88-332-229-01		220 μ F 6.3V Electrolytic		3
C243	88-332-520-01		470 μ F 6.3V Electrolytic		1
C202,302	87-015-106-01		0.47 μ F 6.3V Alox		2
C205,305	88-727-630-01		0.0015 μ F Mylar		2
C229,329,230, 330,231,331	88-727-660-01		0.0022 μ F Mylar		6

Symbol No.	Part No.	Part No. Changed to	Description	Common Model	Q'ty
C221,321	88-727-720-01		0.0047 μ F Mylar		2
C214,314	88-727-740-01		0.0068 μ F Mylar		2
C204,304,223, 323,239,240	88-727-810-01		0.01 μ F Mylar		6
C224,324,213, 313	88-727-830-01		0.02 μ F Mylar		4
C203,303	88-727-840-01		0.033 μ F Mylar		2
C245	88-728-640-01		0.0018 μ F 100V Mylar		1
C246	88-728-750-01		0.0082 μ F 100V Mylar		1
C238	88-728-830-01		0.022 μ F 100V Mylar		1
C237	88-728-850-01		0.047 μ F 100V Mylar		1
C236,336	88-218-610-01		0.001pF Ceramic		2
C209,309	88-218-660-01		0.0022pF Ceramic		2
C211,311	88-212-410-01		100pF Ceramic		2
C208,308	88-212-510-01		300pF Ceramic		2
C222,322	88-212-560-01		560pF Ceramic		2
C248	88-205-910-01		0.1 μ F Ceramic		1
◀ REC BLOCK CIRCUIT BOARD SECTION ▶					
<L-ch only>					
PCB-C	87-033-133-11		REC block circuit board		1
TR601,602, 603	89-307-325-01		Transistor, 2SC-732 (G)		3
TR604	89-106-285-01		Transistor, 2SA-628 (F)		1
D602	87-026-066-01		Diode, M8513A-0		1
D601	88-051-060-91		Diode, 1N-60 (AM)		1
	87-032-558-01		Pin		1
<Resistors>					
R609	88-182-569-01		5.6 Ω 1/4W \pm 10% ELR		1
R610	88-182-100-01		10 Ω 1/4W \pm 10% ELR		1
R616	88-182-332-01		3.3k Ω 1/4W \pm 10% ELR		1
<Capacitors>					
C601,610,612, 615	88-336-500-01		4.7 μ F 25V Electrolytic		4
C603,604,607	88-335-110-01		10 μ F 16V Electrolytic		3
C613	88-332-120-01		100 μ F 6.3V Electrolytic		1
C611	87-015-092-01		0.1 μ F 6.3V Alox		1
C609	88-717-7-0-01		0.0068 μ F Mylar		1
C605	88-717-830-01		0.022 μ F Mylar		1
C606	88-717-910-01		0.1 μ F Mylar		1
C608	88-212-480-01		220pF Ceramic		1
C614,602	88-212-510-01		300pF Ceramic		2
◀ SWITCH CIRCUIT BOARD SECTION ▶					
PCB-E	82-463-647-01		Switch circuit board	*	1
S3,4,5	82-374-613-01		Lever switch (MODE, TAPE, METER)		3
◀ POWER CIRCUIT BOARD SECTION ▶					
PCB-G	82-463-608-01		Power circuit board	*	1
D401	87-027-121-01		Bridge diode 1S-2371		1
F1	87-035-080-01		Fuse 160 mA "T"		1
	87-057-800-01		Fuse label 160 mA "T"		1
F2	87-035-064-01		Fuse 1A "T"		1
	87-057-770-01		Fuse label 1A "T"		1
	87-032-323-01		Fuse clamp		4
	87-033-126-01		PCB tab (D)		2
<Capacitors>					
C402	88-333-130-01		1000 μ F 10V Electrolytic		1
C401	87-012-095-01		Compound capacitor		1
◀ MISCELLANEOUS ▶					
PCB-H	82-463-644-01		Jack circuit board	*	1
T401	82-463-638-01		Power transformer	*	1
D108	87-026-082-01		Light emitting diode S8169 (FM STEREO)		1
SP1,2	82-431-627-01		Speaker		2

Symbol No.	Part No.	Part No. Changed to	Description	Common Model	Q'ty
LM	82-463-613-01		Level meter	*	1
RPH	82-463-623-01		Rec/Pb head	*	1
EH	82-938-639-21		Erase head		1
ECM1,2	80-562-083-21		ECM (CMU-8C (Y))	*	2
M	80-661-880-01		Motor ass'y (AM-130)	*	1
S7	87-031-287-01		Slide switch (OSC)		1
S8	87-031-261-01		Micro switch (MAIN)		1
S9	87-031-280-01		Slide switch (VOLTAGE SELECTOR)		1
J6	87-032-514-01		Headphone jack		1
J4	82-416-647-01		DC jack		1
J5	87-032-434-01		AC jack		1
L109,110	82-401-635-01		FM coil 10t		2
	87-005-080-01		RH core		2
	82-457-697-01		Antenna socket (DIN FM)		1
	82-461-625-01		Fasten ass'y		1
	82-432-664-01		Fasten ass'y		1
	82-463-615-01		Fasten ass'y 1	*	1
	82-463-616-01		Fasten ass'y 2	*	1
			<Resistor>		
R253,353	88-182-271-01		270Ω 1/4W ±10% ELR		2
			<Capacitor>		
C248	88-205-910-01		0.1μF Ceramic		1

ACCESSORIES/PACKAGE

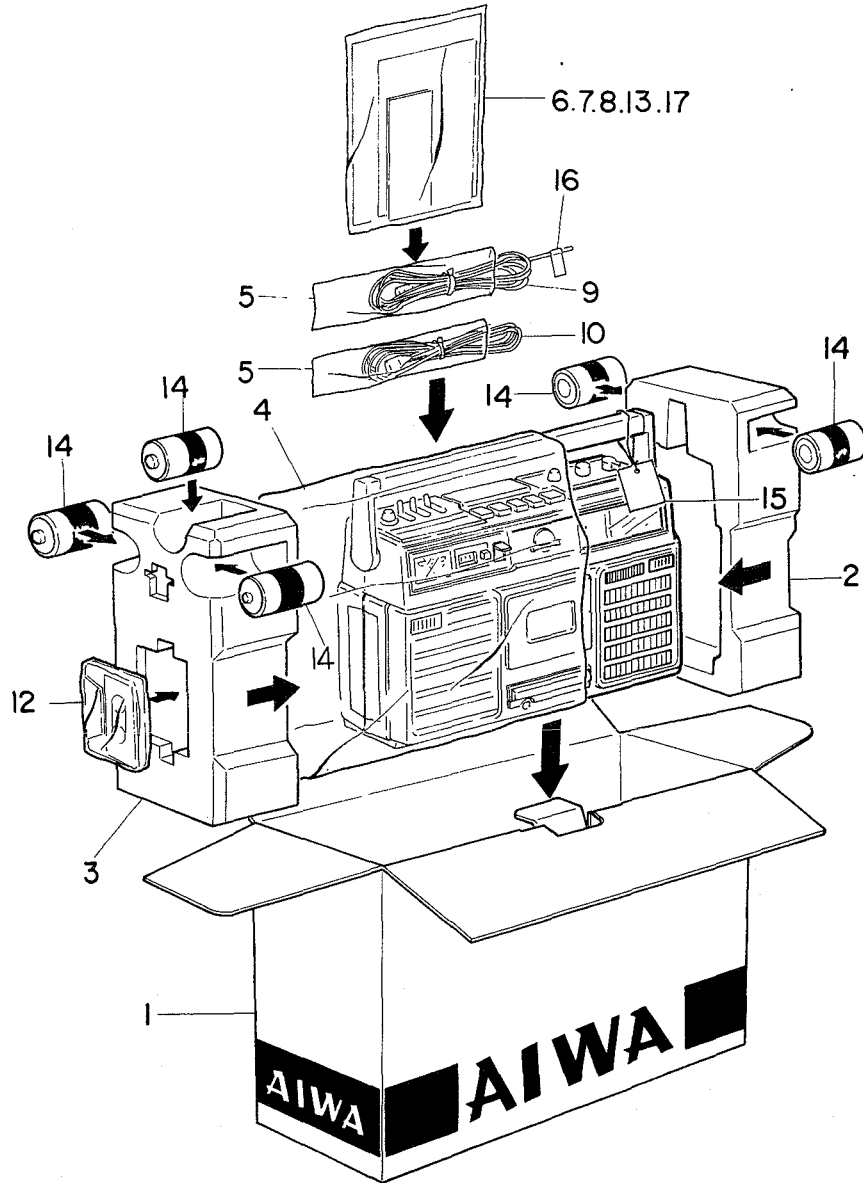

Ref. No.	Part No.	Part No. Changed to	Description	Common Model	Q'ty
1	82-463-855-01		Printed indiv, Packing	*	1
2	82-463-853-01		Cushion R, Printed indiv.	*	1
3	82-463-852-01		Cushion L, Printed indiv.	*	1
4	87-051-143-01		Poly-vinyl sack		1
5	87-051-137-01		Poly-vinyl sack (for AC cord)		1
6	87-051-171-01		Poly-vinyl sack		1
7	82-463-909-01		Instructions booklet - UK model only	*	1
8	82-463-903-01		Instructions booklet - LEE, SEE model only	*	1
9	87-034-845-01		AC cord - UK model only		1
10	87-034-070-01		AC cord - LEE, SEE model only		1
11	87-032-478-01		DIN shorting plug		1
12	80-291-655-01		Tape cassette, DMC-144		1
13	87-058-012-01		Head cleaning pole ass'y		1
14	87-047-039-01		Battery, SUM-1 (AG)		5
15	87-056-007-01		Tag, Power supply - UK model only		1
16	87-056-008-01		Label, AC cord - UK model only		1
17	87-056-009-01		Distributors list		1

