

	TR1	C4	C5	C6
<input type="checkbox"/>	25K41H1	33P	33P	5P
EXCEPT <input type="checkbox"/>	25K4H1	27P	18P	15P

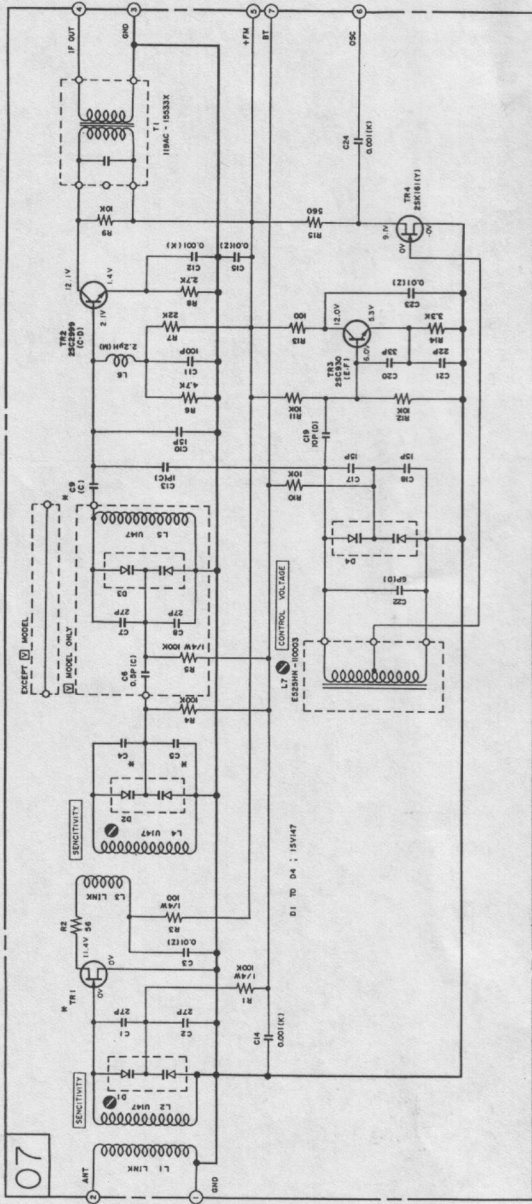

FRONT END PCB C1005B5040

FRONT END
SCHEMATIC DIAGRAM
NO. 7-6 870428A

EXCEPT MODEL ... FE1
 MODEL FE1

NOTE
UNLESS OTHERWISE SPECIFIED:
ALL RESISTORS IN OHMS 1/6W(J)
ALL CAPACITORS IN μ F 50WV(J)

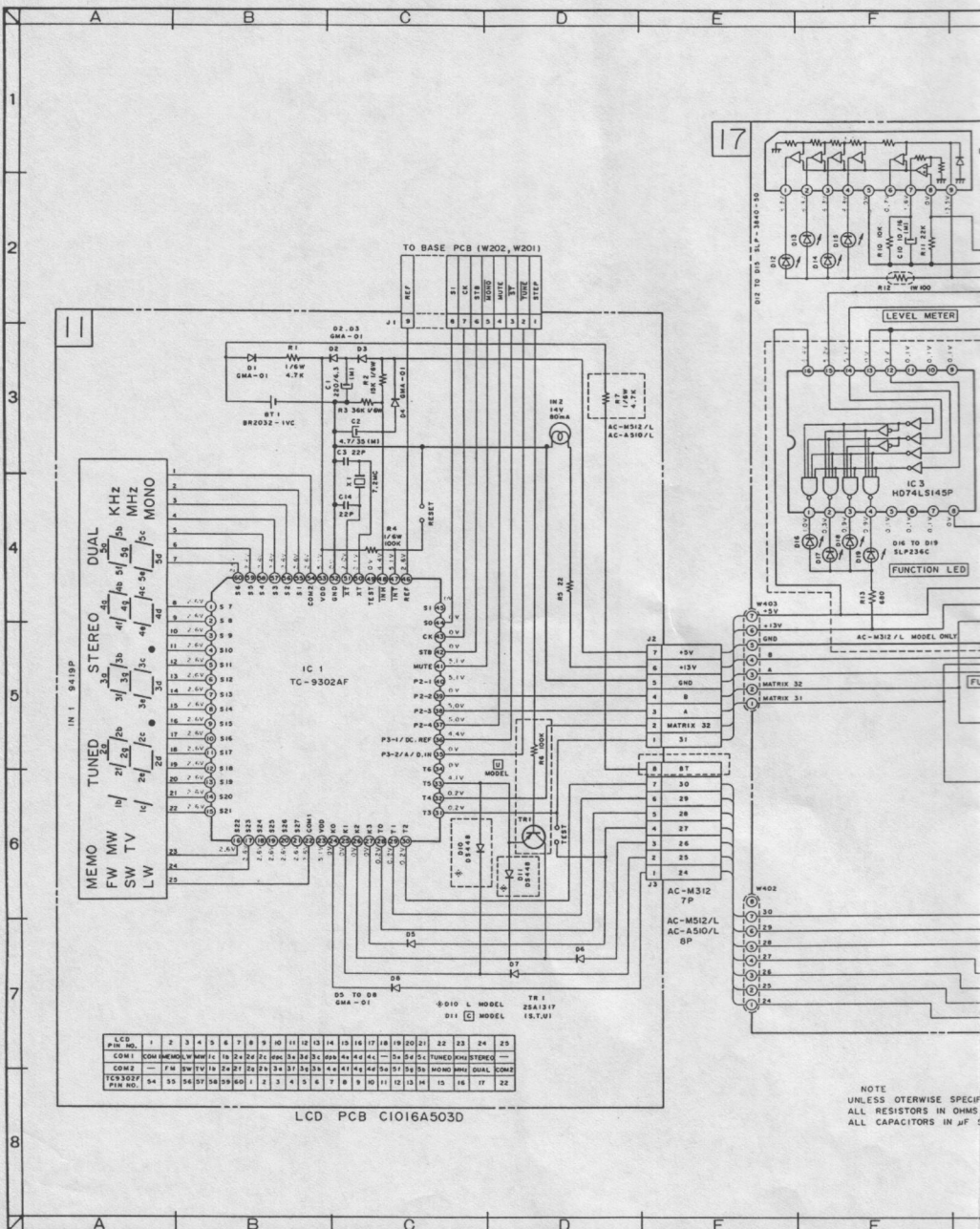

LCD PIN NO.	1	2	3	4	5	6	7	8	9	10	11	12	13	14	15	16	17	18	19	20	21	22	23	24	25
COM1	MONO	MEMO	FM	TV	SW	MW	LW	16	15	14	13	12	11	10	9	8	7	6	5	4	3	2	1	0	9
COM2	FM	TV	SW	MW	LW	16	15	14	13	12	11	10	9	8	7	6	5	4	3	2	1	0	9	8	7
TC9302AF	54	55	56	57	58	59	60	1	2	3	4	5	6	7	8	9	10	11	12	13	14	15	16	17	22

LCD PCB C1016A503D

NOTE
UNLESS OTHERWISE SPECIFIED
ALL RESISTORS IN OHMS
ALL CAPACITORS IN μ F

17

AC-M312/L, 512/L
AC-A510/L
CONTROL & LCD
SCHEMATIC DIAGRAM
NO. 7-5 870427A

NOTE
UNLESS OTHERWISE SPECIFIED
ALL RESISTORS IN OHMS (R) / W (W) / M (M) / K (K)
ALL CAPACITORS IN P.F. (P) / 50WV (V)

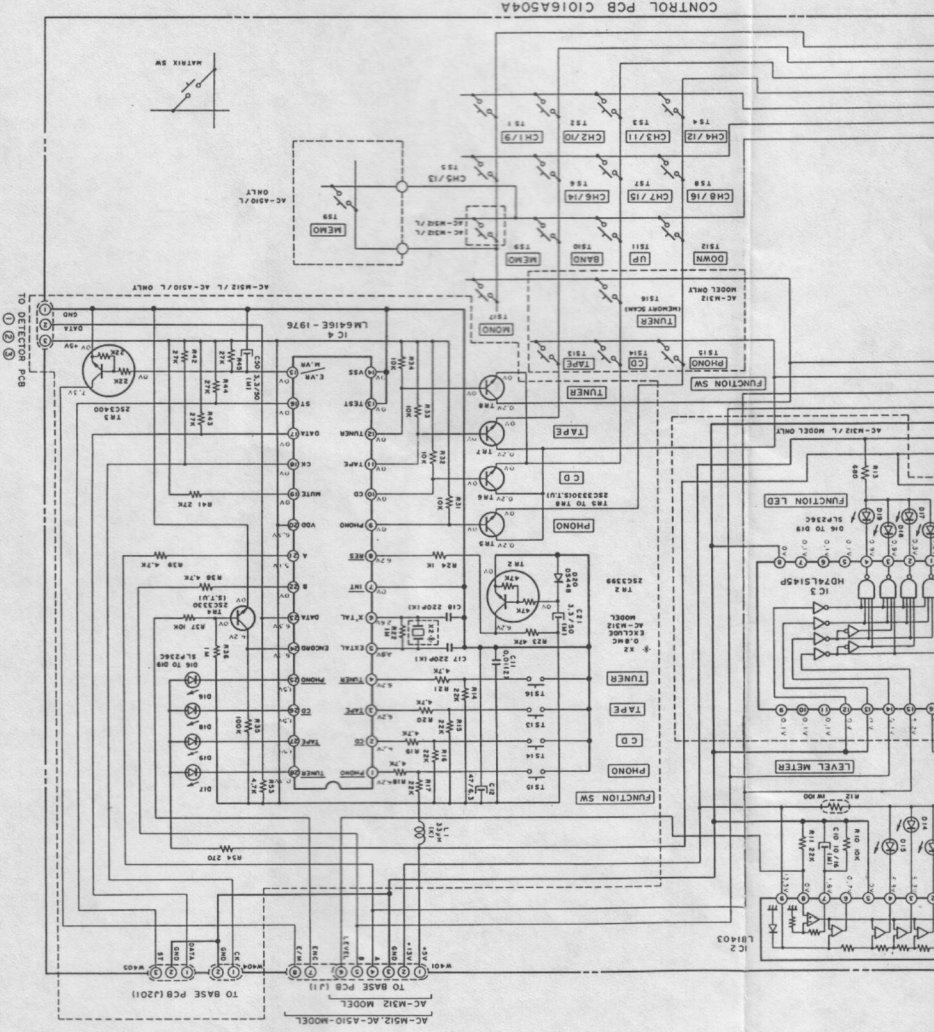

CONTROL PCB C1016A504A

TO DETECTOR PCB
①
②
③

AC-M312, AC-A510-MODEL
TO BASE PCB (J201)
AC-M312/L, AC-A510/L-MODEL
TO BASE PCB (J201)
AC-M312/L, AC-A510/L-MODEL
TO DETECTOR PCB (J202, J203, J204)

K H G F
8
7
6
5
4
3
2
1
K H G F

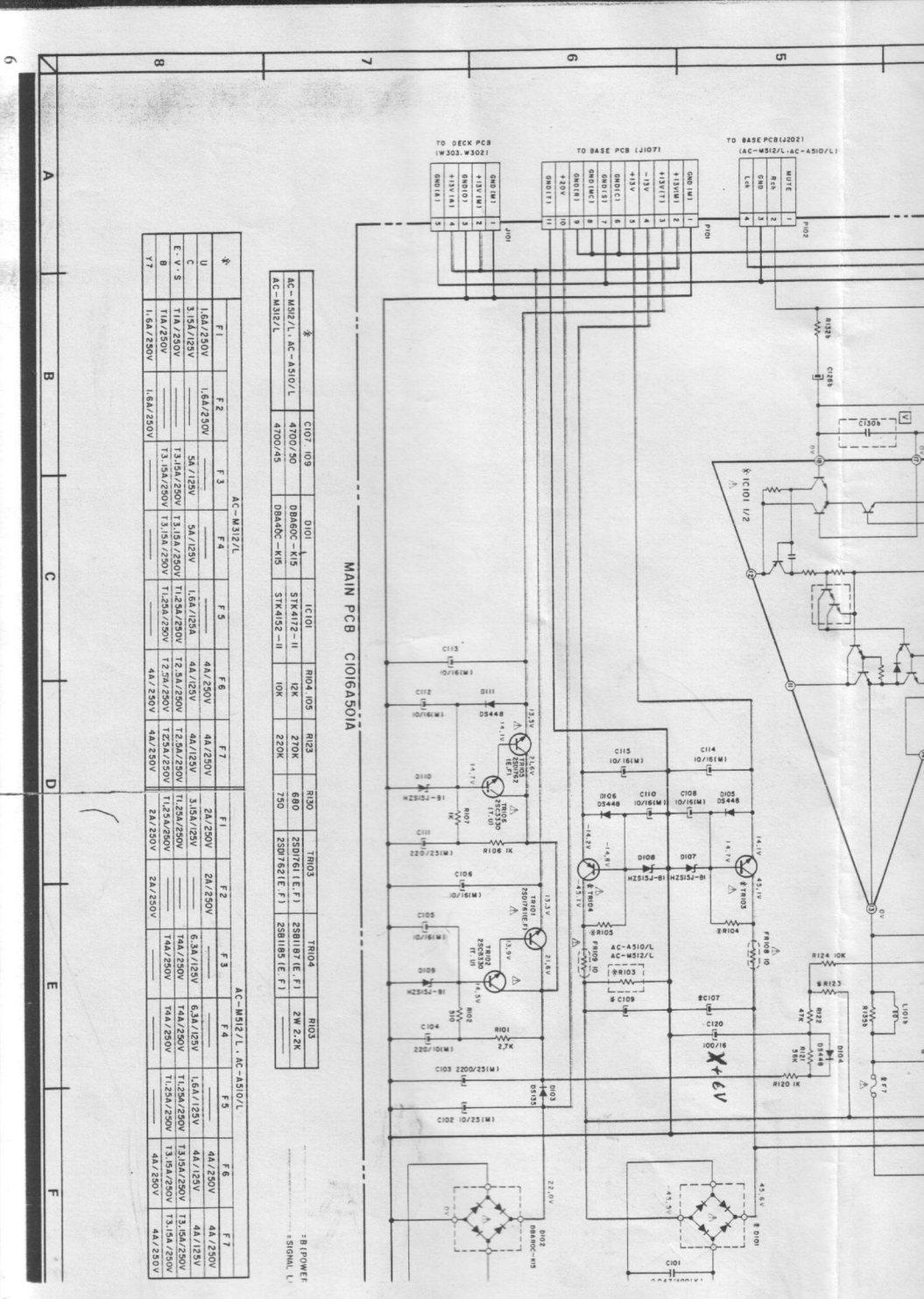

MAIN PCB C1016A501A

AC-M12/L, AC-AS10/L	C107, 40S	D101	IC101	R04, 10S	R23	R30	TN03	R103
AC-M12/L	4T00/50	D0A0C-K1S	3T141Z2-II	1ZK	270K	600	2S0T61E, F1	2W 2.2K
	4T00/45	D0A0C-K1S	3T141S2-II	10K	250K	750	2S0T62E, F1	2S0T19S, E, F1

Φ	AC-M12/L							AC-M12/L, AC-AS10/L							
	F1	F2	F3	F4	F5	F6	F7	F1	F2	F3	F4	F5	F6	F7	
U	1.6A/250V	1.6A/250V				4A/250V	4A/250V	2A/250V	2A/250V						
C	3.15A/125V		5A/125V	5A/125V	1.6A/125A	4A/125V	4A/125V	3.15A/125V		6.3A/125V	6.3A/125V	1.6A/125V	4A/125V	4A/125V	
E.V.S	T1A/250V		T3.15A/250V	T1.15A/250V	T1.25A/250V	T2.5A/250V	T2.5A/250V	T1.25A/250V		T4A/250V	T4A/250V	T1.5A/250V	T3.15A/250V	T3.15A/250V	
B	T1A/250V		T3.15A/250V	T1.15A/250V	T1.25A/250V	T2.5A/250V	T2.5A/250V	T1.25A/250V		T4A/250V	T4A/250V	T1.5A/250V	T3.15A/250V	T3.15A/250V	
Y7	1.6A/250V	1.6A/250V				4A/250V	4A/250V	2A/250V	2A/250V						

POWER SIGNAL L

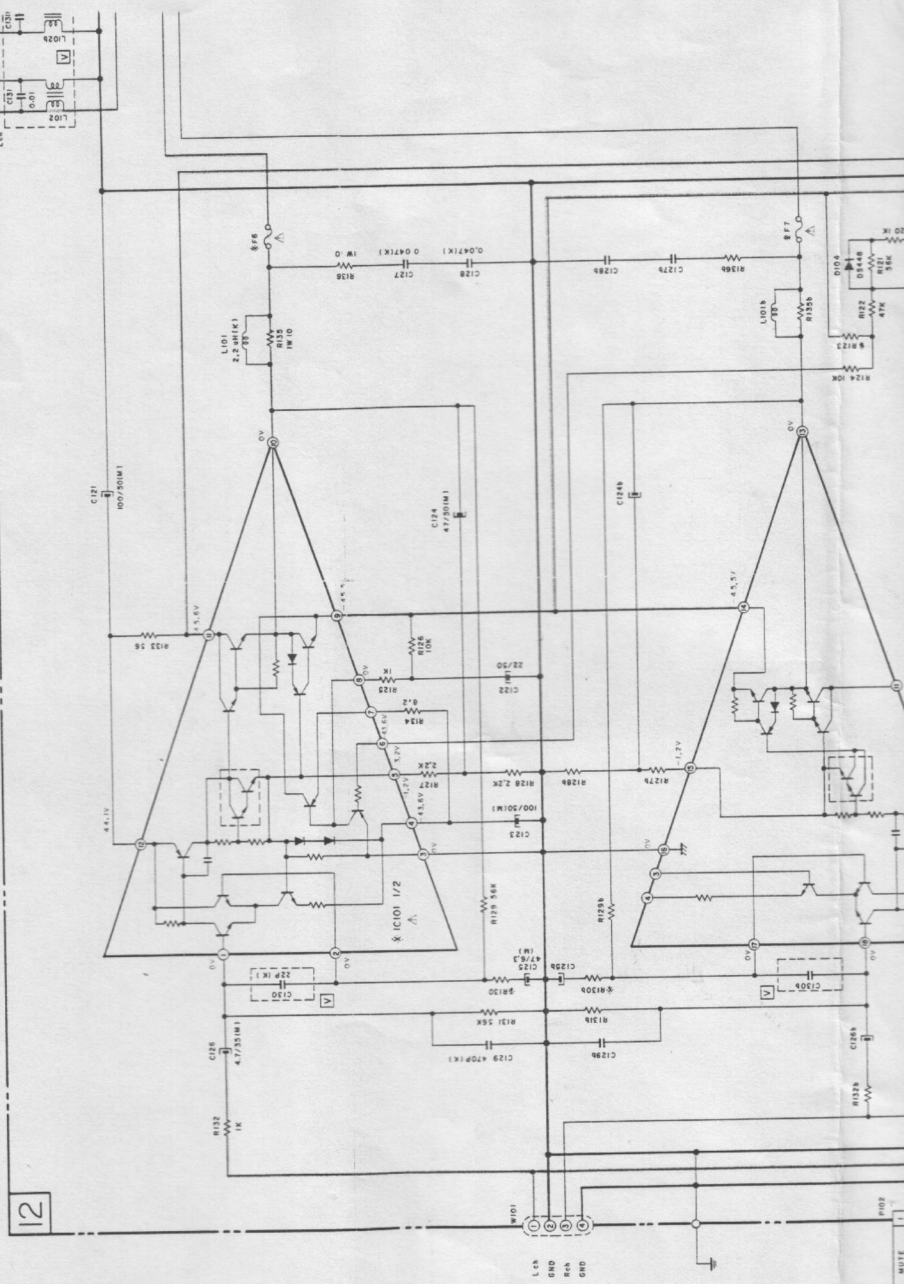

12

1

2

3

4

SPEAKERS (8 Ω to 16 Ω)

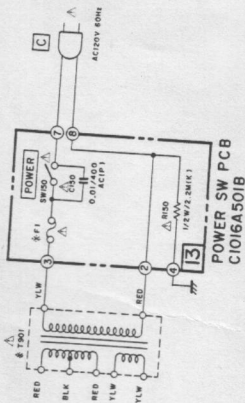
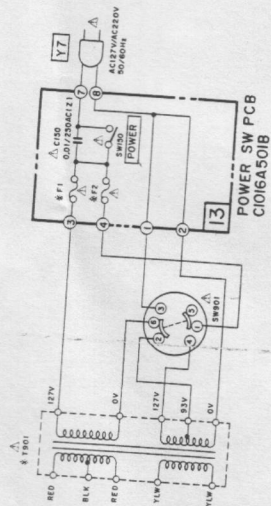
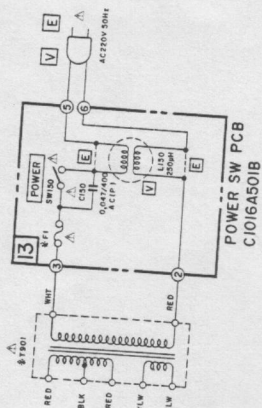
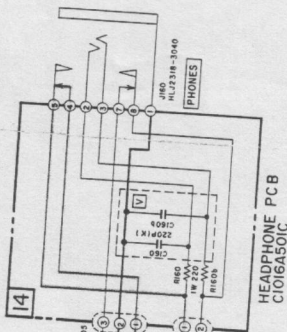

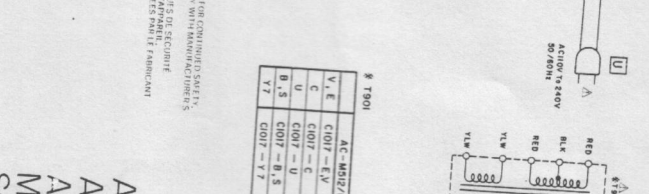
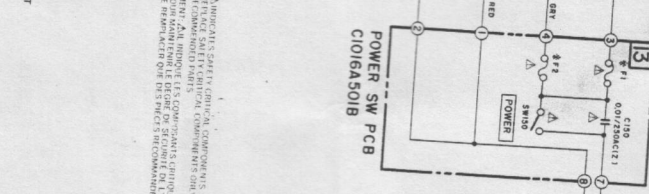
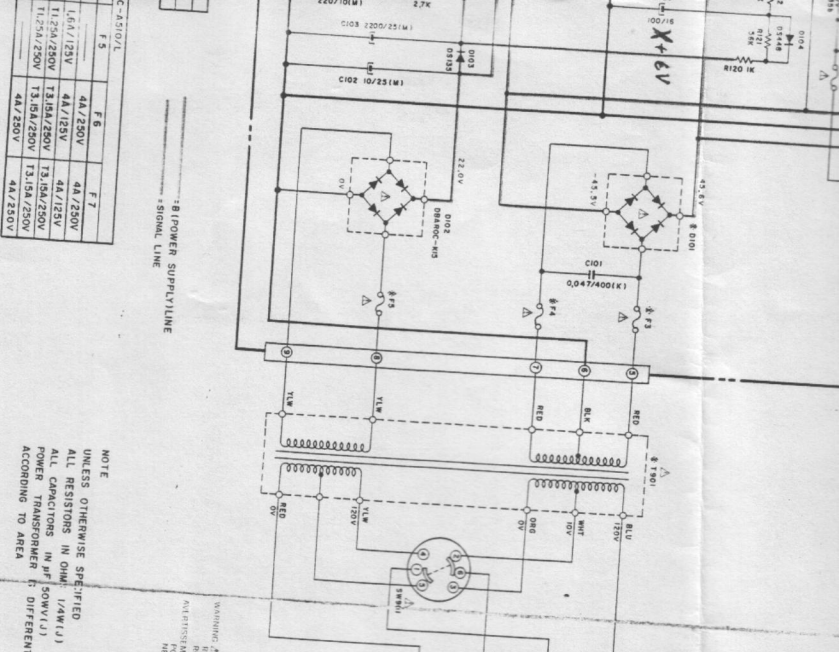

8 T901		8 T902	
V, E	C1017 - E, V	AC-M312/L	AC-M312/L
C	C1017 - C	C1018 - E, V	C1018 - E, V
U	C1017 - U	C1018 - C	C1018 - C
B, S	C1017 - B, S	C1018 - U	C1018 - U
Y, Z	C1017 - Y, Z	C1018 - B, S	C1018 - B, S
		C1018 - Y, Z	C1018 - Y, Z

POWER SUPPLY LINE
SIGNAL LINE

NOTE
UNLESS OTHERWISE SPECIFIED
ALL RESISTORS IN OHM (1/4W, 1/2W)
ALL CAPACITORS IN PF (50V, 100V)
POWER TRANSFORMER IS DIFFERENT
ACCORDING TO AREA

WARNING: A WARNING IS GIVEN TO THE OPERATOR FOR THE
DANGER OF ELECTRIC SHOCK. THE OPERATOR SHOULD
BE ADVISED THAT THE POWER SUPPLY LINE IS
CONNECTED TO THE MAIN POWER SUPPLY LINE.
BEFORE WORKING ON THE CIRCUITRY, THE OPERATOR
SHOULD DISCONNECT THE POWER SUPPLY LINE
FROM THE CIRCUITRY.

AC-M312/L
AC-M512/L
AC-A510/L
MAIN
SCHEMATIC DIAGRAM
NO. 7-2 870424A

POWER SW PCB
C1016A501B

E G H J K

10
A B C D E

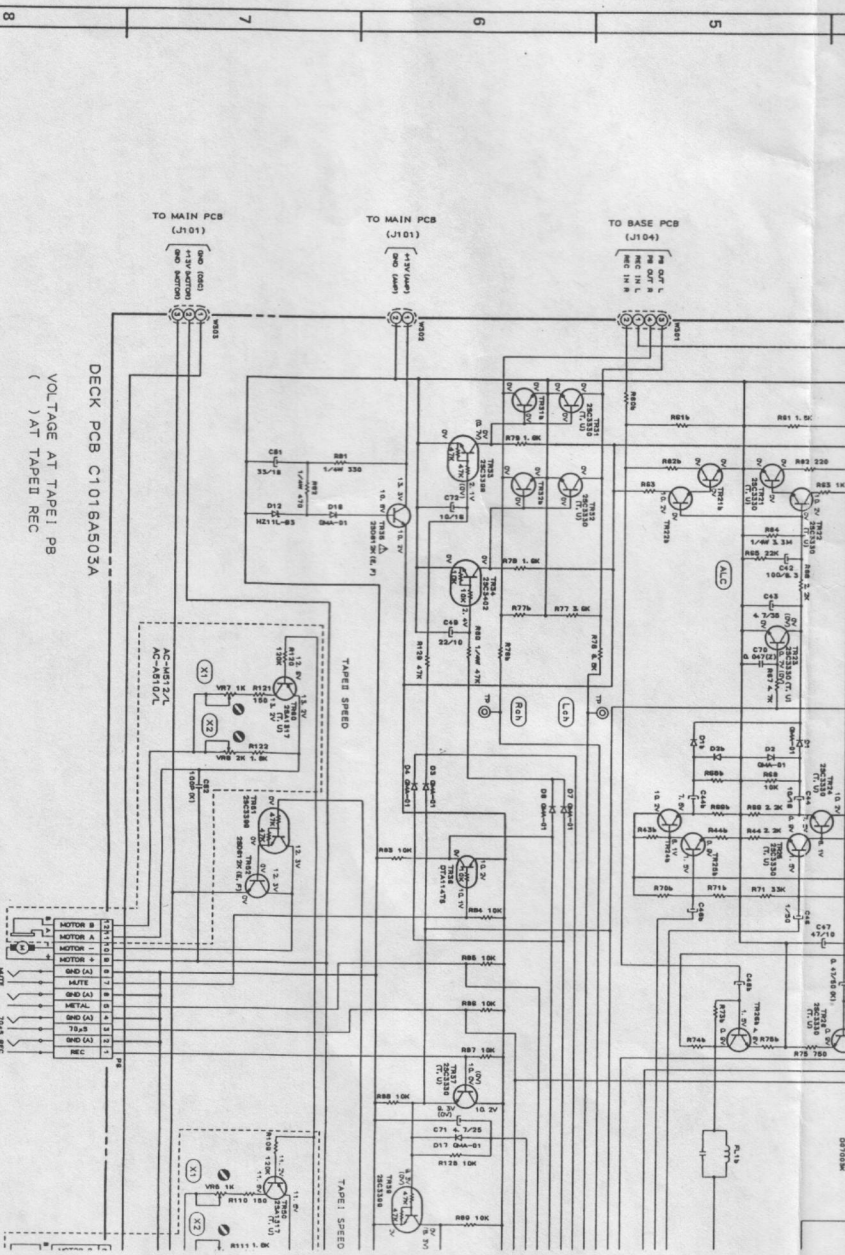

DECK PCB C1016A503A

VOLTAGE AT TAPES REC
() AT TAPES REC

TAPES REC

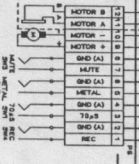

TAPES REC

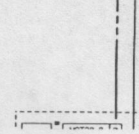

TAPES REC

097008K

A B C D E

1

2

3

4

08

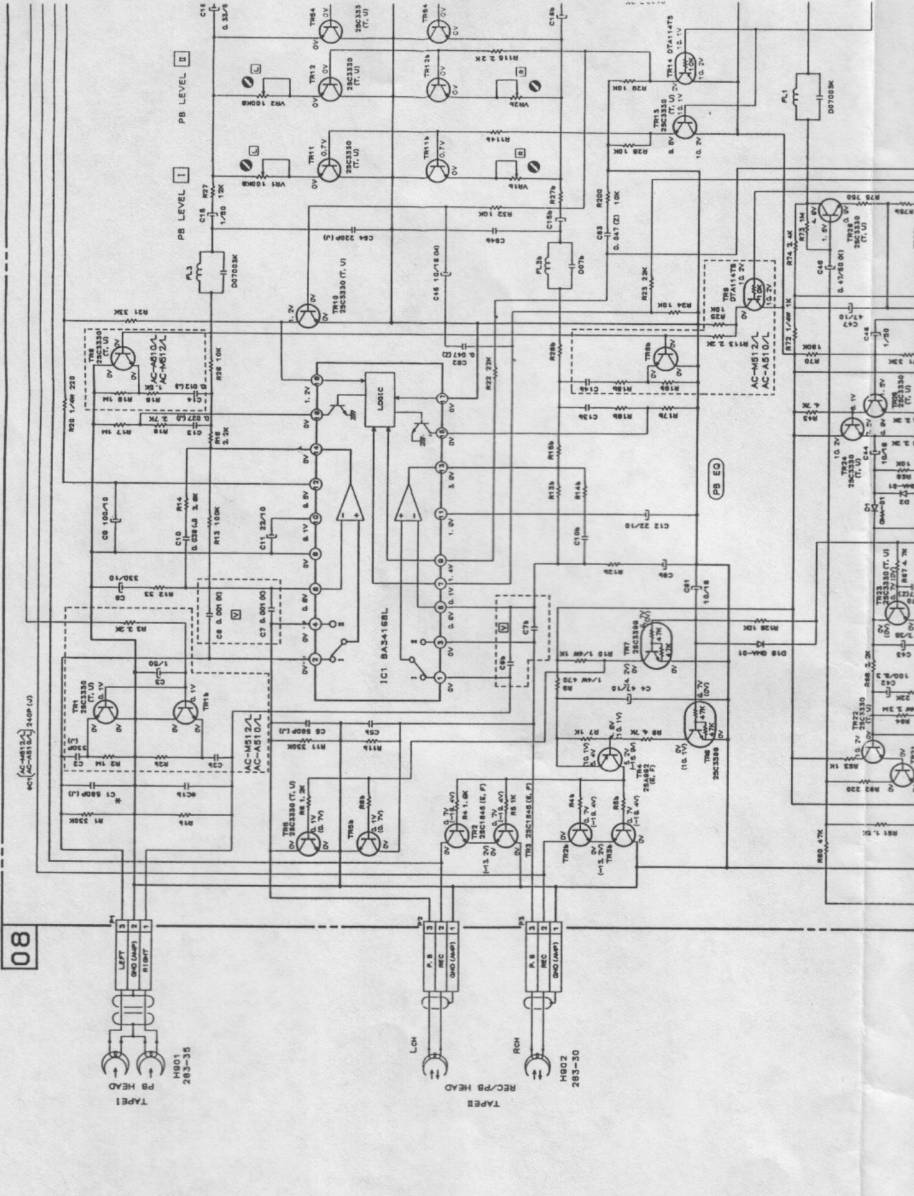

REC/PB HEAD

HH02

283-30

HH01-288-283-35

PB ED

LCH

A.B

REC

HH01-288-283-30

A.B

REC

HH02

283-30

AC-AS101A

AC-AS101A

IC1 BA3-158L

LOGIC

AC-AS101B

AC-AS101B

AC-AS101B

PB LEVEL 1

PB LEVEL 2

PB LEVEL 3

PB LEVEL 4

PB LEVEL 5

PB LEVEL 6

PB LEVEL 7

PB LEVEL 8

PB LEVEL 9

PB LEVEL 10

PB LEVEL 11

PB LEVEL 12

PB LEVEL 13

PB LEVEL 14

PB LEVEL 15

PB LEVEL 16

PB LEVEL 17

PB LEVEL 18

PB LEVEL 19

PB LEVEL 20

PB LEVEL 21

PB LEVEL 22

PB LEVEL 23

PB LEVEL 24

PB LEVEL 25

PB LEVEL 26

PB LEVEL 27

PB LEVEL 28

PB LEVEL 29

PB LEVEL 30

PB LEVEL 31

PB LEVEL 32

PB LEVEL 33

PB LEVEL 34

PB LEVEL 35

PB LEVEL 36

PB LEVEL 37

PB LEVEL 38

PB LEVEL 39

PB LEVEL 40

PB LEVEL 41

PB LEVEL 42

PB LEVEL 43

PB LEVEL 44

PB LEVEL 45

PB LEVEL 46

PB LEVEL 47

PB LEVEL 48

PB LEVEL 49

PB LEVEL 50

PB LEVEL 51

PB LEVEL 52

PB LEVEL 53

PB LEVEL 54

PB LEVEL 55

PB LEVEL 56

PB LEVEL 57

PB LEVEL 58

PB LEVEL 59

PB LEVEL 60

PB LEVEL 61

PB LEVEL 62

PB LEVEL 63

PB LEVEL 64

PB LEVEL 65

PB LEVEL 66

PB LEVEL 67

PB LEVEL 68

PB LEVEL 69

PB LEVEL 70

PB LEVEL 71

PB LEVEL 72

PB LEVEL 73

PB LEVEL 74

PB LEVEL 75

PB LEVEL 76

PB LEVEL 77

PB LEVEL 78

PB LEVEL 79

PB LEVEL 80

PB LEVEL 81

PB LEVEL 82

PB LEVEL 83

PB LEVEL 84

PB LEVEL 85

PB LEVEL 86

PB LEVEL 87

PB LEVEL 88

PB LEVEL 89

PB LEVEL 90

PB LEVEL 91

PB LEVEL 92

PB LEVEL 93

PB LEVEL 94

PB LEVEL 95

PB LEVEL 96

PB LEVEL 97

PB LEVEL 98

PB LEVEL 99

PB LEVEL 100

PB LEVEL 101

PB LEVEL 102

PB LEVEL 103

PB LEVEL 104

PB LEVEL 105

PB LEVEL 106

PB LEVEL 107

PB LEVEL 108

PB LEVEL 109

PB LEVEL 110

PB LEVEL 111

PB LEVEL 112

PB LEVEL 113

PB LEVEL 114

PB LEVEL 115

PB LEVEL 116

PB LEVEL 117

PB LEVEL 118

PB LEVEL 119

PB LEVEL 120

PB LEVEL 121

PB LEVEL 122

PB LEVEL 123

PB LEVEL 124

PB LEVEL 125

PB LEVEL 126

PB LEVEL 127

PB LEVEL 128

PB LEVEL 129

PB LEVEL 130

PB LEVEL 131

PB LEVEL 132

PB LEVEL 133

PB LEVEL 134

PB LEVEL 135

PB LEVEL 136

PB LEVEL 137

PB LEVEL 138

PB LEVEL 139

PB LEVEL 140

PB LEVEL 141

PB LEVEL 142

PB LEVEL 143

PB LEVEL 144

PB LEVEL 145

PB LEVEL 146

PB LEVEL 147

PB LEVEL 148

PB LEVEL 149

PB LEVEL 150

PB LEVEL 151

PB LEVEL 152

PB LEVEL 153

PB LEVEL 154

PB LEVEL 155

PB LEVEL 156

PB LEVEL 157

PB LEVEL 158

PB LEVEL 159

PB LEVEL 160

PB LEVEL 161

PB LEVEL 162

PB LEVEL 163

PB LEVEL 164

PB LEVEL 165

PB LEVEL 166

PB LEVEL 167

PB LEVEL 168

PB LEVEL 169

PB LEVEL 170

PB LEVEL 171

PB LEVEL 172

PB LEVEL 173

PB LEVEL 174

PB LEVEL 175

PB LEVEL 176

PB LEVEL 177

PB LEVEL 178

PB LEVEL 179

PB LEVEL 180

PB LEVEL 181

PB LEVEL 182

PB LEVEL 183

PB LEVEL 184

PB LEVEL 185

PB LEVEL 186

PB LEVEL 187

PB LEVEL 188

PB LEVEL 189

PB LEVEL 190

PB LEVEL 191

PB LEVEL 192

PB LEVEL 193

PB LEVEL 194

PB LEVEL 195

PB LEVEL 196

PB LEVEL 197

PB LEVEL 198

PB LEVEL 199

PB LEVEL 200

PB LEVEL 201

PB LEVEL 202

PB LEVEL 203

PB LEVEL 204

PB LEVEL 205

PB LEVEL 206

PB LEVEL 207

PB LEVEL 208

PB LEVEL 209

PB LEVEL 210

PB LEVEL 211

PB LEVEL 212

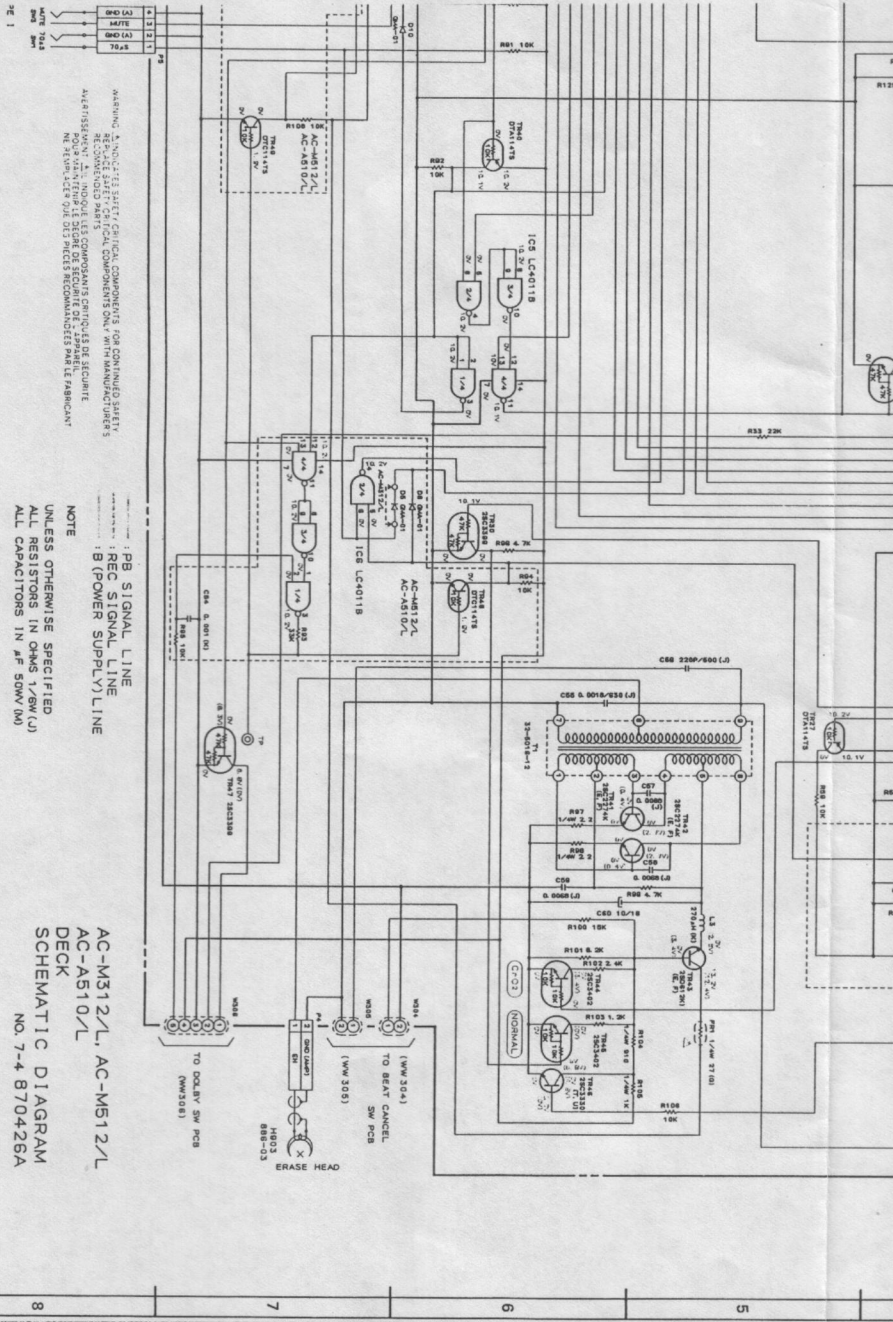

WARNING: AVOID CONTACT WITH ELECTRICAL COMPONENTS FOR CONTINUED SAFETY.
 REPAIRS SHOULD BE MADE BY QUALIFIED PERSONNEL ONLY. REFER TO THE SERVICE MANUAL FOR SAFETY PRECAUTIONS.
 REPAIRS SHOULD BE MADE BY QUALIFIED PERSONNEL ONLY. REFER TO THE SERVICE MANUAL FOR SAFETY PRECAUTIONS.

NOTE: PB SIGNAL LINE
 : REC SIGNAL LINE
 : B (POWER SUPPLY) LINE

UNLESS OTHERWISE SPECIFIED
 ALL RESISTORS IN OHMS (1/8W, 1/4W, 1/2W)
 ALL CAPACITORS IN P.F. (50V, 100V)

AC-M512/L AC-M512/L
 AC-A510/L
 DECK
 SCHEMATIC DIAGRAM
 NO. 7-4-870426A

F G H J K

FM SIGNAL LINE
 AM SIGNAL LINE
 B (POWER SUPPLY) LINE

NOTE
 UNLESS OTHERWISE SPECIFIED
 ALL RESISTORS IN OHMS (1/8W (J))
 ALL CAPACITORS IN μF (50WV (M))

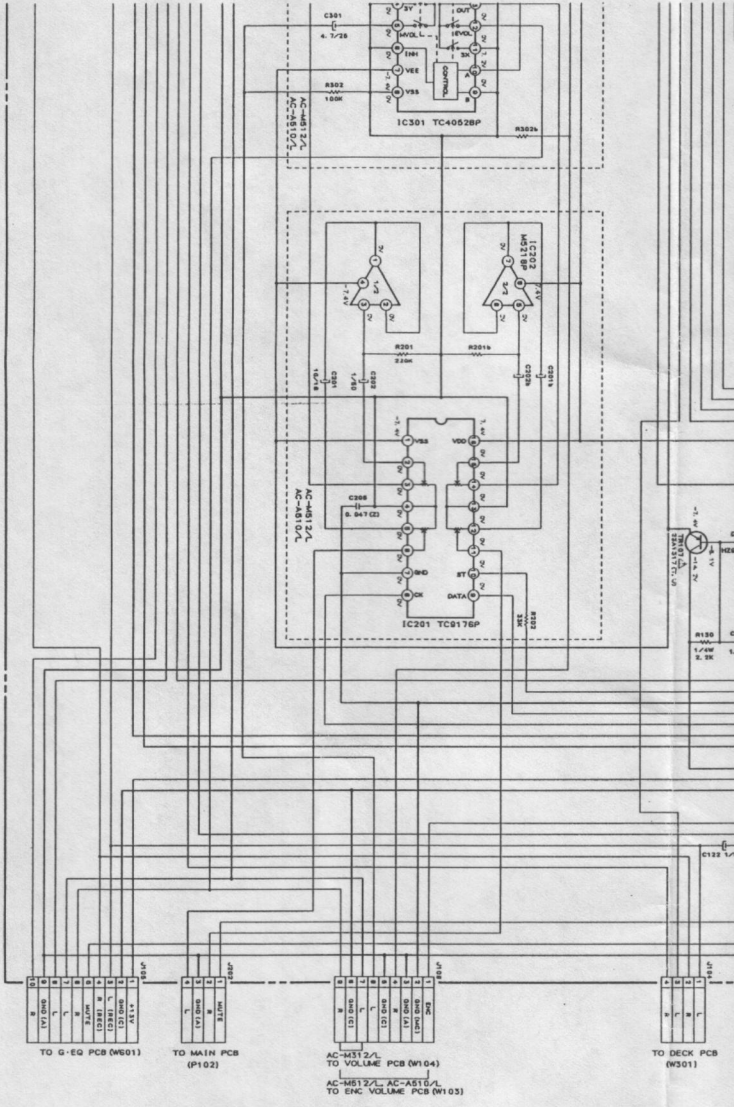

AC-M312/L, AC-M512/L,
 AC-AS10/L
 BASE
 SCHEMATIC DIAGRAM
 NO. 7-3 870425A

G

H

J

K

8

7

6

5

**DETECTOR PCB
C1016A504C**

AC-14801/L AC-14801/L

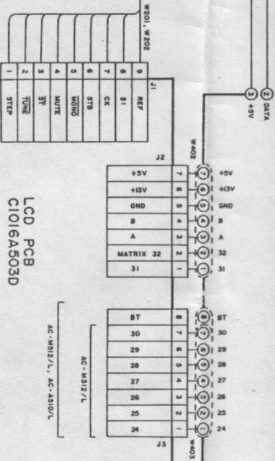

**LCD PCB
C1016A503D**

AC-14812/L AC-14801/L

**DECK PCB
C1016A503A**

AC-14812/L AC-14801/L

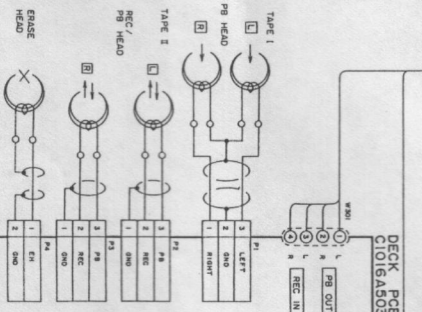

**BEAT SW PCB
C1016A503C**

AC-14812/L AC-14801/L

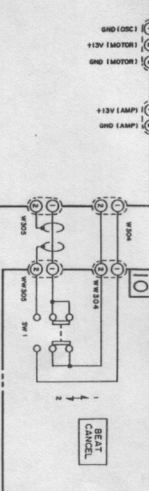

**DOLBY SW PCB
C1016A503B**

AC-14812/L AC-14801/L

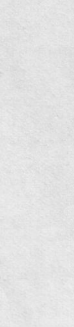

**TAPE 1
C1016A503E**

AC-14812/L AC-14801/L



**TAPE 2
C1016A503F**

AC-14812/L AC-14801/L

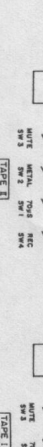

**ERASE
HEAD
C1016A503G**

AC-14812/L AC-14801/L



8

7

6

5

A

B

C

D

E

F

AC-M312/L, AC-M512/L
 AC-A510/L
 DECK BLOCK DIAGRAM
 NO.2-1 870430A

