

Bang & Olufsen

BEOGRAM 5000, type 580x

BEOGRAM 2000, type 582x

Types 5804-5823 PCB 1 = 8005102

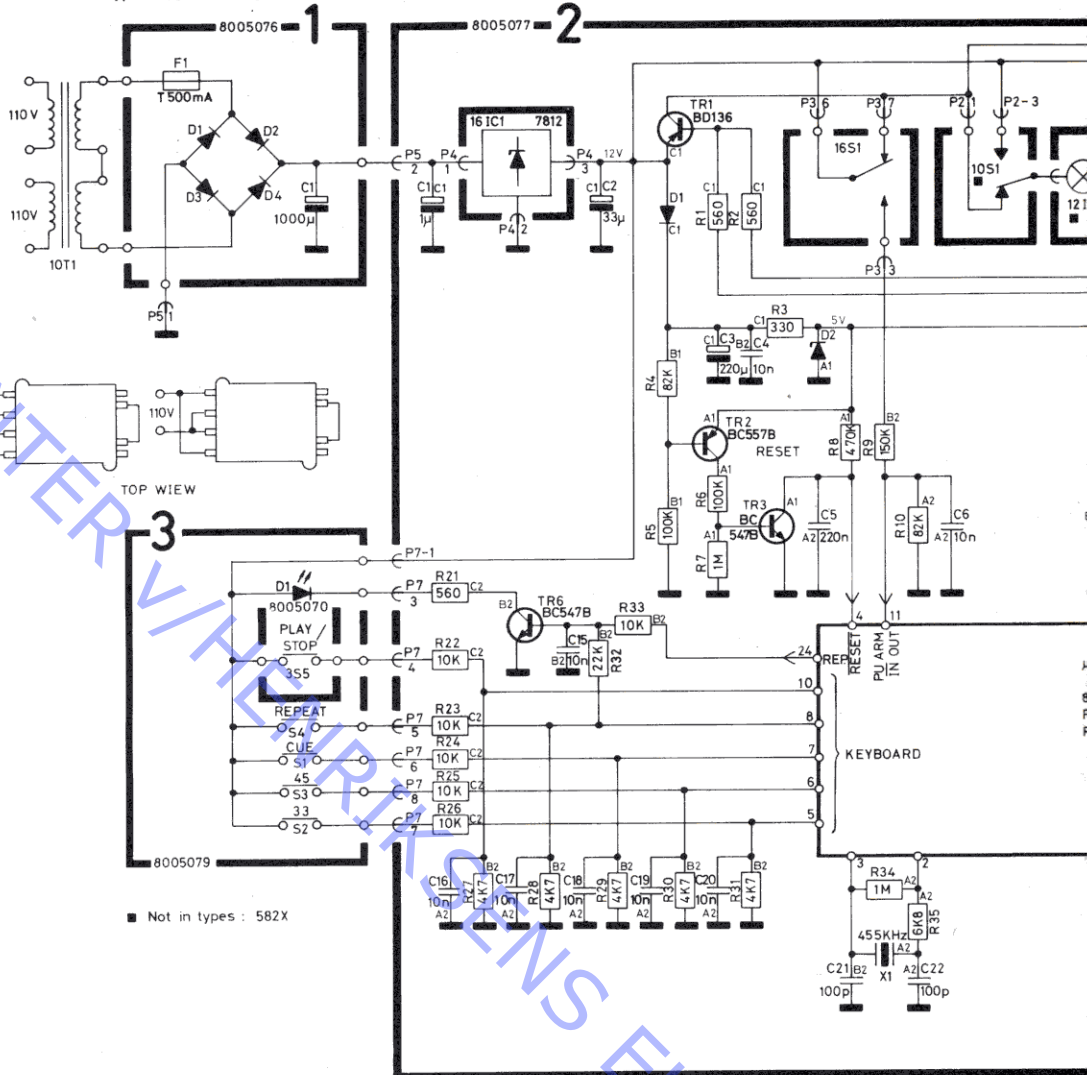

■ Not in types : 582X

PASTE INTO SERVICE MANUAL BEOGRAM 1800

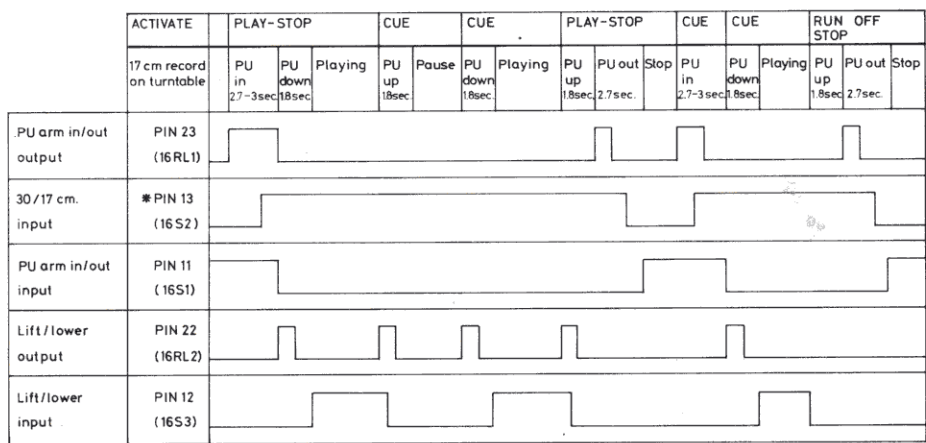

* PIN 13 is constant low with 30 cm. record

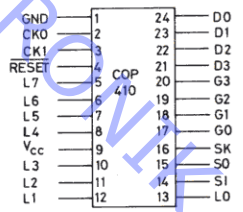

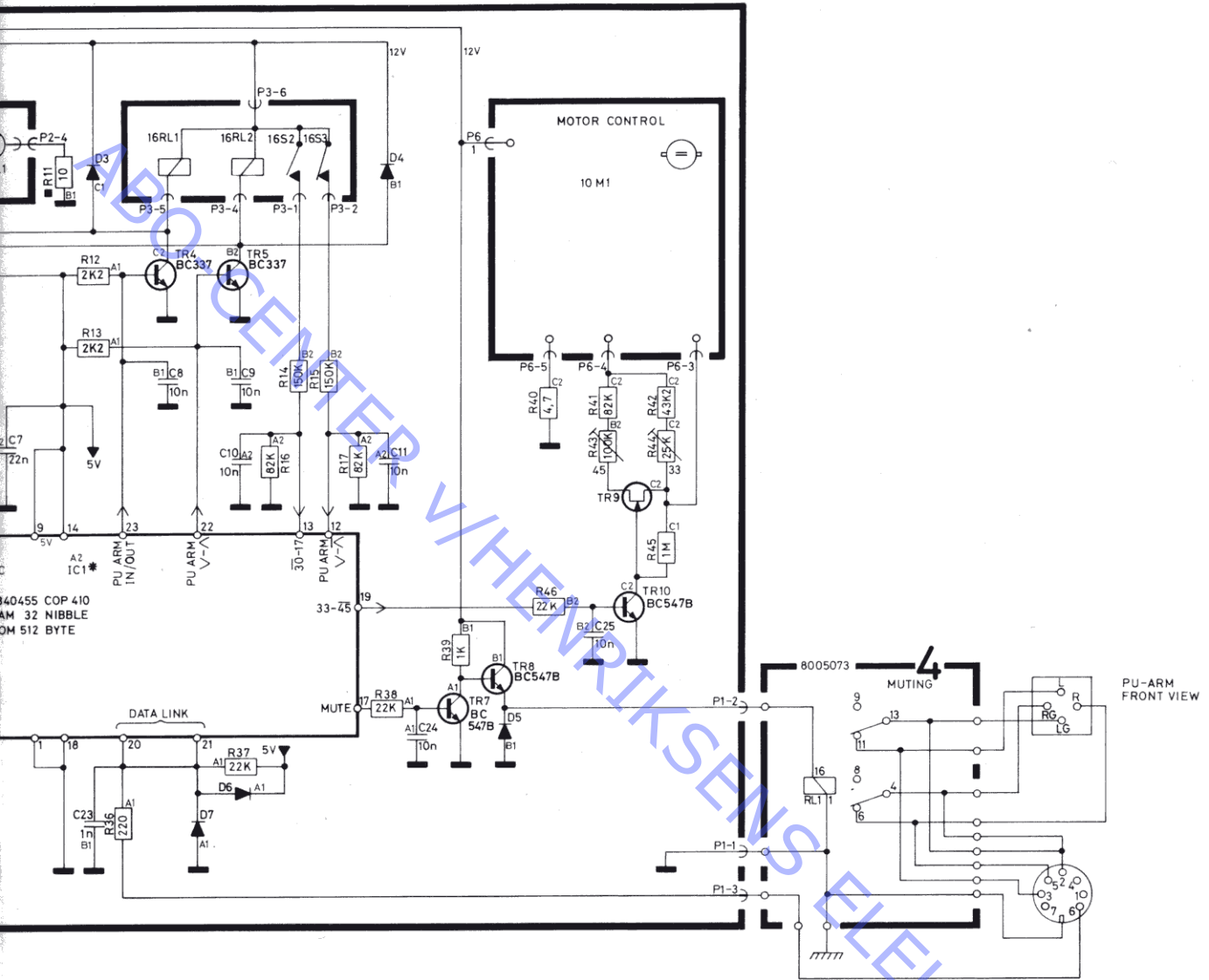

Explanation of the fuse symbols used in the set:

Explication des symboles du fusible utilisés dans l'appareil:

Replace with same type 500 mA-250 V
slow acting fuse.

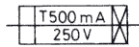

Remplacer par un fusible de meme type retarde et
de 500 mA-250 V.