

## DIAGRAM A Focus & Radial Servo

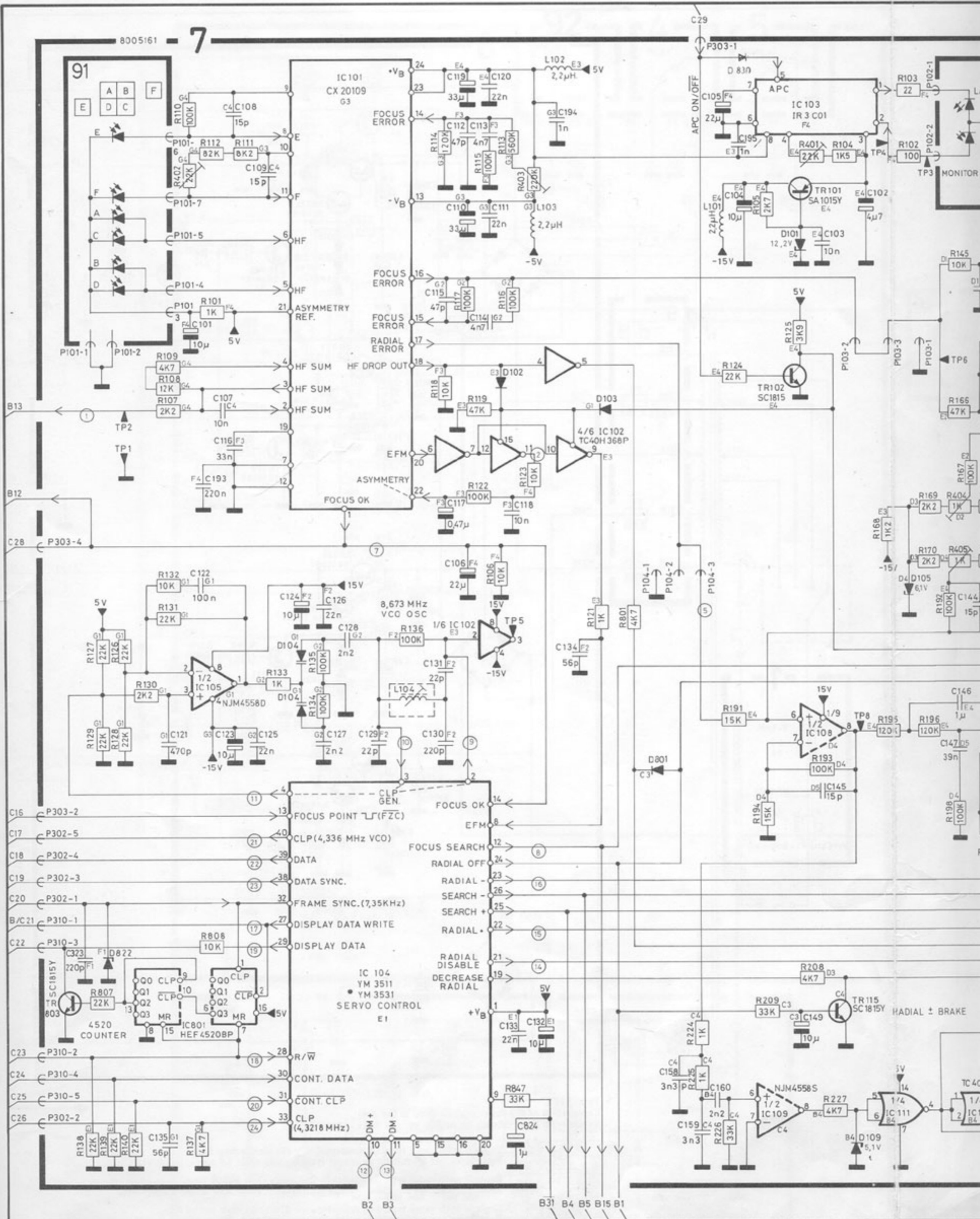

○ Refers to page 1-4

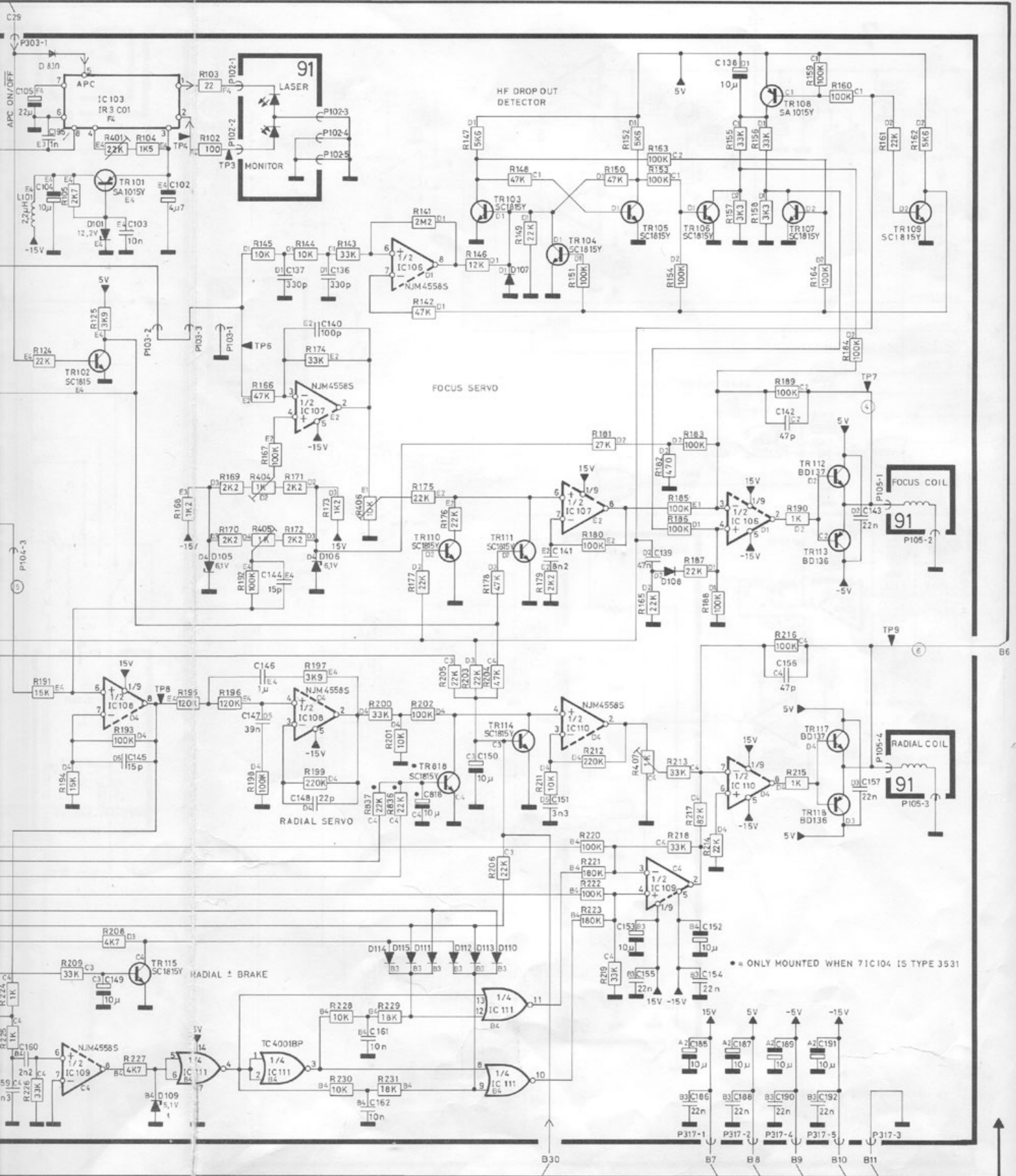



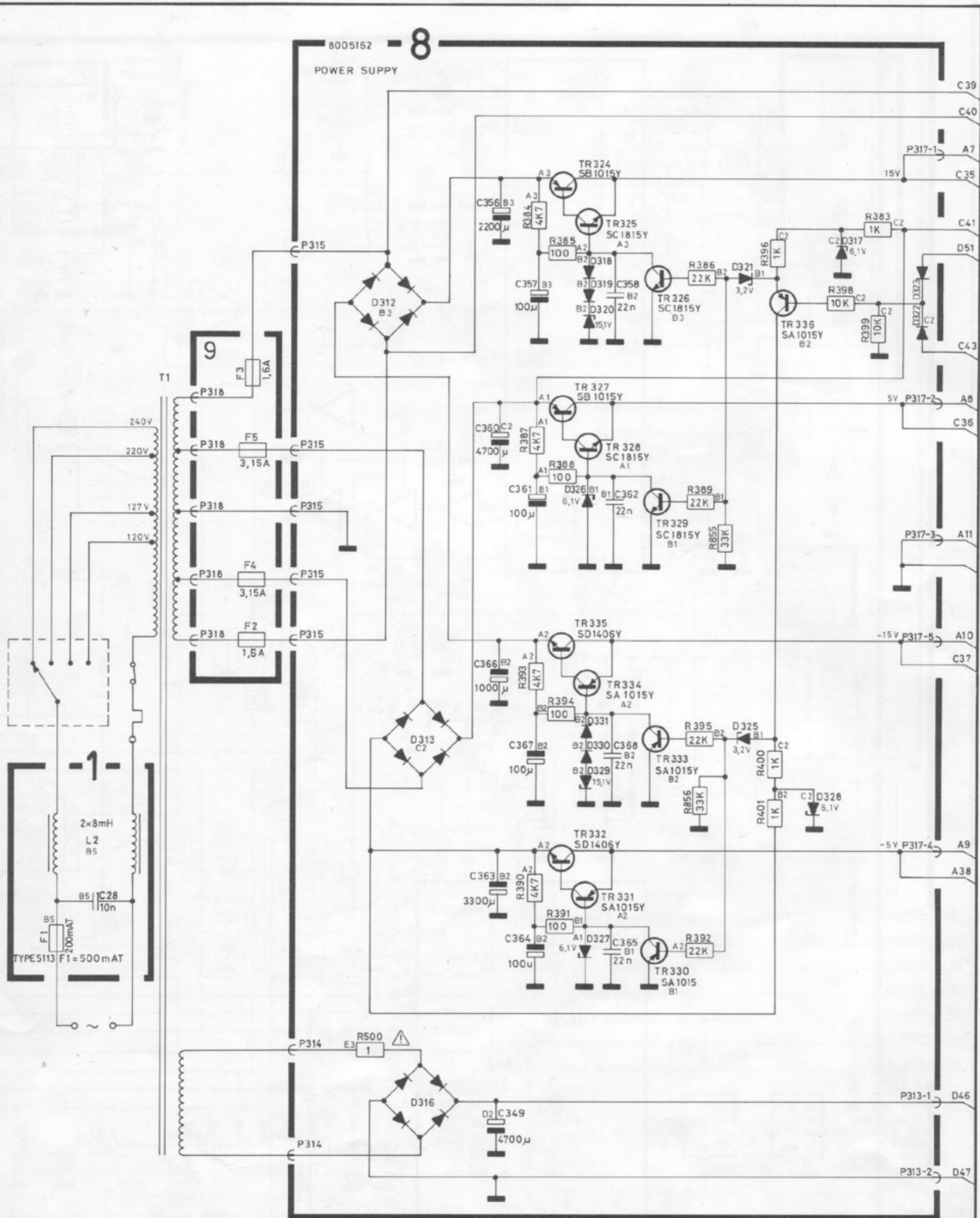

Type 5113.  
 Explanation of the fuse symbols used in the set:  
 Explication de symboles du fusible utilisés dans l'appareil:

- |  |          |      |   |
|--|----------|------|---|
| <table border="1" style="width: 100%; text-align: center;"> <tr><td>T 1.6 A</td></tr> <tr><td>250V</td></tr> </table>  | T 1.6 A  | 250V | Replace with same type 1.6 ampere 250 volts slow acting fuse.<br>Remplacer par un fusible de meme type retardé et de 1,6 ampere 250 volts.            |
| T 1.6 A  |          |      |   |
| 250V   |          |      |   |
| <table border="1" style="width: 100%; text-align: center;"> <tr><td>T 3.15 A</td></tr> <tr><td>250V</td></tr> </table> | T 3.15 A | 250V | Replace with same type 3.15 ampere 250 volts slow acting fuse.<br>Remplacer par un fusible de meme type retardé et de 3,15 ampere 250 volts.          |
| T 3.15 A   |          |      |   |
| 250V   |          |      |   |
| <table border="1" style="width: 100%; text-align: center;"> <tr><td>T500mA</td></tr> <tr><td>250V</td></tr> </table>   | T500mA   | 250V | Replace with same type 500 milliamperes 250 volts slow acting fuse<br>Remplacer par un fusible de meme type retardé et de 500 milliamperes 250 volts. |
| T500mA   |          |      |   |
| 250V   |          |      |   |

## DIAGRAM C Decoder, System Control

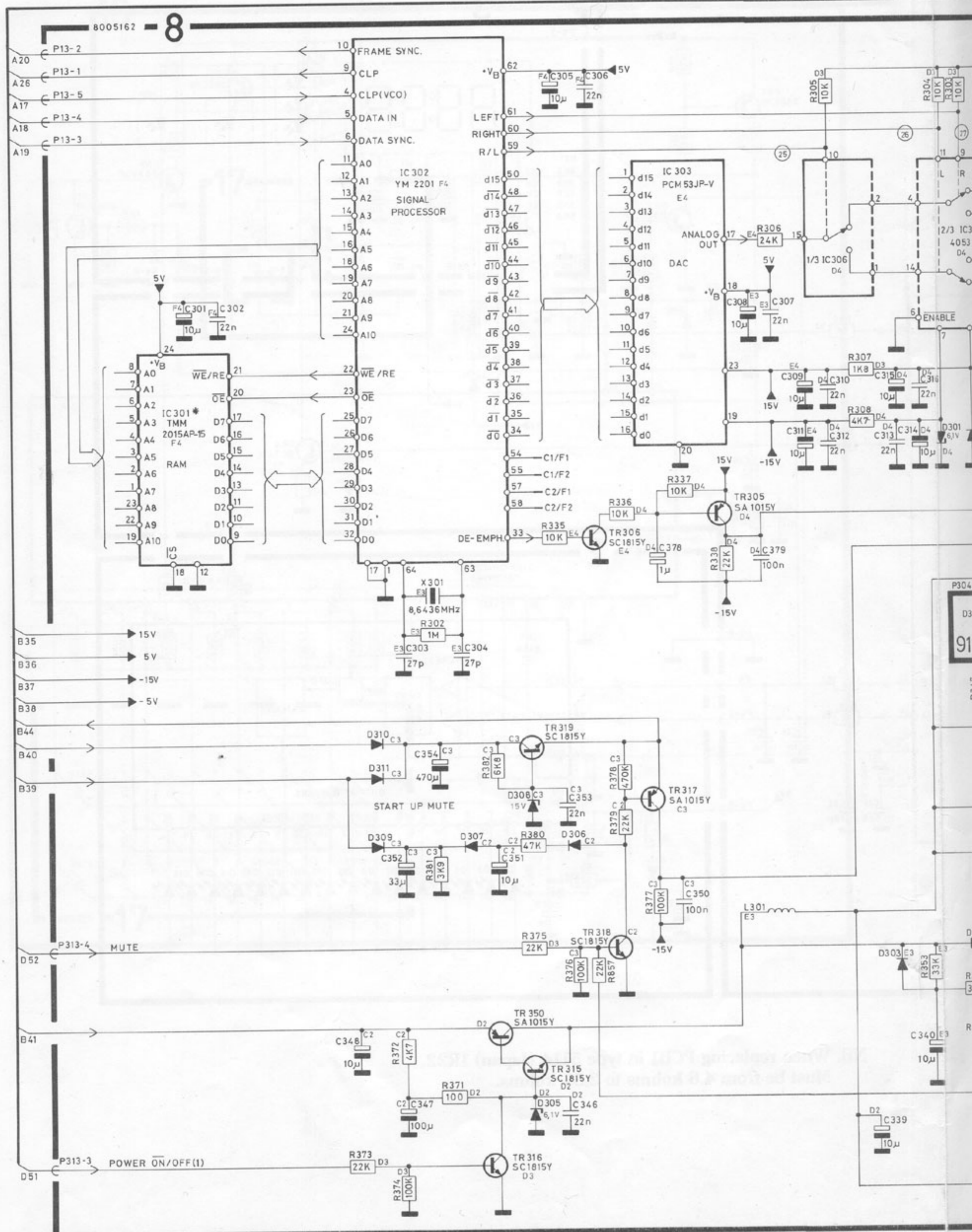

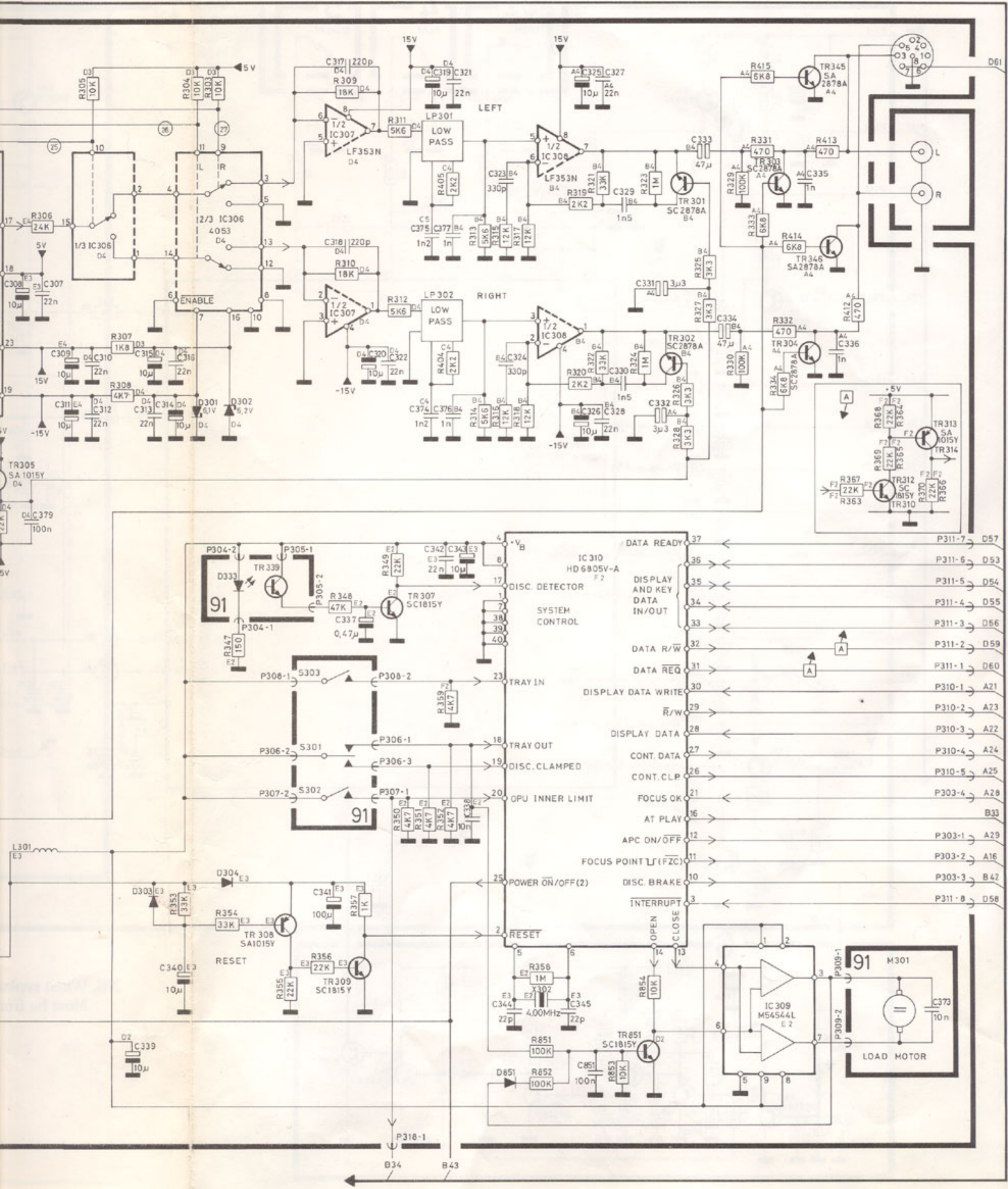
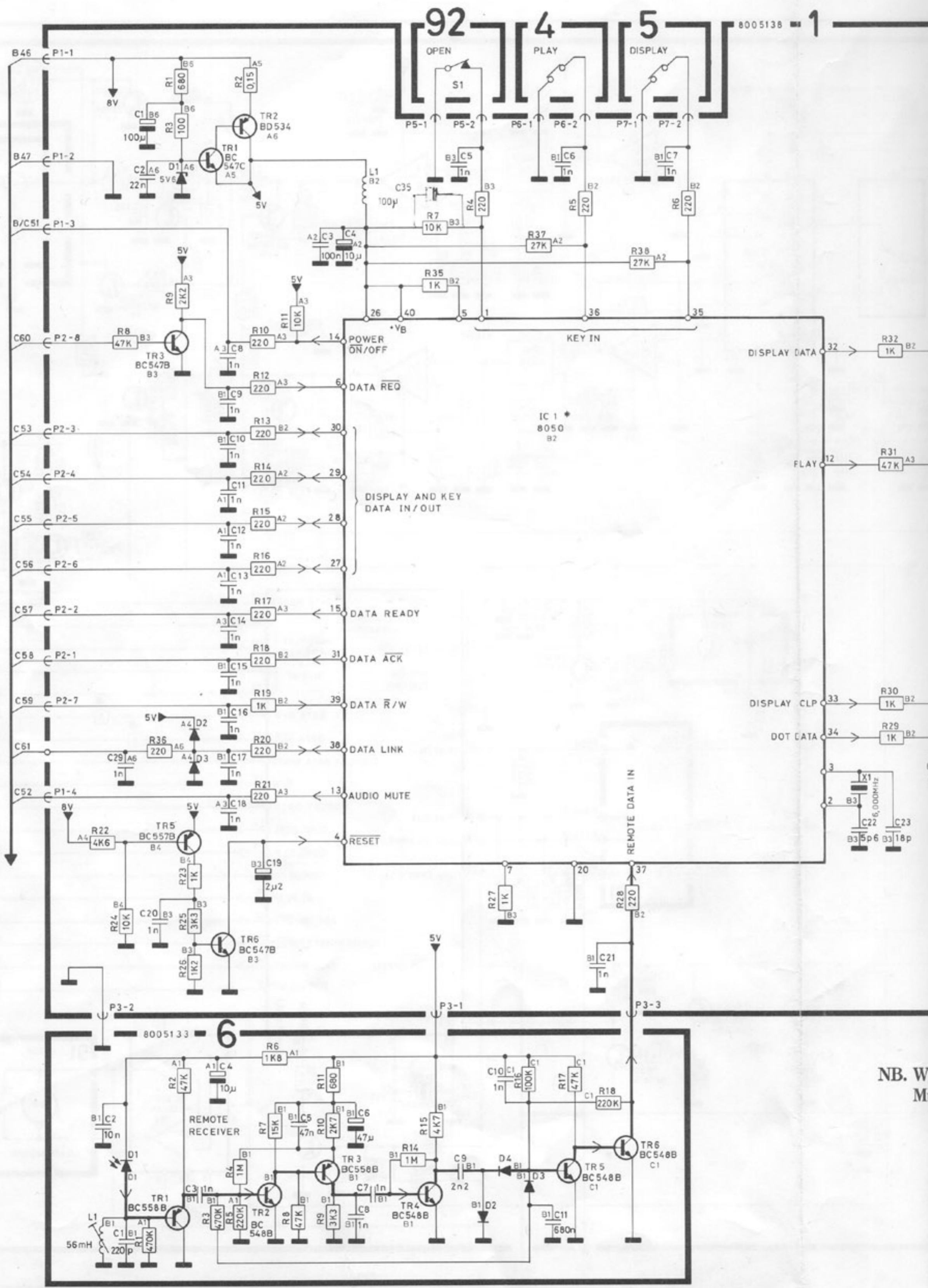
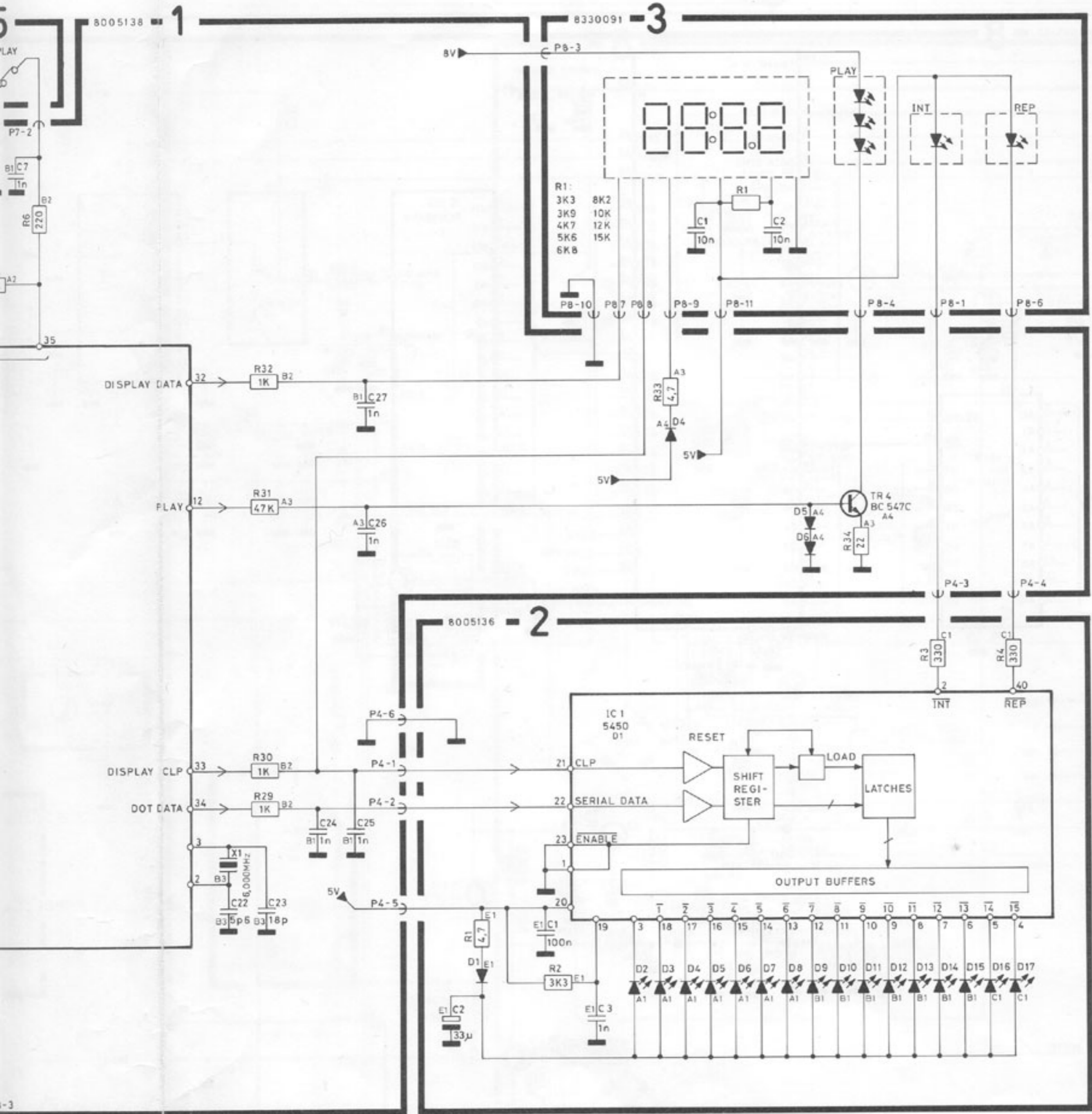

DIAGRAM D Display and Key Control



NB. WI  
Mu



NB. When replacing PCB1 in type 5114 (Japan) 1R22.  
Must be from 4.6 kohms to 2.55 kohms.

R6  
C540B  
C1



## DIAGRAM E Remote transmitter, keyboard

