

Spare parts Dual 1210

Spare parts

Ref. No.	Part No.	Description	Quantity per unit
1	215 470	Automatic spindle	1
2	214 054	Decorative washer mat	1
3	214 213	Turntable mat complete (for turntable 214 212 only)	1
	214 215	Turntable mat complete (for turntable 214 214 only)	1
	214 223	Turntable mat complete (for turntable 214 222 only)	1
	214 063	Shield for pick-up head (for turntable 214 214 only)	1
	201 208	Facing ring for turntable mat (for turntable 214 222 only)	1
4	200 543	Lock ring	1
5	214 212	Turntable and mat assembly	1
	214 214	Turntable and mat assembly with shield for pick-up head	1
	214 222	Turntable and mat assembly with facing ring	1
6	214 050	Speed selector knob, long	1
7	214 220	Speed escutcheon	1
8	213 912	Adjusting wheel	1
9	210 181	Bowed lockwasher 4680/4,2/8a	1
10	213 910	Turntable securing device	1
11	213 911	Cam wheel	1
12	213 906	Speed change lever assembly	1
13	214 210	Shipping screw assembly	1
14	214 605	Oval head screw	2
15	210 187	Bowed lockwasher 4680/5,2/10a	3
16	210 658	Washer 5,1/10/1 St	1
17	210 147	"C" ring 4	3
18	213 895	Automatic spindle AW 3	1
19	201 095	Adapter	1
20	200 709	Single play spindle	1
21	210 369	Hex nut M 5	1
22	210 615	Washer 3,2/20/1,5 St	1
23	204 606	Grommet	1
24	210 816	Machine screw M 4 x 4	2
25	200 613	Bushing	2
26	210 816	Machine screw M 4 x 4	2
27	201 632	Washer	2
28	210 366	Hex nut BM 4	4
29	209 358	Steel ball	1
30	210 362	Hex nut BM 3	2
31	201 229	Guide pin	1
32	214 040	Set screw	1
33	210 187	Bowed lockwasher 4680/5,2/10a	3
34	200 581	Isolation mounting assembly, 2-pole motor	1
35	200 723	Rubber insert isolation mount	3
36	200 722	Steel cup	3
37	200 728	Compression spring isolation mount, 2-pole motor	3
38	200 721	Bushing isolation mount	3
39	214 200	Chassis assembly	1
40	214 066	Name plate CSA	1
	214 068	Name plate 110/220 V, 60 Hz	1
41	200 613	Bushing	2
42	201 632	Rubber washer	2
43	200 713	Washer	2
44	210 624	Washer 4,2/7/0,3 St	4
45	200 718	Compression spring	2
46	210 624	Washer 4,2/7/0,3 St	4
47	210 147	"C" ring 4	3
48	200 712	Spring sleeve	2

Fig. 2 Exploded view, parts below chassis

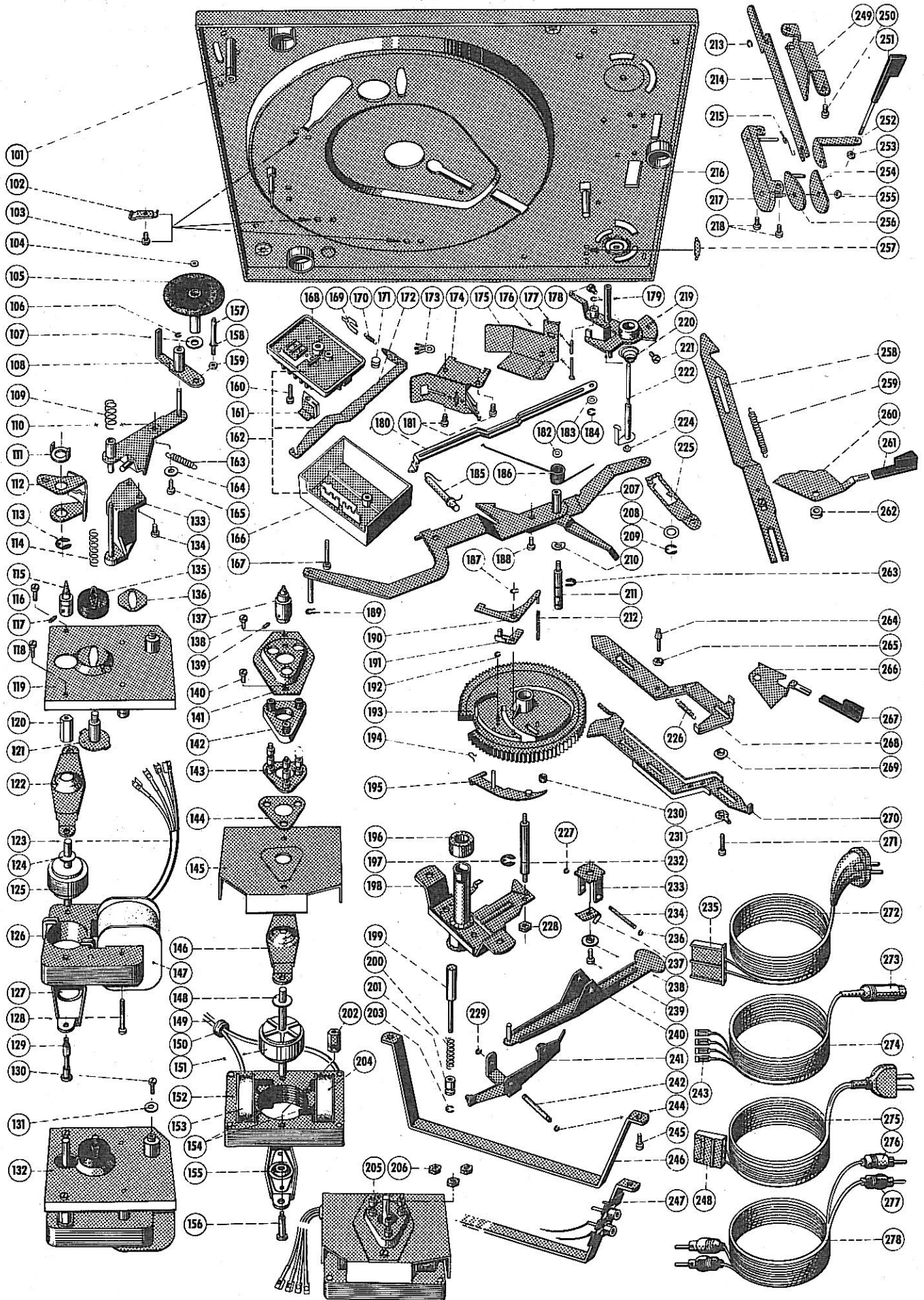

Ref. No.	Part No.	Description	Quantity per unit
49	200 711	Spring clip	2
50	201 145	Positioning screw	1
51	207 839	Damping ring	1
52	200 828	Set screw	1
53	201 132	Finger lift	1
54	210 182	Bowed lockwasher 4680/4,2/8d	1
55	210 630	Washer 4,2/8/0,5 St	1
56	210 197	Grip ring G 4 x 0,8	1
57	215 430	Cartridge mount TK 14	1
	215 438	Cartridge mount TK 14h	1
58	214 216	Tonearm assembly	1
59	214 216	Tonearm complete	1
60	214 217	Tonearm leads with contact block	1
61	210 145	"C"ring 2,3	8
62	214 006	Positioning screw	1
63	214 005	Set plate	1
64	214 007	Release spring	2
65	200 829	Lock nut	1
66	214 218	Spring barrel assembly	1
67	210 146	"C"ring 3,2	3
68	213 987	Bearing post assembly	1
69	201 024	Bearing screw assembly, long	1
70	209 353	Steel ball 2 ϕ	14
71	210 149	"C" ring 6	2
72	214 208	Tonearm rest assembly with arm latch	1
73	210 362	Hex nut M3	2
74	214 221	Dress-up plate, inch markings	1
75	214 020	Switch button	2
76	214 211	Shipping screw, groove threaded	2
	214 047	Shipping screw, groove pierced	2
101	212 122	Bearing tube	1
102	200 447	Cable clamp	3
103	210 472	Machine screw AM 3 x 4	10
104	200 633	Lock washer	1
105	212 117	Idler wheel assembly	1
106	210 146	"C" ring 3,2	3
107	200 110	Idler thrust washer	1
108	212 121	Idler arm assembly	1
109	200 622	Compression spring	1
110	213 908	Idler rocker assembly	1
111	212 123	Speed regulator detent	1
112	213 926	Switching segment	1
113	210 151	"C" ring 7	1
114	200 621	Compression spring	1
115	212 135	Motor pulley 50 cycle, 2-pole motor	1
	212 136	Motor pulley 60 cycle, 2-pole motor	1
116	210 507	Machine screw AM 3,5 x 6	2
117	210 220	Set screw M 2,6 x 3,5	1
118	210 507	Machine screw AM 3,5 x 6	2
119	204 372	Mounting plate, 2-pole motor	1
120	204 476	Motor spacer, 2-pole motor	2
121	204 594	Holding disc	1
122	204 456	Motor bearing top (housing)	1
123	210 731	Insulating sleeve	1
124	204 410	Fiber washer	1
125	204 600	Rotor assembly	1
126	202 992	Stator assembly	1
127	204 454	Motor bearing lower (housing)	1
128	210 522	Machine screw AM 4 x 18	2
129	204 468	Motor bearing housing screw	2
130	210 472	Machine screw AM 3 x 4	10
131	204 608	Washer	1
132	202 991	2-pole motor less pulley.	1
133	200 548	Support assembly	1
134	210 475	Machine screw AM 3 x 5	3
135	202 042	Spacer	1
136	204 607	Washer	1
137	212 115	Motor pulley 50 cycle, 4-pole motor.	1
	212 116	Motor pulley 60 cycle, 4-pole motor.	1
138	210 509	Machine screw AM 3,5 x 8	2
139	210 220	Set screw M 2,6 x 3,5	1
140	210 509	Machine screw AM 3,5 x 8	2
141	204 669	Upper cover, 4-pole motor	1
142	204 668	Isolation mount plate, 4-pole motor	1
143	204 632	Mounting bracket for 4-pole motor	1

Ref. No.	Part No.	Description	Quantity per unit
144	204 666	Isolation washer lower, 4-pole motor	1
145	204 663	Motor shield, 4-pole motor	1
146	204 686	Upper bearing assembly, 4-pole motor	1
147	202 999	Field coil 110/125 V	1
148	204 689	Fiber washer	1
149	210 762	Insulation motor leads	1
150	209 939	Grommet	1
151	204 687	Rotor, 4-pole motor	1
152	202 989	Stator, 4-pole motor	1
153	202 987	Field coil, 110/220 V	2
	204 662	Leaf spring for field coil	4
154	210 140	Spring bushing 2 x 16	4
155	204 685	Bearing assembly lower, 4-pole motor	1
156	204 468	Motor bearing housing screw	2
157	212 125	Idler wheel shaft	1
158	210 145	"C" ring 2,3	8
159	210 361	Hex nut M 3	2
160	210 472	Machine screw AM 3 x 4	10
161	213 978	Locking device, small, for power switch housing	1
	213 979	Locking device, large, for power switch housing	1
162	214 205	Switch assembly	1
163	213 909	Tension spring	1
164	210 584	Washer 3,2/6/0,5 St	1
165	210 469	Machine screw AM 3 x 3	3
166	214 207	Cover for switch assembly	1
167	210 499	Machine screw AM 3 x 30	1
168	214 206	Switch plate assembly	1
169	213 966	Snap spring	1
170	213 967	Spring tension	1
171	213 969	Roller for switch slide	1
172	213 970	Switch slide assembly	1
173	211 614	Solder lug	1
174	207 447	Muting switch	1
175	201 240	Shield	1
176	200 686	Spring pin	1
177	201 174	Compression spring	1
178	210 482	Machine screw AM 3 x 6	1
179	210 143	"C" ring 1,5	1
180	200 688	Shut-off slide	1
181	210 472	Machine screw AM 3 x 4	10
182	210 586	Washer 3,2/7/0,5 St	1
183	201 187	Friction disc	1
184	210 145	"C" ring 2,3	8
185	209 506	Capacitor 10 000 pF/700 V	1
186	213 940	Torsion spring	1
187	210 194	"C" clip G 2 x 0,6	1
188	210 472	Machine screw AM 3 x 4	10
189	210 196	"C" clip G 3 x 0,6	1
190	200 558	Shut-off lever assembly	1
191	200 557	Friction plate	1
192	210 145	"C" ring 2,3	8
193	214 202	Cam wheel complete	1
194	200 522	Snap spring	1
195	214 203	Cam follower lever complete with grommet	1
196	200 554	Ball bearing assembly	1
197	210 149	"C" ring 6	2
198	214 201	Bearing support assembly	1
199	213 918	Change actuator complete	1
200	213 920	Compression spring	1
201	213 921	Bushing	1
202	200 167	Bearing post	2
203	210 145	"C" ring 2,3	8
204	202 987	Field coil 110/220 V	2
	204 662	Leaf spring for field coil	4
205	202 988	Motor less pulley	1
206	210 366	Hex nut BM 4	4
207	214 204	Switch arm	1
208	202 043	Washer 5,8/12/0,5 St	1
209	210 146	"C" ring 3,2	3
210	210 184	Bowed lockwasher 4680/5,2/8	1
211	200 658	Grooved shaft	1
212	200 657	Coiled spring	1
213	210 145	"C" ring 2,3	8
214	201 203	Connecting lever	1
215	201 196	Torsion spring	1

Ref. No.	Part No.	Description	Quantity per unit
216	214 200	Base plate	1
217	201 037	Support bracket assembly	1
218	210 469	Machine screw AM 3 x 3	3
219	214 209	Segment complete with spring pin	1
220	201 179	Conical spring	1
221	210 480	Machine screw AM 3 x 6	1
222	214 034	Lift rod	1
224	200 527	Main lever shaft.	1
225	213 942	Latch complete	1
226	200 103	Tension spring	1
227	210 145	"C" ring 2,3	8
228	210 366	Hex nut BM 4	4
229	210 145	"C ring 2,3	8
230	200 650	Grommet	1
231	209 974	Solder lug	1
232	200 519	Bearing post	1
233	201 185	Main lever bracket	1
234	200 528	Shaft.	1
235	213 980	Input jack housing	1
236	210 145	"C" ring 2,3.	8
237	201 186	Leaf spring	1
238	200 458	Spacer	1
239	210 481	Machine screw AM 3 x 6	1
240	201 094	Main lever complete.	1
241	213 922	Cam rocker	1
242	200 525	Shaft.	1
243	209 436	Lug (amp)	4
244	210 145	"C" ring 2,3	8
245	210 472	Machine screw AM 3 x 4	10
246	202 082	Stand	1
247	211 448	Stand complete with phono jacks	1
248	209 457	Inner casing for AMP-plug	1
249	201 042	Bearing support assembly	1
250	210 479	Machine screw AM 3 x 5,5	1
251	214 042	Arm lift lever	1
252	201 040	Drive cam assembly.	1
253	210 353	Hex nut BM 2	1
254	201 195	Cover washer	1
255	210 366	Hex nut BM 4	4
256	201 039	Drive washer	1
257	200 687	Spring clip	1
258	201 035	Arm positioning slide	1
259	200 453	Tension spring	1
260	213 946	Record size selector lever	1
261	214 020	Selector knob	2
262	200 666	Short spacer	1
263	210 147	"C" ring 4	3
264	207 286	Set screw assembly.	1
265	210 361	Hex nut M 3	2
266	213 947	Manual/auto selector lever	1
267	214 020	Selector knob	2
268	213 950	Switch lever assembly	1
269	200 672	Spacer, long.	1
270	213 951	Start lever	1
271	210 491	Machine screw AM 3 x 14	1
272	213 983	Power cord complete	1
	207 312	Power cord, european	1
273	209 424	Miniature 5-pin plug	1
274	207 303	Plug-in output cable.	1
275	207 311	Power cord, U. S. type plugs	1
	213 984	Power cord, european type plugs	1
276	209 425	Phono plug, yellow	2
277	209 426	Phono plug, red	2
278	207 299	Audio cable, phono connector	1
*	201 858	Securing segment for transport.	2
*	201 859	Securing support	4
*	210 088	Tube clamp	1
*	210 098	Plastic grip	1
*	210 597	Washer 3,2/8/0,5 St	1
*	211 473	Shield for pick-up head.	1
*	214 120	Cartridge mounting hardware	1
*	214 219	Packing carton complete	1
*	214 094	Operating instructions	
*	214 092	Operating instructions (Canada)	
*	214 091	Mounting instructions	