

Lenco

Modell L78

Stücklistenblatt, Preisliste

Exploded drawing, Price-List

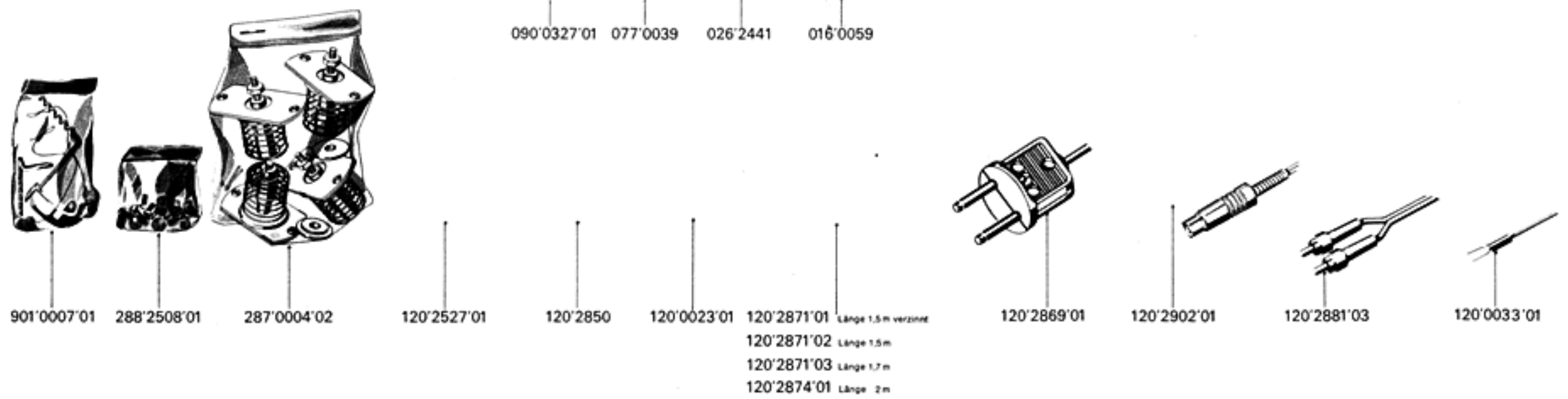
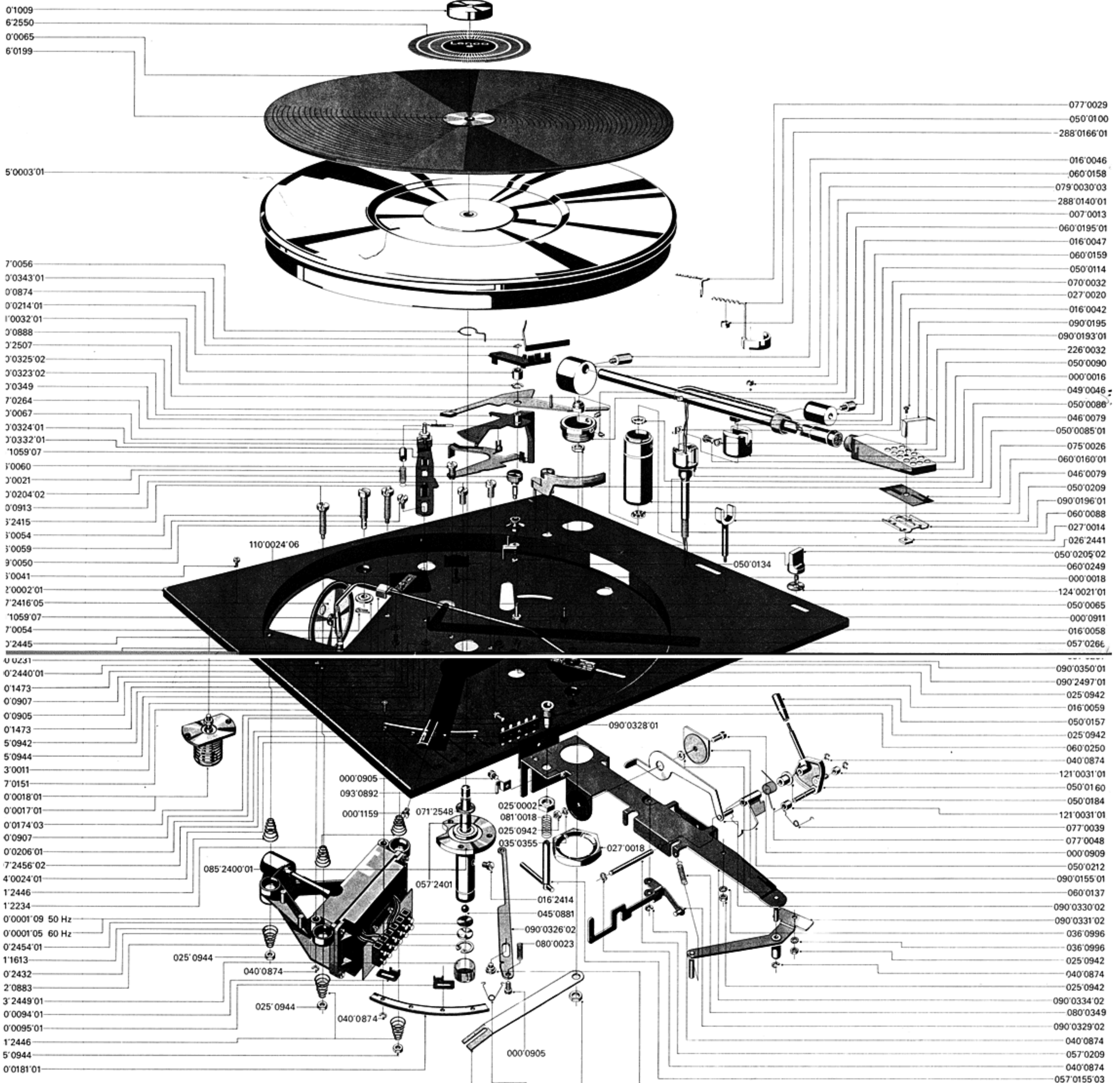

UAI Uher of America Inc.

621 S. Hinury Avenue • Inglewood, California 90301

(213) 649-1272

SPARE PARTS PRICE LIST Lenco L78

Effective: September 1, 1975

PART NO.	PRICE	DESCRIPTION	PART NO.	PRICE	DESCRIPTION
221'0010'01	\$36.16	TONARM COMPLETE	016'0058	\$.14	Special screw
000'0016	.07	Cylindrical screw M2.6 x 6	016'0059	.14	Special screw
016'0046	.72	Hand screw	016'0066	.29	Special screw
016'0047	.72	Hand screw	016'0060	.14	Special screw
026'2441	.14	Hex nut M5.5 x 0.5	016'0067	.72	Special screw
027'0020	.07	Square nut M 2.6	016'2415	.72	Transport security screw
046'0079	.72	Special ball bearing	025'0002	.29	Hex nut M 10
049'0046	.29	Support	025'0942	.07	Hex nut M 3
050'0086	2.39	Support	025'0944	.07	Hex nut M 4
050'0090	2.46	Cover bush	026'2441	.14	Hex nut MF 5.5 x 0.5
060'0114	.14	Rest piece holder	027'0018	.94	Sheet nut M 30 x 1.5
060'0088	1.30	Cone nut	030'0027	.14	Washer
060'0158	7.09	Balance weight	030'1473	.07	Washer 3.2 x 8 x 0.5
060'0159	2.02	Stylus pressure weight	036'0996	.07	Spring tooth washer
060'2507	1.37	Cone nut	039'0050	.14	Three cornered circlip
060'0160'01	10.70	Support cover	040'0874	.14	Circlip size 2.3
070'0032	.14	Rest piece	040'0888	.07	Circlip size 5
079'0030'03	20.25	Tonearm tube with cable	050'0065	.29	Cable clip
090'0193 01	.07	Clamping plate	050'0085'01	5.35	Arm lift complete
			050'0100	1.74	Loading arm complete
226'0032'07	12.73	PLUG-IN HEAD COMPLETE	050'0134	.14	Eccentric stop
016'0042	.29	Special screw	050'0157	1.45	Knob to arm lift lever
027'0014	.07	Square nut M 3	050'0160	2.89	Arm lift lever
075'0026	.14	Inlaying paper	050'0184	.22	Housing
090'0195	.72	Knob	050'0204'02	2.17	Stop knob
090'0196'01	.72	Supporting plate	050'0205'02	2.17	Switch knob
226'0032	8.68	Plug-in head with decorative holes	050'0206'01	1.45	Knob
			050'0209	1.66	Tonearm rest
085'2400'02	12.36	TURNTABLE SPINDLE BEARING	050'0212	.72	Arm lift curve
016'2414	.14	Special screw	050'1009	.29	Adapter
042'0883	.14	Seeger inside spring J 12	057'0151	.72	Spindle
045'0881	.14	Ball bearing Ø 5	057'0292	1.16	Arm lift spindle
057'2401	6.22	Turntable spindle	057'0209	.44	Spindle
071'2548	.14	Felt ring	057'0266	.29	Guide lever pin
073'2449'01	.29	Plastic cap	057'0267	.29	Idler wheel axle
085'2400'01	6.80	Turntable spindle bearing	057'0353	.14	Screw
090'2432	.22	Metal disc	060'0195'01	6.65	Flange complete
090'2454'01	.29	Nylatron plate	060'0231	.72	Special washer
			060'0249	.72	Bushing
090'0334'03	17.79	FRICTION COMPLETE	060'0250	1.45	Arm lever bushing
000'0909	.07	Cylindrical screw M 3 x 8	070'0065	10.48	Turntable rubber mat
025'0942	.07	Hex nut M 3	070'0067	.72	Braking rubber
035'0355	.07	Spring washer	076'0199	.72	Decorative metal disc
060'0137	.14	Distance ring	076'2550	2.02	Stroboscope, 50 Hz
090'0155'01	.29	Cover	077'0029	1.74	Arm
090'0330'02	1.74	Friction lever complete	077'0039	.44	Hinge spring
090'0334'02	5.78	Support complete	077'0058	.29	Torsion spring
000'0018	.07	Cylindrical screw M 2.3 x 5	077'0054	.07	Split pin Ø 1.8 x 15
000'0905	.07	Cylindrical screw M 3 x 4	077'0056	.72	Stop spring
000'0907	.07	Cylindrical screw M 3 x 6	077'2416'05	10.70	Idler wheel complete
000'0911	.07	Cylindrical screw M 3 x 10	080'0017'01	5.71	Spring suspension unit
000'0913	.07	Cylindrical screw M 4 x 8	080'0018'01	5.71	Spring suspension unit
000'1159	.07	Cylindrical screw M 2.6 x 4	080'0027	.29	Tension spring
003'0011	.14	Sunk screw with cross-slit	080'0023	.14	Spring
007'0013	.07	Threaded pin	080'0028	.29	Tension spring
016'0041	.07	Special screw	080'2445	.72	Tension spring
016'0054	.94	Special screw	081'0018	.14	Arm lift pressure spring

PRICES SUBJECT TO CHANGE WITHOUT NOTICE

(Continued on reverse side)

PART NO.	PRICE	DESCRIPTION
081'1613	\$.07	Motor suspension spring
081'2234	.14	Motor suspension spring
081'2446	.14	Motor suspension spring
083'1101	.07	Ring spring size 1
090'0094'01	.14	Right arresting device
090'0095'01	.14	Left arresting device
090'0174'03	6.94	Lever regulating system
090'0181'01	.72	Segment
090'0323'02	2.89	Guide lever
090'0324'01	1.08	Lock lever
090'0325'02	2.75	Switch lever complete
090'0326'02	1.08	Arrest lever
090'0327'01	.77	Tonearm lever
090'0328'01	1.66	Switch rod
090'0329'02	1.52	Stop lever complete
090'0331'02	1.45	Toggle lever complete
050'0230	2.89	Braking lever
090'0350'01	.14	Spring washer
090'2497'01	.14	Guide plate
093'0892	.14	Clip
097'2456'02	.94	Soldering tag strip
110'0024'06	11.28	Micro-switch
121'0031'01	.22	Silicon tubing
121'0032'01	.14	Transport rubber
121'1059'07	.14	Plastic tubing
124'0021'01	.14	Nylatron washer
124'0024'01	.14	Insulating carbon underlay
270'0001'05	62.19	Motor 60 Hz
270'0001'09	57.85	Motor 50 Hz
282'0002'01	28.20	Base plate complete
282'0003'01	47.00	Turntable
288'0140'01	1.52	Antiskating weight 1g
288'0166'01	1.74	Antiskating weight 4g
901'0007'01	6.50	Antiskating complete
288'2508'01	1.88	Mounting parts for plug-in head
287'0004'02	19.52	Spring suspension complete
120'2527'01	4.77	A.C. cable for U.S.A.
120'2850	4.92	Europe A.C. cable
120'2902'01	6.07	PU-cable with diode-plug
120'2881'03	6.36	PU-cable with phone-plug
120'0033'01	1.66	Ground cable
121'0024'02	.14	Tube