

General Exploded View and Parts List

■ Parts List

Item	Part Number	Part Name	Q'ty	Description	Areas
1	EFP-CAMXS3BKE(S)	FRONT PANEL ASSY	1		
1-1	E102614-003SS	FRONT PANEL	1		
1-2	E308156-001	WINDOW SCREEN	1		
1-3	E308158-002SS	INDICATOR	1		
1-4	E69777-003	REFLECTION PLATE	2		
1-5	E406971-221	JVC MARK	2		
2	E207554-002SA	CASSETTE LID ASSY	1	DECK A	
2-1	E207554-002	CASSETTE LID	1	DECK A	
2-2	E406971-221	JVC MARK	1	DECK A	
3	E207557-002	CASSETTE LID ASSY	1	DECK B	
4	E207560-001	CASSETTE HOLDER	1	DECK A	
5	E207561-001	CASSETTE HOLDER	1	DECK B	
6	E407269-002	EJECT SPRING	2		
7	E406713-001	CASSETTE SPRING	4		
8	E75896-002	SPACER	2	FRONT FOOT	
9	SBST3006M	SCREW	4		
10	SBST3008Z	SCREW	3		
11	E102358-332SS	TRAY	1		
12	E207534-002	FITTING	1		
13	SBSF3008M	SCREW	3		
14	E304434-002	DAMPER ASSY	2		
15	E308161-001	EJECT BUTTON	1	DECK B	
16	E308155-002	BALANCE KNOB	2	MIC / BALANCE	
17	E308150-002	VOLUME KNOB ASSY	1		
18	E207550-004	PUSH BUTTON	1		
19	E207552-002	PUSH BUTTON	1		
20	E308148-002	PUSH BUTTON	1	OPEN / CLOSE	
21	E207550-006	PUSH BUTTON	1		
22	E207548-002	PUSH BUTTON	1		
23	E308149-002	PUSH BUTTON	1	TUNING	
24	E308169-002	CIRCUIT BOARD BRACKET	1		
25	SDSF2608Z	SCREW	27		
26	E207536-002	PUSH BUTTON ASSY	1	CD PLAY	
27	EXO010005R10S	SPACER	2		
28	E207539-002SS	PUSH BUTTON	1		A
	E207539-004SS	PUSH BUTTON	1		BS
	E207539-004SS	PUSH BUTTON	1		EF
	E207539-004SS	PUSH BUTTON	1		EN
	E207539-004SS	PUSH BUTTON	1		G
	E207539-004SS	PUSH BUTTON	1		GI
29	E407199-001	INDICATOR	1		
30	E407210-001	REMOCON PLATE	1		
31	E407201-001	INDICATOR	1		
32	E207541-001	PUSH BUTTON ASSY	1	SURROUND	
33	E207543-002	PUSH BUTTON ASSY	1	POWER	
34	E207545-002	PUSH BUTTON ASSY	1	DECK B	
35	E407206-001	INDICATOR	1		
36	E308151-002SS	PUSH BUTTON ASSY	1	DECK A	
37	E407205-001	INDICATOR	2		
38	E308160-001	EJECT BUTTON	1	DECK A	
39	EWR123K-30TT	FLAT WIRE	1		
40	EWR125K-13TT	FLAT WIRE	1		
41	E308168-002	STAY BRACKET	1		
42	E207567-001	HOLDER BRACKET	1		
43	E308162-002	EJECT LEVER	2		

Item	Part Number	Part Name	Q'ty	Description	Areas
44	E407214-001	SPECIAL SCREW	4		
45	GBSF3008Z	SCREW	2		
46	E407304-001	SPRING	2		
47	-----	CASSETTE MECHANISM UNIT ASSY	1	SEE PAGE 2-9	
48	SBST3008C	SCREW	4		
49	SBSF3010C	SCREW	4		
50	E102616-003SS	CHASSIS BASE	1		
51	E75896-006	FELT SPACER	2	REAR FOOT	
52	QHS3876-162	CORD STOPPER	1		A
	QHS3876-162BS	CORD STOPPER	1		BS
	QHS3876-162	CORD STOPPER	1		EF
	QHS3876-162	CORD STOPPER	1		EN
	QHS3876-162	CORD STOPPER	1		G
	QHS3876-162	CORD STOPPER	1		GI
53	E308167-001SS	STAY BRACKET	1		
54	SBSG3008N	SCREW	15		
55	SDSG3006M	SCREW	6		
56	E207564-001	METAL COVER	1		
57	E102617-001	CHASSIS BASE	1		
58	E406507-001	CAUTION LABEL	1		
59	-----	CD MECHANISM UNIT ASSY	1	SEE PAGE 2-7	
60	EWS265-B408	SOCKET WIRE	1	5PIN	
61	SBST3006Z	SCREW	3		
62	EWR615M-14BB	FLAT WIRE	1	15PIN	
63	EWS266-B412	SOCKET WIRE	1	6PIN	
64	E406293-001	SPECIAL SCREW	1		
65	E306837-005	CLAMPER BASE ASSY	1		
65-1	E306836-003	YOKE PLATE	1		
65-2	E74897-002	MAGNET	2		
65-3	E26756-002	CLAMPER BASE	1		
65-4	E306835-001	CLAMPER	1		
66	SBSG3014Z	SCREW	4		
67	E406969-221	LEAF SPRING	1		
68	E307908-001SS	HEAT SINK	1		
69	ETP1070-33EAJ	POWER TRANSFORMER	1		A
	ETP1070-33EAJBS	POWER TRANSFORMER	1		BS
	ETP1070-33EAJ	POWER TRANSFORMER	1		EF
	ETP1070-33EAJ	POWER TRANSFORMER	1		EN
	ETP1070-33EAJ	POWER TRANSFORMER	1		G
	ETP1070-33EAJ	POWER TRANSFORMER	1		GI
70	E65389-004	SPECIAL SCREW	4		
71	QMF51E2-1R25J1	FUSE	2	F101,F102	A
	QMF51E2-1R2J1BS	FUSE	2	F101,F102	BS
	QMF51E2-1R25J1	FUSE	2	F101,F102	EF
	QMF51E2-1R25J1	FUSE	2	F101,F102	EN
	QMF51E2-1R25J1	FUSE	2	F101,F102	G
	QMF51E2-1R25J1	FUSE	2	F101,F102	GI
72	QMF51E2-1R0J1	FUSE	1	F001	A
	QMF51E2-1R0J1BS	FUSE	1	F001	BS
	QMF51E2-1R0J1	FUSE	1	F001	EF
	QMF51E2-1R0J1	FUSE	1	F001	EN
	QMF51E2-1R0J1	FUSE	1	F001	G
	QMF51E2-1R0J1	FUSE	1	F001	GI
73	E207780-001SS	REAR PANEL	1		A
	E207780-002SS	REAR PANEL	1		BS

CD Mechanism Assy and Parts List

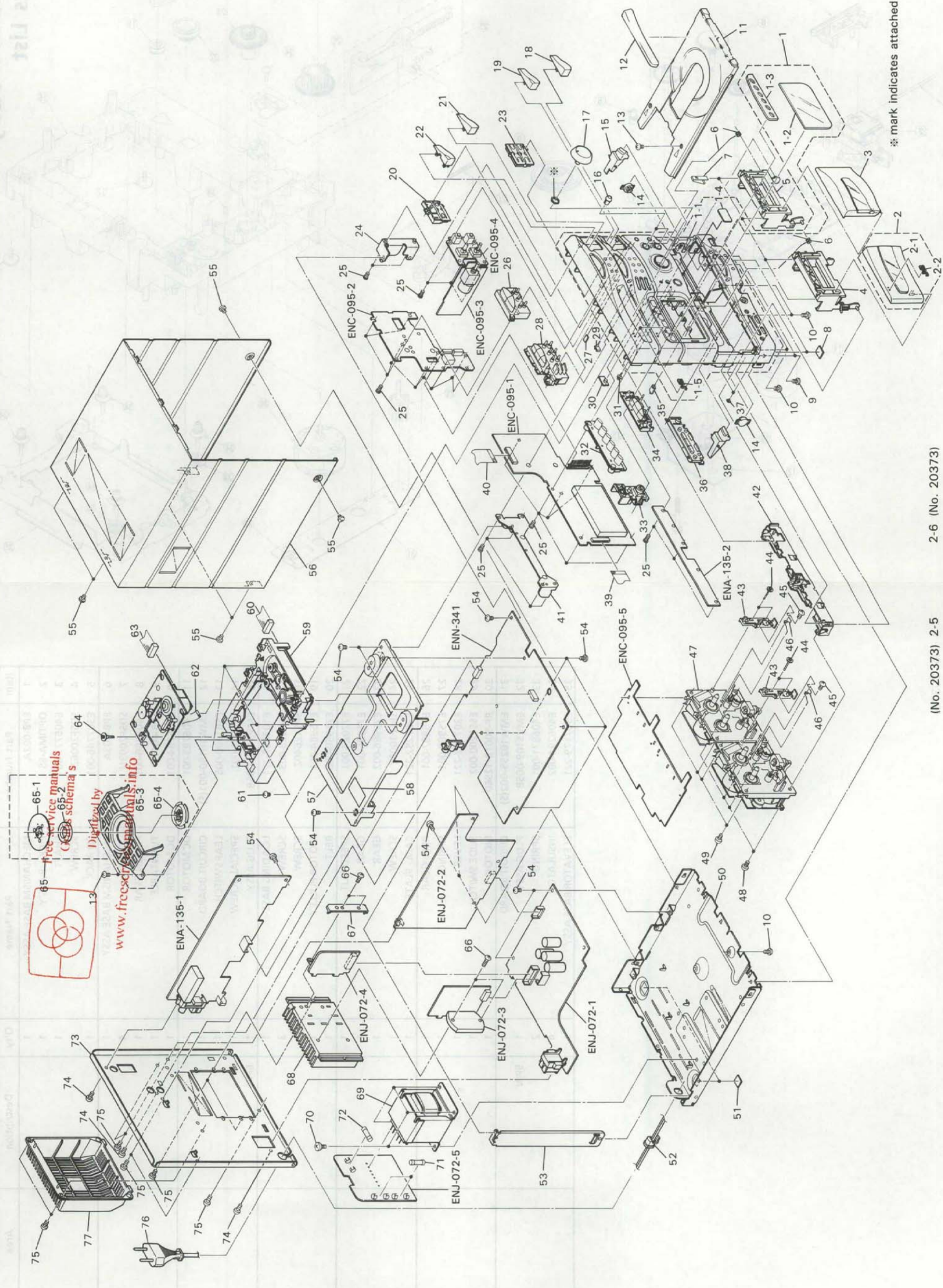

※ mark indicates attached part

CD Mechanism Ass'y and Parts List

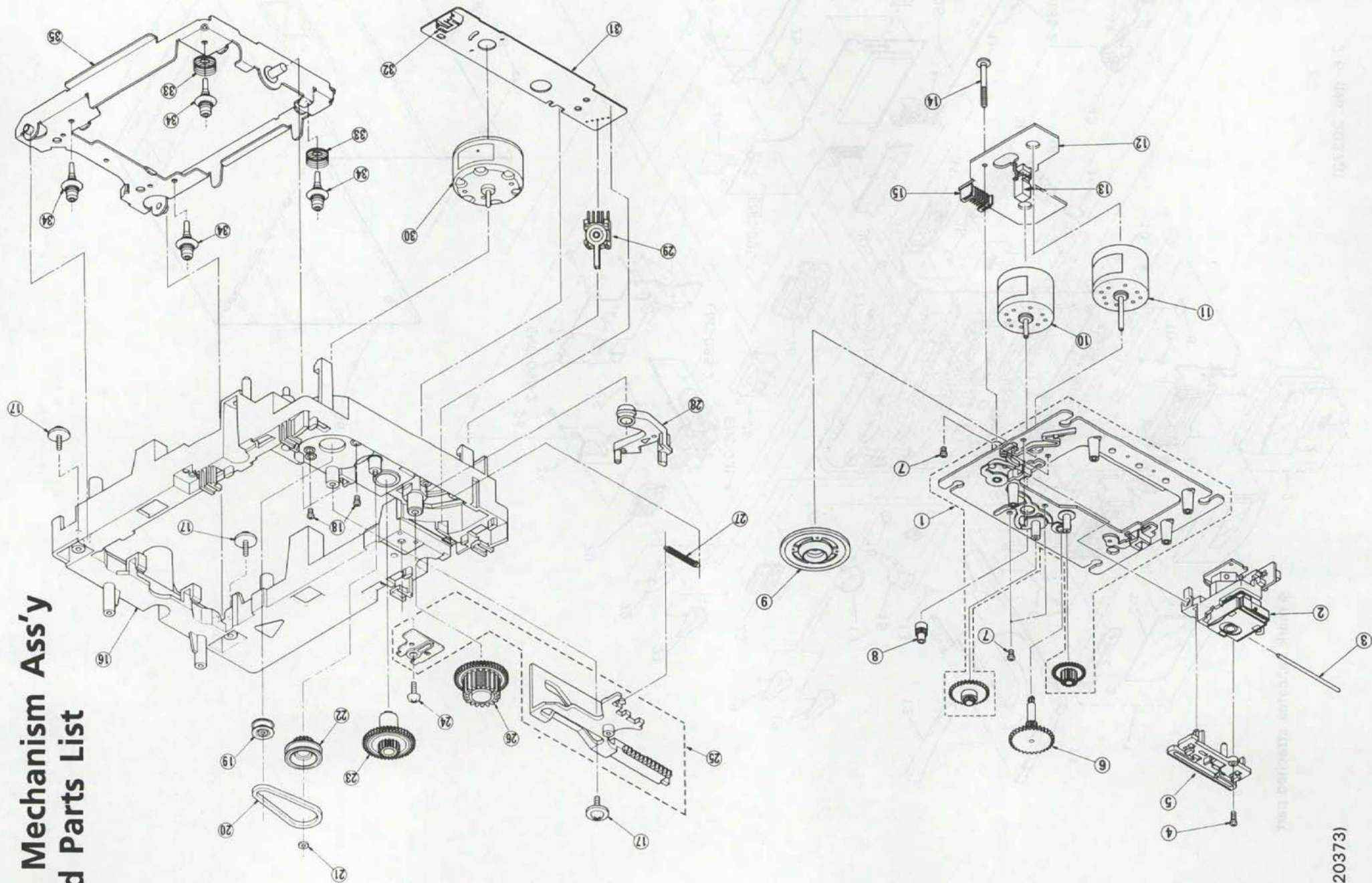

Parts List (CD Mechanism Ass'y)

Item	Part Number	Part Name	Q'ty	Description	Area
1	EPB-002A	MECHANISM BASE ASSY	1		
2	OPTIMA-6S	PICK UP ASS'Y	1		
3	E406777-001	SHAFT	1		
4	SDFS2006Z	SCREW	1		
5	E307746-001	CD RACK	1		
6	EPB-003A	MECHANISM BASE ASSY	1		
7	SDSP2003N	SCREW	4		
8	E406750-001	PINION GEAR	1		
9	EPB-001C	TURNTABLE	1		
10	E406784-001	DC MOTOR	1		
11	E406783-001	DC MOTOR	1		
12	EMW10190-001(S)	CIRCUIT BOARD	1		
13	ESB1100-005	LEAF SWITCH	1		
14	E75832-001	SPECIAL SCREW	1		
15	EMV5109-006B	PLUG ASSY	1	6PIN	
16	E102357-221	LOADING BASE	1		
17	E65923-003	SCREW	3		
18	SPSK2640Z	SCREW	2		
19	E75984-001	MOTOR PULLEY	1		
20	E75950-002	BELT	1		
21	E72024-001	SPEED NUT	1		
22	E75985-001	GEAR	1		
23	E75986-002	GEAR	1		
24	SBSF3008Z	SCREW	1		
25	E307252-221	CAM - PLATE	1		
26	E75987-001	REEL GEAR	1		
27	E75989-001	SPRING	1		
28	E307162-221	LEVER	1		
29	ESS1200-002	SLIDE SWITCH	1		
30	RF-500TB-12560	MOTOR	1		
31	EMW10255-002(S)	CIRCUIT BOARD	1		
32	EMV5109-005B	PLUG ASSY	1	5PIN	
33	E406871-001	SPRING	2		
34	E406294-002	INSULATOR	4		
35	E307179-221	ELEVATOR BASE ASSY	1		

Cassette Mechanism Ass'y and Parts List

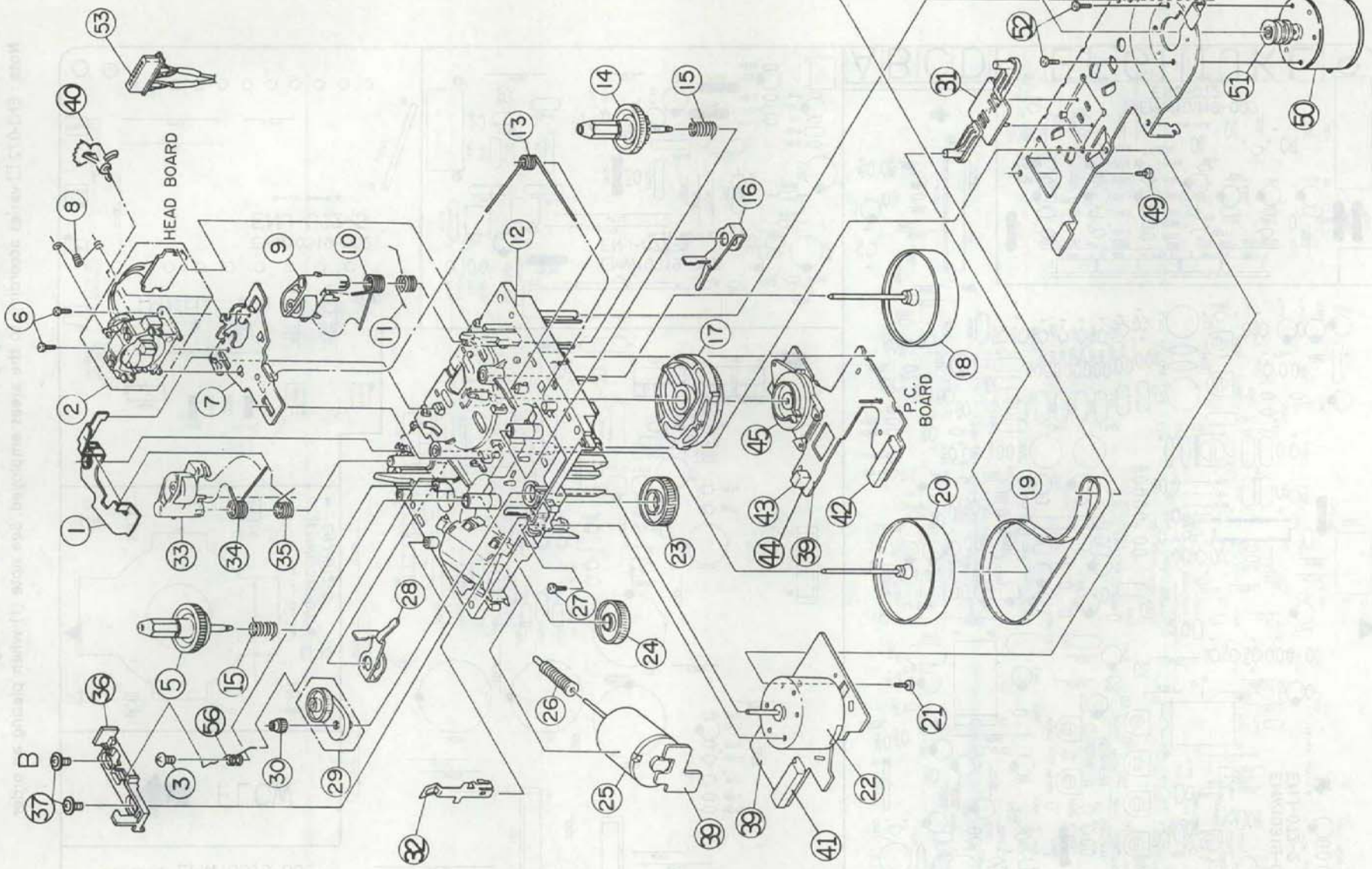

(No. 20373) 2-9

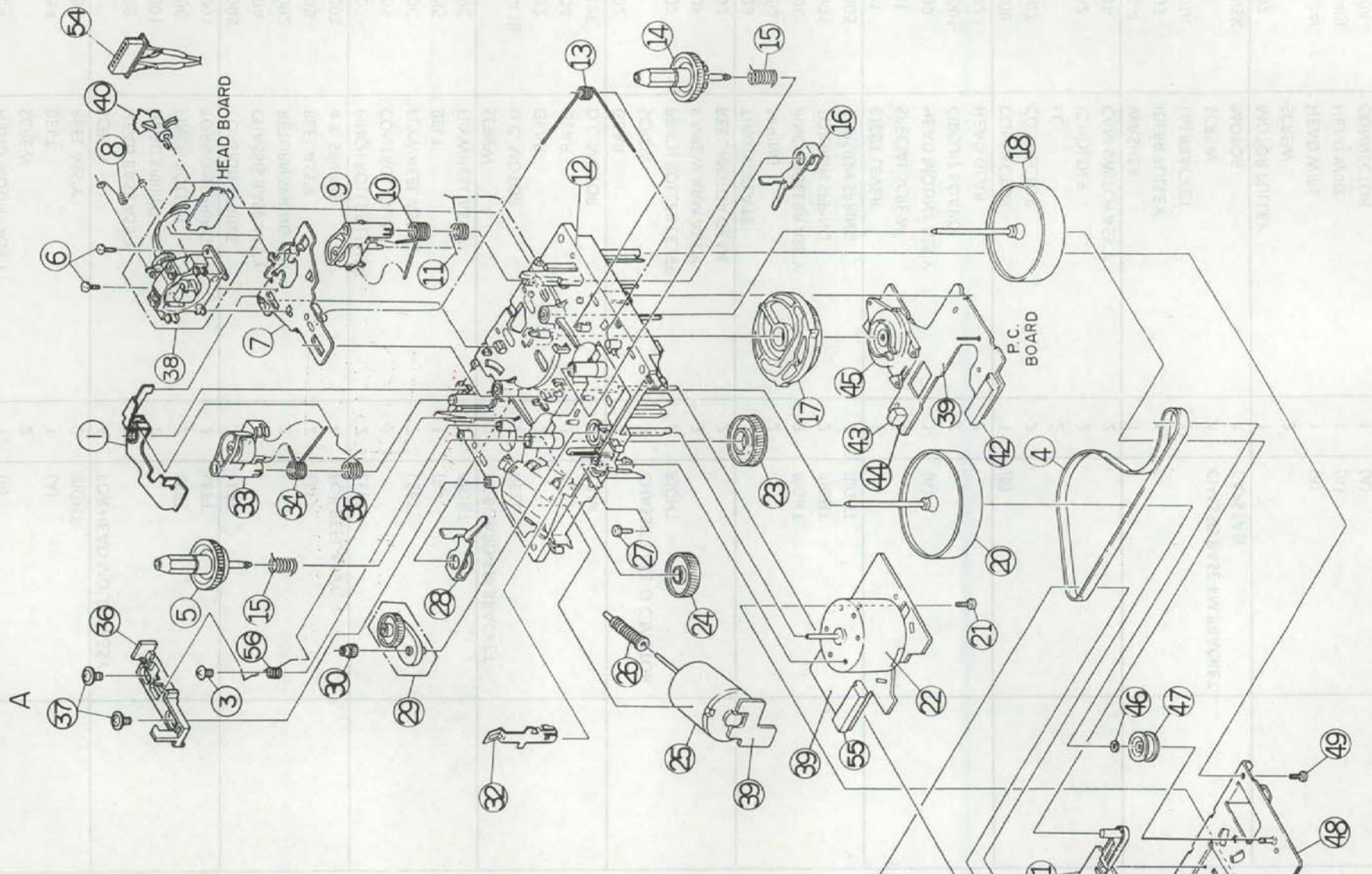

2-10 (No. 20373)

Parts List (Cassette Mechanism Ass'y)

Item	Part Number	Part Name	Q'ty	Description	Area
1	VKL7246-001	EJECT BRACKET	2	(B)	
2	VKS3551-008	HEAD MOUNT ASS'Y	1	(A)	
3	GBSF3008Z	SCREW	2	RIGHT	
4	VKB3001-054	BELT	1	FOR HEAD MOUNT ASSY	
5	VKS5321-00D	REEL ASS'Y	2	LEFT	
6	SDST2004Z	SCREW	4	LEFT	
7	VKL6942-00E	HEAD BASE ASS'Y	2	LEFT	
8	VKW4994-001	HEAD SPRING	2	LEFT	
9	VKP4221-00C	PINCH ROLLER	2	LEFT	
10	VKW4982-001	TORSION SPRING	2	LEFT	
11	VKW4933-005	TORSION SPRING	2	LEFT	
12	VKS1125-00A	CHASSIS BASE ASS'Y	2	LEFT	
13	VKW4930-002	RETURN SPRING	2	LEFT	
14	VKS3480-005	REEL ASS'Y	2	FOR REEL ASSY	
15	VKW4928-003	B.T. SPRING	4	LEFT	
16	VKL6940-002	PINCH ROLLER LEVER	2	LEFT	
17	VKS2209-005	CONTROL CAM	2	LEFT	
18	VKF3186-00C	FLYWHEEL ASS'Y	2	LEFT	
19	VKB3001-055	BELT	1	(B)	
20	VKF3184-00C	FLYWHEEL ASS'Y	2	RIGHT	
21	SDSF2608Z	SCREW	2	PC BOARD-FM BRACKET	
22	MMN-6F4RA38	D.C. MOTOR	2	REEL	
23	VKS5331-002	GEAR	2	CAM	
24	VKS5330-004	GEAR	2	CHASSIS BASE-D.C.MOTOR	
25	MXN-13FB12F	D.C. MOTOR	2	RIGHT	
26	VKS5329-002	GEAR	2	RIGHT	
27	SDSP2605Z	SCREW	2	RIGHT	
28	VKL6939-002	PINCH ROLLER LEVER	2	RIGHT	
29	VKS5325-00F	F.FREW.ARM ASS'Y	2	RIGHT	
30	VKS5328-002	REEL MOTOR GEAR	2	RIGHT	
31	VKS5327-003	THRUST PLATE	2	RIGHT	
32	VKY4628-002	SPRING	2	RIGHT	
33	VKP4219-00C	PINCH ROLLER ASS'Y	2	RIGHT	
34	VKW4981-001	TORSION SPRING	2	RIGHT	
35	VKW4932-005	TORSION SPRING	2	RIGHT	
36	E308162-001	EJECT LEVER	2	(A)	
37	E407214-001	SPECIAL SCREW	4	(B)	
38	VKS3550-008	HEAD MOUNT ASS'Y	1		
39	VMW2362-001	CIRCUIT BOARD	2		
40	VKS3485-002	HEAD GEAR	2		
41	VMC0234-R08	CONNECTOR	1		
42	VMC0234-R07	CONNECTOR	2		
43	DN6851A	I.C.	2		
44	VKS3487-002	IC HOLDER	2		
45	VKS3587-00A	CAM SWITCH ASS'Y	2		
46	WDL163525-4	WASHER	1		
47	VKR4631-003	IDLER PULLEY	1		
48	VKM3618-00A	FM BRACKET	1		
49	SDSF2605Z	SCREW	4	CHASSIS BASE-FM BRACKET	
50	MMI-6H2LWSK	MOTOR	1	CAPSTAN	
51	VKR4632-002	MOTOR PULLEY	1	(B)	
52	SPSP2603Z	SCREW	2	(A)	
53	VDM007P-024I	HEAD WIRE	1	(A)	
54	VDM003P-040I	HEAD WIRE	1	(A)	
55	VMC0234-R04	CONNECTOR	1	(A)	
56	E407304-001	SPRING	2		

Printed Circuit Board Ass'y and Parts List

ENJ-072 Power Supply & Deck PC Board Ass'y

Note : ENJ-072 varies according to the areas employed. See note (1) when placing an order.

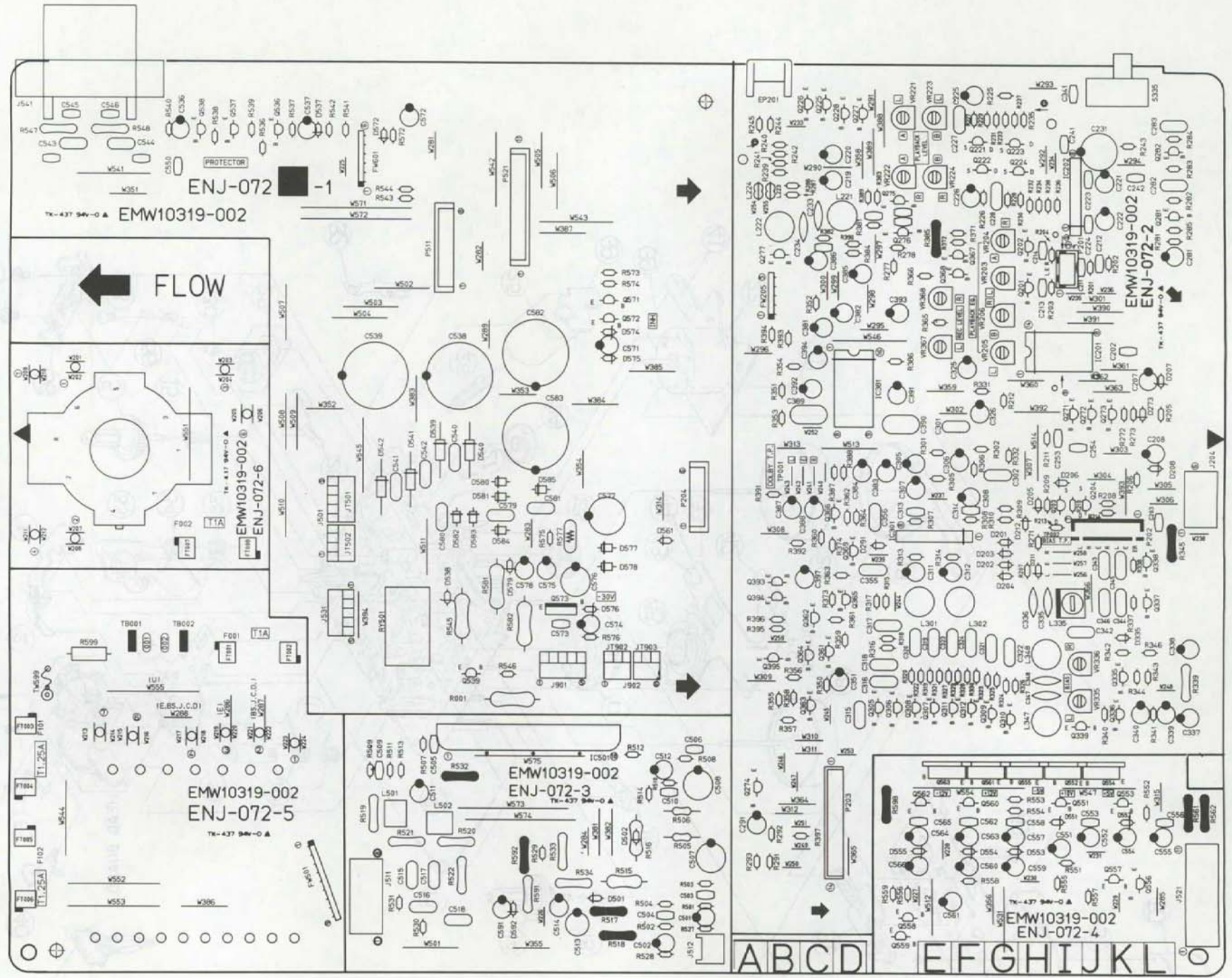

Note (1)

PC Board Ass'y	Designated Areas
ENJ-072 D	Australia
ENJ-072 E	Scandinavia Continental Europe
ENJ-072 F BS	the U.K.
ENJ-072 G	Germany, Italy

TRANSISTORS

ITEM	PART NUMBER	DESCRIPTION	AREA
Q201	DTC144ES	SILICON ROHM	
Q202	DTC144ES	SILICON ROHM	
Q203	2SK373(O,Y)	F.E.T TOSHIBA	
Q204	2SK373(O,Y)	F.E.T TOSHIBA	
Q221	2SK301(Q,R)	F.E.T MATSUSHITA	
Q222	2SK301(Q,R)	F.E.T MATSUSHITA	
Q223	2SK301(Q,R)	F.E.T MATSUSHITA	
Q224	2SK301(Q,R)	F.E.T MATSUSHITA	
Q225	DTC114YS	SILICON ROHM	
Q226	DTC114YS	SILICON ROHM	
Q227	DTC114YS	SILICON ROHM	
Q228	DTC114YS	SILICON ROHM	
Q271	DTC144ES	SILICON ROHM	
Q272	DTA144ES	SILICON ROHM	
Q273	DTA144ES	SILICON ROHM	
Q274	DTC144ES	SILICON ROHM	
Q275	2SD2144S(VW)	SILICON ROHM	
Q276	2SD2144S(VW)	SILICON ROHM	
Q277	DTC144ES	SILICON ROHM	
Q281	2SC1685(Q,R)	SILICON MATSUSHITA	
Q282	2SC1685(Q,R)	SILICON MATSUSHITA	
Q305	DTC144TS	SILICON ROHM	
Q306	DTC144TS	SILICON ROHM	
Q307	DTC144TS	SILICON ROHM	
Q308	DTC144TS	SILICON ROHM	
Q309	DTC144TS	SILICON ROHM	
Q310	DTC144TS	SILICON ROHM	
Q311	DTC144TS	SILICON ROHM	
Q312	DTC144TS	SILICON ROHM	
Q335	2SC945A(P,Q)	SILICON NEC	
Q336	2SC945A(P,Q)	SILICON NEC	
Q337	2SC1685(Q,R)	SILICON MATSUSHITA	
Q338	2SC1685(Q,R)	SILICON MATSUSHITA	
Q339	DTC144ES	SILICON ROHM	
Q361	2SC1685(Q,R)	SILICON MATSUSHITA	
Q362	2SC1685(Q,R)	SILICON MATSUSHITA	
Q363	2SC1685(Q,R)	SILICON MATSUSHITA	
Q364	2SC1685(Q,R)	SILICON MATSUSHITA	
Q365	2SC1685(Q,R)	SILICON MATSUSHITA	
Q366	2SC1685(Q,R)	SILICON MATSUSHITA	
Q367	2SD2144S(VW)	SILICON ROHM	
Q368	2SD2144S(VW)	SILICON ROHM	
Q369	DTC144ES	SILICON ROHM	
Q393	2SD2144S(VW)	SILICON ROHM	
Q394	2SD2144S(VW)	SILICON ROHM	
Q395	DTA144ES	SILICON ROHM	
Q536	2SC1685(Q,R)	SILICON MATSUSHITA	
Q537	2SC1685(Q,R)	SILICON MATSUSHITA	
Q538	2SA933S(R,S)	SILICON ROHM	
Q539	2SC1685(Q,R)	SILICON MATSUSHITA	
Q551	2SC1685(Q,R)	SILICON MATSUSHITA	
Q552	2SD2061(F,G)	SILICON ROHM	
Q553	2SC1685(Q,R)	SILICON MATSUSHITA	
Q554	2SD2061(F,G)	SILICON ROHM	
Q555	2SB1187(F,G)	SILICON ROHM	
Q556	DTC144ES	SILICON ROHM	
Q557	DTA144ES	SILICON ROHM	
Q558	DTA144ES	SILICON ROHM	
Q559	DTC144ES	SILICON ROHM	
Q560	2SC1685(Q,R)	SILICON MATSUSHITA	
Q561	2SD2061(F,G)	SILICON ROHM	
Q562	2SA733A(P,Q)	SILICON NEC	
Q563	2SB1187(F,G)	SILICON ROHM	
Q571	DTC114YS	SILICON ROHM	
Q572	DTC143ZS	SILICON ROHM	
Q573	2SB1357(E,F)	SILICON ROHM	

I. C. S.

ITEM	PART NUMBER	DESCRIPTION	AREA
IC201	BU4066B	I.C. ROHM	
IC202	UPC1228HA	I.C. NEC	
IC301	BA15218N	I.C. ROHM	
IC381	HA12136AT	I.C. HITACHI	
IC501	STK4141MK5	I.C. SANYO	

△ SAFETY PARTS

DIODES

ITEM	PART NUMBER	DESCRIPTION	AREA
D201	1SS119	SILICON HITACHI	
D202	1SS119	SILICON HITACHI	
D203	1SS119	SILICON HITACHI	
D204	1SS119	SILICON HITACHI	
D205	1SS119	SILICON HITACHI	
D206	1SS119	SILICON HITACHI	
D207	MTZ5.6JC	ZENER ROHM	
D208	MTZ5.6JC	ZENER ROHM	
D211	1SS119	SILICON HITACHI	
D212	1SS119	SILICON HITACHI	
D273	1SS119	SILICON HITACHI	
D291	1SS119	SILICON HITACHI	
D335	1SS119	SILICON HITACHI	
D501	1SS119	SILICON HITACHI	
D502	1SS119	SILICON HITACHI	
D537	1SS119	SILICON HITACHI	
D538	MTZ24JC	ZENER ROHM	
D539	ERB12-02RKL1	SILICON KYOUDOU	
D540	ERB12-02RKL1	SILICON KYOUDOU	
D541	ERB12-02RKL1	SILICON KYOUDOU	
D542	ERB12-02RKL1	SILICON KYOUDOU	
D551	MTZ11JC	ZENER ROHM	
D552	MTZ6.8JC	ZENER ROHM	
D553	MTZ5.6JC	ZENER ROHM	
D554	MTZ13JC	ZENER ROHM	
D555	MTZ13JC	ZENER ROHM	
D561	1SS119	SILICON HITACHI	
D572	1SS119	SILICON HITACHI	
D574	MTZ5.1JC	ZENER ROHM	
D575	1SS119	SILICON HITACHI	
D576	MTZ30JC	ZENER ROHM	
D577	1SR139-200	SILICON ROHM	
D578	1SR139-200	SILICON ROHM	
D579	MTZ5.1JC	ZENER ROHM	
D580	1SR139-200	SILICON ROHM	
D581	1SR139-200	SILICON ROHM	
D582	1SR139-200	SILICON ROHM	
D583	1SR139-200	SILICON ROHM	
D584	1SR139-200	SILICON ROHM	
D585	1SR139-200	SILICON ROHM	
D592	1SS119	SILICON HITACHI	

CAPACITORS

ITEM	PART NUMBER	DESCRIPTION	AREA
C202	QCHB1EZ-223	0.022MF 25V CERAMIC	G
C203	QCHB1EZ-223	0.022MF 25V CERAMIC	G
C207	QETB1AM-476	47MF 10V ELECTRO	
C208	QETB1AM-476	47MF 10V ELECTRO	
C211	QCB1HK-471	470PF 50V CERAMIC	
C212	QCB1HK-471	470PF 50V CERAMIC	
C213	QCXB1CM-122	1200PF 16V CERAMIC	
C214	QCXB1CM-122	1200PF 16V CERAMIC	
C219	QETB1HM-225	2.2MF 50V ELECTRO	
C220	QETB1HM-225	2.2MF 50V ELECTRO	
C221	QETB1HM-225	2.2MF 50V ELECTRO	
C222	QETB1HM-225	2.2MF 50V ELECTRO	
C223	QCB1HK-101	100PF 50V CERAMIC	
C224	QCB1HK-101	100PF 50V CERAMIC	
C225	QEK51CM-107	100MF 16V ELECTRO	
C226	QEK51CM-107	100MF 16V ELECTRO	
C227	QFLB1HJ-822	8200PF 50V MYLAR	
C228	QFLB1HJ-822	8200PF 50V MYLAR	
C231	QETB1CM-477	470MF 16V ELECTRO	
C233	QCS21HJ-101	100PF 50V CERAMIC	
C234	QCS21HJ-101	100PF 50V CERAMIC	
C241	QCHB1EZ-223	0.022MF 25V CERAMIC	D
C241	QCHB1EZ-223	0.022MF 25V CERAMIC	E
C241	QCHB1EZ-223	0.022MF 25V CERAMIC	FBS
C242	QCHB1EZ-223	0.022MF 25V CERAMIC	D
C242	QCHB1EZ-223	0.022MF 25V CERAMIC	E
C242	QCHB1EZ-223	0.022MF 25V CERAMIC	FBS
C253	QCXB1CM-182	1800PF 16V CERAMIC	
C254	QCXB1CM-182	1800PF 16V CERAMIC	
C281	QEK51HM-105G	1MF 50V ELECTRO	
C282	QFLB1HJ-223	0.022MF 50V MYLAR	
C283	QFLB1HJ-223	0.022MF 50V MYLAR	
C291	QETB1AM-476	47MF 10V ELECTRO	
C301	QFLB1HJ-104	0.1MF 50V MYLAR	
C302	QFLB1HJ-104	0.1MF 50V MYLAR	
C305	QETB1HM-225	2.2MF 50V ELECTRO	
C306	QETB1HM-225	2.2MF 50V ELECTRO	
C307	QETB1HM-225	2.2MF 50V ELECTRO	
C308	QETB1HM-225	2.2MF 50V ELECTRO	
C311	QETB1EM-226	22MF 25V ELECTRO	
C312	QETB1EM-226	22MF 25V ELECTRO	
C313	QCSB1HJ-470	47PF 50V CERAMIC	
C314	QCSB1HJ-470	47PF 50V CERAMIC	
C315	QFLB1HJ-682	6800PF 50V MYLAR	
C316	QFLB1HJ-682	6800PF 50V MYLAR	

△ SAFETY PARTS

CAPACITORS

Δ	ITEM	PART NUMBER	DESCRIPTION			AREA
	C317	QFLB1HJ-562	5600PF	50V	MYLAR	
	C318	QFLB1HJ-562	5600PF	50V	MYLAR	
	C319	QFLB1HJ-822	8200PF	50V	MYLAR	
	C320	QFLB1HJ-822	8200PF	50V	MYLAR	
	C321	QFLB1HJ-122	1200PF	50V	MYLAR	
	C322	QFLB1HJ-122	1200PF	50V	MYLAR	
	C323	QFLB1HJ-682	6800PF	50V	MYLAR	
	C324	QFLB1HJ-682	6800PF	50V	MYLAR	
	C325	QETB1CM-107	100MF	16V	ELECTRO	
	C326	QETB1CM-107	100MF	16V	ELECTRO	
	C335	QCS21HJ-101	100PF	50V	CERAMIC	
	C336	QCS21HJ-101	100PF	50V	CERAMIC	
	C337	QEK51EM-106	10MF	25V	ELECTRO	
	C338	QEK51EM-476	47MF	25V	ELECTRO	
	C339	QEK51HM-105G	1MF	50V	ELECTRO	
	C340	QETB1HM-105	1MF	50V	ELECTRO	
	C341	QCB1HK-561	560PF	50V	CERAMIC	
	C342	QFP81HJ-822	8200PF	50V	POLY	
	C343	QFLB1HJ-123	0.012MF	50V	MYLAR	
	C344	QFLB1HJ-222	2200PF	50V	MYLAR	
	C345	QFLB1HJ-222	2200PF	50V	MYLAR	
	C346	QFLB1HJ-682	6800PF	50V	MYLAR	
	C347	QCS21HJ-101	100PF	50V	CERAMIC	
	C348	QCS21HJ-101	100PF	50V	CERAMIC	
	C351	QETB1HM-106	10MF	50V	ELECTRO	
	C355	QFLB1HJ-473	0.047MF	50V	MYLAR	
	C356	QFLB1HJ-473	0.047MF	50V	MYLAR	
	C381	QETB1HM-105	1MF	50V	ELECTRO	
	C382	QETB1HM-105	1MF	50V	ELECTRO	
	C383	QETB1HM-475	4.7MF	50V	ELECTRO	
	C384	QETB1HM-475	4.7MF	50V	ELECTRO	
	C385	QETB1HM-105	1MF	50V	ELECTRO	
	C386	QETB1HM-105	1MF	50V	ELECTRO	
	C387	QETB1HM-475	4.7MF	50V	ELECTRO	
	C388	QETB1HM-475	4.7MF	50V	ELECTRO	
	C389	QFV81HJ-224	0.22MF	50V	T.FILM	
	C390	QFV81HJ-224	0.22MF	50V	T.FILM	
	C391	QETB1HM-475	4.7MF	50V	ELECTRO	
	C392	QETB1HM-475	4.7MF	50V	ELECTRO	
	C393	QETB1CM-107	100MF	16V	ELECTRO	
	C394	QETB1HM-475	4.7MF	50V	ELECTRO	
	C397	QETB1EM-226	22MF	25V	ELECTRO	
	C501	EEZ5009-106	10MF		ELECTRO	
	C502	EEZ5009-106	10MF		ELECTRO	
	C503	QCB1HK-471	470PF	50V	CERAMIC	D
	C503	QCB1HK-471	470PF	50V	CERAMIC	E
	C503	QCB1HK-471	470PF	50V	CERAMIC	FBS
	C504	QCB1HK-471	470PF	50V	CERAMIC	D
	C504	QCB1HK-471	470PF	50V	CERAMIC	E
	C504	QCB1HK-471	470PF	50V	CERAMIC	FBS
	C505	QCB1HK-221	220PF	50V	CERAMIC	
	C506	QCB1HK-221	220PF	50V	CERAMIC	
	C507	QETB1EM-107	100MF	25V	ELECTRO	
	C508	QETB1EM-107	100MF	25V	ELECTRO	
	C509	QCSB1HJ-100	10PF	50V	CERAMIC	
	C510	QCSB1HJ-100	10PF	50V	CERAMIC	
	C511	QETB1HM-226	22MF	50V	ELECTRO	
	C512	QETB1HM-226	22MF	50V	ELECTRO	
	C513	QETB1HM-476	47MF	50V	ELECTRO	
	C514	QETB1HM-106	10MF	50V	ELECTRO	
	C515	QFLB1HJ-104	0.1MF	50V	MYLAR	
	C516	QFLB1HJ-104	0.1MF	50V	MYLAR	
	C517	QFLB1HJ-104	0.1MF	50V	MYLAR	
	C518	QFLB1HJ-104	0.1MF	50V	MYLAR	
	C536	QETB1CM-476	47MF	16V	ELECTRO	
	C537	QETB1EM-226	22MF	25V	ELECTRO	
	C538	EET4202-228E	2200MF		ELECTRO	
	C539	EET4202-228E	2200MF		ELECTRO	
	C540	QFLB2AJ-103	0.01MF	100V	MYLAR	D
	C540	QFLB2AJ-103	0.01MF	100V	MYLAR	E
	C540	QFLB2AJ-103	0.01MF	100V	MYLAR	FBS
	C540	QFV82AJ-104	0.1MF	100V	T.FILM	G
	C541	QFLB2AJ-103	0.01MF	100V	MYLAR	D
	C541	QFLB2AJ-103	0.01MF	100V	MYLAR	E
	C541	QFLB2AJ-103	0.01MF	100V	MYLAR	FBS
	C541	QFV82AJ-104	0.1MF	100V	T.FILM	G
	C542	QFLB2AJ-103	0.01MF	100V	MYLAR	D
	C542	QFLB2AJ-103	0.01MF	100V	MYLAR	E
	C542	QFLB2AJ-103	0.01MF	100V	MYLAR	FBS
	C542	QFV82AJ-104	0.1MF	100V	T.FILM	G
	C543	QFLB1HJ-103	0.01MF	50V	MYLAR	G
	C544	QFLB1HJ-103	0.01MF	50V	MYLAR	G
	C545	QCXB1CM-222	2200PF	16V	CERAMIC	G
	C546	QCXB1CM-222	2200PF	16V	CERAMIC	G
	C547	QCF21HP-223	0.022MF	50V	CERAMIC	G
	C548	QCF21HP-223	0.022MF	50V	CERAMIC	G
	C550	QCVB1CM-103	0.01MF	16V	CERAMIC	
	C551	QETB1EM-226	22MF	25V	ELECTRO	
	C552	QETB1CM-476	47MF	16V	ELECTRO	
	C553	QCVB1CM-103	0.01MF	16V	CERAMIC	
	C554	QETB1AM-476	47MF	10V	ELECTRO	
	C555	QETB1AM-476	47MF	10V	ELECTRO	
	C556	QCVB1CM-103	0.01MF	16V	CERAMIC	
	C557	QETB1EM-226	22MF	25V	ELECTRO	
	C558	QCVB1CM-103	0.01MF	16V	CERAMIC	

Δ SAFETY PARTS

CAPACITORS

Δ	ITEM	PART NUMBER	DESCRIPTION			AREA
	C559	QETB1CM-476	47MF	16V	ELECTRO	
	C560	QETB1HM-106	10MF	50V	ELECTRO	
	C561	QETB1HM-106	10MF	50V	ELECTRO	
	C562	QCVB1CM-103	0.01MF	16V	CERAMIC	
	C563	QETB1HM-106	10MF	50V	ELECTRO	
	C564	QETB1EM-226	22MF	25V	ELECTRO	
	C565	QCVB1CM-103	0.01MF	16V	CERAMIC	
	C566	QETB1EM-226	22MF	25V	ELECTRO	
	C571	QETB1HM-225	2.2MF	50V	ELECTRO	
	C572	QETB1HM-106	10MF	50V	ELECTRO	
	C573	QCVB1HK-102	1000PF	50V	CERAMIC	
	C574	QETB1HM-226	22MF	50V	ELECTRO	
	C575	QETB1HM-226	22MF	50V	ELECTRO	
	C576	QETB1JM-476	47MF	63V	ELECTRO	
	C577	QETB1JM-107	100MF	63V	ELECTRO	
	C578	QETB1HM-475	4.7MF	50V	ELECTRO	
	C579	QFLB2AJ-103	0.01MF	100V	MYLAR	
	C580	QFLB2AJ-103	0.01MF	100V	MYLAR	
	C581	QFLB2AJ-103	0.01MF	100V	MYLAR	
	C582	EET3501-228T	2200MF		ELECTRO	
	C583	EET3501-228T	2200MF		ELECTRO	
	C591	QETB1HM-106	10MF	50V	ELECTRO	

RESISTORS

Δ	ITEM	PART NUMBER	DESCRIPTION			AREA
	R201	QRD167J-224	220K	1/6W	CARBON	
	R202	QRD167J-224	220K	1/6W	CARBON	
	R203	QRD167J-512	5.1K	1/6W	CARBON	
	R204	QRD167J-512	5.1K	1/6W	CARBON	
	R205	QRD167J-471	470	1/6W	CARBON	
	R206	QRD167J-471	470	1/6W	CARBON	
	R207	QRD167J-100	10	1/6W	CARBON	
	R208	QRD167J-100	10	1/6W	CARBON	
	R209	QRD167J-105	1M	1/6W	CARBON	
	R210	QRD167J-105	1M	1/6W	CARBON	
	R211	QRD167J-512	5.1K	1/6W	CARBON	
	R212	QRD167J-512	5.1K	1/6W	CARBON	
	R213	QRD167J-475	4.7M	1/6W	CARBON	
	R214	QRD167J-475	4.7M	1/6W	CARBON	
	R225	QRD167J-470	47	1/6W	CARBON	
	R226	QRD167J-470	47	1/6W	CARBON	
	R227	QRD167J-334	330K	1/6W	CARBON	
	R228	QRD167J-334	330K	1/6W	CARBON	
	R229	QRD167J-432	4.3K	1/6W	CARBON	
	R230	QRD167J-432	4.3K	1/6W	CARBON	
	R231	QRD167J-272	2.7K	1/6W	CARBON	
	R232	QRD167J-272	2.7K	1/6W	CARBON	
	R233	QRD167J-272	2.7K	1/6W	CARBON	
	R234	QRD167J-272	2.7K	1/6W	CARBON	
	R235	QRD167J-223	22K	1/6W	CARBON	
	R236	QRD167J-223	22K	1/6W	CARBON	
	R237	QRD167J-752	7.5K	1/6W	CARBON	
	R238	QRD167J-752	7.5K	1/6W	CARBON	
	R239	QRD167J-105	1M	1/6W	CARBON	
	R240	QRD167J-105	1M	1/6W	CARBON	
	R241	QRD167J-105	1M	1/6W	CARBON	
	R242	QRD167J-105	1M	1/6W	CARBON	
	R243	QRD167J-471	470	1/6W	CARBON	
	R244	QRD167J-472	4.7K	1/6W	CARBON	
	R245	QRD167J-472	4.7K	1/6W	CARBON	
	R271	QRD167J-103	10K	1/6W	CARBON	
	R272	QRD167J-472	4.7K	1/6W	CARBON	
	R273	QRD167J-472	4.7K	1/6W	CARBON	
	R277	QRD167J-103	10K	1/6W	CARBON	
	R278	QRD167J-103	10K	1/6W	CARBON	
	R281	QRD167J-104	100K	1/6W	CARBON	
	R282	QRD167J-105	1M	1/6W	CARBON	
	R283	QRD167J-103	10K	1/6W	CARBON	
	R284	QRD167J-105	1M	1/6W	CARBON	
	R285	QRD167J-683	68K	1/6W	CARBON	
	R286	QRD167J-104	100K	1/6W	CARBON	
	R287	QRD167J-104	100K	1/6W	CARBON	
	R291	QRD167J-104	100K	1/6W	CARBON	
	R292	QRD167J-274	270K	1/6W	CARBON	
	R293	QRD167J-562	5.6K	1/6W	CARBON	
	R301	QRD167J-223	22K	1/6W	CARBON	
	R302	QRD167J-223	22K	1/6W	CARBON	
	R305	QRD167J-683	68K	1/6W	CARBON	
	R306	QRD167J-683	68K	1/6W	CARBON	
	R307	QRD167J-153	15K	1/6W	CARBON	
	R308	QRD167J-153	15K	1/6W	CARBON	
	R309	QRD167J-223	22K	1/6W	CARBON	
	R310	QRD167J-223	22K	1/6W	CARBON	
	R313	QRD167J-242	2.4K	1/6W	CARBON	
	R314	QRD167J-242	2.4K	1/6W	CARBON	
	R315	QRD167J-101	100	1/6W	CARBON	
	R316	QRD167J-101	100	1/6W	CARBON	
	R317	QRD167J-391	390	1/6W	CARBON	
	R318	QRD167J-391	390	1/6W	CARBON	
	R319	QRD167J-152	1.5K	1/6W	CARBON	

Δ SAFETY PARTS

RESISTORS

Δ	ITEM	PART NUMBER	DESCRIPTION			AREA
	R320	QRD167J-152	1.5K	1/6W	CARBON	
	R321	QRD167J-432	4.3K	1/6W	CARBON	
	R322	QRD167J-432	4.3K	1/6W	CARBON	
	R323	QRD167J-152	1.5K	1/6W	CARBON	
	R324	QRD167J-152	1.5K	1/6W	CARBON	
	R325	QRD167J-104	100K	1/6W	CARBON	
	R326	QRD167J-104	100K	1/6W	CARBON	
	R327	QRD167J-152	1.5K	1/6W	CARBON	
	R328	QRD167J-152	1.5K	1/6W	CARBON	
	R329	QRD167J-392	3.9K	1/6W	CARBON	
	R330	QRD167J-392	3.9K	1/6W	CARBON	
	R331	QRD161J-221	220	1/6W	CARBON	
	R332	QRD161J-221	220	1/6W	CARBON	
	R337	QRD167J-473	4.7K	1/6W	CARBON	
	R338	QRD167J-473	4.7K	1/6W	CARBON	
Δ	R339	QRD14CJ-5R6S	5.6	1/4W	UNF. CARBON	
	R340	QRD167J-472	4.7K	1/6W	CARBON	
	R341	QRD167J-104	100K	1/6W	CARBON	
	R342	QRD167J-332	3.3K	1/6W	CARBON	
	R343	QRD167J-181	180	1/6W	CARBON	
	R344	QRD167J-201	200	1/6W	CARBON	
Δ	R345	QRZ0077-100	10	1/4W	FUSIBLE	
	R346	QRD167J-103	10K	1/6W	CARBON	
	R350	QRD167J-105	1M	1/6W	CARBON	
	R351	QRD167J-243	24K	1/6W	CARBON	
	R352	QRD167J-243	24K	1/6W	CARBON	
	R353	QRD167J-302	3K	1/6W	CARBON	
	R354	QRD167J-302	3K	1/6W	CARBON	
	R355	QRD167J-561	560	1/6W	CARBON	
	R356	QRD167J-561	560	1/6W	CARBON	
	R357	QRD167J-223	22K	1/6W	CARBON	
	R358	QRD167J-223	22K	1/6W	CARBON	
	R359	QRD167J-332	3.3K	1/6W	CARBON	
	R360	QRD167J-332	3.3K	1/6W	CARBON	
	R361	QRD167J-473	4.7K	1/6W	CARBON	
	R362	QRD167J-473	4.7K	1/6W	CARBON	
	R363	QRD167J-223	22K	1/6W	CARBON	
	R364	QRD167J-223	22K	1/6W	CARBON	
	R365	QRD167J-472	4.7K	1/6W	CARBON	
	R366	QRD167J-472	4.7K	1/6W	CARBON	
	R371	QRD167J-103	10K	1/6W	CARBON	
	R372	QRD167J-103	10K	1/6W	CARBON	
	R373	QRD167J-684	680K	1/6W	CARBON	
	R374	QRD167J-684	680K	1/6W	CARBON	
	R381	QRD167J-153	15K	1/6W	CARBON	
	R382	QRD167J-153	15K	1/6W	CARBON	
	R383	QRD167J-822	8.2K	1/6W	CARBON	
	R384	QRD167J-822	8.2K	1/6W	CARBON	
Δ	R385	QRZ0077-220	22	1/4W	FUSIBLE	
	R386	QRD167J-183	18K	1/6W	CARBON	
	R387	QRD167J-103	10K	1/6W	CARBON	
	R388	QRD167J-103	10K	1/6W	CARBON	
	R389	QRD167J-562	5.6K	1/6W	CARBON	
	R390	QRD167J-562	5.6K	1/6W	CARBON	
	R391	QRD167J-822	8.2K	1/6W	CARBON	
	R392	QRD167J-822	8.2K	1/6W	CARBON	
	R393	QRD167J-103	10K	1/6W	CARBON	
	R394	QRD167J-103	10K	1/6W	CARBON	
	R395	QRD167J-103	10K	1/6W	CARBON	
	R396	QRD167J-103	10K	1/6W	CARBON	
	R397	QRD167J-102	1K	1/6W	CARBON	
	R501	QRD167J-102	1K	1/6W	CARBON	
	R502	QRD167J-102	1K	1/6W	CARBON	
	R503	QRD167J-104	100K	1/6W	CARBON	
	R504	QRD167J-104	100K	1/6W	CARBON	
	R505	ERD141J-471S	470	1/4W	CARBON	
	R506	ERD141J-471S	470	1/4W	CARBON	
	R507	QRD167J-471	470	1/6W	CARBON	
	R508	QRD167J-471	470	1/6W	CARBON	
	R509	QRD167J-104	100K	1/6W	CARBON	
	R510	QRD167J-104	100K	1/6W	CARBON	
	R511	QRD167J-242	2.4K	1/6W	CARBON	
	R512	QRD167J-242	2.4K	1/6W	CARBON	
	R513	QRD167J-242	2.4K	1/6W	CARBON	
	R514	QRD167J-242	2.4K	1/6W	CARBON	
Δ	R515	QRX012J-R22AM	0.22	1W	M. FILM	
Δ	R516	QRX012J-R22AM	0.22	1W	M. FILM	
Δ	R517	QRZ0077-101	100	1/4W	FUSIBLE	
Δ	R518	QRZ0077-100	10	1/4W	FUSIBLE	
Δ	R519	QRD14CJ-100S	10	1/4W	UNF. CARBON	
Δ	R520	QRD14CJ-100S	10	1/4W	UNF. CARBON	
Δ	R521	QRD14CJ-100S	10	1/4W	UNF. CARBON	
Δ	R522	QRD14CJ-100S	10	1/4W	UNF. CARBON	
	R527	QRD167J-104	100K	1/6W	CARBON	
	R528	QRD167J-104	100K	1/6W	CARBON	
	R529	QRD167J-103	10K	1/6W	CARBON	
	R530	QRD167J-154	150K	1/6W	CARBON	
	R531	QRD167J-473	4.7K	1/6W	CARBON	
Δ	R532	QRZ0077-100	10	1/4W	FUSIBLE	
Δ	R533	QRD14CJ-222S	2.2K	1/4W	UNF. CARBON	
Δ	R534	QRD14CJ-222S	2.2K	1/4W	UNF. CARBON	
	R536	QRD167J-472	4.7K	1/6W	CARBON	
	R537	QRD167J-104	100K	1/6W	CARBON	
	R538	QRD167J-104	100K	1/6W	CARBON	
	R539	QRD167J-103	10K	1/6W	CARBON	

Δ SAFETY PARTS

RESISTORS

Δ	ITEM	PART NUMBER	DESCRIPTION			AREA
	R540	QRD167J-104	100K	1/6W	CARBON	
	R541	QRD167J-103	10K	1/6W	CARBON	
	R542	QRD167J-222	2.2K	1/6W	CARBON	
	R543	QRD167J-823	82K	1/6W	CARBON	
	R544	QRD167J-104	100K	1/6W	CARBON	
Δ	R545	QRG022J-391AM	390	2W	O.M. FILM	
	R546	QRD167J-152	1.5K	1/6W	CARBON	
Δ	R547	QRD14CJ-100S	10	1/4W	UNF. CARBON	G
Δ	R548	QRD14CJ-100S	10	1/4W	UNF. CARBON	G
	R551	QRD167J-332	3.3K	1/6W	CARBON	
	R552	QRD167J-392	3.9K	1/6W	CARBON	
	R553	QRD167J-472	4.7K	1/6W	CARBON	
	R554	QRD167J-472	4.7K	1/6W	CARBON	
	R555	QRD167J-472	4.7K	1/6W	CARBON	
	R556	QRD167J-153	15K	1/6W	CARBON	
	R557	QRD167J-103	10K	1/6W	CARBON	
	R558	QRD167J-332	3.3K	1/6W	CARBON	
	R559	QRD167J-222	2.2K	1/6W	CARBON	
Δ	R561	QRZ0077-8R2	8.2	1/4W	FUSIBLE	
Δ	R562	QRZ0077-8R2	8.2	1/4W	FUSIBLE	
	R572	QRD167J-103	10K	1/6W	CARBON	
	R573	QRD167J-102	1K	1/6W	CARBON	
	R574	QRD167J-103	10K	1/6W	CARBON	
	R575	QRD167J-103	10K	1/6W	CARBON	
	R576	QRD167J-562	5.6K	1/6W	CARBON	
Δ	R577	PTH61G25AR4R7M			FUSIBLE	
Δ	R581	QRX022J-2R2AM	2.2	2W	M. FILM	
Δ	R582	QRX022J-2R2AM	2.2	2W	M. FILM	
Δ	R591	QRD14CJ-222S	2.2K	1/4W	UNF. CARBON	
Δ	R592	QRZ0077-100	10	1/4W	FUSIBLE	
Δ	R598	QRZ0077-100	10	1/4W	FUSIBLE	
	VR203	QVPA601-104A	100K		VARIABLE	
	VR204	QVPA601-104A	100K		VARIABLE	
	VR205	QVPA601-104A	100K		VARIABLE	
	VR206	QVPA601-104A	100K		VARIABLE	
	VR221	QVPA601-201A	200		VARIABLE	
	VR222	QVPA601-201A	200		VARIABLE	
	VR223	QVPA601-201A	200		VARIABLE	
	VR224	QVPA601-201A	200		VARIABLE	
	VR335	QVPA601-204A	200K		VARIABLE	
	VR336	QVPA601-204A	200K		VARIABLE	
	VR367	QVPA601-503A	50K		VARIABLE	
	VR368	QVPA601-503A	50K		VARIABLE	

OTHERS

Δ	ITEM	PART NUMBER	DESCRIPTION			AREA
	J204	EMV7125-006R	CONNECTOR (6PIN) BATTERY			
	J511	EMV7125-008R	CONNECTOR (8PIN) AMPLIFIER			
	J512	EMV5109-003B	PLUG ASSY (3PIN) SIGNAL PATH			
	J521	EMV7125-011R	CONNECTOR (11PIN) REGULATOR			
	J531	EMV7122-005	CONNECTOR (5PIN) TO HEAD PHONE			
	J541	EMB90TV-402A	SPEAKER TERMINAL			
	J901	EMV7122-005	CONNECTOR (5PIN) FL. -30V			
	L221	EQL2106-223	INDUCTOR			
	L222	EQL2106-223	INDUCTOR			
	L223	EQL4004-101	INDUCTOR			G
	L224	EQL4004-101	INDUCTOR			G
	L301	EQL2106-562	INDUCTOR			
	L302	EQL2106-562	INDUCTOR			
	L335	ENZ6002-010	OSCILLATOR COIL			
	L347	EQL2106-223	INDUCTOR			
	L348	EQL2106-223	INDUCTOR			
	L501	EQL0001-R45	INDUCTOR			
	L502	EQL0001-R45	INDUCTOR			
	P201	TTL25V-003	CONNECTOR (3PIN) A HEAD WIRE			
	P202	TTL25V-007	CONNECTOR (7PIN) B HEAD WIRE			
	P203	EMV5109-014A	PLUG ASSY (14PIN) DECK CONTROL			
	P204	EMV5125-006	PLUG ASSY (6PIN) ENJ-072-1			
	P511	EMV5125-008	PLUG ASSY (8PIN) TO AMPLIFIER			
	P521	EMV5125-011	PLUG ASSY (11PIN) TO REGULATOR			
	S335	QSS7A12-E01	SLIDE SWITCH (BEET CUT)			
	EP201	E70225-002	EARTH PLATE			
	FS547	E3400-431	FELT SPACER			G
	FS548	E3400-431	FELT SPACER			G
	FT001	VMZ0087-001	FUSE CLIP			
	FT002	VMZ0087-001	FUSE CLIP			
	FT003	VMZ0087-001	FUSE CLIP			
	FT004	VMZ0087-001	FUSE CLIP			
	FT005	VMZ0087-001	FUSE CLIP			
	FT006	VMZ0087-001	FUSE CLIP			
	FW205	EWR35B-13LST	FLAT WIRE (5PIN) PLAY / REC PATH			
	FW501	EWR39E-13LST	FLAT WIRE (9PIN) TRANS. SECONDARY			
	FW601	EWR36E-30LST	FLAT WIRE (6PIN) TO CD PCB			
	JT501	EMV7122-005	CONNECTOR (5PIN) TO SECONDARY			
	JT502	EMV7122-004	CONNECTOR (4PIN) TO SECONDARY			
	JT902	EMV7122-103	CONNECTOR (3PIN) PATH OF J902			
	JT903	EMV7122-103	CONNECTOR (3PIN) PATH OF J902			
	RY501	ESK8D24-212	RELAY			
	TB001	EMZ4001-001	TAB			
	TB002	EMZ4001-001	TAB			

Δ SAFETY PARTS

Note (1)

PC Board Ass'y	Designated Areas
ENC-095 B	Scandinavia Continental Europe
ENC-095 C	the U.K.
ENC-095 H	Australia
ENC-095 I	Italy
ENC-095 J	Germany

TRANSISTORS

ITEM	PART NUMBER	DESCRIPTION	AREA
Q801	DTC114YS	SILICON ROHM	
Q841	DTC144EFF	SILICON ROHM	
Q842	DTC144EFF	SILICON ROHM	
Q843	DTC144EFF	SILICON ROHM	
Q844	DTA114YFF	SILICON ROHM	
Q871	2SD2144S(VW)	SILICON ROHM	
Q872	2SD2144S(VW)	SILICON ROHM	
Q873	DTC144ES	SILICON ROHM	
Q931	DTC144ES	SILICON ROHM	
Q932	DTC144ES	SILICON ROHM	
Q951	2SC3311A(Q,R)	SILICON MATSUSHITA	
Q952	2SC3311A(Q,R)	SILICON MATSUSHITA	
Q953	2SA933S(R,S)	SILICON ROHM	
Q954	2SA933S(R,S)	SILICON ROHM	

I. C. S.

ITEM	PART NUMBER	DESCRIPTION	AREA
IC801	HD404019RC02S	I.C. HITACHI	
IC802	MSC7112-01SS	I.C. NIHON DENSO	
IC803	XR1095CP	I.C. EXAR JAPAN	
IC804	SPS-420-1	I.C. SANYO	
IC851	BA15218N	I.C. ROHM	
IC871	BA15218N	I.C. ROHM	
IC901	HD404719A28FS	I.C. HITACHI	
IC909	TC74HC595AP	I.C. TOSHIBA	
IC931	TA8409S	I.C. TOSHIBA	
IC932	TA8409S	I.C. TOSHIBA	
IC933	TA8409S	I.C. TOSHIBA	
IC934	TA8409S	I.C. TOSHIBA	

DIODES

ITEM	PART NUMBER	DESCRIPTION	AREA
D801	SLR-342MCA47	L.E.D. ROHM	
D802	SLR-342MCA47	L.E.D. ROHM	
D803	SLR-342MCA47	L.E.D. ROHM	
D804	SLR-342MCA47	L.E.D. ROHM	
D805	SLR-342MCA47	L.E.D. ROHM	
D806	SLR-342VC3F	L.E.D. ROHM	
D807	1SS119	SILICON HITACHI	
D808	1SS119	SILICON HITACHI	
D809	1SS119	SILICON HITACHI	
D819	SLR-342MCA47	L.E.D. ROHM	
D833	SLR-342MCA47	L.E.D. ROHM	
D834	SLR-342VC3F	L.E.D. ROHM	
D835	SLR-342VC3F	L.E.D. ROHM	B
D835	SLA-380LT	L.E.D. ROHM	C
D835	SLR-342VC3F	L.E.D. ROHM	H
D835	SLR-342VC3F	L.E.D. ROHM	I
D835	SLR-342VC3F	L.E.D. ROHM	J
D903	1SS119	SILICON HITACHI	

CAPACITORS

ITEM	PART NUMBER	DESCRIPTION	AREA
C801	QCT30CH-120	12PF 50V CERAMIC	
C802	QCVB1CM-103	0.01MF 16V CERAMIC	
C803	QEK51CM-107	100MF 16V ELECTRO	
C806	QCVB1CM-103	0.01MF 16V CERAMIC	
C807	QEK51EM-475G	4.7MF 25V ELECTRO	

△ SAFETY PARTS

CAPACITORS

ITEM	PART NUMBER	DESCRIPTION	AREA
C808	QCVB1CM-103	0.01MF 16V CERAMIC	
C809	QCVB1CM-103	0.01MF 16V CERAMIC	
C810	QCBB1HK-151	150PF 50V CERAMIC	
C811	QCBB1HK-471	470PF 50V CERAMIC	
C812	QCXB1CM-152	1500PF 16V CERAMIC	
C813	QEK51HM-225G	2.2MF 50V ELECTRO	
C814	QEK51HM-225G	2.2MF 50V ELECTRO	
C815	QEK51CM-106G	10MF 16V ELECTRO	
C816	QEK51CM-106G	10MF 16V ELECTRO	
C817	QEK51CM-106G	10MF 16V ELECTRO	
C818	QEA40HZ-10AB	ELECTRO	
C819	QEK51HM-226	22MF 50V ELECTRO	
C851	QCGB1HK-102	1000PF 50V CERAMIC	
C852	QCGB1HK-102	1000PF 50V CERAMIC	
C853	QCBB1HK-101	100PF 50V CERAMIC	
C854	QETB1HM-106	10MF 50V ELECTRO	
C855	QCBB1HK-101	100PF 50V CERAMIC	
C856	QCBB1HK-101	100PF 50V CERAMIC	
C860	QETB1HM-106	10MF 50V ELECTRO	
C861	QETB1HM-106	10MF 50V ELECTRO	
C862	QETB1HM-106	10MF 50V ELECTRO	
C863	QETB1HM-106	10MF 50V ELECTRO	
C864	QETB1HM-106	10MF 50V ELECTRO	
C865	QETB1HM-106	10MF 50V ELECTRO	
C866	QETB1HM-106	10MF 50V ELECTRO	
C867	QCBB1HK-471	470PF 50V CERAMIC	I
C867	QCBB1HK-471	470PF 50V CERAMIC	J
C868	QCBB1HK-471	470PF 50V CERAMIC	I
C868	QCBB1HK-471	470PF 50V CERAMIC	J
C871	QETB1AM-476	47MF 10V ELECTRO	
C872	QETB1AM-476	47MF 10V ELECTRO	
C873	QFLB1HJ-104	0.1MF 50V MYLAR	
C874	QFLB1HJ-104	0.1MF 50V MYLAR	
C875	QEK51HM-225G	2.2MF 50V ELECTRO	
C876	QEK51HM-225G	2.2MF 50V ELECTRO	
C880	QCGB1HK-102	1000PF 50V CERAMIC	
C891	QCBB1HK-471	470PF 50V CERAMIC	I
C891	QCBB1HK-471	470PF 50V CERAMIC	J
C892	QCBB1HK-471	470PF 50V CERAMIC	I
C892	QCBB1HK-471	470PF 50V CERAMIC	J
C901	QCVB1CM-103	0.01MF 16V CERAMIC	
C902	QETB1AM-107	100MF 10V ELECTRO	
C931	QCHB1EZ-223	0.022MF 25V CERAMIC	
C932	QCHB1EZ-223	0.022MF 25V CERAMIC	
C933	QFV81HJ-104	0.1MF 50V T.FILM	
C934	QFV81HJ-104	0.1MF 50V T.FILM	
C935	QETB1CM-107	100MF 16V ELECTRO	
C941	QCS21HJ-471	470PF 50V CERAMIC	

RESISTORS

ITEM	PART NUMBER	DESCRIPTION	AREA
R803	QRD161J-221	220 1/6W CARBON	
R804	QRD161J-221	220 1/6W CARBON	
R805	QRD161J-221	220 1/6W CARBON	
R806	QRD167J-331	330 1/6W CARBON	
R807	QRD167J-104	100K 1/6W CARBON	
R808	QRD167J-223	22K 1/6W CARBON	
R809	QRD167J-473	47K 1/6W CARBON	
R810	QRD167J-470	47 1/6W CARBON	
R811	QRD167J-102	1K 1/6W CARBON	
R814	QRD167J-103	10K 1/6W CARBON	
R815	QRD167J-103	10K 1/6W CARBON	
R816	QRD167J-103	10K 1/6W CARBON	
R817	QRD167J-103	10K 1/6W CARBON	
R818	QRD167J-103	10K 1/6W CARBON	
R819	QRD167J-222	2.2K 1/6W CARBON	
R820	QRD167J-222	2.2K 1/6W CARBON	
R821	QRD167J-222	2.2K 1/6W CARBON	
R823	QRD167J-103	10K 1/6W CARBON	
R828	QRD167J-682	6.8K 1/6W CARBON	
R829	QRD167J-222	2.2K 1/6W CARBON	
R830	QRD167J-112	1.1K 1/6W CARBON	
R831	QRD167J-681	680 1/6W CARBON	
R832	QRD167J-431	430 1/6W CARBON	
R833	QRD167J-331	330 1/6W CARBON	
R834	QRD167J-331	330 1/6W CARBON	
R835	QRD167J-151	150 1/6W CARBON	B
R835	QRD167J-471	470 1/6W CARBON	C
R835	QRD167J-151	150 1/6W CARBON	H
R835	QRD167J-151	150 1/6W CARBON	I
R835	QRD167J-151	150 1/6W CARBON	J
R836	QRD161J-221	220 1/6W CARBON	
R837	QRD167J-112	1.1K 1/6W CARBON	
R838	QRD167J-681	680 1/6W CARBON	
R839	QRD167J-431	430 1/6W CARBON	
R840	QRD167J-563	56K 1/6W CARBON	
R841	QRD167J-222	2.2K 1/6W CARBON	
R842	QRD167J-102	1K 1/6W CARBON	
R843	QRD167J-105	1M 1/6W CARBON	
R844	QRD167J-105	1M 1/6W CARBON	
R845	QRD167J-683	68K 1/6W CARBON	

△ SAFETY PARTS

RESISTORS

ITEM	PART NUMBER	DESCRIPTION	AREA
R846	QRD167J-222	2.2K 1/6W CARBON	
R847	QRD167J-472	4.7K 1/6W CARBON	
R848	QRD167J-103	10K 1/6W CARBON	
R849	QRD167J-222	2.2K 1/6W CARBON	
R851	QRD167J-102	1K 1/6W CARBON	
R852	QRD167J-103	10K 1/6W CARBON	
R853	QRD167J-104	100K 1/6W CARBON	
R854	QRD167J-431	430 1/6W CARBON	
R855	QRD167J-471	470 1/6W CARBON	
R856	QRD167J-471	470 1/6W CARBON	
R857	QRD167J-104	100K 1/6W CARBON	
R859	QRD167J-472	4.7K 1/6W CARBON	
R860	QRD167J-472	4.7K 1/6W CARBON	
R861	QRD167J-103	10K 1/6W CARBON	
R862	QRD167J-103	10K 1/6W CARBON	
R863	QRD167J-102	1K 1/6W CARBON	
R864	QRD167J-102	1K 1/6W CARBON	
R865	QRD167J-102	1K 1/6W CARBON	
R869	QRD167J-203	20K 1/6W CARBON	
R870	QRD167J-203	20K 1/6W CARBON	
R871	QRD167J-682	6.8K 1/6W CARBON	
R872	QRD167J-682	6.8K 1/6W CARBON	
R873	QRD167J-564	560K 1/6W CARBON	
R874	QRD167J-564	560K 1/6W CARBON	
R875	QRD167J-511	510 1/6W CARBON	
R876	QRD167J-511	510 1/6W CARBON	
R877	QRD167J-103	10K 1/6W CARBON	
R878	QRD167J-103	10K 1/6W CARBON	
R879	QRD167J-103	10K 1/6W CARBON	
R880	QRD161J-221	220 1/6W CARBON	
R891	QRD167J-681	680 1/6W CARBON	
R892	QRD167J-681	680 1/6W CARBON	
R893	QRD167J-681	680 1/6W CARBON	
R894	QRD167J-681	680 1/6W CARBON	
R901	QRD167J-105	1M 1/6W CARBON	
R903	QRD167J-103	10K 1/6W CARBON	
R904	QRD167J-471	470 1/6W CARBON	
R909	QRD167J-103	10K 1/6W CARBON	
R911	QRD167J-102	1K 1/6W CARBON	
R921	QRD167J-103	10K 1/6W CARBON	
R922	QRD167J-332	3.3K 1/6W CARBON	
R923	QRD167J-242	2.4K 1/6W CARBON	
R924	QRD167J-562	5.6K 1/6W CARBON	
R925	QRD167J-153	15K 1/6W CARBON	
R926	QRD167J-392	3.9K 1/6W CARBON	
R931	QRD167J-153	15K 1/6W CARBON	
R932	QRD167J-153	15K 1/6W CARBON	
R933	QRD167J-133	13K 1/6W CARBON	
R934	QRD167J-133	13K 1/6W CARBON	
R935	QRD167J-563	56K 1/6W CARBON	
R936	QRD167J-563	56K 1/6W CARBON	
R937	QRD167J-123	12K 1/6W CARBON	
R938	QRD167J-123	12K 1/6W CARBON	
R939	QRD167J-682	6.8K 1/6W CARBON	
R940	QRD167J-682	6.8K 1/6W CARBON	
R941	QRD167J-101	100 1/6W CARBON	
R951	QRD167J-184	180K 1/6W CARBON	
R952	QRD167J-224	220K 1/6W CARBON	
R953	QRD167J-224	220K 1/6W CARBON	
R954	QRD167J-224	220K 1/6W CARBON	
R955	QRD167J-683	68K 1/6W CARBON	
R956	QRD167J-153	15K 1/6W CARBON	
R957	QRD167J-273	27K 1/6W CARBON	
R958	QRD167J-242	2.4K 1/6W CARBON	
R961	QRD167J-103	10K 1/6W CARBON	
R962	QRD167J-103	10K 1/6W CARBON	
R971	QRG022J-150AM	15 2W O.M. FILM	
R972	QRG022J-150AM	15 2W O.M. FILM	
RA802	QRB085J-104	100K 1/8W R.NETWORK	
RA803	QRB135J-104	100K 1/8W R.NETWORK	
RA902	QRB079J-222	2.2K 1/10W R.NETWORK	
RA904	QRB069J-103	10K 1/10W R.NETWORK	
VR851	QVJB84B-E54C	50K VARIABLE	
VR871	QVJB84W-E15B	100K VARIABLE	
VR891	QVDB94B-E15C	100K VARIABLE	
VR951	QVPG401-103	10K VARIABLE	

△ SAFETY PARTS

OTHERS

ITEM	PART NUMBER	DESCRIPTION	AREA
J851	QMS3R30-E40S	MINI JACK (MIC JACK)	
J891	QMS3R30-E40S	MINI JACK (HEADPHONE JACK)	
J991	EMV5142-903	PLUG ASSY (3PIN) VOLUME LED	
K901	ENZ8101-007	INDUCTOR	I
K901	ENZ8101-007	INDUCTOR	J
P921	VMC0234-P04	CONNECT TERMINAL (4PIN) A REEL / CAM	
P922	VMC0234-P08	CONNECT TERMINAL (8PIN) B REEL / CAM	
P923	VMC0234-P07	CONNECT TERMINAL (7PIN) A CAM SWITCH	
P924	VMC0234-P07	CONNECT TERMINAL (7PIN) B CAM SWITCH	
P981	EMV5142-911	PLUG ASSY (11PIN) TO DECK BUTTON	
S801	ESP0001-023M	TACT SWITCH (DISCO)	
S802	ESP0001-023M	TACT SWITCH (HALL)	
S803	ESP0001-023M	TACT SWITCH (STADIUM)	
S804	ESP0001-023M	TACT SWITCH (SURROUND)	
S805	ESP0001-023M	TACT SWITCH (BASS)	
S806	ESP0001-023M	TACT SWITCH (KARAOKE)	
S807	ESP0001-023M	TACT SWITCH (RANDOM)	
S808	ESP0001-023M	TACT SWITCH (JUST EDIT)	
S809	ESP0001-023M	TACT SWITCH (REPEAT)	
S810	ESP0001-023M	TACT SWITCH (A/B)	
S811	ESP0001-023M	TACT SWITCH (PROGRAM)	
S812	ESP0001-023M	TACT SWITCH (CD) BACK SKIP	
S813	ESP0001-023M	TACT SWITCH (CD) FORWARD SKIP	
S814	ESP0001-023M	TACT SWITCH (WAKE UP)	
S815	ESP0001-023M	TACT SWITCH (FM)	
S816	ESP0001-023M	TACT SWITCH (AM)	
S817	ESP0001-023M	TACT SWITCH (TUNING DOWN)	
S818	ESP0001-023M	TACT SWITCH (TUNING UP)	
S819	ESP0001-023M	TACT SWITCH (PLAY / PAUSE)	
S820	ESP0001-023M	TACT SWITCH (STOP)	
S821	ESP0001-023M	TACT SWITCH (SLEEP)	
S822	ESP0001-023M	TACT SWITCH (HOUR)	
S823	ESP0001-023M	TACT SWITCH (MINUTE)	
S824	ESP0001-023M	TACT SWITCH (RECTIME)	
S825	ESP0001-023M	TACT SWITCH (PRESET DOWN)	
S826	ESP0001-023M	TACT SWITCH (PRESET UP)	
S827	ESP0001-023M	TACT SWITCH (OPEN / CLOSE)	
S828	ESP0001-023M	TACT SWITCH (RECTIMER)	
S829	ESP0001-023M	TACT SWITCH (CLOCK ADJ.)	
S830	ESP0001-023M	TACT SWITCH (AUTO PRESET)	
S831	ESP0001-023M	TACT SWITCH (MEMORY)	
S832	ESP0001-023M	TACT SWITCH (AUX)	
S833	ESP0001-023M	TACT SWITCH (TUNER ENTRY)	
S834	ESP0001-023M	TACT SWITCH (AI SLEEP)	
S835	ESP0001-023M	TACT SWITCH (POWER)	
S921	ESB1100-007	LEAF SWITCH (A PACK)	
S922	ESB1100-007	LEAF SWITCH (A CRO2)	
S923	ESB1100-007	LEAF SWITCH (REV REC)	
S924	ESB1100-007	LEAF SWITCH (B CRO2)	
S925	ESB1100-007	LEAF SWITCH (B PACK)	
S926	ESB1100-007	LEAF SWITCH (FWD REC)	
BC203	EWS26E-A920	SOCKET WIRE (14PIN) TO DECK PCB	
BC512	EWS293-0120	SOCKET WIRE (3PIN) TO AMPLIFIER	
BC991	EWS323-A912	SOCKET WIRE (3PIN) TO VOLUME LED	
FL801	ELU0001-142	FL TUBE	
FS903	E3400-431	FELT SPACER	
FS935	E3400-431	FELT SPACER	I
FS935	E3400-431	FELT SPACER	J
FS941	E3400-431	FELT SPACER	
FW101	EWR37B-16LST	FLAT WIRE (6PIN) TO TUNER PCB	
FW531	EWR35B-30LST	FLAT WIRE (5PIN) HEADPHONE PCB	
FW851	EWR38B-20LST	FLAT WIRE (8PIN) FROM CD PCB	
FW901	EWR35B-13LST	FLAT WIRE (5PIN) FL / 30V	
FW902	EWR36B-13LST	FLAT WIRE (6PIN) INH / P.OFF	
FW911	EWR37B-30LST	FLAT WIRE (7PIN) TO CD PCB	
FW921	EWR33B-10SST	FLAT WIRE (3PIN)	
JA701	EMV7123-025R	CONNECTOR (25PIN) TO CD PCB	
JA801	EMV5123-L070	PLUG ASSY (20PIN) TO FRONT PCB	
JA851	EMV7123-023R	CONNECTOR (23PIN) CD, TUNER CONTROLLER	
JB801	EMV7124-009	CONNECTOR (9PIN) KEY MATRIX	
JB802	EMV7124-010	CONNECTOR (10PIN) INDICATOR	
JB851	EMV7123-023R	CONNECTOR (23PIN) SYSTEM CONTROLLER	
TC801	ENZ1003-015	TRIMMER	
XT801	ECX4194-304CF	RESONATOR	
XT901	ECX0004-194KM	RESONATOR	

△ SAFETY PARTS

■ ENN-341 □ CD & Source Selector PC Board Ass'y

Note : ENN-341 □ varies according to the areas employed. See note (1) when placing an order.

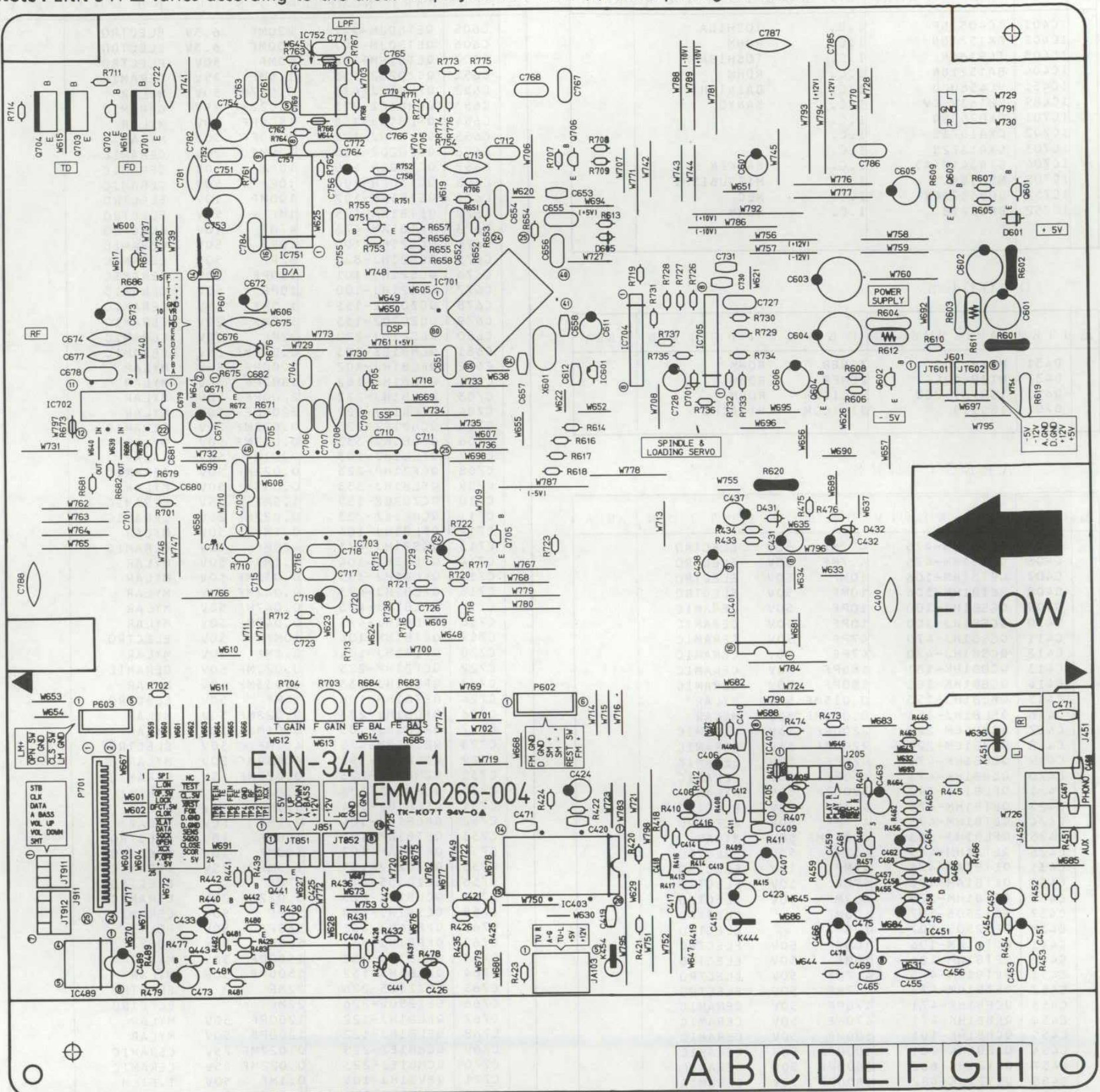

ENN-341 -1
EMW10266-004
TK-K07T 94V-0A

Note (1)

PC Board Ass'y	Designated Areas
ENN-341 D	Australia, the U.K. Scandinavia Continental Europe
ENN-341 E	Germany, Italy

TRANSISTORS

ITEM	PART NUMBER	DESCRIPTION	AREA
Q441	2SD2144S(VW)	SILICON ROHM	
Q442	2SD2144S(VW)	SILICON ROHM	
Q443	DTA144ES	SILICON ROHM	
Q465	2SK163(L1)	F.E.T NEC	
Q466	2SK163(L1)	F.E.T NEC	
Q481	2SC3311A(Q,R)	SILICON MATSUSHITA	
Q601	2SA934(Q,R)	SILICON ROHM	
Q602	2SC3311A(Q,R)	SILICON MATSUSHITA	
Q603	DTC144ES	SILICON ROHM	
Q604	DTA144WS	SILICON ROHM	
Q671	2SA934(Q,R)	SILICON ROHM	
Q701	2SD2037(E,F)	SILICON ROHM	
Q702	2SA934(Q,R)	SILICON ROHM	
Q703	2SD2037(E,F)	SILICON ROHM	
Q704	2SB1357(E,F)	SILICON ROHM	
Q705	DTC144ES	SILICON ROHM	
Q706	2SC3311A(Q,R)	SILICON MATSUSHITA	
Q751	2SC535(B,C)	SILICON HITACHI	

△ SAFETY PARTS

I. C. S.

Δ ITEM	PART NUMBER	DESCRIPTION	AREA
IC401	TC4052BP	I.C. TOSHIBA	
IC402	BA15218N	I.C. ROHM	
IC403	TC9164N	I.C. TOSHIBA	
IC404	BA15218N	I.C. ROHM	
IC451	VC4580LD	I.C. DAINICHI	
IC489	LB1639-CV	I.C. SANYO	
IC701	CXD2505Q	I.C.	
IC702	CXA1571S	I.C.	
IC703	CXA1372S	I.C.	
IC704	STA341M(A)	I.C. SANKEN	
IC705	M5218AL	I.C. MITSUBISHI	
IC751	UPD6376CX	I.C. NEC	
IC752	BA15218	I.C. ROHM	

DIODES

Δ ITEM	PART NUMBER	DESCRIPTION	AREA
D431	MTZ9.1JC	ZENER ROHM	
D432	MTZ9.1JC	ZENER ROHM	
D601	1SR139-200	SILICON ROHM	
D701	1SS119	SILICON HITACHI	

CAPACITORS

Δ ITEM	PART NUMBER	DESCRIPTION	AREA
C405	QETB1HM-475	4.7MF 50V ELECTRO	
C406	QETB1HM-475	4.7MF 50V ELECTRO	
C407	QETB1HM-106	10MF 50V ELECTRO	
C408	QETB1HM-106	10MF 50V ELECTRO	
C409	QCSB1HJ-100	10PF 50V CERAMIC	
C410	QCSB1HJ-100	10PF 50V CERAMIC	
C411	QCSB1HJ-470	47PF 50V CERAMIC	
C412	QCSB1HJ-470	47PF 50V CERAMIC	
C413	QCBB1HK-181	180PF 50V CERAMIC	
C414	QCBB1HK-181	180PF 50V CERAMIC	
C415	QFLB1HJ-153	0.015MF 50V MYLAR	
C416	QFLB1HJ-153	0.015MF 50V MYLAR	
C417	QCXB1CM-222	2200PF 16V CERAMIC	
C418	QCXB1CM-222	2200PF 16V CERAMIC	
C419	QCBB1HK-471	470PF 50V CERAMIC	
C420	QCBB1HK-471	470PF 50V CERAMIC	
C421	QFLB1HJ-392	3900PF 50V MYLAR	
C423	QETB1HM-475	4.7MF 50V ELECTRO	
C424	QETB1HM-475	4.7MF 50V ELECTRO	
C425	QFLB1HJ-683	0.068MF 50V MYLAR	
C426	QETB1HM-475	4.7MF 50V ELECTRO	
C431	QETB1AM-476	47MF 10V ELECTRO	
C432	QETB1AM-476	47MF 10V ELECTRO	
C433	QETB1HM-225	2.2MF 50V ELECTRO	
C437	EE22505-107	100MF ELECTRO	
C438	EE22505-107	100MF ELECTRO	
C441	QETB1HM-106	10MF 50V ELECTRO	
C442	QETB1HM-106	10MF 50V ELECTRO	
C451	QETB1HM-475	4.7MF 50V ELECTRO	
C452	QETB1HM-475	4.7MF 50V ELECTRO	
C453	QCBB1HK-471	470PF 50V CERAMIC	
C454	QCBB1HK-471	470PF 50V CERAMIC	
C455	QCBB1HK-101	100PF 50V CERAMIC	
C456	QCBB1HK-101	100PF 50V CERAMIC	
C457	QCY21HK-682	6800PF 50V CERAMIC	
C458	QCY21HK-682	6800PF 50V CERAMIC	
C459	QCY21HK-182	1800PF 50V CERAMIC	
C460	QCY21HK-182	1800PF 50V CERAMIC	
C461	QCBB1HK-101	100PF 50V CERAMIC	
C462	QCBB1HK-101	100PF 50V CERAMIC	
C463	QETB1HM-475	4.7MF 50V ELECTRO	
C464	QETB1HM-475	4.7MF 50V ELECTRO	
C465	QCHB1EZ-223	0.022MF 25V CERAMIC	
C466	QCHB1EZ-223	0.022MF 25V CERAMIC	
C467	QCBB1HK-331	330PF 50V CERAMIC	E
C468	QCBB1HK-331	330PF 50V CERAMIC	E
C469	QETB1EM-476	47MF 25V ELECTRO	
C470	QETB1EM-476	47MF 25V ELECTRO	
C471	QCBB1HK-561	560PF 50V CERAMIC	
C472	QCVB1CM-103	0.01MF 16V CERAMIC	E
C473	QETB1HM-105	1MF 50V ELECTRO	
C475	QETB1EM-476	47MF 25V ELECTRO	
C476	QETB1EM-476	47MF 25V ELECTRO	
C481	QFLB1HJ-223	0.022MF 50V MYLAR	
C489	QETB1AM-476	47MF 10V ELECTRO	
C490	QCF21HP-223	0.022MF 50V CERAMIC	E
C601	QETB1CM-227	220MF 16V ELECTRO	
C602	QETB1CM-227	220MF 16V ELECTRO	
C603	QETB1CM-108	1000MF 16V ELECTRO	
C604	QETB1CM-108	1000MF 16V ELECTRO	

Δ SAFETY PARTS

CAPACITORS

Δ ITEM	PART NUMBER	DESCRIPTION	AREA
C605	QETB0JM-227	220MF 6.3V ELECTRO	
C606	QETB0JM-107	100MF 6.3V ELECTRO	
C607	QETB1HM-106	10MF 50V ELECTRO	
C651	QCZ0202-155	1.5MF 25V CERAMIC	
C652	QFLB1HJ-473	0.047MF 50V MYLAR	
C653	QCHB1EZ-223	0.022MF 25V CERAMIC	
C654	QFLB1HJ-152	1500PF 50V MYLAR	
C655	QFLB1HJ-102	1000PF 50V MYLAR	
C656	QCZ0202-155	1.5MF 25V CERAMIC	
C657	QCT30CH-100	10PF 50V CERAMIC	
C658	QCT30CH-100	10PF 50V CERAMIC	
C671	QETB1AM-107	100MF 10V ELECTRO	
C672	QETB1HM-105	1MF 50V ELECTRO	
C673	QETB1AM-476	47MF 10V ELECTRO	
C674	QCS21HJ-100	10PF 50V CERAMIC	
C675	QCS21HJ-820	82PF 50V CERAMIC	
C676	QCS21HJ-101	100PF 50V CERAMIC	
C677	QCS21HJ-100	10PF 50V CERAMIC	
C678	QCZ0202-155	1.5MF 25V CERAMIC	
C679	QCZ0202-155	1.5MF 25V CERAMIC	
C680	QCS21HJ-220	22PF 50V CERAMIC	
C681	QCHB1EZ-223	0.022MF 25V CERAMIC	
C682	QFLB1HJ-102	1000PF 50V MYLAR	
C701	QFLB1HJ-182	1800PF 50V MYLAR	
C703	QFLB1HJ-222	2200PF 50V MYLAR	
C704	QFLB1HJ-222	2200PF 50V MYLAR	
C705	QCHB1EZ-223	0.022MF 25V CERAMIC	
C706	QFLB1HJ-333	0.033MF 50V MYLAR	
C707	QFLB1HJ-103	0.01MF 50V MYLAR	
C708	QCF21HP-223	0.022MF 50V CERAMIC	
C709	QFLB1HJ-333	0.033MF 50V MYLAR	
C710	QCZ0202-155	1.5MF 25V CERAMIC	
C711	QCHB1EZ-223	0.022MF 25V CERAMIC	
C712	QFLB1HJ-104	0.1MF 50V MYLAR	
C713	QCS21HJ-471	470PF 50V CERAMIC	
C714	QFLB1HJ-104	0.1MF 50V MYLAR	
C715	QFLB1HJ-333	0.033MF 50V MYLAR	
C716	QFLB1HJ-473	0.047MF 50V MYLAR	
C717	QFLB1HJ-473	0.047MF 50V MYLAR	
C718	QFLB1HJ-473	0.047MF 50V MYLAR	
C719	QETB1HM-106	10MF 50V ELECTRO	
C720	QFLB1HJ-104	0.1MF 50V MYLAR	
C722	QCF21HP-223	0.022MF 50V CERAMIC	
C723	QFLB1HJ-333	0.033MF 50V MYLAR	
C724	QETB1HM-106	10MF 50V ELECTRO	
C726	QFLB1HJ-223	0.022MF 50V MYLAR	
C727	QFLB1HJ-103	0.01MF 50V MYLAR	
C728	QETB1HM-475	4.7MF 50V ELECTRO	
C729	QFLB1HJ-393	0.039MF 50V MYLAR	
C730	QCHB1EZ-223	0.022MF 25V CERAMIC	
C731	QCHB1EZ-223	0.022MF 25V CERAMIC	
C751	QFLB1HJ-104	0.1MF 50V MYLAR	
C752	QFLB1HJ-104	0.1MF 50V MYLAR	
C753	QETB1AM-107	100MF 10V ELECTRO	
C754	QETB1AM-107	100MF 10V ELECTRO	
C755	QCZ0202-155	1.5MF 25V CERAMIC	
C756	EE22505-476	47MF ELECTRO	
C757	QCHB1EZ-223	0.022MF 25V CERAMIC	
C758	QCSB1HJ-560	56PF 50V CERAMIC	
C761	QFP81HJ-561	560PF 50V POLY	
C762	QFP81HJ-561	560PF 50V POLY	
C763	QFLB1HJ-152	1500PF 50V MYLAR	
C764	QFLB1HJ-152	1500PF 50V MYLAR	
C765	EE22505-226	22MF ELECTRO	
C766	EE22505-226	22MF ELECTRO	
C767	QFLB1HJ-122	1200PF 50V MYLAR	
C768	QFLB1HJ-122	1200PF 50V MYLAR	
C769	QCHB1EZ-223	0.022MF 25V CERAMIC	
C770	QCHB1EZ-223	0.022MF 25V CERAMIC	
C771	QFV81HJ-104	0.1MF 50V T.FILM	
C772	QFV81HJ-104	0.1MF 50V T.FILM	
C784	QCZ0202-155	1.5MF 25V CERAMIC	

RESISTORS

Δ ITEM	PART NUMBER	DESCRIPTION	AREA
R405	QRD167J-472	4.7K 1/6W CARBON	
R406	QRD167J-472	4.7K 1/6W CARBON	
R407	QRD167J-104	100K 1/6W CARBON	
R408	QRD167J-104	100K 1/6W CARBON	
R409	QRD167J-393	39K 1/6W CARBON	
R410	QRD167J-393	39K 1/6W CARBON	
R411	QRD167J-104	100K 1/6W CARBON	
R412	QRD167J-104	100K 1/6W CARBON	
R413	QRD167J-104	100K 1/6W CARBON	
R414	QRD167J-104	100K 1/6W CARBON	
R415	QRD167J-473	47K 1/6W CARBON	
R416	QRD167J-473	47K 1/6W CARBON	
R417	QRD167J-822	8.2K 1/6W CARBON	
R418	QRD167J-822	8.2K 1/6W CARBON	
R419	QRD167J-203	20K 1/6W CARBON	

Δ SAFETY PARTS

RESISTORS

ITEM	PART NUMBER	DESCRIPTION	AREA
R420	QRD167J-203	20K 1/6W CARBON	
R421	QRD167J-393	39K 1/6W CARBON	
R422	QRD167J-393	39K 1/6W CARBON	
R423	QRD167J-104	100K 1/6W CARBON	
R424	QRD167J-104	100K 1/6W CARBON	
R425	QRD167J-393	39K 1/6W CARBON	
R426	QRD167J-105	1M 1/6W CARBON	
R427	QRD167J-473	47K 1/6W CARBON	
R428	QRD167J-473	47K 1/6W CARBON	
R429	QRD167J-473	47K 1/6W CARBON	
R430	QRD167J-473	47K 1/6W CARBON	
R431	QRD167J-473	47K 1/6W CARBON	
R432	QRD167J-473	47K 1/6W CARBON	
R433	QRD167J-103	10K 1/6W CARBON	
R434	QRD167J-103	10K 1/6W CARBON	
R435	QRD167J-222	2.2K 1/6W CARBON	
R436	QRD167J-222	2.2K 1/6W CARBON	
R437	QRD167J-224	220K 1/6W CARBON	
R439	QRD167J-224	220K 1/6W CARBON	
R440	QRD167J-224	220K 1/6W CARBON	
R441	QRD167J-103	10K 1/6W CARBON	
R442	QRD167J-103	10K 1/6W CARBON	
R451	QRD167J-222	2.2K 1/6W CARBON	
R452	QRD167J-222	2.2K 1/6W CARBON	
R453	QRD167J-473	47K 1/6W CARBON	
R454	QRD167J-473	47K 1/6W CARBON	
R455	QRD167J-561	560 1/6W CARBON	
R456	QRD167J-561	560 1/6W CARBON	
R457	QRD167J-474	470K 1/6W CARBON	
R458	QRD167J-474	470K 1/6W CARBON	
R459	QRD167J-393	39K 1/6W CARBON	
R460	QRD167J-393	39K 1/6W CARBON	
R461	QRD167J-302	3K 1/6W CARBON	
R462	QRD167J-302	3K 1/6W CARBON	
R463	QRD167J-272	2.7K 1/6W CARBON	
R464	QRD167J-272	2.7K 1/6W CARBON	
R465	QRD167J-105	1M 1/6W CARBON	
R466	QRD167J-105	1M 1/6W CARBON	
R471	QRD167J-332	3.3K 1/6W CARBON	
R472	QRD167J-332	3.3K 1/6W CARBON	
R475	QRD161J-221	220 1/6W CARBON	
R476	QRD161J-221	220 1/6W CARBON	
R477	QRD167J-102	1K 1/6W CARBON	
R478	QRD167J-104	100K 1/6W CARBON	
R480	QRD167J-222	2.2K 1/6W CARBON	
R481	QRD167J-105	1M 1/6W CARBON	
R483	QRD167J-222	2.2K 1/6W CARBON	
R489	QRD14CJ-220S	22 1/4W UNF. CARBON	
R601	QRZ0077-100	10 1/4W FUSIBLE	
R602	QRZ0077-100	10 1/4W FUSIBLE	
R605	QRD167J-472	4.7K 1/6W CARBON	
R606	QRD167J-472	4.7K 1/6W CARBON	
R607	QRD167J-471	470 1/6W CARBON	
R608	QRD167J-182	1.8K 1/6W CARBON	
R609	QRD167J-103	10K 1/6W CARBON	
R610	QRD167J-472	4.7K 1/6W CARBON	
R611	PTH61G25AR4R7M	FUSIBLE	
R612	PTH61G25AR4R7M	FUSIBLE	
R614	QRD167J-102	1K 1/6W CARBON	
R616	QRD167J-102	1K 1/6W CARBON	
R617	QRD167J-391	390 1/6W CARBON	
R618	QRD167J-102	1K 1/6W CARBON	
R619	QRZ0077-5R6	5.6 1/4W FUSIBLE	
R620	QRZ0077-470	47 1/4W FUSIBLE	
R651	QRD167J-332	3.3K 1/6W CARBON	
R652	QRD167J-682	6.8K 1/6W CARBON	
R653	QRD167J-103	10K 1/6W CARBON	
R654	QRD167J-103	10K 1/6W CARBON	
R655	QRD167J-561	560 1/6W CARBON	
R656	QRD167J-561	560 1/6W CARBON	
R657	QRD167J-561	560 1/6W CARBON	
R658	QRD167J-561	560 1/6W CARBON	
R671	QRD167J-100	10 1/6W CARBON	
R672	QRD167J-120	12 1/6W CARBON	
R673	QRD167J-102	1K 1/6W CARBON	
R675	QRD167J-183	18K 1/6W CARBON	
R676	QRD167J-183	18K 1/6W CARBON	
R677	QRD167J-121	120 1/6W CARBON	
R678	QRD167J-103	10K 1/6W CARBON	
R679	QRD167J-332	3.3K 1/6W CARBON	
R680	QRD167J-822	8.2K 1/6W CARBON	
R681	QRD167J-113	11K 1/6W CARBON	
R682	QRD167J-104	100K 1/6W CARBON	
R683	QVPA601-203A	20K VARIABLE	
R684	QVPA601-203A	20K VARIABLE	
R685	QRD167J-103	10K 1/6W CARBON	
R686	QRD167J-910	91 1/6W CARBON	
R701	QRD167J-472	4.7K 1/6W CARBON	
R702	QRD167J-472	4.7K 1/6W CARBON	
R703	QVPA601-203A	20K VARIABLE	
R704	QVPA601-203A	20K VARIABLE	
R705	QRD167J-102	1K 1/6W CARBON	
R706	QRD167J-104	100K 1/6W CARBON	
R707	QRD167J-103	10K 1/6W CARBON	
R708	QRD167J-273	27K 1/6W CARBON	

△ SAFETY PARTS

RESISTORS

ITEM	PART NUMBER	DESCRIPTION	AREA
R709	QRD167J-273	27K 1/6W CARBON	
R710	QRD167J-224	220K 1/6W CARBON	
R711	QRD167J-2R2	2.2 1/6W CARBON	
R712	QRD167J-164	160K 1/6W CARBON	
R713	QRD167J-134	130K 1/6W CARBON	
R714	QRD167J-2R2	2.2 1/6W CARBON	
R715	QRD167J-224	220K 1/6W CARBON	
R716	QRD167J-333	33K 1/6W CARBON	
R717	QRD167J-103	10K 1/6W CARBON	
R718	QRD167J-514	510K 1/6W CARBON	
R719	QRD167J-2R2	2.2 1/6W CARBON	
R720	QRD167J-123	12K 1/6W CARBON	
R721	QRD167J-333	33K 1/6W CARBON	
R722	QRD167J-124	120K 1/6W CARBON	
R723	QRD167J-472	4.7K 1/6W CARBON	
R726	QRD167J-203	20K 1/6W CARBON	
R727	QRD167J-273	27K 1/6W CARBON	
R728	QRD167J-752	7.5K 1/6W CARBON	
R729	QRD167J-752	7.5K 1/6W CARBON	
R730	QRD167J-333	33K 1/6W CARBON	
R731	QRD167J-2R2	2.2 1/6W CARBON	
R732	QRD167J-513	51K 1/6W CARBON	
R733	QRD167J-513	51K 1/6W CARBON	
R734	QRD167J-683	68K 1/6W CARBON	
R735	QRD167J-683	68K 1/6W CARBON	
R736	QRD167J-684	680K 1/6W CARBON	
R737	QRD161J-221	220 1/6W CARBON	
R738	QRD167J-823	82K 1/6W CARBON	
R751	QRD167J-103	10K 1/6W CARBON	
R752	QRD167J-392	3.9K 1/6W CARBON	
R753	QRD167J-182	1.8K 1/6W CARBON	
R754	QRD167J-100	10 1/6W CARBON	
R755	QRD167J-101	100 1/6W CARBON	
R761	QRD167J-362	3.6K 1/6W CARBON	
R762	QRD167J-362	3.6K 1/6W CARBON	
R763	QRD167J-362	3.6K 1/6W CARBON	
R764	QRD167J-362	3.6K 1/6W CARBON	
R765	QRD167J-273	27K 1/6W CARBON	
R766	QRD167J-273	27K 1/6W CARBON	
R767	QRD167J-333	33K 1/6W CARBON	
R768	QRD167J-333	33K 1/6W CARBON	
R771	QRD167J-273	27K 1/6W CARBON	
R772	QRD167J-273	27K 1/6W CARBON	
R773	QRD167J-222	2.2K 1/6W CARBON	
R774	QRD167J-222	2.2K 1/6W CARBON	
R775	QRD167J-332	3.3K 1/6W CARBON	
R776	QRD167J-332	3.3K 1/6W CARBON	

OTHERS

ITEM	PART NUMBER	DESCRIPTION	AREA
J205	EMV7122-005	CONNECTOR(5PIN) DECK SIGNAL	
J451	EMN00TV-209A	2P PIN JACK(AUX/PHONO)	
J452	QSS7A12-E01	SLIDE SWITCH(AUX/PHONO SELECTOR)	
K444	ENZ8101-008	INDUCTOR	
K451	ENZ8101-007	INDUCTOR	E
K454	ENZ8101-008	INDUCTOR	
P601	EMV7144-015	CONNECTOR(15PIN) TO PICKUP	
P602	EMV5109-006A	PLUG ASSY(6PIN) TO CD MECHA.	
P603	EMV5109-005A	PLUG ASSY(5PIN) TO LOADING	
P701	EMV7123-025	CONNECTOR(25PIN) TO FRONT	
X601	ECX0169-344EA	RESONATOR	
FS490	E3400-431	FELT SPACER	E
JA103	EMV7125-005R	CONNECTOR(5PIN) FROM TUNER	
JT601	EMV7122-103	CONNECTOR(3PIN) PART OF J601	
JT602	EMV7122-103	CONNECTOR(3PIN) PART OF J601	
JT851	EMV7122-004	CONNECTOR(4PIN) PART OF J851	
JT852	EMV7122-004	CONNECTOR(4PIN) PART OF J851	
JT911	EMV7122-103	CONNECTOR(3PIN) PART OF J911	
JT912	EMV7122-004	CONNECTOR(4PIN) PART OF J911	

△ SAFETY PARTS

■ ENA-135 □ Tuner PC Board Ass'y

Note : ENA-135 □ varies according to the areas employed. See note (1) when placing an order.

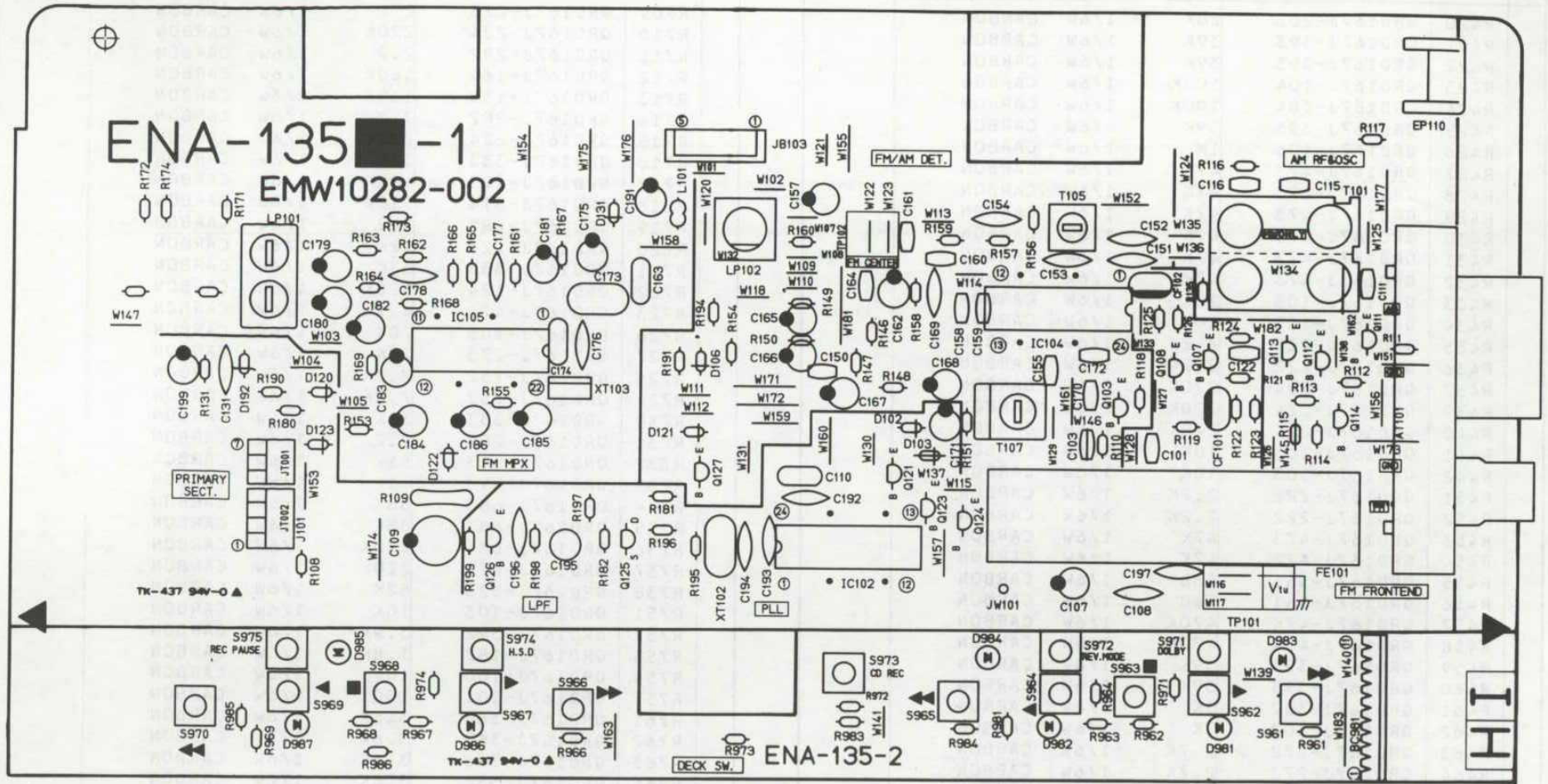

Note (1)

PC Board Ass'y	Designated Areas
ENA-135 C	Australia
ENA-135 D	Scandinavia Continental Europe
ENA-135 E	Germany
ENA-135 F	the U.K.
ENA-135 G	Italy

TRANSISTORS

ITEM	PART NUMBER	DESCRIPTION	AREA
Q103	2SC461(B,C)	SILICON HITACHI	
Q107	2SC535(B,C)	SILICON HITACHI	
Q108	2SC461(B,C)	SILICON HITACHI	
Q111	2SD2144S(VW)	SILICON ROHM	D
Q111	2SD2144S(VW)	SILICON ROHM	E
Q111	2SD2144S(VW)	SILICON ROHM	F
Q111	2SD2144S(VW)	SILICON ROHM	G
Q112	2SD2144S(VW)	SILICON ROHM	D
Q112	2SD2144S(VW)	SILICON ROHM	E
Q112	2SD2144S(VW)	SILICON ROHM	F
Q112	2SD2144S(VW)	SILICON ROHM	G
Q113	2SD2144S(VW)	SILICON ROHM	D
Q113	2SD2144S(VW)	SILICON ROHM	E
Q113	2SD2144S(VW)	SILICON ROHM	F
Q113	2SD2144S(VW)	SILICON ROHM	G
Q114	2SC1740S(R,S)	SILICON ROHM	D
Q114	2SC1740S(R,S)	SILICON ROHM	E
Q114	2SC1740S(R,S)	SILICON ROHM	F
Q114	2SC1740S(R,S)	SILICON ROHM	G
Q121	DTA144ES	SILICON ROHM	D
Q121	DTA144ES	SILICON ROHM	E
Q121	DTA144ES	SILICON ROHM	F
Q121	DTA144ES	SILICON ROHM	G
Q123	DTA144ES	SILICON ROHM	D
Q124	DTA144ES	SILICON ROHM	E
Q125	2SK301(Q2)	F.E.T MATSUSHITA	
Q126	2SC458(D)	SILICON HITACHI	
Q127	DTC144ES	SILICON ROHM	

△ SAFETY PARTS

I. C. S.

ITEM	PART NUMBER	DESCRIPTION	AREA
IC102	LC7218	I.C. SANYO	
IC104	LA1266A	I.C. SANYO	
IC105	LA3401	I.C. SANYO	

DIODES

ITEM	PART NUMBER	DESCRIPTION	AREA
D102	1SS133	SILICON ROHM	D
D102	1SS133	SILICON ROHM	E
D102	1SS133	SILICON ROHM	F
D102	1SS133	SILICON ROHM	G
D103	1SS133	SILICON ROHM	D
D103	1SS133	SILICON ROHM	E
D103	1SS133	SILICON ROHM	F
D103	1SS133	SILICON ROHM	G
D106	1SS133	SILICON ROHM	D
D120	1SS133	SILICON ROHM	D
D121	1SS133	SILICON ROHM	D
D122	1SS133	SILICON ROHM	D
D123	1SS133	SILICON ROHM	D
D192	MTZ5.1JC	ZENER ROHM	
D981	SLR-342MCA47	L.E.D. ROHM	
D982	SLR-342MCA47	L.E.D. ROHM	
D983	SLR-342VC3F	L.E.D. ROHM	
D984	SLR-342VC3F	L.E.D. ROHM	
D985	SLR-342VC3F	L.E.D. ROHM	
D986	SLR-342MCA47	L.E.D. ROHM	
D987	SLR-342MCA47	L.E.D. ROHM	

△ SAFETY PARTS

CAPACITORS

ITEM	PART NUMBER	DESCRIPTION	AREA
C101	QCHB1EZ-223	0.022MF 25V CERAMIC	
C107	QETB1CM-226	22MF 16V ELECTRO	E
C107	QETB1CM-226	22MF 16V ELECTRO	G
C109	QETB1CM-227	220MF 16V ELECTRO	
C110	QCZ0202-155	1.5MF 25V CERAMIC	
C111	QCHB1EZ-223	0.022MF 25V CERAMIC	
C112	QCS21HJ-101	100PF 50V CERAMIC	
C115	QCHB1EZ-223	0.022MF 25V CERAMIC	
C116	QCT30CH-120	12PF 50V CERAMIC	
C122	QCHB1EZ-223	0.022MF 25V CERAMIC	
C131	QCF21HP-223	0.022MF 50V CERAMIC	
C150	QCHB1EZ-223	0.022MF 25V CERAMIC	
C151	QCF21HP-223	0.022MF 50V CERAMIC	
C152	QCF21HP-223	0.022MF 50V CERAMIC	
C153	QCC21EM-223	0.022MF 25V CERAMIC	
C154	QCF21HP-223	0.022MF 50V CERAMIC	
C155	QCHB1EZ-223	0.022MF 25V CERAMIC	
C157	QETB1HM-474	0.47MF 50V ELECTRO	
C158	QCB1HK-101	100PF 50V CERAMIC	
C159	QCB1HK-101	100PF 50V CERAMIC	
C160	QCB1HK-221	220PF 50V CERAMIC	
C161	QCHB1EZ-223	0.022MF 25V CERAMIC	
C162	QETB1EM-106	10MF 25V ELECTRO	
C163	QFN81HJ-102	1000PF 50V MYLAR	
C164	QCHB1EZ-223	0.022MF 25V CERAMIC	
C165	QETB1HM-474	0.47MF 50V ELECTRO	
C166	QETB1HM-225	2.2MF 50V ELECTRO	
C167	QETB1HM-225	2.2MF 50V ELECTRO	
C168	QETB1HM-475	4.7MF 50V ELECTRO	
C169	QCF21HP-223	0.022MF 50V CERAMIC	
C170	QCHB1EZ-223	0.022MF 25V CERAMIC	
C171	QETB1EM-106	10MF 25V ELECTRO	
C172	QCVB1CM-103	0.01MF 16V CERAMIC	
C173	QFN81HJ-223	0.022MF 50V MYLAR	
C174	QFLB1HK-473	0.047MF 50V MYLAR	
C175	QETB1EM-106	10MF 25V ELECTRO	
C176	QCY21HK-102	1000PF 50V CERAMIC	C
C177	QCS21HJ-391	390PF 50V CERAMIC	D
C177	QCS21HJ-471	470PF 50V CERAMIC	E
C177	QCS21HJ-561	560PF 50V CERAMIC	F
C177	QCS21HJ-471	470PF 50V CERAMIC	G
C178	QCS21HJ-391	390PF 50V CERAMIC	C
C178	QCS21HJ-471	470PF 50V CERAMIC	D
C178	QCS21HJ-471	470PF 50V CERAMIC	E
C178	QCS21HJ-561	560PF 50V CERAMIC	F
C178	QCS21HJ-471	470PF 50V CERAMIC	G
C179	QETB1HM-225	2.2MF 50V ELECTRO	
C180	QETB1HM-225	2.2MF 50V ELECTRO	
C181	QETB1EM-106	10MF 25V ELECTRO	
C182	QETB1HM-225	2.2MF 50V ELECTRO	
C183	QETB1HM-105	1MF 50V ELECTRO	
C184	QETB1HM-105	1MF 50V ELECTRO	
C185	QETB1HM-225	2.2MF 50V ELECTRO	
C186	QETB1HM-474	0.47MF 50V ELECTRO	
C191	QETB1HM-475	4.7MF 50V ELECTRO	
C192	QCC21EM-473	0.047MF 25V CERAMIC	
C193	QCS21HJ-180	18PF 50V CERAMIC	
C194	QCS21HJ-180	18PF 50V CERAMIC	
C195	QEN51HM-474	0.47MF 50V NON POLE	
C196	QCY21HK-102	1000PF 50V CERAMIC	
C197	QCF21HP-223	0.022MF 50V CERAMIC	
C199	QETB1HM-475	4.7MF 50V ELECTRO	

RESISTORS

ITEM	PART NUMBER	DESCRIPTION	AREA
R108	QRD167J-103	10K 1/6W CARBON	
R109	QRZ0077-680	68 1/4W FUSIBLE	
R111	QRD167J-472	4.7K 1/6W CARBON	D
R111	QRD167J-472	4.7K 1/6W CARBON	E
R111	QRD167J-472	4.7K 1/6W CARBON	F
R111	QRD167J-472	4.7K 1/6W CARBON	G
R112	QRD167J-472	4.7K 1/6W CARBON	D
R112	QRD167J-472	4.7K 1/6W CARBON	E
R112	QRD167J-472	4.7K 1/6W CARBON	F
R112	QRD167J-472	4.7K 1/6W CARBON	G
R113	QRD167J-472	4.7K 1/6W CARBON	D
R113	QRD167J-472	4.7K 1/6W CARBON	E
R113	QRD167J-472	4.7K 1/6W CARBON	F
R113	QRD167J-472	4.7K 1/6W CARBON	G
R114	QRD167J-103	10K 1/6W CARBON	D
R114	QRD167J-103	10K 1/6W CARBON	E
R114	QRD167J-103	10K 1/6W CARBON	F
R114	QRD167J-103	10K 1/6W CARBON	G
R115	QRD167J-101	100 1/6W CARBON	E
R115	QRD167J-101	100 1/6W CARBON	G
R116	QRD167J-104	100K 1/6W CARBON	
R117	QRD167J-103	10K 1/6W CARBON	D
R117	QRD167J-103	10K 1/6W CARBON	E
R117	QRD167J-103	10K 1/6W CARBON	F
R117	QRD167J-103	10K 1/6W CARBON	G

△ SAFETY PARTS

RESISTORS

ITEM	PART NUMBER	DESCRIPTION	AREA
R118	QRD167J-332	3.3K 1/6W CARBON	
R119	QRD161J-221	220 1/6W CARBON	
R121	QRD167J-391	390 1/6W CARBON	
R122	QRD167J-272	2.7K 1/6W CARBON	
R123	QRD167J-102	1K 1/6W CARBON	
R124	QRD167J-681	680 1/6W CARBON	
R125	QRD167J-332	3.3K 1/6W CARBON	
R126	QRD161J-221	220 1/6W CARBON	
R131	QRD167J-222	2.2K 1/6W CARBON	
R135	QRD167J-470	47 1/6W CARBON	
R146	QRD167J-560	56 1/6W CARBON	
R147	QRD167J-103	10K 1/6W CARBON	
R148	QRD167J-103	10K 1/6W CARBON	
R149	QRD167J-223	22K 1/6W CARBON	
R150	QRD167J-103	10K 1/6W CARBON	
R151	QRD167J-222	2.2K 1/6W CARBON	
R153	QRD167J-103	10K 1/6W CARBON	
R154	QRD167J-103	10K 1/6W CARBON	
R155	QRD167J-562	5.6K 1/6W CARBON	
R156	QRD167J-822	8.2K 1/6W CARBON	
R157	QRD167J-103	10K 1/6W CARBON	
R158	QRD167J-273	27K 1/6W CARBON	
R159	QRD167J-561	560 1/6W CARBON	
R160	QRD167J-183	18K 1/6W CARBON	C
R160	QRD167J-183	18K 1/6W CARBON	D
R160	QRD167J-183	18K 1/6W CARBON	E
R160	QRD167J-822	8.2K 1/6W CARBON	F
R160	QRD167J-183	18K 1/6W CARBON	G
R161	QRD167J-124	120K 1/6W CARBON	C
R161	QRD167J-124	120K 1/6W CARBON	D
R161	QRD167J-124	120K 1/6W CARBON	E
R161	QRD167J-823	82K 1/6W CARBON	F
R161	QRD167J-124	120K 1/6W CARBON	G
R162	QRD167J-124	120K 1/6W CARBON	C
R162	QRD167J-124	120K 1/6W CARBON	D
R162	QRD167J-124	120K 1/6W CARBON	E
R162	QRD167J-124	120K 1/6W CARBON	F
R162	QRD167J-823	82K 1/6W CARBON	G
R162	QRD167J-124	120K 1/6W CARBON	
R163	QRD167J-332	3.3K 1/6W CARBON	
R164	QRD167J-332	3.3K 1/6W CARBON	
R165	QRD167J-274	270K 1/6W CARBON	
R166	QRD167J-274	270K 1/6W CARBON	
R167	QRD167J-393	39K 1/6W CARBON	C
R167	QRD167J-473	47K 1/6W CARBON	D
R167	QRD167J-473	47K 1/6W CARBON	E
R167	QRD167J-473	47K 1/6W CARBON	F
R167	QRD167J-473	47K 1/6W CARBON	G
R168	QRD167J-103	10K 1/6W CARBON	
R169	QRD167J-103	10K 1/6W CARBON	
R171	QRD167J-103	10K 1/6W CARBON	
R172	QRD167J-103	10K 1/6W CARBON	
R173	QRD167J-123	12K 1/6W CARBON	
R174	QRD167J-123	12K 1/6W CARBON	
R180	QRD167J-103	10K 1/6W CARBON	
R181	QRD167J-222	2.2K 1/6W CARBON	
R182	QRD167J-181	180 1/6W CARBON	
R190	QRD167J-103	10K 1/6W CARBON	
R191	QRD167J-562	5.6K 1/6W CARBON	
R194	QRD167J-103	10K 1/6W CARBON	
R195	QRD167J-473	47K 1/6W CARBON	
R196	QRD167J-103	10K 1/6W CARBON	C
R196	QRD167J-222	2.2K 1/6W CARBON	D
R196	QRD167J-222	2.2K 1/6W CARBON	E
R196	QRD167J-222	2.2K 1/6W CARBON	F
R196	QRD167J-222	2.2K 1/6W CARBON	G
R197	QRD167J-222	2.2K 1/6W CARBON	
R198	QRD167J-332	3.3K 1/6W CARBON	C
R198	QRD167J-822	8.2K 1/6W CARBON	D
R198	QRD167J-822	8.2K 1/6W CARBON	E
R198	QRD167J-822	8.2K 1/6W CARBON	F
R198	QRD167J-822	8.2K 1/6W CARBON	G
R199	QRD167J-472	4.7K 1/6W CARBON	
R961	QRD167J-431	430 1/6W CARBON	
R962	QRD167J-681	680 1/6W CARBON	
R963	QRD167J-112	1.1K 1/6W CARBON	
R964	QRD167J-222	2.2K 1/6W CARBON	
R966	QRD167J-431	430 1/6W CARBON	
R967	QRD167J-681	680 1/6W CARBON	
R968	QRD167J-112	1.1K 1/6W CARBON	
R969	QRD167J-222	2.2K 1/6W CARBON	
R971	QRD167J-431	430 1/6W CARBON	
R972	QRD167J-681	680 1/6W CARBON	
R973	QRD167J-112	1.1K 1/6W CARBON	
R974	QRD167J-222	2.2K 1/6W CARBON	
R981	QRD167J-181	180 1/6W CARBON	
R983	QRD167J-331	330 1/6W CARBON	
R984	QRD167J-331	330 1/6W CARBON	
R985	QRD167J-331	330 1/6W CARBON	
R986	QRD167J-181	180 1/6W CARBON	

△ SAFETY PARTS

OTHERS

ITEM	PART NUMBER	DESCRIPTION	AREA
L101	E3400-431	FELT SPACER	
S961	EQL4007-1R0T	INDUCTOR	
S962	ESP0001-023M	TACT SWITCH(A REWIND)	
S963	ESP0001-023M	TACT SWITCH(A REVERSE)	
S964	ESP0001-023M	TACT SWITCH(A STOP)	
S965	ESP0001-023M	TACT SWITCH(A PLAY)	
S966	ESP0001-023M	TACT SWITCH(A FF)	
S967	ESP0001-023M	TACT SWITCH(B REWIND)	
S968	ESP0001-023M	TACT SWITCH(B REVERSE)	
S969	ESP0001-023M	TACT SWITCH(B STOP)	
S970	ESP0001-023M	TACT SWITCH(B PLAY)	
S971	ESP0001-023M	TACT SWITCH(B FF)	
S972	ESP0001-023M	TACT SWITCH(DOLBY)	
S973	ESP0001-023M	TACT SWITCH(REV. MODE)	
S974	ESP0001-023M	TACT SWITCH(CD DIRECT)	
S975	ESP0001-023M	TACT SWITCH(HIGH. SPEED DUBBING)	
T101	EQR7121-004	TACT SWITCH(REC.P)	
T101	EQR7121-002	RF COIL	C
T101	EQR7121-002	RF COIL	D
T101	EQR7121-002	RF COIL	E
T101	EQR7121-002	RF COIL	F
T101	EQR7121-002	RF COIL	G
T105	EQT2140-017	I.F. TRANSFORMER	
T107	ECB1560-010	CERAMIC FILTER	
AT101	EMB41YV-301K	ANTENNA TERMINAL	
BC981	EWS32B-A920	SOCKET WIRE(11PIN) DECK BUTTON	
CF101	ECB2123-006R	CERAMIC FILTER	C
CF101	ECB2118-007R	CERAMIC FILTER	D
CF101	ECB2118-007R	CERAMIC FILTER	E
CF101	ECB2118-007R	CERAMIC FILTER	F

△ SAFETY PARTS

OTHERS

ITEM	PART NUMBER	DESCRIPTION	AREA
CF101	ECB2118-007R	CERAMIC FILTER	G
CF102	ECB2123-006R	CERAMIC FILTER	C
CF102	ECB2118-007R	CERAMIC FILTER	D
CF102	ECB2118-007R	CERAMIC FILTER	E
CF102	ECB2118-007R	CERAMIC FILTER	F
CF102	ECB2118-007R	CERAMIC FILTER	G
EP110	E70225-001	EARTH PLATE	
EP111	E308500-002	SHIELD PLATE	
FE101	EAF2203-001	FRONT END	C
FE101	EAF2203-001	FRONT END	D
FE101	EAF2203-003	FRONT END	E
FE101	EAF2203-001	FRONT END	F
FE101	EAF2203-003	FRONT END	G
JB103	EMV5125-005	PLUG ASSY	
JT001	EMV7122-103	CONNECTOR(3PIN) PART OF P101	
JT002	EMV7122-004	CONNECTOR(4PIN) PART OF P101	
LP101	EQF0101-002	LOW PASS FILTER	
LP102	EQF0102-001	LOW PASS FILTER	E
LP102	EQF0102-001	LOW PASS FILTER	G
XT102	ECX0007-200KC	RESONATOR	
XT103	ECX0000-456KR	RESONATOR	

△ SAFETY PARTS

Accessories List

Part Number	Part Name	Q'ty	Description	Areas
E30580-1954A	INSTRUCTION BOOK	1		A
E30580-1954ABS	INSTRUCTION BOOK	1		BS
E30580-1956A	INSTRUCTION BOOK	1		EF
E30580-1955A	INSTRUCTION BOOK	1		EN
E30580-1956A	INSTRUCTION BOOK	1		G
E30580-1956A	INSTRUCTION BOOK	1		GI
BT20060	WARRANTY CARD	1		BS
BT-20134	WARRANTY CARD	1		G
BT-20122-1	STICKER	1		A
BT-20122	WARRANTY CARD	1		A
BT-20066A	WARRANTY CARD	1		BS
QZL1008-001	FTZ INFORMATION SHEET	1		G
EWP502-005K	BILT-IN ANTENNA	1		A
EWP502-005K	BILT-IN ANTENNA	1		BS
EWP502-005K	BILT-IN ANTENNA	1		EF
EWP502-005K	BILT-IN ANTENNA	1		EN
EWP502-005K	BILT-IN ANTENNA	1		GI
E67007-001	ANTENNA WIRE	1		G
EQB4001-015	LOOP ANTENNA	1		
E43486-340A	SAFETY SHEET	1		BS
EMZ2001-014	ANT. ADAPTOR	1		A
EMZ2001-014	ANT. ADAPTOR	1		BS
EMZ2001-014	ANT. ADAPTOR	1		EF
EMZ2001-014	ANT. ADAPTOR	1		EN
EMZ2001-014	ANT. ADAPTOR	1		GI
RM-SEMXS3U	REMOTE CONTROLLER	1		
UM-4NJ-2PSA	BATTERY	1		
QPGA025-03505B	ENVELOPE	1		

The Marks for Designated Areas

- A Australia
 - BS the U.K.
 - U Universal
 - EN Scandinavia
 - G Germany
 - EF Continental Europe
 - GI Italy
- No mark indicates all areas.

Packing Materials and Part Numbers

Digitized by WWW.FREESERVICE MANUALS.INFO

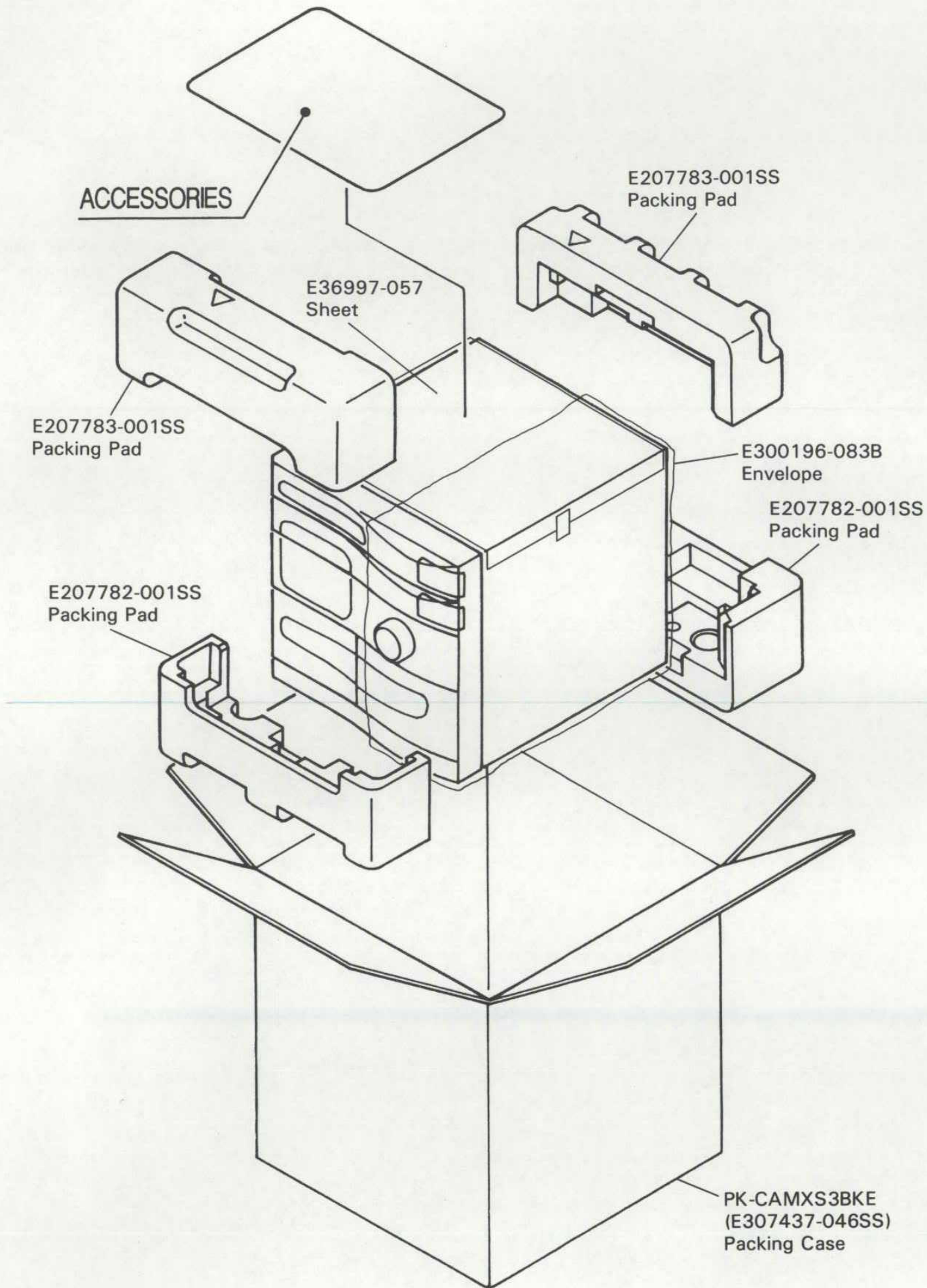

Schematic Diagrams

(1) System Control Section

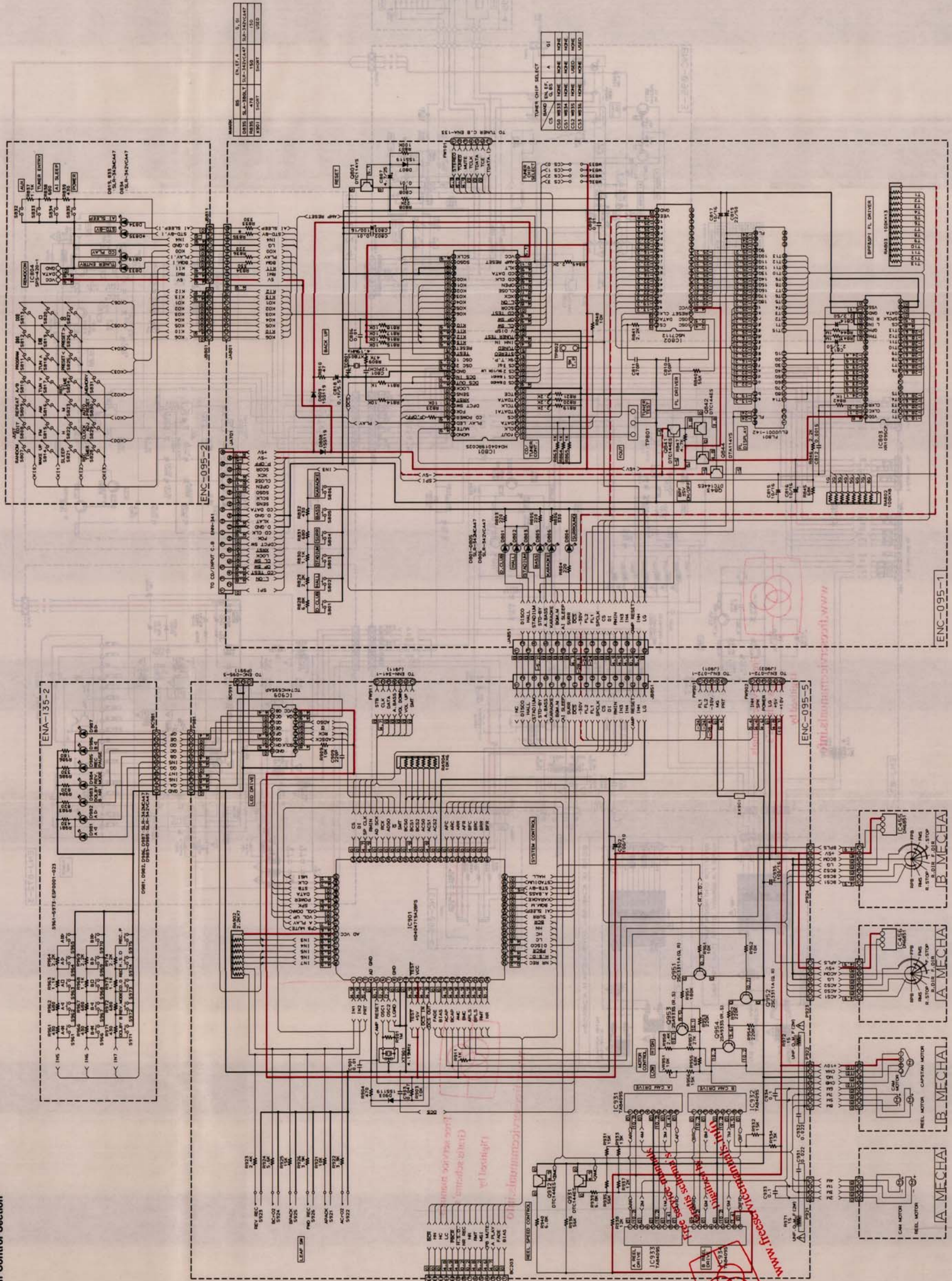

Notes:

1. — indicates + B power supply.
2. - - - - indicates - B power supply.
3. — indicates signal path.
4. When replacing the parts in the shaded are () and those marked with Δ, be sure to use the designated parts to ensure safety.
5. This is the standard circuit diagram. The design and contents are subject to change without notice.

Printed Circuit Boards (1) Front & Deck Controller PCB (ENC-095)

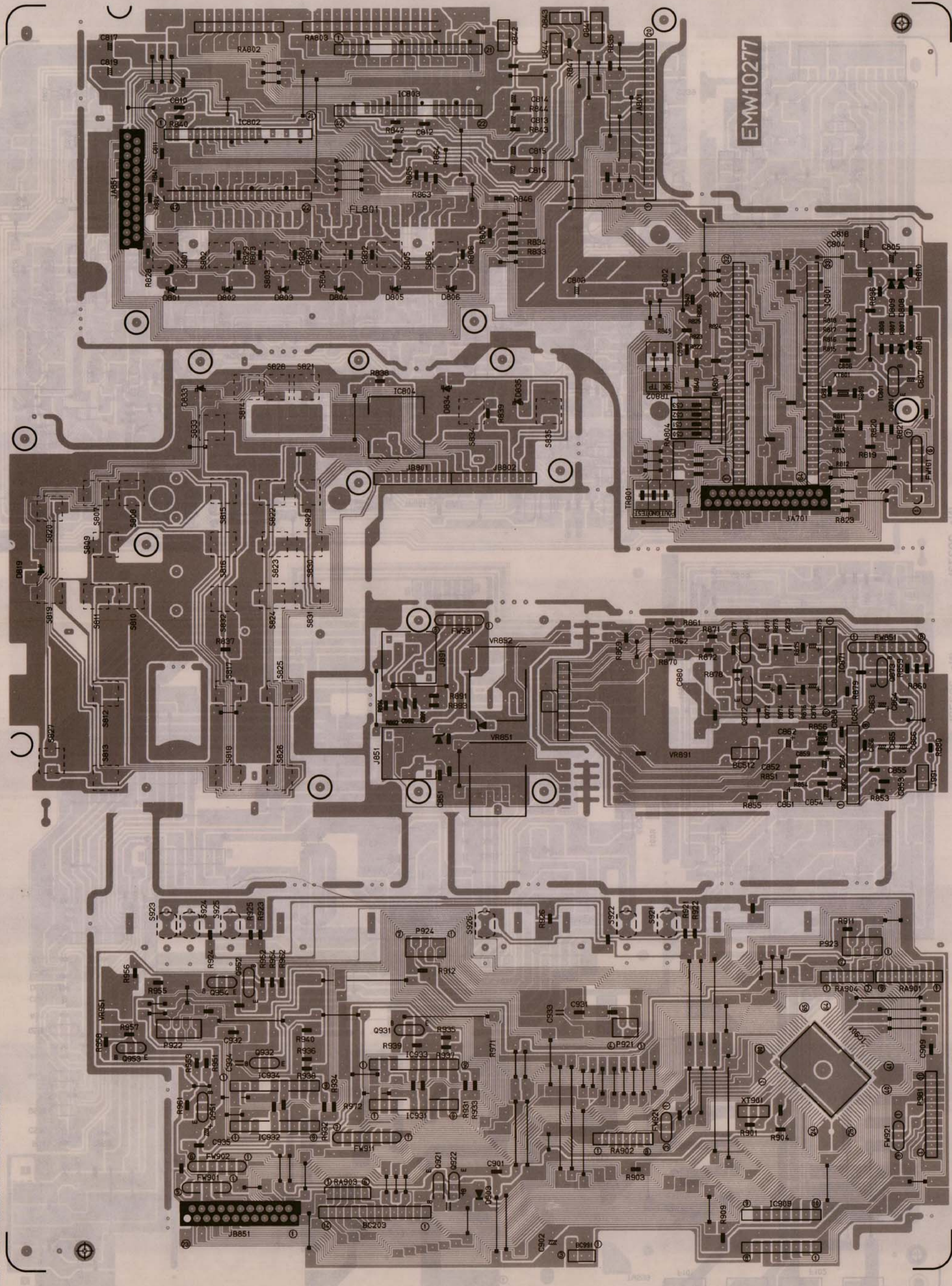

EMW10277

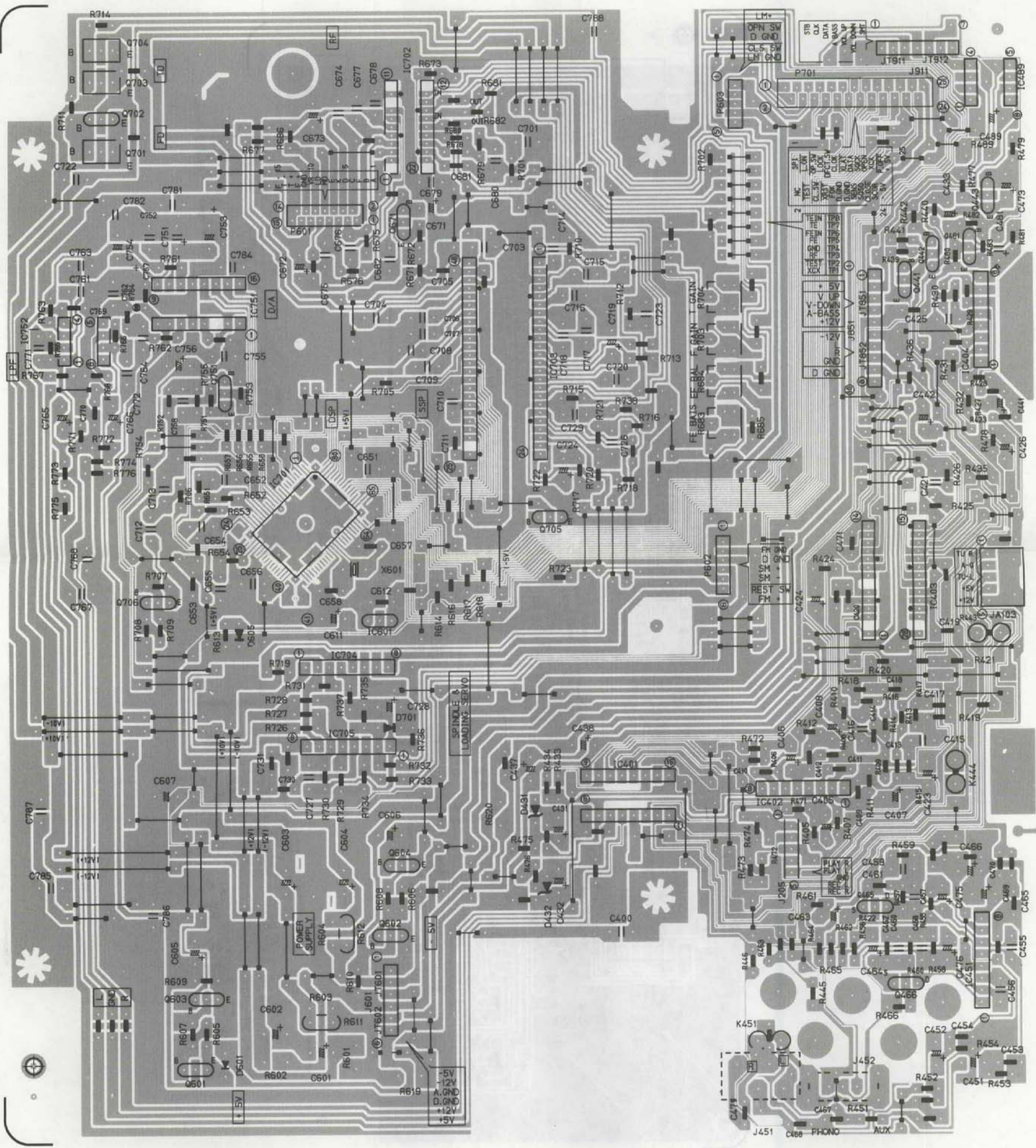

EMW10266

