

JVC

SERVICE MANUAL

STEREO CASSETTE DECK

MODEL **TD-V66** A/B/C/E/G/J/U



Basic Mechanism

KD-V4

	Page		Page
Safety Precautions	2	Location of P.C. Board Parts and Parts List	
Specifications	3	Display Board	12
Location of Main Parts	4	Main Board Parts List	13
Adjustments	5	Main Board Parts	15
Standard Schematic Diagrams		Exploded View of Enclosure Assembly	16
Display Circuit	7	Enclosure Parts List	17
Amplifier Circuit	8	Exploded View of Mechanism Assembly	18
Mechanism Control Circuit	9	Mechanism Parts List	19
Wiring Connections	10	Packing and Parts List	20
		Accessories	20

1 Safety precautions

1. The design of this product contains special hardware. Many circuits and components specially for safety purposes.

For continued protection, no changes should be made to the original design unless authorized in writing by the manufacturer. Replacement parts must be identical to those used in the original circuits. Service should be performed by qualified personnel only.

2. Alterations of the design or circuitry of the product should not be made. Any design alterations or additions will void the manufacturer's warranty and will further relieve the manufacturer of responsibility for personal injury or property damage resulting therefrom.
3. Many electrical and mechanical parts in the product have special safety-related characteristics. These characteristics are often not evident from visual inspection nor can the protection afforded by them necessarily be obtained by using replacement components rated for higher voltage, wattage, etc. Replacement parts which have these special safety characteristics are identified in the parts list of Service manual. Electrical components having such features are identified by \triangle on the schematics and parts list in Service manual. The use of a substitute replacement which does not have the same safety characteristics as the recommended replacement part shown in the parts list in Service manual may create shock, fire, or other hazards.
4. The leads in the products are routed and dressed with ties, clamps, tubings, barriers and/or the like to be separated from live parts, high temperature parts, moving parts and/or sharp edges for the prevention of electric shock and fire hazard.

When service is required, the original lead routing and dress should be observed, and they should be confirmed to be returned to normal, after re-assembling.

5. Leakage current check
(Safety for electrical shock hazard)

After re-assembling the product, always perform an isolation check on the exposed metal parts of the Products (antenna terminals, knobs, metal cabinet, screw heads, earphone jack, control shafts, etc.) to be sure the product is safe to operate without danger of electrical shock.

Do not use a line isolation transformer during this check.

- Plug the AC line cord directly into the AC outlet. Using a "Leakage Current Tester", measure the leakage current from each exposed metal part of the cabinet, particularly any exposed metal part having a return path to the chassis, to a known good earth ground (water pipe, etc.). Any leakage current must not exceed 0.5 mA AC (r.m.s.).

- Alternate check method.

Plug the AC line cord directly into the AC outlet. Use an AC voltmeter having 1,000 ohms per volt or more sensitivity in the following manner. Connect a 1500 Ω 10 W resistor paralleled by a 0.15 μ F AC-type capacitor between an exposed metal part and a known good earth ground (water pipe, etc.).

Measure the AC voltage across the resistor with the AC voltmeter.

Move the resistor connection to each exposed metal part, particularly any exposed metal part having a return path to the chassis, and measure the AC voltage across the resistor. Now, reverse the plug in the AC outlet and repeat each measurement. Any voltage measured must not exceed 0.75 V AC (r.m.s.). This corresponds to 0.5 mA AC (r.m.s.).

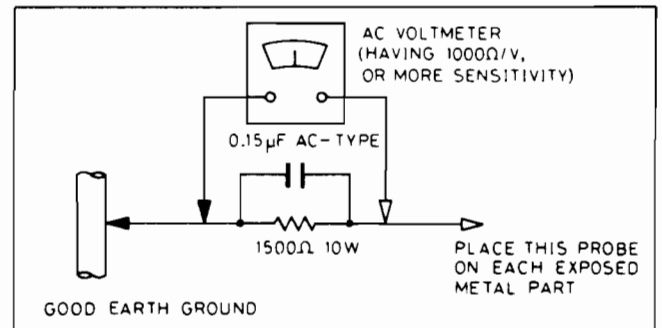

2 Specifications

Type	: Stereo cassette deck	Channel separation	: 40 dB (1 kHz)
Track system	: 4-track, 2-channel	Heads	: SA head for record METAPERM head for playback
Tape speed	: 1-7/8 inch/sec (4.8 cm/sec)		2-Gap ferrite head for erasing
Frequency response	: (-20 dB recording)	Motor	: Electric governed DC Motor for capstan and reel x 1 DC Motor (for FF & Rewind) x 1 DC Motor (for Mechanical drive) x 1
	Metal tape:	Fast forward time	: Approx. 100 sec. with C-60 cassette
	20 – 21,000 (± 3 dB)	Rewind time	: Approx. 100 sec. with C-60 cassette
	15 – 23,000 Hz	Input terminals	:
	15–23000 Hz (DIN 4550)	Input jack x 2	: Min. input level; 80 mV Input impedance; 80 k Ω
	CrO ₂ tape:	Output terminals	:
	20 – 19,000 Hz (± 3 dB)	Output jack x 2	: Output level; 0 – 500 mV Output impedance; 5 k Ω
	15 – 21,000 Hz	Phones jack x 1	: Output level; 0 – 0.6 mW/8 Ω Matching impedance; 8 Ω – 1 k Ω
	15–21000 Hz (DIN 4550)	Other terminal	: Remote control (for R-70E) x 1 Synchro (Compu Link) x 2
	(0 dB recording)	Power requirement	: AC 240/220/120 V, 50/60 Hz (KD-V66A/B/E/G) AC 120 V, 60 Hz (KD-V66C/J) AC 230/127/110V, 50/60 Hz (KD-V66U)
	Metal tape:	Power consumption	: AC 18 watts
	20 – 16,000 Hz (± 3 dB)	Dimensions	: 17-1/4" (435 mm) W 4-3/8" (110 mm) H 11-1/8" (282 mm) D (with feet, buttons, switches)
	CrO ₂ tape:	Weight	: Approx. 10.6 lbs (4.8 kg)
	20 – 9,500 Hz (± 3 dB)	Accessory	: Pin cord 2
	Normal tape:		
	20 – 9,500 Hz (± 3 dB)		
S/N ratio	: 58 dB (S = 1 kHz, K3 = 3 %, N = A-weighted, Metal tape) The S/N is improved by about 15 dB at 500 Hz and by max. 20 dB at 1 kHz ~ 10 kHz with DOLBY C NR on and improved by 5 dB at 1 kHz and by 10 dB at above 5 kHz with ANRS/DOLBY B NR on.		
Improvement of MOL	: 4 dB at 10 kHz with DOLBY C NR on.		
Wow and flutter (Forward direction)	: 0.038 % (WRMS) 0.12 % (DIN 45 500) (with MAXELL UD tape)		
Crosstalk	: 65 dB (1 kHz)		
Harmonic distortion	: K3; 0.5 % THD; 1.0 % (Metal tape, 1 kHz 0 Rated Recording Level)		

Design and specifications subject to change without notice.

3 Location of Main Parts

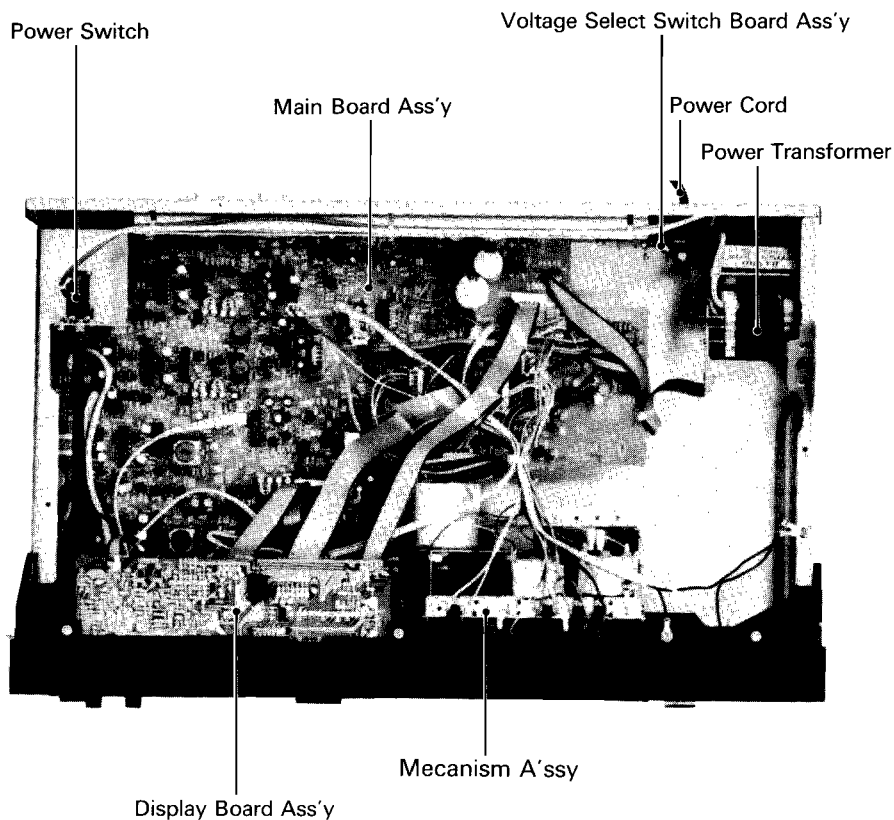

Fig. 3-1

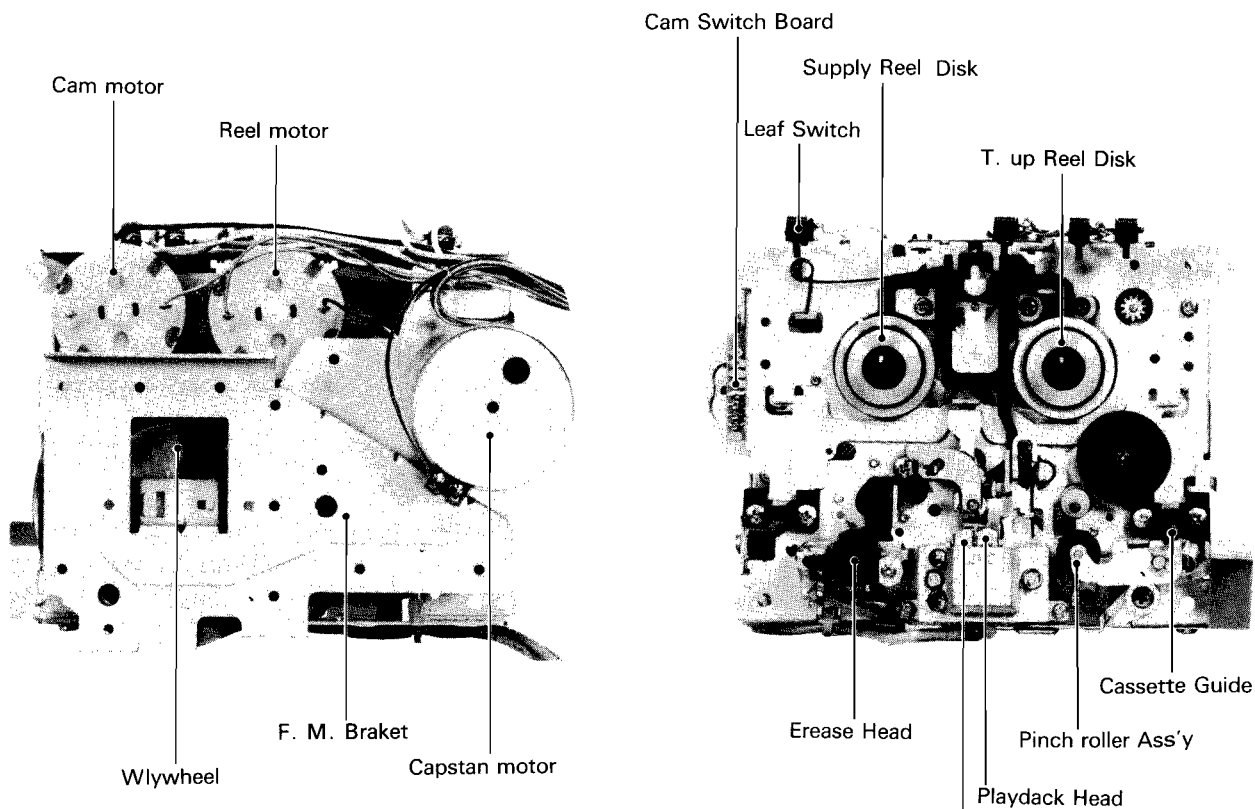

Fig. 3-2

Fig. 3-3

4 Adjustments

Head part

1. Measuring instruments for adjustment

1. **Audio generator** (range: 50 Hz – 20 kHz and output of 0 dB with terminal impedance of 600 ohms)
2. **Attenuator** (with impedance of 600 ohms)
3. **Electronic voltmeter**
4. **Reference tapes**
 TMT702 (for head azimuth adjustment) 14 kHz,
 VTT712 (for tape speed or wow and flutter adjustment) 3KHz,
 VTT724 (reference level) 1 kHz,
 VTT739 (playback frequency response),
 TMT6447 (for music scan),
 TMT6448 (for music scan)
5. **Recording reference tapes**
 The reference tapes should be TS-9 (UD), TS-6(SA) and TS-7 (ME) or their equivalent.
 (Use the designated reference tape of this division.)
6. **Distortion meter** (with band pass filter)
7. **Torque gauge** (cassette) CTG-N
8. **C-120 tape** (for confirming the tape transport) } For mechanism adjustment

Notice: The VTT712 has improved accuracy and TMT702 is newly added. The substitution of VTT658 (10 kHz) is possible.

2. Mechanism adjustments and repairs

(Mechanism adjustment or confirmation are required before performing the electrical circuit adjustment.)

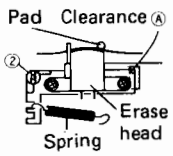
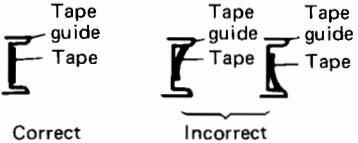
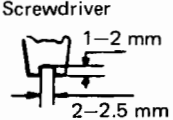
Items	Adjustment	Adjusting point	Standard value	Remarks
Erase head adjustment 	<ol style="list-style-type: none"> 1) Make sure that the moving part of the erase head assembly move smoothly around the pivot of screw (2) and also confirm that there is clearance (A) as shown in the figure during the playback mode. 2) Check the tape transport as follows. Adjust the height of the erase head with screw (2) while observing curl in the tape transport with C-120 tape and adjust so no curl will appear in the tape guide section of the play head or the erase head.  <p>Correct Incorrect</p>	②		Be sure to perform this adjustment after erase head replacement.  <p>Screwdriver 1-2 mm 2-2.5 mm</p> <p>Notes:</p> <ul style="list-style-type: none"> • After adjustment, confirm by ear how effectively the erasure is performed using a metal tape. • After replacement of the erase head, play or record head, loosen the associated wires and clamp a new head then confirm that the new head movement is normal.

Replacement and adjustment of record head and playback head

This deck has three independent heads and the head units are completely separate. However, they are assembled and adjusted on a single head board, therefore they can be dealt with as one unit in principle. Accordingly, replace or adjust the head assembly when any head is defective. In addition,

since certain screws have been precisely adjusted in the factory, care should be taken when handling them as well as referring to the following adjustment items (1. Reference dimensions, 2. Screw explanations, 3. Adjustment methods).

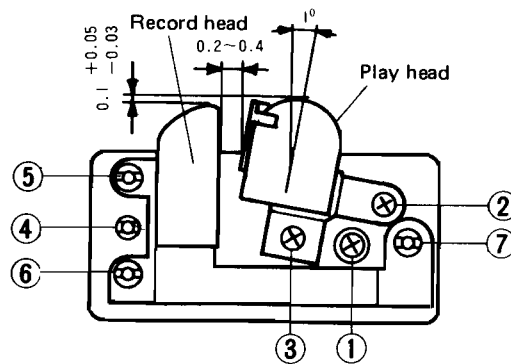

Fig. 4-1

1. Reference dimensions

The reference dimensions of record head and play head are shown in Fig. 4-1. After checking or replacing the head assembly because of characteristic deterioration, confirm that there is no big disagreement.

2. Screw explanations

The screws marked O require adjustment when repairing. The screws marked X are basically required not to move when repairing.

(1) is the head base fixing screw.

(2) and (3) marked X are the play head fixing screws (for adjusting the relative position to the record head).

(4) marked O is a special nut for playback azimuth adjustment.

(5) marked X is a special nut for the record head height adjustment.

(6) marked X is a special nut for the record head tilt adjustment.

(7) marked O is a special nut for the record head azimuth adjustment.

3. Adjusting methods

Perform the following adjustment procedure after head assembly replacement.

1) Play head azimuth

- Connect the LINE OUT jacks to an electronic voltmeter (two-meter VTVM).

- Play test tape TMT-702 and adjust the screw (4) so that the output of electronic voltmeter is optimized.

2) Record head azimuth

- Connect the LINE OUT jacks to a two-meter VTVM.

- Observe the simultaneous monitor output with the two-meter VTVM while recording a 14 kHz signal at ODB (Indicator) -20 dB and adjust the screw (7) so that the output is maximum.

Note: Perform this adjustment using the stable middle part of side A of TS-9 (UD) and also confirm it using TS-6 (SA) and TS-7 (ME).

The above adjustments are recommended to check after fixing the mechanical section to the cabinet.

5 Standard Schematic Diagram

Mechanical Adjustment Procedure of Head Section

Adjust the record and erase heads of TD-V66 3-head mechanism with respect to the play head.

Procedure

1. a) Use gauge M300 and confirm that the gauge can be smoothly inserted in the tape guide of the play head. If the gauge hits the tape guide, adjust the thickness of washers under the cassette guide on the play head side.
Parts No. of adjustment washers:
0.1 mm 13270412AT
0.2 mm 13270412BT
0.3 mm 13270412CT
- b) Adjust the azimuth with the azimuth adjustment screw.
2. Next, adjust the height of the erase head. After adjusting with the adjustment screw on the left of the erase head, apply locking paint.

3. Perform tilt and azimuth adjustment of the record head.
 - a) Roughly adjust the azimuth of the record head with the record head azimuth adjustment screw on the right.
Check the tilt of the head with gauge M300. Perform the checking procedure so that the gauge softly touches the record head and confirm the clearance by applying light from the other side. When there is any clearance at the upper or lower section of the head, adjust with adjustment screw 6.
When adjustment screw 6 is tightened, the clearance of the upper section becomes wider.
 - b) Adjust the azimuth again so that the output level is maximum.

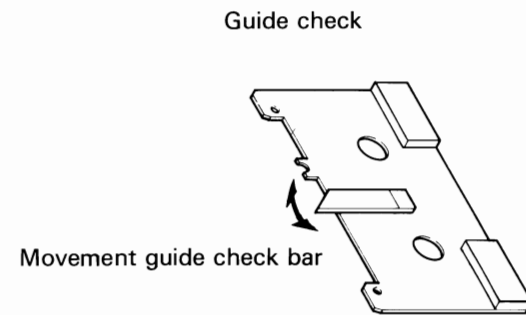

Fig. 4-2

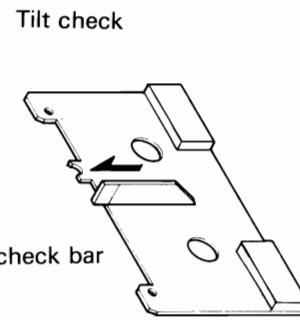

Fig. 4-3

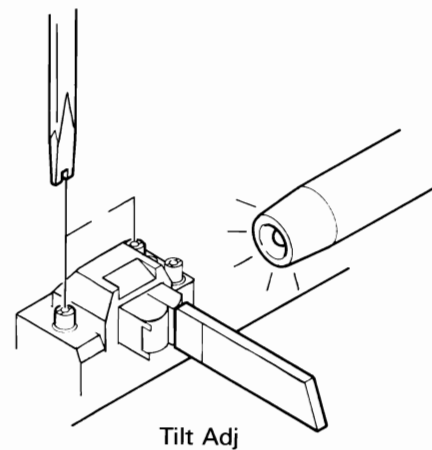

Fig. 4-4

Electronic adjustment are the same as Main adjustment of Model KD-V6. Please refer to servicemanual of KD-V6 A/B/C/E/J/U (No. 4230 - page 9).

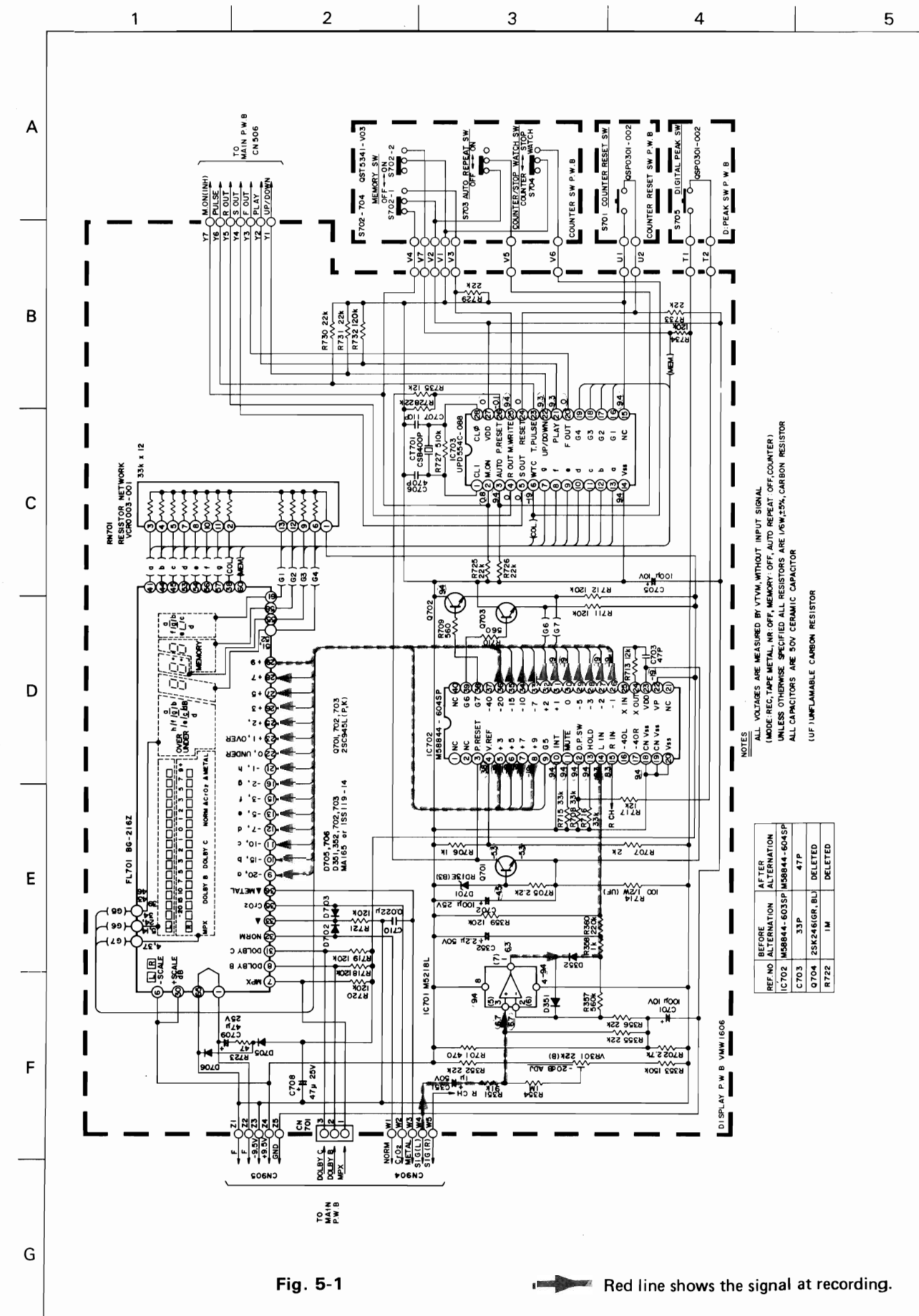

Fig. 5-1

Red line shows the signal at recording.

5 Standard Schematic Diagram (Amplifier Circuit)

1 2 3 4 5 6 7 8 9 10

A
B
C
D
E
F
G

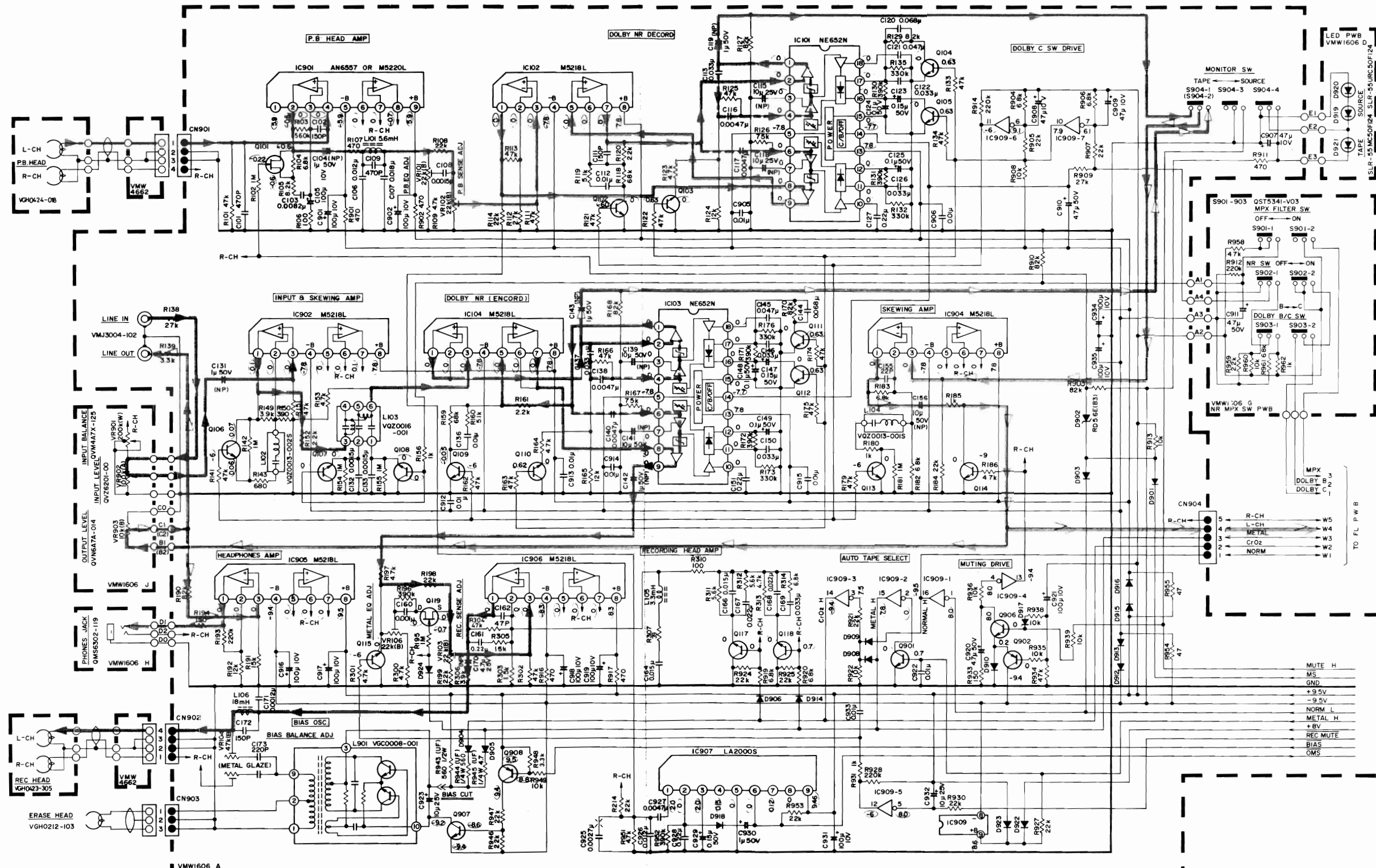

SEMI CONDUCTORS	
Q02, 103, 104, 105, 106, 107	2SC945L(P,K)
108, 109, 110, 111, 112, 113	
117, 118, 901, 906, 907	
Q11, 115	2SD1302(R,S,T)
Q902, 908	2SA733A(P,K)
Q119, 101	2SK246(GR,BL)
ALL Diode	MA165
IC909	M54590P

NOTES
 ALL VOLTAGES ARE MEASURED BY VTVM, WITHOUT INPUT SIGNAL
 (MODE: REC, TAPE: METAL, NR: OFF)
 UNLESS OTHERWISE SPECIFIED ALL RESISTORS ARE 1/6W, ±5%, CARBON RESISTOR.
 ALL CAPACITORS ARE 50V CERAMIC CAPACITOR OR 50V MYLAR CAPACITOR.
 (UF) UNFLAMMABLE CARBON RESISTOR (NP) NON POLARIZED E. CAPACITOR

Blue line shows the signal at playback.
 Red line shows the signal at recording.

Fig. 5-2
 8 (No. 4270)

5 Standard Schematic Diagram (Mechanism Control Circuit)

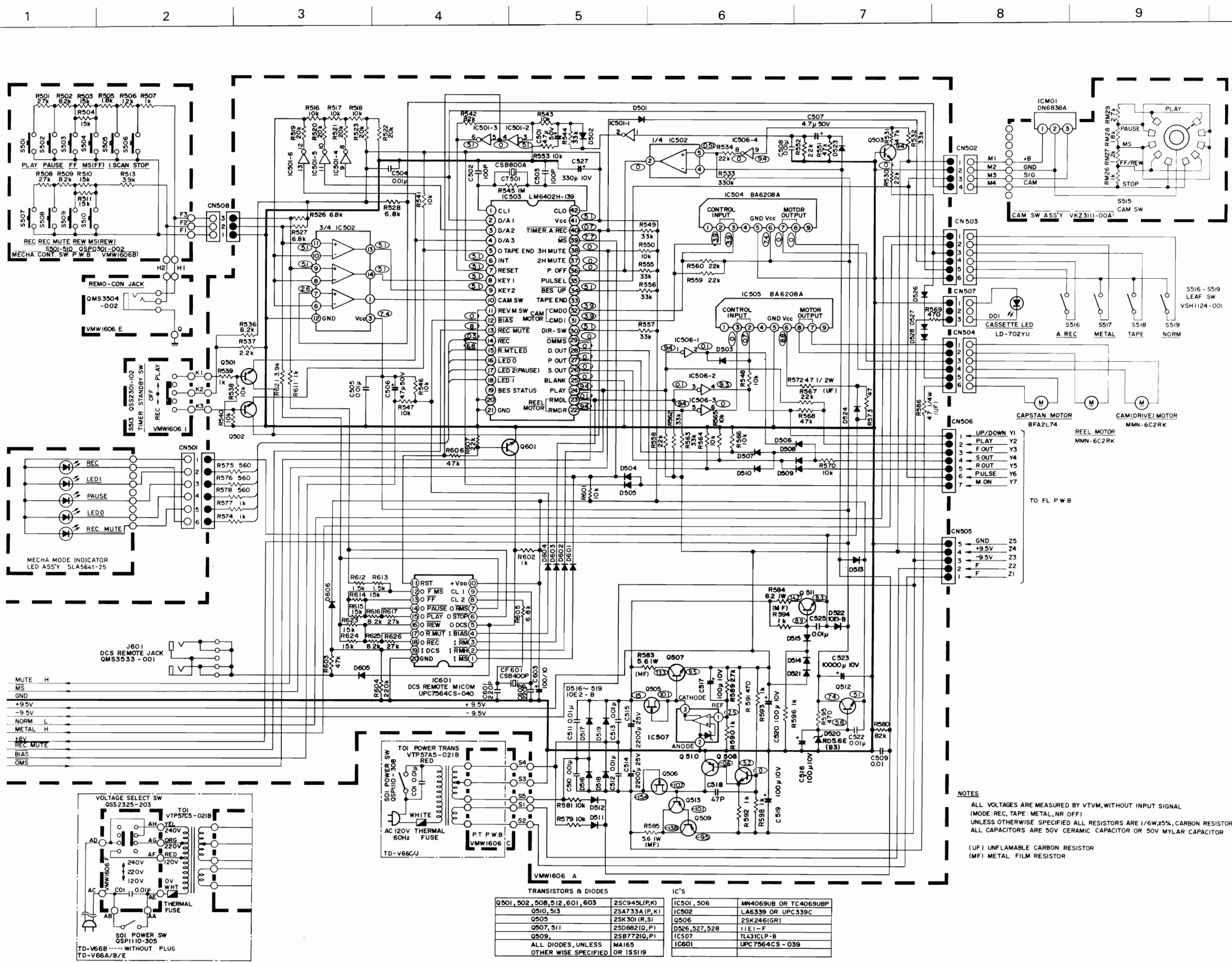

TRANSISTORS & DIODES		IC'S	
Q501, 502, 508, 512, 601, 603	2SC945(I,P,K)	IC501, 506	MM4069UB OR TC4069UBP
Q510, 513	2SA733A(P,K)	IC502	LA6339 OR UPC339C
Q505	2SK301(R,S)	Q506	2SK246(IGR)
Q507, 511	2SD882(I,Q,P)	D526, 527, 528	11E1-F
Q509	2SB772(I,Q,P)	IC507	TL431CLP-B
ALL DIODES, UNLESS OTHERWISE SPECIFIED OR ISS119		IC601	UPC7564CS-039

NOTES
 ALL VOLTAGES ARE MEASURED BY VTVM, WITHOUT INPUT SIGNAL
 (MODE: REC, TAPE: METAL, NR: OFF)
 UNLESS OTHERWISE SPECIFIED ALL RESISTORS ARE 1/6W, 5%, CARBON RESISTOR
 ALL CAPACITORS ARE 50V CERAMIC CAPACITOR OR 50V MYLAR CAPACITOR
 (UF) UNFLAMMABLE CARBON RESISTOR
 (MF) METAL FILM RESISTOR

Fig. 5-3

6 Wiring Connections

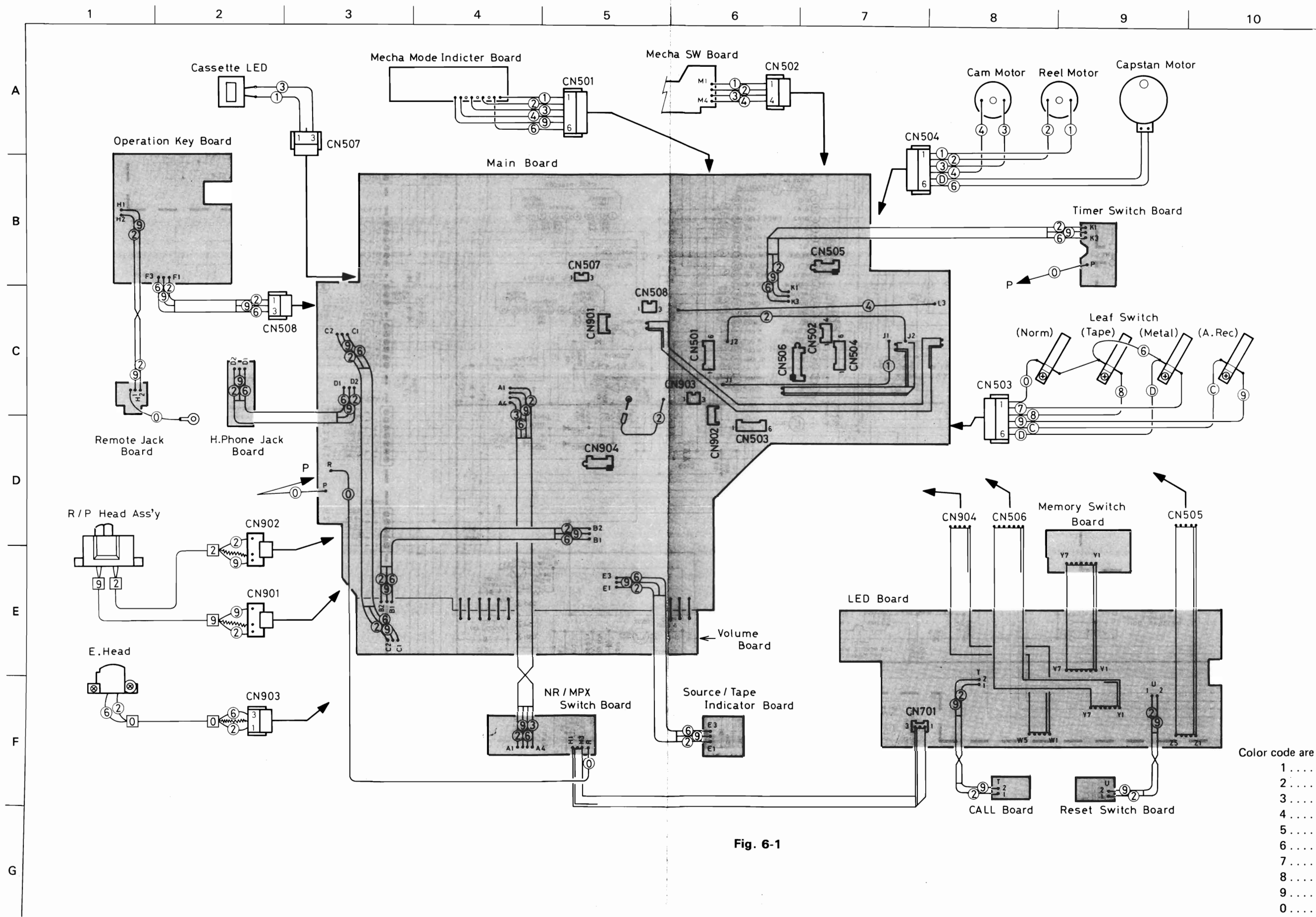

Fig. 6-1

- Color code are shown below.
- 1 Brown
 - 2 Red
 - 3 Orange
 - 4 Yellow
 - 5 Green
 - 6 Blue
 - 7 Violet
 - 8 Grey
 - 9 White
 - 0 Black

TD-V66 B.E

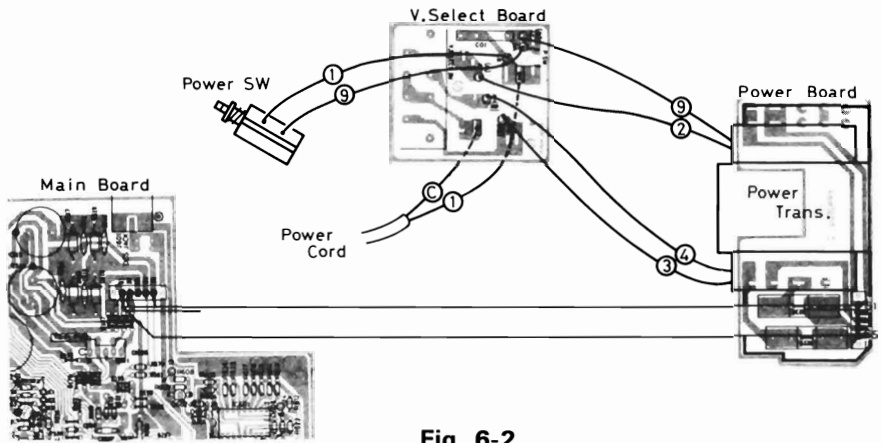

Fig. 6-2

TD-V66 C.J

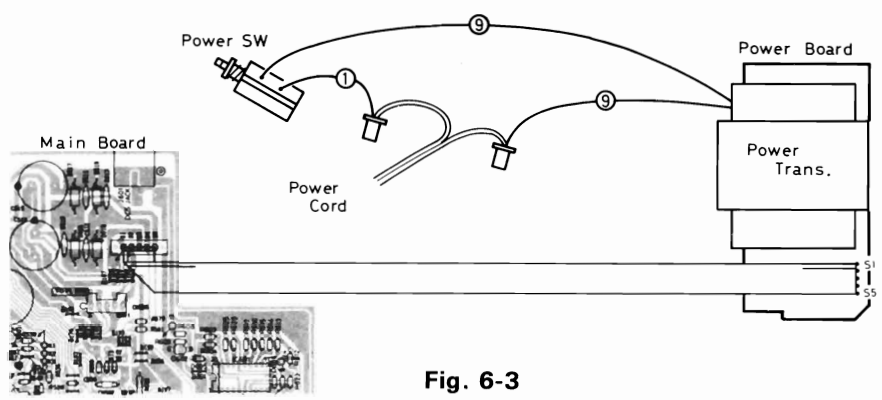

Fig. 6-3

TD-V66 B.E

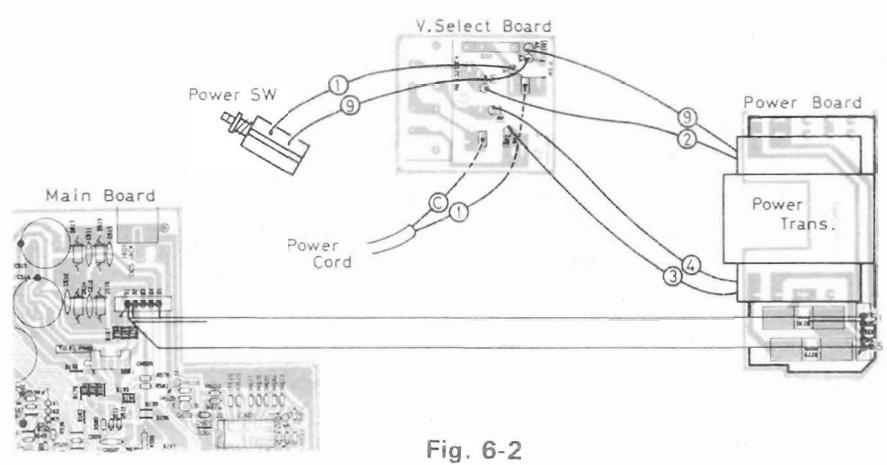

Fig. 6-2

TD-V66 C.J

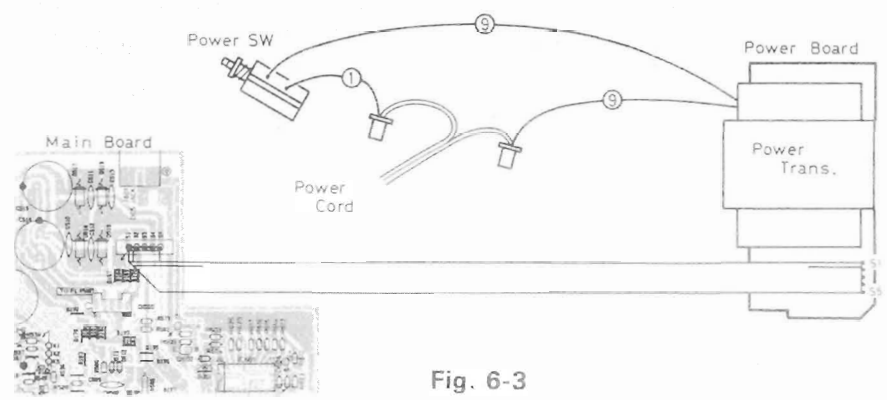

Fig. 6-3

7 Location of P. C. Board Parts and Parts List

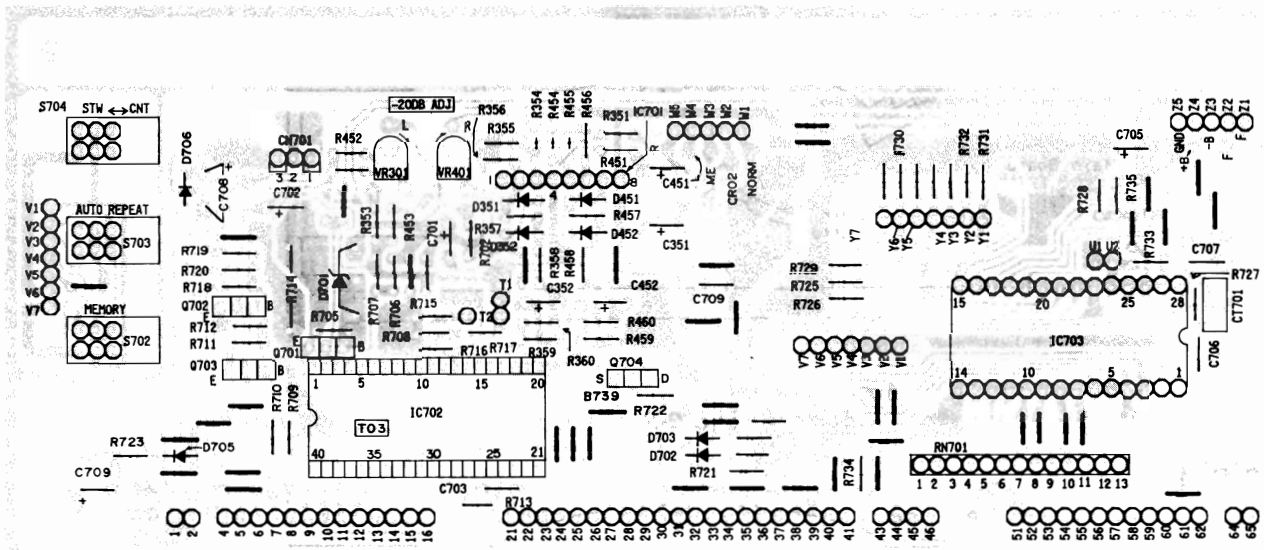
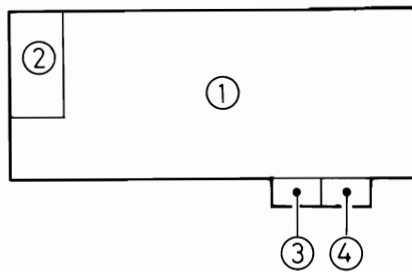

Fig. 7-1

Location of P. C. Board Layout



Location of P.C. Board Layout

1. LCD Board
2. Memory Switch Board
3. CALL Board
4. Reset Switch Board

LCD Board Parts List

△	REF. NO	PARTS NO.	PARTS NAME	QTY
	IC701	M5218L	I. C	1
	IC702	M58844-604SP	I. C.	1
	IC703	UPD554C-088	I. C.	1
	Q701 -Q703	2SC945L(P,K)	TTANSISTOR	3
	D351 ,D352	1SS119	SI. DIODE	8
	D451 ,D452			
	D702 ,D703			
	D705 ,D706			
	VR301,VR401	QVZ1802-223	V RESISTOR	2
	CN701	VMC0007-003	CONNECTOR	1
	S701 ,S705	QSP0301-002	TACT SWITCH	2
	S702 -S704	QST5341-V01	PUSH SWITCH	1
△	R714	QRD129J-101	CARBON RESISTOR	1
	R727	QRD144J-514S	C RESISTOR	1
	R358 ,R458	QRD161J-102	CARBON RESISTOR	3
	R706			
	R354 ,R454	QRD161J-105	CARBON RESISTOR	2
	R713 ,R717	QRD161J-123	CARBON RESISTOR	3
	R735			
	R359 ,R459	QRD161J-124	CARBON RESISTOR	10
	R711 ,R712			
	R718 -R721			
	R732 ,R734			
	R353 ,R453	QRD161J-154	CARBON RESISTOR	2
	R707	QRD161J-202	CARBON RESISTOR	1

△ Parts are safety assurance parts

When replacing those parts, make sure to use the specited one.

△	REF. NO	PARTS NO.	PARTS NAME	QTY
	R705	QRD161J-222	CARBON RESISTOR	1
	R352 ,R355	QRD161J-223	CARBON RESISTOR	13
	R356 ,R452			
	R455 ,R456			
	R725 ,R726			
	R728 -R731			
	R733			
	R360 ,R460	QRD161J-224	CARBON RESISTOR	2
	R702	QRD161J-272	CARBON RESISTOR	1
	R708 ,R715	QRD161J-333	CARBON RESISTOR	3
	R716			
	R723	QRD161J-470	CARBON RESISTOR	1
	R701	QRD161J-471	CARBON RESISTOR	1
	R709 ,R710	QRD161J-561	CARBON RESISTOR	2
	R357 ,R457	QRD161J-564	CARBON RESISTOR	2
	R351 ,R451	QRD161J-913Y	C RESISTOR	2
	CT701	CSB400P	CELA LOCK	1
	C710	QCF11HP-223	C. CAPACITOR	1
	C707	QCS11HJ-111	C. CAPACITOR	1
	C703	QCS11HJ-470	C. CAPACITOR	1
	C706	QCS11HJ-471	C. CAPACITOR	1
	C701 ,C705	QET41AR-107	E. CAPACITOR	2
	C702	QET41ER-107	E CAPACITOR	1
	C708 ,C709	QET41ER-476	E CAPACITOR	2
	C351 ,C451	QET41HR-105	E. CAPACITOR	2
	C352 ,C452	QET51HR-225N	E. CAPACITOR	2

7 Location of P. C. Board Parts and Parts List

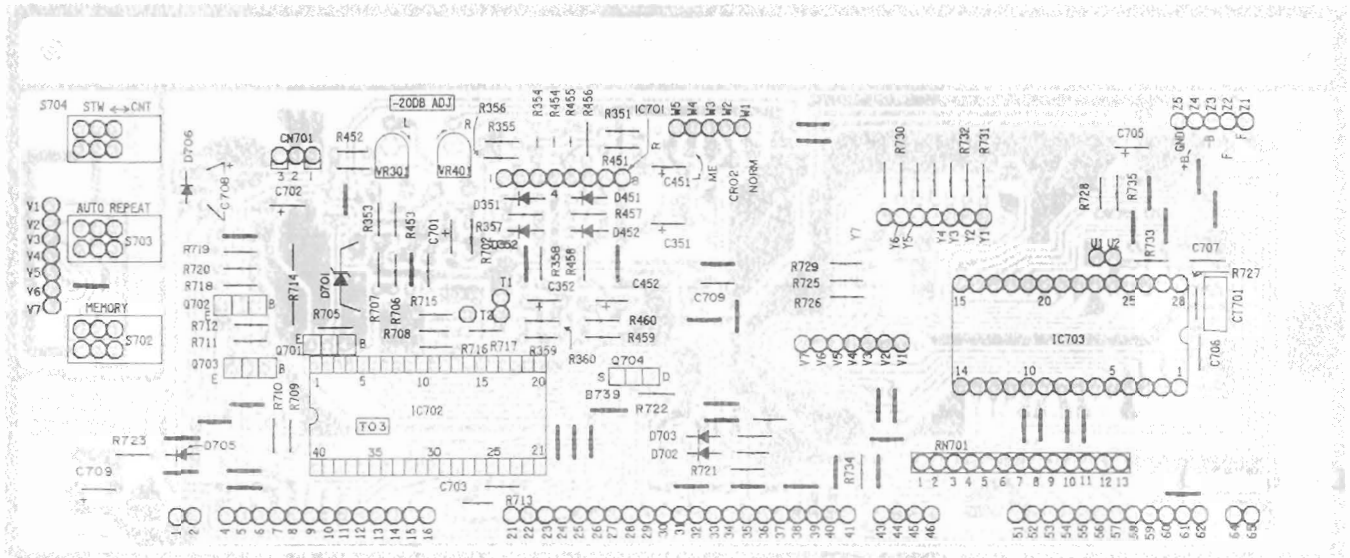
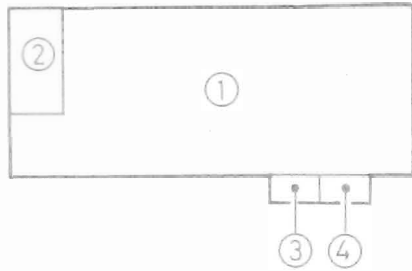

Fig. 7-1

Location of P.C. Board Layout



Location of P.C. Board Layout

1. LCD Board
2. Memory Switch Board
3. CALL Board
4. Reset Switch Board

LCD Board Parts List

REF. NO	PARTS NO.	PARTS NAME	QTY
IC701	M5218L	I.C	1
IC702	M58844-604SP	I.C.	1
IC703	UPD554C-088	I.C.	1
Q701 ~ Q703	2SC945L(P,K)	TRANSISTOR	3
D351, D352	1SS119	SI. DIODE	8
D451, D452			
D702, D703			
D705, D706			
VR301, VR401	QVZ1802-223	V RESISTOR	2
CN701	VMC0007-003	CONNECTOR	1
S701, S705	QSP0301-002	TACT SWITCH	2
S702, S704	QST5341-V01	PUSH SWITCH	1
R714	QRD129J-101	CARBON RESISTOR	1
R727	QRD144J-514S	C RESISTOR	1
R358, R458	QRD161J-102	CARBON RESISTOR	3
R706			
R354, R454	QRD161J-105	CARBON RESISTOR	2
R713, R717	QRD161J-123	CARBON RESISTOR	3
R735			
R359, R459	QRD161J-124	CARBON RESISTOR	10
R711, R712			
R718, R721			
R732, R734			
R353, R453	QRD161J-154	CARBON RESISTOR	2
R707	QRD161J-202	CARBON RESISTOR	1

△ Parts are safety assurance parts

When replacing those parts, make sure to use the specified one.

REF. NO	PARTS NO.	PARTS NAME	QTY
R705	QRD161J-222	CARBON RESISTOR	1
R352, R355	QRD161J-223	CARBON RESISTOR	13
R356, R452			
R455, R456			
R725, R726			
R728 ~ R731			
R733			
R360, R460	QRD161J-224	CARBON RESISTOR	2
R702	QRD161J-272	CARBON RESISTOR	1
R708, R715	QRD161J-333	CARBON RESISTOR	3
R716			
R723	QRD161J-470	CARBON RESISTOR	1
R701	QRD161J-471	CARBON RESISTOR	1
R709, R710	QRD161J-561	CARBON RESISTOR	2
R357, R457	QRD161J-564	CARBON RESISTOR	2
R351, R451	QRD161J-913Y	C RESISTOR	2
CT701	CSB400P	CELA LOCK	1
C710	QCF11HP-223	C. CAPACITOR	1
C707	QCS11HJ-111	C. CAPACITOR	1
C703	QCS11HJ-470	C. CAPACITOR	1
C706	QCS11HJ-471	C. CAPACITOR	1
C701, C705	QET41AR-107	E. CAPACITOR	2
C702	QET41ER-107	E CAPACITOR	1
C708, C709	QET41ER-476	E CAPACITOR	2
C351, C451	QET41HR-105	E. CAPACITOR	2
C352, C452	QET51HR-225N	E. CAPACITOR	2

Main Board Parts List

△ Parts are safety assurance parts
When replacing those parts, make sure to use the specified one.

△	REF. NO	PARTS NO.	PARTS NAME	QTY
	IC901	AN6557	I.C.	1
	IC504,IC505	BA6208A	I.C.	2
	IC907	LA2000S	I.C.	1
	IC502	LA6339	I.C.	1
	IC503	LM6402H-139	I.C.	1
	IC102,IC104	M5218L	I.C.	8
	IC202,IC204			
	IC902,IC904			
	IC905,IC906			
	IC909	M54580P	I.C.	1
	IC101,IC103	NE652N	I.C.	4
	IC201,IC203			
	IC501,IC506	TC4069UBP	I.C.	2
	IC507	TL431CLP-B	I.C. (M)	1
	IC601	UPD7564CS-040	I.C. (M)	1
	Q510 ,Q513	2SA733A(P,K)-T	TRANSISTOR	4
	Q902 ,Q908			
△	Q509	2SB772(Q,P)	SI.TRANSISTOR	1
	Q102 -Q113	2SC945L(P,K)-T	TRANSISTOR	37
	Q117 ,Q118			
	Q202 -Q213			
	Q217 ,Q218			
	Q501 -Q503			
	Q508 ,Q512			
	Q601 ,Q901			
	Q906 ,Q907			
	Q114 ,Q115	2SD1302(RST)TA	TRANSISTOR	4
	Q214 ,Q215			
△	Q507 ,Q511	2SD882(Q,P)	SI.TRANSISTOR	2
	Q101 ,Q119	2SK246(GR)E2	FET	5
	Q201 ,Q219			
	Q506			
	Q505	2SK301(R,S)TA	TRANSISTOR	1
	D921	SLR-55MC50F124	L.E.D.	1
	D919 ,D920	SLR-55URC50F124	L.E.D.	2
	D501 -D515	1SS119	SI.DIODE	36
	D521 ,D523			
	D524 ,D901			
	D903 -D906			
	D908 -D910			
	D912 -D918			
	D922 -D924			
	D601 -D606	1SS254T-77	SI.DIODE	6
	D522	10E1-B	SI.DIODE	1
△	D516 -D519	10E2-B	SI.DIODE	4
	D526 -D528	11E1-F	SI.DIODE	3
	VR901	QVM4A7X-125	V.RESISTOR	1
	VR903	QVN6A7A-014	V.RESISTOR	1
	VR101-VR103	QVZ1802-223	V.RESISTOR	8
	VR106,VR201			
	VR202,VR203			
	VR206			
	VR104,VR204	QVZ3501-473	V.RESISTOR	2
	VR902	QVZ6201-003	V.RESISTOR	1
	CN505,CN904	E04365-005	CONNECTOR	2
	CN506	E04365-007	CONNECTOR	1
	CN507,CN508	QMV5005-003	CONNECTOR	3
	CN903			
	CN502	QMV5005-004	CONNECTOR	1
	CN501,CN503	QMV5005-006	PLUG	3
	CN504			
	CN901,CN902	QMV5010-004	CONNECTOR	2
	S501 -S510	QSP0301-002	TACT SWITCH	10
	S513	QSS2301-102	SLIDE SWITCH	1
	S904	QST5102-V02	PUSH SWITCH	1
	S901 -S903	QST5341-V03	PUSH SWITCH	1
	L901	VGC0008-001	BLOCK	1
	L106 ,L206	VQP0001-183S	INDUCTOR	2
	L105 ,L205	VQP0001-332S	INDUCTOR	2
	L101 ,L201	VQP0001-562S	INDUCTOR	2
	L104 ,L204	VQZ0013-001S	FILTER	2
	L102 ,L202	VQZ0013-002S	FILTER	2
	L103 ,L203	VQZ0016-001	FILTER	2
	R572	QRD129J-4R7	C RESISTOR	1
	△R943	QRD129J-561	OMF.RESISTOR	1
△	R586 ,R945	QRD149J-4R7S	C RESISTOR	2
△	R944	QRD149J-561S	CARBON RESISTOR	1
	R106 ,R206	QRD161J-101	CARBON RESISTOR	85
	R310 ,R410			
△	R156 ,R180	QRD161J-102	CARBON RESISTOR	20
	R185 ,R256			
	R280 ,R285			
	R507 ,R539			
	R574 ,R577			
	R590 ,R592			

△	REF. NO	PARTS NO.	PARTS NAME	QTY
	R593 ,R594			
	R596 ,R598			
	R602 ,R611			
	R931 ,R962			
	R516 -R518	QRD161J-103	CARBON RESISTOR	28
	R538 ,R540			
	R541 ,R543			
	R546 -R548			
	R550 ,R553			
	R564 -R566			
	R570 ,R579			
	R581 ,R601			
	R908 ,R913			
	R922 ,R935			
	R936 ,R938			
	R939 ,R949			
	R960			
	R102 ,R142	QRD161J-105	CARBON RESISTOR	13
	R154 ,R155			
	R181 ,R195			
	R202 ,R242			
	R254 ,R255			
	R281 ,R295			
	R545			
	R506	QRD161J-122	CARBON RESISTOR	1
	R124 ,R165	QRD161J-123	CARBON RESISTOR	6
	R192 ,R224			
	R265 ,R292			
	R194 ,R294	QRD161J-151	CARBON RESISTOR	3
	R933			
	R303 ,R403	QRD161J-152	CARBON RESISTOR	4
	R612 ,R613			
	R191 ,R291	QRD161J-153	CARBON RESISTOR	12
	R305 ,R405			
	R503 ,R504			
	R510 ,R511			
	R614 ,R615			
	R623 ,R624			
	R505	QRD161J-182	CARBON RESISTOR	1
	R519 -R523	QRD161J-203	CARBON RESISTOR	5
	R120 ,R152	QRD161J-222	CARBON RESISTOR	10
	R161 ,R199			
	R220 ,R252			
	R261 ,R299			
	R537 ,R959			
	R108 ,R114	QRD161J-223	CARBON RESISTOR	27
	R184 ,R198			
	R208 ,R214			
	R284 ,R298			
	R530 ,R534			
	R551 ,R552			
	R558 -R560			
	R567 ,R607			
	R905 ,R907			
	R921 ,R924			
	R925 ,R927			
	R930 ,R946			
	R947 ,R953			
	R193 ,R293	QRD161J-224	CARBON RESISTOR	7
	R604 ,R912			
	R914 ,R928			
	R112 ,R212	QRD161J-272	CARBON RESISTOR	3
	R589			
	R138 ,R238	QRD161J-273	CARBON RESISTOR	7
	R501 ,R508			
	R617 ,R626			
	R909			
	R139 ,R239	QRD161J-332	CARBON RESISTOR	3
	R948			
	R532 ,R544	QRD161J-333	CARBON RESISTOR	8
	R549 ,R555			
	R556 ,R557			
	R562 ,R563			
	R132 ,R135	QRD161J-334	CARBON RESISTOR	9
	R173 ,R176			
	R232 ,R235			
	R273 ,R276			
	R533			
	R307 ,R407	QRD161J-390	C RESISTOR	2
	R150 ,R250	QRD161J-391	CARBON RESISTOR	2
	R149 ,R249	QRD161J-392	CARBON RESISTOR	6
	R306 ,R406			
	R513 ,R621			
	R130 ,R131	QRD161J-394	C RESISTOR	11
	R171 ,R172			

△ Parts are safety assurance parts
When replacing those parts, make sure to use the specified one.

△	REF. NO	PARTS NO.	PARTS NAME	QTY
	R196 ,R230 R231 ,R271 R272 ,R296 R952 R573 ,R954	QRD161J-470	CARBON RESISTOR	3
△	R107 ,R207 R569 ,R591 R595 ,R901 R902 ,R911	QRD161J-471	CARBON RESISTOR	10
	R916 ,R917 R109 ,R123 R153 ,R164 R186 ,R197 R209 ,R223	QRD161J-472	CARBON RESISTOR	21
	R253 ,R264 R286 ,R297 R300 ,R301 R313 ,R400 R401 ,R413			
	R531 ,R951 R958 R101 ,R111 R113 ,R121 R122 ,R125 R133 ,R134 R141 ,R151 R162 ,R163 R166 ,R174 R175 ,R179	QRD161J-473	CARBON RESISTOR	40
	R201 ,R211 R213 ,R221 R222 ,R225 R233 ,R234 R241 ,R251			
	R262 ,R263 R266 ,R274 R275 ,R279 R302 ,R304 R402 ,R404			
	R568 ,R603 R606 ,R934 R119 ,R160 R219 ,R260	QRD161J-512	CARBON RESISTOR	4
△	R575 ,R576	QRD161J-561	CARBON RESISTOR	3
	R578 R311 ,R312 R411 ,R412 R103 ,R203 R143 ,R243	QRD161J-562	CARBON RESISTOR	4
	R104 ,R182 R183 ,R204 R282 ,R283 R314 ,R414 R526 ,R528	QRD161J-564 QRD161J-681 QRD161J-682	CARBON RESISTOR CARBON RESISTOR CARBON RESISTOR	2 2 17
	R605 ,R904 R906 ,R919 R920 ,R961 R118 ,R159 R218 ,R259	QRD161J-683	CARBON RESISTOR	4
	R126 ,R167 R226 ,R267	QRD161J-753	CARBON RESISTOR	4
	R105 ,R205 R502 ,R509 R536 ,R616	QRD161J-822	CARBON RESISTOR	7
	R625 R127 ,R129 R168 ,R170 R190 ,R227 R229 ,R268 R270 ,R290	QRD161J-823	CARBON RESISTOR	14
	R542 ,R580 R903 ,R910			
△	R583 ,R585	QRX019J-5R6	M.F.RESISTOR	2
△	R584	QRX019J-8R2	M.F.RESISTOR	1
	CF601 CT501	CSB400P CSB800A	CELA LOCK LOCK	1 1
	C504 ,C505 C508 ,C513 C522 ,C525 C526 ,C905 C906 ,C912 C913 ,C915 C922 ,C933 C502 ,C503	QCF11HP-103	C.CAPACITOR	19
		QCS11HJ-101	C.CAPACITOR	2

△	REF. NO	PARTS NO.	PARTS NAME	QTY
	C102 ,C111 C202 ,C211 C155 ,C255 C173 ,C273 C601 ,C602	QCS11HJ-151 QCS11HJ-220 QCS11HJ-221	C.CAPACITOR C.CAPACITOR C.CAPACITOR	4 2 4
	C162 ,C262 C518 C101 ,C109 C201 ,C209 C172 ,C272	QCS11HJ-470 QCS11HJ-471 QCS32HJ-151ZV	C.CAPACITOR C.CAPACITOR C.CAPACITOR	3 4 2
	C170 ,C270 C115 ,C118 C139 ,C141 C156 ,C215 C218 ,C239	QEN41EM-475 QEN61EM-106Z	NP.E.CAPACITOR NP.E.CAPACITOR	2 10
	C241 ,C256 C104 ,C119 C131 ,C142 C143 ,C204 C219 ,C231	QEN61HM-105Z	NP.E.CAPACITOR	10
	C242 ,C243 C105 ,C205 C516 ,C517 C519 ,C520 C603 ,C901	QET41AR-107	E.CAPACITOR	17
	C902 ,C916 C917 ,C919 C921 ,C931 C934 ,C935 C527	QET41AR-337	E.CAPACITOR	1
	C908 ,C909 C923 ,C932 C514 ,C515 C124 ,C125 C148 ,C149	QET41AR-476 QET41ER-106 QET41ER-228 QET41HR-104	E CAPACITOR E.CAPACITOR E.CAPACITOR E CAPACITOR	2 2 2 8
	C224 ,C225 C248 ,C249 C930 C123 ,C147 C223 ,C247 C929	QET41HR-105 QET41HR-154	E.CAPACITOR E CAPACITOR	1 5
	C501 ,C506 C507 ,C910 C911 ,C920 C523	QET41HR-475	E.CAPACITOR	6
△	C160 ,C260 C171 ,C271 C108 ,C132 C133 ,C208 C232 ,C233	QET51AR-109N QFN41HJ-102 QFN41HJ-122 QFN41HJ-152	E.CAPACITOR M.CAPACITOR M.CAPACITOR M CAPACITOR	1 2 2 6
	C925 C116 ,C117 C138 ,C140 C216 ,C217 C238 ,C240 C927	QFN41HJ-272 QFN41HJ-472	M.CAPACITOR M.CAPACITOR	1 9
	C103 ,C203 C112 ,C136 C212 ,C236 C107 ,C207 C167 ,C168 C267 ,C268 C127 ,C151 C161 ,C227 C251 ,C261	QFN41HJ-822 QFV41HJ-103 QFV41HJ-183 QFV41HJ-223 QFV41HJ-224	M CAPACITOR TF.CAPACITOR TF.CAPACITOR TF.CAPACITOR TF.CAPACITOR	2 4 2 4 7
	C928 C113 ,C122 C126 ,C137 C146 ,C150 C169 ,C213 C222 ,C226 C237 ,C246 C250 ,C269 C121 ,C145 C221 ,C245	QFV41HJ-333 QFV41HJ-473	TF CAPACITOR TF.CAPACITOR	14 4
	C120 ,C144 C220 ,C244 C106 ,C206 C926 C164 ,C166 C264 ,C266 J601 J1 J2 J4	QFV41HJ-683 QFV71HJ-123ZM QFV71HJ-153ZM	TF CAPACITOR T.F.CAPACITOR T.F.CAPACIROR	4 3 4
	FW62 FW61	QMS3533-001 QWE351-164K4K QWE352-164K4K QWE354-224K4K VWS302-164K4K VWS302-254K4K	JACK UL VINYL WIRE UL VINYL WIRE UL VINYL WIRE UL CP JUMPER UL CP JUMPER	1 1 1 1 1 1

1 2 3 4 5 6 7 8 9 10

A B C D E F G

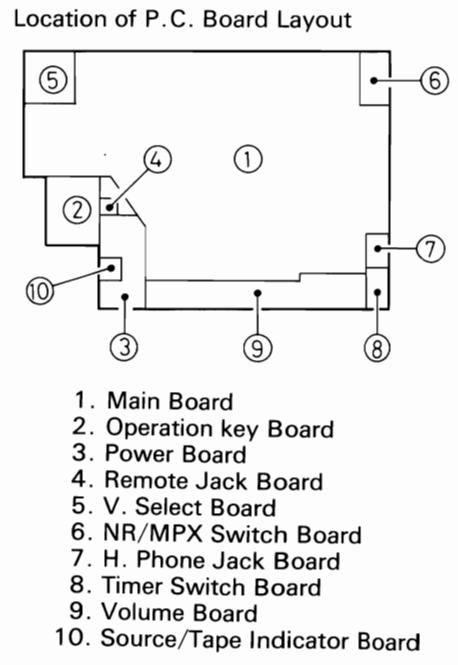
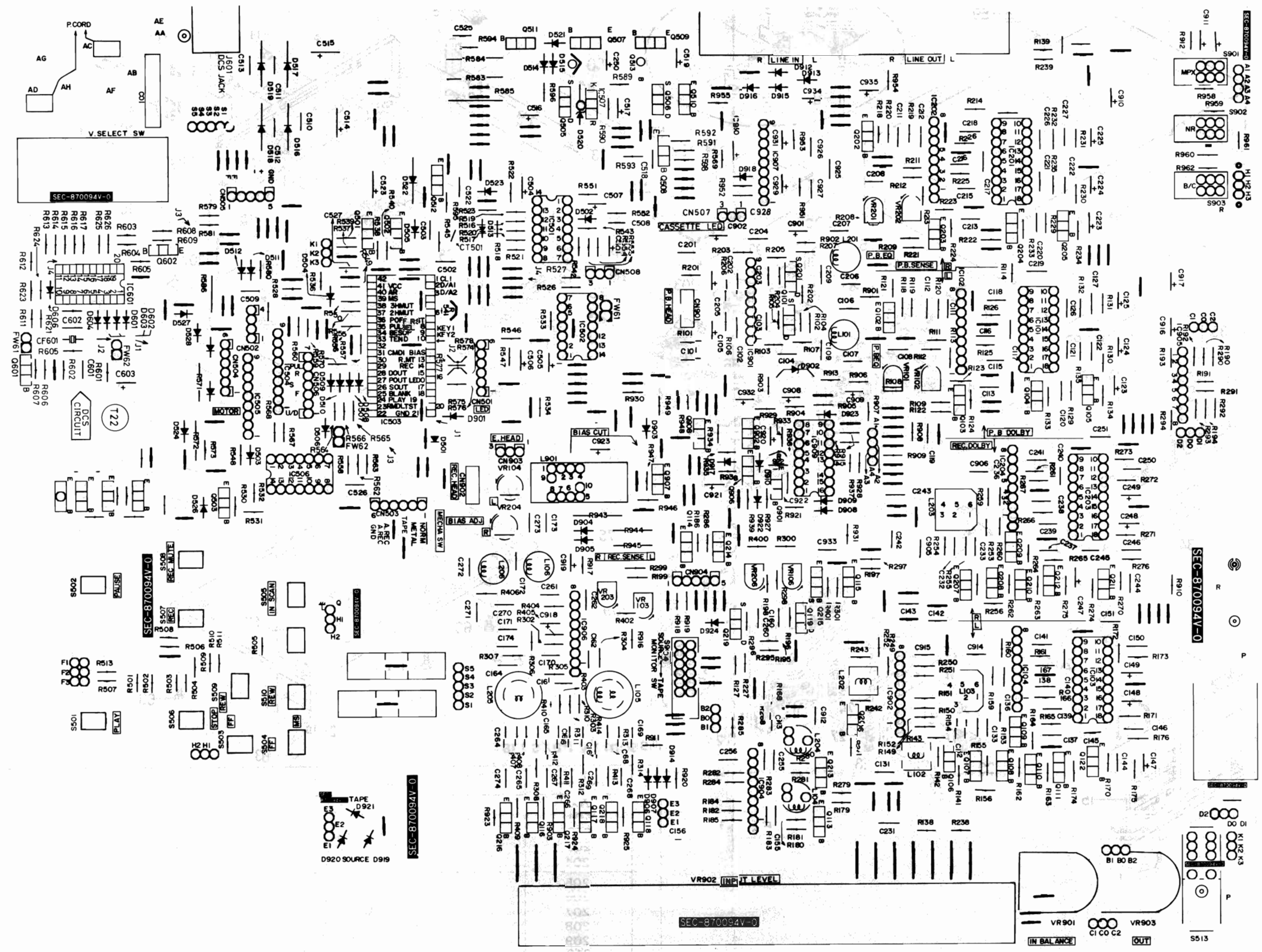

Fig. 7-2

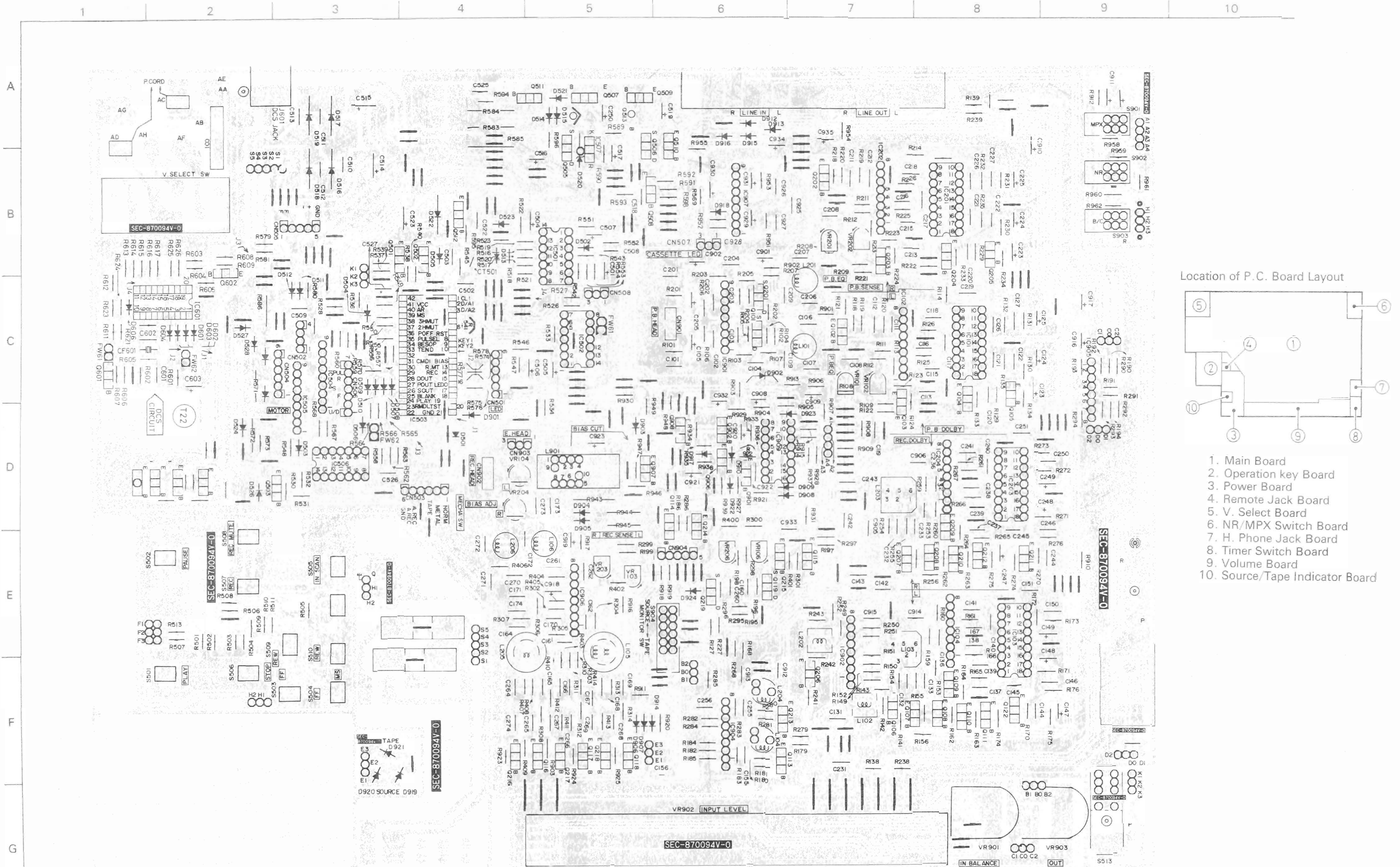

Fig. 7-2

8 Exploded View of Enclosure Assembly

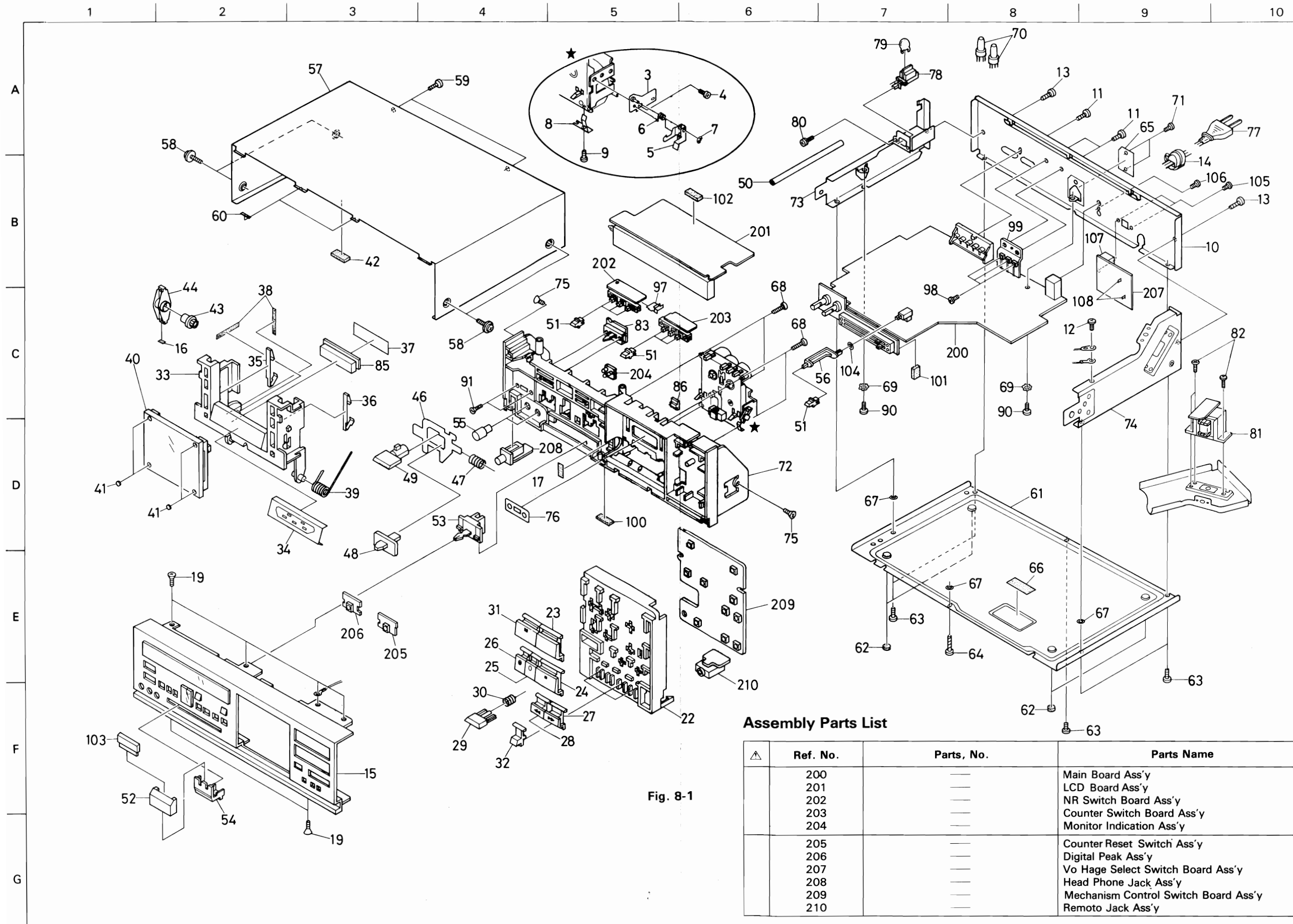

Fig. 8-1

Assembly Parts List

△	Ref. No.	Parts, No.	Parts Name	Q'ty
	200	—	Main Board Ass'y	1
	201	—	LCD Board Ass'y	1
	202	—	NR Switch Board Ass'y	1
	203	—	Counter Switch Board Ass'y	1
	204	—	Monitor Indication Ass'y	1
	205	—	Counter Reset Switch Ass'y	1
	206	—	Digital Peak Ass'y	1
	207	—	Vo Hage Select Switch Board Ass'y	1
	208	—	Head Phone Jack Ass'y	1
	209	—	Mechanism Control Switch Board Ass'y	1
	210	—	Remoto Jack Ass'y	1

Enclosure Parts List

△ Parts are safety assurance parts
When replacing those parts, make sure to use the specified one.

△ REF	PARTS NO.	PARTS NAME	REMARKS	QTY
3	VKL5324-00B	BRACKET		1
4	SDST2604Z	SCREW		1
5	VKL3491-002	EJECT LEVER		1
6	VKW4396-002	SPRING		1
7	REE2500	E.RING		1
8	VKY4296-001	SPRING		1
9	SDST2603Z	SCREW		1
10	VJC2127-012	REAR PANEL	TD-V66C/J	1
	VJC2127-013	REAR PANEL	TD-V66A/B/E/G/U	1
11	SDSF3008N	SCREW	FOR HEAT SINK	2
	SDSF3008N	SCREW	FOR PIN JACK	1
12	SDST3006Z	SCREW	FOR LUG	1
13	SDST3006N	SCREW	FOR REAR PANEL	2
△ 14	QHS3876-162	S.R.BUSHING	TD-V66A/C/E/G/J/U	1
△ 14	QHS3876-162BS	S.R.BUSHING	TD-V66B	1
15	ZCTDV66Y-FBK	FRONT PLATE ASS'Y		1
16	VYSS1R3-011	SPACER		1
17	VYSA1R8-029	SPACER		1
19	SSSF3008Z	SCREW		6
22	VJD2210-001	P.BUTTON CASE		1
23	VXP3098-003	PUSH BUTTON	FOR PLAY	1
24	VXP3098-004	PUSH BUTTON	FOR STOP	1
25	VXP3099-001	PUSH BUTTON	FOR REC	1
26	VXP3099-002	PUSH BUTTON	FOR REC MUTE	1
27	VXP3100-004	PUSH BUTTON	FOR FF	1
28	VXP3100-003	PUSH BUTTON	FOR REW	1
29	VXP4349-00A	PUSH BUTTON		1
30	VKW3001-063	COMP SPRING		1
31	VXP3102-002	PUSH BUTTON	FOR PAUSE	1
32	VXP4348-001	PUSH BUTTON	FOR IS/BS/MS	3
33	VJT2121-001	CASSETTE HOLDER		1
34	VJD4953-001	LID PLATE		1
35	VKY4271-007	C.SPRING		1
36	VKY4271-008	C.SPRING		1
37	VYSA1R4-066	SPACER		1
38	FO0303-34	SPACER		2
39	VKW3006-091	SPRING		1
40	VJT4116-00B	CASSETTE LID		1
41	VJD4954-001	ESCUTCHEON		4
42	VYSR103-019	SPACER		1
43	VYH5133-002	GEAR		1
44	VYH5134-002	DAMPER HOLDER		1
46	VKL5490-002	BRACKET		1
47	VKW3001-077	C.SPRING		1
48	VXS4041-005	SLIDE KNOB		1
49	VXP4345-001	PUSH BUTTON		1
50	VKS4003-008	PIPE		1
51	VXP4346-001	PUSH BUTTON		7
52	VXS4175-001	SLIDE KNOB	FOR INPUT	1
53	VKS3184-002	SLIDE LEVER		1
54	VKS3265-001	LEVER		1
55	VXL4181-005	KNOB		2
56	VYH5139-002	ARM		1
57	VJC2101-005	TOP COVER		1
58	VKZ3001-004	SPECIAL SCREW		4
59	SDST3006N	SCREW		2
60	VYSA1R8-027	SPACER		2
61	VJC1195-010	BOTTOM COVER		1

△ REF	PARTS NO.	PARTS NAME	REMARKS	QTY
62	VJF4003-002	FOOT		4
63	SDST3006Z	SCREW		5
64	SBSF3010Z	SCREW		1
65	VYN2167-002KA	NAME PLATE	TD-V66B	1
	VYN2167-003KA	NAME PLATE	TD-V66A	1
	VYN2167-004KA	NAME PLATE	TD-V66C	1
	VYN2167-005KA	NAME PLATE	TD-V66E	1
	VYN2167-006KA	NAME PLATE	TD-V66J	1
	VYN2167-007KA	NAME PLATE	TD-V66U	1
	VYN2167-008KA	NAME PLATE	TD-V66G	1
66	VYSA1R4-071	SPACER		1
67	VYSS201-006	SPACER		3
68	SBSF3010Z	SCREW		4
69	WBS3000N	WASHER	FOR P.C.BOARD	2
△ 70	VMC0044-001	CONNECTOR	TD-V66C/J	2
71	SDST3006N	SCREW	FOR NAME PLATE	2
72	VJC1311-001	FRONT PANEL		1
73	VKL3488-001	AMP.CHASSIS(L)		1
74	VKL3494-001	AMP.CHASSIS(R)		1
75	SSST3006Z	SCREW	FOR FRONT PANEL	2
76	VJD4437-004	DISK PLATE		1
△ 77	QMP1200-200	POWER CORD	TD-V66C/J	1
△ 77	QMP2560-200	POWER CORD	TD-V66A	1
△ 77	QMP3900-200	POWER CORD	TD-V66E/G/U	1
△ 78	QMP9017-008BS	AC CORD	TD-V66B	1
△ 78	QSP1110-305	PUSH SWITCH	TD-V66A/E/G	1
△ 78	QSP1110-305BS	PUSH SWITCH	TD-V66B	1
△ 78	QSP1110-308	PUSH SWITCH	TD-V66C/J	1
△ 79	QCZ9014-103	C.CAPACITOR	TD-V66C/J	1
	QFZ9010-103	M.CAPACITOR	TD-V66A/B/E/G	1
80	LPSP3006Z	SCREW	FOR POWER SWITCH	1
△ 81	VTP57A5-021B	POWER TRANSF.	TD-V66C/J	1
△ 81	VTP57C5-021B	POWER TRANSF.	TD-V66A/E/G	1
△ 81	VTP57C5-021BBS	POWER TRANSF.	TD-V66B	1
82	SDST3006Z	SCREW	FOR P.TRANSFORMER	3
85	SLA-5641-25	L.E.D		1
△ 86	LD-702YU	L.E.D		1
90	SDST3006Z	SCREW	FOR P.C.BOARD	2
91	SSSP2606Z	SCREW	FOR TIMER SWITCH	2
97	VMA4194-001	SHIELD PLATE	FOR S901	1
98	DPSP3008Z	SCREW		3
99	VMH4006-002	HEAT SINK		1
100	VYSS1R5-012	SPACER		1
101	VYSR110-011	SPACER		1
102	VYSR105-004	SPACER		1
103	VJD4955-002	FINDER		1
104	Q03093-502	WASHER		1
105	SDSP3006N	SCREW	FOR V.SELECT	2
106	SDSF3008N	SCREW	FOR SYNCHRO	1
△ 107	QSS2325-203	SLIDE SWITCH	TD-V66A/E/G	1
△ 108	QSS2325-203BS	SLIDE SWITCH	TD-V66B	1
	VMZ0034-002	TAB	TD-V66A/B/E/G/U	2

9 Exploded View of Mechanism Assembly

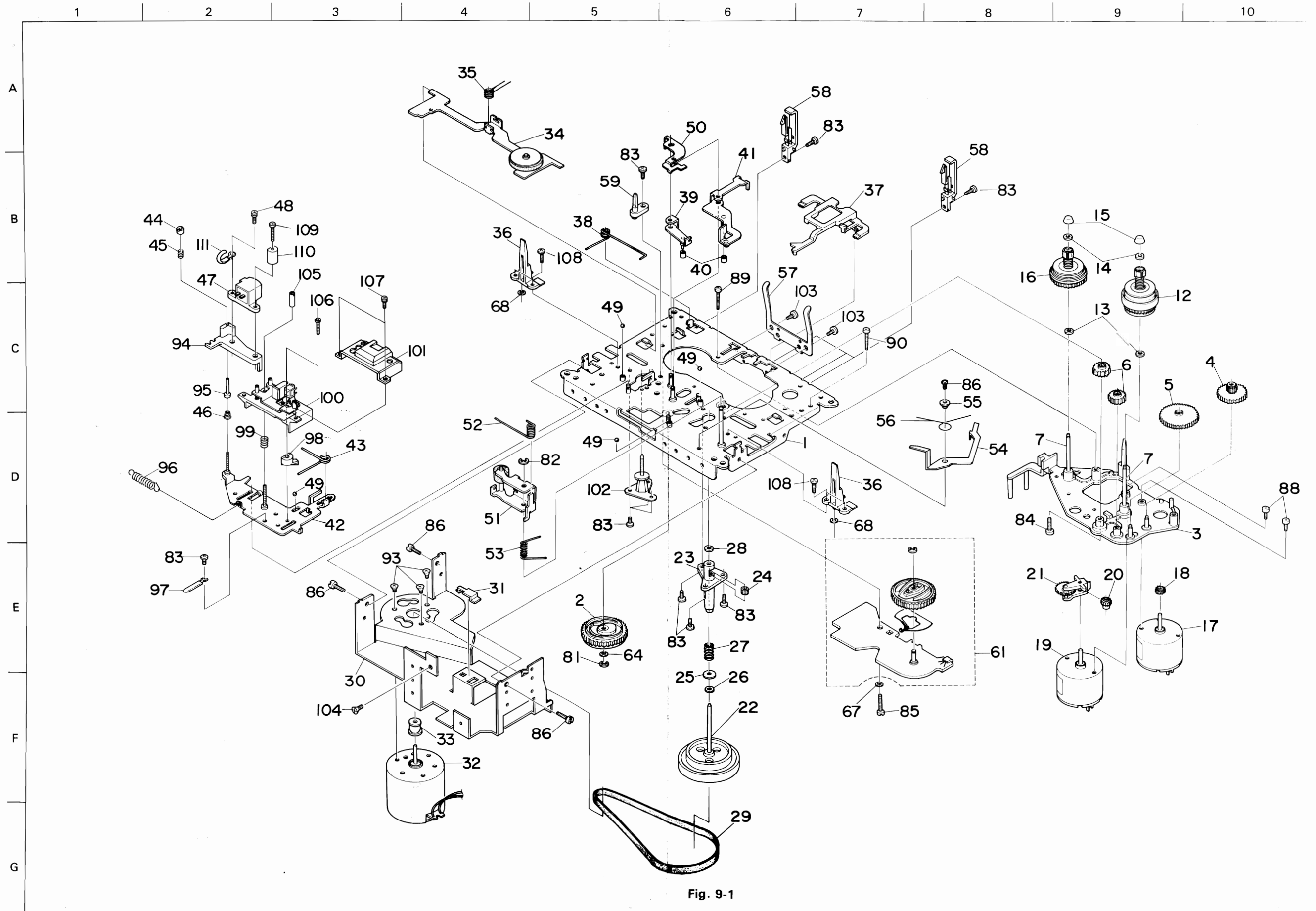

Fig. 9-1

Mechanism Parts List

△ Parts are safety assurance parts
When replacing those parts, make sure to use the specified one.

△	REF.	PARTS NO.	PARTS NAME	REMARKS	QTY
	1	VKL2175-00D	CHASSIS BASE		1
	2	VKS2122-001	P.ROLLER CAM		1
	3	VKL2174-002	DISK BASE		1
	4	VKR3001-001	GEAR(2)		1
	5	VKR3001-002	GEAR(2)		1
	6	VKR3000-001	GEAR(1)		2
	7	VKH4188-002	REEL SHAFT		2
	12	VKR4449-00A	T-UP REEL ASS'Y		1
	13	VKZ4003-010	FELT	BACK TENSION	1
		VKZ4003-010	FELT	BACK TENSION	1
	14	VKR4170-001	RING		1
		VKR4170-001	RING		1
	15	VKS4131-001	REEL STOPPER		1
		VKS4131-001	REEL STOPPER		1
	16	VKR4450-00A	S.REEL ASS'Y		1
	17	MMN-6C2RK	DC MOTOR	CAM	1
	18	VKR4326-001	MOTOR GEAR	CAM MOTOR	1
	19	MMN-6C2RK	DC MOTOR	REEL	1
	20	VKR3000-003	GEAR(1)	REEL MOTOR	1
	21	VKS4503-00C	F/R ASS'Y		1
	22	VKF3141-00A	FYWHEEL ASS'Y		1
	23	VKF4122-00A	C.METAL ASS'Y		1
	24	VKR4180-002	ROLLER	TAKE-UP	1
	25	Q03093-622	WASHER	THRUST	1
	26	Q03093-827	WASHER	THRUST	1
	27	VKW3001-010	SPRING	THRUST	1
	28	Q03093-522	WASHER	OIL CUT	1
	29	VKB3001-030	BELT		1
	30	VKL3726-001	F.M.BRACKET		1
	31	VKS4437-001	THRUST PLATE		1
△	32	BFA2L74-B	DC MOTOR	CAPSTAN	1
	33	VKR4317-002	MOTOR PULLEY		1
	34	VKL3411-00C	T-UP IDLER ASSY		1
	35	VKW3006-099	TORSION SPRING	TAKE-UP	1
	36	VKS4505-004	CASSETTE GUIDE		2
	37	VKS3162-003	BRAKE BAR		1
	38	VKW4597-002	TORSION SPRING	BRAKE BAR	1
	39	VKL5316-00B	HEAD BASE ARM		1
	40	VKH3000-058	COLLAR		1
		VKH3000-058	COLLAR		1
	41	VKL3421-00A	PINCH R.LEVER		1
	42	VKL3493-00C	HEAD BASE ASS'Y		1
	43	VKW4467-001	TORSION SPRING		1
	44	VKH4240-001	ADJUST SCREW		1
	45	VKW3001-040	C.SPRING		1
	46	VKW4430-001	C.SPRING		1
	47	VGH0212-103	ERASER HEAD		1
	48	LPSP2012Z	SCREW	E.HEAD	1
	49	T41615-004	STEEL BALL	FOR HEAD BASE	4
	50	VKY4278-002	PLATE	FOR HEAD BASE	1
	51	VKP4131-00C	P.R.ARM ASS'Y		1
	52	VKW3006-056	TORSION SPRING	PINCH ROLLER	1
	53	VKW3006-057	TORSION SPRING	RETURN	1
	54	VKL5553-001	DOOR SAFETY		1

△ Parts are safety assurance parts
When replacing those parts, make sure to use the specified one.

△ REF.	PARTS NO.	PARTS NAME	REMARKS	QTY
55	VKH4418-001	COLLAR	DOOR SAFETY	1
56	VKW3006-061	TORSION SPRING	DOOR SAFETY	1
57	VKY4279-001	PACK SPRING		1
58	VSH1124-002	LEAF SWITCH		4
59	VKS4512-002	GUIDE		1
61	VKZ3111-00A	SWITCH	CAM SWITCH ASS'Y	1
64	Q03093-834	WASHER	P.ROLLER CAM	1
67	WNS2600N	WASHER	CAM SWITCH	1
68	13270412BT	WASHER	CASSETTE GUIDE	2
81	REE2000	E.RING	P.ROLLER CAM	1
82	REE2500	E.RING	PINCH ROLLER	1
83	SDST2605Z	SCREW	GUID POST	1
	SDST2605Z	SCREW	C.METAL/TENSION	6
	SDST2605Z	SCREW	LEAF SWITCH	4
	SDST2605Z	SCREW	WIRE HOLDER	1
84	SDST2608Z	SCREW	D.BASE UNIT	1
85	SDST2612Z	SCREW	D.BASE UNIT	1
86	SDST2605Z	SCREW	DOOR SAFETY	1
	SDST2605Z	SCREW	F.M.BRACKET	3
88	DPSP2608Z	SCREW	REEL MOTOR	1
	DPSP2608Z	SCREW	CAM/REEL MOTOR	1
89	SPSP2613Z	SCREW	REEL MOTOR	1
90	SPSP2615Z	SCREW	CAM MOTOR	1
93	SSSP2604Z	SCREW	CAPSTAN MOTOR	3
94	VKF4110-001	E.HEAD LEVER		1
95	VKH3001-041	FLANGE COLLAR		1
96	VKW3002-138	TENSION SPRING		1
97	VKZ4001-007	WIRE HOLDER		1
98	VKS4536-002	HEAD COLLAR		1
99	VKW3001-094	SPRING		1
101	VKZ3110-001	HEAD COVER		1
102	VKS4598-00A	TENSION HOLDER	TENSION	1
103	SDST2604Z	SCREW	PACK SPRING	2
104	SSST2605Z	SCREW	F M BRACKET	1
105	VKH4411-001	AZIMATH SCREW		1
106	SPSX2010N	SCREW		1
107	LPSP2004Z	SCREW	HEAD COVER	2
108	SDST2606Z	SCREW	CASSETTE GUIDE	4
109	LPSP2005Z	SCREW	E.HEAD	1
110	VKH4874-001	COLLAR (R)	E.HEAD	1

10 Packing and Packing Parts List

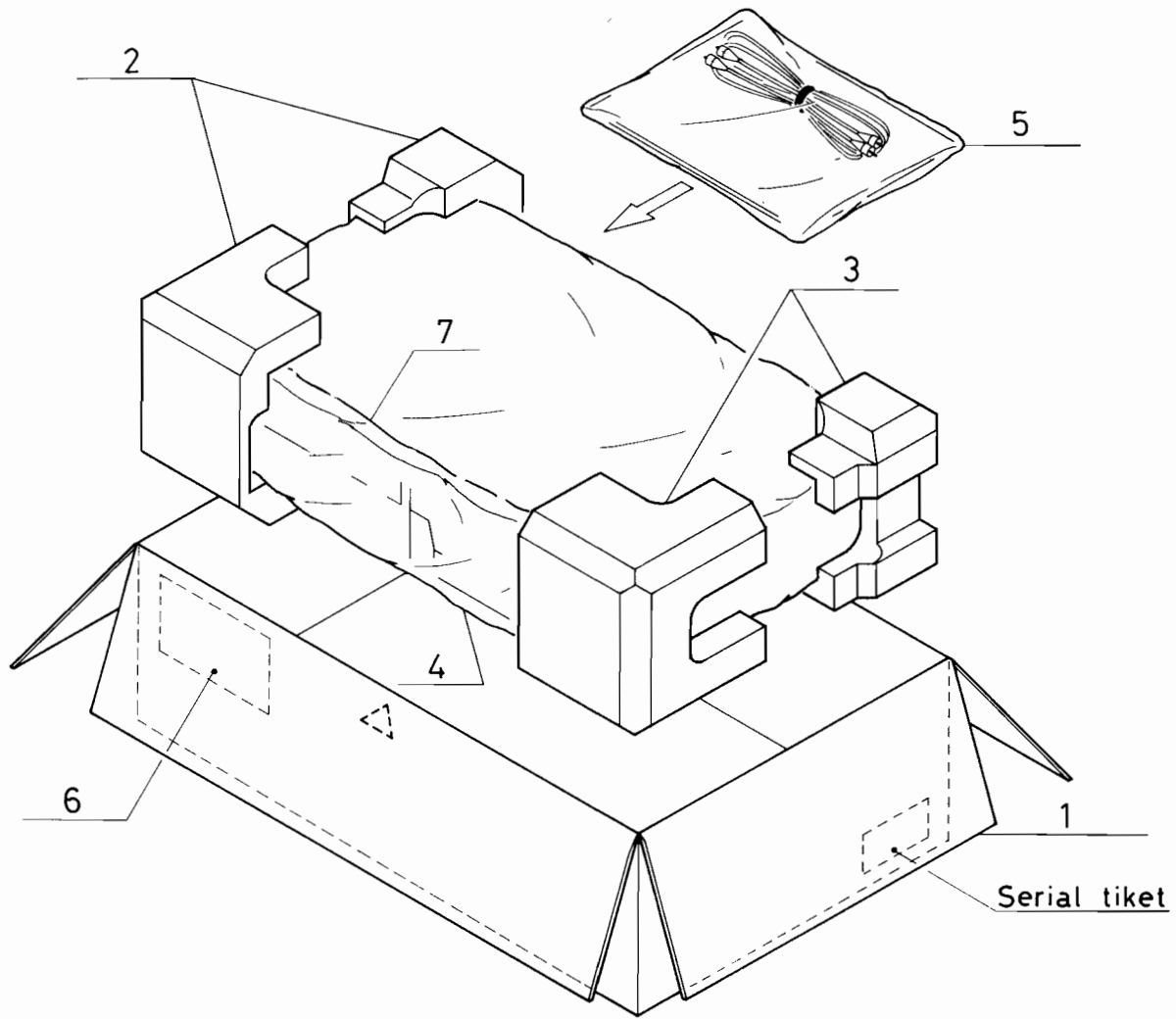



Fig. 10-1

Ref. No.	Parts No.	Parts Name	Remarks	Q'ty
1	TPC2167-002	Carton	TD-V66B	1
"	VPC2167-003	"	TD-V66A	1
"	VPC2167-004	"	TD-V66C	1
"	VPC2167-005	"	TD-V66E	1
"	VPC2167-006	"	TD-V66J	1
"	VPC2167-007	"	TD-V66U	1
"	VPC2167-008	"	TD-V66G	1
2	VPH3125-001	Cushion	Left side	1
3	VPH3126-001	Cushion	Right side	1
4	VPE3005-026	Poly bag	for unit	1
5	VPE3005-007	Poly bag	for Inst. Book	1
6	E66416-003	Envelope	TD-V66J/U(PX, EES) for warranty card	1
7	VPK4002-006	Sheet	for unit	1
	Q04141H	Wire clamp	for power card	1

11 Accessories

	Parts No.	Parts Name	Remarks	Q'ty
	VNN2167-211	Instruction Book	TD-V66 B/E/G	1
	VNN2167-621	"	TD-V66 A/C/J/U	1
	VNN2167-411	"	TD-V66 E (Netherlands/Belgium)	1
	BT20060	Warranty Card	TD-V66 B	1
	BT20066	"	TD-V66 B/G (for JED)	1
	BT20029C	"	TD-V66 A	1
	BT20025H	"	TD-V66 C	1
	BT20047C	"	TD-V66 J/U (for PX, EES)	1
	BT20064	"	TD-V66 G (for JED)	1
	BT20071A	Service Center List	TD-V66 C	1
	BT20046B	Special Reply Card	TD-V66 J/U	1
	BT20044E	Safety Guide	TD-V66 J	1
	VNC1200-002	Copyright Law Warning	TD-V66 C	1
	VNC5311-203	Caution Card	TD-V66 U (for EES)	1
	VNC5311-204	Caution Card	TD-V66 U (for PX)	1
	VNC2200-013	Instruction Sheet	TD-V66 G	1
	VMP0039-00A	Pin Cord		1
	EWP805-001	Remote Wire		1
	V04062-001	Simens Plug (2)	TD-V66 U	1

JVC

VICTOR COMPANY OF JAPAN, LIMITED.
 AUDIO PRODUCTS DIVISION MAEBASHI PLANT 10-1, 1-chome, Ohwatari-cho, Maebashi-city 371, Japan