

SPECIFICATIONS

- AMPLIFIER SECTION**
- Power Output:** 30 W (EIAJ Distortion 5%)
Distortion 50 W/5% 44 W/1% (IHF music power)
- Frequency Response:** 40 ~ 20,000 Hz
- Input and Sensitivity**
- Phono: 2 mV (50 kΩ)
 - Tape Play: 200 mV (50 kΩ)
 - Mic: 4 mV (20 kΩ)
- Tone Control**
- Bass: 100 Hz ± 7.5 dB
 - Treble: 10 kHz ± 7.5 dB
 - Loudness: 100 Hz ± 6.5 dB
- S/N**
- Phono: More than 65 dB
 - Mic: More than 70 dB
 - Tape Play: More than 75 dB

- TUNER SECTION**
- Frequency Range**
- FM: 88 ~ 108 MHz
 - AM: 520 ~ 1,610 kHz
- Sensitivity**
- FM: 2.5 μV (S/N 30 dB)
 - AM: 15 μV (S/N 20 dB)
 - S/N: More than 70 dB
- FM Antenna Impedance:** 300 Ω Balanced
- FM Separation:** More than 35 dB (1 kHz)
- Dimensions:** H 132 mm
W 456 mm
D 348 mm

- TURNTABLE SECTION**
- Drive System:** Belt drive automatic turntable
- Automatic mechanism:** Auto-return, Auto-cut
- Motor:** 4-poles synchronous
- Turntable platter:** 12 inches zinc die-cast alloy
- Speed:** 2 speeds, 33-1/3 and 45 rpm
- Wow and Flutter:** Less than 0.07 %
- Tonearm:** Static Balance Type. Pipe arm, Plug-in. Direct-reading stylus force gauge
- Cartridge:** V-47
- Stylus:** Diamond
- Stylus Force:** 2 g
- Replacement Stylus:** N-47
- Dimensions:** H 149 mm
W 456 mm
D 347 mm

- SPEAKER SECTION**
- Front speaker**
- Woofer: 8 inches cone type
 - Tweeter: 2-3/4 inches Cone type
- Frequency Response:** 50 ~ 20,000 Hz
- Enclosure:** Bass reflex
- Impedance:** 8 Ω
- Dimensions:** H 570 mm
W 272 mm
D 223 mm

- STEREO UNIT**
- Power Supply:** AC 110 ~ 120V/220 ~ 240V
- Total Weight:** 27.6 kg (60.72 lbs)

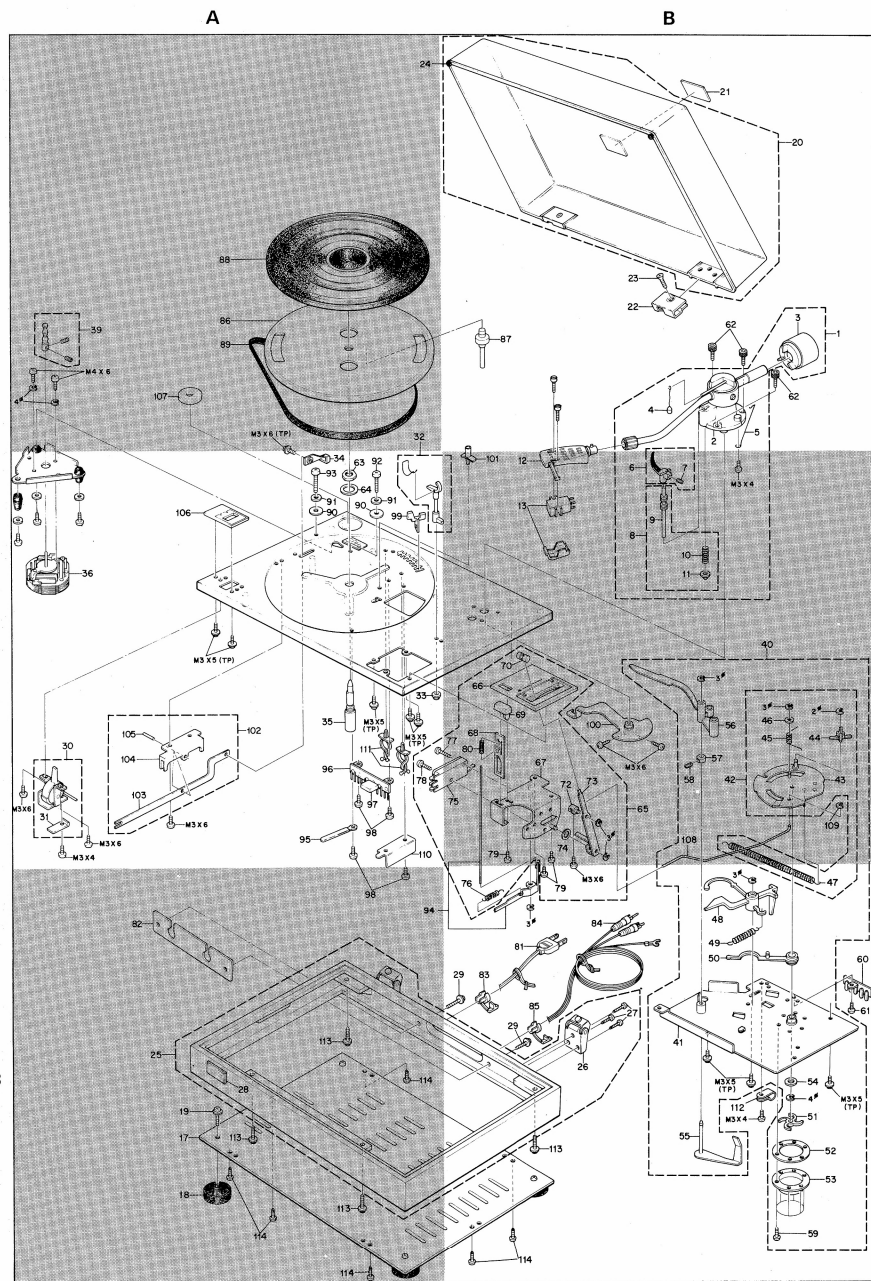

☆: New Parts

Fig. No.	Parts No.	Description	Re- marks
1	J91-0094-05	Tonearm ass'y	☆ 1B
2	J91-0084-05	Tonearm	1B
3	D91-0044-08	Main weight ass'y	1B
4	D91-0045-08	Canceller weight ass'y	1B
5	J91-0483-08	Bias rod	1B
6	D39-0047-08	Tonearm support ass'y	2B
7	N73-2604-41	Mounting screw	2B
8	D21-0423-08	Elevation shaft ass'y	☆ 2B
9	D21-0424-08	Elevation shaft	☆ 2B
10	G01-0347-08	Compression spring	☆ 2B
11	F99-0013-08	Tip	☆ 2B
12	J92-0021-05	Shell ass'y	2B
13	T21-0051-05	Cartridge (V-47)	2B
14	N09-0265-05	Cartridge mounting screw (M2.6 x 6)	1B
15	—	—	—
16	—	—	—
17	A40-0157-13	Bottom board	☆ 3A
18	J02-0307-05	Insulator	☆ 3A
19	N09-0514-05	TP screw (M4 x 10)	☆ 3A
20	A53-0026-02	Turntable cover	☆ 1B
21	B44-0028-14	Turntable cover sticker	1B
22	J50-0048-05	Hinge (A)	1B
23	N33-4008-13	Flat head screw (M4 x 8)	1B
24	G13-0405-04	Cushion	1A
25	A03-0210-22	Turntable case ass'y (M, S, W type)	☆ 3A
	A03-0504-02	Turntable case ass'y (X type)	☆ 3A
26	J50-0301-05	Hinge (B) (M, S, W type)	☆ 3B
	J50-0302-05	Hinge (B) (X type)	☆ 3B
27	N61-3113-41	Round head wood screw	3B
28	B43-0512-04	KENWOOD badge	3A
29	N09-0531-05	TP screw (M3 x 20)	3B
30	D12-0085-04	Operation lever ass'y	☆ 2A
31	G02-0070-04	Plate spring	2A
32	D39-0059-03	Tonearm rest	1A
33	N09-0404-04	Special nut	2A
34	D10-0225-24	Speed selector guide	2A
35	D23-0140-04	Turntable platter bearing ass'y	2A
36	T41-0102-05	Motor	2A
37	—	—	—
38	—	—	—
39	—	—	—
40	D15-0162-04	Motor pulley (50 Hz), D15-0163-04 (60 Hz)	1A
	D40-0211-12	Return operation ass'y	☆ 2B
41	A10-0498-23	Mechanism chassis caked ass'y	☆ 3B
42	D12-0082-04	Center cam ass'y	☆ 2B
43	D12-0083-14	Center cam caked ass'y	☆ 2B
44	D12-0073-14	Cross cam	2B
45	G01-0282-14	Cross cam spring	2B
46	N15-1040-11	Flat head washer	2B
47	G01-0283-04	Return spring	3B
48	D11-0184-15	Center arm	3B
49	G01-0291-04	Center arm spring	3B
50	D10-0244-04	Rest arm	☆ 3B
51	D19-0046-04	Control runner	3B
52	G50-0014-04	Packing	3B
53	F07-0362-14	Oil pan	3B
54	G53-0041-05	Mini packing	3B
55	D10-0423-04	Detecting operation arm ass'y	☆ 3B
56	D10-0247-04	Detection arm	2B
57	J31-0402-04	Sleeve	2B
58	N72-2604-46	Special screw (M2.6 x 4)	2B
59	N30-3006-46	Pan head screw (M3 x 6)	3B
60	E22-0416-05	Lug	3B
61	N87-3006-46	Tap tight screw (M3 x 6)	3B
62	N09-0271-04	Bolt with hex. hole	1B
63	N14-0048-14	Nut	2A
64	N19-0142-04	Washer	2A
65	D40-0212-33	Operation ass'y	☆ 2B
66	A21-0269-13	Dress panel (C)	☆ 2B
67	D10-0260-14	Mechanism chassis caked ass'y	☆ 2B
68	D19-0053-04	Slide plate	☆ 2B
69	K29-0279-14	Cut button	☆ 2B
70	K29-0280-14	Play knob	☆ 2B
71	—	—	—

Fig. No.	Parts No.	Description	Re- marks
72	D23-0145-04	Rod bearing	☆ 2B
73	D10-0248-14	Play lever	☆ 2B
74	N19-0020-04	Poly washer	2B
75	S50-2002-05	Micro switch	2B
76	G01-0350-04	Tension spring	☆ 3B
77	N09-0195-14	Polycarbonate screw (M3 x 14)	2B
78	N30-3014-46	Pan head screw (M3 x 14)	2A
79	N87-3008-46	Tap tight screw (M3 x 8)	2B
80	G01-0348-04	Compression spring	☆ 2B
81	E30-0459-05	Power cord (W type)	3B
	E30-0545-05	Power cord (M type)	3B
	E30-0185-05	Power cord (X type)	3B
	040-0306-05	Power cord (S type)	3B
82	J19-1201-04	Cord stopper (X, S, W type)	☆ 3A
	J19-0502-04	Cord stopper (M type)	3A
83	J41-0017-05	Cord bushing (W type)	3B
	J41-0024-05	Cord bushing (X, S type)	3B
	J41-0006-00	Cord bushing (M type)	3B
84	E30-1303-05	Audio cable	3B
85	J41-0017-05	Cord bushing	3B
86	D02-0019-05	Turntable platter	☆ 1A
87	D19-0032-04	Trip pin	1B
88	G16-0050-12	Turntable sheet	1A
89	D16-0057-03	Drive belt	1A
90	B59-0020-04	Shipping screw caution card	2A
91	N15-1040-46	Washer	2A
92	N30-4012-46	Screw (M4 x 12)	2A
93	N30-4020-46	Screw (M4 x 20)	2A
94	D10-0249-03	Cut lever	☆ 3A
95	J19-0306-05	Lead crammer	2A
96	E22-0421-05	Lug	2A
	R90-0101-05	CR Parts	2A
97	N87-3006-46	Tap tight screw (M3 x 6)	2A
98	N87-3006-46	Return spring adjust knob	2A, 3A
99	K29-0221-14	Return arm ass'y	2B
100	D11-0199-14	—	—
101	K29-0229-15	Detecting adjust knob	2B
102	D10-0271-04	Speed selector lever ass'y	☆ 2A
103	D10-0224-04	Speed selector lever	2A
104	D23-0150-04	Bearing	☆ 2A
105	D21-0410-04	Shaft	2A
106	B03-0114-04	Dress panel (B)	2A
107	W01-0057-04	EP adapter	1A
108	D10-0428-04	Operation rod	☆ 2B
109	N24-3015-60	E washer (1.5φ)	2B
110	D21-2201-04	L shaped hardware	☆ 2A
111	J11-0021-05	V shaped crammer	2A
112	J61-0044-05	Nylon crammer	3B
113	N09-0507-05	TP screw (M4 x 14)	3A, 3B
114	N61-3113-46	Round wood screw	3A, 3B
—	S31-2001-05	Slide switch (Power voltage selector) (M, W type)	—
—	D32-0080-14	Switch stopper (M, W type)	—
—	W01-0035-00	Small driver (M, W type)	—
M3 x 4	N30-3004-46	Pan head screw (M3 x 4)	—
M3 x 6	N30-3006-46	Pan head screw (M3 x 6)	—
M3 x 5	N09-0506-05	TP screw (M3 x 5)	—
(TP)	—	—	—
M4 x 6	N30-4006-46	Pan head screw (M4 x 6)	—
2φ	N24-3020-60	E washer (2φ)	—
3φ	N24-3030-60	E washer (3φ)	—
4φ	N24-3040-60	E washer (4φ)	—