

2SA733 (A)
2SA954
2SA999
2SB764
2SC2003
2SC2320
2SC935 (A)
2SD1302
2SD863

MC1495L

2SC2167

NJM4200D

M5231TL

UPD4069UC

LA1231NS
LA3350S
LM7001

LA1245

UPC1163HA

M5218P

LC7570

UPC7805HF

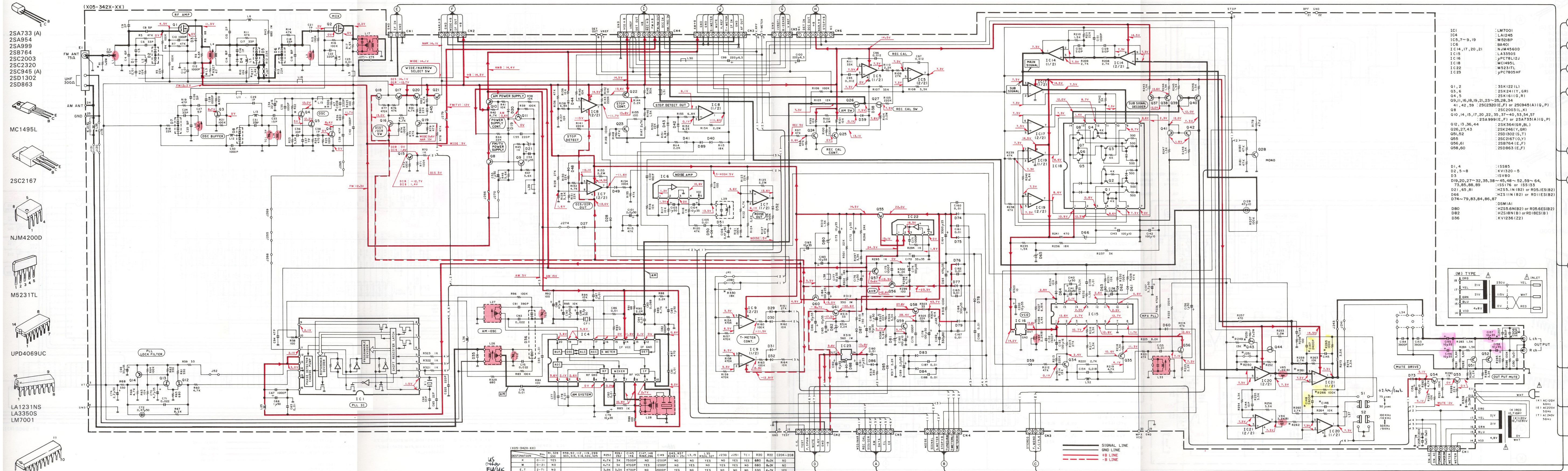

UPC7812J

2SK246

2SK364

3SK122

2SK161

2SK211

2SK302

2SK425

BA401

CXP5016-216S

(X05-342X-XX)

DESTINATION	Max. 330	303, 313, 318, 320, 325	R292	R262	C145	C147, 148	C149, 265, 266	C49	Q43, 837	L3, 19	L32, 327	J230	J251	IC1	R20	R22	C204-208			
M	0-21	YES	NO	1200P	NO	NO	YES	680	4.7K	3K	7500P	NO	1200P	NO	NO	YES	680	6.2K	NO	
M	0-21	NO	NO	1200P	NO	NO	YES	1200P	NO	NO	NO	NO	NO	NO	NO	NO	NO	680	8.2K	NO
E, T	2-71	NO	NO	3.9K	3.3K	4700P	NO	2000P	YES	NO	NO	NO	NO	NO	NO	NO	330	4.7K	YES	

- IC1 : LM7001
IC4 : LA1245
IC5,7~9,19 : M5218P
IC6 : BA401
IC14,17,20,21 : NJM4560D
IC15 : LA3350S
IC16 : UPC7812J
IC18 : MC1495L
IC22 : M5231TL
IC23 : UPC7805HF
- Q1,2 : 3SK122 (L)
Q3,6 : 2SK241 (Y,GR)
Q4,5 : 2SK161 (G,R)
Q9,11,16,18,19,21,23~25,28,34 : 2SA999 (E,F) or 2SA7331A (I,Q,P)
Q8 : 2SC2003 (L,K)
Q10,14,15,17,20,22,35,37~40,53,54,57 : 2SC2320 (L,K)
Q12,13,36,44 : 2SK364 (GR,BL)
Q26,27,43 : 2SK246 (Y,GR)
Q51,52 : 2SD1302 (S,T)
Q55 : 2SC2167 (O,Y)
Q56,61 : 2SB764 (E,F)
Q58,60 : 2SD863 (E,F)
- D1,4 : 1SS85
D2,5~8 : KV1230-5
D3 : 1SS180
D19,20,27~32,35,38~45,48~52,59~64,73,85,88,89 : 1SS176 or 1SS153
D21,65,61 : HZ53,1N (B2) or RDS,IES1(B2)
D66 : HZ51N (B2) or RDI1ES1(B2)
D74~79,83,84,86,87 : DSM1A
D80 : HZ59.6N (B2) or RDS,6ES1(B2)
D82 : HZ58N (B) or RDI1ES1(B)
D36 : KV1236 (Z2)

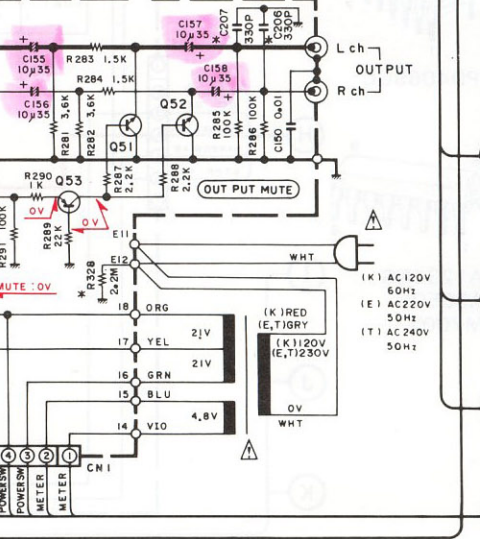
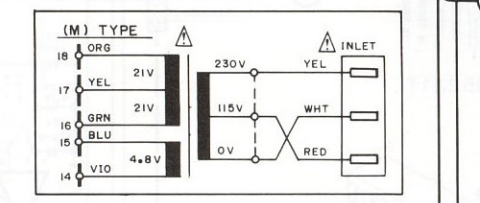

KT-990D
KENWOOD

CAUTION: For continued safety, replace safety critical components only with manufacturer's recommended parts (refer to parts list). Δ. Indicates safety critical components. To reduce the risk of electric shock, leakage-current or resistance measurements shall be carried out (exposed parts are acceptably insulated from the supply circuit) before the appliance is returned to the customer.

- DC voltages are measured with a high impedance voltmeter. Values may vary slightly due to variations between individual instruments or/and units.
- Les tensions c.c. doivent être mesurées avec un voltmètre à haute impédance. Les valeurs peuvent différer légèrement du fait des variations inhérentes aux appareils et aux instruments de mesure individuels.
- Die angegebenen Gleichspannungswerte wurden mit einem hochohmigen Spannungsmesser gemessen. Dabei schwanken die Meßwerte aufgrund von Unterschieden zwischen einzelnen Instrumenten oder Geräten u.U. geringfügig.

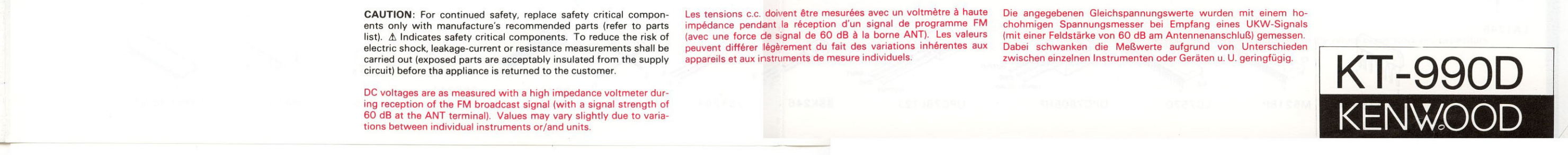
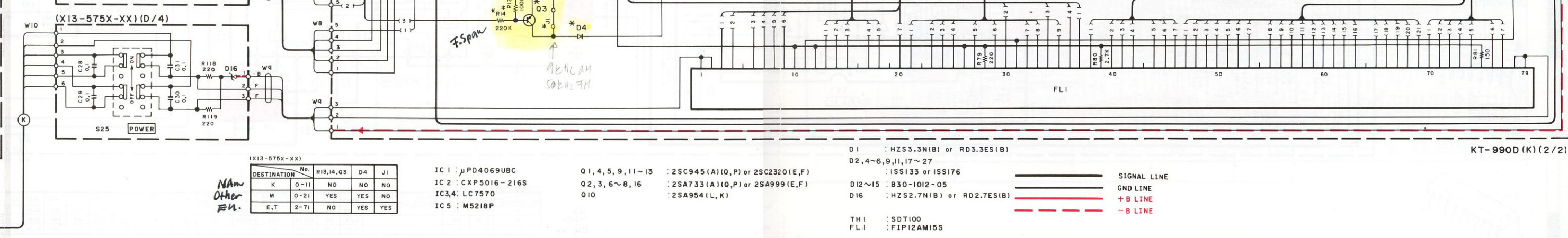
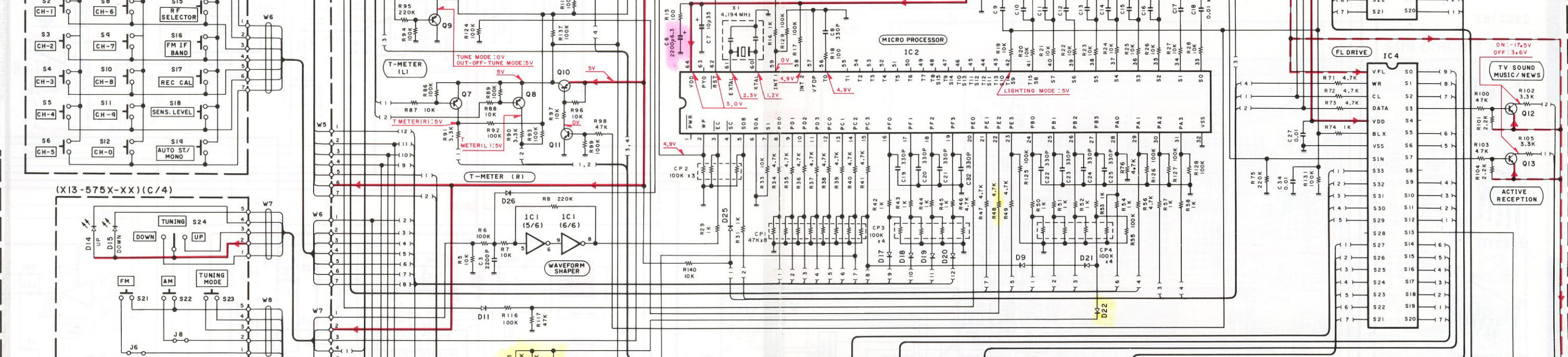
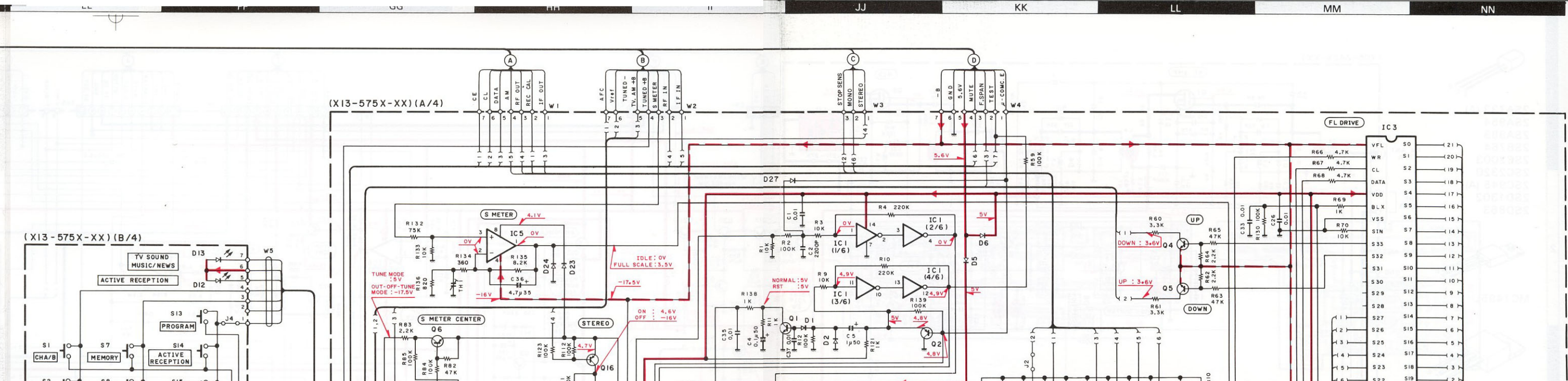
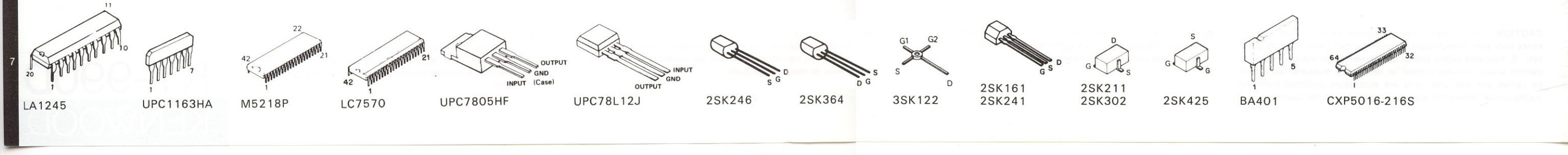
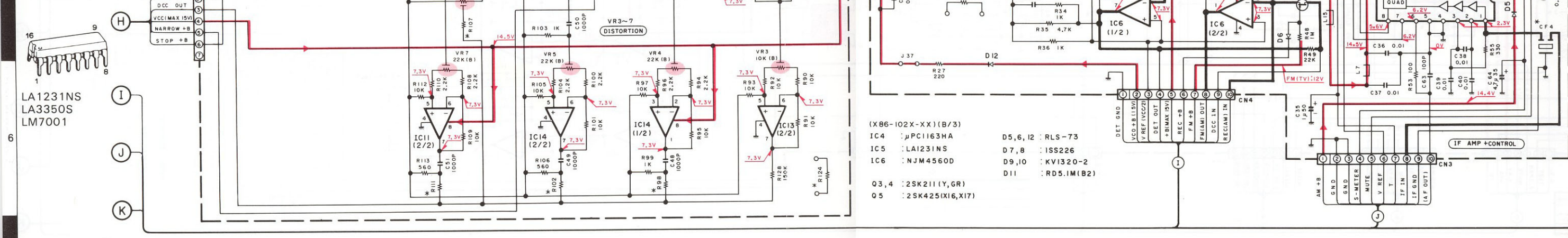
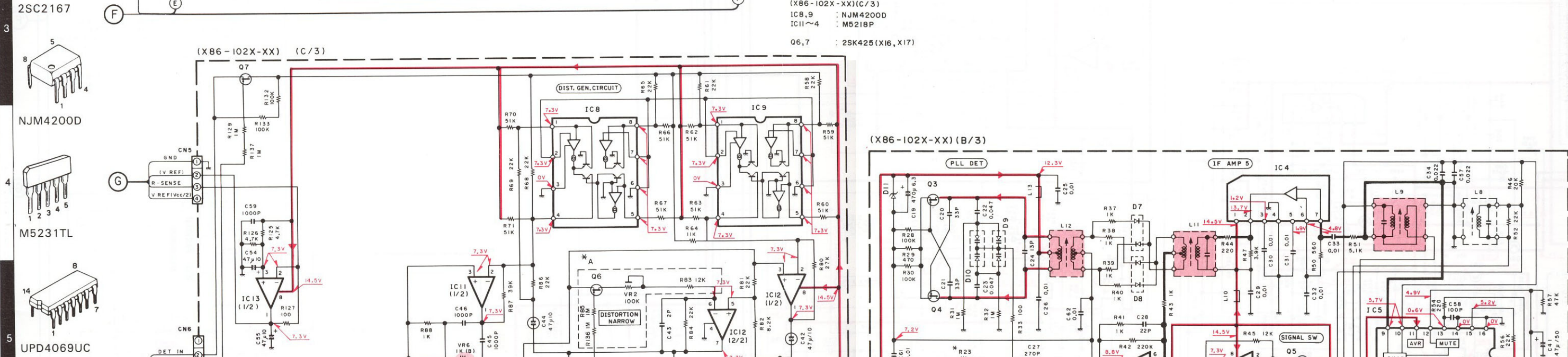
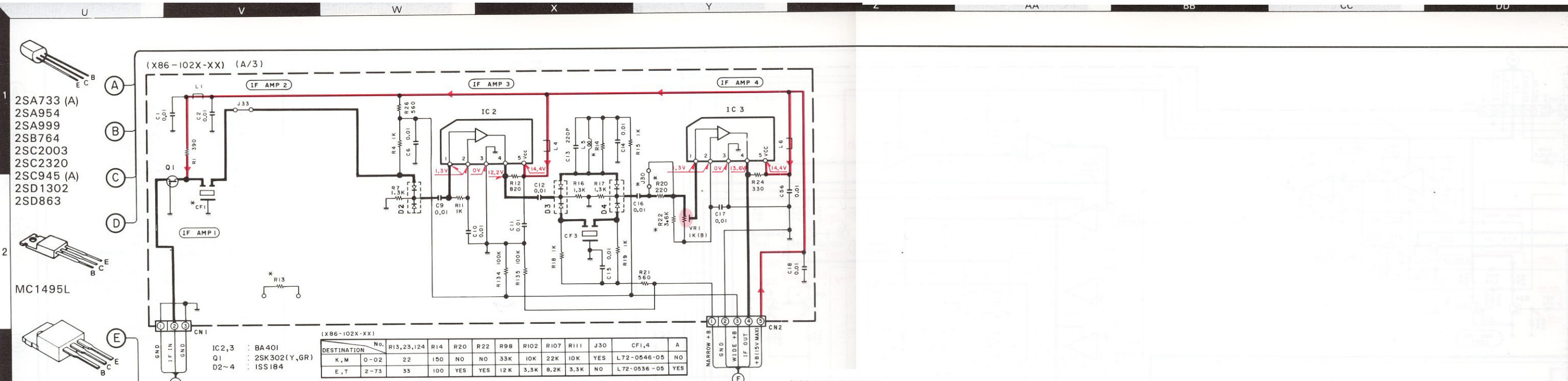

- 2SA733 (A)
- 2SA954
- 2SA999
- 2SB764
- 2SC2003
- 2SC2320
- 2SC945 (A)
- 2SD1302
- 2SD863

- MC1495L

- 2SC2167

- NJM4200D

- M5213TL

- UPD4069UC

- LA1231NS
- LA3350S
- LM7001

- LA1245

- UPC1163HA

- M5218P

- LC7570

- UPC7805HF

- UPC78L12J

- 2SK246

- 2SK364

- 3SK122

- 2SK161
- 2SK241

- 2SK211
- 2SK302

- 2SK425

- BA401

- CXP5016-216S

DESTINATION	No.	R13,14,Q3	D4	J1
K	0-11	NO	NO	NO
M	0-21	YES	YES	NO
E,T	2-73	NO	YES	YES

IC 1	IC 2	IC 3,4	IC 5
μPD4069UBC	CXP5016-216S	M5218P	M5218P

D1	D2,4-6,9,11,17-27	D12~15	D16	FL1
HZS3.3N(B) or RD3.3S(B)	ISS133 or ISS176	B30-10I2-05	HZS2.7N(B) or RD2.7S(B)	SDT100
				FIP12AM15S

Q1,4,5,9,11-13	Q2,3,6~8,16	Q10
2SC945 (A)(Q,P) or 2SC2320 (E,F)	2SA733 (A)(Q,P) or 2SA999 (E,F)	2SA954 (L,K)

CAUTION: For continued safety, replace safety critical components only with manufacturer's recommended parts (refer to parts list). Δ Indicates safety critical components. To reduce the risk of electric shock, leakage-current or resistance measurements shall be carried out (exposed parts are acceptably insulated from the supply circuit) before the appliance is returned to the customer.

Les tensions c.c. doivent être mesurées avec un voltmètre à haute impédance pendant la réception d'un signal de programme FM (avec une force de signal de 60 dB à la borne ANT). Les valeurs peuvent différer légèrement du fait des variations inhérentes aux appareils et aux instruments de mesure individuels.

Die angegebenen Gleichspannungswerte wurden mit einem hochohmigen Spannungsmesser bei Empfang eines UKW-Signals (mit einer Feldstärke von 60 dB am Antennenanschluss) gemessen. Dabei schwanken die Meßwerte aufgrund von Unterschieden zwischen einzelnen Instrumenten oder Geräten u. U. geringfügig.

DC voltages are as measured with a high impedance voltmeter during reception of the FM broadcast signal (with a signal strength of 60 dB at the ANT terminal). Values may vary slightly due to variations between individual instruments or/and units.

