

# KENWOOD

---

# KX-1030

MODEL

---

SERVICE MANUAL

---

2SA564  
2SA721  
2SC536  
2SC828  
2SC1327

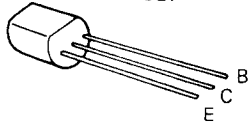

2SA699  
2SC1226

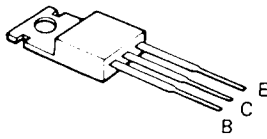

2SB22

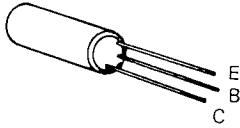

Semiconductor name	Substitutions
2SA564	2SA733
2SA699	2SB595, 2SB596
2SA721	2SA640, 2SA620WB
2SB22	-
2SC828	2SC536, 2SC945
2SC1226	2SC1013
2SC1327	2SC1000
AN360	-
NE545B	-
TA7060P	-

- IC101, 102 : AN360
- IC103~106 : NE545B
- IC107, 108 : TA7066P
- Q101 ~ 106, 302, 303, 401 ~ 407, 502, 503, 505 ~ 507 : 2SC828(R) or 2SC536(F)
- Q107 ~ 112 : 2SC1327(S,T) or 2SC1571G(H)
- Q113, 114 : 2SA721(R,S)
- Q301 : 2SB22
- Q501 : 2SC1226(Q,R)
- Q504, 903 : 2SA564(R)
- Q508 : 2SA699(Q,R)
- Q901, 902, 904, 2SC828(R) or 2SC536(F)
- D1 ~ 10, 905 : 1S188 AM or 1N60 or OA90
- D301, 401 ~ 404, 504, 505, 903, 904 : WG713 or 1S2473 or TD9600-16-1
- D501, 502 : W02
- D901, 901, 902 : 1N4002
- ZD501 : WZ182

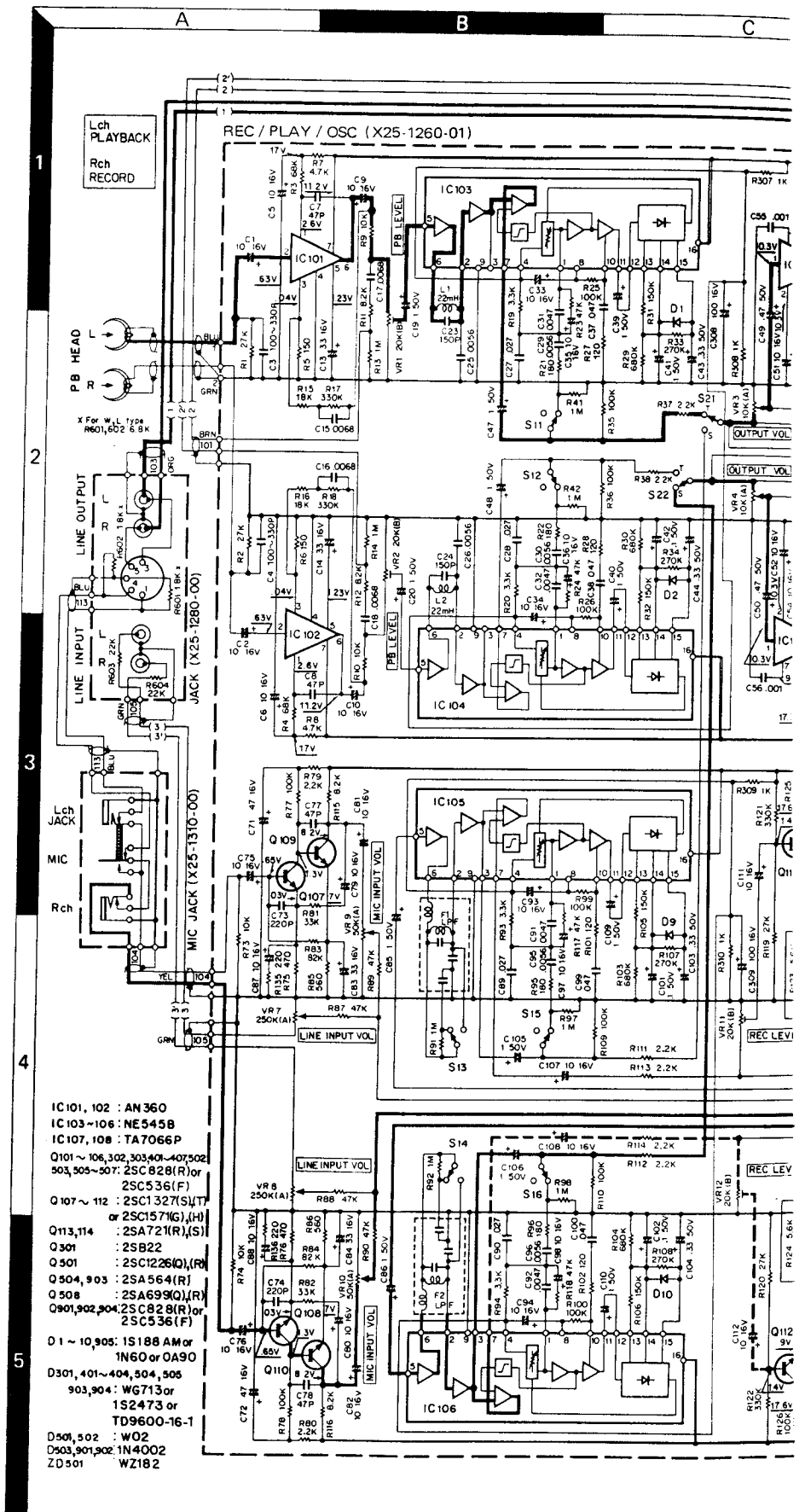

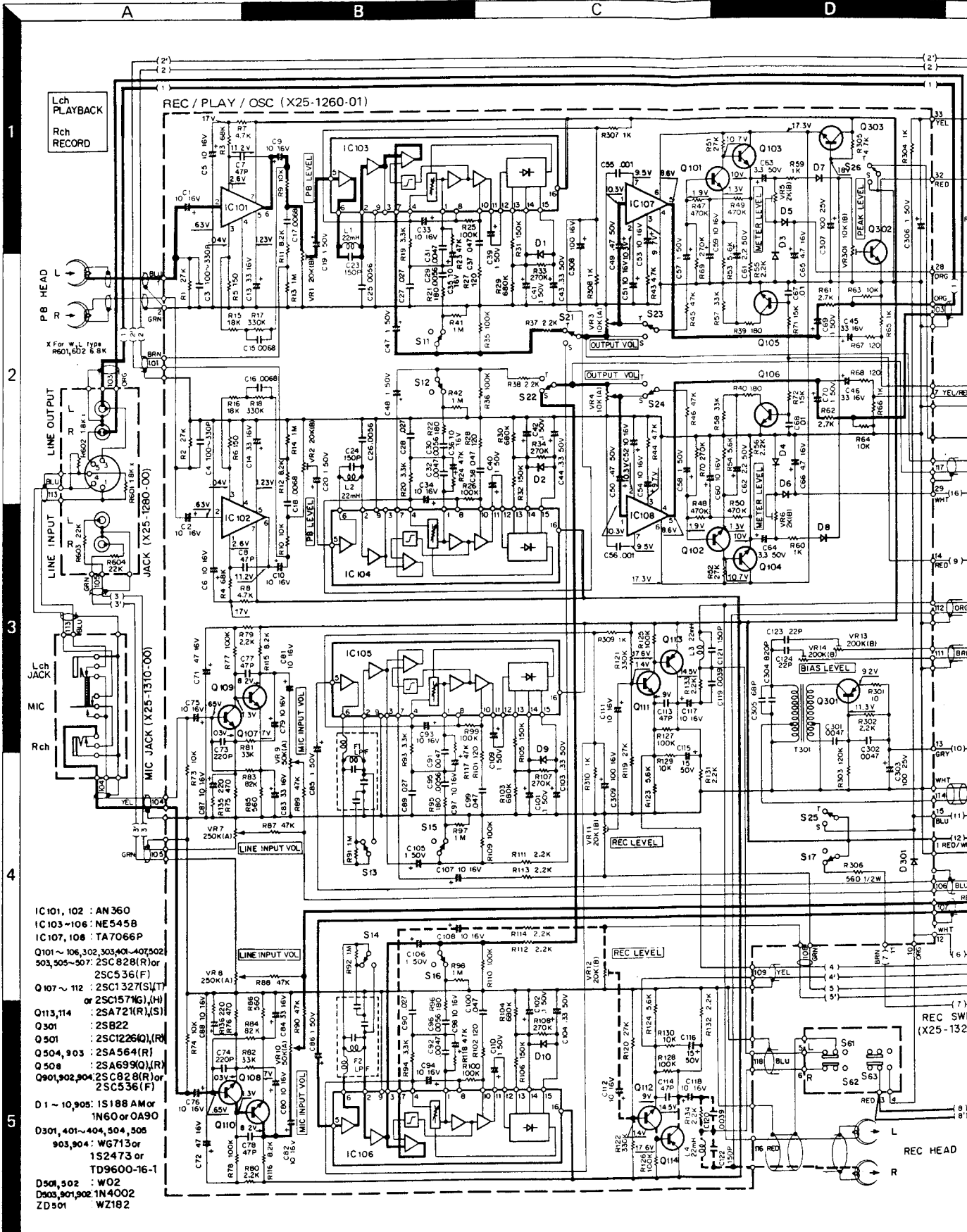

1  
2  
3  
4  
5

(2)  
(2)  
33  
32  
28  
27  
26  
25  
24  
23  
22  
21  
20  
19  
18  
17  
16  
15  
14  
13  
12  
11  
10  
9  
8  
7  
6  
5  
4  
3  
2  
1

Lch  
PLAYBACK  
Rch  
RECORD

PB HEAD  
L  
R

LINE OUTPUT  
LINE INPUT  
JACK (X25-1280-00)

Lch  
JACK  
MIC  
Rch

MIC JACK (X25-1310-00)

LINE INPUT VOL  
MIC INPUT VOL

LINE INPUT VOL  
MIC INPUT VOL

REC LEVEL  
PB LEVEL

PB LEVEL  
REC LEVEL

MIC INPUT VOL  
LINE INPUT VOL

LINE INPUT VOL  
MIC INPUT VOL

LINE INPUT VOL  
MIC INPUT VOL

OUTPUT VOL  
REC LEVEL  
BIAS LEVEL

OUTPUT VOL  
REC LEVEL

REC LEVEL  
BIAS LEVEL

REC LEVEL  
BIAS LEVEL

REC LEVEL  
BIAS LEVEL

REC SWIT  
(X25-1320)

REC HEAD  
L  
R

# STEREO CASSETTE DECK

C

D

E

F

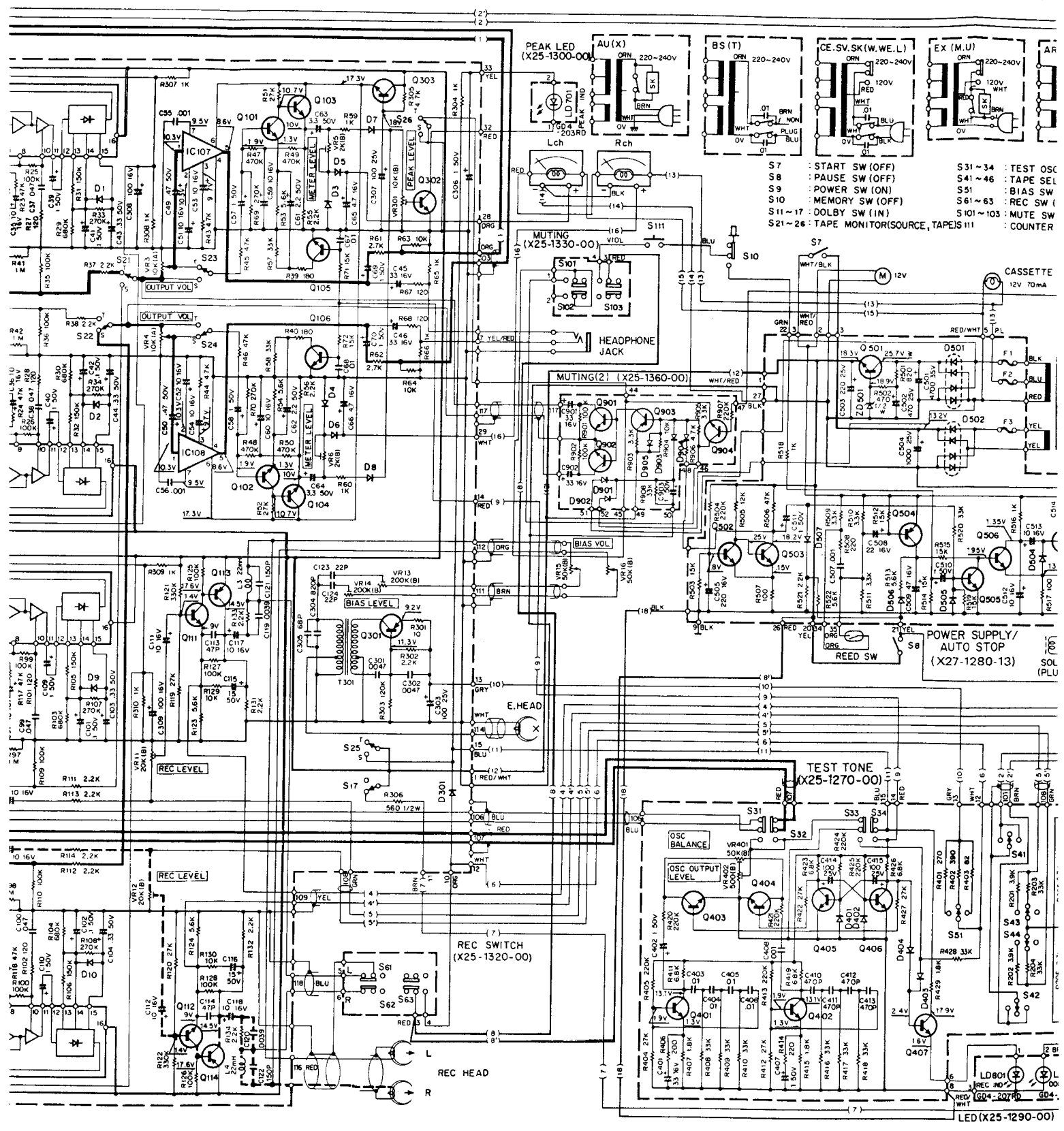

- S7 : START SW (OFF)
- S8 : PAUSE SW (OFF)
- S9 : POWER SW (ON)
- S10 : MEMORY SW (OFF)
- S11~17 : DOLBY SW (IN)
- S21~26 : TAPE MONITOR(SOURCE, TAPES III)
- S31~34 : TEST OSC
- S41~46 : TAPE SEL
- S51 : BIAS SW
- S61~63 : REC SW (
- S101~103 : MUTE SW
- : COUNTER

POWER SUPPLY/  
AUTO STOP  
(X27-1280-13)

TEST TONE  
(X25-1270-00)

REC SWITCH  
(X25-1320-00)

LED(X25-1290-00)

# (KX-1003) KX-1030 <sup>①</sup>

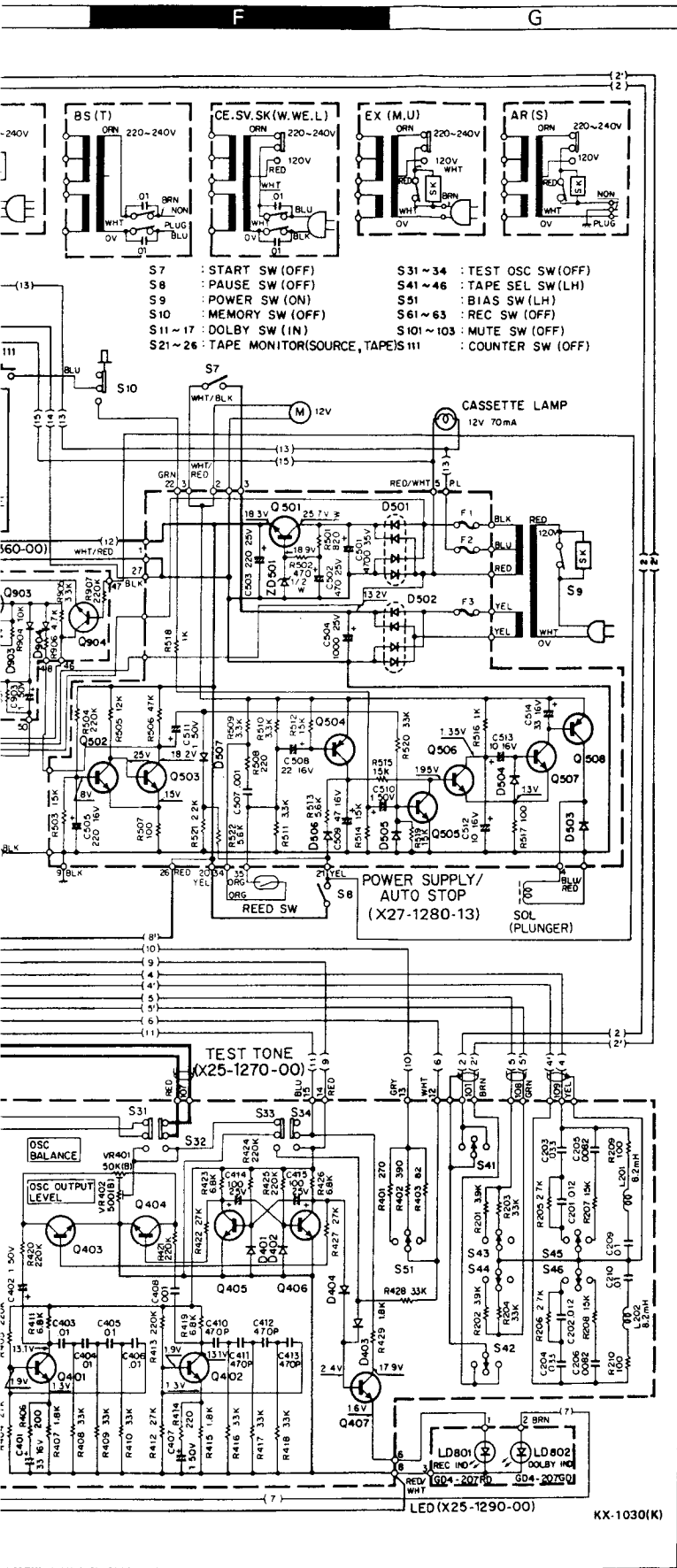
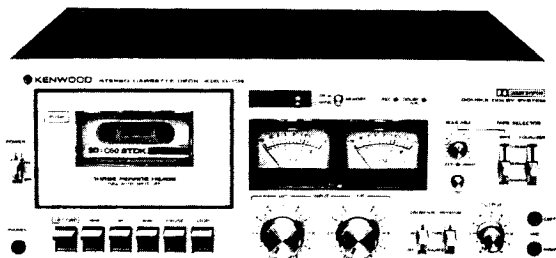

- |                             |   |
|-----------------------------|---|
| Type                        | Front Loading Stereo Cassette Deck with Dolby System  |
| Track System                | 4-Track, 2-Channel Stereo/Mono Recording/Playback   |
| Recording System            | AC Bias System (Bias Frequency: 85 kHz)   |
| Erasing System              | AC System   |
| Tape Speeds                 | 4.76 cm/sec (1-7/8 ips)   |
| Heads                       | Three Ferrite Heads Type<br>Recording and Playback Combination Head x 1<br>Erasing Head x 1   |
| Motor                       | Electrically-Controlled DC Motor  |
| Fast Winding Time           | Approx. 80 seconds with C-60 tape   |
| Frequency Response          | Normal Tape: 25 Hz to 17,000 Hz (35 Hz to 15,000 Hz ± 3 dB)<br>CrO <sub>2</sub> Tape: 25 Hz to 20,000 Hz (35 Hz to 18,000 Hz ± 3 dB)<br>Ferri-CrO <sub>2</sub> Tape: 25 Hz to 19,000 Hz (35 Hz to 17,000 Hz ± 3 dB)   |
| Signal to Noise Ratio       | Dolby ON (Over 5 kHz): 65 dB (Normal Tape), 67 dB (CrO <sub>2</sub> )<br>Dolby OFF: 55 dB (Normal Tape), 57 dB (CrO <sub>2</sub> )  |
| Harmonic Distortion         | Less than 1.3% (at 1 kHz, 0VU with Normal Tape)   |
| Wow and Flutter             | 0.06% (WRMS)  |
| Input Sensitivity/Impedance | Line x 2: 77.5 mV/56k ohms<br>0.1 mV/10k ohms. Europe and Scandinavia model<br>DIN x 1: 10.9 mV/1.5k ohms. Other Countries model  |
| Output Level/Load Impedance | Microphones x 2: 0.19 mV/10k ohms<br>Line x 2: 775 mV (0VU)/2.0k ohms<br>DIN x 1: 775 mV (0VU)/2.0k ohms<br>Headphones/1: 48.9 mV/8 ohms to 16 ohms   |
| Build in Features           | Three Ferrite Heads Type<br>Dolby Noise Reduction System with Indicator<br>Three Position Bias Selector (Normal-Chrome-Reserve)<br>Three Position Equalization Selector (Normal-Chrome-Reserve)<br>Fine Bias Adjustment Controls with Oscillator<br>Full Auto Shut-Off Mechanism in All Modes<br>Mic/Line Mixing<br>Memory Rewind<br>LED Peak and Recording Indicator<br>Tape Monitor<br>Three Digit Tape Counter<br>Two Large Size Illuminated VU Meters<br>Two Microphone Jacks, Headphone Jack<br>DIN Rec/P.B. Connector |
| Power Requirements          | AC 120V, 60 Hz: USA and Canada Model<br>AC 220V, 50 Hz: Australia Model<br>AC 240V, 50 Hz: U.K. Model<br>AC 120V/220V (Switchable), 50/60 Hz: Other Countries   |
| Power Consumption           | 13.0 watts  |
| Dimensions                  | W: 430 mm/16-15/16"<br>H: 167 mm/6-9/16"<br>D: 332 mm/13-1/16"  |
| Weight                      | 7.5 kg, 16.5 lbs  |
| Supplied Accessories        | Stereo Connection Cord x 2<br>Head Cleaning Kit x 1   |
| Reference Tape*             | Normal: TDK SD C-90<br>Chrome: TDK SA C-60<br>Reserve: SONY DUAD C-60   |

TRIO follows a policy of continuous advancements in development. For this reason specifications may be changed without notice.

NOTE: \*Dolby is trademark of Dolby Laboratories, Inc.

KX-1030(K)

A B C D

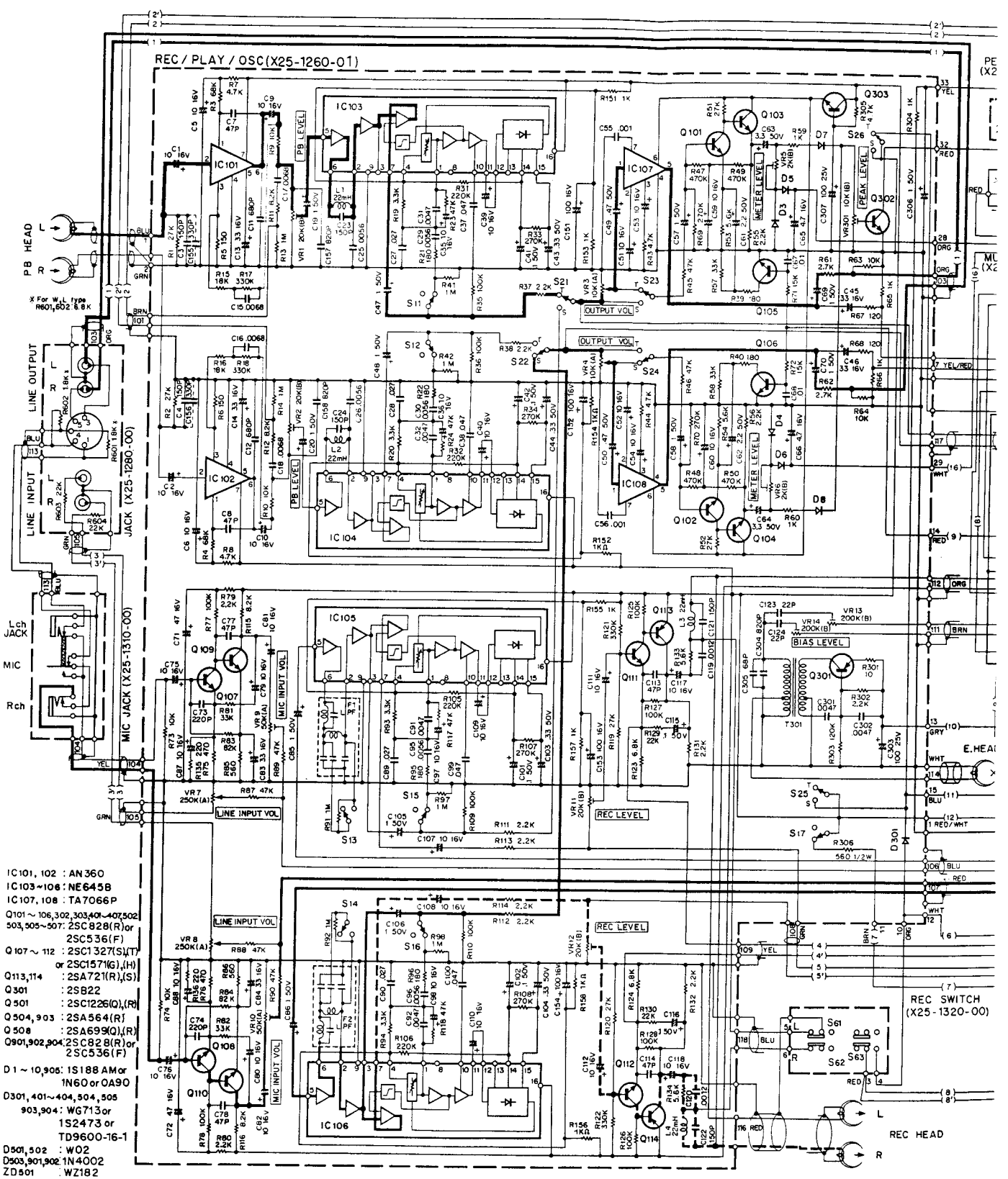

- IC101, 102 : AN360
- IC103~106 : NE645B
- IC107, 108 : TA7066P
- Q101 ~ 106, 302, 303, 401~407, 502
- 503, 505~507 : 2SC828(R) or 2SC536(F)
- Q107 ~ 112 : 2SC1327(S)(T) or 2SC1571G(I), (H)
- Q113, 114 : 2SA721(R), (S)
- Q301 : 2SB22
- Q501 : 2SC1226(Q), (R)
- Q504, 903 : 2SA564(R)
- Q508 : 2SA699(Q), (R)
- Q901, 902, 904 : 2SC828(R) or 2SC536(F)
- D1 ~ 10, 908 : 1S188 AM or 1N60 or OA90
- D301, 401~404, 504, 505
- 903, 904 : WG713 or 1S2473 or TD9600-16-1
- D501, 502 : W02
- D503, 901, 902 : 1N4002
- ZD501 : WZ182

2  
3  
4  
51

NOTE: We reserve the right to make modifications in this model in accordance with technical developments.

B C D E F

260-01)

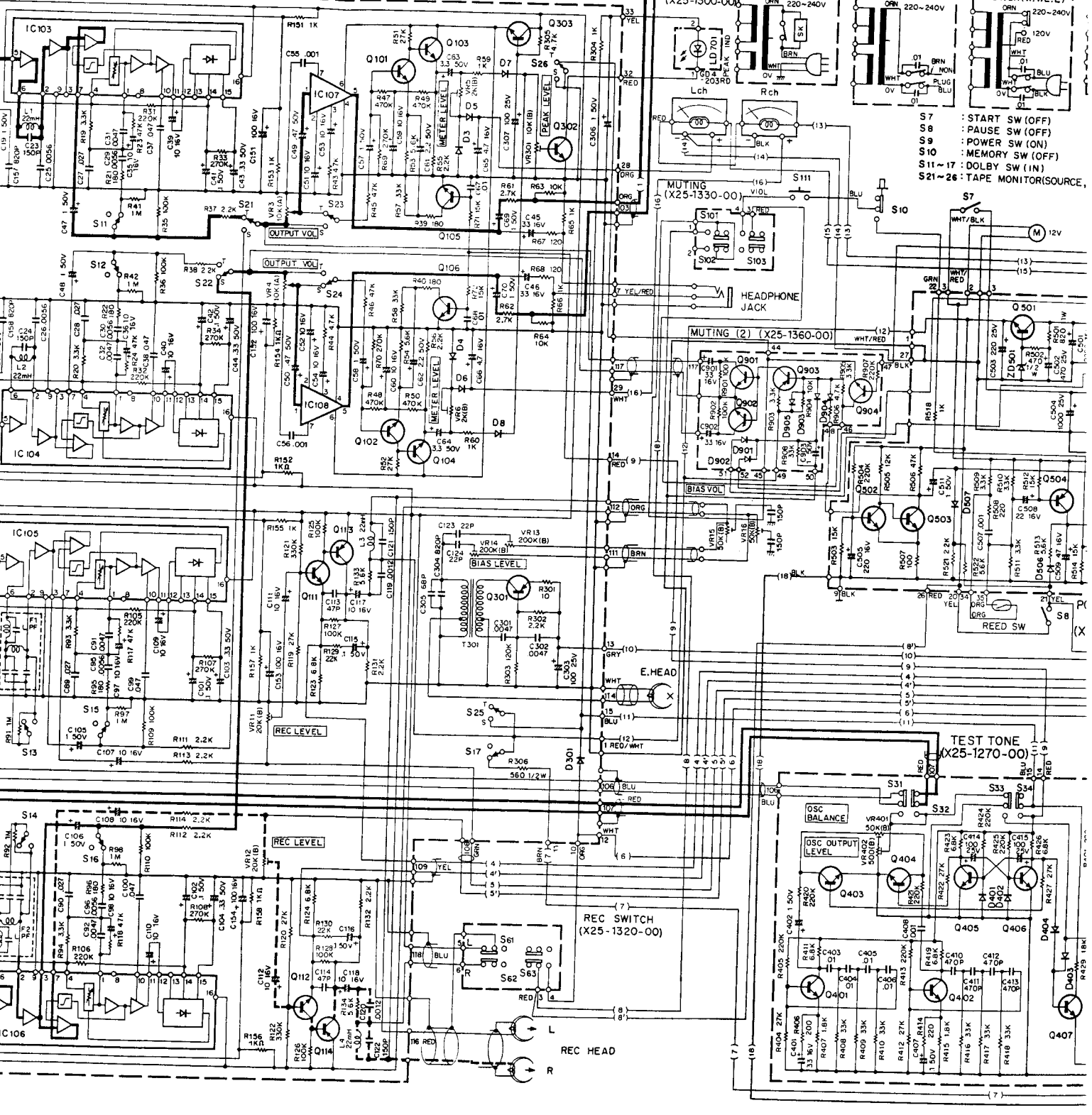

- S7 : START SW (OFF)
- S8 : PAUSE SW (OFF)
- S9 : POWER SW (ON)
- S10 : MEMORY SW (OFF)
- S11 ~ 17 : DOLBY SW (IN)
- S21 ~ 26 : TAPE MONITOR(SOURCE)

ifications in this model in accordance with technical developments.

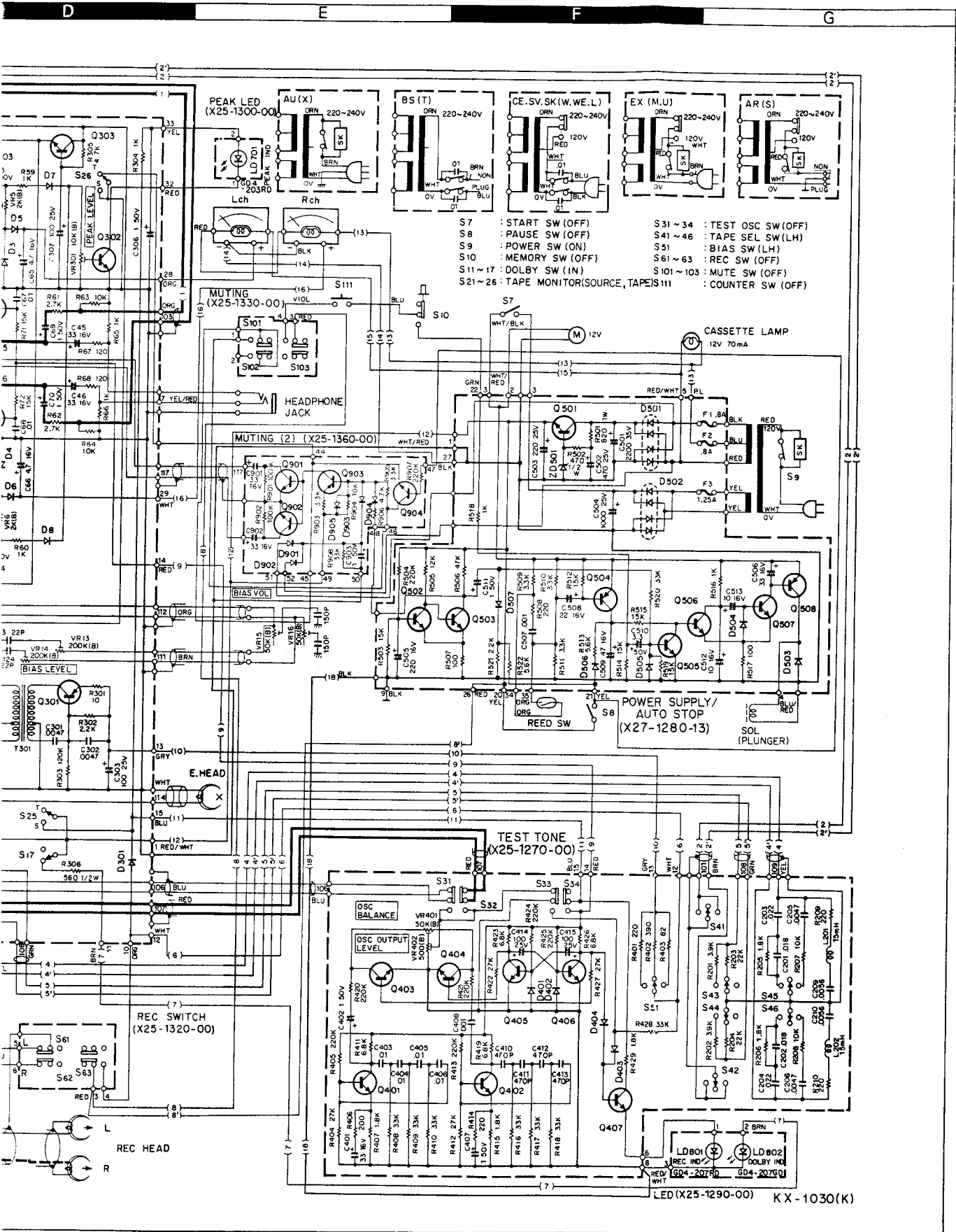

ical developments.



Fig. No.	Parts No.	Description	Remarks
106	D16-0207-08	Square belt	☆ 8B
107	B09-0008-18	Reel cap	8A
108	N19-0249-08	Polyethylene slider washer φ1.6 × φ6 × 0.25	8A
109	D14-0205-08	Idler ass'y	☆ 8B
110	D14-0056-08	Idler "B" ass'y (REW idler)	8B
111	G01-0303-08	Idler "B" lever spring	8B
112	D19-0203-08	Pause slide holding plate	8B
113	D10-0479-08	Lever (2) ass'y for removing pause lock	☆ 8B
114	G01-0300-08	Pause lock plate spring	8B
115	D12-0205-08	Pause lock plate	☆ 8B
116	D10-0476-08	Plate ass'y for unattended recording operation	8B
117	D10-0496-08	Tension arm ass'y "B"	☆ 8B
118	G09-0203-08	Drive roller spring	8B
119	G01-0307-08	REW lever spring "B"	8B
120	G01-0302-08	FR lever spring "D"	8B
121	D10-0201-08	REW lever "B"	8B
122	D10-0480-08	Muting lever ass'y	☆ 8B
123	D10-0483-08	FF lever	☆ 8B
124	A10-1015-08	Mechanism chassis ass'y	☆ 8A
125	G01-0639-08	Eject safty claw	☆ 7A
126	D21-0625-08	Cassette helf holding lever shaft	☆ 8A
127	J21-2239-08	Mechanism holder "L" ass'y	☆ 8A
128	G09-0211-08	Cassette lock plate spring	☆ 8A
129	D12-0206-08	Cassette lock plate	☆ 8A
130	N09-0582-08	Screw with steps M3 × 5	☆ 8A
131	D19-0204-08	REC safety claw	☆ 8A
132	G09-0210-08	REC safety claw spring	☆ 8A
133	D10-0485-08	Cassette half holding lever	☆ 8A
134	G09-0209-08	Cassette half spring	☆ 8A
135	J31-0412-08	Faucet for mounting frame	☆ 8A
136	J31-0301-08	Felt faucet ass'y	☆ 8A
137	N09-0808-08	Flat head screw M1.6 × 4	☆ 8A
138	A13-0506-08	Angle for mounting mechanism	☆ 8A
139	D10-0482-08	Arm ass'y for preventing eject operation	☆ 8A
140	D10-0198-08	Brake lever	8A
141	G03-0011-08	Brake lever spring	8A
142	D03-0007-18	Reel base ass'y	☆ 8A
143	G01-0635-18	Back tension spring	☆ 8A
144	N19-0515-08	Washer φ6.2 × φ9.5 × 0.15	☆ 8A
145	B11-0303-08	Prism plate	☆ 9A
146	G09-0208-18	Erase head plate spring	☆ 8.9A
147	J21-2237-18	Erase head plate ass'y	☆ 9A
148	T32-0004-08	Erase head	9A
149	T34-0005-05	REC/PLAY head	☆ 9A
150	A11-0316-08	Head base ass'y	☆ 8A
151	G01-0629-08	Adjusting head spring	☆ 8A
152	G01-0630-08	Fixing head spring	☆ 9A
153	G01-0305-18	Pinch roller spring	9A
154	D10-0467-18	Pinch roller arm ass'y	☆ 9A
155	G01-0634-08	Head base shaft spring	9A
156	D39-0043-08	Head base shaft	9A
157	G10-0631-08	Head base spring	☆ 9A
158	N09-0205-08	Screw with toothed washer M2 × 5	9A

Fig. No.	Parts No.	Description	Remarks
159	N19-1020-46	Toothed washer	9A
160	G02-0065-08	Head base holding spring	9A
161	N09-0583-08	Hexagonal screw M2.6	☆ 9A
162	F01-0608-08	Head protector	☆ 9A
163	A29-0301-08	Cassette plate	☆ 9A
164	G09-0207-08	REC switch operation wire	☆ 9A
165	G01-0672-08	Brake operation lever spring (1)	☆ 9A
166	K29-0629-08	Pushbutton block ass'y	☆ 9A
167	D21-0623-08	Pushbutton shaft	☆ 9A
168	D10-0474-08	Pushbutton operation plate ass'y	☆ 9A
169	G01-0645-08	Pushbutton operation plate spring	☆ 9A
170	D10-0473-08	STOP pushbutton lever ass'y	☆ 9B
171	G09-0206-08	STOP pushbutton spring	☆ 9B
172	G09-0205-08	Pushbutton spring	☆ 9A
173	D10-0470-08	Pushbutton lever "A"	☆ 9A
174	D10-0471-08	Pushbutton lever "B"	☆ 9A
175	D10-0472-08	REC pushbutton lever	☆ 9A
176	K29-0630-08	Operational pushbutton	☆ 9A
177	D10-0475-08	Eject lever holder ass'y	☆ 9B
178	D10-0481-18	Housing arm ass'y "L"	☆ 9A
179	D10-0497-18	Housing arm ass'y "R"	☆ 9B
180	D10-0486-08	Housing arm interlock plate	☆ 9B
181	J21-2238-08	Mechanism holder "R" ass'y	☆ 8B
182	S59-1043-08	Reed switch	8B
183	D14-0206-08	Counter idler	☆ 9B
184	D16-0208-08	Counter belt	☆ 9B
185	B35-0203-08	Tape counter	☆ 9B
186	G01-0636-08	Muting lever spring	☆ 9B
187	X25-1330-00	MUTING SWITCH PC board ass'y	☆ 9B
188	A15-0303-08	Frame for switch	9B
189	X25-1320-00	REC SWITCH PC board ass'y	☆ 9B
190	J21-2262-08	Wire holder	☆ 9B
191	G01-0637-08	Housing arm spring	☆ 9B
192	F14-0106-08	Lamp tube	8B
193	B30-0507-08	Pilot lamp 12V 60 mA	☆ 8B
194	G02-0311-08	Head base holding screw "B"	9A
195	N09-0813-08	Screw with toothed washer	9A

Fig. No.	Parts No.
M2 × 8	N30-2008-46
M3 × 8	N30-3008-46
M3 × 4 (Bi-Tap)	N89-3004-46
M3 × 6 (Bi-Tap)	N89-3006-46
M2.6 × 4 (SEMUS)	N09-0199-08
M2.6 × 6 (SEMUS)	N09-0202-08
M2.6 × 7 (SEMUS)	N09-0200-08
M2.6 × 8 (SEMUS)	N09-0203-08
M2.6 × 15 (SEMUS)	N09-0201-08
M2 × 3 (F)	N32-2003-46
M3 × 5 (B)	N35-3005-46
M3 × 14 (B)	N35-3014-46
M2.6	N10-2026-46
M3	N10-2030-46
φ1.5 (ER)	N24-3015-60
φ2 (ER)	N24-3020-60
φ2.5 (ER)	N24-3025-60
φ3 (ER)	N24-3030-60
φ4 (ER)	N24-3040-60

7

8

9

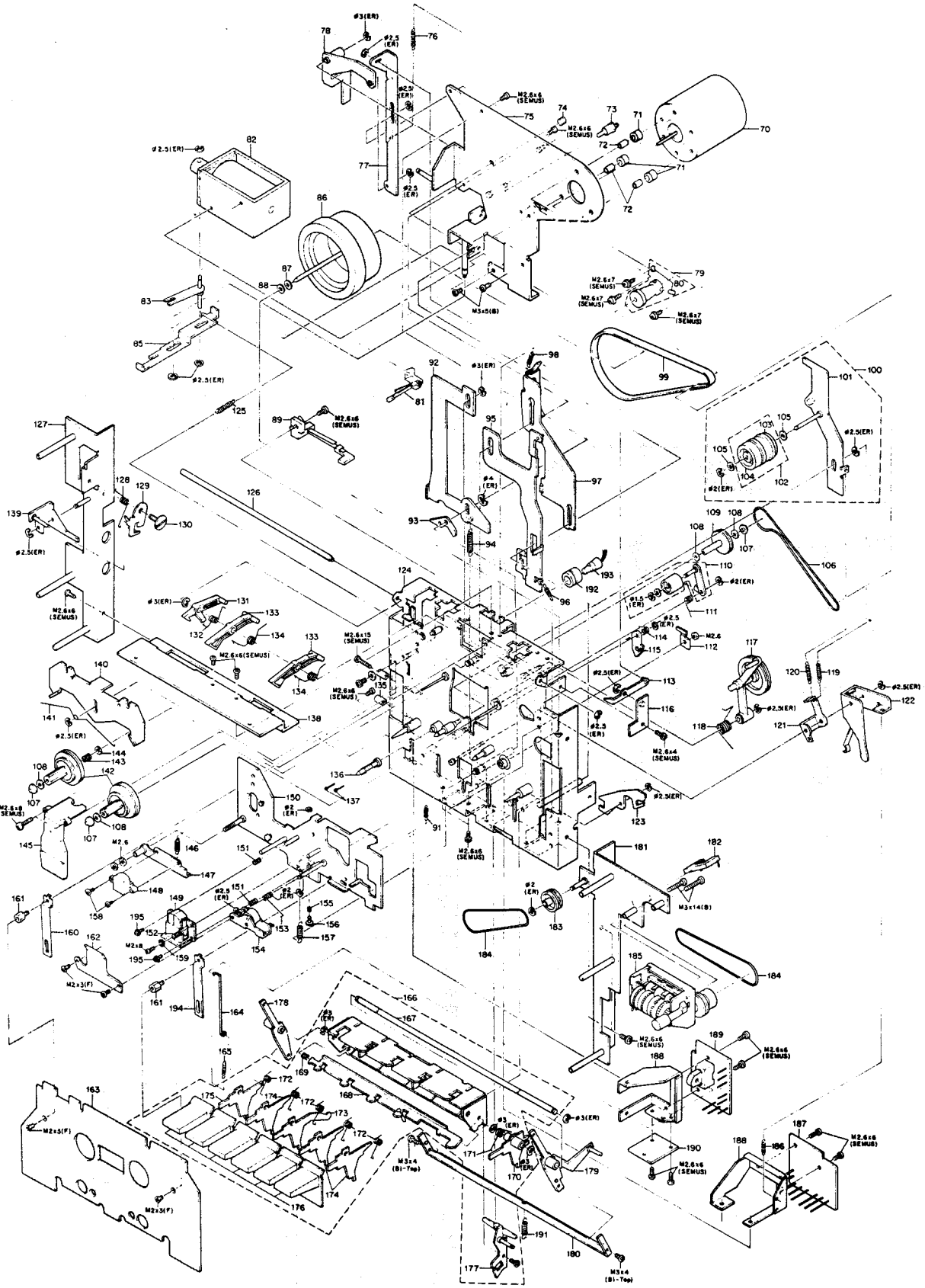



● : Refer to Destinations' Parts List  
 ☆ : New parts

Fig. No.	Parts No.	Description	Remarks
1	A01-0603-08	Case	☆ 1B
2	B42-1334-08	Adjustment sheet	☆ 1B
3	N09-0233-08	Binding head tap tight screw M4×8	1A,B
4	A23-1207-08	Rear panel	☆ 2B
5	●	Power cord	1B
6	●	Power cord bushing	2B
7	●	Power cord clamp holder A	☆ 2B
8	●	Slide switch	2B
9	●	Switch stopper holder	2B
10	N08-0128-25	GND terminal	2B
11	●	JACK PC board ass'y	☆ 2B
12	●	Panel ass'y (includes the parts of 13,14,15,16,18 and 19)	☆ 3A
13	B10-0501-08	Meter front glass	☆ 2A
14	B07-0511-08	Escutcheon for mechanism chassis ass'y	☆ 2A
15	B07-0510-08	Escutcheon for tape counter	☆ 3A
16a	B07-0508-08	Switch sleeve A	☆ 2A
16b	B07-0509-08	Switch sleeve B	☆ 3A
17	N29-0202-08	Nylon rivet φ3.5 × 5.5	2B
18	B07-0205-04	Escutcheon (small)	☆ 3A
19	B07-0206-04	Escutcheon (big)	☆ 3A
20	K23-0614-08	Knob (lever switch, outside)	☆ 3A
21	K23-0606-08	Knob (lever switch, inside)	☆ 3A
22	K23-0618-08	Knob (BIAS VR, outside)	☆ 3A
23	K23-0616-08	Knob (BIAS VR, inside)	☆ 3A
24	K23-0620-08	Knob (OUTPUT VR, outside)	☆ 3A
25	K23-0608-08	Knob (OUTPUT VR, inside)	☆ 3A
26	K27-0051-04	Knob (lever switch)	☆ 3A
27	A40-0518-08	Bottom plate	☆ 3A
28	J02-0308-08	Leg	3B
29	N09-0571-08	Binding head tap tight screw	3B
30	●	Cassette lid	☆ 3A
31	—	—	—
32	F31-0403-08	Power transformer holder	4A
33	●	Power transformer	☆ 4A
34	F20-0404-08	Insulation plate	☆ 4A
35	●	POWER SUPPLY/AUTO STOP PC board ass'y	☆ 4B
36	F10-1009-08	Shielding plate for power transformer	☆ 4A
37	J42-0308-08	Bushing	4B
38	J21-2243-08	Top plate	☆ 5B
39	J19-0468-08	Lead holder	5B
40	J21-2241-08	Side plate	☆ 5A,5B
41	F20-0403-08	Shielding plate for motor	☆ 5B
42	J21-2242-08	Middle plate	☆ 5B
43	—	—	—
44	F20-0402-08	Insulating sheet for power switch	☆ 5B
45	B31-0501-05	VU meter	☆ 5A
46	J21-2244-08	VU meter holder	☆ 5A
47	X25-1300-00	PEAK LED PC board ass'y	☆ 5A
48	X25-1270-00	TEST TONE PC board ass'y	☆ 6B
49	●	Power switch	☆ 5A
50	E11-0304-08	Headphone jack	6A
51	S40-2304-08	Pushbutton switch for memory rewind operation	☆ 6A
52	X25-1290-00	LED PC board ass'y	☆ 6A

Fig. No.	Parts No.	Description	Remarks
53	R21-4302-08	Variable resistor 50kΩ(B) × 2 VR15, 16	☆ 6A
54	X25-1310-00	MIC JACK PC board ass'y	☆ 6B
55	X25-1260-01	REC/PLAY/OSC PC board ass'y	☆ 6B
56	K23-0612-08	Knob (OSC)	☆ 6A
57	K23-0610-08	Knob (MEMORY REWIND)	☆ 6A
58	J21-2240-08	Back plate	☆ 6A
59	—	—	—
60	A21-0646-08	VU meter dress board	☆ 6A
61	X25-1360-00	MUTING (2) PC board ass'y	☆ 2A
62	—	—	—
63	—	—	—
64	—	—	—
65	—	—	—
66	—	—	—
67	—	—	—
68	—	—	—
69	—	—	—
70	T42-0104-08	Motor	7B
71	G13-0415-08	Rubber for motor	☆ 7B
72	J31-0128-08	Faucet for motor	7B
73	D21-0624-08	Stopping shaft	☆ 7B
74	N09-0208-18	Flywheel thrust adjusting screw	☆ 7B
75	J19-1224-08	Flywheel holder ass'y	☆ 7B
76	G01-0638-08	Spring for returning	☆ 7A
77	D10-0521-08	Link lever for removing pause lock	☆ 7A
78	D10-0477-08	Lever (1) ass'y for removing pause lock	☆ 7A
79	D15-0503-08	Motor pulley ass'y	☆ 7B
80	N70-2003-16	Set screw	7B
81	S46-1302-08	Leaf switch (PAUSE)	7A
82	T94-0055-08	Plunger	☆ 7A
83	D10-0478-08	Shut-off lever (2) ass'y	☆ 7A
84	—	—	—
85	D10-0484-08	Shut-off lever (1)	☆ 7A
86	D01-0303-08	Flywheel ass'y	☆ 7A
87	N19-0234-08	Washer φ2.5 × 0.25	7A
88	N19-0504-08	Polyethylene slider washer φ5 × φ2.5 × 0.25	7A
89	S46-1304-08	Leaf switch for motor	7A
90	—	—	—
91	G01-0294-08	Record prevention spring	☆ 8A
92	D10-0197-08	Brake operation lever	7A
93	D10-0199-08	Lock defeat plate	8A
94	G01-0632-08	Brake operation lever spring	☆ 8B
95	D10-0469-18	Pause operation lever ass'y	☆ 8B
96	G01-0633-08	Pause operation lever spring	☆ 8B
97	D10-0195-18	FF interlock lever ass'y	8B
98	G01-0297-08	FF interlock lever spring	7B
99	D16-0206-08	Flat belt	☆ 7B
100	D10-0468-08	FR lever block ass'y	☆ 7B
101	D10-0193-08	FR lever ass'y	7A
102	D14-0204-08	Idler "A" ass'y (FW idler)	☆ 8B
103	D14-0055-08	Idler "A1" ass'y	8B
104	D14-0203-08	Idler "A2" ass'y	8B
105	N19-0529-08	Washer φ2.5 × 0.1	8B

A

B

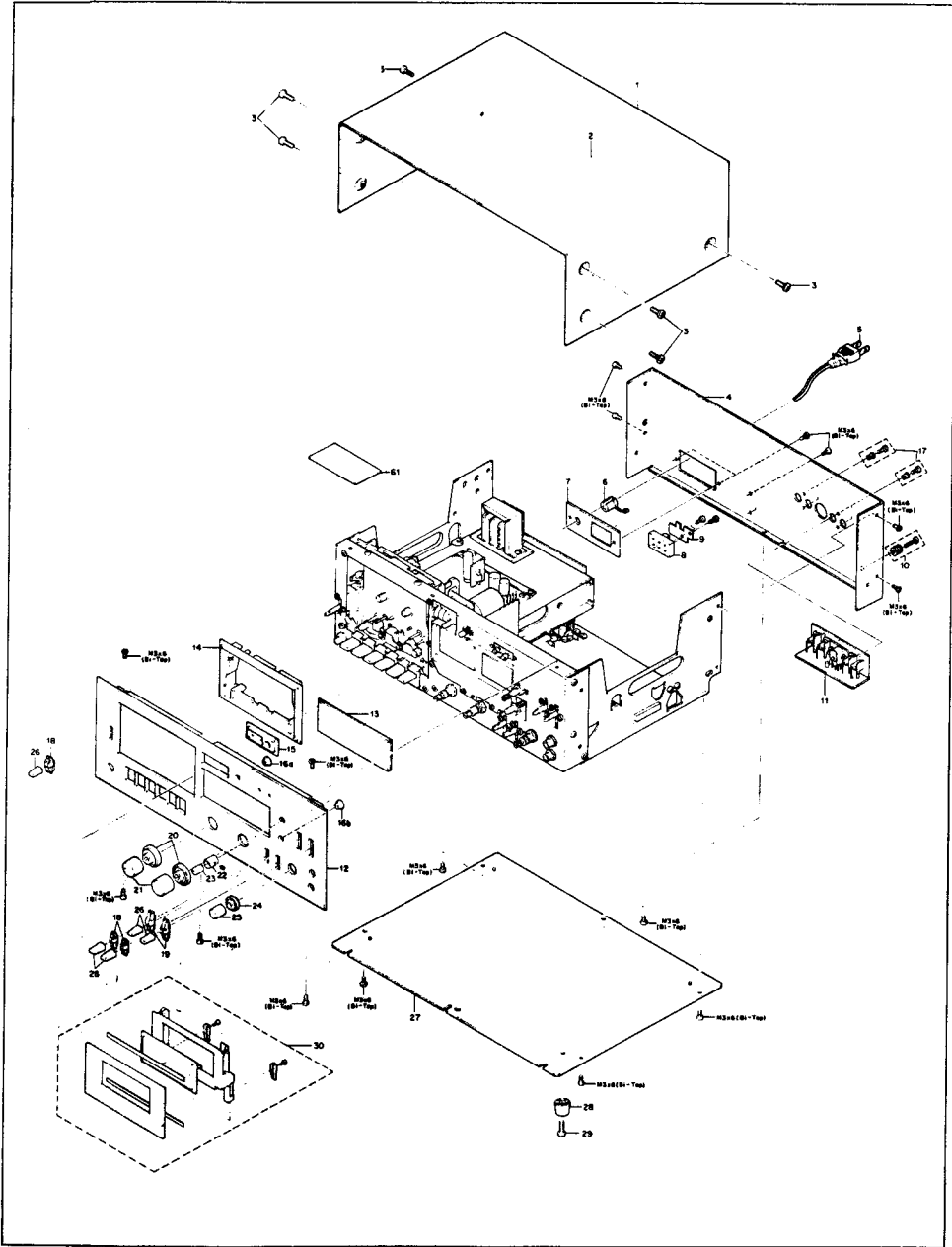

A

B

