

A MECHA ASS'Y  
 D40-1267-06 (M, X) (X-87) D40-1280-05 (T, E) (X-87)  
 D40-1267-05 (M, X) (X-87) D40-1267-06 (M, X, T, E) (X-87)

X28-2550-01 (M, X) (X-97) (JAPAN MADE)  
 X28-2550-06 (X, T, E) (X-87) (SINGAPORE MADE)

X28-2550-03 (M,  
 X28-2550-08 (M)

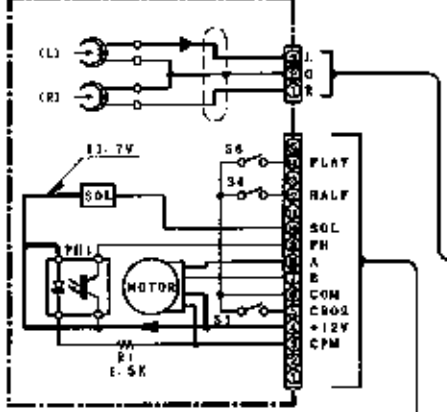

PH1 : NJM5106K  
 B MECHA ASS'Y  
 D40-1260-06 (M, X) (X-87)  
 D40-1258-05 (M, X) (X-87)  
 D40-1261-06 (T, E) (X-87)  
 D40-1260-06 (M, X, T, E) (X-57)

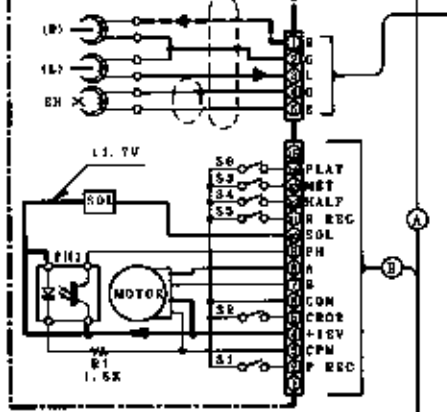

PH1 : NJM5165X  
 IC1 : MS0845-1525P  
 IC2 : HA12157N  
 IC3 : MSMS887I  
 IC5 : XRU4052R or TC4052RP  
 IC6, 7 : TA812ES  
 IC8-10 : RC4585D or NJM4585D  
 IC11, 12 : XRA1088R  
 IC13 : DA15218-DX or RC4585D-D or NJM4585D-D

Q1 : 2SB1870  
 Q2 : 2SD2081  
 Q3, 10 : 2SA200 (E, F)  
 Q4-8 : 2SC3940A  
 Q11-13, 20 : 2SA100A (Q, R) or 2SA1048 (Y, GR)  
 Q14-18 : 2SC9911A (Q, R) or 21-27, 47, 48 3SC2458 (Y, GR)  
 Q28-31 : UN4112 or DTA124ES  
 Q19, 32-38 : UN4213 or DTC124ES  
 42-46, 48-58  
 D1-11, 89 : 5S6888 or JSR159-100 84, 87  
 D12, 18 : 3B7210  
 D14-16 : RD2, 7ES (B2) or HZ52, 7N (B2)  
 D17 : RD3, 8ES (B8) or HZ53, 3N (B2)  
 D18, 19 : RD4, 7ES (B) or HZ54, 7N (B)  
 D108 : RD5, 9ES (B2) or HZ56, 6N (B2)  
 D20 : RD6, 2ES (B2) or HZ56, 2N (B2)  
 D21 : RD6, 2ES (B3) or HZ56, 2N (B2)  
 D22 : RD24ES (D) or HZ584N (B)  
 D23 : RD3DES (B) or HZ590N (B)  
 D24-62 : 1S3199 or HSS104  
 65-88 :  
 89-102 :  
 L9 : L32-0888-05  
 ED1 : FIP9CM8R

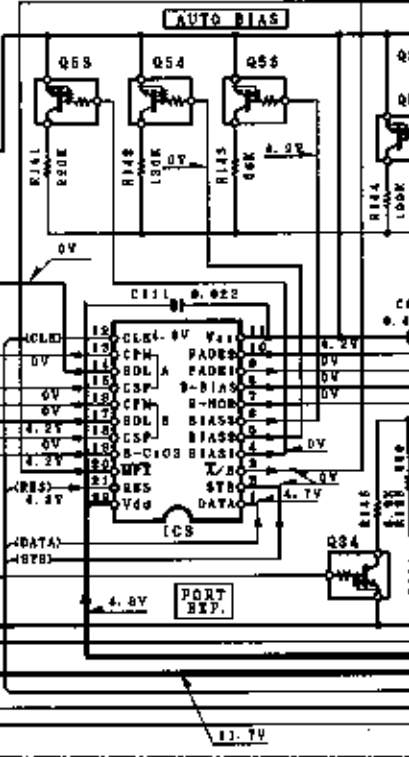
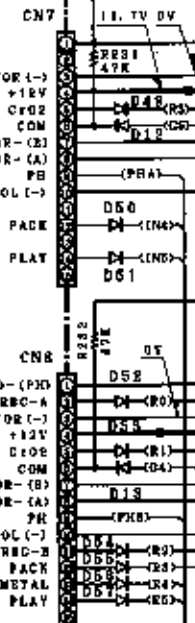
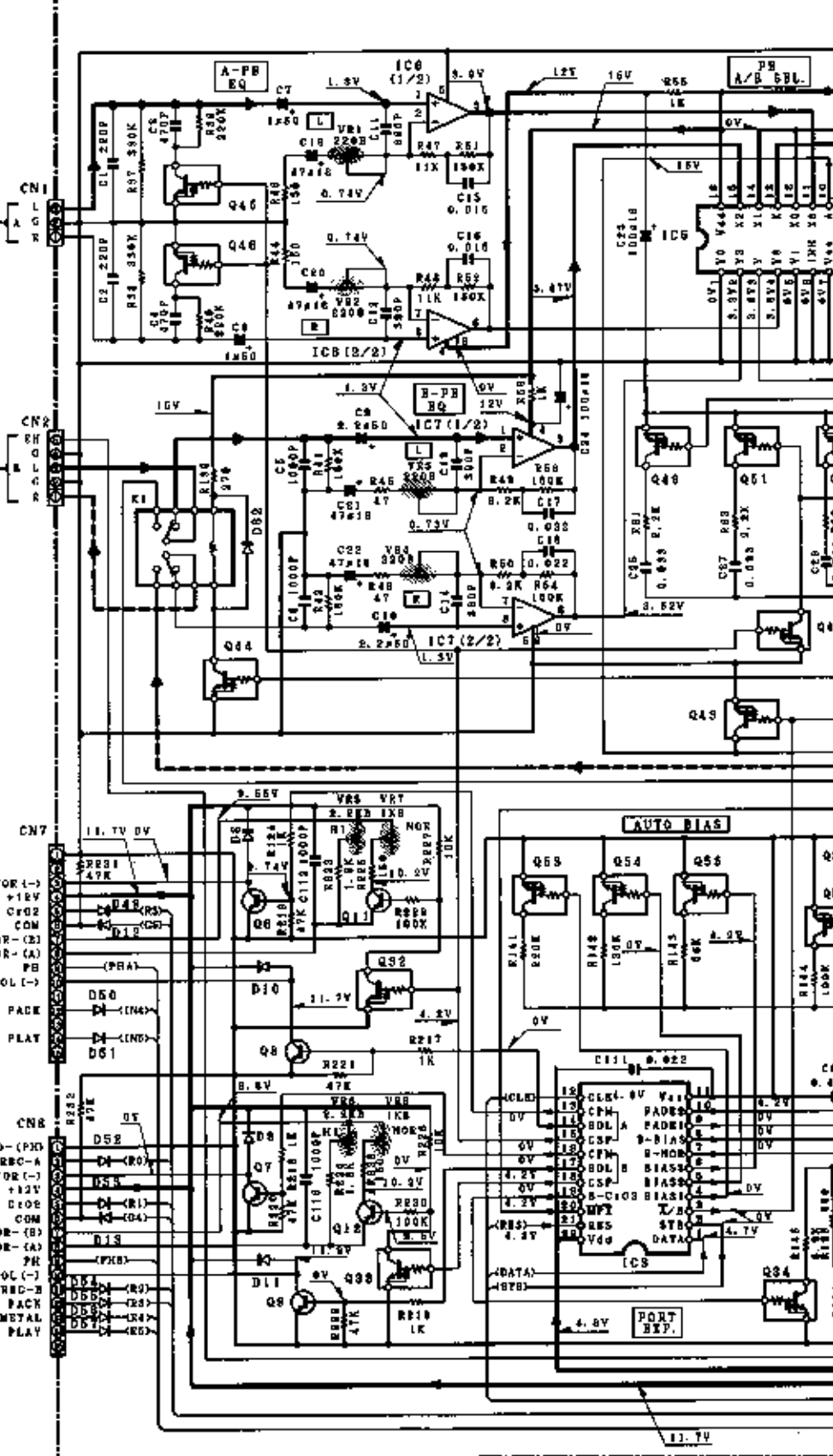



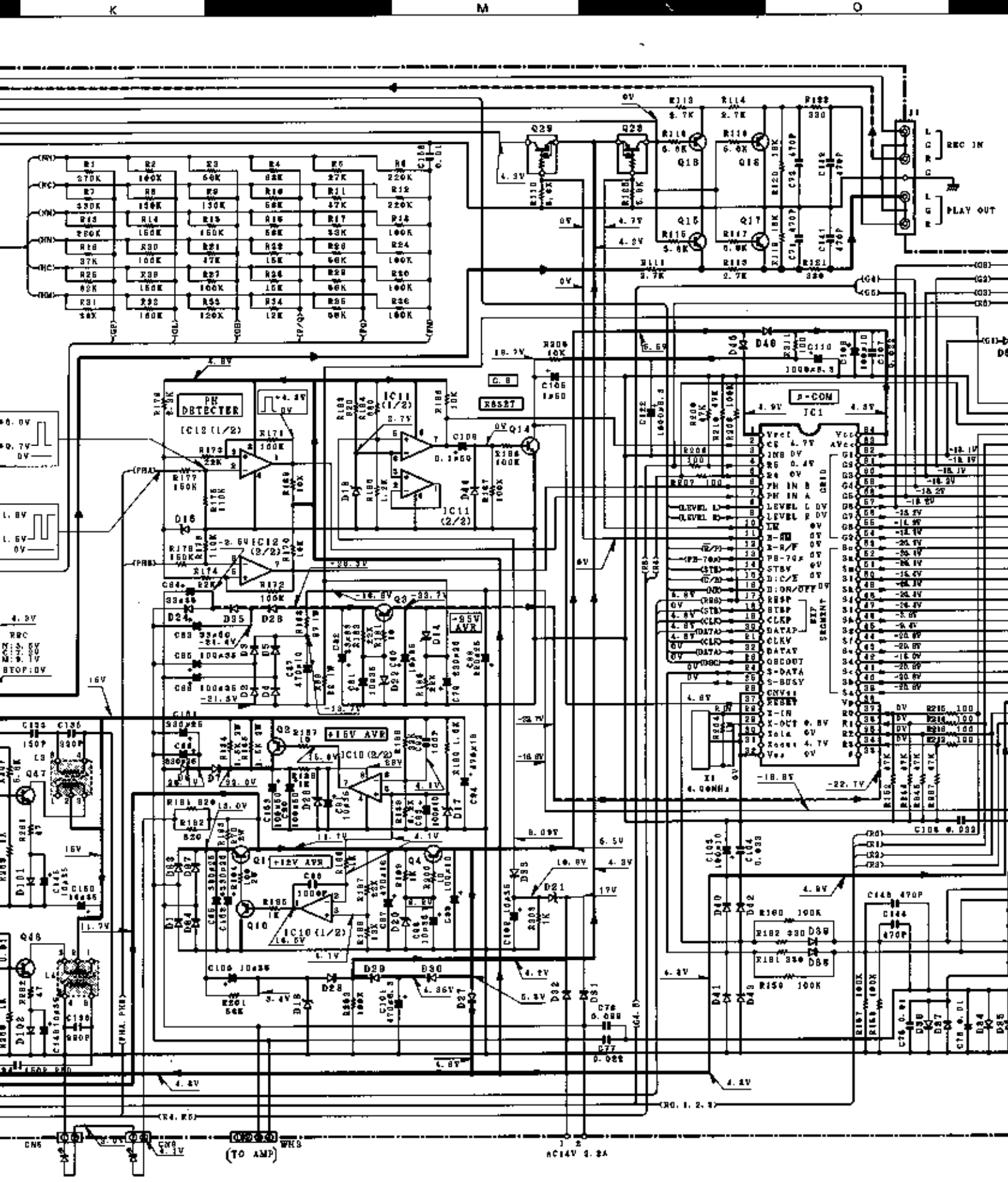

Die angegebenen Gleichspannungswerte wurden bei eingesetzter Cassette in der Wiedergabe mit einem hochohmigen Spannungsmesser gemessen. Dabei schwanken die Meßwerte aufgrund von Unterschieden zwischen einzelnen Instrumenten oder Geräten u. U. geringfügig. Die angegebenen Gleichspannungswerte der Vormagnetsierungsschaltung wurden in der Aufnahme-Betriebsart gemessen.

Les tensions c.c. doivent être mesurées avec un voltmètre à haute impédance, une cassette étant insérée en mode de lecture. Les valeurs peuvent différer légèrement du fait des variations inhérentes aux appareils et aux instruments de mesure individuels. Les tensions c.c. du circuit de polarité doivent être mesurées, l'appareil étant en mode d'enregistrement.

DC voltages are to be measured with a high impedance voltmeter, a cassette tape being inserted in playback mode. The values may vary slightly due to variations between individual instruments and devices. The DC voltages of the polarity circuit should be measured, the device being in recording mode.

Table of DC voltage measurements (CG. 1. 2. 3):

CG. 1	16V
CG. 2	4.5V
CG. 3	1.5V
CG. 4	0V
CG. 5	0.02V
CG. 6	0.02V
CG. 7	0.02V
CG. 8	0.02V
CG. 9	0.02V
CG. 10	0.02V
CG. 11	0.02V
CG. 12	0.02V
CG. 13	0.02V
CG. 14	0.02V
CG. 15	0.02V
CG. 16	0.02V
CG. 17	0.02V
CG. 18	0.02V
CG. 19	0.02V
CG. 20	0.02V
CG. 21	0.02V
CG. 22	0.02V
CG. 23	0.02V
CG. 24	0.02V
CG. 25	0.02V
CG. 26	0.02V
CG. 27	0.02V
CG. 28	0.02V
CG. 29	0.02V
CG. 30	0.02V
CG. 31	0.02V
CG. 32	0.02V
CG. 33	0.02V
CG. 34	0.02V
CG. 35	0.02V
CG. 36	0.02V
CG. 37	0.02V
CG. 38	0.02V
CG. 39	0.02V
CG. 40	0.02V
CG. 41	0.02V
CG. 42	0.02V
CG. 43	0.02V
CG. 44	0.02V
CG. 45	0.02V
CG. 46	0.02V
CG. 47	0.02V
CG. 48	0.02V
CG. 49	0.02V
CG. 50	0.02V
CG. 51	0.02V
CG. 52	0.02V
CG. 53	0.02V
CG. 54	0.02V
CG. 55	0.02V
CG. 56	0.02V
CG. 57	0.02V
CG. 58	0.02V
CG. 59	0.02V
CG. 60	0.02V
CG. 61	0.02V
CG. 62	0.02V
CG. 63	0.02V
CG. 64	0.02V
CG. 65	0.02V
CG. 66	0.02V
CG. 67	0.02V
CG. 68	0.02V
CG. 69	0.02V
CG. 70	0.02V
CG. 71	0.02V
CG. 72	0.02V
CG. 73	0.02V
CG. 74	0.02V
CG. 75	0.02V
CG. 76	0.02V
CG. 77	0.02V
CG. 78	0.02V
CG. 79	0.02V
CG. 80	0.02V
CG. 81	0.02V
CG. 82	0.02V
CG. 83	0.02V
CG. 84	0.02V
CG. 85	0.02V
CG. 86	0.02V
CG. 87	0.02V
CG. 88	0.02V
CG. 89	0.02V
CG. 90	0.02V
CG. 91	0.02V
CG. 92	0.02V
CG. 93	0.02V
CG. 94	0.02V
CG. 95	0.02V
CG. 96	0.02V
CG. 97	0.02V
CG. 98	0.02V
CG. 99	0.02V
CG. 100	0.02V

X28-255X-XX (B/4)

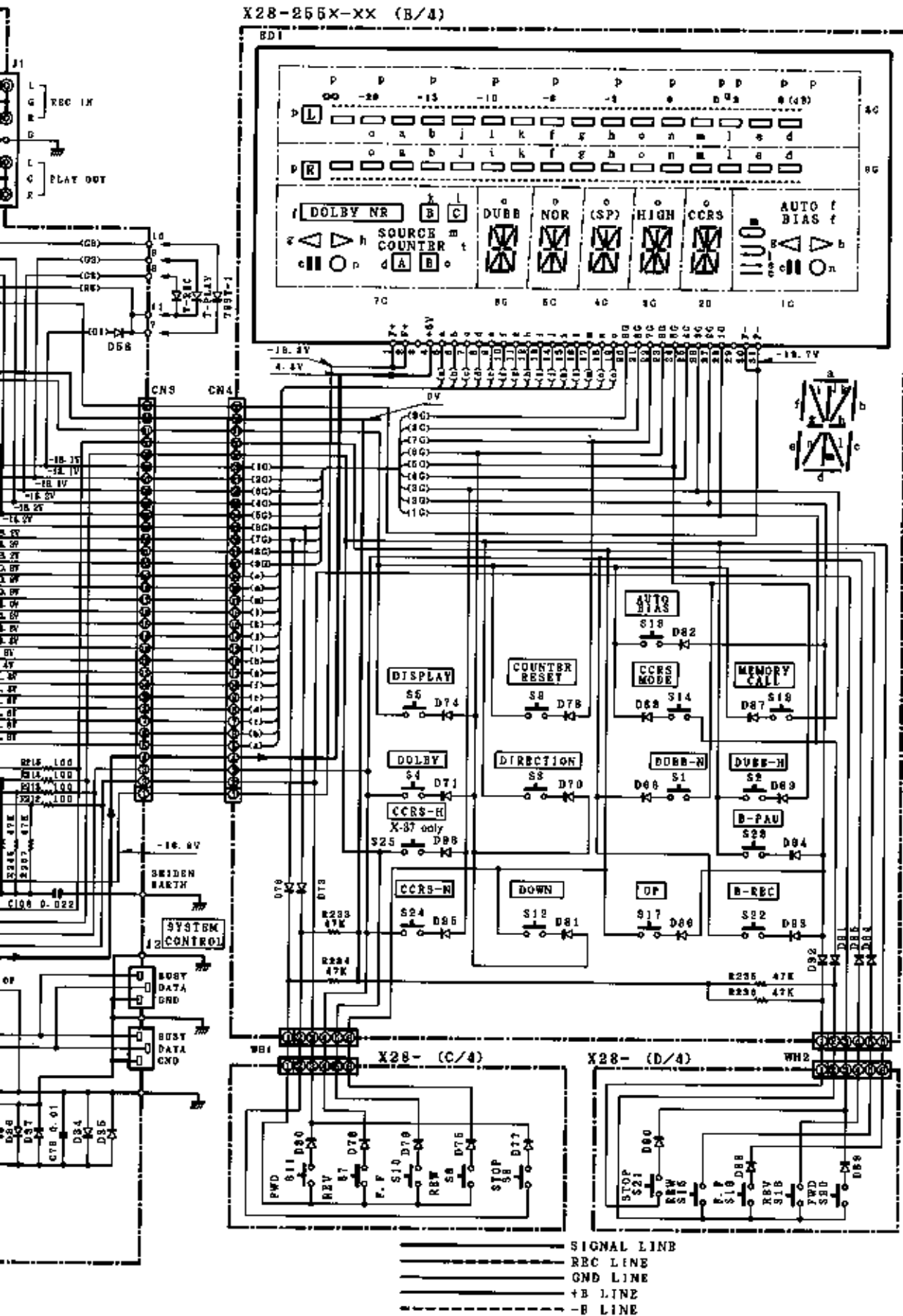

2SA999  
2SC3940A

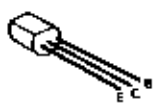

2SA1175  
2SC2785

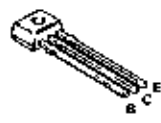

DTA124ES  
DTC124ES  
UN4112  
2SA1048  
2SA933S  
2SC1740S  
2SC2458

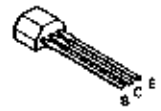

2SB1370  
2SD2061



UN4212  
2SA1309A  
2SC3311A

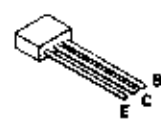

MSM59371

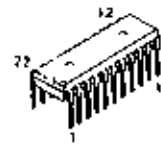

**CAUTION:** For continued safety, replace safety critical components only with manufacturer's recommended parts (refer to parts list). **⚠** Indicates safety critical components. To reduce the risk of electric shock, leakage-current or resistance measurements shall be carried out (exposed parts are acceptably insulated from the supply circuit) before the appliance is returned to the customer.

DC voltages are as measured with a high impedance voltmeter with a cassette loaded at playback mode. Values may vary slightly due to variations between individual instruments and units. Bias circuit DC voltages are as measured while in the record mode.

Y26-3700-21







# EXPLODED VIEW (MECHANISM UNIT)

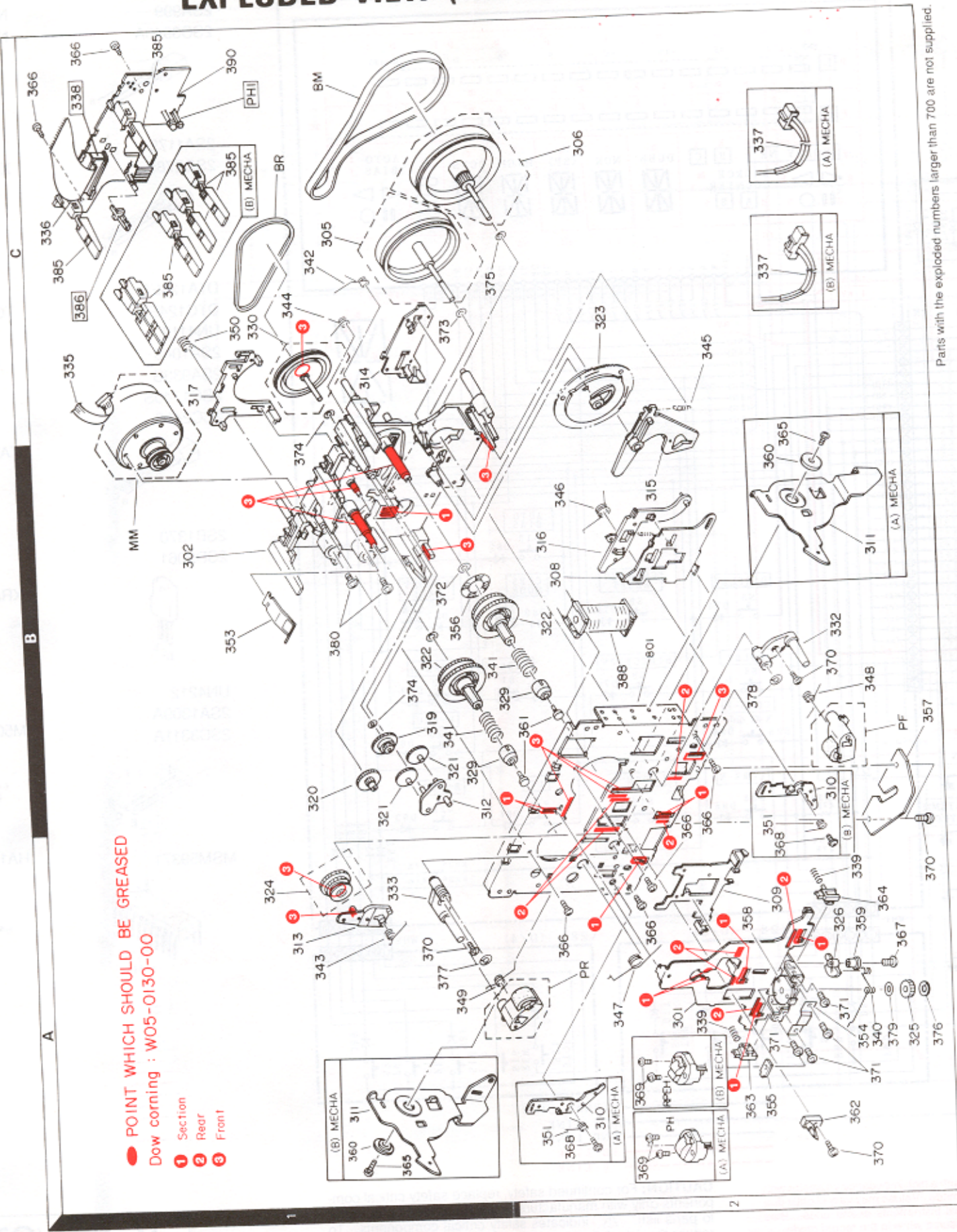

**● POINT WHICH SHOULD BE GREASED**  
 Dow corning : W05-0130-00

- 1** Section
- 2** Rear
- 3** Front

Parts with the exploded numbers larger than 700 are not supplied.



## EXPLODED VIEW (UNIT)

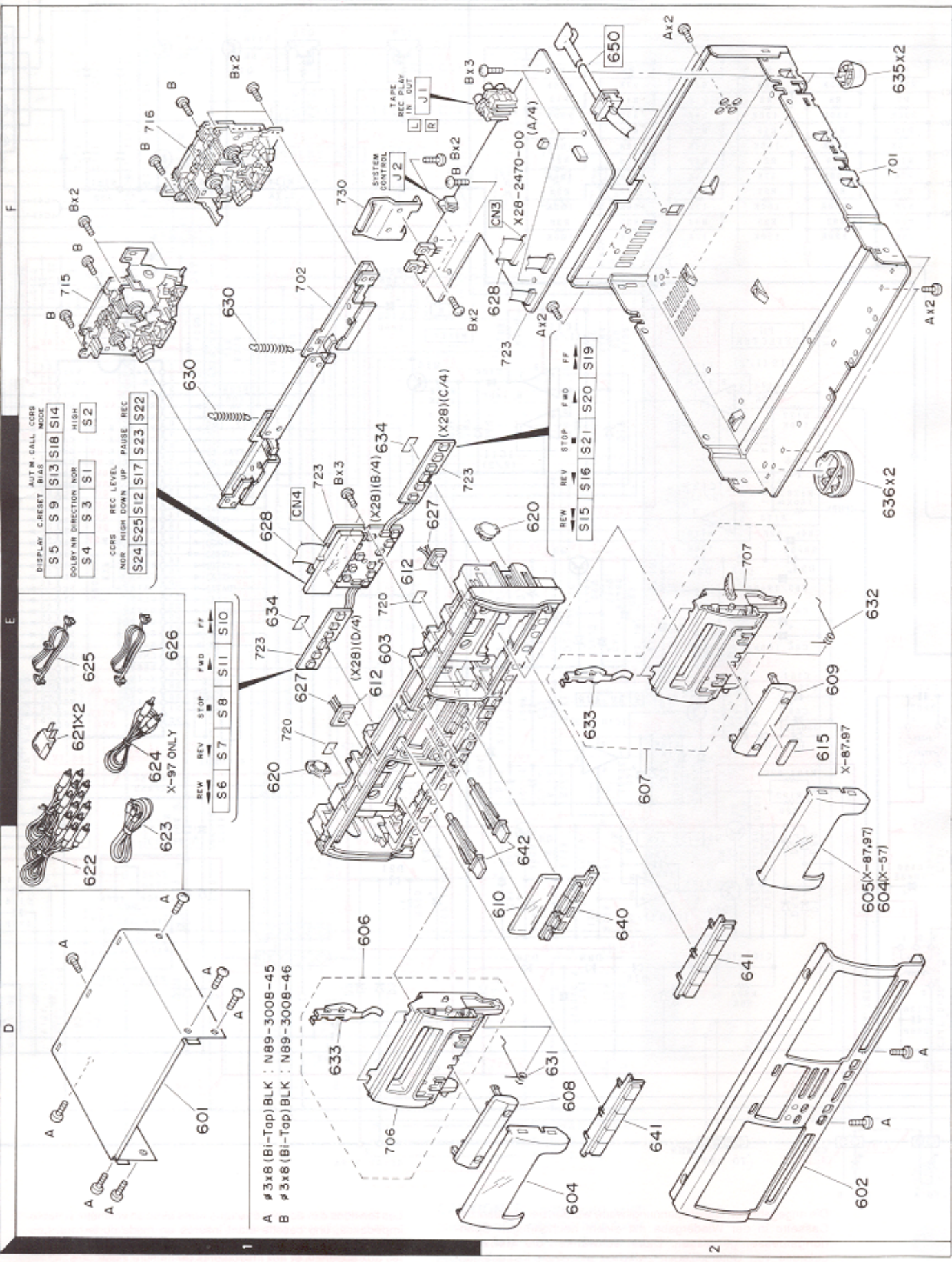

Parts with the exploded numbers larger than 700 are not supplied.



PARTS LIST

No.2

\* New Parts  
Parts without Parts No. are not supplied.  
Les articles non mentionnés dans le Parts No. ne sont pas fournis.  
Teile ohne Parts No. werden nicht geliefert.

Ref. No. 参照番号	Address 位置	Parts No. 部品番号	Description 部品名 / 規格	Desti- nation 仕
606	1D	A53-1378-03	CASSETTE HOLDER ASSY	A
607	2E	A53-1380-03	CASSETTE HOLDER ASSY	B
608	2D	807-2210-03	ESCUTCHEON	A
609	2E	807-2211-03	ESCUTCHEON	B
610	2D	810-1929-04	FRONT GLASS	A
612	1E	830-0740-05	LED(SUB-201C) TAPE BACK LIGHT	A
615	2E	843-0297-04	BADGE	B
-	-	846-0096-33	WARRANTY CARD	X
-	-	846-0310-03	WARRANTY CARD	TE
620	1E, 2E	039-0176-05	DAMPER	M
622	1E	E03-0115-05	AC PLUG ADAPTER	M
623	1E	E30-0505-05	AUDIO CORD	A
624	1D	E30-0615-05	AUDIO CORD	B
625	1E	E30-2627-05	CORD WITH CONNECTOR	A
626	1E	E30-2628-05	CORD WITH CONNECTOR	B
627	1E	E31-4860-05	WIRING HARNESS LED LEAD WIRE	A
628	1E, 2F	E35-0165-05	FLAT CABLE CN3-CN4	B
630	1F	G01-3405-04	EXTENSION SPRING	J
631	2D	G01-3406-04	TORSION COIL SPRING	J
632	2E	G01-3407-04	TORSION COIL SPRING	J
633	1D, 2E	G02-0944-04	FLAT SPRING	S
634	1E	G11-0155-14	SOFT TAPE	S
-	-	H10-5334-02	POLYSTYRENE FOAMED FIXTURE L	M
-	-	H10-5335-02	POLYSTYRENE FOAMED FIXTURE R	MX
-	-	H10-5590-02	POLYSTYRENE FOAMED FIXTURE L	EX
-	-	H10-5590-02	POLYSTYRENE FOAMED FIXTURE R	EX
-	-	H20-0564-04	PROTECTION COVER	T
-	-	H25-0232-04	PROTECTION BAG (235X350X0.03)	M
-	-	H25-0304-04	PROTECTION BAG (0232 PRINTED)	MX
-	-	H25-0451-04	PROTECTION BAG (0232 PRINTED)	EX
-	-	H25-0456-04	PROTECTION BAG (0304 PRINTED)	T
-	-	H50-0768-04	ITEM CARTON CASE	J
-	-	H50-0784-04	ITEM CARTON CASE	M
-	-	H50-0785-04	ITEM CARTON CASE	X
-	-	H50-0807-04	ITEM CARTON CASE	TE
635	2E	J02-0366-15	FOOT	J
636	2E	J02-1040-05	FOOT	S
640	2D	K29-4431-04	KN08 SELECTOR	S
641	2D	K29-4432-03	KN08 MECHANISM CONTROL	S
642	2D	K29-4433-04	KN08 EJECT	S
A	1D, 2F	N89-3008-45	BINDING HEAD TAPTITE SCREW	J

X-97 (UNIT)  
METALLIC CABINET  
PANEL  
SUB PANEL  
CASSETTE LID  
CASSETTE LID  
CASSETTE LID  
CASSETTE HOLDER ASSY  
CASSETTE HOLDER ASSY  
ESCUTCHEON  
CASSETTE HOLDER

L:Scandinavia  
Y:PAF(East, Hawaii)  
Y:AFES(Europe)

K:USA  
T:England  
X:Australia  
M:Other Areas

J: Japan made  
S: Singapore made  
A: A DECK  
B: B DECK

△ indicates safety critical components

No.1

\* New Parts  
Parts without Parts No. are not supplied.  
Les articles non mentionnés dans le Parts No. ne sont pas fournis.  
Teile ohne Parts No. werden nicht geliefert.

Ref. No. 参照番号	Address 位置	Parts No. 部品番号	Description 部品名 / 規格	Desti- nation 仕
601	1D	A01-1905-21	METALLIC CABINET	A
602	2D	A60-0484-02	PANEL	B
603	1E	A22-1570-01	SUB PANEL	A
604	2D	A53-1376-03	CASSETTE LID	B
606	1D	A53-1378-03	CASSETTE HOLDER ASSY	A
607	2E	A53-1380-03	CASSETTE HOLDER ASSY	B
608	2D	807-2210-03	ESCUTCHEON	A
609	2E	807-2211-03	ESCUTCHEON	B
610	2D	810-1929-04	FRONT GLASS	A
612	1E	807-1720-04	WARRANTY CARD	X
-	-	846-0096-33	WARRANTY CARD	TE
-	-	846-0310-03	WARRANTY CARD	M
620	1E, 2E	039-0176-05	DAMPER	M
622	1E	E03-0115-05	AC PLUG ADAPTER	M
623	1E	E30-0505-05	AUDIO CORD	A
624	1E	E30-0615-05	AUDIO CORD	B
625	1E	E30-2627-05	CORD WITH CONNECTOR	A
626	1E	E30-2628-05	CORD WITH CONNECTOR	B
628	1E, 2F	E35-0165-05	FLAT CABLE CN3-CN4	A
630	1F	G01-3405-04	EXTENSION SPRING	J
631	2D	G01-3406-04	TORSION COIL SPRING	J
632	2E	G01-3407-04	TORSION COIL SPRING	J
633	1D, 2E	G02-0944-04	FLAT SPRING	S
634	1E	G11-0155-14	SOFT TAPE	S
-	-	H10-5334-02	POLYSTYRENE FOAMED FIXTURE L	M
-	-	H10-5335-02	POLYSTYRENE FOAMED FIXTURE R	MX
-	-	H10-5590-02	POLYSTYRENE FOAMED FIXTURE L	EX
-	-	H10-5590-02	POLYSTYRENE FOAMED FIXTURE R	EX
-	-	H20-0564-04	PROTECTION COVER	T
-	-	H25-0232-04	PROTECTION BAG (235X350X0.03)	M
-	-	H25-0304-04	PROTECTION BAG (0232 PRINTED)	MX
-	-	H25-0451-04	PROTECTION BAG (0232 PRINTED)	EX
-	-	H25-0456-04	PROTECTION BAG (0304 PRINTED)	T
-	-	H50-0770-04	ITEM CARTON CASE	J
-	-	H50-0821-04	ITEM CARTON CASE	M
-	-	H50-0822-04	ITEM CARTON CASE	X
-	-	H50-0854-04	ITEM CARTON CASE	TE
635	2E	J02-0366-15	FOOT	J
636	2E	J02-1040-05	FOOT	S
640	2D	K29-4431-04	KN08 SELECTOR	S
641	2D	K29-4432-03	KN08 MECHANISM CONTROL	S
642	2D	K29-4433-04	KN08 EJECT	S
A	1D, 2F	N89-3008-45	BINDING HEAD TAPTITE SCREW	J

X-87 (UNIT)  
METALLIC CABINET  
PANEL  
SUB PANEL  
CASSETTE LID  
CASSETTE LID

L:Scandinavia  
Y:PAF(East, Hawaii)  
Y:AFES(Europe)

K:USA  
T:England  
X:Australia  
M:Other Areas

J: Japan made  
S: Singapore made  
A: A DECK  
B: B DECK

△ indicates safety critical components



PARTS LIST

No.4

Parts without Parts No. are not supplied.  
Les articles non mentionnés dans le Parts No. ne sont pas fournis.  
Teile ohne Parts No. werden nicht geliefert.

Ref. No. 参照番号	Address 位置	Parts No. 部品番号	Description 部品名 / 規格	Desti- nation 向	Re- marks 備考
C29		CE04KW1C33JM	ELECTR0		J
C29		CE04LM1C33IM	ELECTR0		S
C30		CE04KM1V100M	ELECTR0		J
C30		CE04LM1V100M	ELECTR0		S
C31	.32	CE04KW1H010M	ELECTR0		J
C31	.32	CE04LM1H010M	ELECTR0		S
C33	.34	CE04KW1HR47M	ELECTR0		J
C33	.34	CE04LM1HR47M	ELECTR0		S
C33	.34	CE04KW1HR47M	ELECTR0		J
C33	.34	CE04LM1HR47M	ELECTR0		S
C35	.36	CE04KW1H010M	ELECTR0		J
C35	.36	CE04LM1H010M	ELECTR0		S
C37	.38	CE04KW1HR47M	ELECTR0		J
C37	.38	CE04LM1HR47M	ELECTR0		S
C39		CE04KW1H010M	ELECTR0		J
C39		CE04LM1H010M	ELECTR0		S
C40		CK45FSL1H472Z	CERAMIC		J
C41	.42	CE04KW1H010M	ELECTR0		J
C41	.42	CE04LM1H010M	ELECTR0		S
C43	.44	CK45FSL1H222K	CERAMIC		J
C45	.46	CC45FSL1H221J	CERAMIC		S
C47	.48	CE04KW1H2R2M	ELECTR0		J
C47	.48	CE04LM1H2R2M	ELECTR0		S
C49	.54	C092FMIH223Z	MYLAR		J
C55	.56	CE04KW1H010M	ELECTR0		J
C55	.56	CE04LM1H010M	ELECTR0		S
C57	.60	CE04KW1H0R1M	ELECTR0		J
C57	.60	CE04LM1H0R1M	ELECTR0		S
C61	.62	CK45FSL1H232Z	CERAMIC		J
C63	.64	CE04KW1V100M	ELECTR0		J
C63	.64	CE04LM1V100M	ELECTR0		S
C65	.66	CE04KW1H2R2M	ELECTR0		J
C65	.66	CE04LM1H2R2M	ELECTR0		S
C67	.68	CE04KW1HR47M	ELECTR0		J
C67	.68	CE04LM1HR47M	ELECTR0		S
C69	.70	CE04KW1H2R2M	ELECTR0		J
C69	.70	CE04LM1H2R2M	ELECTR0		S
C71	.72	CK45FSL1H471K	CERAMIC		J
C71	.72	CK45FSL1H471K	CERAMIC		S
C73	.74	CC45FSL1H180J	CERAMIC		J
C73	.74	CC45FSL1H180J	CERAMIC		S
C76	.78	CK45FSL1H03Z	CERAMIC		J
C76	.78	CK45FSL1H03Z	CERAMIC		S
C79		CE04KW1E221M	ELECTR0		J
C79		CE04LM1E221M	ELECTR0		S
C80	.81	CE04KW1V100M	ELECTR0		J
C80	.81	CE04LM1V100M	ELECTR0		S
C82		CE04KW1J330M	ELECTR0		J
C82		CE04LM1J330M	ELECTR0		S
C83		CE04KW1H330M	ELECTR0		J
C83		CE04LM1H330M	ELECTR0		S
C84		CE04KW1V330M	ELECTR0		J
C84		CE04LM1V330M	ELECTR0		S
C85	.86	CE04KW1V101M	ELECTR0		J
C85	.86	CE04LM1V101M	ELECTR0		S
C87		CE04KW1A471M	ELECTR0		J
C87		CE04LM1A471M	ELECTR0		S

K New Parts

Parts without Parts No. are not supplied.  
Les articles non mentionnés dans le Parts No. ne sont pas fournis.  
Teile ohne Parts No. werden nicht geliefert.

No.3

Parts without Parts No. are not supplied.  
Les articles non mentionnés dans le Parts No. ne sont pas fournis.  
Teile ohne Parts No. werden nicht geliefert.

Ref. No. 参照番号	Address 位置	Parts No. 部品番号	Description 部品名 / 規格	Desti- nation 向	Re- marks 備考
609	2E	B07-2211-03	ESCUTCHEON		B
610	2D	B10-1929-04	FRONT GLASS		
612	1E	B30-0710-05	LEDS(LF-201C) TAPE BACK LIGHT		
615	2E	B43-0237-04	RANGE	X	
		B46-0096-33	WARRANTY CARD		
		B46-0310-03	WARRANTY CARD		
620	1E, 2E	039-0176-05	DAMPER		
621	1E	E03-0115-05	AC PLUG ADAPTER		
622	1E	E30-0505-05	AUDIO CORD	M	
623	1D	E30-0415-05	AUDIO CORD		
624	1D	E30-1427-05	AUDIO CORD		
625	1E	E30-2627-05	CORD WITH CONNECTOR		
626	1E	E30-2628-05	CORD WITH CONNECTOR		
627	1E	E31-4860-05	WIRING HARNESS		
628	1E, 2F	E35-0165-05	FLAT CABLE CN3-CN4		
630	1F	G01-3405-04	EXTENSION SPRING		
631	2D	G01-3406-04	TORSION COIL SPRING		
632	2E	G01-3407-04	TORSION COIL SPRING		
633	1D, 2E	G02-0944-04	TORSION COIL SPRING		
634	1E	G10-0146-04	NON-WOVEN FABRIC		
		H10-5334-02	POLYSTYRENE FRAMED FIXTURE L		
		H10-5335-02	POLYSTYRENE FRAMED FIXTURE R		
		H20-0564-04	PROTECTION COVER	A	
		H25-0232-04	PROTECTION BAG (235X350X0.03)	B	
		H25-0304-04	PROTECTION BAG		
		H50-0767-04	ITEM CARTON CASE	X	
635	2F	J02-0366-15	FOOT		
636	2E	J02-1040-05	FOOT		
640	2D	K29-4431-04	REAR		
641	2D	K29-4432-03	FRONT		
642	2D	K29-4433-04	KN08 SELECTOR		
			KN08 MECHANISM CONTROL		
			KN08 EJECT		
A	1D, 2F	M89-3008-45	RECORD/PLAYBACK AMPLIFIER UNIT (X28-2550-XX)		
C1	.2	CC45FSL1H221J	220PF J		
C3	.4	CK45FSL1H471K	470PF K		
C5	.6	CK45FSL1H02K	1000PF K		
C5	.6	CK45FSL1H102K	1000PF K		
C5	.6	CK45FSL1H561K	560PF K		
C7	.8	CE04KW1H010M	ELECTR0		9
C7	.8	CE04LM1H010M	ELECTR0		5
C9	.10	CE04KW1H2R2M	ELECTR0		J
C9	.10	CE04LM1H2R2M	ELECTR0		S
C11	.14	CK45FSL1H391K	ELECTR0		J
C11	.14	CK45FSL1H391K	ELECTR0		S
C15	.16	C092FMIH153J	MYLAR		J
C17	.18	C092FMIH223Z	MYLAR		J
C19	.22	CE04KW1C470M	ELECTR0		J
C19	.22	CE04LM1C470M	ELECTR0		S
C23	.24	CE04KW1C101M	ELECTR0		J
C23	.24	CE04LM1C101M	ELECTR0		S
C23	.24	CE04KW1C101M	ELECTR0		J
C25	.26	CF92FMIH333Z	MF		J
C27	.28	CK45FSL1H333Z	CERAMIC		J

K New Parts

Parts without Parts No. are not supplied.  
Les articles non mentionnés dans le Parts No. ne sont pas fournis.  
Teile ohne Parts No. werden nicht geliefert.

L:Scandinavia  
Y:PA(Far East, Hawaii)  
Y:AMFES(Europe)  
K:USA  
T:England  
X:Australia  
P:Canada  
E:Europe  
M:Other Areas  
J: Japan made  
S: Singapore made  
A: A DECK  
B: B DECK  
5: X-57  
8: X-87  
9: X-97  
△ indicates safety critical components



PARTS LIST

No.6

\* New Parts  
Parts without Parts No. are not supplied.  
Les articles non mentionnés dans le Parts No. ne sont pas fournis.  
Teile ohne Parts No. werden nicht geliefert.

Ref. No. 参照番号	Address 位置	Parts No. 部品番号	Description 部品名 / 規格	Desti- nation 仕向	Re- marks 備考
C122		CE04DW0J102M	ELECTRØ 1000UF 6.3WV	J	
C123		CE04EVOJ102M	ELECTRØ 1000UF 6.3WV	S	
C124		CC45FSL1H560J	CERAMIC 56PF J	J	
C125		CE04KW1H0R1M	ELECTRØ 0.1UF 50WV	J	
C126		CE04ALM1H0R1M	ELECTRØ 0.1UF 50WV	J	
C127		CK45EB1H561K	CERAMIC 56DPF K	9	
C128		CK45EB1H561K	CERAMIC 56DPF K	8	
C129		CK45EB1H561K	CERAMIC 0.010UF Z	9	
C130		CK45FF1H103Z	CERAMIC 0.010UF Z	8	
C131		CK45FF1H103Z	CERAMIC 0.010UF Z	9	
C132		CK45FF1H103Z	CERAMIC 0.010UF Z	8	
C133		CK45FF1H103Z	CERAMIC 0.010UF Z	9	
C134		CK45FF1H103Z	CERAMIC 0.010UF Z	8	
C135		CK45FF1H103Z	CERAMIC 0.010UF Z	9	
C136		CK45FF1H103Z	CERAMIC 0.010UF Z	8	
C137		CK45FF1H103Z	CERAMIC 0.010UF Z	9	
C138		CK45FF1H103Z	CERAMIC 0.010UF Z	8	
C139		CK45FF1H103Z	CERAMIC 0.010UF Z	9	
C140		CK45FF1H103Z	CERAMIC 0.010UF Z	8	
C141		CK45FF1H103Z	CERAMIC 0.010UF Z	9	
C142		CK45FF1H103Z	CERAMIC 0.010UF Z	8	
C143		CK45FF1H103Z	CERAMIC 0.010UF Z	9	
C144		CK45FF1H103Z	CERAMIC 0.010UF Z	8	
C145		CK45FF1H103Z	CERAMIC 0.010UF Z	9	
C146		CK45FF1H103Z	CERAMIC 0.010UF Z	8	
C147		CK45FF1H103Z	CERAMIC 0.010UF Z	9	
C148		CK45FF1H103Z	CERAMIC 0.010UF Z	8	
C149		CK45FF1H103Z	CERAMIC 0.010UF Z	9	
C150		CK45FF1H103Z	CERAMIC 0.010UF Z	8	
C151		CK45FF1H103Z	CERAMIC 0.010UF Z	9	
C152		CK45FF1H103Z	CERAMIC 0.010UF Z	8	
C153		CK45FF1H103Z	CERAMIC 0.010UF Z	9	
C154		CK45FF1H103Z	CERAMIC 0.010UF Z	8	
C155		CK45FF1H103Z	CERAMIC 0.010UF Z	9	
C156		CK45FF1H103Z	CERAMIC 0.010UF Z	8	
C157		CK45FF1H103Z	CERAMIC 0.010UF Z	9	
C158		CK45FF1H103Z	CERAMIC 0.010UF Z	8	
C159		CK45FF1H103Z	CERAMIC 0.010UF Z	9	
C160		CK45FF1H103Z	CERAMIC 0.010UF Z	8	
C161		CK45FF1H103Z	CERAMIC 0.010UF Z	9	
C162		CK45FF1H103Z	CERAMIC 0.010UF Z	8	
C163		CK45FF1H103Z	CERAMIC 0.010UF Z	9	
C164		CK45FF1H103Z	CERAMIC 0.010UF Z	8	
C165		CK45FF1H103Z	CERAMIC 0.010UF Z	9	
C166		CK45FF1H103Z	CERAMIC 0.010UF Z	8	
C167		CK45FF1H103Z	CERAMIC 0.010UF Z	9	
C168		CK45FF1H103Z	CERAMIC 0.010UF Z	8	
C169		CK45FF1H103Z	CERAMIC 0.010UF Z	9	
C170		CK45FF1H103Z	CERAMIC 0.010UF Z	8	
C171		CK45FF1H103Z	CERAMIC 0.010UF Z	9	
C172		CK45FF1H103Z	CERAMIC 0.010UF Z	8	
C173		CK45FF1H103Z	CERAMIC 0.010UF Z	9	
C174		CK45FF1H103Z	CERAMIC 0.010UF Z	8	
C175		CK45FF1H103Z	CERAMIC 0.010UF Z	9	
C176		CK45FF1H103Z	CERAMIC 0.010UF Z	8	
C177		CK45FF1H103Z	CERAMIC 0.010UF Z	9	
C178		CK45FF1H103Z	CERAMIC 0.010UF Z	8	
C179		CK45FF1H103Z	CERAMIC 0.010UF Z	9	
C180		CK45FF1H103Z	CERAMIC 0.010UF Z	8	
C181		CK45FF1H103Z	CERAMIC 0.010UF Z	9	
C182		CK45FF1H103Z	CERAMIC 0.010UF Z	8	
C183		CK45FF1H103Z	CERAMIC 0.010UF Z	9	
C184		CK45FF1H103Z	CERAMIC 0.010UF Z	8	
C185		CK45FF1H103Z	CERAMIC 0.010UF Z	9	
C186		CK45FF1H103Z	CERAMIC 0.010UF Z	8	
C187		CK45FF1H103Z	CERAMIC 0.010UF Z	9	
C188		CK45FF1H103Z	CERAMIC 0.010UF Z	8	
C189		CK45FF1H103Z	CERAMIC 0.010UF Z	9	
C190		CK45FF1H103Z	CERAMIC 0.010UF Z	8	
C191		CK45FF1H103Z	CERAMIC 0.010UF Z	9	
C192		CK45FF1H103Z	CERAMIC 0.010UF Z	8	
C193		CK45FF1H103Z	CERAMIC 0.010UF Z	9	
C194		CK45FF1H103Z	CERAMIC 0.010UF Z	8	
C195		CK45FF1H103Z	CERAMIC 0.010UF Z	9	
C196		CK45FF1H103Z	CERAMIC 0.010UF Z	8	
C197		CK45FF1H103Z	CERAMIC 0.010UF Z	9	
C198		CK45FF1H103Z	CERAMIC 0.010UF Z	8	
C199		CK45FF1H103Z	CERAMIC 0.010UF Z	9	
C200		CK45FF1H103Z	CERAMIC 0.010UF Z	8	
C201		CK45FF1H103Z	CERAMIC 0.010UF Z	9	
C202		CK45FF1H103Z	CERAMIC 0.010UF Z	8	
C203		CK45FF1H103Z	CERAMIC 0.010UF Z	9	
C204		CK45FF1H103Z	CERAMIC 0.010UF Z	8	
C205		CK45FF1H103Z	CERAMIC 0.010UF Z	9	
C206		CK45FF1H103Z	CERAMIC 0.010UF Z	8	
C207		CK45FF1H103Z	CERAMIC 0.010UF Z	9	
C208		CK45FF1H103Z	CERAMIC 0.010UF Z	8	
C209		CK45FF1H103Z	CERAMIC 0.010UF Z	9	
C210		CK45FF1H103Z	CERAMIC 0.010UF Z	8	
C211		CK45FF1H103Z	CERAMIC 0.010UF Z	9	
C212		CK45FF1H103Z	CERAMIC 0.010UF Z	8	
C213		CK45FF1H103Z	CERAMIC 0.010UF Z	9	
C214		CK45FF1H103Z	CERAMIC 0.010UF Z	8	
C215		CK45FF1H103Z	CERAMIC 0.010UF Z	9	
C216		CK45FF1H103Z	CERAMIC 0.010UF Z	8	
C217		CK45FF1H103Z	CERAMIC 0.010UF Z	9	
C218		CK45FF1H103Z	CERAMIC 0.010UF Z	8	
C219		CK45FF1H103Z	CERAMIC 0.010UF Z	9	
C220		CK45FF1H103Z	CERAMIC 0.010UF Z	8	
C221		CK45FF1H103Z	CERAMIC 0.010UF Z	9	
C222		CK45FF1H103Z	CERAMIC 0.010UF Z	8	
C223		CK45FF1H103Z	CERAMIC 0.010UF Z	9	
C224		CK45FF1H103Z	CERAMIC 0.010UF Z	8	
C225		CK45FF1H103Z	CERAMIC 0.010UF Z	9	
C226		CK45FF1H103Z	CERAMIC 0.010UF Z	8	
C227		CK45FF1H103Z	CERAMIC 0.010UF Z	9	
C228		CK45FF1H103Z	CERAMIC 0.010UF Z	8	
C229		CK45FF1H103Z	CERAMIC 0.010UF Z	9	
C230		CK45FF1H103Z	CERAMIC 0.010UF Z	8	
C231		CK45FF1H103Z	CERAMIC 0.010UF Z	9	
C232		CK45FF1H103Z	CERAMIC 0.010UF Z	8	
C233		CK45FF1H103Z	CERAMIC 0.010UF Z	9	
C234		CK45FF1H103Z	CERAMIC 0.010UF Z	8	
C235		CK45FF1H103Z	CERAMIC 0.010UF Z	9	
C236		CK45FF1H103Z	CERAMIC 0.010UF Z	8	
C237		CK45FF1H103Z	CERAMIC 0.010UF Z	9	
C238		CK45FF1H103Z	CERAMIC 0.010UF Z	8	
C239		CK45FF1H103Z	CERAMIC 0.010UF Z	9	
C240		CK45FF1H103Z	CERAMIC 0.010UF Z	8	
C241		CK45FF1H103Z	CERAMIC 0.010UF Z	9	
C242		CK45FF1H103Z	CERAMIC 0.010UF Z	8	
C243		CK45FF1H103Z	CERAMIC 0.010UF Z	9	
C244		CK45FF1H103Z	CERAMIC 0.010UF Z	8	
C245		CK45FF1H103Z	CERAMIC 0.010UF Z	9	
C246		CK45FF1H103Z	CERAMIC 0.010UF Z	8	
C247		CK45FF1H103Z	CERAMIC 0.010UF Z	9	
C248		CK45FF1H103Z	CERAMIC 0.010UF Z	8	
C249		CK45FF1H103Z	CERAMIC 0.010UF Z	9	
C250		CK45FF1H103Z	CERAMIC 0.010UF Z	8	

L:Scandinavia K:USA P:Canada  
Y:Far East, Hawaii T:England E:Europe  
Y:AFES(Europe) X:Australia M:Other Areas  
J: Japan made  
S: Singapore made  
5: X-57  
8: X-87  
9: X-97  
A indicates safety critical components.

No.5

\* New Parts  
Parts without Parts No. are not supplied.  
Les articles non mentionnés dans le Parts No. ne sont pas fournis.  
Teile ohne Parts No. werden nicht geliefert.

Ref. No. 参照番号	Address 位置	Parts No. 部品番号	Description 部品名 / 規格	Desti- nation 仕向	Re- marks 備考
C87		CE04LW1A471M	ELECTRØ 470UF 10WV	S	
C88		CE04KW1E221M	ELECTRØ 220UF 25WV	J	
C89		CE04LW1E221M	ELECTRØ 220UF 25WV	S	
C90		CE04DW1E331M	ELECTRØ 330UF 25WV	J	
C91		CE04KW1E331M	ELECTRØ 330UF 25WV	J	
C92		CE04LW1E331M	ELECTRØ 330UF 25WV	S	
C93		CE04KW1H101M	ELECTRØ 100UF 50WV	J	
C94		CE04LW1H101M	ELECTRØ 100UF 50WV	J	
C95		CE04KW1V100M	ELECTRØ 100UF 35WV	J	
C96		CC45FSL1H101J	CERAMIC 100PF J	S	
C97		CE04KW1A101M	ELECTRØ 100UF 10WV	J	
C98		CE04LW1A101M	ELECTRØ 100UF 10WV	S	
C99		CE04KW1C471M	ELECTRØ 470UF 16WV	J	
C100		CE04LW1C471M	ELECTRØ 470UF 16WV	S	
C101		CE04KW1E331M	ELECTRØ 330UF 25WV	J	
C102		CE04LW1E331M	ELECTRØ 330UF 25WV	J	
C103		CE04KW1V100M	ELECTRØ 100UF 35WV	J	
C104		CE04LW1V100M	ELECTRØ 100UF 35WV	S	
C105		CE04KW1H101M	ELECTRØ 100UF 10WV	J	
C106		CE04LW1H101M	ELECTRØ 100UF 10WV	S	
C107		CE04KW0J471M	ELECTRØ 470UF 6.3WV	J	
C108		CE04LW0J471M	ELECTRØ 470UF 6.3WV	S	
C109		CE04KW1A101M	ELECTRØ 100UF 10WV	J	
C110		CE04LW1A101M	ELECTRØ 100UF 10WV	S	
C111		CE04DW0J102M	ELECTRØ 1000UF 6.3WV	J	
C112		CK45FF1H223Z	CERAMIC 0.022UF Z	S	
C113		CK45FF1H102K	CERAMIC 0.022UF Z	J	
C114		CK45FF1H102K	CERAMIC 0.022UF Z	S	
C115		CE04KW1H0R1M	ELECTRØ 0.1UF 50WV	J	
C116		CE04LW1H0R1M	ELECTRØ 0.1UF 50WV	S	
C117		CE04KW1H2R2M	ELECTRØ 2.2UF 50WV	J	
C118		CE04LW1H2R2M	ELECTRØ 2.2UF 50WV	S	
C119		CK45FB1H392K	CERAMIC 3900PF K	9	
C120		CK45FB1H682K	CERAMIC 6800PF K	9	
C121		CK45FF1H103Z	CERAMIC 0.010UF Z	9	
C122		CK45FF1H103Z	CERAMIC 0.010UF Z	8	
C123		CK45FF1H103Z	CERAMIC 0.010UF Z	9	
C124		CK45FF1H103Z	CERAMIC 0.010UF Z	8	
C125		CK45FF1H103Z	CERAMIC 0.010UF Z	9	
C126		CK45FF1H103Z	CERAMIC 0.010UF Z	8	
C127		CK45FF1H103Z	CERAMIC 0.010UF Z	9	
C128		CK45FF1H103Z	CERAMIC 0.010UF Z	8	
C129		CK45FF1H103Z	CERAMIC 0.010UF Z	9	
C130		CK45FF1H103Z	CERAMIC 0.010UF Z	8	
C131		CK45FF1H103Z	CERAMIC 0.010UF Z	9	
C132		CK45FF1H103Z	CERAMIC 0.010UF Z	8	
C133		CK45FF1H103Z	CERAMIC 0.010UF Z	9	
C134		CK45FF1H1			





PARTS LIST

No.10

Ref. No. 参照番号	Address 位置	Parts No. 部品番号	Description 部品名 / 規格	Desti- nation 仕向
315	2B	D10-3217-08	TRIGGER ARM	
316	2B	D10-3218-08	SELECT ARM	
317	1C	D10-3219-08	BRAKE ARM	
319	1B	D13-0965-08	CLUTCH GEAR	
320	1B	D13-0966-08	REV GEAR	
321	1B	D13-0967-08	FR GEAR	
322	1B, 2B	D13-0968-08	REEL GEAR	
323	2C	D13-0970-08	PLAY CAM GEAR	
324	1A	D13-0974-08	PLAY GEAR ASSY	
325	2A	D13-0981-08	ROTATION GEAR	
326	2A	D13-0982-08	RETURN GEAR	
329	1B	D19-0270-18	REEL CAP	
330	1C	D19-0273-08	CLUTCH PULLEY ASSY	RIGHT
332	2B	D23-0277-08	HOUSING ASSY	LEFT
333	1A	D23-0270-08	HOUSING ASSY	
335	1C	E35-0264-08	MOTOR WIRE	
336	1C	E35-0267-08	FLAT WIRE 1SP	
337	2C	E35-0268-08	HEAD WIRE 5P	B
337	2C	E35-0290-08	HEAD WIRE 3P	A
338	1C	E40-4244-05	PIN CONNECTOR	
339	2A	G01-3500-08	TAPE GUIDE SPRING	
340	2A	G01-3428-08	RETURN GEAR SPRING	
341	1B	G01-3429-08	REEL SPRING	
342	1C	G01-3431-08	CLUTCH ARM SPRING	
343	1A	G01-3432-08	PLAY ARM SPRING	
344	1C	G01-3433-08	SHIFT SELECT LEVER SPRING	
345	2C	G01-3434-08	TRIGGER ARM SPRING	
346	2B	G01-3435-08	SHIFT LEVER SPRING	
347	2A	G01-3436-08	HEAD CHASSIS SPRING	
348	2B	G01-3437-08	PINCH ROLLER ARM SPRING	RIGHT
349	1A	G01-3438-08	PINCH ROLLER ARM SPRING	LEFT
350	2A	G01-3440-08	INTER LOCK LEVER SPRING	RIGHT
351	2A	G01-3441-08	INTER LOCK LEVER SPRING	LEFT
353	1B	G02-0913-08	PACK LOCK FLAT SPRING	
354	2A	G02-0994-08	AZIMUTH SPRING	
355	2A	G11-2117-08	HEAD WIRE CLAMPER	
356	1B	G16-0760-08	REFLECT SEAL	
357	2B	G16-0786-08	INSULATING SHEET	
358	2A	J21-5918-08	HEAD PLATE ASSY	
359	2A	J31-0850-08	RETURN GEAR COLLAR	
360	1A, 2B	J31-0851-08	EJECT LEVER COLLAR	
361	2B	J42-0183-08	REEL CAP BUSHING	
362	2A	J90-0680-08	CASSETTE GUIDE	
363	2A	J90-0692-08	TAPE GUIDE	LEFT
364	2A	J90-0693-08	TAPE GUIDE	RIGHT
365	1A, 2B	N09-2870-08	BINDING HEAD TAP TITE	M2.6X5
366	2A, 1C	N09-2871-08	TAPPING SCREW	M2X6
367	2A	N09-2872-08	TAPPING SCREW	M1.7X8
368	2A	N09-2953-08	WASHER HEAD SCREW	M2X10
369	2A	N09-2876-08	HEAD SCREW	
370	1A, 2A	N09-2877-08	TAP TITE SCREW	M2X4
371	2A	N09-2951-08	AZIMUTH SCREW	
372	1B	N19-1224-08	PLAY WASHER	4.1X6.5X0.25
373	1C	N19-1225-08	FLAT WASHER	2.1X4.0X0.25

L:Scandinavia  
Y:YF(X:Far East, Hawaii)  
Y:YAF(E:Europe)

K:USA  
T:England  
X:Australia

P:Canada  
E:Europe  
M:Other Areas

A: A DECK  
B: B DECK

△ indicates safety critical components

No.9

Ref. No. 参照番号	Address 位置	Parts No. 部品番号	Description 部品名 / 規格	Desti- nation 仕向
Q20		2SA1309A(Q,R)	TRANSISTOR	9 J
Q20		2SA1309A(Q,R)	TRANSISTOR	8 J
Q20		2SA933S(Q,R)	TRANSISTOR	8 S
Q21 -26		2SC1740S(Q,R)	TRANSISTOR	5 S
Q21 -26		2SC2458(Y,GR)	TRANSISTOR	5 J
Q21 -26		2SC2785(F,B)	TRANSISTOR	5 S
Q21 -26		2SC3311A(Q,R)	TRANSISTOR	5 J
Q21 -27		2SC1740S(Q,R)	TRANSISTOR	8 S
Q21 -27		2SC2458(Y,GR)	TRANSISTOR	9 J
Q21 -27		2SC2458(Y,GR)	TRANSISTOR	8 J
Q21 -27		2SC2785(F,B)	TRANSISTOR	8 S
Q21 -27		2SC3311A(Q,R)	TRANSISTOR	8 J
Q21 -27		2SC3311A(Q,R)	TRANSISTOR	9 J
Q28 -31		DTA124ES	DIGITAL TRANSISTOR	8
Q28 -31		DTA124ES	DIGITAL TRANSISTOR	9
Q28 -31		DTA124ES	DIGITAL TRANSISTOR	5
Q28 -31		DTA124ES	DIGITAL TRANSISTOR	5
Q31		UN4112	DIGITAL TRANSISTOR	5
Q32 -39		UN4112	DIGITAL TRANSISTOR	8
Q32 -39		DTG124ES	DIGITAL TRANSISTOR	9
Q32 -39		DTG124ES	DIGITAL TRANSISTOR	8
Q32 -39		UN4212	DIGITAL TRANSISTOR	9
Q32 -39		UN4212	DIGITAL TRANSISTOR	8
Q32 -39		DTG124ES	DIGITAL TRANSISTOR	5
Q32 -39		UN4212	DIGITAL TRANSISTOR	5
Q37		DTG124ES	DIGITAL TRANSISTOR	5
Q37		DTG124ES	DIGITAL TRANSISTOR	5
Q42 -46		DTG124ES	DIGITAL TRANSISTOR	5
Q42 -46		UN4212	DIGITAL TRANSISTOR	5
Q47 -48		UN4212	DIGITAL TRANSISTOR	6 S
Q47 -48		2SC1740S(Q,R)	TRANSISTOR	9 J
Q47 -48		2SC2458(Y,GR)	TRANSISTOR	8 J
Q47 -48		2SC2458(Y,GR)	TRANSISTOR	9 J
Q47 -48		2SC2785(F,B)	TRANSISTOR	8 S
Q47 -48		2SC3311A(Q,R)	TRANSISTOR	9 J
Q49 -56		DTG124ES	DIGITAL TRANSISTOR	8 J
Q49 -56		UN4212	DIGITAL TRANSISTOR	8 J
<b>MECHANISM ASSY (D40-132X-XX)</b>				
301	2A	A10-2999-08	HEAD CHASSIS CALKED ASSY	
302	1B	A11-0784-08	BASE CHASSIS ASSY	
305	1C	001-0138-08	FLYWHEEL ASSY LEFT	
306	2C	001-0139-08	FLYWHEEL ASSY RIGHT	MX
306	2C	001-0139-08	FLYWHEEL ASSY RIGHT	5B
306	2C	001-0142-08	FLYWHEEL ASSY RIGHT	ET
308	2B	D10-3210-08	SHIFT LEVER	
309	2A	D10-3211-08	PLAY SHIFT LEVER	RIGHT
310	2B	D10-3212-08	INTER LOCK LEVER	LEFT
310	2A	D10-3220-08	INTER LOCK LEVER	RIGHT
311	2B	D10-3241-08	EJECT LEVER	RIGHT
311	1A	D10-3242-08	EJECT LEVER	LEFT
312	1B	D10-3214-08	FR ARM	
313	1A	D10-3215-08	PLAY ARM	
314	1C	D10-3216-08	SHIFT SELECT LEVER	

L:Scandinavia  
Y:YF(X:Far East, Hawaii)  
Y:YAF(E:Europe)

K:USA  
T:England  
X:Australia

P:Canada  
E:Europe  
M:Other Areas

J: Japan made  
S: Singapore made

A: A DECK  
B: B DECK

5: X-57  
8: X-87  
9: X-97

△ indicates safety critical components



PARTS LIST

No.11

\* New Parts  
 Parts without Parts No. are not supplied.  
 Les articles non mentionnés dans le Parts No. ne sont pas fournis.  
 Teile ohne Parts No. werden nicht geliefert.

Ref. No. 参照番号	Address 位置	New Parts 部品番号	Description 部品名 / 規格	Destination 仕向	Re- marks 備考
374	1B	N19-1285-08	FLAT WASHER /1.6X3.0X0.13		
375	1C	N19-1286-08	FLAT WASHER /2.3X4.0X0.25		
376	2A	N19-1287-08	FLAT WASHER /3.5X6.5X0.5		
377	1A	N19-1288-08	FLAT WASHER /1.6X3.0X0.13		
378	2B	N19-1289-08	FLAT WASHER /1.6X3.0X0.13		
379	2A	N19-1317-08	POLYSLIDER WASHER 4.45X7.0X0.2		
380	1B	N35-2604-46	BINDING HEAD MACHINE SCREW		
385	1C	S74-0006-08	LEAF SWITCH (REC.METAL Cr02)		
386	1C	S74-0007-08	LEAF SWITCH (PACK DETECT)		
388	2B	T94-0228-08	SOLENOID ASSY		
390	1C	W02-1130-08	ELECTRIC UNIT		
BM	1C	D16-0332-08	MAIN BELT		
BR	1C	D16-0331-08	REEL BELT		
PF	2B	D14-0341-08	PINCH ROLLER ASSY		
PR	2A	D14-0340-08	PINCH ROLLER ASSY		
MM	1B	T42-0599-08	DC MOTOR ASSY		
PH	2A	T31-0066-08	PLAYBACK HEAD		
RPEH	2A	T39-0015-08	REC/PLAYBACK/ERASE HEAD		A
RPEH	2A	T39-0020-08	REC/PLAYBACK/ERASE HEAD		B
PH1	1C	N3L5165K	PHOTO REFLECTOR		SB
R1		RD14862152J	RD 1.5K J 1/6W		

L:Scandinavia K:USA P:Canada  
 Y:FXF (East, Hawaii) T:England E:Europe  
 Y:AFES(Europe) X:Australia M:Other Areas

A: A DECK 5: X-57  
 B: B DECK 8: X-87  
 9: X-97

⚠ indicates safety critical components