

Magnavox

SERVICE MANUAL

THE MAGNAVOX COMPANY • SERVICE DEPARTMENT
FORT WAYNE, INDIANA

5283

MODEL W801, 802 & 812 AUTOMATIC RECORD PLAYERS



GENERAL

These Record Players utilize an 11-inch turntable and a 4-pole, synchronous drive motor. The W812 employs a short control post and the W801 employs a tall control post. The W802 employs a lighted (22) tall control post. These record players are designed for use with 7", 10", or 12" records at speeds of 16 2/3, 33 1/3, 45, or 78 R.P.M.

Change Cycle

The changer employs a "Velocity Trip" mechanism which initiates the change cycle when the Tone Arm undergoes increased inward acceleration. This takes place after the stylus enters the lead-out groove at the end of the record.

As the Tone Arm tracks the record, a post attached to the Vertical Pivot Bracket Assembly (106) pushes against the Striker Slide (88-3). The Striker Slide is fed inward, makes contact with the Striker Friction Plate (62-4), and moves the Striker (62-3) toward the Turntable Hub. The velocity of the Tone Arm, during normal tracking, is not sufficient to trip the mechanism because the wiping action of the hub projection moves the Striker back with each revolution of the turntable.

However, when the stylus enters the lead-out groove at the end of the record, the velocity of the Striker Slide is sufficient to cause the Striker to move in ahead of the turntable hub projection. The projection then engages the Striker and pushes it far enough to move the Intermediate Gear (62-5) out of the recess in the periphery of the Main Cam Gear (64). This meshes the Intermediate Gear with both the Turntable Gear and the Main Cam Gear and initiates the change cycle. Failure of this automatic trip mechanism may be due to the presence of contaminants on the Striker

and Striker Friction Plate (Refer to Servicing the Intermediate Gear & Striker Assembly).

As the Main Cam Gear starts its change cycle rotation, it actuates the Muting Switch Slider (32), which in turn causes the Muting Switch Contact to ground the pickup output.

While the Main Cam Gear rotates, the roller on the Tone Arm Lift Lever (103) rides on a series of elevations on the Main Cam Gear, which cause the Lift Lever to pivot. This moves the Tone Arm Lift Rod (98) and controls the vertical travel of the Tone Arm.

As the Main Cam Gear continues to rotate, the Tone Arm sizes the next record. The Cam-Follower Pin on the Feed Lever (109) moves laterally with the Tone Arm to one of three grooves in the Main Cam Gear. The selected groove determines the Tone Arm set-down position.

As the Main Cam Gear rotates, the roller located atop the Record Dropping Slide (66) contacts a cam lobe and is pushed outward, away from the center of the cam. This causes lateral movement of the pawl within the Record Dropping Spindle (15) which pushes the bottom record off of the spindle shelf and drops it onto the turntable. As the Record Dropping Slide retracts, the Pawl Lift Spring pushes the pawl upward and into position for the following record.

At the end of the change cycle the Intermediate Gear drops into a recess of the Main Cam Gear and disengages from the Turntable Gear. As this occurs the Muting Switch Contact opens and the Cam-Follower Pin moves out of the cam groove and into the "play recess" area of the Main Cam Gear.

Automatic Shut-Off

As the Main Cam Gear (64) rotates during the change cycle, the Auto-Stop Swing Plate is pivoted by rubbing against the pivot post atop the Sub-Plate Assembly (68). This positions the Swing Plate at the exit of the raised ramp on the shut-off groove. As the Tone Arm moves toward the center of the Turntable the Cam-Follower Pin moves into a section of the shut-off groove near the center of the Main Cam Gear. When the Tone Arm reaches its point of innermost travel, the Cam-Follower Pin is fed onto the Auto-Stop Swing Plate. The Swing Plate then transports the Cam-Follower Pin across the face of the Main Cam Gear and deposits it in a section of the shut-off groove near the cam's outer edge. The free end of the Swing Plate now extends beyond the outer edge of the Main Cam Gear and is held in this position.

OPERATING INSTRUCTIONS

1. Unstow the changer, if required, by sliding the Slide Latches (14) in the direction opposite the "Lock" arrow.
2. Rotate the Balance Arm (1) fully clockwise, lift it up, and rotate it counterclockwise until it is positioned over the Tone Arm.
3. Check to ensure that the Tone Arm is not locked in place (in its transit position) atop the Tone Arm Rest (9). Free the Tone Arm by pulling upward on it at a point near the Tone Arm Rest. The Record Player will function only when the Tone Arm is free to move up and away from the Rest.
4. Place a quantity of records, not exceeding ten, on the Record Dropping Spindle (15) and lower them to the spindle offset step. To insure proper indexing, records of different sizes must be stacked with the largest size at the bottom. All records should be of the same speed.
5. Position the Balance Arm over the stacked records and select the correct stylus.
6. Set the Speed Control Knob (23) to desired speed.
7. Move the "Off-On-Auto (Rej.)" Knob (18) to the "Auto (Rej.)" position and release the knob when the turntable begins to revolve. The Tone Arm will now move over and set down on the first record. To reject any record turn the "Off-On-Auto (Rej.)" knob to the "Auto (Rej.)" position and then release the knob.

Adapter for 45 RPM Records

1. Place the "Off-On-Auto (Rej.)" knob in the "Off" position. Note the positioning instructions printed on the adapter. Place the adapter on the Record Dropping Spindle (15) and press downward until the adapter is firmly seated.

Tone Arm Set-Down Adjustment

Automatic tone arm set-down positioning for various sizes of records is accomplished by "sampling" the outside diameter of the bottom record resting on the spindle shelf. After the record is dropped to the turntable it is contacted by the stylus approximately 1/16" in from the record edge.

This adjustment has been accurately set at the factory. If field adjustment is required, adjust the Tone Arm Position Adjustment Screw (104) located on the Vertical Pivot

As the Main Cam Gear continues to rotate, this protruding section of the Swing Plate trips the Auto-Stop Lever (82), which in turn releases the Auto-Trip Lever (76), Operating Lever Assembly (77), and Switch Lever (79). The Switch Lever opens the contacts of the spring-locked AC switch and removes the power from the changer. At this point the Intermediate Gear drops into a recess of the Main Cam Gear and disengages from the Turntable Gear.

Speed Change

As the Speed Control Knob (23) is moved, its motion is transmitted through the Speed Change Cam Drive Link (24) to the Speed Change Cam (54). Rotation of the cam raises or lowers the Idler Wheel (25) in steps that place it opposite the appropriate diameter step on the Motor Pulley.

2. To remove the adapter pull it straight up from the spindle.

Manual Play

1. Lift the Balance Arm (1) and swing it out over the Tone Arm.
2. Place the record on the turntable.
3. Set the Speed Control Knob (23) to desired speed.
4. Rotate the "Off-On-Auto (Rej.)" knob to the "On" position.
5. Place the stylus on the record manually. After the record has been played, the Tone Arm will return to the rest position and the instrument will shut off automatically. If only a portion of the record is to be played, the Tone Arm can be lifted manually and placed on its rest after the selected passage is played.

Transporting the Record Player (Instrument)

Always prepare the Record Player for transit by doing the following:

1. Stow the changer by pressing downward on the Baseplate (70) and sliding the Slide Latches (14) in the direction of the "Lock" arrow.
2. Stow the Tone Arm by pressing it firmly downward atop the Tone Arm Rest (9) until it is locked in place.
3. Stow the Balance Arm (1) by rotating it fully clockwise, pressing it downward, and rotating it fully counterclockwise.

ADJUSTMENTS

Coupling (105). See adjustment "A" (Figure 1). Rotate the screw clockwise to set the Tone Arm down closer to the record's edge. Adjust the screw counter-clockwise to set the Tone Arm down further from the record's edge.

Since only one-quarter turn of the adjustment screw will move the Tone Arm set-down position approximately 1/16", the screw should be turned only a slight amount at a time before checking the result. It may be necessary to repeat this procedure several times while checking the set-down position after each adjustment.

Tone Arm Height Adjustment

Tone Arm Height Adjustment Screw (96) sets the height to which the Tone Arm raises during the change cycle. As the Tone Arm swings out under the stacked records it must clear the bottom record in the stack by approximately 1/4". Make adjustment "B" (Figure 1) by rotating the screw clockwise to lower the Tone Arm and counterclockwise to raise it. Check Tone Arm tracking on a single record.

Stylus Pressure Adjustment

Use a suitable gram scale to measure stylus pressure. Follow the scale manufacturer's instructions. Stylus pressure is set by rotating the Stylus Pressure Adjustment Screw (3-4J). See adjustment "C" (Figure 1). Correct stylus pressure is between 3 and 3 1/4 grams.

AC Switch Adjustment

Remove Switch Mounting Screws (59), Switch Lever (79), Switch Cover (58-6), and Switch Slider (58-5). Reform the fixed Switch Contact (58-3) so that its free end (opposite the lead end) rests against its stop. Replace the Switch by reversing the preceding steps.

Pickup Tracking Adjustments

Improper pickup tracking may be caused by any one of the following:

1. Insufficient slack in pickup leads.

Check to assure that the pickup leads move freely and that sufficient lead slack is maintained between the rear of the Tone Arm and the Baseplate (70).

2. Cam-Follower Pin is touching bottom of Main Cam Gear (64).

Determine whether or not the Cam-Follower Pin on the Feed Lever Assembly (109) is touching the cam surface when it is in the "Play recess" area of the cam. The pin is correctly positioned when there is approximately 1/32" clearance between the pin and surface of the Main Cam. To obtain the correct clearance rotate the Feed Lever Adjustment Screw (109-1). See adjustment "D" (Figure 2).

3. Chipped or damaged stylus.

If the pickup stylus is worn or damaged, replace with an exact replacement type stylus (Refer to Pickup & Needle Chart).

4. Improper stylus pressure.

Refer to Stylus Pressure Adjustment.

Vertical Pivot Bracket Play Adjustment

The position of the Play Adjustment Screw (113) determines the vertical "play" between the Vertical Pivot Bracket (106) and the Pivot Base Bracket (108). Set adjustment screw "E" (Figure 2) to provide approximately 1/64" of vertical travel between these parts.

Idler Wheel Height Adjustment

The Idler Wheel (25) should be adjusted so that it contacts the Motor Pulley in the center of the proper step. Make certain that the bottom face of the Idler Wheel does not rub on the upper face of the next lower pulley step.

Remove the Turntable (Refer to Turntable Removal and Replacement). To vertically position the Idler Wheel rotate adjustment screw "F" (Figure 3) which is located atop the Idler Lift Bracket (57). Turn the screw counterclockwise (as viewed from above) to lower the Idler Wheel, and clockwise to raise it. The motor must be freely suspended beneath the baseplate (as in normal operation) when the adjustment is made.

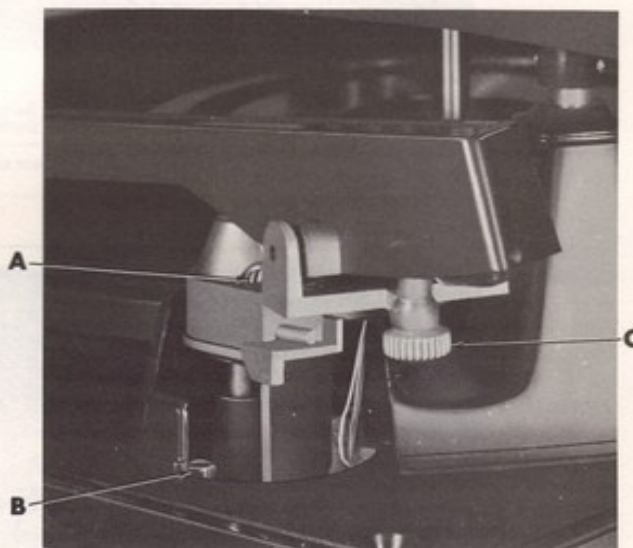

Figure 1 - Tone Arm & Stylus Pressure Adjustments

INSTRUCTIONS FOR SERVICING AND REPLACING PARTS

Stowing and Removing the Record Player

These record players employ a Slide Latch system which provides a quick method of changer stowage.

The Hold-Down Screws should be removed and set aside when the instrument is unpacked. To unstow the changer, slide the Slide Latches (14) in the direction opposite the "Lock" arrow. To stow the changer press down on the Baseplate (70) and slide the Slide Latches in the direction of the "Lock" arrow.

To remove the Record Player from the instrument unstow the changer, rotate the Slide Latches 90 degrees and remove them from the Baseplate. Disconnect the wiring between

the Record Player and the instrument and lift the Record Player out of the instrument.

Turntable Removal and Replacement

1. Place the "Off-On-Auto (Rej.)" knob in the "Off" position and remove the C-clip (16), located on the Record Dropping Spindle (15) just atop the Turntable (17).
2. Grasp the Turntable by its outer edge and rotate it slightly while lifting it off of the spindle. Check the bottom of the turntable and the base of the spindle to ensure that all spindle-mounted parts remain in place on the spindle (Refer to Exploded View of Parts Below Baseplate).

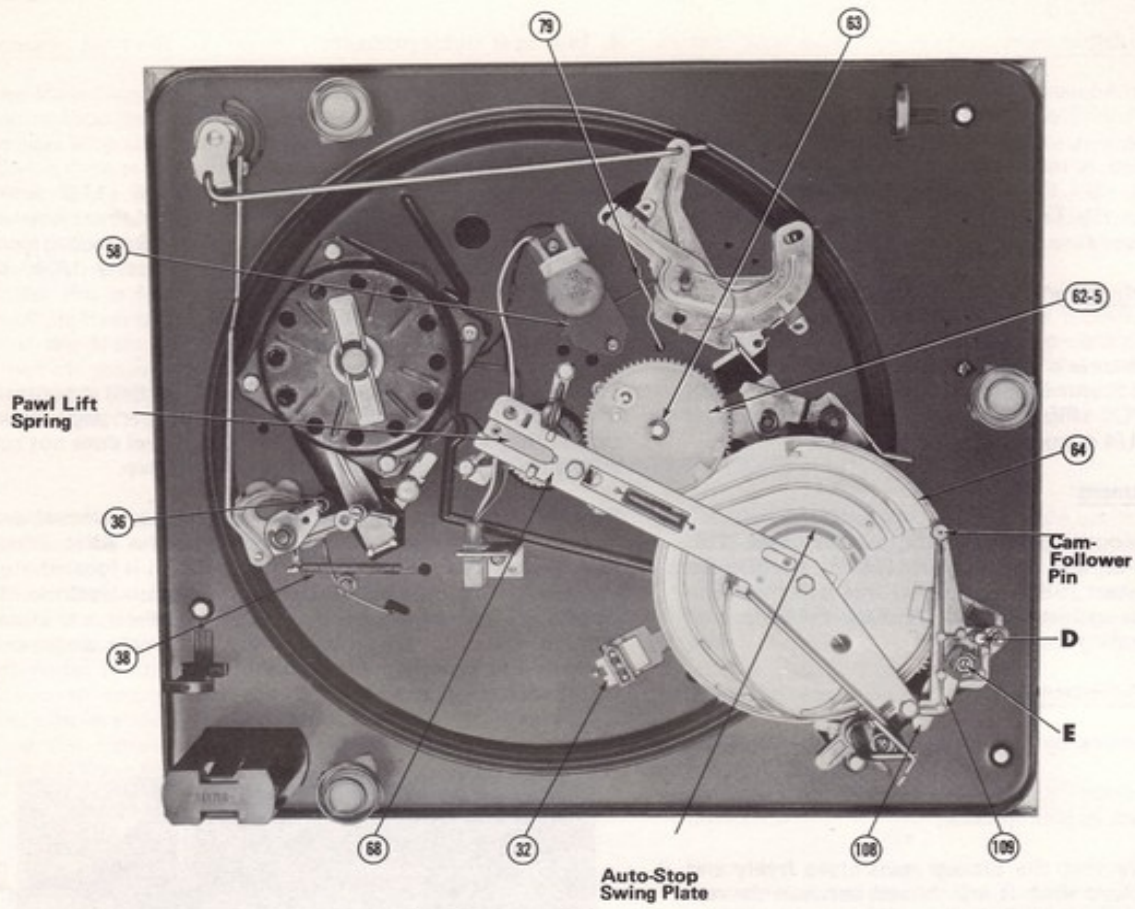

Figure 2 -- Bottom View of Baseplate

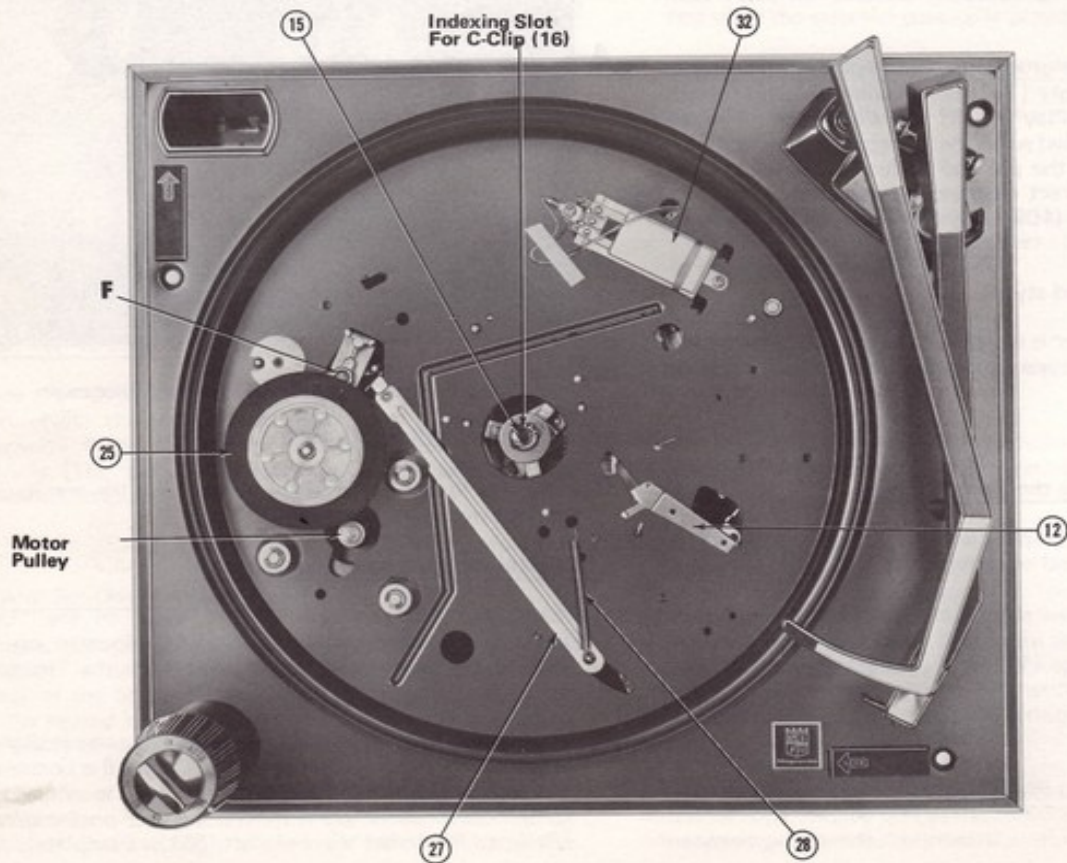

Figure 3 -- Top View of Baseplate with Turntable Removed

3. Ensure that the Thrust Bearing Assembly (52) and its washers are free of foreign material. These parts should be lubricated, when required, with a small quantity of grease such as Shell Darina 1 or equivalent. The Thrust Bearing Assembly should be positioned with its flat side facing up. Steel Thrust Washers (51) should be in place directly above and below the Thrust Bearing Assembly. One or more Rubber Washers (50) used as shims are placed between the upper Thrust Washer (51) and the turntable hub. A "dimpled" Self-Aligning Washer (53) is located directly beneath the lower Thrust Washer (51).
4. Make certain that the Idler Wheel (25) is in its retracted or "Off" position so that it will not interfere with replacement of the turntable.
5. Set the Turntable back into place over the Record Dropping Spindle and press it downward until it is firmly seated on the Spigot Housing (60). Secure C-clip (16). The C-clip will seat properly only when its center projection is lined up with the small slot in the Spigot Housing.

Idler Wheel Removal and Replacement

1. Remove the Turntable (Refer to Turntable Removal and Replacement) and note the placement of all parts mounted on the Idler Arm Assembly (48).
2. Remove C-clip (26) from atop the Idler Wheel Spindle.
3. Lift the Idler Wheel (25) from its spindle. Ensure that Plastic Washer (46) remains in place on the spindle directly beneath the Idler Wheel.
4. Replace the Idler Wheel by reversing the preceding steps.
5. Check that the Idler Wheel rotates freely and ensure that it correctly contacts the Motor Pulley (Refer to Idler Wheel Height Adjustment).
6. Replace Turntable and secure C-clip (16).

Motor Removal and Replacement

1. Remove Turntable (Refer to Turntable Removal and Replacement).
2. Remove the motor ground lead (at motor end).
3. Remove the AC Switch Mounting Screws (59) and Switch Cover (58-6). Unsolder the motor lead from its contact.
4. Compare the lengths and colors of corresponding wires on the original and replacement motors. Clip the wire between the Motor Assembly (45) and the Molex connector. The wire can be spliced, if required, when the replacement motor is installed.
5. Grasp the Motor Assembly and remove the three motor mounting C-clips (29) and Washers (30).
6. Mount the replacement motor and either splice the wires or terminate them at the proper points on the switch and Molex connector. If the switch contacts have been disturbed, check them as they are reinstalled (Refer to AC Switch Adjustment).
7. Reassemble the AC Switch (58) and replace the motor ground lead.

8. Check Idler Wheel height (Refer to Idler Wheel Height Adjustment).
9. Replace Turntable and secure C-clip (16).

AC Switch Removal and Replacement

1. Remove Switch Mounting Screws (59), Switch Lever (79), Switch Cover (58-6) and Switch Slider (58-5).
2. Lift out the Contact Clamp (58-4) and the Switch Contacts (58-2 & 58-3).
3. Unsolder the Capacitor (58-7) and leads from the switch contacts.
4. Reverse the preceding steps to replace the Switch.

Record Dropping Slide Assembly Removal and Replacement

1. Remove the Sub-Plate Assembly Mounting Screws (69 & 115).
2. Remove the Sub-Plate Assembly (68) along with the Record Dropping Slide Assembly (66). Be careful not to misplace the Record Dropping Slide Spacer (65) located between the Slide Assembly and the Main Cam Gear (64).
3. Reverse the preceding steps to replace the assembly.

Feed Lever Assembly Removal and Replacement

1. Remove the C-clip (112), Spring (111), and Washer (110) which hold the Feed Lever (Cam-Follower) Assembly (109) in place against the base of the Vertical Pivot Bracket Assembly (106).
2. Slip the Feed Lever from its spindle.
3. Reverse the preceding steps to replace the assembly.

Main Cam Gear Removal and Replacement

1. Remove the Record Dropping Slide Assembly (66) (Refer to Record Dropping Slide Assembly Removal and Replacement).
2. Remove the Feed Lever Assembly (109) (Refer to Feed Lever Assembly Removal and Replacement).
3. Place the "Off-On-Auto (Rej.)" knob in the "On" position to provide maximum lateral movement of the Intermediate Gear (62-5).
4. Remove the Balance Arm Locating Bracket (114).
5. Retract the Intermediate Gear and remove the Main Cam Gear (64) from its spindle.
6. To replace the Main Cam Gear, retract the Intermediate Gear and place the Main Cam Gear back on its spindle. Mesh the Cam Gear indexing teeth with the two indexing recesses on the Intermediate Gear.
7. Replace the Balance Arm Locating Bracket.
8. Remount the Feed Lever using the required washers, spring, and C-clip.

9. Replace the Record Dropping Slide Assembly (Refer to Record Dropping Slide Assembly Removal and Replacement).

Intermediate Gear Removal and Replacement

1. Place the "Off-On-Auto (Rej.)" knob in the "On" position.
2. Rotate the Main Cam Gear (64) until the Intermediate Gear (62-5) rests in the recess on the edge of the Main Cam Gear.
3. Remove the C-clip (63) from the Intermediate Gear spindle.
4. Move the Intermediate Gear away from the Main Cam Gear and slip the Intermediate Gear from its spindle.
5. Reverse the preceding steps to replace the Intermediate Gear.

Record Dropping Spindle Assembly Removal and Replacement

1. Remove C-Clip (16) from center of turntable.
Note: The center tab on the C-clip locks the Record Spindle to the Spigot Housing.
2. The Record Spindle can now be removed by pulling it straight out from the Spigot Housing.
3. Reverse the foregoing procedure to reassemble.

Vertical Pivot Bracket & Coupling Assembly Removal and Replacement

1. Remove the Tone Arm Mounting Screw (116) and detach the Tone Arm. Place the Tone Arm on the Turntable with the stylus facing up.
2. Remove the Feed Lever (109). (Refer to Feed Lever Assembly Removal and Replacement).
3. Remove the Bias Spring (118) from between the Pivot Base Bracket Assembly (108) and the Vertical Pivot Bracket Assembly (106).
4. Unscrew the Pivot Base Bracket Mounting Screw (107) and remove the Pivot Base Bracket Assembly.
5. Note how the Tone Arm Positioning Spring (117) holds the Pivot Coupling (105) in place atop the Pivot Bracket (106).
6. Back out the Tone Arm Position Adjustment Screw (104) until the Adjustment Rocker (105-2) no longer rests in the notch atop the Pivot Bracket.
7. Grasp the Pivot Bracket (106) and rotate the Pivot Coupling (105) clockwise until one end of the Tone Arm Positioning Spring (117) is free. Remove the spring.
8. Grasp the Pivot Bracket (106), separate it from the Pivot Coupling (105) and lower it through the hole in the baseplate.
9. Reverse the preceding steps to replace the assembly. NOTE...The Adjustment Rocker (105-2) must be pivoted

upward (completely within the Pivot Coupling) to allow reassembly of the Pivot Bracket and the Pivot Coupling. The Tone Arm Positioning Spring (117) must be re-installed in the exact location noted in step 5.

10. Check the Tone Arm Set-Down, Tone Arm Height, Stylus Pressure, Pickup Tracking, and Vertical Pivot Bracket Play Adjustments.

Control Post Light Removal and Replacement (W802)

1. Remove pins 2 and 6 from molex connector.
2. Remove Tape and leads from baseplate (70).
3. Remove reject knob (18), C-clip (19), and notched washer (20) from shaft (42).
4. Pull reject shaft away from baseplate (70) and remove hex nut (40) and notched washer (39).
5. Pull speed control knob (23) up from baseplate, allowing leads to be pulled completely up thru baseplate.
6. Remove control indicator ring (21) from speed control knob (23). Lamp, lead, and pin assembly (22) can now be replaced.
7. Reverse the preceding steps to replace the assembly.

Servicing the Intermediate Gear & Striker Assembly

To gain access to the component parts of the Intermediate Gear & Striker Assembly proceed as follows:

1. Remove the Intermediate Gear (62-5) (refer to Intermediate Gear Removal & Replacement).
2. Remove the small C-clip (62-2) that retains the Striker (62-3) and remove the Striker from its pivot post.
3. Remove the C-clip (62-8), Washer (62-7), and Spring (62-6) from the Striker Pressure Plate and Post Assembly (62-1).
4. Remove the Striker Friction Plate (62-4), and the Striker Pressure Plate and Post Assembly.
5. Clean or replace parts as required but do not apply any form of lubrication.
6. Reverse the preceding steps to replace the assembly.

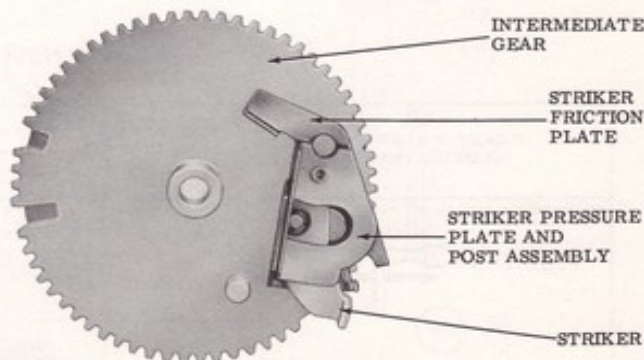

Intermediate Gear Assembly

INSTRUCTIONS FOR SERVICING AND REPLACING PARTS (CONT.)

Adapting the Motor Pulley for 50 Cycle Use

For 50 cycle operation it is necessary to increase the diameter of each motor pulley step. This is accomplished by placing a "stepped" sleeve-type adapter over the original Motor Pulley. The adapter is supplied in 50 Cycle Adapter Kit No. 170572-1 and is installed as follows:

1. Remove the Turntable (refer to Turntable Removal and Replacement).
2. Ensure that the "Off-On-Auto (Rej.)" knob is positioned to "Off"
3. Apply Duco Cement or equivalent to the exterior of the Motor Pulley and to the Interior of the adapter sleeve. Press the adapter sleeve into place over the Motor Pulley. Remove the excess cement. Allow the cement to dry before operating the Record Player.
4. Replace the Turntable and secure C-clip (16).

NOTE...To convert back to 60 cycle operation the original 60 cycle configuration must be restored. To accomplish this perform steps 1 and 2 above. Then apply heat (with a soldering iron) to the Motor Pulley and adapter sleeve until the cement softens. Remove the adapter sleeve and then remove all traces of cement from the pulley with a solvent such as nail polish remover. Replace the Turntable and secure C-clip (16).

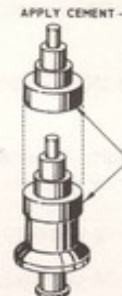

Installing the 50 Cycle Adapter

MODEL-PICKUP-STYLUS CROSS REFERENCE

MODEL	PICKUP (WITH STYLUS)	STYLUS (NEEDLE)
W801-01-00	560345-1	560344-2
W801-02-00	560345-1	560344-2
W801-03-00	560350-1	560344-2
W802-01-00	560345-1	560344-2
W802-02-00	560345-1	560344-2
W812-01-00	560345-1	560344-2

PICKUP & NEEDLE CHART

PICKUP & NEEDLE ILLUSTRATION	PICKUP BODY COLOR	PICKUP	NEEDLE BODY COLOR	NEEDLE	NEEDLE TIP
		PART NO.		PART NO.	MATERIAL SIZE
 USES ONE NEEDLE WITH TWO TIPS	WHITE	560345-1 (with needles)	BLACK with WHITE or GOLD PRINTING	560344-2	SAPPHIRE .003 DIAMOND .0007
	GRAY	560350-1 (with needles)	BLACK with WHITE or GOLD PRINTING	560344-2	SAPPHIRE .003 DIAMOND .0007

EXPLODED VIEW OF PARTS BELOW BASEPLATE

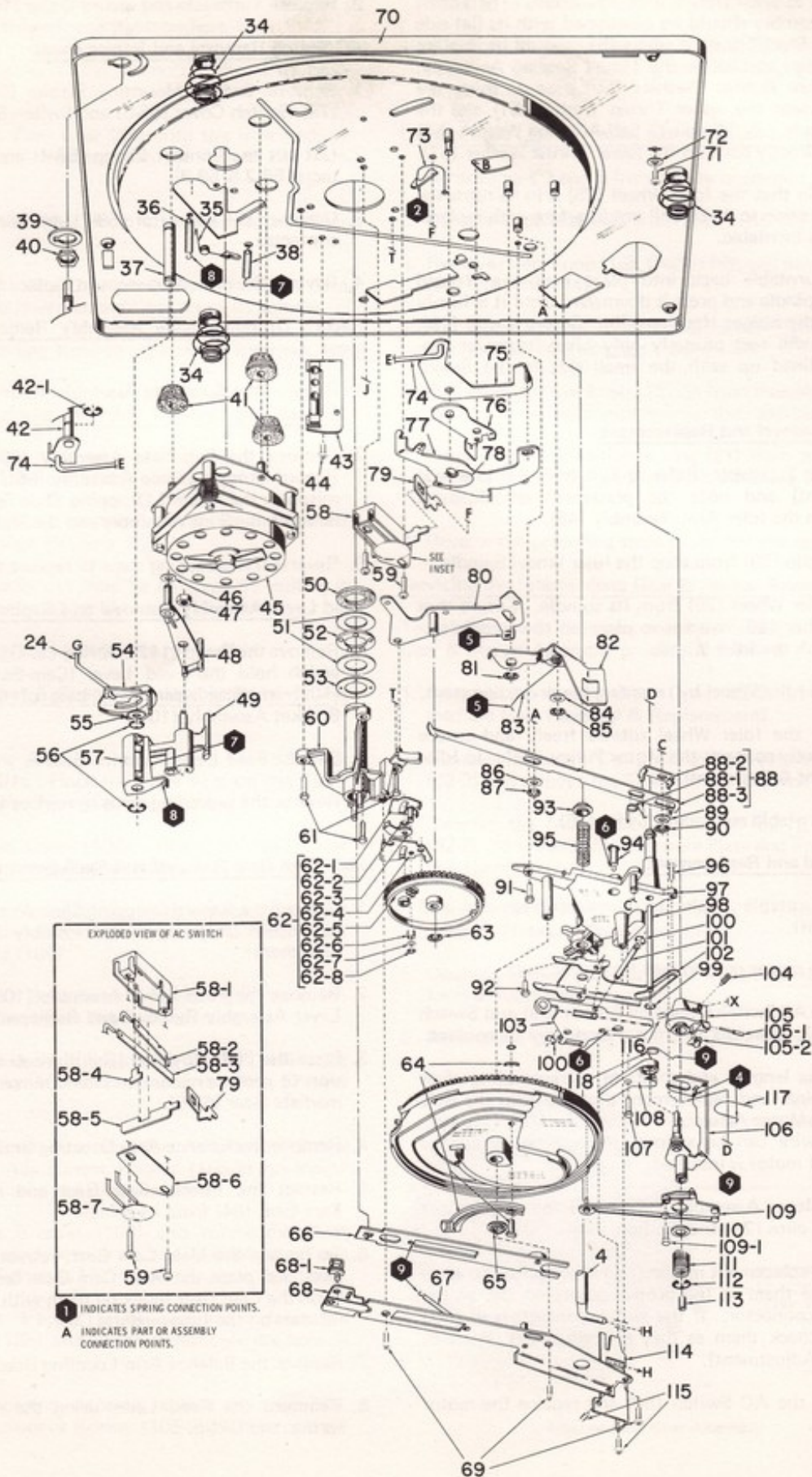

REPLACEMENT PARTS LIST

Note: When ordering replacement parts please specify the part number as shown in this list including Description, Chassis, and Model Number. Complete information will help expedite the order. Replacement parts may occasionally differ in part number or value from the Factory installed part. In either event the replacement part has been chosen to provide equal or improved performance.

REF.	DESCRIPTION	PART NO.	REF.	DESCRIPTION	PART NO.
1	Balance Arm (with Trim)(W801)	76130445	31	45 RPM Adapter Holder (Brown)	141718-3
1	Balance Arm (with Trim)(W802,W812)	76130432	32	Muting Switch Assy.	76130421
1-1	Balance Arm (w/o Trim) (W801)	76190172	33	Muting Switch Mtg. Screw	76245022
1-1	Balance Arm (w/o Trim)(W802,W812)	76190179	34	Mounting Spring	76204034
1-2	Rear Balance Arm Trim Plate	76230555	35	Speed Index Spring	76203018
1-3	Front Balance Arm Trim Plate	76230556	36	Idler Lift Spring	76201025
1-4	Center Balance Arm Trim Plate(W802, W812)	76230557	37	Speed Change Pivot Stud	76171865
2	Balance Arm Retainer Pin	76170428	38	Idler Tension Spring	76200032
3	Tone Arm Assy.(Less Pickup)(W801)	76120068	39	Notched Washer (W801,W812)	76160312
3	Tone Arm Assy.(Less Pickup)(W802, W812)	76120071	39	Notched Washer (W802)	76190176
3-1	Tone Arm (with Trim) (W801)	76125079	40	Hexagonal Nut	76171355
3-1	Tone Arm (with Trim) (W802,W812)	76125060	41	Motor Mtg. Grommet	76210102
3-1A	Tone Arm (without Trim) (W801)	76125080	42	Control Lever Assy. (W801,W802)	76130423
3-1A	Tone Arm (without Trim) (W802,W812)	76125061	42-1	Control Lever Assy. (W812)	76130431
3-1B	Rear Tone Arm Trim Plate	76230553	43	C-Clip	76252906
3-1C	Front Tone Arm Trim Plate (W801)	76230559	43	Molex Conn.Mtg.Bracket (W801, W812)	76164071
3-1C	Front Tone Arm Trim Plate (W802, W812)	76230554	43	Molex Conn. Mtg. Bracket (W802)	76164076
3-1D	Center Tone Arm Trim Plate (W802, W812)	76230558	44	Screw	76245002
3-1E	Tone Arm Rest Clip (Not Shown)	76166003	45	Motor Assembly	76110056
3-2	Tone Arm Weight	76190104	46	Plastic Washer	76211855
3-3	Screw	76245023	47	Hexagonal Locknut	76246251
3-4	Tone Arm Bracket Pivot Assy.	76125024	48	Idler Arm Assembly	76130367
3-4A	Spring Anchor Plate	76160205	49	Idler Swivel Assembly	76130366
3-4B	Counterbalance Spring	76200027	50	Rubber Washer 1/16" Thick (See Note A)	76210353
3-4C	C-Clip	76252901	50	Rubber Washer 1/32" Thick (See Note A)	76210352
3-4D	Spring Adjustment Plate	76190011	51	Thrust Washer	76160037
3-4E	Tone Arm Bracket & Bearing Assy. (Late Production)	76125059	52	Thrust Bearing Assy.	76130167
3-4F	Tone Arm Bracket	76190112	53	Self-Aligning Washer	76160040
3-4G	Horizontal Pivot Thrust Bearing (Late Production only)	76180300	54	Speed Change Cam	76180307
3-4H	Horizontal Pivot Bearing (Late Production only)	76180301	55	Flat Washer	76250003
3-4I	Spring	76201005	56	C-Clip	76252911
3-4J	Stylus Pressure Adjustment Screw	76171350	57	Idler Lift Bracket	76190164
3-4K	Horizontal Pivot Pin	76171063	58-1	Switch Housing	76183512
3-4L	Pivot Pin Collar (Early Prod.only)	76171340	58-2	Switch Contact (Moving)	76273257
3-5	Tone Arm Wiring Harness	76125072	58-3	Switch Contact (Fixed)	76273256
3-6	Screw	76245023	58-4	Contact Clamp	76213013
3-7	Record Brush	76123001	58-5	Switch Slider	76213031
3-8	Clamp Plate	76160206	58-6	Switch Cover	76213014
3-9	Screw	76245023	58-7	Capacitor, .01 mfd.,+80-20%,2250V	76270040
3-10	Tone Arm Lead Retainer	76166029	59	Switch Mounting Screw	76245119
4	Balance Arm Spindle (W801,W802)	76171772	60	Turntable Spigot Housing Assy.	76130426
4	Balance Arm Spindle (W812)	76171788	61	Spigot Housing Mtg. Screw	76245123
5	Balance Arm Return Spring	76201021	62	Intermediate Gear & Striker Assy.	76130389
6	C-Clip (W801,W802)	76252906	62-1	Striker Pressure Plate & Post Assy.	76130398
6	C-Clip (W812)	76252913	62-2	C-Clip	76252901
7	Balance Arm & Tone Arm Pedestal (W801,W802)	76190175	62-3	Striker (Plastic)	76180315
7	Balance Arm & Tone Arm Pedestal (W812)	76190170	62-4	Striker Friction Plate	76160262
8	Screw	76245013	62-5	Intermediate Gear Assembly	76130310
9	Tone Arm Rest	76180321	62-6	Compression Spring	76201026
10	Hexagonal Nut	76246002	62-7	Flat Washer	76250044
11	Baseplate Plug (Brown)	103038-2	62-8	C-Clip	76252901
12	Auto Trip Link	76160235	63	C-Clip	76252801
13	Nameplate, Magnavox	76231558	64	Main Cam Gear Assembly	76130299
14	Changer Hold-Down Slide Latch(Brown)	141704-2	65	Record Dropping Slide Spacer	76171345
15	Record Dropping Spindle Assy. (W801, W802)	76130427	66	Record Dropping Slide Assy.	76130301
15	Record Dropping Spindle Assy.(W812)	76130438	67	Record Dropping Slide Spring	76200034
16	C-Clip	76253403	68	Sub-Plate Assembly	76130381
17	Turntable (w/Mat & Trim)(W801)	76130437	68-1	Lead Dressing Clip	76180314
17	Turntable (w/Mat & Trim)(W802,W812)	76130449	69	Screw	76245120
17-1	Turntable Mat	76210035	70	Baseplate (Unit Plate) Assembly	76130052
17-2	Turntable Trim (Center)	76230549	71	Screw	76240001
17-3	Turntable Trim (Outer)	76230550	72	Washer	76252001
18	Off-On-Reject Knob Assy.	76130136	73	Auto Trip Link Spring	76203010
19	C-Clip	76252802	74	Operating Lever Drive Link	76205017
20	Notched Washer	76160005	75	Operating Crank	76160293
21	Control Ind. Ring Assy. (W801)	76130453	76	Auto-Trip Lever	76160238
21	Control Ind. Ring Assy.(w/Bulb Clamp) (W802)	76130451	77	Operating Lever Assy.	76160292
21	Control Ind. Ring Assy. (Short Post) (W812)	76130430	78	Operating Lever Spring	76203025
21-1	Indicator Ring Trim Plate	76230548	79	Switch Lever	76160255
22	Lamp, Lead, & Pin Assy. (See Miscellaneous for Transformer & Switch) (W802)	76130455	80	Intermediate Gear Lever Assy.	76130307
23	Speed Control Knob (W801)	76180326	81	C-Clip	76252801
23	Speed Control Knob (W802)	76180327	82	Auto-Stop Lever	76160247
23	Speed Control Knob (W812)	76180319	83	Auto-Stop Lever Spring	76203012
24	Speed Change Cam Drive Link	76130422	84	Fibre Washer	76212264
25	Idler Wheel	76130419	85	C-Clip	76252801
26	C-Clip	76252908	86	Fibre Washer	76212264
27	Idler Withdraw Bar Assy.	76130382	87	C-Clip	76252801
28	Switch Off Spring	76200036	88	Striker Slide Assy.	76130339
29	C-Clip	76252801	88-1	Striker Safety Spring	76203017
30	Motor Mounting Washer	76250053	88-2	Striker Safety Slide	76164075
			88-3	Striker Slide	76164072
			89	Fibre Washer	76212264
			90	C-Clip	76252801
			91	Screw	76245123
			92	Screw	76245121
			93	Balance Arm Spring Disc	76160081
			94	Tone Arm Rocker Lift Spring	76204027
			95	Balance Arm Spring	76201004
			96	Tone Arm Height Adjustment Screw	76245115
			97	Tone Arm Pivot Base Assembly	76130371
			98	Tone Arm Lift Rod	76174019

Note A - Use 1/16" or 1/32" thick washers as required to obtain turntable clearance.

REPLACEMENT PARTS LIST (CONT.)

5283-10

REF.	DESCRIPTION	PART NO.
99	C-Clip	76252901
100	C-Clip	76252901
101	Lifter Pivot	76171078
102	Tone Arm Height Adjuster (W812)	76160317
102	Tone Arm Height Adjuster (W801, W802)	76160289
103	Tone Arm Lift Lever Assy. (W801, W802)	76130372
103	Tone Arm Lift Lever Assy. (W812)	76130434
104	Tone Arm Position Adjustment Screw	76171601
105	Vertical Pivot Coupling Assembly	76130374
105-1	Adjustment Rocker Pivot Pin	76171080
105-2	Position Adjustment Rocker	76160295
106	Vertical Pivot Bracket Assembly	76130373
107	Pivot Base Mtg. Screw	76245121
108	Pivot Base Bracket Assembly	76130429
109	Feed Lever Assembly	76130376
109-1	Feed Lever Adjustment Screw	76245110
110	Washer	76250003
111	Feed Lever Spring	76201019
112	C-Clip	76252904
113	Play Adjustment Screw	76170871
114	Balance Arm Locating Bracket (W801, W802)	76164078
114	Balance Arm Locating Bracket (W812)	76164082
115	Screw	76245002

REF.	DESCRIPTION	PART NO.
116	Screw	76240704
117	Tone Arm Positioning Spring	76203019
118	Bias Spring	76203023
MISCELLANEOUS		
	45 RPM Adapter	523717-2
	Black Acetate Tape for Lighted Post (W802)	76212526
	Baseplate Trim	731103-1
	50 Cycle Adapter Kit	170572-1
	3-Pin Molex Housing (Changer Mounted) (W801, W812)	180734-2
	6-Pin Molex Housing (Changer Mounted) (W802)	180732-2
	Molex Contacts, Male	180726-1
	Hold-Down Screw	102825-132
	Hold-Down Speed Nut	730964-1
	Nylon Hold-Down Spacer (White)	141715-1
	Nylon Hold-Down Spacer (Black)	141715-2
	Switch (Control Post Light) (W802)	160448-1
	Transformer (Control Post Light) (W802) (3-Way only)	320362-4
	Transformer (Control Post Light) (W802) (All Others)	320362-3

EXPLODED VIEW OF PARTS ABOVE BASEPLATE

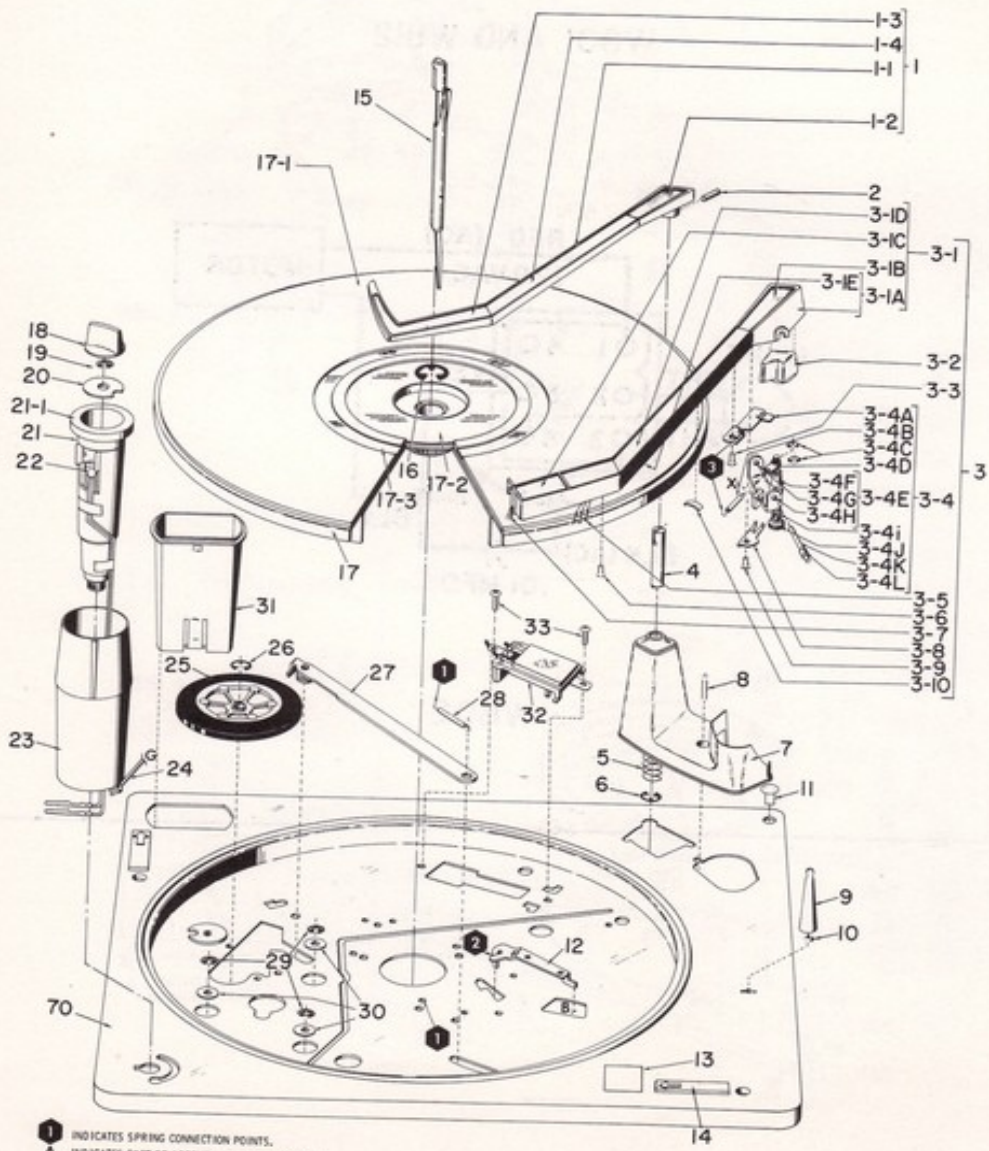

1 INDICATES SPRING CONNECTION POINTS.
 A... INDICATES PART OR ASSEMBLY CONNECTION POINTS.