

SERVICE MANUAL

STEREO INTEGRATED AMPLIFIER
MODEL DA-U310

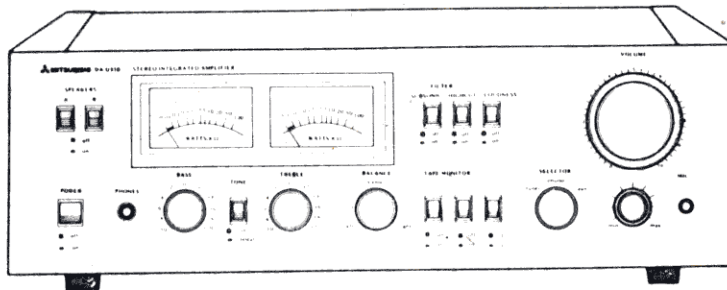

CONTENTS

SPECIFICATIONS	2
ADJUSTMENTS	3
SERVICE PARTS LIST	4
PRINTED CIRCUIT BOARDS	5 to 8
SCHEMATIC DIAGRAM	9 to 10
WIRING DIAGRAM	11 to 12
PRINTED CIRCUIT BOARDS (Continued)	13 to 14

SCHEMATIC DIAGRAM

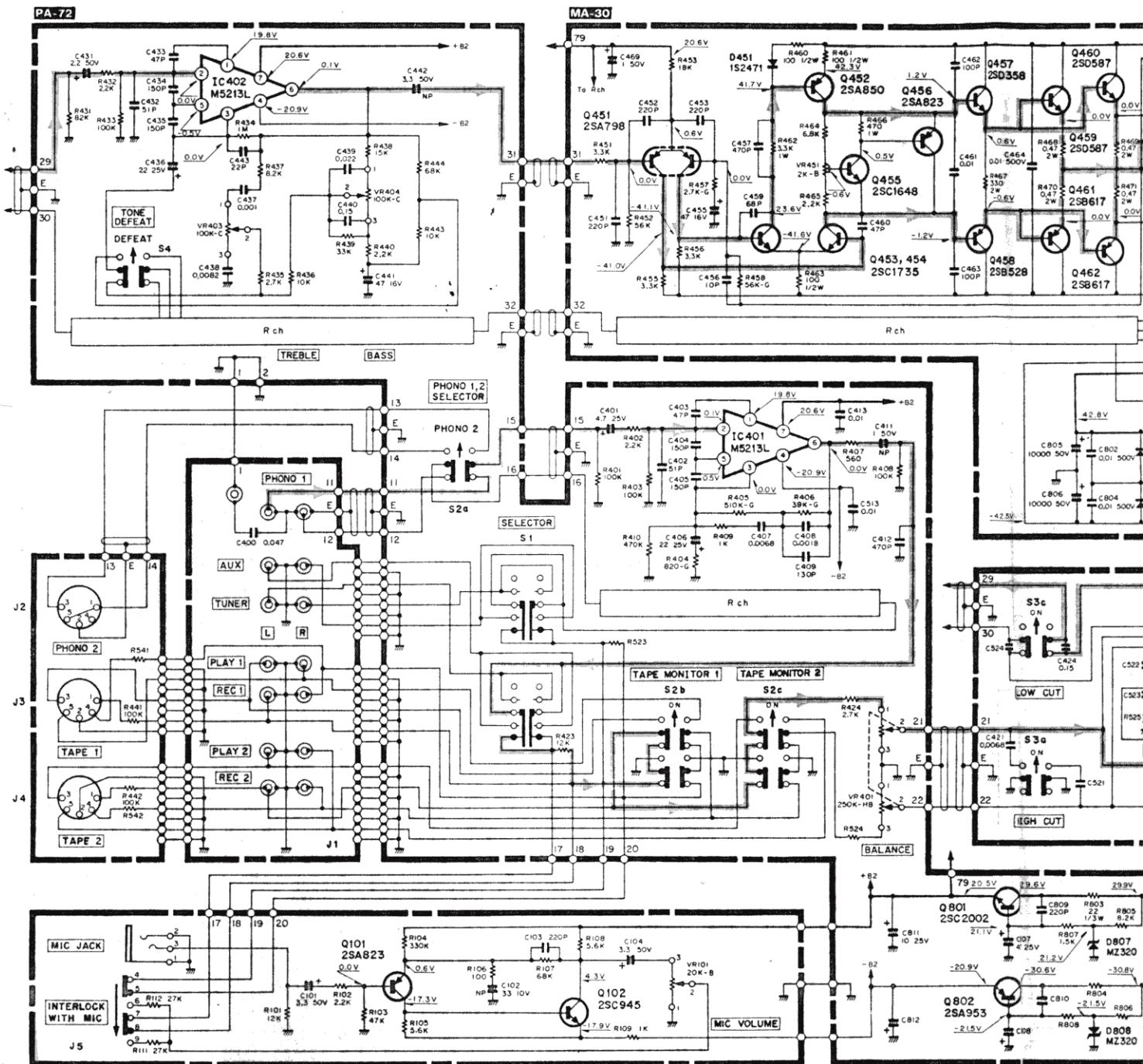

EXTERNAL VIEW AND POLARITY DIAGRAM OF THE TRANSISTOR, IC

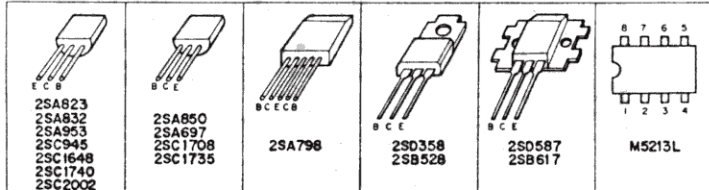

- Note: 1 S1 SELECTOR SwitchPHONO Position
 2 S2-a PHONO 1,2 SELECTOR Switch.....PHONO 1 Position
 2 S2-b TAPE MONITOR 1 Switch.....OFF Position
 2 S2-c TAPE MONITOR 2 Switch.....OFF Position
 S3-a HIGH CUT Switch.....OFF Position
 S3-b LOUDNESS Switch.....OFF Position
 S3-c LOW CUT Switch.....OFF Position
 S4 TONE DEFEAT Switch.....ON Position
 S5-a SPEAKER SELECTOR Switch.....ON Position
 S5-b SPEAKERS Switch.....OFF Position
- 2 Unit of C and R
 (1) C
 (2) R
 (3) The voltage in each se
 DC 20K Ω /V tester.

This circuit is a basic dia
change without notice for



Components marked with symbol have special char
important to safety and performance. For continued safe
replace with components of identical value and characteri

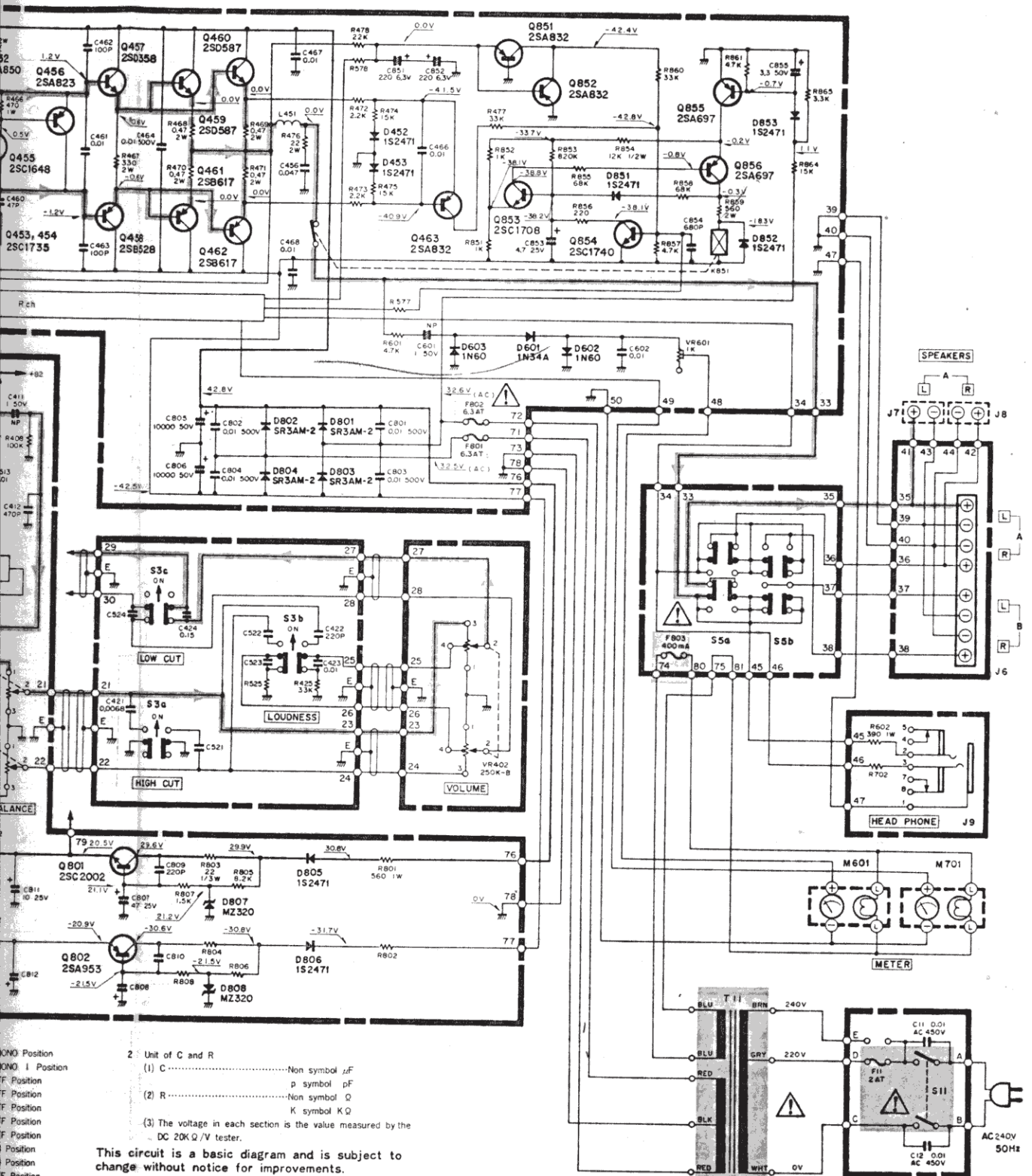

- 2 Unit of C and R
- (1) C Non symbol pF
 - p symbol pF
 - (2) R Non symbol Ω
 - K symbol K Ω
- (3) The voltage in each section is the value measured by the DC 20K Ω/V tester.

This circuit is a basic diagram and is subject to change without notice for improvements.

with ⚠ symbol have special characteristics, and performance. For continued safety, please use components of identical value and characteristics.