

SERVICE MANUAL

MONITOR SERIES

3300

INTEGRATED AMPLIFIER

CONTENTS
-3300-

REAR / FRONT PANEL CONNECTIONS	PAGE 3
SPECIFICATIONS	PAGE 4
ALIGNMENT METHOD	PAGE 5 - 6
SCHEMATIC DIAGRAM	PAGE 7 - 8
PCB LAYOUT AND WIRING DIAGRAM	PAGE 9 - 10
PCB LAYOUT AND WIRING DIAGRAM	PAGE 11 - 12
EXPLODED VIEW, EXPLODED LIST	PAGE 13 - 14
PARTS LIST	PAGE 15 - 16
PACKING DIAGRAM	PAGE 17

REAR PANEL

- | | | |
|-----------------------------------|---------------------------------|--------------------------|
| 1. AC Line Cord. | 8. MM/MC Selector. | 15. Preamp Out, Main In. |
| 2. AC Outlets (not in U.K. model) | 9. Phono Capacitance (MM only). | 16. Lab Input. |
| 3. Speakers A. | 10. Tuner Input. | 17. Bridging. |
| 4. Speakers B. | 11. Video Sound Input. | 18. Soft Clipping. |
| 5. Infrasonic Filter. | 12. CD Input. | 19. Speaker Impedance. |
| 6. Phono Input. | 13. Tape 1 Input/Output. | |
| 7. Phono Ground. | 14. Tape 2 Input/Output. | |

CAUTION
 RISK OF ELECTRIC SHOCK
 DO NOT OPEN

CAUTION TO REDUCE THE RISK OF ELECTRIC SHOCK, DO NOT REMOVE COVER (OR BACK). NO USER-SERVICEABLE PARTS INSIDE. REFER SERVICING TO QUALIFIED SERVICE PERSONNEL.

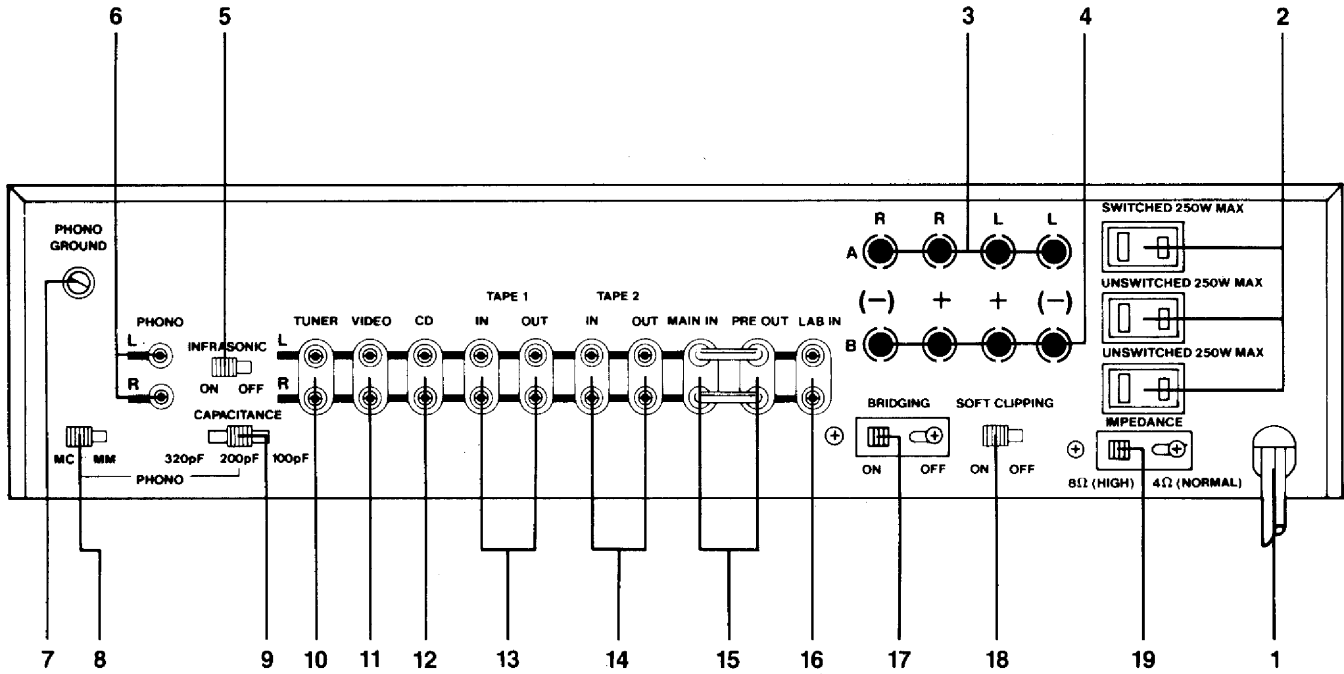

FRONT PANEL

- | | | |
|----------------------|-------------------------|-------------------------|
| 1. Power. | 7. Tone Control Bypass. | 13. Mono. |
| 2. Phones. | 8. Treble. | 14. Low Level. |
| 3. Speaker Selector. | 9. Treble Range. | 15. Volume/Balance. |
| 4. Bass EQ. | 10. Tape Copy. | 16. Overload Indicator. |
| 5. Bass Range. | 11. Tape Monitor. | |
| 6. Bass. | 12. Input Selector. | |

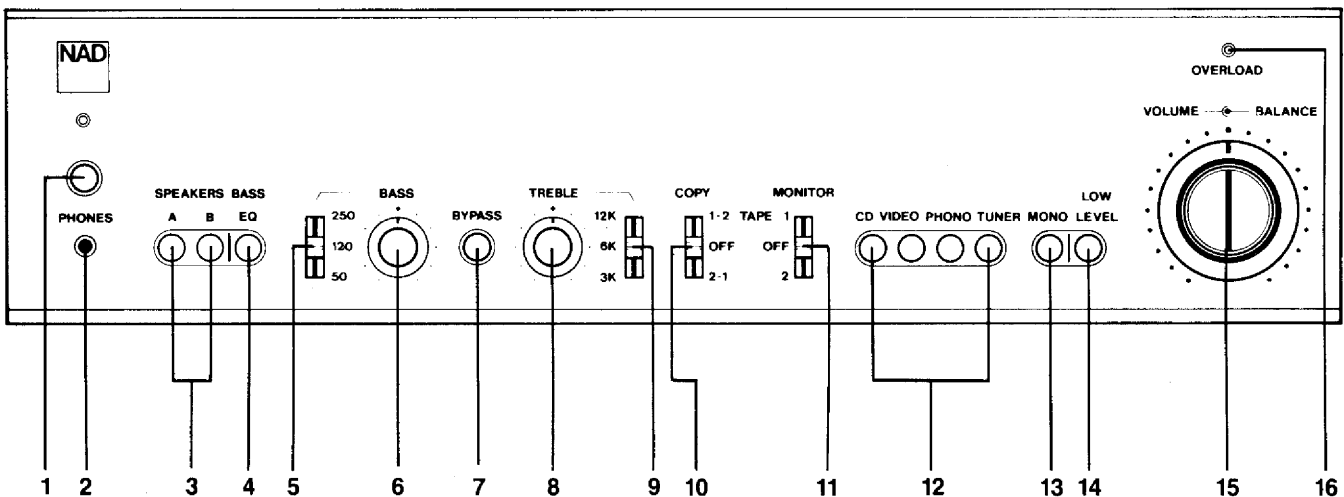

Specifications

The 3300 Monitor Series Amplifier

Note: Specifications are measured in accordance with EIA Standard RS-490 (IHF A-202). Measurements referenced to 8 ohms are taken with the Speaker Impedance selector set to "8Ω (High)." Measurements for 4 and 2 ohms are taken with the impedance selector at "4Ω (Normal)."

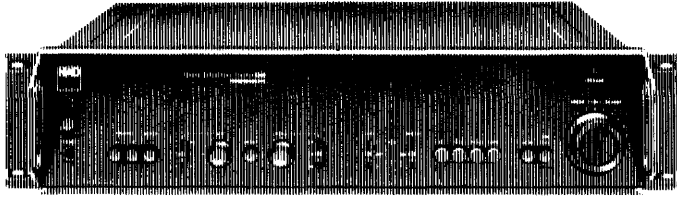

Power Amplifier Section

CONTINUOUS AVERAGE POWER

OUTPUT INTO 8 OHMS (min. RMS

power per channel into 8 ohms, 20Hz–20kHz, both channels driven, with no more than the rated distortion)

60 W (17.8 dBW)

Rated distortion (THD), 20Hz–20kHz

0.03%

Clipping power at 8 ohms

(maximum continuous power per channel)

70W

IHF dynamic headroom at 8 ohms

+6 dB

IHF dynamic power

(maximum short-term power per channel)

8 ohms: 250W

4 ohms: 300W

2 ohms: 400W

Peak output current (amperes)

>30A

Reactive load rating

+1.5 dB

Transient overload recovery time

<1 μsec

Slew factor

>50

Slew rate

30V/μsec

Damping factor (ref. 8Ω, at 50 Hz)

>100

Input impedance

30 kΩ

Input sensitivity for rated power

1 V

Input sensitivity for 1 watt out

120 mV

Power amplifier gain

28dB (25×)

THD (Total Harmonic Distortion,

20Hz–20kHz, from 250mW to rated output)

<0.03%

SMPTE I.M. (Intermodulation

Distortion, 60Hz + 7kHz, 4:1, from 250mW to rated output)

<0.03%

IHF I.M. (CCIF IM Distortion,

19 + 20 kHz at rated output)

<0.03%

Preamplifier Section

Phono Input

Input impedance (R and C)

MM: 47kΩ + 100/200/300 pF

MC: 100Ω + 1000 pF

Input sensitivity ref. 1 watt

MM: 0.4 mV

MC: 0.02 mV

Input overload

MM: 18mV/170mV/1.5V

0.8mV/8mV/70mV

THD (20Hz–20kHz) and IM Dist. at +30 dB level

<0.02%

RIAA response accuracy

±0.3dB

S/N ratio, IHF A-weighted, with cartridge connected

MM: 80 dB ref. 5 mV

MC: 80 dB ref. 0.5 mV

Line Level Inputs (CD, Video, Tape)

Input impedance

180kΩ + 100pF

Input sensitivity ref. 1 watt

25 mV

Maximum input signal

8V rms

Signal to noise ratio, A-weighted

100 dB ref. 1 W

118 dB ref. rated power

Frequency response, 20Hz–20kHz

±0.5 dB

Crosstalk between channels

60 dB at 1 kHz

50 dB at 20 kHz

Crosstalk between inputs

70 dB at 1 kHz

60 dB at 20 kHz

Line-level outputs

Preamp output impedance

800Ω

Maximum output level

10 V

Tape output impedance

1000Ω (buffered)

Tape output infrasonic filter

–3dB at 15 Hz, 12 dB/octave

Controls

Treble

±10 dB at 3, 6, or 12 kHz

Bass

±10 dB at 50, 100, or 250 Hz

Bass EQ

+3 dB at 60 Hz, +6 dB at 32 Hz

Infrasonic filter (switchable)

–3 dB at 14 Hz, 18 dB/octave

Audio muting (low level)

–20 dB

Physical Specifications

Dimensions (Width × Height × Depth)

43.2 cm. × 10.5 cm. × 38.1 cm.

17 in. × 4.12 in. × 15 in.

Net Weight

10 kg/22 lb

Shipping Weight

11.3 kg/25 lb

Power Consumption

375W—110, 120, 220 or 240 VAC

(50/60Hz)

NOTE: Specifications are those in effect at the time of printing. NAD reserves the right to change specifications or designs at any time without notice.

ALIGNMENT METHOD

AUDIO SECTION 3300

IMPORTANT

Speaker Impedance switch should be in 8 ohm position while adjusting center voltage and idling current.

INITIAL ADJUSTMENT (No load connected)

A. CENTER VOLTAGE

1. Connect DC millivoltmeter to L channel output terminals.
2. Turn on and adjust to $0\text{ V} \pm 30\text{mV}$ with VR 5 (10Kohm). Connect DC millivoltmeter to R channel output terminals and adjust VR 6 to $0\text{ V} \pm 30\text{mV}$.

B. IDLING CURRENT

1. Connect DC millivoltmeter across R289 (0.22 ohm, TP1, TP2 output transistor s collector resistor) and adjust VR 7 for 6 - 7.2mV reading on meter. Repeat adjust with VR 8, connecting meter across R290 (0.22 ohm, TP4, TP5)
2. Leave power on for minimum 30 minutes.

FINAL ADJUSTMENT

C. CENTER VOLTAGE

1. Repeat step A above.

D. IDLING CURRENT

1. Repeat step B and adjust with VR 7, VR 8 for 6.6mV reading on meter.

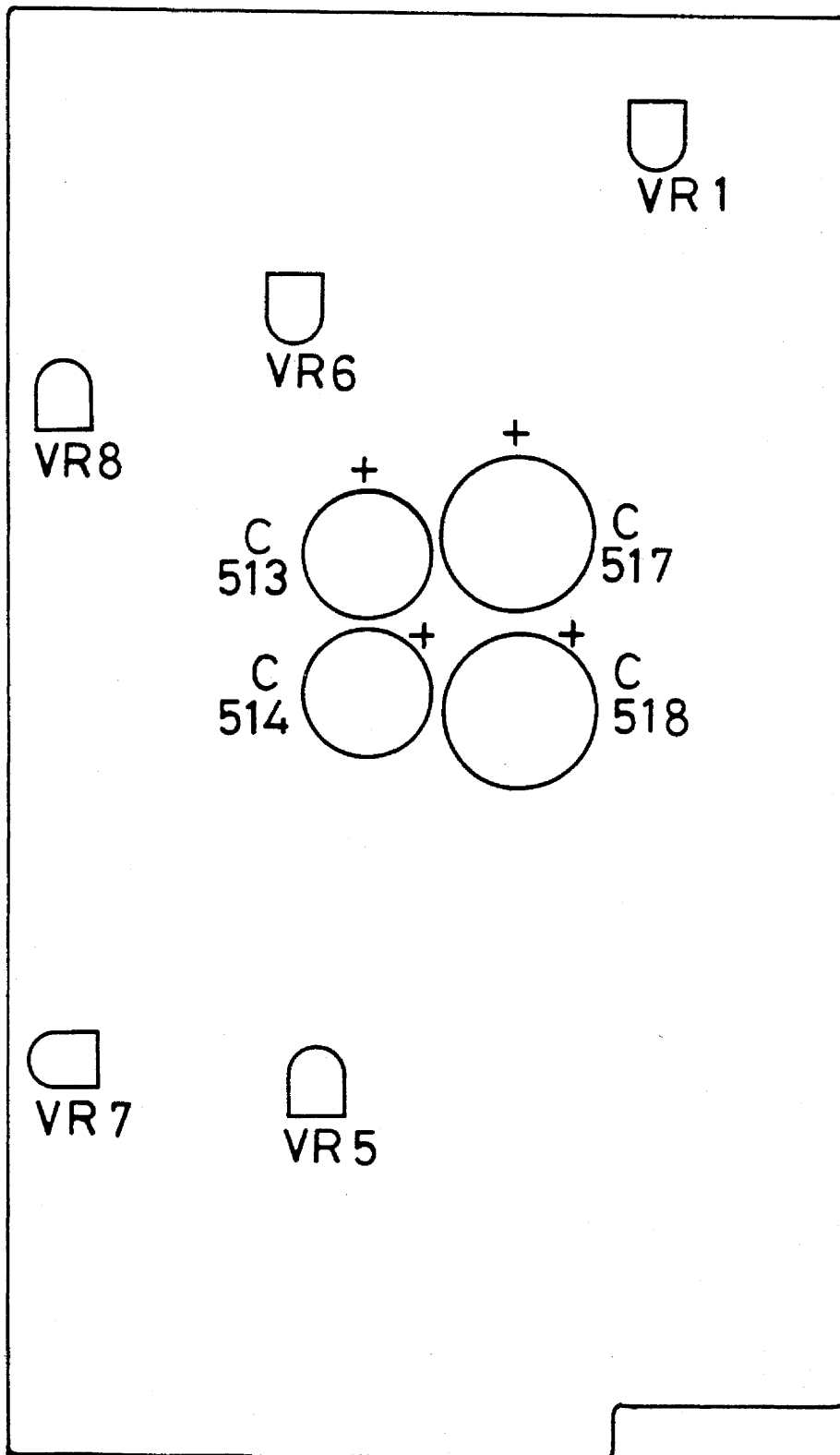

ALIGNMENT METHOD

NAD 3300 SCHEMATIC DIAGRAM

- SW1a ~ 1d MM/MC SWITCH : MM : MC
- SW2a ~ 2b MM LOAD SWITCH : 100P : 200P : 320P
- SW3a ~ 3b FUNCTION SWITCH : PHONO, TUNER, VIDEO, CD
- SW4a ~ 4b BASS EQ SWITCH : 1 : SOURCE, 2
- SW5a ~ 5d TAPE DUBBING SWITCH : 1-2 : OFF 2-1
- SW6 INFRASONIC SWITCH : IN : OUT
- SW7a ~ 7d BASS EQ SWITCH : IN : OUT
- SW8 MODE SWITCH : MONO : STEREO
- SW9a ~ 9d BY PASS SWITCH : ON : OFF
- SW10a ~ 10d BASS SELECTOR SWITCH : 250HZ : 120HZ, 50HZ
- SW11a ~ 11d TREBLE SELECTOR SWITCH : 12 KHZ, 6 KHZ, 3 KHZ
- SW12a ~ 12b LEVEL SWITCH : 0dB, -20dB
- SW13a ~ 13b SOFT CLIPPING SWITCH : ON : OFF
- SW14a ~ 14b BRIDGING SWITCH : ON : OFF
- SW15 SPEAKER SWITCH : ON : OFF
- SW16 SPEAKER B SWITCH : ON : OFF
- SW17a ~ 17b POWER SWITCH : ON : OFF
- SW18a ~ 18b RELAY 1 SWITCH : ON : OFF
- SW19a ~ 19b RELAY 2 SWITCH : ON : OFF
- SW20a ~ 20b RELAY 3 SWITCH : ON : OFF
- SW21a ~ 20b SPEAKER SELECTOR : 8ohm, 4ohm
- REMARK R151-R174 4.7MΩ

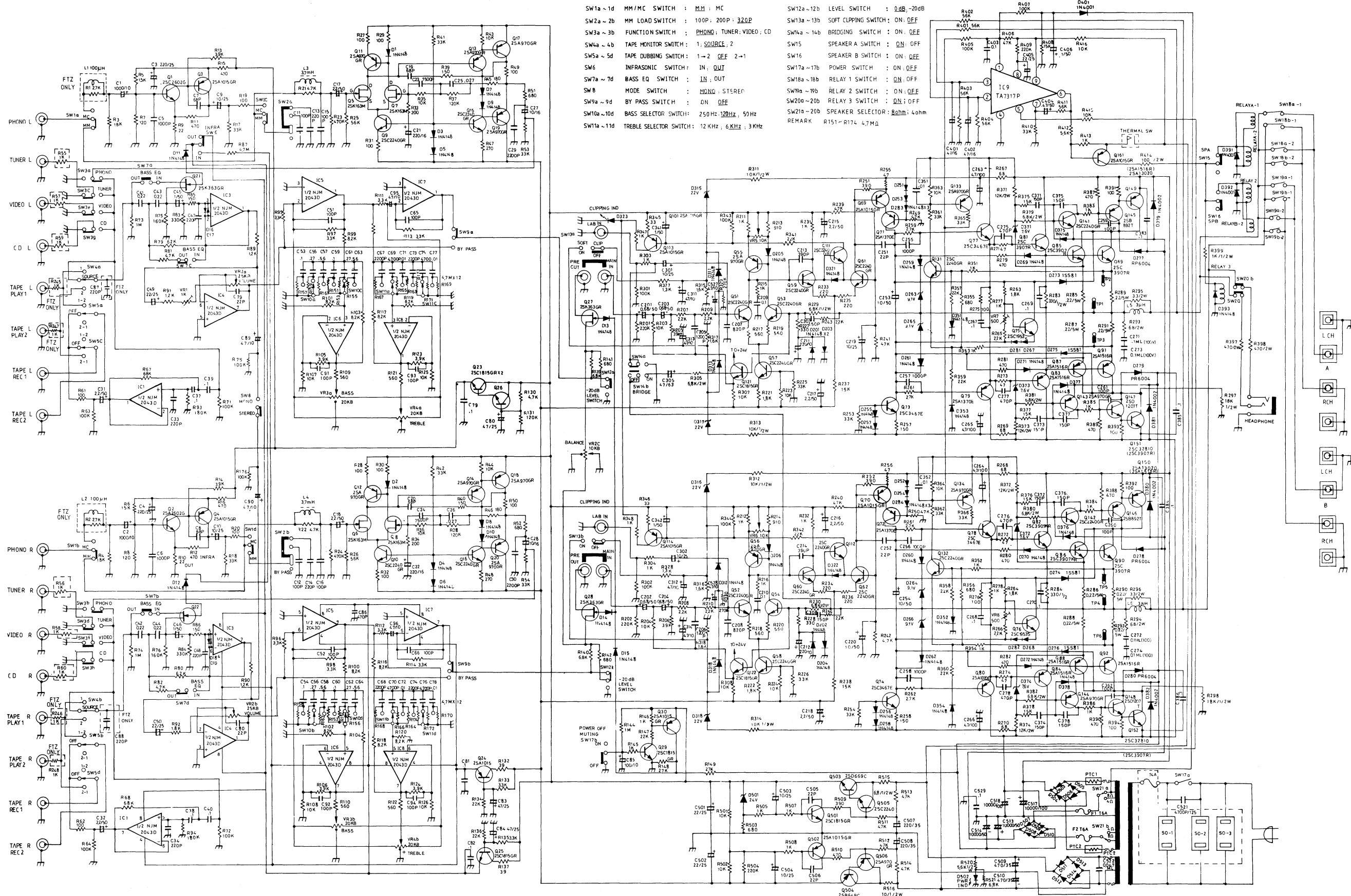

NAD 3300 PCB COMPONENT LOCATION AND WIRING DIAGRAM

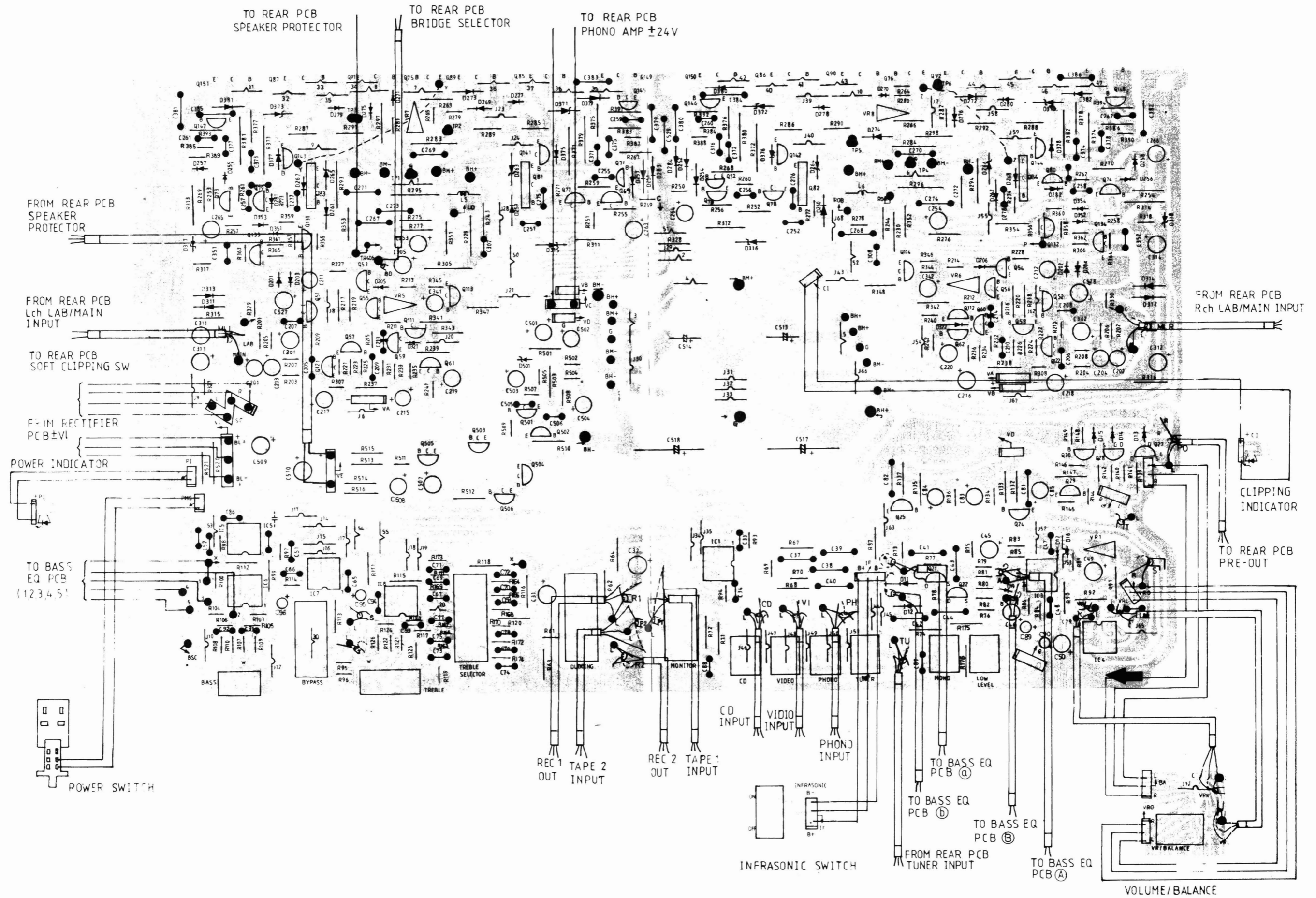

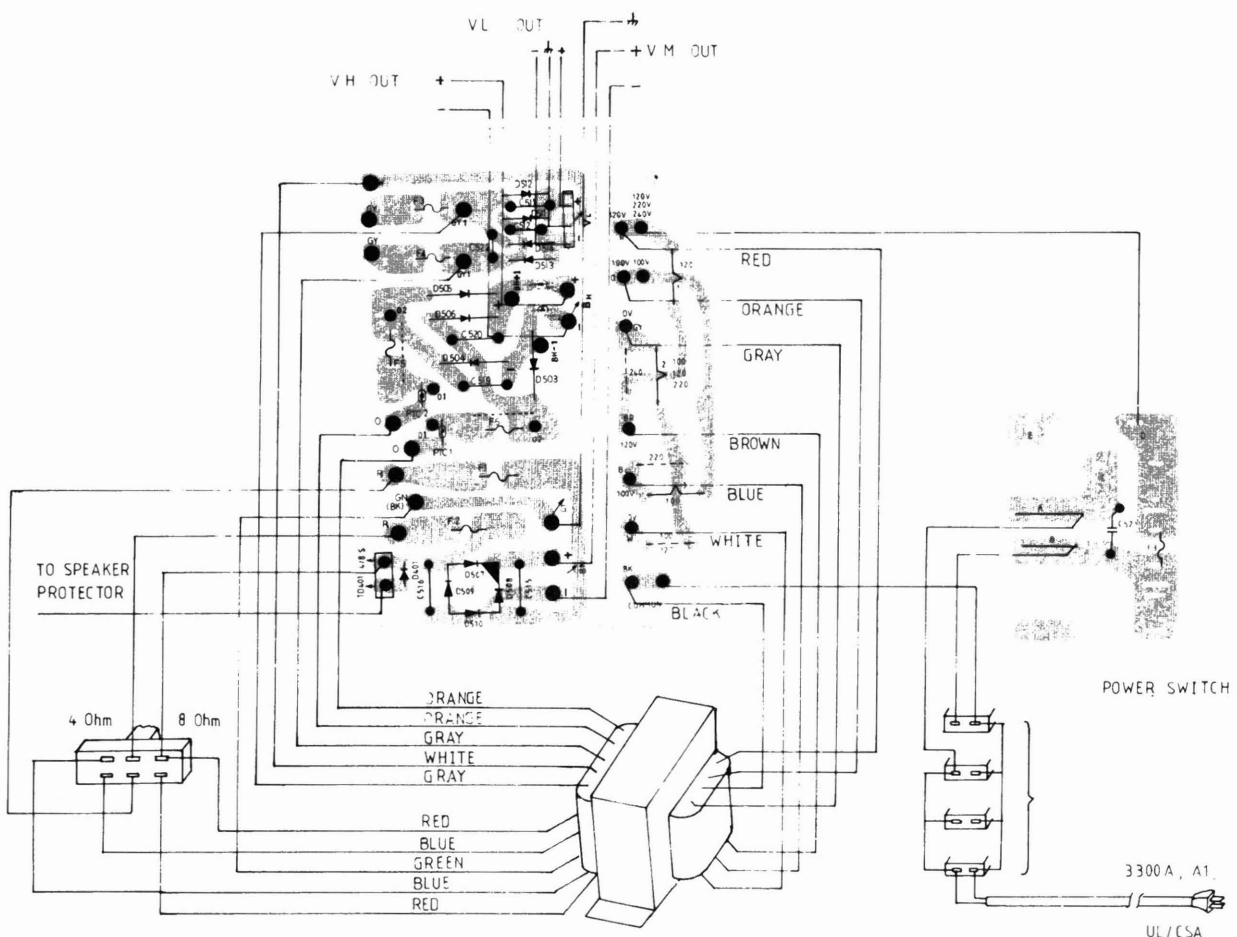
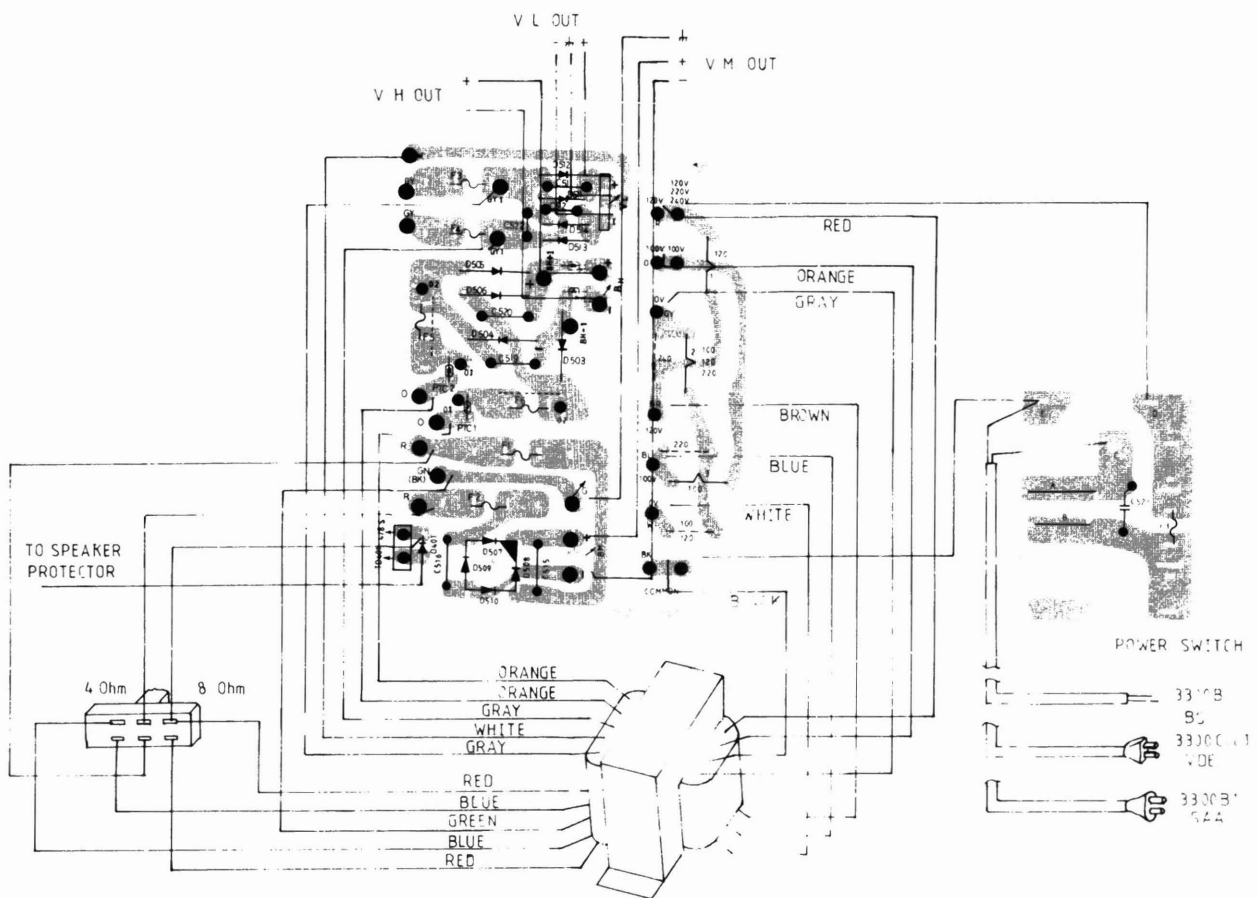

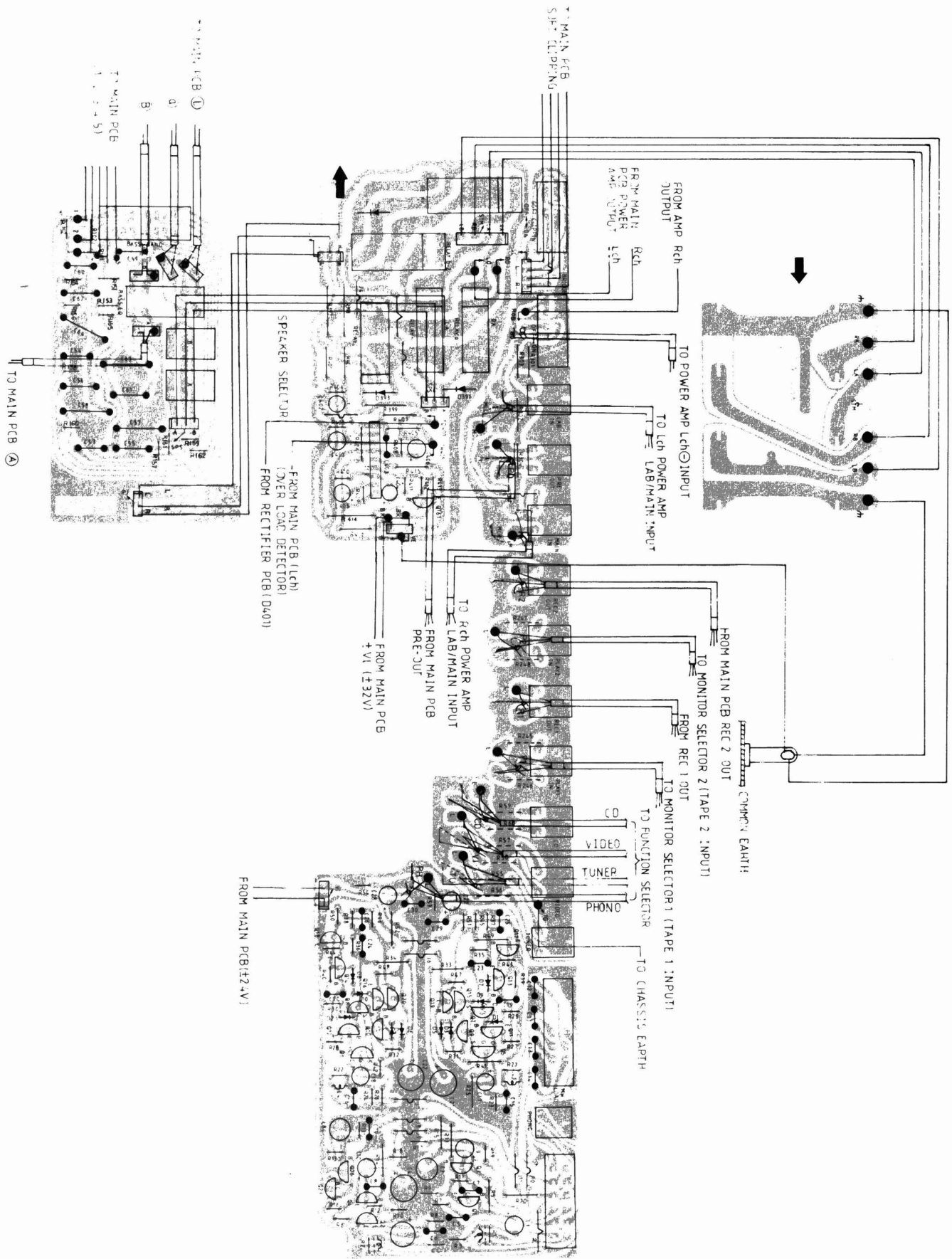

EXPLODED VIEW

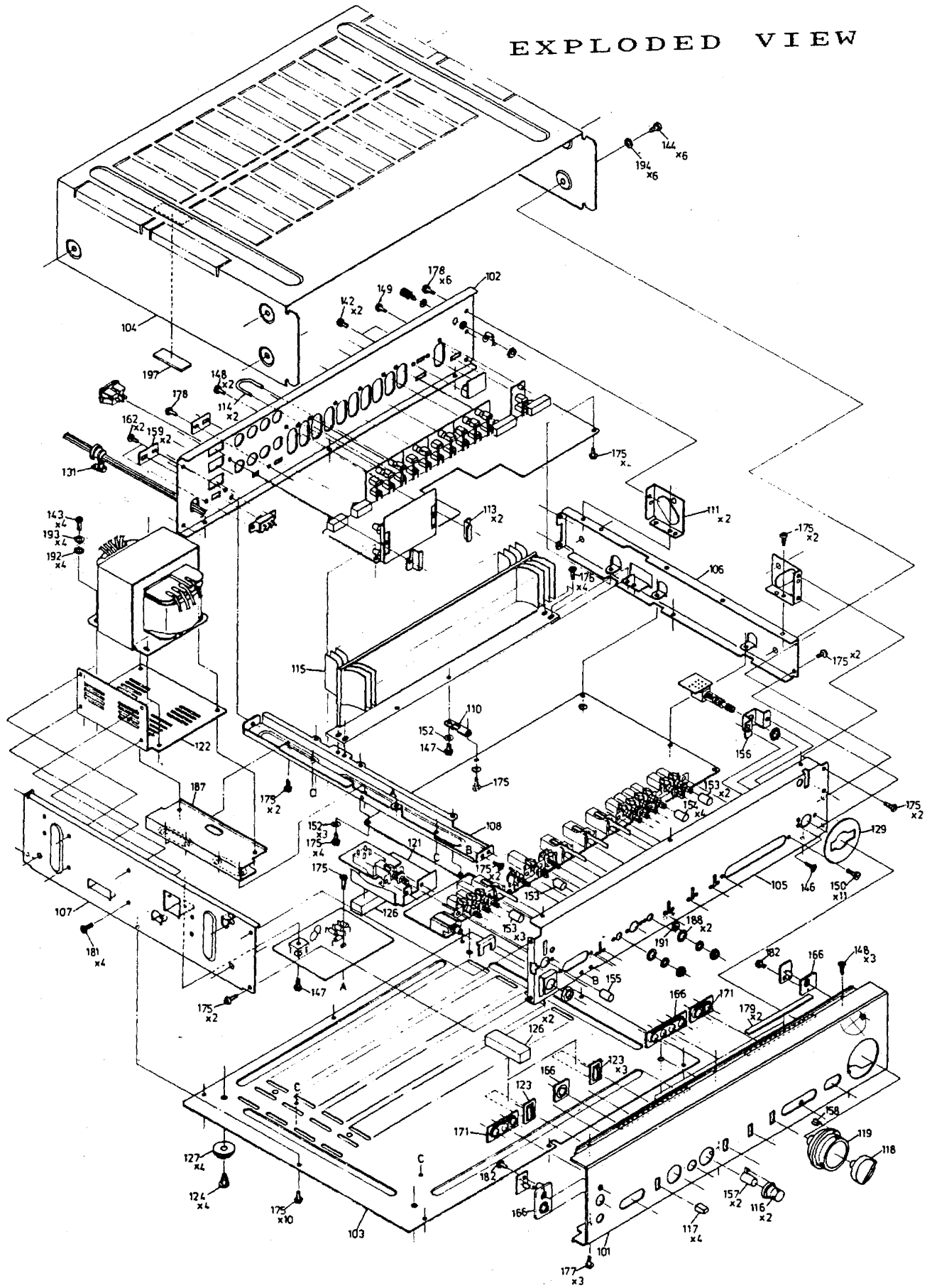

EXPLODED PARTS LIST

ITEM	PARTS NO.	DESCRIPTION	Q'TY
101	50 HPNLC1191-3PD	FRONT PANEL	1
102	38 GCOVR1024-3	BACK COVER	1
103	82 LCHSM1137-3P	CHASSIS	1
104	32 GCABU1050-3ZD	CABINET U	1
105	29 LANGV1041-3P	VA ANGLE	1
106	38 LANGF1200-3P	SIDE ANGLE (R)	1
107	17 LANGF1201-3P	SIDE ANGLE (L)	1
108	88 LANGF1202-3P	MIDDLE ANGLE	1
110	01 LANGK1408-3P	PCB ANGLE	1
111	72 LANGK1409-3P		2
113	20 LANGK1410-3P		2
114	40 QTIPP1001-3	JACK TIP	2
115	61 PRDAA1063-3G		1
116	53 JKNBR1624-3F	VR KNOB	2
117	66 JKNBL1625-3FD	LEVEL KNOB	4
118	77 JKNBR1626-3FD	BALANCE KNOB	1
119	88 JKNBR1627-3F	VOLUME KNOB	1
121	80 PSLD-1117-3-A		1
122	18 LANGK1509-3PL-B		1
123	47 PSPA-1143-3	LEVEL KNOB SPACER	4
124	58 LHLD-1267-3D	LEG PIN	4
126	27 PCUSS1304-3PD	PCB X 2, SHIELD-P X 1	3
127	09 PCUSS1305-3PD	LEG	4
131	56 LHLDK0066-1F	AC CORD BUSHING	1
142	54 XBBSQ26P04000	INFRASONIC SW X 2	2
143	83 XBPSD40P08000	TRANS ANG X 4	4
144	44 XDPSQ40P08000	CAB U X 6	6
146	67 XCBSD30P06000	LANGK1468 X 2	2
147	37 XCBSD30P12000	LANGK1408 X 1, TR X 1	2
148	36 XCBSQ30P06000	LANGK1210 X 2, PANEL X 3	5
149	85 XCBSQ30P08000	JACK X 7	7
150	46 XBPSD30P06000	PUSH SW X 3, LEVEL SW X 8	11
152	61 XWVSE43-05080	PCB X 3, LANGK1408 X 1	4
153	30 JKNBP1623-3FD-A	PUSH KNOB	6
154	88 JKNBP1623-3FC	PUSH KNOB	4
155	06 JKNBP1722-3F	POWER KNOB	1
156	60 LANGK1468-3P	VOLUME/BALANCE SW ANGLE	1
157	84 LHLD-1253-3	VR KNOB HOLDER	2
158	66 LHLD-1254-3	VOLUME KNOB HOLDER	1
159	13 LHLD-1252-3	SW HOLDER PLATE	2
162	40 XBBSQ30P06000	TURBO SW X 2	2
166	65 PSPA-1142-3	PUSH KNOB SPACER	1
171	83 PSPA-1141-3	PUSH KNOB SPACER	1
175	47 XHBSD30P06000	PCB X 7, VA X 6, CHASSIS X 10, LANGK1409 X 2, LANGK-1202 X 4, LANGK1408 X 1.	30
176	37 XCSSD30P08000	PRDAA1063 X 4	4
177	47 XHBSD30P06000	CHAS-R X 3	3
178	16 XHBSQ30P06000	BACK COVER X 7	7
179	56 PCUSS1062-3PD-B	PANEL SPONG	2
181	59 XBBSD40P06000	LANGF1201 X 4	4
182	33 XEBSD26P06000	LED X 2	2
187	35 LANGR1512-3PL-B	TRANS ANGLE	1
188	50 TRAP-1001-3RD		2
191	71 XWHSQ55-08120	PANEL * VA X 1	1
192	30 XWBSD42-10080	TRANS WASHER	4
193	33 XWSSD42-08100	TRANS SP WASHER	4
194	27 XWHSQ42-08100	CAB-U X 6	6
197	33 PCUSS1372-3	CAB X 1	1

3 3 0 0 B I L L O F M A T E R I A L S

SYMBOL NO	PARTS NO	DESCRIPTION	SYMBOL NO	PARTS NO	DESCRIPTION
BREAKER	QBRE-1001-3-V	*UP072* THERMAL BREAKER	R-045,046	VRCPSV4--181J-P	CARBON FILM FIXED RESISTOR
F-003	QFS-D602S-32K	FUSE	R-003,004	VRCPSV4--182J-P	CARBON FILM FIXED RESISTOR
F-003	QFS-D632H-31D	FUSE	R-009,010	VRCPSV4--220J-P	CARBON FILM FIXED RESISTOR
F-001,002	QFS-D632S-32K	FUSE	R-265	VRCPSV4--222J-P	CARBON FILM FIXED RESISTOR
HOLDER	QFSHC1002-3	FUSE HOLD	R-409	VRCPSV4--224J-P	CARBON FILM FIXED RESISTOR
SOCKET	QJAKP1005-3D2	2P RCA SOCKET	R-047,048	VRCPSV4--271J-P	CARBON FILM FIXED RESISTOR
SOCKET	QJAKP1014-304	4P RCA SOCKET	R-148,149	VRCPSV4--273J-P	CARBON FILM FIXED RESISTOR
SOCKET	QJAKP1017-3D6	6P RCA SOCKET	R095,096,097,	VRCPSV4--332J-P	CARBON FILM FIXED RESISTOR
JACK	QJAKS1017-3DV	PHONES JACK	098,114		
JUMPER	QJUM-0003D8125	12.5 MM, JUMPER	R-053	VRCPSVR--333J--	CARBON FILM FIXED RESISTOR
L0002	QLUGS0944-1	LUG	R017,018,042,	VRCPSV4--333J-P	CARBON FILM FIXED RESISTOR
LUG	QPINM1001-3	LUG	054,410		
PHONO PCB	QP4B-6391-3	PCB 330x79x1.6	R271,272,273,274	VRCPSV4--470J-P	CARBON FILM FIXED RESISTOR
EQ, RG, SP, PCB	QP4B-6392-3-1	175.5x109.5x1.6, 94V-0	R-016	VRCPSV4--471J--	CARBON FILM FIXED RESISTOR
PRE/MAIN AMP PCB	QP4B-6393-3	330x196x1.6 94V-0	R279,280,281,387,	VRCPSV4--471J-P	CARBON FILM FIXED RESISTOR
SOCKET	QSOCP1014-31D	AC OUTLET	388,389,390,282		
SW005,011	QSW-B1042-34-3	SWITCH, DUBBING-TREBLE	R-130	VRCPSV4--472J--	CARBON FILM FIXED RESISTOR
SW004	QSW-B1043-32-3	SWITCH, MONITOR	R-021,022	VRCPSV4--172J-P	CARBON FILM FIXED RESISTOR
SW009	QSW-P1076-32-2	SWITCH, BYPASS	R-249,250	VRCPSV4--473J-P	CARBON FILM FIXED RESISTOR
SW015,016,07	QSW-P1077-33	SWITCH, SPK A, B, BASS, EQ	R-023,024	VRCPSV4--474J-P	CARBON FILM FIXED RESISTOR
SW03,08,012	QSW-P1083-37	(CD. VIDEO. PHONO. TUNER) SWITCH	R109,110,121,122	VRCPSV4--561J-P	CARBON FILM FIXED RESISTOR
SW017	QSW-P1084-32V2	POWER SW	R-412	VRCPSV4--562J--	CARBON FILM FIXED RESISTOR
SW013,014	QSW-P1088-32D2	POWER SW	R-404,026	VRCPSV4--563J--	CARBON FILM FIXED RESISTOR
SW006	QSW-S1033-32-2	SOFT CLIPPING/BRIGDE SW	R-403,411	VRCPSV4--563J-P	CARBON FILM FIXED RESISTOR
SW001	QSW-S1052-32-2	INFRASONIC SW	R-079,080	VRCPSV4--623J-P	CARBON FILM FIXED RESISTOR
SW021 A. B.	QSW-S1064-34-2	MM/HC SELECTOR SW	R-051	VRCPSV4--681J-P	CARBON FILM FIXED RESISTOR
SW022	QSW-S1066-32-2	40HM/80HM SELECTOR SW	R-101	VRCPSV4--822J--	CARBON FILM FIXED RESISTOR
TIP	QSW-S1069-32-3	MM LOAD SW	R100,103,104,	VRCPSV4--822J-P	CARBON FILM FIXED RESISTOR
TERMINAL	QTIPP1001-3	JACK TIP	117,119		
TERMINAL	QTHLB1070-3	GROUND TERMINAL	R-151,152,153,	VRCPSV6--475J--	CARBON FILM FIXED RESISTOR
TERMINAL	QTMK1002-304	BINDING POST	154,155,156,157,		
L-005,006	RCILS0010-3FS2	COIL, 3UH	158,159,160,161,		
L-003,004	RCILT1005-3	COIL, 3.7NH	R-399	VRCPTV2--102J--	CARBON FILM FIXED RESISTOR
TERMINAL	QTMK1002-304-A	BINDING POST	R311,312,313,314	VRCPTV2--103J--	CARBON FILM FIXED RESISTOR
D-323,502	RLEDGR101-3D1	LIGHT EMITTING DIODE	R-297,298	VRCPTV2--183J--	CARBON FILM FIXED RESISTOR
X' FORMER	RPT-J1003-3-EX	POWER TRANSFORMER, 220V/50Hz	R-283,284	VRCPTV2--331J--	CARBON FILM FIXED RESISTOR
X' FORMER	RPT-J1003-3-EXA	POWER TRANSFORMER, 240V/50Hz	R-520	VRCPTV2--562J--	CARBON FILM FIXED RESISTOR
R-035,036	RR-C2103F-3V4-P	CARBON FILM FIXED RESISTOR	R-229,230	VRCPTV2--682J--	CARBON FILM FIXED RESISTOR
R-038	RR-C2124F-3V4--	CARBON FILM FIXED RESISTOR	R-020,049	VRCPTV4--101J-T	CARBON FILM FIXED RESISTOR
R-037	RR-C2124F-3V4-P	CARBON FILM FIXED RESISTOR	R-303,304	VRCPTV4--102J-T	CARBON FILM FIXED RESISTOR
SW020	RRLYD1014-3C-D-	RELAY	R-415,416	VRCPTV4--103J-T	CARBON FILM FIXED RESISTOR
SW018,019	RRLYD1044-3EDG-	A-2, RELAY B-2	R-175,176	VRCPTV4--104J-T	CARBON FILM FIXED RESISTOR
PTC01,02	RTHM-1001-3GU--	POSTITOR	R-074	VRCPTV4--105J-T	CARBON FILM FIXED RESISTOR
V0003	RVR-RK001-3J2C-	ROTARY VARIABLE RESISTOR	R-090,091	VRCPTV4--122J-T	CARBON FILM FIXED RESISTOR
VOL/BALANCE	RVR-RK002-3J2C-	ROTARY VARIABLE RESISTOR	R-328	VRCPTV4--132J-T	CARBON FILM FIXED RESISTOR
V0004	RVR-RM003-3Z3--	ROTARY VARIABLE RESISTOR	R-237,238	VRCPTV4--153J-T	CARBON FILM FIXED RESISTOR
V007,008	RVRSH8003-8501-	SEMI-FIXED VAR. RES. 10kohm	R-316,315	VRCPTV4--162J-T	CARBON FILM FIXED RESISTOR
V0001	RVRSH8101-3102-	SEMI-FIXED VAR. RES. 1kohm	R-092,263	VRCPTV4--182J-T	CARBON FILM FIXED RESISTOR
V0005,006	RVRSH8101-3103-	SEMI-FIXED VAR. RES. 10kohm	R-033,034	VRCPTV4--201J-T	CARBON FILM FIXED RESISTOR
C091,092,093,094	VCDSDU1HL101J--	CERAMIC CAPACITOR	R-243,244,266	VRCPTV4--222J-T	CARBON FILM FIXED RESISTOR
C051,052,065,066	VCDSDU1HL101J-P	CERAMIC CAPACITOR	R-147,341,342	VRCPTV4--223J-T	CARBON FILM FIXED RESISTOR
C-307	VCDSDU1HL151J--	CERAMIC CAPACITOR	R-259	VRCPTV4--272J-T	CARBON FILM FIXED RESISTOR
C385,376,377,	VCDSDU1HL151J-P	CERAMIC CAPACITOR	R-111,112,113,	VRCPTV4--332J-T	CARBON FILM FIXED RESISTOR
308,371,372,			133,135		
374,378,373					
C505,506,079,080	VCDSDU1HL220J-P	CERAMIC CAPACITOR	R-253,254	VRCPTV4--333J-T	CARBON FILM FIXED RESISTOR
C033,034,047,048	VCDSDU1HL221J-P	CERAMIC CAPACITOR	R-132,137	VRCPTV4--390J-T	CARBON FILM FIXED RESISTOR
C-213,214	VCDSDU1HL391J--	CERAMIC CAPACITOR	R-252	VRCPTV4--391J-T	CARBON FILM FIXED RESISTOR
C-086	VCDSDU1HL471J--	CERAMIC CAPACITOR	R-255,256	VRCPTV4--470J-T	CARBON FILM FIXED RESISTOR
C275,276,277,278	VCDSDU1HL471J-P	CERAMIC CAPACITOR	R-510	VRCPTV4--471J-T	CARBON FILM FIXED RESISTOR
C-020	VCDSDU1HL680J--	CERAMIC CAPACITOR	R-239,512,513,514	VRCPTV4--472J-T	CARBON FILM FIXED RESISTOR
			R-406	VRCPTV4--473J-T	CARBON FILM FIXED RESISTOR

C-007,008,019	VCDSDU1HL680J-P	CERAMIC CAPACITOR	R-087	VRCPTV4--475J-T	CARBON FILM FIXED RESISTOR
C259,260,261,262	VCDSDU2HL101J--	CERAMIC CAPACITOR	R-217,218,219,220	VRCPTV4--561J-T	CARBON FILM FIXED RESISTOR
C-251,252	VCDSDU2HL220J-P	CERAMIC CAPACITOR	R-401,402,025	VRCPTV4--563J-T	CARBON FILM FIXED RESISTOR
C-085	VCEACU1AG107M-P	ELECTROLYTIC CAPACITOR	R-267,268,269,270	VRCPTV4--680J-T	CARBON FILM FIXED RESISTOR
C-001,002	VCEACU1AG108M--	ELECTROLYTIC CAPACITOR	R-503	VRCPTV4--681J-T	CARBON FILM FIXED RESISTOR
C-211,212	VCEACU1AG227M-P	ELECTROLYTIC CAPACITOR	R-521,139	VRCPTV4--682J-T	CARBON FILM FIXED RESISTOR
C-089,090,095	VCEACU1AG476M--	ELECTROLYTIC CAPACITOR	R-067,068	VRCPTV4--683J-T	CARBON FILM FIXED RESISTOR
C-313,527,096, 311,312,314,528	VCEACU1AG476H-P	ELECTROLYTIC CAPACITOR	R-102	VRCPTV4--822J--	CARBON FILM FIXED RESISTOR
C-021,022	VCEACU1CG227M--	ELECTROLYTIC CAPACITOR	R-099,115,116	VRCPTV4--822J-T	CARBON FILM FIXED RESISTOR
C-401,402	VCEACU1CG476M-P	ELECTROLYTIC CAPACITOR	118,120		
C-405	VCEACU1EG226M-P	ELECTROLYTIC CAPACITOR	R-061	VRCPTV6--101J-T	CARBON FILM FIXED RESISTOR
C-003,004	VCEACU1EG227M--	ELECTROLYTIC CAPACITOR	R-307	VRCPTV6--103J-T	CARBON FILM FIXED RESISTOR
C-080	VCEACU1EG476M--	ELECTROLYTIC CAPACITOR	R-344	VRCPTV6--104J-T	CARBON FILM FIXED RESISTOR
C-083,084	VCEACU1EG476M-P	ELECTROLYTIC CAPACITOR	R-073,144	VRCPTV6--105J-T	CARBON FILM FIXED RESISTOR
C-046,341	VCEACU1HG105M--	ELECTROLYTIC CAPACITOR	R-089	VRCPTV6--122J-T	CARBON FILM FIXED RESISTOR
C219,253,301,503 504,220,254,302	VCEACU1HG106M-P	ELECTROLYTIC CAPACITOR	R-327	VRCPTV6--132J-T	CARBON FILM FIXED RESISTOR
C-018	VCEACU1HG225M--	ELECTROLYTIC CAPACITOR	R-257,258	VRCPTV6--151J-T	CARBON FILM FIXED RESISTOR
C-017	VCEACU1HG225H-P	ELECTROLYTIC CAPACITOR	R-317,318	VRCPTV6--162J-T	CARBON FILM FIXED RESISTOR
C-404	VCEACU1HG474M-P	ELECTROLYTIC CAPACITOR	R-075,076	VRCPTV6--164J-T	CARBON FILM FIXED RESISTOR
C-203,204	VCEACU1HG684M--	ELECTROLYTIC CAPACITOR	R-221,222	VRCPTV6--182J-T	CARBON FILM FIXED RESISTOR
C-201,202	VCEACU1HG684H-P	ELECTROLYTIC CAPACITOR	R-093,094	VRCPTV6--184J-T	CARBON FILM FIXED RESISTOR
C-305	VCEACU1JG476M--	ELECTROLYTIC CAPACITOR	R-233,234,235,236	VRCPTV6--221J-T	CARBON FILM FIXED RESISTOR
C-509	VCEACU1VG108Y--	ELECTROLYTIC CAPACITOR	R-207,208,209,210	VRCPTV6--222J-T	CARBON FILM FIXED RESISTOR
C-507,508	VCEACU1VG227M--	ELECTROLYTIC CAPACITOR	R-134,136,357, 358,359,360	VRCPTV6--223J-T	CARBON FILM FIXED RESISTOR
C-510	VCEACU1VG477M--	ELECTROLYTIC CAPACITOR	R-202	VRCPTV6--224J-T	CARBON FILM FIXED RESISTOR
C-517,518	VCEACU2AG109Y--	ELECTROLYTIC CAPACITOR	R-260,262	VRCPTV6--272J-T	CARBON FILM FIXED RESISTOR
C263,264,265,266	VCEACU2AG475M-P	ELECTROLYTIC CAPACITOR	R-329,330	VRCPTV6--274J-T	CARBON FILM FIXED RESISTOR
C-513,514	VCEALS1HG109Y--	ELECTROLYTIC CAPACITOR	R-346	VRCPTV6--330J-T	CARBON FILM FIXED RESISTOR
C255,256,257,258	VCKBDU1HY102K-P	CERAMIC CAPACITOR	R-227,228	VRCPTV6--331J-T	CARBON FILM FIXED RESISTOR
C-207,208	VCKBDU1HY821K-P	CERAMIC CAPACITOR	R-225,226,361, 362,365,366	VRCPTV6--333J-T	CARBON FILM FIXED RESISTOR
C-005,006	VCKDDU1HY102M-P	CERAMIC CAPACITOR	R-083,084	VRCPTV6--334J-T	CARBON FILM FIXED RESISTOR
C-521	VCKEDU7EV472MW3	CERAMIC CAPACITOR	R-509,251	VRCPTV6--391J-T	CARBON FILM FIXED RESISTOR
C267,268,269,270	VCKFDU1HY104Z--	CERAMIC CAPACITOR	R-105,106,124	VRCPTV6--392J-T	CARBON FILM FIXED RESISTOR
C383,384,385,386	VCKFDU2AY104Z--	CERAMIC CAPACITOR	R-205,206	VRCPTV6--393J-T	CARBON FILM FIXED RESISTOR
C-521	VCKFDU7BY472PD3	CERAMIC CAPACITOR	R-082	VRCPTV6--472J-T	CARBON FILM FIXED RESISTOR
C-522	VCMHU2AG473K--	CERAMIC CAPACITOR	R-141,142	VRCPTV6--681J-T	CARBON FILM FIXED RESISTOR
C057,058,063,064	VCMHIY2AG564J--	POLYPROFILM CAPACITOR	R-140	VRCPTV6--682J-T	CARBON FILM FIXED RESISTOR
C071,072,077,078	VCPELU1HG103J-P	POLYPROFILM CAPACITOR	R-214,213	VRCPTV6--683J-T	CARBON FILM FIXED RESISTOR
C037,308,309,040	VCPELU1HG104J--	POLYPROFILM CAPACITOR	R-516	VRCPTV6--911J-T	CARBON FILM FIXED RESISTOR
C-205,206	VCPELU1HG122J-P	POLYPROFILM CAPACITOR	R-515	VRCPTV6--912J--	FUSE RESISTOR
C-029,030	VCPELU1HG222J-P	POLYPROFILM CAPACITOR	R-285,286,287,288	VRCPTV6--913J--	FUSE RESISTOR
C041,042,043,044	VCPELU1HG224J--	POLYPROFILM CAPACITOR	288,289,290,291, 381,382	VRCPTV6--914J--	WIRE WOUND RESISTOR
C-025,026	VCPELU1HG273J-P	POLYPROFILM CAPACITOR	R-006	VRHPSV4--152F--	METAL FILM RESISTOR
C05,056,061,062	VCPELU1HG274J--	POLYPROFILM CAPACITOR	R-011,012	VRHPSV4--471F-P	METAL OXIDE FILM RESISTOR
C069,070,075,076	VCPELU1HG472J-P	POLYPROFILM CAPACITOR	R-005	VRHPTV4--152F-T	METAL OXIDE FILM RESISTOR
C271,272,273,274	VCPELU2AG104K--	POLYPROFILM CAPACITOR	R-013,014	VRHPTV4--392F-T	METAL OXIDE IFLM RESISTOR
C-023,024	VCPSSQU1HG752J--	POLYPROFILM CAPACITOR	R-614	VRNMT02--101J--	CARBON (SOLID) RESISTOR
C209,210,081,082 351,352,529.	VCSRDU1EY104M--	POLYPROFILM CAPACITOR	R-371,372,373,374	VRNMT02--123J--	METAL OXIDE FILM RESISTOR
R-028,030		CARBON FILM FIXED RESISTOR	R-295,296	VRNMT02--3R3J--	METAL OXIDE FILM RESISTOR
R027,029,031,032 019,050	VRCPSV4--101J--	CARBON FILM FIXED RESISTOR	R-397,398	VRNMT02--471J--	METAL OXIDE FILM RESISTOR
R-413	VRCPSV4--101J-P	CARBON FILM FIXED RESISTOR	R-293,294	VRNMT02--6R8J--	METAL OXIDE FILM RESISTOR
R-044	VRCPSV4--102J-P	CARBON FILM FIXED RESISTOR	R-395,379,380, 381,382	VRNMT02--682J--	METAL OXIDE IFLM RESISTOR
R-043	VRCPSV4--103J--	CARBON FILM FIXED RESISTOR	D-507,508,509,510	VSDPBF604-----	DIODE
R-008	VRCPSV4--103J-P	CARBON FILM FIXED RESISTOR	D-277,278,279,280	VSDPR6004-----	DIODE
R-007	VRCPSV4--121J--	CARBON FILM FIXED RESISTOR	D-401	VSDIN4001-----	DIODE
R-131	VRCPSV4--121J-P	CARBON FILM FIXED RESISTOR	D-379,380,381,382	VSDIN4004-----	DIODE
R-039,040	VRCPSV4--124J-P	CARBON FILM FIXED RESISTOR	F-393	VSDIN4148-----	DIODE
R-408	VRCPSV4--151J--	CARBON FILM FIXED RESISTOR	D-314,322,283,261	VSDIN4148-----T	DIODE
	VRCPSV4--151J-P	CARBON FILM FIXED RESISTOR	284,011,012,262, D-503,504,505,506	VSDIN5404-----	DIODE

SYMBOL NO	PARTS NO.	DESCRIPTION	SYMBOL NO	PARTS NO.	DESCRIPTION
D-273, 274, 275, 276	VSD15S81	DIODE	WASHER	XVRS042-10080	WASHER
IC001, 003, 004,	VSINJM2043D	INTEGRATED CIRCUIT	WASHER	XVRS042-08100	CAB-UM*6
005, 006, 007, 008			WASHER	XVRS055-P8120	PANELAVA*1
IC009	VSITA7317P	INTEGRATED CIRCUIT	WASHER	XWSSD42-10000	TRANS SP WASHER
Q-003, 004, 161	VST2SA1015GR	TRANSISTOR	WASHER	XVWS064-06110	WASHER
Q-071, 072, 079, 080	VST2SA1370E	TRANSISTOR	WASHER	XVWSE43-05080	PCBX3
Q-083, 084	VST2SA1516R	TRANSISTOR	NELJLOCK	ZADHSDNJ-LK	10. NELJLOCK
Q-011, 012, 013, 014	VST2SA970GR	TRANSISTOR	CHEMINE	ZADHSDNCM575	30 CHEMINE-575
017, 018, 019, 020.			CLEANER	ZCLNR-ARKLONE-A	CLEANER
Q-504	VST2SB649AC	TRANSISTOR	FLUX	ZFLUXMH820V	36 FLUX-MH-820V
Q-145, 146	VST2SB892T	TRANSISTOR	WIRE HOLDER	ZHLDW-1001	80 WIRE-HOLD-BLK-300M
Q-023, 026	VST2SC1815GR	TRANSISTOR	TICO SIL POLISH	ZSLCN-TC-POLSH	10 TICO-SIL-POLISH
Q-075, 076	VST2SC1953S	TRANSISTOR	SILICONE	ZSLCN-UH103	01 SILICONE-UH-103
Q-009, 010, 015, 016	VST2SC2240GR	TRANSISTOR	SOLDER	ZSOLD0630	59 SOL-BAR-63/37
Q-001, 002	VST2SC2602G	TRANSISTOR	SOLDER	ZSOLDM500-1R2	SOLDER
Q-073, 074, 077, 078	VST2SC3467E	TRANSISTOR	SOLDER	ZSOLDW630-1R0	SOLDER
Q-081, 082	VST2SC3907R	TRANSISTOR	STAPLES	ZSTPL-3319	STAPLES
Q-147, 148	VST2SD1207T	TRANSISTOR	TAPE	ZTAPE0012M018	TAPE
Q-503	VST2SD669AC	TRANSISTOR	TAPE	ZTAPE06R0M018	TAPE
Q-005, 006, 007, 008	VST2SK163M	TRANSISTOR	TAPE	ZTAPE012T022	TAPE
Q-027, 028, 021, 022	VST2SK363GR	TRANSISTOR	TAPE	ZTAPE019T045	TAPE
D-315, 316, 317, 318	VSZHZ22-1	ZENER DIODE	TAPE	ZTAPEJ010D036	TAPE
D-501	VSZHZ24-1	ZENER DIODE	TAPE	ZTAPEM012A045	TAPE
D-371, 372, 373, 374	VSZHZ7C-3	ZENER DIODE	TAPE	ZTAPEM9R0A045	TAPE
D-263, 264, 265, 266	VSZHZ9X-1	ZENER DIODE	TAPE	ZTAPEP012D020D	TAPE
MULTIPLE WIRE	VMA4T0K2C-A3B	AC CODE	TIE PP	ZTAPE0075H050	89 TPE-PP-75-TRC-50M
PWB-6393. PHS	VWPA6T7W2CD3K-	POWER SW PARALLEL WIRE	THINNER	ZTHNR-4520	43 THINNER-4520
PWB-6391. YR	VWPA6T7W3CD3K-	PARALLEL WIRE	MULTI WAX	ZMAX-MSM700	20 MULTI-WAX-SM-700
PWB-6393. YR					
PWB-6391. BA					
PWB-6391. BA					
PWB-6392. STM	VWPA6T7W4CD3K-	PARALLEL WIRE			
PWB-6391. STM					
PWB-6393. BH	VWPA6T7Y5DID3K-	PARALLEL WIRE			
BH+ LEFT					
PWB-6393. BH	VWPA6T7Y9DID3K-	PARALLEL WIRE			
PWB-6391. BD	VWPA6T7Y9DID3K-	SHIELD WIRE			
PWB-6393. BD	VWPA6T7Y9DID3K-	SHIELD WIRE			
PWB-6391. MLL	VWSAB-JT2CX-FI-	SHIELD WIRE			
PWB-6393. MLL					
PWB-6392. A	VWSAB-JY2FX-FI-	SHIELD WIRE			
PWB-6393. A					
STRIP WIRE	VWTOR6001-SW----	STRIP WIRE			
SCREW	XBBS040P06000----	A-H-6201*4			
SCREW	SBBS028P04000----	INFRASONIC SWX2			
SCREW	XBBS030P06000----	TURBO SWX2			
SCREW	XBPSD30P06000----	PUSH SWX3, LEVEL SH*8.			
SCREW	XBPSD40P08000----	TRANS ANGX4			
SCREW	XCBSD30P06000----	A-F-6468*2			
SCREW	XCBSD30P08000----	RAD-P-099B*2			
SCREW	XCBSD30P12000----	RAD-P-6063*14			
SCREW	XCBSD40P08000----	A-H-6201*4			
SCREW	XCBSQ30P06000----	PANEL*3			
SCREW	XCBSQ30P08000----	JACKX7			
SCREW	XCPSD30P06000----	ANG-FIX-6468*2			
SCREW	XCSSD30P08000----	SCREW			
SCREW	XDPSQ40P08000----	CAB UX6			
SCREW	XBSD26P06000----	LED*2			
SCREW	XHBSD30P06000----	PCB*4, VA*6, A-F-6409*2,			
SCREW		PANEL*1, TRANS*2.			
SCREW	XHBS030P06000----	CAB-B*6			

PACKING DIAGRAM

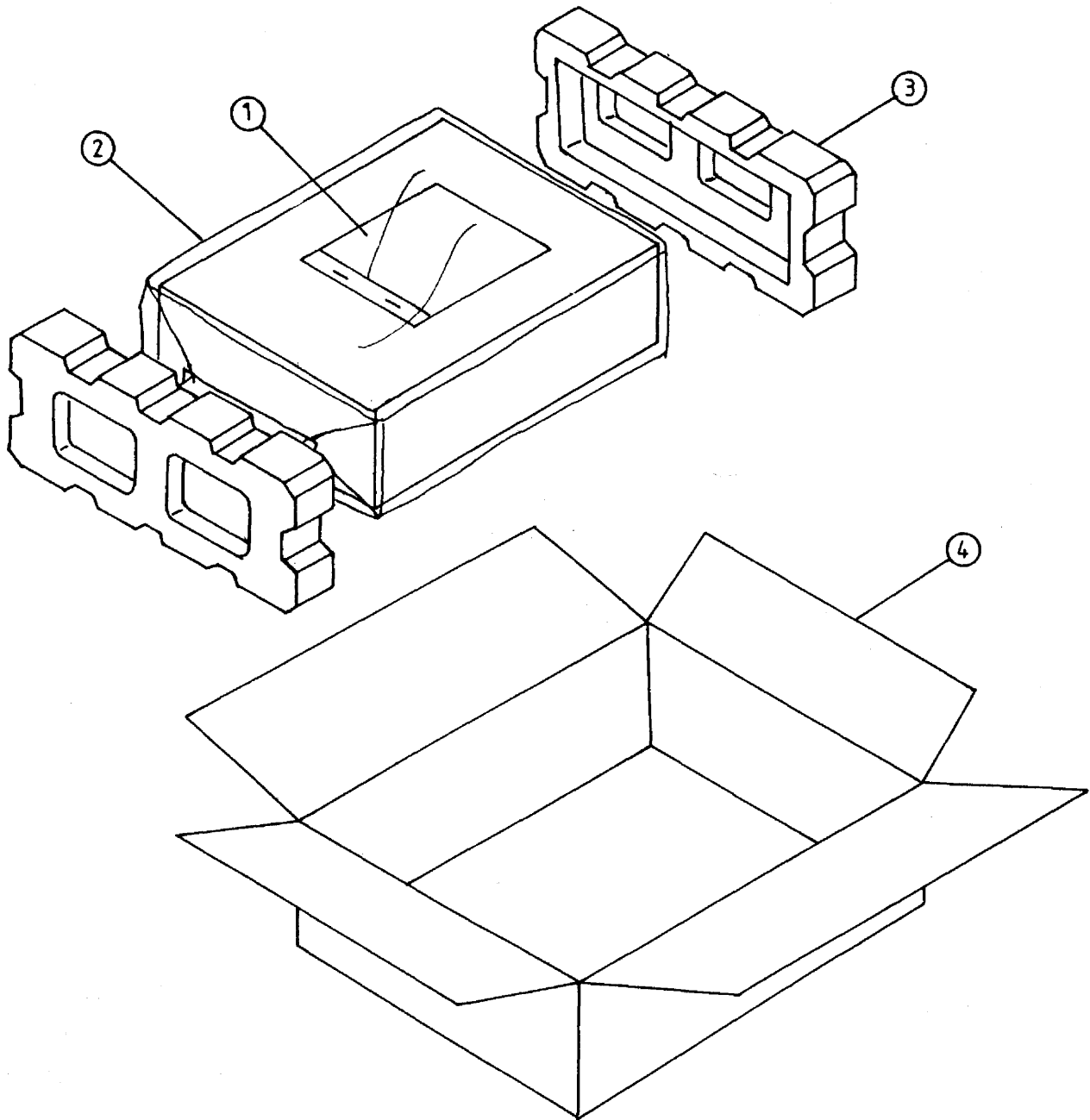

PACKING LIST FOR NAD-3300

ITEM	PARTS NO.	NAME	Q'TY
1	77TINSE2007-3	OWNER'S MANUAL	1
2	34SSAKH1200-3-T	PE BAG	1
3	65SPAKA1308-3F	POLYLON	2
4	82SPAKC1621-3R--A	GIFT BOX	1

SERVICE MANUAL

3300

INTEGRATED AMPLIFIER

NAD ELECTRONICS
BOSTON/LONDON