

Nakamichi

Service Manual

ST-2

FM Stereo Tuner

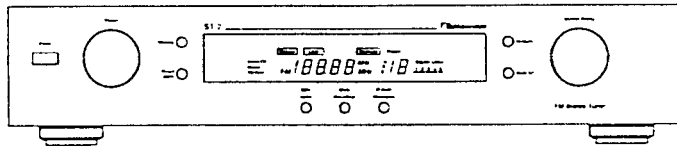

CONTENTS

| | |
|---|---|
| 1. General | 1 |
| 2. Mechanism Ass'y and Parts List | 3 |
| 2.1. Synthesis | 3 |
| 2.2. Front Panel Ass'y (A01) | 4 |

1. GENERAL

Reference Service Manual

The base Model of ST-2 is Tuner 2. In this Service Manual, identical sections/items are omitted. So, please refer to the Service Manual of Tuner 2 (0Q06155A).

1.1. Product Code

C108

1.2. Destinations

EP, UK, AUS, SAU, OTR, JPN

Abbreviation

| | |
|---------------------|--------------------|
| EP — Europe | SAU — Saudi Arabia |
| UK — United Kingdom | OTR — Other |
| AUS — Australia | JPN — Japan |

1.3. Cautions/Warnings

(1) Product Safety Notice

Parts marked with the symbol  in the schematic diagram have critical characteristics.

Use ONLY replacement parts recommended by the manufacturer. It is recommended that the unit be operated from a suitable DC supply or batteries during initial check-out procedures.

(2) Leakage Current Check/Resistance Check

Before returning the unit to the customer, make sure you make either (1) a leakage current check or (2) a line to chassis resistance check. If the leakage current exceeds 0.5 milliamp, or if the resistance from chassis to either side of the power cord is less than 240 k ohms, the unit is defective.

WARNING — DO NOT return the unit to the customer until the problem is located and corrected.

(3) Lithium Battery Caution

Use ONLY replacement parts recommended by the manufacturer. Replacement must be done only by qualified service personnel because of risk for explosion.

VARNING

Litiumbatteri. Explosionsfara vid felaktig hantering. Byte får endast ske av sakkunnig personal enligt servicedokumentationens anvisningar.

ADVARSEL!

Lithiumbatterier. Eksplosionsfare. Udskiftning må kun foretages af en sagkyndig og som beskrevet i servicemanualen.

batterieme kun må udskiftes med batterier af samme fabrikat og type.

1.4. Voltage Selector

Voltage Selector is installed on the Rear Panel of the ST-2 (SAU and OTR). The voltage selector can select either 110V-120V or 220V-240V at customer's disposal.

1.5. Package Ass'y

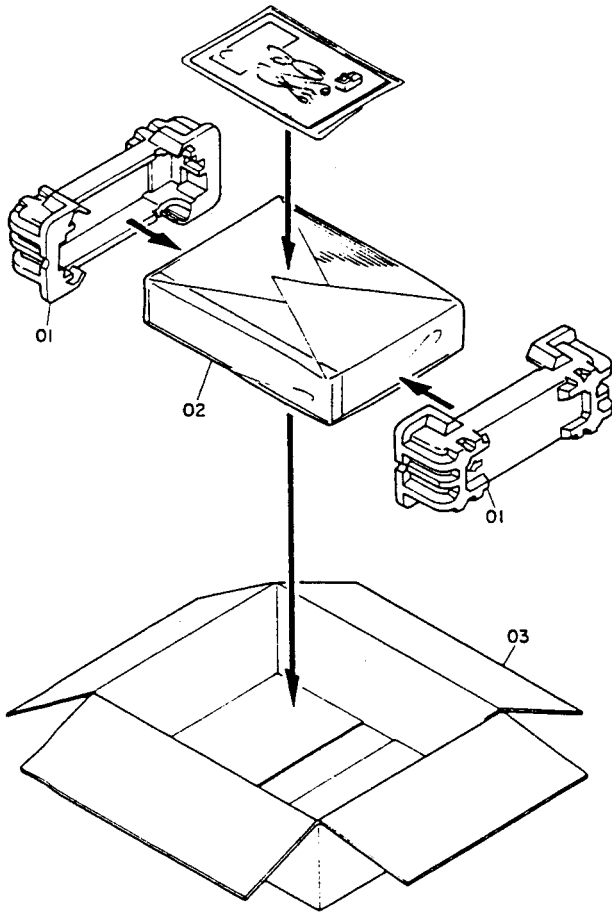

Fig. 1.1

| Schematic Ref. No. | Part No. | Description | Qty |
|--------------------|----------|----------------------|-----|
| — | — | Package Ass'y | |
| 01 | 0F04707B | Packing | 2 |
| 02 | 0F04458A | Soft Sheet | 1 |
| 03 | 0F04753A | Carton Box | 1 |

1.6. Accessory Ass'y

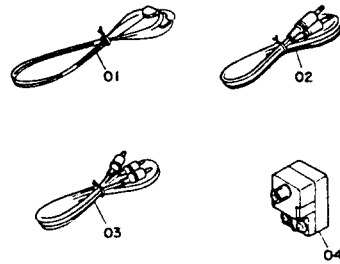

Fig. 1.2

| Schematic Ref. No. | Part No. | Description | Qty |
|--------------------|----------|---|-----|
| — | DA04738A | Accessory Ass'y (EP) | 1 |
| — | DA04735A | Accessory Ass'y (UK) | 1 |
| — | DA04740A | Accessory Ass'y (AUS, OTR) | 1 |
| — | DA04739A | Accessory Ass'y (SAU) | 1 |
| — | DA04736A | Accessory Ass'y (JPN) | 1 |
| 01 | 0B90081A | Feeder Antenna | 1 |
| 02 | 0D06136A | Mini Plug Cord | 1 |
| 03 | DA04521A | Pin Plug Cord | 1 |
| 04 | 0B90208A | Antenna Adapter EP FA-322 (EP, UK) | 1 |
| — | 0B90194A | Antenna Adapter F YAE21-0120 (AUS, SAU, OTR, JPN) | 1 |
| — | 0D06461A | Owner's Manual (English) | 1 |
| — | 0D06464A | Owner's Manual (French) | 1 |
| — | 0D06463A | Owner's Manual (German) | 1 |
| — | 0D06462A | Owner's Manual (Japanese) | 1 |

2. MECHANISM ASS'Y AND PARTS LIST

2.1. Synthesis

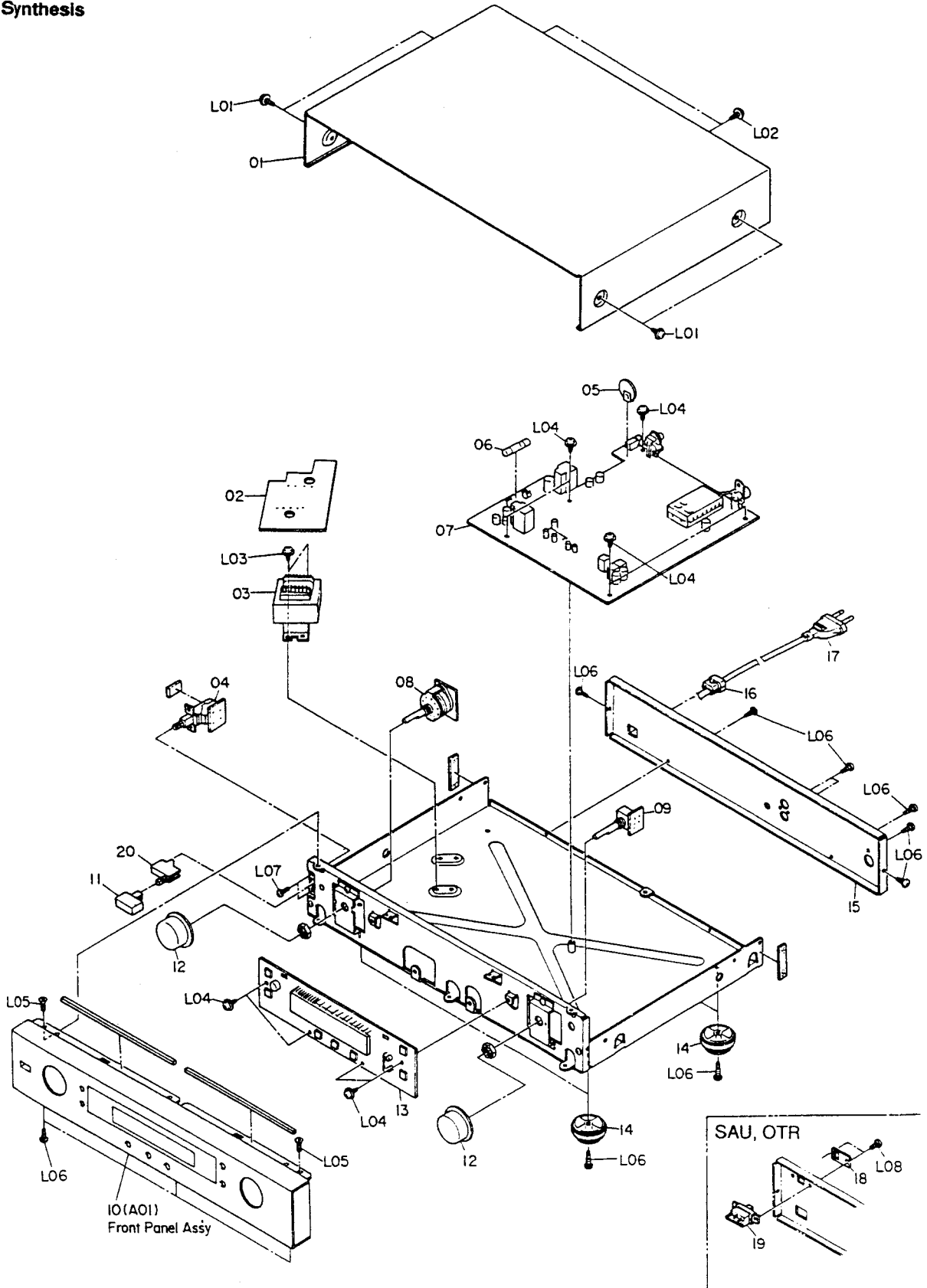

Fig. 2.1

2.2. Front Panel Ass'y (A01)

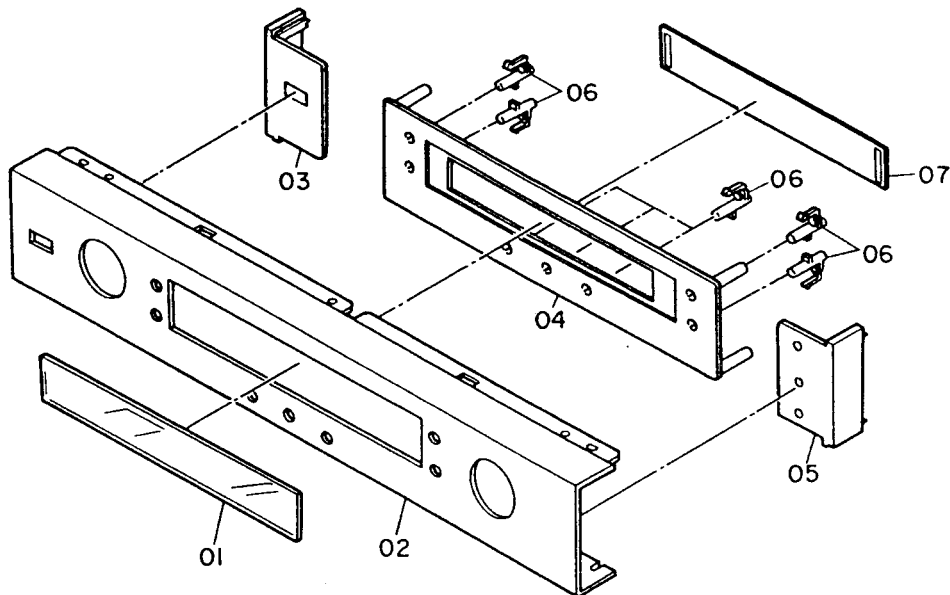

Fig. 2.2

2.1. Synthesis

| Schematic Ref. No. | Part No. | Description | Q'ty |
|--------------------|----------|---|------|
| Synthesis | | | |
| 01 | 0H06168A | Top Cover | 1 |
| 02 | BA08497A | Transformer P.C.B. Ass'y (EP, UK, AUS) | 1 |
| | BA08412A | Transformer P.C.B. Ass'y (SAU, OTR) | 1 |
| | BA08576A | Transformer P.C.B. Ass'y (JPN) | 1 |
| 03 | 0B50214A | Power Transformer 230V (EP, UK, AUS) | 1 |
| | 0B50217A | Power Transformer 120-230V (SAU, OTR) | 1 |
| | 0B50215A | Power Transformer 100V (JPN) | 1 |
| 04 | BA08413A | Power Switch P.C.B. Ass'y | 1 |
| 05 | 0B90200B | Lithium Battery [B601] | 1 |
| 06 | 0B08344A | Fuse T200mA 250V [F401] (EP, UK, AUS) | 1 |
| | 0B90599A | Fuse T250mA 250V [F401] (SAU, OTR, JPN) | 1 |
| 07 | BA08420A | Main P.C.B. Ass'y (EP, UK) | 1 |
| | BA08714A | Main P.C.B. Ass'y (AUS, SAU) | 1 |
| | BA08422A | Main P.C.B. Ass'y (OTR) | 1 |
| | BA08421A | Main P.C.B. Ass'y (JPN) | 1 |
| 08 | BA08414A | Rotary Switch P.C.B. Ass'y | 1 |
| 09 | BA08415A | Pulse Switch P.C.B. Ass'y | 1 |
| 10 | HA06672A | Front Panel Ass'y | 1 |
| 11 | 0H06418A | Power Knob | 1 |
| 12 | HA06673A | Tuning Knob Ass'y | 2 |
| 13 | BA08416A | Display P.C.B. Ass'y (EP, UK, AUS, SAU) | 1 |
| | BA08419A | Display P.C.B. Ass'y (OTR) | 1 |
| | BA08417A | Display P.C.B. Ass'y (JPN) | 1 |
| 14 | 0H06477A | Leg | 4 |
| 15 | 0H06653A | Rear Panel (EP, UK, AUS, JPN) | 1 |
| | 0H06655A | Rear Panel (SAU) | 1 |
| | 0H06654A | Rear Panel (OTR) | 1 |
| 16 | 0B90280A | Cord Bushing (EP, UK, AUS, SAU) | 1 |

| Schematic Ref. No. | Part No. | Description | Q'ty |
|--------------------|----------|--|------|
| 17 | 0B90283A | Cord Bushing (OTR, JPN) | 1 |
| | 0B08093U | AC Power Cord (EP) | 1 |
| | 0B08348A | AC Power Cord (UK) | 1 |
| | 0B05241A | Power Cord (AUS) | 1 |
| | 0B80336A | AC Power Cord KP-235 (SAU, OTR, JPN) | 1 |
| 18 | 0M05611A | Voltage Lock Plate (SAU) | 1 |
| | 0M05858A | Voltage Lock Plate (OTR) | 1 |
| 19 | 0B07092U | Voltage Selector Switch (SAU, OTR) | 1 |
| 20 | 0J07146A | Power Joint | 1 |
| L01 | 0E03032A | BT4x8 + Washer Faced (Black Chromate) | 1 |
| L02 | 0E03632A | BT3x8 + Binding With Washer (Black Chromate) | 1 |
| L03 | 0E03432A | BT3x6 + Tapping (Black Chromate) | 1 |
| L04 | 0E03157A | BT3x8 + Binding With Washer | 1 |
| L05 | 0E03054A | BT3x8 + Countersunk | 1 |
| L06 | 0E00921A | BT3x8 + Binding (Black Chromate) | 1 |
| L07 | 0E00612A | M3x6 + Pan (2A) | 1 |
| L08 | 0E00985A | M3x6 + Binding (SAU, OTR) | 1 |

2.2. Front Panel Ass'y (A01)

| Schematic Ref. No. | Part No. | Description | Q'ty |
|--------------------|-----------------|--------------------------|----------|
| A01 | HA06672A | Front Panel Ass'y | 1 |
| 01 | HA06674A | Display Window Ass'y | 1 |
| 02 | 0H06658A | Front Panel | 1 |
| 03 | 0H06659A | Side Escutcheon L | 1 |
| 04 | 0H06662A | Center Escutcheon | 1 |
| 05 | 0H06660A | Side Escutcheon R | 1 |
| 06 | 0H06447B | Push Knob | 7 |
| 07 | JA04804A | FL Filter Ass'y | 1 |

TUNER P.C.B.

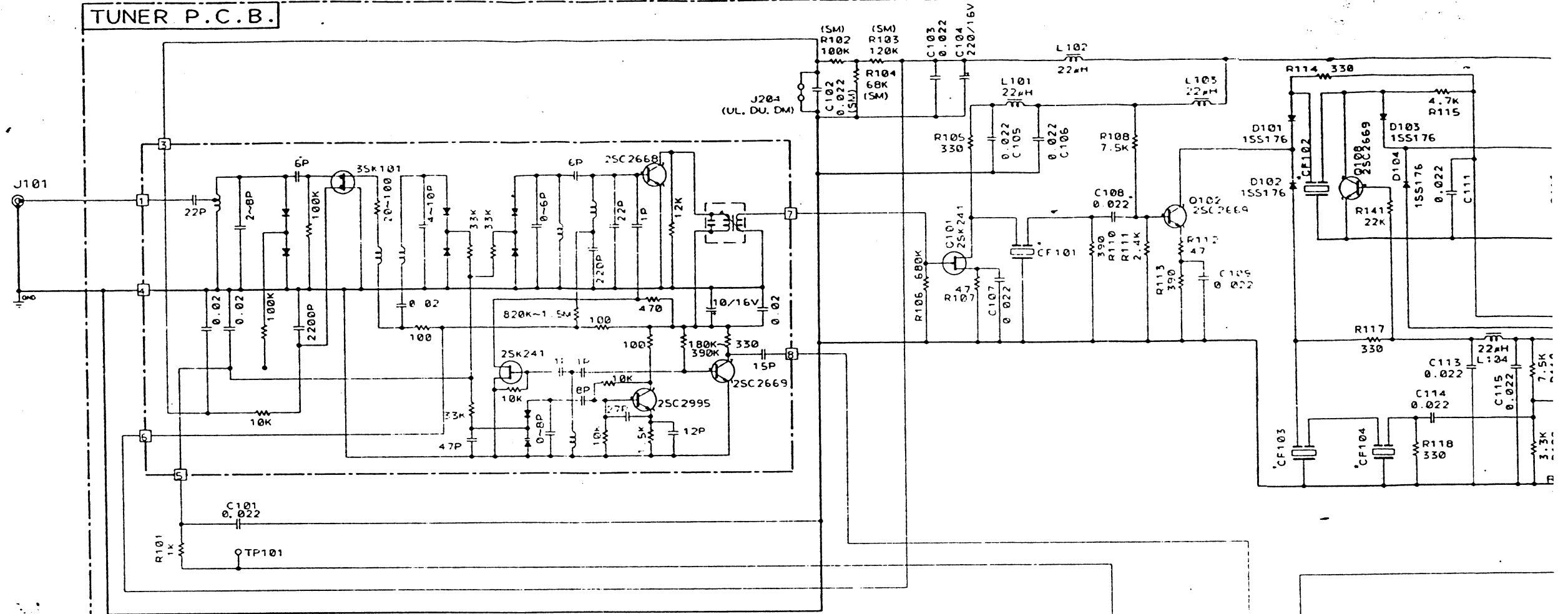

*注 向行先別部品選択

| | UL, DU, DM | SM |
|-------|-----------------|-----------------|
| CF101 | SFE10.7ML | SFE10.7MS3GH15A |
| CF102 | SFE10.7ML | SFE10.7MS3GH15A |
| CF103 | SFE10.7MS3GH15A | SFE10.7MJ10A |
| CF104 | SFE10.7MS3GH15A | SFE10.7MJ10A |
| CF105 | SFE10.7ML | SFE10.7MS3GH15A |

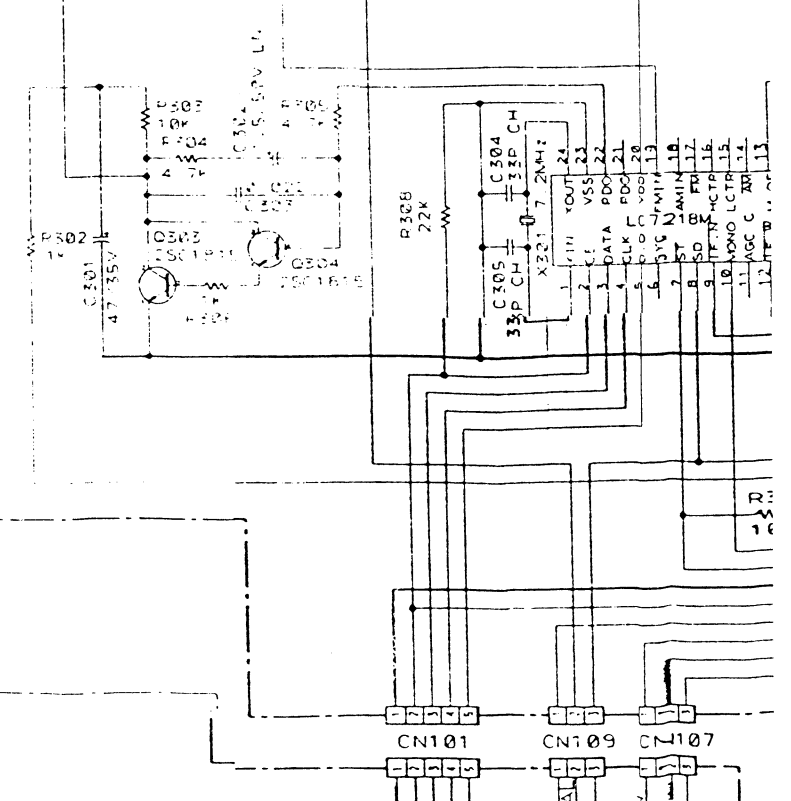

FL DISPLAY

CN101 CN109 CN107

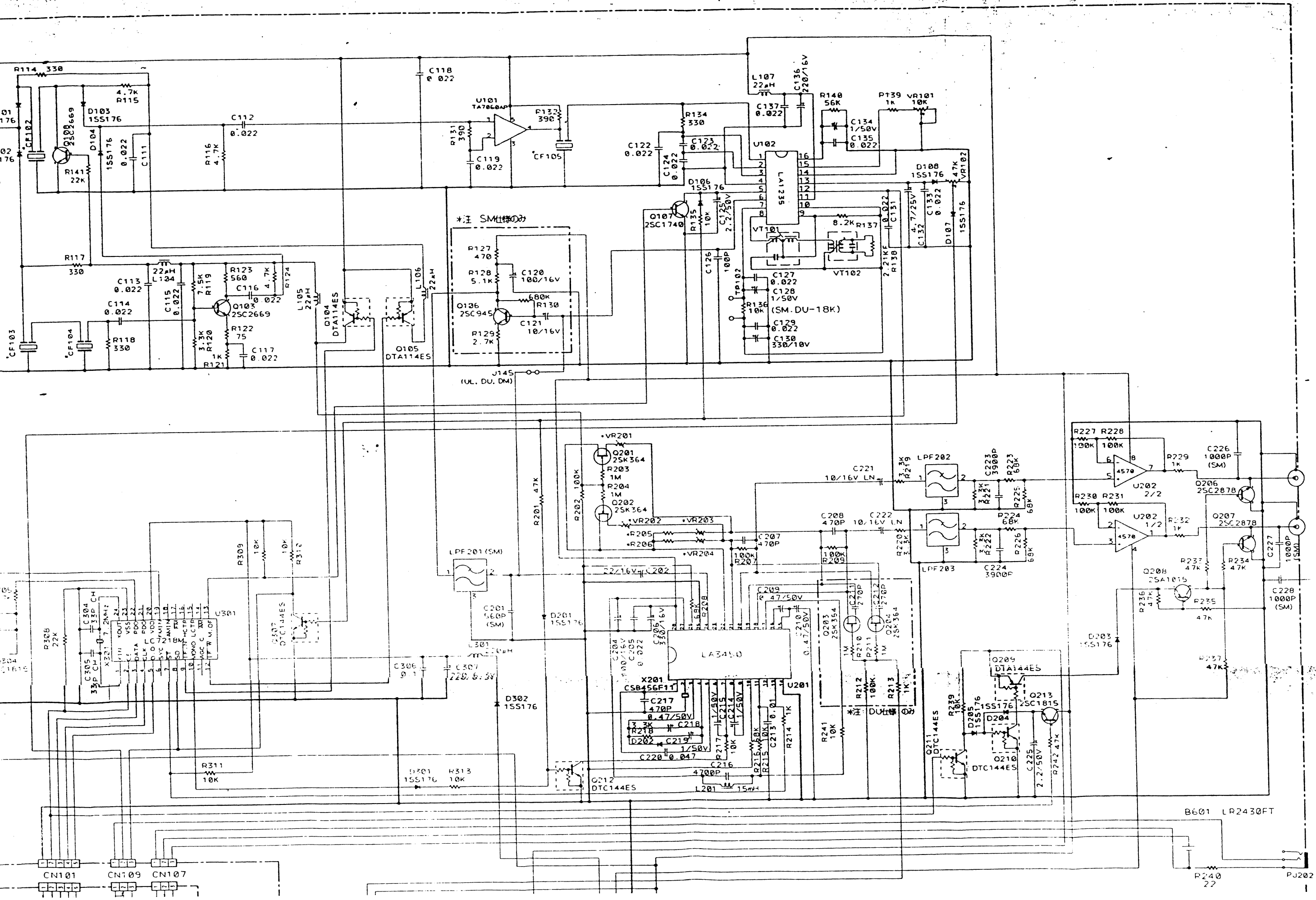

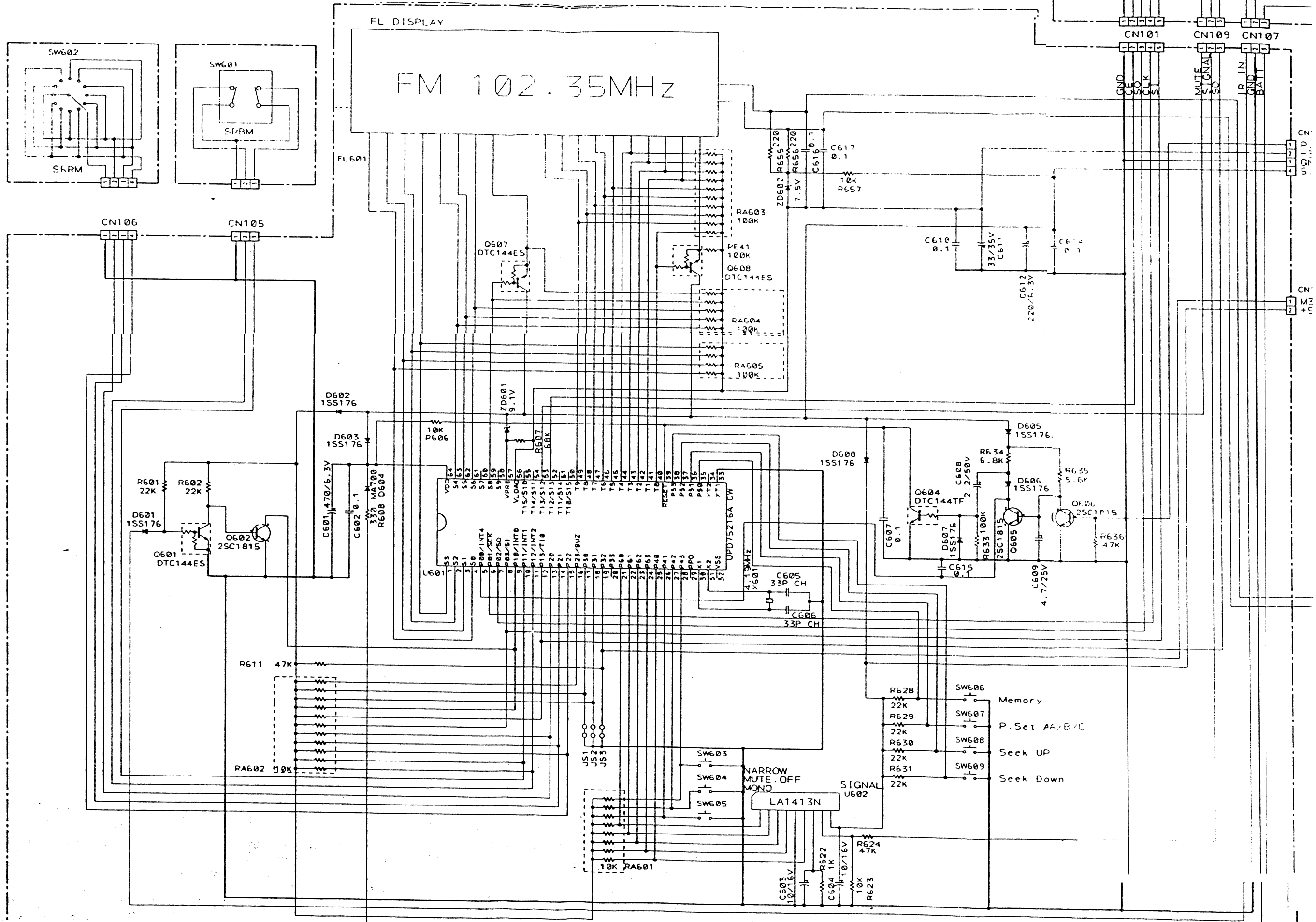

FL DISPLAY

FM 102.35MHz

- Memory
- P. Set AA/B/C
- Seek UP
- Seek Down

R3
W
101

CN
101
GND
10K
MUTE
ALIGN
VCC
IR IN
GND
BATT

CN
M2
4C

C603
10/16V

R622
10K

R623
10/16V

R624
47K

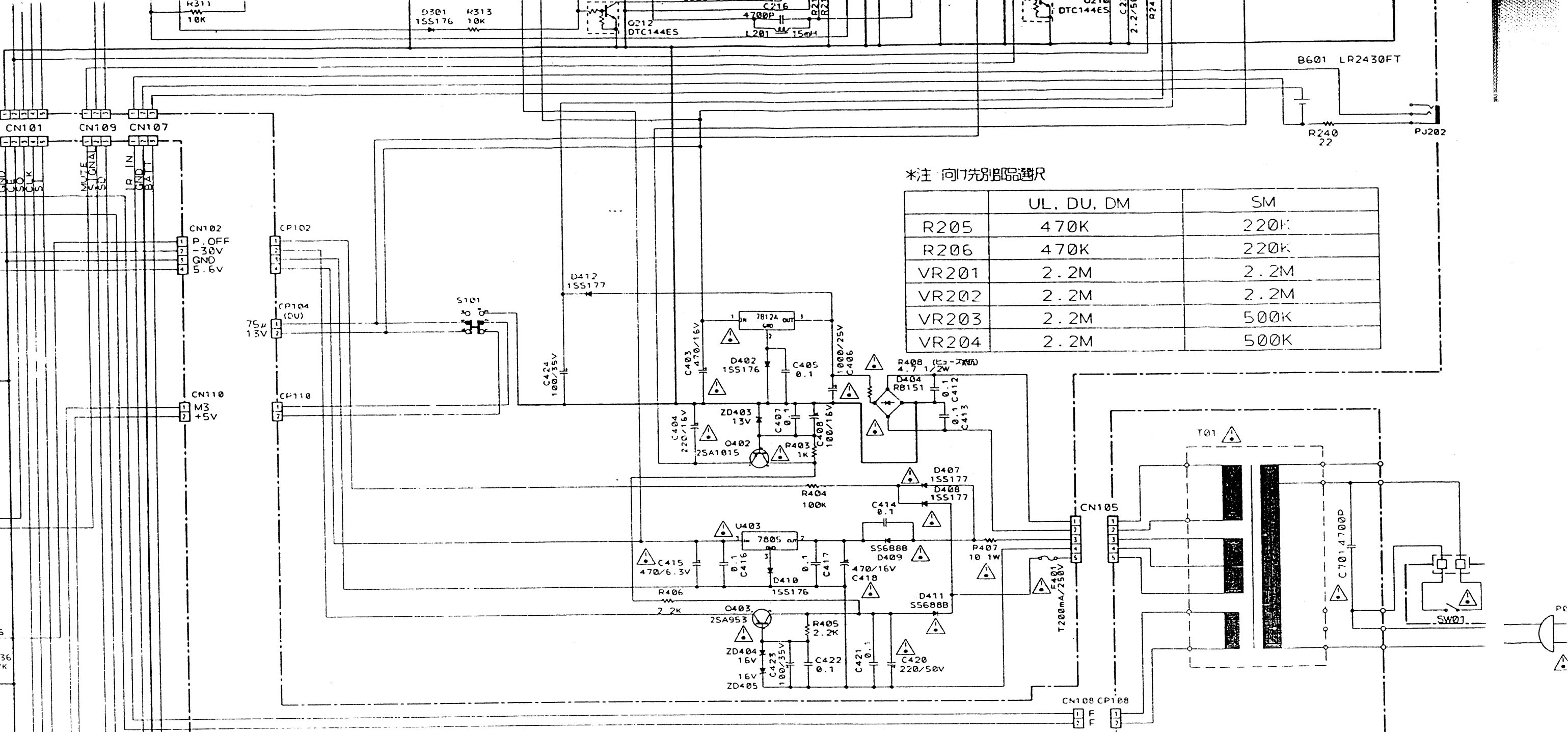

*注 向け先別部品選択

| | UL, DU, DM | SM |
|-------|------------|------|
| R205 | 470K | 220K |
| R206 | 470K | 220K |
| VR201 | 2.2M | 2.2M |
| VR202 | 2.2M | 2.2M |
| VR203 | 2.2M | 500K |
| VR204 | 2.2M | 500K |

* WARNING :

Parts marked with this symbol  have critical characteristics. Use ONLY replacement parts recommended by the manufacturer.

* CAUTION :

Before returning the unit to the customer, make sure you make either (1) a leakage current check or (2) a line to chassis resistance check. If the leakage current exceeds 0.5 milliamps, or if the resistance from chassis to either side of the power cord is less than 240 K Ohms, the unit is defective.

* WARNING :

DO NOT return the unit to the customer until the problem is located and corrected.

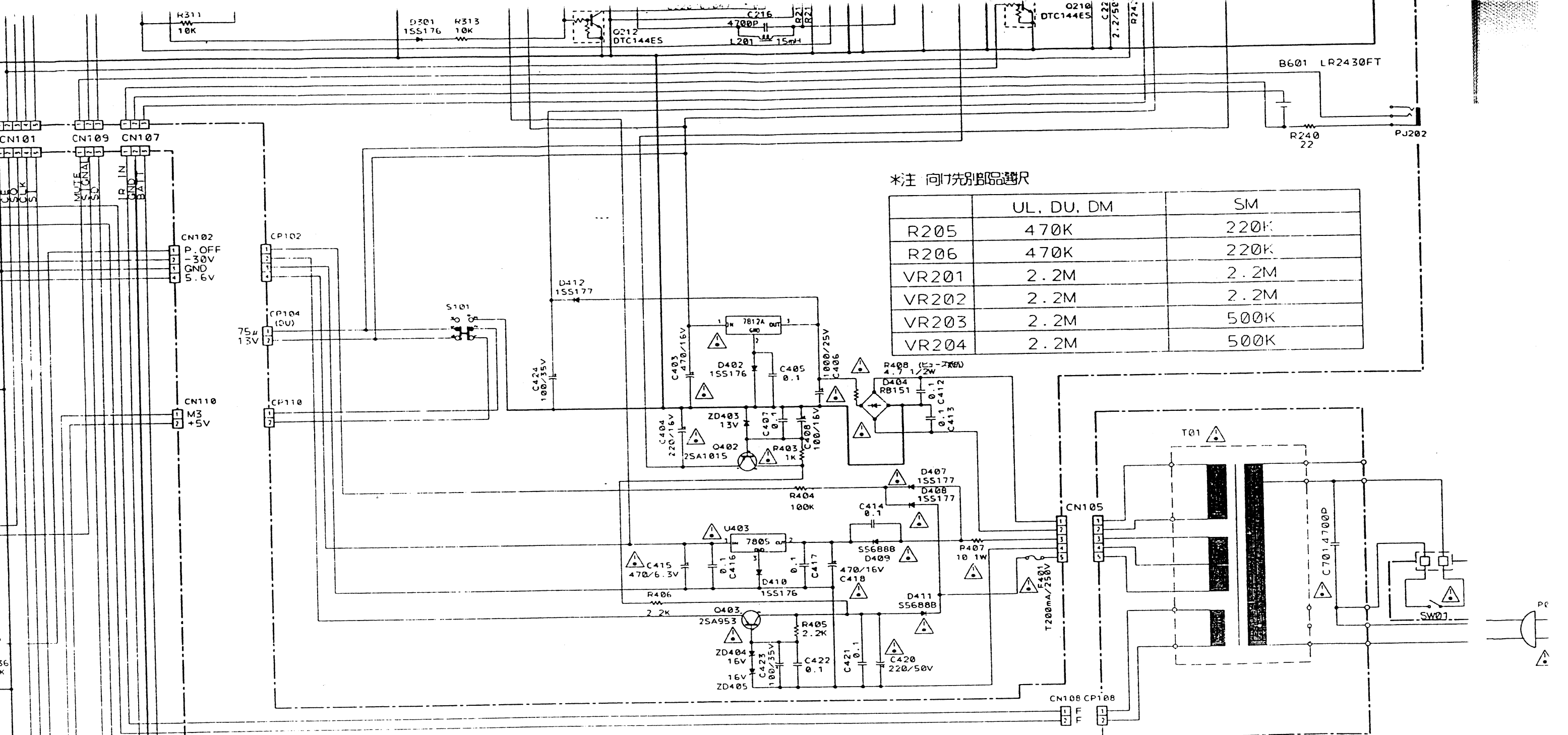

*注 向付先別部品選択

| | UL, DU, DM | SM |
|-------|------------|------|
| R205 | 470K | 220K |
| R206 | 470K | 220K |
| VR201 | 2.2M | 2.2M |
| VR202 | 2.2M | 2.2M |
| VR203 | 2.2M | 500K |
| VR204 | 2.2M | 500K |

* WARNING :

Parts marked with this symbol have critical characteristics. Use ONLY replacement parts recommended by the manufacturer.

* CAUTION :

Before returning the unit to the customer, make sure you make either (1) a leakage current check or (2) a line to chassis resistance check. If the leakage current exceeds 0.5 milliamps, or if the resistance from chassis to either side of the power cord is less than 240 K Ohms, the unit is defective.

* WARNING :

DO NOT return the unit to the customer until the problem is located and corrected.