

ONKYO SERVICE MANUAL

SOLID STATE STEREO PRE MAIN AMPLIFIER

model **A-7022**

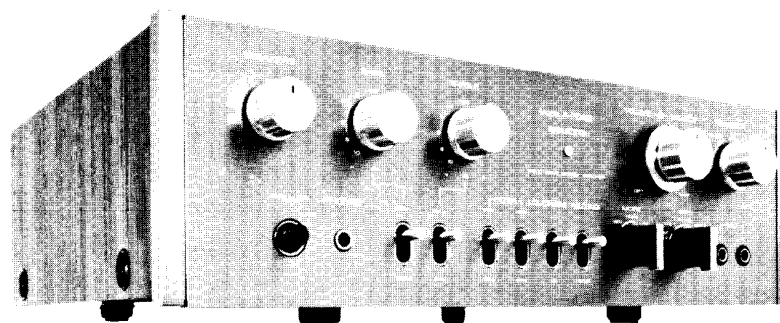

INDEX

Item	Page
Specifications	1
Component Locations	2
Adjustment of the Idling Current	3
Parts List	3 ~ 5
Packing Procedure	6
Circuit Board—Component Location	7 ~ 9
Circuit Diagram	10~11
Line Voltage and Fuse	12

ONKYO®
AUDIO COMPONENT

SPECIFICATIONS

Main Amplifier Section					MODE(REV, NORM, R+L, L, R)
Power Output Dynamic	200W (IHF 4 Ω) 150W (IHF 8 Ω)				VOLUME/BALANCE
Continuous	72W + 72W (4 Ω both channel driven) 65W / 65W (8 Ω each channel driven) 52W + 52W (8 Ω both channel driven)				TREBLE
Total Harmonic Distortion	0.1% at Rated Output 0.03% at 10W Output				BASS
Inter Modulation Distortion	0.05% at Rated Output				FREQUENCY SHIFT SWITCH
Power Bandwidth	10-100,000Hz(-3dB THD 0.2%)				BASS(400Hz, 125Hz) TREBLE(2kHz, 8kHz)
Signal to Noise Ratio	110dB(IHF A NETWORK)				MUTING
Damping Factor	80 at 8 Ω				LOUDNESS
Rated Input and Impedance	1V/100k Ω				FILTER HIGH LOW
Load Impedance	4-16 Ω				PHONO SENSITIVITY (1.2/2.4/4.8mV)
Pre Amplifier Section					PRE MAIN SEPARABLE SWITCH(UNITE-SEPARATE)
Input Sensitivity	PHONO-1/-2:1.2/2.4/4.8mV(50k Ω) TUNER, AUX, TAPE PLAY: 100mV(100k Ω)	Inputs			PHONO-1, PHONO-2, TUNER, AUX, MIC L/R TAPE PLAY-1, TAPE PLAY-2, MAIN IN
Total Harmonic Distortion	0.03% at Rated Output				SPEAKER-A, SPEAKER-B
Intermodulation Distortion	0.05% at Rated Output	Outputs			TAPE REC-1, TAPE REC-2 PRE OUT AC OUTLET UNSWITCHED, SWITCHED \times 2
RIAA Deviation	\pm 0.5dB (30-15,000Hz)				PHONES
Phono Overload	300mV RMS at 1kHz, 1.4V RMS at 10kHz				2 Phono inputs
Signal to Noise Ratio	PHONO-1/-2:75dB(IHF A NETWORK) TUNER/AUX:90dB(IHF A NETWORK)	Features			2 Tape Monitor and Printing 2dB Step Tone Controller 2 Choice of Turn over Frequency ASO type protection circuit Transient Killer circuit Main Amplifier incorporating OCL circuit MIC input Big Phono Overload
Output Voltage	1V				Power Supply Rating
Tone Control with 2dB/step Switch and Frequency Shift type					ac 110/120/220/240V 50/60Hz
Frequency Shift	BASS:400/125Hz TREBLE:2k/8kHz	Semiconductors			44 Transistors, 30 Diodes, 2 Thermistors
Bass Control	\pm 5 steps Boost and Cut				Dimensions
Treble Control	\pm 5 steps Boost and Cut				16 5/8" W x 53/8" H x 14 3/4" D 423mm W x 136mm H x 373mm D
Filter HIGH	8kHz(6dB/oct.)	Weight			10.5kgr, 23lbs
LOW	30Hz(6dB/oct.)				
Muting	-20dB				
Loudness	+5dB at 70Hz, +5dB at 10kHz				
Controls	POWER SPEAKERS(OFF, A, B, A+B) SELECTOR(AUX, TUNER, PHONO 1, PHONO 2, MIC) TAPE MONITOR(PRINT 1-2, TAPE-1, SOURCE, TAPE-2, PRINT 2-1)				

1. COMPONENT LOCATIONS

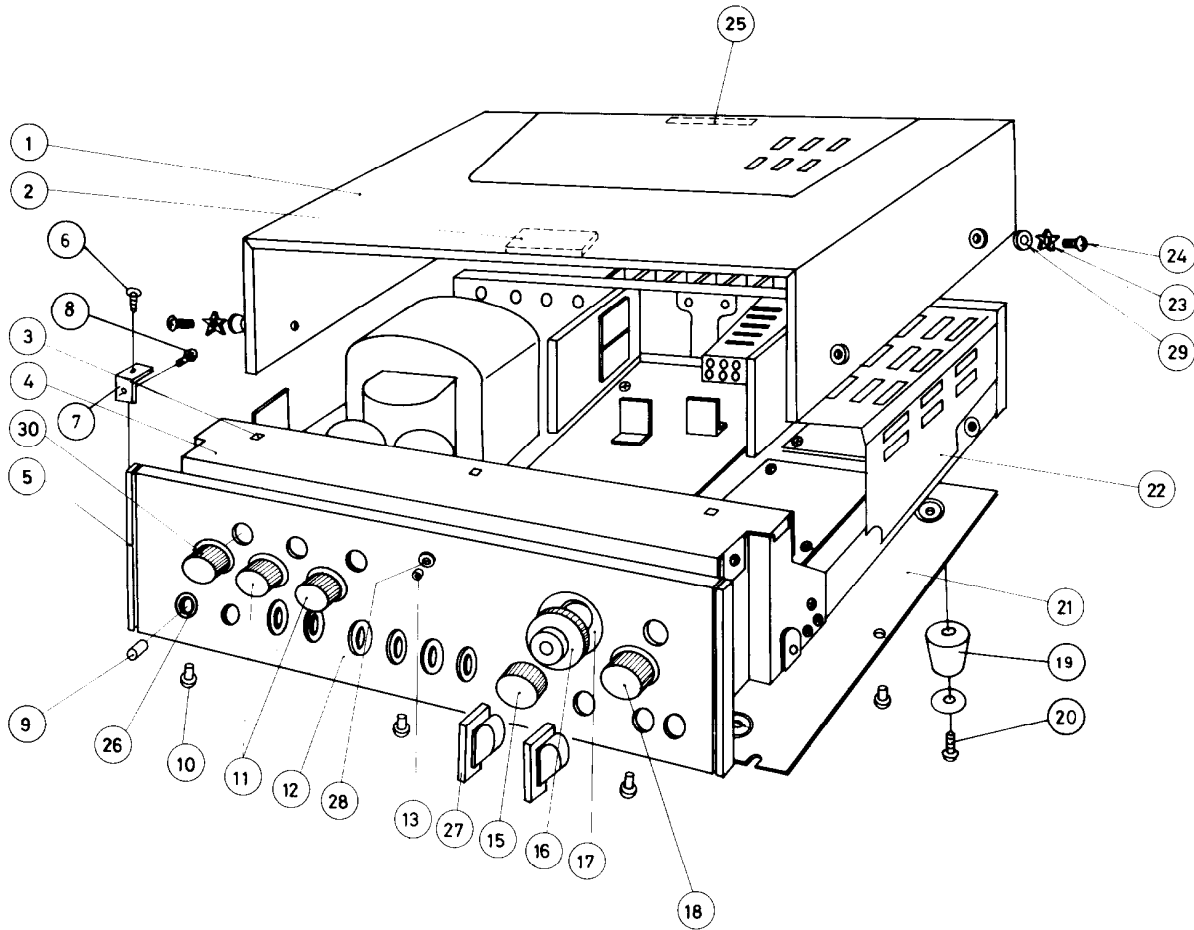

KEY NO.	DESCRIPTION	KEY NO.	DESCRIPTION
1	Amp Box assembly	17	Knob Sheet
2	Soft Block	18	Knob-Selector
3	Front Fiber Board	19	Rubber Cushion
4	Front Cover	20	Tapping Screw(4+12)
5	End Cap	21	Bottom Cover
6	Flat Screw(3S+5F)	22	Chassis
7	Joiner	23	Toothed Lock Washer
8	Pan head Screw(3P+8F)	24	Truss Screw(4+20)
9	Knob-Push Switch	25	Soft Block
10	Binder Screw(3+6)	26	Knob Guide
11	Knob-Tone	27	Knob-Tape
12	Front Panel	28	Facet Ring
13	Facet	29	Concave Washer
15	Knob-Volume	30	Knob-Speaker
16	Knob-Balance		

2. ADJUSTMENT OF THE IDLING CURRENT

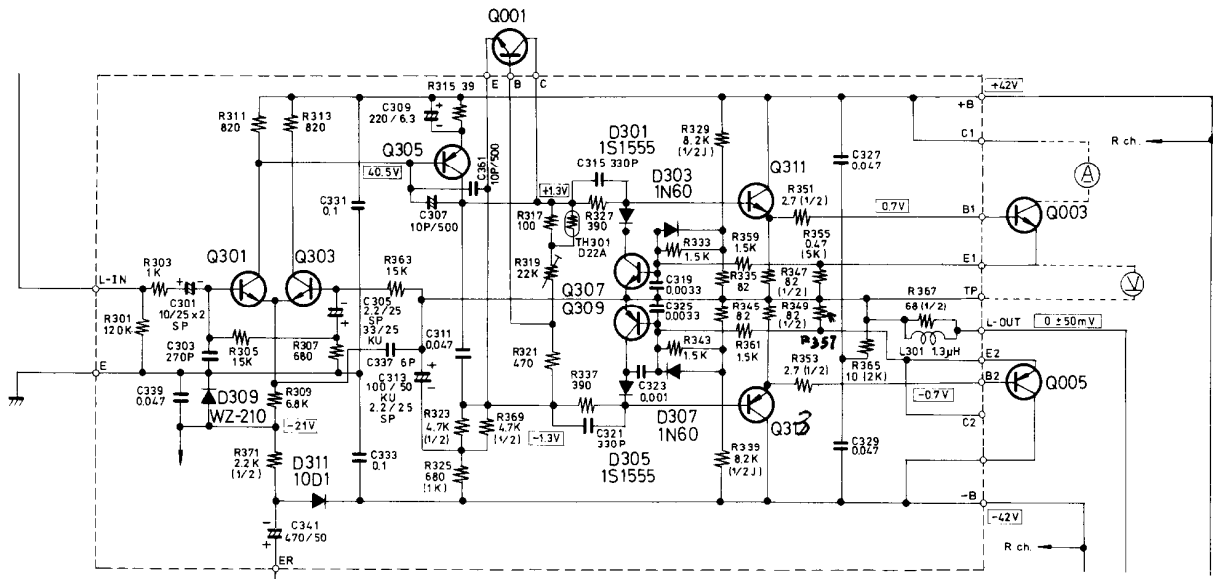

Instrument required : DC Ammeter 50mA or 100mA.

DC Voltmeter 50mV or VTVM.

When replacing the POWER transistor (Q003, Q004, Q005, Q006) or the DRIVER transistor (Q311, Q312, Q313, Q314), check the idling current of the POWER transistor.

To adjust to normal value (40 ± 5)mA, proceed as follows.

(Lch) (1) Cut the connection between +B and collector of Q003 on MAIN Amp assembly, and connect a DC Ammeter.

(2) Adjust the current to (40 ± 5)mA, with R319(2.2k Ω) after switching on for 10 minutes.

(3) After adjusting, connect original wiring.

If a DC Voltmeter (50mV) or VTVM is available, connect the Voltmeter between E1 and TP terminals.

Adjust the voltage to (20 ± 2.5)mV with R319(2.2k Ω).

(Rch) Using R320(2.2k Ω), adjust in the same manner as indicated above.

* Note: Volume—Minimum. Open Load.

3. PARTS LIST

PARTS NO.	DESCRIPTION	SPECIFICATION	Q'TY	STOCK NO.
U001	Equalizer Amp ass'y	NAEQ-206	1	12939506
U002	Tone Amp ass'y	NATC-186b	1	12939586B
U003	Main Amp ass'y	NAMA-187a	1	12939587A
U004	Power Supply ass'y	NAFI-207	1	12939507
U005	Protector ass'y	NAPC-208	1	12939508
Q001	Transistor	2SC945(P)	2	2210353
Q002	"	"	"	"
Q003	"	2SD218(M)	2	2200042
Q004	"	"	"	"
Q005	"	2SA649(M)	2	2200142
Q006	"	2SB541A	"	"

PARTS NO.	DESCRIPTION	SPECIFICATION	Q'TY	STOCK NO.	
PL001	Pilot Lamp	6.3VO.15A	1	210003	
T001	Transformer-Power	NPT-552ADGQ	1	230056	
C007 C009	Capacitor-Electrolytic	CE62W50V8200 μ F	2	3504035A	
		CE04W50V33 μ F	2	325783301A	
C305, 306	Capacitor-SP	SP04C25V2.2 μ F	4	392250229	
C033 C044	"	SP04C25V10 μ F	2		Volume Balance
R015	Variable Resistor	N24RDG500KMN250KB2T	1	5104006	
S001	Switch-Rotary	NRS-385-20Y	1	250165-1	Selector
S003	"	NRS-465-15Y	1	350175-2	Tape Monitor
S004	"	NRS-125-15Y	1	250180-1	Mode
S008, S009	"	NRS-2211-20Yb	2	250117	Tone
S013	"	NRS-124-20Y	1	250118-1	Speakers
S002	Switch-Slide	NSS-2323	1	250121	Phono Sens
S012	"	NSS-4224	1	250122	Pre-Main
S005, 010 011, 017	Switch-Lever	NLS-122-29SL	4	250119-1	Muting Filter Loudness
S006, 007	"	NLS-142-29SL	2	250120-1	Frequency Shift
S014	Switch-Power	NPS111LA2	1	250157	
S015	Klixon	9700L-26-11	1	252009	
S016	"	9700L-21-11	1	252011	
	Jack-Stereo Head Phone	3P64M	1	250126	
	Jack-Microphone	HJ-631S-H-3	2	250176-1	
F001	Fuse	1.5A-T	1	252015	
F002	"	2A-T	1	252002	
	Amp Box ass'y		1	280762	
	Front Panel		1	280759	
	End Cap		2	280367	
	Facet		1	280556	
	Joiner		4	280376	
	Knob-Tone		2	283085	
	Knob-Selector		1	283086	
	Knob-Volume		1	283087	
	Knob-Balance		1	283088	
	Knob-Speaker		1	283096	
	Knob-Tape ass'y		2	283103	
	Knob-Power		1	283071	
	Bottom Cover		1	270295	
	Rubber Cushion		4	280379	
	Master Carton Box		1	290378	
	Side Pad		2	290203-1	
NATC-186b					
Q201 ~ Q204	Transistor	2SA493(GR)	4	2210235	
Q205, Q206	"	2SC1000(0-1)	2	2210280	
Q207, Q208	"	2SC733(GR)	2	2210085	
Q209	"	2SC734(0-1)	1	2210060	
D201, D203	Silicon Diode	1S1554	2	223106	
C201, C202	Capacitor-Electrolytic	CE04W25VO.47 μ F	2	352754791A	
C205, C206	"	CE04W6.3V100 μ F	2	352721011A	
C203, C204	"	CE04W35V220 μ F	1	352762211A	
C229 ~ C232	Capacitor-SP	SP04C25V2.2 μ F(M)	4	3500023	

PARTS NO.	DESCRIPTION	SPECIFICATION	Q'TY	STOCK NO.	
C233 ~ C234	Capacitor-SNP	SNP04C25V22 μ F (M)	2	3500027	
	"	" 2.2 μ F (M)	2	3500025	
NAMA-187a					
Q301 ~ Q304	Transistor	2SC1000(0-1)	4	2210280	
Q305, Q306 Q313, Q314	"	2SA706(52)	4	2200032	
Q307, Q308	"	2SC735(GR)	2	2210245	
Q309, Q310	"	2SA562(GR)	2	2210255	
Q311, Q312	"	2SC1124(2)	2	2200016	
D301, D302 D305, D306	Silicon Diode	1S1555	4	223105	
D311	"	10D1	1	223801	
D303, D304 D307, D308	Germanium Diode	1N60(N)FM	4	2231031	
D309	Zener Diode	WZ-210	1	223921	
L301, L302	Coil-Load Compensation	S-1.3B	2	231001	
C309, C310	Capacitor-Electrolytic	CE04W 6.3V220 μ F	2	352722211A	
C341	"	" 50V470 μ F	1	352784711A	
R319, R320	Resistor-Semi Fixed	R-HK2.2KB	2	5225005	
TH301, TH302	Thermistor	D-22A	2	4000003	
NAEQ-206					
Q101, Q102	Transistor	2SA493(GR)	2	2210235	
Q103, Q104	"	2SC1000(0-1)	2	2210280	
Q105, Q106	"	2SC1124(3)	2	2200101	
D101, D102	Silicon Diode	1S1555	2	223105	
	Capacitor-Electrolytic	CE04W16V47 μ F	2	352744701A	
	"	" 6.3V220 μ F	2	352722211A	
	"	" 25V100 μ F	3	352751011A	
C101, C102	Capacitor-SP	SP04C25V2.2 μ F	2	3500023	
C125, C126	"	" 10 μ F	2	3500024	
NAFI-207					
Q401, Q407	Transistor	2SD234(O)	2	2200113	
Q403	"	2SA561(O)	1	2210073	
Q405	"	2SC945(P)	1	2210353	
D403	Silicon Diode	10DC2R	1	223813	
D405	"	10D1	1	223801	
D401	Zener Diode	WZ-270	1	223922	
NAPC-208					
Q501	Transistor	2SC945(P)	1	2210353	
Q503	"	2SC945(Q)	1	2210354	
Q505	"	2SD235	1	2200013	
Q507, Q509	"	2SC634A(70)	2	2210187	
D509, D511 D515, D517	Silicon Diode	10D1	4	223801	
D519, D521 D523, D525	"	SR3AM-6B	4	223815	
D501, D503 D505, D507	Germanium Diode	1N60(N)FM	4	2231031	
D513	Zener Diode	BZ-120	1	223918	
C501	Capacitor-Electrolytic	CE04W25V1 μ F	1	352750101A	
C503	"	" 16V100 μ F	1	352741011A	
C505	"	" 1000 μ F	1	352741021A	
C513, C515	"	CE04W 50V 47 μ F	2	352784701A	
C521, C523	"	" 25V220 μ F	2	352752211A	
S501	Relay	NRSP5A-DC12	1	250166	

4. PACKING PROCEDURE

1. Tighten SPEAKER terminals by a hand.
2. Clean an AMP BOX assembly, attending to your fingerprints.
3. Set a SENSITIVITY SWITCH to center(2.4mV).
4. Clean a REAR PANEL and a RADIATOR.
5. Insert SHORTED PIN into PHONO-1,2 terminals.
6. Wrap a POWER CORD with a AC CORD WRAPPER and bind it with a rubber band.
7. Wrap unit with a AMP COVER and attach a SIDE PAD to both sides.
8. Put in a CARTON BOX and make sure the front marks of the carton matches the unit front.
9. Put an ACCESSORY BAG including an INSTRUCTION BOOKLET, WARRANTY CARD etc. in the box.
10. Close the CARTON BOX and seal.

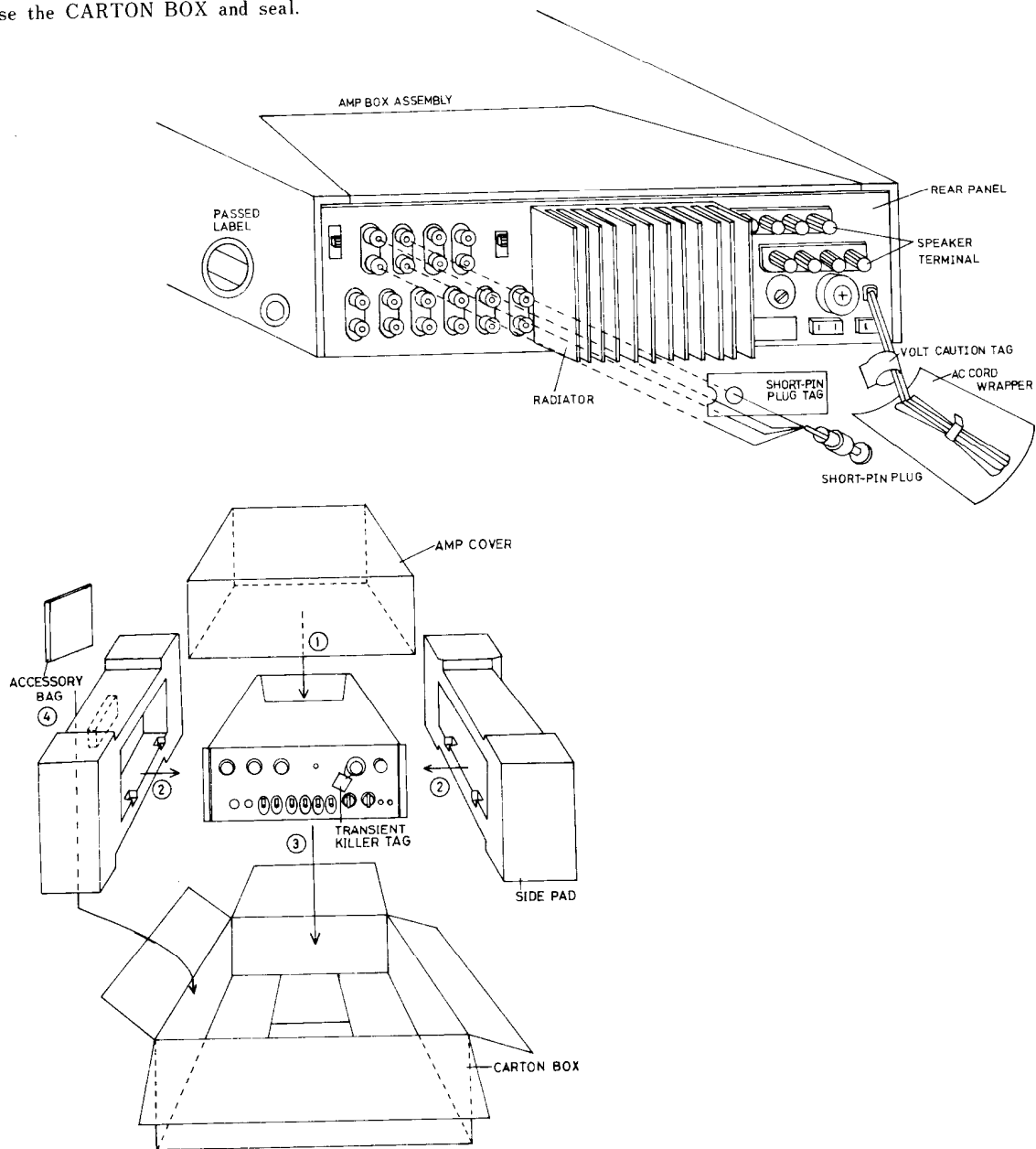

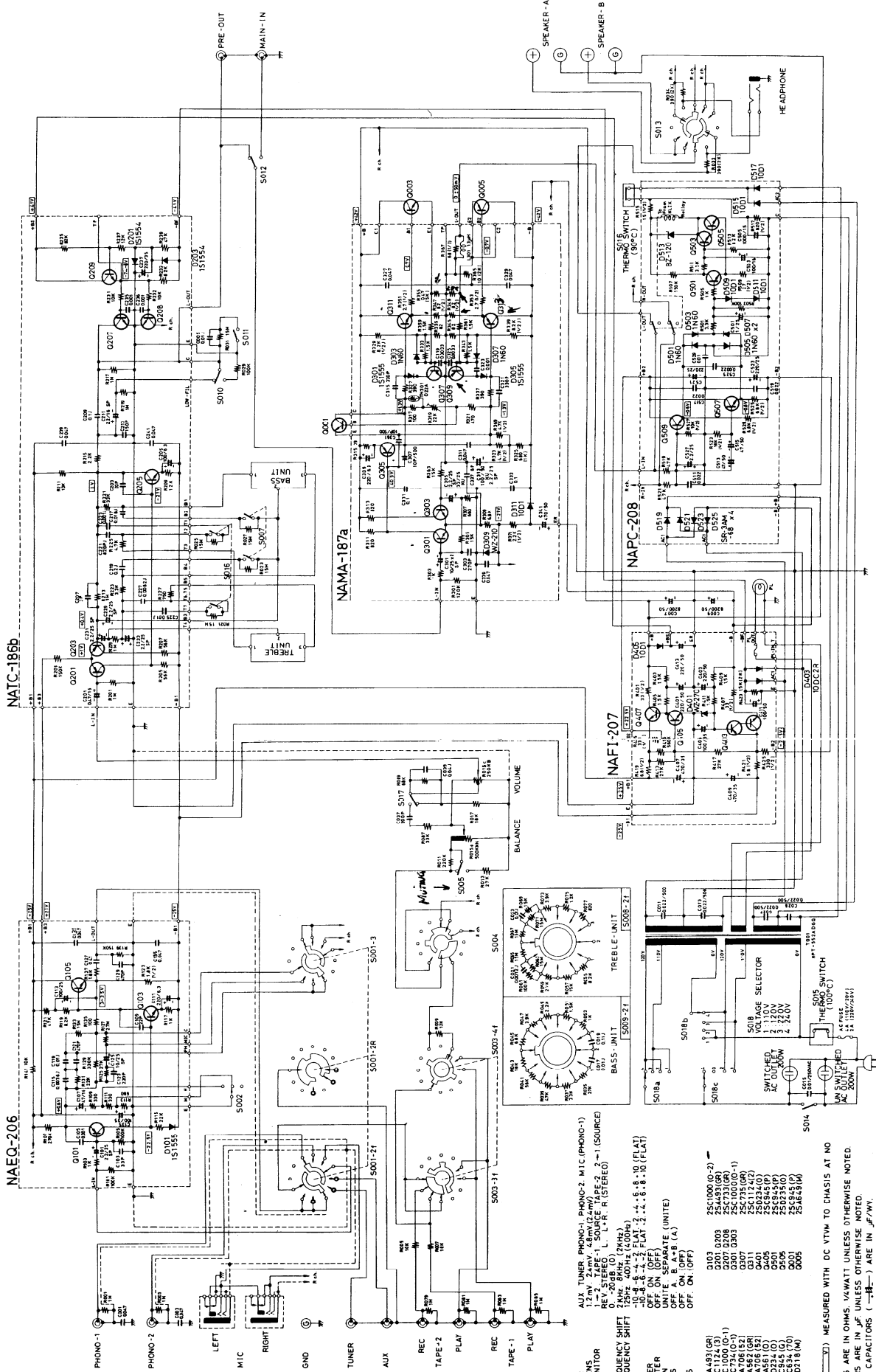

- 501 6X4 (GR) 251090 (0-2)
 502 PHONO-1 251493 (GR)
 503 PHONO-2 251493 (GR)
 504 TAPE MONITOR 251731 (GR)
 505 TAPE-1 SOURCE TAPE-2 2-1 (SOURCED) 251731 (GR)
 506 TAPE-2 SOURCE TAPE-2 2-1 (SOURCED) 251731 (GR)
 507 MOTTING 251731 (GR)
 508 6BE6 251731 (GR)
 509 HIGH FREQUENCY SHIFT 24Hz 8MHz 2KHz 2 251731 (GR)
 510 TREBLE FILTER 2.4, 4, 6, 8, 10 (FLAT) 251731 (GR)
 511 BASS FILTER 2.4, 4, 6, 8, 10 (FLAT) 251731 (GR)
 512 PRE-MAIN 251731 (GR)
 513 HIGH FILTER 251731 (GR)
 514 POWER 251731 (GR)
 515 LOUDNESS 251731 (GR)
- 0101 251493 (GR)
 0105 251493 (GR)
 0201 0208 251493 (GR)
 0207 0208 251731 (GR)
 0301 0303 251731 (GR)
 0311 251731 (GR)
 0401 251731 (GR)
 0403 251731 (GR)
 0407 251731 (GR)
 0501 251731 (GR)
 0505 251731 (GR)
 0507 0509 251731 (GR)
- 5018a 100V 100mA
 5018b 100V 100mA
 5018c 100V 100mA
 5018d 100V 100mA
 5018e 100V 100mA
 5018f 100V 100mA
 5018g 100V 100mA
 5018h 100V 100mA
 5018i 100V 100mA
 5018j 100V 100mA
 5018k 100V 100mA
 5018l 100V 100mA
 5018m 100V 100mA
 5018n 100V 100mA
 5018o 100V 100mA
 5018p 100V 100mA
 5018q 100V 100mA
 5018r 100V 100mA
 5018s 100V 100mA
 5018t 100V 100mA
 5018u 100V 100mA
 5018v 100V 100mA
 5018w 100V 100mA
 5018x 100V 100mA
 5018y 100V 100mA
 5018z 100V 100mA
- 5019 100V 100mA
 5020 100V 100mA
 5021 100V 100mA
 5022 100V 100mA
 5023 100V 100mA
 5024 100V 100mA
 5025 100V 100mA
 5026 100V 100mA
 5027 100V 100mA
 5028 100V 100mA
 5029 100V 100mA
 5030 100V 100mA
 5031 100V 100mA
 5032 100V 100mA
 5033 100V 100mA
 5034 100V 100mA
 5035 100V 100mA
 5036 100V 100mA
 5037 100V 100mA
 5038 100V 100mA
 5039 100V 100mA
 5040 100V 100mA
 5041 100V 100mA
 5042 100V 100mA
 5043 100V 100mA
 5044 100V 100mA
 5045 100V 100mA
 5046 100V 100mA
 5047 100V 100mA
 5048 100V 100mA
 5049 100V 100mA
 5050 100V 100mA
 5051 100V 100mA
 5052 100V 100mA
 5053 100V 100mA
 5054 100V 100mA
 5055 100V 100mA
 5056 100V 100mA
 5057 100V 100mA
 5058 100V 100mA
 5059 100V 100mA
 5060 100V 100mA
 5061 100V 100mA
 5062 100V 100mA
 5063 100V 100mA
 5064 100V 100mA
 5065 100V 100mA
 5066 100V 100mA
 5067 100V 100mA
 5068 100V 100mA
 5069 100V 100mA
 5070 100V 100mA
 5071 100V 100mA
 5072 100V 100mA
 5073 100V 100mA
 5074 100V 100mA
 5075 100V 100mA
 5076 100V 100mA
 5077 100V 100mA
 5078 100V 100mA
 5079 100V 100mA
 5080 100V 100mA
 5081 100V 100mA
 5082 100V 100mA
 5083 100V 100mA
 5084 100V 100mA
 5085 100V 100mA
 5086 100V 100mA
 5087 100V 100mA
 5088 100V 100mA
 5089 100V 100mA
 5090 100V 100mA
 5091 100V 100mA
 5092 100V 100mA
 5093 100V 100mA
 5094 100V 100mA
 5095 100V 100mA
 5096 100V 100mA
 5097 100V 100mA
 5098 100V 100mA
 5099 100V 100mA
 5100 100V 100mA

* DC VOLTAGE MEASURED WITH DC VTVM TO CHASSIS AT NO SIGNAL INPUT.
 * ALL RESISTORS ARE IN OHMS, UNLESS OTHERWISE NOTED.
 * ALL CAPACITORS ARE IN μ F, UNLESS OTHERWISE NOTED.
 * ELECTROLYTIC CAPACITORS (—E—) ARE IN μ F/WV.

