

ADJUSTMENT PROCEDURE

Instrument required

Oscilloscope, Test disc (SONY YEDS-18), Jitter meter and AC voltmeter.

1. Slide Balance Adjustment

1. Connect the audio oscillator between the P155 sensor output and GND as shown bellow. (Ch.1)
2. Turn on the switch of set. (Wait for a moment still focus serch finished.)
3. Adjust the semi-fixed resistor R174 (pushing the S101) so that the waveform on the oscilloscope becomes 0V.
(After checking the pickup go back to innermost positon.)

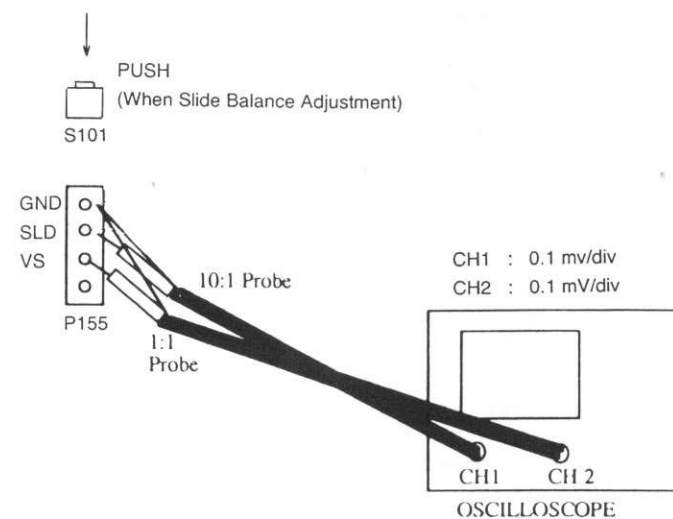

2. Slide Offset Adjustment

1. Connect the audio oscillator between P155 SLD output and GND.
2. Turn on the switch of set. (Wait for a moment still focus serch finished.)
3. Adjust the semi-fixed resistor R175 so that the waveform on the oscilloscope becomes 0V.
(Check the GND positon of audio oscillator.)

3. confirmation of Jitter

1. Connect the jitter meter to P155, and confirm the jitter value is less than 14nSec.

4. Auto Adjustment

1. If you push the [UP] button and [DISPLAY] button together when the power switch turns ON,
2. Insert the disc and closed by [OPEN/CLOSE] button, the disc will read in and autoadjustmen will start. you can enter to the Test mode.
When the autoadjustmen finished, disc's information will displayed.
At times error message (Er Fg, Er Fe) will displayed, but it is not bud condition.
Push the [OPEN/CLOSE] button and [DIGITAL OUT] button together When the power ON no disc condition, you will cancel the test mode.

BLOCK DIAGRAM

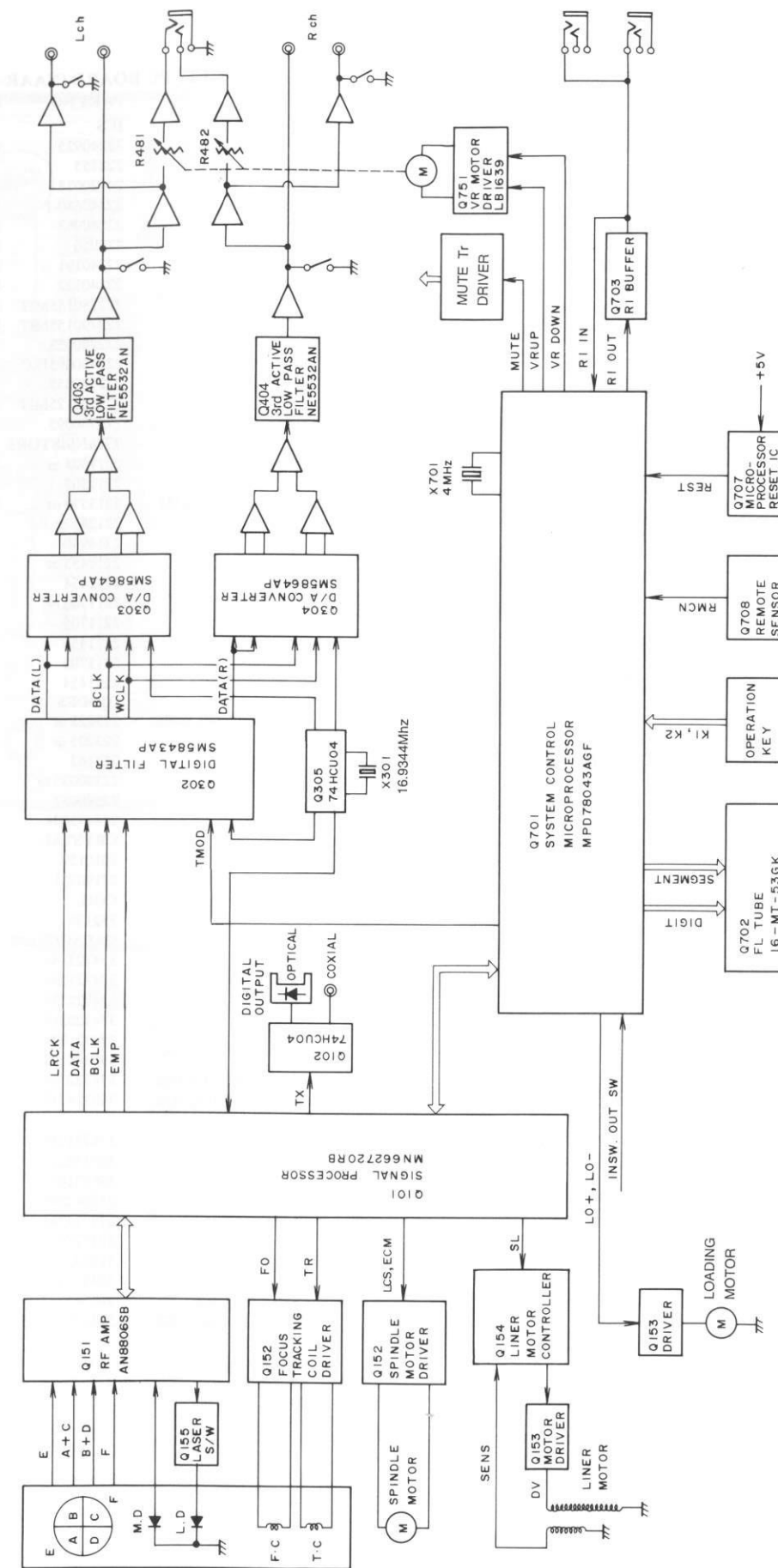

MECHANISM-EXPLODED VIEW

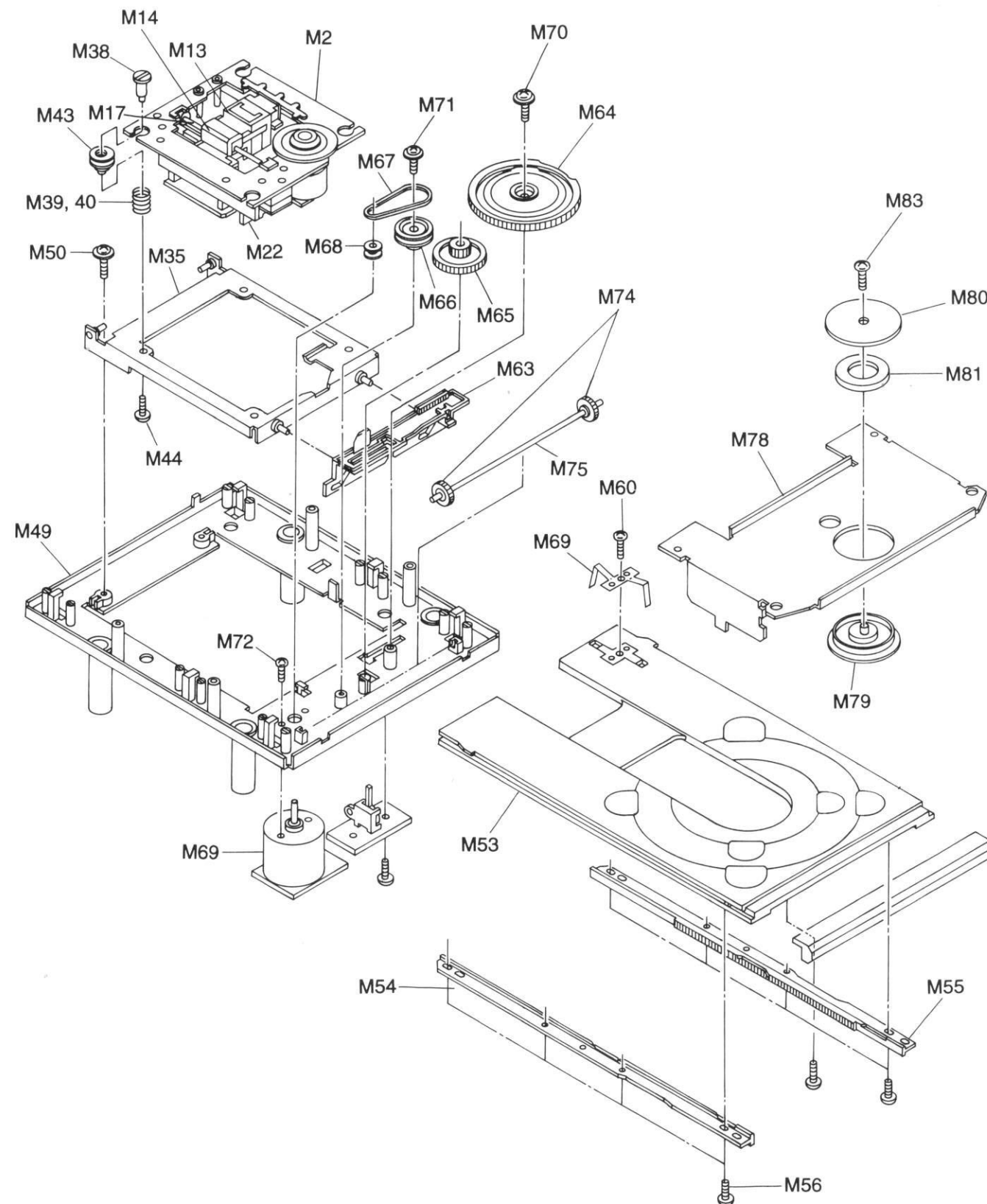

MECHANISM-PARTS LIST

| REF NO. | PART NO. | DESCRIPTION |
|---------|--------------|------------------------|
| M2 | 24802023 | CHASSIS (PU)AS |
| M13 | 24804019 | PICK UP |
| M14 | 24840100 | BLOCK (RET) |
| M17 | 24828013 | SHAFT (PU) |
| M18 | 27270322 | SPACER |
| M19 | 27270323 | SPACER |
| M21 | 24804020 | LINEAR MOTOR |
| M35 | 24802020 | CHASSIS (SUB)AS |
| M38 | 24826007A-1 | HOLDER (FLT) |
| M39 | 27180462 | SPRING (FRG) |
| M40 | 27180461 | SPRING (FLS) |
| M43 | 27301466A | CUSHION |
| M44 | 82142004 | 2P+4F(BC), SCREW |
| M49 | 24802022A | CHASSIS (MAIN) |
| M50 | 831430088 | 3TTW+8B(BC), SCREW |
| M53 | 24840101 | DISC TRAY |
| M54 | 24810032 | RACK (L) |
| M55 | 24810033 | RACK (R) |
| M56 | 834426068 | 2.6TTS+6B(BC), SCREW |
| M59 | 24820031 | PLATE (E) |
| M60 | 838430088 | 3TTB+8B(BC), SCREW |
| M63 | 24810034A | CAM PLATE |
| M64 | 24810035A | GEAR (MAIN) |
| M65 | 24810036 | GEAR |
| M66 | 24810037 | PULLEY |
| M67 | 24816012 | BELT |
| M68 | 27300859A | PULLEY MO |
| M69 | 24502234A | MDH2B60, MOTOR |
| M70 | 831430088 | 3TTW+8B(BC), SCREW |
| M71 | 831426060 | 2.6TTW+6P(BC), SCREW |
| M72 | 82113003 | 3P+3F, SCREW |
| M74 | 24810038 | GEAR (SYN) |
| M75 | 24828015 | SHAFT (SYN) |
| M78 | 24840103 | PLATE (CH) |
| M79 | 24824005 | CAP (CH) |
| M80 | 27301344 | YOKE (CH) |
| M81 | 28181019A | MAGNET |
| M83 | 833426050 | 2.6TTP+5P(BC), SCREW |
| M85 | 838430088 | 3TTB+8B(BC), SCREW |
| M86 | 2061112060UL | CRIMP AS |
| M92 | 1H302553-1 | NAETC-5653-1 |
| M93 | 2049041022 | NCFC9-041022, FFC |
| M94 | 2042131022 | NCFC2-131022, FFC |
| M95 | 834426068 | 2.6TTS+6B, (BC), SCREW |

CAUTION ON REPLACEMENT OF PICKUP

The laser diode in the optical pickup block is so sensitive to static electricity, surge current and etc. that the components are liable to be broken down or its reliability remarkably deteriorated.

During repair, carefully take the following precautions.

1. When replacing the optical pickup, first short the LD terminals and remove the connector. Also, when attaching the new optical pickup, after attaching the connector, unsolder the LD terminals.
2. Do not touch the optical pickup object lens with the hands.

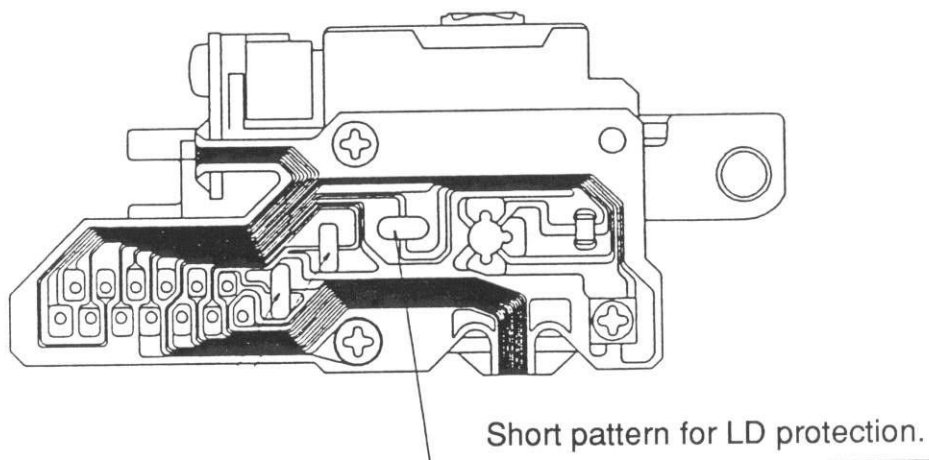

MECHANISM-EXPLODED VIEW

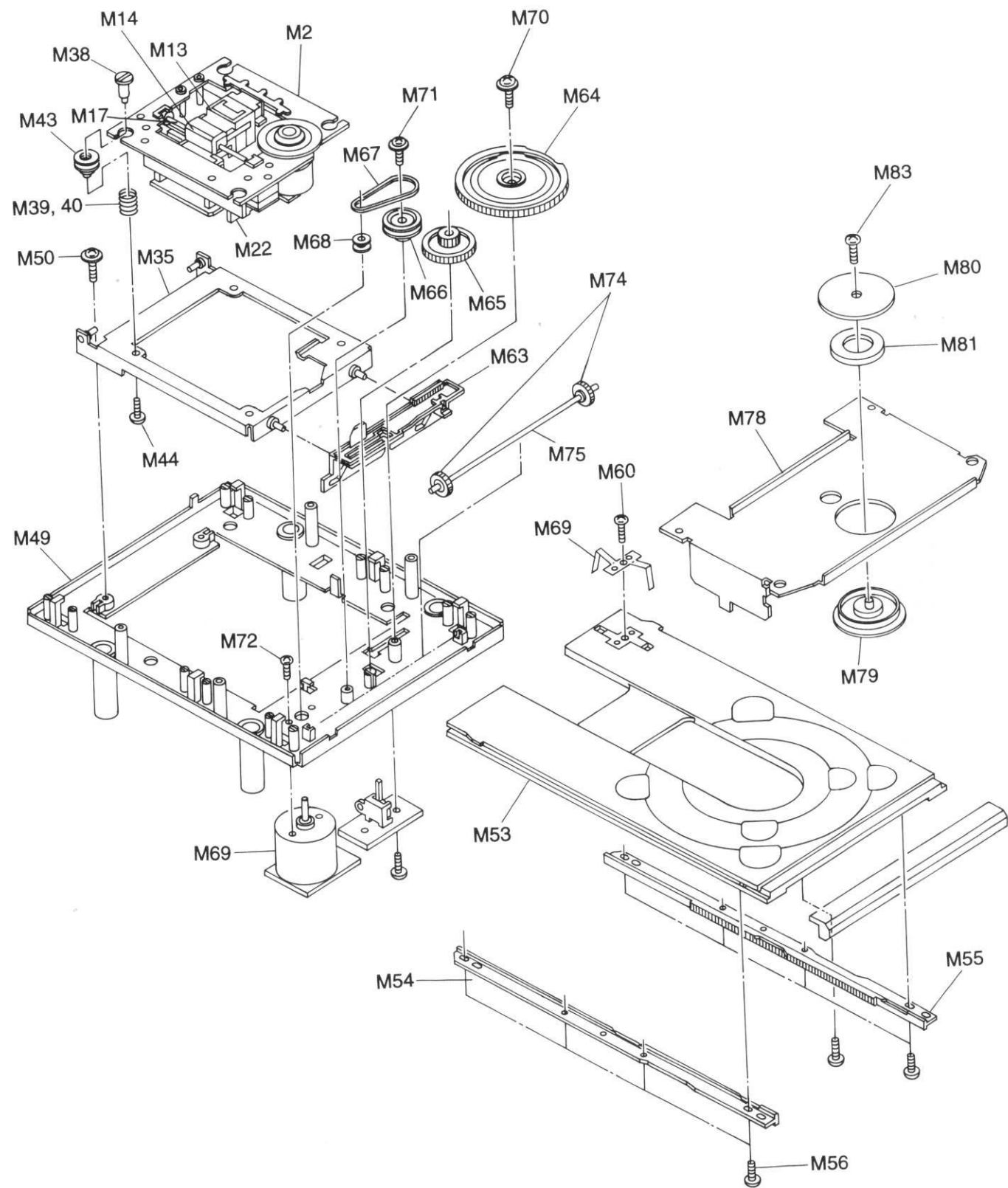

MECHANISM-PARTS LIST

| REF NO. | PART NO. | DESCRIPTION |
|---------|--------------|------------------------|
| M2 | 24802023 | CHASSIS (PU)AS |
| M13 | 24804019 | PICK UP |
| M14 | 24840100 | BLOCK (RET) |
| M17 | 24828013 | SHAFT (PU) |
| M18 | 27270322 | SPACER |
| M19 | 27270323 | SPACER |
| M21 | 24804020 | LINEAR MOTOR |
| M35 | 24802020 | CHASSIS (SUB)AS |
| M38 | 24826007A-1 | HOLDER (FLT) |
| M39 | 27180462 | SPRING (FRG) |
| M40 | 27180461 | SPRING (FLS) |
| M43 | 27301466A | CUSHION |
| M44 | 82142004 | 2P+4F(BC), SCREW |
| M49 | 24802022A | CHASSIS (MAIN) |
| M50 | 831430088 | 3TTW+8B(BC), SCREW |
| M53 | 24840101 | DISC TRAY |
| M54 | 24810032 | RACK (L) |
| M55 | 24810033 | RACK (R) |
| M56 | 834426068 | 2.6TTS+6B(BC), SCREW |
| M59 | 24820031 | PLATE (E) |
| M60 | 838430088 | 3TTB+8B(BC), SCREW |
| M63 | 24810034A | CAM PLATE |
| M64 | 24810035A | GEAR (MAIN) |
| M65 | 24810036 | GEAR |
| M66 | 24810037 | PULLEY |
| M67 | 24816012 | BELT |
| M68 | 27300859A | PULLEY MO |
| M69 | 24502234A | MDH2B60, MOTOR |
| M70 | 831430088 | 3TTW+8B(BC), SCREW |
| M71 | 831426060 | 2.6TTW+6P(BC), SCREW |
| M72 | 82113003 | 3P+3F, SCREW |
| M74 | 24810038 | GEAR (SYN) |
| M75 | 24828015 | SHAFT (SYN) |
| M78 | 24840103 | PLATE (CH) |
| M79 | 24824005 | CAP (CH) |
| M80 | 27301344 | YOKE (CH) |
| M81 | 28181019A | MAGNET |
| M83 | 833426050 | 2.6TTP+5P(BC), SCREW |
| M85 | 838430088 | 3TTB+8B(BC), SCREW |
| M86 | 2061112060UL | CRIMP AS |
| M92 | 1H302553-1 | NAETC-5653-1 |
| M93 | 2049041022 | NCFC9-041022, FFC |
| M94 | 2042131022 | NCFC2-131022, FFC |
| M95 | 834426068 | 2.6TTS+6B, (BC), SCREW |

CHASSIS EXPLODED VIEW

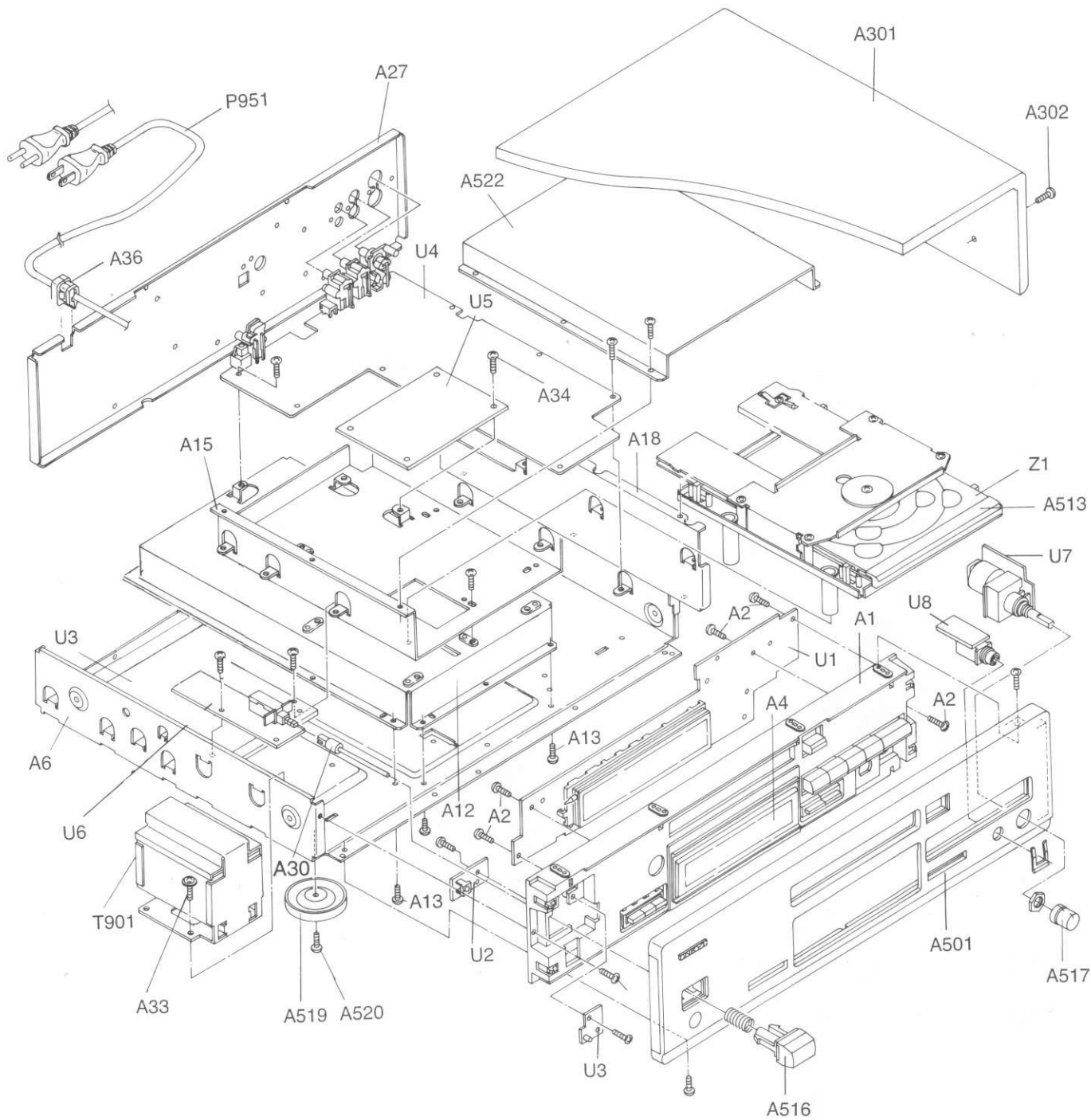

CHASSIS EXPLODED VIEW PARTS LIST

| REF NO. | PART NO. | DESCRIPTION | REF NO. | PART NO. | DESCRIPTION |
|---------|------------|--------------------------|---------|--------------|--------------------------------------|
| A1 | 27110912A | FRONT BRACKET ASS'Y | A516 | 28325264 | KNOB(POW) |
| | 27110913A | FRONT BRACKET ASS'Y <S> | | 28325265 | KNOB(POW) <S> |
| | 27110904A | FRONT BRACKET ASS'Y <G> | | 28325238 | KNOB(POW) <G> |
| A2 | 838130088 | 3TTB+8B, SCREW | A517 | 28325256 | KNOB(BAL) |
| A3 | 28133349-1 | BACK PLATE | | 28325257 | KNOB(BAL) <S> |
| | 28133345 | BACK PLATE <S,G> | | 28325258 | KNOB(BAL) <G> |
| A4 | 28191731A | CLEAR PLATE | A519 | 27175311 | LEG AS |
| A5 | 831430088 | 3TTW+8B(BC), SCREW | A520 | 831430088 | 3TTW+8B(BC), SCREW |
| A6 | 27100308-1 | CHASSIS | A522 | 28184632-1 | COVER(M) |
| A7 | 838430088 | 3TTB+8B(BC), SCREW | A523 | 838430088 | 3TTB+8B(BC), SCREW |
| A9 | 27130771 | BRACKET(KZ) | A528 | 27190972 | HOLDER(L) |
| A10 | 838130088 | 3TTB+8B, SCREW | A529 | 838230088 | 3TTB+8B(Ni), SCREW |
| A12 | 27130765-1 | BRACKET(D) | A531 | 29361961 | LABEL(ALL3) |
| A13 | 838430088 | 3TTB+8B(BC), SCREW | E801 | 2061112200UL | CRIMP AS |
| A14 | 28140761 | 13x240x25, CUSHION | E802 | 2047271512 | NCFC7-271512, FLAT CABLE |
| A15 | 27130766-1 | BRACKET(U) | L901 | 230915 | RBD25HA-00, CORE |
| A16 | 838130088 | 3TTB+8B, SCREW | L901A | 831430088 | 3TTW+8B(BC), SCREW |
| A18 | 27130764 | BRACKET(PC) | P951 | △ 253174Y | AS-UC-6#18, AC CORD <D,C> |
| A19 | 838430088 | 3TTB+8B(BC), SCREW | | △ 253148 | AS-CEE, AC CORD <P,T,W> |
| A21 | 831430088 | 3TTW+8B(BC), SCREW | | △ 253196HIT | AS-BS, AC CORD <E> |
| A26 | 27300833 | WS-2NS, CLAMP | T901 | △ 2301170 | NPT-1260D, POWER TRANSFORMER <D,C> |
| A27 | 27122190 | REAR PANEL <D,C> | | △ 2301171 | NPT-1260P, POWER TRANSFORMER <P,E,T> |
| | 27122191 | REAR PANEL <P,E,T> | | △ 2301172 | NPT-1260DG, POWER TRANSFORMER <W> |
| | 27122192 | REAR PANEL <W> | U1 | 1H302552-2 | NAETC-5652-2 |
| A28 | 838430088 | 3TTB+8B(BC), SCREW | U2 | 1H302549-2 | NADIS-5649-2 |
| A30 | 27273161 | JOINT(POW) | U3 | 1H302557-2 | NAETC-5657-2 |
| A33 | 830440109 | 4TTC+10C(BC), SCREW | U4 | 1H302589-1A | NAAR-5689-1A <except W> |
| A34 | 838130088 | 3TTB+8B, SCREW | | 1H302589-1B | NAAR-5689-1B <W> |
| A36 | △ 27300750 | #2271, CORD BUSHING | U5 | 1H302590-1A | NADG-5690-1A <except W> |
| A301 | 28184635 | TOP COVER | | 1H302590-1B | NADG-5690-1B <W> |
| | 28184636 | TOP COVER <S> | U6 | 1H302591-1A | NASW-5691-1A <except W> |
| | 28184637 | TOP COVER <G> | | 1H302591-1B | NASW-5691-1B <W> |
| A302 | 838440088 | 4TTB+8B(BC), SCREW | U7 | 1H302592-1A | NAAF-5692-1A <except W> |
| | 838240088 | 4TTB+8B(Ni), SCREW <S,G> | | 1H302592-1B | NAAF-5692-1B <W> |
| A303 | 838430088 | 3TTB+8B(BC), SCREW | U8 | 1H302593-1A | NAAF-5693-1A <except W> |
| A304 | 28140761 | 13x240x25, CUSHION | | 1H302593-1B | NAAF-5693-1B <W> |
| A501 | 27211794 | FRONT PANEL | U9 | 1H302594-1A | NASW-5694-1A <except W> |
| | 27211795 | FRONT PANEL <S> | | 1H302594-1B | NASW-5694-1B <W> |
| | 27211796 | FRONT PANEL <G> | Z1 | 1H301122 | NCD-61, CD MECHANISM ASS'Y <S> |
| A502 | 28125307 | END CAP(L) | | 1H302122 | NCD-61, CD MECHANISM ASS'Y |
| | 28125309 | END CAP(L) <S> | | 1H303122 | NCD-61, CD MECHANISM ASS'Y <G> |
| | 28125311 | END CAP(L) <G> | Z2 | 838130088 | 3TTB+8B, SCREW |
| A503 | 28125308 | END CAP(R) | Z3 | 838430088 | 3TTB+8B(BC), SCREW |
| | 28125310 | END CAP(R) <S> | | | |
| | 28125312 | END CAP(R) <G> | | | |
| A504 | 27267913 | GUIDE(POW) | | | |
| | 27267914 | GUIDE(POW) <S> | | | |
| | 27267915 | GUIDE(POW) <G> | | | |
| A505 | 28191730 | CLEAR PLATE(RE) | | | |
| A506 | 28198839 | FACET(POW) | | | |
| A507 | 27267922A | GUIDE(PLAY) | | | |
| | 27267923A | GUIDE(PLAY) <S> | | | |
| | 27267893A | GUIDE(PLAY) <G> | | | |
| A508 | 28135243 | BADGE | | | |
| | 28135242 | BADGE <S,G> | | | |
| A509 | 28141288 | t0.8x19x15, CUSHION | | | |
| A511 | 801525 | 3TTB+8B(BC), SCREW | | | |
| A512 | 27267927 | GUIDE(DO) | | | |
| | 27267928 | GUIDE(DO) <S> | | | |
| | 27267929 | GUIDE(DO) <G> | | | |
| A513 | 28148334 | DOOR | | | |
| | 28148335 | DOOR <S> | | | |
| | 28148333 | DOOR <G> | | | |
| A514 | 834426068 | 2.6TTS+6B(BC), SCREW | | | |

<S> : Silver model only
 : Black model only
 <G> : Golden model only
 <D> : 120V model only
 <P> : 230V model only
 <W> : Worldwide model only
 <C> : Canadian model only
 <E> : British model only
 <T> : Taiwanese model only

NOTE: THE COMPONENTS IDENTIFIED BY MARK △ ARE CRITICAL FOR RISK OF FIRE AND ELECTRIC SHOCK. REPLACE ONLY WITH PART NUMBER SPECIFIED.