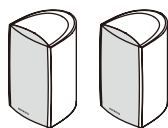
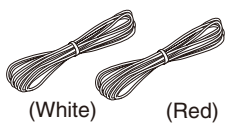
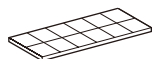
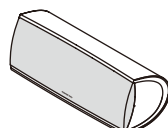

ONKYO® SERVICE MANUAL**5.1ch Home Theater Speaker Package
MODEL HTP-690(B)****Front speaker (SKF-690)**

Front speakers

(White) (Red)
Speaker cables 11 ft.
(3.5 m)

12 rubber stoppers* (For Front/Surround speakers)

Center speaker (SKC-690)

Center speaker

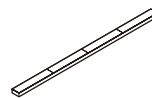
(Green)
Speaker cable 10 ft.
(3.0 m)

4 rubber stoppers*

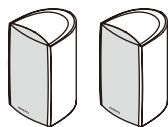
Surround speaker (SKR-690)

Surround speakers

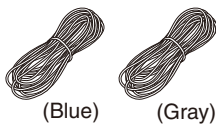
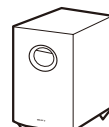
(Blue) (Gray)
Speaker cables 26 ft.
(8.0 m)

Subwoofer

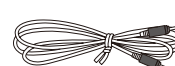
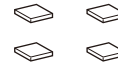
RCA cable 10 ft.
(3.0 m)

4 floor pads

Black model

B MDC | 120V AC, 60Hz

SAFETY-RELATED COMPONENT WARNING!!COMPONENTS IDENTIFIED BY MARK  ON THE SCHEMATIC DIAGRAM AND IN THE PARTS LIST ARE CRITICAL FOR RISK OF FIRE AND ELECTRIC SHOCK.

REPLACE THESE COMPONENTS WITH ONKYO PARTS WHOSE PART NUMBERS APPEAR AS SHOWN IN THIS MANUAL. MAKE LEAKAGE-CURRENT OR RESISTANCE MEASUREMENTS TO DETERMINE THAT EXPOSED PARTS ARE ACCEPTABLY INSULATED FROM THE SUPPLY CIRCUIT BEFORE RETURNING THE APPLIANCE TO THE CUSTOMER.

**ONKYO SOUND & VISION CORPORATION
Service Department**

EXPLODED VIEWS - 1
SKW-780

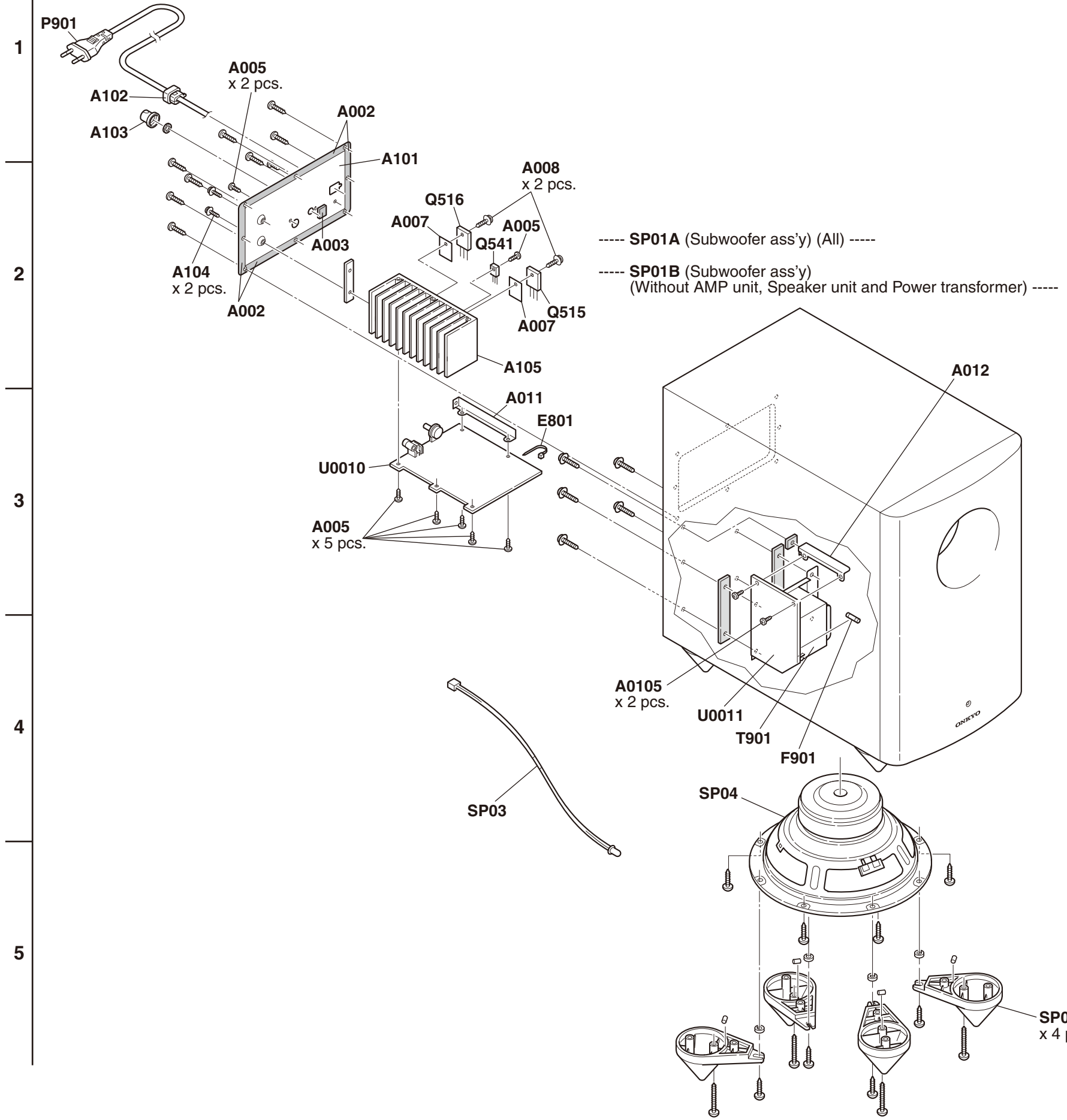

REF. NO.	PART NAME	DESCRIPTION	Q'TY	PART NO. (SN)	REMARKS
SKW-780					
SP01A	SPK SYSTEM ASSY	ALL	1	000-SKW780BMDC	
SP01B	SUBWOOFER ASSY	Without AMP unit and Power transformer	1	???	
SP02	FOOT		4	D249-W55001B-01	
SP03	LED HARNESS Ass'y		1	335-SKW750-01	
SP04	WOOFER (ONKYO)	OAE(JITRA)	1	W2302B	
[SEMI CONDUCTOR]					
Q515	TR	2SC5359-R	1	2203082	
Q515 or	TR	2SC5359-O	(1)	2203083	
Q516	TR	2SA1987-R(Q)	1	2203072	
Q516 or	TR	2SA1987-O	(1)	2203073GR	
Q541	TR	2SC3423-Y	1	2202104	
Q541 or	TR	2SC3423-O	(1)	2202103	
[CHASSIS SCREW]					
A001	HEAT SINK	230	1	27160591	
A002	CUSHION	---	2	28141682	
A003	CUSHION	---	1	28141691	
A007	ISO SHEET	AC262	2	223025	
A011	RETAINER	(PCB)	1	27142025	
A012	RETAINER	(TRANS)SKW-538	1	27142177A	
A101	REAR PANEL	SKW-780DAMP(X)MDD/MDC(S&	1	27124183B	N
A102	BUSHING	S-RELIEF #2271	1	27300750	
A103	KNOB	(VOL)	1	28326463	
A005	SCREW	3TTB+8B(3BC)	10	838430088GR	
A008	SCREW	3SMS8W.SW+14B(CU)	2	801634	
A104	SCREW	3SMS8W.SW+14B(3BC)	2	801433GR	
[TRANS COIL]					
T901	P TRANS	NPT-1578D	1	2301948	!
[SW TRM]					
F901	FUSE	5A-UL/T-233	1	252326GR	!
P901	AC CORD	AS-UC-2	1	253368BLTK	!
P901 or	AC CORD	AS-UC-2	(1)	253368AYUN	!
[OTHERS]					
E801	WIRE TIE	BSK-1	1	260208	
[TUNER UNIT]					
U001	U0010 ~ U0012	BAAF-0491-2H *	1	1B139591-2H	
U0010	MAIN PCB AS	BAAF-0491-2H	1	1B1395491-2H	
U0011	POWER SUPPLY PCB AS	BAPS-0492-2H	1	1B1395492-2H	
U0012	ETC	BAETC-0498-2H	1	NSP	

A

B

C

D

E

Exploded views - 2

SKF-648/690, SKC-648/690, SKR-648/690

1

SP20a

TERMINAL :
White / Black

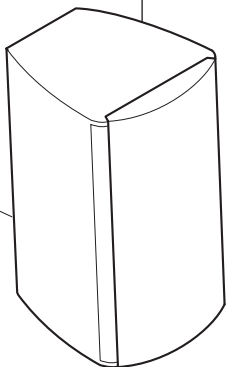

SKF-648/690 <L>

2

SP21a

TERMINAL :
Red / Black

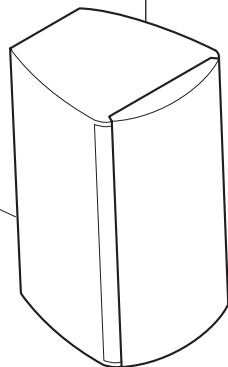

SKF-648/690 <R>

3

SP25a

TERMINAL :
Blue / Black

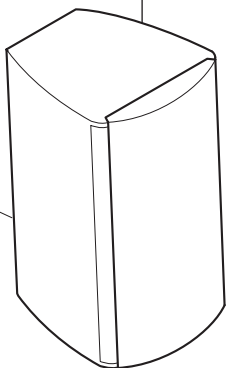

SKR-648/690 <L>

4

SP26a

TERMINAL :
Gray / Black

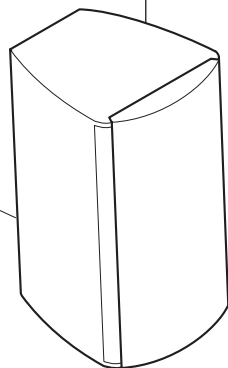

SKR-648/690 <R>

SP23a

TERMINAL :
Green / Black

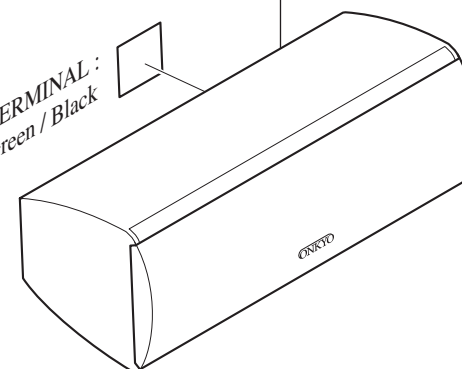

SKC-648/690

ASRA

W-770D,SKW-

U01 MAIN PC BOARD

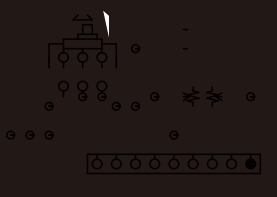

CONTROL SKW-204/208

Notes:
NC: No

CONTROL SKW-204/208

POWER NEED TO CONFIR

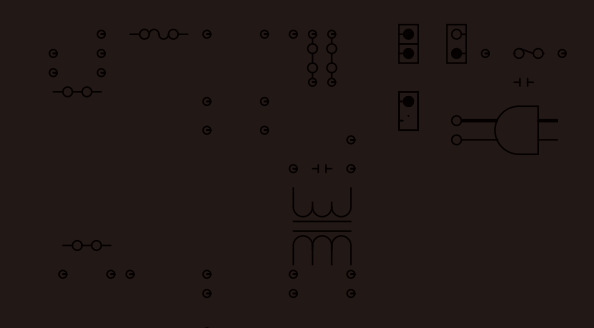
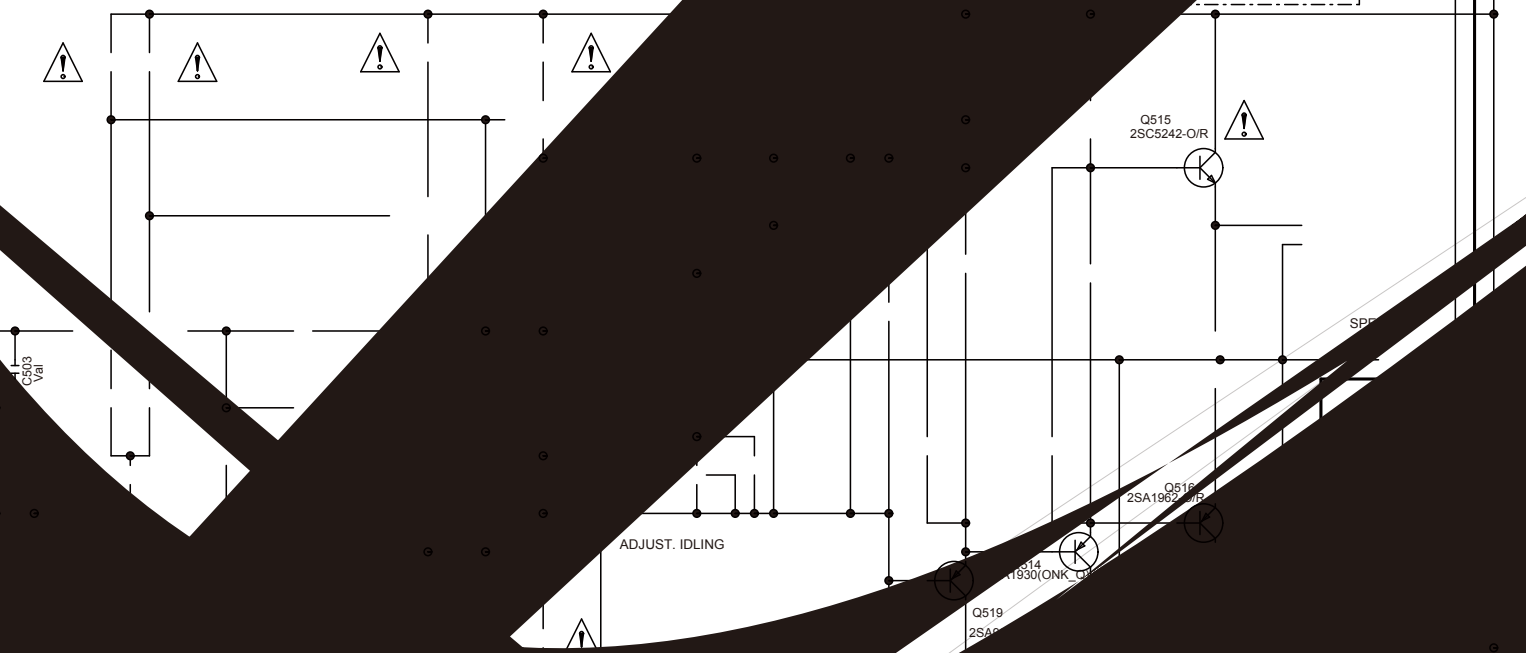

ADJUSTMENT OF IDLING CURRENT

[When]

1. Exchange transistors (Q505 - Q519).
2. Exchange MAIN PC board ass'y (NAAF-8829).

[Procedure]

<Note> No speaker load and No input signal.

1. Short test point P631 for amplifier is under active mode.
2. Adjust the trimming resistor R544 so that the reading of multimeter becomes 52 ohm to 53 ohm.
3. Connect the DC voltmeter to test point P531. <Fig-1>
4. Connect the power cord into the AC outlet.
5. Confirm the voltage of above point after 6 minutes to 8 minutes. (Heat running)
6. When less than 3.20 mV : Readjust the trimming resistor above so that the voltage becomes 4.5 mV to 5.0 mV.
When 3.30 mV to 5.20 mV : Not necessary to adjust.
When 5.21 mV to 10.0 mV : Readjust the trimming resistor above so that the voltage becomes 5.0 mV to 5.5 mV.
When 10.1 mV to 20.0 mV : Readjust the trimming resistor above so that the voltage becomes 5.6 mV to 6.0 mV.
7. Disconnect the power cord from the AC outlet.
8. Disconnect the DC voltmeter.

	SKW-50	1.6A/230V
ZE	SKW-770MMO	230V 1.6A/230V
	SKW-770MDD	120V
ZH	SKW-580MDD	120V
	SKW-580MDS	120V
	SKW-580MMO	
	SKW-580MMV	
	SW-31ADM	
	SW-31	

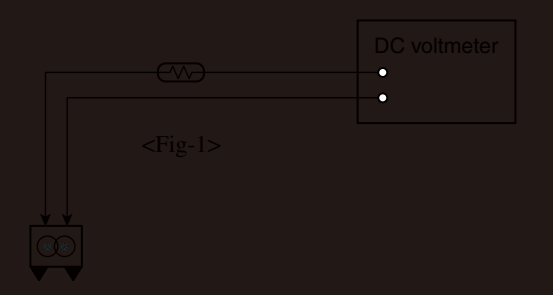

HTP-690

<Note>

Parts marked by 'NSP' are generally unavailable because they are not in our Master Spare Parts List.

**NOTE : THE COMPONENTS IDENTIFIED BY THE MARK
! ARE CRITICAL FOR RISK OF FIRE AND
ELECTRIC SHOCK. REPLACE ONLY WITH PART
NUMBER SPECIFIED.**

HTP-690

EXPLODED VIEW PARTS LIST

REF. NO.	PART NAME	DESCRIPTION	Q'TY	PART NO. (SN)	REMARKS
SKW-780					
SP01A	SPK SYSTEM ASSY	ALL	1	000-SKW780BMDC	
SP01B	SUBWOOFER ASSY	Without AMP unit and Power transformer	1	???	
SP02	FOOT		4	D249-W55001B-01	
SP03	LED HARNESS Ass'y		1	335-SKW750-01	
SP04	WOOFER (ONKYO)	OAE(JITRA)	1	W2302B	
[SEMI CONDUCTOR]					
Q515	TR	2SC5359-R	1	2203082	
Q515 or	TR	2SC5359-O	(1)	2203083	
Q516	TR	2SA1987-R(Q)	1	2203072	
Q516 or	TR	2SA1987-O	(1)	2203073GR	
Q541	TR	2SC3423-Y	1	2202104	
Q541 or	TR	2SC3423-O	(1)	2202103	
[CHASSIS SCREW]					
A001	HEAT SINK	230	1	27160591	
A002	CUSHION	---	2	28141682	
A003	CUSHION	---	1	28141691	
A007	ISO SHEET	AC262	2	223025	
A011	RETAINER	(PCB)	1	27142025	

A012	RETAINER	(TRANS)SKW-538	1	27142177A	
A101	REAR PANEL	SKW-780DAMP(X)MDD/MDC(S&V	1	27124183B	N
A102	BUSHING	S-RELIEF #2271	1	27300750	
A103	KNOB	(VOL)	1	28326463	
A005	SCREW	3TTB+8B(3BC)	10	838430088GR	
A008	SCREW	3SMS8W.SW+14B(CU)	2	801634	
A104	SCREW	3SMS8W.SW+14B(3BC)	2	801433GR	
[TRANS COIL]					
T901	P TRANS	NPT-1578D	1	2301948	!
[SW TRM]					
F901	FUSE	5A-UL/T-233	1	252326GR	!
P901	AC CORD	AS-UC-2	1	253368BLTK	!
P901 or	AC CORD	AS-UC-2	(1)	253368AYUN	!
[OTHERS]					
E801	WIRE TIE	BSK-1	1	260208	
[TUNER UNIT]					
U001	U0010 ~ U0012	BAAF-0491-2H *	1	1B139591-2H	
U0010	MAIN PCB AS	BAAF-0491-2H	1	1B1395491-2H	
U0011	POWER SUPPLY PCB AS	BAPS-0492-2H	1	1B1395492-2H	
U0012	ETC	BAETC-0498-2H	1	NSP	
[PACKING]					
A601	LABEL	LABEL SHEET	1	29360840A	
A603	TAPE	(SEROHAN)NITTO NO.29	1	29110149	
A604	TAPE	TAPE(CLOTH-16U)	1	29110083	
A903	SHEET	200x150t0.5	1	29095961	
[ACCESSARY]					
F901C	LABEL	5A/125V	1	29360462	

HTP-690

PACKING PROCEDURES PARTS LIST

REF. NO.	PART NAME	DESCRIPTION	Q'TY	PART NO. (SN)	REMARKS
----------	-----------	-------------	------	---------------	---------

PC BOARD PARTS LIST

HTP-690

U001	U0010 ~ U0012	BAAF-0491-2H *	1	1B139591-2H
U0010	MAIN PCB AS	BAAF-0491-2H	1	1B1395491-2H
U0011	POWER SUPPLY PCB AS	BAPS-0492-2H	1	1B1395492-2H
U0012	ETC	BAETC-0498-2H	1	NSP

CIRCUIT NO.	PART NAME	DESCRIPTION	Q'TY	PART NO. (SN)	REMARKS
[SEMI CONDUCTOR]					
D501	ZENER D	MTZJ5.6B	1	224470562T	
D601	ZENER D	MTZJ3.6B	1	224470362T	
D602	ZENER D	MTZJ3.6B	1	224470362T	
D603	DIODE	ISS133	1	223163T	
D605	DIODE	ISS133	1	223163T	
D606	DIODE	ISS133	1	223163T	
D607	DIODE	ISS133	1	223163T	
D651	DIODE	ISS133	1	223163T	
D652	DIODE	ISS133	1	223163T	
D707	DIODE	ISS133	1	223163T	<X MDD>
D708	DIODE	ISS133	1	223163T	<X MDD>
D709	DIODE	ISS133	1	223163T	<X MDD>
D901	DIODE	D3SBA60	1	22380272F	
D901 or	DIODE	RBV402	(1)	22380022F	
D911	DIODE	ISS133	1	223163T	
D913	DIODE	ISS133	1	223163T	
D917	DIODE	ISS133	1	223163T	
D918	DIODE	ISS133	1	223163T	
D919	DIODE	RLIN4003	1	22380260T	
D920	ZENER D	MTZJ9.1B	1	224470912T	
Q301	IC	NJM4558L-D	1	22240293	

Q501	TR	2SC2240-BL(TPE2_F)	1	2211406T
Q502	TR	2SC2240-BL(TPE2_F)	1	2211406T
Q503	TR	2SC2240-BL(TPE2_F)	1	2211406T
Q505	TR	2SA949-O(TPE6_F)	1	2211353T
Q505 or	TR	2SA949-Y(TPE6_F)	(1)	2211354T
Q505 or	TR	KTA1024-Y	(1)	2215844T
Q506	TR	2SC2229-O(TPE6_F)	1	2211633T
Q506 or	TR	2SC2229-Y(TPE6_F)	(1)	2211634T
Q506 or	TR	KTC3206-Y	(1)	2215854T
Q507	TR	2SA949-O(TPE6_F)	1	2211353T
Q507 or	TR	2SA949-Y(TPE6_F)	(1)	2211354T
Q507 or	TR	KTA1024-Y	(1)	2215844T
Q509	TR	2SA949-O(TPE6_F)	1	2211353T
Q509 or	TR	2SA949-Y(TPE6_F)	(1)	2211354T
Q509 or	TR	KTA1024-Y	(1)	2215844T
Q510	TR	2SC2229-O(TPE6_F)	1	2211633T
Q510 or	TR	2SC2229-Y(TPE6_F)	(1)	2211634T
Q510 or	TR	KTC3206-Y	(1)	2215854T
Q513	TR	2SC5171(ONK_Q)	1	2203010
Q513 or	TR	KTD2061-Y	(1)	2203434
Q514	TR	2SA1930(ONK_Q)	1	2203000
Q514 or	TR	KTBI369-Y	(1)	2203424
Q517	TR	2SA933S-S	1	2213355T
Q517 or	TR	2SA933S-R	(1)	2213354T
Q517 or	TR	KTA1267-GR	(1)	2215995T
Q518	TR	2SC2235-Y(TPE6_F)	1	2211654T
Q519	TR	2SA965-Y(TPE6_F)	1	2211644T
Q602	TR	KRC103M	1	2215810T
Q602 or	TR	DTC124ES	(1)	2213160T
Q603	TR	2SC1740S-S	1	2213285T
Q603 or	TR	2SC1740S-R	(1)	2213284T
Q603 or	TR	KTC3199-GR	(1)	2215864T
Q604	TR	2SA933S-S	1	2213355T

Q604 or	TR	2SA933S-R	(1)	2213354T	
Q604 or	TR	KTA1267-GR	(1)	2215995T	
Q605	TR	2SA933S-S	1	2213355T	
Q605 or	TR	2SA933S-R	(1)	2213354T	
Q605 or	TR	KTA1267-GR	(1)	2215995T	
Q606	TR	KRA103M	1	2215780T	
Q606 or	TR	DTA124ES	(1)	2212600T	
Q607	TR	2SA933S-S	1	2213355T	
Q607 or	TR	2SA933S-R	(1)	2213354T	
Q607 or	TR	KTA1267-GR	(1)	2215995T	
Q608	TR	2SC1740S-S	1	2213285T	
Q608 or	TR	2SC1740S-R	(1)	2213284T	
Q608 or	TR	KTC3199-GR	(1)	2215864T	
Q610	TR	2SA933S-S	1	2213355T	
Q610 or	TR	2SA933S-R	(1)	2213354T	
Q610 or	TR	KTA1267-GR	(1)	2215995T	
Q612	TR	2SC1740S-S	1	2213285T	
Q612 or	TR	2SC1740S-R	(1)	2213284T	
Q612 or	TR	KTC3199-GR	(1)	2215864T	
Q703	TR	2SC1740S-S	1	2213285T	<X MDD>
Q703 or	TR	2SC1740S-R	(1)	2213284T	<X MDD>
Q703 or	TR	KTC3199-GR	(1)	2215864T	<X MDD>
Q704	TR	2SC1740S-S	1	2213285T	<X MDD>
Q704 or	TR	2SC1740S-R	(1)	2213284T	<X MDD>
Q704 or	TR	KTC3199-GR	(1)	2215864T	<X MDD>
Q705	TR	2SA933S-S	1	2213355T	<X MDD>
Q705 or	TR	2SA933S-R	(1)	2213354T	<X MDD>
Q705 or	TR	KTA1267-GR	(1)	2215995T	<X MDD>
Q706	TR	DTC123JS	1	2213640T	<X MDD>
Q901	TR	DTC123JS	1	2213640T	
Q902	IC	78M05AHF(MPC78M05AHF)	1	222780055NEC	
Q902 or	IC	78M05(NJM78M05FA)	(1)	222780055JRC	
[TRANS COIL]					

T902	P TRANS	NPT-1520JQ	1	2301812A	<X MDD>
[CAPACITOR]					
C301	UPZ C	2AUPZTF221JE	1	376332214T	<X MDD>
C302	UTSP C	CE04W50V-47M(UTSP)	1	397584707T	
C303	TF C	ECQ-V50V-223J	1	374722234T	<X MDD>
C501	UTSP C	CE04W50V-47M(UTSP)	1	397584707T	
C503	TF C	ECQ-V50V-474J	1	374724744T	<X MDD>
C504	UTSP C	CE04W25V-220M(UTSP)	1	397552217T	
C505	CERA C	CC45CH50V-020C	1	345340201T	
C506	CERA C	CC45CH50V-070D	1	345340702T	
C514	UPZ C	2AUPZTF101JE	1	376331014T	
C517	VR C	CE04W100V-22M(VR)	1	394692207T	
C519	TF C	ECQ-V50V-224J	1	374722244T	
C520	TF C	ECQ-V50V-224J	1	374722244T	
C526	VR C	CE04W100V-22M(VR)	1	394692207T	
C527	UTSP C	CE04W50V-1M(UTSP)	1	397580107T	
C528	VR C	CE04W100V-22M(VR)	1	394692207T	
C601	UTSP C	CE04W50V-10M(UTSP)	1	397581007T	
C602	UTSP C	CE04W50V-10M(UTSP)	1	397581007T	
C603	UTSP C	CE04W10V-470M(UTSP)	1	397534717T	
C604	UTSP C	CE04W50V-4.7M(UTSP)	1	397580477T	
C605	UTSP C	CE04W50V-4.7M(UTSP)	1	397580477T	
C704	UTSP C	CE04W10V-470M(UTSP)	1	397534717T	<X MDD>
C707	TF C	ECQ-V50V-223J	1	374722234T	<X MDD>
C709	TF C	ECQ-V50V-223J	1	374722234T	<X MDD>
C903	TF C	ECQ-V100V-104J	1	374731044T	
C904	TF C	ECQ-V100V-104J	1	374731044T	
C905	ELECT C	CE62W63V-5600M	1	3504399	<X MDD>
C905 or	ELECT C	CE69W63V-5600M	(1)	3504481	<X MDD>
C906	ELECT C	CE62W63V-5600M	1	3504399	<X MDD>
C906 or	ELECT C	CE69W63V-5600M	(1)	3504481	<X MDD>
C907	UTSP C	CE04W25V-220M(UTSP)	1	397552217T	
C908	UTSP C	CE04W25V-220M(UTSP)	1	397552217T	

C911	UTSK C	CE04W25V-1000M(UTSK)	1	398351027S	
C912	UTSK C	CE04W25V-1000M(UTSK)	1	398351027S	
C914	UTSK C	CE04W25V-1000M(UTSK)	1	398351027S	
C915	TF C	ECQ-V50V-224J	1	374722244T	
C916	IS C	MKP R46 103M	1	3500202S	
C917	UTSP C	CE04W50V-22M(UTSP)	1	397582207T	
C919	TF C	ECQ-V50V-104J	1	374721044T	
C921	PLA C	MKP R46 104M	1	3800041S	<X MDD>
C955	TF C	ECQ-V50V-223J	1	374722234T	
[RESISTOR]					
R301	CARBON R	R16J-1K	1	417341024T	
R302	VARI R	N17RGL20KB15M	1	5151508	
R303	CARBON R	R16J-47K	1	417344734T	
R304	CARBON R	R16J-82K	1	417348234T	<X MDD>
R305	CARBON R	R16J-33K	1	417343334T	<X MDD>
R307	CARBON R	R16J-270	1	417342714T	
R501	CARBON R	R16J-1K	1	417341024T	
R502	CARBON R	R16J-33K	1	417343334T	
R503	CARBON R	R16J-5.6K	1	417345624T	
R504	CARBON R	R16J-2.2K	1	417342224T	
R505	NF CARBON R	R25J-1.0K	1	415471024T	
R506	NF CARBON R	R25J-1.0K	1	415471024T	
R507	CARBON R	R16J-33K	1	417343334T	
R508	NF CARBON R	R25J-47	1	415474704T	
R509	CARBON R	R16J-1K	1	417341024T	
R510	CARBON R	R16J-100K	1	417341044T	
R511	NF CARBON R	R25J-82	1	415478204T	
R512	NF CARBON R	R25J-68	1	415476804T	
R513	NF CARBON R	R25J-82	1	415478204T	
R514	NF CARBON R	R25J-82	1	415478204T	
R515	CARBON R	R16J-12K	1	417341234T	
R516	CARBON R	R16J-12K	1	417341234T	
R517	CARBON R	R16J-3.3K	1	417343324T	

R521	CARBON R	R16J-220	1	417342214T
R522	CARBON R	R16J-220	1	417342214T
R526	METAL O R	RS1/2WBJ-82	1	443528204T
R527	CARBON R	R16J-270	1	417342714T
R528	METAL O R	RS1/2WBJ-390	1	443523914T
R531	METAL PR	RF-5EGKR22	1	4000201
R531 or	METAL PR	RGC55 0.22	(1)	4000132
R531 or	METAL P R	RGC55C 0.22 K	(1)	4000157
R531 or	METAL PR	MPR5W+5W 0R22	(1)	4000233
R533	METAL R	RNU1WCJ-3.3	1	453630334T
R541	NF CARBON R	R25J-820	1	415478214T
R542	CARBON R	R16J-150	1	417341514T
R543	CARBON R	R16J-180	1	417341814T
R544	TRIM R	N06HR100BC	1	5210399T
R601	CARBON R	R16J-5.6K	1	417345624T
R602	CARBON R	R16J-100K	1	417341044T
R603	CARBON R	R16J-150K	1	417341544T
R604	CARBON R	R16J-180	1	417341814T
R605	CARBON R	R16J-22	1	417342204T
R609	CARBON R	R16J-39K	1	417343934T
R610	CARBON R	R16J-560K	1	417345644T
R611	CARBON R	R16J-820K	1	417348244T
R612	CARBON R	R16J-39K	1	417343934T
R613	CARBON R	R16J-470K	1	417344744T
R614	CARBON R	R16J-120K	1	417341244T
R615	CARBON R	R16J-22K	1	417342234T
R616	CARBON R	R16J-100K	1	417341044T
R617	CARBON R	R16J-1K	1	417341024T
R619	CARBON R	R16J-22K	1	417342234T
R620	CARBON R	R16J-100K	1	417341044T
R621	CARBON R	R16J-1K	1	417341024T
R622	CARBON R	R16J-10K	1	417341034T
R623	CARBON R	R16J-22K	1	417342234T

R624	CARBON R	R16J-100K	1	417341044T	
R625	CARBON R	R16J-180K	1	417341844T	
R626	CARBON R	R16J-2.2M	1	417342254T	
R627	CARBON R	R16J-680K	1	417346844T	
R628	CARBON R	R16J-330K	1	417343344T	
R630	CARBON R	R16J-10K	1	417341034T	
R631	CARBON R	R16J-10K	1	417341034T	
R651	METAL O R	RS1WBJ-10K	1	443621034T	
R652	CARBON R	R16J-470K	1	417344744T	
R653	CARBON R	R16J-680K	1	417346844T	
R654	CARBON R	R16J-330K	1	417343344T	
R704	CARBON R	R16J-100K	1	417341044T	<X MDD>
R714	CARBON R	R16J-47K	1	417344734T	<X MDD>
R715	CARBON R	R16J-10K	1	417341034T	<X MDD>
R716	CARBON R	R16J-1K	1	417341024T	<X MDD>
R717	CARBON R	R16J-10K	1	417341034T	<X MDD>
R904	METAL R	RNU1/2WCJ-0.22	1	453532294T	
R905	METAL R	RNU1/2WCJ-0.47	1	453534794T	
R906	METAL O R	RS1/2WBJ-22	1	443522204T	
R907	METAL O R	RS1/2WBJ-22	1	443522204T	
R954	METAL O R	RS1/2WBJ-33	1	443523304T	
R981	METAL O R	RS1WBJ-470	1	443624714T	
R982	METAL O R	RS1WBJ-470	1	443624714T	
R983	METAL O R	RS1WBJ-470	1	443624714T	
R984	METAL O R	RS1WBJ-470	1	443624714T	<X MDD>
[SW TRM]					
E801	RETAINER	KANAGU(EARTH)	1	27141059	
F901A	FUSE HOL	NSCT-1P2506	1	25052609T	
F901Aor	FUSE HOL	NSCT-1P2031	(1)	25052133T	
F901B	FUSE HOL	NSCT-1P2506	1	25052609T	
F901Bor	FUSE HOL	NSCT-1P2031	(1)	25052133T	
P301	PIN JACK	NPJ-1PDB581	1	25045801	
P301 or	PIN JACK	NPJ-1PDBL382	(1)	25045567	

P301 or	PIN JACK	NPJ-1PDB556	(1)	25045774	
P531	PLUG	NPLG-2P29	1	25055038	
P535A	SOCKET AS	NSAS-2P1852	1	2009991188UL	<X MDD>
P631	PLUG	NPLG-2P29	1	25055038	
P632A	PLUG	NPLG-3P131	1	25055147	
P902A	PLUG	NPLG-2P632	1	25055676	
P903A	PLUG	NPLG-4P151	1	25055167	
P903B	SOCKET AS	NSAS-7P1834	1	20099900740UL	
P908A	SOCKET AS	NSAS-10P1152	1	2002A391040UL	
P908B	PLUG	NPLG-5P133	1	25055149	
RL901	RELAY	NRL-1P5A-DC9-179	1	25065669	

ONKYO®

ONKYO SOUND & VISION CORPORATION

Technical Support, Service Dept.: 2-1, Nisshin-cho, Neyagawa-shi, OSAKA 572-8540, JAPAN
Tel: 072-831-8023 Fax: 072-831-8163

ONKYO U.S.A. CORPORATION

18 Park Way, Upper Saddle River, N.J. 07458, U.S.A.
Tel: 800-229-1687, 201-785-2600 Fax: 201-785-2650
<http://www.us.onkyo.com/>

ONKYO EUROPE ELECTRONICS GmbH

Liegnitzerstrasse 6, 82194 Grobenzell, GERMANY
Tel: +49-8142-4401-0 Fax: +49-8142-4401-555
<http://www.eu.onkyo.com/>

ONKYO EUROPE ELECTRONICS GmbH (UK BRANCH)

The Coach House 81A High Street, Marlow, Buckinghamshire, SL7 1AB, UK
Tel: +44-(0)1628-473-350 Fax: +44-(0)1628-401-700

ONKYO CHINA LIMITED

Unit 1033, 10/F, Star House, No 3, Salisbury Road, Tsim Sha Tsui Kowloon, Hong Kong.
Tel: 852-2429-3118 Fax: 852-2428-9039
<http://www.ch.onkyo.com/>