

# Service Manual

## DVD Changer



### SL-DV150 SL-DV170

Colour

(S).....Silver Type

Areas

(PP).....U.S.A. and Canada.

(EG).....Europe.

(EE).....Russia.

(GCP).....Latin America.

(GCS).....Asia and Southeast Asia.

(GK).....China.

(GN).....Oceania.

Brand name

Technics.....(EG), (EE) and (GN) areas

Panasonic.....Other areas

**Subject :** To correct the error description of Loading Unit Parts Location.

Please file and use this supplement manual together with the service manual for Model No. SL-DV150 (PP), Order No. AD9906158C1 and SL-DV150 (EG), Order No. AD9907166C2 and SL-DV150 (GCP/GCS/GK/GN), Order No. AD9907179C3 and SL-DV170 (EG), Order No. AD0005114C2 and SL-DV170 (EE/GCS/GN), Order No. AD0007129A8 and SL-DV170 (GK), Order No. AD0008137A3.

#### **WARNING**

This service information is designed for experienced repair technicians only and is not designed for use by the general public. It does not contain warnings or cautions to advise non-technical individuals of potential dangers in attempting to service a product. Products powered by electricity should be serviced or repaired only by experienced professional technicians. Any attempt to service or repair the product or products dealt with in this service information by anyone else could result in serious injury or death.

# 1 Loading Unit Parts Location

<Error description>

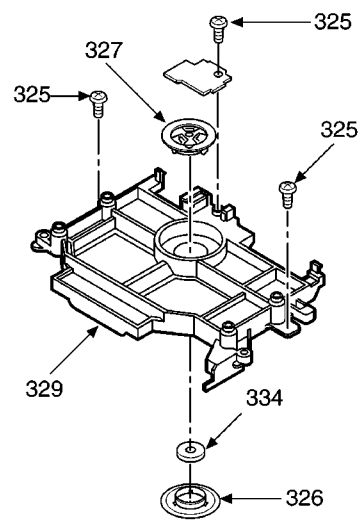

<Correct description>

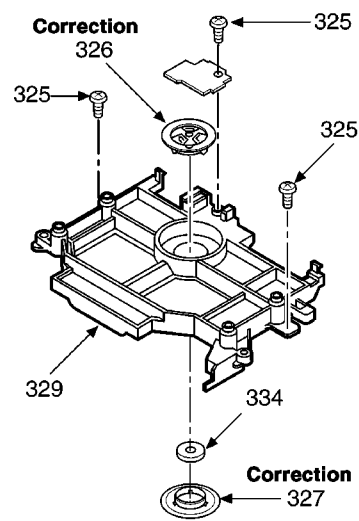

Ref. No.	Part No.	Part Name & Description	Pcs	Remarks
326	RMR0334	MAGNET HOLDER	1	
327	RMR0624-W2	CLAMPER	1	