

<R42-344-0>

SERVICE MANUAL

HI-COMPACT STEREO

C-5600D

FV

<73C02Y31K>

 **PIONEER®**

CONTENTS

1. SPECIFICATIONS	3
2. SCHEMATIC DIAGRAMS, P.C. BOARD and PARTS LISTS	
2.1 Circuit Connection Diagram	5
2.2 Tuner Assembly (W35-028)	9
2.3 Equalizer Amplifier Assembly (W15-065)	16
2.4 Switch Circuit Assembly (W15-072)	18
2.5 Head Phone Amplifier Assembly (W15-057)	20
2.6 Control Amplifier Assembly (W22-003)	22
2.7 Power Amplifier Assembly (W36-006)	25
2.8 Power Supply Assembly (W16-016)	30
3. PARTS LOCATION	
3.1 Front Panel	32
3.2 Rear Panel	33
3.3 Assembly Board	34
3.4 Speaker System	35
4. SPEAKER CONNECTION	36
TURNTABLE ASSEMBLY and PARTS LISTS of C-5600D/FV	
1. EXPLODED VIEW	38
2. AUTO-RETURN ASSEMBLY	41
3. TONEARM ASSEMBLY	44
4. PU-LINKING PLATE ASSEMBLY	44
5. CENTER SHAFT BEARING ASSEMBLY	45
6. ELEVATION SHAFT GUIDE PIN ASSEMBLY	45
7. SPEED SELECTOR ASSEMBLY	46
8. FUNCTION LEVER ASSEMBLY	47
9. ELEVATION ASSEMBLY	48
10. PHONO MOTOR ASSEMBLY	49
11. CIRCUIT BOARD ASSEMBLY	50
12. SPEAKER SYSTEM PACKING	51
13. CONTROL CENTER PACKING	52
14. DIAL CORD STRINGING	55
15. 8P-PLUG CONNECTIONS	55

1. SPECIFICATIONS

SEMICONDUCTORS

FET	1
Transistors	53
Diodes, etc.	30

AUDIO SECTION

2-channel, 2-way multi-amplifier system

Music Power Output: HIGH Range 30W (IHF rating)
 LOW Range 30W (IHF rating)

Total Music Power Output: 60W

Frequency Response: ±3dB, from 20Hz to 60kHz (AUX)

Hum & Noise Ratio: PHONO MAG better than 80dB
 AUX better than 95dB
 (at volume control max., tone control flat, IHF rating)

Input Impedance & Sensitivity:
 (at 1kHz, rated output) PHONO MAG: 2mV 50kΩ
 TAPE MONITOR: 160mV 100kΩ
 AUX: 160mV 100kΩ

Output Terminals & Jacks:
 Output connector (8P)
 Stereo Headphones Jack
 Tape Recording Jack
 Tape Rec/P.B. Connector (DIN type)
 Preamplifier Output Jack

Bass Control: -13dB to +14dB (at 50Hz)
 Treble Control: -10dB to +9dB (at 10kHz)
 Loudness Contour: Switchable to ON-OFF, +12dB at 50Hz, +5dB at 10kHz, with VOLUME control set at -40dB

FM SECTION

Frequency Range:	87.5 to 108MHz
IHF Sensitivity:	2.5μV
Image Rejection:	55dB (at 98MHz)
Muting:	Switchable to ON-OFF
Antenna Input:	300 Ω, balanced

FM MULTIPLEX SECTION

Circuitry:	Time-switching type demodulator, FM Mono Stereo Automatic Selection
Channel Separation:	35dB (at 1kHz)

AM SECTION

Frequency Range:	525 to 1605kHz
IHF Sensitivity:	10μV
Image Rejection:	47dB (at 1000kHz)
Antenna Input:	Built-in ferrite loopstick antenna

TURNTABLE

Belt-driven, full-automatic system (with auto-cut, auto-lead-in, repeat and V-shaped stylus protector)

Cartridge (PC-35)
 Induced magnet type
 Diamond stylus (tipped: 0.5mil); PN-35 for replacement use
 Stylus pressure range: 2 to 3g
 Frequency response: 10 to 25,000Hz

Tonearm
 Static balance system, pipe arm
 Cartridge attaching dimensions: EIA and JIS standards

Phono motor
 4-pole hysteresis synchronous type
 Speed: 2 speeds (33-1/3 and 45 rpm)
 Turntable platter: 12-inch(30cm) aluminum die-cast
 Wow: 0.1%
 Synchronizing voltage: 100V or higher
 Working voltage: 120V AC, 50 or 60Hz (capstan exchangeable)
 Power consumption 12W

RECEIVER AND TURNTABLE SECTION

Walnut enclosure oil finished

External dimensions: 8-1/8" (H) x 21-11/16" (W) x 14-3/16" (D) (including dust cover)

Weight: 33 lb (including receiver and turntable)

SPEAKER SYSTEM

Enclosure: Closed type surface: oil finished

Speakers: 2-way system
 Low range 8" Woofer
 High range 2-1/2" Tweeter

Impedance: 8Ω

Frequency response: 35 to 20,000Hz

External dimensions: 22" (H) x 12-3/16" (W) x 9-3/4" (D)

Weight: 18lb 14oz

Total weight: 70lb 7oz

MISCELLANEOUS

Power requirements: 110V, 120V, 130V, 220V and 240V
 50 or 60Hz

Power consumption: 85W (Receiver and Turntable)

ACCESSORIES

Indoor AM lead antenna	1
T-type FM antenna	1
Polishing cloth	1
Pin-plug	4
1A Fuse	2
0.5A Fuse	1
Operating instructions	1
For turntable use	
EP adaptor	1
Lubricant	1
Screwdriver for unpacking	1
Small screwdriver	1
Capstan	1
Rubber bush	1

Specifications and the design subject to possible modification without notice due to improvements.

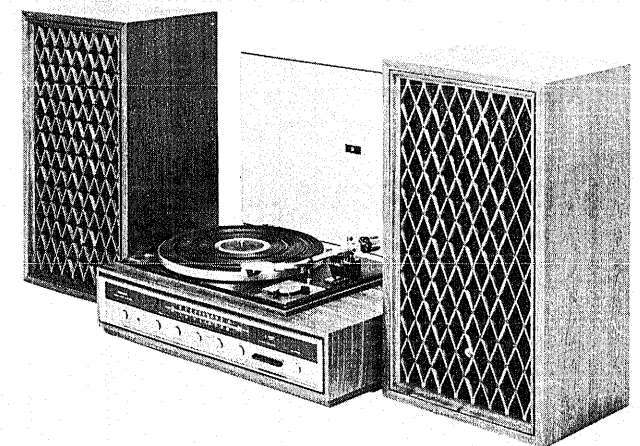

2. SCHEMATIC DIAGRAMS P.C. BOARD AND PARTS LISTS

2.1 CIRCUIT CONNECTION DIAGRAM

C-5600D

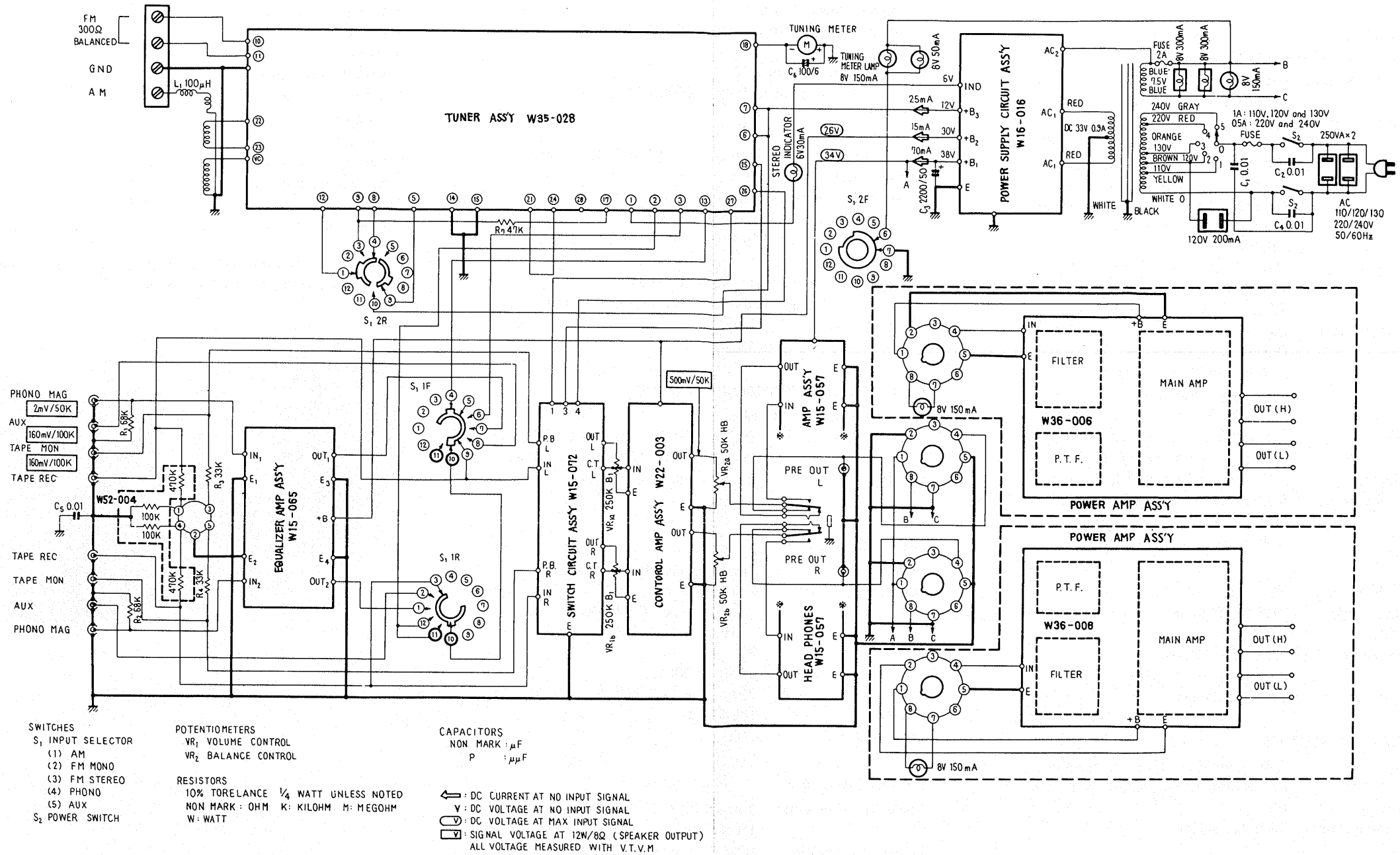

MISCELLANEOUS PARTS LIST

- CAPACITORS: IN μ F UNLESS OTHERWISE NOTED p: pF
- RESISTORS: IN Ω , $\frac{1}{2}$ W UNLESS OTHERWISE NOTED k: k Ω , M: M Ω

CAPACITORS

Symbol	Description	Part No.
C1	Ceramic 0.01 DC 1.4kV	C43-003-0
C2	Ceramic 0.01 DC 1.4kV	C43-003-0
C3	Electrolytic 2200 50V	C52-078-0
C4	Ceramic 0.01 DC 1.4kV	C43-003-0
C5	Ceramic 0.01 50V	CKDYF 103Z 50
C6	Electrolytic 100 6V	CEA 101P 6

RESISTORS

Symbol	Description	Part No.
VR1	Volume control 250k Ω -B1	C82-042-0
VR2	Balance control 50k Ω -HB	C82-041-0
R1	Carbon film 68k	RD $\frac{1}{4}$ PS 683KNL
R2	Carbon film 68k	RD $\frac{1}{4}$ PS 683KNL
R3	Carbon film 33k	RD $\frac{1}{4}$ PS 333KNL
R4	Carbon film 33k	RD $\frac{1}{4}$ PS 333KNL

TRANSFORMER AND COILS

Symbol	Description	Part No.
T1	Power transformer	T52-144-B
T2	Ferrite antenna coil	T42-022-C
L1	Choke coil	T24-030-0

SELECTORS

Symbol	Description	Part No.
S1	Selector switch	S13-021-C
S2	Power switch	S11-016-A
S3	Line voltage selector	S11-018-0

OTHERS

Symbol	Description	Part No.
	Tuner assembly	W35-028-C
	Equalizer amplifier assembly	W15-065-B
	Control amplifier assembly	W22-003-0
	Headphone amplifier assembly	W15-057-0
	Switch circuit assembly	W15-072-0
	Power supply assembly	W16-016-B
	Power amplifier assembly	W36-006-A
	Front panel	KNF-003-B
	Dial pulley	M42-041-F
	Dial scale	A33-130-0

Symbol	Description	Part No.	
	Tuning meter assembly	A91-015-0	
	Stereo indicator bracket	A62-049-B	
	Power lamp bracket	A62-059-A	
	Knob(power, bass, treble, balance, volume, selector)	A12-154-A	
	Knob (tuning)	A12-156-A	
	Push knob (demi switch)	A19-078-0	
	Input terminal 6P socket	K22-013-0	
	Output terminal 2P socket	K21-009-D	
	Antenna terminal 4P	K11-018-0	
	AC outlet	K82-007-A	
	Headphone jack	K72-020-0	
	Connector socket 8P	K24-002-0	
	Connector socket (DIN)	K93-003-B	

SPEAKER SYSTEM

Symbol	Description	Part No.	
	Wooden grille (with grille net)	A66-008-A	
	Pilot lamp plate	A45-031-B	
	Speaker cord (8P-plug)	D53-021-B	
	Speaker cord holder	M63-023-B	
	Woofers	20-32F	
	Tweeter	66-47F	
	Pilot lamp 8V 150mA	E22-002-0	
	Power amplifier assembly	W36-006-A	

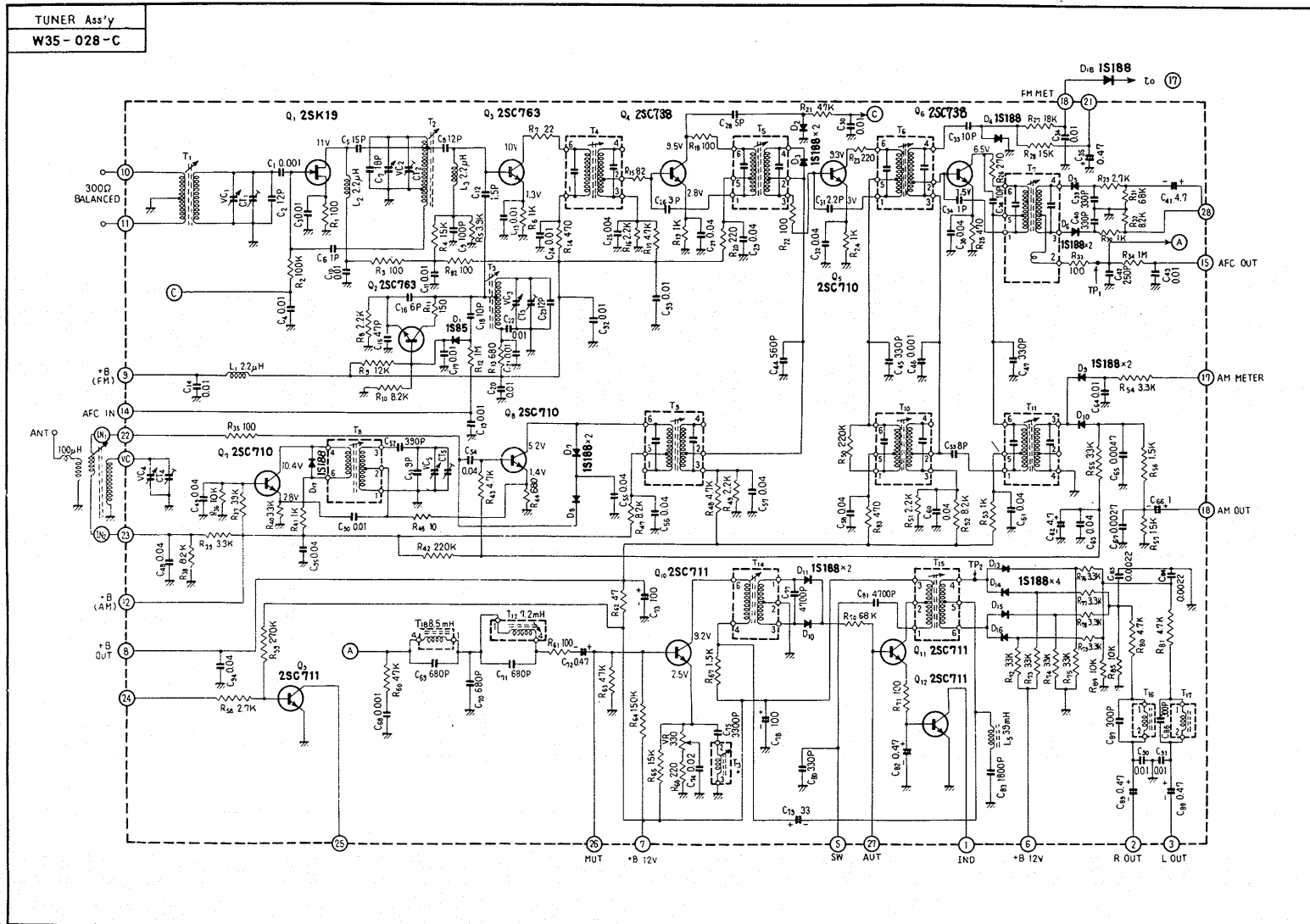

6

Foil Side

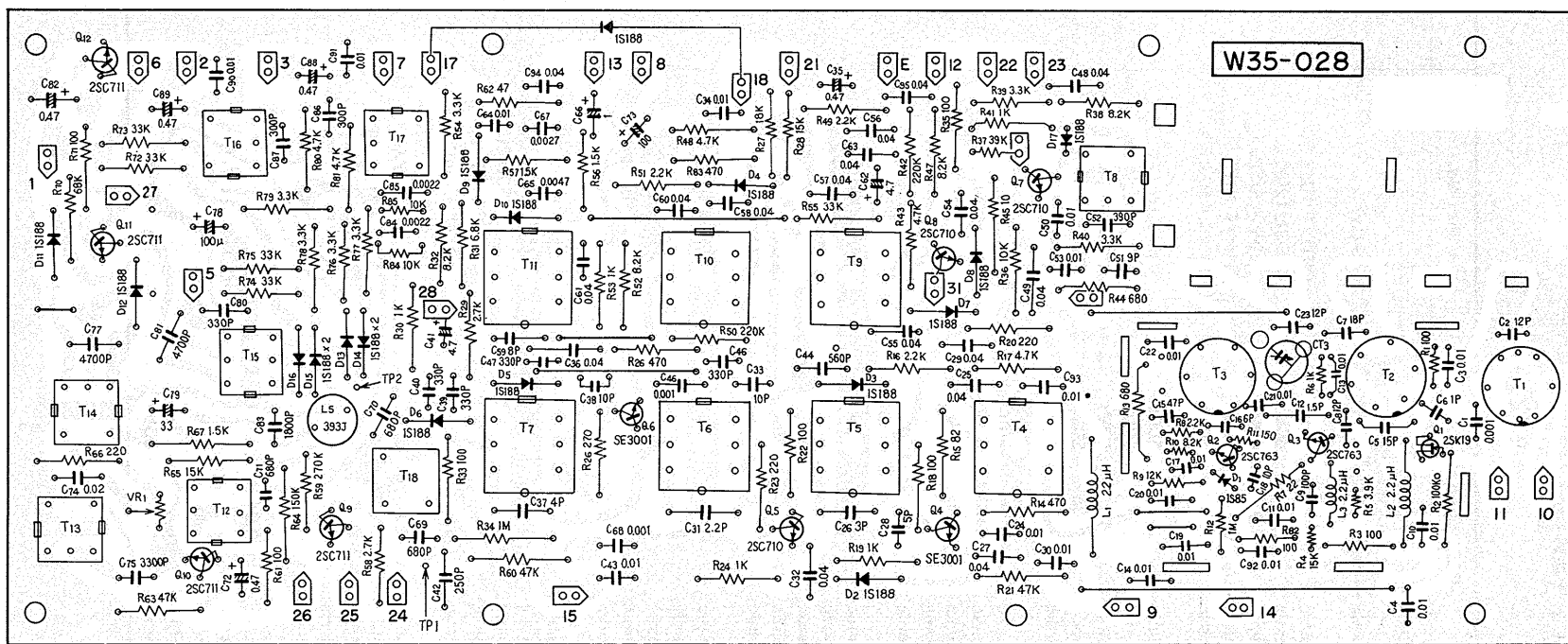

- 2SC763
- 2SC710
- 2SC711
- 2SC738

2SK19

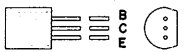
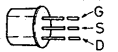

TUNER ASSEMBLY PARTS LIST

CAPACITORS

Symbol	Description	Part No.
VC	Tuning capacitors	C64-042-B
CT3	Ceramic trimmer	C43-007-A
C1	Ceramic 0.001 50V	CKDYF 102Z 50
C2	Ceramic 12p 50V	CCDSL 120K 50
C3	Ceramic 0.01 50V	CKDYF 103Z 50
C4	Ceramic 0.01 50V	CKDYF 103Z 50
C5	Ceramic 15p 50V	CCDSL 150K 50
C6	Ceramic 1 500V	CGB 010K 500
C7	Ceramic 18p 50V	CCDSL 180K 50
C8	Ceramic 12p 50V	CCDSL 120K 50
C9	Ceramic 100p 50V	CCDSL 101K 50
C10	Ceramic 0.01 50V	CKDYF 103Z 50
C11	Ceramic 0.01 50V	CKDYF 103Z 50
C12	Ceramic 1.5 500V	CGB 1R5K 500
C13	Ceramic 0.01 50V	CKDYF 103Z 50
C14	Ceramic 0.01 50V	CKDYF 103Z 50
C15	Ceramic 47p 50V	CCDSL 470K 50
C16	Ceramic 6p 50V	CCDTJ 060D 50
C17	Ceramic 0.01 50V	CKDYF 103Z 50
C18	Ceramic 10p 50V	CCDTJ 100F 50
C19	Ceramic 0.01 50V	CCDYF 103Z 50
C20	Ceramic 0.01 50V	CKDYF 103Z 50
C21	Ceramic 0.01 50V	CKDYB 103K 50
C22	Ceramic 0.01 50V	CKDYB 103K 50
C23	Ceramic 12p 50V	CCDTJ 120K 50
C24	Ceramic 0.01 50V	CKDYF 103Z 50
C25	Ceramic 0.04 50V	CKDYF 403Z 50
C26	Ceramic 3p 50V	CCDSL 030D 50
C27	Ceramic 0.04 50V	CKDYF 403Z 50
C28	Ceramic 5p 50V	CCDSL 050D 50
C29	Ceramic 0.04 50V	CKDYF 403Z 50
C30	Ceramic 0.01 50V	CKDYF 103Z 50
C31	Ceramic 2.2 500V	CGB 2R2K 500
C32	Ceramic 0.047 25V	CKDBC 473Z 25
C33	Ceramic 10p 50V	CCDSL 100K 50
C34	Ceramic 0.01 50V	CKDYF 103Z 50
C35	Electrolytic 0.47 50V	CEA R47P 50
C36	Ceramic 0.047 25V	CKDBC 473Z 25
C37	Ceramic 4p 50V	CCDSL 040D 50
C38	Ceramic 10p 50V	CCDSL 100D 50
C39	Ceramic 330p 50V	CKDYB 331K 50
C40	Ceramic 330p 50V	CKDYB 331K 50

Symbol	Description	Part No.
C41	Electrolytic 4.7 25V	CEA 4R7P 25
C42	Ceramic 250p 50V	CCDSL 251K 50
C43	Ceramic 0.01 50V	CKDYF 103Z 50
C44	Ceramic 560p 50V	CKDYB 561K 50
C45	Ceramic 330p 50V	CKDYB 331K 50
C46	Ceramic 0.001 50V	CKDYB 102K 50
C47	Ceramic 330p 50V	CKDYB 331K 50
C48	Ceramic 0.04 50V	CKDYF 403Z 50
C49	Ceramic 0.04 50V	CKDYF 403Z 50
C50	Mylar 0.01 50V	CQMA 103K 50
C51	Ceramic 9p 50V	CCDSL 090D 50
C52	Styrol 390p 50V	COSA 391K 50
C53	Mylar 0.01 50V	CQMA 103K 50
C54	Ceramic 0.04 50V	CKDYF 403Z 50
C55	Ceramic 0.04 50V	CKDYF 403Z 50
C56	Ceramic 0.04 50V	CKDYF 403Z 50
C57	Ceramic 0.04 50V	CKDYF 403Z 50
C58	Ceramic 0.04 50V	CKDYF 403Z 50
C59	Ceramic 8p 50V	CCDSL 080F 50
C60	Ceramic 0.04 50V	CKDYF 403Z 50
C61	Ceramic 0.04 50V	CKDYF 403Z 50
C62	Electrolytic 4.7 25V	CEA 4R7P 25
C63	Ceramic 0.04 50V	CKDYF 403Z 50
C64	Ceramic 0.01 50V	CKDYF 103Z 50
C65	Mylar 0.0047 50V	CQMA 472K 50
C66	Electrolytic 1 50V	CEA 010P 50
C67	Mylar 0.0027 50V	CQMA 272K 50
C68	Ceramic 0.001 50V	CKDYB 102K 50
C70	Styrol 680p 50V	COSA 681J 50
C72	Electrolytic 0.47 50V	CEA R47P 50
C73	Electrolytic 100 16V	CEA 101P 16
C74	Mylar 0.02 50V	CQMA 203K 50
C75	Styrol 0.0033 50V	C15-011-A
C77	Styrol 0.0047 50V	C15-013-A
C78	Electrolytic 100 16V	CEA 101P 16
C79	Electrolytic 33 16V	CEA 330P 16
C80	Ceramic 330p 50V	CKDYB 331K 50
C81	Styrol 0.0047 50V	C15-013-A
C82	Electrolytic 0.47 50V	CEA R47P 50
C83	Styrol 0.0018 50V	COSA 182J 50
C84	Mylar 0.0022 50V	CQMA 222K 50
C85	Mylar 0.0022 50V	CQMA 222K 50
C88	Electrolytic 0.47 50V	CEA R47P 50
C89	Electrolytic 0.47 50V	CEA R47P 50
C90	Mylar 0.01 50V	CQMA 103K 50
C91	Mylar 0.01 50V	CQMA 103K 50
C92	Ceramic 0.01 50V	CKDYF 103Z 50
C93	Ceramic 0.01 50V	CKDYF 103Z 50
C94	Ceramic 0.04 50V	CKDYF 403Z 50
C95	Ceramic 0.04 50V	CKDYF 403Z 50

RESISTORS

Symbol	Description	Part No.
VR1	Semi-fixed	C92-065-A
R1	Carbon film 100	RD¼VS 101J
R2	Carbon film 100	RD¼PS 101J
R3	Carbon film 100	RD¼VS 101J
R4	Carbon film 15k	RD¼VS 153J
R5	Carbon film 3.9k	RD¼VS 392J
R6	Carbon film 1k	RD¼VS 102J
R7	Carbon film 22	RD¼PS 220J
R8	Carbon film 2.2k	RD¼VS 222J
R9	Carbon film 12k	RD¼VS 123J
R10	Carbon film 8.2k	RD¼VS 822J
R11	Carbon film 150	RD¼VS 151J
R12	Carbon film 1M	RD¼VS 105J
R13	Carbon film 680	RD¼PS 681J
R14	Carbon film 470	RD¼PS 471J
R15	Carbon film 82	RD¼PS 820J
R16	Carbon film 2.2k	RD¼PS 222J
R17	Carbon film 4.7k	RD¼PS 472J
R18	Carbon film 100	RD¼PS 101J
R19	Carbon film 1k	RD¼PS 102J
R20	Carbon film 220	RD¼PS 221J
R21	Carbon film 47k	RF¼PS 473J
R22	Carbon film 100	RD¼PS 101J
R23	Carbon film 220	RD¼PS 221J
R24	Carbon film 1k	RD¼PS 102J
R25	Carbon film 470	RD¼PS 471J
R26	Carbon film 270	RD¼PS 271J
R27	Carbon film 18k	RD¼PS 183J
R28	Carbon film 1.5k	RD¼PS 152J
R29	Carbon film 2.7k	RD¼PS 272J
R30	Carbon film 1k	RD¼PS 102J
R31	Carbon film 6.8k	RD¼PS 682J
R32	Carbon film 8.2k	RD¼PS 822J
R33	Carbon film 100	RD¼PS 101J
R34	Carbon film 1M	RD¼PS 105J
R35	Carbon film 100	RD¼PS 101J
R36	Carbon film 10k	RD¼PS 103J
R37	Carbon film 39k	RD¼VS 393J
R38	Carbon film 6.8k	RD¼PS 682J
R39	Carbon film 3.3k	RD¼PS 332J
R40	Carbon film 3.3k	RD¼PS 332J
R41	Carbon film 1k	RD¼PS 102J
R42	Carbon film 220k	RD¼PS 224J
R43	Carbon film 4.7k	RD¼PS 472J
R44	Carbon film 680	RD¼PS 681J
R45	Carbon film 10	RD¼PS 100J

Symbol	Description	Part No.
R47	Carbon film 8.2k	RD¼PS 822J
R48	Carbon film 4.7k	RD¼PS 472J
R49	Carbon film 2.2k	RD¼PS 222J
R50	Carbon film 220k	RD¼PS 224J
R51	Carbon film 2.2k	RD¼PS 222J
R52	Carbon film 8.2k	RD¼PS 822J
R53	Carbon film 1k	RD¼PS 102J
R54	Carbon film 3.3k	RD¼PS 332J
R55	Carbon film 33k	RD¼PS 333J
R56	Carbon film 1.5k	RD¼PS 152J
R57	Carbon film 1.5k	RD¼PS 152J
R58	Carbon film 2.7k	RD¼PS 272J
R59	Carbon film 270k	RD¼PS 274J
R60	Carbon film 47k	RD¼PS 473J
R61	Carbon film 100	RD¼PS 101J
R62	Carbon film 47	RD¼PS 470J
R63	Carbon film 47k	RD¼PS 473J
R64	Carbon film 150k	RD¼PS 154J
R65	Carbon film 1.5k	RD¼PS 152J
R66	Carbon film 220	RD¼PS 221J
R67	Carbon film 1.5k	RD¼PS 152J
R70	Carbon film 4.7k	RD¼PS 472J
R71	Carbon film 100	RD¼PS 101J
R72	Carbon film 33k	RD¼PS 333J
R73	Carbon film 33k	RD¼PS 333J
R74	Carbon film 33k	RD¼PS 333J
R75	Carbon film 33k	RD¼PS 333J
R76	Carbon film 3.3k	RD¼PS 332J
R77	Carbon film 3.3k	RD¼PS 332J
R78	Carbon film 3.3k	RD¼PS 332J
R79	Carbon film 3.3k	RD¼PS 332J
R80	Carbon film 4.7k	RD¼PS 472J
R81	Carbon film 4.7k	RD¼PS 472J
R82	Carbon film 100	RD¼VS 101J
R83	Carbon film 470	RD¼PS 471J
R84	Carbon film 10k	RD¼VS 103J
R85	Carbon film 10k	RD¼VS 103J

SEMICONDUCTORS

Symbol	Description	Part No.
Q1	2SK19-Y FET	
Q2	2SC763-D Transistor	
Q3	2SC763-D Transistor	
Q4	2SC738-D Transistor	
Q5	2SC710R-D Transistor	
Q6	2SC738-D Transistor	
Q7	2SC710-D Transistor	
Q8	2SC710-D Transistor	
Q9	2SC711-F Transistor	
Q10	2SC711-E Transistor	

Symbol	Description	Part No.
Q11	2SC711-E	Transistor
Q12	2SC711-F	Transistor
D1	1S85	Diode
D2	1S188 FM-1	Diode
D3	1S188 FM-1	Diode
D4	1S188 FM-1	Diode
D5	1S188 FM-1	Diode
D6	1S188 FM-1	Diode
D7	1S188 FM-1	Diode
D8	1S188 FM-1	Diode
D9	1S188 FM-1	Diode
D10	1S188 FM-1	Diode
D11	1S188 FM-1	Diode
D12	1S188 FM-1	Diode
D13	1S188 FM-1	Diode
D14	1S188 FM-1	Diode
D15	1S188 FM-1	Diode
D16	1S188 FM-1	Diode
D17	1S188 FM-1	Diode
D18	1S188 FM-1	Diode

TRANSFORMERS and COILS

Symbol	Description	Part No.
T1	FM antenna coil	T22-020-A
T2	FM RF coil	T21-023-A
T3	FM osc coil	T23-043-B
T4	FM IF transformer	T73-034-0
T5	FM IF transformer	T73-035-A
T6	FM IF transformer	T73-036-0
T7	FM IF transformer	T74-011-0
T8	AM osc coil	T43-006-0
T9	AM IF transformer	T71-028-0
T10	AM IF transformer	T71-028-0
T11	AM IF transformer	T72-022-0
T12	SCA filter	ATM-006-0
T13	19kHz transformer	T75-023-B
T14	19kHz transformer	T75-024-B
T15	38kHz transformer	T75-025-B
T16	38kHz leak filter	ATM-004-0
T17	38kHz leak filter	ATM-004-0
T18	SCA filter	ATM-007-0
L1	RF choke coil	T24-028-A
L2	RF choke coil	T24-028-A
L3	RF choke coil	T24-028-A
L5	Coil 39 mH	T75-006-B

2.3 EQUALIZER AMPLIFIER ASSEMBLY (W15-065)

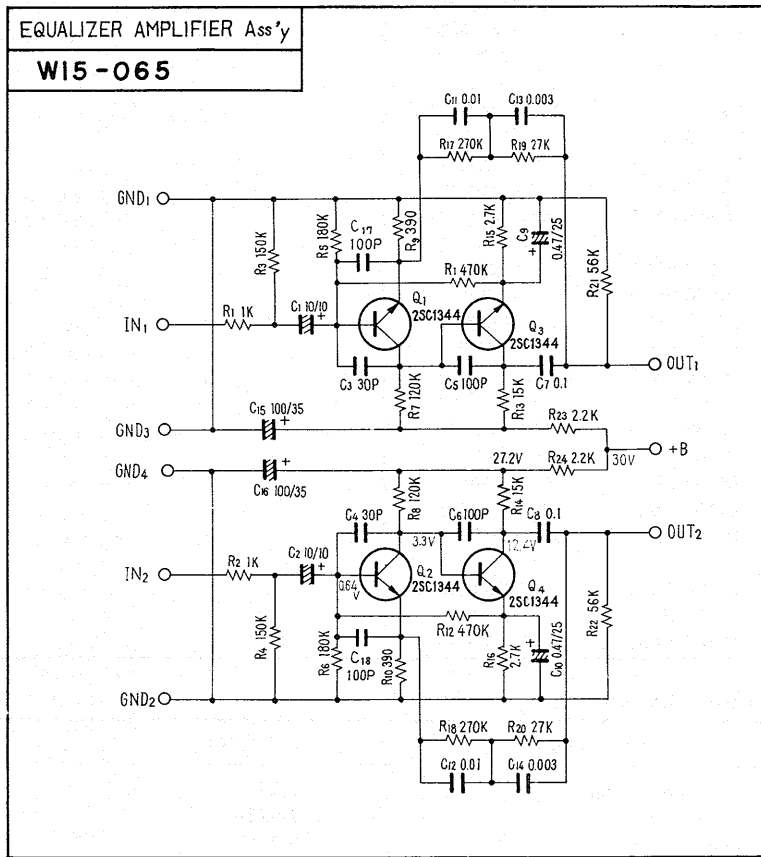

Foil Side

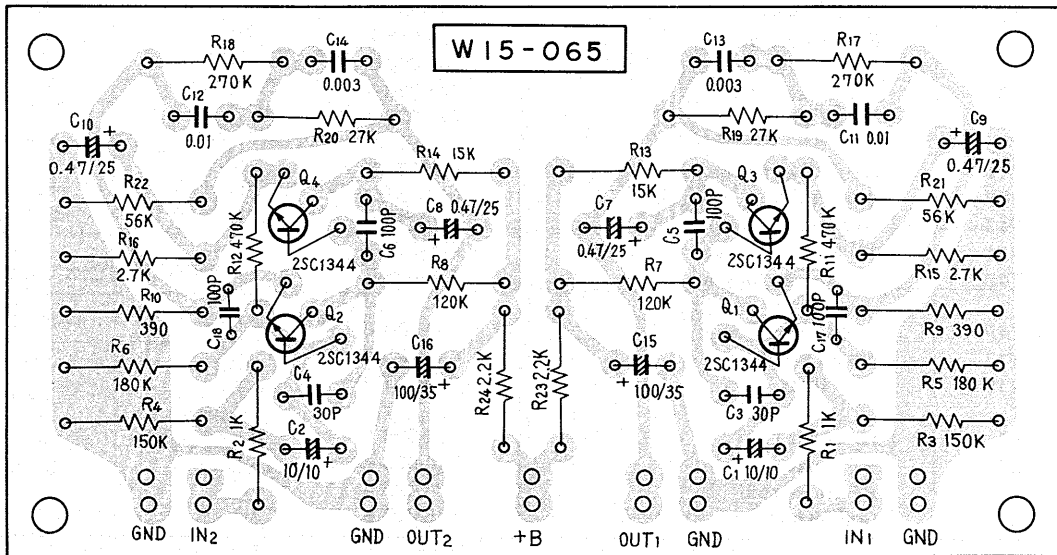

2SC1344

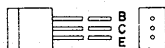

CAPACITORS

Symbol	Description		Part No.
C1	Electrolytic	10 10V	CEA 100P 10
C2	Electrolytic	10 10V	CEA 100P 10
C3	Ceramic	30p 50V	CCDSL 300K 50
C4	Ceramic	30p 50V	CCDSL 300K 50
C5	Ceramic	100p 50V	CCDSL 101K 50
C6	Ceramic	100p 50V	CCDSL 101K 50
C7	Mylar	0.1 50V	CQMA 104K 50
C8	Mylar	0.1 50V	CQMA 104K 50
C9	Electrolytic	0.47 25V	CSYA R47M 25
C10	Electrolytic	0.47 25V	CSYA R47M 25
C11	Mylar	0.01 50V	CQMA 103M 50
C12	Mylar	0.01 50V	CQMA 103M 50
C13	Mylar	0.003 50V	CQMA 302M 50
C14	Mylar	0.003 50V	CQMA 302M 50
C15	Electrolytic	100 35V	CEA 101P 35
C16	Electrolytic	100 35V	CEA 101P 35
C17	Ceramic	100p 50V	CCDSL 101K 50
C18	Ceramic	100p 50V	CCDSL 101K 50

RESISTORS

Symbol	Description		Part No.
R1	Carbon film	1k	RD $\frac{1}{4}$ PS 102J
R2	Carbon film	1k	RD $\frac{1}{4}$ PS 102J
R3	Carbon film	150k	RD $\frac{1}{4}$ PS 154J
R4	Carbon film	150k	RD $\frac{1}{4}$ PS 154J
R5	Carbon film	180k	RD $\frac{1}{4}$ PS 184J
R6	Carbon film	180k	RD $\frac{1}{4}$ PS 184J
R7	Carbon film	120k	RD $\frac{1}{4}$ PS 124J
R8	Carbon film	120k	RD $\frac{1}{4}$ PS 124J
R9	Carbon film	390	RD $\frac{1}{4}$ PS 391J
R10	Carbon film	390	RD $\frac{1}{4}$ PS 391J
R11	Carbon film	470k	RD $\frac{1}{4}$ PS 474J
R12	Carbon film	470k	RD $\frac{1}{4}$ PS 474J
R13	Carbon film	15k	RD $\frac{1}{4}$ PS 153J
R14	Carbon film	15k	RD $\frac{1}{4}$ PS 153J
R15	Carbon film	2.7k	RD $\frac{1}{4}$ PS 272J
R16	Carbon film	2.7k	RD $\frac{1}{4}$ PS 272J
R17	Carbon film	270k	RD $\frac{1}{4}$ PS 274J
R18	Carbon film	270k	RD $\frac{1}{4}$ PS 274J
R19	Carbon film	27k	RD $\frac{1}{4}$ PS 273J
R20	Carbon film	27k	RD $\frac{1}{4}$ PS 273J
R21	Carbon film	56k	RD $\frac{1}{4}$ PS 563J
R22	Carbon film	56k	RD $\frac{1}{4}$ PS 563J
R23	Carbon film	2.2k	RD $\frac{1}{4}$ PS 222J
R24	Carbon film	2.2k	RD $\frac{1}{4}$ PS 222J

TRANSISTORS

Symbol	Description		Part No.
Q1	2SC1344-E	Transistor	
Q2	2SC1344-E	Transistor	
Q3	2SC1344-E	Transistor	
Q4	2SC1344-E	Transistor	

2.4 SWITCH CIRCUIT ASSEMBLY (W15-072)

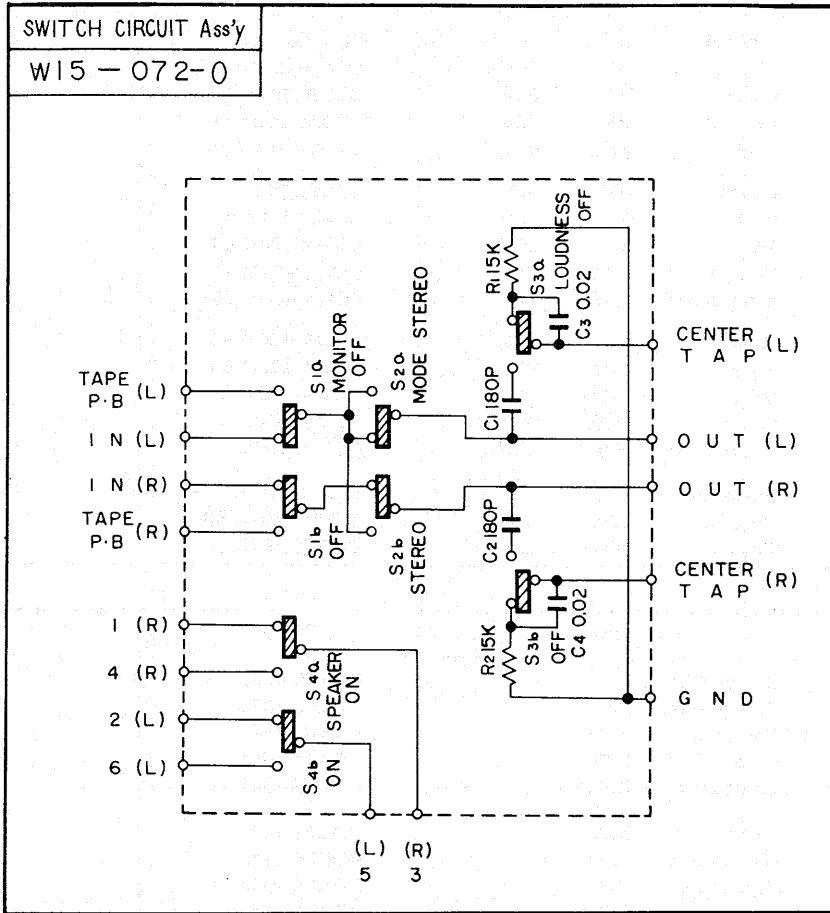

Foil Side

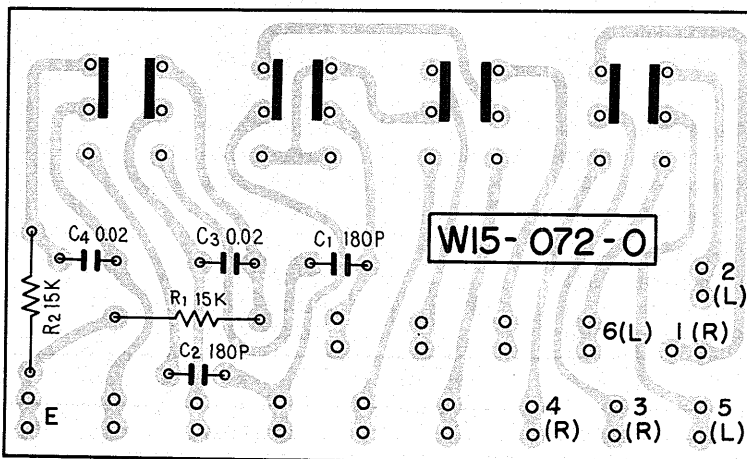

PARTS LIST

Symbol	Description			Part No.	
C1	Ceramic	180p	50V	CCDSL 181K 50	
C2	Ceramic	180p	50V	CCDSL 181K 50	
C3	Mylar	0.02	50V	CQMA 203K 50	
C4	Mylar	0.02	50V	CQMA 203K 50	
R1	Carbon film	15k		RD¼PS 153K	
R2	Carbon film	15k		RD¼PS 153K	
S1	Demi Switch			S31-016-A	
S2	Demi Switch			S31-016-A	
S3	Demi Switch			S31-016-A	
S4	Demi Switch			S31-016-A	

2.5 HEADPHONE AMPLIFIER ASSEMBLY (W15-057)

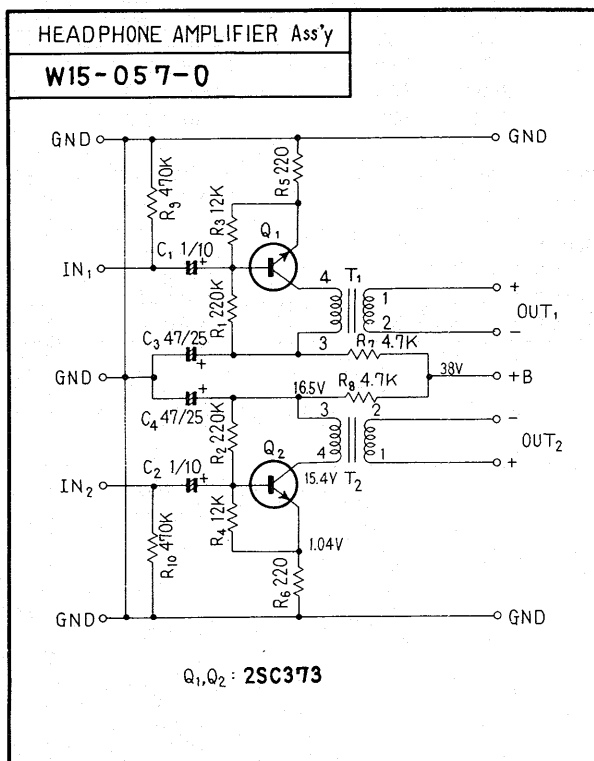

Foil Side

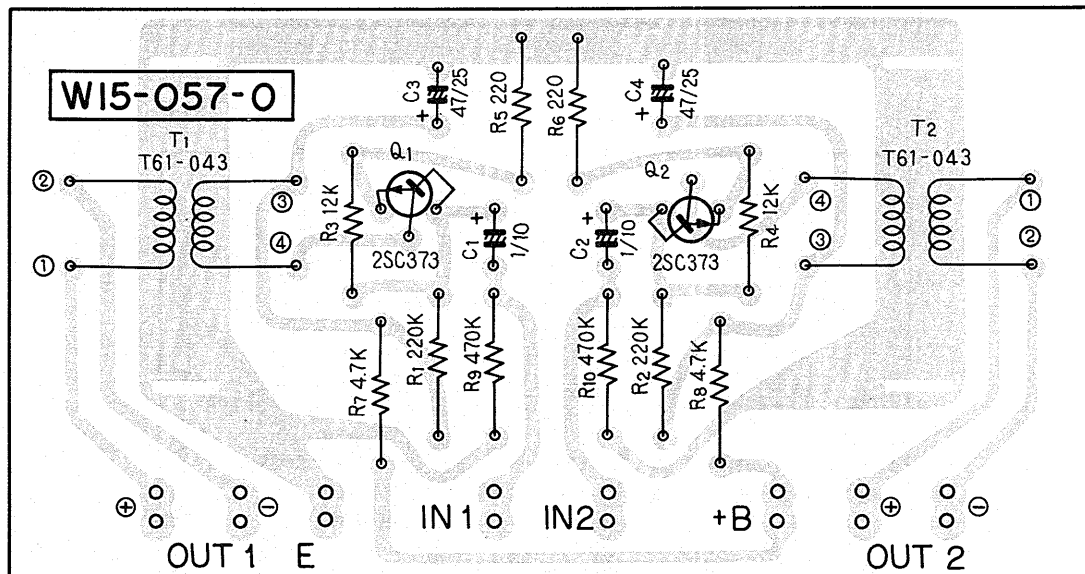

2SC373

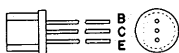

CAPACITORS

Symbol	Description	Part No.
C1	Electrolytic 1 10V	CEA 010P 10
C2	Electrolytic 1 10V	CEA 010P 10
C3	Electrolytic 47 25V	CEA 470P 25
C4	Electrolytic 47 25V	CEA 470P 25

RESISTORS

Symbol	Description	Part No.
R1	Carbon film 220k	RD¼PS 224K
R2	Carbon film 220k	RD¼PS 224k
R3	Carbon film 12k	RD¼PS 123k
R4	Carbon film 12k	RD¼PS 123K
R5	Carbon film 220	RD¼PS 221K
R6	Carbon film 220	RD¼PS 221K
R7	Carbon film 2.7k	RD¼PS 272K
R8	Carbon film 2.7k	RD¼PS 272K
R9	Carbon film 470k	RD¼PS 474K
R10	Carbon film 470k	RD¼PS 474K

TRANSISTORS

Symbol	Description	Part No.
Q1	2SC373 Transistor	
Q2	2SC373 Transistor	

TRANSFORMERS

Symbol	Description	Part No.
T1	Transformer	T61-043-B
T2	Transformer	T61-043-B

2.6 CONTROL AMPLIFIER ASSEMBLY (W22-003)

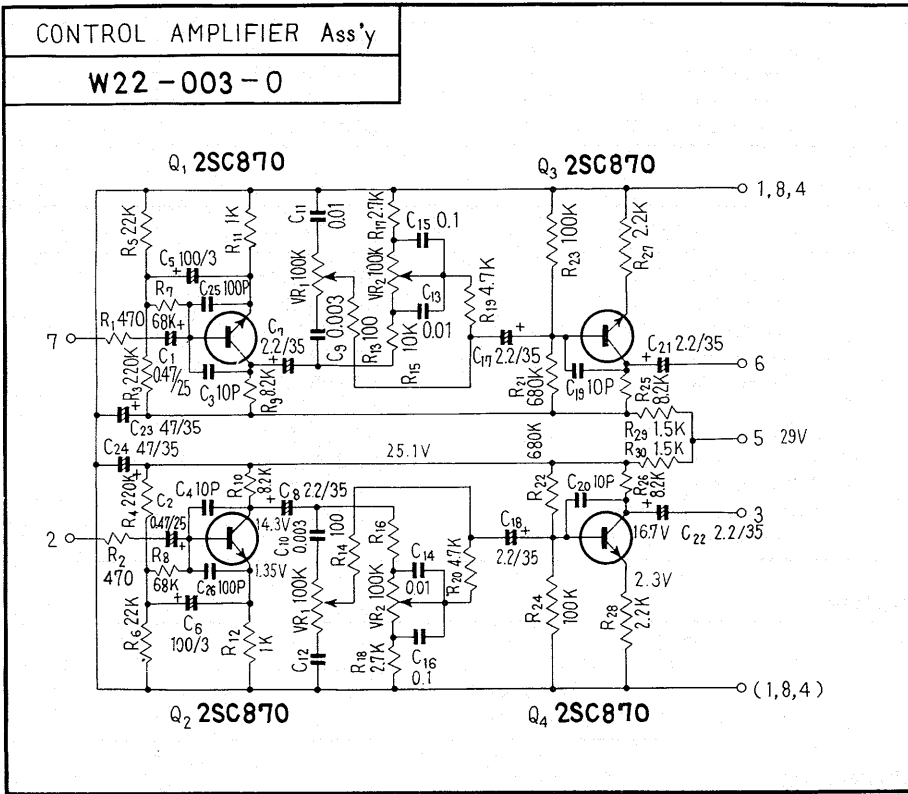

Foil Side

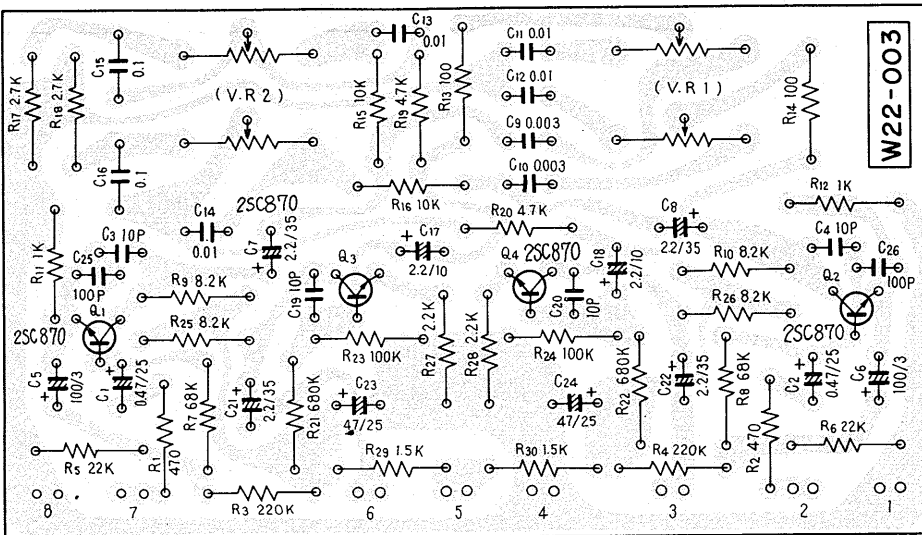

2SC870

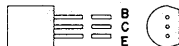

CAPACITORS

Symbol	Description	Part No.
C1	Electolytic 0.47 25V	CEA R47P 25
C2	Electolytic 0.47 25V	CEA R47P 25
C3	Ceramic 10p 50V	CCDSL 100K 50
C4	Ceramic 10p 50V	CCDSL 100K 50
C5	Electolytic 100 3V	CEA 101P 3
C6	Electolytic 100 3V	CEA 101P 3
C7	Electolytic 2.2 35V	CEA 2R2P 35
C8	Electolytic 2.2 35V	CEA 2R2P 35
C9	Mylar 0.003 50V	CQMA 302M 50
C10	Mylar 0.003 50V	CQMA 302M 50
C11	Mylar 0.01 50V	CQMA 103M 50
C12	Mylar 0.01 50V	CQMA 103M 50
C13	Mylar 0.01 50V	CQMA 103M 50
C14	Mylar 0.01 50V	CQMA 103M 50
C15	Mylar 0.1 50V	CQMA 104M 50
C16	Mylar 0.1 50V	CQMA 104M 50
C17	Electolytic 2.2 35V	CEA 2R2P 35
C18	Electolytic 2.2 35V	CEA 2R2P 35
C19	Ceramic 10p 50V	CCDSL 100K 50
C20	Ceramic 10p 50V	CCDSL 100K 50
C21	Electolytic 2.2 35V	CEA 2R2P 35
C22	Electolytic 2.2 35V	CEA 2R2P 35
C23	Electolytic 47 35V	CEA 470P 35
C24	Electolytic 47 35V	CEA 470P 35
C25	Ceramic 100p 50V	CCDSL 101K 50
C26	Ceramic 100p 50V	CCDSL 101K 50

RESISTORS

Symbol	Description	Part No.
VR1	Dual 100K-B	C82-046-A
VR2	Dual 100K-B	C82-046-A
R1	Carbon film 470	RD½PS 471K
R2	Carbon film 470	RD½PS 471K
R3	Carbon film 220k	RD½PS 224K
R4	Carbon film 220k	RD½PS 224K
R5	Carbon film 22k	RD½PS 223K
R6	Carbon film 22k	RD½PS 223K
R7	Carbon film 68k	RD½PS 683K
R8	Carbon film 68k	RD½PS 683K
R9	Carbon film 8.2k	RD½PS 822K
R10	Carbon film 8.2k	RD½PS 822K
R11	Carbon film 1k	RD½PS 102K
R12	Carbon film 1k	RD½PS 102K
R13	Carbon film 100	RD½PS 101K
R14	Carbon film 100	RD½PS 101K
R15	Carbon film 10k	RD½PS 103K

Symbol	Description	Part No.
R16	Carbon film 10k	RD¼PS 103K
R17	Carbon film 2.7k	RD¼PS 272k
R18	Carbon film 2.7k	RD¼PS 272K
R19	Carbon film 4.7k	RD¼PS 472K
R20	Carbon film 4.7k	RD¼PS 472K
R21	Carbon film 680k	RD¼PS 684K
R22	Carbon film 680k	RD¼PS 684K
R23	Carbon film 100k	RD¼PS 104K
R24	Carbon film 100k	RD¼PS 104K
R25	Carbon film 8.2k	RD¼PS 822K
R26	Carbon film 8.2k	RD¼PS 822K
R27	Carbon film 2.2k	RD¼PS 222K
R28	Carbon film 2.2k	RD¼PS 222K
R29	Carbon film 1.5k	RD¼PS 152K
R30	Carbon film 1.5k	RD¼PS 152K

TRANSISTORS

Symbol	Description	Part No.
Q1	2SC870-BL Transistor	
Q2	2SC870-BL Transistor	
Q3	2SC870-BL Transistor	
Q4	2SC870-BL Transistor	

2.7 POWER AMPLIFIER ASSEMBLY (W36-006)

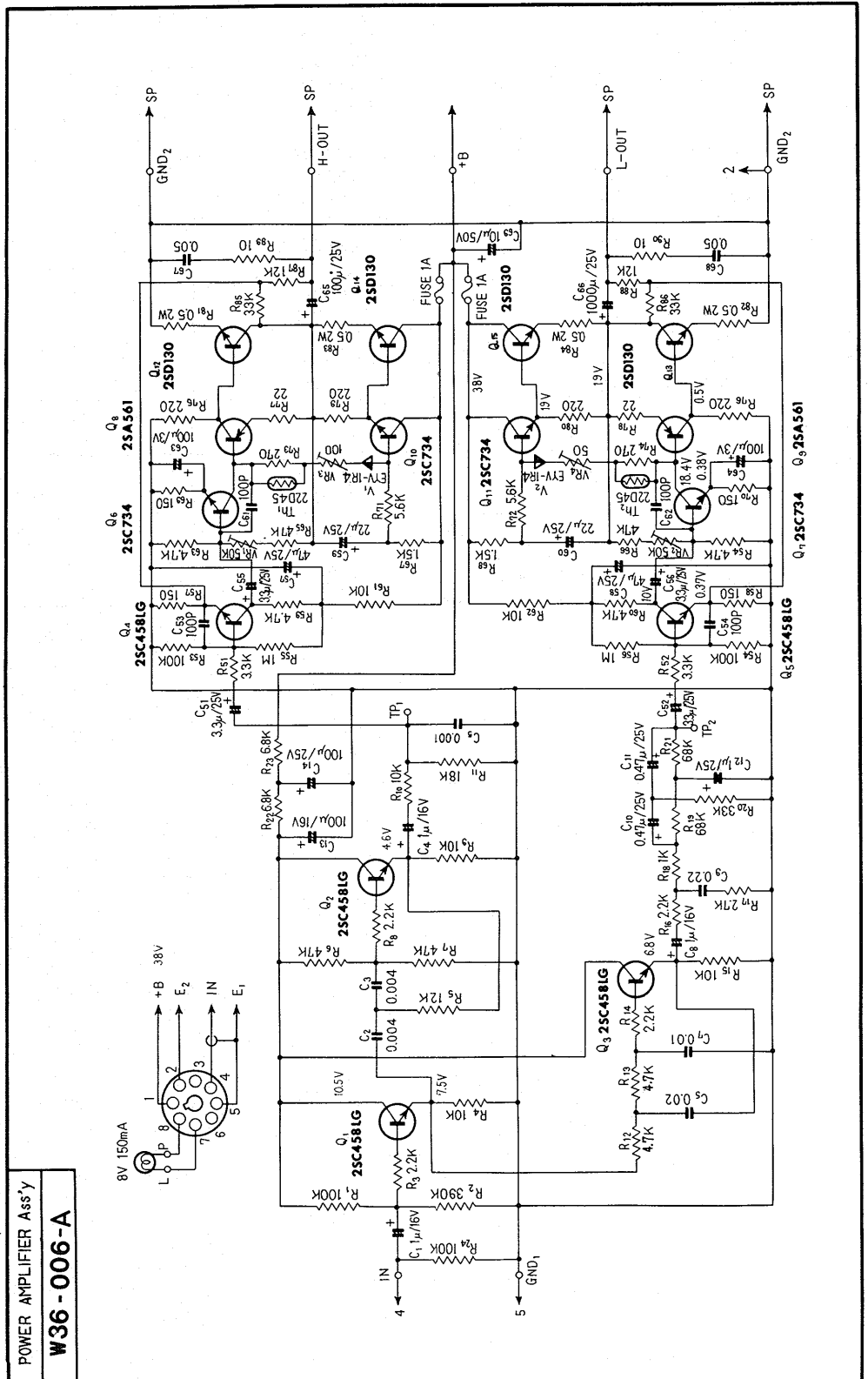

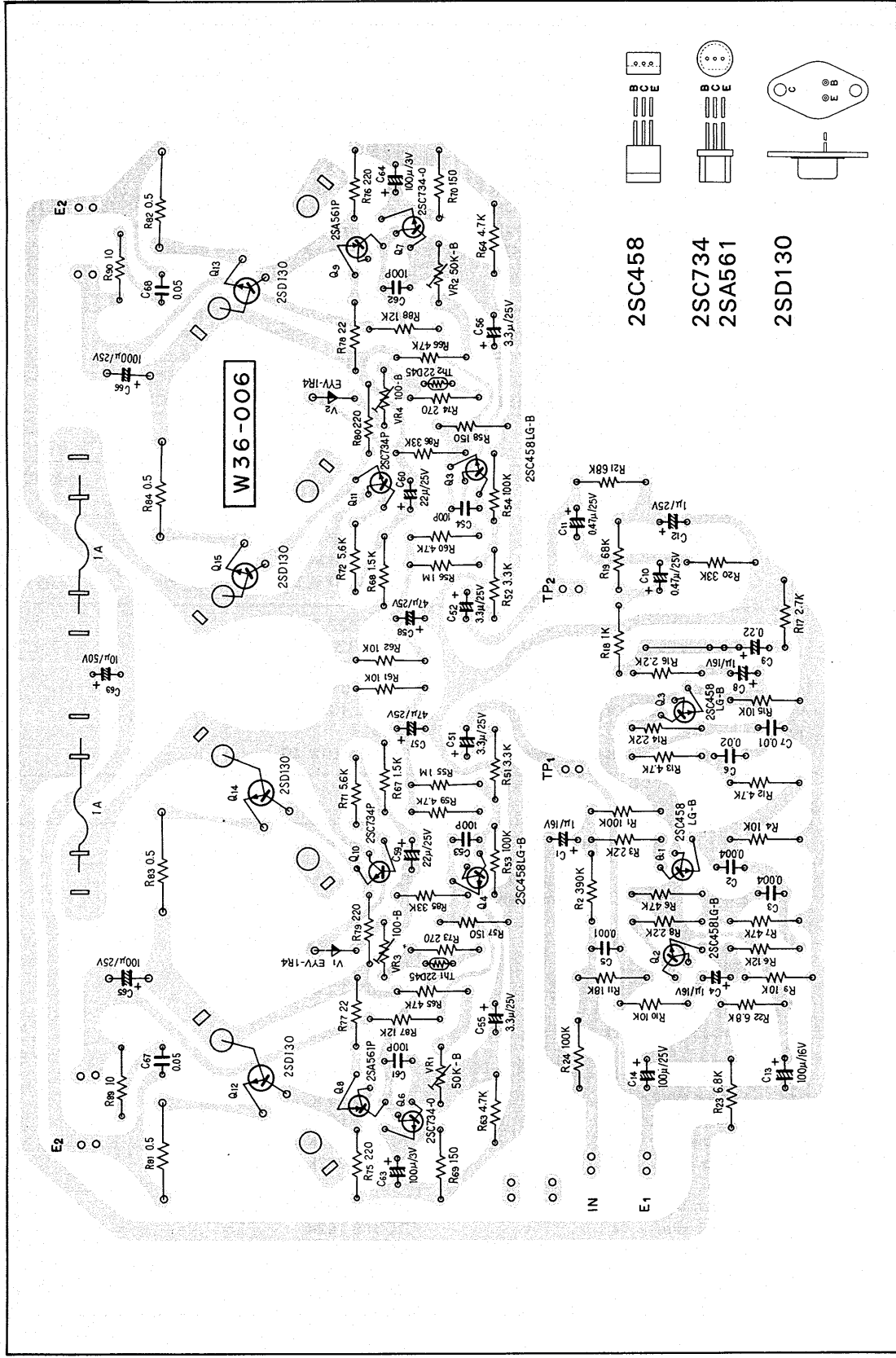

CAPACITORS

Symbol	Description	Part No.
C1	Electrolytic 1 16V	CEA 010P 16
C2	Mylar 0.004 50V	CQMA 402K 50
C3	Mylar 0.004 50V	CQMA 402K 50
C4	Electrolytic 1 16V	CEA 010P 16
C5	Mylar 0.001 50V	CQMA 102K 50
C6	Mylar 0.02 50V	CQMA 203K 50
C7	Mylar 0.01 50V	CQMA 103K 50
C8	Electrolytic 1 16V	CEA 010P 16
C9	Electrolytic 0.22 25V	CSYA R22M 25
C10	Electrolytic 0.47 25V	CSYA R47M 25
C11	Electrolytic 0.47 25V	CSYA R47M 25
C12	Electrolytic 1 25V	CSYA 010M 25
C13	Electrolytic 10 16V	CEA 100P 16
C14	Electrolytic 10 25V	CEA 100P 25
C51	Electrolytic 3.3 25V	CEA 3R3P 25
C52	Electrolytic 3.3 25V	CEA 3R3P 25
C53	Ceramic 100p 50V	CCDSL 101K 50
C54	Ceramic 100p 50V	CCDSL 101K 50
C55	Electrolytic 3.3 25V	CEA 3R3P 25
C56	Electrolytic 3.3 25V	CEA 3R3P 25
C57	Electrolytic 47 25V	CEA 470P 25
C58	Electrolytic 47 25V	CEA 470P 25
C59	Electrolytic 22 25V	CEA 220P 25
C60	Electrolytic 22 25V	CEA 220P 25
C61	Ceramic 100p 50V	CCDSL 101K 50
C62	Ceramic 100p 50V	CCDSL 101K 50
C63	Electrolytic 100 3V	CEA 101P 3
C64	Electrolytic 100 3V	CEA 101P 3
C65	Electrolytic 10 25V	CEA 100P 25
C66	Electrolytic 1000 25V	CEA 102P 25
C67	Mylar 0.05 50V	CQMA 503K 50
C68	Mylar 0.05 50V	CQMA 503K 50

RESISTORS

Symbol	Description	Part No.
VR1	Semi-fixed (50K-B)	C92-040-0
VR2	Semi-fixed (50K-B)	C92-040-0
VR3	Semi-fixed (100-B)	C92-032-D
VR4	Semi-fixed (100-B)	C92-032-D
R1	Carbonfilm 100k	RD¼PS 104J
R2	Carbon film 390k	RD¼PS 394J
R3	Carbon film 2.2k	RD¼PS 222J
R4	Carbon film 10k	RD¼PS 103J
R5	Carbon film 12k	RD¼PS 123J
R6	Carbon film 47k	RD¼PS 473J
R7	Carbon film 47k	RD¼PS 473J
R8	Carbon film 2.2k	RD¼PS 222J
R9	Carbon film 10k	RD¼PS 103J
R10	Carbon film 10k	RD¼PS 103J

Symbol	Description	Part No.
R11	Carbon film 18k	RD¼PS 183J
R12	Carbon film 4.7k	RD¼PS 4R7J
R13	Carbon film 4.7k	RD¼PS 4R7J
R14	Carbon film 2.2k	RD¼PS 2R2J
R15	Carbon film 10k	RD¼PS 103J
R16	Carbon film 2.2k	RD¼PS 222J
R17	Carbon film 2.7k	RD¼PS 272J
R18	Carbon film 1k	RD¼PS 102J
R19	Carbon film 68k	RD¼PS 683J
R20	Carbon film 33k	RD¼PS 333J
R21	Carbon film 68k	RD¼PS 683J
R22	Carbon film 6.8k	RD¼PS 682J
R23	Carbon film 6.8k	RD¼PS 682J
R24	Carbon film 100k	RD¼PS 104J
R51	Carbon film 3.3k	RD¼PS 332J
R52	Carbon film 3.3k	RD¼PS 332J
R53	Carbon film 100k	RD¼PS 104J
R54	Carbon film 100k	RD¼PS 104J
R55	Carbon film 1M	RD¼PS 105J
R56	Carbon film 1M	RD¼PS 105J
R57	Carbon film 150	RD¼PS 151J
R58	Carbon film 150	RD¼PS 151J
R59	Carbon film 4.7k	RD¼PS 472J
R60	Carbon film 4.7k	RD¼PS 472J
R61	Carbon film 10k	RD¼PS 103J
R62	Carbon film 10k	RD¼PS 103J
R63	Carbon film 4.7k	RD¼PS 472J
R64	Carbon film 4.7k	RD¼PS 472J
R65	Carbon film 47k	RD¼PS 473J
R66	Carbon film 47k	RD¼PS 473J
R67	Carbon film 1.5k	RD¼PS 152J
R68	Carbon film 1.5k	RD¼PS 152J
R69	Carbon film 150	RD¼PS 151J
R70	Carbon film 150	RD¼PS 151J
R71	Carbon film 5.6k	RD¼PS 562J
R72	Carbon film 5.6k	RD¼PS 562J
R73	Carbon film 270	RD¼PS 271J
R74	Carbon film 270	RD¼PS 271J
R75	Carbon film 220	RD¼PS 221J
R76	Carbon film 220	RD¼PS 221J
R77	Carbon film 22	RD¼PS 220J
R78	Carbon film 22	RD¼PS 220J
R79	Carbon film 220	RD¼PS 221J
R80	Carbon film 220	RD¼PS 221J
R81	Metal oxide 0.5 2W	RS2P OR5K
R82	Metal oxide 0.5 2W	RS2P OR5K
R83	Metal oxide 0.5 2W	RS2P OR5K
R84	Metal oxide 0.5 2W	RS2P OR5K
R85	Carbon film 33k	RD¼PS 333J
R86	Carbon film 33k	RD¼PS 333J

Symbol	Description	Part No.
R87	Carbon film 12k	RD½PS 123J
R88	Carbon film 12k	RD½PS 123J
R89	Carbon film 10	RD½PS 100J
R90	Carbon film 10	RD½PS 100J

SEMICONDUCTORS

Symbol	Description	Part No.
Q1	2SC458LG-C Transistor	
Q2	2SC458LG-C Transistor	
Q3	2SC458LG-C Transistor	
Q4	2SC458LG-C Transistor	
Q5	2SC458LG-C Transistor	
Q6	2SC734-Y Transistor	
Q7	2SC734-Y Transistor	
Q8	2SA561P Transistor	
Q9	2SA561P Transistor	
Q10	2SC734P Transistor	
Q11	2SC734P Transistor	
Q12	2SD130 Transistor	
Q13	2SD130 Transistor	
Q14	2SD130 Transistor	
Q15	2SD130 Transistor	
V1	Varistor EYV-1R4	
V2	Varistor EYV-1R4	
Th1	Thermistor 22D45	
Th2	Thermistor 22D45	

2.8 POWER SUPPLY CIRCUIT ASSEMBLY (W16-016)

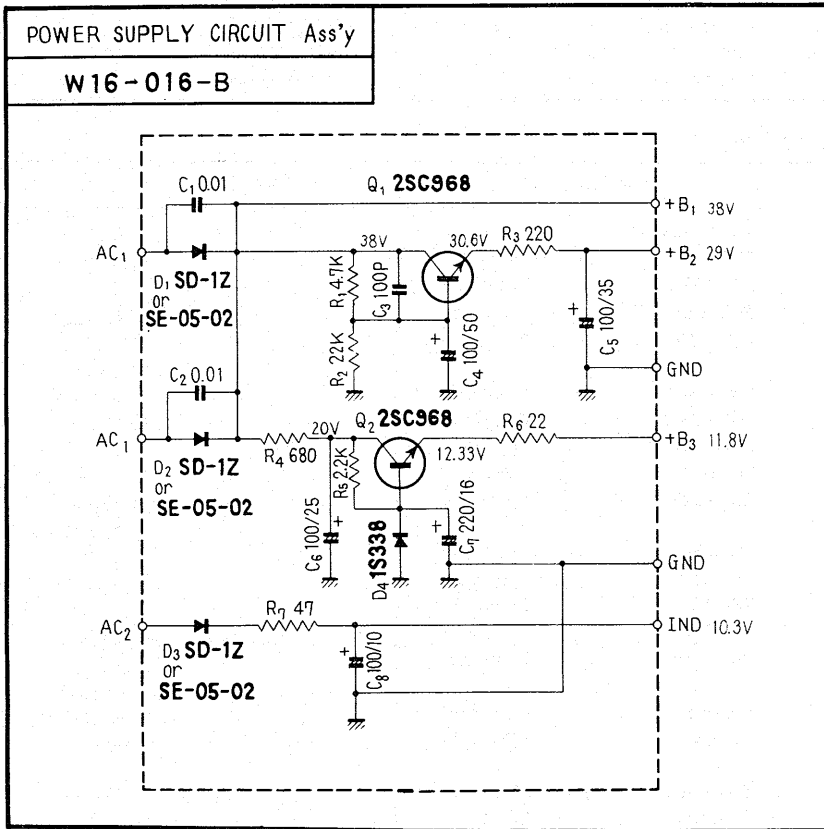

Foil Side

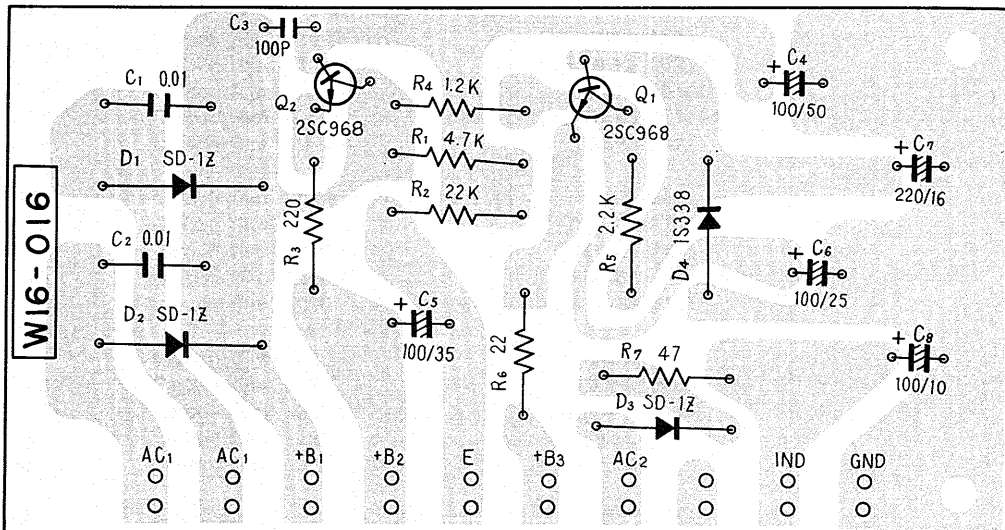

2SC968

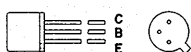

CAPACITORS

Symbol	Description			Part No.
C1	Ceramic	0.01	DC 1.4kV	ACG-004-0
C2	Ceramic	0.01	DC 1.4kV	ACG-004-0
C3	Ceramic	100p	50V	CCDSL 101K 50
C4	Electrolytic	100	50V	CEA 101P 50
C5	Electrolytic	100	35V	CEA 101P 35
C6	Electrolytic	100	25V	CEA 101P 25
C7	Electrolytic	220	16V	CEA 221P 16
C8	Electrolytic	100	10V	CEA 101P 10

RESISTORS

Symbol	Description			Part No.
R1	Carbon film	4.7k		RD¼PS 472K
R2	Carbon film	22k		RD¼PS 223K
R3	Carbon film	220		RD¼PS 221K
R4	Carbon film	1.2k		RD¼PS 122K
R5	Carbon film	2.2k		RD¼PS 222K
R6	Carbon film	22		RD¼PS 220K
R7	Carbon film	47		RD¼PS 470K
R8	Metal oxide	680	1W	RS 1P 681K

TRANSISTORS

Symbol	Description		Part No.
Q1	2SC968	Transistor	
Q2	2SC968	Transistor	

DIODES

Symbol	Description		Part No.
D1	SD-1Z	Diode	
D2	SD-1Z	Diode	
D3	SD-1Z	Diode	
D4	WZ-130	Zener diode	

3. PART LOCATION

3.1 FRONT PANEL

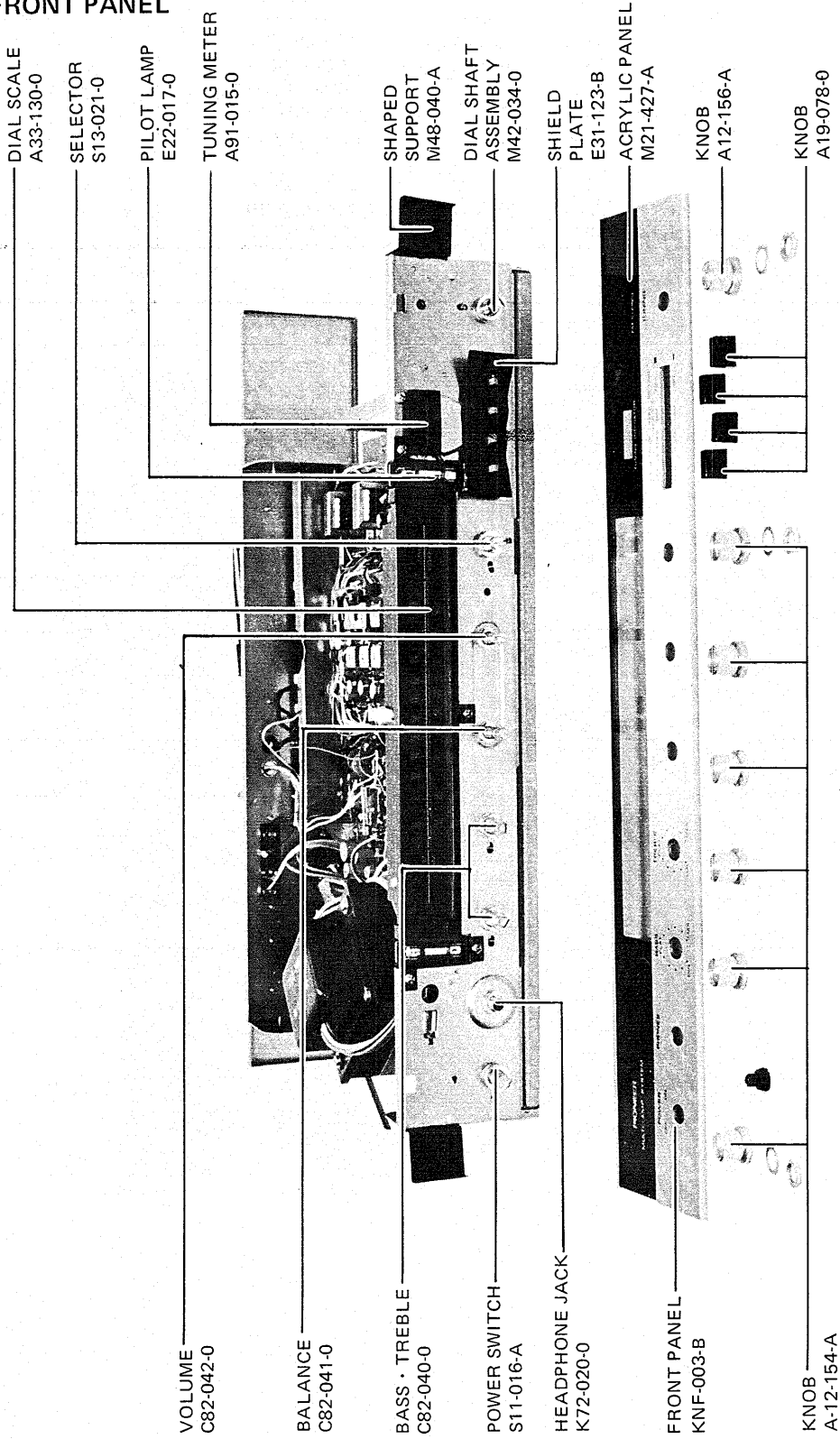

3.2 REAR PANEL

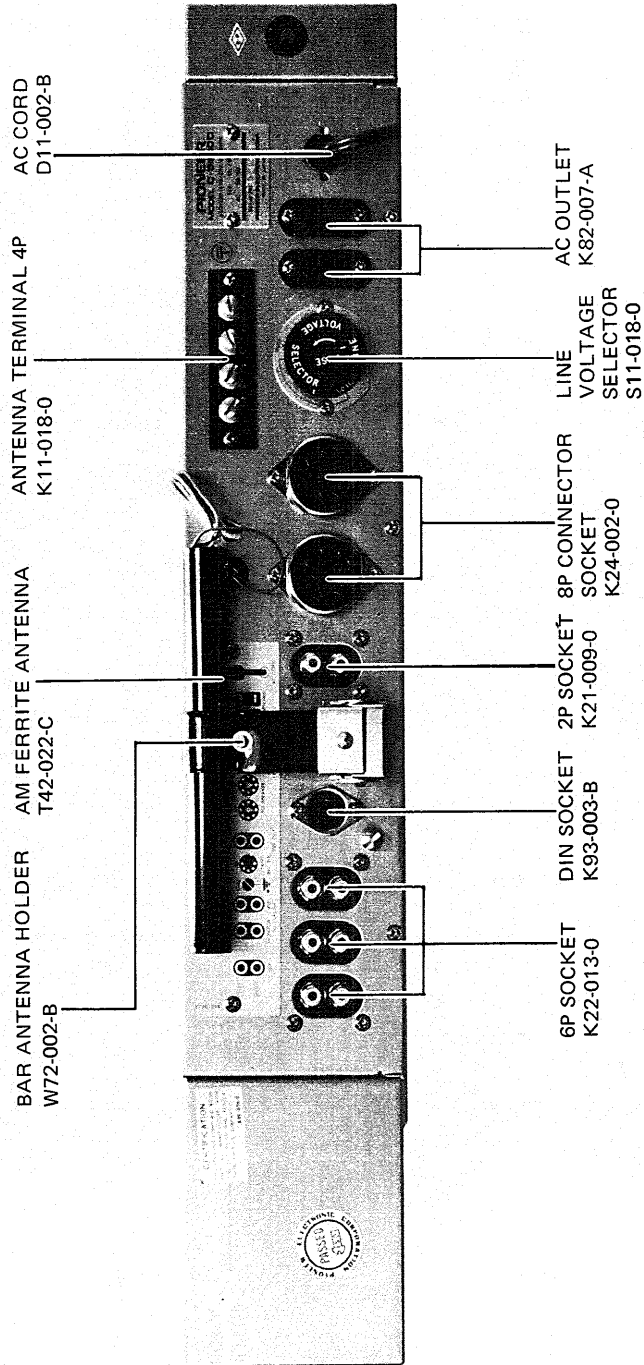

3.3 ASSEMBLY BOARD

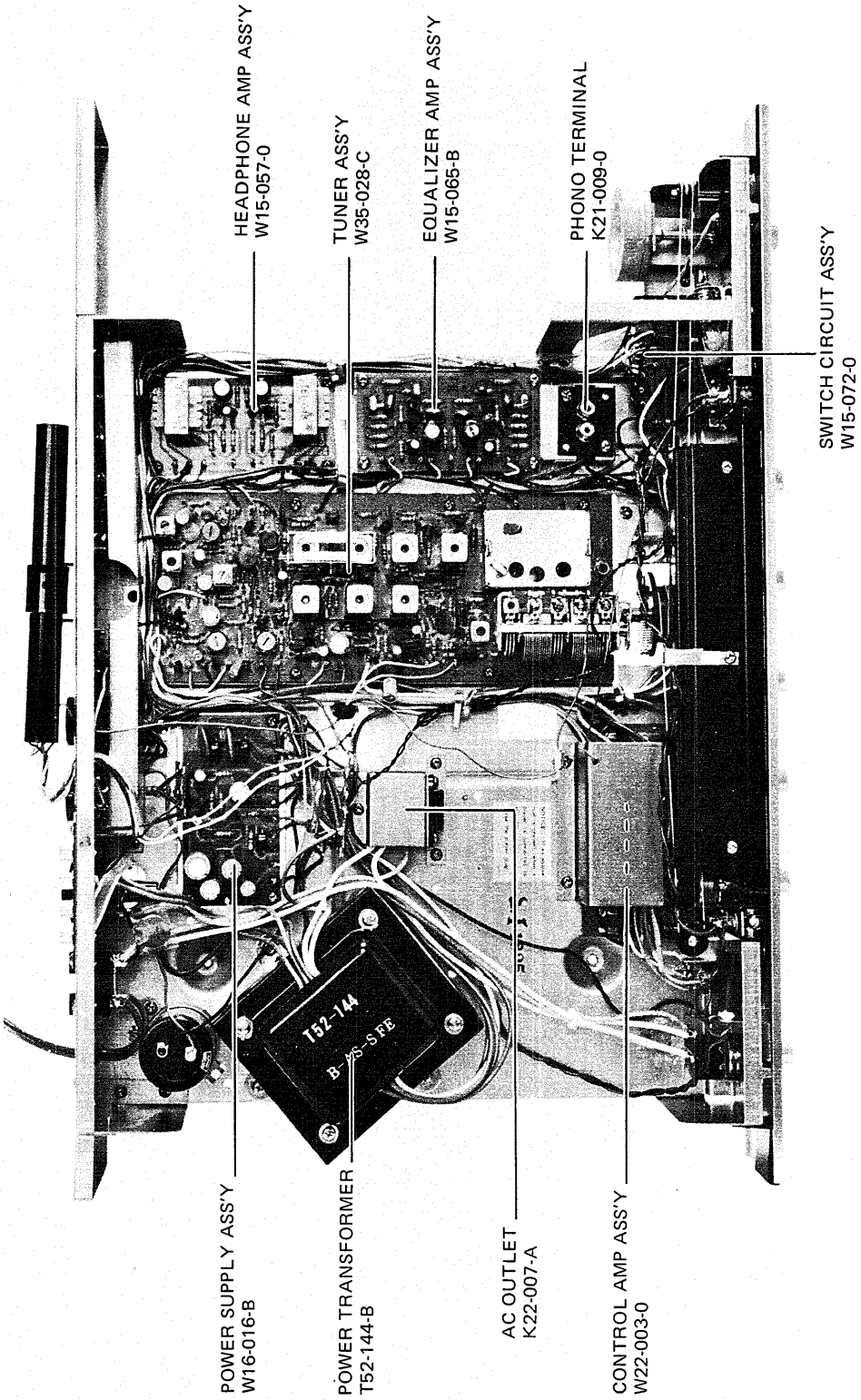

3.4 SPEAKER SYSTEM

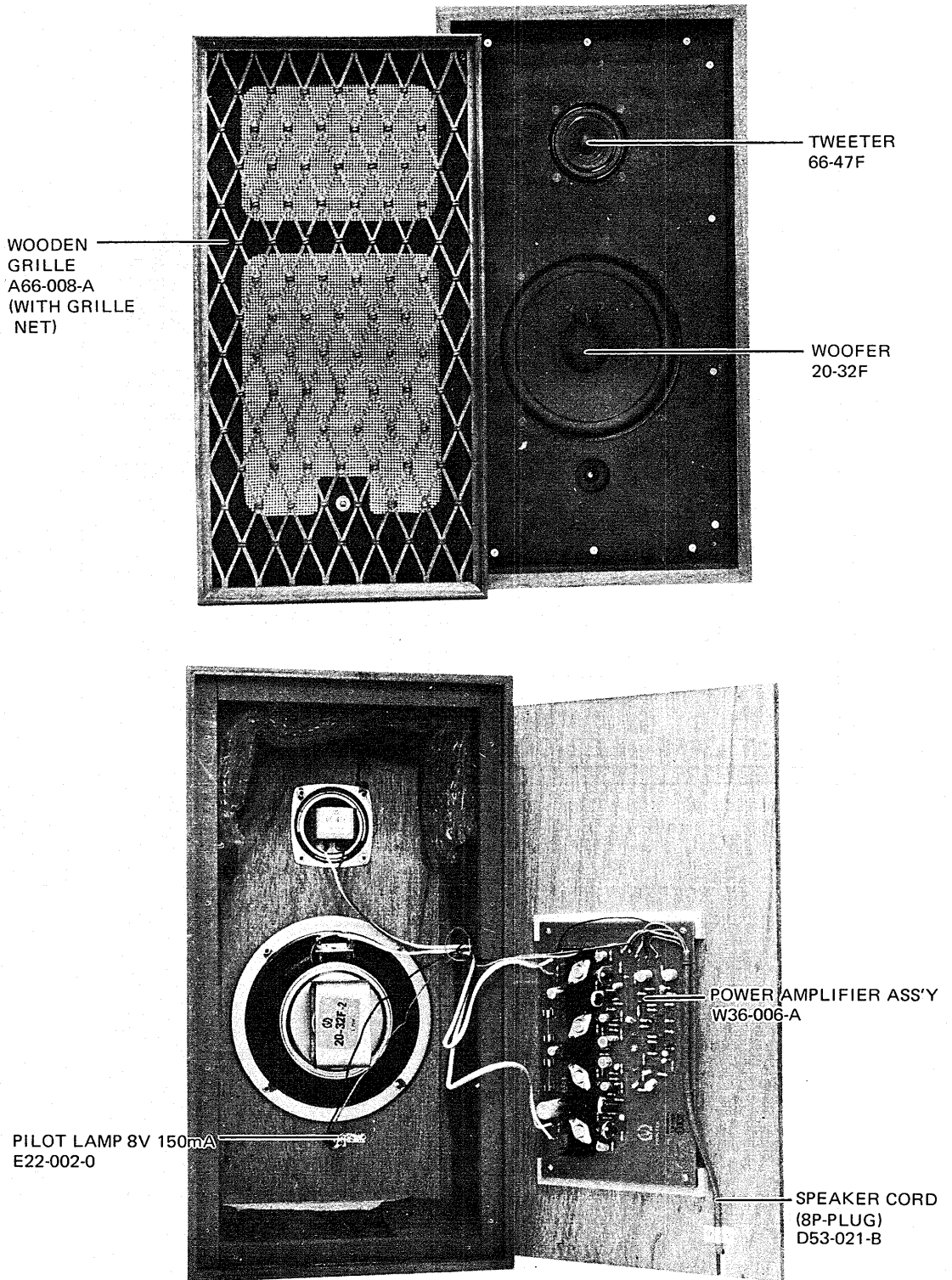

4. SPEAKER CONNECTION

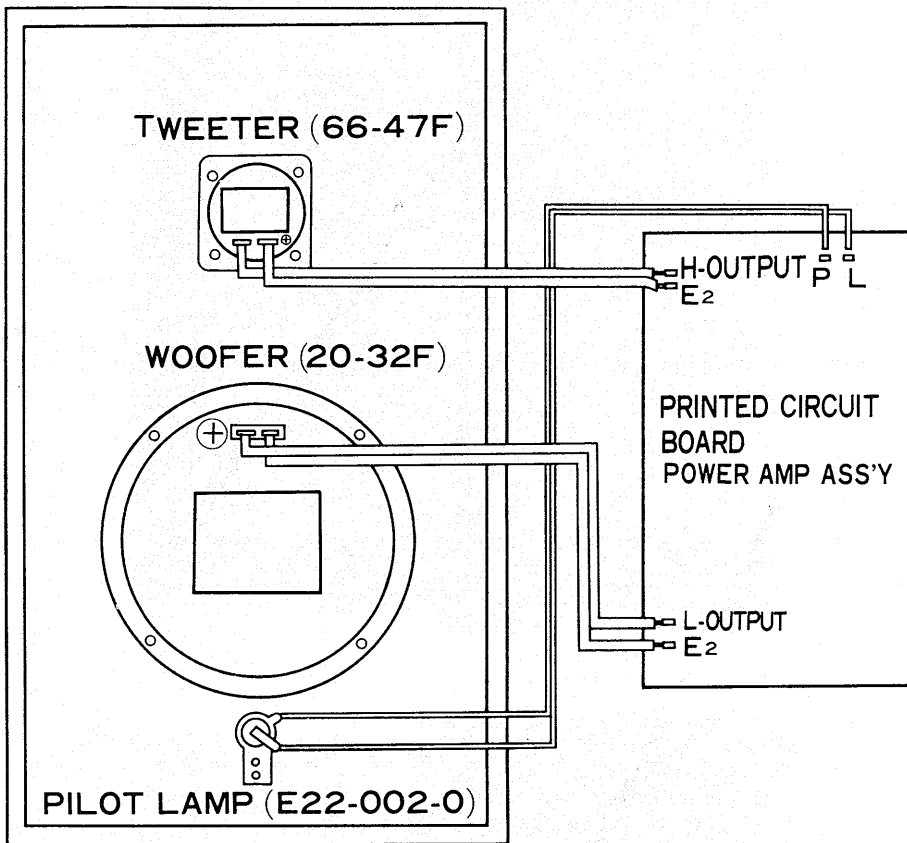

TURNTABLE ASSEMBLY
and PARTS LISTS

C-5600D
FV

1. EXPLODED VIEW

NOTICE: Any parts asterisked (*) are subject to being not supplied.

Key No.	Description	Part No.
1	Center ring plate	A61-602-A
2	Rubber mat	E31-166-A
3	Turntable platter	KXA-180-B
4*	Panel	
5	Belt	KEB-004-0
6	Speed selector template	A51-011-0
7	Function lever knob	N93-044-C
8*	Angle plate	KNA-027-0
9*	Oil cap	
10	Spring Washer 4φ	
11	Screw	N51-065-0
12	Nut	B71-656-A
13	Washer	B22-650-0
14	⊕ M3 x 8 machine screw	
15	Pin	KNK-071-B
16	⊕ M5 x 6 machine screw	
17	⊕ M4 x 10 machine screw	
20	Machine screw assembly (MOTOR)	KBA-025-0
21	⊕ M3 x 6 machine screw	
22	Flat washer 4φ	
23	Function lever template	KAK-004-0
24	Boss	KNK-186-A
25	⊕ M4 x 6 machine screw	
26	Retaining washer E-type(E-2)	
27	Stopper	W71-755-D
28	Adaptor catch	N93-007-A
29	Elevator knob	A19-618-A
30	Rubber grommet (B)	E31-744-0
31	Elevator lever template	A51-012-0
32	Rubber grommet (A)	E31-743-0
35	Spring washer 3φ	
36	⊕ M3 x 8 machine screw	
38	⊕ M3 x 5 machine screw	
40	Elevation arm assembly	N93-045-F
41	Spring(A)	KXA-237-D
42	Spring(B)	KXA-238-D
43	Spring(C)	KXA-239-D
44	Spring(D)	KXA-240-D
45	Rubber cushion	E33-001-0
46	Tonearm rest	KXA-201-0
47	Rest stand	N55-639-A
48	M3 nut	
53	Output cord	KDE-018-B
55	Terminal strip lug-type	KKC-008-0
56	⊕ M3 x 4 machine screw	
57	Power cord	D54-640-A
58	Select lever lod	

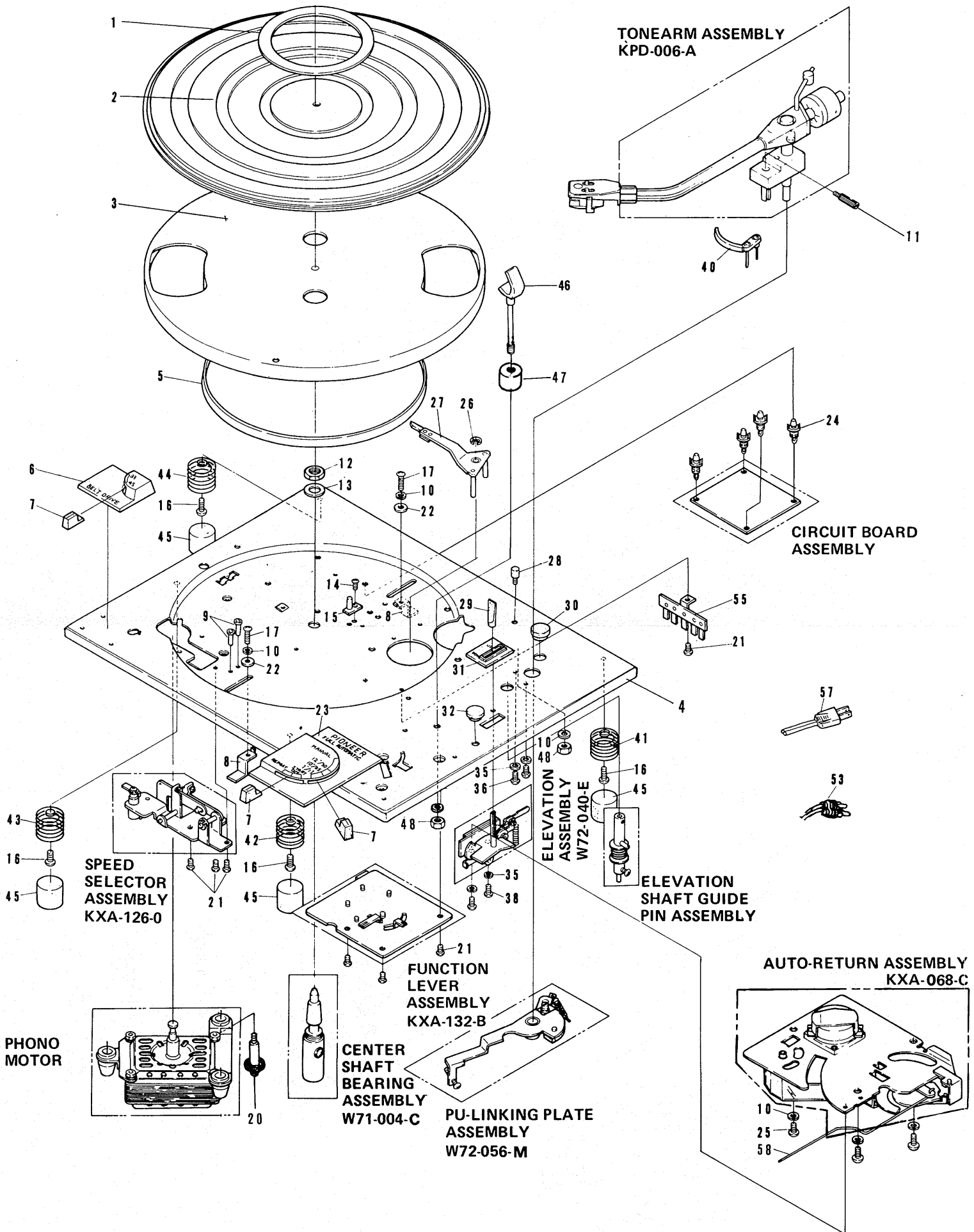

2. AUTO-RETURN ASSEMBLY (KXA-068-C)

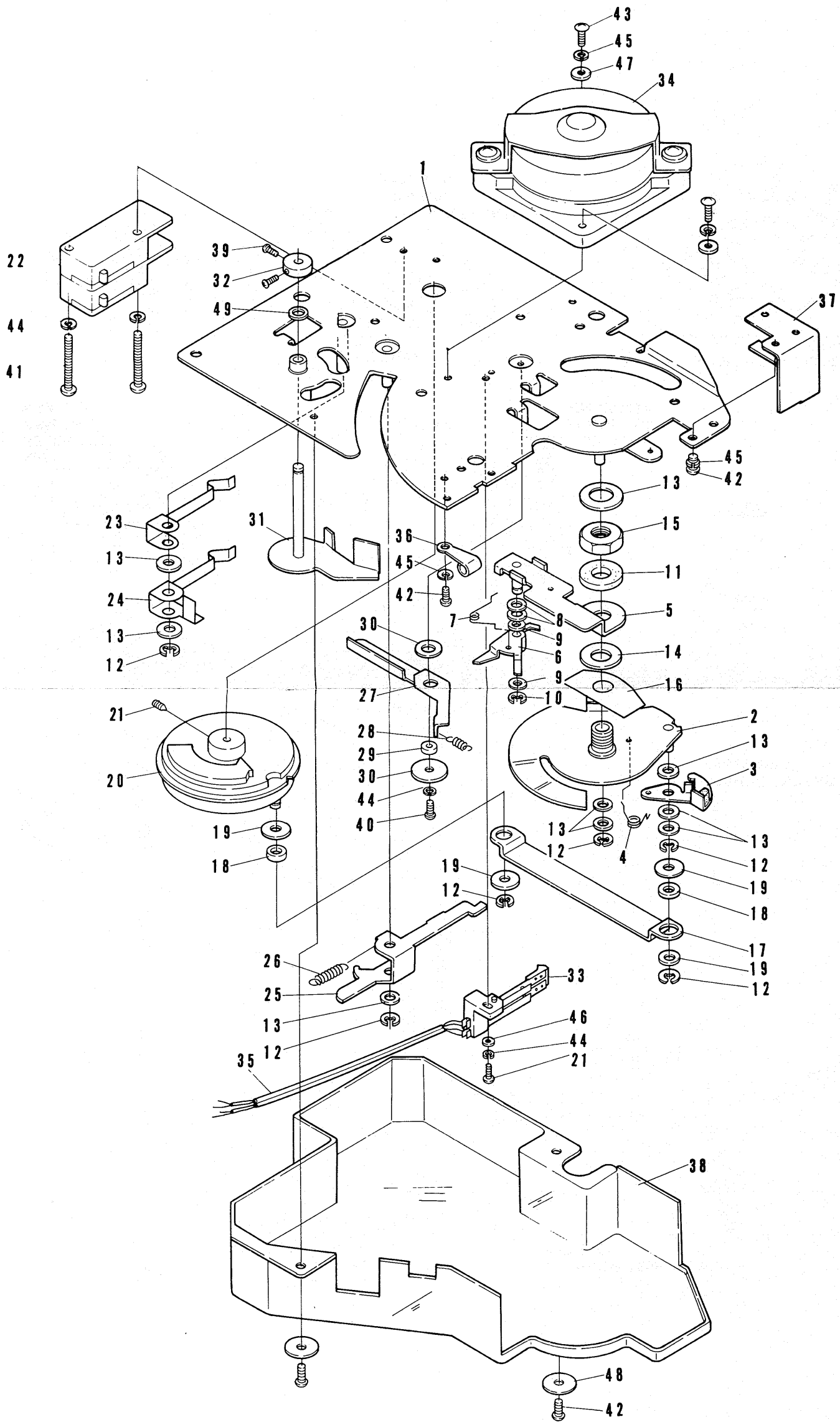

NOTICE: Any parts asterisked (*) are subject to being not supplied.

Key No.	Description	Part No.	
1*	Auto-return panel unit	KWM-010-D	
2	Cam plate	KWM-011-A	
3	Return lever unit	KWM-012-B	
4	Spring	B33-609-A	
5*	Starting lever unit	KWM-013-0	
6	Lock lever unit	KWM-005-0	
7	Spring	B33-635-A	
8	Flat washer 3.2φ x 6φ x 0.5t		
9	Teflon washer 3.2φ x 6φ x 0.3t		
10	Retaining washer E-type (E-2.1)		
11	Rubber washer	KNA-097-0	
12	Retaining washer E-type (E-3)		
13	Teflon washer 4.2φ x 8φ x 0.5t		
14	Teflon washer	B23-629-0	
15	Nut	KLA-159-0	
16	Plate spring (D)	KNA-099-B	
17*	Crank lever	KNA-100-A	
18	Spacer	W73-660-0	
19	Nylon washer 4.2φ x 8φ x 0.3t		
20	Cum unit	KWM-014-C	
21	⊕ M2.6 x 6 set screw		
22	Microswitch	KSF-009-0	
23	Actuator (A)	KNA-101-A	
24	Actuator (B)	KNA-102-B	
25*	Break lever	KNA-103-A	
26	Spring	KBH-040-0	
27*	Return lever	KNA-104-C	
28	Spring	KBH-027-B	
29	Return lever hub	KLA-068-A	
30	Washer	KNA-170-0	
31	Aluminum plate	KWM-015-A	
32	Retaining collar	N51-786-B	
33	Switch	KSN-001-A	
34	Warren motor	KXM-002-A	
35*	Cable	KDA-006-0	
36*	Cable clamp	K16-602-0	
37*	Stop angle	KNA-217-0	
38	Plastic cover	KNK-047-B	
39	⊕ M2.6 x 3 machine screw		
40	⊕ M2.6 x 5 machine screw		
41	⊕ M2.6 x 25 machine screw		
42	⊕ M3 x 5 machine screw		
43	⊕ M3 x 8 machine screw		
44	Spring washer 2.6φ		
45	Spring washer 3φ		
46	Flat washer M2.6		
47	Flat washer M3		
48	Cushion washer 3.2φ x 8φ x 0.5t		
49	Teflon washer 3.2φ x 8φ x 0.3t		

3. TONEARM ASSEMBLY (KPD-006-A)

NOTICE: Any parts asterisked (*) are subject to being not supplied.

Key No.	Description	Part No.
1	Main weight	W73-013-0
2	Screw	B11-657-C
3	Washer	B23-642-0
4*	Arm head	
5	Rateral balance	W73-166-0
6*	Cartridge (PC-35)	
7	Nut	B71-653-0

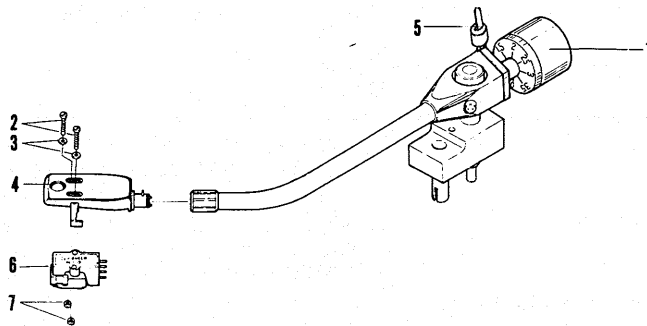

4. PU-LINKING PLATE ASSEMBLY (W72-056-M)

NOTICE: Any parts asterisked (*) are subject to being not supplied.

Key No.	Description	Part No.
1*	Pu-linking plate unit	W72-081-J
2	Spring	B31-749-B
3*	Screw	N54-048-0
4	Spring	B31-745-B
5	⌀ M4 x 6 machine screw	KBA-002-0
6*	Weight	N82-001-0
7	Flat washer 3φ	
8	Spring washer 3φ	
9	⌀ M3 x 10 machine screw	
10	Nut M3	
11	⌀ M3 x 12 machine screw	

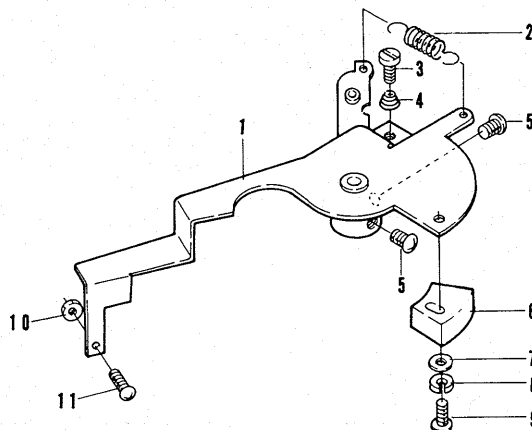

5. CENTER SHAFT BEARING ASSEMBLY (W71-004-C)

NOTICE: Any parts asterisked (*) are subject to being not supplied.

Key No.	Description	Part No.	
1*	Center shaft	N54-786-B	
2*	Steelball 1/8"		
3*	Center shaft bearing	N23-614-C	
4	Spring washer 3φ		
5	⊕ M3 x 5 machine screw		

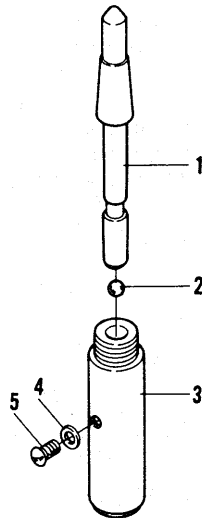

6. ELEVATION SHAFT GUIDE PIN ASSEMBLY

NOTICE: Any parts asterisked (*) are subject to being not supplied.

Key No.	Description	Part No.	
1	Washer (M)	B22-612-0	
2	Spring	B31-645-A	
3	Washer (M)	B22-612-0	
4	Retaining washer E-type		
5	Pin	N51-791-A	
6	⊕ M2.6 x 4 machine screw		
7	Elevation shaft	N51-073-B	
8	Pin	N92-602-0	

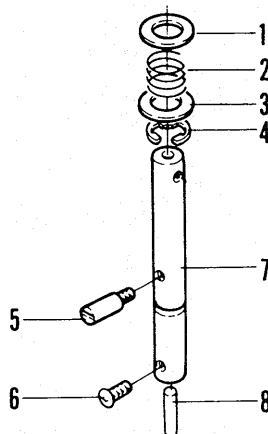

7. SPEED SELECTOR ASSEMBLY (KXA-126-0)

NOTICE: Any parts asterisked (*) are subject to being not supplied.

Key No.	Description	Part No.	
1*	Belt shifter	W72-051-C	
2	Spring	B31-028-B	
3*	Speed selector plate unit	W72-050-A	
4	Flat washer 4φ		
5*	Speed selector panel unit	W72-049-A	
6	Retaining washer E-type (E-3)		
7	Washer	N64-031-A	
8	Spring	B31-029-A	
9*	Cam unit	W72-052-A	
10	Flat washer 4φ		
11	Retaining washer E-type (E-3)		
12*	Speed selector lever	N64-030-B	
13	Spring washer 2.6φ		
14	⊕ M2.6 x 5 machine screw		

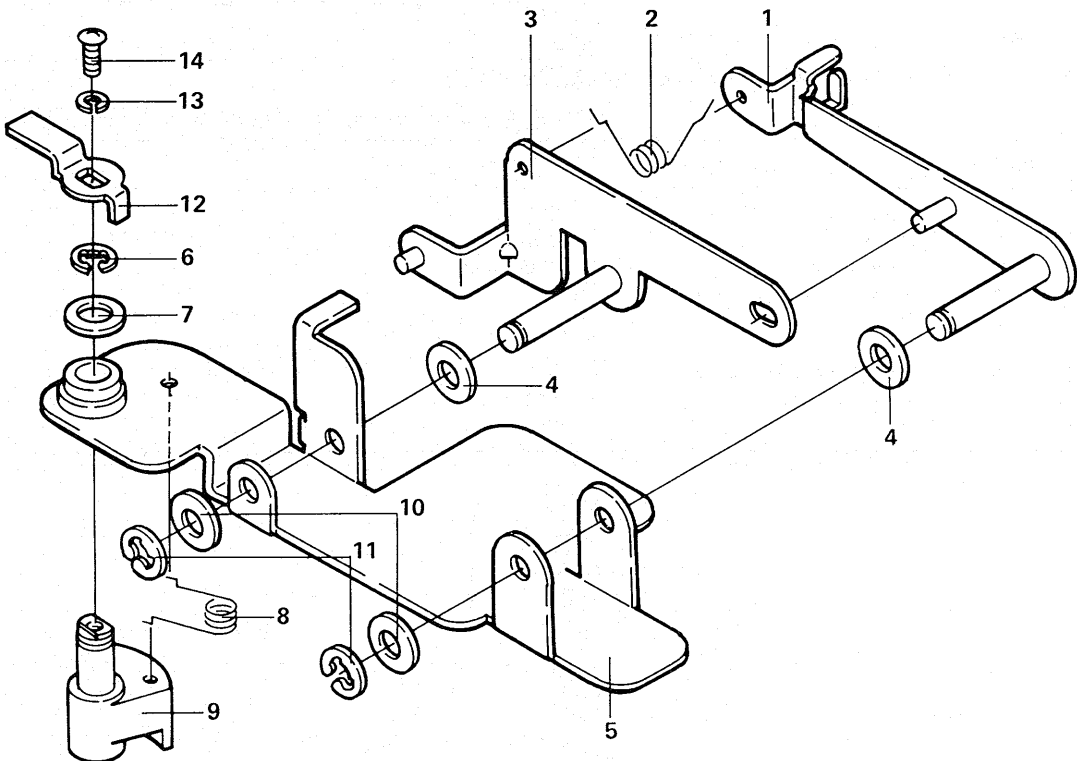

8. FUNCTION LEVER ASSEMBLY (KXA-132-B)

NOTICE: Any parts asterisked (*) are subject to being not supplied.

Key No.	Description	Part No.
1*	Function board assembly	W72-054-B
2*	Washer	B22-642-0
3*	Start lever plate	W71-757-0
4*	Start lever washer	N51-795-0
5*	Start lever	N64-029-0
6*	Selector lever washer	B51-794-0
7*	Selector lever spring	B31-746-0
8*	Selector lever	W72-059-A
9*	Washer	B22-643-0
10	Switch	S48-624-E
11*	Switch cover	E32-685-C

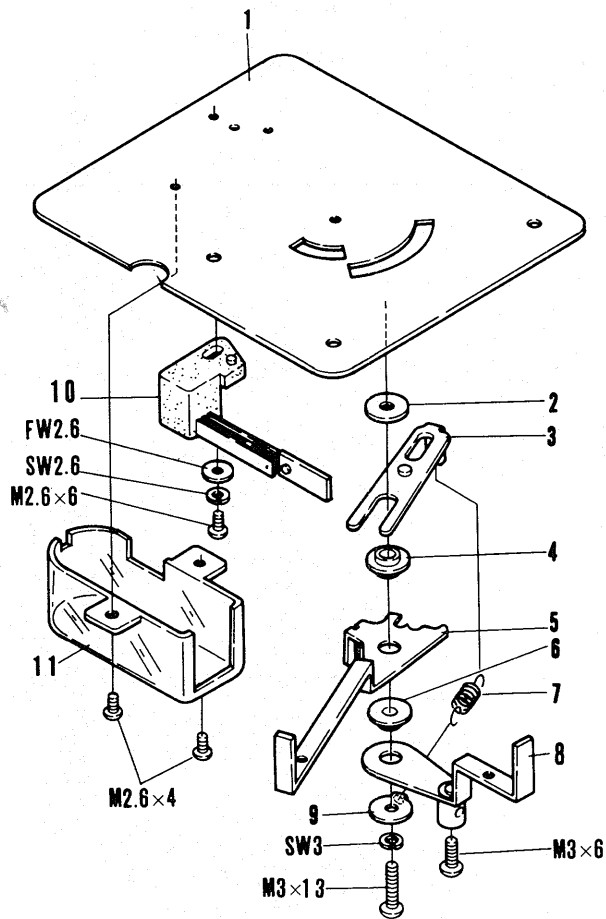

9. ELEVATION ASSEMBLY (W72-040-E)

NOTICE: Any parts asterisked (*) are subject to being not supplied.

Key No.	Description	Part No.
1*	Elevation plate	N62-799-B
2*	Rubber cushion	E31-736-A
3*	Lifter unit	W71-763-B
4*	Elevator plate unit	W72-041-0
5	Spring washer 2φ	
6	⊕ M2 x 5 machine screw	
7*	Lever (A) for tonearm elevator	N62-770-0
8	Spring washer 3φ	
9*	Nut	B71-636-0
10*	Spacer	B21-659-0
11*	Lever (B) for tonearm elevator	N64-013-0
12	Spring	B31-748-0
13	M3 nut	
14	Spring washer 3φ	
15*	Washer	B21-661-0
16	Spring	B33-608-B
17*	Lever	N51-064-B
18	Nut M2.6	
19*	Elevator cam	N93-035-B
20	Washer 4.2φ x 8φ x 0.3t	
21	Retaining washer E-type (E-3)	
22	Spring	B31-026-B

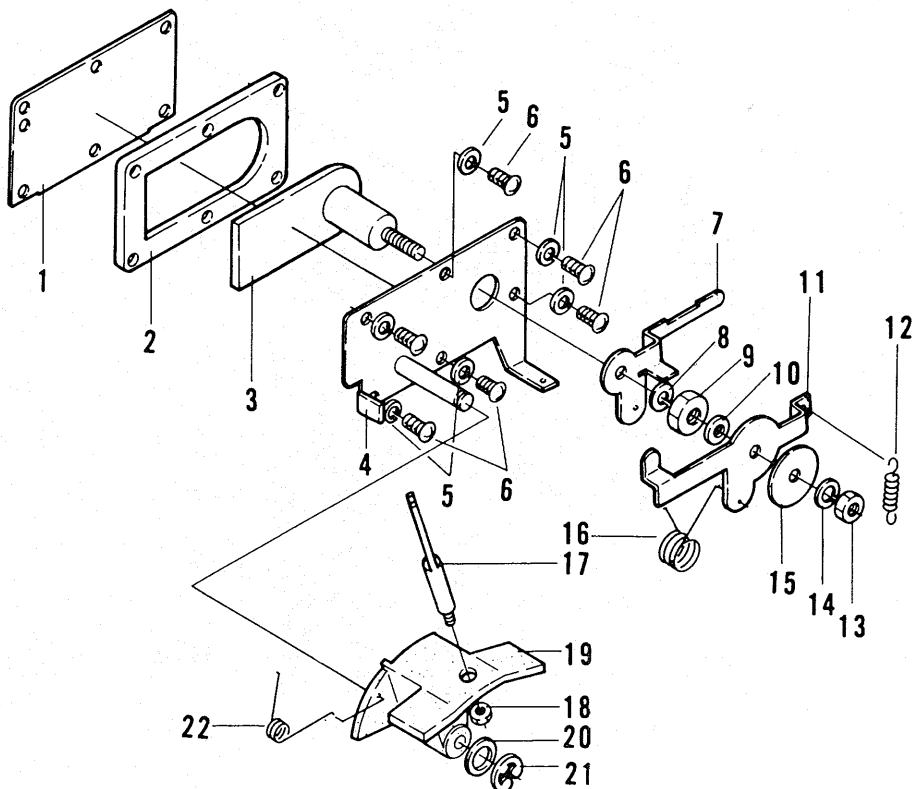

10. PHONO MOTOR ASSEMBLY

NOTICE: Any parts asterisked (*) are subject to being not supplied.

Key No.	Description	Part No.	
1	Nut M4		
2	Spring washer 4φ		
3*	Motor cushion (B)	N64-018-0	
4*	Motor cushion (A)	N61-017-0	
5	Motor pulley 50Hz 60Hz	N24-005-E N24-006-E	
6	Rubber cushion	E31-605-A	
7	Phono motor	N11-006-D	

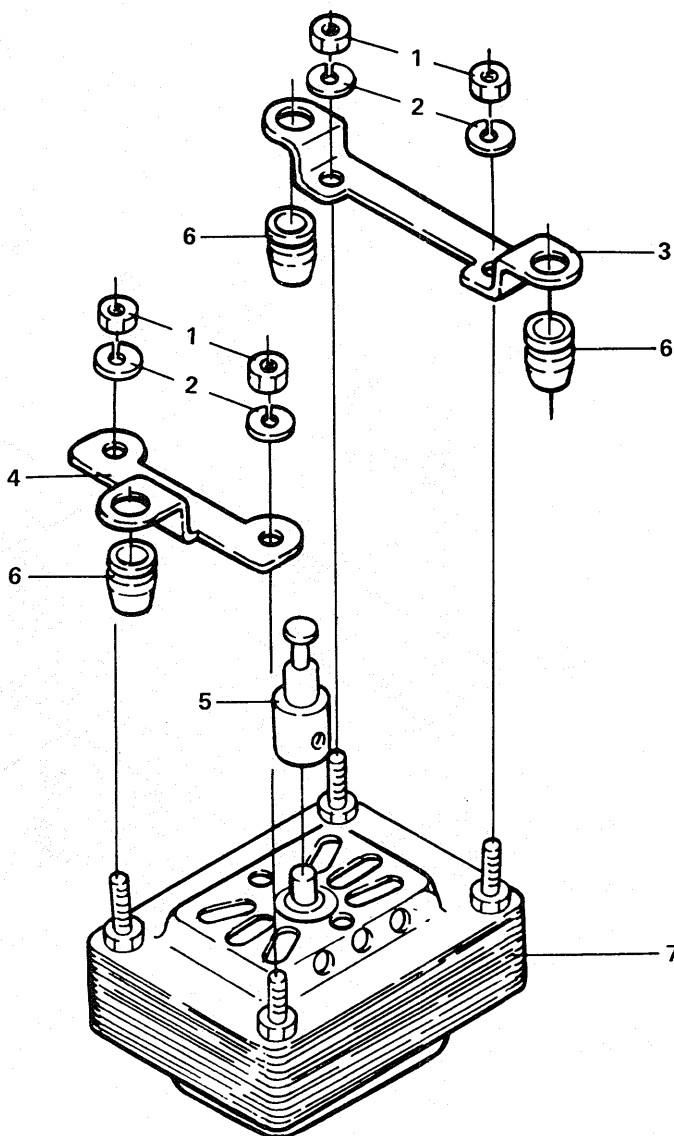

11. CIRCUIT BOARD ASSEMBLY

NOTICE: Any parts asterisked (*) are subject to being not supplied.

Key No.	Description	Part No.
1	Fuse 0.3A	E21-017-0
2	Fuse holder	K91-006-0
3	Circuit board	KNP-033-0
4	Terminal A	KNA-036-0
5	Terminal B	K28-005-A
6	Capacitor 0.047 μ F	KCE-003-0

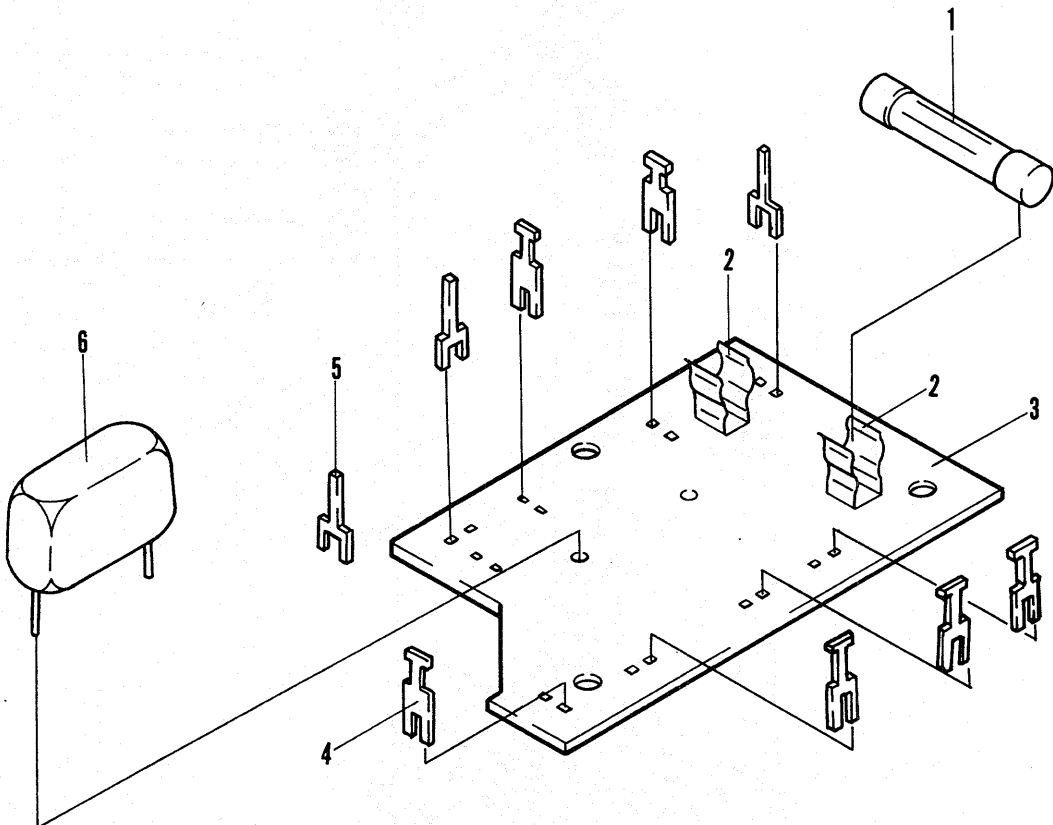

12. SPEAKER SYSTEM PACKING

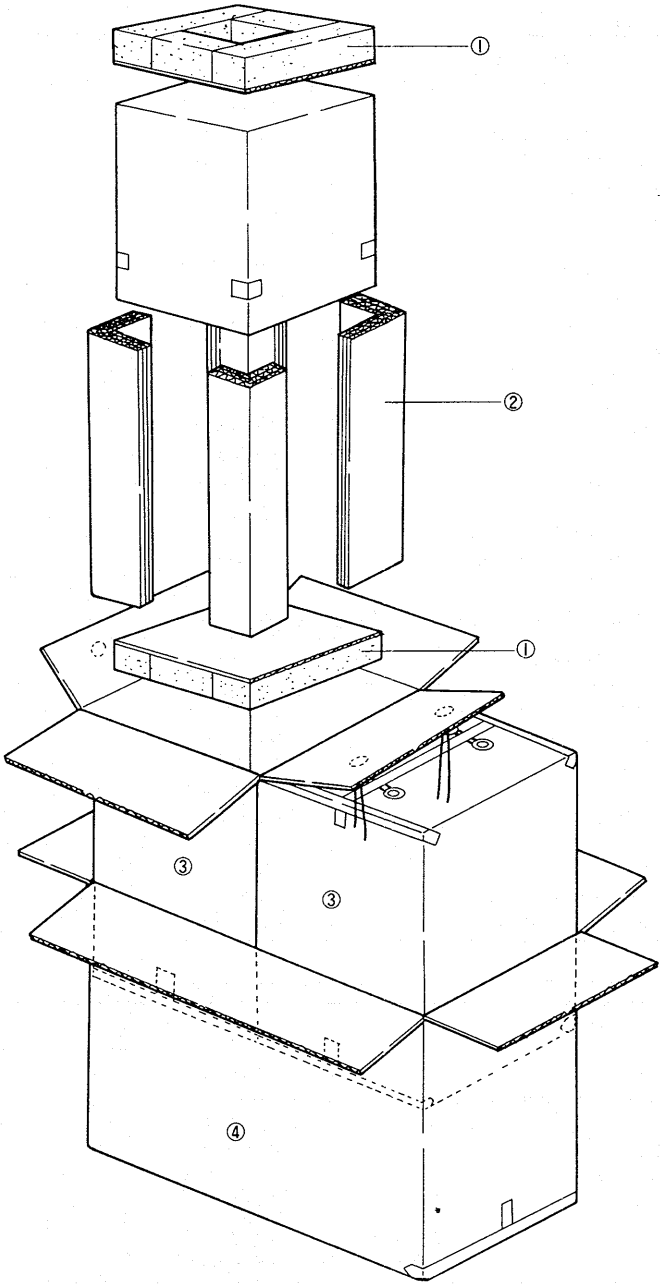

NOTICE: Any parts asterisked (*) are subject to being not supplied.

Key No.	Description	Part No.	
1	Pad A	KHK-012-0	
2	Pad B	KHK-011-A	
3	Packing case A	KHF-006-0	
4	Packing case B	KHG-025-0	
	PACKING CASE ASSEMBLY WITH 1,2,3, and 4	KHK-038-0	

13. CONTROL CENTER PACKING

PACKING CASE IN CENTER BOX

Key No.	Description	Part No.
1	Pad A	KHA-014-0
2	Dust cover packing case	H22-037-A
3	Dust cover assembly	M63-022-B
4	Accessory parts A	
5	Pad B	H22-036-0
6	Cabinet assembly	KMN-003-0
7	Metal frame A	KAP-003-A
8	Metal frame B	KAP-004-A
9	Accessory parts B	
10	Rubber mat assembly	E31-166-A
11	Card board case	KHF-005-B
12	Pad C	KHA-013-0
13	Packing case A	KHG-024-0
14	Packing case B	KHP-003-0
	PACING CASE ASSEMBLY WITH 1,5,11,12,13, and 14	KHK-037-B

ACCESSORY PARTS A indicates key No. 4 (See the next page.)

Key No.	Description	Part No.
	FM T-type antenna	D53-001-A
	AM read antenna	D53-022-A
	Pin plug	K72-015-A
	Fuse 1A	E21-004-0
	Fuse 0.5A	E21-007-0
	Felt pad	E33-008-0
	Polishing cloth	E33-009-0
	Operating instructions	KRB-005-A

ACCESSORY PARTS B indicates key No. 9 (See the next page.)

Key No.	Description	Part No.
	EP adaptor	M93-603-A
	Screwdriver for unpacking	P25-607-A
	Oil	N93-665-0
	Rubber bush A	E31-743-0
	Small screw driver	E11-125-A
	Rubber bush B	E31-744-0
	Capstan 50Hz	N24-005-E
	60Hz	N24-006-E

OTHERS

Key No.	Description	Part No.
	Center box assembly	KMN-003-0
	Hinge B with stopper	M62-078-A
	Hinge C	M62-079-A
	Accessory parts B box	KHX-001-D
	Accessory parts B box cover	KHX-002-D
	Tonearm cover A	H52-003-A
	Tonearm cover B	H52-004-A

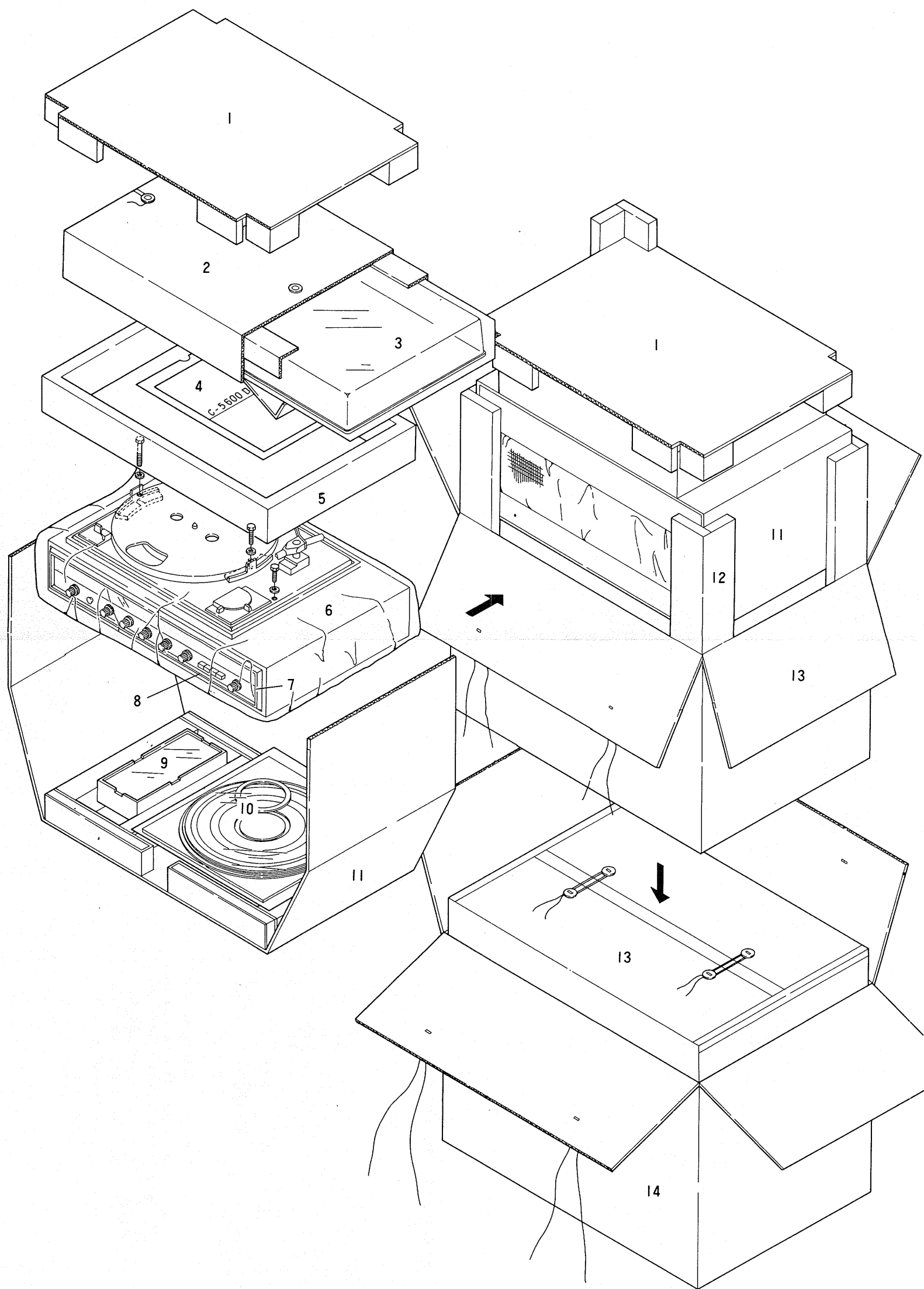

53

54

C-5600D

14. DIAL CORD STRINGING

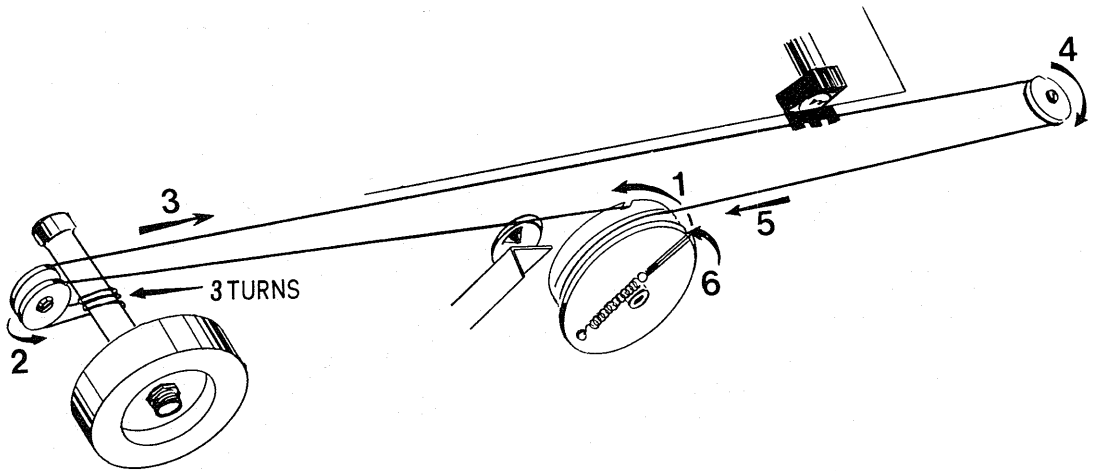

15. 8P-PLUG CONNECTIONS

8P-PLUG

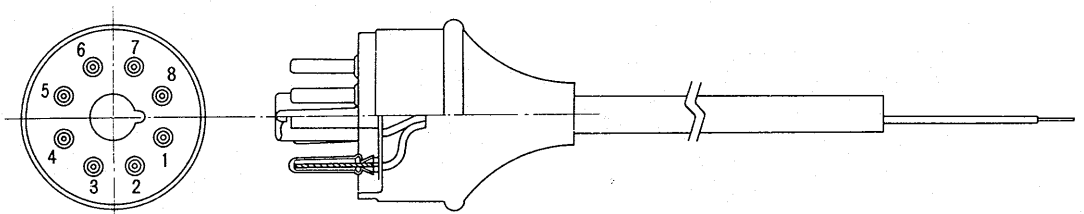

- Shield wire(-). To be connected to 5 of the 8P-PLUG.
- Braid wire(+). To be connected to 4.
- Red wire. To be connected to 1.
- Black wire. To be connected to 2.
- Yellow wire. To be connected to 8.
- Blue wire. To be connected to 7.

PIONEER ELECTRONIC CORPORATION
15-5, 4-Chome, Ohmori-nishi, Ohra-ku, Tokyo, Japan

U.S. PIONEER ELECTRONICS CORPORATION
178 Commerce Road, Carlstadt New Jersey 07072 U.S.A.

PIONEER ELECTRONIC (EUROPE) N.V.
Meir-center, Meir 21, 2000 Antwerp, Belgium

© MAR. 1973

PRINTED IN JAPAN