

Service Manual

ORDER NO.
RRV4156

DJ MIXER

DJM-350-W

THIS MANUAL IS APPLICABLE TO THE FOLLOWING MODEL(S) AND TYPE(S).

Model	Type	Power Requirement	Remarks
DJM-350-W	SYXJ8	AC 220 V to 240 V	
DJM-350-W	UXJCB	AC 120 V	
DJM-350-W	LXJ	AC 110 V to 120 V or 220 V to 240 V	
DJM-350-W	AXJ5	AC 220 V to 240 V	
DJM-350-W	KXJ5	AC 220 V	

This service manual should be used together with the following manual(s):

Model	Order No.	Remarks
DJM-350/SYXJ8	RRV4063	

This product is the same as the DJM-350, except for the colors. The major changes are as shown below.

Exterior panels (control panel, front panel, side panels, and rear panel): Changed to white

LED colors: Green changed to blue

Amber (LEVEL meters: CH1, CH2, and Master) changed to white

Amber (FADER START CH1 and CH2) changed to blue

When replacing the above-mentioned parts, be sure to use the parts described in this manual.

Two of the four master effects have been changed, as follows:

GATE to NOISE, CRUSH to SHORT ECHO

With these changes, the firmware becomes different from that for the base model.

With the name modification of the master effect, the button to press at Test Mode-on is changed from [GATE] to [NOISE]. (Refer to P3.)

PIONEER CORPORATION 1-1, Shin-ogura, Saiwai-ku, Kawasaki-shi, Kanagawa 212-0031, Japan

PIONEER ELECTRONICS (USA) INC. P.O. Box 1760, Long Beach, CA 90801-1760, U.S.A.

PIONEER EUROPE NV Haven 1087, Keetberglaan 1, 9120 Melsele, Belgium

PIONEER ELECTRONICS ASIACENTRE PTE. LTD. 253 Alexandra Road, #04-01, Singapore 159936

©PIONEER CORPORATION 2010

1. SERVICE PRECAUTIONS

1.1 About the New slider knob

The new slider knob adopted by this product is designed so that it is not pulled out easily. Therefore, the method for removing the slider knob is different from the conventional method; it can only be pulled out after part ① is removed.

[Component formation]

locked by parts ① and ③ shown below.

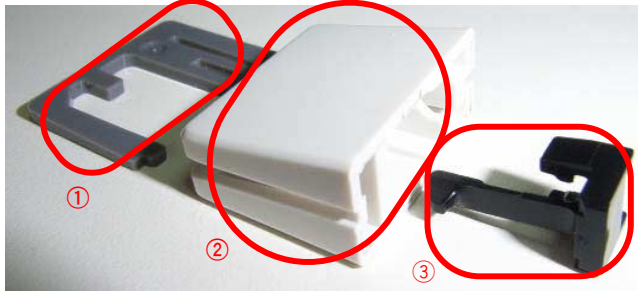

- ① Slider knob 2: DAC2770
- ② Slider knob 1: DAC2769
- ③ Slider knob stopper: DNK5888

[Distinguishing method]

New slider knob: The line of the knob does not reach the bottom on one side.

Conventional slider knob: The line of the knob reaches the bottom on the both sides.



The line reaches the bottom.



The line does not reach the bottom.

[Disassembly and reassembly]

① Find the side on which the line reaches the bottom.

② Insert a pair of needle-nose pliers or a similar tool beneath the line then push the slider knob ② upward. To protect the panel from being scratched, use protective material.

③ Remove slider knob 2.

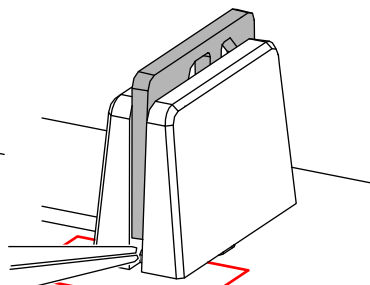
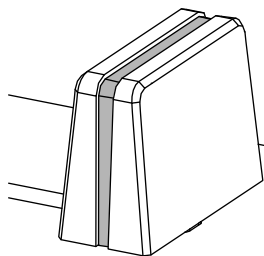

Protective material
(a piece of cardboard, etc.)

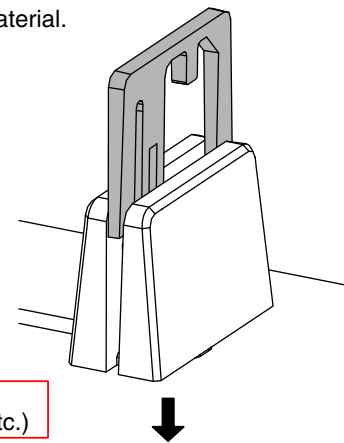

⑤ Remove the slider knob stopper.

④ Pull out slider knob 1.

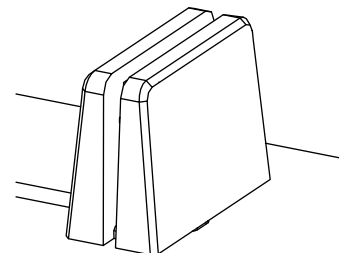
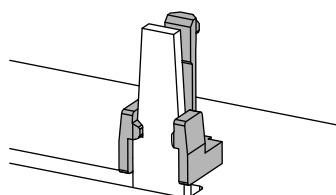

[Note on reassembling the slider knob stopper]

When reassembling a slider knob stopper, be careful of the stopper attachment position.

Normally, attach it to the right side for a vertical slider, and to the front side for a horizontal slider.

1.2 About the Test Mode-on

With the name modification of the master effect, the button to press at Test Mode-on is changed from [GATE] to [NOISE].

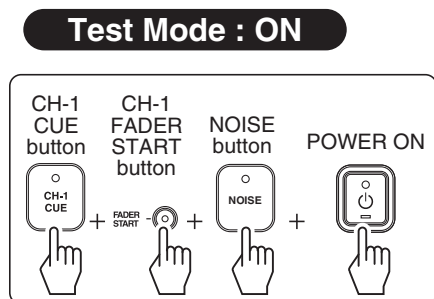

1.3 About the Firmware

The firmware of this product is different from that for the base model, because two main effects differ between these models. However, these two types of firmware can be updated to either of the types, because both types of firmware are designed to be able to be installed in either of the two models. This is to respond to the needs of users who may wish to select the effects functions at their discretion. The labels on which effect names are printed are enclosed with the product so that a user who has updated the firmware for this product to that for the base model can stick them on the product. (Part No.: DRW2480)

How to handle during servicing

First check the type of firmware and its version.

In principle, before returning the repaired product to the user, update the firmware of the product to the latest version of the firmware that was installed when the product was received to be repaired.

If the type of firmware cannot be confirmed, update to the latest version of the firmware corresponding to the type of model.

The model-type-based differences with regard to firmware are as shown in the table below.

Item	DJM-350	DJM-350-W
Indication of the model name upon power-on	The LEVEL meter LEDs show as "D," "J," "M," "-", "3," "5," "0."	The LEVEL meter LEDs show as "D," "J," "M," "-", "3," "5," "0," "W."
Types of Master Effects	GATE • CRUSH • JET • FILTER	NOISE • SHORT ECHO • JET • FILTE
Indication of the firmware version	Indicated as Ver 1.xx (starting with "1")	Indicated as Ver 5 .xx (starting with "5")
Version check method (disclosed to users)	While holding the [CRUSH] and [FILTER] keys pressed, turn the unit on. The version is repeatedly indicated with the LEVEL meter LEDs.	While holding the [SHORT ECHO] and [FILTER] keys pressed, turn the unit on. The version is repeatedly indicated with the LEVEL meter LEDs.

Note on Replacement of the MAIN Assy

The firmware for a MAIN Assy service part may not be the latest.

When replacing the MAIN Assy, be sure to update the firmware to the latest, following "How to handle during servicing," mentioned above.

2. CONTRAST OF MISCELLANEOUS PARTS

NOTES: ● Parts marked by "NSP" are generally unavailable because they are not in our Master Spare Parts List.

● The Δ mark found on some component parts indicates the importance of the safety factor of the part. Therefore, when replacing, be sure to use parts of identical designation.

● Screws adjacent to ∇ mark on product are used for disassembly.

● For the applying amount of lubricants or glue, follow the instructions in this manual.

(In the case of no amount instructions, apply as you think it appropriate.)

● Nos. indicate the pages and Nos. in the service manual for the base model.

● When ordering resistors, first convert resistance values into code form as shown in the following examples.

Ex.1 When there are 2 effective digits (any digit apart from 0), such as 560 ohm and 47k ohm (tolerance is shown by J=5%, and K=10%).

560 Ω \rightarrow 56 x 10¹ \rightarrow 561 RD1/4PU $\boxed{5}$ $\boxed{6}$ $\boxed{1}$ J

47k Ω \rightarrow 47 x 10³ \rightarrow 473 RD1/4PU $\boxed{4}$ $\boxed{7}$ $\boxed{3}$ J

0.5 Ω \rightarrow R50 RN2HR $\boxed{5}$ $\boxed{0}$ K

1 Ω \rightarrow 1R0 RS1P $\boxed{1}$ \boxed{R} $\boxed{0}$ K

Ex.2 When there are 3 effective digits (such as in high precision metal film resistors).

5.62k Ω \rightarrow 562 x 10¹ \rightarrow 5621 RN1/4PC $\boxed{5}$ $\boxed{6}$ $\boxed{2}$ $\boxed{1}$ F

2.1 CONTRAST TABLE

(1) All models are constructed the same except for the following:

Mark	No.	Symbol and Description	DJM-350/ SYXJ8, CUXJ, LXJ, KXJ5, AXJ5	DJM-350-W/ SYXJ8, UXJCB, LXJ, KXJ5, AXJ5	Remarks
NSP	P43-4	PCB ASSEMBLIES 1..MAIN Assy	DWX3112	DWX3256	
		1..PANL ASSY	DWM2383	DWM2436	
	P45-1	2..VRSW ASSY	DWX3117	DWX3254	
	P45-2	2..FADR ASSY	DWX3118	DWX3255	
		PACKING SECTION Instruction Manual	Not used	DRH1115	No.1 (EFFECT Spec Caution)
		Other Manual	Not used -> DRH1116	DRH1116	No.2 (Description for label sticker)
		Caution Card Label	Not used Not used -> DRW2481	DRM1347 DRW2480	No.3 (*1) No.4 (For EFFECT fucution change)
				(*1) Prevention Caution for forcing to pull out the kob	
Δ	P43-18	EXTERIOR SECTION USB Cover	DNK4999	DNK5906	
	P43-19	Side Panel L	DNK5554	DNK5898	
	P43-21	Front Panel	DNK5556	DNK5899	
	P43-22	USB Holder	DNK5598	DNK5908	
	P43-37	Screw (FE)	DBA1290	DBA1436	
P43-38	Screw	BBZ30P060FTB(x 20)	BBZ30P060FTB(x 16)	No.5	
P43-42	Screw	PBH30P080FTB	Not used		
	Screw	Not used	BBZ30P060FNI		
		CONTROL PANEL SECTION			
	P45-8	Rotary VR Knob (B)	DAA1257	DAA1272	
	P45-9	SW Cap MIC	DAC2346 -> DAC2773	DAC2774	
	P45-10	Slider Knob	DAC2501	Not used	
	P45-11	Button MIC Assy	DAC2583	DAC2703	
	P45-12	Button CUE	DAC2582	DAC2704	
	P45-14	Button Fader R	DAC2586	DAC2695	
	P45-15	Button EFFECT Assy	DAC2587	DAC2713	
	P45-16	Button EFFECT	DAC2588	DAC2686	
	P45-18	Button REC Assy	DAC2589	DAC2708	
	P45-19	Button REC	DAC2602	DAC2705	
	P45-23	SW Cap Fader	DAC2591 -> DAC2771	DAC2772	
	P45-24	Button Fader L	DAC2593	DAC2697	
	P45-25	Button CUE1 Assy	DAC2600	DAC2736	

Mark	No.	Symbol and Description	DJM-350/ SYXJ8, CUXJ, LXJ, KXJ5, AXJ5	DJM-350-W/ SYXJ8, UXJCB, LXJ, KXJ5, AXJ5	Remarks
	P45-28 P45-31	Button CUE2 Assy Level Plate	DAC2601 DAH2788	DAC2737 DAH2846	
	P45-34 P45-36 P45-40	Control Panel STANDBY Guard Screw (FE) Slider Knob(W) 1 Slider Knob(W)2 Slider Knob Stopper	DNB1180 DNK5730 DBA1290 Not used Not used Not used	DNB1190 DNK5907 DBA1436 DAC2769 DAC2770 DNK5888	No.6 No.7 No.8

(2) DJM-350/SYXJ8 and DJM-350-W/SYXJ8 are constructed the same except for the following:

Mark	No.	Symbol and Description	DJM-350/SYXJ8	DJM-350-W/SYXJ8,	Remarks
	P41-15	PACKING SECTION Packing Case	DHG2963	DHG3000	
	P43-15 P43-20	EXTERIOR SECTION Rear Panel Side Panel R	DNC1948 DNK5555	DNC2048 DNK5913	

(3) DJM-350/CUXJ and DJM-350-W/UXJCB are constructed the same except for the following:

Mark	No.	Symbol and Description	DJM-350/CUXJ	DJM-350-W/UXJCB	Remarks
	P41-15	PACKING SECTION Packing Case Caution Card	DHG2964 Not used -> DRM1352	DHG3001 DRM1352	No.9 (Ventilation Caution)
	P43-15 P43-20	EXTERIOR SECTION Rear Panel Side Panel R	DNC1948 DNK5555	DNC2049 DNK5913	

(4) DJM-350/LXJ and DJM-350-W/LXJ are constructed the same except for the following:

Mark	No.	Symbol and Description	DJM-350/LXJ	DJM-350-W/LXJ	Remarks
	P41-15	PACKING SECTION Packing Case	DHG2966	DHG3002	
	P43-15 P43-20	EXTERIOR SECTION Rear Panel Side Panel R	DNC1950 DNK5601	DNC2062 DNK5895	

(5) DJM-350/KXJ5 and DJM-350-W/KXJ5 are constructed the same except for the following:

Mark	No.	Symbol and Description	DJM-350/KXJ5	DJM-350-W/KXJ5	Remarks
	P41-15	PACKING SECTION Packing Case	DHG2968	DHG2999	
	P43-15 P43-20	EXTERIOR SECTION Rear Panel Side Panel R	DNC1948 DNK5555	DNC2053 DNK5913	

(6) DJM-350/AXJ5 and DJM-350-W/AXJ5 are constructed the same except for the following:

Mark	No.	Symbol and Description	DJM-350/AXJ5	DJM-350-W/AXJ5	Remarks
	P41-15	PACKING SECTION Packing Case	DHG2967	DHG3004	
	P43-15 P43-20	EXTERIOR SECTION Rear Panel Side Panel R	DNC1948 DNK5555	DNC2052 DNK5913	

2.2 EXPLODED VIEWS

PACKING SECTION

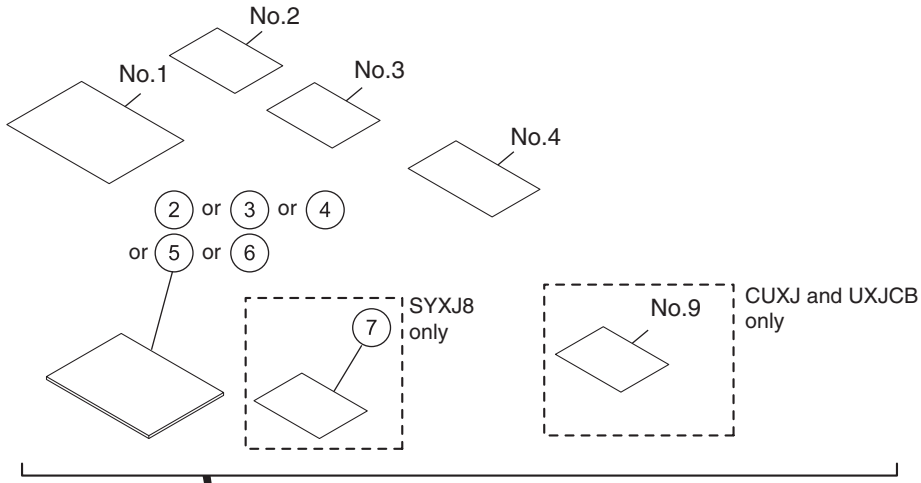

EXTERIOR SECTION

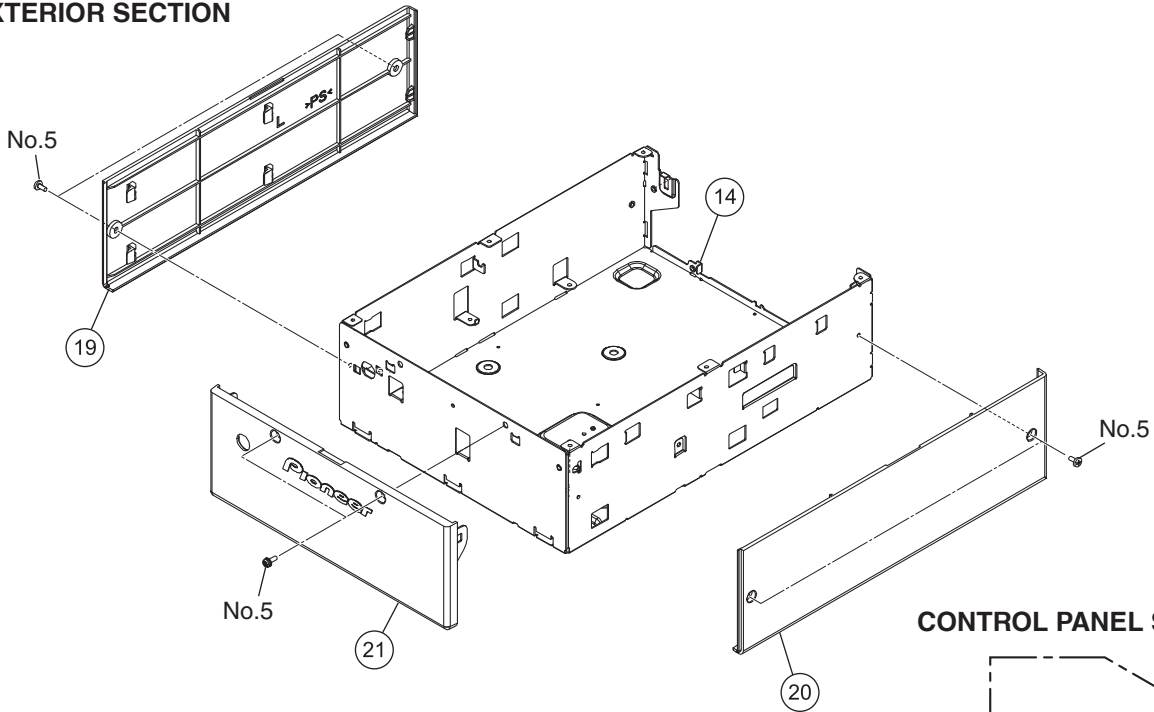

CONTROL PANEL SECTION

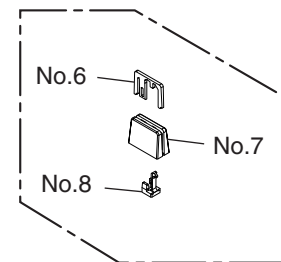

2.3 CCONTRAST OF PCB ASSEMBLIES

GF VRSW ASSY

DWX3136 and DWX3135 are constructed the same except for the following:

Mark	Symbol and Description	DWX3136	DWX3135	Remarks
D5002		SLI-343Y8C(KLMN)	SLR343WBC7T(MN)	
D5003		SLI-343Y8C(KLMN)	SLR343WBC7T(MN)	
D5004		TLGE68TG(NP)	SLR343BC4T(JK)	
D5005		TLGE68TG(NP)	SLR343BC4T(JK)	
D5006		TLGE68TG(NP)	SLR343BC4T(JK)	
D5007		TLGE68TG(NP)	SLR343BC4T(JK)	
D5009		SLI-343Y8C(KLMN)	SLR343WBC7T(MN)	
D5010		SLI-343Y8C(KLMN)	SLR343WBC7T(MN)	
D5011		TLGE68TG(NP)	SLR343BC4T(JK)	
D5012		TLGE68TG(NP)	SLR343BC4T(JK)	
D5013		TLGE68TG(NP)	SLR343BC4T(JK)	
D5014		TLGE68TG(NP)	SLR343BC4T(JK)	
D5016		SLI-343Y8C(KLMN)	SLR343WBC7T(MN)	
D5017		SLI-343Y8C(KLMN)	SLR343WBC7T(MN)	
D5018		TLGE68TG(NP)	SLR343BC4T(JK)	
D5019		TLGE68TG(NP)	SLR343BC4T(JK)	
D5020		TLGE68TG(NP)	SLR343BC4T(JK)	
D5021		TLGE68TG(NP)	SLR343BC4T(JK)	
D5022		SLI-343Y8C(KLMN)	SLR343BC4T(JK)	
D5023		SLI-343Y8C(KLMN)	SLR343BC4T(JK)	
D5024		SLI-343M8C(FGHJ)	SLR343BC4T(JK)	
D5025		SLI-343M8C(FGHJ)	SLR343BC4T(JK)	
D5026		TLGE68TG(NP)	SLR343BC4T(JK)	
D5029		SLI-343M8C(FGHJ)	SLR343BC4T(JK)	
D5030		SLI-343M8C(FGHJ)	SLR343BC4T(JK)	
D5031		SLI-343M8C(FGHJ)	SLR343BC4T(JK)	
R5031		RS1/10SR563J	RS1/10SR103J	
R5032		RS1/10SR563J	RS1/10SR103J	
R5033		RS1/10SR563J	RS1/10SR103J	
R5034		RS1/10SR563J	RS1/10SR103J	
R5035		RS1/10SR563J	RS1/10SR103J	
R5036		RS1/10SR563J	RS1/10SR103J	
R5037		RS1/10SR563J	RS1/10SR103J	
R5041		RS1/10SR820J	RS1/10SR271J	
R5042		RS1/10SR820J	RS1/10SR271J	
R5043		RS1/10SR820J	RS1/10SR271J	
R5044		RS1/10SR820J	RS1/10SR271J	
R5048		RS1/10SR820J	RS1/10SR271J	
R5049		RS1/10SR820J	RS1/10SR271J	
R5050		RS1/10SR820J	RS1/10SR271J	
R5051		RS1/10SR820J	RS1/10SR271J	
R5064		RS1/10SR221J	RS1/10SR271J	
R5065		RS1/10SR221J	RS1/10SR271J	
R5066		RS1/10SR820J	RS1/10SR271J	
R5067		RS1/10SR820J	RS1/10SR271J	
R5069		RS1/10SR820J	RS1/10SR181J	
R5070		RS1/10SR820J	RS1/10SR271J	
R5071		RS1/10SR563J	RS1/10SR103J	
R5072		RS1/10SR563J	RS1/10SR103J	

Mark	Symbol and Description	DWX3136	DWX3135	Remarks
	R5073	RS1/10SR563J	RS1/10SR103J	
	R5082	RS1/10SR820J	RS1/10SR271J	
	R5084	RS1/10SR820J	RS1/10SR271J	
	R5086	RS1/10SR820J	RS1/10SR271J	
	R5088	RS1/10SR820J	RS1/10SR271J	
	R5093	RS1/10SR681J	RS1/10SR391J	
	R5096	RS1/10SR820J	RS1/10SR271J	
	R5097	RS1/10SR820J	RS1/10SR271J	

EF FADR ASSY

DWX3118 and DWX3255 are constructed the same except for the following:

Mark	Symbol and Description	DWX3118	DWX3255	Remarks
	D6009	SLI-343Y8C(KLMN)	SLR343BC4T(JK)	
	D6010	SLI-343Y8C(KLMN)	SLR343BC4T(JK)	
	R6001	RS1/10SR221J	RS1/10SR331J	
	R6002	RS1/10SR221J	RS1/10SR331J	

GF MAIN ASSY

DWX3112 and DWX3256 are constructed the same except for the following:

Mark	Symbol and Description	DWX3112	DWX3256	Remarks
	IC1011	DYW1794	DYW1802	