

STEREO TURNTABLE  
**PL-115D**  
KCT, KUT

<ART-165-0>

*Service Manual*



 **PIONEER**<sup>®</sup>

# CONTENTS

1.	SPECIFICATIONS .....	4
2.	PANEL FACILITIES .....	5
3.	PARTS LOCATIONS	
3.1	Top View .....	7
3.2	Bottom View .....	9
4.	EXPLODED VIEW	
4.1	Main Panel .....	11
4.2	Sub Panel .....	13
4.3	Tone Arm .....	14
4.4	Cabinet .....	15
4.5	Packing .....	16
5.	NOMENCLATURE OF SCREWS, WASHERS AND NUTS .....	17

# 1. SPECIFICATIONS

## MOTOR AND TURNTABLE

Motor ..... 4-pole synchronous  
Turntable drive ..... Belt-driven  
Speed ..... Two speeds: 33-1/3rpm, 45rpm  
Wow and flutter ..... 0.07% (WRMS) or less  
S/N ..... 50dB (JIS) or more  
(using Pioneer cartridge model PC-135)  
Turntable platter ..... 30cm diam. aluminum alloy  
Moment of inertia ..... 135kg-cm<sup>2</sup> (including rubber mat)

## TO NEARM

Tonearm type ..... Static-balance, S-shaped, pipe arm  
Effective arm length ..... 221mm  
Tracking error ..... +3° ~ -1°  
Overhang ..... 15.5mm  
Usable cartridge weight ..... 4g (min.) ~ 10g (max.)  
(For cartridge weighs over 8.5g, attach the sub weight)

## SUBFUNCTIONS

Automatic return tonearm system  
Anti-skating force control  
Plug-in type headshell  
Oil-damped arm elevator  
Hinges (Free-adjustable)  
Lateral balancer

## MISCELLANEOUS

Power requirements ..... AC 120V, 60Hz  
Power consumption ..... 10W  
Dimensions ..... 440(W) × 362(D) × 159(H) mm  
17-5/16(W) × 14-1/4(D) × 6-1/4(H) in.  
Weight ..... 6kg, 13 lb 3 oz.

## ACCESSORIES

Headshell ..... 1  
Accessory oil ..... 1  
Overhang gauge ..... 1  
45rpm adaptor ..... 1  
Screwdriver ..... 1  
Sub weight ..... 1  
Cartridge mounting screws ..... 6  
Cartridge mounting nuts ..... 2  
Cartridge mounting washers ..... 2  
Operating instructions ..... 1

### NOTE:

*Specifications and design subject to possible modification without notice due to improvements.*



## 2. PANEL FACILITIES

### HEADSHELL STAND

A spare headshell can be stored in this stand. Align the headshell pins with the stand grooves and insert. Observe that the headshell length is not greater than the height of the dust cover. This stand can also be used for storing the 45rpm adaptor.

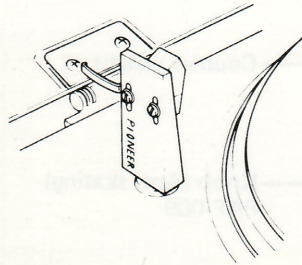

### SPEED SELECT LEVER

Either of the two speeds, 33-1/3rpm or 45rpm, can be selected by this lever. Only change the position while the turntable is rotating.

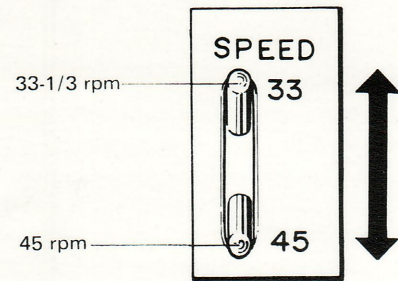

### 45RPM ADAPTOR

A 45rpm record adaptor is supplied in the accessory box, which permits 45rpm EP records with large center holes to be played.

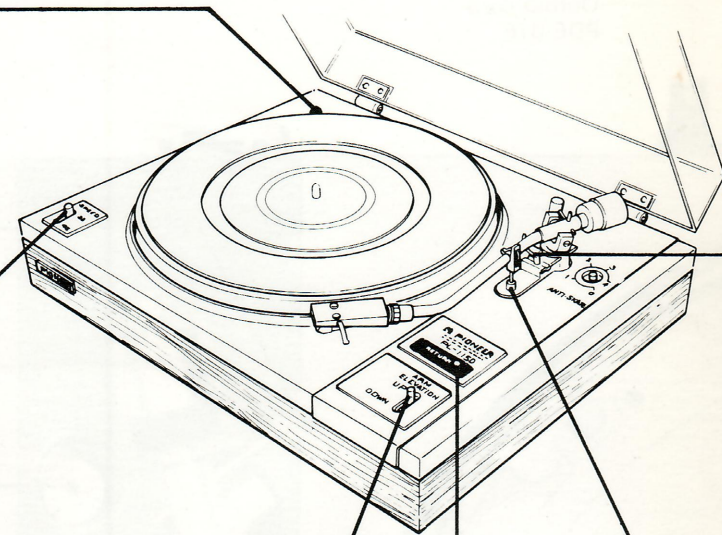

### ARM ELEVATION

Arm elevation may require adjustment according to cartridge height. If necessary, use the accessory screwdriver to loosen the setscrew and adjust (see figure).

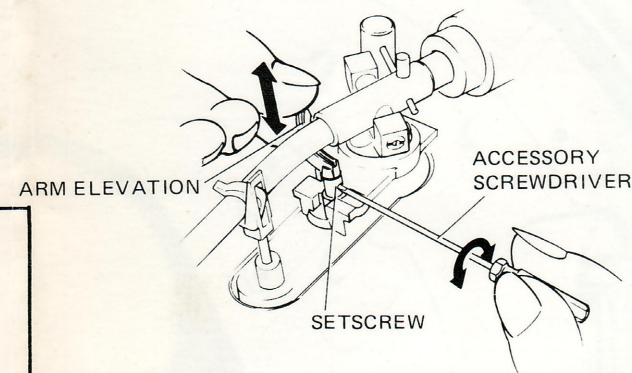

### RETURN BUTTON

To stop playback before the end of a record, press this button; the tonearm returns automatically to the arm rest then the power is switched off.



RETURN BUTTON

### ARM REST

The arm rest supports the tonearm, which should be secured by the arm clamp when not in use. Before raising the tonearm, be sure to release the clamp.

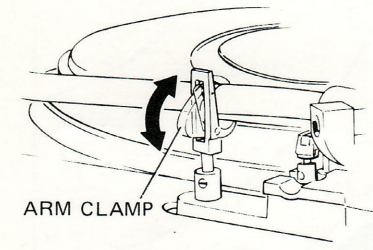

ARM CLAMP

### ARM ELEVATION LEVER

Setting this lever to UP raises the tonearm, while setting it to DOWN lowers the tonearm gently onto the record. This device is convenient for cueing any position on the record without fear of scratching the record surface.

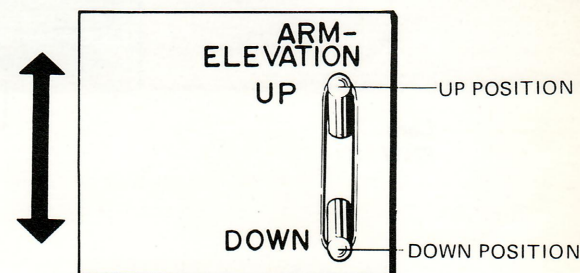

## OPERATION

1. Place the record to be played on the turntable platter.
2. Remove the stylus cover and disengage the arm clamp.
3. After setting the ARM ELEVATION lever to UP, move the tonearm from the arm rest. (The turntable platter will begin to rotate.)
4. Set the SPEED select lever to the correct speed according to the record to be played.
5. Position the tonearm above the desired portion of the record by hand.
6. Move the ARM ELEVATION lever to DOWN. The stylus will be gently lowered onto the record.
7. Adjust the volume and tone controls of the stereo amplifier as desired.
8. When the record is finished, the tonearm returns to the arm rest automatically and the power is cut off. It is advisable to replace the stylus cover for protection whenever the turntable is not in use.

#### NOTE:

Before playing the next record, be sure to re-set the ARM ELEVATION lever to the UP position to avoid damage.

- If you wish to stop play in the middle, simply push the RETURN button (The tonearm will return to the arm rest, then the power will be switched off).

#### To Take Full Advantage of the Arm Elevation Lever

The ARM ELEVATION lever is particularly convenient when you wish to choose a particular track from an LP record.

- If you move the tonearm with the ARM ELEVATION lever set to DOWN, take care not to damage the stylus point.

#### OPERATING PRECAUTIONS

- Keep stylus and records clean. Use a stylus brush to clean the stylus and a good quality record cleaner to clean the records each time before and after playing.
- Avoid exerting unnecessary force on the tonearm. When changing headshells, set the tonearm in the arm rest and engage the clamp.
- Take care not to impart vibration to the turntable while a record is playing. Record and stylus can be damaged.
- Never touch the SPEED select lever if the turntable is stationary. The speed can be changed only while the turntable is rotating.
- Never obstruct the turntable by hand while it is rotating. This may cause damage.



### 3. PARTS LOCATIONS

#### 3.1 TOP VIEW

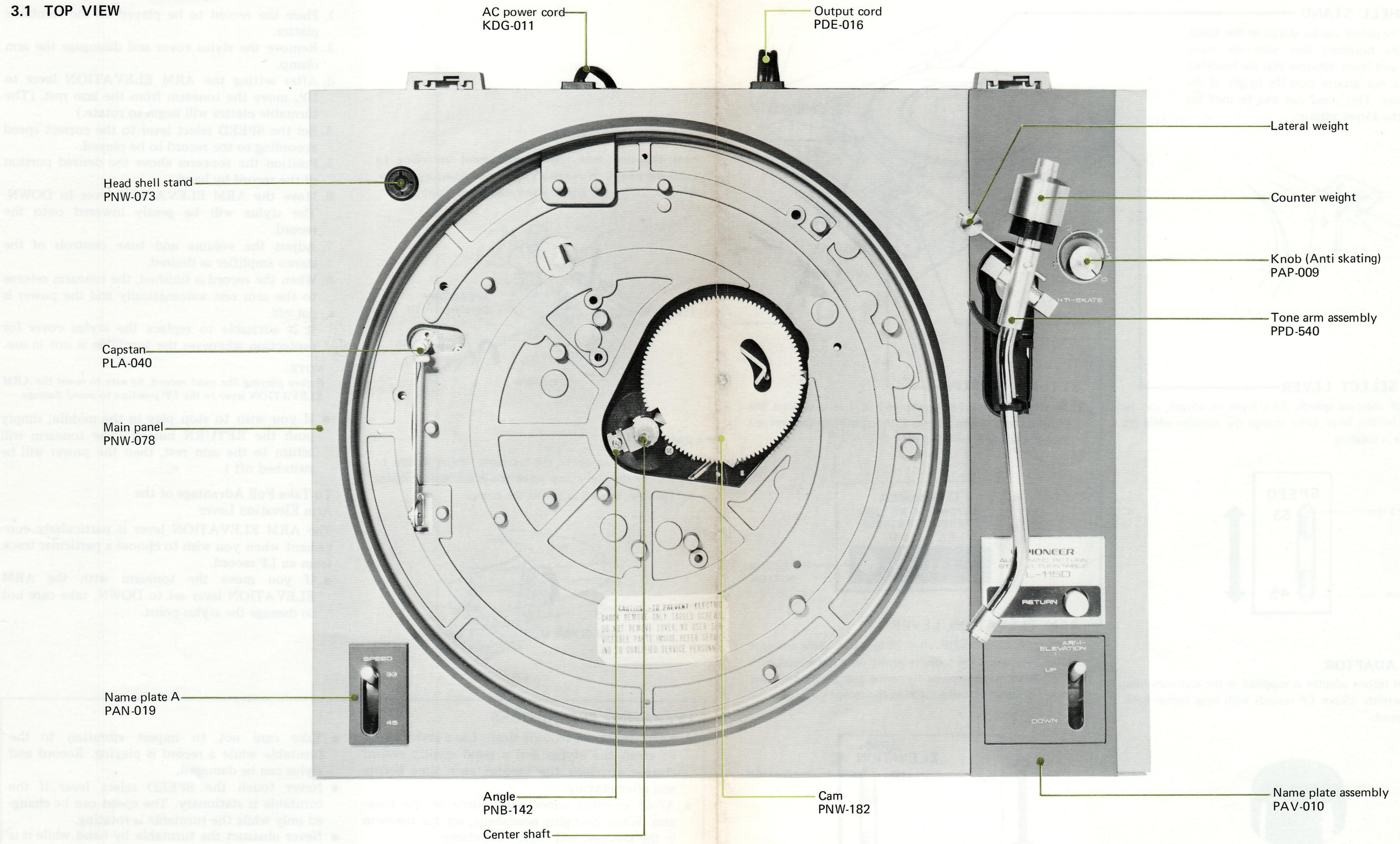



3.2 BOTTOM VIEW

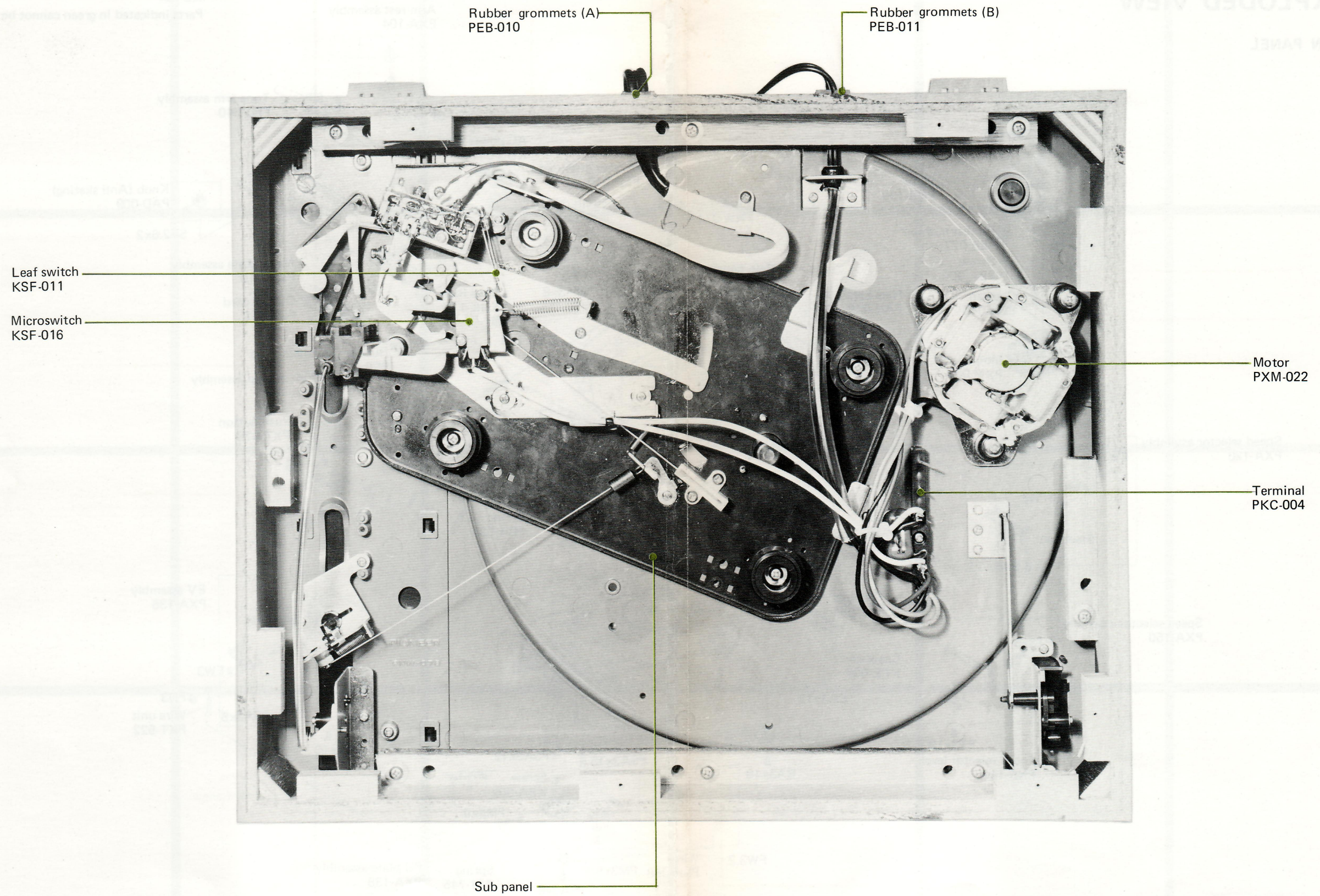



# 4. EXPLODED VIEW

## 4.1 MAIN PANEL

NOTE:  
Parts indicated in green cannot be supplied.

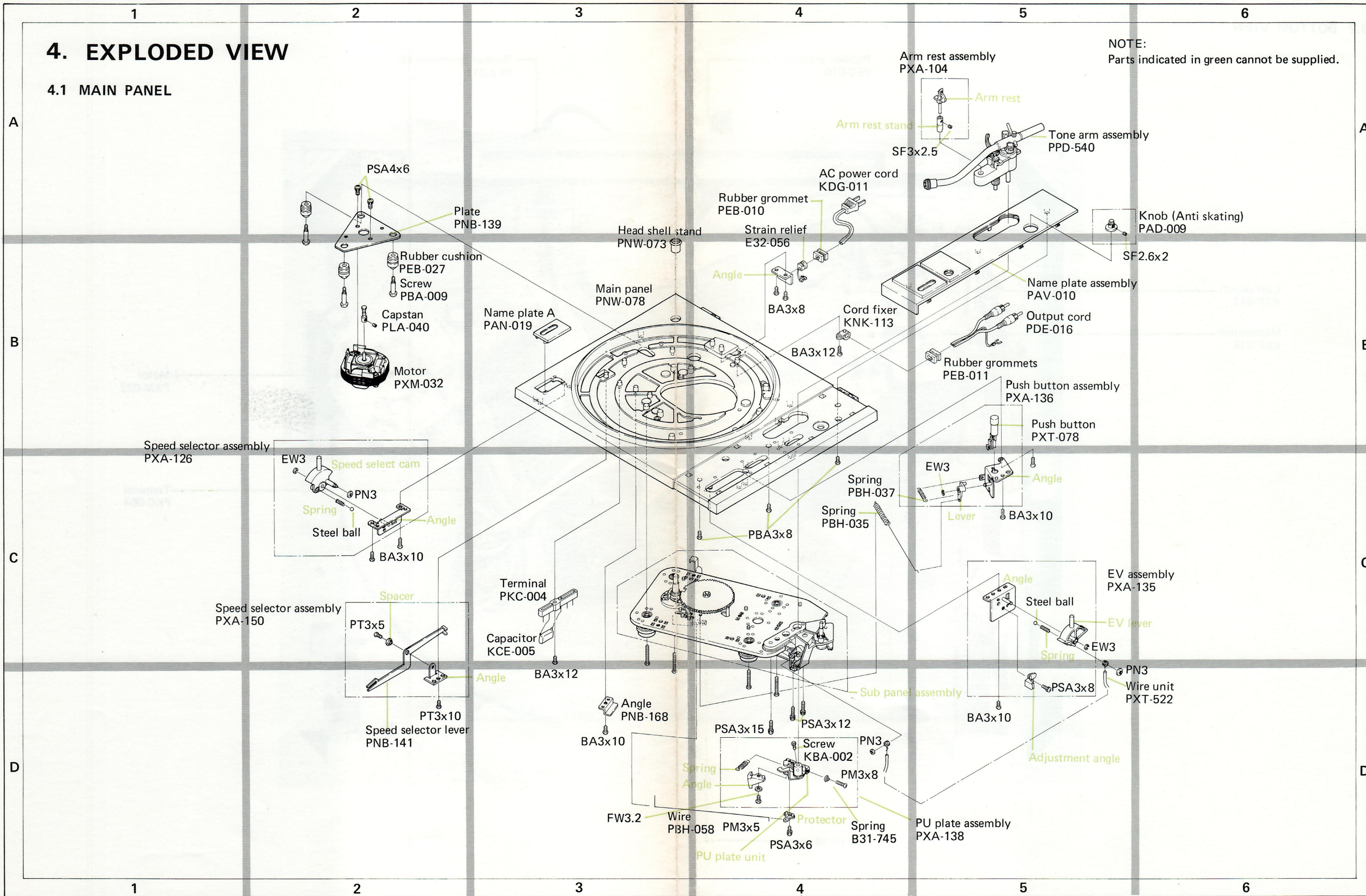



4.2 SUB PANEL

NOTE:  
Parts indicated in green cannot be supplied.

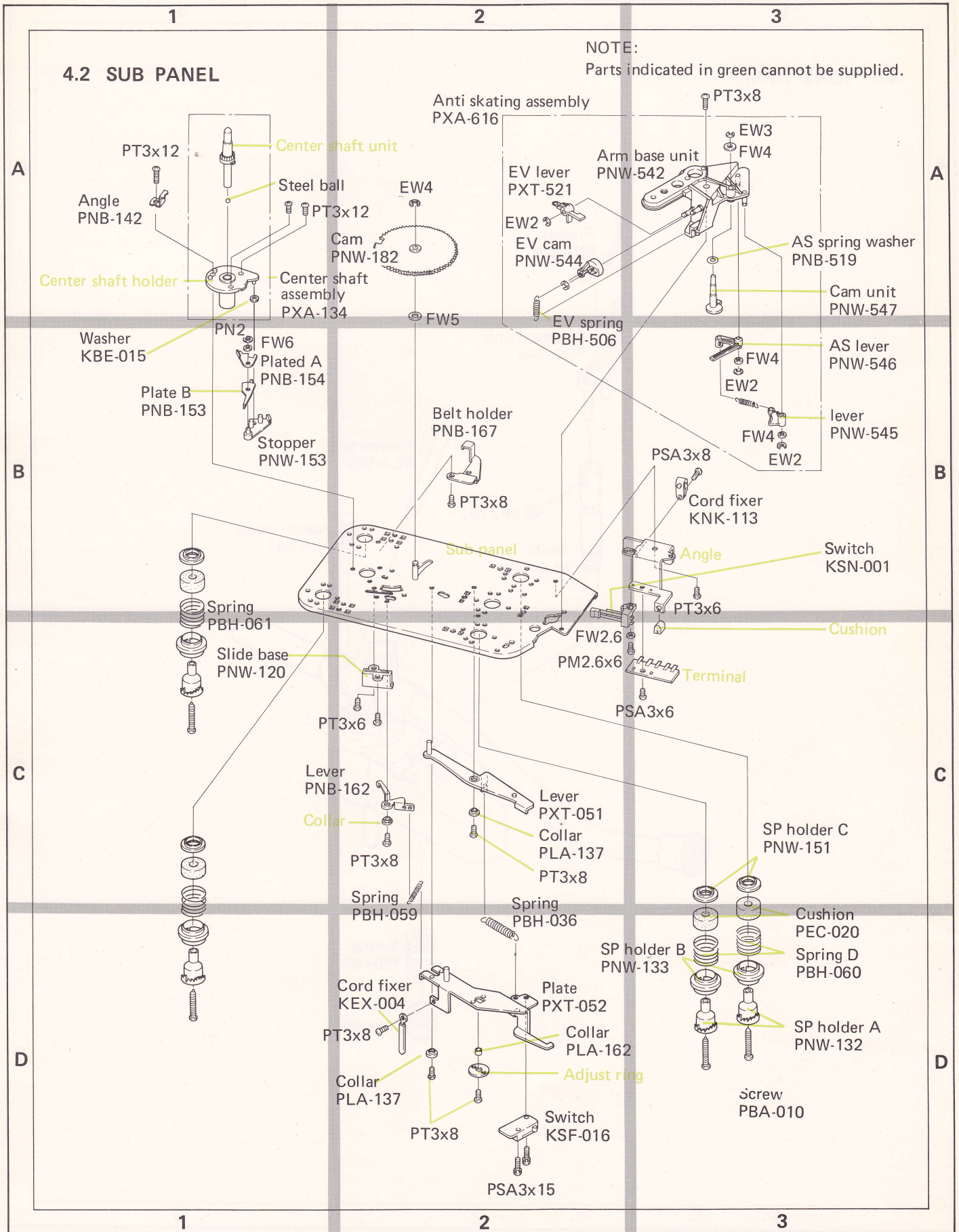



### 4.3 TONE ARM

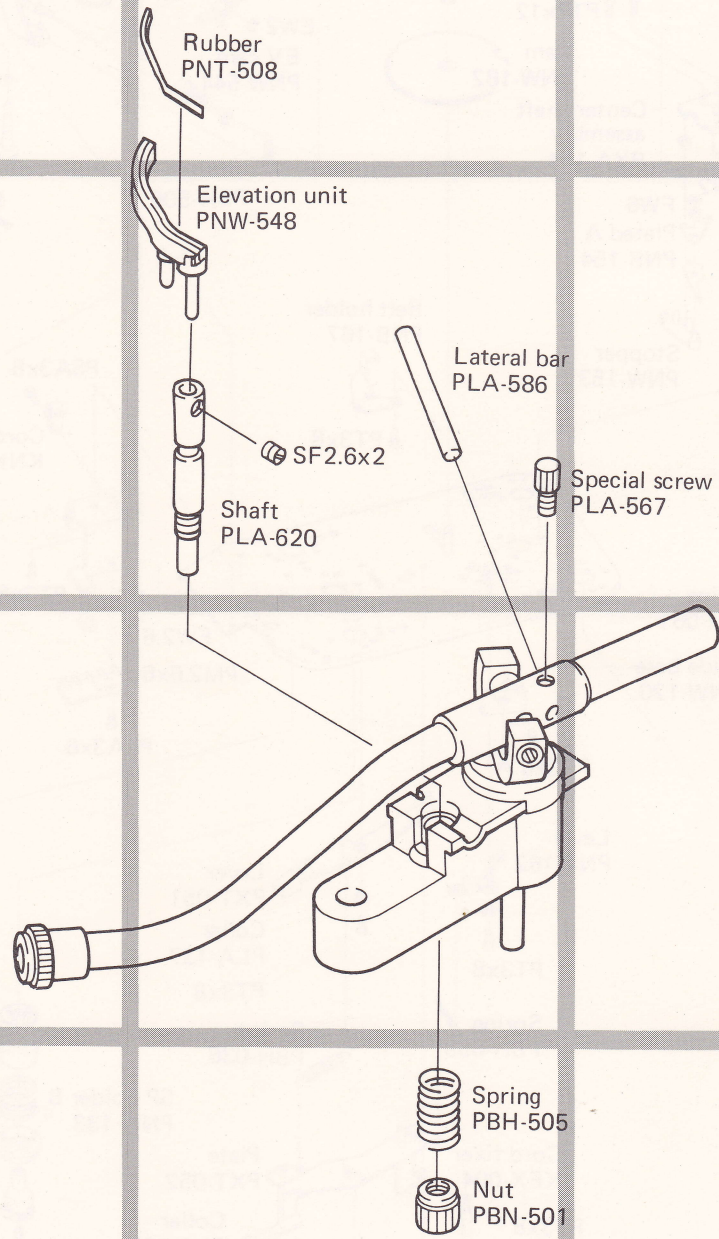



4.4 CABINET

Dust cover assembly  
PXA-159

NOTE:  
Parts indicated in green cannot be supplied.

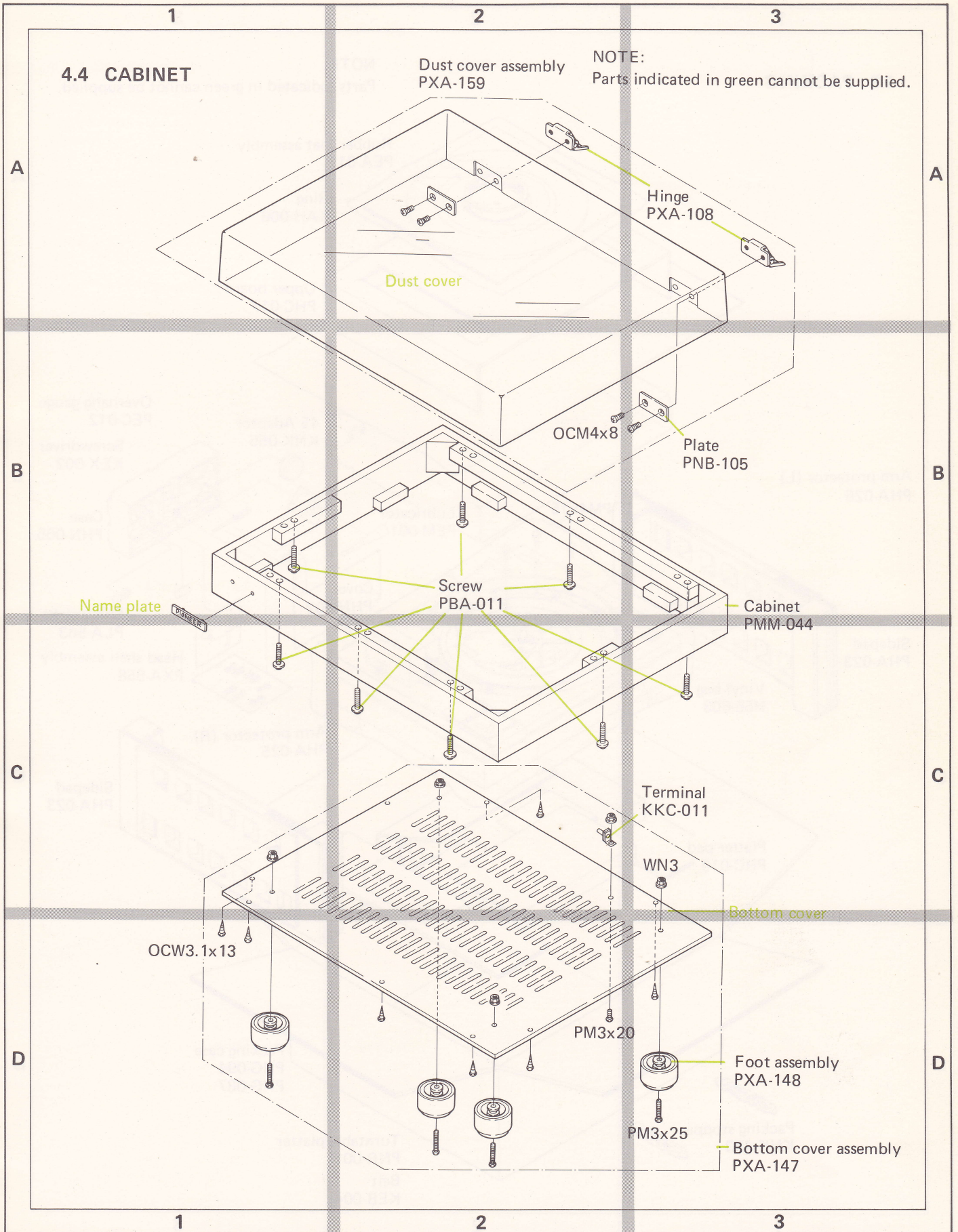



# 4.5 PACKING

NOTE:  
Parts indicated in green cannot be supplied.

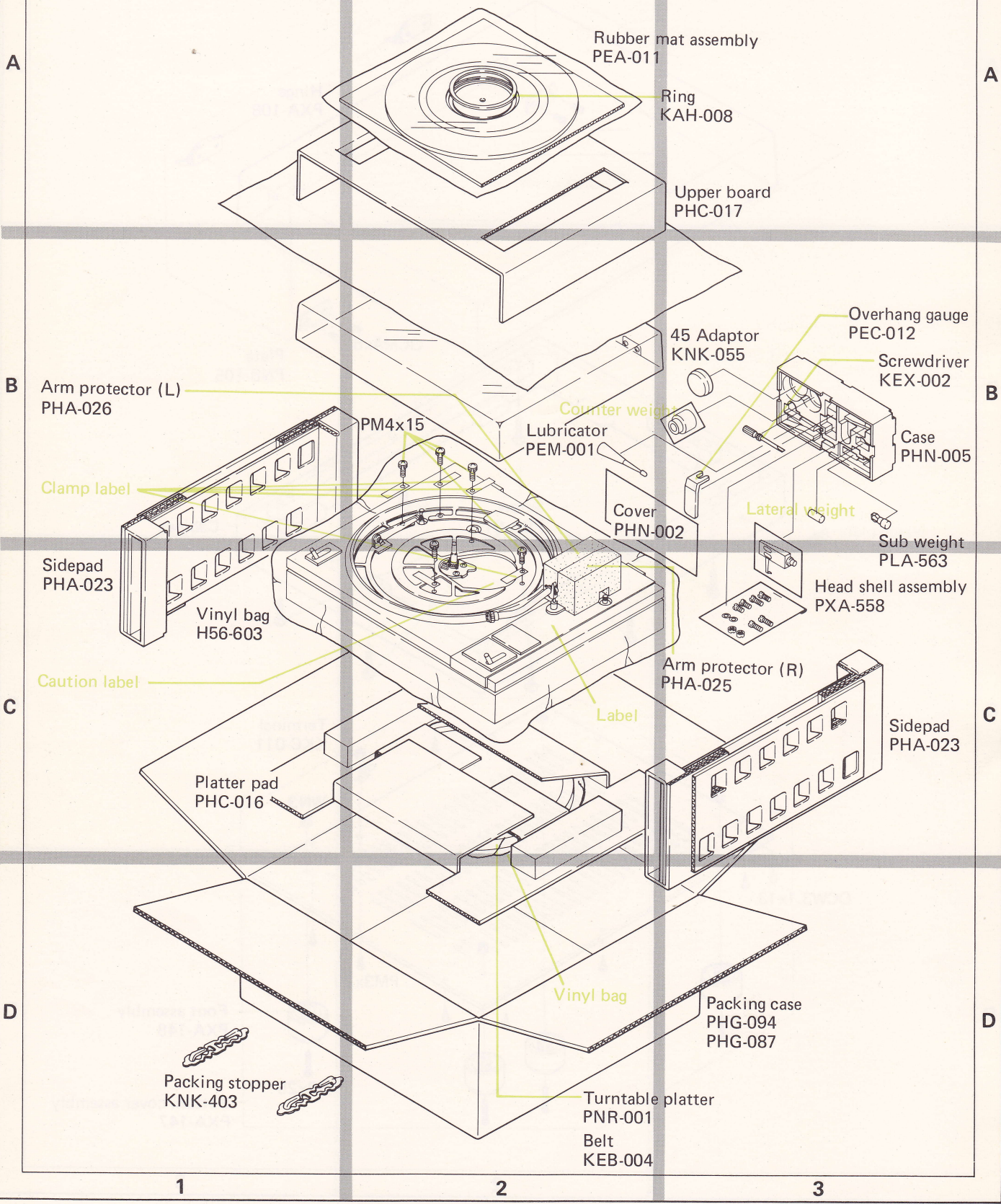



# 5. NOMENCLATURE OF SCREWS, WASHERS AND NUTS

The following symbols stand for screws, washers and nuts as shown in exploded view.

Symbol	Description	Shape
RT	Brazier head tapping screw	
PT	Pan head tapping screw	
PTT	Special screw (A)	
PTBA	Special screw (B)	
POTBA	Special screw (C)	
OCT	Oval countersunk head tapping screw	
PM	Pan head machine screw	
CM	Countersunk head machine screw	
OCM	Oval countersunk head machine screw	
TM	Truss head machine screw	
BM	Binding head machine screw	
PSA	Pan head screw with spring lock washer	
PSB	Pan head screw with spring lock washer and flat washer	
PSF	Pan head screw with flat washer	

Symbol	Description	Shape
EW	E type washer	
FW	Flat washer	
SW	Spring lock washer	
N	Nut	
WN	Washer faced nut	
PN	Push nut	
FFW	Fiber flat washer	
SC	Slotted set screw (Cone point)	
SF	Slotted set screw (Flat point)	
HS	Hexagon socket headless set screw	
OCW	Oval countersunk head wood screw	
CW	Countersunk head wood screw	
RW	Round head wood screw	

### EXAMPLE

PM • 3x8

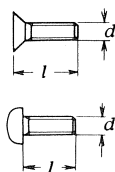
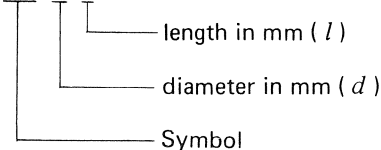

FW • 9φ x 1<sup>t</sup>

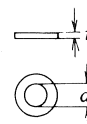
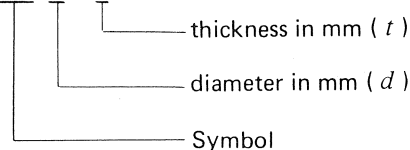



**PIONEER ELECTRONIC CORPORATION**

4-1, Meguro 1-Chome, Meguro-ku, Tokyo 153, Japan

**U.S. PIONEER ELECTRONICS CORPORATION**

75 Oxford Drive, Moonachie, New Jersey 07074, U.S.A.

**PIONEER ELECTRONIC (EUROPE) N.V.**

Luithagensteenweg no. 9, 2030 Antwerp, Belgium

**PIONEER ELECTRONICS AUSTRALIA PTY. LTD.**

178-184 Boundary Road, Braeside, Victoria 3195, Australia

© FEB. 1976 Printed in Japan