

DIRECT DRIVE
STEREO TURNTABLE
PL-510
HGT

<ART-170-0>

Service Manual

Additional Information

This leaflet provides the description of the parts applied only HGT model.

For detailed instructions on adjustments, description, etc., please refer to the Service Manual of PL-510/KCT, KUT, KLT.

1. SCHEMATIC DIAGRAM

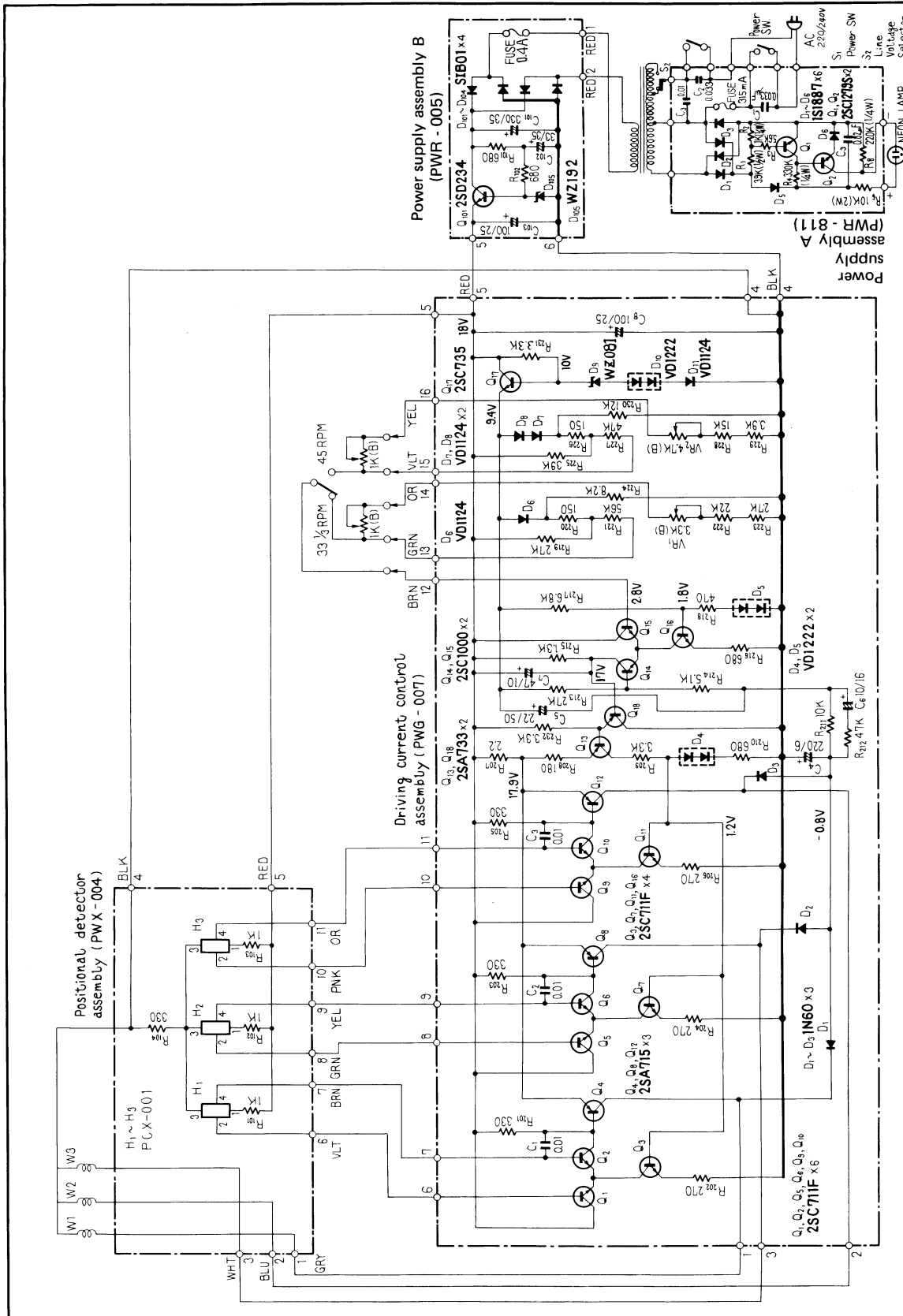

2. EXPLODED VIEW

NOTE:
Parts indicated in green cannot be supplied.

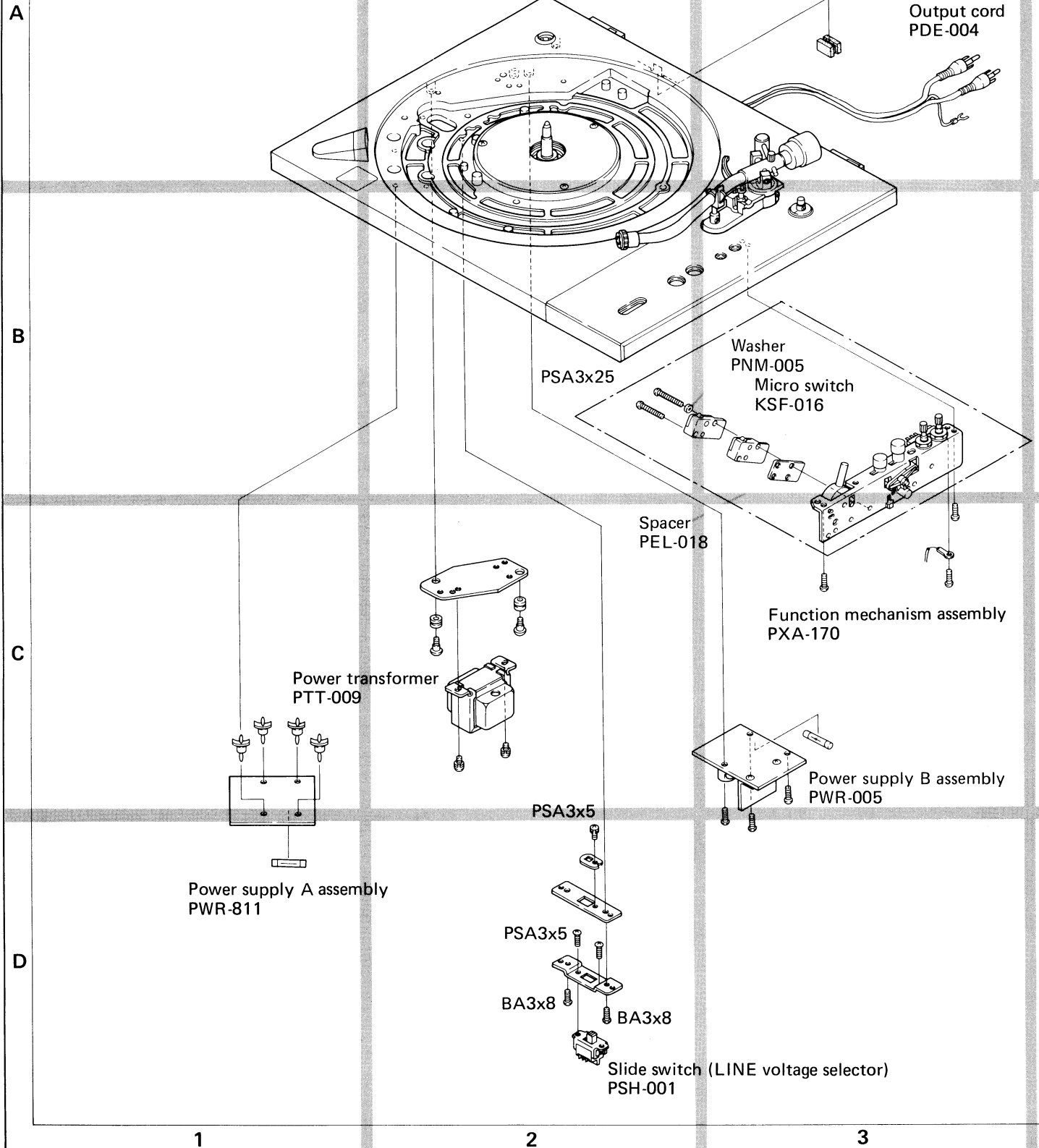

4

5

6

The parts indicated the designation and parts number are newly-employed as HGT model.

The parts without description are the same as the parts in the KCT model.

Output cord
PDE-004

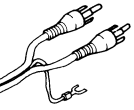

ism assembly

ly B assembly

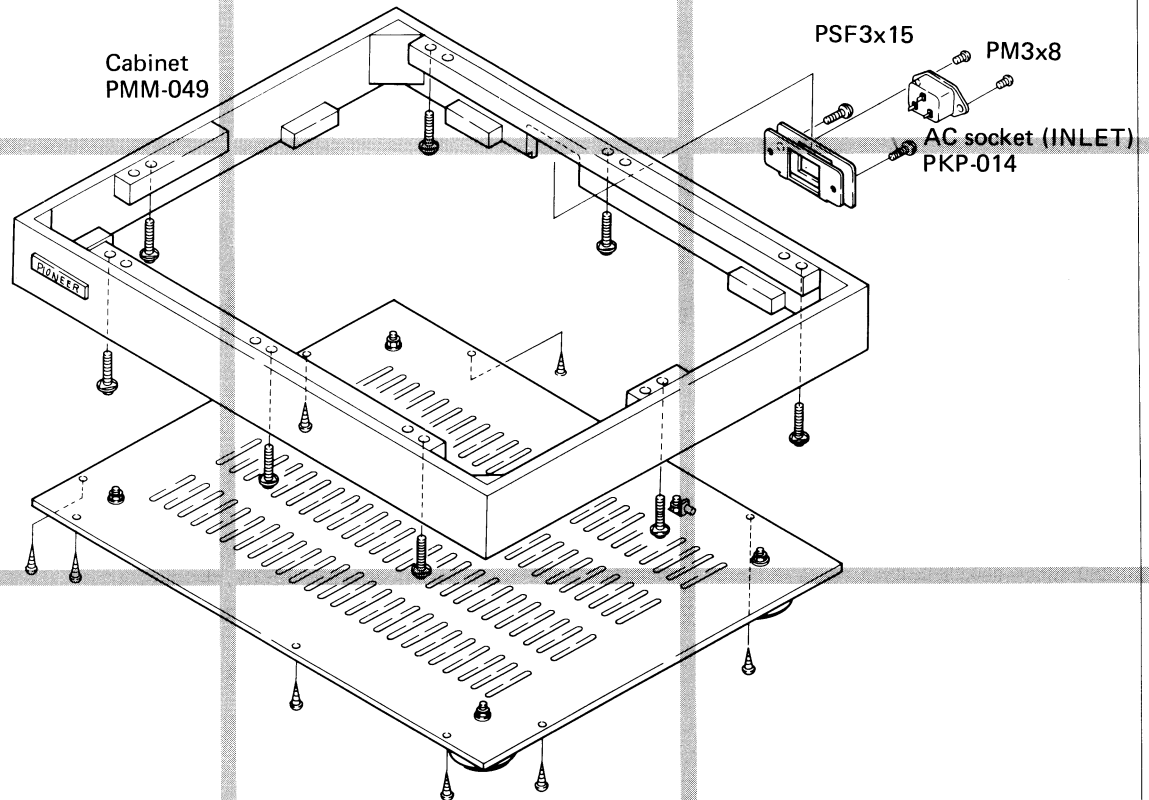

The following parts are changed the parts number as shown in the table.

| Part Name | Part No. (HGT model) |
|------------------------|--------------------------|
| Anti skating assembly | PXA-600 |
| Rubber mat assembly | PEA-013 |
| Headshell assembly | PXA-630 |
| Packing case | PHG-098 |
| Power supply assemblyB | PWR-005 |
| Fuse 4A | PEK-005 |
| Fuse clip | KKR-001 |
| Operating instructions | PRB-026 (English) |
| Operating instructions | PRD-012 (French/Germany) |

4

5

6

3. P. C. BOARD PATTERN AND PARTS LIST

POWER SUPPLY ASSEMBLY A (PWR-811)

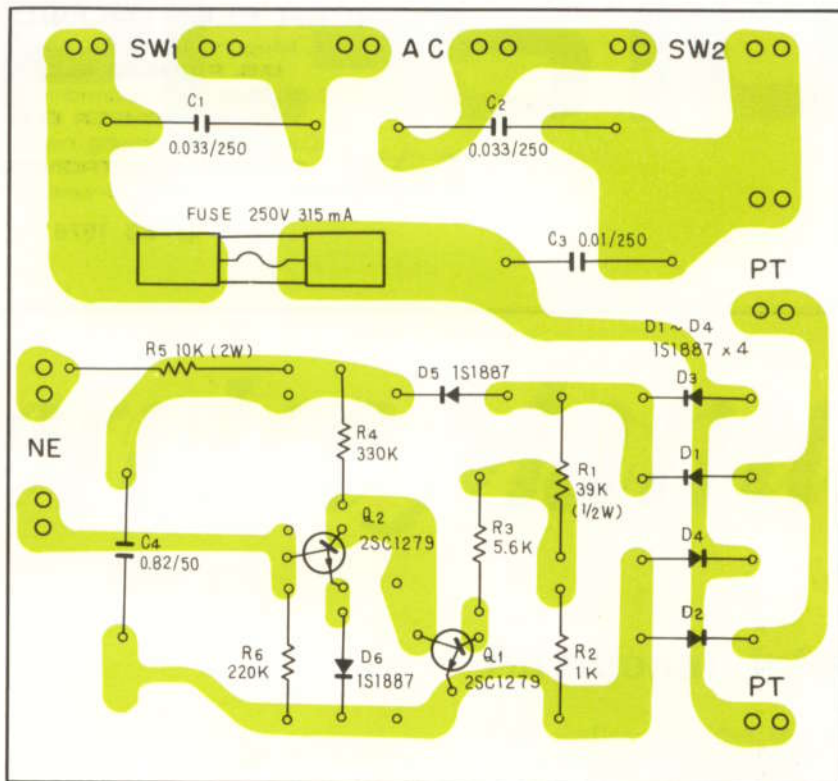

Part List of Power Supply Assembly A (PWR-811)

| Symbol | Description | Part No. |
|--------|-------------------------|--------------------|
| C1 | Ceramic 0.033 250V | PCL-013 |
| C2 | Ceramic 0.033 250V | PCL-013 |
| C3 | Ceramic 0.01 250V | ACG-001 |
| C4 | Ceramic 0.82 50V | PCL-010 |
| R1 | Carbon film 39k 1/2W | RD1/2P 393J |
| R2 | Carbon film 1k | RD1/2P 102J |
| R3 | Carbon film 5.6k | RD1/2P 562J |
| R4 | Carbon film 330k | RD1/2P 334J |
| R5 | Metal oxide 10k 2W | RS2P 103J |
| R6 | Carbon film 220k | RD1/2P 224J |
| D1 | Diode | 1S1887 |
| D2 | Diode | 1S1887 |
| D3 | Diode | 1S1887 |
| D4 | Diode | 1S1887 |
| D5 | Diode | 1S1887 |
| D6 | Diode | 1S1887 |
| Q1 | Transistor | 2SC1279S |
| Q2 | Transistor | 2SC1279S |
| FU | Fuse 315mA Fuse clip | KEK-008 KKR-001 |

PIONEER ELECTRONIC CORPORATION

4-1, Meguro 1-Chome, Meguro-ku, Tokyo 153, Japan

U.S. PIONEER ELECTRONICS CORPORATION

75 Oxford Drive, Moonachie, New Jersey 07074, U.S.A.

PIONEER ELECTRONIC (EUROPE) N.V.

Luithagensteenweg no. 9, 2030 Antwerp, Belgium

PIONEER ELECTRONICS AUSTRALIA PTY. LTD.

178-184 Boundary Road, Braeside, Victoria 3195, Australia

© FEB. 1976

Printed in Japan