

- SWITCHES**
- 1. AM
  - 2. FM PHONO
  - 3. FM AUTO
  - 4. PHONO 1
  - 5. PHONO 2
  - 6. AUX 1
  - 7. AUX 2

- RIGHT CHANNEL FRONT**
- 1. PHONO 1
  - 2. PHONO 2
  - 3. AUX 1
  - 4. AUX 2
  - 5. REC TAPE 1
  - 6. REC TAPE 2
  - 7. MON
  - 8. REC TAPE 1
  - 9. REC TAPE 2
  - 10. MON

- REAR**
- 1. AUX 1
  - 2. AUX 2
  - 3. REC TAPE 1
  - 4. REC TAPE 2
  - 5. MON
  - 6. REC TAPE 1
  - 7. REC TAPE 2
  - 8. MON

- NOTES**
- 1. SIGNAL VOLTAGE NECESSARY FOR OBTAINING 70% OF OUTPUT POWER (100%)
  - 2. DC OR D.C. TAGE AT NO INPUT SIGNAL
  - 3. DC CURRENT AT NO INPUT SIGNAL
  - 4. IN D.C. 1/2 W. ± 5% TOLERANCE UNLESS OTHERWISE NOTED
  - 5. IN A.C. 1/2 W. ± 5% TOLERANCE UNLESS OTHERWISE NOTED
  - 6. IN pF UNLESS OTHERWISE NOTED
  - 7. p.p.s.

- 51: WIDE SELECTOR**
- 1. 7CH. STEREO
  - 2. 4CH. MATRIX REGULAR
  - 3. 4CH. MATRIX SQ
  - 4. 4CH. DISCRETE

- 52: REGENERATION MODE**
- 1. FRONT
  - 2. REAR

- 53: PRIMER SWITCH**
- 1. OFF-ON
  - 2. RELAY

- ROTATION CONTROLS**
- 1. INT. VOLUME
  - 2. SEPARATED
  - 3. REGENERATION VOLUME

MINI SWITCH UNIT  
AWS-025

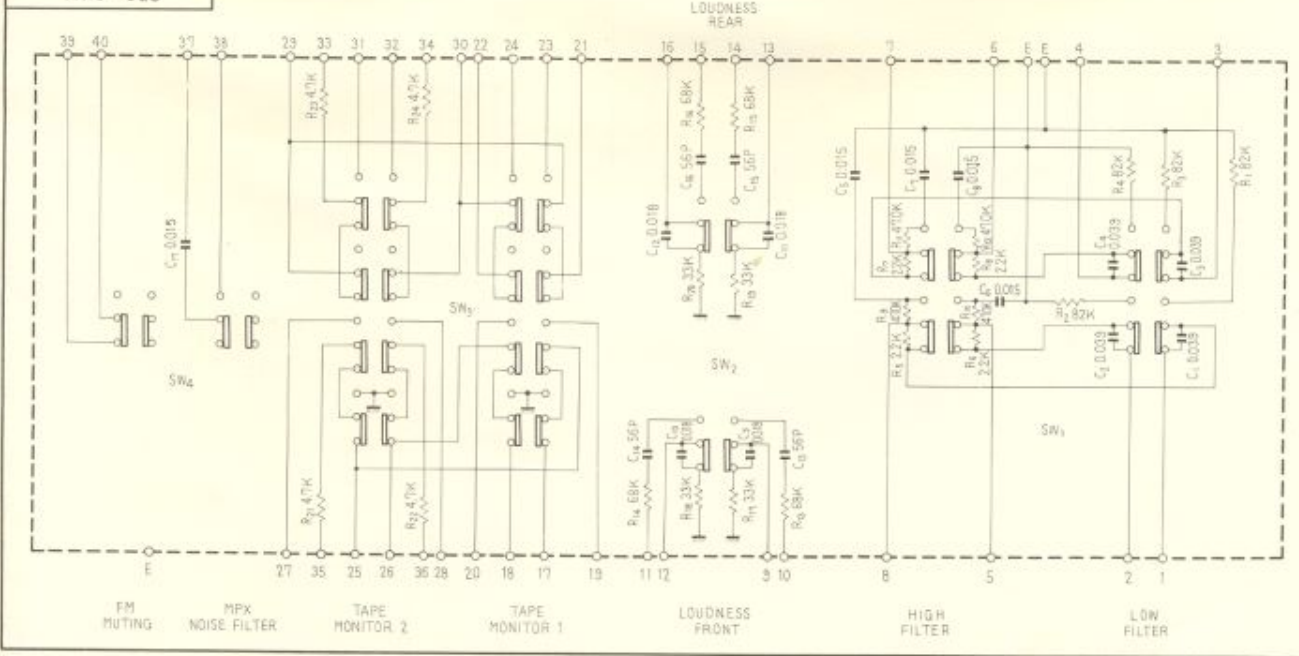

DECODER UNIT  
AWM-031

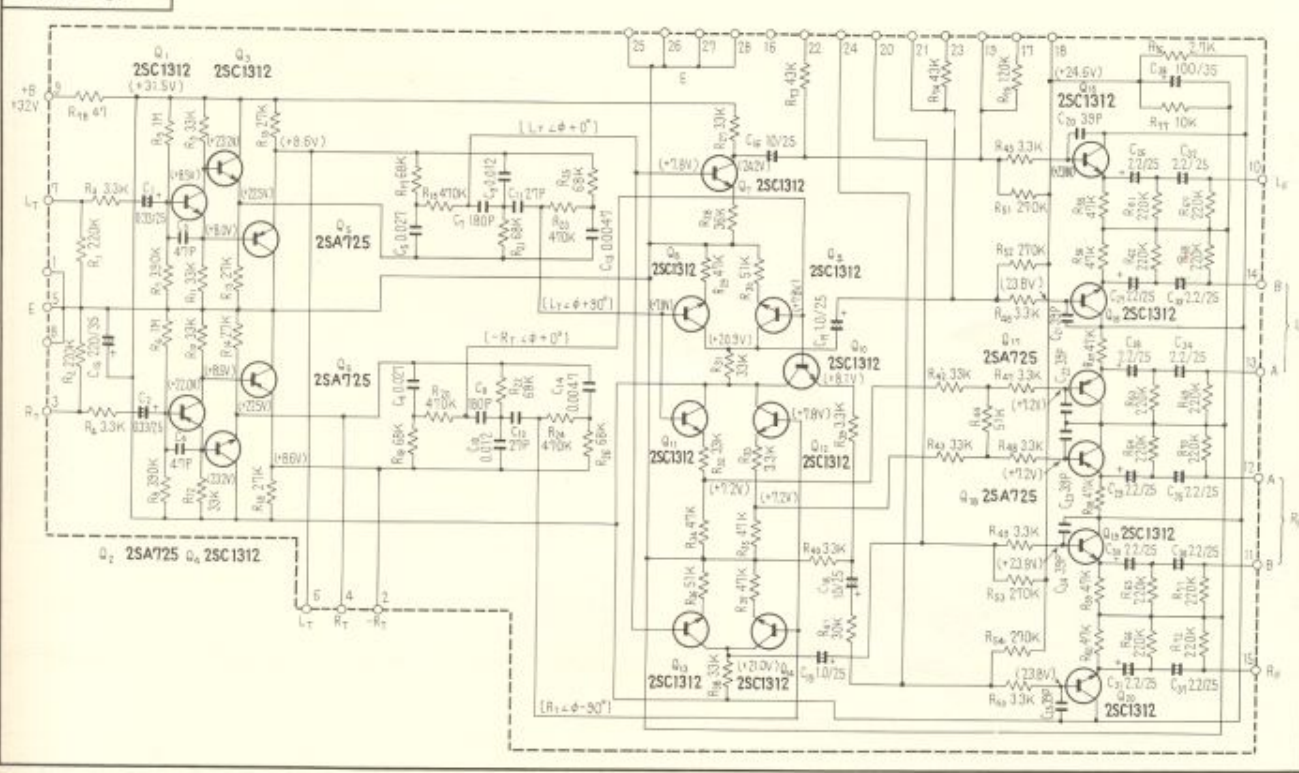

LOGIC UNIT

AWM-032

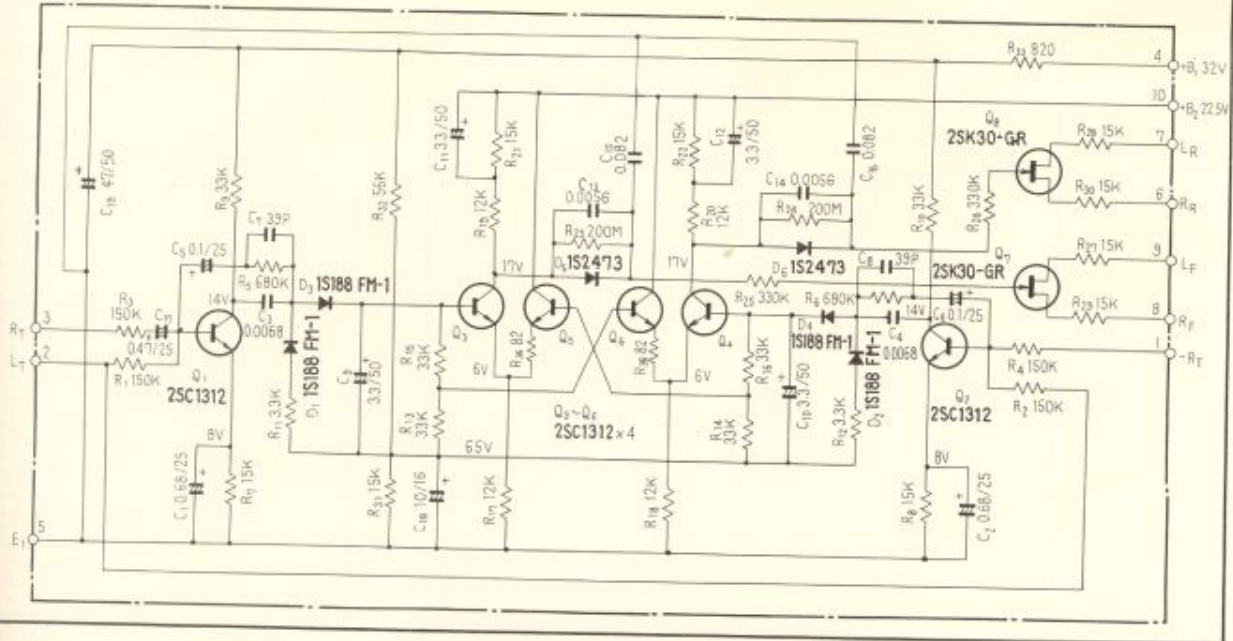

BALANCE VOLUME UNIT

AWX-035

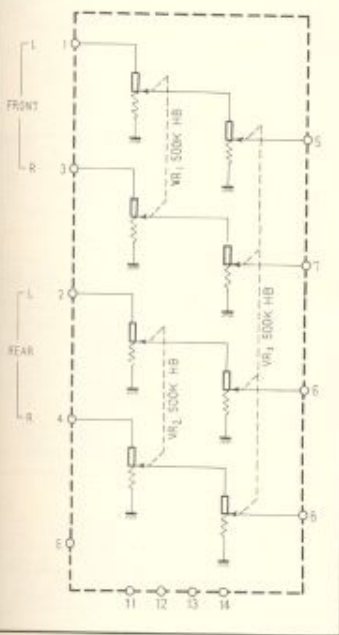

LEVEL CONTROL UNIT

AWX-034

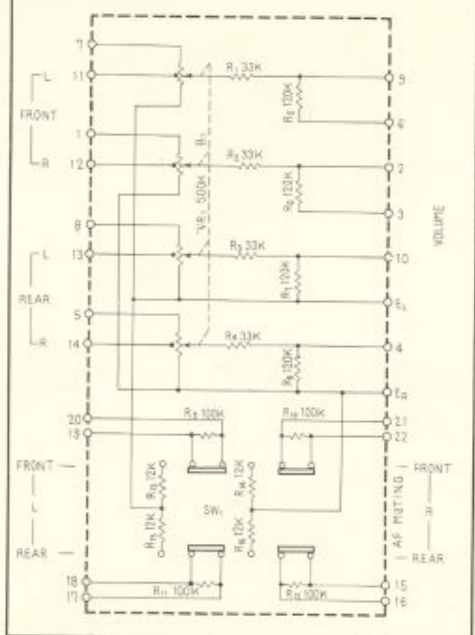

TONE CONTROL UNIT

AWG-014

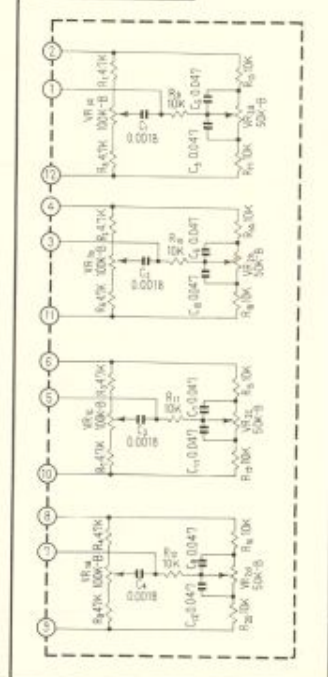

FM/AM UNIT  
AWE - 015

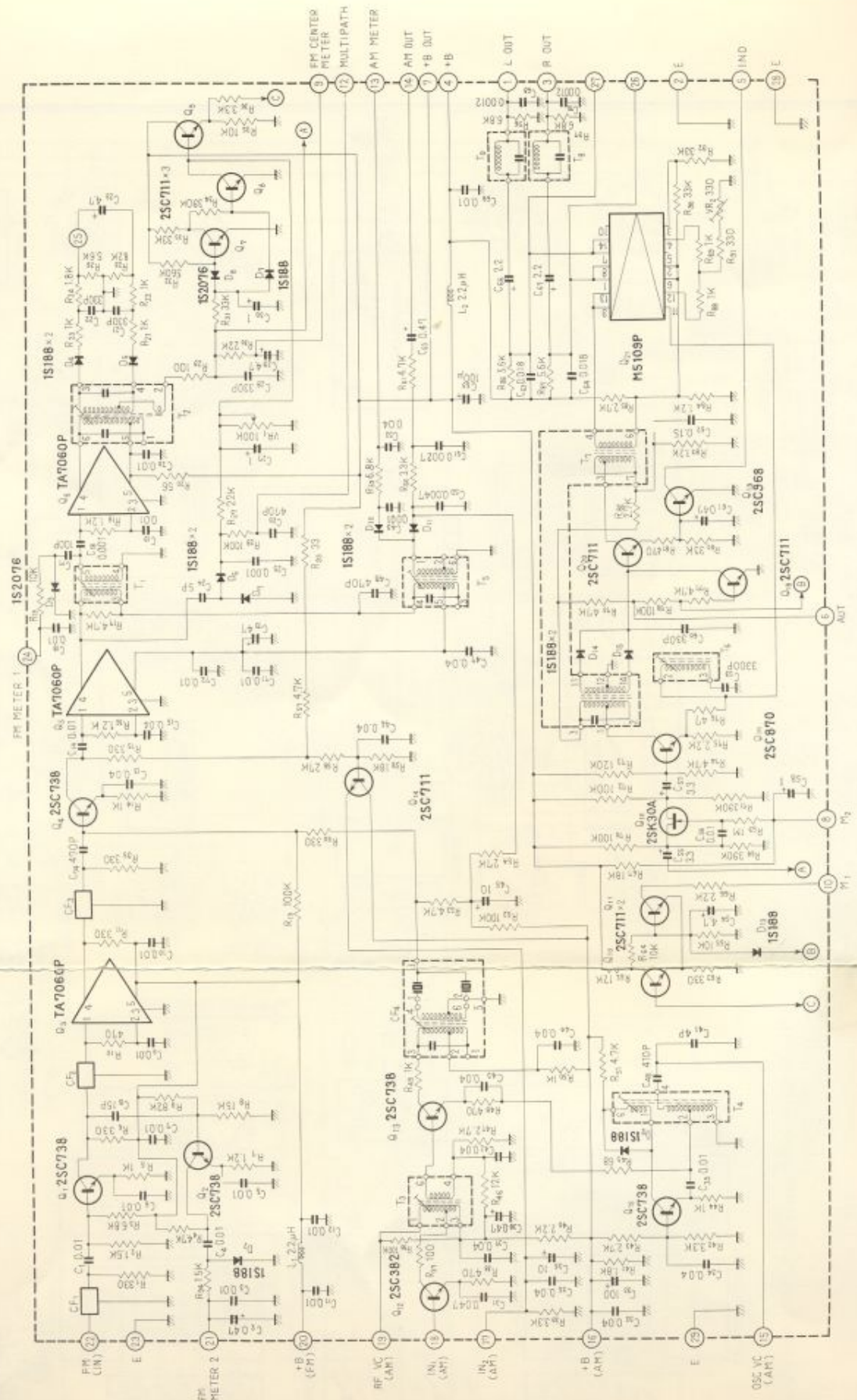

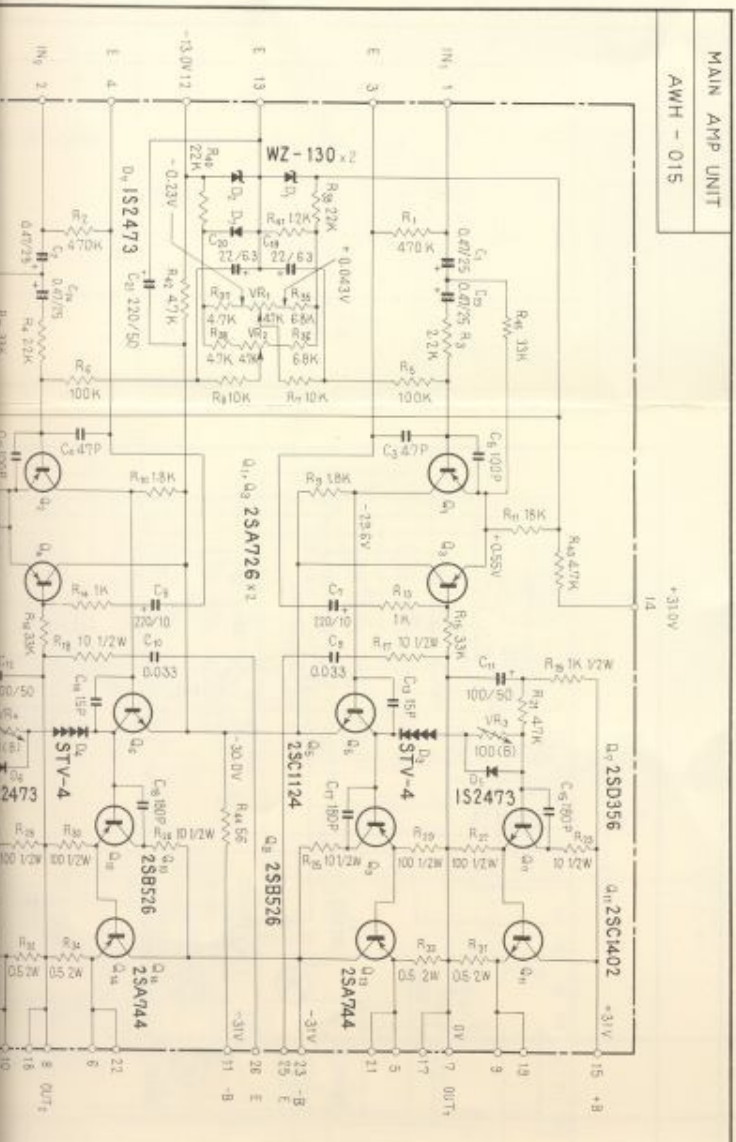
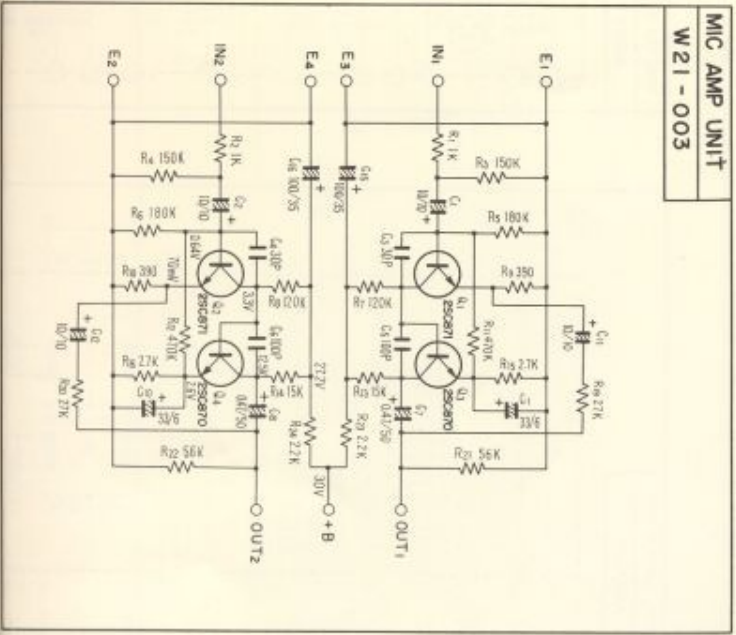
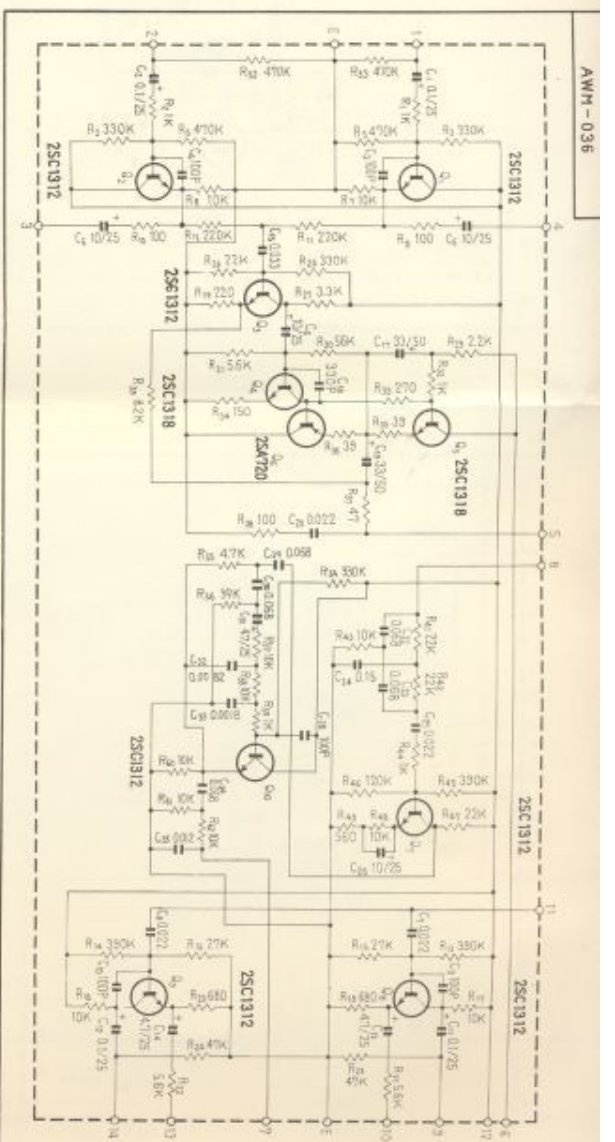
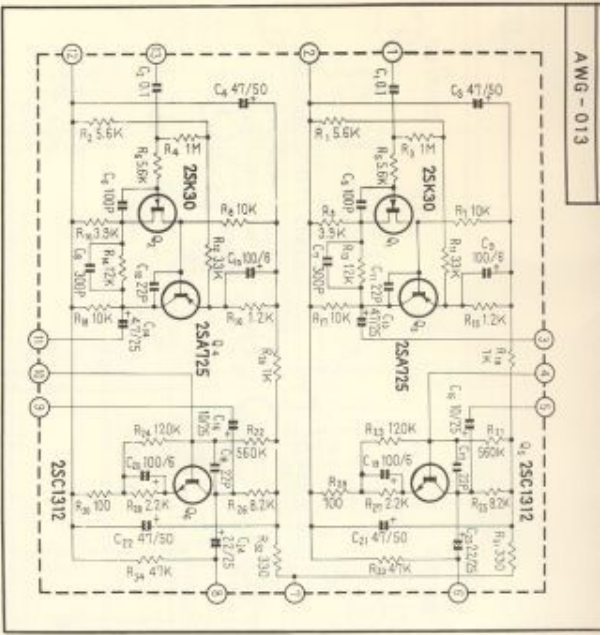

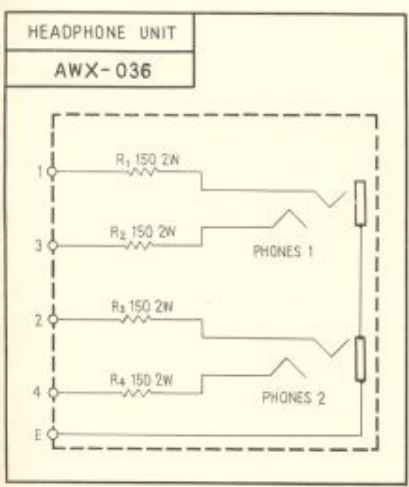
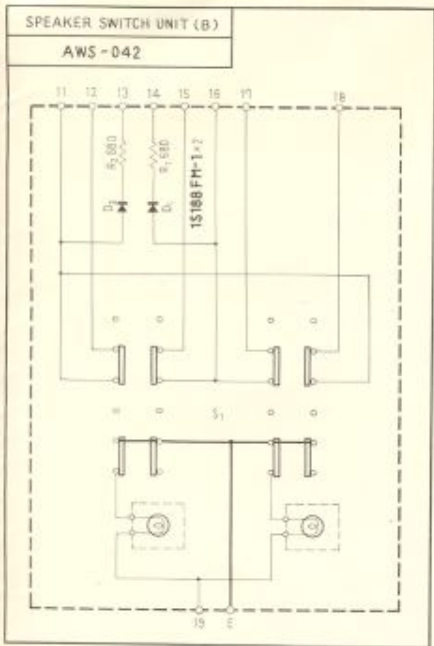

# QX-9900

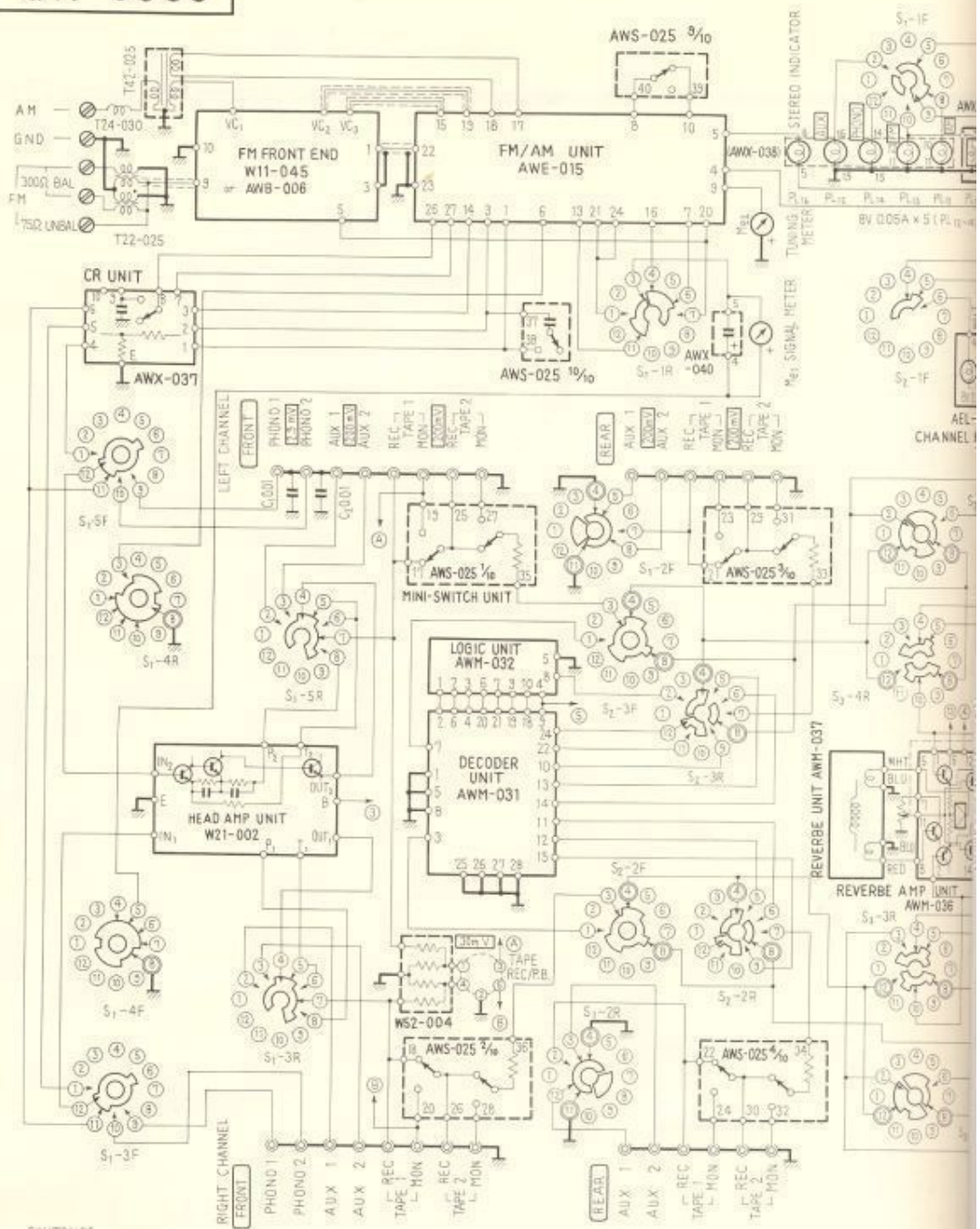

- SWITCHES**
- S<sub>1</sub> - INPUT SELECTOR**
1. AM
  2. FM MONO
  3. FM AUTO
  4. PHONO 1
  5. PHONO 2
  6. AUX 1
  7. AUX 2

- S<sub>2</sub> - MODE SELECTOR**
1. 2CH. STEREO
  2. 4CH. MATRIX REGULAR
  3. 4CH. MATRIX SQ
  4. 4CH. DISCRETE

- S<sub>3</sub> - REVERBERATION MODE**
1. FRONT
  2. REAR
  3. OFF
  4. MIC
- S<sub>5</sub> - PRE & MAIN SWITCH**
1. INTERCOUPLED
  2. SEPARATED

- S<sub>6</sub> - POWER SWITCH**
1. OFF-ON
- S<sub>6</sub> - RELAY**

**NOTES**

IN Ω  
K = KΩ  
M = MΩ  
P = pF

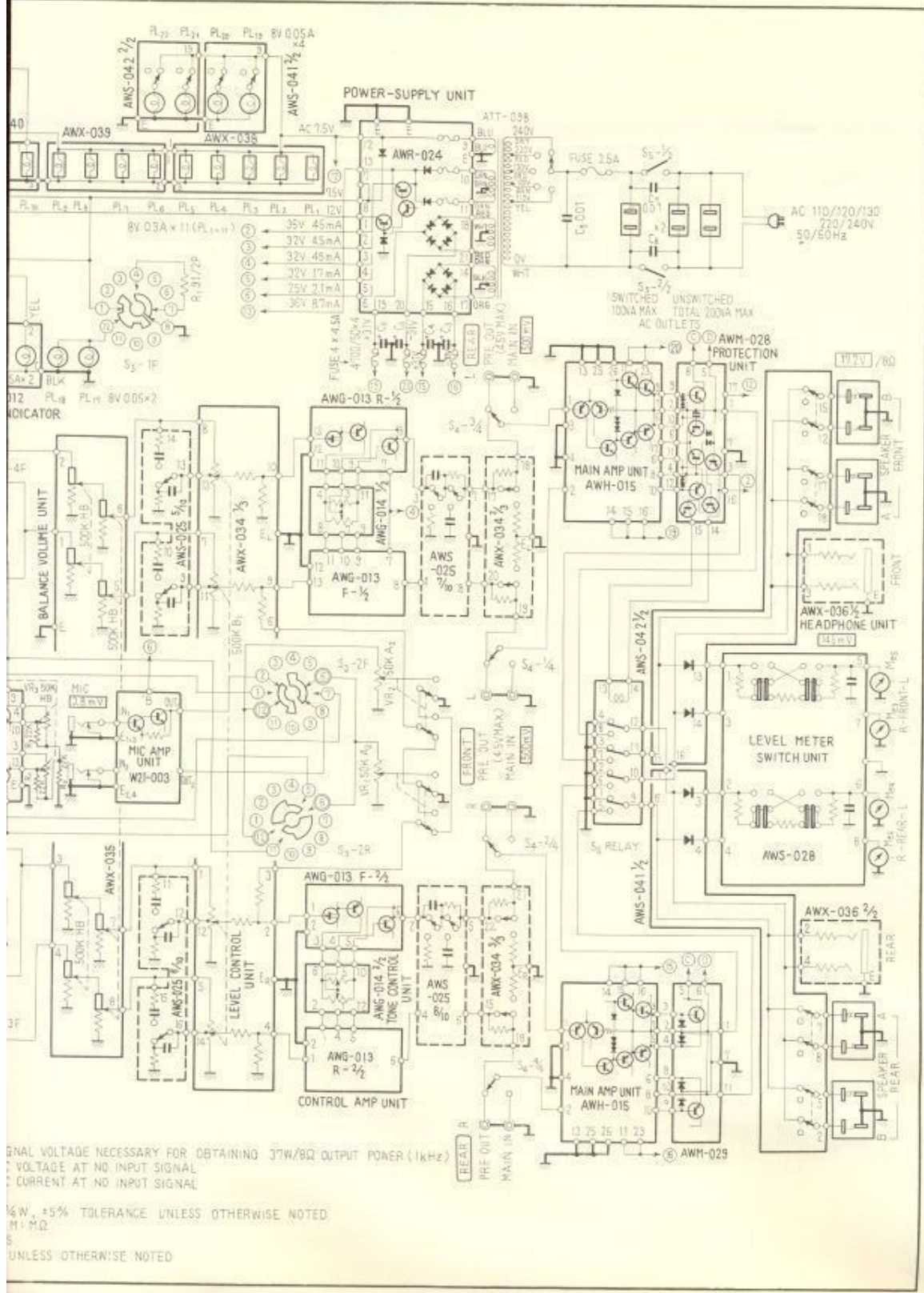

SIGNAL VOLTAGE NECESSARY FOR OBTAINING 37W/8Ω OUTPUT POWER (1kHz)  
 VOLTAGE AT NO INPUT SIGNAL  
 CURRENT AT NO INPUT SIGNAL  
 1/2W, ±5% TOLERANCE UNLESS OTHERWISE NOTED  
 M1 MΩ  
 S UNLESS OTHERWISE NOTED

