

# Service Manual

ORDER NO.  
RRV2580

AUDIO/VIDEO MULTI-CHANNEL RECEIVER

# VSX-AX10

**THIS MANUAL IS APPLICABLE TO THE FOLLOWING MODEL(S) AND TYPE(S).**

Type	Model	Power Requirement	The voltage can be converted by the following method.
	VSX-AX10		
SB	○	AC110/120-127V/220V/230-240V	With the voltage selector

\* : Alter the wiring of the Power-supply block at the primary winding of Power-transformer referring to the "Line Voltage Selection" described in this Manual.

● This service manual should be used together with the following manual(s):

Model No.	Order No.	Remarks
VSX-49TX/KU/CA	RRV2523	

## CONTENTS

1. CONTRAST OF MISCELLANEOUS PARTS .....	2
2. PCB CONNECTION DIAGRAM .....	11
3. SCHEMATIC DIAGRAM .....	13
4. REMOTE CONTROL UNIT .....	28

# 1. CONTRAST OF MISCELLANEOUS PARTS

- NOTES: ● Parts marked by "NSP" are generally unavailable because they are not in our Master Spare Parts List.  
 ● The  $\Delta$  mark found on some component parts indicates the importance of the safety factor of the part. Therefore, when replacing, be sure to use parts of identical designation.  
 ● Screws adjacent to  $\blacktriangledown$  mark on product are used for disassembly.  
 ● Reference Nos. indicate the pages and Nos. in the service manual for the base model.  
 ● When ordering resistors, first convert resistance values into code form as shown in the following examples.  
 Ex.1 When there are 2 effective digits (any digit apart from 0), such as 560 ohm and 47k ohm (tolerance is shown by J=5%, and K=10%).

560  $\rightarrow$  56 x 10<sup>1</sup>  $\rightarrow$  561 ..... RD1/4PU  $\boxed{5}\boxed{6}\boxed{1}J$   
 47k  $\rightarrow$  47 x 10<sup>3</sup>  $\rightarrow$  473 ..... RD1/4PU  $\boxed{4}\boxed{7}\boxed{3}J$   
 0.5  $\rightarrow$  R50 ..... RN2H  $\boxed{R}\boxed{5}\boxed{0}K$   
 1  $\rightarrow$  1R0 ..... RS1P  $\boxed{1}\boxed{R}\boxed{0}K$

Ex.2 When there are 3 effective digits (such as in high precision metal film resistors).

5.62k  $\rightarrow$  562 x 10<sup>1</sup>  $\rightarrow$  5621 ..... RN1/4PC  $\boxed{5}\boxed{6}\boxed{2}\boxed{1}F$

## ■ CONTRAST OF TABLE

VSX-49TX/KU/CA and VSX-AX10/SB are constructed the same except for the following:

Ref. No.	Mark	Symbol and Description	Part No.		Remarks
			VSX-49TX /KU/CA	VSX-AX10 /SB	
<b>PCB ASSEMBLIES</b>					
P7- 1	NSP	VR & MOTHER ASSY └ MOTHER ASSY	AWM7562 AWX7890	AWM7568 AWX7896	
P9- 2	NSP	PS & SP ASSY	AWK7712	AWK7714	
P9- 3		└ SP (B) ASSY	AWX7852	AWX7854	
P9- 4		└ AC PRIMARY ASSY	AWX7834	AWX7835	
P11- 6		└ SP (A) ASSY	AWX7848	AWX7850	
P11- 7		└ POSISTER (L) ASSY	AWX7844	AWX7845	
		└ POSISTER (R) ASSY	AWX7846	AWX7847	
		└ VOLTAGE SEL ASSY	Not used	AWX7842	No. 1
		└ POSISTER(MT) ASSY	Not used	AWX8061	No. 2
P9- 6	NSP	VIDEO ASSY	AWQ7010	AWQ7015	
P9- 7		└ V-CONVERT ASSY	AWX7952	AWX8078	
P9- 9		└ COMPONENT ASSY	AWX7953	AWX7955	
P9-10		└ COMPOSITE ASSY	AWX7942	AWX7944	
		└ A/V I/O ASSY	AWX7938	AWX7940	
P9-12	NSP	A/D & CONTROL ASSY	AWM7558	AWM7659	
P13- 1		└ ANALOG IN & A/D ASSY	AWX7878	AWX7873	
		└ DISPLAY ASSY	AWX7864	AWX7866	
P9- 1		FM/AM TUNER Module	AXQ7237	AXQ7238	
<b>PACKING SECTION</b>					
P3- 1	$\Delta$	AC Power Cord	ADG7061	ADG7062	
P3- 4	$\Delta$	AC Power Cord	Not used	ADG7056	No. 3
P3- 7		Remote Control Unit	AXD7295	AXD7298	
		Operating Instructions (English)	ARB7249	AHA7251	
		Operating Instructions(Chinese)	Not used	ARC7343	No. 4
P3- 9	NSP	Warranty Card	ARY1026	Not used	
P3-14		Packing Case	AHD8029	AHD8030	
		Caution 220V Label	Not used	ARR7019	No. 5
		$\Delta$ AC Plug Adapter	Not used	AKX7011	Accessories
		Caution Card SB	Not used	ARM7063	No. 6
		Caution Card SB	Not used	ARM7064	No. 7
		NTSC Attention SB	Not used	ARM7066	No. 8

Ref. No.	Mark	Symbol and Description	Part No.		Remarks
			VSX-49TX /KU/CA	VSX-AX10 /SB	
<b>EXTERIOR SECTION</b>					
P5- 1	NSP	Top Plate	ANE7298	ANE7299	
P5- 2		Side Alum	AAH7081	AAH7093	
P5- 6	NSP	Energy Star Label	AAAX7876	Not used	
P5-12		Screw	FBT40T080FZK	FBT40P080FNI	
P5-22		DTS License Label	ARW7148	Not used	
P5-23		Screw	BBZ30P080FCC	IBZ30T080FCC	
P5-24		65 Label	ARW7050	Not used	
P5-25		Screw	BBT30P100FCC	ABA1050	
P5-27	NSP	FUSE Coution Label	VRW-548	Not used	No. 9
		Side Alum	Not used	AAH7093	
		Edgeing guard	Not used	PEC1016	No.10
		Side Alum	ADX7369	ADX7394	No.11
		CN4005	Not used	B2P-VH	No.12
<b>CHASSIS SECTION</b>					
P7-12	⚠	Power Transformer (T1)	ATS7320	Not used	
P7-12	⚠	Power Transformer (AC110V/120-127V/220V/230-240V)	Not used	ATS7323	
P7-29	NSP	Fan Holder	ANG7373	ANG7371	
P7-59	⚠	Fuse ( FU4 )	VEK1023 (4A/125V)	REK1027 (T3.15A/L250V)	
P7-60	⚠	Fuse ( FU5-FU8 )	VEK1019 (2A/125V)	REK1025 (T2.0A/L250V)	
P7-76	⚠	Fuse ( FU9, FU10 )	VEK1014 (1A/125V)	REK1021 (T800mA/250V)	
		Fan Motor	Not used	AXM7018	No.13
<b>REAR PANEL SECTION</b>					
P9-13		Rear Panel	ANC8036	ANC8094	
P9-20	⚠	Fuse (FU1)	AEK-306 (12A/125V)	AEK7071 (T10A/L250V)	
P9-24		Speaker Sheet	AAK7959	AAK7963	
	⚠	Fuse (FU2,FU3 : T6.3A/250V)	Not used	REK-108	No.14
	⚠	Voitage Selector	Not used	AKX-507	No.15
<b>HEAT SINK SECTION</b>					
P11- 8		Heat Sink L	ANH7155	ANH7148	
P11- 9		Heat Sink R	ANH7156	ANH7162	
<b>FRONT PANEL SECTION</b>					
P13-11		Front Panel	ANB7269	ANB7270	
P13-12		Name Plate	PAN1376	VAM1377	
P13-13		Rotary Knob L	AAA7018	AAA7016	
P13-15		Rotary Knob S	AAA7015	AAA7013	
P13-17		Panel Base L	AMB7788	AMB7786	
P13-18		Panel Base R	AMB7791	AMB7789	
P13- 19		POWER Button	AAD7440	AAD7485	
P13-20		POWER Button M	AAD7442	AAD7491	
P13-26		Door Pane	ANB7273	ANB7271	
P13-27		Door Cushion	AED7051	AED9014	
P13-28		Door Plate	AAH7077	AAH7078	
P13-29		FL Lens	AAK7934	AAK7933	
P13-30		Inner Panel	AAH7087	AAH7088	
P13-34		Panel Base C	AMB7785	AMB7783	

# VSX-AX10

Ref. No.	Mark	Symbol and Description	Part No.		Remarks
			VSX-49TX /KU/CA	VSX-AX10 /SB	
<b>FRONT PANEL SECTION</b>					
		Panel Spacer left S	Not used	AMR7415	No.16
		Panel Spacer right S	Not used	AMR7416	No.17
		Panel Spacer left L	Not used	AMR7417	No.18
		Panel Spacer right L	Not used	AMR7418	No.19
<b>REMOTE CONTROL SECTION</b>					
P161-2		PCB ASSY	AZC7299	AZC7300	
P161-13		Seal A	AZA7415	AZA7421	
P161-14		Seal B	AZA7416	AZA7420	
P161-16		Case A	AZN7783	AZN7795	
P161-17		Name Plate	AZA7406	AZA7409	
P161-21		Case B	AZN7784	AZN7796	
P161-23		Pen Holder	AZN7786	AZN7798	
P161-26		Battery Cover	AZN7785	AZN7797	
P161-32		Slide Knob	AZA7347	AZA7365	
P161-36		Key Top A	AZA7345	AZA7363	
P161-37		Key Top B	AZA7346	AZA7364	
P161-39		Rubber Sheet B	AZA7349	AZA7371	

Notes : ●The numbers in the remarks column correspond to the numbers on the “ EXPLODED VIEWS ”.

● For PCB ASSEMBLIES, Refer to “CONTRAST OF PCB ASSEMBLIES”, “2. PCB CONNECTION DIAGRAM” and “3. SCHEMATIC DIAGRAM”.

## ■ EXPLODED VIEWS

### ● PACKING SECTION

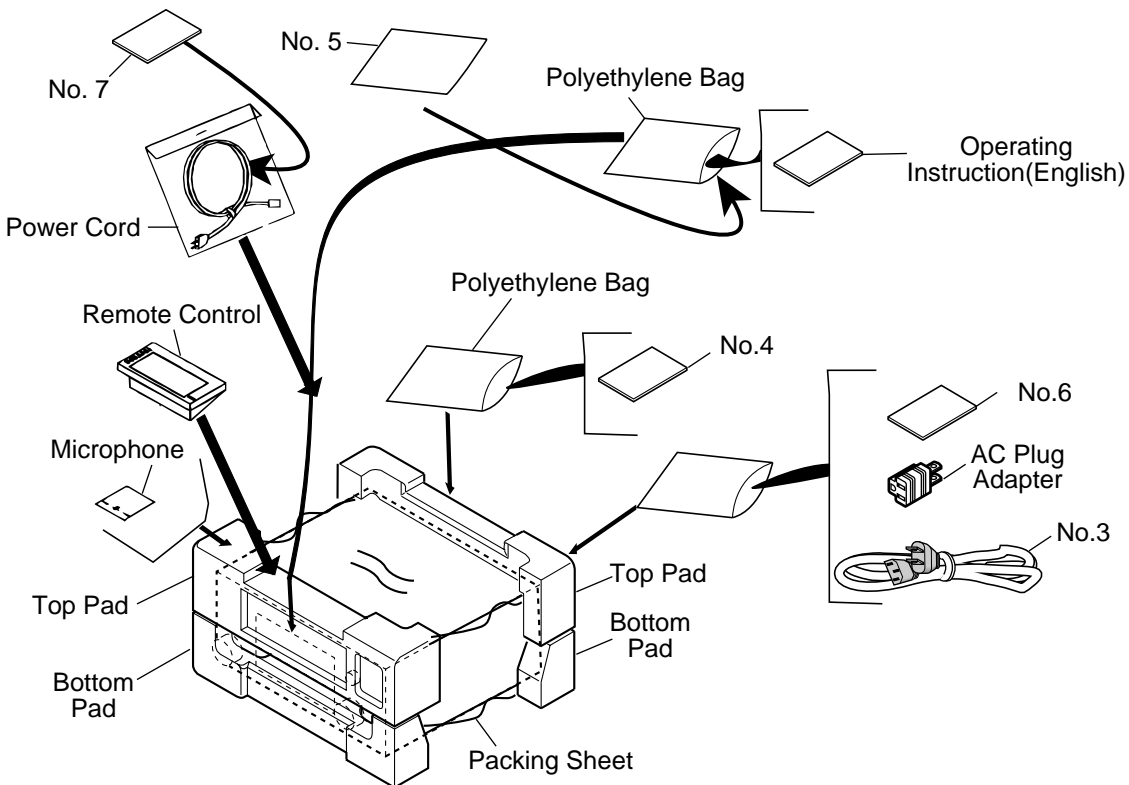

● EXTERIOR SECTIONS

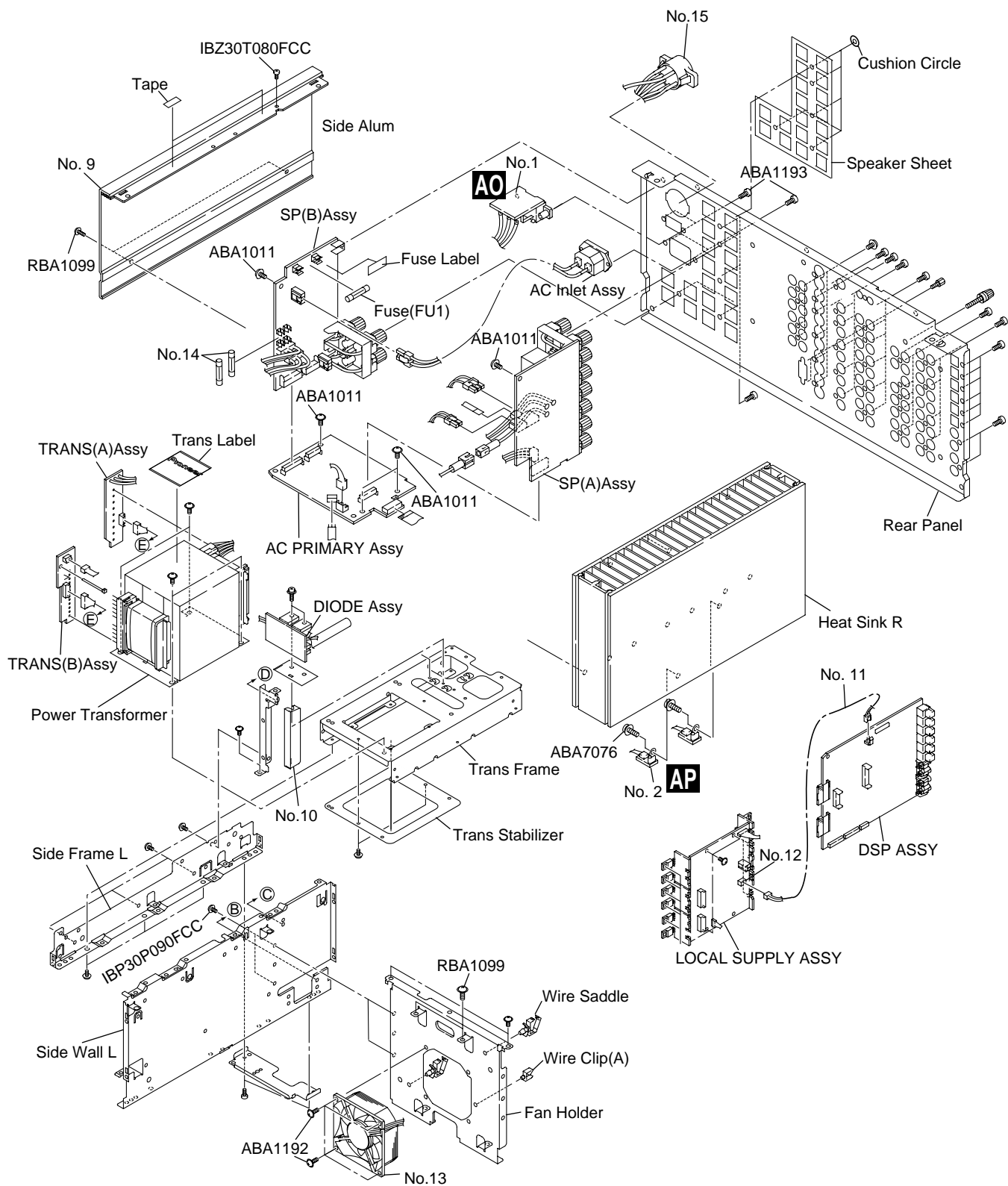

# VSX-AX10

## ● FRONT PANEL SECTIONS

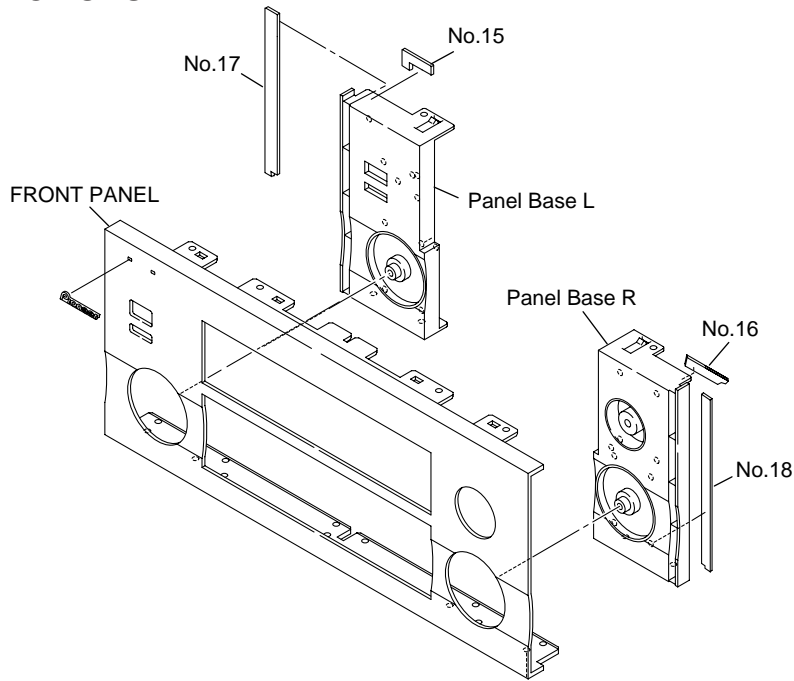

## ■ CONTRAST OF PCB ASSEMBLIES

### **A** FM/AM TUNER Module

AXQ7238 and AXQ7237 are constructed the same except for the following:

Mark	Symbol and Description	Part No.		Remarks
		AXQ7237	AXQ7238	
	C216, C217	CKSRYB153K50	CKSRYB123K50	

### **B**F AV I/O ASSY

AWX7940 and AWX7938 are constructed the same except for the following :

Mark	Symbol and Description	Part No.		Remarks
		AWX7938	AWX7940	
	IC2051	UPC4570C	Not used	
	IC2052	M62429FP	Not used	
	Q2051	HN1C03F(AB)	Not used	
	D2051	UDZS5.6B	Not used	
	C2051, C2052, C2059, C2060	CEJQ1R0M50	Not used	
	C2053, C2054, C2063, C2064	CCSRCH101J50	Not used	
	C2061, C2065, C2066	CEJQ100M16	Not used	
	C2069	CKSRYB103K50	Not used	
	R2051, R2052, R9069	RS1/16S474J	RS1/16S0R0J	
	R2053, R2054	RS1/16S221J	Not used	
	R2055, R2056	RS1/16S474J	Not used	
	R2057, R2058	RS1/16S220J	Not used	
	R2061, R2062	RS1/16S472J	Not used	
	R2063, R2064, R2069, R2070, R2073, R2074	RS1/16S103J	Not used	
	R2065	RD1/2LMF561J	Not used	
	R2067, R2068, R2071, R2072, R2075, R2076	RS1/16S102J	Not used	
	R9069	Not used	RS1/16S0R0J	
	JA2051	DKB1045	Not used	

**CF COMPOSITE ASSY**

AWX7944 and AWX7942 are constructed the same except for the following :

Mark	Symbol and Description	Part No.		Remarks
		AWX7942	AWX7944	
	IC2107 C2159,C2160,C2161 C2164 R2163,R2164,R2165 R2169  2105 2P PIN JACK JA2106 1P PIN JACK	TC74HC4051AFT CKSRYB103K50 CCSRCH181J50 RS1/16S102J RS1/16S750J  AKB7076 Not used	Not used Not used Not used Not used Not used  Not used AKB7142	

**EF V-CONVERT ASSY**

AWX8078 and AWX7951 are constructed the same except for the following :

Mark	Symbol and Description	Part No.		Remarks
		AWX7952	AWX8078	
	IC2861 Q2855, Q2856 Q2857, Q2905 C2947, C2949, C2974 C2950  C2948, C2951- C2953, C2955, C2961- C2965 C2980 C2954 C2956, C2957 C2958- C2960  C2975 C2988 L2858 R2909 R2910- R2914, R2938, R2939  R2915 R2916, R2948 R2936, R2937	Not used Not used Not used Not used Not used  Not used Not used Not used Not used Not used  Not used Not used Not used Not used  Not used Not used Not used Not used	TA8772AN 2SC4081(RS) UN5212 CKSRYB103K50 CEAT470M10  CKSRYB104K16 CKSRYB104K16 CEAT100M50 CKSRYB474K10 CEAT1R0M50  CEAT101M10 CCSRCH100D50 LAU100J RS1/16S103J RS1/16S102J  RS1/16S362J RS1/16S473J Not used	

**FF COMPONENT ASSY**

AWX7955 and AWX7953 are constructed the same except for the following:

Mark	Symbol and Description	Part No.		Remarks
		AWX7953	AWX7955	
	D2501 R2572 J2504	1SS355 RS1/16S102J AKN7014	Not used Not used Not used	

# VSX-AX10

## **F** ANALOG IN & A/D ASSY

AWX7873 and AWX7878 are constructed the same except for the following:

Mark	Symbol and Description	Part No.		Remarks
		AWX7878	AWX7873	
	IC3901 D3901, D3902 C3951, C3952 C3953, C3954 R3555, R3556  R3951, R3952 R3955- R3957 R3958, R3959 R3065, R3069	BU4052BCF UDZS6.2B CEAT100M50 CKSRYB473K50 RS1/16S105J  RS1/16S472J RS1/16S221 RS1/16S223J RS1/16S0R0J	Not used Not used Not used Not used Not used  Not used Not used Not used Not used	

## **M**F DISPLAY ASSY

AWX7866 and AWX7864 are constructed the same except for the following:

Mark	Symbol and Description	Part No.		Remarks
		AWX7864	AWX7866	
	IC3061 Q3003 Q3063 D3029 D3062- D3064, D3066  C3063 R3029 R3063 R3065, R3069 R3066  R3078	TC74HC4053AFT UN5212 RN2903 SLI-343DUW(STU) 1SS355  CKSRYB153K50 RS1/16S561J RS1/16S223J RS1/16S103J RS1/16S392J  Not used	Not used Not used Not used Not used Not used  Not used Not used Not used Not used Not used  RS1/16S0R0J	

## **AB**F AC PRIMARY ASSY

AWX7835 and AWX7834 are constructed the same except for the following:

Mark	Symbol and Description	Part No.		Remarks
		AWX7834	AWX7835	
△	Q1105 Q1106 D1107 D1108 R1107  R1118, R1119 R1120 R1121 T1101 CN1106	Not used Not used Not used Not used RS1/16S104J  RS1/16S0R0J Not used Not used ATT7043 Not used	2SC2412K(QR) DTA124EK UDZ2.7B 1SS355 RS1/16S473J  Not used RS1/16S0R0J RS1/16S183J ATT7041 B02B-XASK-1	



**RF MOTHER ASSY**

AWX7896 and AWX7890 are constructed the same except for the following:

Mark	Symbol and Description	Part No.		Remarks
		AWX7890	AWX7896	
	Q5809	UN5112	Not used	
	Q5811	Not used	RN4903	
	Q5812	Not used	RN1903	
	Q5813	Not used	2SC5174P	
	Q5814	Not used	2SA1932P	
	D5808	Not used	UDZ36B	
	D5809, D5816	Not used	UDZ12B	
	D5810, D5812	Not used	1SS355	
	D5811	Not used	UDZS5.1B	
	D5813, D5818	Not used	UDZ15B	
	C5851, C5854	Not used	CEAT100M50	
	C5852, C5853	Not used	CKSRYB103K50	
	C5858	CKSRYB103K50	Not used	
	R5891, R5893- R5897	RS1/16S0R0J	Not used	
	R5842	Not used	RS1/16S104J	
	R5843, R5844	Not used	RS1/16S394J	
	R5845, R5848	Not used	RS1/16S101J	
	R5846, R5849	Not used	RS1/16S471J	
	R5854	Not used	RS1/16S103J	
	R5862	RS1/16S102J	Not used	
	R5864	RS1/16S104J	Not used	
	R5932	RS1/16S154J	Not used	
	CN5802	52045-1345	Not used	
	CN5826	Not used	KM250MA3	

# VSX-AX10

## **AJ** F SP (B) ASSY

AWX7854 and AWX7852 are constructed the same except for the following:

Mark	Symbol and Description	Part No.		Remarks
		AWX7852	AWX7854	
	Q1002 D1003, D1004 R1001, R1002 R1003 R1005, R1006	DTC124EK 1SS355 ACN7104 RCN1080 RS1/16S220J	Not used Not used Not used Not used RS1/16S0R0J	
△	CN1004 1P AC OUTLET CN1003	AKP1033 RKP1834	Not used Not used	
△	CN1006 4P SPEAKER TERMINAL H1003- H1006 FUSE CLIP RY1002	AKE7076 Not used ASR7016	XKE3019 AKR1004 Not used	
△	J1001 3P BOARD IN WIRE	Not used	ADX7357	
△	J1002 3P BOARD IN WIRE	Not used	ADX7389	

## **AD** SP (A) ASSY

AWX7850 and AWX7848 are constructed the same except for the following :

Mark	Symbol and Description	Part No.		Remarks
		AWX7848	AWX7850	
△	R1213, R1214	Not used	RS1LMF471J	
△	CN1201 6P SPEAKER TERMINAL	AKE7075	AKE7061	
△	CN1202 8P SPEAKER TERMINAL	AKE7074	AKE7059	

## **AG** POSISTER (L) ASSY

AWX7845 and AWX7844 are constructed the same except for the following:

Mark	Symbol and Description	Part No.		Remarks
		AWX7844	AWX7845	
△	TH1901 POSISTOR	AEX7006	AEX7007	

## **AH** POSISTER (R) ASSY

AWX7847 and AWX7846 are constructed the same except for the following:

Mark	Symbol and Description	Part No.		Remarks
		AWX7846	AWX7847	
△	TH1902 POSISTOR	AEX7006	AEX7007	

■ PCB PARTS LIST

Mark	No.	Description	Part No.
------	-----	-------------	----------

**AO** VOLTAGE SEL ASSY

SWITCHES

△	S1401	VOLTAGE SELECTOR	AKX1033
---	-------	------------------	---------

**AP** POSISTER(MT) ASSY

OTHERS

	CN1905	CONNECTOR	S2B-PH-K-S
△	TH1903	POSISTOR	AEX7007

2. PCB CONNECTION DIAGRAM

2.1 VOLTAGE SEL. and POSISTER(MT) ASSYS

**AO** VOLTAGE SEL. ASSY

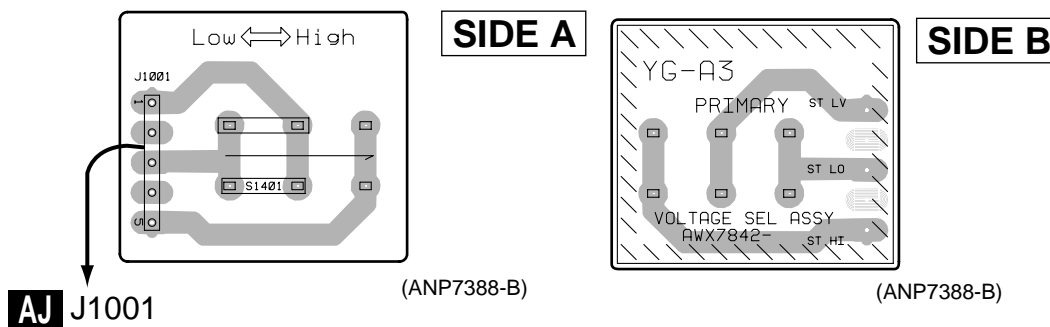

**AP** POSISTER(MT) ASSY

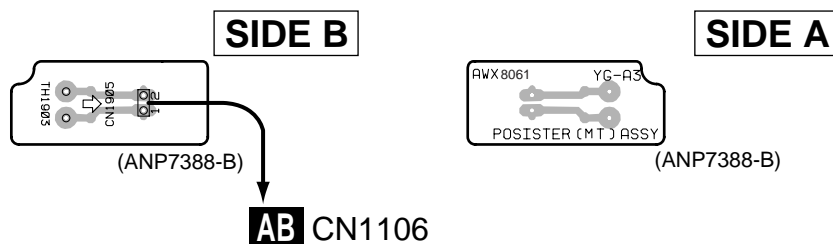

## ● Line Voltage Selection

Line Voltage can be changed by the following modification:

1. Disconnect the AC power cord.
2. Remove the cover.
3. Change the connection wire from SP (B) ASSY (W122, W123 and W137, W138) to POWER TRANSFORMER as follows.

Voltage	Jumper No. of SP(B) ASSY	Attention
230V	As it is	
240V	Eliminate W122, W123 Add W137, W138	It applies to UK Model & for Britain (240V).

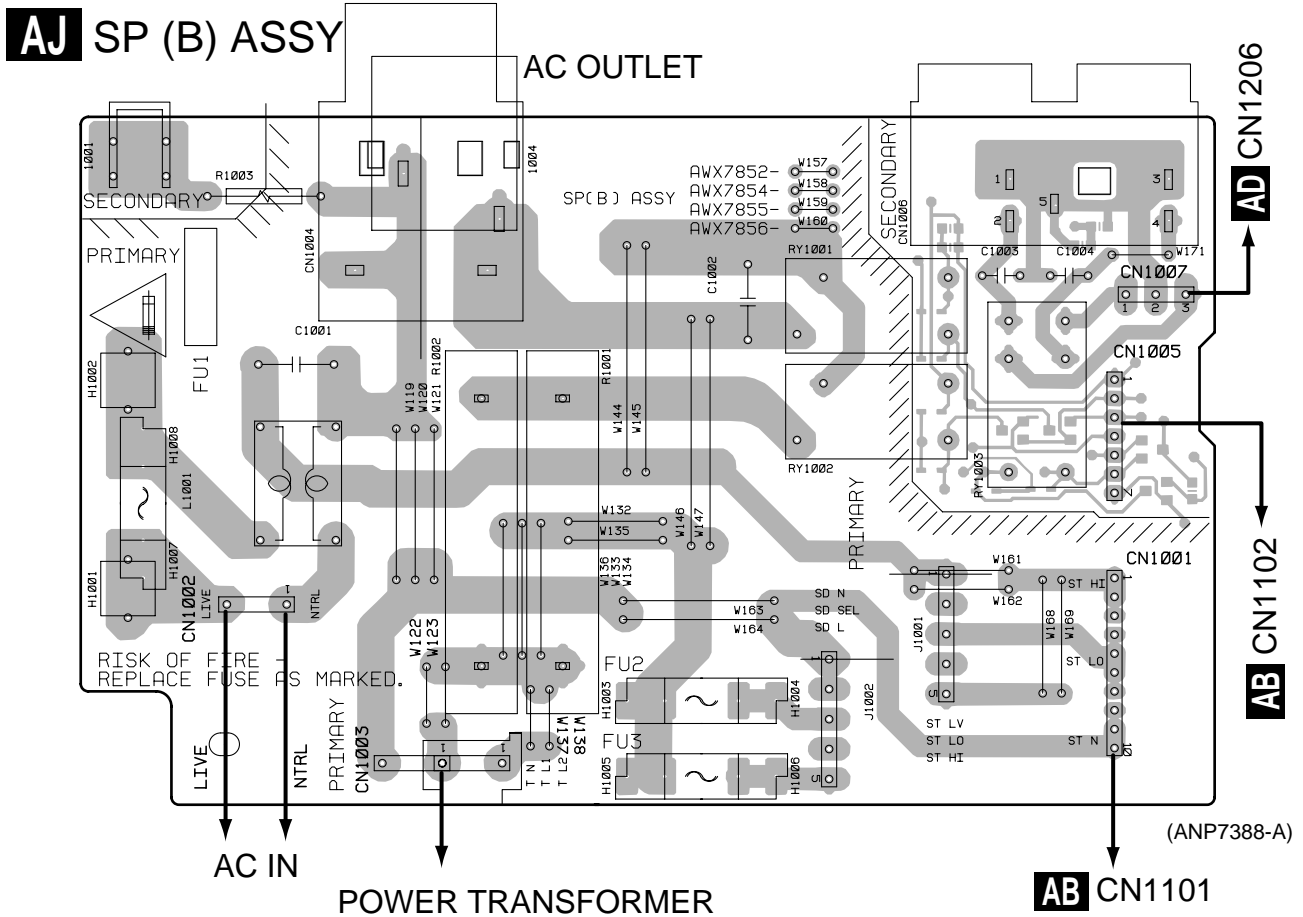

# 3. SCHEMATIC DIAGRAM

## 3.1 OVERALL WIRING DIAGRAM

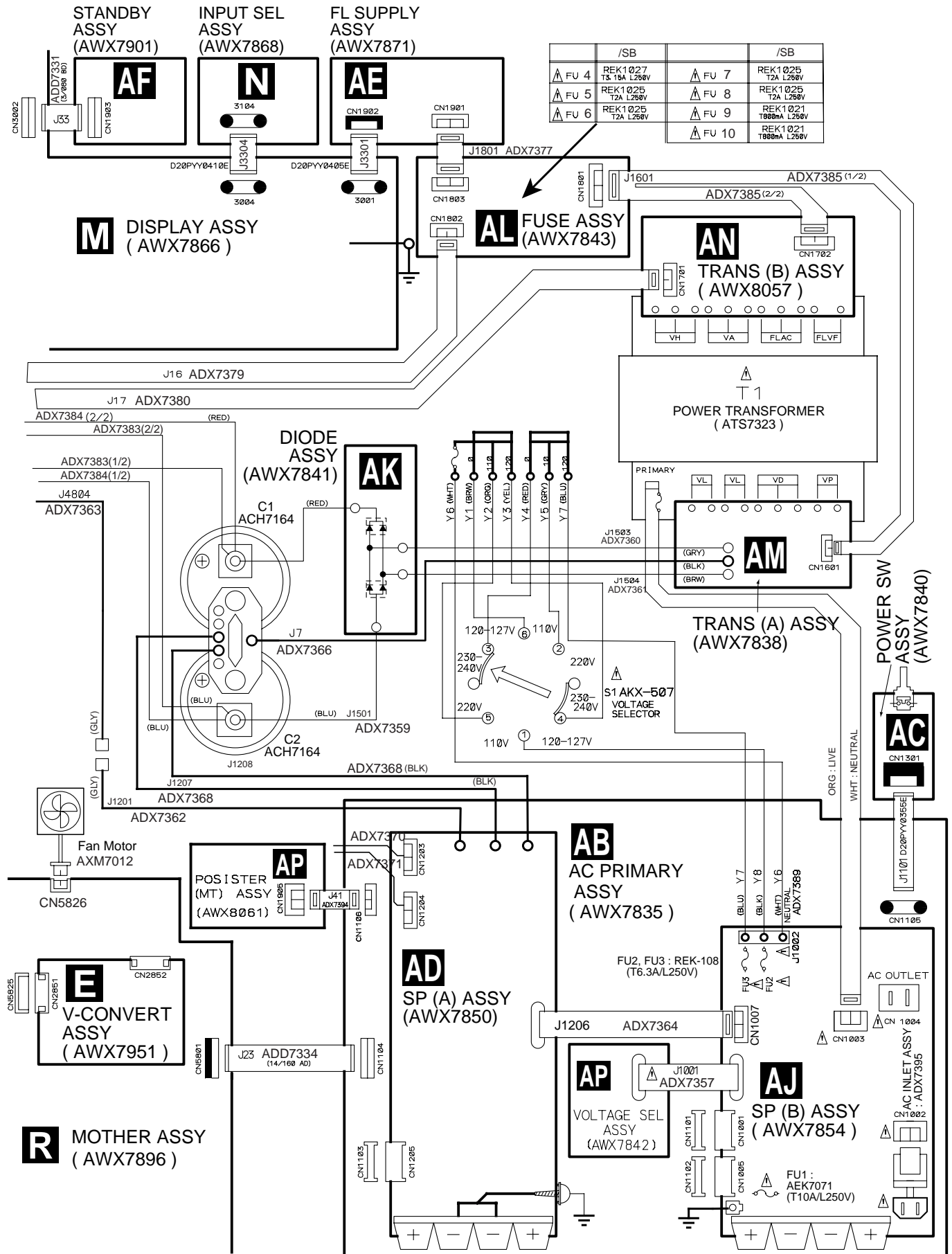

### 3.2 A/V I/O ASSY

A

B

C

D

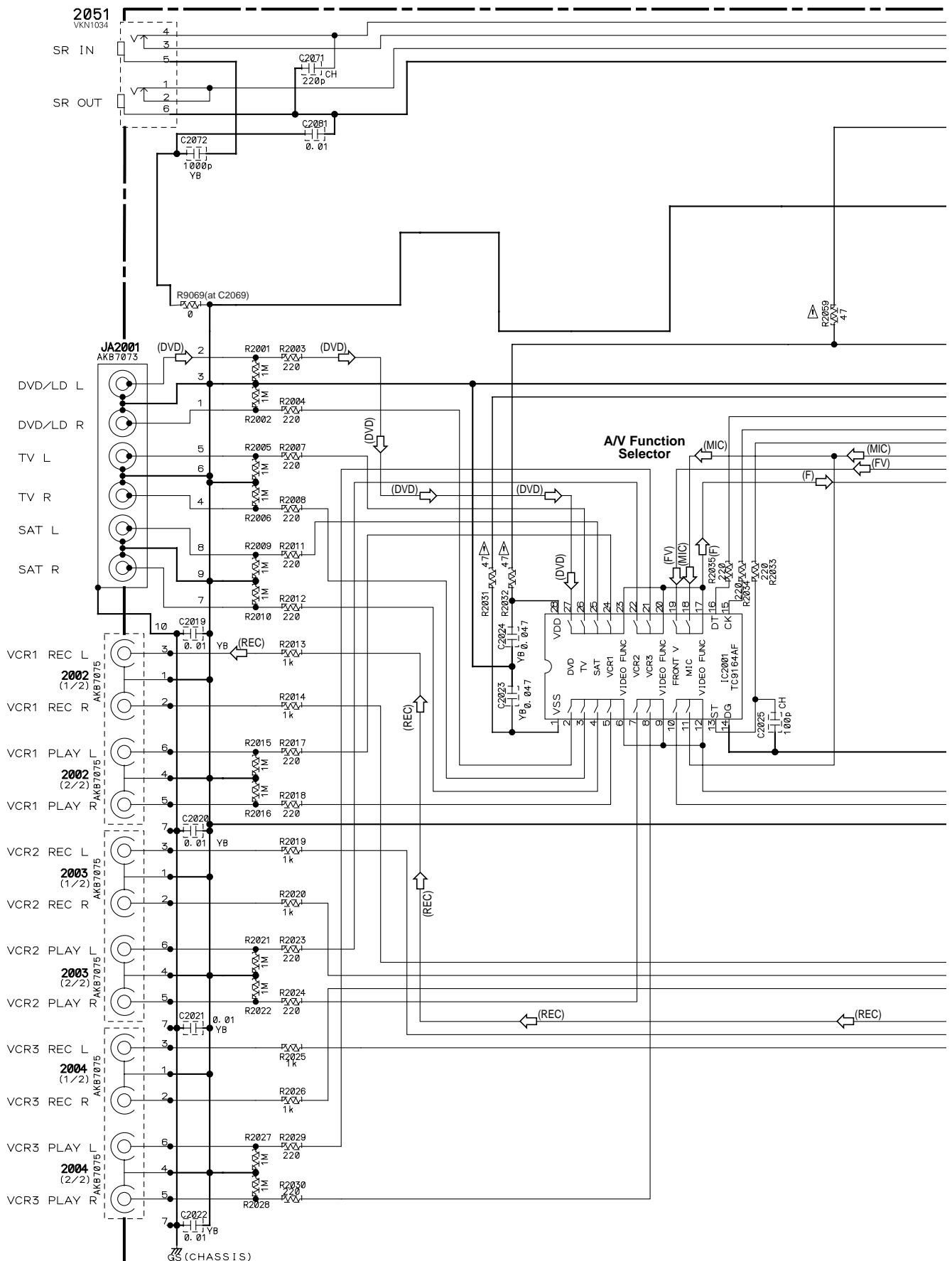

**B** F AV I/O ASSY (AWX7940)

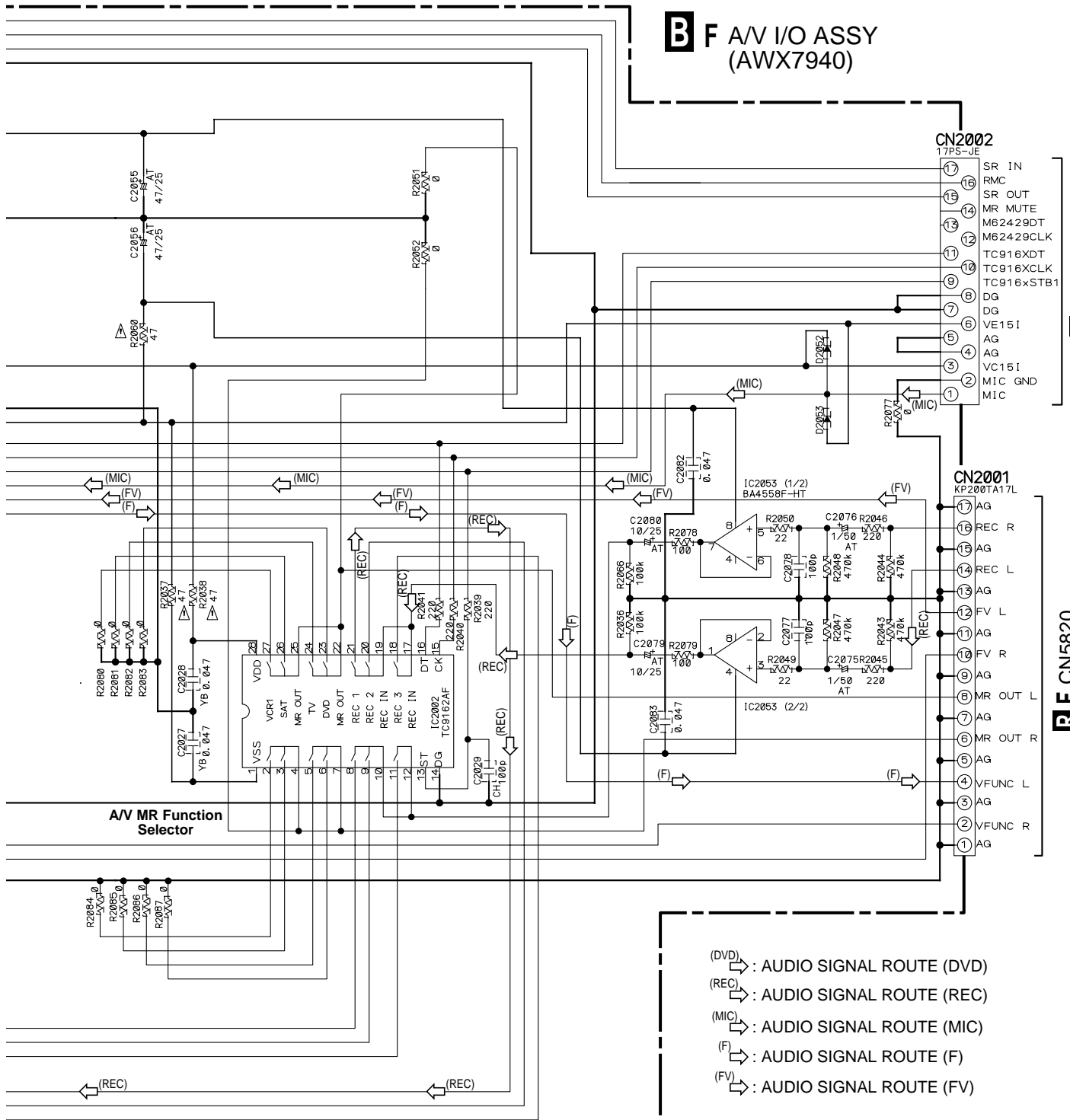

**R** F CN5821

**R** F CN5820

- (DVD) : AUDIO SIGNAL ROUTE (DVD)
- (REC) : AUDIO SIGNAL ROUTE (REC)
- (MIC) : AUDIO SIGNAL ROUTE (MIC)
- (F) : AUDIO SIGNAL ROUTE (F)
- (FV) : AUDIO SIGNAL ROUTE (FV)

**NOTES**

1. RESISTORS  
Unit: k-kΩ M-MΩ or unless otherwise noted.  
Rated power: 1/16W unless otherwise noted.  
Tolerance: (J) ±5% unless otherwise noted.
2. CAPACITORS  
Unit: p-pF or μF unless otherwise noted.  
Ratings: Capacity (μF)/Voltage (V) unless otherwise noted.  
Rated Voltage: 50V except for electrolytic capacitors.  
AT : CEAT, JQ : CEJQ
3. DIODES  
Indicated in 1SS355.

### 3.3 COMPOSITE ASSY

## CF COMPOSITE ASSY (AWX7944)

A

B

C

D

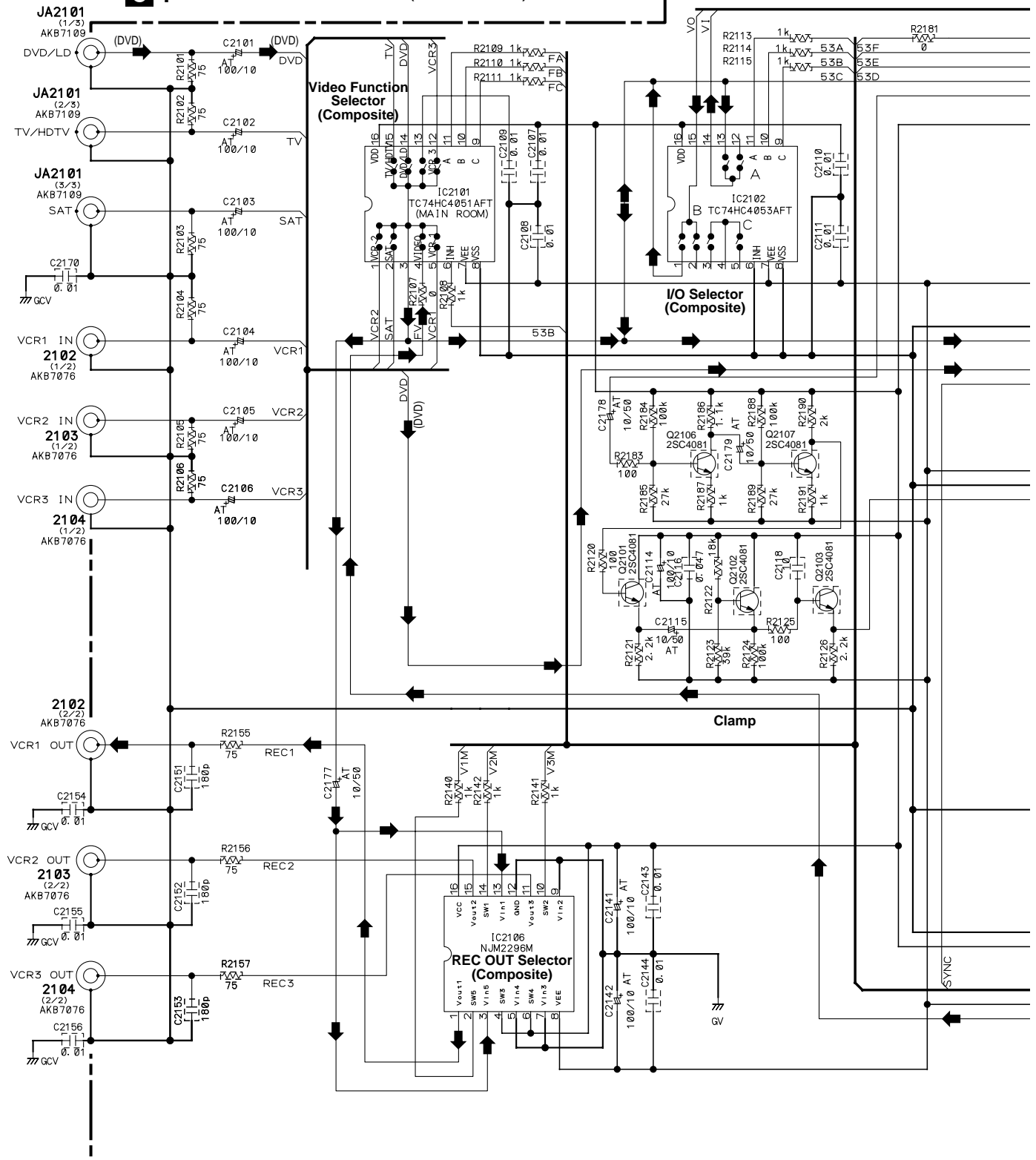



○ : The power supply is shown with the marked box.

(DVD) : VIDEO SIGNAL ROUTE (DVD)  
▶ : VIDEO SIGNAL ROUTE  
▶ (OSD) : VIDEO SIGNAL ROUTE (OSD)

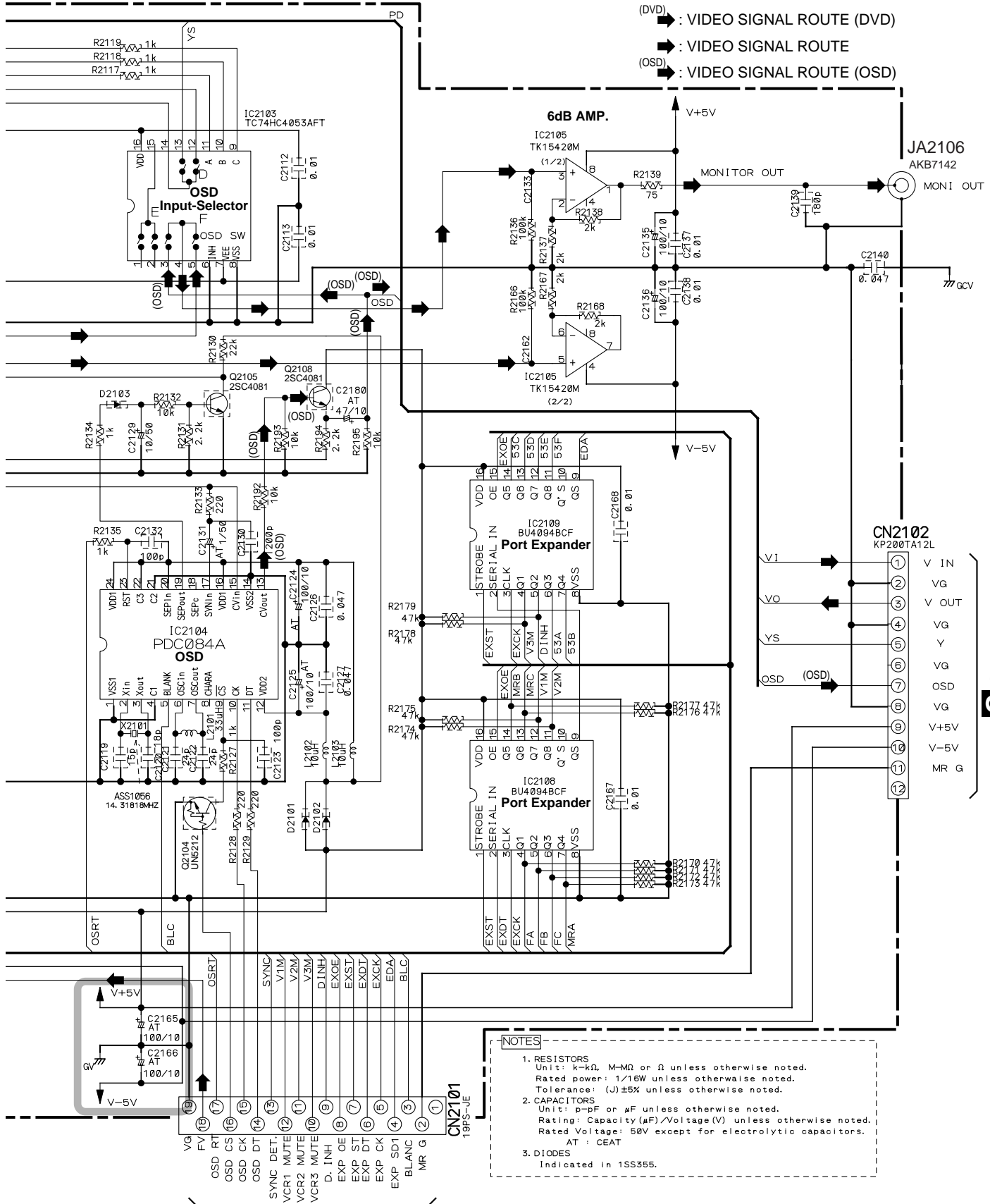

**NOTES**

- RESISTORS**  
 Unit: k=kΩ, M=MΩ or Ω unless otherwise noted.  
 Rated power: 1/16W unless otherwise noted.  
 Tolerance: (J)±5% unless otherwise noted.
- CAPACITORS**  
 Unit: p=pF or μF unless otherwise noted.  
 Rating: Capacity (μF)/Voltage (V) unless otherwise noted.  
 Rated Voltage: 50V except for electrolytic capacitors.  
 AT : CEAT
- DIODES**  
 Indicated in 1SS355.

RF CN5822

CF

3.4 V-CONVERT ASSY

A

B

C

D

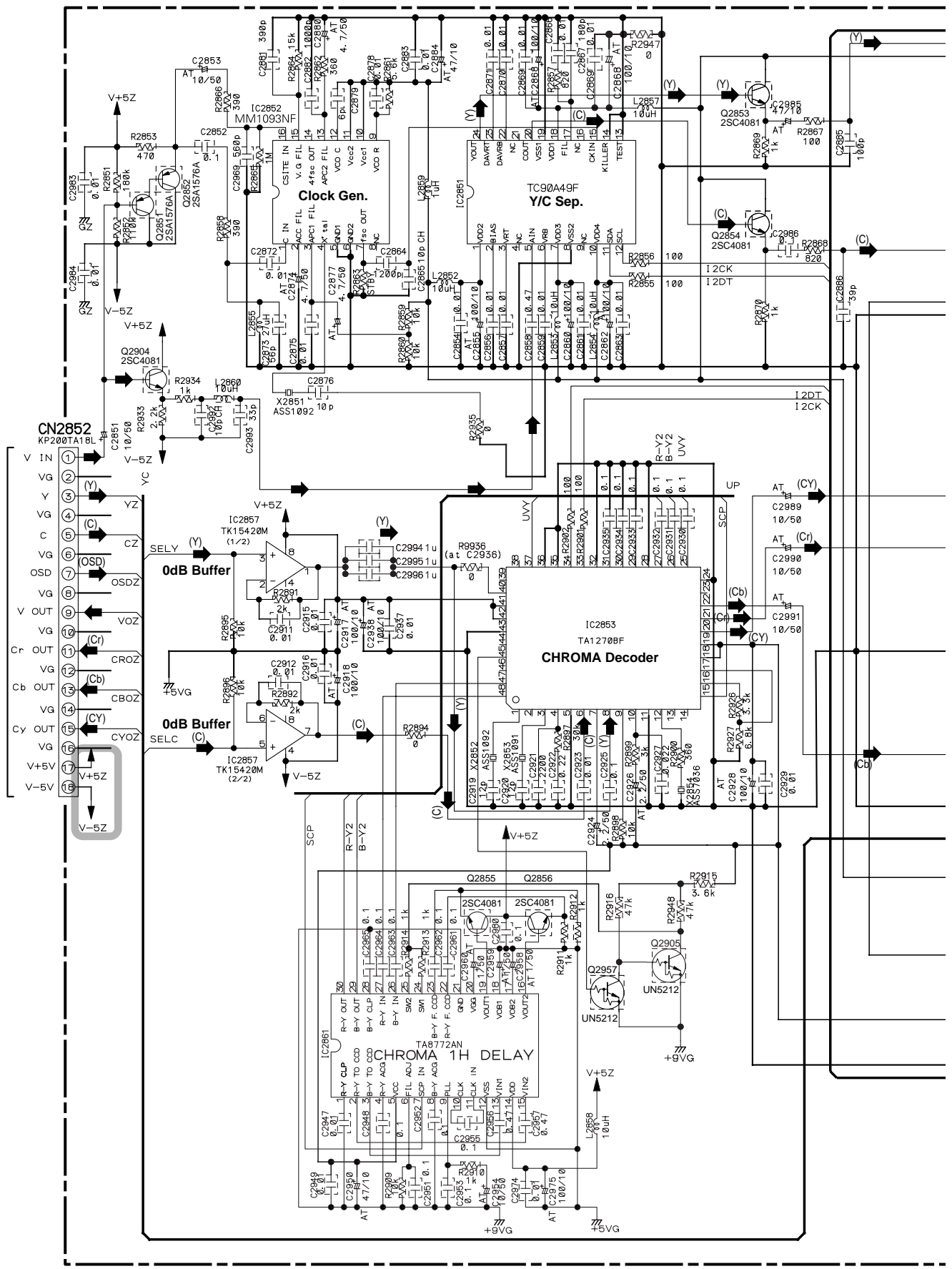

**FV-CONVERT ASSY (AWX8078)**

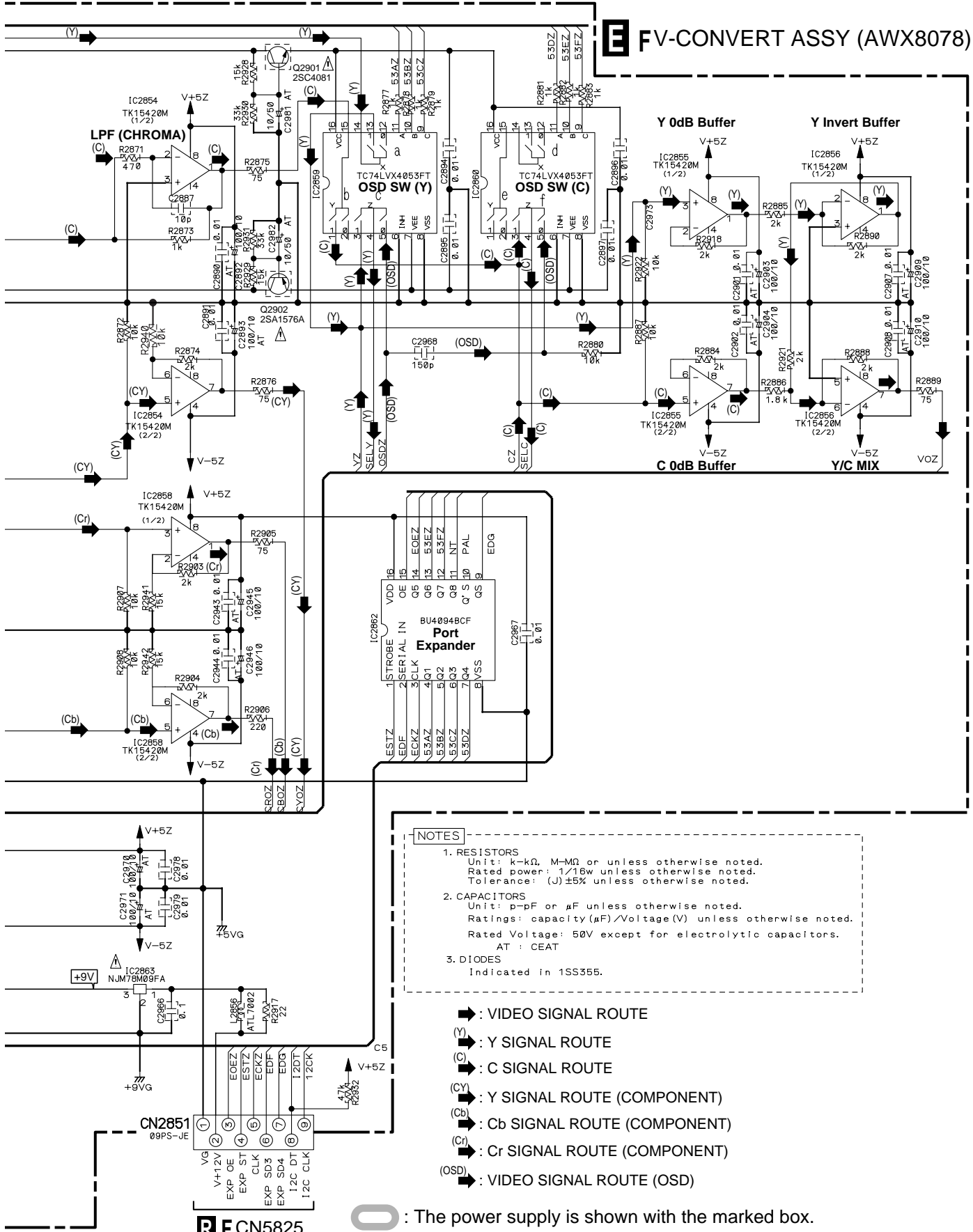

- NOTES**
- RESISTORS  
Unit: k- $\Omega$ , M- $\Omega$  or unless otherwise noted.  
Rated power: 1/16w unless otherwise noted.  
Tolerance: (J)  $\pm$ 5% unless otherwise noted.
  - CAPACITORS  
Unit: p-pF or  $\mu$ F unless otherwise noted.  
Ratings: capacity ( $\mu$ F)/Voltage (V) unless otherwise noted.  
Rated Voltage: 50V except for electrolytic capacitors.  
AT : CEAT
  - DIODES  
Indicated in 1SS355.

- ➔ : VIDEO SIGNAL ROUTE
- (Y) : Y SIGNAL ROUTE
- (C) : C SIGNAL ROUTE
- (CY) : Y SIGNAL ROUTE (COMPONENT)
- (Cb) : Cb SIGNAL ROUTE (COMPONENT)
- (Cr) : Cr SIGNAL ROUTE (COMPONENT)
- (OSD) : VIDEO SIGNAL ROUTE (OSD)

**O** : The power supply is shown with the marked box.

**R FCN5825**



3.5 DISPLAY ASSY

A

B

C

D

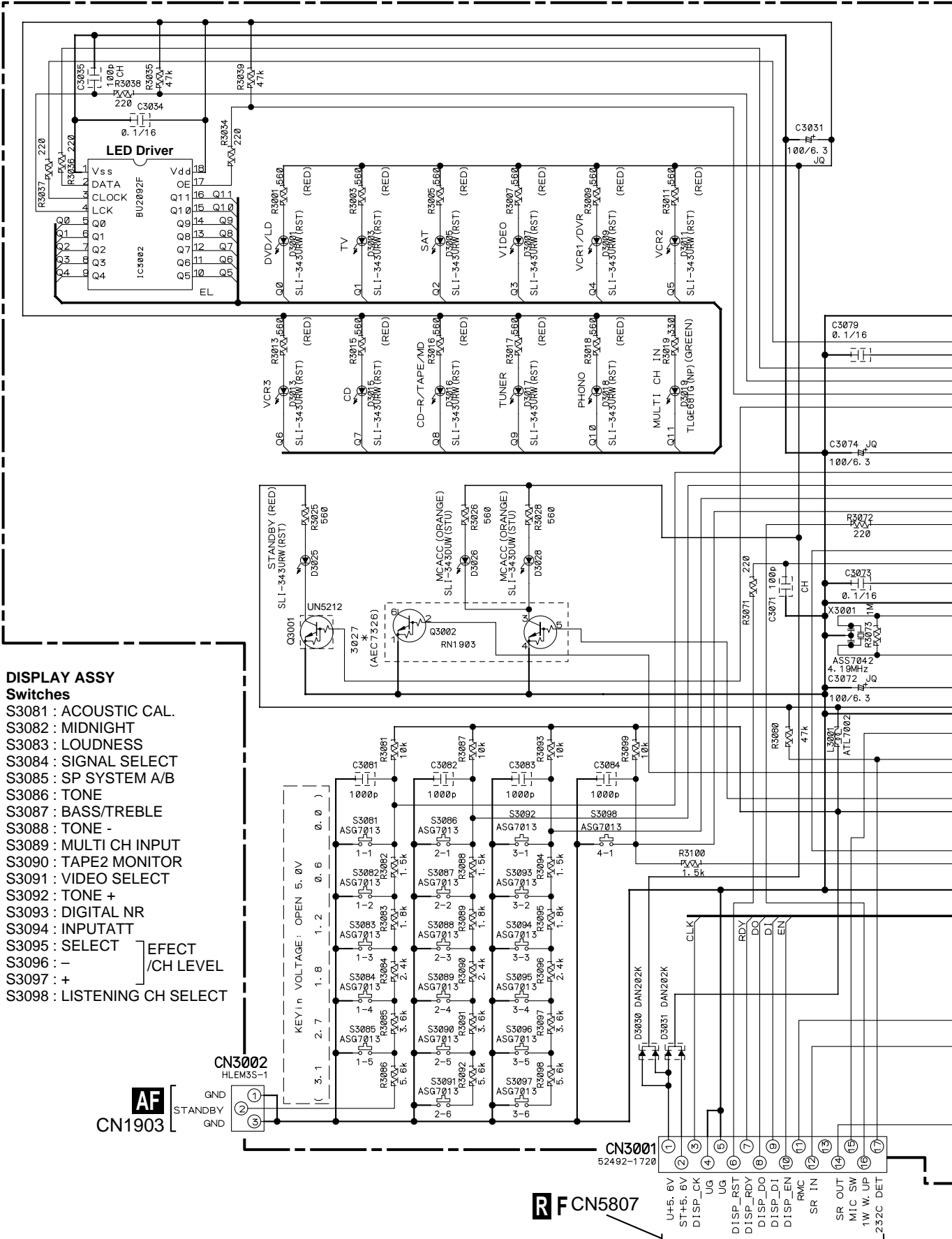

**DISPLAY ASSY  
Switches**

- S3081 : ACOUSTIC CAL.
- S3082 : MIDNIGHT
- S3083 : LOUDNESS
- S3084 : SIGNAL SELECT
- S3085 : SP SYSTEM A/B
- S3086 : TONE
- S3087 : BASS/TREBLE
- S3088 : TONE -
- S3089 : MULTI CH INPUT
- S3090 : TAPE2 MONITOR
- S3091 : VIDEO SELECT
- S3092 : TONE +
- S3093 : DIGITAL NR
- S3094 : INPUTATT
- S3095 : SELECT ] EFECT
- S3096 : - ] /CH LEVEL
- S3097 : + ]
- S3098 : LISTENING CH SELECT

# M F DISPLAY ASSY (AWX7866)

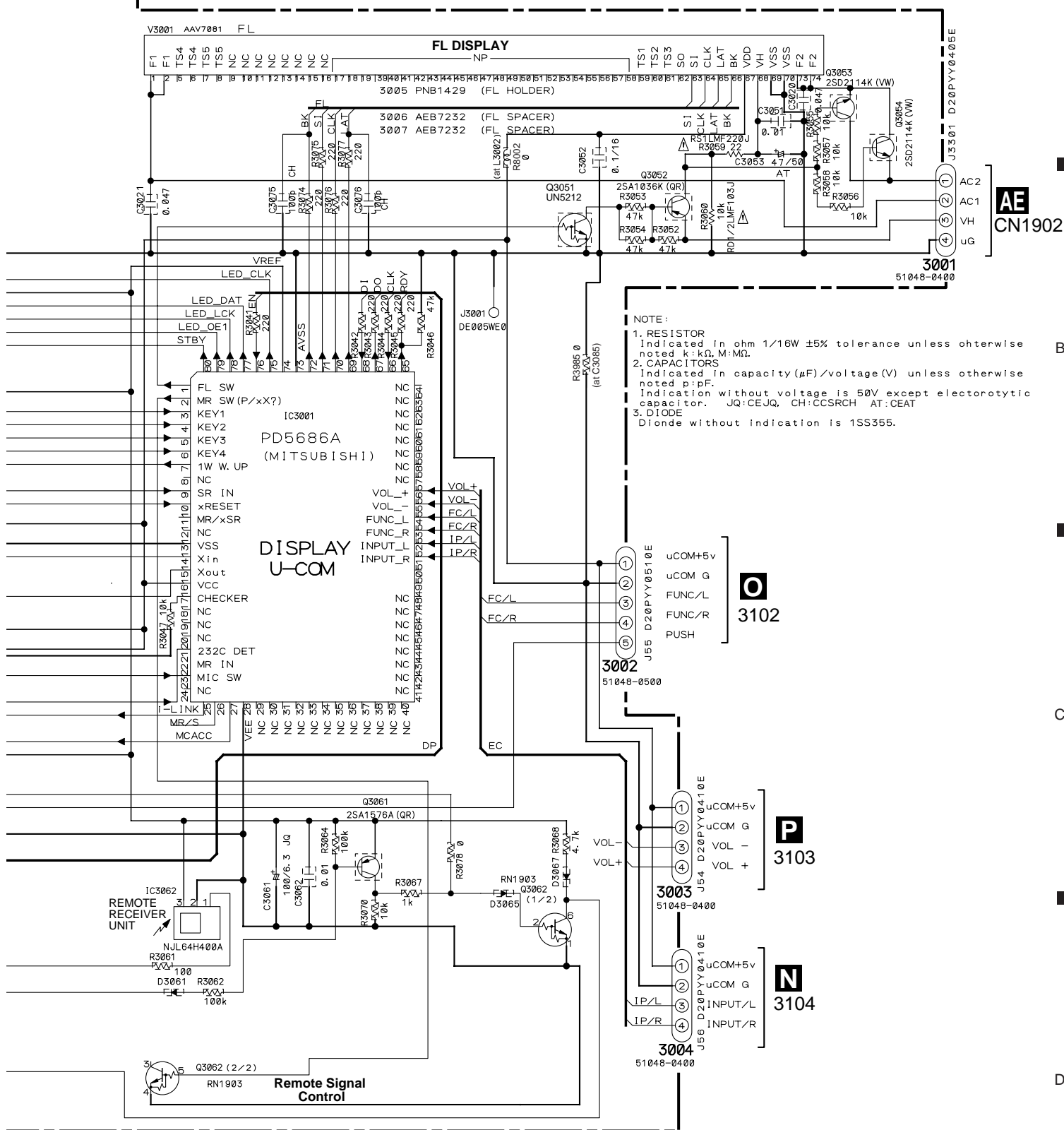

3.6 MOTHER ASSY

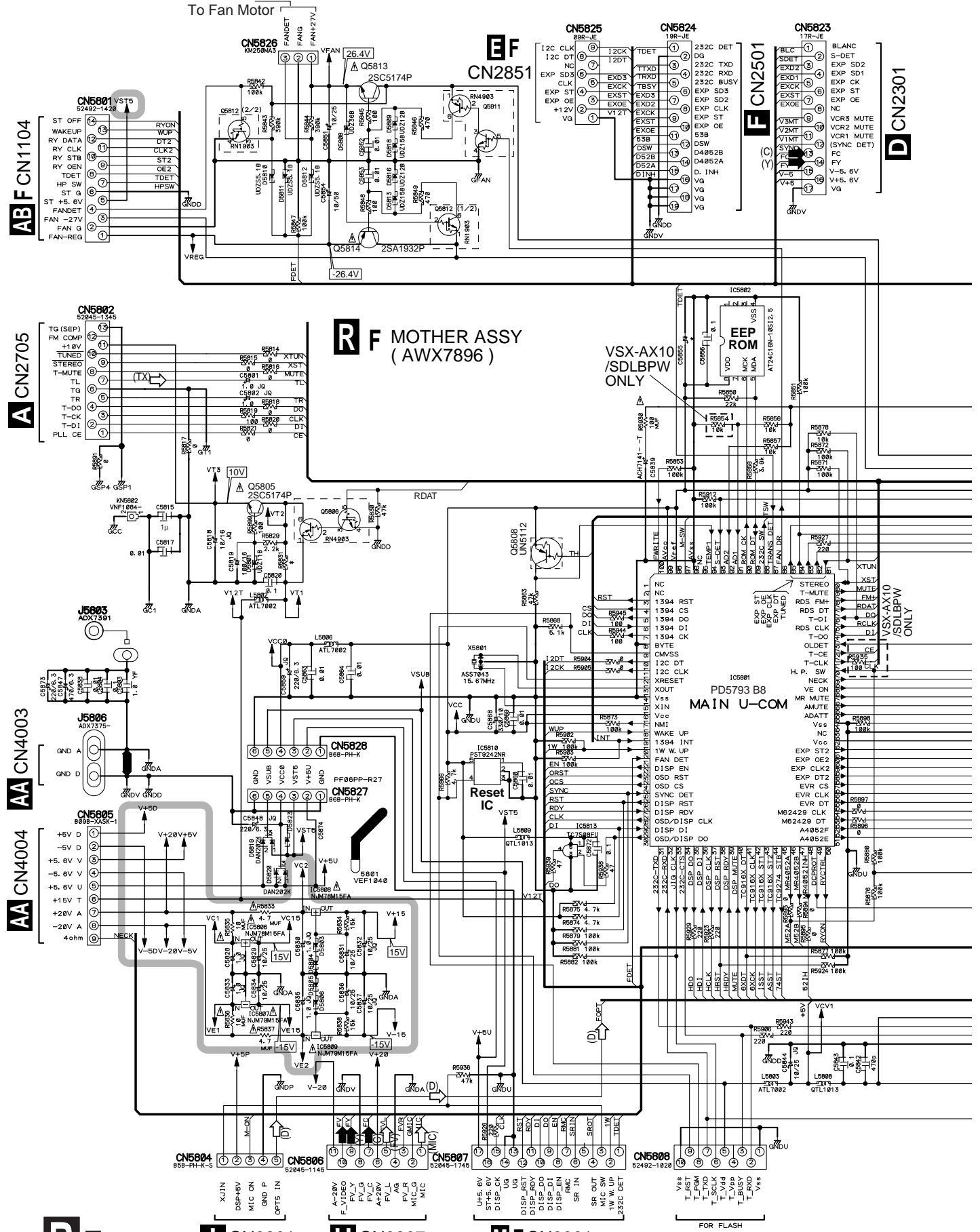

➔ : VIDEO SIGNAL ROUTE

➔ (Y) : Y SIGNAL ROUTE

➔ (C) : C SIGNAL ROUTE

(D) ➔ : AUDIO SIGNAL ROUTE (DIGITAL)

(REC) ➔ : AUDIO SIGNAL ROUTE (REC)

(MIC) ➔ : AUDIO SIGNAL ROUTE (MIC)

(F) ➔ : AUDIO SIGNAL ROUTE (F)

(FV) ➔ : AUDIO SIGNAL ROUTE (FV)

(C) ➔ : AUDIO SIGNAL ROUTE (C)

(S) ➔ : AUDIO SIGNAL ROUTE (S)

(SB) ➔ : AUDIO SIGNAL ROUTE (SB)

(TX) ➔ : AUDIO SIGNAL ROUTE (TUNER)

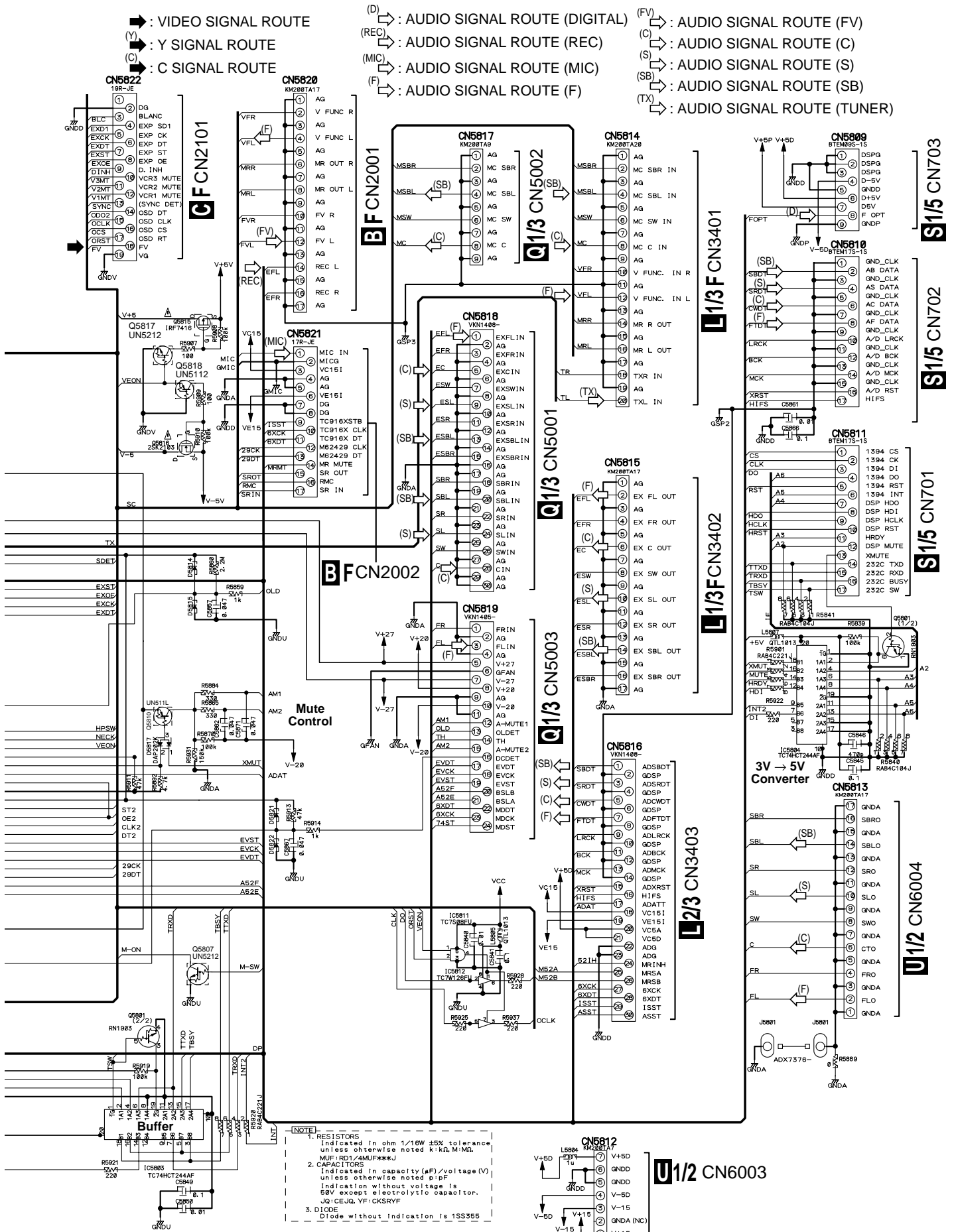

Ⓞ : The power supply is shown with the marked box.



3.7 AC PRIMARY and SP (A) ASSYS

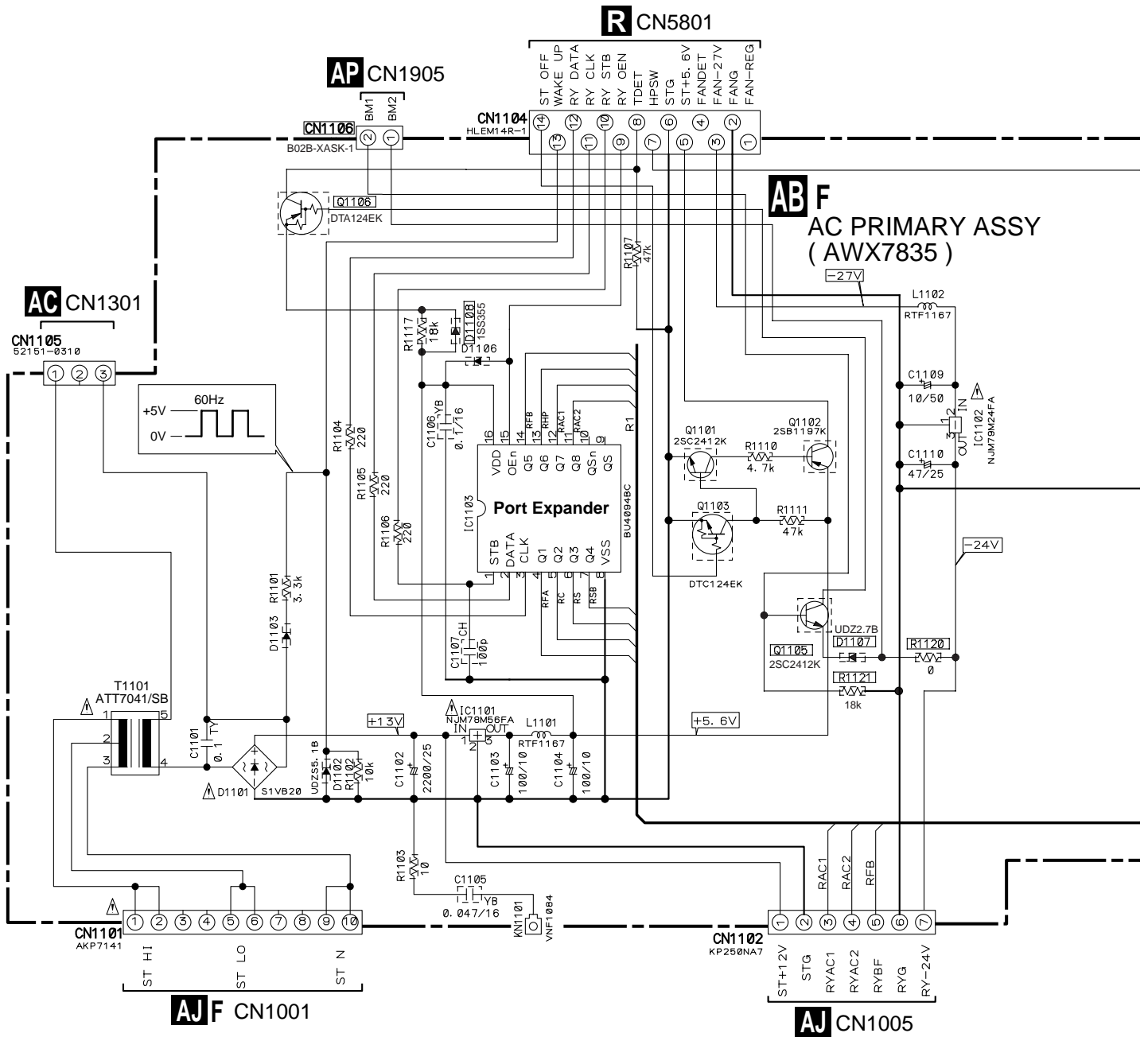

The  $\Delta$  mark found on some component parts indicates the importance of the safety factor of the part. Therefore, when replacing, be sure to use parts of identical designation.

- NOTES**
- RESISTORS**  
INDICATED IN Ohm 1/16W ± 5% TOLERANCE UNLESS NOTED K:Kohm M:MOhm
  - CAPACITORS**  
INDICATED INCAPACITY (uF) / VOLTAGE (V) UNLESS OTHERWISE NOTED p:pF  
INDICATED WITHOUT VOLTAGE IS 50V
  - DIODES**  
NO MARK DIODES ARE 1SS355
  - VOLTAGE**  
INDICATED IN DC VOLTAGE
- |  |             |  |              |
|--|-------------|--|--------------|
|  | RS1/16S***J |  | CCSRCH***J** |
|  | CFTYA***J50 |  | CKSRVB***K** |
|  | CFTLA***J** |  | CEAT***M**   |
|  |             |  | CEJQ***M**   |



- ⇨ : AUDIO SIGNAL ROUTE
- (F) ⇨ : AUDIO SIGNAL ROUTE (F)
- (C) ⇨ : AUDIO SIGNAL ROUTE (C)
- (S) ⇨ : AUDIO SIGNAL ROUTE (S)
- (SB) ⇨ : AUDIO SIGNAL ROUTE (SB)

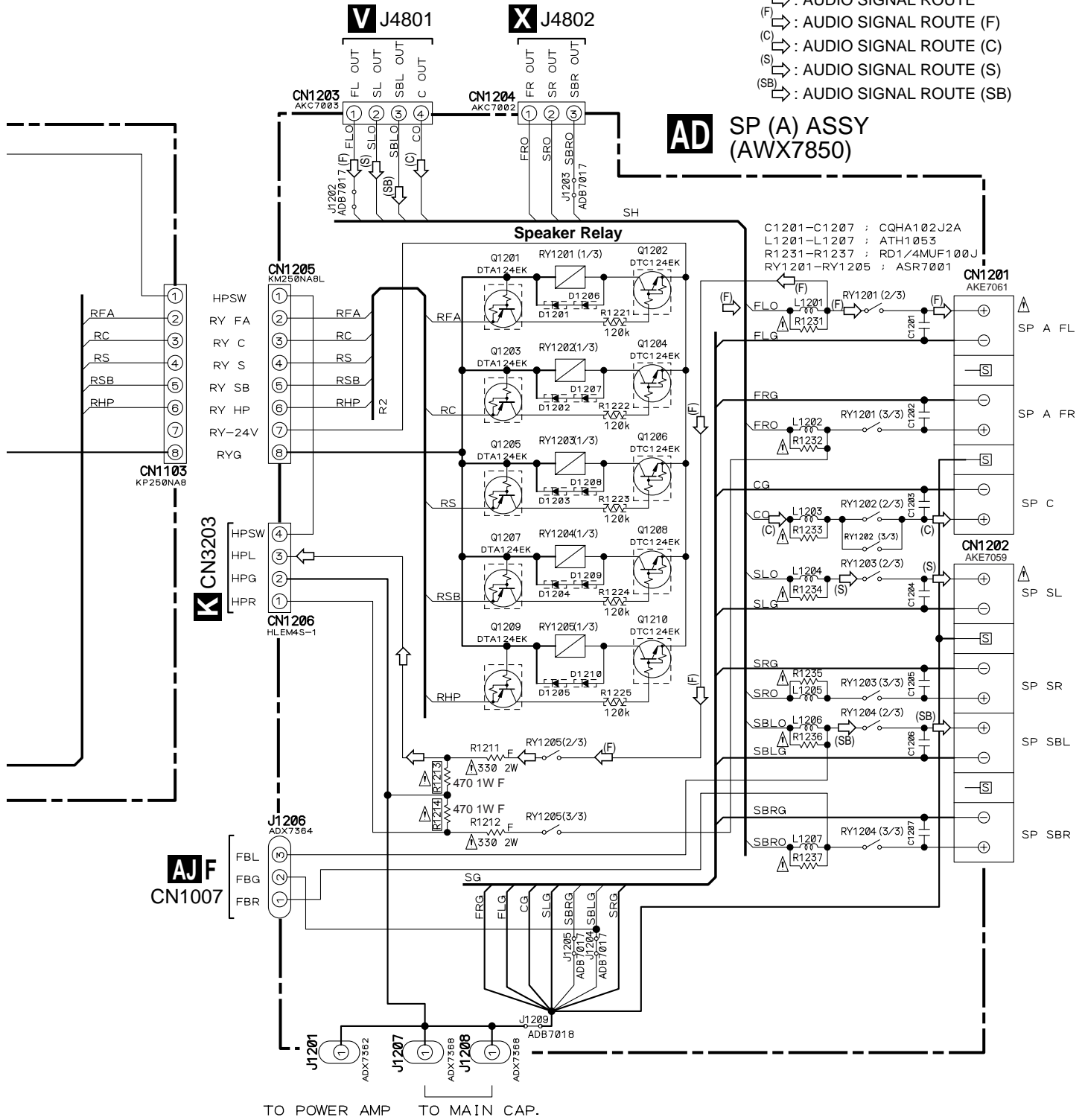

3.8 POSISTER (MT), SP (B), DIODE, TRANS (A), TRANS (B), FUSE and VOLTAGE SEL. ASSYS

A

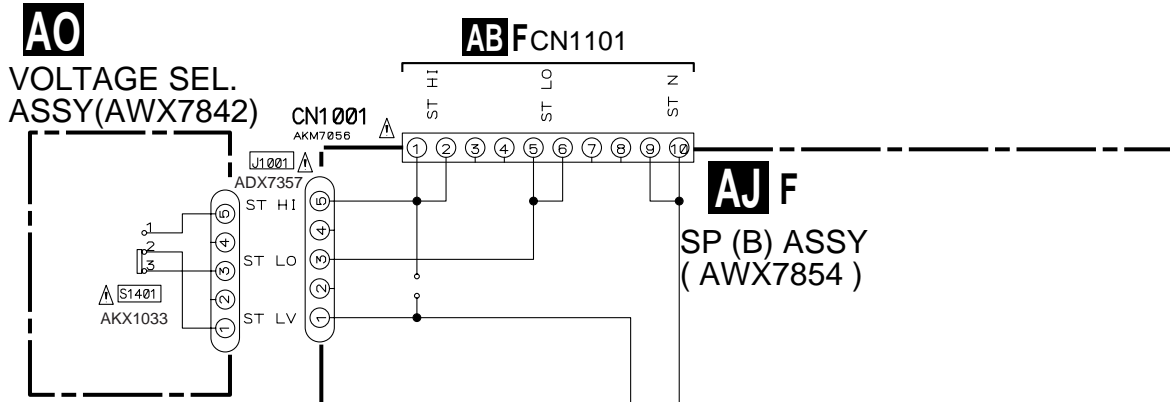

B

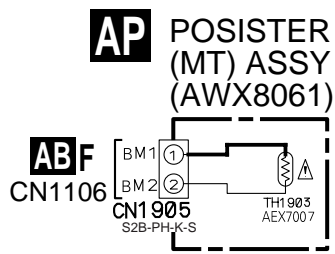

C

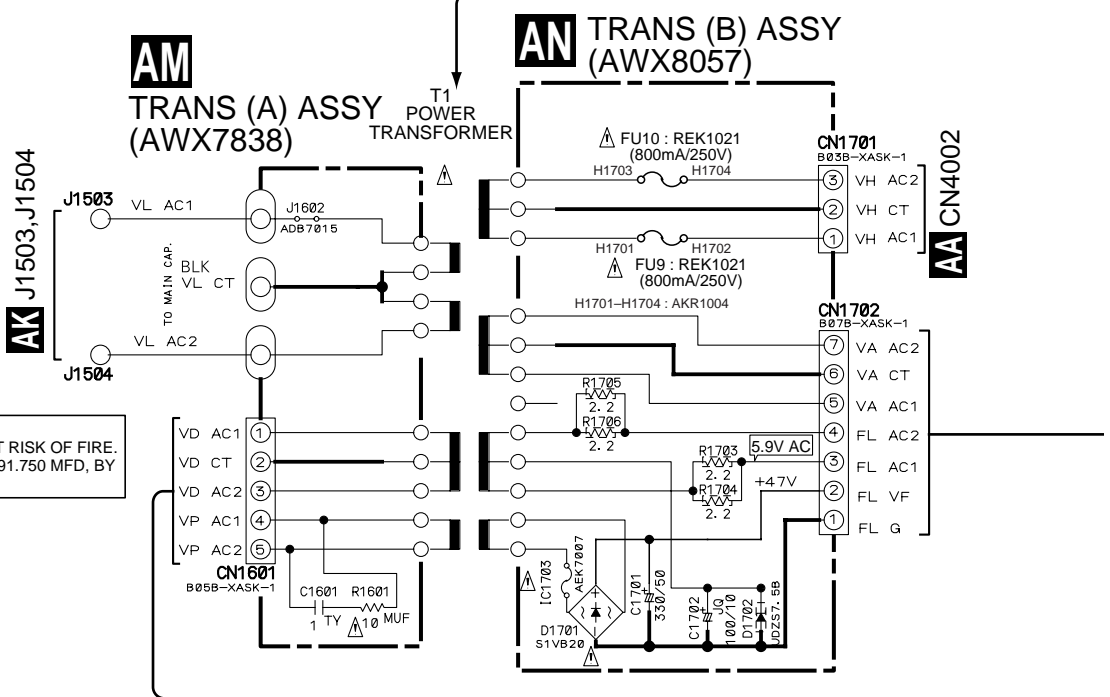

CAUTION : FOR CONTINUED PROTECTION AGAINST RISK OF FIRE. REPLACE ONLY WITH SAME TYPE NO. 491.750 MFD, BY LITTELFUSE INK. FOR IC1703 (AEK7007).

D

• NOTE FOR FUSE REPLACEMENT

**CAUTION** -FOR CONTINUED PROTECTION AGAINST RISK OF FIRE. REPLACE WITH SAME TYPE AND RATINGS ONLY.

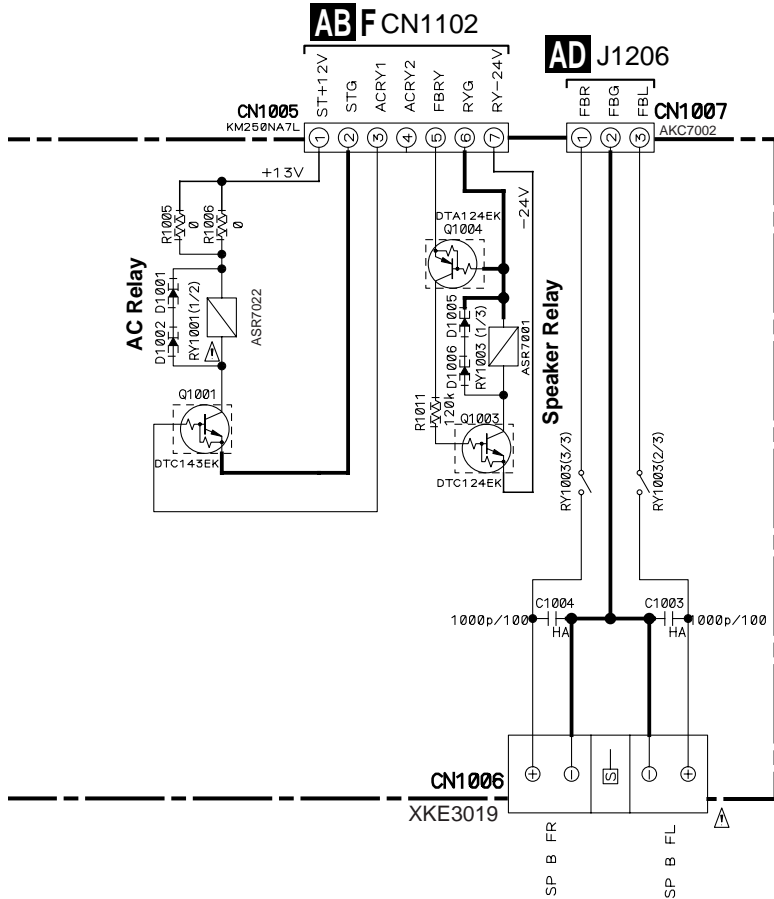

The  $\Delta$  mark found on some component parts indicates the importance of the safety factor of the part. Therefore, when replacing, be sure to use parts of identical designation.

NOTES

- 1. RESISTORS  
INDICATED IN Ohm 1/16W ±5% TOLERANCE UNLESS NOTED K:KOhm M:MOhm
- 2. CAPACITORS  
INDICATED IN CAPACITY (uF) / VOLTAGE (V) UNLESS OTHERWISE NOTED p:pF  
INDICATED WITHOUT VOLTAGE IS 50V EXCEPT
- 3. DIODES  
NO MARK DIODES ARE 1SS355
- 4. VOLTAGE  
INDICATED IN DC VOLTAGE

- $\text{---}\text{W}\text{---}$  MUF RD1/8MUF\*\*\*J
- $\text{---}\text{M}\text{---}$  MMF RD1/2MMF\*\*\*J
- $\text{---}\text{||}\text{---}$  TY CFTYA\*\*\*J50
- $\text{---}\text{||}\text{---}$  HA CQHA\*\*\*J\*\*
- $\text{---}\text{||}\text{---}$  CEAT\*\*\*M\*\*
- $\text{---}\text{||}\text{---}$  CEJQ\*\*\*M\*\*

**AL** FUSE ASSY (AWX7843)

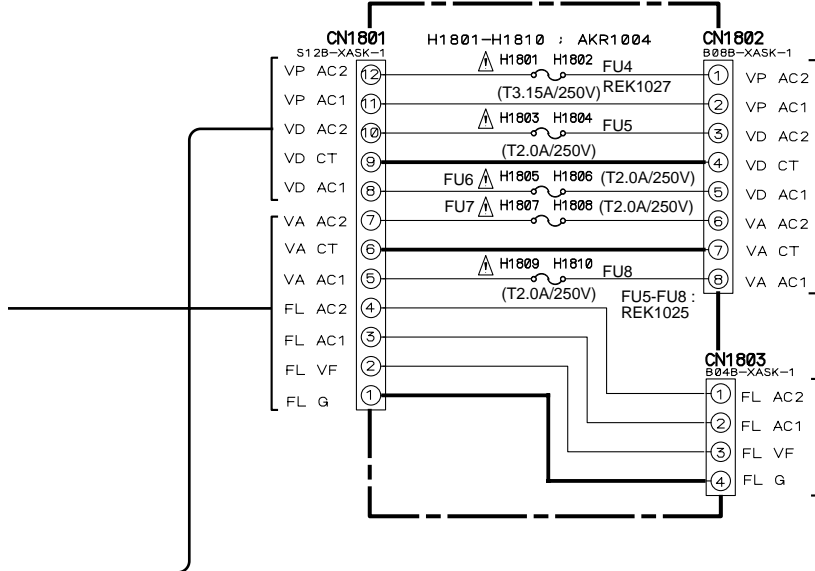

**AA** CN4001

**AE** CN1901

## 4. REMOTE CONTROL UNIT [AXD7298]

### 4.1 CONTRAST OF MISCELLANEOUS PARTS

- NOTES :
- Parts marked by “ NSP ” are generally unavailable because they are not in our Master Spare Parts List.
  - The  $\triangle$  mark found on some component parts indicates the importance of the safety factor of the part. Therefore, when replacing, be sure to use parts of identical designation.
  - Screw adjacent to  $\nabla$  mark on the product are used for disassembly.
  - Reference Nos. indicate the pages and Nos. in the service manual for the base model.

#### ■ CONTRAST TABLE

AXD7298 and AXD7295 are constructed the same except for the following:

Ref. No.	Mark	Symbol and Description	Part No.		Remarks
			AXD7295	AXD7298	
P161- 2		PCB Assy	AZC7299	AZC7300	
P161-13		Seal A	AZA7415	AZA7421	
P161-14		Seal B	AZA7416	AZA7420	
P161-16		Case A	AZN7783	AZN7795	
P161-17		Name Plate	AZA7406	AZA7409	
P161-21		Case B	AZN7784	AZN7796	
P161-23		Pen Holder	AZN7786	AZN7798	
P161-26		Battery Cover	AZN7785	AZN7797	
P161-32		Slide Knob	AZA7347	Not used	
P161-36		Key Top A	AZA7345	AZA7363	
P161-37		Key Top B	AZA7346	AZA7364	
P161-39		Rubber Sheet B	AZA7349	AZA7371	
P161-40		Rubber Sheet C	AZA7411	AZA7411	