

SERVICE MANUAL



STEREO AMPLIFIER

JA 20

(EUROPE)

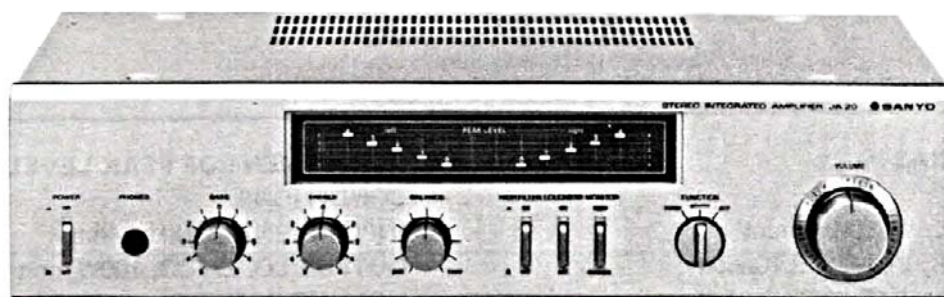

NOTE:

SPECIFICATIONS

The below mentioned specifications are mainly based on the IHF measurements standard. They can therefore not directly be compared with specifications based on the DIN standard or other standards.

Continuous output power	20 W x 2 (at 8 ohms, 1% distortion)
Total harmonic distortion	0.1% (16 W output, 8 ohms)
Input sensitivity and impedance	
PHONO	2.5 mV/47 kohms
AUX/TUNER/TAPE PLAY	150 mV/47 kohms
Phono overload level	120 mV RMS (at 1 kHz)
Output level	
TAPE REC	150 mV
Frequency response	10 Hz – 40 kHz (AUX)
Tone control response	
BASS	±8 dB (at 100 Hz)
TREBLE	±8 dB (at 10 kHz)
High filter response	8 kHz (–6 dB/oct.)
Loudness control response (Vol. –30 dB)	
100 Hz/10 kHz	+8 dB/+4 dB
Signal to noise ratio	70 dB
Power requirements	AC: 220 V, 50 Hz
Power consumption	90 W
AC output socket	AC: 18 V, 300 mA (max.)
Dimensions (Approx.)	380 (W) x 180 (D) x 88 (H) mm (15-3/16" x 7-1/8" x 3-1/2")
Weight (Approx.)	3.6 kg (7 lbs. 15 ozs.)

* Specifications subject to change without notice.

WM-6567

FRONT PANEL DISASSEMBLY _____

FITTING OF LED METER PCB ASS'Y _____

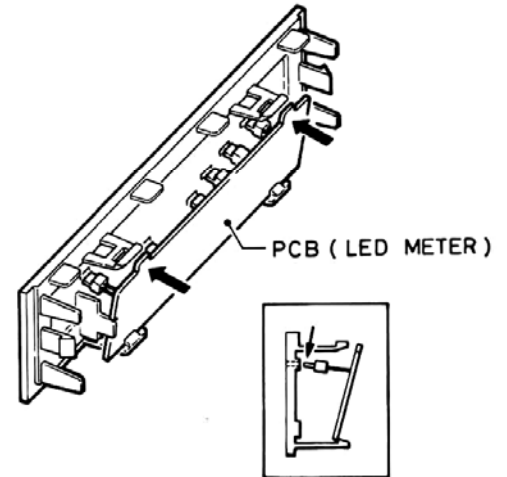
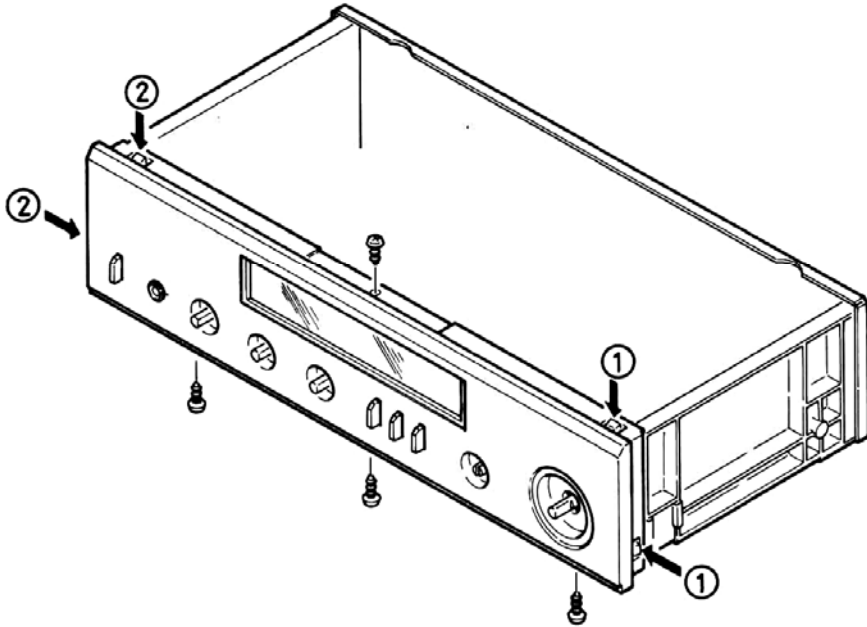

ADJUSTMENT _____

1. ADJUSTMENT OF BIAS

* CONDITIONS

- VOLUME CONTROL: "0" (Minimum)
- BALANCE CONTROL VOLUME: (Center)
- BASS CONTROL VOLUME: "0" (Center)
- TREBLE CONTROL VOLUME: "0" (Center)
- FUNCTION SWITCH: TUNER
- MONITOR SWITCH: SOURCE
- HIGH FILTER SWITCH: OFF
- LOUDNESS SWITCH: OFF
- OUTPUT LOAD: NO LOAD

After the power switch is turned on, adjust SVR703 and SVR803 respectively as follows:

L - channel: SVR703 for 2 ~ 3mV reading between the both leads of R734.

R - channel: SVR803 for 2 ~ 3mV reading between the both leads of R834.

2. ADJUSTMENT OF PEAK LEVEL METER

* CONDITIONS

- INPUT SIGNAL: 1kHz, 46mV
- OUTPUT LOAD: 8Ω, 100W, non-inductive resistance
- VOLUME CONTROL: "10" (Maximum)

- (1) Introduce test oscillator signal to the TUNER terminal.
- (2) Adjust test oscillator signal so that LED "3" of the right side peak level meter begins to light. (The output voltage of the right side becomes about 3.5V at this time.)
- (3) Next, check that the output voltage of left speaker is same as the right side. Adjust with SVR762 so that LED "3" of peak level meter begins to light.

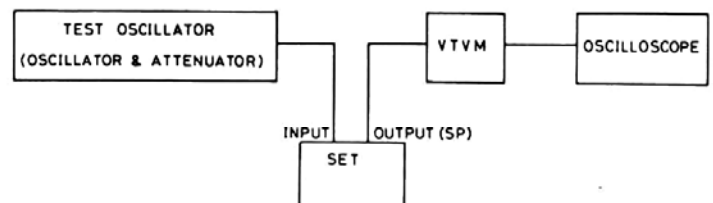

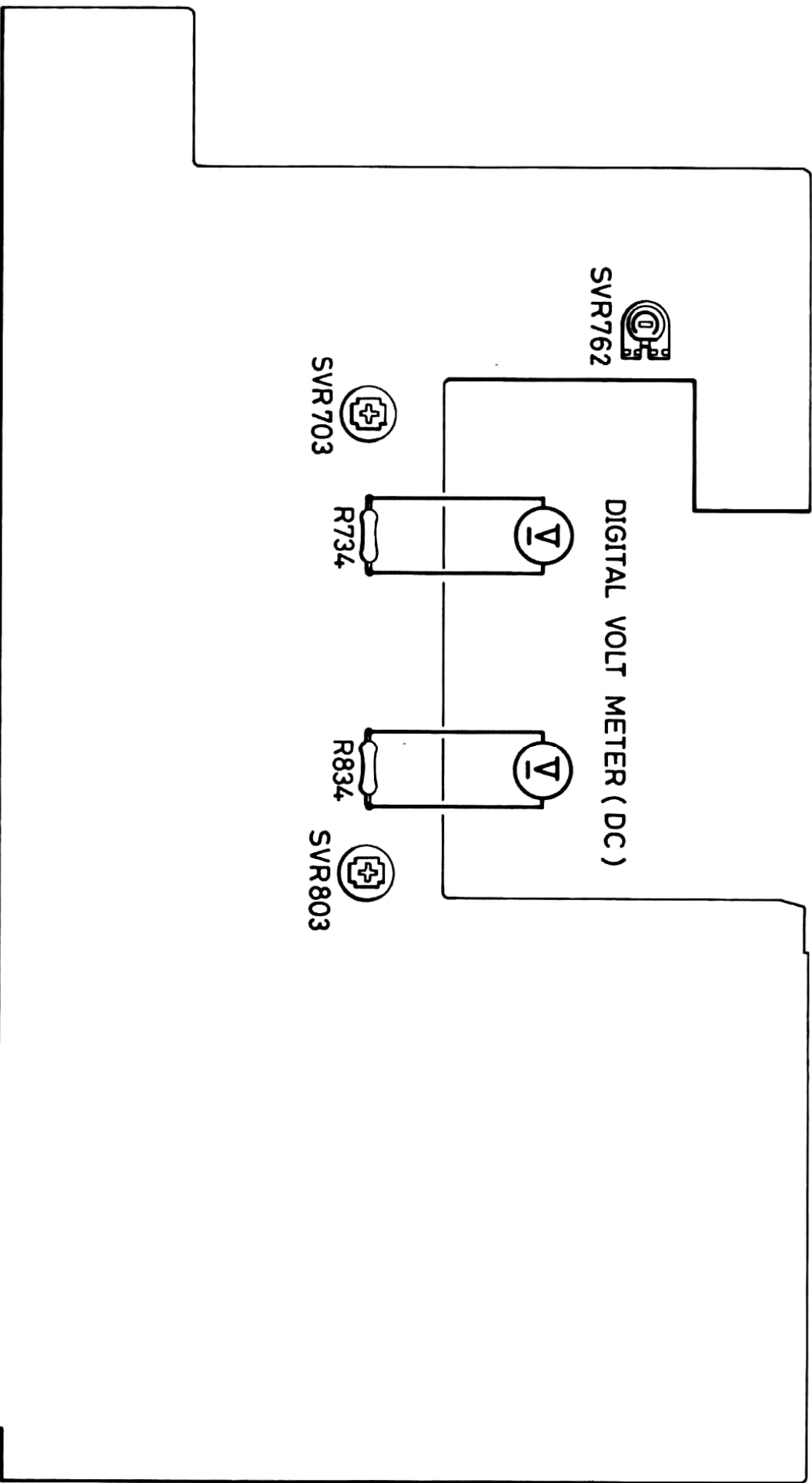

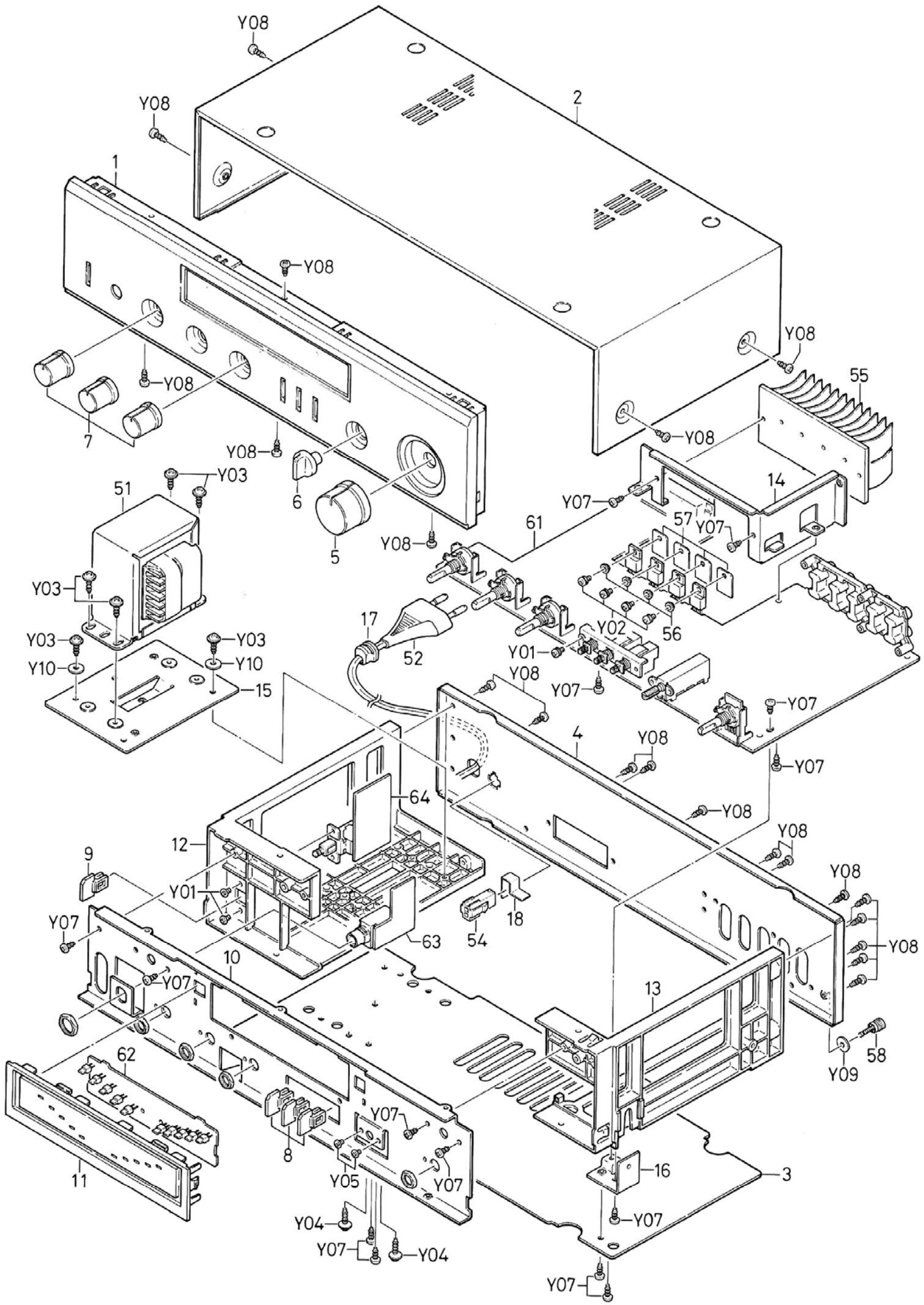

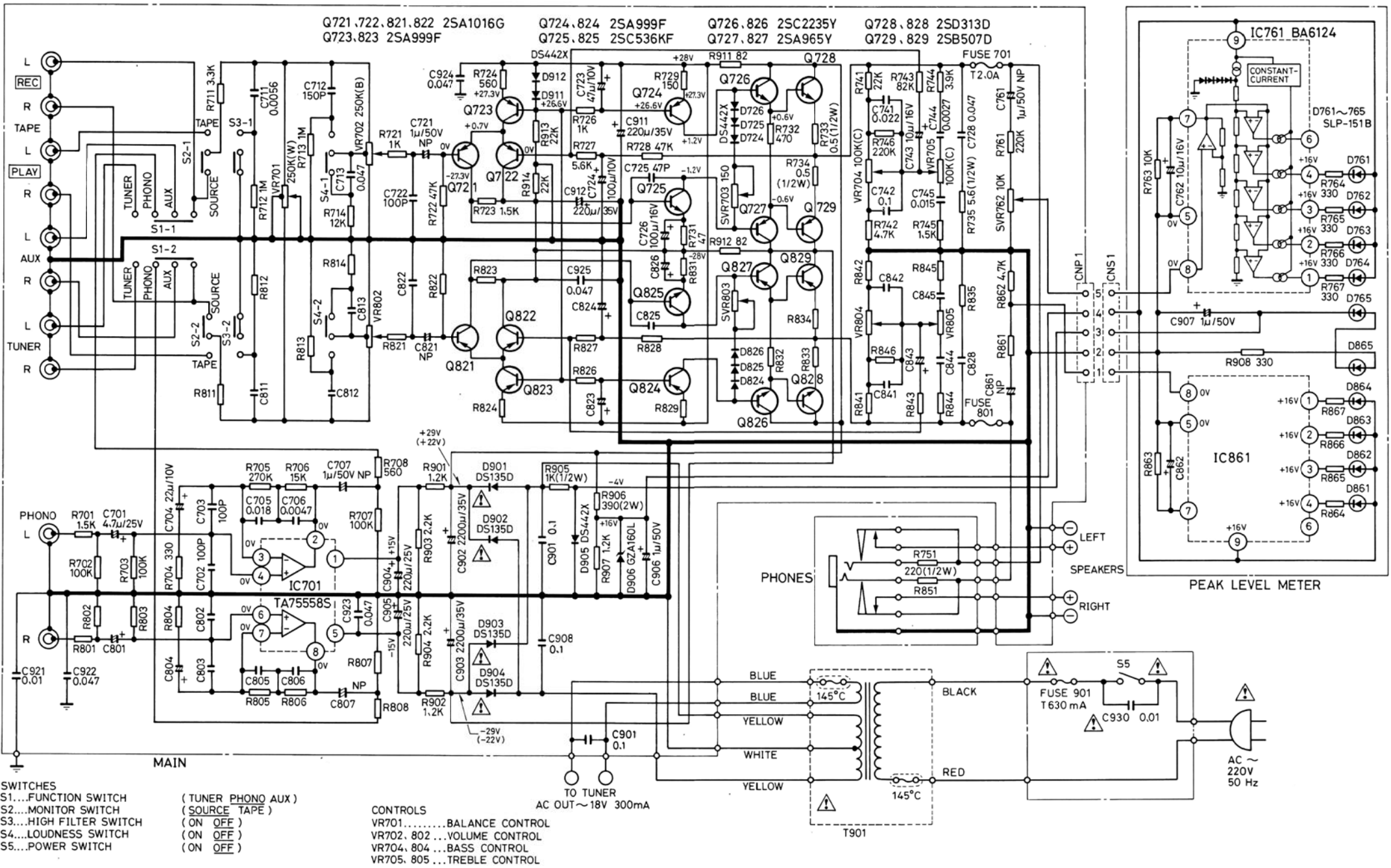

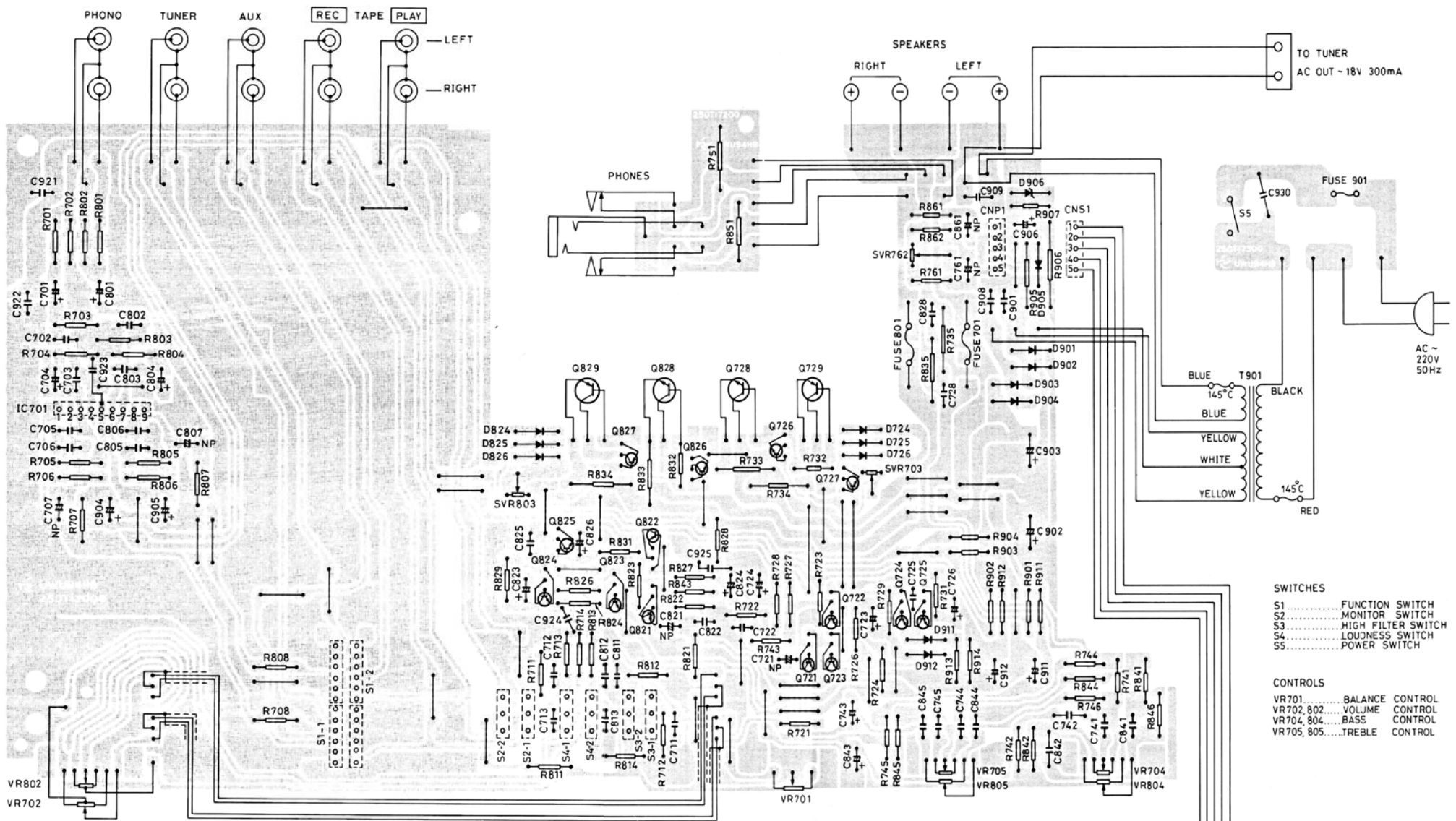

IC701.....TA7558 S



IC761, 861.....BA 6124

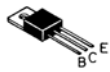

Q728, 828.....2SD313D
Q729, 829.....2SB507



Q721, 821
Q722, 822.....2SA1016



Q726, 826.....2SC2235
Q727, 827.....2SA965

