

SERVICE MANUAL

SKANTIC

LUXOR

8108



TYPE 110 9114



— 220 V AC/ +9 V DC



— 1.3 W

Bandhastighet
Tape speed 4.75 cm/s

Svaj
Wow and flutter 0.30 %

Snabbspolning
Fast wind 110 s (C-60)

Frekvensområde
Frequency response 125 - 6300 Hz

Signal/brusförhållande
Signal/Noise ratio 45 dB

AM
Frekvensområde
Frequency range 520 - 1620 kHz

FM
88 - 108 MHz

Mellanfrekvens
IM frequency 455 kHz

10.7 MHz

Max känslighet
Sensitivity max 56 dB/m

23.5 dB

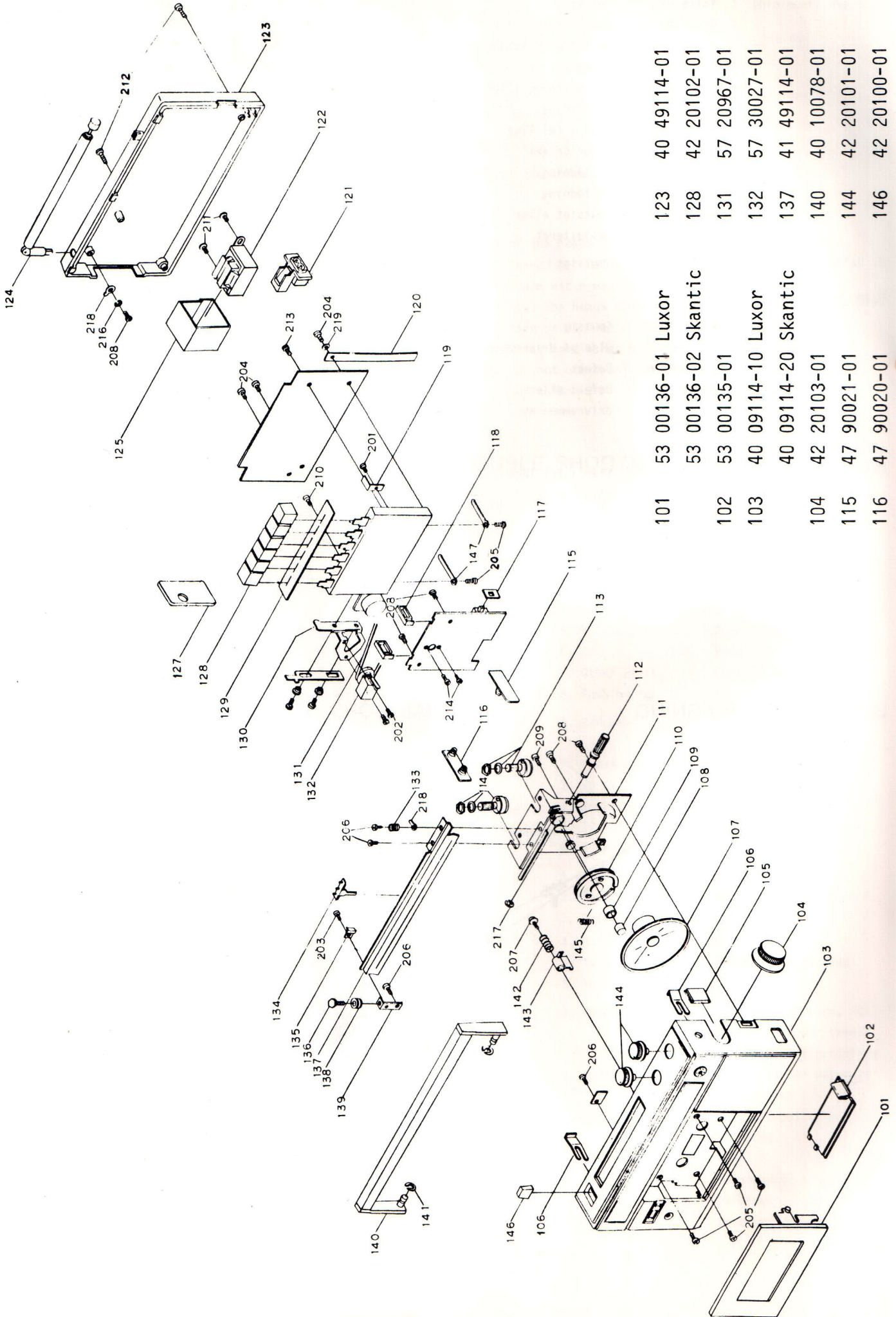

KOPPLINGSSCHEMA CIRCUIT DIAGRAM

SW101 ... AM/FM SELECTOR SWITCH
 SW202 ... REC/PLAY SWITCH
 SW201 ... RADIO/TAPE/SLEEP SWITCH
 SW301 ... AC/DC SWITCH

