

PS-4750

*USA Model
Canada Model*



STEREO TURNTABLE SYSTEM

SPECIFICATIONS

TURNTABLE

Platter:	13 $\frac{3}{8}$ " (34 cm) SBMC (Sony Bulk Mould Compound)
Drive system:	DC servo-controlled motor, direct drive
Speed:	33 $\frac{1}{3}$ rpm, 45 rpm
Wow and flutter:	0.03% WRMS
S/N ratio:	70 dB

TONEARM

Type:	Statically balanced, universal
Pivot to stylus length:	9 $\frac{11}{32}$ " (237 mm)
Overall arm length:	12 $\frac{3}{8}$ " (314 mm)
Overhang:	15 mm
Tracking-force adjustment range:	0 – 3 g
Shell weight:	14.5 g
Cartridge weight range:	4 – 14 g

GENERAL

Power requirements:	120 V ac, 60 Hz
Power consumption:	6 W
Dimensions:	477(w) x 175(h) x 420(d) mm 18 $\frac{13}{16}$ (w) x 6 $\frac{7}{8}$ (h) x 16 $\frac{9}{16}$ (d) inches
Net weight:	8.5 kg, 18 lb 12 oz
Shipping weight:	12.6 kg, 27 lb 12 oz

Cartridge is not supplied
with this turntable system.

SONY[®]
SERVICE MANUAL

**SECTION 1
REMOVAL AND REPLACEMENT**

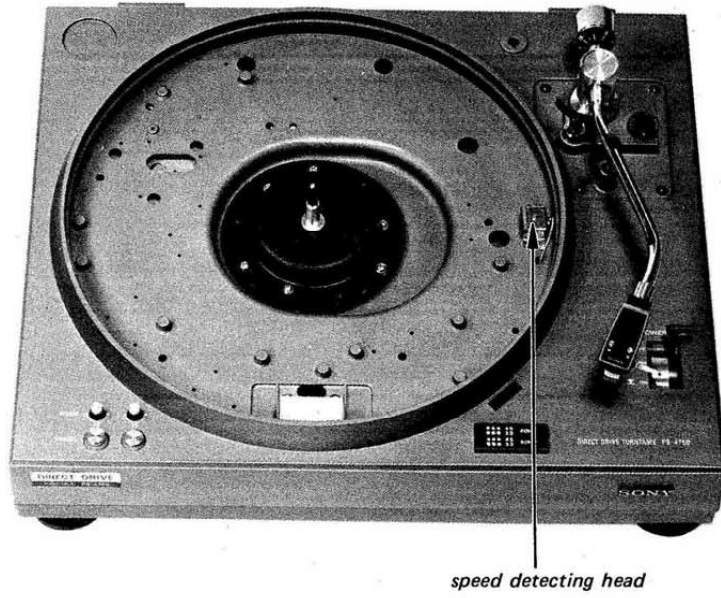

Fig. 1-2

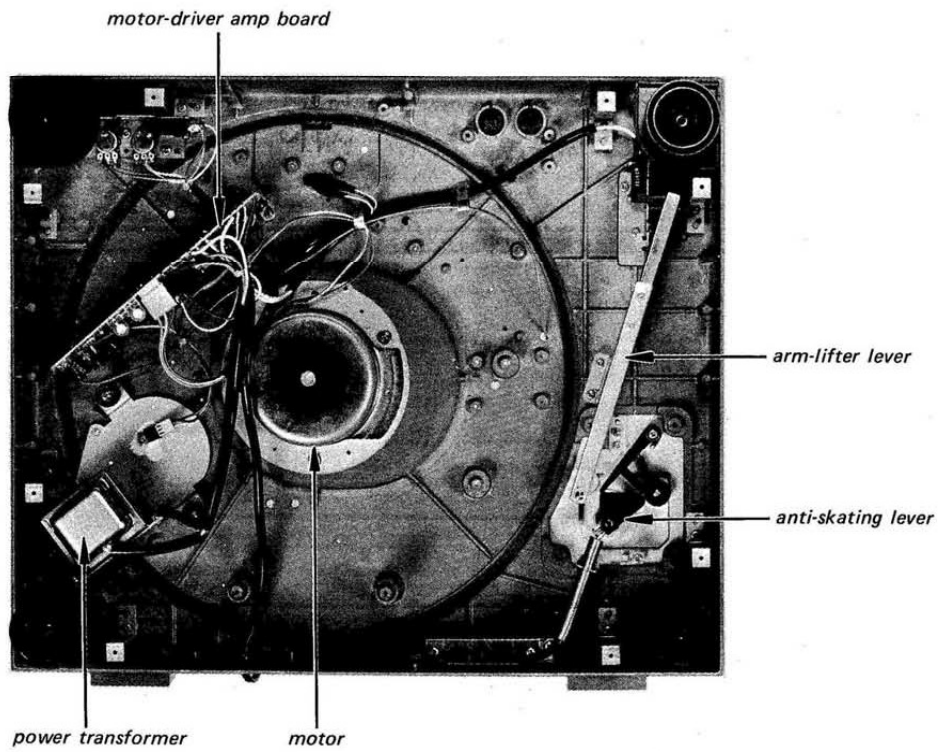

Fig. 1-2.

1-1. DUST COVER REMOVAL

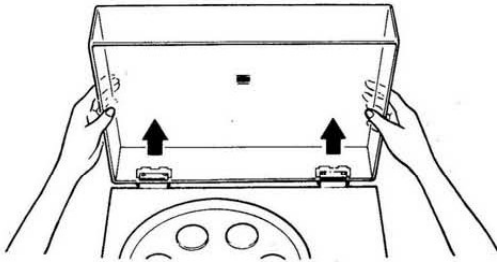

Fig. 1-3.

1-2. TURNTABLE REMOVAL

Remove the two rubber mats with arrows.

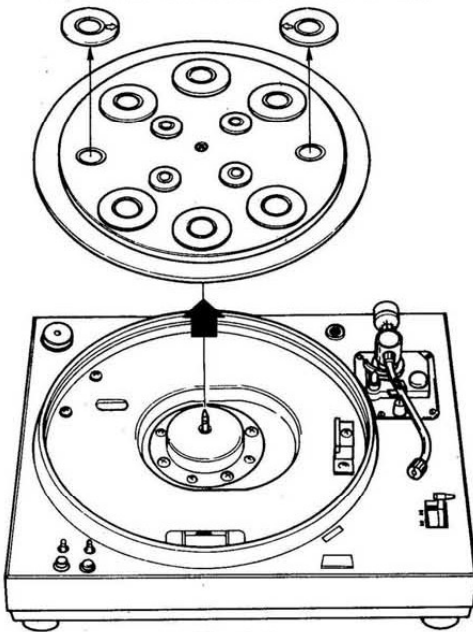

Fig. 1-4.

1-3. BOTTOM PANEL REMOVAL

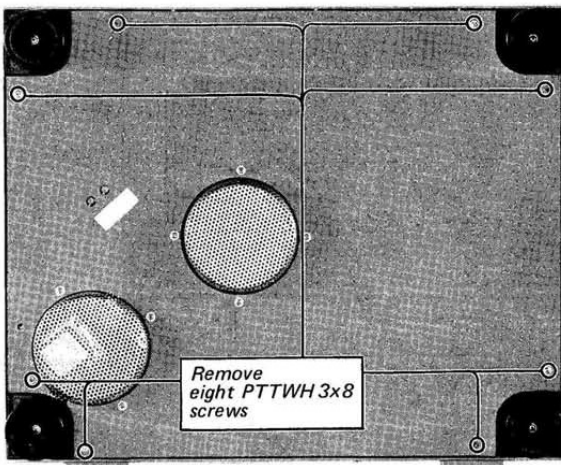
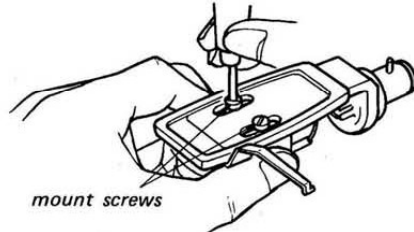

Fig. 1-5.

1-4. CARTRIDGE INSTALLATION

① Install cartridge.



mount screws

Fig. 1-6.

② Connect the lead wires.

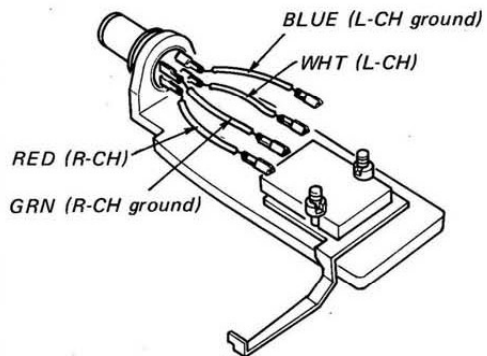

Fig. 1-7.

③ Adjust overhang.

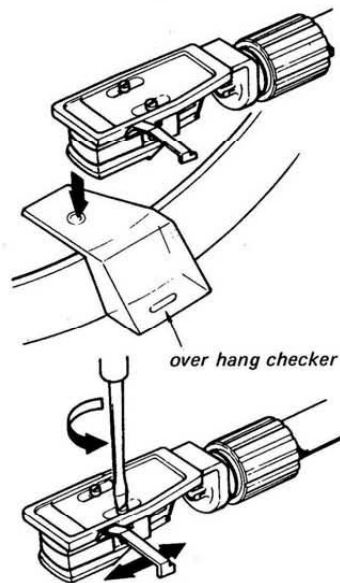

Fig. 1-8.

④ Tighten the mount screws.

1-5. TONEARM REPLACEMENT

① Remove the shell head and the counter weight from the tonearm.

② Remove the shielding case (screw ①). Remove the ground wire (screws ② and ③). Remove the spring (screw ④). Disconnect the six output wires at the terminals.

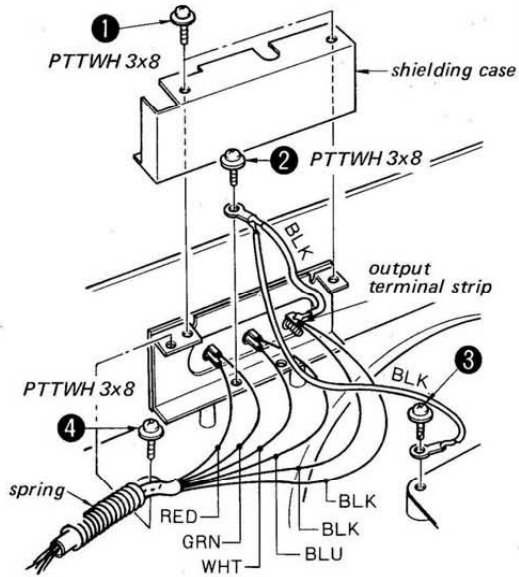

Fig. 1-9.

③ Remove ⑤ and ⑥

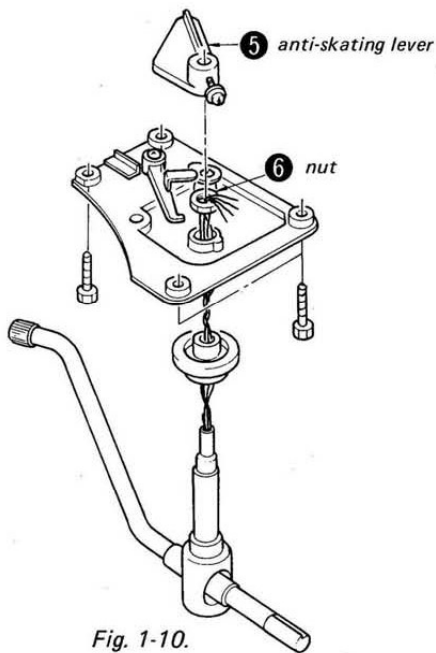

Fig. 1-10.

④ Replace the tonearm.

1-6. MOTOR REPLACEMENT

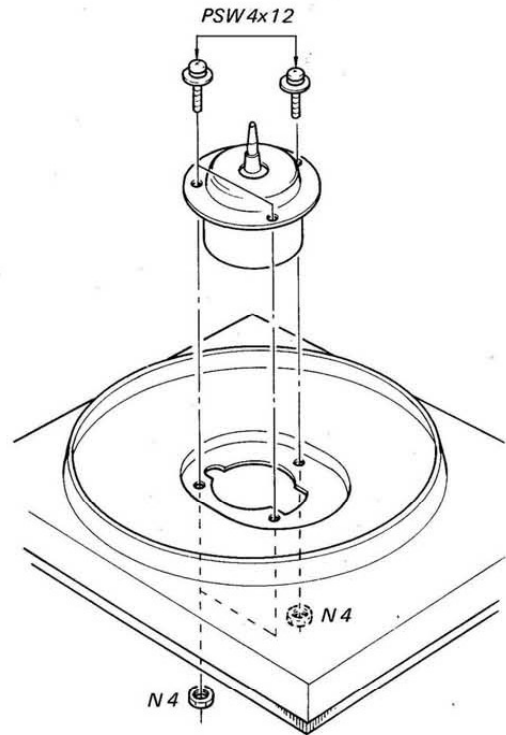

Fig. 1-11.

1-7. ANTI-SKATING LEVER INSTALLATION

Lock the tonearm in the arm rest, and align the \square of the anti-skating lever with the center of the cam A as shown below.

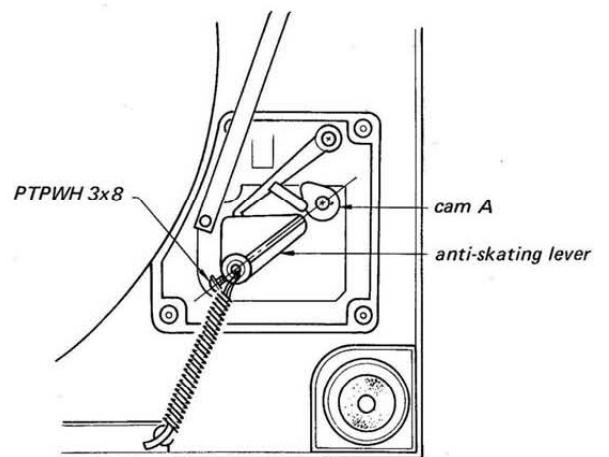

Fig. 1-12.

SECTION 2 ADJUSTMENT

2-1. TONEARM HEIGHT ADJUSTMENT

- ① Set the arm lifter at ∇ position. Then, adjust **C** so that the arm-lifter lever makes contacts at **A** and **B** as shown at right.

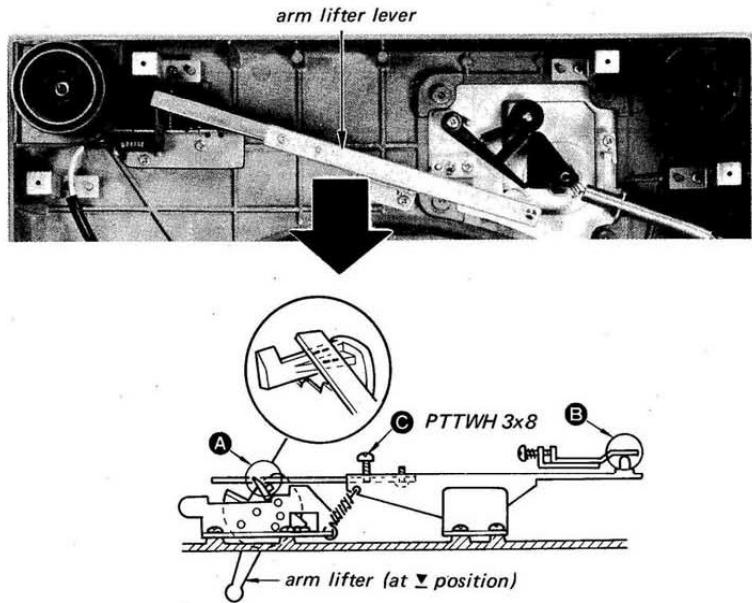

Fig. 1-13.

- ② Adjust the height.

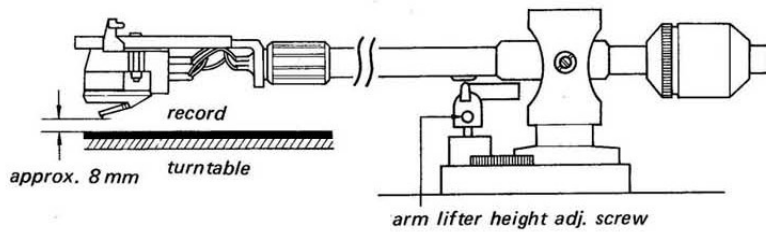

Fig. 1-14.

2-2. SPEED CONTROL ADJUSTMENT

When the correct speed is not within the adjustable range of the pitch control, adjust SPEED CONTROL (see Fig. 1-15).

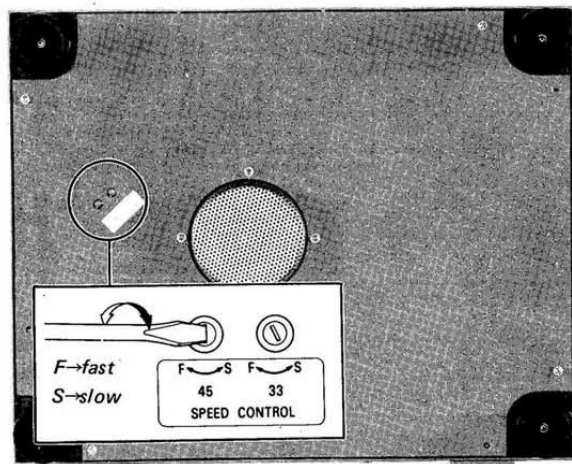
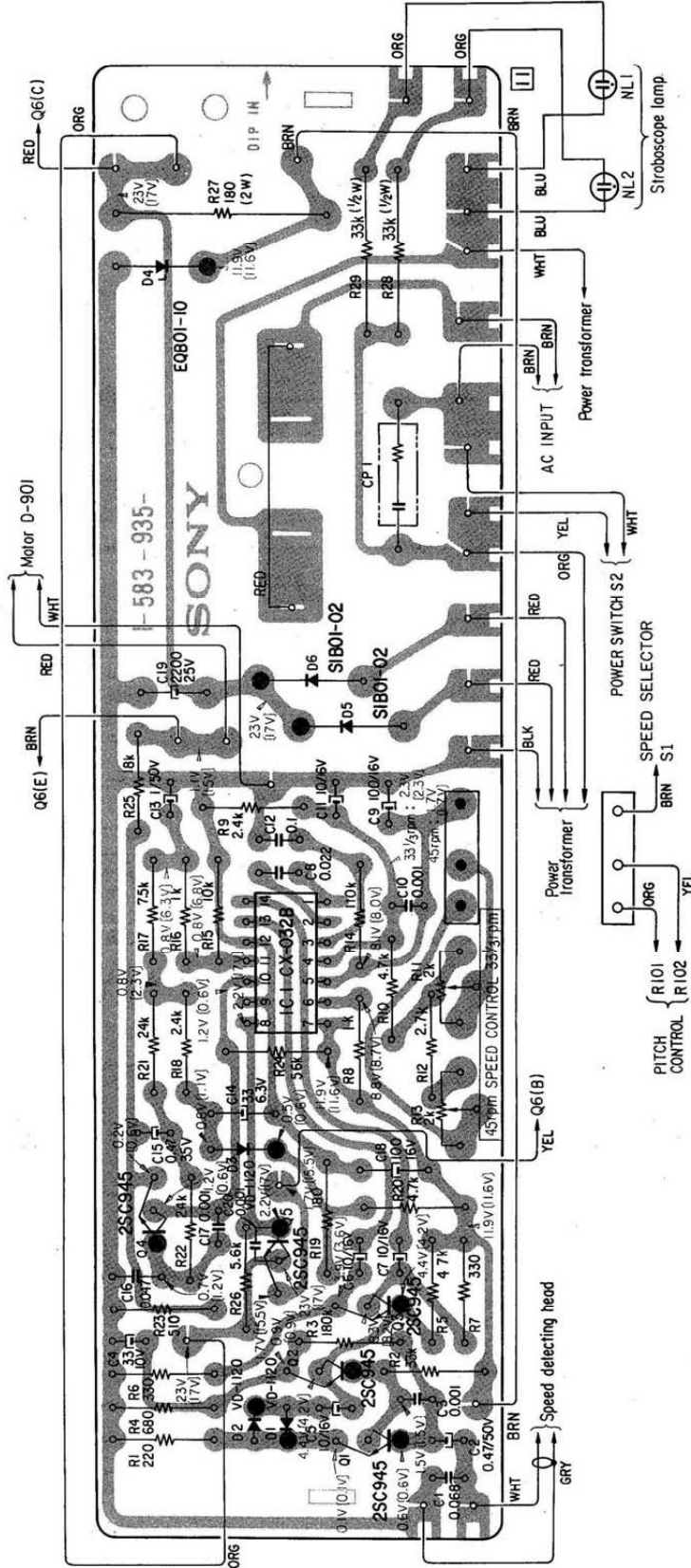

Fig. 1-15.

SECTION 3
DIAGRAMS

3-1. MOUNTING DIAGRAM
— Conductor Side —

MOTOR-DRIVE AMP and POWER SW BOARDS



- CX-032B**
7 6 5 4 3 2 1
8 9 10 11 12 13 14
WHT dot
(Top view)
- 2SC945**
anode
cathode
- 2SC1173 (O6)**
C
B
E
B
C
E
- VD-1120**
cathode
anode
- S1B01-02**
C
B
E
B
C
E
- EOB01-12Z**
C
B
E
B
C
E

3-2. SCHEMATIC DIAGRAM

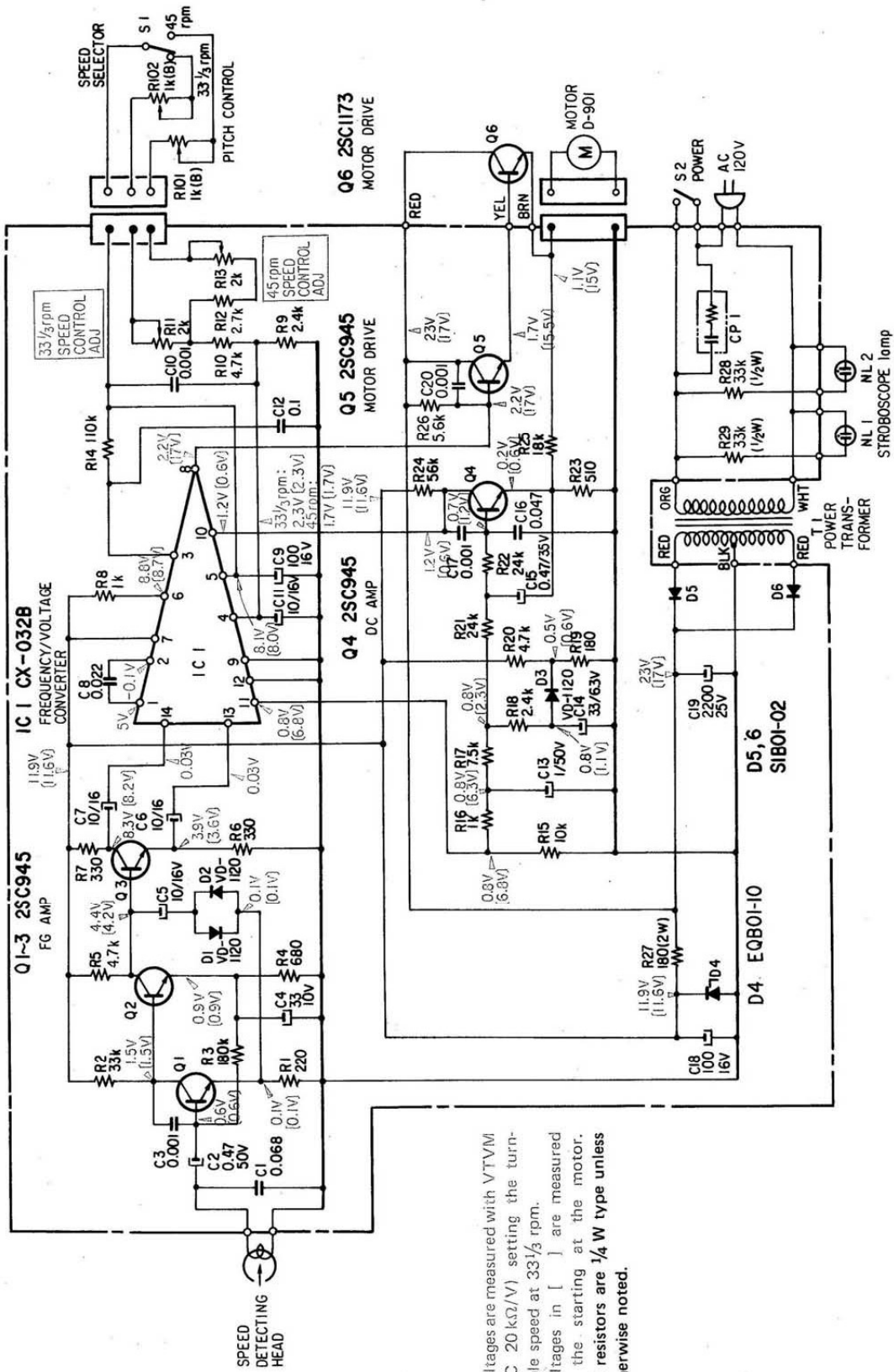

Note: Voltages are measured with VTVM (DC 20 kΩ/V) setting the turntable speed at 33 1/3 rpm. Voltages in [] are measured at the starting of the motor. All resistors are 1/4 W type unless otherwise noted.

**SECTION 4
EXPLODED VIEW**

(1)

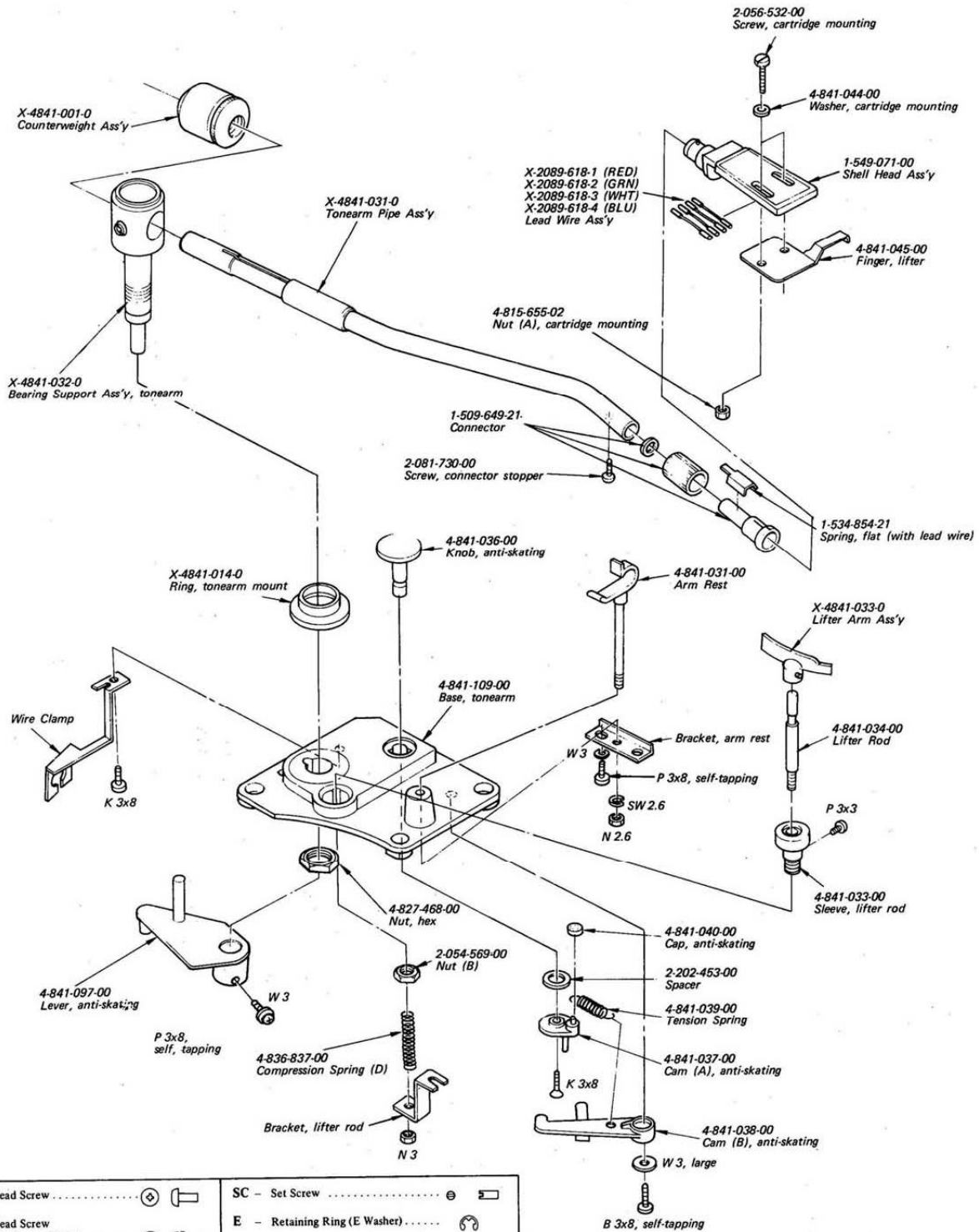

P - Pan Head Screw	SC - Set Screw
PS - Pan Head Screw with Spring Washer	E - Retaining Ring (E Washer)
K - Flat Countersunk Head Screw	W - Washer
B - Binding Head Screw	SW - Spring Washer
RK - Oval Countersunk Head Screw	LW - Lock Washer
T - Truss Head Screw	N - Nut
R - Round Head Screw	
F - Flat Fillister Head Screw	

Example

Type of Slot

P 3x10

Length in mm (L)

Diameter in mm (D)

Type of Head

Note:

- Items without part number and description are not available.
- All screws are Phillips (cross recess) type unless otherwise noted.
- (-) = slotted head

Note:
 ○ Items without part number and description are not available.
 ○ All screws are Phillips (cross recess) type unless otherwise noted.
 (-) = slotted head

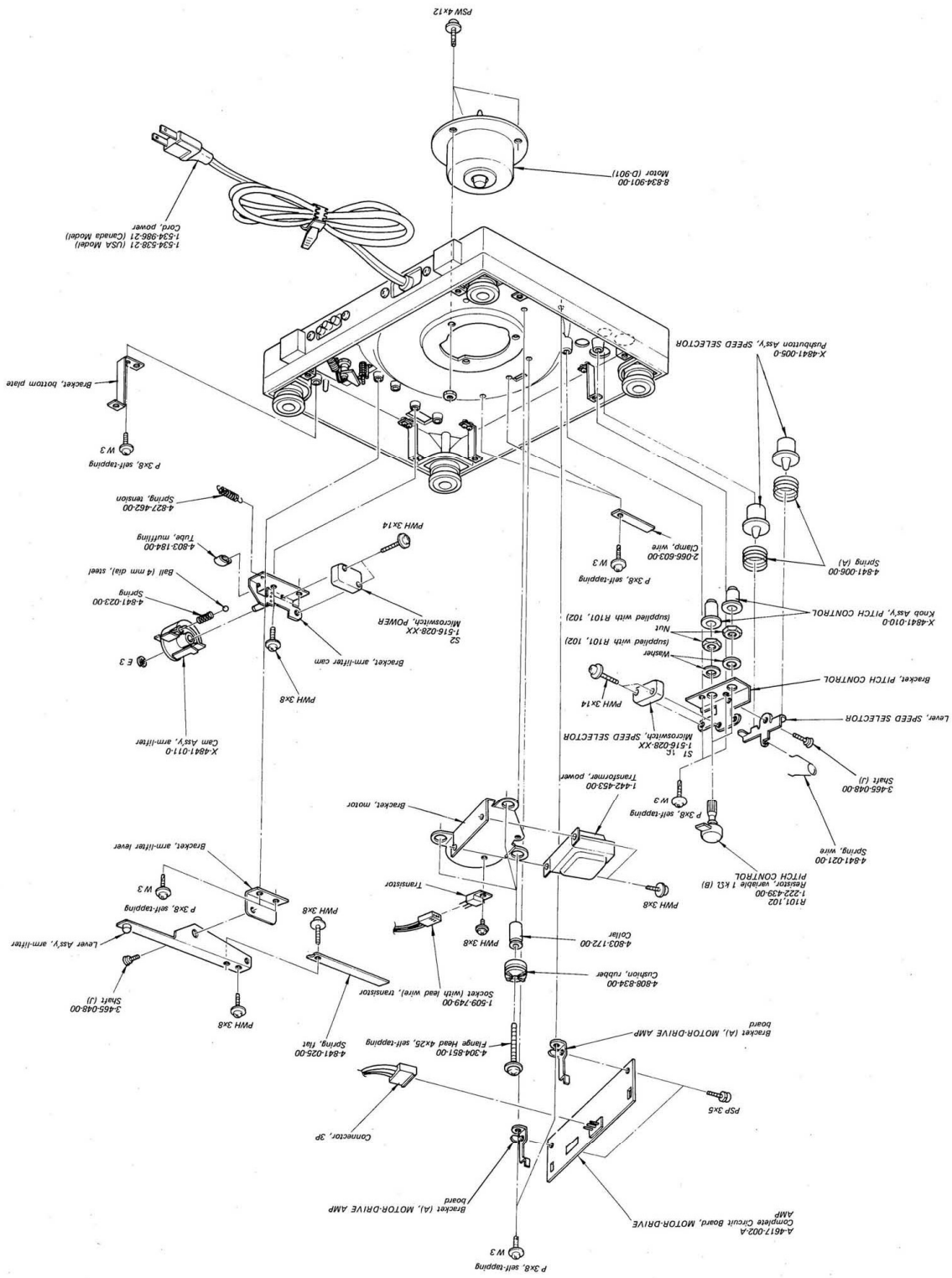

PS-4750 PS-4750

PS-4750 PS-4750

Note:
 ○ Items without part number and description are not available.
 ○ All screws are Phillips (cross recess) type unless otherwise noted.
 (-) = slotted head

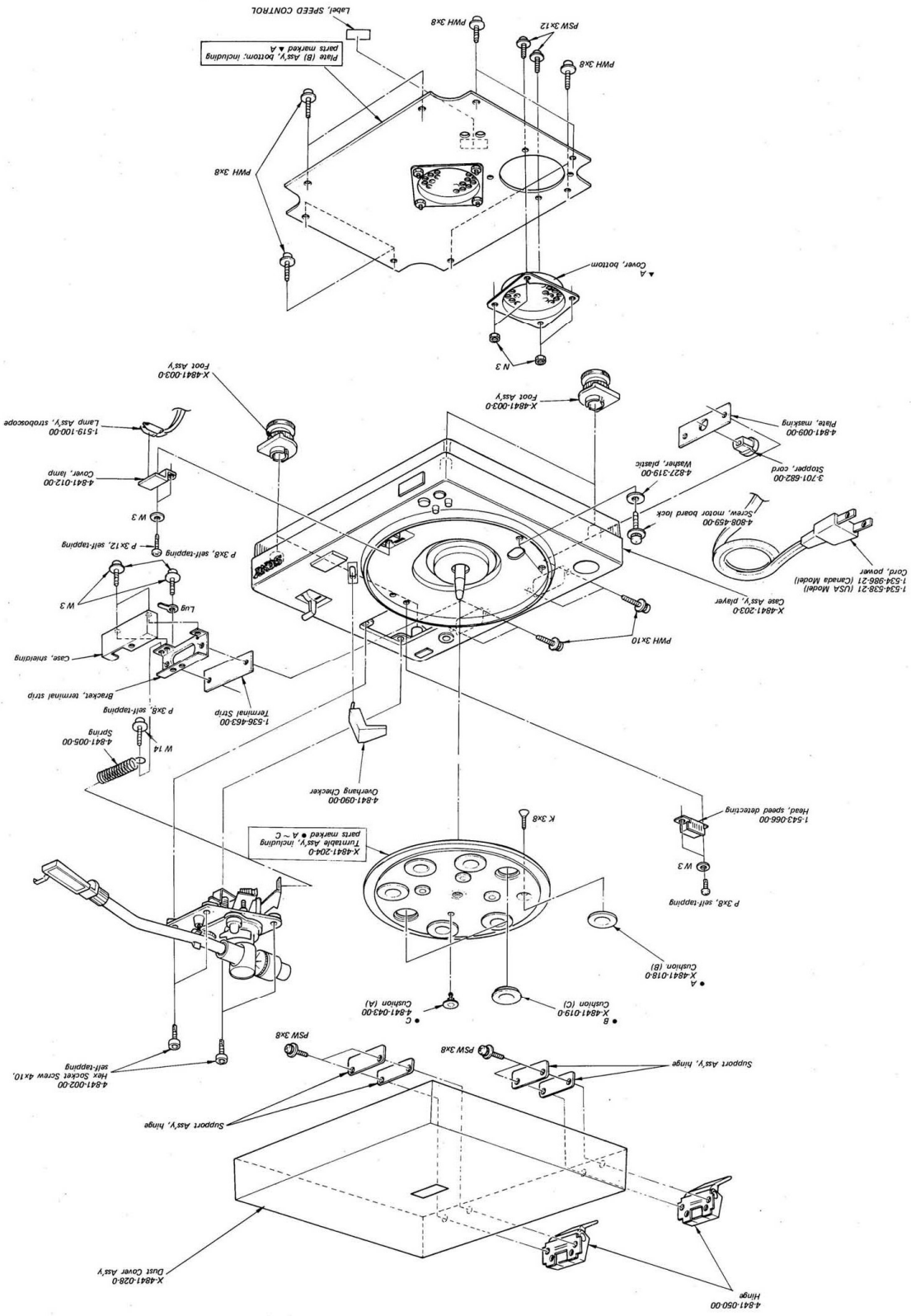

SECTION 5 ELECTRICAL PARTS LIST

Ref. No. Part No. Description

COMPLETE CIRCUIT BOARD

A-4617-002-A Motor-drive Amp

SEMICONDUCTORS

Transistors

Q1~5 2SC945
Q6 2SC1173

IC

IC1 CX-032B

Diodes

D1~3 VD-1120
D4 EQB01-10
D5,6 SIB01-02

CAPACITORS

All capacitors are in μF ($p = \mu\mu$). 50V or less working volts are omitted except for electrolytic type. (elect = electrolytic)

C	Part No.	Value	Voltage	Material
1	1-105-683-12	0.068		mylar
2	1-121-726-11	0.47	50 V	elect
3	1-105-661-12	0.001		mylar
4	1-121-402-11	33	10 V	elect
5~7	1-121-651-11	10	16 V	elect
8	1-105-677-12	0.022		mylar
9	1-121-415-11	100	16 V	elect
10	1-105-661-12	0.001		mylar
11	1-121-651-11	10	16 V	elect
12	1-105-525-12	0.1		mylar
13	1-121-391-11	1	50 V	elect

Ref. No. Part No. Description

14	1-131-229-21	33	6.3 V	tantalum
15	1-131-213-21	0.47	35V	tantalum
16	1-105-681-12	0.047		mylar
17	1-105-661-12	0.001		mylar
18	1-121-415-11	100	16 V	elect
19	1-123-067-11	2200	25 V	elect
20	1-105-661-12	0.001		mylar

RESISTORS

All resistors are in Ω . The $\frac{1}{4}\text{W}$, $\pm 5\%$ carbon type resistors, except special types, are omitted from this list. Check their resistance values in the schematic diagram. (k = 1,000, M = 1,000 k)

R

27	1-206-058-11	180	2W	metal oxide
28,29	1-202-609-31	33 k	$\frac{1}{2}\text{W}$	composition
11,13	1-221-663-21	2 k	adjustable	(SPEED CONTROL adj)
101,102	1-222-439-00	1 k	(B) variable	(PITCH CONTROL)

SWITCHES

S1	1-516-028-XX	Micro, SPEED SELECTOR
S2	1-516-028-XX	Micro, POWER

MISCELLANEOUS

CP1	1-231-057-00	Encapsulated Component
NL1,2	1-519-100-00	Lamp Ass'y, stroboscope
T1	1-442-453-00	Transformer, power
	1-508-704-00	Pin, connecting
	1-509-649-21	Connector
	1-509-749-00	Socket (with lead wire), transistor
	1-534-538-21	Cord, power (USA Model)
	1-534-854-21	Spring, flat (with lead wire)
	1-534-986-21	Cord, power (Canada Model)
	1-536-463-00	Terminal Strip
	1-543-066-00	Head, speed detecting
	1-549-071-00	Shell Head Ass'y
	8-834-901-00	Motor (D-901)

<u>Part No.</u>	<u>Description</u>
PACKING MATERIALS AND ACCESSORIES	
1-551-085-00	Cord, with connector (male)
3-701-354-00	Label, tack
3-701-616-00	Bag, plastic; counterweight
3-701-628-00	Bag, plastic; 45 rpm manual adaptor/ cord (with connector)
3-701-630-00	Bag, plastic; instruction manual
3-701-634-00	Bag, plastic; turntable platter
3-780-594-21	Manual, instruction
4-801-128-00	Sheet, protection
4-808-630-00	Adaptor, manual; 45 rpm
4-841-106-00	Sheet, protection
4-841-107-00	Cushion, side
4-841-108-00	Cushion, accessories
4-841-203-00	Carton
4-841-204-00	Cushion, bottom
4-841-205-00	Cushion, insulating

Sony Corporation

© 1975

— 14 —