

STR-7015

USA Model
Canada Model
UK Model
AEP Model

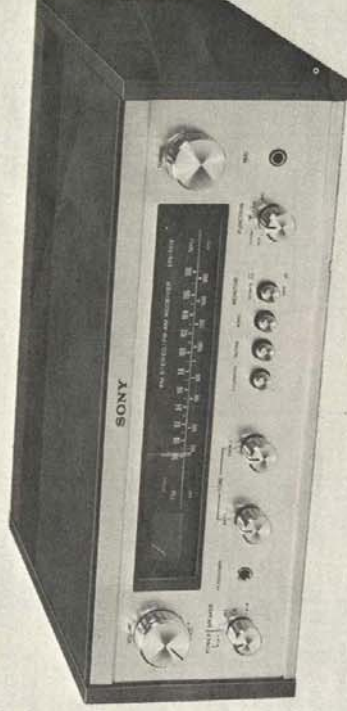

FM STEREO / FM-AM RECEIVER

SPECIFICATIONS

FM SECTION

Tuning Range: 87.5 — 108 MHz
Intermediate Frequency: 10.7 MHz
Antenna Terminals: 300 Ω , balanced
75 Ω , unbalanced
Sensitivity: 2.2 μ V, IHF
1.7 μ V, S/N = 26 dB (1 kHz, 40 kHz deviation)
(UK, AEP Model)
S/N = 30 dB (USA, Canada Model)

Image Rejection: 55 dB
IF Rejection: 90 dB
Spurious Rejection: 78 dB
AM Suppression: 55 dB
Capture Ratio: 3 dB
Selectivity: 60 dB, IHF
S/N Ratio: 68 dB

Frequency Response: 30 — 15,000 Hz \pm 0 dB
Harmonic Distortion: Mono: 0.3% Stereo 0.8%
at 400 Hz, 100% modulation (75 kHz deviation)

Stereo Separation: 35 dB at 400 Hz

AM SECTION

Tuning Range: 530 — 1,605 kHz
Intermediate Frequency: 455 kHz (USA Model)
468 kHz (Canada, UK, AEP Model)
Antenna: Built-in ferrite-rod antenna and external antenna terminal
Sensitivity: 48 dB/m, built-in antenna
30 μ V, external antenna
Image Rejection: 56 dB at 1,000 kHz
IF Rejection: 40 dB at 1,000 kHz
S/N Ratio: 50 dB
Harmonic Distortion: 0.8%

— continues to page 2 —

SONY[®]
SERVICE MANUAL

AUDIO AMPLIFIER SECTION

Continuous RMS

Power Output: Less than 0.8% THD, both channels driven simultaneously

At 40–20,000 Hz

15+15W (8Ω)

At 1 kHz

16+16W (8Ω)

18+18W (4Ω)

According to DIN 45500

15+15W (8Ω)

18+18W (4Ω)

Harmonic Distortion: Less than 0.8% at rated output
Less than 0.1% at 1W output

Damping Factor: 25 at 1 kHz (8Ω)

Residual Noise: Less than 0.08 microwatt

IM Distortion: Less than 0.8% at rated output

(60 Hz: 7 kHz = 4:1)
Less than 0.1% at 1W output

Frequency response:

| | |
|-------------------------------|------------------------------------|
| PHONO | RIAA equalization curve ± 2 dB |
| MIC | 30–10,000 Hz $+0_{-3}$ dB |
| AUX TAPE REC/PB (input) | 30–40,000 Hz $+0_{-3}$ dB |

Output Voltage and Impedance:

| | Voltage | Impedance | Input level |
|-----------------|---------|-----------|--|
| REC OUT | 250 mV | 10 kΩ | PHONO 2.5 mV MIC 2 mV |
| REC/PB (output) | 30 mV | 82 kΩ | AUX } TAPE } 250 mV REC/PB (input) } |

HEADPHONES: Accepts 8Ω–10 kΩ headphones.

SPEAKER: Accepts 4–16 Ω speakers.

Tone controls: BASS \pm dB at 100 Hz

TREBLE \pm dB at 10 kHz

Loudness

controls:

+8 dB at 50 Hz, +4 dB at 10 kHz

(Attenuation: 30 dB)

GENERAL

Power Requirements: 120 V AC, 60 Hz (USA, Canada Model)

110, 127, 220 or 240 V AC, 50/60 Hz

(UK, AEP Model)

Power Consumption: 85 W (USA Model)

110 W (Canada Model)

160 W (UK, AEP Model)

Ac Outlets: 2 unswitched, total 300 W (USA, Canada Model)

Dimensions:

Approx.

427(w) x 149(h) x 340(d) mm

16 $\frac{7}{8}$ (w) x 57 $\frac{3}{8}$ (h) x 13 $\frac{3}{8}$ (d) inches } (USA, Canada Model)

427(w) x 149(h) x 345(d) mm } (UK, AEP Model)

16 $\frac{7}{8}$ (w) x 57 $\frac{3}{8}$ (h) x 13 $\frac{3}{8}$ (d) inches } Model)

including projecting parts and controls

Weight:

Approx. 7.4 kg. 16 lb 5 oz (net)

Approx. 9.7 kg. 21 lb 6 oz (with

shipping carton)

Input Sensitivity, Impedance and S/N Ratio:

| | Sensitivity | Impedance | S/N | Weighting Network |
|------------------------|-------------|-----------|-------|-------------------|
| PHONO | 2.5 mV | 47 kΩ | 60 dB | B |
| MIC | 2 mV | 47 kΩ | 60 dB | B |
| AUX | 250 mV | 100 kΩ | 70 dB | A |
| TAPE REC/PB (input) | 250 mV | 100 kΩ | 80 dB | A |

Note: Measured with rated output power into 8 Ω loads (both channels driven simultaneously) at 1 kHz.

Applicable Serial No.

USA Model Serial No. 802,001 and later

Canada Model Serial No. 700,001 and later

UK Model Serial No. 600,001 and later

AEP Model Serial No. 500,001 and later

SECTION 1 OUTLINE

1-1. BLOCK DIAGRAM

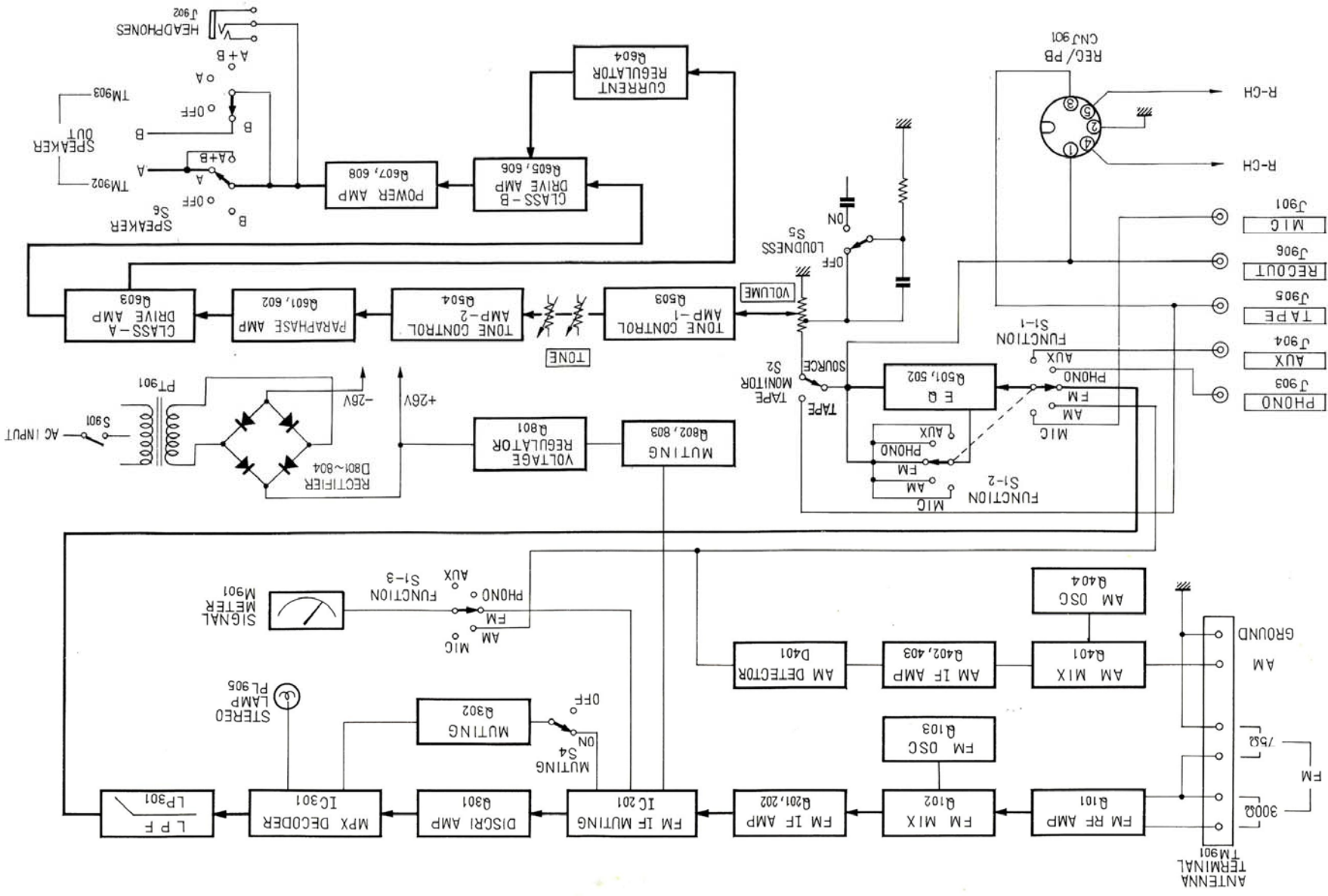

1-2. EXTERNAL VIEW

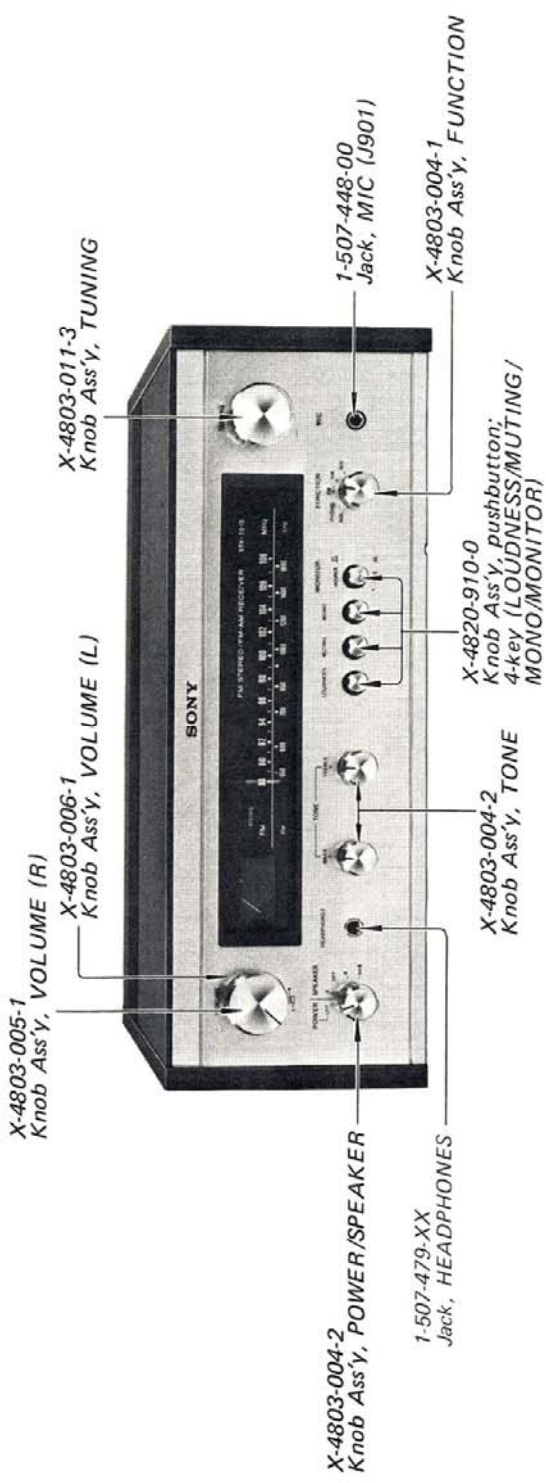

1-3. DIAL CORD STRINGING

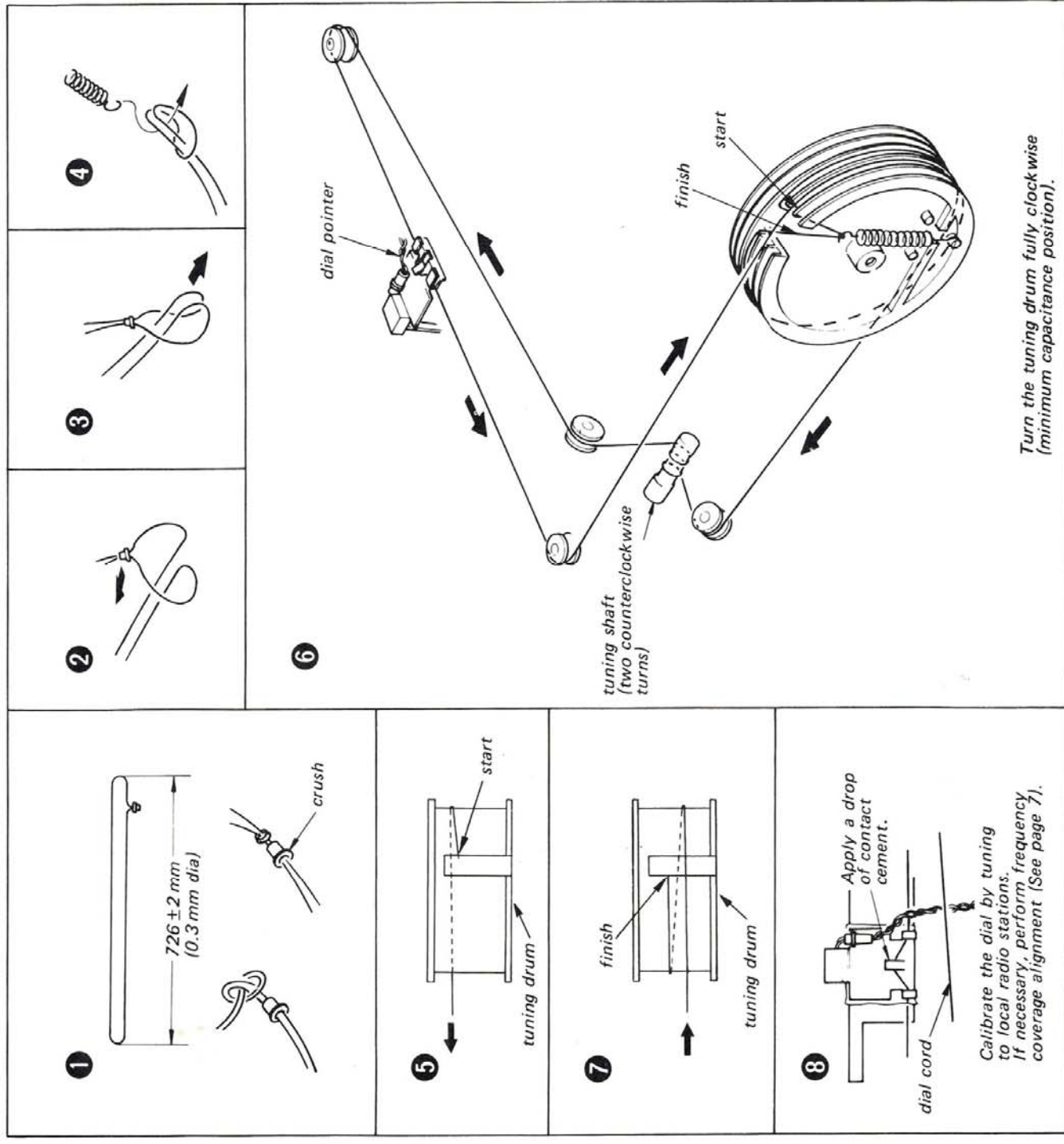

SECTION 2 ALIGNMENTS AND ADJUSTMENTS

2-1. DC BIAS ADJUSTMENT

Note: Allow about five minutes for warming up the set.

Procedure:

1. Turn on the POWER switch, and increase the ac line voltage up to the rated value by using a variable transformer.
2. Adjust RT601(L) and RT651(R) for 40 mV reading on the meter with no signal input.

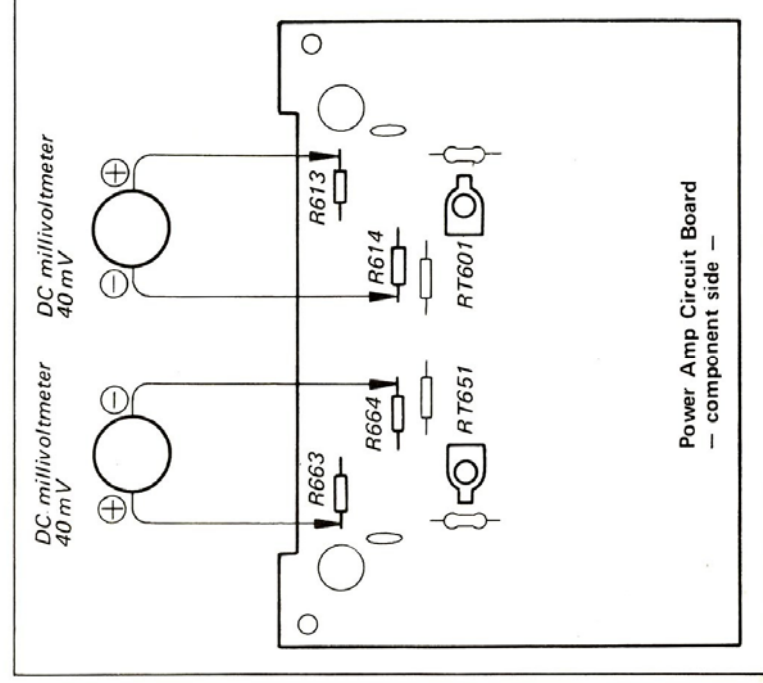

2-2. FM IF AND DISCRIMINATOR ALIGNMENTS (See p.7 for the procedure.)

FM I-F CERAMIC FILTERS

The ceramic filters used in the fm i-f circuit are color coded according to their specified center frequencies.

| Part No. | Specified Center Freq. | Color |
|--------------|------------------------|--------|
| 1-527-220-11 | 10.70 MHz | red |
| 1-527-220-21 | 10.67 MHz | blue |
| 1-527-220-31 | 10.73 MHz | orange |
| 1-527-220-41 | 10.64 MHz | black |
| 1-527-220-51 | 10.76 MHz | white |



Setup:

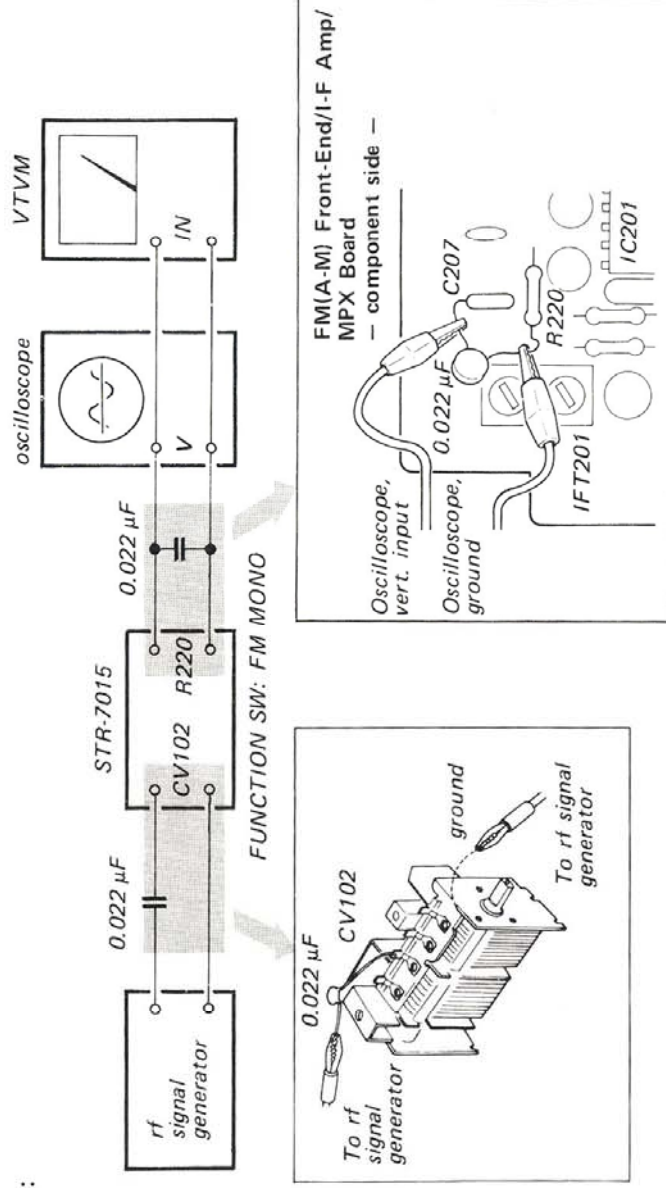

2-3. FM FREQUENCY COVERAGE AND TRACKING ALIGNMENTS (See p.7 for the procedure.)

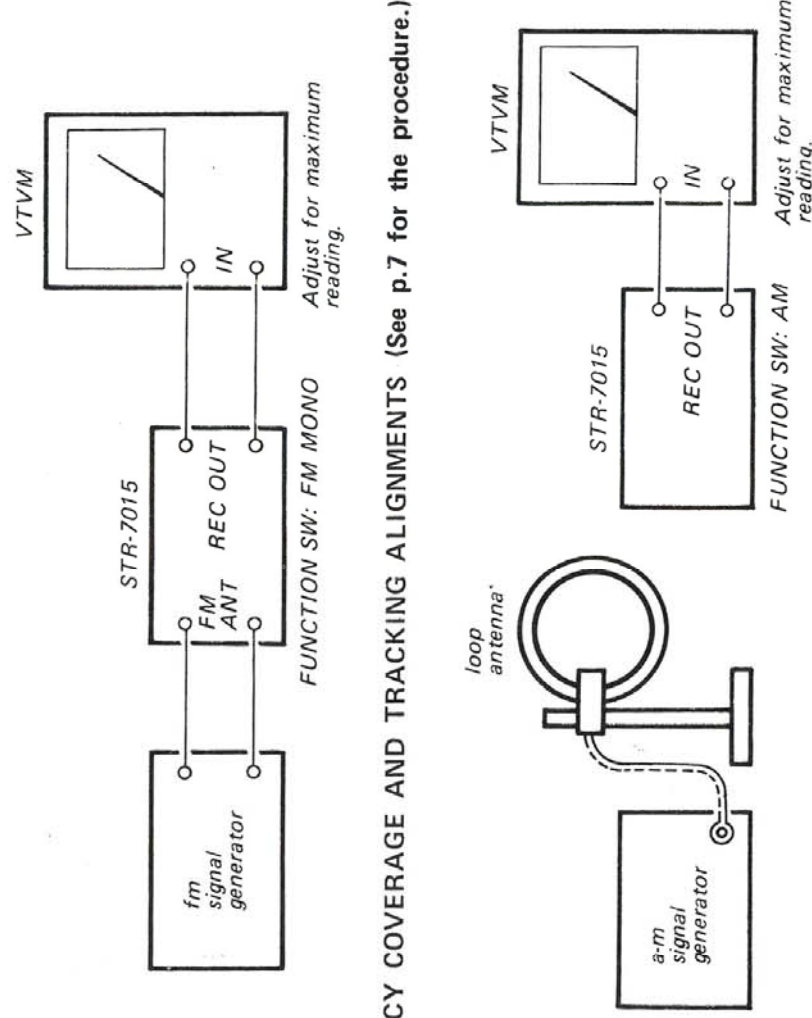

Setup:

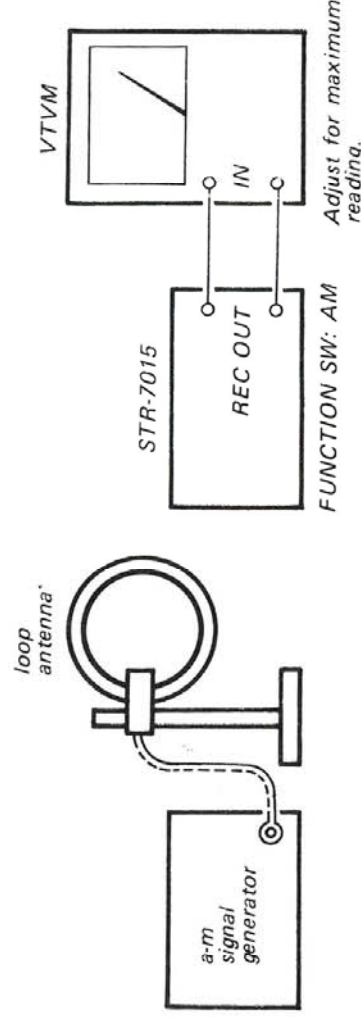

2-4. AM FREQUENCY COVERAGE AND TRACKING ALIGNMENTS (See p.7 for the procedure.)

Setup:



| FM IF AND DISCRIMINATOR | | |
|-------------------------|---|--|
| Step | Signal Generator Setting: Frequency = (center freq. of ceramic filter) Modulation | Procedure |
| 1 | FM 400 Hz 75 kHz deviation (100 %) | Tune STR-7015 to SG signal. |
| 2 | AM 400 Hz 30 % | Oscilloscope  <i>Adjust</i>  |
| 3 | FM 400 Hz 75 kHz deviation (100 %) | Adjust for maximum reading on VTVM. |

| FM FREQUENCY COVERAGE |
|--|
| 108.4 MHz (※ 108.0 MHz) (modulated) |
| 87.5 MHz (modulated) |

Note: ※ West Germany Model only.

| FM TRACKING ALIGNMENT |
|--|
| 87.5 MHz (modulated) |
| 108.4 MHz (※ 108.0 MHz) (modulated) |

Note: ※ West Germany Model only.

| AM TRACKING |
|-----------------------|
| 1,400 kHz (modulated) |
| 600 kHz (modulated) |

| AM FREQUENCY COVERAGE | DIAL INDICATION |
|-----------------------|-----------------|
| 550 kHz (modulated) | 550 kHz |
| 1,600 kHz (modulated) | 1600 kHz |

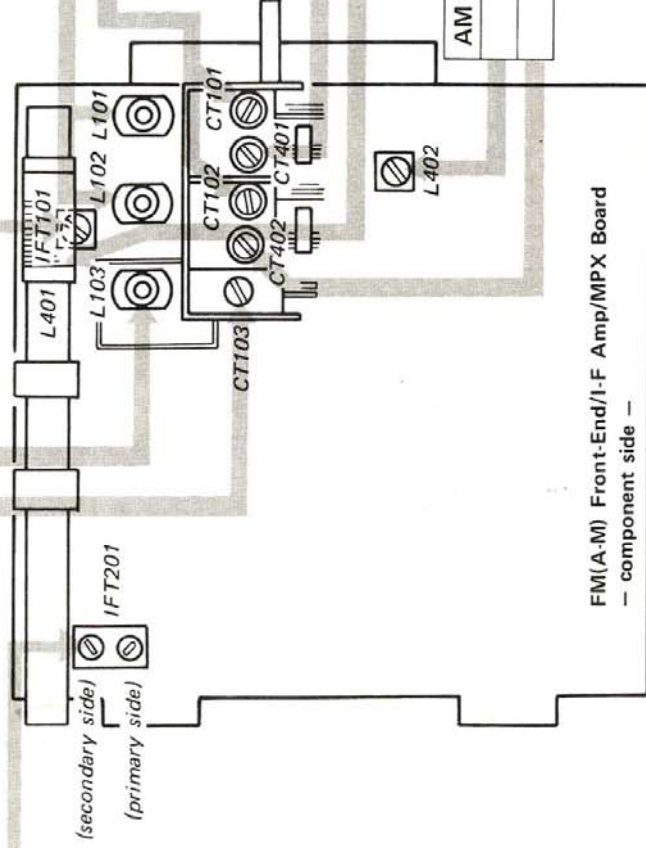

2-5. A-M I-F ALIGNMENT

Note: No alignment is necessary.
The alignment is done already in Factory.

2-6. SIGNAL METER CALIBRATION

Setup:

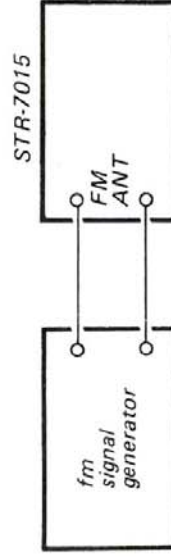

FM Signal Generator Setting:

Carrier frequency: 98 MHz
Modulation: 400 Hz, 75 kHz deviation (100%)
Output level: 70 dB

Procedure:

1. Precisely tune the receiver to 98 MHz.
2. Adjust **RT201** for the specified position on the SIGNAL meter.

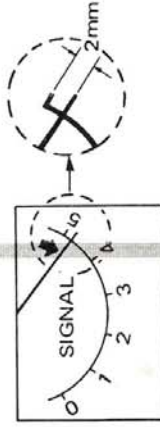

2-7. 19kHz ADJUSTMENT

Setup:

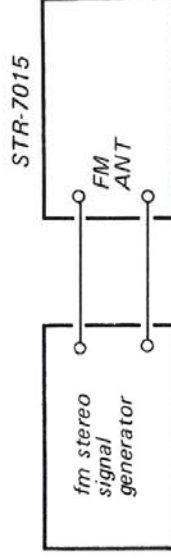

FM Stereo Signal Generator Setting:

Carrier frequency: 98 MHz
Modulation: 400 Hz, 75 kHz deviation (100%)
Output level: 70 dB

Procedure:

1. Tune the receiver to 98 MHz.
2. Adjust **RT301** for 19 kHz ± 30 Hz on the counter.

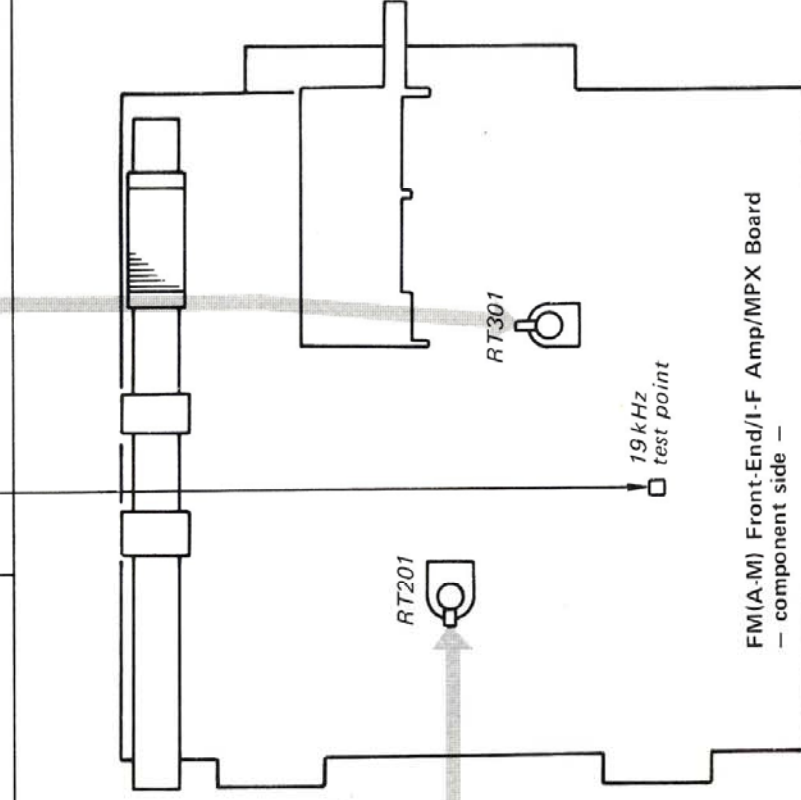
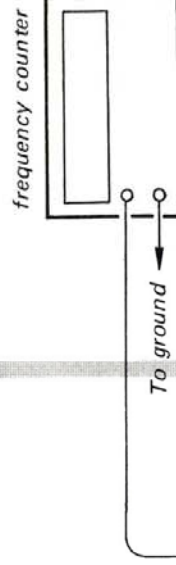

MEMO

A series of horizontal dotted lines for writing, consisting of 25 lines.

SECTION 4 DIAGRAMS

4-1. MOUNTING DIAGRAM — AC/Speaker Board —
— Conductor Side —

- USA Model Serial No. 802,001 and later
- Canada Model Serial No. 700,001 and later
- UK Model Serial No. 600,001 and later
- AEP Model Serial No. 500,001 and later

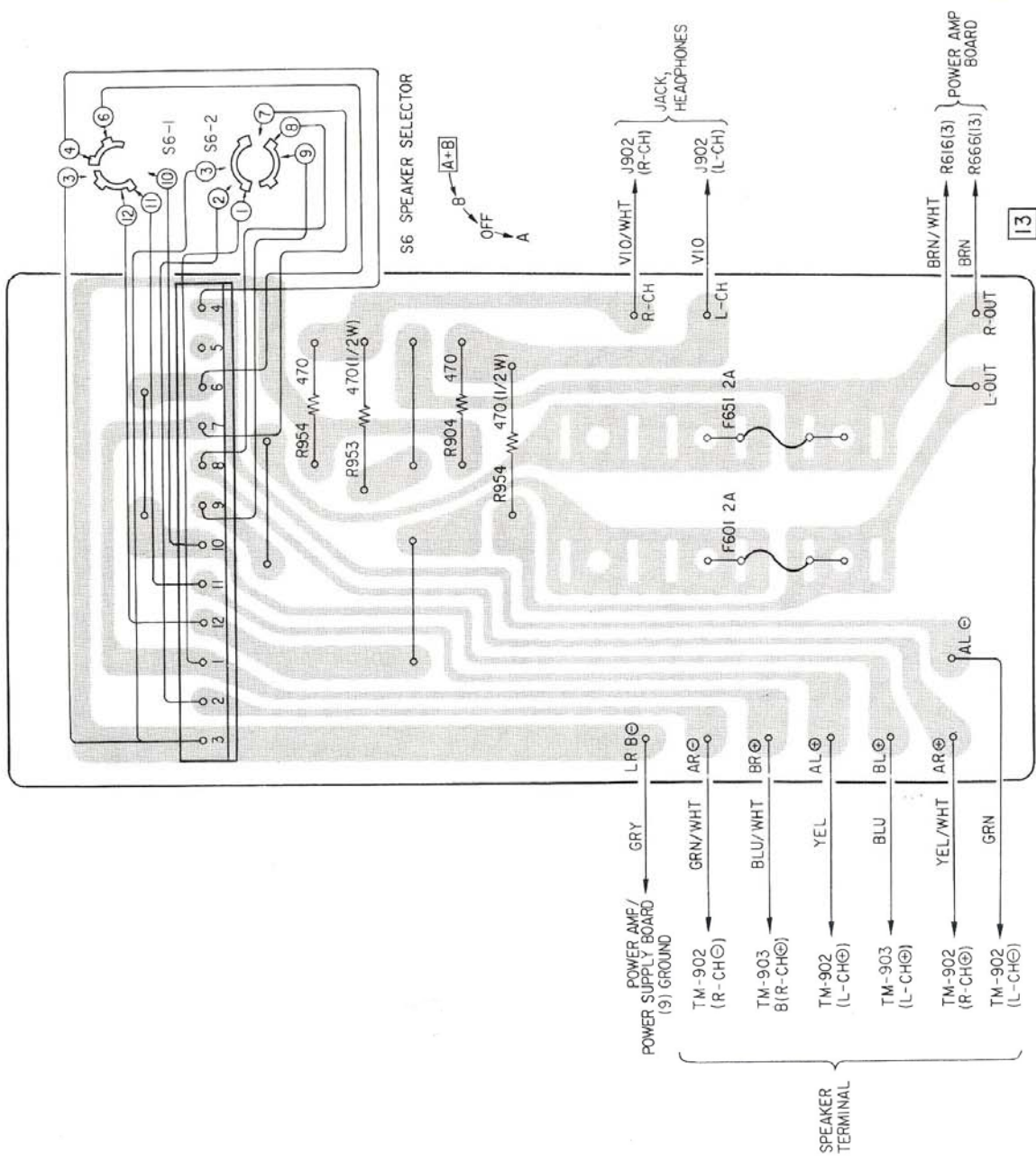

4-2. MOUNTING DIAGRAM - Fm (A-m) Front-End/I-f Amp/MPX Board -

- Conductor Side -

USA Model Serial No. 802,001 and later
 Canada Model Serial No. 700,001 and later
 UK Model Serial No. 600,001 and later
 AEP Model Serial No. 500,001 and later

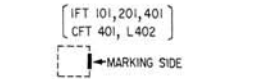
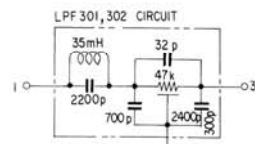
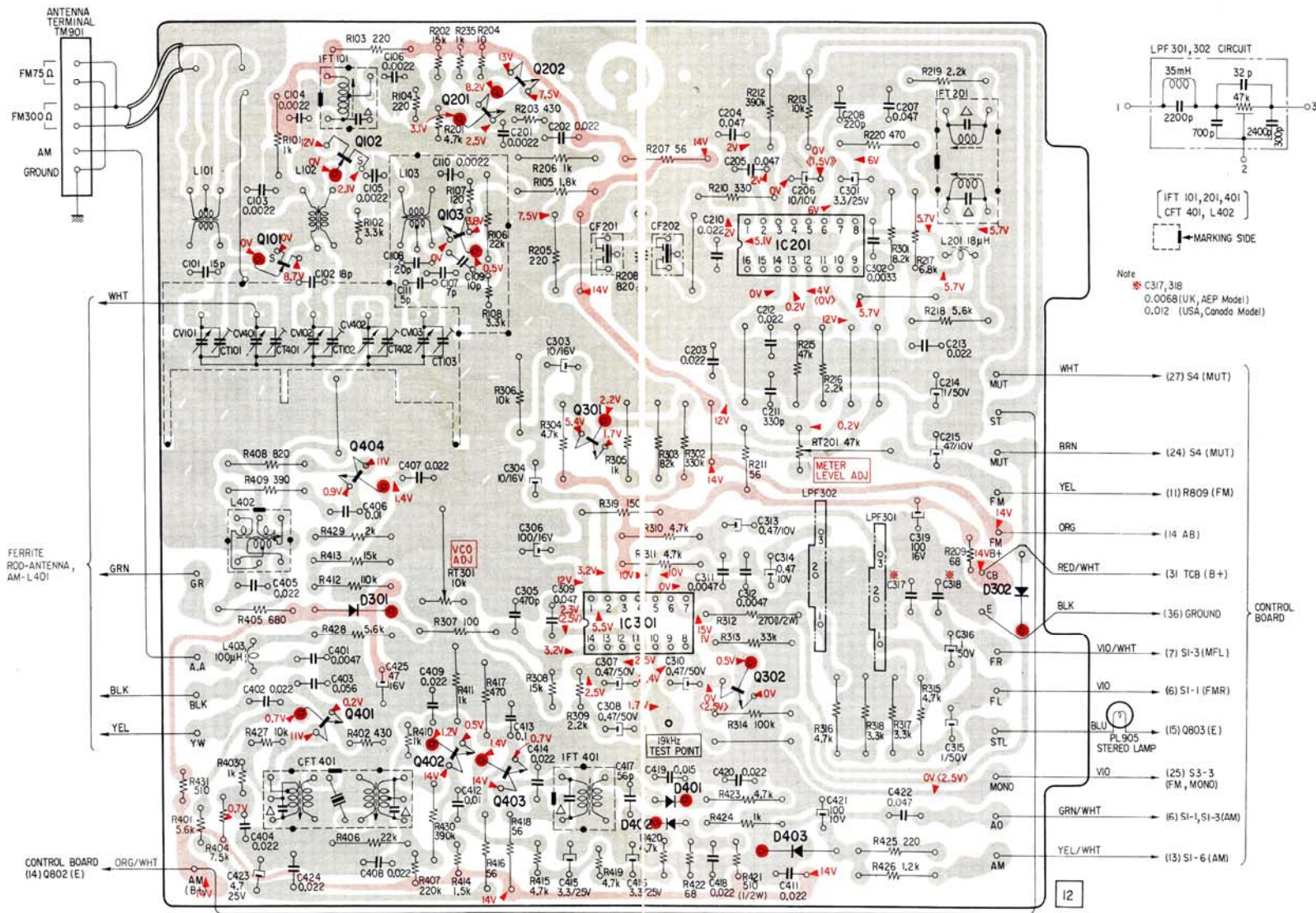

Note
 * C317, 318
 0.0068 (UK, AEP Model)
 0.012 (USA, Canada Model)

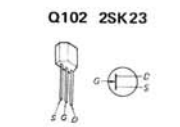
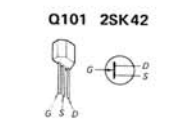

Q201, 202 2SC403C
 Q301 2SC631A
 Q302, 401 2SC633A

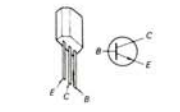

Q103, 402
 Q403, 404 2SC710

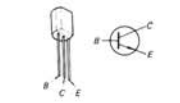

D301, 302 1S1555
 D401, 402 1T22A
 D403 1T40

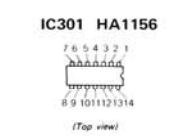
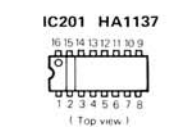
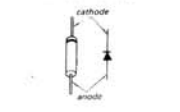

Note: < > : STEREO operation
 ▲ ▼ : MUTING ON
 [] : B+ pattern

| | | | | | | | |
|----|-----|-----|-----|-----|-----|-------|-----|
| Q | 101 | 102 | 201 | 202 | | | |
| IC | | 404 | 103 | | 301 | IC201 | |
| | | 401 | 402 | 403 | | 302 | |
| D | | 301 | | | 401 | 403 | 302 |
| | | | | | 402 | | |

4-3. MOUNTING DIAGRAM – Power Amp/Power Supply Board –

– Conductor Side –

USA Model Serial No. 802,001 and later
 Canada Model Serial No. 700,001 and later
 UK Model Serial No. 600,001 and later
 AEP Model Serial No. 500,001 and later

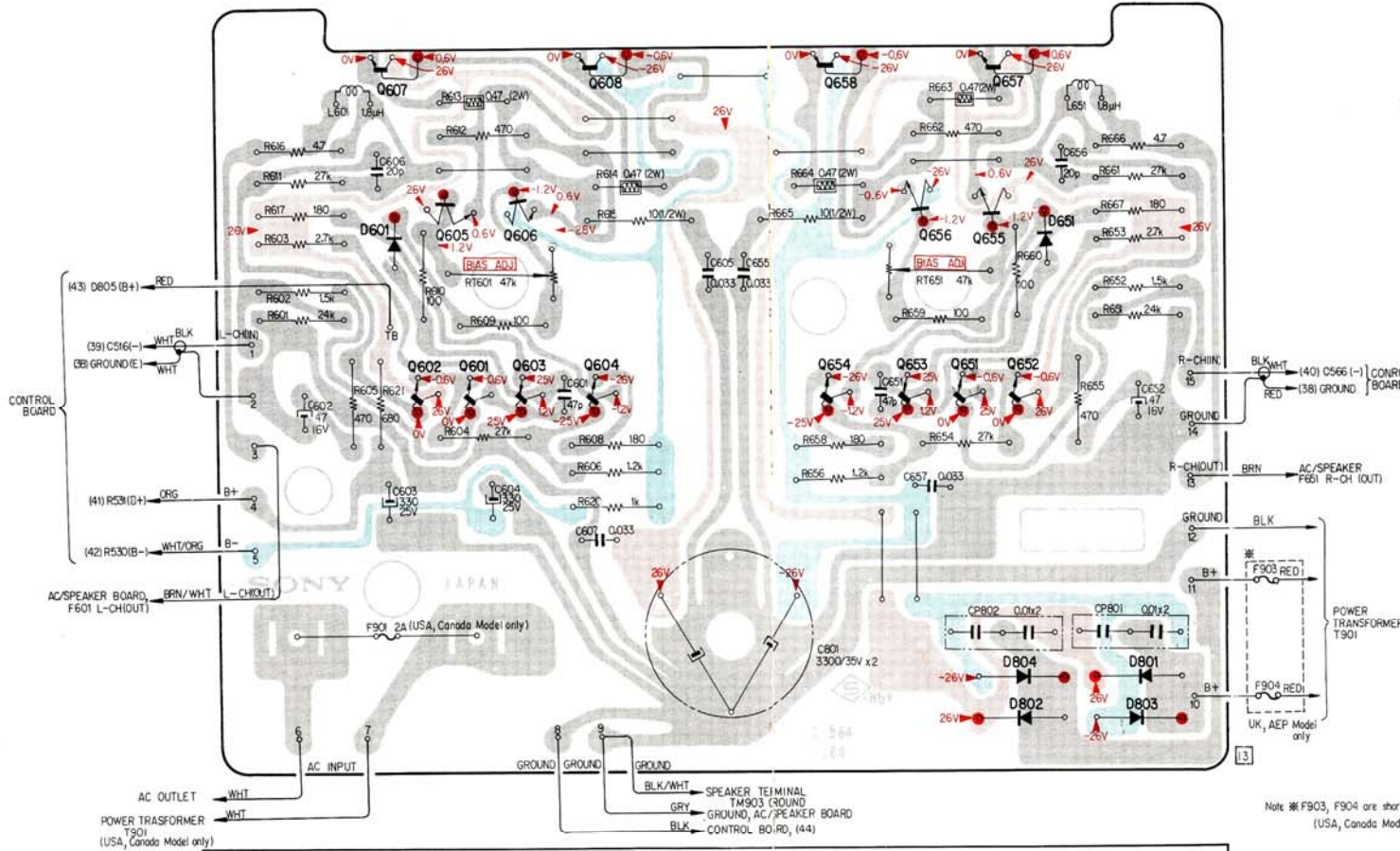

- | | | |
|---------------------------------|----------------------------------|---|
| Q601, 602 Q604 | 2SC632A 2SC634A | Q606 2SA706 |
| | | |
| Q603 2SA705 | | Q60E 2SA671 |
| | | |
| Q605 2SC1124 | | D601, 651 SV-04F |
| | | |
| Q607 2SC1061 | | D801, 802 D803, 804 10E-2 |
| | | |

Note * F903, F904 are short-circuited (USA, Canada Model only)

Note: : B+ pattern
 : B- pattern

| | | | | | | | | | | | | | |
|---|-----|-----|-----|-----|-----|-----|-----|-----|-----|-----|-----|-----|-----|
| Q | 607 | 605 | 601 | 606 | 603 | 604 | 658 | 656 | 651 | 655 | 652 | | |
| D | | 601 | | | | | | | | 804 | 651 | 801 | 803 |

4-4. MOUNTING DIAGRAM - Control Board -

- Conductor Side -

USA Model Serial No. 802,001 and later
 Canada Model Serial No. 700,001 and later
 UK Model Serial No. 600,001 and later
 AEP Model Serial No. 500,001 and later

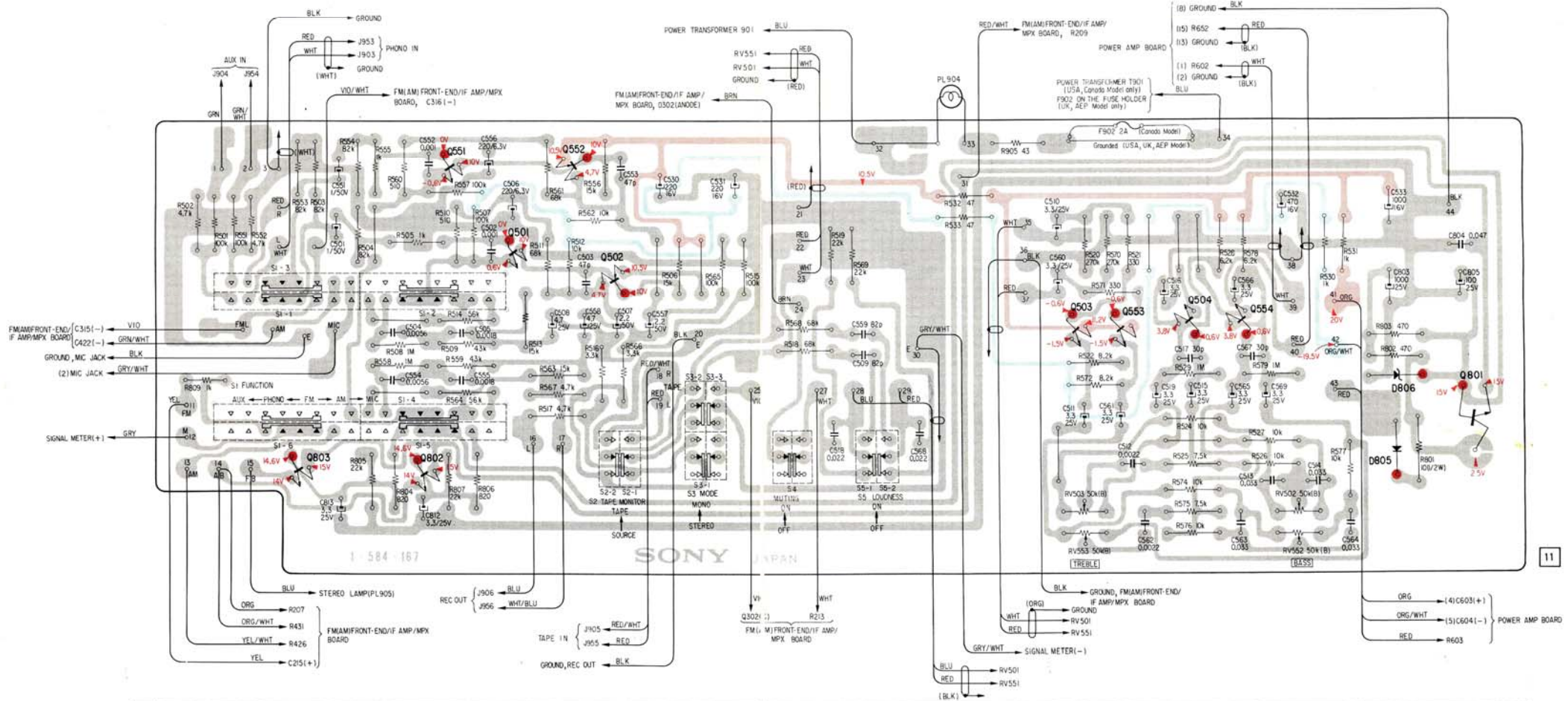

| | | | | | | | | | | | | |
|---|-----|-----|-----|-----|-----|--|-----|-----|-----|-----|--|------------|
| Q | | 551 | 501 | 552 | 502 | | 503 | 553 | 504 | 554 | | 801 |
| D | 803 | 802 | | | | | | | | | | 806 805 |

Q501, 551 } 2SC631A
 Q504, 554 }
 Q503, 553 } 2SC634A

Q502, 552 2SA705

Q801 2SC1060

Q802, 803 2 C1364

D806 EQA-01-16

D805 10E-2

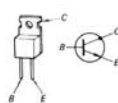

Note: — : B+ pattern
— : B- pattern

4-5. SCHEMATIC DIAGRAM

USA Model Serial No. 802,001 and later
 Canada Model Serial No. 700,001 and later
 UK Model Serial No. 600,001 and later
 AEP Model Serial No. 500,001 and later

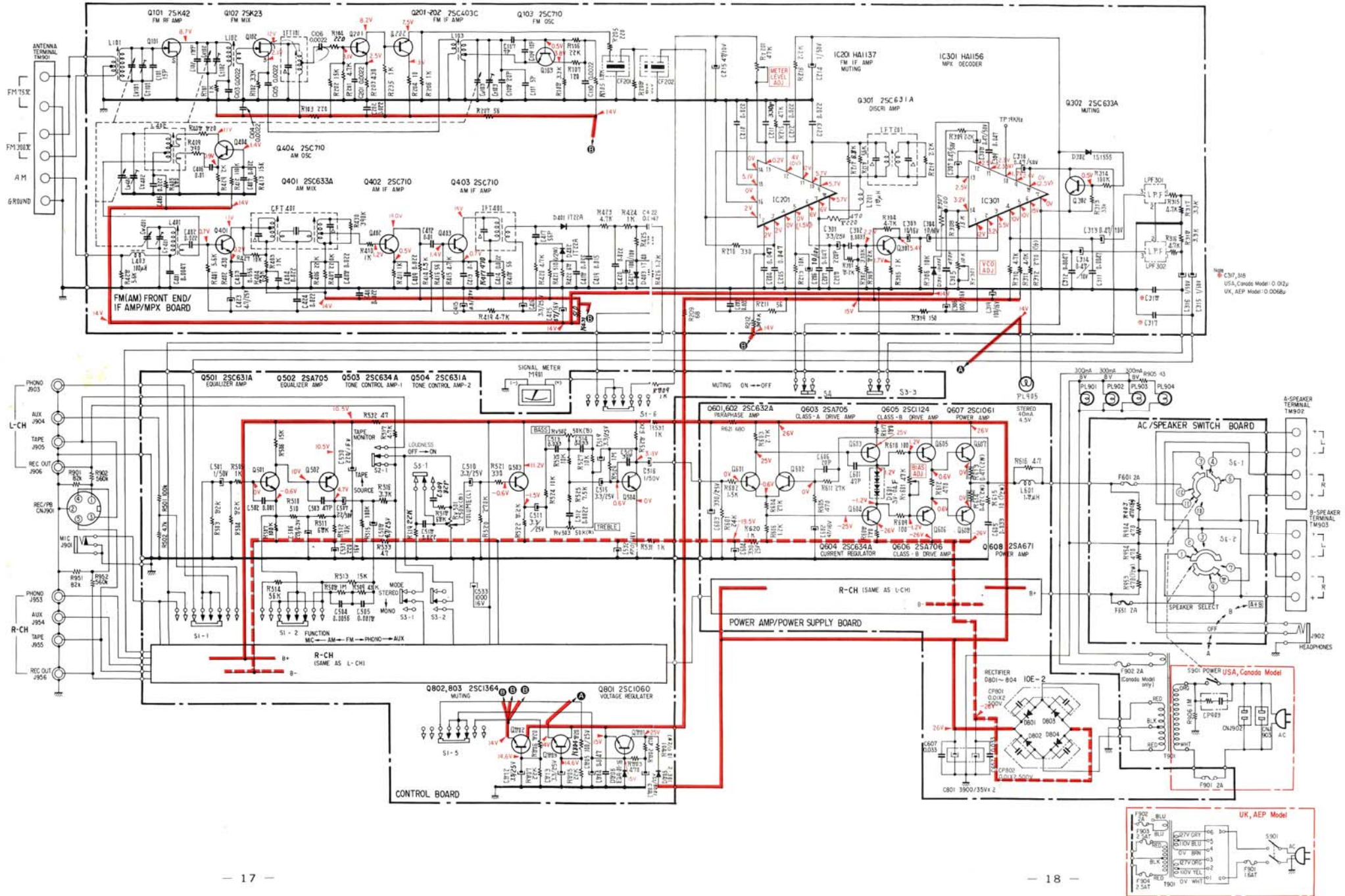

NS C37, 318
 USA, Canada Model: 0 012
 UK, AEP Model: 0 0066

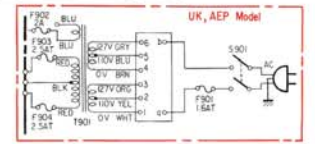

Note:

- All capacitors are in μF unless otherwise noted. 50 or less working volts are omitted except for electrolytic type.
p = $\mu\mu\text{F}$
- All resistors are in Ω , $\frac{1}{2}\text{W}$, unless otherwise noted.
k = 1,000 M = 1,000 k
- Voltages are DC with respect to ground unless otherwise noted. Readings taken under no-signal conditions with a VOM (20k Ω /V).
- Voltage variations may be noted due to normal production tolerances.

◀ : STEREO operation

▶ : MUTING ON

■ : indicates B + line

■ : indicates B - line

● **Switch Mode:**

| Ref. No. | Switch | Position |
|----------|----------|----------|
| S1 | FUNCTION | FM |
| S2 | MONITOR | SOURCE |
| S3 | MODE | STEREO |
| S4 | MUTING | OFF |
| S5 | LOUDNESS | OFF |
| S6 | SPEAKER | A + B |
| S7 | POWER | OFF |

SECTION 6 ELECTRICAL PARTS LIST

| <u>Ref. No.</u> | <u>Part No.</u> | <u>Description</u> | <u>Ref. No.</u> | <u>Part No.</u> | <u>Description</u> |
|--|--|---|-----------------|-----------------|-------------------------------|
| COMPLETE CIRCUIT BOARDS | | | | | |
| A-4351-039-A | Fm (A-m) Front-End/I-f Amp/MPX (USA, Canada Model) | C103~106 C107 | 1-102-257-11 | 0.0022 | ceramic |
| A-4351-040-A | Fm (A-m) Front-End/I-f Amp/MPX (UK, AEP Model) | C108 | 1-102-804-11 | 20 p | ceramic |
| A-4375-042-A | Control (USA, UK, AEP Model) | C109 | 1-101-978-11 | 10 p | ceramic |
| A-4375-043-A | Control (Canada Model) | C110 | 1-102-257-11 | 0.0022 | ceramic |
| A-4388-057-A | Power Amp/Power Supply (USA, Canada Model) | C111 | 1-102-872-11 | 5 p | ceramic |
| A-4388-058-A | Power Amp/Power Supply (UK, AEP Model) | C201 | 1-102-257-11 | 0.0022 | ceramic |
| A-4474-020-A | AC/Speaker | C202,203 | 1-101-924-11 | 0.022 | ceramic |
| X-4826-421-A | Connector, REC/PB | C204,205 | 1-101-925-11 | 0.047 | ceramic |
| | | C206 | 1-121-469-11 | 10 | 10 V elect |
| | | C207 | 1-105-681-12 | 0.047 | mylar |
| | | C208 | 1-102-978-11 | 220 p | ceramic |
| | | C210 | 1-101-924-11 | 0.022 | ceramic |
| | | C211 | 1-102-820-11 | 330 p | ceramic |
| | | C212,213 | 1-101-924-11 | 0.022 | ceramic |
| | | C214 | 1-121-391-11 | 1 | 50 V elect |
| | | C215 | 1-121-352-11 | 47 | 10 V elect |
| | | C301 | 1-121-392-11 | 3.3 | 25 V elect |
| | | C302 | 1-105-667-12 | 0.0033 | mylar |
| | | C303,304 | 1-121-651-11 | 10 | 16 V elect |
| | | C305 | 1-103-717-11 | 470 p | styrol |
| | | C306 | 1-121-415-11 | 100 | 16 V elect |
| | | C307,308 | 1-121-726-11 | 0.47 | 50 V elect |
| | | C309 | 1-105-681-12 | 0.047 | mylar |
| | | C310 | 1-121-726-11 | 0.47 | 50 V elect |
| | | C311,312 | 1-105-669-12 | 0.0047 | mylar |
| | | C313,314 | 1-127-022-11 | 0.47 | 10 V solid aluminum |
| | | C315,316 | 1-121-391-11 | 1 | 50 V elect |
| | | | 1-105-514-12 | 0.012 | mylar |
| | | C317,318 | 1-105-671-12 | 0.0068 | (USA, Canada Model) mylar |
| | | C319 | 1-121-415-11 | 100 | (UK, AEP Model) 16 V elect |
| | | C401 | 1-105-669-12 | 0.0047 | mylar |
| | | C402 | 1-101-924-11 | 0.022 | ceramic |
| | | C403 | 1-105-682-12 | 0.056 | ceramic |
| | | C404 | 1-101-924-11 | 0.022 | ceramic |
| | | C405 | 1-105-677-12 | 0.022 | mylar |
| | | C406 | 1-105-673-12 | 0.01 | mylar |
| | | C407 | 1-105-677-12 | 0.022 | mylar |
| TRANSFORMERS, COILS AND INDUCTORS | | | | | |
| IFT101 | 1-403-914-00 | IFT, 10.7 MHz | | | |
| IFT201 | 1-404-011-00 | Transformer, discriminator | | | |
| IFT401 | 1-403-149-00 | IFT, 455 kHz | | | |
| | 1-403-150-00 | I-f Trans./Ceramic Filter (USA, Canada Model) | | | |
| CFT401 | 1-403-830-00 | I-f Trans./Ceramic Filter (UK, AEP Model) | | | |
| L101 | 1-401-541-00 | Coil, fm antenna | | | |
| L102 | 1-405-599-00 | Coil, fm rf | | | |
| L103 | 1-405-598-00 | Coil, fm osc | | | |
| L201 | 1-407-160-XX | Microinductor 18 μ H | | | |
| L401 | 1-401-425-41 | Ferrite rod antenna, a-m | | | |
| L402 | 1-405-444-00 | Coil, a-m osc | | | |
| L403 | 1-407-169-XX | Microinductor 100 μ H | | | |
| L601,651 | 1-407-592-51 | Microinductor 1.8 μ H | | | |
| | 1-442-478-00 | Transformer, power (AEP Model) | | | |
| | 1-442-479-00 | Transformer, power (Canada Model) | | | |
| T901 | 1-442-480-00 | Transformer, power (USA Model) | | | |
| | 1-442-482-00 | Transformer, power (UK Model) | | | |
| CAPACITORS | | | | | |
| C101 | 1-102-951-11 | 15 p | | | ceramic |
| C102 | 1-102-953-11 | 18 p | | | ceramic |

All capacitors are in μ F unless otherwise indicated.
50 or less working volts are omitted except for electrolytic type. (elect = electrolytic, p = μ F)

| <u>Ref. No.</u> | <u>Part No.</u> | <u>Description</u> | <u>Ref. No.</u> | <u>Part No.</u> | <u>Description</u> |
|-----------------|-----------------|--------------------|-----------------|-----------------|----------------------------|
| C408,409 | 1-101-924-11 | 0.022 ceramic | C605,655 | 1-105-679-12 | 0.033 mylar |
| C411 | 1-101-924-11 | 0.022 ceramic | C606,656 | 1-102-958-11 | 20p ceramic |
| C412 | 1-101-923-11 | 0.01 ceramic | C607,657 | 1-105-679-12 | 0.033 mylar |
| C413 | 1-105-685-12 | 0.1 mylar | | | |
| C414 | 1-101-924-11 | 0.022 ceramic | C801 | 1-125-095-11 | (3900 + 3900) 35 V elect |
| | | | C802 | | |
| C415,416 | 1-121-392-11 | 3.3 25 V elect | C803 | 1-123-066-11 | 1000 25 V elect |
| C417 | 1-101-884-11 | 56p ceramic | C804 | 1-105-681-12 | 0.047 mylar |
| C418 | 1-101-924-11 | 0.022 ceramic | C805 | 1-121-935-11 | 100 25 V elect |
| C419 | 1-105-675-12 | 0.015 mylar | C812,813 | 1-121-392-11 | 3.3 25 V elect |
| C420 | 1-105-677-12 | 0.022 mylar | | | |
| C421 | 1-121-414-11 | 100 10 V elect | | | |
| C422 | 1-105-681-12 | 0.047 mylar | | | |
| C423 | 1-121-395-11 | 4.7 25 V elect | | | |
| C424 | 1-101-924-11 | 0.022 ceramic | | | |
| C425 | 1-121-409-11 | 47 16 V elect | | | |
| C501,551 | 1-121-912-11 | 1 50 V elect | R312 | 1-202-559-11 | 270 ¼ W composition |
| C502,552 | 1-105-661-12 | 0.001 mylar | R421 | 1-202-566-11 | 510 ½ W composition |
| C503,553 | 1-101-880-11 | 47p ceramic | R529,579 | 1-244-745-09 | 1 M ¼ W low-noise |
| C504,554 | 1-105-670-12 | 0.0056 mylar | R530,531 | 1-211-935-11 | 1 k ¼ W nonflammable |
| C505,555 | 1-105-664-12 | 0.0018 mylar | R532,533 | 1-211-514-11 | 47 ¼ W nonflammable |
| C506,556 | 1-121-419-11 | 220 6.3 V elect | R608,658 | 1-211-528-11 | 180 ¼ W nonflammable |
| C507,557 | 1-123-050-11 | 2.2 50 V elect | R613,663 | | |
| C508,558 | 1-121-395-11 | 4.7 25 V elect | R614,664 | 1-217-153-11 | 0.47 2 W nonflammable |
| C509,559 | 1-102-971-11 | 82p ceramic | R615,665 | 1-202-525-11 | 10 ½ W composition |
| C510,560 | | | R617,667 | 1-211-528-11 | 180 ¼ W nonflammable |
| C511,561 | 1-121-913-11 | 3.3 25 V elect | R620 | 1-211-935-11 | 1 k ¼ W nonflammable |
| | | | R621 | 1-211-542-11 | 680 ¼ W nonflammable |
| C512,562 | 1-105-665-12 | 0.0022 mylar | R801 | 1-211-590-11 | 10 ½ W nonflammable |
| C513,563 | 1-105-679-12 | 0.033 mylar | R802,803 | 1-211-538-11 | 470 ¼ W nonflammable |
| C514,564 | | | R903,953 | 1-202-565-11 | 470 ½ W composition |
| C515,565 | 1-121-913-11 | 3.3 25 V elect | R906 | 1-202-719-11 | 1 M ½ W composition |
| C516,566 | 1-121-912-11 | 1 50 V elect | | | (USA, Canada Model only) |
| C517,567 | 1-102-962-11 | 30p ceramic | RT201 | 1-222-765-00 | 47k adjustable |
| C518,568 | 1-105-677-12 | 0.022 mylar | RT301 | 1-222-752-00 | 10k adjustable |
| C519,569 | 1-121-913-11 | 3.3 25 V elect | RT601,651 | 1-222-765-00 | 47k adjustable |
| C530,531 | 1-121-421-11 | 220 16 V elect | RV501 | 1-224-674-00 | 250k (B) variable (VOLUME) |
| C532 | 1-121-426-11 | 470 16 V elect | | | |
| C533 | 1-121-245-11 | 1000 16 V elect | RV502,552 | | |
| | | | RV503,553 | 1-222-544-00 | 50k (B) variable (TONE) |
| C601,651 | 1-101-880-11 | 47p ceramic | | | |
| C602,652 | 1-121-409-11 | 47 16 V elect | | | |
| C603,604 | 1-121-654-11 | 330 25 V elect | | | |

RESISTORS

All resistors are in Ω , ¼ W, $\pm 5\%$ carbon resistors (except special type) are omitted. Check schematic diagram for the resistance values. k = 1000, M = 1000 k

| <u>Ref. No.</u> | <u>Part No.</u> | <u>Description</u> |
|----------------------|-----------------|--|
| SWITCHES | | |
| S1 | 1-516-676-00 | Rotary/Slide (FUNCTION) |
| S2~5 | 1-516-794-00 | 4-key (MONITOR, MONO, MUTING, LOUDNESS) |
| S6 | 1-516-793-00 | Rotary (SPEAKER)/POWER (USA Model) |
| S901 | 1-516-795-00 | Rotary (SPEAKER)/POWER (Canada, UK, AEP Model) |
| LAMPS | | |
| PL901 | 1-518-237-00 | Meter, 8 V 300 mA |
| PL902,903 | 1-518-070-XX | Dial, 8 V 300 mA |
| PL904 | 1-518-230-00 | Pointer, dial |
| PL905 | 1-518-169-XX | Stereo, 4.5 V 40 mA |
| MISCELLANEOUS | | |
| 1-508-690-00 | | Plug, voltage selector (UK, AEP Model) |
| 1-509-546-00 | | Connector, ac input; 3-p (UK, AEP Model) |
| CNJ901 | 1-509-551-00 | Connector, REC/PB |
| CNJ902,903 | 1-526-528-00 | Outlet, AC (USA, Canada Model) |
| CP801,802 | 1-102-355-11 | Capacitor, ceramic 0.01 μ 500 V |
| CP903 | 1-231-057-31 | Encapsulated Component (USA, Canada Model) |
| CT101,401 | 1-151-263-00 | Capacitor, tuning |
| CT102,402 | | |
| CT103 | | |
| CV101,401 | | |
| CV102,402 | | |
| CV103 | | |
| CF201,202 | 1-527-220-00 | Filter, ceramic; fm i-f |
| F601,602 | 1-532-455-XX | Fuse, 2 A |
| F901 | { 1-532-363-XX | Fuse, 2 A (USA, Canada Model) |
| | { 1-532-259-00 | Fuse, 1.6 AT (UK, AEP Model) |
| F903,904 | 1-532-286-00 | Fuse, 2.5 AT (UK, AEP Model) |
| F902 | { 1-532-268-00 | Fuse, 2 A (Canada Model) |
| | { 1-532-203-00 | Fuse, 2 A (UK, AEP Model) |
| | { 1-532-204-00 | Fuse, 2 A (UK, AEP Model) |
| | { 1-532-455-XX | Fuse, 2 A (USA Model) |
| F601,651 | 1-532-298-00 | Fuse, 2 A (Canada Model) |
| | 1-533-069-XX | Holder, fuse; 4 p (UK, AEP Model) |
| | 1-534-985-XX | Cord, power (USA, Canada Model) |

| <u>Ref. No.</u> | <u>Part No.</u> | <u>Description</u> |
|-----------------|-----------------|---------------------------|
| J901 | 1-507-448-00 | Jack, MIC |
| J902 | 1-507-479-XX | Jack, HEADPHONES |
| LPF301,302 | 1-231-303-00 | Low Pass Filter |
| M901 | 1-520-130-00 | Meter, signal |
| TM901 | 1-536-469-00 | Terminal, strip (ANTENNA) |
| TM902,903 | 1-536-415-00 | Terminal, strip (APEAKER) |

HARDWARE

SCREWS

All screws are phillips type (cross recess type) unless otherwise indicated.

| | | |
|--------------|-----|-----------------------|
| 7-682-163-01 | P | 4 x 12 |
| 7-682-547-01 | B | 3 x 6 |
| 7-682-549-01 | B | 3 x 10 |
| 7-682-560-01 | B | 4 x 6 |
| 7-682-646-01 | PS | 3 x 5 |
| 7-682-948-01 | PSW | 3 x 8 |
| 7-682-949-01 | PSW | 3 x 10 |
| 7-682-951-01 | PSW | 3 x 14 |
| 7-682-961-01 | PSW | 4 x 8 |
| 7-685-533-21 | B | 2.6 x 6, self-tapping |
| 7-685-546-21 | B | 3 x 8, self-tapping |

MISCELLANEOUS

| | |
|--------------|---|
| 7-623-408-07 | Washer, lock (external tooth); 3 mm dia |
| 7-623-508-01 | Lug, 3 mm dia |
| 7-624-109-01 | Retaining Ring, 5 mm dia |
| 7-684-013-01 | Nut, 3 mm dia |

| <u>Part No.</u> | <u>Description</u> |
|--------------------|---|
| ACCESSORIES | |
| X-4490-002-0 | Cloth Ass'y, polishing |
| 1-501-083-21 | Ribbon Antenna, fm |
| 3-780-685-21 | Manual, instruction (USA Model) |
| 3-780-685-11 | Manual, instruction (Canada, UK, AEP Model) |
| 1-534-819-11 | Cord, power; 3 p (UK Model) |

Sony Corporation