

# TA-H6700

## SERVICE MANUAL

*AEP Model*  
*UK Model*

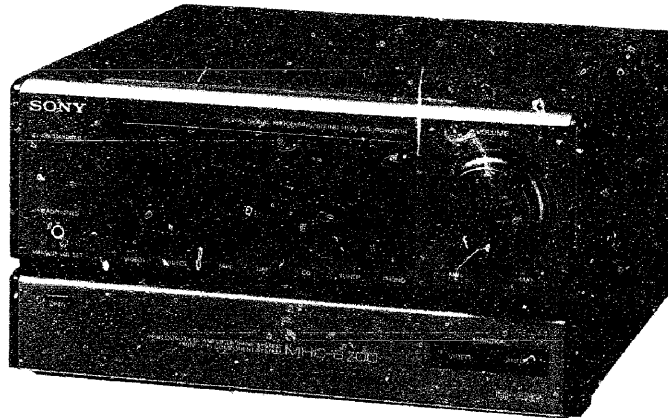

This set is the Amplifier section in MHC-6700.

### SPECIFICATIONS

#### Continuous RMS power output

For satellite speaker:  
28 + 28 watts (8 ohms at  
1 kHz, DIN)  
33 + 33 watts (8 ohms at  
1 kHz, 5% THD)  
For bass speaker:  
32 + 32 watts (6 ohms at  
110 Hz, DIN)  
37 + 37 watts (6 ohms at  
110 Hz, 5% THD)

#### Music power output

For satellite speaker:  
50 + 50 watts (8 ohms at  
1 kHz, 10% THD)  
For bass speaker:  
55 + 55 watts (6 ohms at  
110 Hz, 10% THD)

#### Outputs

HEADPHONES  
(stereo minijack):  
accepts headphones of  
8 ohms or more  
SPEAKER (SATELLITE):  
accepts speakers of  
8 to 16 ohms  
SPEAKER (BASS):  
accepts speakers of  
6 to 16 ohms

Design and specifications subject to change without notice.

#### SAFETY-RELATED COMPONENT WARNING!!

COMPONENTS IDENTIFIED BY MARK  $\triangle$  OR DOTTED LINE WITH MARK  $\triangle$  ON THE SCHEMATIC DIAGRAMS AND IN THE PARTS LIST ARE CRITICAL TO SAFE OPERATION. REPLACE THESE COMPONENTS WITH SONY PARTS WHOSE PART NUMBERS APPEAR AS SHOWN IN THIS MANUAL OR IN SUPPLEMENTS PUBLISHED BY SONY.

INTEGRATED STEREO AMPLIFIER  
**SONY**®

TABLE OF CONTENTS

MODEL IDENTIFICATION

— Model Number Label —

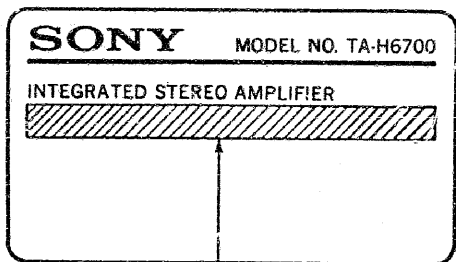

- AEP model : AC: 220—230V~50/60Hz
- Italian model : AC: 220—230V~50Hz
- Germany model: SYSTEM MHC-5700  
AC: 220—230V~50Hz
- UK model : AC: 240V~50Hz

<u>Section</u>	<u>Title</u>	<u>Page</u>
<b>1. GENERAL</b>		
1-1.	Parts Identification .....	2
<b>2. DISASSEMBLY</b>		
2-1.	Front Panel Assy .....	3
2-2.	Panel Board .....	3
2-3.	Back Panel .....	4
2-4.	Jack Board, Speaker Board .....	4
2-5.	Power Board, DSP Board .....	5
2-6.	Power Transformer .....	5
<b>3. DIAGRAMS</b>		
3-1.	Circuit Boards Location .....	6
3-2.	Semiconductor Lead Layouts .....	6
3-3.	Printed Wiring Boards — Power/Jack/Volume Section — .....	8
3-4.	Schematic Diagram — Power/Jack/Volume Section — .....	11
3-5.	Schematic Diagram — DSP Section — .....	14
3-6.	Printed Wiring Board — DSP Section — .....	17
3-7.	Printed Wiring Board — Panel Section — .....	21
3-8.	Schematic Diagram — Panel Section — .....	25
<b>4. EXPLODED VIEWS</b>		
4-1.	Front Panel Assy .....	29
4-2.	Chassis Section .....	30
<b>5. ELECTRICAL PARTS LIST</b>		31

SECTION 1  
GENERAL

This section is extracted from instruction manual.

1-1. PARTS IDENTIFICATION

- 1** SYSTEM POWER switch and STANDBY indicator  
The indicator remains lit as long as the AC power cord is connected to a wall outlet.
- 2** HEADPHONES jack (stereo minijack)
- 3** Display window
- 4** VOLUME control
- 5** VIDEO and AUDIO FUNCTION selectors
- 6** Function indicators
- 7** WAKE UP VOL SET indicator
- 8** OPEN tab

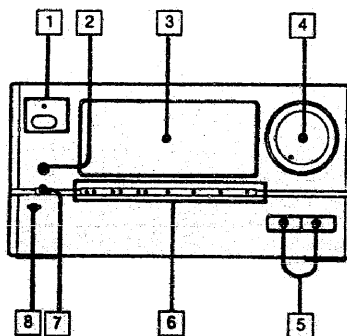

# SECTION 2 DISASSEMBLY

Note : Follow the disassembly procedure in the numerical order given.

## 2-1. FRONT PANEL ASSY

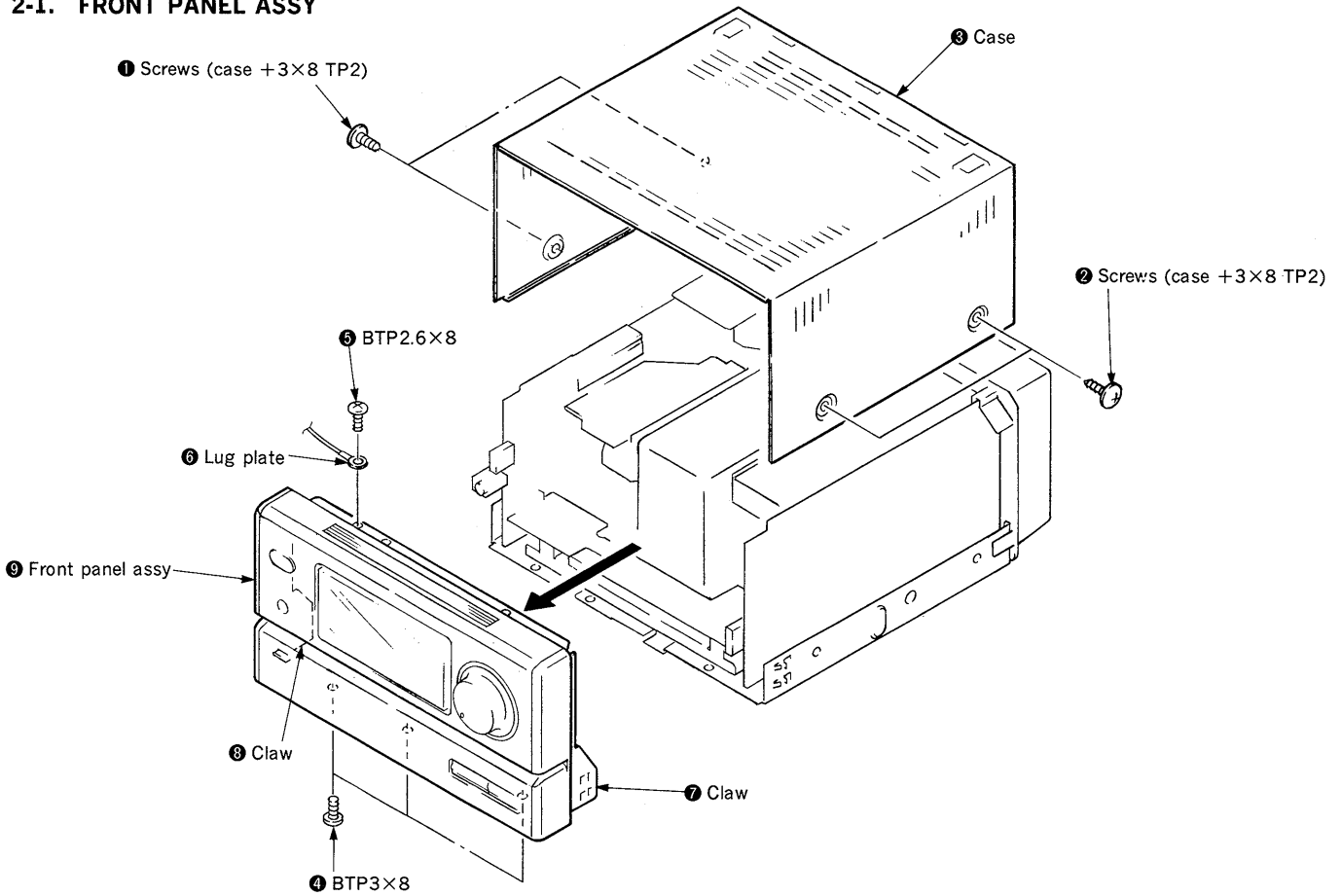

## 2-2. PANEL BOARD

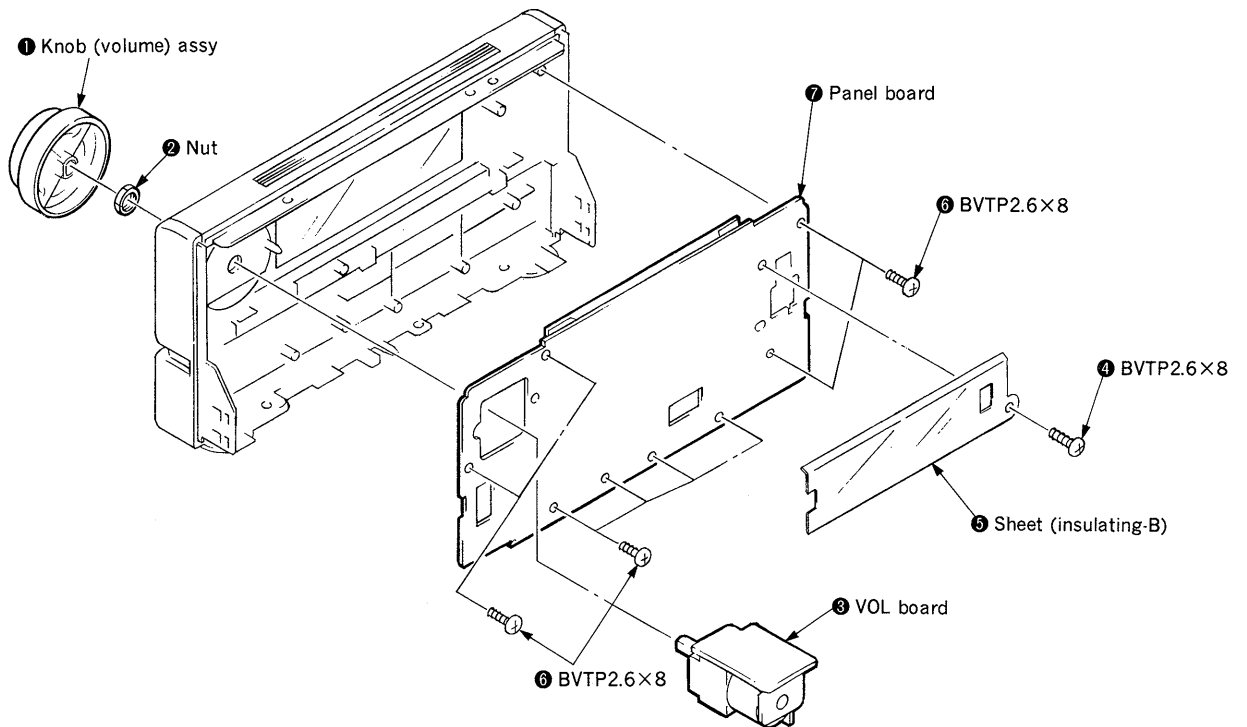

2-3. BACK PANEL

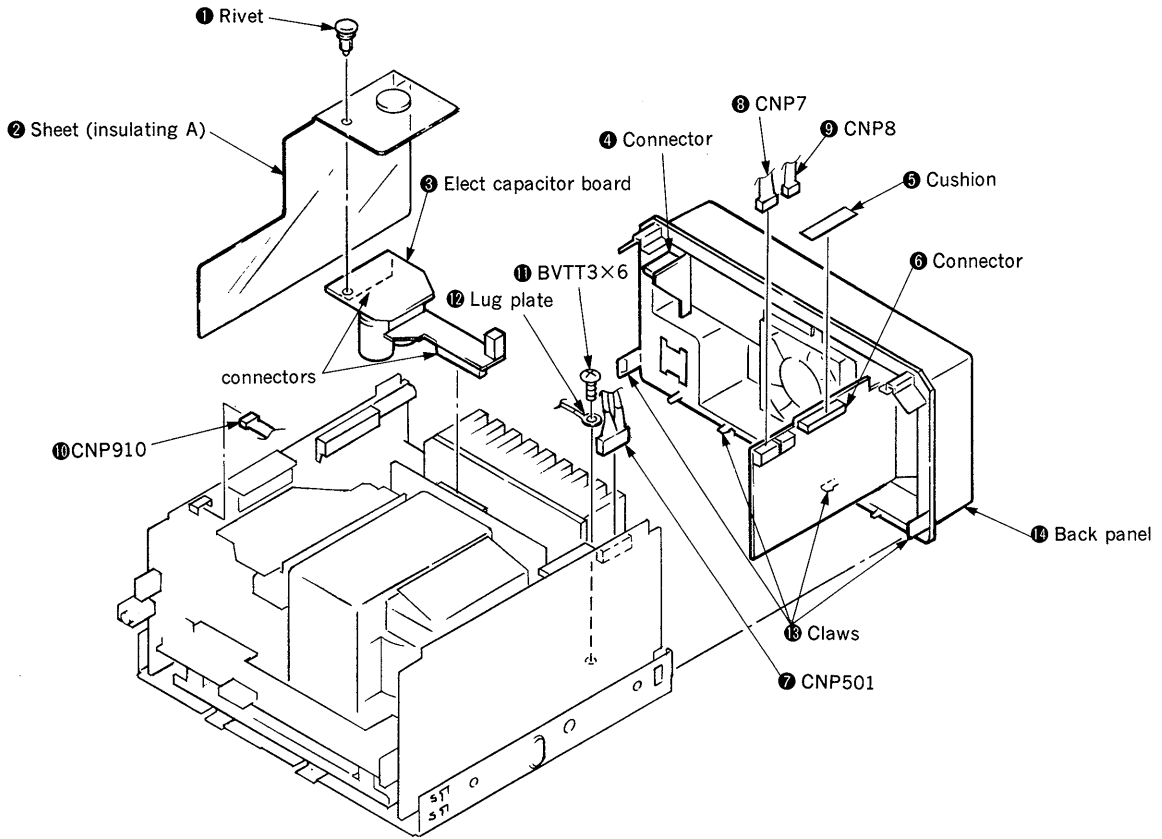

2-4. JACK BOARD, SPEAKER BOARD

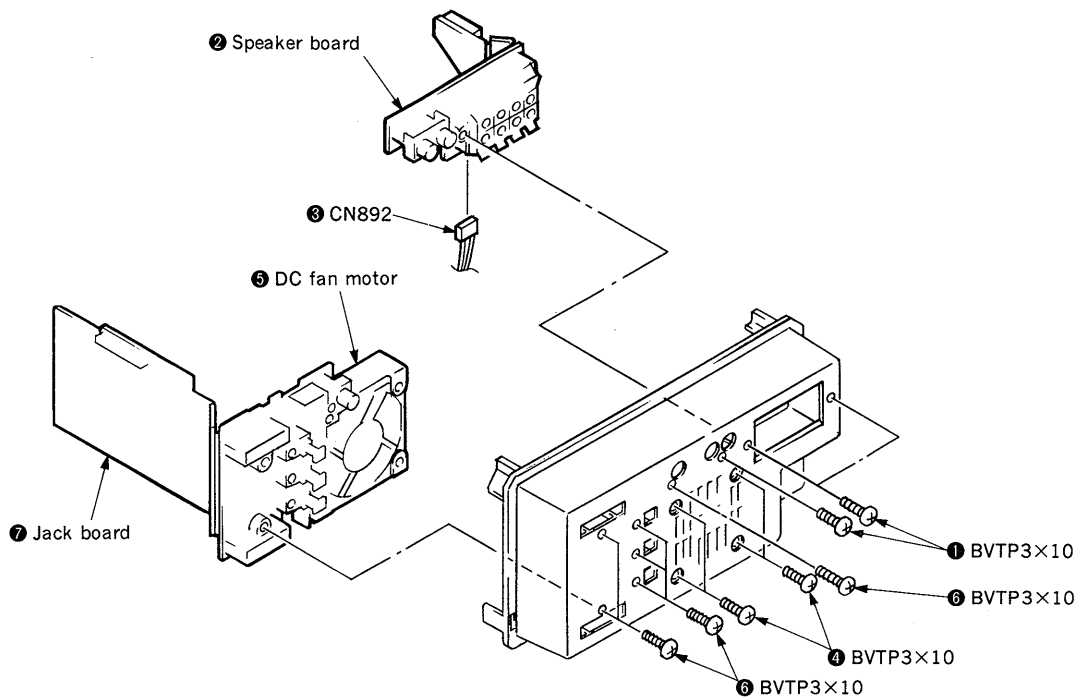

## 2-5. POWER BOARD, DSP BOARD

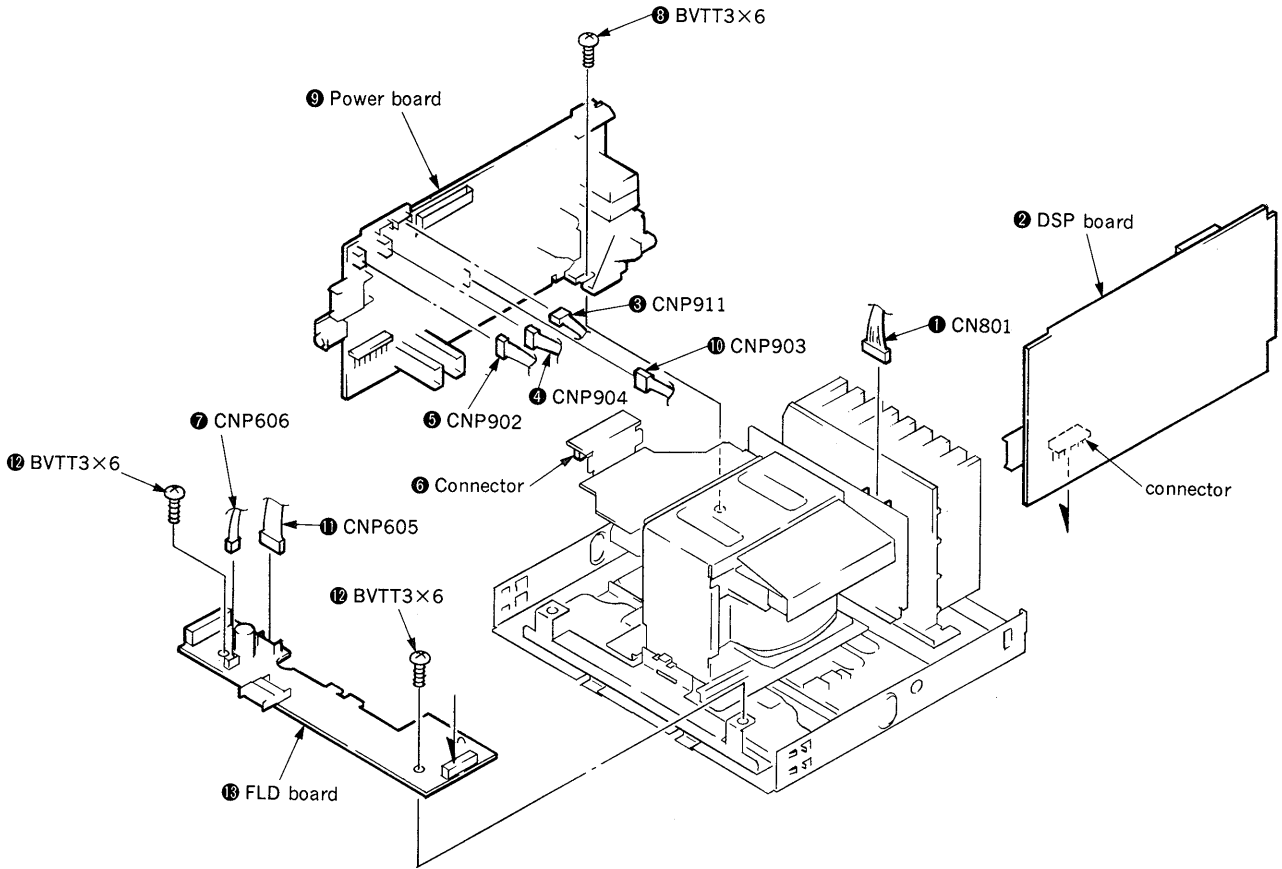

## 2-6. POWER TRANSFORMER

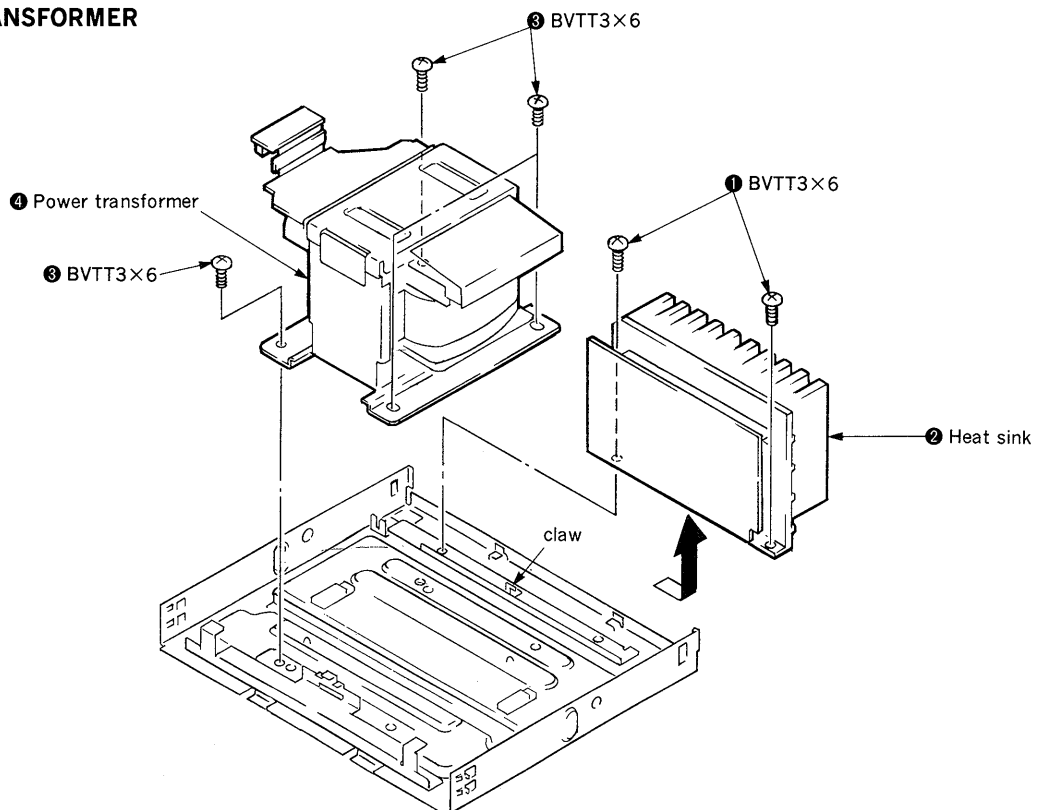

**SECTION 3  
DIAGRAMS**

**3-1. CIRCUIT BOARDS LOCATION**

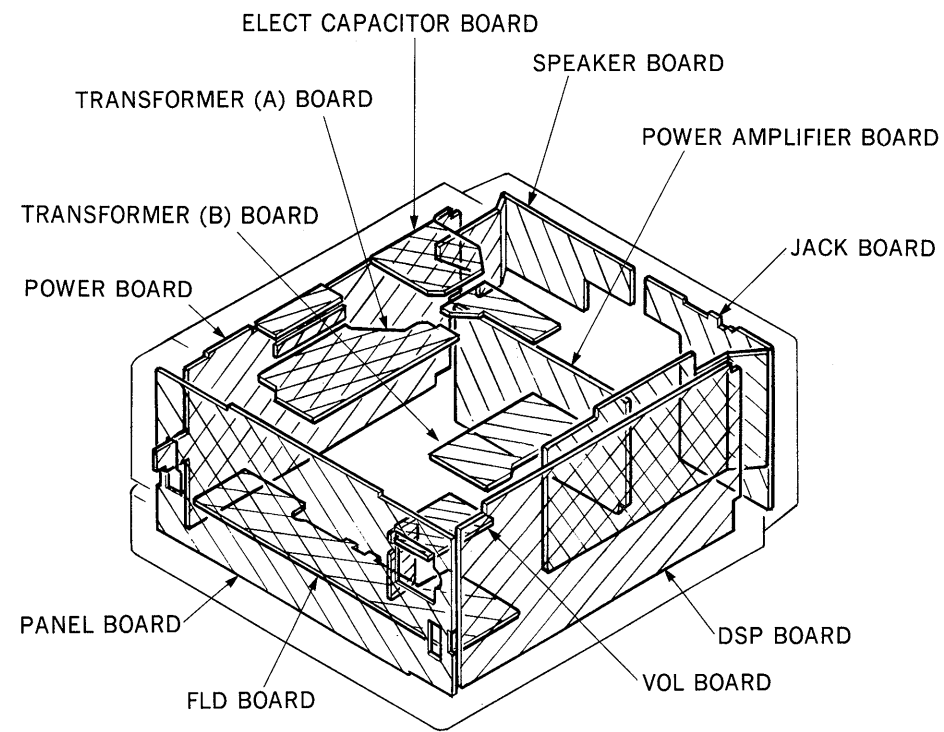

**3-2. SEMICONDUCTOR LEAD LAYOUTS**

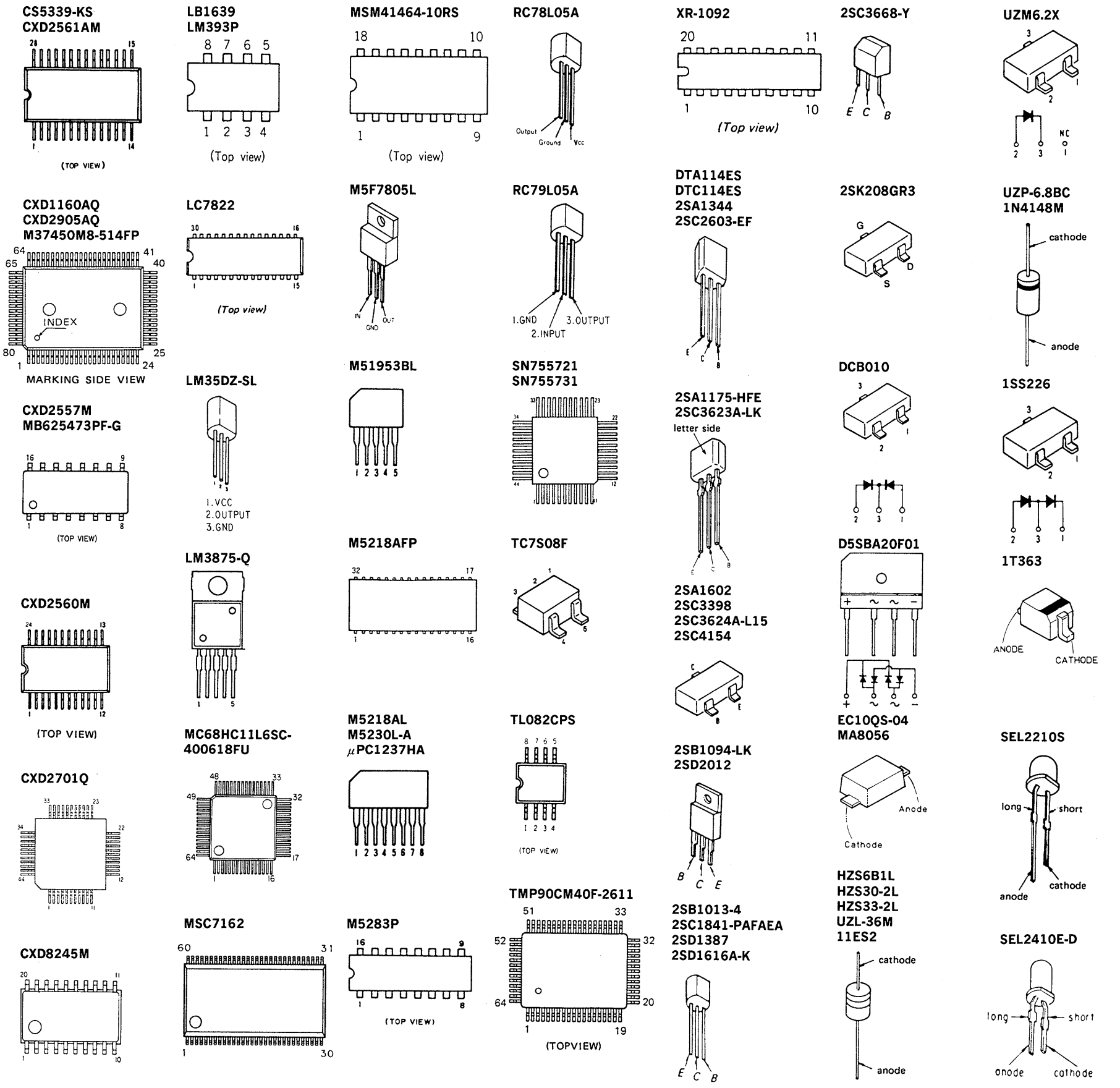

● Semiconductor Location

Ref. No.	Location	Ref. No.	Location
D601	G-20	IC1	C-13
D602	G-20	IC2	D-13
D701	G-16	IC3	C-13
D702	F-17	IC601	G-20
D703	F-17	IC651	H-3
D704	G-16	IC701	F-16
D705	G-16	IC702	H-16
D706	G-17	IC703	G-17
D801	H-15	IC801	I-15
D802	G-15	IC821	I-14
D821	H-15	IC851	I-16
D822	G-15	IC871	I-18
D851	H-17	IC901	G-2
D852	G-15	IC902	J-4
D871	H-17		
D872	G-15	Q601	F-20
D891	C-3	Q602	G-20
D892	C-3	Q651	I-2
D901	D-3	Q652	H-3
D902	F-3	Q661	H-3
D903	F-3	Q701	F-16
D904	G-4	Q801	H-15
D905	G-4	Q821	H-14
D906	F-4	Q851	G-17
D907	F-4	Q871	H-18
D908	G-4	Q901	G-1
D909	G-4	Q902	G-1
D910	I-4	Q903	G-3
D911	H-4	Q904	J-4
D915	I-11	Q905	H-4
D916	I-11	Q906	H-4
D917	J-12	Q908	D-5
D918	K-12	Q909	D-3
D919	D-5	Q910	F-3
D920	H-5	Q911	D-5
D1001	J-6	Q1001	J-7
D1002	J-6	Q1002	J-9
D1003	J-6	Q1101	E-5
D1004	J-6	Q1601	I-3
D1005	I-11	Q1602	H-3
D1006	I-7		
D1007	I-7		
D1008	I-9		
D1009	I-9		
D1010	I-7		
D1101	E-4		
D1102	E-4		

Note:  
 ● — : parts extracted from the component side.  
 ● G : Germany model  
 IT : Italian model

3-3. PRINTED WIRING BOARDS — POWER/JACK/VOLUME SECTION — ● Refer to page 6 for Semiconductor Lead Layouts.

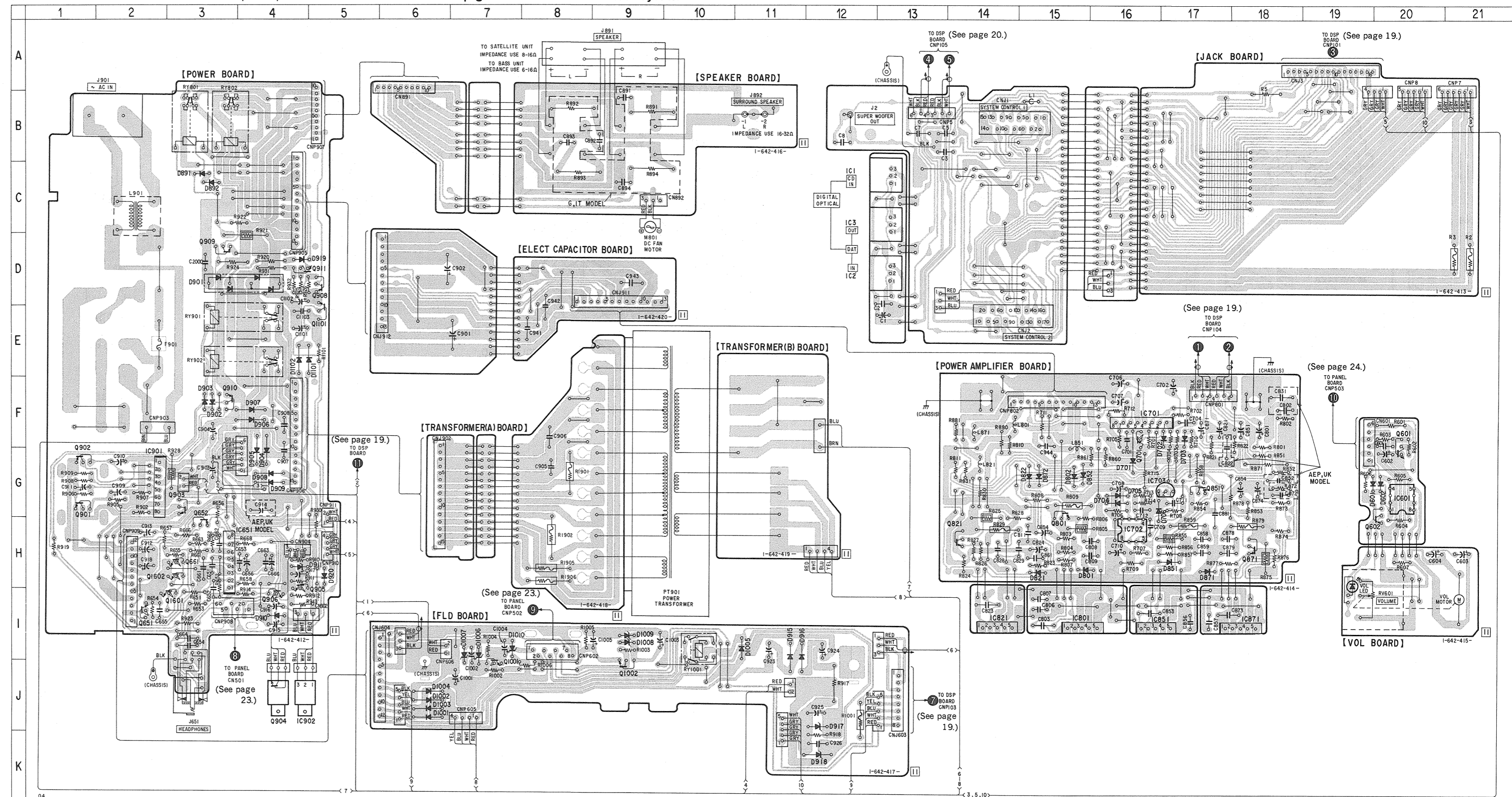

3-4. SCHEMATIC DIAGRAM — POWER/JACK/VOLUME SECTION — Refer to page 28 for IC Block Diagrams.

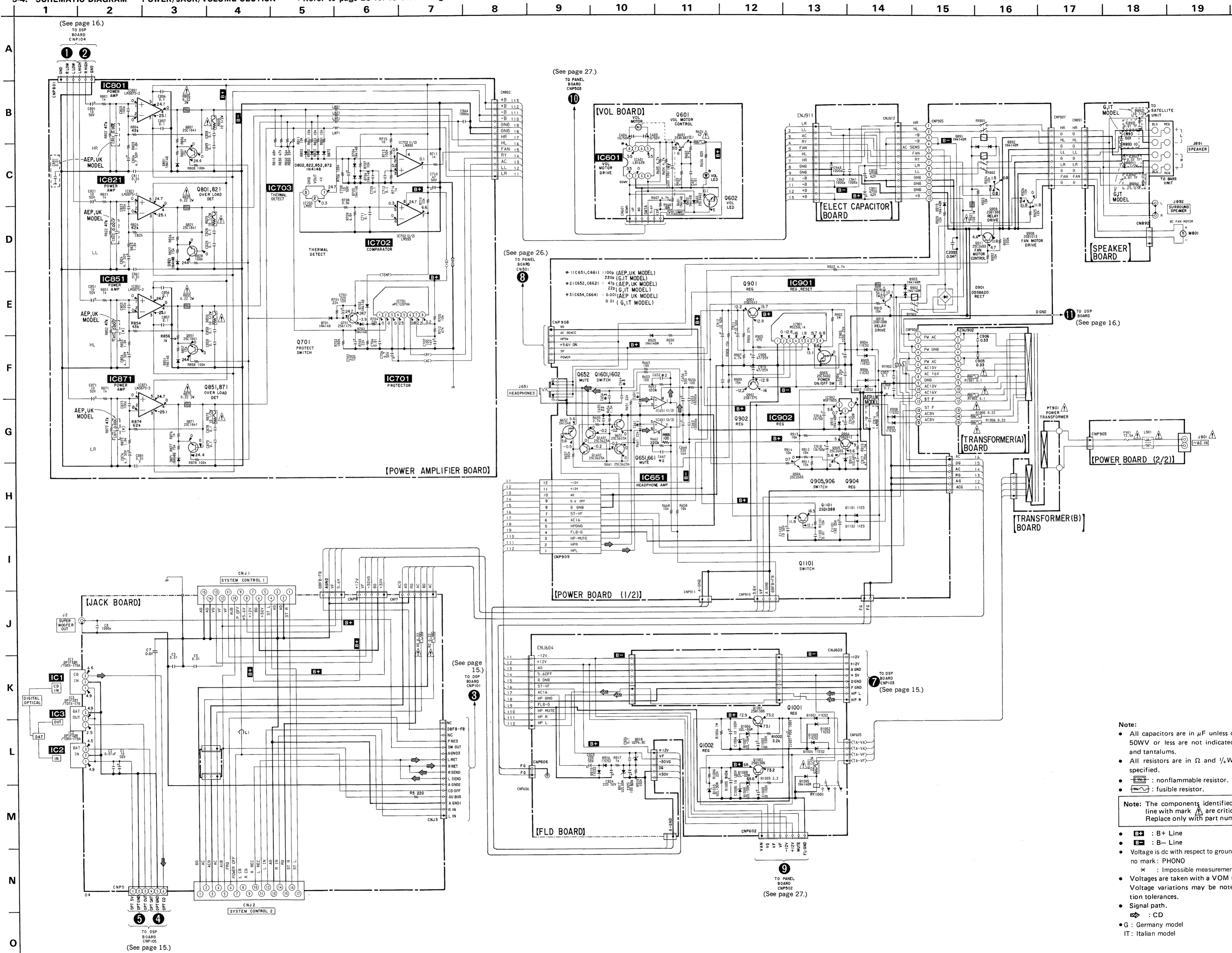

**Note:**

- All capacitors are in  $\mu\text{F}$  unless otherwise noted.  $\text{pF}$ :  $\mu\text{F}$  50WV or less are not indicated except for electrolytics and tantalums.
- All resistors are in  $\Omega$  and  $\frac{1}{4}\text{W}$  or less unless otherwise specified.
- $\square$ : nonflammable resistor.
- $\square$ : fusible resistor.

**Note:** The components identified by mark  $\Delta$  or dotted line with mark  $\Delta$  are critical for safety. Replace only with part number specified.

- $\text{B+}$ : B+ Line
- $\text{B-}$ : B- Line
- Voltage is dc with respect to ground under no-signal conditions. no mark: PHONO
- $\times$ : impossible measurement point
- Voltages are taken with a VOM (Input Impedance  $10\text{M}\Omega$ ). Voltage variations may be noted due to normal production tolerances.
- Signal path
- $\square$ : CD
- G: Germany model
- IT: Italian model



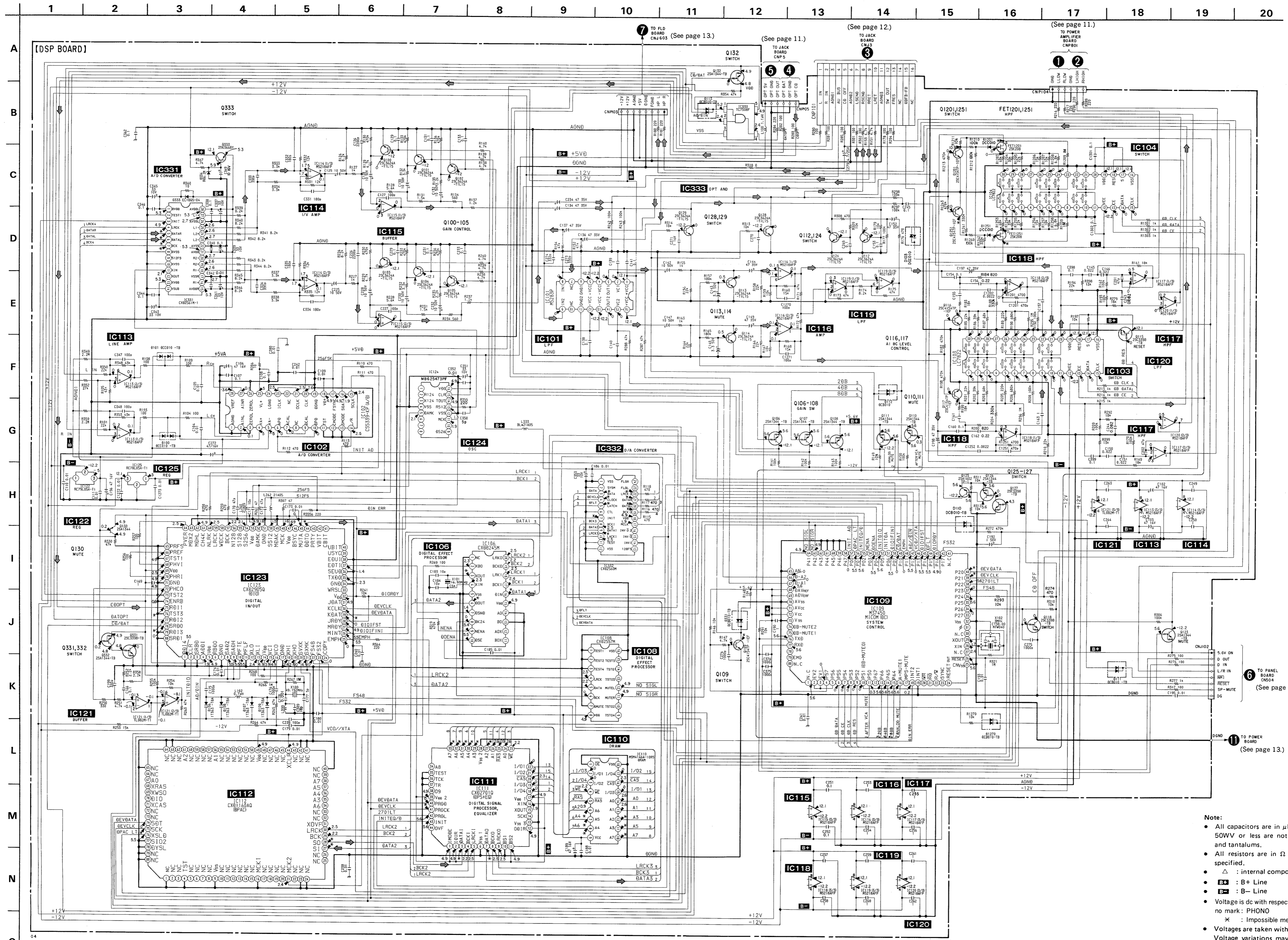

**Note:**

- All capacitors are in  $\mu\text{F}$  unless otherwise noted.  $\text{pF}$  =  $\mu\text{F}$  50WV or less are not indicated except for electrolytics and tantalums.
- All resistors are in  $\Omega$  and  $\frac{1}{4}\text{W}$  or less unless otherwise specified.
- $\triangle$  : internal component.
- **B+** : B+ Line
- **B-** : B- Line
- Voltage is dc with respect to ground under no-signal conditions. no mark : PHONO
- \* : Impossible measurement point
- Voltages are taken with a VOM (input Impedance 10M $\Omega$ ). Voltage variations may be noted due to normal production tolerances.
- Signal path.
- $\square$  : CD

3-6. PRINTED WIRING BOARD — DSP SECTION — • Refer to page 6 for Semiconductor Lead Layouts.

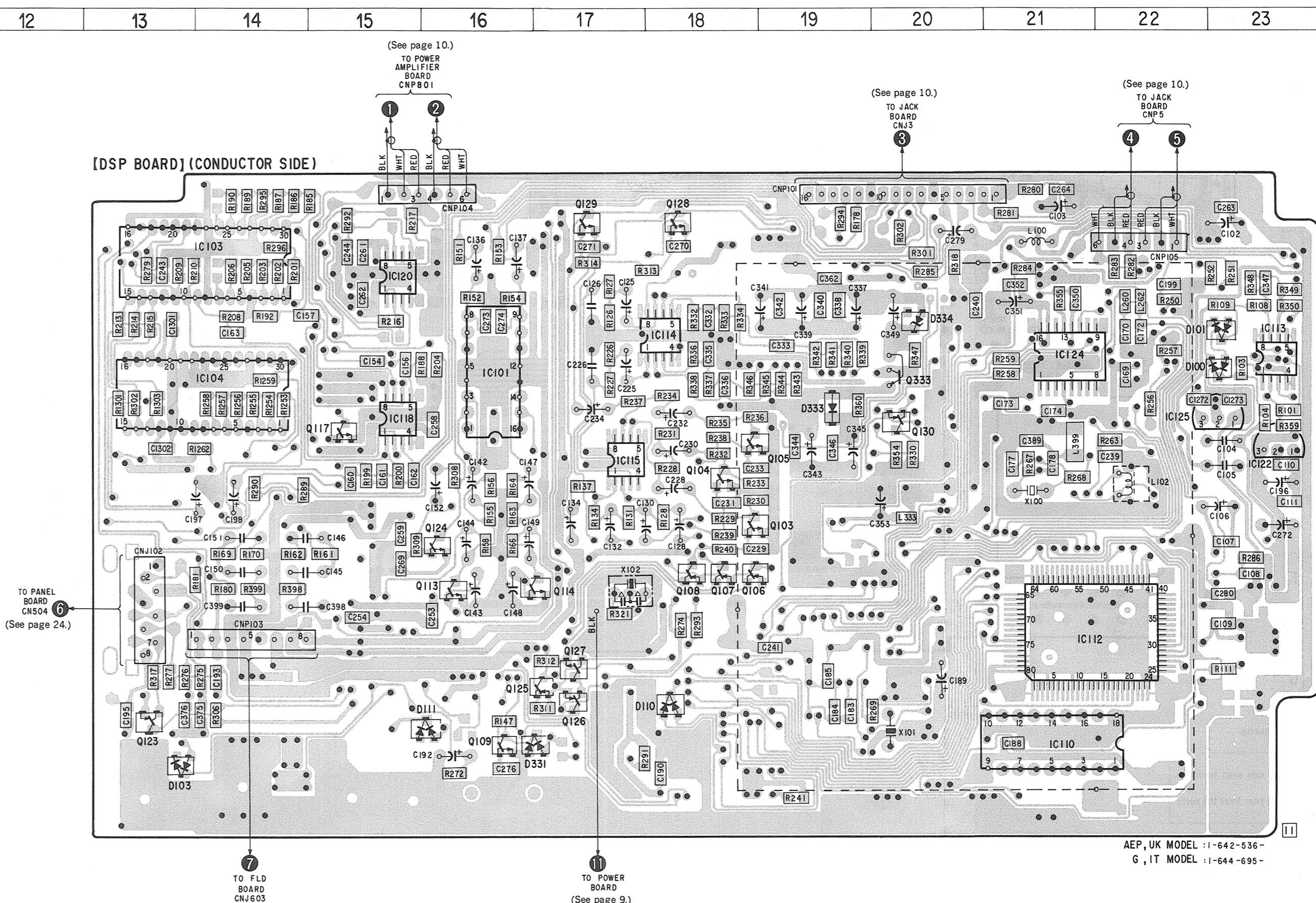
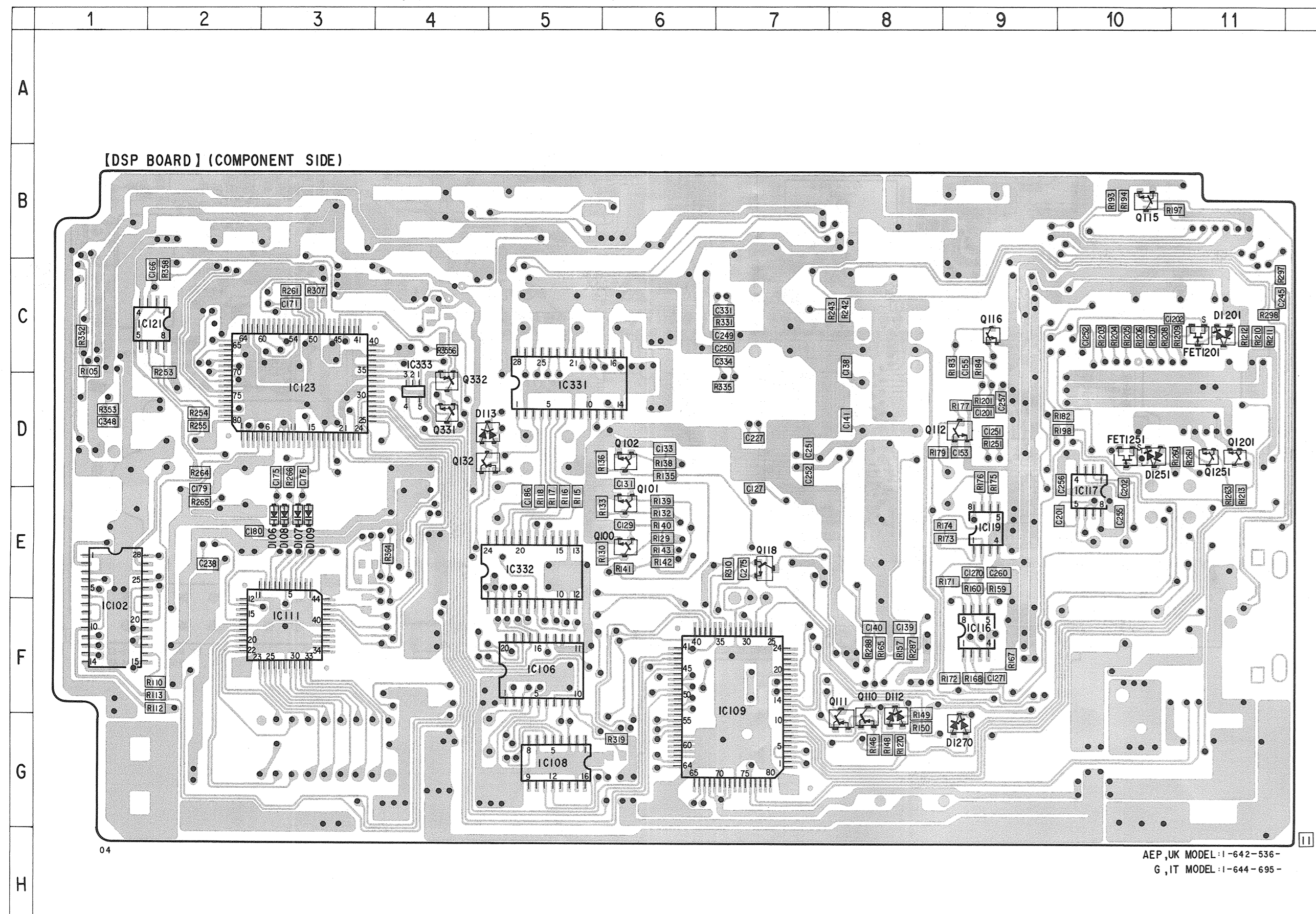

• Semiconductor Location

Ref. No.	Location	Ref. No.	Location
D100	C-23	IC123	D-3
D101	C-23	IC124	C-21
D103	G-13	IC125	D-23
D106	E-3	IC331	D-5
D107	E-3	IC332	E-5
D108	E-3	IC333	D-4
D109	E-3		
D110	F-18	Q100	E-6
D111	G-16	Q101	E-6
D112	G-8	Q102	D-6
D113	D-4	Q103	E-18
D331	G-16	Q104	D-18
D333	D-19	Q105	D-18
D334	C-20	Q106	E-18
D1201	C-11	Q107	E-18
D1251	D-10	Q108	E-18
D1270	G-9	Q109	G-16
		Q110	G-8
FET1201	C-11	Q111	G-8
FET1251	D-10	Q112	D-9
		Q113	E-16
IC101	D-16	Q114	E-16
IC102	F-1	Q115	B-10
IC103	C-14	Q116	C-9
IC104	D-14	Q117	D-15
IC106	F-5	Q118	E-7
IC108	G-5	Q123	G-13
IC109	F-7	Q124	E-16
IC110	G-21	Q125	F-17
IC111	F-3	Q126	F-17
IC112	F-21	Q127	F-17
IC113	C-23	Q128	B-18
IC114	C-18	Q129	B-17
IC115	D-17	Q130	D-20
IC116	F-9	Q132	D-4
IC117	E-10	Q331	D-4
IC118	D-15	Q332	D-4
IC119	E-9	Q333	C-20
IC120	C-15	Q1201	D-11
IC121	C-2	Q1251	D-11
IC122	D-23		

**Note:**  
 ○ — parts extracted from the component side.  
 ● — Through hole.  
 ▨ — Pattern from the side which enables seeing.  
 (The other layers' patterns are not indicated.)

**Caution:**  
 Pattern face side: Parts on the pattern face side seen from the (Conductor side) pattern face are indicated.  
 Parts face side: Parts on the parts face side seen from the parts (Component side) face are indicated.

• G : Germany model  
 IT : Italian model

● Semiconductor Location 3-7. PRINTED WIRING BOARD — PANEL SECTION — ● Refer to page 6 for Semiconductor Lead Layouts.

Ref. No.	Location
D501	F-11
D502	F-13
D503	F-12
D504	C-22
D505	C-20
D506	C-19
D507	C-18
D508	C-17
D509	C-15
D510	F-15
D511	C-21
D512	C-19
D514	C-17
D515	C-16
D521	C-20
D522	B-17
D523	B-25
IC501	D-20
IC502	E-21
IC503	F-20
IC504	D-18
IC505	F-18
IC506	E-17
IC507	E-15
IC508	C-3
IC509	D-24
Q501	F-13
Q502	F-11
Q503	F-12
Q504	F-11
Q505	F-11
Q506	F-15
Q507	E-11
Q508	C-5
Q509	C-7
Q510	C-8
Q511	C-9
Q512	C-11
Q513	C-11
Q514	C-11
Q515	C-19
Q516	C-19
Q517	C-19

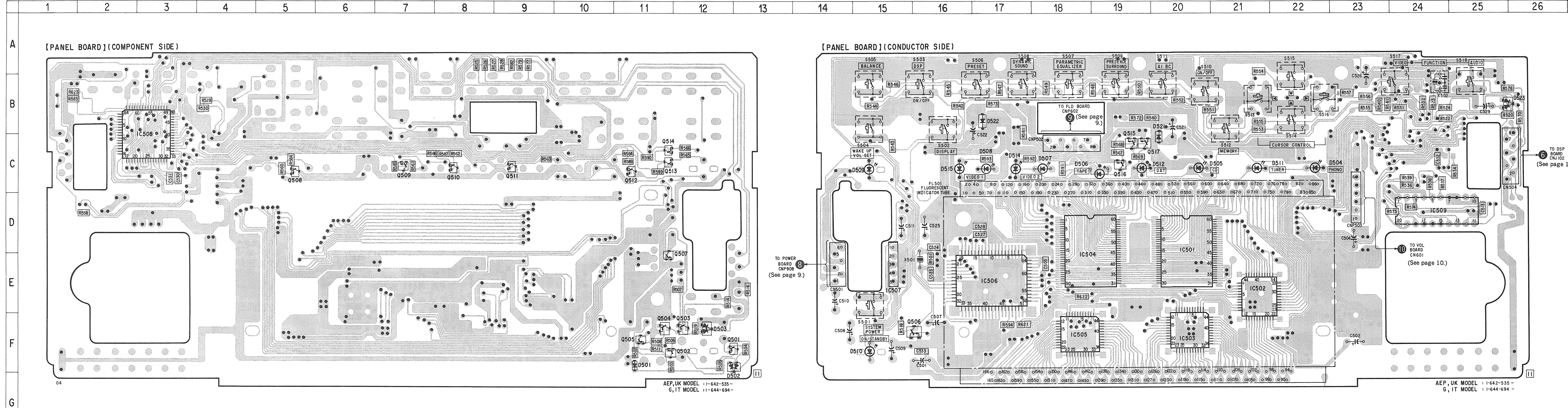

**Note:**  
 ● : Through hole.  
 ● : Pattern from the side which enables seeing.  
 (The other layers' patterns are not indicated.)

**Caution:**  
 Pattern face side: Parts on the pattern face side seen from the (Conductor side) pattern face are indicated.  
 Parts face side: Parts on the parts face side seen from the parts (Component side) face are indicated.

● G : Germany model  
 IT : Italian model



• IC Block Diagrams

IC601 LB1639

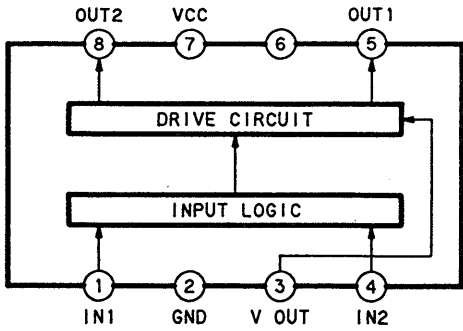

IC701  $\mu$ PC1237HA

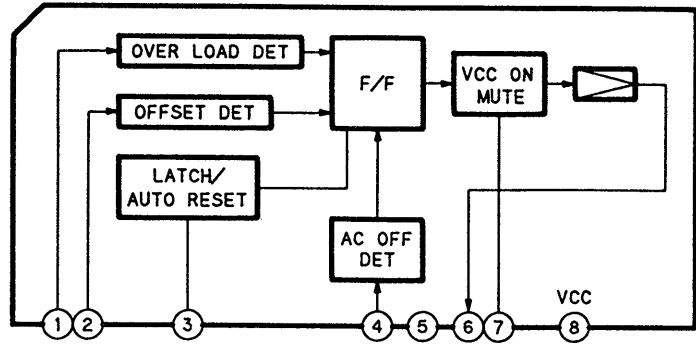

IC901 M5230L-A

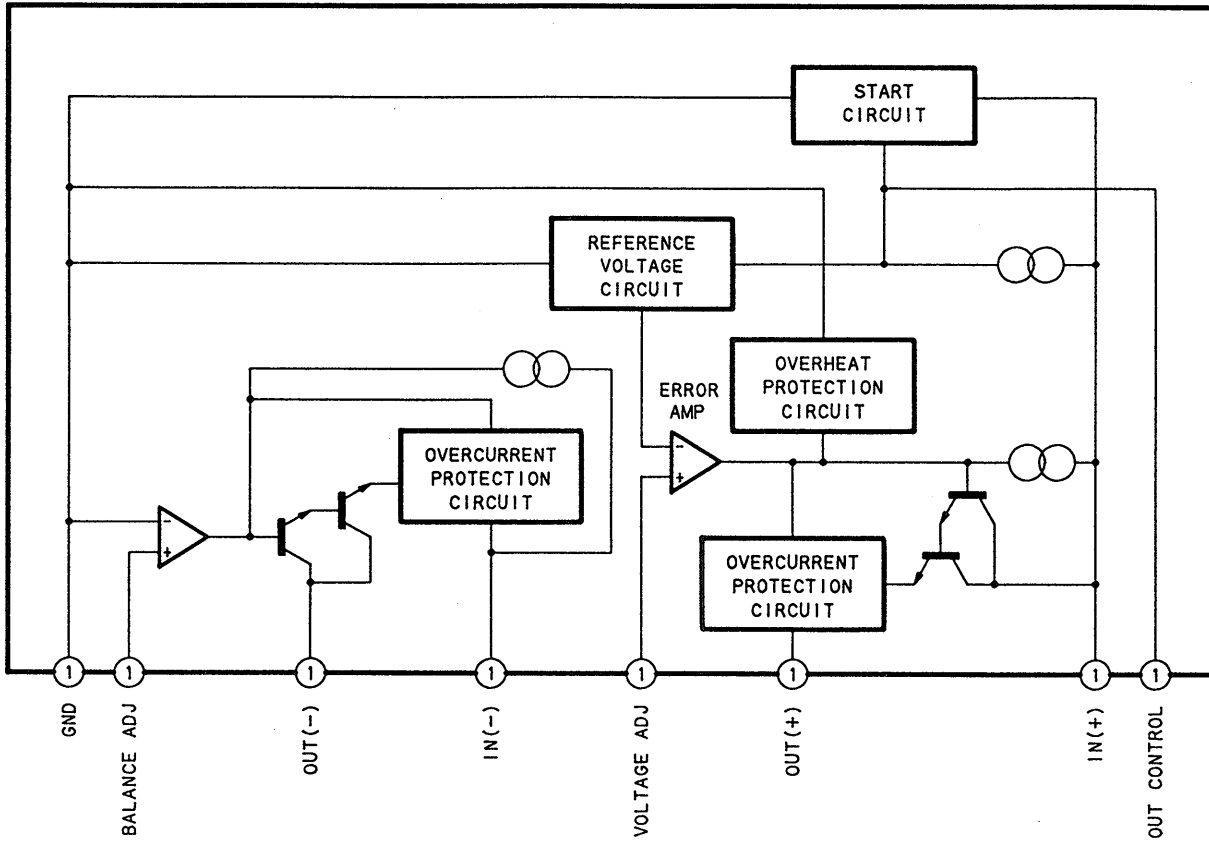

## SECTION 4 EXPLODED VIEWS

**NOTE:**

- The mechanical parts with no reference number in the exploded views are not supplied.
- Items marked "\*" are not stocked since they are seldom required for routine service. Some delay should be anticipated when ordering these items.

- -XX and -X mean standardized parts, so they may have some difference from the original one.
- Color Indication of Appearance Parts  
Example :  
KNOB, BALANCE (WHITE)... (RED)  
                  ↑                  ↑  
                  Parts Color Cabinet's Color

- Hardware (# mark) list is given in the last of this parts list.

The components identified by mark  $\triangle$  or dotted line with mark  $\triangle$  are critical for safety. Replace only with part number specified.

- G : Germany model
- IT : Italian model

### 4-1. FRONT PANEL ASSY

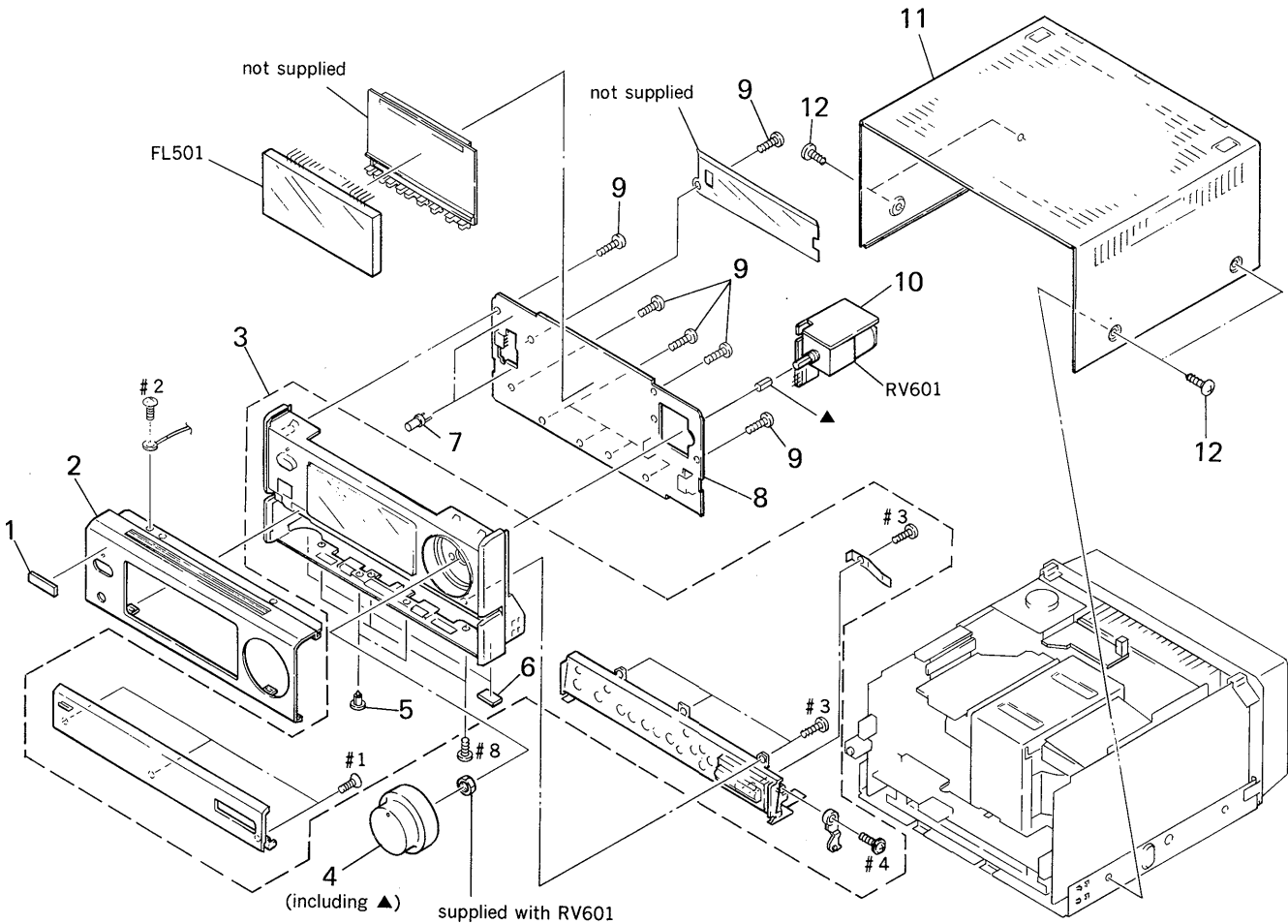

Ref. No.	Part No.	Description	Remark
1	4-942-636-01	EMBLEM (NO. 3.5), SONY	
2	X-4942-475-1	PANEL ASSY, FRONT	
3	X-4942-467-1	PANEL (BASE) ASSY	
4	X-4942-472-2	KNOB (VOLUME) ASSY	
5	4-812-134-00	RIVET NYLON, 3.5	
6	4-930-336-21	FOOT (FELT)	
* 7	3-362-478-21	HOLDER (T), LED	
* 8	A-4347-005-A	PANEL BOARD, COMPLETE (AEP, UK)	
* 8	A-4356-121-A	PANEL BOARD, COMPLETE (G, IT)	

Ref. No.	Part No.	Description	Remark
9	4-951-620-01	SCREW (2.6X8), +BVTP	
* 10	1-642-415-11	VOL BOARD	
* 11	4-932-841-41	CASE	
12	3-363-099-01	SCREW (CASE +3X8 TP2)	
FL501	1-519-654-11	INDICATOR TUBE, FLUORESCENT	
RV601	1-241-803-11	RES, VAR, CARBON (WITH MOTOR) 10K (VOLUME)	

## 4-2. CHASSIS SECTION

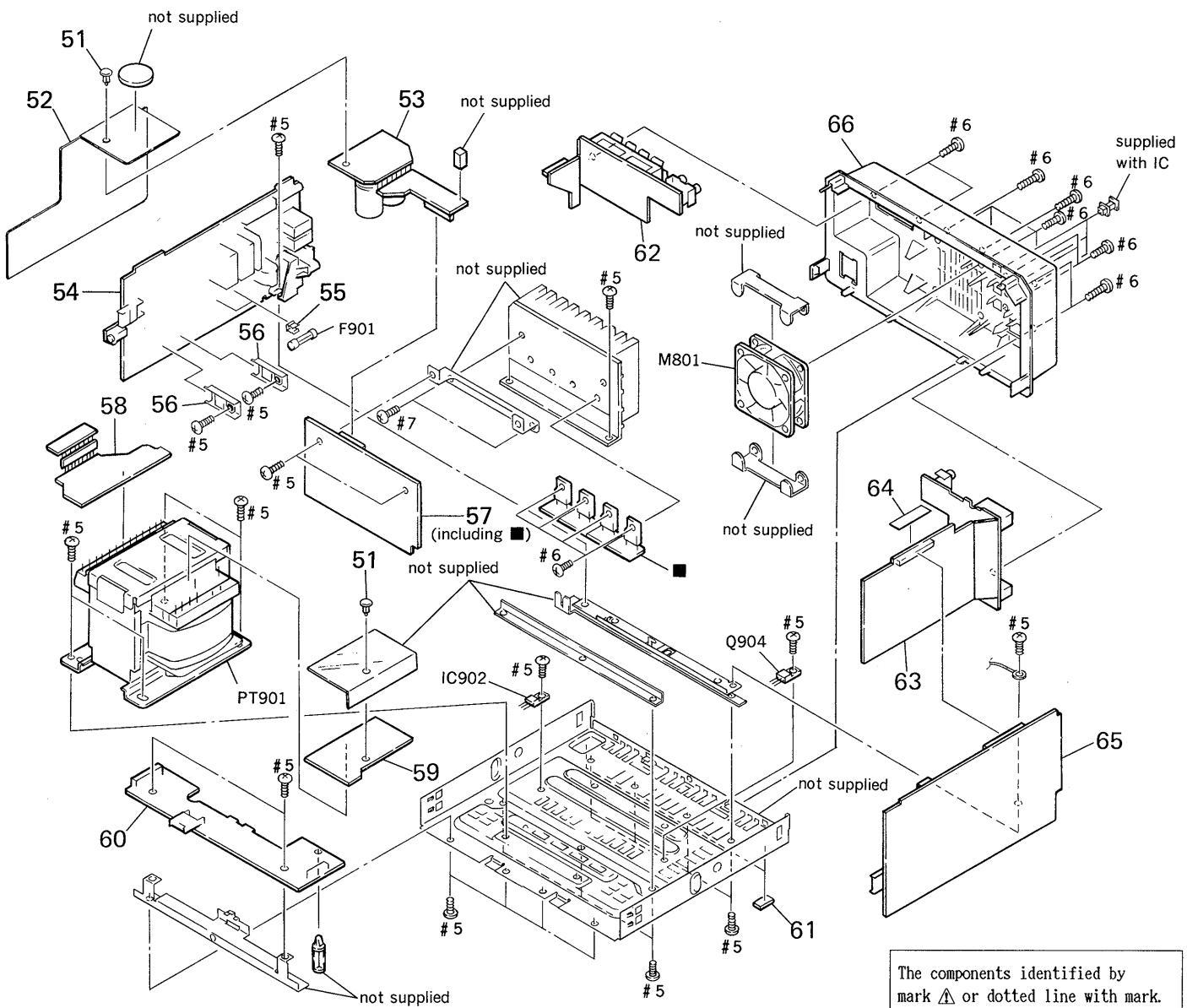

Ref. No.	Part No.	Description	Remark
	51	4-812-134-11 RIVET NYLON, 3.5	
*	52	4-945-055-11 SHEET (INSULATING A)	
*	53	1-642-420-11 ELECT CAPACITOR BOARD	
*	54	A-4347-007-A POWER BOARD, COMPLETE (AEP, UK)	
*	54	A-4347-012-A POWER BOARD, COMPLETE (G, IT)	
*	55	1-533-213-31 HOLDER, FUSE	
*	56	3-309-144-21 HEAT SINK	
*	57	A-4347-010-A POWER AMPLIFIER BOARD, COMPLETE (AEP, UK)	
*	57	A-4347-013-A POWER AMPLIFIER BOARD, COMPLETE (G, IT)	
*	58	1-642-418-11 TRANSFORMER (A) BOARD	
*	59	1-642-419-11 TRANSFORMER (B) BOARD	
*	60	A-4345-999-A FLD BOARD, COMPLETE	
	61	4-930-336-21 FOOT (FELT)	

Ref. No.	Part No.	Description	Remark
*	62	1-642-416-11 SPEAKER BOARD	
*	63	1-642-413-11 JACK BOARD	
	64	4-860-518-00 CUSHION	
*	65	A-4347-003-A DSP BOARD, COMPLETE (AEP, UK)	
*	65	A-4356-123-A DSP BOARD, COMPLETE (G, IT)	
*	66	4-948-766-11 PANEL, BACK	
$\triangle$	F901	1-532-286-00 FUSE, TIME-LAG (T2. 5A)	
	IC902	8-759-231-53 IC M5F7805L	
	M801	1-541-860-11 MOTOR, DC FAN	
$\triangle$	PT901	1-450-881-11 TRANSFORMER, POWER (UK)	
$\triangle$	PT901	1-450-883-11 TRANSFORMER, POWER (AEP, G, IT)	
	Q904	8-729-209-15 TRANSISTOR 2SD2012	

## SECTION 5 ELECTRICAL PARTS LIST

DSP

PANEL

**NOTE:**

- Due to standardization, replacements in the parts list may be different from the parts specified in the diagrams or the components used on the set.
- -XX and -X mean standardized parts, so they may have some difference from the original one.
- RESISTORS  
All resistors are in ohms.  
METAL: Metal-film resistor.  
METAL OXIDE: Metal oxide-film resistor.  
F: nonflammable

- Items marked "\*" are not stocked since they are seldom required for routine service. Some delay should be anticipated when ordering these items.
- SEMICONDUCTORS  
In each case, u:  $\mu$ , for example:  
uA ..:  $\mu$ A.    uPA.:  $\mu$ PA.  
uPB.:  $\mu$ PB.    uPC.:  $\mu$ PC.    uPD.:  $\mu$ PD..
- CAPACITORS  
uF:  $\mu$ F
- COILS  
uH:  $\mu$ H

The components identified by mark  $\Delta$  or dotted line with mark  $\Delta$  are critical for safety. Replace only with part number specified.

When indicating parts by reference number, please include the board.

- G : Germany model
- IT : Italian model

Ref. No.	Part No.	Description	Remark		
*	A-4347-003-A	DSP BOARD, COMPLETE (AEP, UK)			
*	A-4356-123-A	DSP BOARD, COMPLETE (G, IT)			
		*****			
*	A-4347-005-A	PANEL BOARD, COMPLETE (AEP, UK)			
*	A-4356-121-A	PANEL BOARD, COMPLETE (G, IT)			
		*****			
		< CAPACITOR >			
	C102	1-124-589-11 ELECT	47uF	20%	16V
	C103	1-124-589-11 ELECT	47uF	20%	16V
	C104	1-136-153-00 FILM	0.01uF	5%	50V
	C105	1-136-153-00 FILM	0.01uF	5%	50V
	C106	1-124-589-11 ELECT	47uF	20%	16V
	C107	1-164-004-11 CERAMIC CHIP	0.1uF	10%	25V
	C108	1-164-004-11 CERAMIC CHIP	0.1uF	10%	25V
	C109	1-164-232-11 CERAMIC CHIP	0.01uF		50V
	C110	1-164-232-11 CERAMIC CHIP	0.01uF		50V
	C111	1-164-232-11 CERAMIC CHIP	0.01uF		50V
	C125	1-124-915-11 ELECT	10uF	20%	63V
	C126	1-130-475-00 MYLAR	0.0022uF	5%	50V
	C127	1-163-117-00 CERAMIC CHIP	100PF	5%	50V
	C128	1-124-915-11 ELECT	10uF	20%	63V
	C129	1-164-004-11 CERAMIC CHIP	0.1uF	10%	25V
	C130	1-124-915-11 ELECT	10uF	20%	63V
	C131	1-164-004-11 CERAMIC CHIP	0.1uF	10%	25V
	C132	1-124-915-11 ELECT	10uF	20%	63V
	C133	1-164-004-11 CERAMIC CHIP	0.1uF	10%	25V
	C134	1-126-947-11 ELECT	47uF	20%	35V
	C136	1-126-947-11 ELECT	47uF	20%	35V
	C137	1-126-947-11 ELECT	47uF	20%	35V
	C138	1-164-004-11 CERAMIC CHIP	0.1uF	10%	25V
	C139	1-164-346-11 CERAMIC CHIP	1uF		16V
	C140	1-164-346-11 CERAMIC CHIP	1uF		16V
	C141	1-164-004-11 CERAMIC CHIP	0.1uF	10%	25V
	C142	1-124-915-11 ELECT	10uF	20%	63V
	C143	1-126-162-11 ELECT	3.3uF	20%	50V
	C144	1-126-947-11 ELECT	47uF	20%	35V
	C145	1-136-157-00 FILM	0.022uF	5%	50V

Ref. No.	Part No.	Description	Remark		
	C146	1-136-157-00 FILM	0.022uF	5%	50V
	C147	1-124-915-11 ELECT	10uF	20%	63V
	C148	1-126-162-11 ELECT	3.3uF	20%	50V
	C149	1-126-947-11 ELECT	47uF	20%	35V
	C150	1-136-157-00 FILM	0.022uF	5%	50V
	C151	1-136-157-00 FILM	0.022uF	5%	50V
	C152	1-126-947-11 ELECT	47uF	20%	35V
	C153	1-164-004-11 CERAMIC CHIP	0.1uF	10%	25V
	C154	1-164-004-11 CERAMIC CHIP	0.1uF	10%	25V
	C155	1-164-346-11 CERAMIC CHIP	1uF		16V
	C156	1-164-489-11 CERAMIC CHIP	0.22uF	10%	16V
	C157	1-164-346-11 CERAMIC CHIP	1uF		16V
	C160	1-164-004-11 CERAMIC CHIP	0.1uF	10%	25V
	C161	1-164-346-11 CERAMIC CHIP	1uF		16V
	C162	1-164-489-11 CERAMIC CHIP	0.22uF	10%	16V
	C163	1-164-346-11 CERAMIC CHIP	1uF		16V
	C166	1-164-004-11 CERAMIC CHIP	0.1uF	10%	25V
	C169	1-164-346-11 CERAMIC CHIP	1uF		16V
	C170	1-163-109-00 CERAMIC CHIP	47PF	5%	50V
	C171	1-163-227-11 CERAMIC CHIP	10PF	5%	50V
	C172	1-163-109-00 CERAMIC CHIP	47PF	5%	50V
	C173	1-164-232-11 CERAMIC CHIP	0.01uF		50V
	C174	1-164-232-11 CERAMIC CHIP	0.01uF		50V
	C175	1-163-141-00 CERAMIC CHIP	0.001uF	5%	50V
	C176	1-163-141-00 CERAMIC CHIP	0.001uF	5%	50V
	C178	1-163-141-00 CERAMIC CHIP	0.001uF	5%	50V
	C179	1-164-232-11 CERAMIC CHIP	0.01uF		50V
	C180	1-164-232-11 CERAMIC CHIP	0.01uF		50V
	C183	1-163-227-11 CERAMIC CHIP	10PF	5%	50V
	C184	1-163-227-11 CERAMIC CHIP	10PF	5%	50V
	C185	1-164-232-11 CERAMIC CHIP	0.01uF		50V
	C186	1-164-232-11 CERAMIC CHIP	0.01uF		50V
	C188	1-164-232-11 CERAMIC CHIP	0.01uF		50V
	C189	1-124-589-11 ELECT	47uF	20%	16V
	C190	1-164-346-11 CERAMIC CHIP	1uF		16V
	C192	1-124-902-00 ELECT	0.47uF	20%	50V
	C193	1-164-232-11 CERAMIC CHIP	0.01uF		50V
	C195	1-164-232-11 CERAMIC CHIP	0.01uF		50V
	C196	1-124-589-11 ELECT	47uF	20%	16V
	C197	1-126-947-11 ELECT	47uF	20%	35V



DSP

PANEL

Ref. No.	Part No.	Description	Remark	Ref. No.	Part No.	Description	Remark
C198	1-126-947-11	ELECT	47uF 20% 35V	C333	1-163-131-00	CERAMIC CHIP 390PF 5% 50V	
C199	1-163-129-00	CERAMIC CHIP	330PF 5% 50V	C334	1-163-123-00	CERAMIC CHIP 180PF 5% 50V	
C201	1-163-109-00	CERAMIC CHIP	47PF 5% 50V	C335	1-163-123-00	CERAMIC CHIP 180PF 5% 50V	
C202	1-163-109-00	CERAMIC CHIP	47PF 5% 50V	C336	1-163-131-00	CERAMIC CHIP 390PF 5% 50V	
C225	1-124-915-11	ELECT	10uF 20% 63V	C337	1-124-229-00	ELECT 33uF 20% 10V	
C226	1-130-475-00	MYLAR	0.0022uF 5% 50V	C338	1-164-004-11	CERAMIC CHIP 0.1uF 10% 25V	
C227	1-163-117-00	CERAMIC CHIP	100PF 5% 50V	C339	1-124-229-00	ELECT 33uF 20% 10V	
C228	1-124-915-11	ELECT	10uF 20% 63V	C340	1-164-004-11	CERAMIC CHIP 0.1uF 10% 25V	
C229	1-164-004-11	CERAMIC CHIP	0.1uF 10% 25V	C341	1-124-229-00	ELECT 33uF 20% 10V	
C230	1-124-915-11	ELECT	10uF 20% 63V	C342	1-164-232-11	CERAMIC CHIP 0.01uF 50V	
C231	1-164-004-11	CERAMIC CHIP	0.1uF 10% 25V	C343	1-124-229-00	ELECT 33uF 20% 10V	
C232	1-124-915-11	ELECT	10uF 20% 63V	C344	1-164-004-11	CERAMIC CHIP 0.1uF 10% 25V	
C233	1-164-004-11	CERAMIC CHIP	0.1uF 10% 25V	C345	1-124-229-00	ELECT 33uF 20% 10V	
C234	1-126-947-11	ELECT	47uF 20% 35V	C346	1-164-004-11	CERAMIC CHIP 0.1uF 10% 25V	
C238	1-164-232-11	CERAMIC CHIP	0.01uF 50V	C347	1-163-117-00	CERAMIC CHIP 100PF 5% 50V	
C239	1-163-117-00	CERAMIC CHIP	100PF 5% 50V	C348	1-163-117-00	CERAMIC CHIP 100PF 5% 50V	
C240	1-164-232-11	CERAMIC CHIP	0.01uF 50V	C349	1-126-157-11	ELECT 10uF 20% 16V	
C241	1-164-232-11	CERAMIC CHIP	0.01uF 50V	C350	1-163-222-11	CERAMIC CHIP 5PF 0.25PF50V	
C243	1-164-345-11	CERAMIC CHIP	0.082uF 10% 25V	C351	1-124-229-00	ELECT 33uF 20% 10V	
C244	1-164-345-11	CERAMIC CHIP	0.082uF 10% 25V	C352	1-164-232-11	CERAMIC CHIP 0.01uF 50V	
C245	1-164-004-11	CERAMIC CHIP	0.1uF 10% 25V	C353	1-124-229-00	ELECT 33uF 20% 10V	
C249	1-164-346-11	CERAMIC CHIP	1uF 16V	C362	1-164-004-11	CERAMIC CHIP 0.1uF 10% 25V	
C250	1-164-346-11	CERAMIC CHIP	1uF 16V	C375	1-163-141-00	CERAMIC CHIP 0.001uF 5% 50V	
C251	1-164-004-11	CERAMIC CHIP	0.1uF 10% 25V	C376	1-163-141-00	CERAMIC CHIP 0.001uF 5% 50V	
C252	1-164-004-11	CERAMIC CHIP	0.1uF 10% 25V	C389	1-163-099-00	CERAMIC CHIP 18PF 5% 50V	
C253	1-164-346-11	CERAMIC CHIP	1uF 16V	C398	1-136-165-00	FILM 0.1uF 5% 50V	
C254	1-164-346-11	CERAMIC CHIP	1uF 16V	C399	1-136-165-00	FILM 0.1uF 5% 50V	
C255	1-164-346-11	CERAMIC CHIP	1uF 16V	C501	1-124-667-11	ELECT 10uF 20% 100V	
C256	1-164-346-11	CERAMIC CHIP	1uF 16V	C502	1-124-667-11	ELECT 10uF 20% 100V	
C257	1-164-346-11	CERAMIC CHIP	1uF 16V	C504	1-124-667-11	ELECT 10uF 20% 100V	
C258	1-164-346-11	CERAMIC CHIP	1uF 16V	C505	1-164-004-11	CERAMIC CHIP 0.1uF 10% 25V	
C259	1-164-346-11	CERAMIC CHIP	1uF 16V	C507	1-126-157-11	ELECT 10uF 20% 16V	
C260	1-164-346-11	CERAMIC CHIP	1uF 16V	C508	1-124-589-11	ELECT 47uF 20% 16V	
C261	1-164-346-11	CERAMIC CHIP	1uF 16V	C509	1-126-163-11	ELECT 4.7uF 20% 50V	
C262	1-164-346-11	CERAMIC CHIP	1uF 16V	C510	1-126-301-11	ELECT 1uF 20% 50V	
C263	1-164-346-11	CERAMIC CHIP	1uF 16V	C511	1-126-163-11	ELECT 4.7uF 20% 50V	
C264	1-164-346-11	CERAMIC CHIP	1uF 16V	C513	1-163-124-00	CERAMIC CHIP 200PF 5% 50V	
C269	1-164-004-11	CERAMIC CHIP	0.1uF 10% 25V	C521	1-124-589-11	ELECT 47uF 20% 16V	
C270	1-164-346-11	CERAMIC CHIP	1uF 16V	C522	1-124-589-11	ELECT 47uF 20% 16V	
C271	1-164-346-11	CERAMIC CHIP	1uF 16V	C523	1-163-104-00	CERAMIC CHIP 30PF 5% 50V	
C272	1-124-589-11	ELECT	47uF 20% 16V	C524	1-163-104-00	CERAMIC CHIP 30PF 5% 50V	
C273	1-163-129-00	CERAMIC CHIP	330PF 5% 50V	C525	1-126-176-11	ELECT 220uF 20% 10V	
C274	1-163-129-00	CERAMIC CHIP	330PF 5% 50V	C526	1-126-157-11	ELECT 10uF 20% 16V	
C275	1-163-141-00	CERAMIC CHIP	0.001uF 5% 50V	C527	1-164-004-11	CERAMIC CHIP 0.1uF 10% 25V	
C276	1-163-141-00	CERAMIC CHIP	0.001uF 5% 50V	C528	1-164-004-11	CERAMIC CHIP 0.1uF 10% 25V	
C279	1-126-163-11	ELECT	4.7uF 20% 50V	C529	1-124-234-00	ELECT 22uF 20% 16V	
C280	1-164-232-11	CERAMIC CHIP	0.01uF 50V	C530	1-163-141-00	CERAMIC CHIP 0.001uF 5% 50V	
C331	1-163-123-00	CERAMIC CHIP	180PF 5% 50V	C531	1-163-141-00	CERAMIC CHIP 0.001uF 5% 50V	
C332	1-163-123-00	CERAMIC CHIP	180PF 5% 50V	C532	1-164-004-11	CERAMIC CHIP 0.1uF 10% 25V	

DSP

PANEL

Ref. No.	Part No.	Description	Remark
C1201	1-163-005-11	CERAMIC CHIP 470PF 10%	50V
C1202	1-164-161-11	CERAMIC CHIP 0.0022uF 10%	100V
C1251	1-163-005-11	CERAMIC CHIP 470PF 10%	50V
C1252	1-164-161-11	CERAMIC CHIP 0.0022uF 10%	100V
C1270	1-163-117-00	CERAMIC CHIP 100PF 5%	50V
C1271	1-163-117-00	CERAMIC CHIP 100PF 5%	50V
C1272	1-164-232-11	CERAMIC CHIP 0.01uF	50V
C1273	1-164-232-11	CERAMIC CHIP 0.01uF	50V
C1301	1-164-004-11	CERAMIC CHIP 0.1uF 10%	25V
C1302	1-164-004-11	CERAMIC CHIP 0.1uF 10%	25V
< CONNECTOR >			
* CN501	1-568-318-11	PLUG, CONNECTOR 6P	
* CN504	1-568-320-11	PLUG, CONNECTOR 8P	
CNJ102	1-568-319-11	SOCKET, CONNECTOR 8P	
CNP101	1-566-144-11	CONNECTOR, BOARD TO BOARD 16P	
CNP103	1-573-146-11	PLUG, CONNECTOR 8P	
* CNP104	1-564-509-11	PLUG, CONNECTOR 6P	
* CNP105	1-564-521-11	PLUG, CONNECTOR 6P	
* CNP502	1-568-320-11	PLUG, CONNECTOR 8P	
CNP503	1-561-115-00	SOCKET, CONNECTOR 6P	
< DIODE >			
D100	8-719-800-76	DIODE 1SS226	
D101	8-719-800-76	DIODE 1SS226	
D103	8-719-800-76	DIODE 1SS226	
D106	8-719-002-81	DIODE 1T363	
D107	8-719-002-81	DIODE 1T363	
D108	8-719-002-81	DIODE 1T363	
D109	8-719-002-81	DIODE 1T363	
D110	8-719-990-39	DIODE DCB010	
D111	8-719-990-39	DIODE DCB010	
D112	8-719-990-39	DIODE DCB010	
D113	8-719-990-39	DIODE DCB010	
D331	8-719-990-39	DIODE DCB010	
D333	8-719-210-39	DIODE EC10QS-04	
D334	8-719-021-49	DIODE UZM6. 2X	
D501	8-719-422-46	DIODE MA8056	
D502	8-719-990-39	DIODE DCB010	
D503	8-719-990-39	DIODE DCB010	
D504	8-719-301-39	LED SEL2210S (PHONO)	
D505	8-719-301-39	LED SEL2210S (CD)	
D506	8-719-301-39	LED SEL2210S (TAPE)	
D507	8-719-301-39	LED SEL2210S (VIDEO2)	
D508	8-719-301-39	LED SEL2210S (VIDEO1)	
D509	8-719-301-39	LED SEL2210S (WAKE UP VOL SET)	
D510	8-719-301-39	LED SEL2210S (ON/STANDBY)	
D511	8-719-301-39	LED SEL2210S (TUNER)	
D512	8-719-301-39	LED SEL2210S (DAT)	

Ref. No.	Part No.	Description	Remark
D514	8-719-301-44	LED SEL2410E-D (VIDEO2)	
D515	8-719-301-44	LED SEL2410E-D (VIDEO1)	
D521	8-719-422-46	DIODE MA8056	
D522	8-719-422-46	DIODE MA8056	
D523	8-719-990-39	DIODE DCB010	
D1201	8-719-800-76	DIODE 1SS226	
D1251	8-719-800-76	DIODE 1SS226	
D1270	8-719-990-39	DIODE DCB010	
< TRANSISTOR >			
FET1201	8-729-232-69	TRANSISTOR 2SK208GR3	
FET1251	8-729-232-69	TRANSISTOR 2SK208GR3	
< FLUORESCENT INDICATOR >			
FL501	1-519-654-11	INDICATOR TUBE, FLUORESCENT	
< IC >			
IC101	8-759-635-26	IC M5283P	
IC102	8-759-045-15	IC CS5339-KS	
IC103	8-759-805-14	IC LC7822	
IC104	8-759-805-14	IC LC7822	
IC106	8-759-511-68	IC CXD8245M	
IC108	8-752-339-86	IC CXD2557M	
IC109	8-759-059-84	IC M37450M8-514FP	
IC110	8-759-973-04	IC MSM41464-10RS	
IC111	8-752-341-99	IC CXD2701Q	
IC112	8-752-332-80	IC CXD1160AQ	
IC113	8-759-636-55	IC M5218AFP	
IC114	8-759-636-55	IC M5218AFP	
IC115	8-759-636-55	IC M5218AFP	
IC116	8-759-636-55	IC M5218AFP	
IC117	8-759-636-55	IC M5218AFP	
IC118	8-759-636-55	IC M5218AFP	
IC119	8-759-636-55	IC M5218AFP	
IC120	8-759-636-55	IC M5218AFP	
IC121	8-759-908-17	IC TL082CPS	
IC122	8-759-982-44	IC RC79L05A	
IC123	8-759-054-64	IC CXD2905AQ	
IC124	8-759-517-14	IC MB625473PF-G	
IC125	8-759-982-21	IC RC78L05A	
IC331	8-752-349-01	IC CXD2561AM	
IC332	8-752-342-65	IC CXD2560M	
IC333	8-759-234-20	IC TC7S08F	
IC501	8-759-512-46	IC MSC7162	
IC502	8-759-512-45	IC SN755731	
IC503	8-759-512-45	IC SN755731	
IC504	8-759-512-46	IC MSC7162	
IC505	8-759-512-47	IC SN755721	

DSP

PANEL

Ref. No.	Part No.	Description	Remark	Ref. No.	Part No.	Description	Remark
IC506	8-759-059-82	IC TMP90CM40F-2611		Q505	8-729-602-36	TRANSISTOR 2SA1602	
IC507	8-759-605-16	IC M51953BL		Q506	8-729-805-41	TRANSISTOR 2SC3398	
IC508	8-759-059-83	IC MC68HC11L6SC400618FU		Q507	8-729-602-21	TRANSISTOR 2SC4154	
IC509	8-759-512-48	IC XR-1092		Q508	8-729-602-21	TRANSISTOR 2SC4154	
		< COIL >		Q509	8-729-602-21	TRANSISTOR 2SC4154	
L100	1-410-397-21	FERRITE BEAD INDUCTOR		Q510	8-729-602-21	TRANSISTOR 2SC4154	
L102	1-406-416-11	COIL (OSC)		Q511	8-729-602-21	TRANSISTOR 2SC4154	
L260	1-412-390-21	INDUCTOR CHIP 0uH		Q512	8-729-602-21	TRANSISTOR 2SC4154	
L262	1-412-390-21	INDUCTOR CHIP 0uH		Q513	8-729-602-21	TRANSISTOR 2SC4154	
L333	1-412-390-21	INDUCTOR CHIP 0uH		Q514	8-729-602-21	TRANSISTOR 2SC4154	
L399	1-410-369-11	INDUCTOR CHIP 1uH		Q515	8-729-602-21	TRANSISTOR 2SC4154	
		< TRANSISTOR >		Q516	8-729-602-21	TRANSISTOR 2SC4154	
Q100	8-729-107-46	TRANSISTOR 2SC3624A-L15		Q517	8-729-602-21	TRANSISTOR 2SC4154	
Q101	8-729-107-46	TRANSISTOR 2SC3624A-L15		Q1201	8-729-602-21	TRANSISTOR 2SC4154	
Q102	8-729-107-46	TRANSISTOR 2SC3624A-L15		Q1251	8-729-602-21	TRANSISTOR 2SC4154	
Q103	8-729-107-46	TRANSISTOR 2SC3624A-L15				< RESISTOR >	
Q104	8-729-107-46	TRANSISTOR 2SC3624A-L15		R101	1-216-081-00	METAL CHIP 22K 5% 1/10W	
Q105	8-729-107-46	TRANSISTOR 2SC3624A-L15		R103	1-216-025-00	METAL CHIP 100 5% 1/10W	
Q106	8-729-805-65	TRANSISTOR 2SA1344		R104	1-216-025-00	METAL CHIP 100 5% 1/10W	
Q107	8-729-805-65	TRANSISTOR 2SA1344		R105	1-216-088-00	METAL CHIP 43K 5% 1/10W	
Q108	8-729-805-65	TRANSISTOR 2SA1344		R108	1-216-025-00	METAL CHIP 100 5% 1/10W	
Q109	8-729-602-21	TRANSISTOR 2SC4154		R109	1-216-025-00	METAL CHIP 100 5% 1/10W	
Q110	8-729-805-65	TRANSISTOR 2SA1344		R110	1-216-041-00	METAL CHIP 470 5% 1/10W	
Q111	8-729-805-65	TRANSISTOR 2SA1344		R111	1-216-041-00	METAL CHIP 470 5% 1/10W	
Q112	8-729-107-46	TRANSISTOR 2SC3624A-L15		R112	1-216-041-00	METAL CHIP 470 5% 1/10W	
Q113	8-729-107-46	TRANSISTOR 2SC3624A-L15		R113	1-216-041-00	METAL CHIP 470 5% 1/10W	
Q114	8-729-107-46	TRANSISTOR 2SC3624A-L15		R115	1-216-041-00	METAL CHIP 470 5% 1/10W	
Q115	8-729-805-41	TRANSISTOR 2SC3398		R116	1-216-041-00	METAL CHIP 470 5% 1/10W	
Q116	8-729-602-21	TRANSISTOR 2SC4154		R117	1-216-041-00	METAL CHIP 470 5% 1/10W	
Q117	8-729-602-21	TRANSISTOR 2SC4154		R118	1-216-041-00	METAL CHIP 470 5% 1/10W	
Q118	8-729-805-41	TRANSISTOR 2SC3398		R126	1-216-071-00	METAL CHIP 8.2K 5% 1/10W	
Q123	8-729-805-65	TRANSISTOR 2SA1344		R127	1-216-049-00	METAL CHIP 1K 5% 1/10W	
Q124	8-729-107-46	TRANSISTOR 2SC3624A-L15		R128	1-216-067-00	METAL CHIP 5.6K 5% 1/10W	
Q125	8-729-602-36	TRANSISTOR 2SA1602		R129	1-216-065-00	METAL CHIP 4.7K 5% 1/10W	
Q126	8-729-805-65	TRANSISTOR 2SA1344		R130	1-216-113-00	METAL CHIP 470K 5% 1/10W	
Q127	8-729-805-41	TRANSISTOR 2SC3398		R131	1-216-053-00	METAL CHIP 1.5K 5% 1/10W	
Q128	8-729-107-46	TRANSISTOR 2SC3624A-L15		R132	1-216-061-00	METAL CHIP 3.3K 5% 1/10W	
Q129	8-729-107-46	TRANSISTOR 2SC3624A-L15		R133	1-216-113-00	METAL CHIP 470K 5% 1/10W	
Q130	8-729-805-65	TRANSISTOR 2SA1344		R134	1-216-043-00	METAL CHIP 560 5% 1/10W	
Q132	8-729-805-65	TRANSISTOR 2SA1344		R135	1-216-057-00	METAL CHIP 2.2K 5% 1/10W	
Q331	8-729-805-41	TRANSISTOR 2SC3398		R136	1-216-113-00	METAL CHIP 470K 5% 1/10W	
Q332	8-729-805-65	TRANSISTOR 2SA1344		R137	1-216-051-00	METAL CHIP 1.2K 5% 1/10W	
Q333	8-729-205-97	TRANSISTOR 2SC3668-Y		R138	1-216-065-00	METAL CHIP 4.7K 5% 1/10W	
Q501	8-729-602-36	TRANSISTOR 2SA1602		R139	1-216-065-00	METAL CHIP 4.7K 5% 1/10W	
Q502	8-729-602-21	TRANSISTOR 2SC4154		R140	1-216-065-00	METAL CHIP 4.7K 5% 1/10W	
Q503	8-729-805-65	TRANSISTOR 2SA1344		R141	1-216-097-00	METAL CHIP 100K 5% 1/10W	
Q504	8-729-805-65	TRANSISTOR 2SA1344		R142	1-216-097-00	METAL CHIP 100K 5% 1/10W	
				R143	1-216-097-00	METAL CHIP 100K 5% 1/10W	

DSP

PANEL

Ref. No.	Part No.	Description	Remark		
R146	1-216-073-00	METAL CHIP	10K	5%	1/10W
R147	1-216-065-00	METAL CHIP	4.7K	5%	1/10W
R148	1-216-073-00	METAL CHIP	10K	5%	1/10W
R149	1-216-073-00	METAL CHIP	10K	5%	1/10W
R150	1-216-097-00	METAL CHIP	100K	5%	1/10W
R151	1-216-065-00	METAL CHIP	4.7K	5%	1/10W
R152	1-216-089-00	METAL CHIP	47K	5%	1/10W
R153	1-216-065-00	METAL CHIP	4.7K	5%	1/10W
R154	1-216-089-00	METAL CHIP	47K	5%	1/10W
R155	1-216-049-00	METAL CHIP	1K	5%	1/10W
R156	1-216-081-00	METAL CHIP	22K	5%	1/10W
R157	1-216-103-00	METAL CHIP	180K	5%	1/10W
R158	1-216-081-00	METAL CHIP	22K	5%	1/10W
R159	1-216-073-00	METAL CHIP	10K	5%	1/10W
R160	1-216-077-00	METAL CHIP	15K	5%	1/10W
R161	1-216-079-00	METAL CHIP	18K	5%	1/10W
R162	1-216-097-00	METAL CHIP	100K	5%	1/10W
R163	1-216-049-00	METAL CHIP	1K	5%	1/10W
R164	1-216-081-00	METAL CHIP	22K	5%	1/10W
R165	1-216-103-00	METAL CHIP	180K	5%	1/10W
R166	1-216-081-00	METAL CHIP	22K	5%	1/10W
R167	1-216-073-00	METAL CHIP	10K	5%	1/10W
R168	1-216-077-00	METAL CHIP	15K	5%	1/10W
R169	1-216-079-00	METAL CHIP	18K	5%	1/10W
R170	1-216-097-00	METAL CHIP	100K	5%	1/10W
R171	1-216-089-00	METAL CHIP	47K	5%	1/10W
R172	1-216-089-00	METAL CHIP	47K	5%	1/10W
R173	1-216-089-00	METAL CHIP	47K	5%	1/10W
R174	1-216-071-00	METAL CHIP	8.2K	5%	1/10W
R175	1-216-089-00	METAL CHIP	47K	5%	1/10W
R176	1-216-041-00	METAL CHIP	470	5%	1/10W
R177	1-216-097-00	METAL CHIP	100K	5%	1/10W
R178	1-216-025-00	METAL CHIP	100	5%	1/10W
R179	1-216-073-00	METAL CHIP	10K	5%	1/10W
R180	1-216-033-00	METAL CHIP	220	5%	1/10W
R181	1-216-033-00	METAL CHIP	220	5%	1/10W
R182	1-216-113-00	METAL CHIP	470K	5%	1/10W
R183	1-216-079-00	METAL CHIP	18K	5%	1/10W
R184	1-216-047-00	METAL CHIP	820	5%	1/10W
R185	1-216-081-00	METAL CHIP	22K	5%	1/10W
R186	1-216-689-11	METAL CHIP	39K	0.5%	1/10W
R187	1-216-093-00	METAL CHIP	68K	5%	1/10W
R188	1-216-109-00	METAL CHIP	330K	5%	1/10W
R189	1-216-105-00	METAL CHIP	220K	5%	1/10W
R190	1-216-117-00	METAL CHIP	680K	5%	1/10W
R192	1-216-097-00	METAL CHIP	100K	5%	1/10W
R193	1-216-097-00	METAL CHIP	100K	5%	1/10W
R194	1-216-081-00	METAL CHIP	22K	5%	1/10W
R197	1-216-073-00	METAL CHIP	10K	5%	1/10W

Ref. No.	Part No.	Description	Remark		
R198	1-216-113-00	METAL CHIP	470K	5%	1/10W
R199	1-216-079-00	METAL CHIP	18K	5%	1/10W
R200	1-216-047-00	METAL CHIP	820	5%	1/10W
R201	1-216-081-00	METAL CHIP	22K	5%	1/10W
R202	1-216-689-11	METAL CHIP	39K	0.5%	1/10W
R203	1-216-093-00	METAL CHIP	68K	5%	1/10W
R204	1-216-109-00	METAL CHIP	330K	5%	1/10W
R205	1-216-105-00	METAL CHIP	220K	5%	1/10W
R206	1-216-117-00	METAL CHIP	680K	5%	1/10W
R208	1-216-097-00	METAL CHIP	100K	5%	1/10W
R209	1-216-097-00	METAL CHIP	100K	5%	1/10W
R210	1-216-081-00	METAL CHIP	22K	5%	1/10W
R213	1-216-049-00	METAL CHIP	1K	5%	1/10W
R214	1-216-049-00	METAL CHIP	1K	5%	1/10W
R215	1-216-049-00	METAL CHIP	1K	5%	1/10W
R216	1-216-033-00	METAL CHIP	220	5%	1/10W
R217	1-216-033-00	METAL CHIP	220	5%	1/10W
R226	1-216-071-00	METAL CHIP	8.2K	5%	1/10W
R227	1-216-049-00	METAL CHIP	1K	5%	1/10W
R228	1-216-067-00	METAL CHIP	5.6K	5%	1/10W
R229	1-216-065-00	METAL CHIP	4.7K	5%	1/10W
R230	1-216-113-00	METAL CHIP	470K	5%	1/10W
R231	1-216-053-00	METAL CHIP	1.5K	5%	1/10W
R232	1-216-061-00	METAL CHIP	3.3K	5%	1/10W
R233	1-216-113-00	METAL CHIP	470K	5%	1/10W
R234	1-216-043-00	METAL CHIP	560	5%	1/10W
R235	1-216-057-00	METAL CHIP	2.2K	5%	1/10W
R236	1-216-113-00	METAL CHIP	470K	5%	1/10W
R237	1-216-051-00	METAL CHIP	1.2K	5%	1/10W
R238	1-216-065-00	METAL CHIP	4.7K	5%	1/10W
R239	1-216-065-00	METAL CHIP	4.7K	5%	1/10W
R240	1-216-065-00	METAL CHIP	4.7K	5%	1/10W
R241	1-216-073-00	METAL CHIP	10K	5%	1/10W
R242	1-216-097-00	METAL CHIP	100K	5%	1/10W
R243	1-216-097-00	METAL CHIP	100K	5%	1/10W
R250	1-216-037-00	METAL CHIP	330	5%	1/10W
R251	1-216-065-00	METAL CHIP	4.7K	5%	1/10W
R252	1-216-057-00	METAL CHIP	2.2K	5%	1/10W
R253	1-216-077-00	METAL CHIP	15K	5%	1/10W
R254	1-216-073-00	METAL CHIP	10K	5%	1/10W
R255	1-216-097-00	METAL CHIP	100K	5%	1/10W
R256	1-216-025-00	METAL CHIP	100	5%	1/10W
R257	1-216-025-00	METAL CHIP	100	5%	1/10W
R258	1-216-041-00	METAL CHIP	470	5%	1/10W
R259	1-216-041-00	METAL CHIP	470	5%	1/10W
R261	1-216-017-00	METAL CHIP	47	5%	1/10W
R264	1-216-089-00	METAL CHIP	47K	5%	1/10W
R265	1-216-089-00	METAL CHIP	47K	5%	1/10W
R266	1-216-121-00	METAL CHIP	1M	5%	1/10W

DSP	PANEL
-----	-------

Ref. No.	Part No.	Description	Remark			Ref. No.	Part No.	Description	Remark		
R267	1-216-121-00	METAL CHIP	1M	5%	1/10W	R336	1-216-075-00	METAL CHIP	12K	5%	1/10W
R268	1-216-025-00	METAL CHIP	100	5%	1/10W	R337	1-216-061-00	METAL CHIP	3.3K	5%	1/10W
R269	1-216-025-00	METAL CHIP	100	5%	1/10W	R338	1-216-061-00	METAL CHIP	3.3K	5%	1/10W
R272	1-216-113-00	METAL CHIP	470K	5%	1/10W	R339	1-216-071-00	METAL CHIP	8.2K	5%	1/10W
R274	1-216-041-00	METAL CHIP	470	5%	1/10W	R340	1-216-071-00	METAL CHIP	8.2K	5%	1/10W
R275	1-216-025-00	METAL CHIP	100	5%	1/10W	R341	1-216-071-00	METAL CHIP	8.2K	5%	1/10W
R276	1-216-025-00	METAL CHIP	100	5%	1/10W	R342	1-216-071-00	METAL CHIP	8.2K	5%	1/10W
R277	1-216-049-00	METAL CHIP	1K	5%	1/10W	R343	1-216-071-00	METAL CHIP	8.2K	5%	1/10W
R279	1-216-079-00	METAL CHIP	18K	5%	1/10W	R344	1-216-071-00	METAL CHIP	8.2K	5%	1/10W
R280	1-216-025-00	METAL CHIP	100	5%	1/10W	R345	1-216-071-00	METAL CHIP	8.2K	5%	1/10W
R281	1-216-025-00	METAL CHIP	100	5%	1/10W	R346	1-216-071-00	METAL CHIP	8.2K	5%	1/10W
R282	1-216-025-00	METAL CHIP	100	5%	1/10W	R347	1-216-065-00	METAL CHIP	4.7K	5%	1/10W
R283	1-216-025-00	METAL CHIP	100	5%	1/10W	R348	1-216-088-00	METAL CHIP	43K	5%	1/10W
R284	1-216-033-00	METAL CHIP	220	5%	1/10W	R349	1-216-129-00	METAL CHIP	2.2M	5%	1/10W
R285	1-216-025-00	METAL CHIP	100	5%	1/10W	R350	1-216-081-00	METAL CHIP	22K	5%	1/10W
R286	1-216-001-00	METAL CHIP	10	5%	1/10W	R352	1-216-083-00	METAL CHIP	27K	5%	1/10W
R287	1-216-089-00	METAL CHIP	47K	5%	1/10W	R353	1-216-088-00	METAL CHIP	43K	5%	1/10W
R288	1-216-089-00	METAL CHIP	47K	5%	1/10W	R354	1-216-089-00	METAL CHIP	47K	5%	1/10W
R289	1-216-033-00	METAL CHIP	220	5%	1/10W	R355	1-216-033-00	METAL CHIP	220	5%	1/10W
R290	1-216-033-00	METAL CHIP	220	5%	1/10W	R358	1-216-057-00	METAL CHIP	2.2K	5%	1/10W
R291	1-216-073-00	METAL CHIP	10K	5%	1/10W	R359	1-216-129-00	METAL CHIP	2.2M	5%	1/10W
R292	1-216-079-00	METAL CHIP	18K	5%	1/10W	R360	1-216-001-00	METAL CHIP	10	5%	1/10W
R293	1-216-073-00	METAL CHIP	10K	5%	1/10W	R364	1-216-033-00	METAL CHIP	220	5%	1/10W
R294	1-216-025-00	METAL CHIP	100	5%	1/10W	R398	1-216-076-00	METAL CHIP	13K	5%	1/10W
R295	1-216-121-00	METAL CHIP	1M	5%	1/10W	R399	1-216-076-00	METAL CHIP	13K	5%	1/10W
R296	1-216-121-00	METAL CHIP	1M	5%	1/10W	R501	1-216-121-00	METAL CHIP	1M	5%	1/10W
R297	1-216-097-00	METAL CHIP	100K	5%	1/10W	R502	1-216-071-00	METAL CHIP	8.2K	5%	1/10W
R298	1-216-097-00	METAL CHIP	100K	5%	1/10W	R503	1-216-055-00	METAL CHIP	1.8K	5%	1/10W
R301	1-216-025-00	METAL CHIP	100	5%	1/10W	R504	1-216-073-00	METAL CHIP	10K	5%	1/10W
R302	1-216-025-00	METAL CHIP	100	5%	1/10W	R505	1-216-081-00	METAL CHIP	22K	5%	1/10W
R306	1-216-097-00	METAL CHIP	100K	5%	1/10W	R506	1-216-081-00	METAL CHIP	22K	5%	1/10W
R307	1-216-017-00	METAL CHIP	47	5%	1/10W	R507	1-216-073-00	METAL CHIP	10K	5%	1/10W
R308	1-216-041-00	METAL CHIP	470	5%	1/10W	R508	1-216-081-00	METAL CHIP	22K	5%	1/10W
R309	1-216-073-00	METAL CHIP	10K	5%	1/10W	R511	1-216-081-00	METAL CHIP	22K	5%	1/10W
R310	1-216-073-00	METAL CHIP	10K	5%	1/10W	R514	1-216-081-00	METAL CHIP	22K	5%	1/10W
R311	1-216-073-00	METAL CHIP	10K	5%	1/10W	R516	1-216-073-00	METAL CHIP	10K	5%	1/10W
R312	1-216-073-00	METAL CHIP	10K	5%	1/10W	R518	1-216-073-00	METAL CHIP	10K	5%	1/10W
R313	1-216-073-00	METAL CHIP	10K	5%	1/10W	R520	1-216-089-00	METAL CHIP	47K	5%	1/10W
R314	1-216-073-00	METAL CHIP	10K	5%	1/10W	R521	1-216-025-00	METAL CHIP	100	5%	1/10W
R317	1-216-025-00	METAL CHIP	100	5%	1/10W	R522	1-216-025-00	METAL CHIP	100	5%	1/10W
R318	1-216-295-00	METAL CHIP	0	5%	1/10W	R523	1-216-121-00	METAL CHIP	1M	5%	1/10W
R319	1-216-113-00	METAL CHIP	470K	5%	1/10W	R524	1-216-025-00	METAL CHIP	100	5%	1/10W
R321	1-216-121-00	METAL CHIP	1M	5%	1/10W	R525	1-216-025-00	METAL CHIP	100	5%	1/10W
R330	1-216-089-00	METAL CHIP	47K	5%	1/10W	R526	1-216-025-00	METAL CHIP	100	5%	1/10W
R331	1-216-075-00	METAL CHIP	12K	5%	1/10W	R527	1-216-025-00	METAL CHIP	100	5%	1/10W
R332	1-216-075-00	METAL CHIP	12K	5%	1/10W	R528	1-216-025-00	METAL CHIP	100	5%	1/10W
R333	1-216-061-00	METAL CHIP	3.3K	5%	1/10W	R529	1-216-025-00	METAL CHIP	100	5%	1/10W
R334	1-216-061-00	METAL CHIP	3.3K	5%	1/10W	R530	1-216-025-00	METAL CHIP	100	5%	1/10W
R335	1-216-075-00	METAL CHIP	12K	5%	1/10W	R531	1-216-025-00	METAL CHIP	100	5%	1/10W

DSP	PANEL
-----	-------

Ref. No.	Part No.	Description	Remark		
R532	1-216-025-00	METAL CHIP	100	5%	1/10W
R534	1-216-073-00	METAL CHIP	10K	5%	1/10W
R535	1-216-025-00	METAL CHIP	100	5%	1/10W
R536	1-216-025-00	METAL CHIP	100	5%	1/10W
R537	1-216-025-00	METAL CHIP	100	5%	1/10W
R538	1-216-025-00	METAL CHIP	100	5%	1/10W
R539	1-216-025-00	METAL CHIP	100	5%	1/10W
R540	1-216-053-00	METAL CHIP	1.5K	5%	1/10W
R541	1-216-053-00	METAL CHIP	1.5K	5%	1/10W
R542	1-216-025-00	METAL CHIP	100	5%	1/10W
R543	1-216-025-00	METAL CHIP	100	5%	1/10W
R544	1-216-027-00	METAL CHIP	120	5%	1/10W
R545	1-216-027-00	METAL CHIP	120	5%	1/10W
R546	1-216-027-00	METAL CHIP	120	5%	1/10W
R547	1-216-027-00	METAL CHIP	120	5%	1/10W
R548	1-216-029-00	METAL CHIP	150	5%	1/10W
R549	1-216-029-00	METAL CHIP	150	5%	1/10W
R550	1-216-063-00	METAL CHIP	3.9K	5%	1/10W
R551	1-216-063-00	METAL CHIP	3.9K	5%	1/10W
R552	1-216-057-00	METAL CHIP	2.2K	5%	1/10W
R553	1-216-057-00	METAL CHIP	2.2K	5%	1/10W
R554	1-216-063-00	METAL CHIP	3.9K	5%	1/10W
R555	1-216-063-00	METAL CHIP	3.9K	5%	1/10W
R556	1-216-075-00	METAL CHIP	12K	5%	1/10W
R557	1-216-075-00	METAL CHIP	12K	5%	1/10W
R558	1-216-025-00	METAL CHIP	100	5%	1/10W
R560	1-216-027-00	METAL CHIP	120	5%	1/10W
R561	1-216-027-00	METAL CHIP	120	5%	1/10W
R562	1-216-021-00	METAL CHIP	68	5%	1/10W
R563	1-216-021-00	METAL CHIP	68	5%	1/10W
R564	1-216-021-00	METAL CHIP	68	5%	1/10W
R565	1-216-027-00	METAL CHIP	120	5%	1/10W
R566	1-216-027-00	METAL CHIP	120	5%	1/10W
R567	1-216-049-00	METAL CHIP	1K	5%	1/10W
R568	1-216-073-00	METAL CHIP	10K	5%	1/10W
R569	1-216-049-00	METAL CHIP	1K	5%	1/10W
R570	1-216-025-00	METAL CHIP	100	5%	1/10W
R572	1-216-025-00	METAL CHIP	100	5%	1/10W
R573	1-216-025-00	METAL CHIP	100	5%	1/10W
R574	1-216-069-00	METAL CHIP	6.8K	5%	1/10W
R575	1-216-089-00	METAL CHIP	47K	5%	1/10W
R577	1-216-073-00	METAL CHIP	10K	5%	1/10W
R578	1-216-073-00	METAL CHIP	10K	5%	1/10W
R579	1-216-073-00	METAL CHIP	10K	5%	1/10W
R580	1-216-025-00	METAL CHIP	100	5%	1/10W
R581	1-216-025-00	METAL CHIP	100	5%	1/10W
R582	1-216-073-00	METAL CHIP	10K	5%	1/10W
R583	1-216-049-00	METAL CHIP	1K	5%	1/10W
R584	1-216-049-00	METAL CHIP	1K	5%	1/10W

Ref. No.	Part No.	Description	Remark		
R585	1-216-049-00	METAL CHIP	1K	5%	1/10W
R586	1-216-049-00	METAL CHIP	1K	5%	1/10W
R587	1-216-049-00	METAL CHIP	1K	5%	1/10W
R588	1-216-049-00	METAL CHIP	1K	5%	1/10W
R589	1-216-049-00	METAL CHIP	1K	5%	1/10W
R590	1-216-049-00	METAL CHIP	1K	5%	1/10W
R591	1-216-019-00	METAL CHIP	56	5%	1/10W
R592	1-216-019-00	METAL CHIP	56	5%	1/10W
R593	1-216-019-00	METAL CHIP	56	5%	1/10W
R594	1-216-073-00	METAL CHIP	10K	5%	1/10W
R621	1-216-049-00	METAL CHIP	1K	5%	1/10W
R622	1-216-049-00	METAL CHIP	1K	5%	1/10W
R623	1-216-081-00	METAL CHIP	22K	5%	1/10W
R1201	1-216-065-00	METAL CHIP	4.7K	5%	1/10W
R1203	1-216-093-00	METAL CHIP	68K	5%	1/10W
R1204	1-216-689-11	METAL CHIP	39K	0.5%	1/10W
R1205	1-216-081-00	METAL CHIP	22K	5%	1/10W
R1206	1-216-077-00	METAL CHIP	15K	5%	1/10W
R1207	1-216-073-00	METAL CHIP	10K	5%	1/10W
R1208	1-216-069-00	METAL CHIP	6.8K	5%	1/10W
R1209	1-216-121-00	METAL CHIP	1M	5%	1/10W
R1210	1-216-097-00	METAL CHIP	100K	5%	1/10W
R1211	1-216-073-00	METAL CHIP	10K	5%	1/10W
R1212	1-216-097-00	METAL CHIP	100K	5%	1/10W
R1213	1-216-113-00	METAL CHIP	470K	5%	1/10W
R1251	1-216-065-00	METAL CHIP	4.7K	5%	1/10W
R1253	1-216-093-00	METAL CHIP	68K	5%	1/10W
R1254	1-216-689-11	METAL CHIP	39K	0.5%	1/10W
R1255	1-216-081-00	METAL CHIP	22K	5%	1/10W
R1256	1-216-077-00	METAL CHIP	15K	5%	1/10W
R1257	1-216-073-00	METAL CHIP	10K	5%	1/10W
R1258	1-216-069-00	METAL CHIP	6.8K	5%	1/10W
R1259	1-216-121-00	METAL CHIP	1M	5%	1/10W
R1260	1-216-097-00	METAL CHIP	100K	5%	1/10W
R1261	1-216-109-00	METAL CHIP	330K	5%	1/10W
R1262	1-216-109-00	METAL CHIP	330K	5%	1/10W
R1263	1-216-113-00	METAL CHIP	470K	5%	1/10W
R1270	1-216-073-00	METAL CHIP	10K	5%	1/10W
R1301	1-216-049-00	METAL CHIP	1K	5%	1/10W
R1302	1-216-049-00	METAL CHIP	1K	5%	1/10W
R1303	1-216-049-00	METAL CHIP	1K	5%	1/10W
R3556	1-216-033-00	METAL CHIP	220	5%	1/10W
< SWITCH >					
S501	1-554-303-21	SWITCH, TACTILE (SYSTEM POWER)			
S502	1-554-303-21	SWITCH, TACTILE (DISPLAY)			
S503	1-554-303-21	SWITCH, TACTILE (DSP)			
S504	1-554-303-21	SWITCH, TACTILE (WAKE UP VOL SET)			
S505	1-554-303-21	SWITCH, TACTILE (BALANCE)			

DSP

PANEL

ELECT CAPACITOR

FLD

POWER AMPLIFIER

SPEAKER

TRANSFORMER (A)

TRANSFORMER (B)

VOL

Ref. No.	Part No.	Description	Remark	Ref. No.	Part No.	Description	Remark
S506	1-554-303-21	SWITCH, TACTILE (PRESET)		C712	1-164-159-11	CERAMIC	0.1uF 50V
S507	1-554-303-21	SWITCH, TACTILE (PARAMETRIC EQUALIZER)		C801	1-124-907-11	ELECT	10uF 20% 50V
S508	1-554-303-21	SWITCH, TACTILE (DYNAMIC SOUND)		C802	1-162-294-31	CERAMIC	0.001uF 10% 50V
S509	1-554-303-21	SWITCH, TACTILE (PRESENCE SURROUND)				(AEP, UK)	
S510	1-554-303-21	SWITCH, TACTILE (ON/OFF)		C803	1-162-282-31	CERAMIC	100PF 10% 50V
				C804	1-124-927-11	ELECT	4.7uF 20% 100V
S511	1-554-303-21	SWITCH, TACTILE (AI BC)		C806	1-136-165-00	FILM	0.1uF 5% 50V
S512	1-554-303-21	SWITCH, TACTILE (MEMORY)		C807	1-136-165-00	FILM	0.1uF 5% 50V
S513	1-554-303-21	SWITCH, TACTILE (CURSOR CONTROL ◀)		C808	1-136-165-00	FILM	0.1uF 5% 50V
S514	1-554-303-21	SWITCH, TACTILE (CURSOR CONTROL ▲)		C809	1-136-165-00	FILM	0.1uF 5% 50V
S515	1-554-303-21	SWITCH, TACTILE (CURSOR CONTROL ▼)		C811	1-162-306-11	CERAMIC	0.01uF 20% 16V
S516	1-554-303-21	SWITCH, TACTILE (CURSOR CONTROL ▶)		C821	1-124-907-11	ELECT	10uF 20% 50V
S517	1-554-303-21	SWITCH, TACTILE (VIDEO FUNCTION)		C822	1-162-294-31	CERAMIC	0.001uF 10% 50V
S518	1-554-303-21	SWITCH, TACTILE (AUDIO FUNCTION)				(AEP, UK)	
		< VIBRATOR >		C823	1-162-282-31	CERAMIC	100PF 10% 50V
X100	1-578-667-11	VIBRATOR, CRYSTAL (49.152MHz)		C824	1-124-927-11	ELECT	4.7uF 20% 100V
X101	1-577-253-11	VIBRATOR, CERAMIC (16.93MHz)		C828	1-136-165-00	FILM	0.1uF 5% 50V
X102	1-579-125-11	VIBRATOR, CERAMIC (8MHz)		C829	1-136-165-00	FILM	0.1uF 5% 50V
X501	1-579-351-11	VIBRATOR, CERAMIC (15MHz)		C831	1-162-306-11	CERAMIC	0.01uF 20% 16V
X502	1-579-125-11	VIBRATOR, CERAMIC (8MHz)				(AEP, UK)	
		*****		C851	1-124-907-11	ELECT	10uF 20% 50V
*	1-642-420-11	ELECT CAPACITOR BOARD		C852	1-162-294-31	CERAMIC	0.001uF 10% 50V
		*****				(AEP, UK)	
*	A-4345-999-A	FLD BOARD, COMPLETE		C853	1-162-282-31	CERAMIC	100PF 10% 50V
		*****		C854	1-124-927-11	ELECT	4.7uF 20% 100V
*	A-4347-010-A	POWER AMPLIFIER BOARD, COMPLETE (AEP, UK)		C856	1-136-165-00	FILM	0.1uF 5% 50V
*	A-4347-013-A	POWER AMPLIFIER BOARD, COMPLETE (G, IT)		C857	1-136-165-00	FILM	0.1uF 5% 50V
		*****		C858	1-136-165-00	FILM	0.1uF 5% 50V
*	1-642-416-11	SPEAKER BOARD		C859	1-136-165-00	FILM	0.1uF 5% 50V
		*****		C861	1-162-306-11	CERAMIC	0.01uF 20% 16V
*	1-642-418-11	TRANSFORMER (A) BOARD		C871	1-124-907-11	ELECT	10uF 20% 50V
		*****		C872	1-162-294-31	CERAMIC	0.001uF 10% 50V
*	1-642-419-11	TRANSFORMER (B) BOARD				(AEP, UK)	
		*****		C873	1-162-282-31	CERAMIC	100PF 10% 50V
*	1-642-415-11	VOL BOARD		C874	1-124-927-11	ELECT	4.7uF 20% 100V
		*****		C878	1-136-165-00	FILM	0.1uF 5% 50V
		< CAPACITOR >		C879	1-136-165-00	FILM	0.1uF 5% 50V
C601	1-162-306-11	CERAMIC	0.01uF 20% 16V	C881	1-162-306-11	CERAMIC	0.01uF 20% 16V
C602	1-126-933-11	ELECT	100uF 20% 16V	C891	1-136-153-00	FILM	0.01uF 5% 50V (G, IT)
C603	1-124-915-11	ELECT	10uF 20% 63V	C892	1-136-153-00	FILM	0.01uF 5% 50V (G, IT)
C604	1-124-915-11	ELECT	10uF 20% 63V	C893	1-136-153-00	FILM	0.01uF 5% 50V (G, IT)
C701	1-126-176-11	ELECT	220uF 20% 10V	C894	1-136-153-00	FILM	0.01uF 5% 50V (G, IT)
C702	1-126-176-11	ELECT	220uF 20% 10V	C901	1-126-224-11	ELECT	4700uF 20% 42V
C704	1-162-306-11	CERAMIC	0.01uF 20% 16V	C902	1-126-224-11	ELECT	4700uF 20% 42V
C706	1-124-927-11	ELECT	4.7uF 20% 100V	C905	1-136-171-00	FILM	0.33uF 5% 50V
C707	1-126-101-11	ELECT	100uF 20% 16V	C906	1-136-171-00	FILM	0.33uF 5% 50V
C708	1-124-907-11	ELECT	10uF 20% 50V	C923	1-124-911-11	ELECT	220uF 20% 50V
C709	1-164-159-11	CERAMIC	0.1uF 50V	C924	1-124-911-11	ELECT	220uF 20% 50V
C710	1-124-910-11	ELECT	47uF 20% 50V	C925	1-124-122-11	ELECT	100uF 20% 50V
C711	1-164-159-11	CERAMIC	0.1uF 50V	C926	1-164-159-11	CERAMIC	0.1uF 50V

## ELECT CAPACITOR

## FLD

## POWER AMPLIFIER

## SPEAKER

## TRANSFORMER (A)

## TRANSFORMER (B)

## VOL

Ref. No.	Part No.	Description	Remark		
C941	1-162-294-31	CERAMIC	0.001uF	10%	50V
C942	1-162-294-31	CERAMIC	0.001uF	10%	50V
C943	1-162-294-31	CERAMIC	0.001uF	10%	50V
C944	1-162-294-31	CERAMIC	0.001uF	10%	50V
C1001	1-123-605-00	ELECT	100uF	20%	100V
C1002	1-124-667-11	ELECT	10uF	20%	100V
C1003	1-124-667-11	ELECT	10uF	20%	100V
C1004	1-124-667-11	ELECT	10uF	20%	100V
C1005	1-124-667-11	ELECT	10uF	20%	100V
< CONNECTOR >					
CN601	1-560-942-00	PIN, CONNECTOR 6P			
CN891	1-563-311-11	CONNECTOR, BOARD TO BOARD 10P			
* CN892	1-564-518-11	PLUG, CONNECTOR 3P			
CNJ603	1-569-656-11	HOUSING, CONNECTOR 8P			
CNJ604	1-573-147-11	HOUSING, CONNECTOR 12P			
CNJ902	1-573-095-11	SOCKET, CONNECTOR 15P			
* CNJ911	1-573-094-11	SOCKET, CONNECTOR 13P			
* CNJ912	1-573-094-11	SOCKET, CONNECTOR 13P			
CNP602	1-568-319-11	SOCKET, CONNECTOR 8P			
CNP605	1-564-507-11	PLUG, CONNECTOR 4P			
* CNP606	1-564-505-11	PLUG, CONNECTOR 2P			
* CNP801	1-564-521-11	PLUG, CONNECTOR 6P			
* CNP802	1-573-087-11	PIN, CONNECTOR 13P			
* CNP903	1-564-321-00	PIN, CONNECTOR 2P			
< DIODE >					
D601	8-719-987-63	DIODE	1N4148M		
D602	8-719-987-63	DIODE	1N4148M		
D701	8-719-987-63	DIODE	1N4148M		
D702	8-719-987-63	DIODE	1N4148M		
D703	8-719-987-63	DIODE	1N4148M		
D704	8-719-987-63	DIODE	1N4148M		
D705	8-719-987-63	DIODE	1N4148M		
D706	8-719-987-63	DIODE	1N4148M		
D801	8-719-987-63	DIODE	1N4148M		
D802	8-719-987-63	DIODE	1N4148M		
D821	8-719-987-63	DIODE	1N4148M		
D822	8-719-987-63	DIODE	1N4148M		
D851	8-719-987-63	DIODE	1N4148M		
D852	8-719-987-63	DIODE	1N4148M		
D871	8-719-987-63	DIODE	1N4148M		
D872	8-719-987-63	DIODE	1N4148M		
D915	8-719-200-82	DIODE	11ES2		
D916	8-719-200-82	DIODE	11ES2		
D917	8-719-934-22	DIODE	HZS30-2L		
D918	8-719-014-88	DIODE	UZP-6.8BC		
D1001	8-719-200-82	DIODE	11ES2		
D1002	8-719-200-82	DIODE	11ES2		

Ref. No.	Part No.	Description	Remark		
D1003	8-719-200-82	DIODE	11ES2		
D1004	8-719-200-82	DIODE	11ES2		
D1005	8-719-987-63	DIODE	1N4148M		
D1006	8-719-002-73	DIODE	UZL-36M		
D1007	8-719-002-73	DIODE	UZL-36M		
D1008	8-719-934-26	DIODE	HZS33-2L		
D1009	8-719-934-26	DIODE	HZS33-2L		
D1010	8-719-934-22	DIODE	HZS30-2L		
< IC >					
IC601	8-759-820-62	IC	LB1639		
IC701	8-759-111-68	IC	uPC1237HA		
IC702	8-759-987-16	IC	LM393P		
IC703	8-759-512-73	IC	LM35DZ-SL		
IC801	8-759-069-56	IC	LM3875-Q		
IC821	8-759-069-56	IC	LM3875-Q		
IC851	8-759-069-56	IC	LM3875-Q		
IC871	8-759-069-56	IC	LM3875-Q		
< JACK >					
J891	1-537-336-11	TERMINAL BOARD (SPEAKER)			
J892	1-573-110-11	JACK, PIN 2P (SURROUND SPEAKER)			
< COIL >					
* L801	1-420-872-00	COIL, AIR CORE			
* L821	1-420-872-00	COIL, AIR CORE			
* L851	1-420-872-00	COIL, AIR CORE			
* L871	1-420-872-00	COIL, AIR CORE			
< TRANSISTOR >					
Q601	8-729-801-93	TRANSISTOR	2SD1387		
Q602	8-729-900-80	TRANSISTOR	DTC114ES		
Q701	8-729-119-76	TRANSISTOR	2SA1175-HFE		
Q801	8-729-140-84	TRANSISTOR	2SC1841-PAFAEA		
Q821	8-729-140-84	TRANSISTOR	2SC1841-PAFAEA		
Q851	8-729-140-84	TRANSISTOR	2SC1841-PAFAEA		
Q871	8-729-140-84	TRANSISTOR	2SC1841-PAFAEA		
Q1001	8-729-111-29	TRANSISTOR	2SD1616A-K		
Q1002	8-729-111-29	TRANSISTOR	2SD1616A-K		
< RESISTOR >					
$\Delta$ R601	1-212-849-00	FUSIBLE	4.7	5%	1/4W F
R602	1-249-422-11	CARBON	2.7K	5%	1/4W
R603	1-249-422-11	CARBON	2.7K	5%	1/4W
R604	1-249-425-11	CARBON	4.7K	5%	1/4W
R605	1-249-425-11	CARBON	4.7K	5%	1/4W
R606	1-249-416-11	CARBON	820	5%	1/4W
R607	1-249-425-11	CARBON	4.7K	5%	1/4W
R701	1-249-433-11	CARBON	22K	5%	1/4W

The components identified by mark  $\Delta$  or dotted line with mark.  $\Delta$  are critical for safety. Replace only with part number specified.



**ELECT CAPACITOR**

**FLD**

**POWER AMPLIFIER**

**SPEAKER**

**TRANSFORMER (A)**

**TRANSFORMER (B)**

**VOL**

**JACK**

**POWER**

Ref. No.	Part No.	Description	Remark
R702	1-249-441-11	CARBON 100K 5%	1/4W
R703	1-249-433-11	CARBON 22K 5%	1/4W
R704	1-249-433-11	CARBON 22K 5%	1/4W
R705	1-249-429-11	CARBON 10K 5%	1/4W
R706	1-249-429-11	CARBON 10K 5%	1/4W
R707	1-249-429-11	CARBON 10K 5%	1/4W
R708	1-249-424-11	CARBON 3.9K 5%	1/4W
R709	1-249-427-11	CARBON 6.8K 5%	1/4W
R710	1-249-429-11	CARBON 10K 5%	1/4W
R711	1-249-417-11	CARBON 1K 5%	1/4W
R712	1-249-437-11	CARBON 47K 5%	1/4W
R713	1-249-441-11	CARBON 100K 5%	1/4W
R714	1-249-417-11	CARBON 1K 5%	1/4W
R715	1-249-393-11	CARBON 10 5%	1/4W
R801	1-249-417-11	CARBON 1K 5%	1/4W
R802	1-249-437-11	CARBON 47K 5%	1/4W
R803	1-249-420-11	CARBON 1.8K 5%	1/4W
R804	1-247-870-11	CARBON 43K 5%	1/4W
△R805	1-217-151-00	RES, METAL PLATE 0.22	2W
R806	1-249-417-11	CARBON 1K 5%	1/4W
R807	1-249-431-11	CARBON 15K 5%	1/4W
R808	1-249-441-11	CARBON 100K 5%	1/4W
△R809	1-212-958-00	FUSIBLE 10 5%	1/2W F
R810	1-249-439-11	CARBON 68K 5%	1/4W
R811	1-249-429-11	CARBON 10K 5%	1/4W
R821	1-249-417-11	CARBON 1K 5%	1/4W
R822	1-249-437-11	CARBON 47K 5%	1/4W
R823	1-249-420-11	CARBON 1.8K 5%	1/4W
R824	1-247-874-11	CARBON 62K 5%	1/4W
△R825	1-217-151-00	RES, METAL PLATE 0.22	2W
R826	1-249-417-11	CARBON 1K 5%	1/4W
R827	1-249-431-11	CARBON 15K 5%	1/4W
R828	1-249-441-11	CARBON 100K 5%	1/4W
△R829	1-212-958-00	FUSIBLE 10 5%	1/2W F
R830	1-249-437-11	CARBON 47K 5%	1/4W
R831	1-249-429-11	CARBON 10K 5%	1/4W
R851	1-249-417-11	CARBON 1K 5%	1/4W
R852	1-249-437-11	CARBON 47K 5%	1/4W
R853	1-249-420-11	CARBON 1.8K 5%	1/4W
R854	1-247-870-11	CARBON 43K 5%	1/4W
△R855	1-217-151-00	RES, METAL PLATE 0.22	2W
R856	1-249-417-11	CARBON 1K 5%	1/4W
R857	1-249-431-11	CARBON 15K 5%	1/4W
R858	1-249-441-11	CARBON 100K 5%	1/4W
△R859	1-212-958-00	FUSIBLE 10 5%	1/2W F
R860	1-249-438-11	CARBON 56K 5%	1/4W
R861	1-249-429-11	CARBON 10K 5%	1/4W
R871	1-249-417-11	CARBON 1K 5%	1/4W
R872	1-249-437-11	CARBON 47K 5%	1/4W

Ref. No.	Part No.	Description	Remark
R873	1-249-420-11	CARBON 1.8K 5%	1/4W
R874	1-247-874-11	CARBON 62K 5%	1/4W
△R875	1-217-151-00	RES, METAL PLATE 0.22	2W
R876	1-249-417-11	CARBON 1K 5%	1/4W
R877	1-249-431-11	CARBON 15K 5%	1/4W
R878	1-249-441-11	CARBON 100K 5%	1/4W
△R879	1-212-958-00	FUSIBLE 10 5%	1/2W F
R880	1-249-436-11	CARBON 39K 5%	1/4W
R881	1-249-429-11	CARBON 10K 5%	1/4W
R891	1-247-727-11	CARBON 10 5%	1/2W (G, IT)
R892	1-247-727-11	CARBON 10 5%	1/2W (G, IT)
R893	1-247-727-11	CARBON 10 5%	1/2W (G, IT)
R894	1-247-727-11	CARBON 10 5%	1/2W (G, IT)
R917	1-247-713-11	CARBON 1K 5%	1/4W
R918	1-249-441-11	CARBON 100K 5%	1/4W
△R1001	1-212-966-00	FUSIBLE 22 5%	1/2W F
R1002	1-249-421-11	CARBON 2.2K 5%	1/4W
R1003	1-249-421-11	CARBON 2.2K 5%	1/4W
R1004	1-247-903-00	CARBON 1M 5%	1/4W
R1005	1-247-902-11	CARBON 910K 5%	1/4W
R1006	1-249-433-11	CARBON 22K 5%	1/4W
△R1901	1-219-134-11	FUSIBLE 0.1 5%	1/4W F
△R1902	1-219-134-11	FUSIBLE 0.1 5%	1/4W F
△R1905	9-910-999-33	FUSIBLE 0.22 5%	1/4W F
△R1906	9-910-999-33	FUSIBLE 0.22 5%	1/4W F
< VARIABLE RESISTOR >			
RV601	1-241-803-11	RES, VAR, CARBON (WITH MOTOR)	10K (VOLUME)
< RELAY >			
RY1001	1-515-886-11	RELAY	
*****			
*	1-642-413-11	JACK BOARD	
*****			
*	A-4347-007-A	POWER BOARD, COMPLETE (AEP, UK)	
*	A-4347-012-A	POWER BOARD, COMPLETE (G, IT)	
*****			
*	1-533-213-31	HOLDER, FUSE	
*	3-309-144-21	HEAT SINK	
	7-682-547-04	SCREW +BVTT 3X6 (S)	
< CAPACITOR >			
C1	1-124-915-11	ELECT 10uF 20%	63V
C2	1-162-306-11	CERAMIC 0.01uF 20%	16V
C3	1-162-306-11	CERAMIC 0.01uF 20%	16V
C5	1-136-153-00	FILM 0.01uF 5%	50V
C7	1-162-306-11	CERAMIC 0.01uF 20%	16V
C8	1-162-294-31	CERAMIC 0.001uF 10%	50V

The components identified by mark △ or dotted line with mark. △ are critical for safety. Replace only with part number specified.

JACK

POWER

Ref. No.	Part No.	Description			Remark
C651	1-162-282-31	CERAMIC (AEP, UK)	100PF	10%	50V
C651	1-162-286-31	CERAMIC	220PF	10%	50V (G, IT)
C652	1-162-207-31	CERAMIC	22PF	5%	50V (G, IT)
C652	1-162-215-31	CERAMIC (AEP, UK)	47PF	5%	50V
C653	1-161-379-00	CERAMIC	0.01uF	20%	25V
C654	1-161-379-00	CERAMIC	0.01uF	20%	25V (G, IT)
C654	1-162-294-31	CERAMIC (AEP, UK)	0.001uF	10%	50V
C655	1-124-282-00	ELECT	22uF	20%	25V
C656	1-124-119-00	ELECT	330uF	20%	16V
C661	1-162-282-31	CERAMIC (AEP, UK)	100PF	10%	50V
C661	1-162-286-31	CERAMIC	220PF	10%	50V (G, IT)
C662	1-162-207-31	CERAMIC	22PF	5%	50V (G, IT)
C662	1-162-215-31	CERAMIC (AEP, UK)	47PF	5%	50V
C663	1-161-379-00	CERAMIC	0.01uF	20%	25V
C664	1-161-379-00	CERAMIC	0.01uF	20%	25V (G, IT)
C664	1-162-294-31	CERAMIC (AEP, UK)	0.001uF	10%	50V
C665	1-124-282-00	ELECT	22uF	20%	25V
C666	1-124-119-00	ELECT	330uF	20%	16V
C903	1-126-943-11	ELECT	2200uF	20%	25V
C904	1-126-943-11	ELECT	2200uF	20%	25V
C907	1-136-165-00	FILM	0.1uF	5%	50V
C908	1-136-165-00	FILM	0.1uF	5%	50V
C909	1-124-477-11	ELECT	47uF	20%	25V
C910	1-124-477-11	ELECT	47uF	20%	25V
C911	1-124-915-11	ELECT	10uF	20%	63V
C912	1-124-915-11	ELECT	10uF	20%	63V
C913	1-124-915-11	ELECT	10uF	20%	63V
C914	1-126-937-11	ELECT (AEP, UK)	4700uF	20%	16V
C915	1-124-915-11	ELECT	10uF	20%	63V
C916	1-124-915-11	ELECT	10uF	20%	63V
C917	1-126-947-11	ELECT	47uF	20%	35V
C918	1-124-915-11	ELECT	10uF	20%	63V
C1101	1-126-948-11	ELECT	100uF	20%	35V
C1102	1-124-915-11	ELECT	10uF	20%	63V
C1103	1-161-379-00	CERAMIC	0.01uF	20%	25V
C2000	1-101-006-00	CERAMIC	0.047uF		50V

< CONNECTOR >

\* CN902 1-564-506-11 PLUG, CONNECTOR 3P  
 \* CN904 1-564-506-11 PLUG, CONNECTOR 3P  
 \* CNJ1 1-580-739-11 SOCKET, CONNECTOR 15P (SYSTEM CONTROL 1)  
 \* CNJ2 1-580-740-11 SOCKET, CONNECTOR 17P (SYSTEM CONTROL 2)  
 \* CNJ3 1-563-534-11 CONNECTOR, BOARD TO BOARD 16P

Ref. No.	Part No.	Description		Remark
* CNP7	1-564-499-11	PIN, CONNECTOR 6P		
* CNP8	1-564-498-11	PIN, CONNECTOR 5P		
* CNP903	1-564-321-00	PIN, CONNECTOR 2P		
* CNP905	1-573-087-11	PIN, CONNECTOR 13P		
CNP906	1-573-109-11	PIN, CONNECTOR 15P		
* CNP907	1-506-981-11	PIN, CONNECTOR 10P		
CNP908	1-568-317-11	SOCKET, CONNECTOR 6P		
* CNP909	1-573-148-11	PLUG, CONNECTOR 12P		
* CNP910	1-564-338-00	PIN, CONNECTOR 4P		
* CNP911	1-564-505-11	PLUG, CONNECTOR 2P		
< DIODE >				
D891	8-719-987-63	DIODE	1N4148M	
D892	8-719-987-63	DIODE	1N4148M	
D901	8-719-510-68	DIODE	D5SBA20F01	
D902	8-719-987-63	DIODE	1N4148M	
D903	8-719-987-63	DIODE	1N4148M	
D904	8-719-200-82	DIODE	11ES2	
D905	8-719-200-82	DIODE	11ES2	
D906	8-719-200-82	DIODE	11ES2	
D907	8-719-200-82	DIODE	11ES2	
D908	8-719-200-82	DIODE	11ES2	
D909	8-719-200-82	DIODE	11ES2	
D910	8-719-987-63	DIODE	1N4148M	
D911	8-719-933-36	DIODE	HZS6B1L	
D919	8-719-987-63	DIODE	1N4148M	
D920	8-719-987-63	DIODE	1N4148M	
D1101	8-719-200-82	DIODE	11ES2	
D1102	8-719-200-82	DIODE	11ES2	
< IC >				
IC1	8-749-921-11	IC	GP1F32R (DIGITAL OPTICAL CD IN)	
IC2	8-749-921-11	IC	GP1F32R (DIGITAL OPTICAL DAT IN)	
IC3	8-749-921-12	IC	GP1F32T (DIGITAL OPTICAL DAT OUT)	
IC651	8-759-634-50	IC	M5218AL	
IC901	8-759-602-66	IC	M5230L-A	
< JACK >				
J2	1-569-662-11	JACK, PIN 1P (SUPER WOOFER OUT)		
J651	1-562-837-21	JACK (HEADPHONES)		
△J901	1-526-931-11	INLET, AC (~ AC IN)		
< COIL >				
L1	1-410-397-21	FERRITE BEAD INDUCTOR		
< LINE FILTER >				
△L901	1-424-485-11	FILTER, LINE		

The components identified by  
 mark △ or dotted line with mark.  
 △ are critical for safety.  
 Replace only with part number  
 specified.

JACK

POWER

Ref. No.	Part No.	Description	Remark
< TRANSISTOR >			
Q651	8-729-141-30	TRANSISTOR 2SC3623A-LK	
Q652	8-729-900-61	TRANSISTOR DTA114ES	
Q661	8-729-141-30	TRANSISTOR 2SC3623A-LK	
Q901	8-729-209-15	TRANSISTOR 2SD2012	
Q902	8-729-141-83	TRANSISTOR 2SB1094-LK	
Q903	8-729-900-80	TRANSISTOR DTC114ES	
Q905	8-729-620-05	TRANSISTOR 2SC2603-EF	
Q906	8-729-620-05	TRANSISTOR 2SC2603-EF	
Q908	8-729-801-84	TRANSISTOR 2SB1013-4	
Q909	8-729-111-29	TRANSISTOR 2SD1616A-K	
Q910	8-729-111-29	TRANSISTOR 2SD1616A-K	
Q911	8-729-620-05	TRANSISTOR 2SC2603-EF	
Q1101	8-729-111-29	TRANSISTOR 2SD1616A-K	
Q1601	8-729-141-30	TRANSISTOR 2SC3623A-LK	
Q1602	8-729-141-30	TRANSISTOR 2SC3623A-LK	
< RESISTOR >			
△R2	9-910-999-33	FUSIBLE 0.22 5%	1/4W F
△R3	9-910-999-33	FUSIBLE 0.22 5%	1/4W F
R5	1-249-409-11	CARBON 220 5%	1/4W
R651	1-249-433-11	CARBON 22K 5%	1/4W
R652	1-247-881-00	CARBON 120K 5%	1/4W
R653	1-249-405-11	CARBON 100 5%	1/4W
R654	1-249-419-11	CARBON 1.5K 5%	1/4W
R655	1-249-422-11	CARBON 2.7K 5%	1/4W
R656	1-249-405-11	CARBON 100 5%	1/4W
R657	1-249-441-11	CARBON 100K 5%	1/4W
R658	1-249-429-11	CARBON 10K 5%	1/4W
R661	1-249-433-11	CARBON 22K 5%	1/4W
R662	1-247-881-00	CARBON 120K 5%	1/4W
R663	1-249-405-11	CARBON 100 5%	1/4W
R666	1-249-405-11	CARBON 100 5%	1/4W
R668	1-249-429-11	CARBON 10K 5%	1/4W
R902	1-247-903-00	CARBON 1M 5%	1/4W
R905	1-249-413-11	CARBON 470 5%	1/4W
R906	1-249-434-11	CARBON 27K 5%	1/4W
R907	1-249-425-11	CARBON 4.7K 5%	1/4W
R908	1-249-431-11	CARBON 15K 5%	1/4W
R909	1-249-431-11	CARBON 15K 5%	1/4W
R910	1-249-419-11	CARBON 1.5K 5%	1/4W
R911	1-249-429-11	CARBON 10K 5%	1/4W
R912	1-249-429-11	CARBON 10K 5%	1/4W
R913	1-249-429-11	CARBON 10K 5%	1/4W
R914	1-249-429-11	CARBON 10K 5%	1/4W
R919	1-249-429-11	CARBON 10K 5%	1/4W
R920	1-249-429-11	CARBON 10K 5%	1/4W
△R921	1-215-863-11	METAL OXIDE 100 5%	1W F

Ref. No.	Part No.	Description	Remark
R922	1-249-429-11	CARBON 10K 5%	1/4W
R923	1-249-425-11	CARBON 4.7K 5%	1/4W
R924	1-249-429-11	CARBON 10K 5%	1/4W
R925	1-249-429-11	CARBON 10K 5%	1/4W
R926	1-249-429-11	CARBON 10K 5%	1/4W
△R928	1-216-425-11	METAL OXIDE 56 5%	1W F
R930	1-249-417-11	CARBON 1K 5%	1/4W
R931	1-249-441-11	CARBON 100K 5%	1/4W
R932	1-249-429-11	CARBON 10K 5%	1/4W
R1101	1-249-429-11	CARBON 10K 5%	1/4W

< RELAY >

RY801	1-515-790-11	RELAY
RY802	1-515-790-11	RELAY
RY901	1-515-626-11	RELAY
RY902	1-515-626-11	RELAY

\*\*\*\*\*

MISCELLANEOUS

\*\*\*\*\*

△F901	1-532-286-00	FUSE, TIME-LAG (T2.5A)
IC902	8-759-231-53	IC M5F7805L
M801	1-541-860-11	MOTOR, DC FAN
△PT901	1-450-881-11	TRANSFORMER, POWER (UK)
△PT901	1-450-883-11	TRANSFORMER, POWER (AEP, G, IT)

Q904	8-729-209-15	TRANSISTOR 2SD2012
------	--------------	--------------------

\*\*\*\*\*

\*\*\*\*\*

HARDWARE LIST

\*\*\*\*\*

#1	7-685-203-19	SCREW +KTP 2X5 TYPE2 NON-SLIT
#2	7-685-534-19	SCREW +BTP 2.6X8 TYPE2 N-S
#3	7-685-133-19	SCREW +BTP 2.6X6 TYPE2 N-S
#4	7-685-132-19	SCREW +PTPW 2.6X5 (TYPE2)
#5	7-682-547-04	SCREW +BVTT 3X6 (S)
#6	7-685-647-79	SCREW +BVTP 3X10 TYPE2 N-S
#7	7-685-645-79	SCREW +BVTP 3X6 TYPE2 IT-3
#8	7-682-547-09	SCREW +BVTT 3X6 (S)

The components identified by mark △ or dotted line with mark △ are critical for safety. Replace only with part number specified.