

# TA-H7710D

## SERVICE MANUAL

*AEP Model  
UK Model*



This set is the Amplifier section in MHC-7710D.

### SPECIFICATIONS

Continuous RMS power output	50 + 50 watts (6 ohms at 1 kHz, DIN) 58 + 58 watts (6 ohms at 1 kHz, 5% THD)
Music power output	85 + 85 watts (6 ohms at 1 kHz 10% THD)
Outputs	HEADPHONES (stereo minijack): accepts headphones of 8 ohms or more SPEAKERS: accepts speakers of 6 to 16 ohms

Design and specifications subject to change without notice.

#### SAFETY-RELATED COMPONENT WARNING!!

COMPONENTS IDENTIFIED BY MARK  $\triangle$  OR DOTTED LINE WITH MARK  $\triangle$  ON THE SCHEMATIC DIAGRAMS AND IN THE PARTS LIST ARE CRITICAL TO SAFE OPERATION. REPLACE THESE COMPONENTS WITH SONY PARTS WHOSE PART NUMBERS APPEAR AS SHOWN IN THIS MANUAL OR IN SUPPLEMENTS PUBLISHED BY SONY.

INTEGRATED STEREO AMPLIFIER  
**SONY**<sup>®</sup>

TABLE OF CONTENTS

MODEL IDENTIFICATION

— Model Number Label —

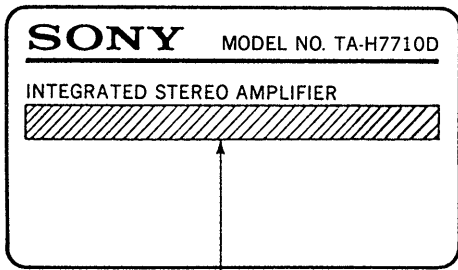

AEP model: AC: 220—230V~50/60Hz  
 UK model : AC: 240V~50Hz

<i>Section</i>	<i>Title</i>	<i>Page</i>
<b>1. GENERAL</b>		
1-1.	Parts Identification .....	2
<b>2. DISASSEMBLY</b>		
2-1.	Front Panel Assy .....	3
2-2.	Panel Board .....	3
2-3.	Back Panel .....	4
2-4.	Jack Board, Speaker Board .....	4
2-5.	Power Board, DSP Board .....	5
2-6.	Power Transformer .....	5
<b>3. DIAGRAMS</b>		
3-1.	Circuit Boards Location .....	6
3-2.	Semiconductor Lead Layouts .....	6
3-3.	Printed Wiring Boards	
	— Power/Jack/Volume Section — .....	8
3-4.	Schematic Diagram	
	— Power/Jack/Volume Section — .....	11
3-5.	Schematic Diagram — DSP Section — .....	14
3-6.	Printed Wiring Board — DSP Section — .....	17
3-7.	Printed Wiring Board — Panel Section — .....	21
3-8.	Schematic Diagram — Panel Section — .....	25
<b>4. EXPLODED VIEWS</b>		
4-1.	Front Panel Assy .....	29
4-2.	Chassis Section .....	30
<b>5. ELECTRICAL PARTS LIST</b>		31

SECTION 1  
 GENERAL

This section is extracted from instruction manual.

1-1. PARTS IDENTIFICATION

- 1 SYSTEM POWER switch and STANDBY indicator  
 The indicator remains lit as long as the AC power cord is connected to a wall outlet.
- 2 HEADPHONES jack (stereo minijack)
- 3 Display window
- 4 VOLUME control 28
- 5 VIDEO and AUDIO FUNCTION selectors 22 147
- 6 Function indicators 22 147
- 7 WAKE UP VOL SET indicator 140
- 8 OPEN tab

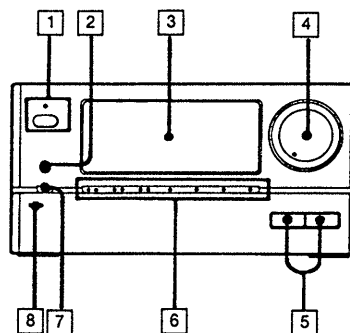

# SECTION 2 DISASSEMBLY

Note: Follow the disassembly procedure in the numerical order given.

## 2-1. FRONT PANEL ASSY

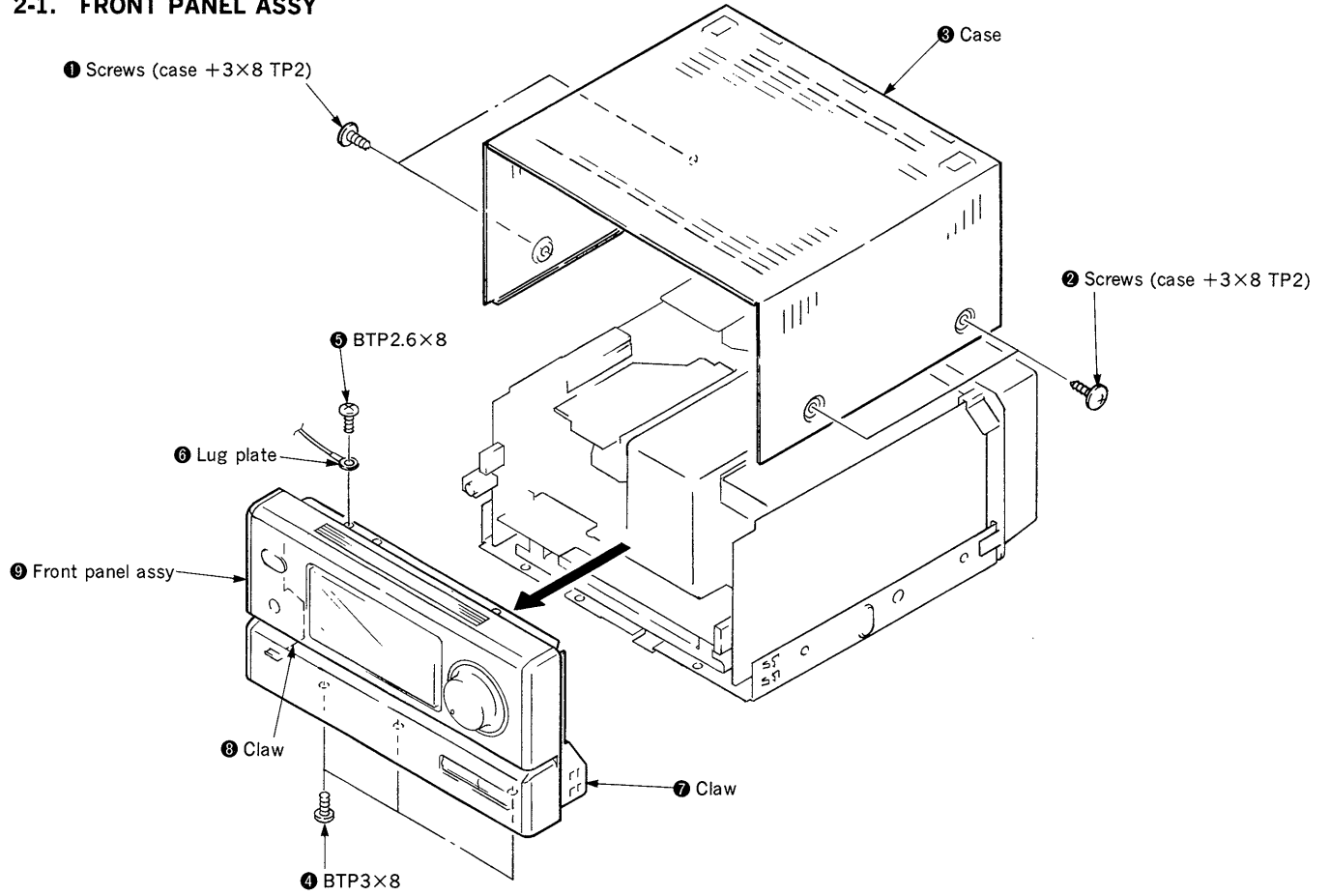

## 2-2. PANEL BOARD

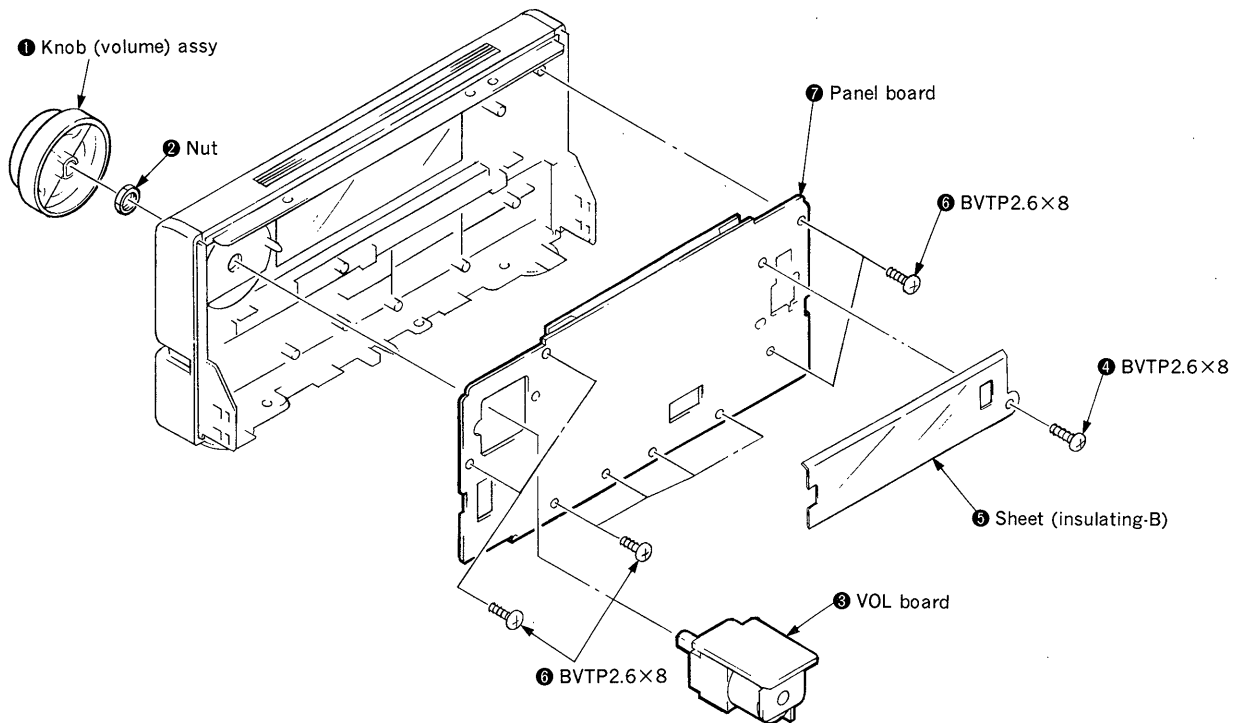

2-3. BACK PANEL

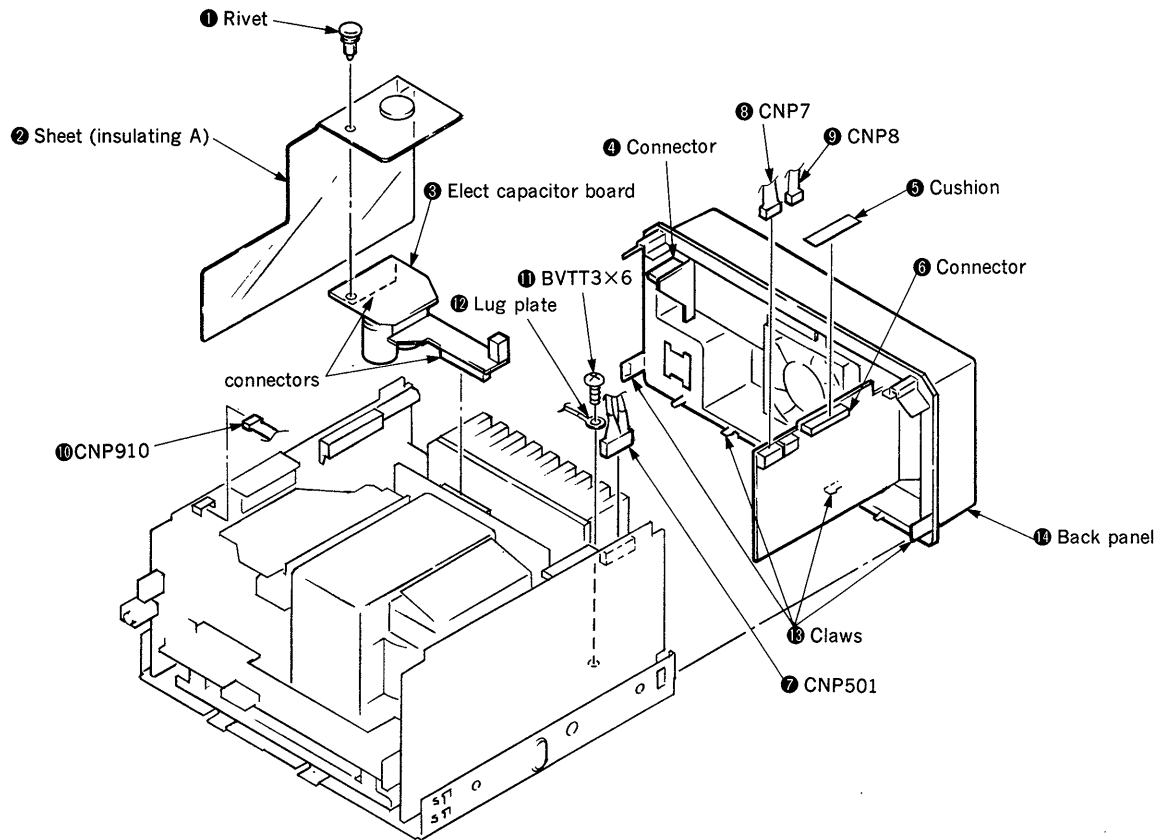

2-4. JACK BOARD, SPEAKER BOARD

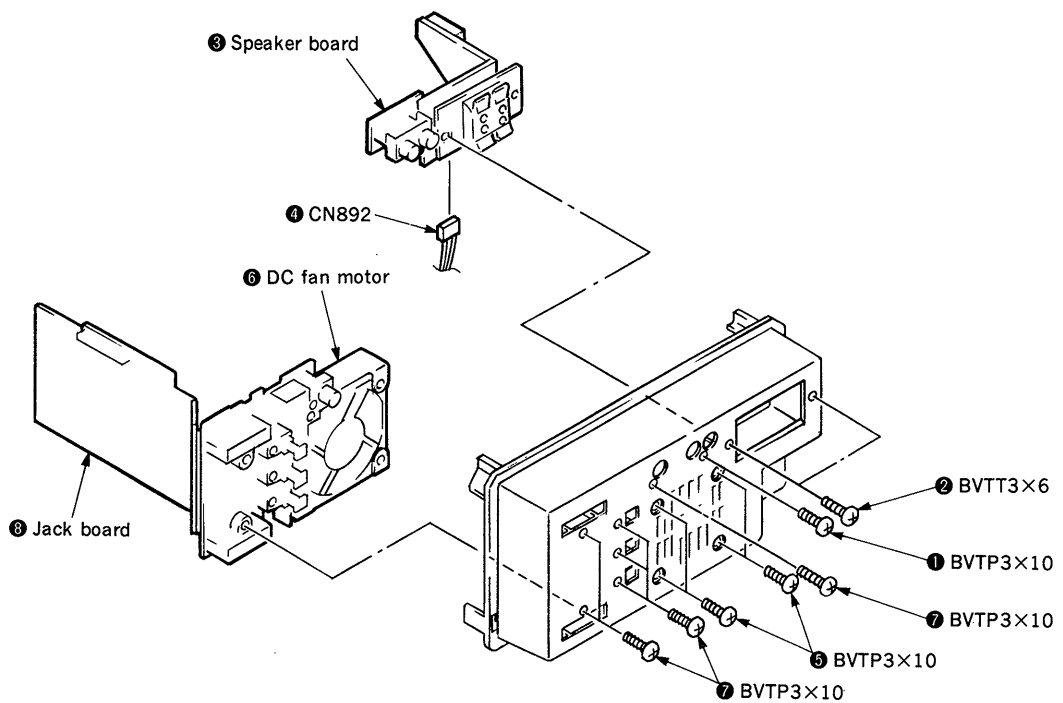



## 2-5. POWER BOARD, DSP BOARD

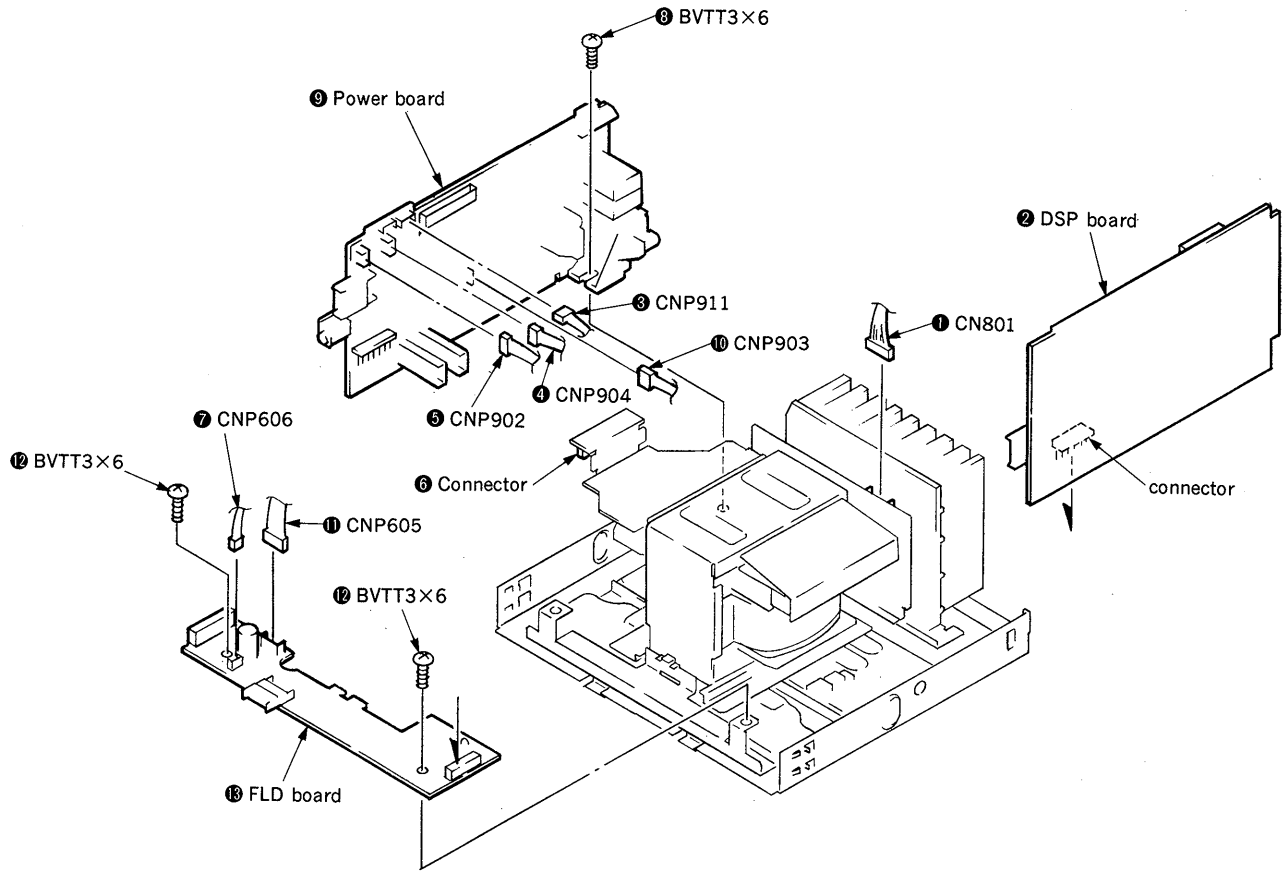

## 2-6. POWER TRANSFORMER

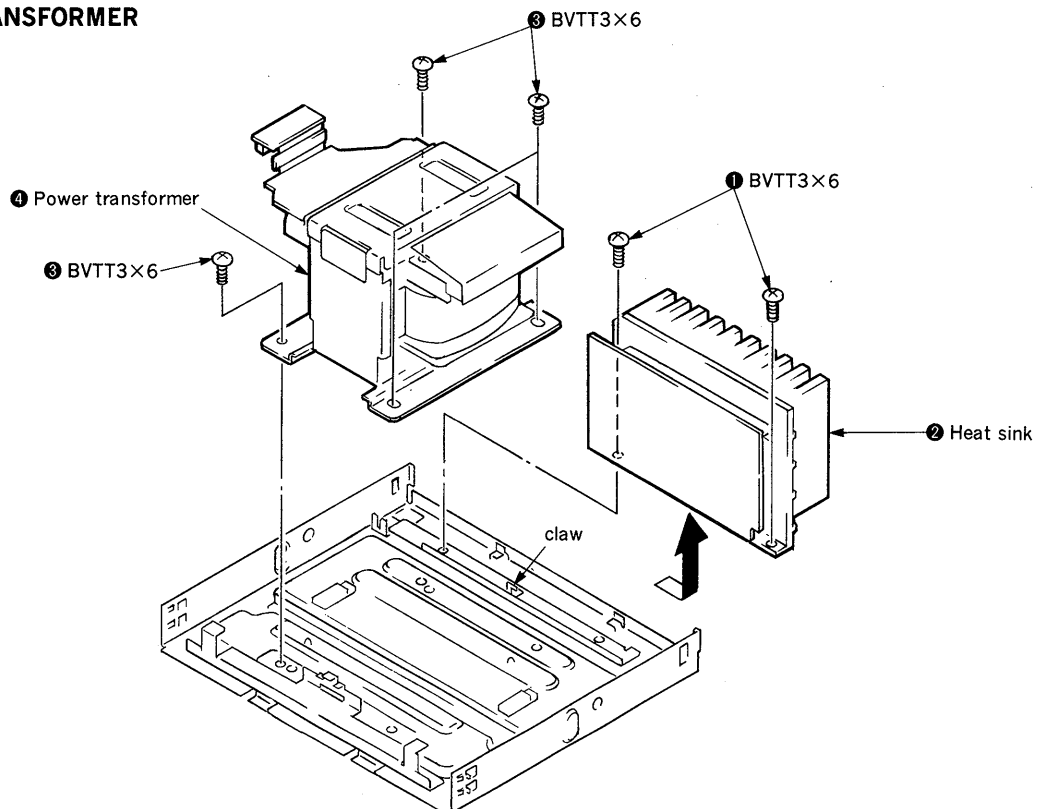

SECTION 3  
DIAGRAMS

3-1. CIRCUIT BOARDS LOCATION

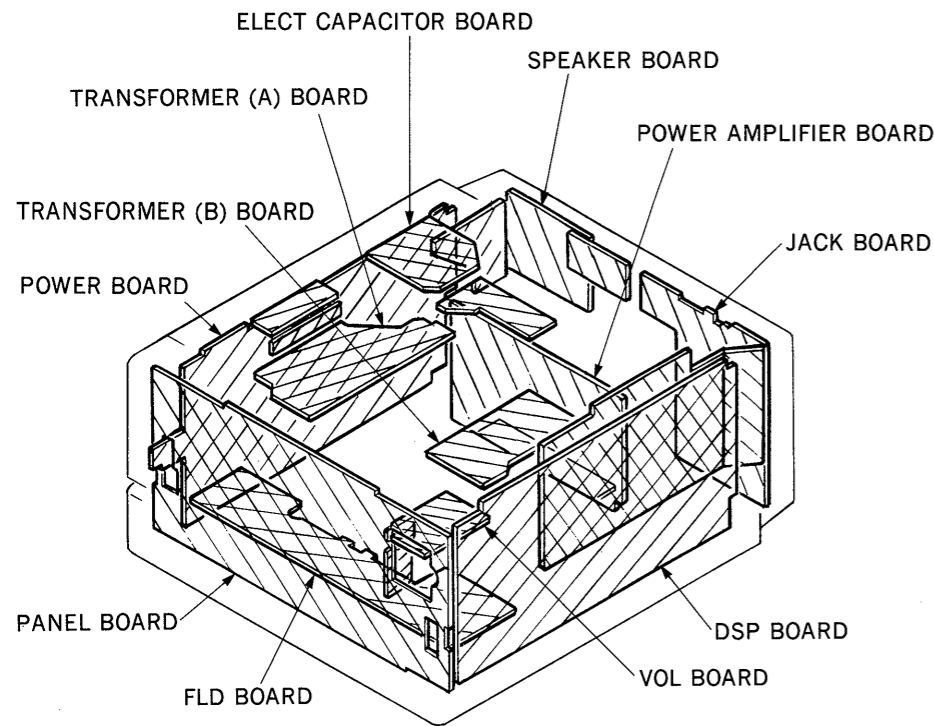

3-2. SEMICONDUCTOR LEAD LAYOUTS

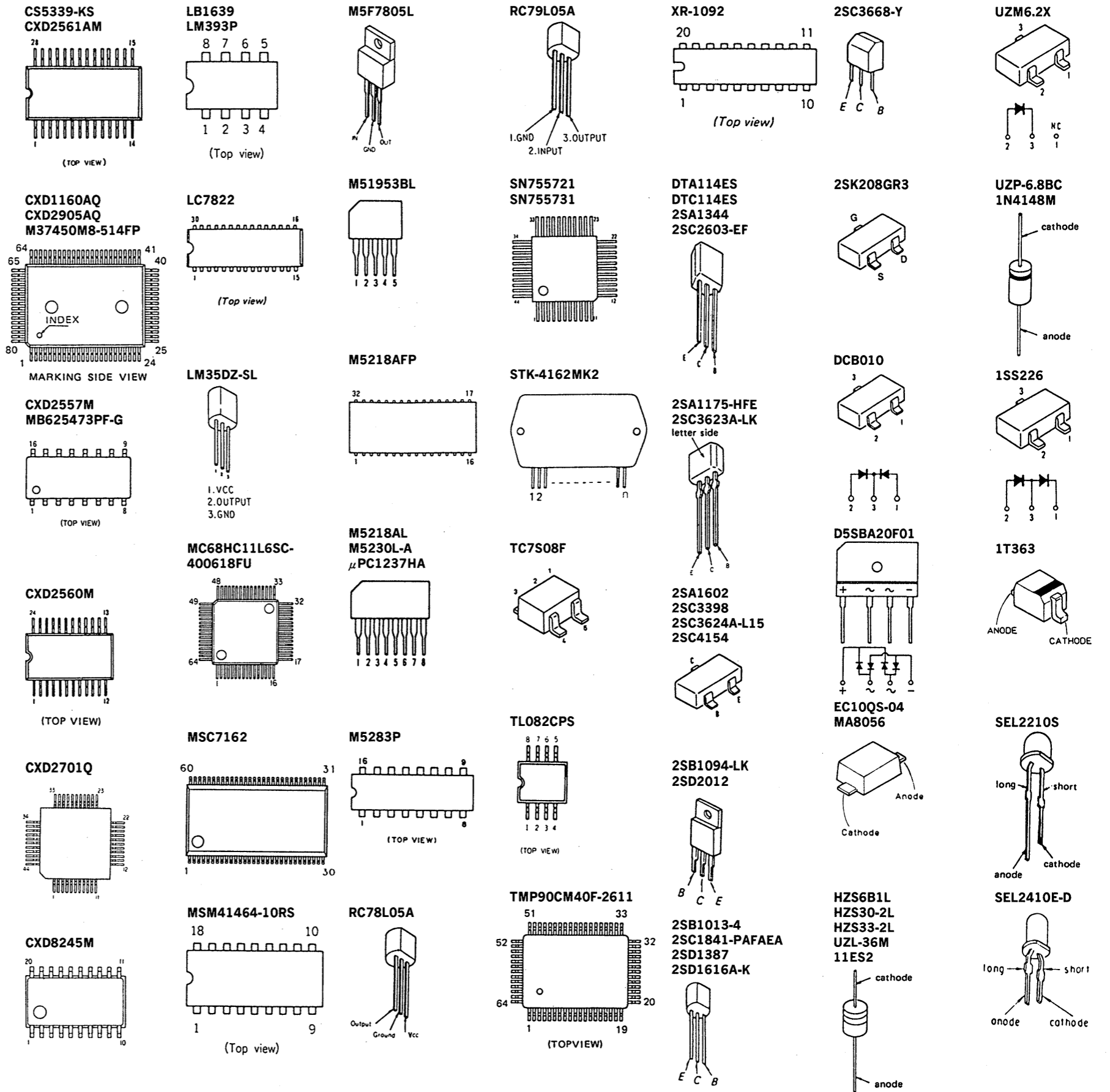

● Semiconductor Location

Ref. No.	Location	Ref. No.	Location
D601	G-20	IC1	C-13
D602	G-20	IC2	D-13
D703	G-17	IC3	C-13
D704	H-18	IC601	G-20
D705	H-18	IC651	H-3
D706	G-17	IC701	F-16
D801	G-16	IC702	G-17
D802	H-17	IC703	G-16
D851	G-16	IC801	I-16
D852	H-17	IC901	G-2
D891	C-3	IC902	J-4
D892	C-3		
D901	D-3	Q601	F-20
D902	F-3	Q602	G-20
D903	F-3	Q651	I-2
D904	G-4	Q652	H-3
D905	G-4	Q661	H-3
D906	F-4	Q701	F-17
D907	F-4	Q801	H-16
D908	G-4	Q851	H-16
D909	G-4	Q901	G-1
D910	I-4	Q902	G-1
D911	H-4	Q903	G-3
D915	I-11	Q904	J-4
D916	I-11	Q905	H-4
D917	J-12	Q906	H-4
D918	K-12	Q908	D-5
D919	D-5	Q909	D-3
D920	H-5	Q910	F-3
D1001	J-6	Q911	D-5
D1002	J-6	Q1001	J-7
D1003	J-6	Q1002	J-9
D1004	J-6	Q1101	E-5
D1005	I-11	Q1601	I-3
D1006	I-7	Q1602	H-3
D1007	I-7		
D1008	I-9		
D1009	I-9		
D1010	I-7		
D1101	E-4		
D1102	E-4		

Note:  
● ○ : parts extracted from the component side.

3-3. PRINTED WIRING BOARDS — POWER/JACK/VOLUME SECTION — ● Refer to page 6 for Semiconductor Lead Layouts.

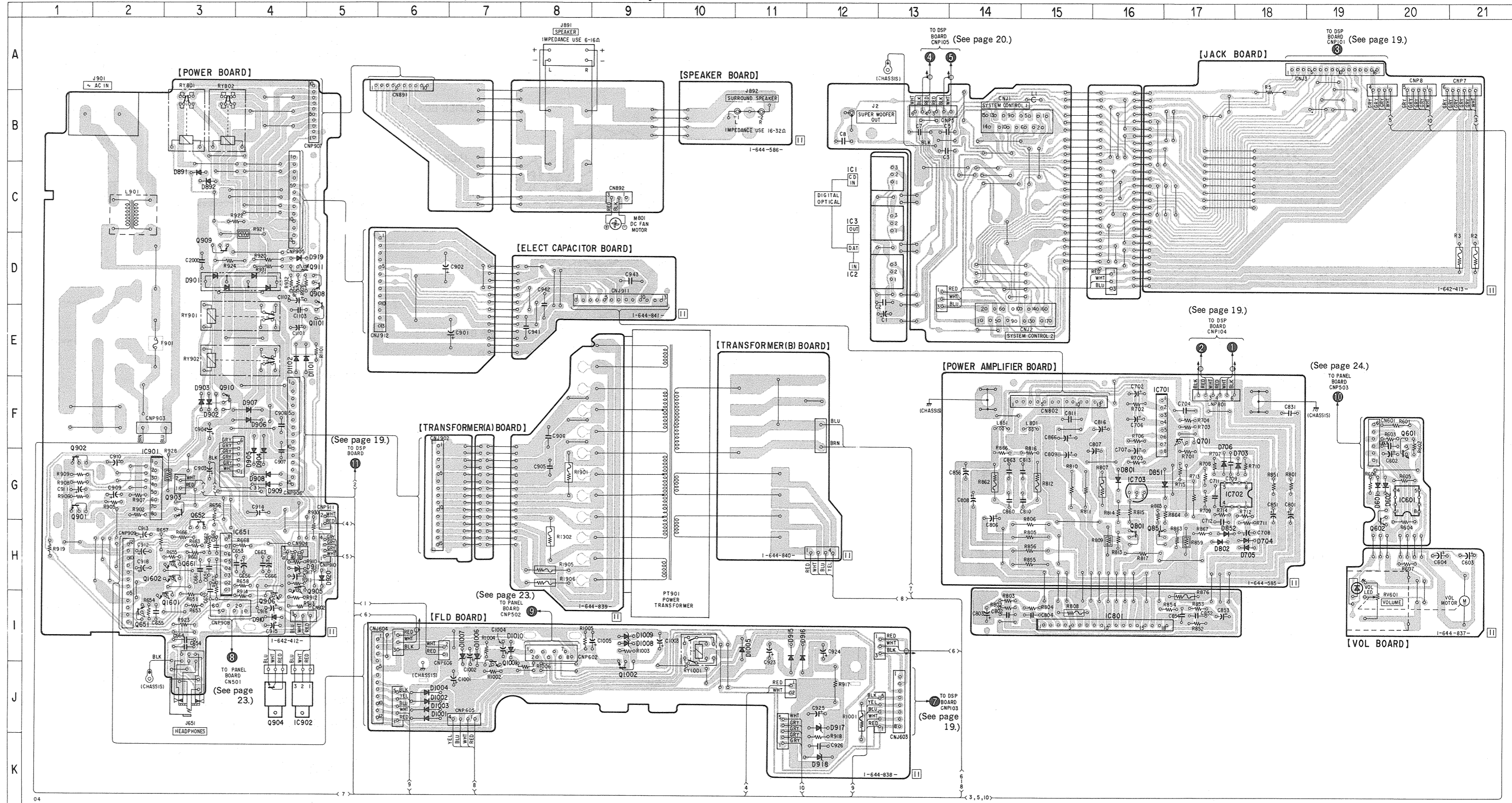

3-4. SCHEMATIC DIAGRAM — POWER/JACK/VOLUME SECTION — Refer to page 28 for IC Block Diagrams.

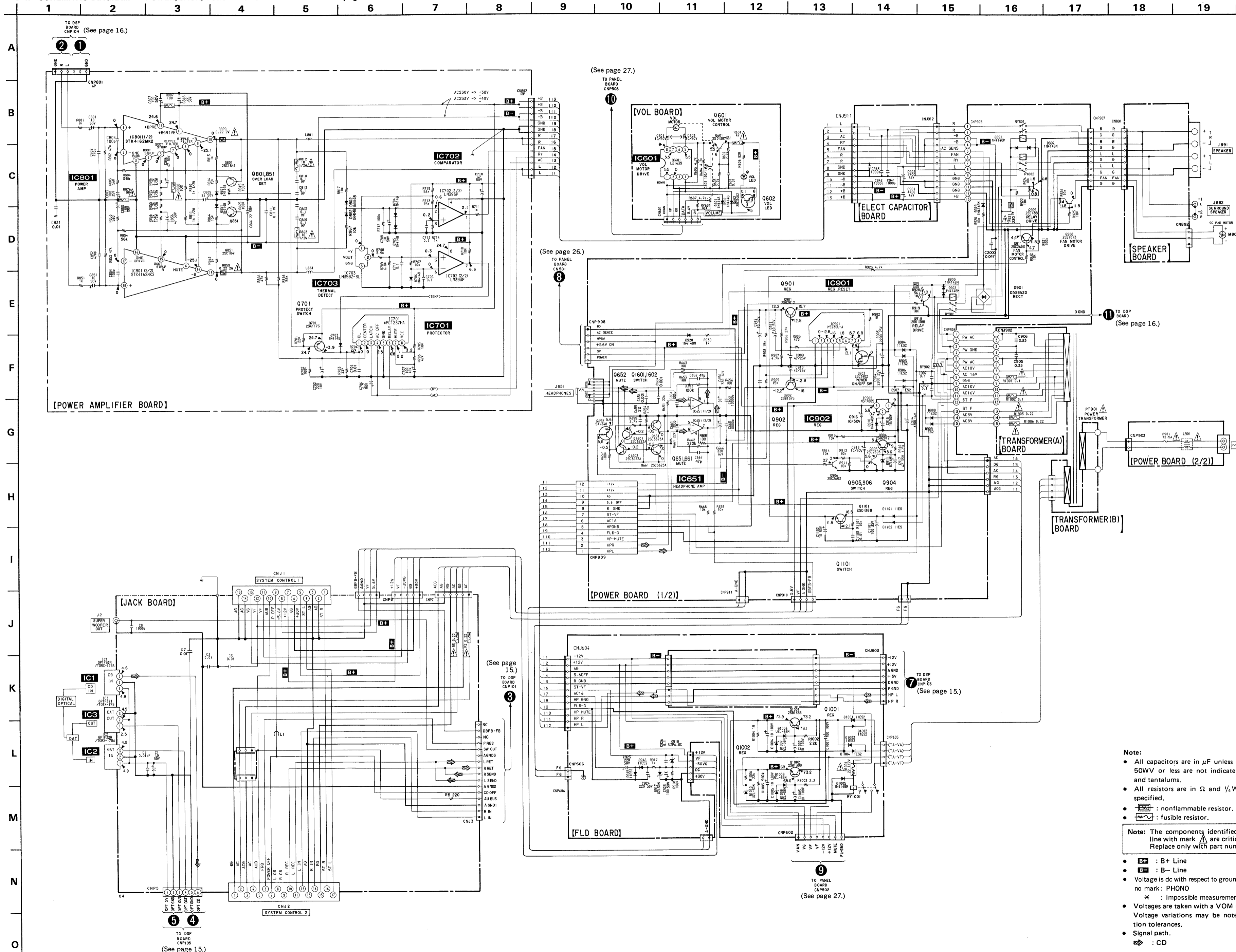



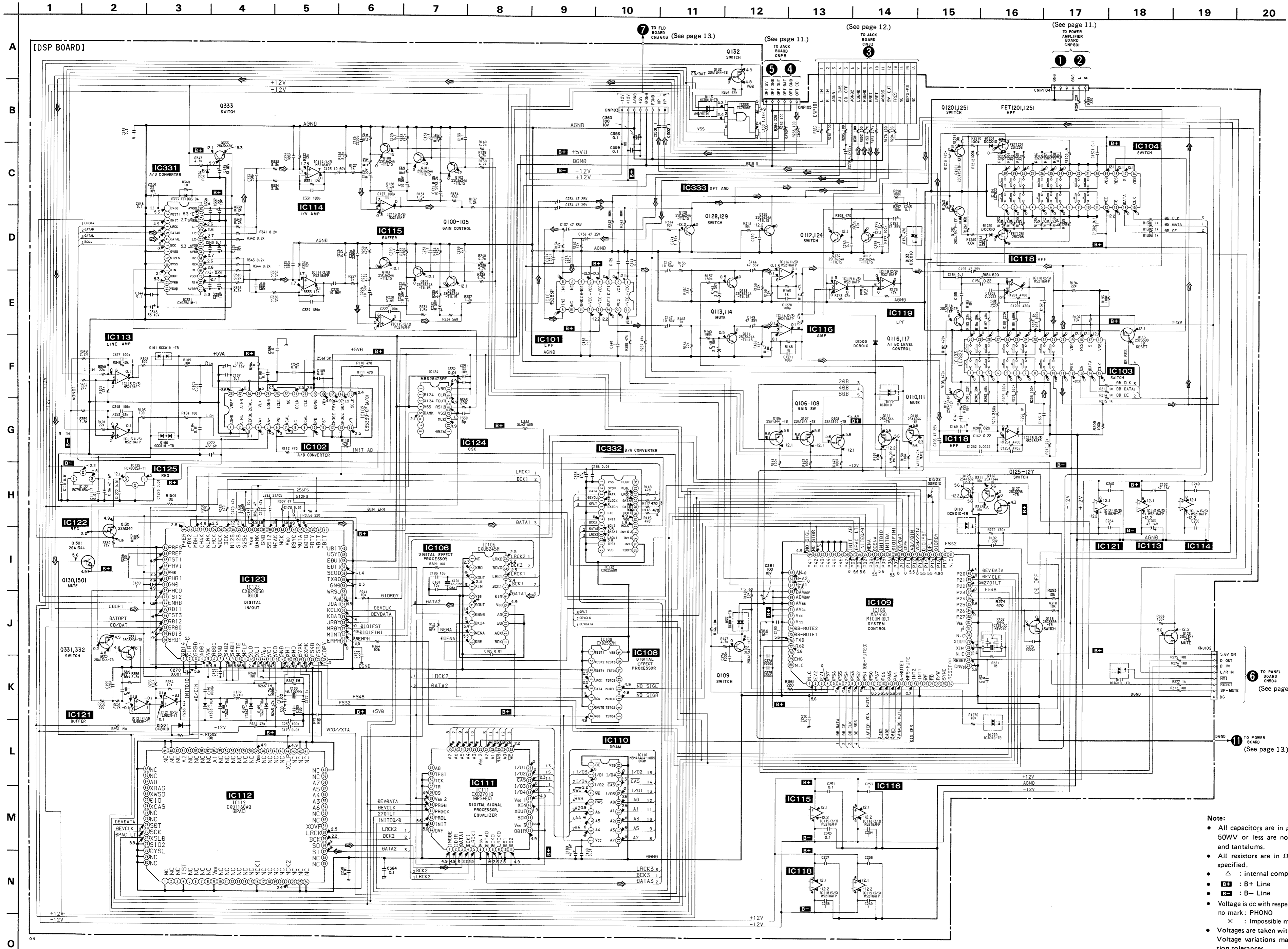

- Note:
- All capacitors are in  $\mu\text{F}$  unless otherwise noted.  $\text{pF}$ :  $\mu\text{F}$  50WV or less are not indicated except for electrolytics and tantalums.
  - All resistors are in  $\Omega$  and  $\frac{1}{4}\text{W}$  or less unless otherwise specified.
  - $\Delta$ : internal component.
  - $B+$ : B+ Line
  - $B-$ : B- Line
  - Voltage is dc with respect to ground under no-signal conditions. no mark: PHONO
  - $\times$ : Impossible measurement point
  - Voltages are taken with a VOM (Input Impedance  $10\text{M}\Omega$ ). Voltage variations may be noted due to normal production tolerances.
  - Signal path.
  - $\Rightarrow$ : CD



3-6. PRINTED WIRING BOARD — DSP SECTION — • Refer to page 6 for Semiconductor Lead Layouts.

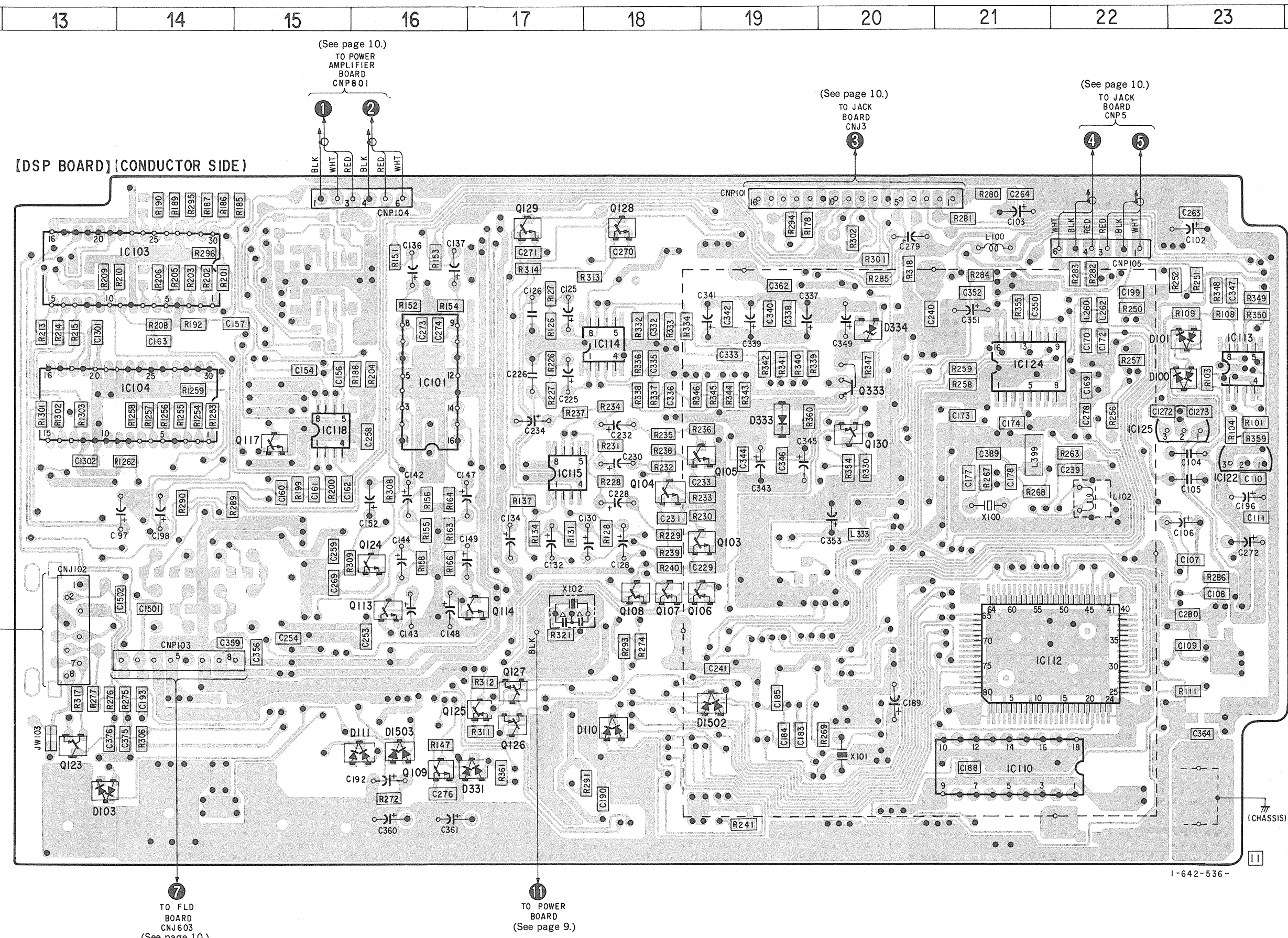
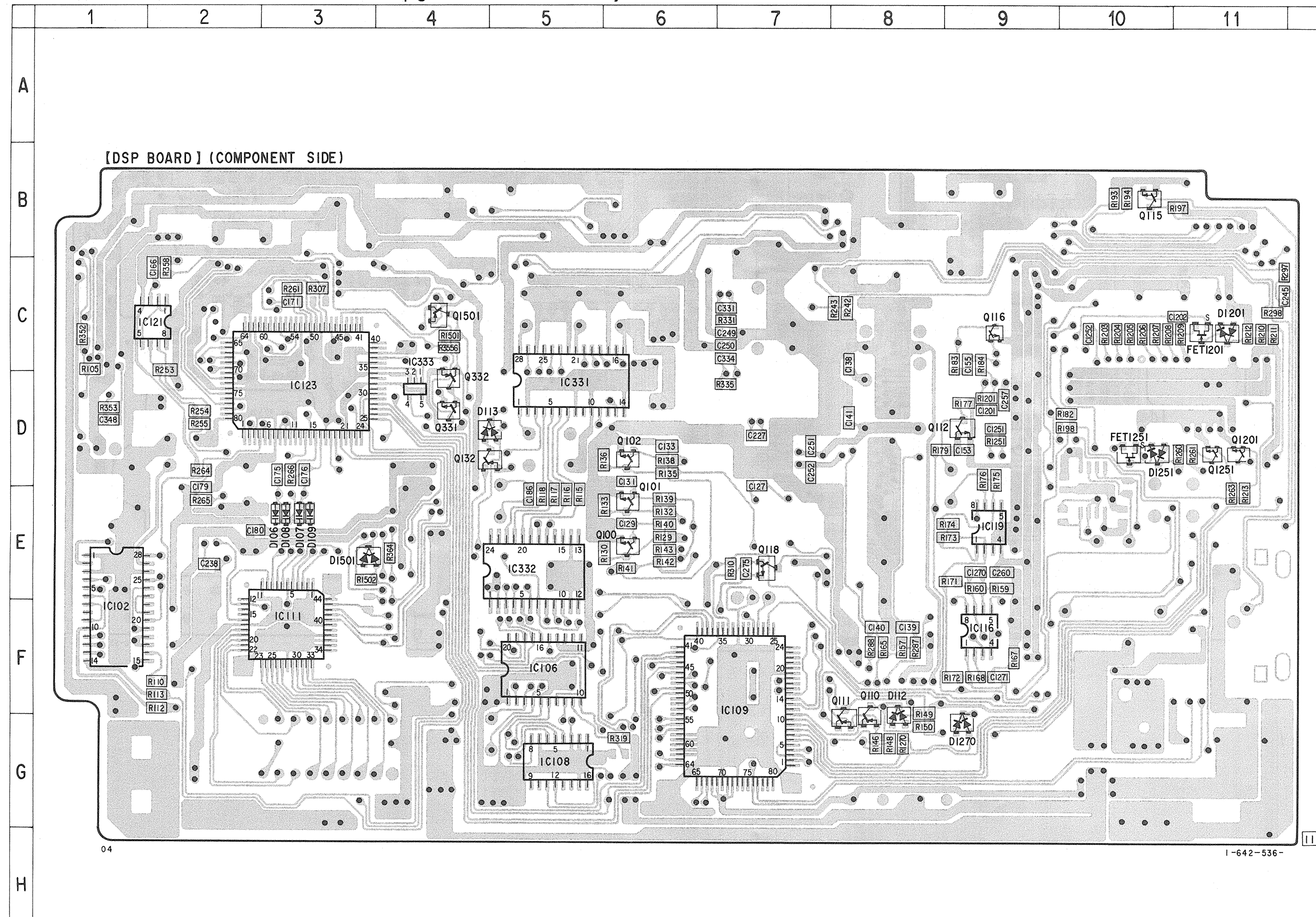

• Semiconductor Location

Ref. No.	Location	Ref. No.	Location
D100	C-23	IC123	D-3
D101	C-23	IC124	C-21
D103	G-13	IC125	D-23
D106	E-3	IC331	D-5
D107	E-3	IC332	E-5
D108	E-3	IC333	D-4
D109	E-3		
D110	F-18	Q100	E-6
D111	G-16	Q101	E-6
D112	G-8	Q102	D-6
D113	D-4	Q103	E-18
D331	G-16	Q104	D-18
D333	D-19	Q105	D-18
D334	C-20	Q106	E-18
D1201	C-11	Q107	E-18
D1251	D-10	Q108	E-18
D1270	G-9	Q109	G-16
D1501	E-3	Q110	G-8
D1502	G-16	Q111	G-8
D1503	F-18	Q112	D-9
		Q113	E-16
FET1201	C-11	Q114	E-16
FET1251	D-10	Q115	B-10
		Q116	C-9
IC101	D-16	Q117	D-15
IC102	F-1	Q118	E-7
IC103	C-14	Q123	G-13
IC104	D-14	Q124	E-16
IC106	F-5	Q125	F-17
IC108	G-5	Q126	F-17
IC109	F-7	Q127	F-17
IC110	G-21	Q128	B-18
IC111	F-3	Q129	B-17
IC112	F-21	Q130	D-20
IC113	C-23	Q132	D-4
IC114	C-18	Q331	D-4
IC115	D-17	Q332	D-4
IC116	F-9	Q333	C-20
IC118	D-15	Q1201	D-11
IC119	E-9	Q1251	D-11
IC121	C-2	Q1501	C-4
IC122	D-23		

Note:  
 • — : parts extracted from the component side.  
 • — : Through hole.  
 • : Pattern from the side which enables seeing.  
 (The other layers' patterns are not indicated.)

Caution:  
 Pattern face side: Parts on the pattern face side seen from the (Conductor side) pattern face are indicated.  
 Parts face side: Parts on the parts face side seen from the parts (Component side) face are indicated.



● Semiconductor Location 3-7. PRINTED WIRING BOARD — PANEL SECTION — ● Refer to page 6 for Semiconductor Lead Layouts.

Ref. No.	Location
D501	F-11
D502	F-13
D503	F-12
D504	C-22
D505	C-20
D506	C-19
D507	C-18
D508	C-17
D509	C-15
D510	F-15
D511	C-21
D512	C-19
D514	C-17
D515	C-16
D521	C-20
D522	B-17
D523	B-25
IC501	D-20
IC502	E-21
IC503	F-20
IC504	D-18
IC505	F-18
IC506	E-17
IC507	E-15
IC508	C-3
IC509	D-24
Q501	F-13
Q502	F-11
Q503	F-12
Q504	F-11
Q505	F-11
Q506	F-15
Q507	E-11
Q508	C-5
Q509	C-7
Q510	C-8
Q511	C-9
Q512	C-11
Q513	C-11
Q514	C-11
Q515	C-19
Q516	C-19
Q517	C-19

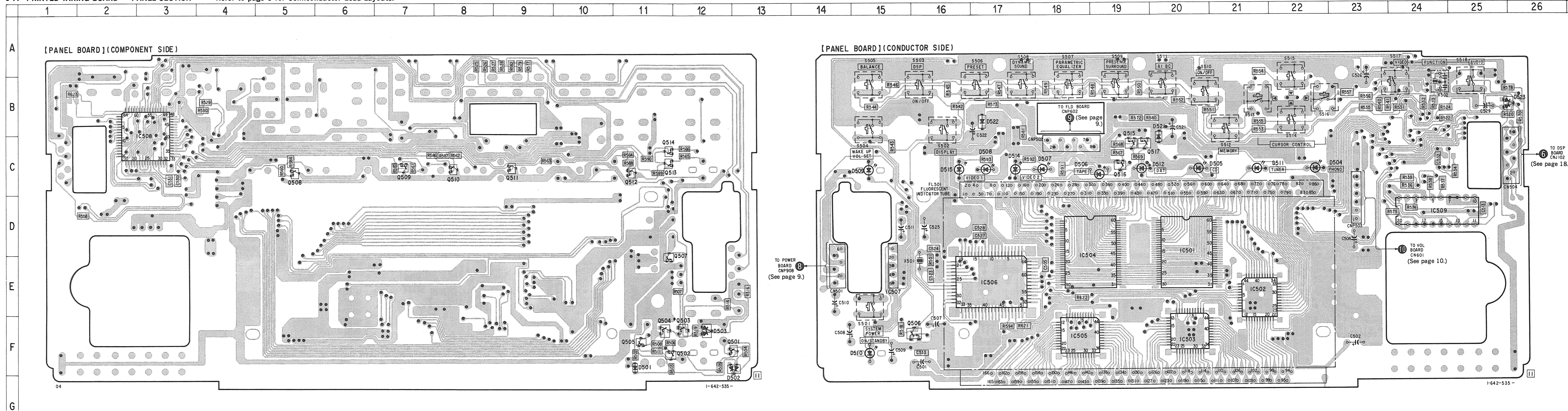

Note:  
 ● : Through hole.  
 ● : Pattern from the side which enables seeing.  
 (The other layers/patterns are not indicated.)

Caution:  
 Pattern face side: Parts on the pattern face side seen from the (Conductor side) pattern face are indicated.  
 Parts face side: Parts on the parts face side seen from the parts face are indicated.

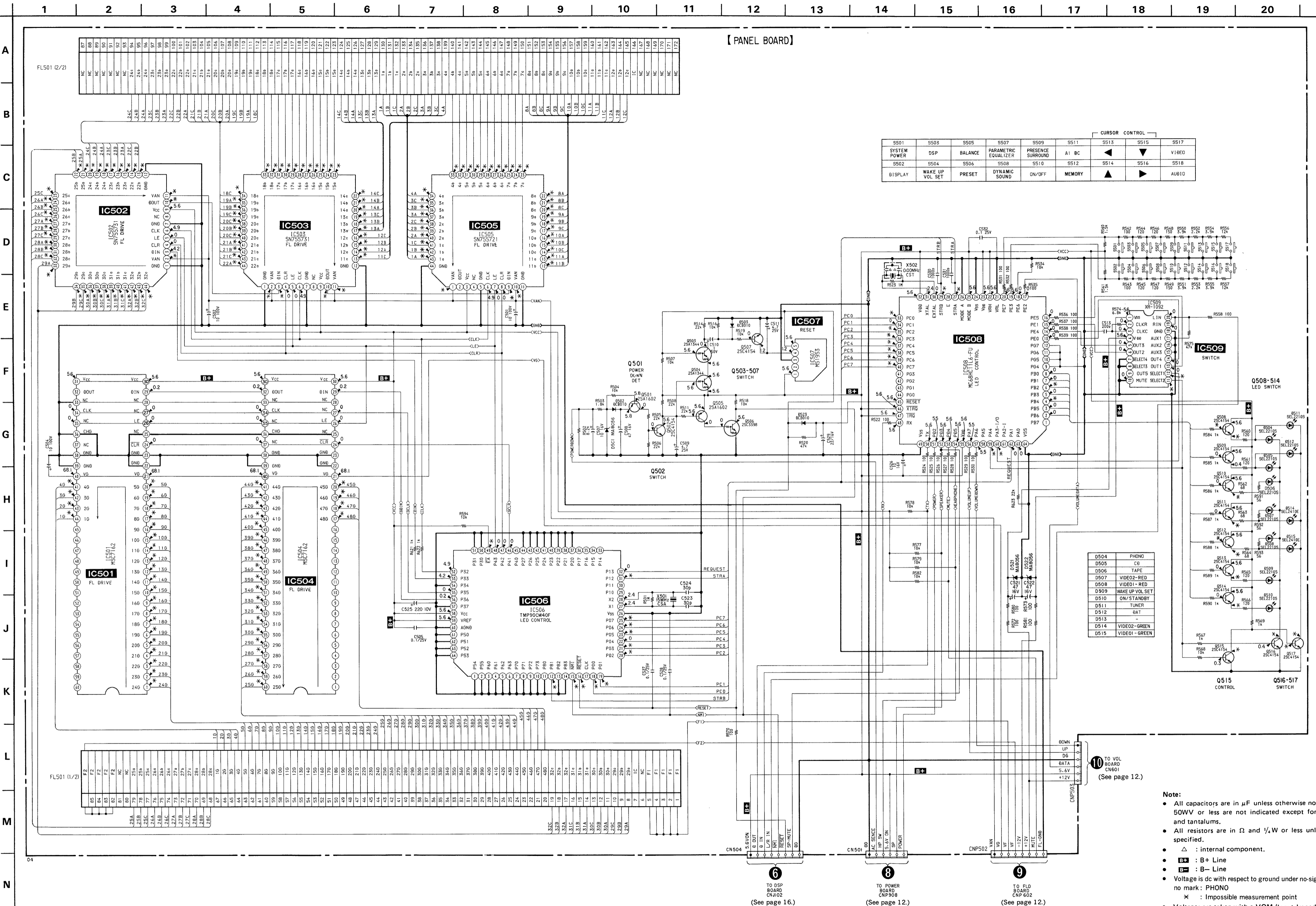

[ PANEL BOARD ]

CURSOR CONTROL									
S501	S503	S505	S507	S509	S511	S513	S515	S517	
SYSTEM POWER	DSP BALANCE	PARAMETRIC EQUALIZER	PRESENCE SURROUND	A1 BC	V18E0				
S502	S504	S506	S508	S510	S512	S514	S516	S518	
BISPLAY	WAKE UP VOL SET	PRESET	DYNAMIC SOUND	DN/OFF	MEMORY			AUB10	

DS04	PHONO
DS05	CD
DS06	TAPE
DS07	VIDEO2-RED
DS08	VIDEO1-RED
DS09	WAKE UP VOL SET
DS10	ON/STANDBY
DS11	TUNER
DS12	BAT
DS13	-
DS14	VIDEO2-GREEN
DS15	VIDEO1-GREEN

- Note:**
- All capacitors are in  $\mu\text{F}$  unless otherwise noted.  $\text{pF}$  :  $\mu\text{M}$ F 50WV or less are not indicated except for electrolytics and tantalums.
  - All resistors are in  $\Omega$  and  $1/2\text{W}$  or less unless otherwise specified.
  - $\Delta$  : internal component.
  - B+** : B+ Line
  - B-** : B- Line
  - Voltage is dc with respect to ground under no-signal conditions. no mark : PHONO
  - \* : Impossible measurement point
  - Voltagers are taken with a VOM (Input Impedance 10M $\Omega$ ). Voltage variations may be noted due to normal production tolerances.



• IC Block Diagrams

IC601 LB1639

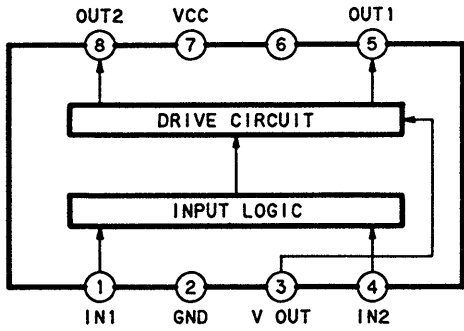

IC701  $\mu$ PC1237HA

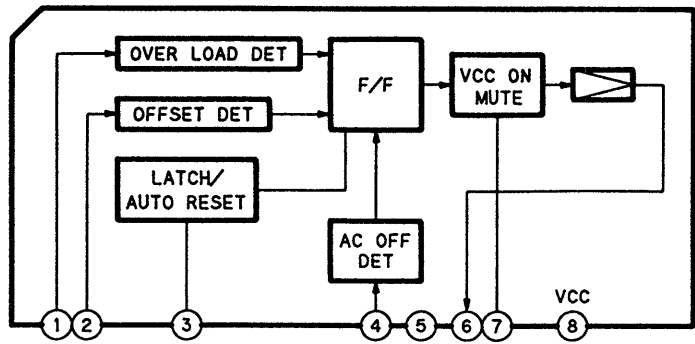

IC901 M5230L-A

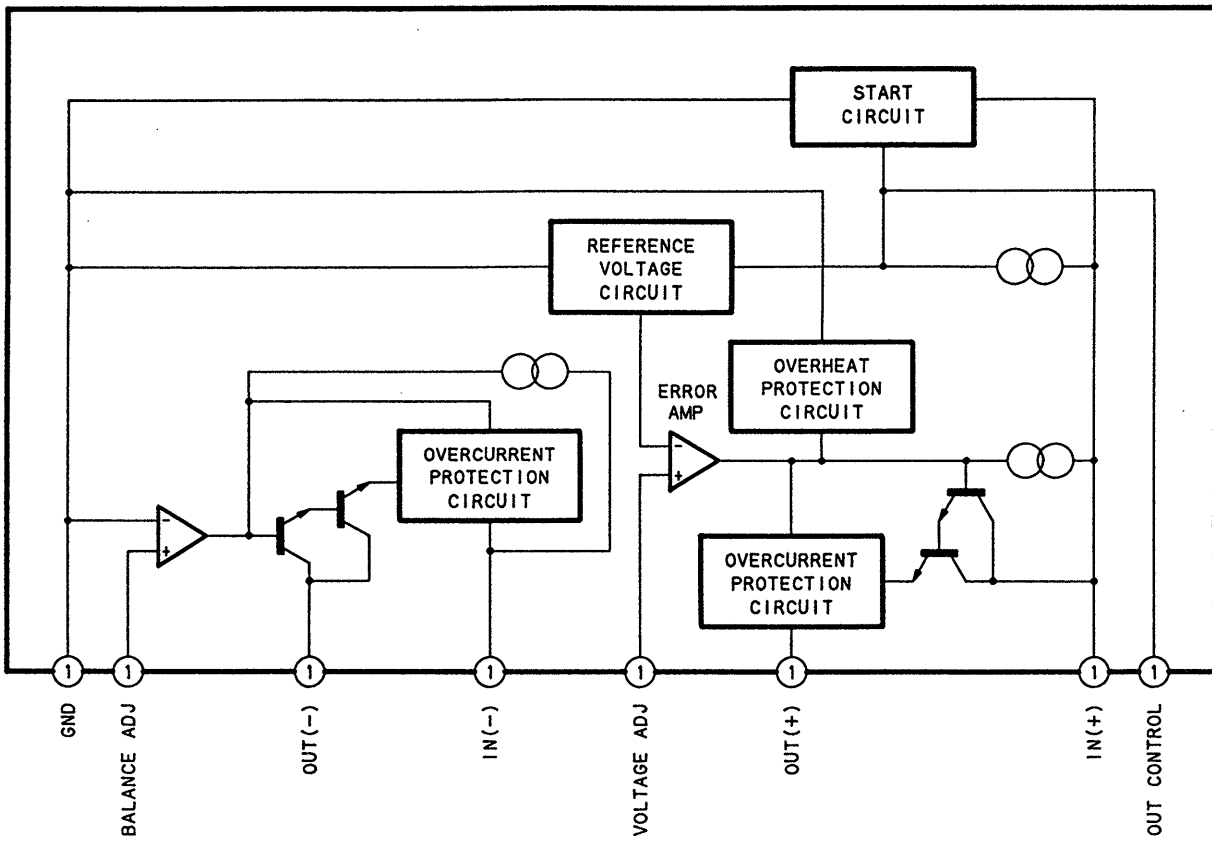

## SECTION 4 EXPLODED VIEWS

**NOTE:**

- The mechanical parts with no reference number in the exploded views are not supplied.
- Items marked "\*" are not stocked since they are seldom required for routine service. Some delay should be anticipated when ordering these items.

- -XX and -X mean standardized parts, so they may have some difference from the original one.

● Color Indication of Appearance Parts  
 Example :  
 KNOB, BALANCE (WHITE)... (RED)  
                   ↑                  ↑  
                   Parts Color Cabinet's Color

- Hardware (# mark) list is given in the last of this parts list.

The components identified by mark  $\triangle$  or dotted line with mark  $\triangle$  are critical for safety. Replace only with part number specified.

### 4-1. FRONT PANEL ASSY

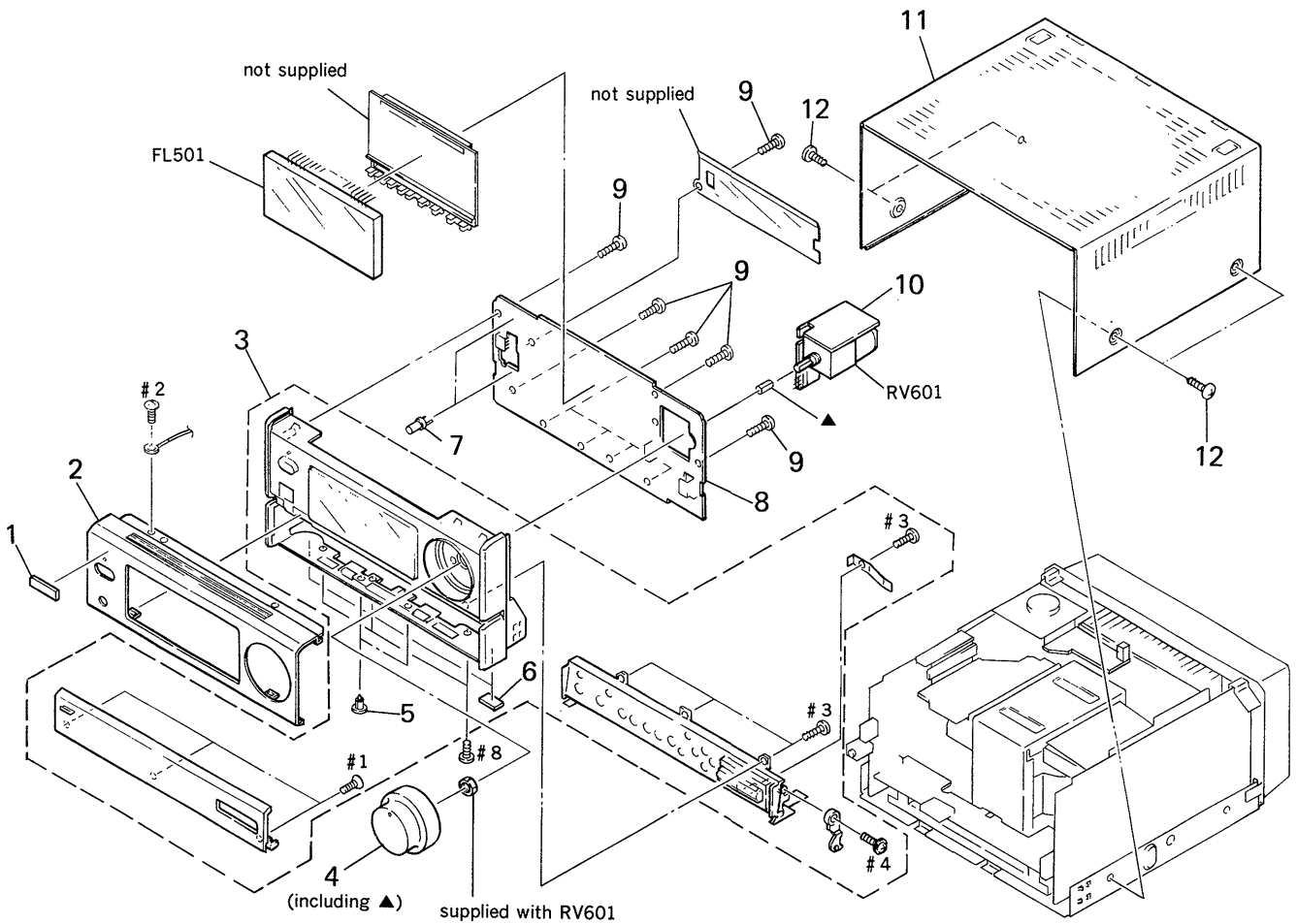

Ref. No.	Part No.	Description	Remark
1	4-942-636-11	EMBLEM (NO. 3.5), SONY	
2	X-4942-476-2	PANEL ASSY, FRONT	
3	X-4942-716-1	PANEL (BASE) ASSY	
4	X-4942-478-1	KNOB (VOLUME) ASSY	
5	4-812-134-00	RIVET NYLON, 3.5	
6	4-930-336-21	FOOT (FELT)	
* 7	3-362-478-21	HOLDER (T), LED	

Ref. No.	Part No.	Description	Remark
* 8	A-4347-015-A	PANEL BOARD, COMPLETE	
9	4-928-635-01	SCREW, +BV (2.6X8) TAPPING	
* 10	1-644-837-11	VOL BOARD	
* 11	4-932-841-71	CASE	
12	3-363-099-01	SCREW (CASE +3X8 TP2)	
FL501	1-519-654-11	INDICATOR TUBE, FLUORESCENT	
RV601	1-241-803-11	RES, VAR, CARBON (WITH MOTOR) 10K (VOLUME)	

## 4-2. CHASSIS SECTION

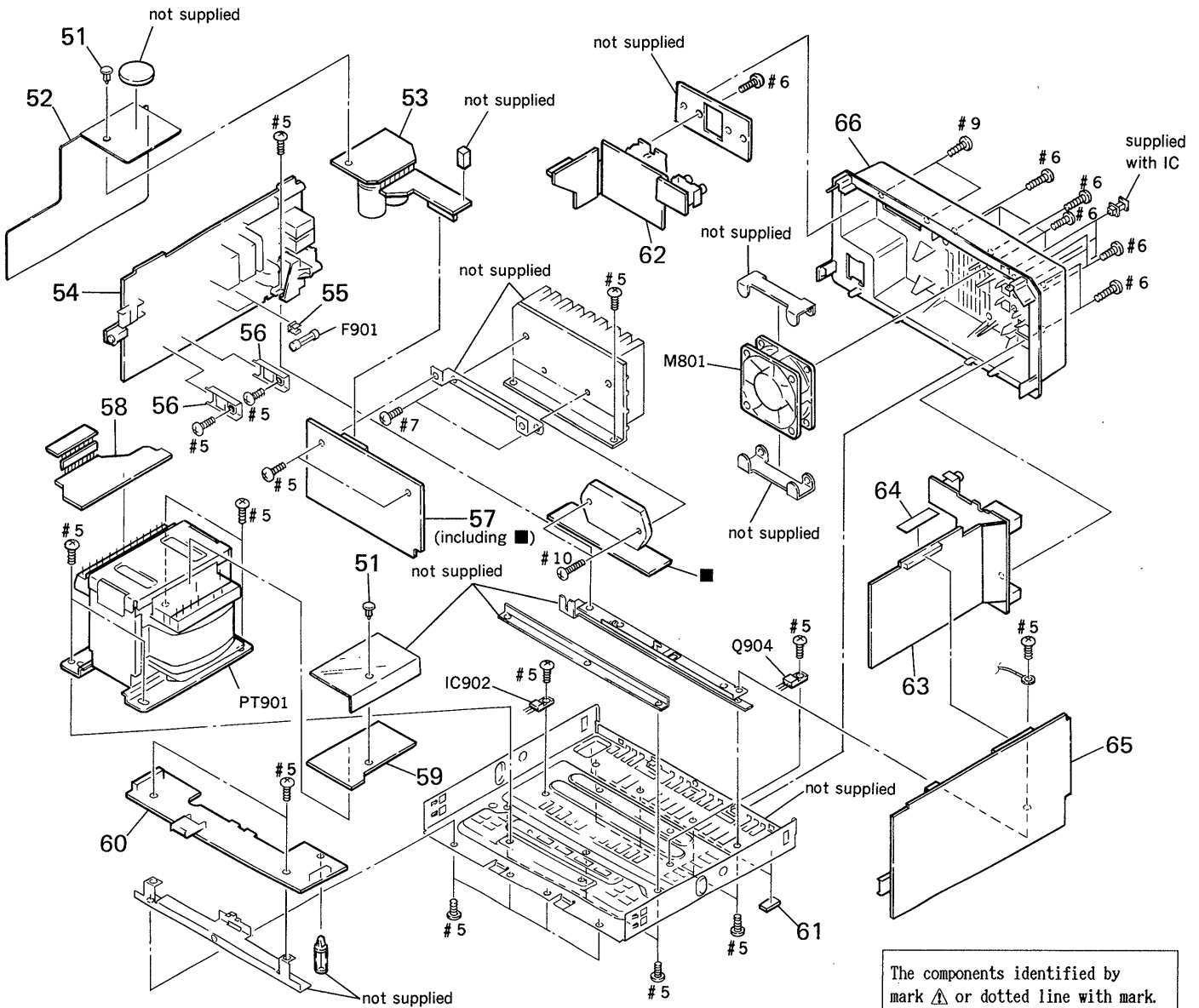

Ref. No.	Part No.	Description	Remark
	51	4-812-134-11 RIVET NYLON, 3.5	
*	52	4-945-055-11 SHEET (INSULATING A)	
*	53	1-644-841-11 ELECT CAPACITOR BOARD	
*	54	A-4356-274-A POWER BOARD, COMPLETE	
*	55	1-533-213-31 HOLDER, FUSE	
*	56	3-309-144-21 HEAT SINK	
*	57	A-4356-052-A POWER AMPLIFIER BOARD, COMPLETE	
*	58	1-644-839-11 TRANSFORMER (A) BOARD	
*	59	1-644-840-11 TRANSFORMER (B) BOARD	
*	60	A-4356-256-A FLD BOARD, COMPLETE	
	61	4-930-336-21 FOOT (FELT)	

Ref. No.	Part No.	Description	Remark
*	62	1-644-586-11 SPEAKER BOARD	
*	63	1-642-413-11 JACK BOARD	
	64	4-860-518-00 CUSHION	
*	65	A-4356-275-A DSP BOARD, COMPLETE	
*	66	4-948-766-61 PANEL, BACK	
	$\triangle$ F901	1-532-286-00 FUSE, TIME-LAG (T2.5A)	
	IC902	8-759-231-53 IC TA7805S	
	M801	1-541-860-11 MOTOR, DC FAN	
	$\triangle$ PT901	1-450-977-11 TRANSFORMER, POWER (AEP)	
	$\triangle$ PT901	1-450-978-11 TRANSFORMER, POWER (UK)	
	Q904	8-729-209-15 TRANSISTOR 2SD2012	

## SECTION 5 ELECTRICAL PARTS LIST

DSP

PANEL

## NOTE:

- Due to standardization, replacements in the parts list may be different from the parts specified in the diagrams or the components used on the set.
- -XX and -X mean standardized parts, so they may have some difference from the original one.
- RESISTORS  
All resistors are in ohms.  
METAL: Metal-film resistor.  
METAL OXIDE: Metal oxide-film resistor.  
F: nonflammable

- Items marked "\*" are not stocked since they are seldom required for routine service. Some delay should be anticipated when ordering these items.
- SEMICONDUCTORS  
In each case, u:  $\mu$ , for example:  
uA ..:  $\mu$ A.    uPA..:  $\mu$ PA.  
uPB..:  $\mu$ PB.    uPC..:  $\mu$ PC.    uPD..:  $\mu$ PD.
- CAPACITORS  
uF:  $\mu$ F
- COILS  
uH:  $\mu$ H

The components identified by mark  $\triangle$  or dotted line with mark  $\triangle$  are critical for safety. Replace only with part number specified.

When indicating parts by reference number, please include the board.

Ref. No.	Part No.	Description	Remark	Ref. No.	Part No.	Description	Remark
*	A-4356-275-A	DSP BOARD, COMPLETE *****		C152	1-126-947-11	ELECT 47uF 20%	35V
*	A-4347-015-A	PANEL BOARD, COMPLETE *****		C153	1-164-004-11	CERAMIC CHIP 0.1uF 10%	25V
				C154	1-164-004-11	CERAMIC CHIP 0.1uF 10%	25V
				C155	1-164-346-11	CERAMIC CHIP 1uF	16V
				C156	1-164-489-11	CERAMIC CHIP 0.22uF 10%	16V
*	3-362-478-21	HOLDER (T), LED  < CAPACITOR >		C157	1-164-346-11	CERAMIC CHIP 1uF	16V
				C160	1-164-004-11	CERAMIC CHIP 0.1uF 10%	25V
				C161	1-164-346-11	CERAMIC CHIP 1uF	16V
C102	1-124-589-11	ELECT 47uF 20%	16V	C162	1-164-489-11	CERAMIC CHIP 0.22uF 10%	16V
C103	1-124-589-11	ELECT 47uF 20%	16V	C163	1-164-346-11	CERAMIC CHIP 1uF	16V
C104	1-136-153-00	FILM 0.01uF 5%	50V	C166	1-164-004-11	CERAMIC CHIP 0.1uF 10%	25V
C105	1-136-153-00	FILM 0.01uF 5%	50V	C169	1-164-346-11	CERAMIC CHIP 1uF	16V
C106	1-124-589-11	ELECT 47uF 20%	16V	C170	1-163-109-00	CERAMIC CHIP 47PF 5%	50V
C107	1-164-004-11	CERAMIC CHIP 0.1uF 10%	25V	C171	1-163-227-11	CERAMIC CHIP 10PF 5%	50V
C108	1-164-004-11	CERAMIC CHIP 0.1uF 10%	25V	C172	1-163-109-00	CERAMIC CHIP 47PF 5%	50V
C109	1-164-232-11	CERAMIC CHIP 0.01uF	50V	C173	1-164-232-11	CERAMIC CHIP 0.01uF	50V
C110	1-164-232-11	CERAMIC CHIP 0.01uF	50V	C174	1-164-232-11	CERAMIC CHIP 0.01uF	50V
C111	1-164-232-11	CERAMIC CHIP 0.01uF	50V	C175	1-163-141-00	CERAMIC CHIP 0.001uF 5%	50V
C125	1-124-915-11	ELECT 10uF 20%	63V	C176	1-163-141-00	CERAMIC CHIP 0.001uF 5%	50V
C126	1-130-475-00	MYLAR 0.0022uF 5%	50V	C178	1-163-141-00	CERAMIC CHIP 0.001uF 5%	50V
C127	1-163-117-00	CERAMIC CHIP 100PF 5%	50V	C179	1-164-232-11	CERAMIC CHIP 0.01uF	50V
C128	1-124-915-11	ELECT 10uF 20%	63V	C180	1-164-232-11	CERAMIC CHIP 0.01uF	50V
C129	1-164-004-11	CERAMIC CHIP 0.1uF 10%	25V	C183	1-163-227-11	CERAMIC CHIP 10PF 5%	50V
C130	1-124-915-11	ELECT 10uF 20%	63V	C184	1-163-227-11	CERAMIC CHIP 10PF 5%	50V
C131	1-164-004-11	CERAMIC CHIP 0.1uF 10%	25V	C185	1-164-232-11	CERAMIC CHIP 0.01uF	50V
C132	1-124-915-11	ELECT 10uF 20%	63V	C186	1-164-232-11	CERAMIC CHIP 0.01uF	50V
C133	1-164-004-11	CERAMIC CHIP 0.1uF 10%	25V	C187	1-163-141-00	CERAMIC CHIP 0.001uF 5%	50V
C134	1-126-947-11	ELECT 47uF 20%	35V	C188	1-164-232-11	CERAMIC CHIP 0.01uF	50V
C136	1-126-947-11	ELECT 47uF 20%	35V	C189	1-124-589-11	ELECT 47uF 20%	16V
C137	1-126-947-11	ELECT 47uF 20%	35V	C190	1-164-346-11	CERAMIC CHIP 1uF	16V
C138	1-164-004-11	CERAMIC CHIP 0.1uF 10%	25V	C192	1-124-902-00	ELECT 0.47uF 20%	50V
C139	1-164-346-11	CERAMIC CHIP 1uF	16V	C193	1-164-232-11	CERAMIC CHIP 0.01uF	50V
C140	1-164-346-11	CERAMIC CHIP 1uF	16V	C196	1-124-589-11	ELECT 47uF 20%	16V
C141	1-164-004-11	CERAMIC CHIP 0.1uF 10%	25V	C197	1-126-947-11	ELECT 47uF 20%	35V
C142	1-124-915-11	ELECT 10uF 20%	63V	C198	1-126-947-11	ELECT 47uF 20%	35V
C143	1-126-162-11	ELECT 3.3uF 20%	50V	C199	1-163-129-00	CERAMIC CHIP 330PF 5%	50V
C144	1-126-947-11	ELECT 47uF 20%	35V	C225	1-124-915-11	ELECT 10uF 20%	63V
C147	1-124-915-11	ELECT 10uF 20%	63V	C226	1-130-475-00	MYLAR 0.0022uF 5%	50V
C148	1-126-162-11	ELECT 3.3uF 20%	50V	C227	1-163-117-00	CERAMIC CHIP 100PF 5%	50V
C149	1-126-947-11	ELECT 47uF 20%	35V	C228	1-124-915-11	ELECT 10uF 20%	63V

DSP

PANEL

Ref. No.	Part No.	Description	Remark	Ref. No.	Part No.	Description	Remark
C229	1-164-004-11	CERAMIC CHIP 0.1uF	10% 25V	C346	1-164-004-11	CERAMIC CHIP 0.1uF	10% 25V
C230	1-124-915-11	ELECT 10uF	20% 63V	C347	1-163-117-00	CERAMIC CHIP 100PF	5% 50V
C231	1-164-004-11	CERAMIC CHIP 0.1uF	10% 25V	C348	1-163-117-00	CERAMIC CHIP 100PF	5% 50V
C232	1-124-915-11	ELECT 10uF	20% 63V	C349	1-126-157-11	ELECT 10uF	20% 16V
C233	1-164-004-11	CERAMIC CHIP 0.1uF	10% 25V	C350	1-163-222-11	CERAMIC CHIP 5PF	0.25PF50V
C234	1-126-947-11	ELECT 47uF	20% 35V	C352	1-164-232-11	CERAMIC CHIP 0.01uF	50V
C238	1-164-232-11	CERAMIC CHIP 0.01uF	50V	C353	1-124-229-00	ELECT 33uF	20% 10V
C239	1-163-117-00	CERAMIC CHIP 100PF	5% 50V	C356	1-164-004-11	CERAMIC CHIP 0.1uF	10% 25V
C240	1-164-232-11	CERAMIC CHIP 0.01uF	50V	C359	1-164-004-11	CERAMIC CHIP 0.1uF	10% 25V
C241	1-164-232-11	CERAMIC CHIP 0.01uF	50V	C360	1-124-443-00	ELECT 100uF	20% 10V
C245	1-164-004-11	CERAMIC CHIP 0.1uF	10% 25V	C361	1-124-443-00	ELECT 100uF	20% 10V
C249	1-164-346-11	CERAMIC CHIP 1uF	16V	C362	1-164-004-11	CERAMIC CHIP 0.1uF	10% 25V
C250	1-164-346-11	CERAMIC CHIP 1uF	16V	C364	1-164-004-11	CERAMIC CHIP 0.1uF	10% 25V
C251	1-164-004-11	CERAMIC CHIP 0.1uF	10% 25V	C375	1-163-141-00	CERAMIC CHIP 0.001uF	5% 50V
C252	1-164-004-11	CERAMIC CHIP 0.1uF	10% 25V	C376	1-163-141-00	CERAMIC CHIP 0.001uF	5% 50V
C253	1-164-346-11	CERAMIC CHIP 1uF	16V	C389	1-163-099-00	CERAMIC CHIP 18PF	5% 50V
C254	1-164-346-11	CERAMIC CHIP 1uF	16V	C501	1-124-667-11	ELECT 10uF	20% 100V
C257	1-164-346-11	CERAMIC CHIP 1uF	16V	C502	1-124-667-11	ELECT 10uF	20% 100V
C258	1-164-346-11	CERAMIC CHIP 1uF	16V	C504	1-124-667-11	ELECT 10uF	20% 100V
C259	1-164-346-11	CERAMIC CHIP 1uF	16V	C505	1-164-004-11	CERAMIC CHIP 0.1uF	10% 25V
C260	1-164-346-11	CERAMIC CHIP 1uF	16V	C507	1-126-157-11	ELECT 10uF	20% 16V
C263	1-164-346-11	CERAMIC CHIP 1uF	16V	C508	1-124-589-11	ELECT 47uF	20% 16V
C264	1-164-346-11	CERAMIC CHIP 1uF	16V	C509	1-126-163-11	ELECT 4.7uF	20% 50V
C269	1-164-004-11	CERAMIC CHIP 0.1uF	10% 25V	C510	1-126-301-11	ELECT 1uF	20% 50V
C270	1-164-346-11	CERAMIC CHIP 1uF	16V	C511	1-126-163-11	ELECT 4.7uF	20% 50V
C271	1-164-346-11	CERAMIC CHIP 1uF	16V	C513	1-163-124-00	CERAMIC CHIP 200PF	5% 50V
C272	1-124-589-11	ELECT 47uF	20% 16V	C521	1-124-589-11	ELECT 47uF	20% 16V
C273	1-163-129-00	CERAMIC CHIP 330PF	5% 50V	C522	1-124-589-11	ELECT 47uF	20% 16V
C274	1-163-129-00	CERAMIC CHIP 330PF	5% 50V	C523	1-163-104-00	CERAMIC CHIP 30PF	5% 50V
C275	1-163-141-00	CERAMIC CHIP 0.001uF	5% 50V	C524	1-163-104-00	CERAMIC CHIP 30PF	5% 50V
C276	1-163-141-00	CERAMIC CHIP 0.001uF	5% 50V	C525	1-126-176-11	ELECT 220uF	20% 10V
C278	1-163-141-00	CERAMIC CHIP 0.001uF	5% 50V	C526	1-126-157-11	ELECT 10uF	20% 16V
C279	1-126-163-11	ELECT 4.7uF	20% 50V	C527	1-164-004-11	CERAMIC CHIP 0.1uF	10% 25V
C280	1-164-232-11	CERAMIC CHIP 0.01uF	50V	C528	1-164-004-11	CERAMIC CHIP 0.1uF	10% 25V
C331	1-163-123-00	CERAMIC CHIP 180PF	5% 50V	C529	1-124-234-00	ELECT 22uF	20% 16V
C332	1-163-123-00	CERAMIC CHIP 180PF	5% 50V	C530	1-163-141-00	CERAMIC CHIP 0.001uF	5% 50V
C333	1-163-131-00	CERAMIC CHIP 390PF	5% 50V	C531	1-163-141-00	CERAMIC CHIP 0.001uF	5% 50V
C334	1-163-123-00	CERAMIC CHIP 180PF	5% 50V	C532	1-164-004-11	CERAMIC CHIP 0.1uF	10% 25V
C335	1-163-123-00	CERAMIC CHIP 180PF	5% 50V	C1201	1-163-005-11	CERAMIC CHIP 470PF	10% 50V
C336	1-163-131-00	CERAMIC CHIP 390PF	5% 50V	C1202	1-164-161-11	CERAMIC CHIP 0.0022uF	10% 100V
C337	1-124-229-00	ELECT 33uF	20% 10V	C1251	1-163-005-11	CERAMIC CHIP 470PF	10% 50V
C338	1-164-004-11	CERAMIC CHIP 0.1uF	10% 25V	C1252	1-164-161-11	CERAMIC CHIP 0.0022uF	10% 100V
C339	1-124-229-00	ELECT 33uF	20% 10V	C1270	1-163-117-00	CERAMIC CHIP 100PF	5% 50V
C340	1-164-004-11	CERAMIC CHIP 0.1uF	10% 25V	C1271	1-163-117-00	CERAMIC CHIP 100PF	5% 50V
C341	1-124-229-00	ELECT 33uF	20% 10V	C1272	1-164-232-11	CERAMIC CHIP 0.01uF	50V
C342	1-164-232-11	CERAMIC CHIP 0.01uF	50V	C1273	1-164-232-11	CERAMIC CHIP 0.01uF	50V
C343	1-124-229-00	ELECT 33uF	20% 10V	C1301	1-164-004-11	CERAMIC CHIP 0.1uF	10% 25V
C344	1-164-004-11	CERAMIC CHIP 0.1uF	10% 25V	C1302	1-164-004-11	CERAMIC CHIP 0.1uF	10% 25V
C345	1-124-229-00	ELECT 33uF	20% 10V	C1501	1-164-346-11	CERAMIC CHIP 1uF	16V

DSP

PANEL

Ref. No.	Part No.	Description	Remark
C1502	1-164-346-11	CERAMIC CHIP 1uF	16V
< CONNECTOR >			
* CN501	1-568-318-11	PLUG, CONNECTOR 6P	
* CN504	1-568-320-11	PLUG, CONNECTOR 8P	
CNJ102	1-568-319-11	SOCKET, CONNECTOR 8P	
CNP101	1-566-144-11	CONNECTOR, BOARD TO BOARD 16P	
CNP103	1-573-146-11	PLUG, CONNECTOR 8P	
* CNP104	1-564-509-11	PLUG, CONNECTOR 6P	
* CNP105	1-564-521-11	PLUG, CONNECTOR 6P	
* CNP502	1-568-320-11	PLUG, CONNECTOR 8P	
CNP503	1-561-115-00	SOCKET, CONNECTOR 6P	
< DIODE >			
D100	8-719-800-76	DIODE 1SS226	
D101	8-719-800-76	DIODE 1SS226	
D103	8-719-800-76	DIODE 1SS226	
D106	8-719-002-81	DIODE 1T363	
D107	8-719-002-81	DIODE 1T363	
D108	8-719-002-81	DIODE 1T363	
D109	8-719-002-81	DIODE 1T363	
D110	8-719-990-39	DIODE DCB010	
D111	8-719-990-39	DIODE DCB010	
D112	8-719-990-39	DIODE DCB010	
D113	8-719-990-39	DIODE DCB010	
D331	8-719-990-39	DIODE DCB010	
D333	8-719-210-39	DIODE EC10QS-04	
D334	8-719-021-49	DIODE UZM6. 2X	
D501	8-719-422-46	DIODE MA8056	
D502	8-719-990-39	DIODE DCB010	
D503	8-719-990-39	DIODE DCB010	
D504	8-719-301-39	LED SEL2210S (PHONO)	
D505	8-719-301-39	LED SEL2210S (CD)	
D506	8-719-301-39	LED SEL2210S (TAPE)	
D507	8-719-301-39	LED SEL2210S (VIDEO2)	
D508	8-719-301-39	LED SEL2210S (VIDEO1)	
D509	8-719-301-39	LED SEL2210S (WAKE UP VOL SET)	
D510	8-719-301-39	LED SEL2210S (ON/STANDBY)	
D511	8-719-301-39	LED SEL2210S (TUNER)	
D512	8-719-301-39	LED SEL2210S (DAT)	
D514	8-719-301-44	LED SEL2410E-D (VIDEO2)	
D515	8-719-301-44	LED SEL2410E-D (VIDEO1)	
D521	8-719-422-46	DIODE MA8056	
D522	8-719-422-46	DIODE MA8056	
D523	8-719-990-39	DIODE DCB010	
D1201	8-719-800-76	DIODE 1SS226	
D1251	8-719-800-76	DIODE 1SS226	
D1270	8-719-990-39	DIODE DCB010	
D1501	8-719-990-39	DIODE DCB010	

Ref. No.	Part No.	Description	Remark
D1502	8-719-990-39	DIODE DCB010	
D1503	8-719-990-39	DIODE DCB010	
< TRANSISTOR >			
FET1201	8-729-232-69	TRANSISTOR 2SK208GR3	
FET1251	8-729-232-69	TRANSISTOR 2SK208GR3	
< FLUORESCENT INDICATOR >			
FL501	1-519-654-11	INDICATOR TUBE, FLUORESCENT	
< IC >			
IC101	8-759-635-26	IC M5283P	
IC102	8-759-045-15	IC CS5339-KS	
IC103	8-759-805-14	IC LC7822	
IC104	8-759-805-14	IC LC7822	
IC106	8-759-511-68	IC CXD8245M	
IC108	8-752-339-86	IC CXD2557M	
IC109	8-759-059-84	IC M37450M8-514FP	
IC110	8-759-973-04	IC MSM41464-10RS	
IC111	8-752-341-99	IC CXD2701Q	
IC112	8-752-332-80	IC CXD1160AQ	
IC113	8-759-636-55	IC M5218AFP	
IC114	8-759-636-55	IC M5218AFP	
IC115	8-759-636-55	IC M5218AFP	
IC116	8-759-636-55	IC M5218AFP	
IC118	8-759-636-55	IC M5218AFP	
IC119	8-759-636-55	IC M5218AFP	
IC121	8-759-908-17	IC TL082CPS	
IC122	8-759-982-44	IC RC79L05A	
IC123	8-759-054-64	IC CXD2905AQ	
IC124	8-759-517-14	IC MB625473PF-G	
IC125	8-759-982-21	IC RC78L05A	
IC331	8-752-349-01	IC CXD2561AM	
IC332	8-752-342-65	IC CXD2560M	
IC333	8-759-234-20	IC TC7S08F	
IC501	8-759-512-46	IC MSC7162	
IC502	8-759-512-45	IC SN755731	
IC503	8-759-512-45	IC SN755731	
IC504	8-759-512-46	IC MSC7162	
IC505	8-759-512-47	IC SN755721	
IC506	8-759-059-82	IC TMP90CM40F-2611	
IC507	8-759-605-16	IC M51953BL	
IC508	8-759-059-83	IC MC68HC11L6SC400618FU	
IC509	8-759-512-48	IC XR-1092	
< JUMPER RESISTOR >			
JW103	1-216-095-00	METAL CHIP 0	5% 1/10W

DSP

PANEL

Ref. No.	Part No.	Description	Remark	Ref. No.	Part No.	Description	Remark
< COIL >							
L100	1-410-397-21	FERRITE BEAD INDUCTOR		Q509	8-729-602-21	TRANSISTOR 2SC4154	
L102	1-406-416-11	COIL (OSC)		Q510	8-729-602-21	TRANSISTOR 2SC4154	
L260	1-412-390-21	INDUCTOR CHIP 0uH		Q511	8-729-602-21	TRANSISTOR 2SC4154	
L262	1-412-390-21	INDUCTOR CHIP 0uH		Q512	8-729-602-21	TRANSISTOR 2SC4154	
L333	1-412-390-21	INDUCTOR CHIP 0uH		Q513	8-729-602-21	TRANSISTOR 2SC4154	
L399	1-410-369-11	INDUCTOR CHIP 1uH		Q514	8-729-602-21	TRANSISTOR 2SC4154	
< TRANSISTOR >							
Q100	8-729-107-46	TRANSISTOR 2SC3624A-L15		Q515	8-729-602-21	TRANSISTOR 2SC4154	
Q101	8-729-107-46	TRANSISTOR 2SC3624A-L15		Q516	8-729-602-21	TRANSISTOR 2SC4154	
Q102	8-729-107-46	TRANSISTOR 2SC3624A-L15		Q517	8-729-602-21	TRANSISTOR 2SC4154	
Q103	8-729-107-46	TRANSISTOR 2SC3624A-L15		Q1201	8-729-602-21	TRANSISTOR 2SC4154	
Q104	8-729-107-46	TRANSISTOR 2SC3624A-L15		Q1251	8-729-602-21	TRANSISTOR 2SC4154	
Q105	8-729-107-46	TRANSISTOR 2SC3624A-L15		Q1501	8-729-805-65	TRANSISTOR 2SA1344	
Q106	8-729-805-65	TRANSISTOR 2SA1344		< RESISTOR >			
Q107	8-729-805-65	TRANSISTOR 2SA1344		R101	1-216-081-00	METAL CHIP 22K 5% 1/10W	
Q108	8-729-805-65	TRANSISTOR 2SA1344		R103	1-216-025-00	METAL CHIP 100 5% 1/10W	
Q109	8-729-602-21	TRANSISTOR 2SC4154		R104	1-216-025-00	METAL CHIP 100 5% 1/10W	
Q110	8-729-805-65	TRANSISTOR 2SA1344		R105	1-216-088-00	METAL CHIP 43K 5% 1/10W	
Q111	8-729-805-65	TRANSISTOR 2SA1344		R108	1-216-025-00	METAL CHIP 100 5% 1/10W	
Q112	8-729-107-46	TRANSISTOR 2SC3624A-L15		R109	1-216-025-00	METAL CHIP 100 5% 1/10W	
Q113	8-729-107-46	TRANSISTOR 2SC3624A-L15		R110	1-216-041-00	METAL CHIP 470 5% 1/10W	
Q114	8-729-107-46	TRANSISTOR 2SC3624A-L15		R111	1-216-041-00	METAL CHIP 470 5% 1/10W	
Q115	8-729-805-41	TRANSISTOR 2SC3398		R112	1-216-041-00	METAL CHIP 470 5% 1/10W	
Q116	8-729-602-21	TRANSISTOR 2SC4154		R113	1-216-041-00	METAL CHIP 470 5% 1/10W	
Q117	8-729-602-21	TRANSISTOR 2SC4154		R115	1-216-041-00	METAL CHIP 470 5% 1/10W	
Q118	8-729-805-41	TRANSISTOR 2SC3398		R116	1-216-041-00	METAL CHIP 470 5% 1/10W	
Q123	8-729-805-65	TRANSISTOR 2SA1344		R117	1-216-041-00	METAL CHIP 470 5% 1/10W	
Q124	8-729-107-46	TRANSISTOR 2SC3624A-L15		R118	1-216-041-00	METAL CHIP 470 5% 1/10W	
Q125	8-729-602-36	TRANSISTOR 2SA1602		R126	1-216-071-00	METAL CHIP 8.2K 5% 1/10W	
Q126	8-729-805-65	TRANSISTOR 2SA1344		R127	1-216-049-00	METAL CHIP 1K 5% 1/10W	
Q127	8-729-805-41	TRANSISTOR 2SC3398		R128	1-216-067-00	METAL CHIP 5.6K 5% 1/10W	
Q128	8-729-107-46	TRANSISTOR 2SC3624A-L15		R129	1-216-065-00	METAL CHIP 4.7K 5% 1/10W	
Q129	8-729-107-46	TRANSISTOR 2SC3624A-L15		R130	1-216-113-00	METAL CHIP 470K 5% 1/10W	
Q130	8-729-805-65	TRANSISTOR 2SA1344		R131	1-216-053-00	METAL CHIP 1.5K 5% 1/10W	
Q132	8-729-805-65	TRANSISTOR 2SA1344		R132	1-216-061-00	METAL CHIP 3.3K 5% 1/10W	
Q331	8-729-805-41	TRANSISTOR 2SC3398		R133	1-216-113-00	METAL CHIP 470K 5% 1/10W	
Q332	8-729-805-65	TRANSISTOR 2SA1344		R134	1-216-043-00	METAL CHIP 560 5% 1/10W	
Q333	8-729-205-97	TRANSISTOR 2SC3668-Y		R135	1-216-057-00	METAL CHIP 2.2K 5% 1/10W	
Q501	8-729-602-36	TRANSISTOR 2SA1602		R136	1-216-113-00	METAL CHIP 470K 5% 1/10W	
Q502	8-729-602-21	TRANSISTOR 2SC4154		R137	1-216-051-00	METAL CHIP 1.2K 5% 1/10W	
Q503	8-729-805-65	TRANSISTOR 2SA1344		R138	1-216-065-00	METAL CHIP 4.7K 5% 1/10W	
Q504	8-729-805-65	TRANSISTOR 2SA1344		R139	1-216-065-00	METAL CHIP 4.7K 5% 1/10W	
Q505	8-729-602-36	TRANSISTOR 2SA1602		R140	1-216-065-00	METAL CHIP 4.7K 5% 1/10W	
Q506	8-729-805-41	TRANSISTOR 2SC3398		R141	1-216-097-00	METAL CHIP 100K 5% 1/10W	
Q507	8-729-602-21	TRANSISTOR 2SC4154		R142	1-216-097-00	METAL CHIP 100K 5% 1/10W	
Q508	8-729-602-21	TRANSISTOR 2SC4154		R143	1-216-097-00	METAL CHIP 100K 5% 1/10W	
				R146	1-216-073-00	METAL CHIP 10K 5% 1/10W	
				R147	1-216-065-00	METAL CHIP 4.7K 5% 1/10W	
				R148	1-216-073-00	METAL CHIP 10K 5% 1/10W	

DSP

PANEL

Ref. No.	Part No.	Description	Remark			Ref. No.	Part No.	Description	Remark		
R149	1-216-073-00	METAL CHIP	10K	5%	1/10W	R208	1-216-097-00	METAL CHIP	100K	5%	1/10W
R150	1-216-097-00	METAL CHIP	100K	5%	1/10W	R209	1-216-097-00	METAL CHIP	100K	5%	1/10W
R151	1-216-065-00	METAL CHIP	4.7K	5%	1/10W	R210	1-216-081-00	METAL CHIP	22K	5%	1/10W
R152	1-216-089-00	METAL CHIP	47K	5%	1/10W	R213	1-216-049-00	METAL CHIP	1K	5%	1/10W
R153	1-216-065-00	METAL CHIP	4.7K	5%	1/10W	R214	1-216-049-00	METAL CHIP	1K	5%	1/10W
R154	1-216-089-00	METAL CHIP	47K	5%	1/10W	R215	1-216-049-00	METAL CHIP	1K	5%	1/10W
R155	1-216-049-00	METAL CHIP	1K	5%	1/10W	R226	1-216-071-00	METAL CHIP	8.2K	5%	1/10W
R156	1-216-081-00	METAL CHIP	22K	5%	1/10W	R227	1-216-049-00	METAL CHIP	1K	5%	1/10W
R157	1-216-103-00	METAL CHIP	180K	5%	1/10W	R228	1-216-067-00	METAL CHIP	5.6K	5%	1/10W
R158	1-216-081-00	METAL CHIP	22K	5%	1/10W	R229	1-216-065-00	METAL CHIP	4.7K	5%	1/10W
R159	1-216-073-00	METAL CHIP	10K	5%	1/10W	R230	1-216-113-00	METAL CHIP	470K	5%	1/10W
R160	1-216-049-00	METAL CHIP	1K	5%	1/10W	R231	1-216-053-00	METAL CHIP	1.5K	5%	1/10W
R163	1-216-049-00	METAL CHIP	1K	5%	1/10W	R232	1-216-061-00	METAL CHIP	3.3K	5%	1/10W
R164	1-216-081-00	METAL CHIP	22K	5%	1/10W	R233	1-216-113-00	METAL CHIP	470K	5%	1/10W
R165	1-216-103-00	METAL CHIP	180K	5%	1/10W	R234	1-216-043-00	METAL CHIP	560	5%	1/10W
R166	1-216-081-00	METAL CHIP	22K	5%	1/10W	R235	1-216-057-00	METAL CHIP	2.2K	5%	1/10W
R167	1-216-073-00	METAL CHIP	10K	5%	1/10W	R236	1-216-113-00	METAL CHIP	470K	5%	1/10W
R168	1-216-049-00	METAL CHIP	1K	5%	1/10W	R237	1-216-051-00	METAL CHIP	1.2K	5%	1/10W
R171	1-216-089-00	METAL CHIP	47K	5%	1/10W	R238	1-216-065-00	METAL CHIP	4.7K	5%	1/10W
R172	1-216-089-00	METAL CHIP	47K	5%	1/10W	R239	1-216-065-00	METAL CHIP	4.7K	5%	1/10W
R173	1-216-089-00	METAL CHIP	47K	5%	1/10W	R240	1-216-065-00	METAL CHIP	4.7K	5%	1/10W
R174	1-216-071-00	METAL CHIP	8.2K	5%	1/10W	R241	1-216-073-00	METAL CHIP	10K	5%	1/10W
R175	1-216-089-00	METAL CHIP	47K	5%	1/10W	R242	1-216-097-00	METAL CHIP	100K	5%	1/10W
R176	1-216-041-00	METAL CHIP	470	5%	1/10W	R243	1-216-097-00	METAL CHIP	100K	5%	1/10W
R177	1-216-097-00	METAL CHIP	100K	5%	1/10W	R250	1-216-037-00	METAL CHIP	330	5%	1/10W
R178	1-216-025-00	METAL CHIP	100	5%	1/10W	R251	1-216-065-00	METAL CHIP	4.7K	5%	1/10W
R179	1-216-073-00	METAL CHIP	10K	5%	1/10W	R252	1-216-057-00	METAL CHIP	2.2K	5%	1/10W
R182	1-216-113-00	METAL CHIP	470K	5%	1/10W	R253	1-216-077-00	METAL CHIP	15K	5%	1/10W
R183	1-216-079-00	METAL CHIP	18K	5%	1/10W	R254	1-216-073-00	METAL CHIP	10K	5%	1/10W
R184	1-216-047-00	METAL CHIP	820	5%	1/10W	R255	1-216-097-00	METAL CHIP	100K	5%	1/10W
R185	1-216-081-00	METAL CHIP	22K	5%	1/10W	R256	1-216-025-00	METAL CHIP	100	5%	1/10W
R186	1-216-689-11	METAL CHIP	39K	0.5%	1/10W	R257	1-216-025-00	METAL CHIP	100	5%	1/10W
R187	1-216-093-00	METAL CHIP	68K	5%	1/10W	R258	1-216-041-00	METAL CHIP	470	5%	1/10W
R188	1-216-109-00	METAL CHIP	330K	5%	1/10W	R259	1-216-041-00	METAL CHIP	470	5%	1/10W
R189	1-216-105-00	METAL CHIP	220K	5%	1/10W	R261	1-216-017-00	METAL CHIP	47	5%	1/10W
R190	1-216-117-00	METAL CHIP	680K	5%	1/10W	R264	1-216-089-00	METAL CHIP	47K	5%	1/10W
R192	1-216-097-00	METAL CHIP	100K	5%	1/10W	R265	1-216-089-00	METAL CHIP	47K	5%	1/10W
R193	1-216-097-00	METAL CHIP	100K	5%	1/10W	R266	1-216-121-00	METAL CHIP	1M	5%	1/10W
R194	1-216-081-00	METAL CHIP	22K	5%	1/10W	R267	1-216-121-00	METAL CHIP	1M	5%	1/10W
R197	1-216-073-00	METAL CHIP	10K	5%	1/10W	R268	1-216-025-00	METAL CHIP	100	5%	1/10W
R198	1-216-113-00	METAL CHIP	470K	5%	1/10W	R269	1-216-025-00	METAL CHIP	100	5%	1/10W
R199	1-216-079-00	METAL CHIP	18K	5%	1/10W	R270	1-216-073-00	METAL CHIP	10K	5%	1/10W
R200	1-216-047-00	METAL CHIP	820	5%	1/10W	R272	1-216-113-00	METAL CHIP	470K	5%	1/10W
R201	1-216-081-00	METAL CHIP	22K	5%	1/10W	R274	1-216-041-00	METAL CHIP	470	5%	1/10W
R202	1-216-689-11	METAL CHIP	39K	0.5%	1/10W	R275	1-216-025-00	METAL CHIP	100	5%	1/10W
R203	1-216-093-00	METAL CHIP	68K	5%	1/10W	R276	1-216-025-00	METAL CHIP	100	5%	1/10W
R204	1-216-109-00	METAL CHIP	330K	5%	1/10W	R277	1-216-049-00	METAL CHIP	1K	5%	1/10W
R205	1-216-105-00	METAL CHIP	220K	5%	1/10W	R280	1-216-025-00	METAL CHIP	100	5%	1/10W
R206	1-216-117-00	METAL CHIP	680K	5%	1/10W	R281	1-216-025-00	METAL CHIP	100	5%	1/10W



DSP

PANEL

Ref. No.	Part No.	Description	Remark			Ref. No.	Part No.	Description	Remark		
R282	1-216-025-00	METAL CHIP	100	5%	1/10W	R347	1-216-065-00	METAL CHIP	4.7K	5%	1/10W
R283	1-216-025-00	METAL CHIP	100	5%	1/10W	R348	1-216-088-00	METAL CHIP	43K	5%	1/10W
R284	1-216-033-00	METAL CHIP	220	5%	1/10W	R349	1-216-129-00	METAL CHIP	2.2M	5%	1/10W
R285	1-216-025-00	METAL CHIP	100	5%	1/10W	R350	1-216-081-00	METAL CHIP	22K	5%	1/10W
R286	1-216-001-00	METAL CHIP	10	5%	1/10W	R352	1-216-083-00	METAL CHIP	27K	5%	1/10W
R287	1-216-089-00	METAL CHIP	47K	5%	1/10W	R353	1-216-088-00	METAL CHIP	43K	5%	1/10W
R288	1-216-089-00	METAL CHIP	47K	5%	1/10W	R354	1-216-089-00	METAL CHIP	47K	5%	1/10W
R289	1-216-033-00	METAL CHIP	220	5%	1/10W	R355	1-216-033-00	METAL CHIP	220	5%	1/10W
R290	1-216-033-00	METAL CHIP	220	5%	1/10W	R358	1-216-057-00	METAL CHIP	2.2K	5%	1/10W
R291	1-216-073-00	METAL CHIP	10K	5%	1/10W	R359	1-216-129-00	METAL CHIP	2.2M	5%	1/10W
R293	1-216-073-00	METAL CHIP	10K	5%	1/10W	R360	1-216-001-00	METAL CHIP	10	5%	1/10W
R294	1-216-025-00	METAL CHIP	100	5%	1/10W	R364	1-216-073-00	METAL CHIP	10K	5%	1/10W
R295	1-216-121-00	METAL CHIP	1M	5%	1/10W	R501	1-216-121-00	METAL CHIP	1M	5%	1/10W
R296	1-216-121-00	METAL CHIP	1M	5%	1/10W	R502	1-216-071-00	METAL CHIP	8.2K	5%	1/10W
R297	1-216-097-00	METAL CHIP	100K	5%	1/10W	R503	1-216-055-00	METAL CHIP	1.8K	5%	1/10W
R298	1-216-097-00	METAL CHIP	100K	5%	1/10W	R504	1-216-073-00	METAL CHIP	10K	5%	1/10W
R301	1-216-025-00	METAL CHIP	100	5%	1/10W	R505	1-216-081-00	METAL CHIP	22K	5%	1/10W
R301	1-216-033-00	METAL CHIP	220	5%	1/10W	R506	1-216-081-00	METAL CHIP	22K	5%	1/10W
R302	1-216-025-00	METAL CHIP	100	5%	1/10W	R507	1-216-073-00	METAL CHIP	10K	5%	1/10W
R306	1-216-097-00	METAL CHIP	100K	5%	1/10W	R508	1-216-081-00	METAL CHIP	22K	5%	1/10W
R307	1-216-017-00	METAL CHIP	47	5%	1/10W	R511	1-216-081-00	METAL CHIP	22K	5%	1/10W
R308	1-216-041-00	METAL CHIP	470	5%	1/10W	R514	1-216-081-00	METAL CHIP	22K	5%	1/10W
R309	1-216-073-00	METAL CHIP	10K	5%	1/10W	R516	1-216-073-00	METAL CHIP	10K	5%	1/10W
R310	1-216-073-00	METAL CHIP	10K	5%	1/10W	R518	1-216-073-00	METAL CHIP	10K	5%	1/10W
R311	1-216-073-00	METAL CHIP	10K	5%	1/10W	R520	1-216-089-00	METAL CHIP	47K	5%	1/10W
R312	1-216-073-00	METAL CHIP	10K	5%	1/10W	R522	1-216-025-00	METAL CHIP	100	5%	1/10W
R313	1-216-073-00	METAL CHIP	10K	5%	1/10W	R523	1-216-121-00	METAL CHIP	1M	5%	1/10W
R314	1-216-073-00	METAL CHIP	10K	5%	1/10W	R524	1-216-025-00	METAL CHIP	100	5%	1/10W
R317	1-216-025-00	METAL CHIP	100	5%	1/10W	R525	1-216-025-00	METAL CHIP	100	5%	1/10W
R318	1-216-295-00	METAL CHIP	0	5%	1/10W	R526	1-216-025-00	METAL CHIP	100	5%	1/10W
R319	1-216-113-00	METAL CHIP	470K	5%	1/10W	R527	1-216-025-00	METAL CHIP	100	5%	1/10W
R321	1-216-121-00	METAL CHIP	1M	5%	1/10W	R528	1-216-025-00	METAL CHIP	100	5%	1/10W
R330	1-216-089-00	METAL CHIP	47K	5%	1/10W	R529	1-216-025-00	METAL CHIP	100	5%	1/10W
R331	1-216-075-00	METAL CHIP	12K	5%	1/10W	R530	1-216-025-00	METAL CHIP	100	5%	1/10W
R332	1-216-075-00	METAL CHIP	12K	5%	1/10W	R531	1-216-025-00	METAL CHIP	100	5%	1/10W
R333	1-216-061-00	METAL CHIP	3.3K	5%	1/10W	R532	1-216-025-00	METAL CHIP	100	5%	1/10W
R334	1-216-061-00	METAL CHIP	3.3K	5%	1/10W	R534	1-216-073-00	METAL CHIP	10K	5%	1/10W
R335	1-216-075-00	METAL CHIP	12K	5%	1/10W	R535	1-216-025-00	METAL CHIP	100	5%	1/10W
R336	1-216-075-00	METAL CHIP	12K	5%	1/10W	R536	1-216-025-00	METAL CHIP	100	5%	1/10W
R337	1-216-061-00	METAL CHIP	3.3K	5%	1/10W	R537	1-216-025-00	METAL CHIP	100	5%	1/10W
R338	1-216-061-00	METAL CHIP	3.3K	5%	1/10W	R538	1-216-025-00	METAL CHIP	100	5%	1/10W
R339	1-216-071-00	METAL CHIP	8.2K	5%	1/10W	R539	1-216-025-00	METAL CHIP	100	5%	1/10W
R340	1-216-071-00	METAL CHIP	8.2K	5%	1/10W	R540	1-216-053-00	METAL CHIP	1.5K	5%	1/10W
R341	1-216-071-00	METAL CHIP	8.2K	5%	1/10W	R541	1-216-053-00	METAL CHIP	1.5K	5%	1/10W
R342	1-216-071-00	METAL CHIP	8.2K	5%	1/10W	R542	1-216-025-00	METAL CHIP	100	5%	1/10W
R343	1-216-071-00	METAL CHIP	8.2K	5%	1/10W	R543	1-216-025-00	METAL CHIP	100	5%	1/10W
R344	1-216-071-00	METAL CHIP	8.2K	5%	1/10W	R544	1-216-027-00	METAL CHIP	120	5%	1/10W
R345	1-216-071-00	METAL CHIP	8.2K	5%	1/10W	R545	1-216-027-00	METAL CHIP	120	5%	1/10W
R346	1-216-071-00	METAL CHIP	8.2K	5%	1/10W	R546	1-216-027-00	METAL CHIP	120	5%	1/10W

Ref. No.	Part No.	Description	Remark			Ref. No.	Part No.	Description	Remark		
R547	1-216-027-00	METAL CHIP	120	5%	1/10W	R1204	1-216-689-11	METAL CHIP	39K	0.5%	1/10W
R548	1-216-029-00	METAL CHIP	150	5%	1/10W	R1205	1-216-081-00	METAL CHIP	22K	5%	1/10W
R549	1-216-029-00	METAL CHIP	150	5%	1/10W	R1206	1-216-077-00	METAL CHIP	15K	5%	1/10W
R550	1-216-063-00	METAL CHIP	3.9K	5%	1/10W	R1207	1-216-073-00	METAL CHIP	10K	5%	1/10W
R551	1-216-063-00	METAL CHIP	3.9K	5%	1/10W	R1208	1-216-069-00	METAL CHIP	6.8K	5%	1/10W
R552	1-216-057-00	METAL CHIP	2.2K	5%	1/10W	R1209	1-216-121-00	METAL CHIP	1M	5%	1/10W
R553	1-216-057-00	METAL CHIP	2.2K	5%	1/10W	R1210	1-216-097-00	METAL CHIP	100K	5%	1/10W
R554	1-216-063-00	METAL CHIP	3.9K	5%	1/10W	R1211	1-216-073-00	METAL CHIP	10K	5%	1/10W
R555	1-216-063-00	METAL CHIP	3.9K	5%	1/10W	R1212	1-216-097-00	METAL CHIP	100K	5%	1/10W
R556	1-216-075-00	METAL CHIP	12K	5%	1/10W	R1213	1-216-113-00	METAL CHIP	470K	5%	1/10W
R557	1-216-075-00	METAL CHIP	12K	5%	1/10W	R1214	1-216-045-00	METAL CHIP	680	5%	1/10W
R558	1-216-025-00	METAL CHIP	100	5%	1/10W	R1251	1-216-065-00	METAL CHIP	4.7K	5%	1/10W
R560	1-216-027-00	METAL CHIP	120	5%	1/10W	R1253	1-216-093-00	METAL CHIP	68K	5%	1/10W
R561	1-216-027-00	METAL CHIP	120	5%	1/10W	R1254	1-216-689-11	METAL CHIP	39K	0.5%	1/10W
R562	1-216-021-00	METAL CHIP	68	5%	1/10W	R1255	1-216-081-00	METAL CHIP	22K	5%	1/10W
R563	1-216-021-00	METAL CHIP	68	5%	1/10W	R1256	1-216-077-00	METAL CHIP	15K	5%	1/10W
R564	1-216-021-00	METAL CHIP	68	5%	1/10W	R1257	1-216-073-00	METAL CHIP	10K	5%	1/10W
R565	1-216-027-00	METAL CHIP	120	5%	1/10W	R1258	1-216-069-00	METAL CHIP	6.8K	5%	1/10W
R566	1-216-027-00	METAL CHIP	120	5%	1/10W	R1259	1-216-121-00	METAL CHIP	1M	5%	1/10W
R567	1-216-049-00	METAL CHIP	1K	5%	1/10W	R1260	1-216-097-00	METAL CHIP	100K	5%	1/10W
R568	1-216-073-00	METAL CHIP	10K	5%	1/10W	R1261	1-216-073-00	METAL CHIP	10K	5%	1/10W
R569	1-216-049-00	METAL CHIP	1K	5%	1/10W	R1262	1-216-097-00	METAL CHIP	100K	5%	1/10W
R570	1-216-025-00	METAL CHIP	100	5%	1/10W	R1263	1-216-113-00	METAL CHIP	470K	5%	1/10W
R572	1-216-025-00	METAL CHIP	100	5%	1/10W	R1264	1-216-045-00	METAL CHIP	680	5%	1/10W
R573	1-216-025-00	METAL CHIP	100	5%	1/10W	R1270	1-216-073-00	METAL CHIP	10K	5%	1/10W
R574	1-216-069-00	METAL CHIP	6.8K	5%	1/10W	R1301	1-216-049-00	METAL CHIP	1K	5%	1/10W
R575	1-216-089-00	METAL CHIP	47K	5%	1/10W	R1302	1-216-049-00	METAL CHIP	1K	5%	1/10W
R577	1-216-073-00	METAL CHIP	10K	5%	1/10W	R1303	1-216-049-00	METAL CHIP	1K	5%	1/10W
R578	1-216-073-00	METAL CHIP	10K	5%	1/10W	R1501	1-216-073-00	METAL CHIP	10K	5%	1/10W
R579	1-216-073-00	METAL CHIP	10K	5%	1/10W	R1502	1-216-073-00	METAL CHIP	10K	5%	1/10W
R580	1-216-025-00	METAL CHIP	100	5%	1/10W	R3556	1-216-033-00	METAL CHIP	220	5%	1/10W
R581	1-216-025-00	METAL CHIP	100	5%	1/10W						
R582	1-216-073-00	METAL CHIP	10K	5%	1/10W			< SWITCH >			
R584	1-216-049-00	METAL CHIP	1K	5%	1/10W	S501	1-554-303-21	SWITCH, TACTILE (SYSTEM POWER)			
R585	1-216-049-00	METAL CHIP	1K	5%	1/10W	S502	1-554-303-21	SWITCH, TACTILE (DISPLAY)			
R586	1-216-049-00	METAL CHIP	1K	5%	1/10W	S503	1-554-303-21	SWITCH, TACTILE (DSP)			
R587	1-216-049-00	METAL CHIP	1K	5%	1/10W	S504	1-554-303-21	SWITCH, TACTILE (WAKE UP VOL SET)			
R588	1-216-049-00	METAL CHIP	1K	5%	1/10W	S505	1-554-303-21	SWITCH, TACTILE (BALANCE)			
R589	1-216-049-00	METAL CHIP	1K	5%	1/10W	S506	1-554-303-21	SWITCH, TACTILE (PRESET)			
R590	1-216-049-00	METAL CHIP	1K	5%	1/10W	S507	1-554-303-21	SWITCH, TACTILE (PARAMETRIC EQUALIZER)			
R591	1-216-019-00	METAL CHIP	56	5%	1/10W	S508	1-554-303-21	SWITCH, TACTILE (DYNAMIC SOUND)			
R592	1-216-019-00	METAL CHIP	56	5%	1/10W	S509	1-554-303-21	SWITCH, TACTILE (PRESENCE SURROUND)			
R593	1-216-019-00	METAL CHIP	56	5%	1/10W	S510	1-554-303-21	SWITCH, TACTILE (ON/OFF)			
R594	1-216-073-00	METAL CHIP	10K	5%	1/10W	S511	1-554-303-21	SWITCH, TACTILE (AI BC)			
R621	1-216-049-00	METAL CHIP	1K	5%	1/10W	S512	1-554-303-21	SWITCH, TACTILE (MEMORY)			
R622	1-216-049-00	METAL CHIP	1K	5%	1/10W	S513	1-554-303-21	SWITCH, TACTILE (CURSOR CONTROL ◀)			
R623	1-216-081-00	METAL CHIP	22K	5%	1/10W	S514	1-554-303-21	SWITCH, TACTILE (CURSOR CONTROL ▶)			
R1201	1-216-065-00	METAL CHIP	4.7K	5%	1/10W	S515	1-554-303-21	SWITCH, TACTILE (CURSOR CONTROL ▼)			
R1203	1-216-093-00	METAL CHIP	68K	5%	1/10W						

**DSP**   **PANEL**   **ELECT CAPACITOR**   **FLD**   **POWER AMPLIFIER**  
**SPEAKER**   **TRANSFORMER (A)**   **TRANSFORMER (B)**   **VOL**

Ref. No.	Part No.	Description	Remark	Ref. No.	Part No.	Description	Remark
S516	1-554-303-21	SWITCH, TACTILE (CURSOR CONTROL ▶)		C831	1-162-306-11	CERAMIC	0.01uF 20% 16V
S517	1-554-303-21	SWITCH, TACTILE (VIDEO FUNCTION)		C851	1-124-907-11	ELECT	10uF 20% 50V
S518	1-554-303-21	SWITCH, TACTILE (AUDIO FUNCTION)		C852	1-162-290-31	CERAMIC	470PF 10% 50V
		< VIBRATOR >		C853	1-124-122-11	ELECT	100uF 20% 50V
X100	1-578-667-11	VIBRATOR, CRYSTAL (49.152MHz)		C854	1-162-282-31	CERAMIC	100PF 10% 50V
X101	1-577-253-11	VIBRATOR, CERAMIC (16.93MHz)		C856	1-124-910-11	ELECT	47uF 20% 50V
X102	1-579-125-11	VIBRATOR, CERAMIC (8MHz)		C860	1-136-165-00	FILM	0.1uF 5% 50V
X501	1-579-351-11	VIBRATOR, CERAMIC (15MHz)		C863	1-136-165-00	FILM	0.1uF 5% 50V
X502	1-579-125-11	VIBRATOR, CERAMIC (8MHz)		C866	1-126-233-11	ELECT	22uF 20% 50V
*****							
*	1-644-841-11	ELECT CAPACITOR BOARD		C901	1-126-224-11	ELECT	4700uF 20% 42V
		*****		C905	1-136-171-00	FILM	0.33uF 5% 50V
*	A-4356-256-A	FLD BOARD, COMPLETE		C906	1-136-171-00	FILM	0.33uF 5% 50V
		*****		C923	1-124-911-11	ELECT	220uF 20% 50V
*	A-4356-052-A	POWER AMPLIFIER BOARD, COMPLETE		C924	1-124-911-11	ELECT	220uF 20% 50V
		*****		C925	1-124-122-11	ELECT	100uF 20% 50V
*	1-644-586-11	SPEAKER BOARD		C926	1-164-159-11	CERAMIC	0.1uF 50V
		*****		C941	1-162-294-31	CERAMIC	0.001uF 10% 50V
*	1-644-839-11	TRANSFORMER (A) BOARD		C942	1-162-294-31	CERAMIC	0.001uF 10% 50V
		*****		C943	1-162-294-31	CERAMIC	0.001uF 10% 50V
*	1-644-840-11	TRANSFORMER (B) BOARD		C1001	1-123-605-00	ELECT	100uF 20% 100V
		*****		C1002	1-124-667-11	ELECT	10uF 20% 100V
*	1-644-837-11	VOL BOARD		C1003	1-124-667-11	ELECT	10uF 20% 100V
		*****		C1004	1-124-667-11	ELECT	10uF 20% 100V
		< CAPACITOR >		C1005	1-124-667-11	ELECT	10uF 20% 100V
C601	1-162-306-11	CERAMIC	0.01uF 20% 16V	< CONNECTOR >			
C602	1-126-933-11	ELECT	100uF 20% 16V	CN601	1-560-942-00	PIN, CONNECTOR 6P	
C603	1-124-915-11	ELECT	10uF 20% 63V	* CN802	1-573-087-11	PIN, CONNECTOR 13P	
C604	1-124-915-11	ELECT	10uF 20% 63V	CN891	1-563-311-11	CONNECTOR, BOARD TO BOARD 10P	
C702	1-126-176-11	ELECT	220uF 20% 10V	* CN892	1-564-518-11	PLUG, CONNECTOR 3P	
C704	1-162-306-11	CERAMIC	0.01uF 20% 16V	CNJ603	1-569-656-11	HOUSING, CONNECTOR 8P	
C706	1-124-927-11	ELECT	4.7uF 20% 100V	CNJ604	1-573-147-11	HOUSING, CONNECTOR 12P	
C707	1-126-101-11	ELECT	100uF 20% 16V	CNJ902	1-573-095-11	SOCKET, CONNECTOR 15P	
C708	1-124-907-11	ELECT	10uF 20% 50V	* CNJ911	1-573-094-11	SOCKET, CONNECTOR 13P	
C709	1-164-159-11	CERAMIC	0.1uF 50V	* CNJ912	1-573-094-11	SOCKET, CONNECTOR 13P	
C710	1-124-910-11	ELECT	47uF 20% 50V	CNP602	1-568-319-11	SOCKET, CONNECTOR 8P	
C711	1-164-159-11	CERAMIC	0.1uF 50V	CNP605	1-564-507-11	PLUG, CONNECTOR 4P	
C712	1-164-159-11	CERAMIC	0.1uF 50V	* CNP606	1-564-505-11	PLUG, CONNECTOR 2P	
C801	1-124-907-11	ELECT	10uF 20% 50V	* CNP801	1-564-521-11	PLUG, CONNECTOR 6P	
C802	1-162-290-31	CERAMIC	470PF 10% 50V	* CNP903	1-564-321-00	PIN, CONNECTOR 2P	
C803	1-124-122-11	ELECT	100uF 20% 50V	< DIODE >			
C804	1-162-282-31	CERAMIC	100PF 10% 50V	D601	8-719-987-63	DIODE	1N4148M
C806	1-124-910-11	ELECT	47uF 20% 50V	D602	8-719-987-63	DIODE	1N4148M
C807	1-124-122-11	ELECT	100uF 20% 50V	D703	8-719-987-63	DIODE	1N4148M
C809	1-126-233-11	ELECT	22uF 20% 50V	D704	8-719-987-63	DIODE	1N4148M
C810	1-136-165-00	FILM	0.1uF 5% 50V	D705	8-719-987-63	DIODE	1N4148M
C811	1-136-165-00	FILM	0.1uF 5% 50V	D706	8-719-987-63	DIODE	1N4148M
C813	1-136-165-00	FILM	0.1uF 5% 50V				
C816	1-126-233-11	ELECT	22uF 20% 50V				

## ELECT CAPACITOR

## FLD

## POWER AMPLIFIER

## SPEAKER

## TRANSFORMER (A)

## TRANSFORMER (B)

## VOL

Ref. No.	Part No.	Description	Remark	Ref. No.	Part No.	Description	Remark
D801	8-719-987-63	DIODE 1N4148M		R606	1-249-416-11	CARBON 820 5%	1/4W
D802	8-719-987-63	DIODE 1N4148M		R607	1-249-425-11	CARBON 4.7K 5%	1/4W
D851	8-719-987-63	DIODE 1N4148M		R701	1-249-433-11	CARBON 22K 5%	1/4W
D852	8-719-987-63	DIODE 1N4148M		R702	1-249-441-11	CARBON 100K 5%	1/4W
D915	8-719-200-82	DIODE 11ES2		R703	1-249-433-11	CARBON 22K 5%	1/4W
D916	8-719-200-82	DIODE 11ES2		R704	1-249-433-11	CARBON 22K 5%	1/4W
D917	8-719-934-22	DIODE HZS30-2L		R705	1-249-429-11	CARBON 10K 5%	1/4W
D918	8-719-014-88	DIODE UZP-6.8BC		R706	1-249-437-11	CARBON 47K 5%	1/4W
D1001	8-719-200-82	DIODE 11ES2		R707	1-249-429-11	CARBON 10K 5%	1/4W
D1002	8-719-200-82	DIODE 11ES2		R708	1-249-424-11	CARBON 3.9K 5%	1/4W
D1003	8-719-200-82	DIODE 11ES2		R709	1-249-427-11	CARBON 6.8K 5%	1/4W
D1004	8-719-200-82	DIODE 11ES2		R710	1-249-429-11	CARBON 10K 5%	1/4W
D1005	8-719-987-63	DIODE 1N4148M		R711	1-249-417-11	CARBON 1K 5%	1/4W
D1006	8-719-002-73	DIODE UZL-36M		R712	1-249-441-11	CARBON 100K 5%	1/4W
D1007	8-719-002-73	DIODE UZL-36M		R713	1-247-876-11	CARBON 75K 5%	1/4W
D1008	8-719-934-26	DIODE HZS33-2L		R714	1-249-417-11	CARBON 1K 5%	1/4W
D1009	8-719-934-26	DIODE HZS33-2L		R715	1-249-438-11	CARBON 56K 5%	1/4W
D1010	8-719-934-22	DIODE HZS30-2L		R801	1-249-417-11	CARBON 1K 5%	1/4W
		< IC >		R802	1-249-437-11	CARBON 47K 5%	1/4W
IC601	8-759-820-62	IC LB1639		R803	1-249-414-11	CARBON 560 5%	1/4W
IC701	8-759-111-68	IC $\mu$ PC1237HA		R804	1-249-438-11	CARBON 56K 5%	1/4W
IC702	8-759-987-16	IC LM393P		R805	1-247-756-11	CARBON 2.2K 5%	1/2W
IC703	8-759-947-34	IC LM35DZ		R806	1-247-756-11	CARBON 2.2K 5%	1/2W
IC801	8-749-900-24	IC STK-4162MK2		$\Delta$ R807	1-212-881-11	FUSIBLE 100 5%	1/4W F
		< JACK >		$\Delta$ R808	1-212-881-11	FUSIBLE 100 5%	1/4W F
J891	1-537-276-11	TERMINAL BOARD (SPEAKER)		$\Delta$ R809	1-217-151-00	RES, METAL PLATE 0.22	2W
J921	1-573-110-11	JACK, PIN 2P (SURROUND SPEAKER)		R810	1-247-752-11	CARBON 1K 5%	1/2W
		< COIL >		R811	1-247-752-11	CARBON 1K 5%	1/2W
* L801	1-420-872-00	COIL, AIR CORE		$\Delta$ R812	1-212-958-00	FUSIBLE 10 5%	1/2W F
* L851	1-420-872-00	COIL, AIR CORE		R813	1-249-417-11	CARBON 1K 5%	1/4W
		< TRANSISTOR >		R814	1-249-431-11	CARBON 15K 5%	1/4W
Q601	8-729-801-93	TRANSISTOR 2SD1387		R815	1-249-441-11	CARBON 100K 5%	1/4W
Q602	8-729-900-80	TRANSISTOR DTC114ES		R816	1-249-438-11	CARBON 56K 5%	1/4W
Q701	8-729-119-76	TRANSISTOR 2SA1175-HFE		R817	1-249-429-11	CARBON 10K 5%	1/4W
Q801	8-729-140-84	TRANSISTOR 2SC1841-PAFAEA		R851	1-249-417-11	CARBON 1K 5%	1/4W
Q851	8-729-140-84	TRANSISTOR 2SC1841-PAFAEA		R852	1-249-437-11	CARBON 47K 5%	1/4W
Q1001	8-729-111-29	TRANSISTOR 2SD1616A-K		R853	1-249-414-11	CARBON 560 5%	1/4W
Q1002	8-729-111-29	TRANSISTOR 2SD1616A-K		R854	1-249-438-11	CARBON 56K 5%	1/4W
		< RESISTOR >		R855	1-247-756-11	CARBON 2.2K 5%	1/2W
$\Delta$ R601	1-212-849-00	FUSIBLE 4.7 5%	1/4W F	R856	1-247-756-11	CARBON 2.2K 5%	1/2W
R602	1-249-422-11	CARBON 2.7K 5%	1/4W	$\Delta$ R859	1-217-151-00	RES, METAL PLATE 0.22	2W
R603	1-249-422-11	CARBON 2.7K 5%	1/4W	$\Delta$ R862	1-212-958-00	FUSIBLE 10 5%	1/2W F
R604	1-249-425-11	CARBON 4.7K 5%	1/4W	R863	1-249-417-11	CARBON 1K 5%	1/4W
R605	1-249-425-11	CARBON 4.7K 5%	1/4W	R864	1-249-431-11	CARBON 15K 5%	1/4W
				R865	1-249-441-11	CARBON 100K 5%	1/4W
				R866	1-249-437-11	CARBON 47K 5%	1/4W
				R867	1-249-429-11	CARBON 10K 5%	1/4W
				$\Delta$ R876	1-212-881-11	FUSIBLE 100 5%	1/4W F
				R917	1-247-713-11	CARBON 1K 5%	1/4W

The components identified by mark  $\Delta$  or dotted line with mark  $\Delta$  are critical for safety. Replace only with part number specified.

**ELECT CAPACITOR**

**FLD**

**POWER AMPLIFIER**

**SPEAKER**

**TRANSFORMER (A)**

**TRANSFORMER (B)**

**VOL**

**JACK**

**POWER**

Ref. No.	Part No.	Description	Remark		
R918	1-249-441-11	CARBON	100K	5%	1/4W
△R1001	1-212-966-00	FUSIBLE	22	5%	1/2W F
R1002	1-249-421-11	CARBON	2.2K	5%	1/4W
R1003	1-249-421-11	CARBON	2.2K	5%	1/4W
R1004	1-247-903-00	CARBON	1M	5%	1/4W
R1005	1-247-902-11	CARBON	910K	5%	1/4W
R1006	1-249-433-11	CARBON	22K	5%	1/4W
△R1901	1-219-134-11	FUSIBLE	0.1	5%	1/4W F
△R1902	1-219-134-11	FUSIBLE	0.1	5%	1/4W F
△R1905	9-910-999-33	FUSIBLE	0.22	5%	1/4W F
△R1906	9-910-999-33	FUSIBLE	0.22	5%	1/4W F
< VARIABLE RESISTOR >					
RV601	1-241-803-11	RES, VAR, CARBON (WITH MOTOR)	10K		(VOLUME)
< RELAY >					
RY1001	1-515-886-11	RELAY			
*****					
*	1-642-413-11	JACK BOARD			
*****					
*	A-4356-274-A	POWER BOARD, COMPLETE			
*****					
*	1-533-213-31	HOLDER, FUSE			
*	3-309-144-21	HEAT SINK			
	7-682-547-04	SCREW +BVTT 3X6 (S)			
< CAPACITOR >					
C1	1-124-915-11	ELECT	10uF	20%	63V
C2	1-162-306-11	CERAMIC	0.01uF	20%	16V
C3	1-162-306-11	CERAMIC	0.01uF	20%	16V
C5	1-136-153-00	FILM	0.01uF	5%	50V
C7	1-162-306-11	CERAMIC	0.01uF	20%	16V
C8	1-162-294-31	CERAMIC	0.001uF	10%	50V
C651	1-162-282-31	CERAMIC	100PF	10%	50V
C652	1-162-215-31	CERAMIC	47PF	5%	50V
C653	1-161-379-00	CERAMIC	0.01uF	20%	25V
C654	1-162-294-31	CERAMIC	0.001uF	10%	50V
C655	1-124-282-00	ELECT	22uF	20%	25V
C656	1-124-119-00	ELECT	330uF	20%	16V
C661	1-162-282-31	CERAMIC	100PF	10%	50V
C662	1-162-215-31	CERAMIC	47PF	5%	50V
C663	1-161-379-00	CERAMIC	0.01uF	20%	25V
C664	1-162-294-31	CERAMIC	0.001uF	10%	50V
C666	1-124-119-00	ELECT	330uF	20%	16V
C903	1-126-943-11	ELECT	2200uF	20%	25V
C904	1-126-943-11	ELECT	2200uF	20%	25V
C907	1-136-165-00	FILM	0.1uF	5%	50V

Ref. No.	Part No.	Description	Remark		
C908	1-136-165-00	FILM	0.1uF	5%	50V
C909	1-124-477-11	ELECT	47uF	20%	25V
C910	1-124-477-11	ELECT	47uF	20%	25V
C911	1-124-915-11	ELECT	10uF	20%	63V
C912	1-124-915-11	ELECT	10uF	20%	63V
C913	1-124-915-11	ELECT	10uF	20%	63V
C914	1-126-937-11	ELECT	4700uF	20%	16V
C915	1-124-915-11	ELECT	10uF	20%	63V
C916	1-124-915-11	ELECT	10uF	20%	63V
C917	1-126-947-11	ELECT	47uF	20%	35V
C918	1-124-915-11	ELECT	10uF	20%	63V
C1101	1-126-948-11	ELECT	100uF	20%	35V
C1102	1-124-915-11	ELECT	10uF	20%	63V
C1103	1-161-379-00	CERAMIC	0.01uF	20%	25V
C2000	1-101-006-00	CERAMIC	0.047uF		50V
< CONNECTOR >					
* CN902	1-564-506-11	PLUG, CONNECTOR 3P			
* CN904	1-564-506-11	PLUG, CONNECTOR 3P			
* CNJ1	1-580-739-11	SOCKET, CONNECTOR 15P (SYSTEM CONTROL 1)			
* CNJ2	1-580-740-11	SOCKET, CONNECTOR 17P (SYSTEM CONTROL 2)			
* CNJ3	1-563-534-11	CONNECTOR, BOARD TO BOARD 16P			
* CNP7	1-564-499-11	PIN, CONNECTOR 6P			
* CNP8	1-564-498-11	PIN, CONNECTOR 5P			
* CNP903	1-564-321-00	PIN, CONNECTOR 2P			
* CNP905	1-573-087-11	PIN, CONNECTOR 13P			
* CNP906	1-573-109-11	PIN, CONNECTOR 15P			
* CNP907	1-506-981-11	PIN, CONNECTOR 10P			
* CNP908	1-568-317-11	SOCKET, CONNECTOR 6P			
* CNP909	1-573-148-11	PLUG, CONNECTOR 12P			
* CNP910	1-564-338-00	PIN, CONNECTOR 4P			
* CNP911	1-564-505-11	PLUG, CONNECTOR 2P			
< DIODE >					
D891	8-719-987-63	DIODE	1N4148M		
D892	8-719-987-63	DIODE	1N4148M		
D901	8-719-510-68	DIODE	D5SBA20F01		
D902	8-719-987-63	DIODE	1N4148M		
D903	8-719-987-63	DIODE	1N4148M		
D904	8-719-200-82	DIODE	11ES2		
D905	8-719-200-82	DIODE	11ES2		
D906	8-719-200-82	DIODE	11ES2		
D907	8-719-200-82	DIODE	11ES2		
D908	8-719-200-82	DIODE	11ES2		
D909	8-719-200-82	DIODE	11ES2		
D910	8-719-987-63	DIODE	1N4148M		
D911	8-719-933-36	DIODE	HZS6B1L		
D919	8-719-987-63	DIODE	1N4148M		
D920	8-719-987-63	DIODE	1N4148M		

The components identified by mark △ or dotted line with mark △ are critical for safety. Replace only with part number specified.

JACK	POWER
------	-------

Ref. No.	Part No.	Description	Remark
D1101	8-719-200-82	DIODE 11ES2	
D1102	8-719-200-82	DIODE 11ES2	
< IC >			
IC1	8-749-921-11	IC GP1F32R (DIGITAL OPTICAL CD IN)	
IC2	8-749-921-11	IC GP1F32R (DIGITAL OPTICAL DAT IN)	
IC3	8-749-921-12	IC GP1F32T (DIGITAL OPTICAL DAT OUT)	
IC651	8-759-634-50	IC M5218AL	
IC901	8-759-602-66	IC M5230L-A	
< JACK >			
J2	1-569-662-11	JACK, PIN 1P (SUPER WOOFER)	
J651	1-562-837-21	JACK (HEADPHONES)	
△J901	1-526-931-11	INLET, AC (~ AC IN)	
< COIL >			
L1	1-410-397-21	FERRITE BEAD INDUCTOR	
< LINE FILTER >			
△L901	1-424-485-11	FILTER, LINE	
< TRANSISTOR >			
Q651	8-729-141-30	TRANSISTOR 2SC3623A-LK	
Q652	8-729-900-61	TRANSISTOR DTA114ES	
Q661	8-729-141-30	TRANSISTOR 2SC3623A-LK	
Q901	8-729-209-15	TRANSISTOR 2SD2012	
Q902	8-729-141-83	TRANSISTOR 2SB1094-LK	
Q903	8-729-900-80	TRANSISTOR DTC114ES	
Q905	8-729-620-05	TRANSISTOR 2SC2603-EF	
Q906	8-729-620-05	TRANSISTOR 2SC2603-EF	
Q908	8-729-801-84	TRANSISTOR 2SB1013-4	
Q909	8-729-111-29	TRANSISTOR 2SD1616A-K	
Q910	8-729-111-29	TRANSISTOR 2SD1616A-K	
Q911	8-729-620-05	TRANSISTOR 2SC2603-EF	
Q1101	8-729-111-29	TRANSISTOR 2SD1616A-K	
Q1601	8-729-141-30	TRANSISTOR 2SC3623A-LK	
Q1602	8-729-141-30	TRANSISTOR 2SC3623A-LK	
< RESISTOR >			
△R2	9-910-999-33	FUSIBLE 0.22 5% 1/4W F	
△R3	9-910-999-33	FUSIBLE 0.22 5% 1/4W F	
R5	1-249-409-11	CARBON 220 5% 1/4W	
R651	1-249-433-11	CARBON 22K 5% 1/4W	
R652	1-247-887-00	CARBON 220K 5% 1/4W	
R653	1-249-405-11	CARBON 100 5% 1/4W	
R654	1-249-423-11	CARBON 3.3K 5% 1/4W	
R655	1-249-417-11	CARBON 1K 5% 1/4W	
R656	1-249-405-11	CARBON 100 5% 1/4W	
R657	1-249-441-11	CARBON 100K 5% 1/4W	

Ref. No.	Part No.	Description	Remark
R658	1-249-429-11	CARBON 10K 5% 1/4W	
R661	1-249-433-11	CARBON 22K 5% 1/4W	
R662	1-247-887-00	CARBON 220K 5% 1/4W	
R663	1-249-405-11	CARBON 100 5% 1/4W	
R666	1-249-405-11	CARBON 100 5% 1/4W	
R668	1-249-429-11	CARBON 10K 5% 1/4W	
R902	1-247-903-00	CARBON 1M 5% 1/4W	
R905	1-249-413-11	CARBON 470 5% 1/4W	
R906	1-249-434-11	CARBON 27K 5% 1/4W	
R907	1-249-425-11	CARBON 4.7K 5% 1/4W	
R908	1-249-431-11	CARBON 15K 5% 1/4W	
R909	1-249-431-11	CARBON 15K 5% 1/4W	
R910	1-249-419-11	CARBON 1.5K 5% 1/4W	
R911	1-249-429-11	CARBON 10K 5% 1/4W	
R912	1-249-429-11	CARBON 10K 5% 1/4W	
R913	1-249-429-11	CARBON 10K 5% 1/4W	
R914	1-249-429-11	CARBON 10K 5% 1/4W	
R919	1-249-429-11	CARBON 10K 5% 1/4W	
R920	1-249-429-11	CARBON 10K 5% 1/4W	
△R921	1-215-865-11	METAL OXIDE 220 5% 1W F	
R922	1-249-429-11	CARBON 10K 5% 1/4W	
R923	1-249-425-11	CARBON 4.7K 5% 1/4W	
R924	1-249-429-11	CARBON 10K 5% 1/4W	
R925	1-249-429-11	CARBON 10K 5% 1/4W	
R926	1-249-429-11	CARBON 10K 5% 1/4W	
△R928	1-216-425-11	METAL OXIDE 56 5% 1W F	
R930	1-249-417-11	CARBON 1K 5% 1/4W	
R930	1-249-423-11	CARBON 3.3K 5% 1/4W	
R931	1-249-441-11	CARBON 100K 5% 1/4W	
R932	1-249-429-11	CARBON 10K 5% 1/4W	
R1101	1-249-429-11	CARBON 10K 5% 1/4W	
< RELAY >			
RY801	1-515-790-11	RELAY	
RY802	1-515-790-11	RELAY	
RY901	1-515-626-11	RELAY	
RY902	1-515-626-11	RELAY	

\*\*\*\*\*

## MISCELLANEOUS

\*\*\*\*\*

△F901	1-532-286-00	FUSE, TIME-LAG (T2.5A)
IC902	8-759-231-53	IC TA7805S
M801	1-541-860-11	MOTOR, DC FAN
△PT901	1-450-977-11	TRANSFORMER, POWER (AEP)
△PT901	1-450-978-11	TRANSFORMER, POWER (UK)

Q904 8-729-209-15 TRANSISTOR 2SD2012

\*\*\*\*\*

The components identified by mark △ or dotted line with mark △ are critical for safety. Replace only with part number specified.

Ref. No.	Part No.	Description	Remark
----------	----------	-------------	--------

\*\*\*\*\*  
**HARDWARE LIST**  
 \*\*\*\*\*

- |     |              |                               |  |
|-----|--------------|-------------------------------|--|
| #1  | 7-685-203-14 | SCREW +KTP 2X5 TYPE2 NON-SLIT |  |
| #2  | 7-685-534-19 | SCREW +BTP 2. 6X8 TYPE2 N-S   |  |
| #3  | 7-685-133-19 | SCREW +BTP 2. 6X6 TYPE2 N-S   |  |
| #4  | 7-685-132-19 | SCREW +PTPWH 2. 6X5 (TYPE2)   |  |
| #5  | 7-682-547-04 | SCREW +BVTT 3X6 (S)           |  |
| #6  | 7-685-647-79 | SCREW +BVTP 3X10 TYPE2 N-S    |  |
| #7  | 7-685-645-79 | SCREW +BVTP 3X6 TYPE2 IT-3    |  |
| #8  | 7-685-646-79 | SCREW +BTP 3X8 TYPE2 N-S      |  |
| #9  | 7-682-547-09 | SCREW +BVTT 3X6 (S)           |  |
| #10 | 7-685-650-79 | SCREW +BVTP 3X16 TYPE2 IT-3   |  |