

TANDBERG

TR 220 G

Illustrated Parts List

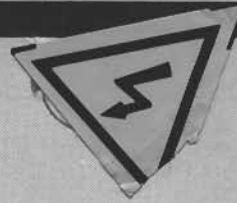

INSTRUCTIONS FOR ORDERING REPLACEMENT PARTS

For service and replacement parts contact your nearest Tandberg office or

write to: Tandbergs Radiofabrikk A/S
Service and Spares Department
P.O. Box 218
N 1301 Sandvika, Norway

Telex: 18007 kurer n

When ordering please quote the model number together with the ordering number and the full description of each part required.

Example: Model Dual 1225
713547 Spindel
713803 Platetallerken

Note! The numbers on the illustrations are index numbers and must not be used when ordering. Please refer to the parts list for the ordering number and description.

INSTRUKS FOR BESTILLING AV DELER

For service og servicedeler kontakt nærmeste Tandberg kontor eller bruk adressen som er vist ovenfor.

Modellnummer må alltid oppgis ved bestilling av deler. Bestillingsnr. og beskrivelse finnes i listen.

Eksempel: Modell Dual 1225
713547 Spindel
713803 Platetallerken

Merk! Tallene på tegningen er indeksnumre og må ikke brukes ved bestilling. Bestillingsnr. og beskrivelse finnes i listen.



Index	SPECIFY THIS WHEN ORDERING		Description (notes)	Reference
	Ordering No.	Beskrivelse (merkader)		
1	992936	Skrue	Screw, transport, assembly	
3	713640	Adapter	Disc, centring	
4	713547	Spindel	Spindle	
5	713618	Skive	Disc, facing	
6	713543	Ring	Ring, retaining	
7	713705	Ring	Ring, facing	
8	713802	Matte	Mat, turntable, complete	
9	713803	Platetallerken	Turntable, complete	
10	713708	Knapp	Knob, speed regulator	
11	713706	Ring	Ring, dial	
12	713659	Skrue	Screw, adjustment	
13	713863	Pickup	Cartridge, DMS 210	
14	713864	Stift	Stylus, DN 211 for DMS 210	
	713666	Stift	Stylus, DN 201 for DMS 200	
15	950217	Mal	Template, cartridge mounting	
17	713806	Oppheng	Suspension, complete	
18	713807	Hode	Head, tone arm, with lead	
24	713622	Holder	Mounting, cartridge, TK 14	
25	713808	Støtte	Support, tone arm, assembly	
26	219162	Mutter	Nut, 3 mm	
33	713720	Hendel	Lever	
34	713653	Skilt	Plate, name	
35	713818	Plate	Plate, 1225	
36	713624	Knapp	Knob	
37	237970	Skive	Washer, lock, 1.5 mm	
38	713634	Hylse	Sleeve, adjuster	
39	713683	Tapp	Pivot, bearing	
40	713689	Fjær	Spring, compression	
41	210556	Skrue	Screw, 3 x 3 mm	
42	713824	Deksel	Cover, with lift pin	
43	713674	Skrue	Screw, adjuster	
44	713709	Arm	Handle, tone arm	
45	268192	Mutter	Nut, 2 mm	
46	713817	Plate	Plate, chassis	
47	713613	Nagle	Pin, semicircular, 2 x 6 mm	
49	713620	Skrue	Screw, transport, assembly	
54	713820	Arm	Tone arm, complete	
55	713821	Vekt	Weight	
57	713823	Lager	Bearing, complete	
58	713809	Hus	Housing, spring	
59	713704	Plate	Plate	
60	237905	Skrue	Screw, 3 x 8 mm	
61	713703	Skrue	Screw, adjusting	
62	713794	Fjær	Spring, compression	
63	215320	Skive	Washer, 3.4 x 6 x 0.5 mm	
64	713627	Skrue	Screw, set	
65	713702	Mutter	Nut, lock	
66	713810	Brakett	Bracket, bearing, complete	
67	713701	Viser	Pointer	
68	713707	Skrue	Screw, bearing	
69	713725	Knapp	Knob, antiskating	

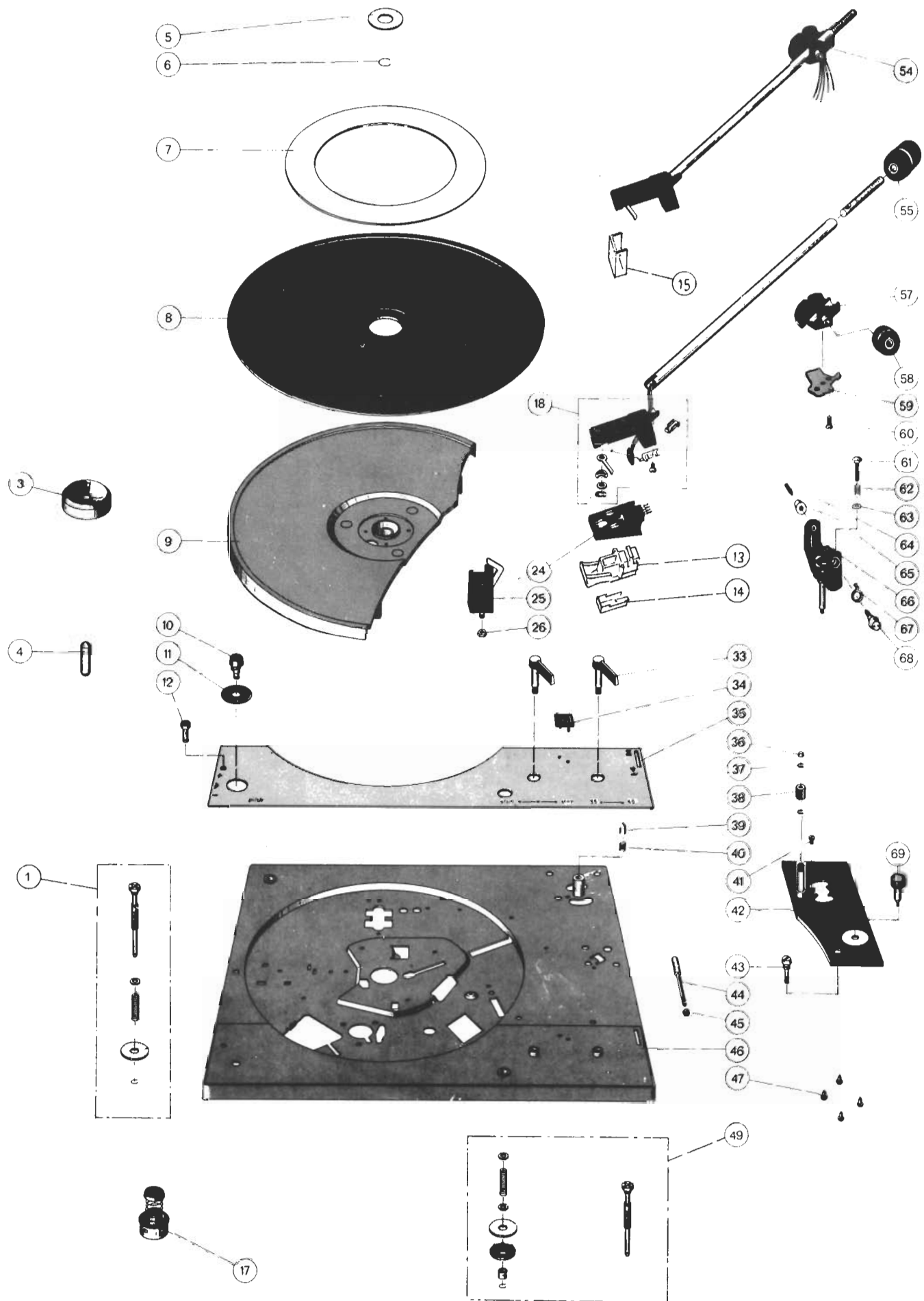

Index	SPECIFY THIS WHEN ORDERING		Description (notes)	Reference
	Ordering No.	Beskrivelse (merknader)		
100	713796	Skive	Washer, spring, 6.4 x 11 x 0.15 mm	
101	713671	Hjul	Wheel, adjusting	
102	215320	Skive	Washer, 3.4 x 6 x 0.5 mm	
103	265218	Mutter	Nut, 3 mm	
104	713660	Hjul	Wheel, adjusting	
105	713581	Skive	Washer, lock	
106	936930	Skive	Washer, 4.2 x 8 x 1 mm	
107	239651	Skive	Washer, lock, 3.2 mm	
108	713669	Segment	Segment, selector	
109	713697	Fjær	Spring, compression	
110	713684	Brakett	Bracket, complete	
111	206842	Skrue	Screw, 3 x 4 mm	
112	713698	Aksel	Spindle, bearing	
113	349950	Brakett	Bracket, motor	
126	713672	Hjul	Wheel, regulator	
127	713693	Plate	Plate, regulator	
128	713601	Skive	Washer, 3.2 x 8 x 1 mm	
129	713699	Fjær	Spring, compression	
130	713685	Arm	Lever, change	
131	713670	Skive	Washer, adjustment	
132	713711	Plate	Plate, screen	
133	713811	Vender	Switch, muting, complete	
134	713607	Loddeøgre	Lug, soldering	
135	210556	Skrue	Screw, 3 x 3 mm	
136	200457	Mutter	Nut, 4 mm	
137	713800	Hjul	Pulley, motor, 50 Hz	
	713801	Hjul	Pulley, motor, 60 Hz	
138	713779	Skrue	Screw, set, 2.5 x 3.5 mm	
150	713834	Motor	Motor, 4 pole, 110/220 V, AM400	
151	239651	Skive	Washer, lock, 3.2 mm	
152	713630	Hjul	Wheel, idler	
153	713544	Skive	Washer, lock, 3.2 mm	
154	713700	Skive	Washer, plastic	
155	713710	Arm	Arm, idler	
156	713817	Plate	Plate, chassis	
157	713667	Stang	Rod, control	
160	713570	Kondensator	Capacitor, 10nF/1000 V/10%	
166	203194	Skrue	Screw, 3 x 28 mm	
167	713829	Bryter	Switch, power, complete	
170	260807	Skrue	Screw, 3 x 35 mm	
171	713825	Plate	Plate, connection with cover	
172	713633	Skrue	Screw, 4 x 6 mm	
173	713712	Bolt	Bolt, change actuator	
174	713615	Fjær	Spring, compression	
175	713616	Bøssing	Bushing	
176	230542	Skive	Washer, lock, 2.3 mm	
177	713695	Sleide	Slide, switch	
178	230542	Skive	Washer, lock, 2.3 mm	
179	230542	Skive	Washer, lock, 2.3 mm	
180	713686	Arm	Arm, shift	
181	713694	Fjær	Spring, tension	
182	215320	Skive	Washer, 3.4 x 6 x 0.5 mm	
183	713692	Plate	Lever, start, complete	
184	713788	Fjær	Spring, tension	
185	230542	Skive	Washer, lock, 2.3 mm	
186	217152	Skive	Washer, 4.3 x 9 x 0.8 mm	
187	219162	Mutter	Nut, 3 mm	
188	713546	Fjær	Spring, retaining	
189	234256	Skive	Washer, lock, 1.9 mm	
190	713677	Arm	Lever, shut-off	
191	713715	Plate	Plate, friction	
192	230542	Skive	Washer, lock, 2.3 mm	
193	713812	Hjul	Wheel, main cam	
194	713545	Hylse	Bushing, rubber	
195	713714	Hendel	Lever, cam follower	
196	713541	Fjær	Spring, snap	
197	713713	Kulelager	Ball, bearing	
198	200457	Mutter	Nut, 4 mm	
199	713813	Brakett	Bracket, bearing	
200	713656	Fjær	Spring, tension	
201	713637	Plate	Plate, square section	
202	713717	Arm	Pawl, complete	
203	713696	Skive	Washer, 3.2 x 13 x 0.5 mm	
204	230542	Skive	Washer, lock, 2.3 mm	
205	713657	Bolt	Bolt	
206	713681	Mutter	Nut, flanged	
207	713632	Fjær	Spring, tension	
208	713676	Vinkel	Lever, start	
209	713716	Arm	Lever, change, complete	

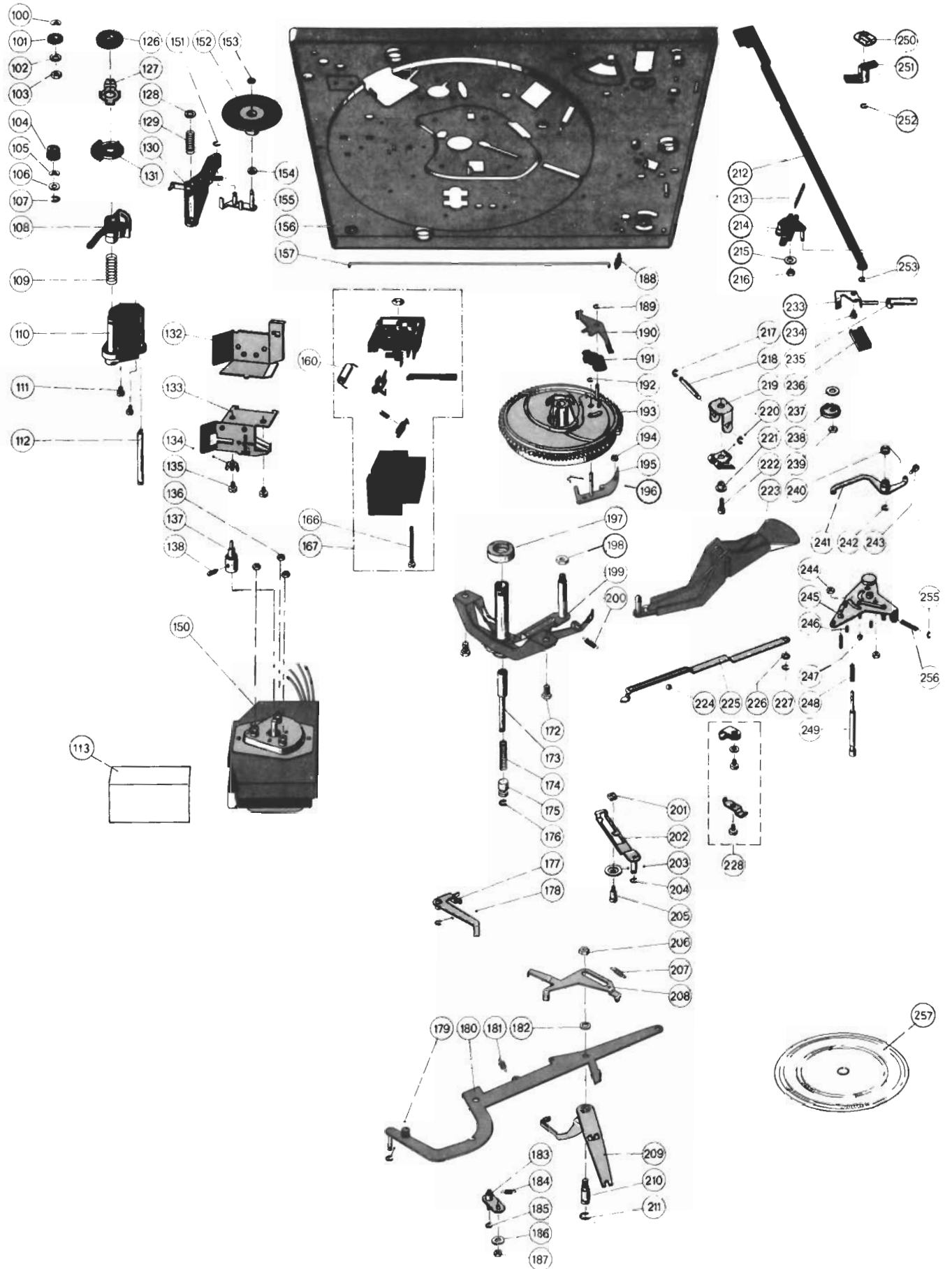

Index	SPECIFY THIS WHEN ORDERING		Description (notes)	Reference
	Ordering No.	Beskrivelse (merknader)		
210	713682	Bolt	Pin, grooved	
211	235937	Skive	Washer, lock, 4 mm	
212	713673	Skinne	Arm, positioning	
213	713680	Fjær	Spring, leaf	
214	713718	Arm	Lever, adjusting	
215	217152	Skive	Washer, 4.3 x 9 x 0.8 mm	
216	219162	Mutter	Nut, 3 mm	
217	230542	Skive	Washer, lock, 2.3 mm	
218	713542	Aksel	Spindle	
219	713679	Holder	Support, bearing	
220	713678	Fjær	Spring, leaf	
221	713540	Avstandsstykke	Spacer	
222	212237	Skrue	Screw, 3 x 6 mm	
223	713814	Arm	Lever, main	
224	233229	Kule	Ball, 4 mm	
225	713675	Sleide	Arm, cut-off	
226	713558	Skive	Disc, skating	
227	230542	Skive	Washer, lock, 2.3 mm	
228	713789	Klips	Clip, cable, complete	
233	713719	Vinkel	Bracket, bearing	
234	713795	Skrue	Screw, 3 x 3 mm	
235	713687	Arm	Cam, lift	
236	713688	Plate	Plate, brake	
237	713626	Skive	Washer	
238	713642	Skive	Washer, plastic	
239	219162	Mutter	Nut, 3 mm	
240	713691	Fjær	Spring	
241	713726	Arm	Arm, skating, complete	
242	239651	Skive	Washer, lock, 3.2 mm	
243	713643	Skrue	Screw	
244	265218	Mutter	Nut, 3 mm	
245	713822	Segment	Segment, complete	
246	713722	Skrue	Screw, set, 2 x 4 mm	
247	713649	Tapp	Stud	
248	713625	Fjær	Spring, compression	
249	713721	Bolt	Bolt, lift	
250	713647	Fjær	Spring, locking	
251	713668	Lager	Bearing, guide	
252	230542	Skive	Washer, lock, 2.3 mm	
253	230542	Skive	Washer, lock, 2.3 mm	
255	713557	Skive	Washer, adjusting	
256	713635	Fjær	Spring, tension	
257	713606	Skive	Disc, stroboscope, 50/60 Hz	

TANDBERGS RADIOFABRIKK A/S
N – 1301 Sandvika – Norway

I535 - 6 - 77 Part No. 714051
Printed in Norway by Tøyen-Trykk A/S