

E

TEAC TECHNICAL INFORMATION

9511

TASCAM DA-P1, No Operation with Battery Pack

8th September 1995

Phenomenon

Power of the DA-P1 does not turn on when the unit is operated with **full-charged battery pack** BP-D1. * No problem on the operation with AC adaptor PS-D1 or not full-charged battery.

Cause

The U5, D/A Converter IC PCM1710U, requires two different voltage supply, Vdd for digital and Vcc2 for analogue. In case a difference of both voltage exceeds a certain amount while powering up, the U5 may go to latch up state. Use of full-charged battery results in the highest prime voltage supply. And it causes a chance that the U5 enters such state. This state allows to draw a huge current of +5V supply circuit. Finally, the foldback current limiting function of the U325, 3 Prong Regulator IC, works and system control is unable to start.

Solution

Remove a bottom cover and make a short circuit on R20, 10 Ω chip resistor.

12 pcs Screws Fixing The Bottom Cover

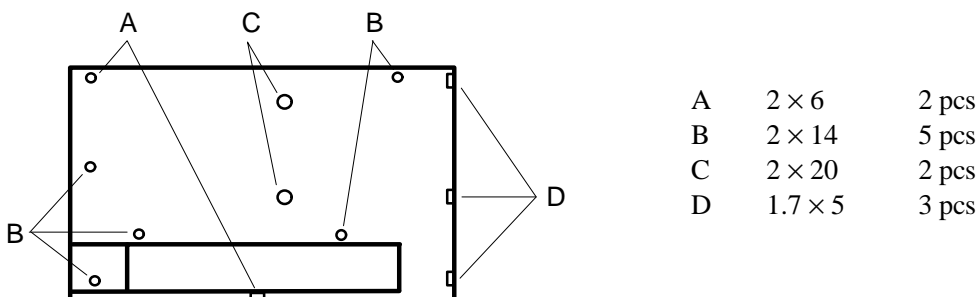

Bottom View & Location of R20

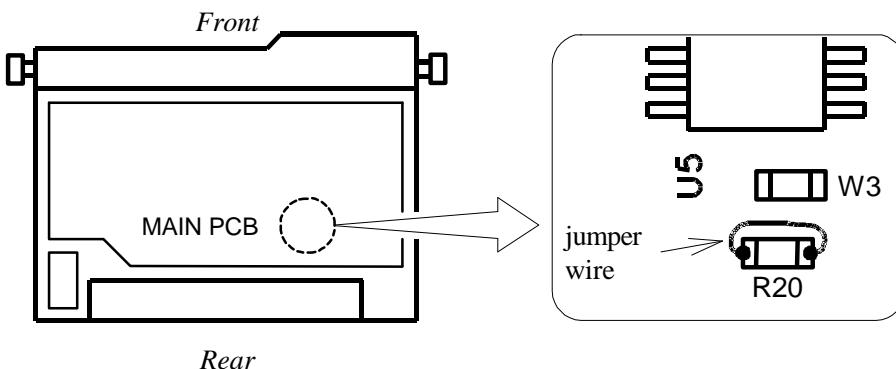

Products serial numbered up to 49999 stocked in TEAC warehouse have been reworked on replacing R20 with chip jumper. They are identifiable with "C" mark stamped at the right side of serial number shown on carton. All products serial numbered 50001 and up have been modified at the production line and have no "C" mark.

TEAC TECHNICAL INFORMATION

9711

DA-30MK2, DA-P1, R-9, Capstan Thrust Bearing

20th June 1997

Symptom: Capstan motor does not rotate. Error 02 is indicated in the display window.

Cause: Wear of the capstan thrust bearing (Ref 4-37, S/M). The Rotor touches to the motor coil.

Solution: Change the material of the thrust bearing. Duration is improved.

New thrust bearing, **P/No. V000592-00A** has been introduced in the following products:

DA-30Mk2/R/9 S/No. 390501 and higher

DA-P1 S/No. 210361 and higher

When the thrust bearing is replaced, follow the procedure indicated below.

- 1 Dissolve the screw lock with alcohol.
- 2 Replace the old thrust bearing with new, **P/No. V000592-00A**.
 Note: Old part and new part can be identified by color difference.
 Old part is gray color and new part is black color.
- 3 Insert a jig spacer (0.25 t), **P/No. J003856-00A** between rotor and coil as shown below.
- 4 Adjust the height of the rotor by rotating the thrust bearing.
- 5 Pull out the spacer.
- 6 Secure the thrust bearing with screw lock.

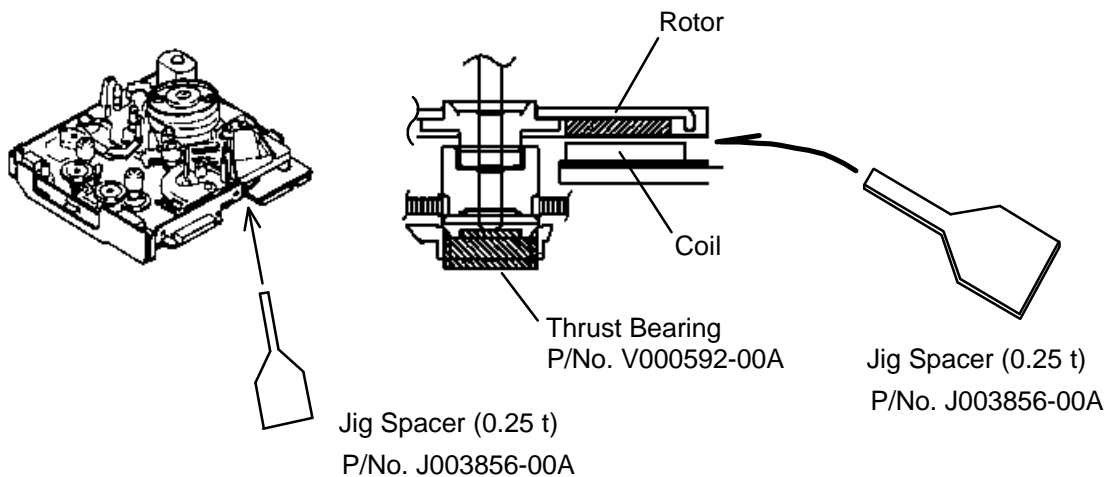

TEAC TECHNICAL INFORMATION

9708

DA-30Mk2, DA-P1, R-9, Changes on the Mechanism Assy

14th March 1997

Changes have been made on the Mechanism Assy as following:

Model	Part Number: Old → New	New Mechanism mounted on
DA-30Mk2/R-9	M000191-00B → M000191-00C	S/No. 340001 and higher
DA-P1	M002619-00B → M002619-00C	S/No. 160001 and higher

* Mechanism Assy (-00B) and (-00C) are compatible.

Details for the changes are as following:

1 Sensor Block (FG Head)

To eliminate the mechanical position adjustment, Sensor Block (Ref 4-59, S/M) has been changed. Because of the shape of the new Sensor Block, Screw (Ref 4-4) and Chassis Base Block (Ref 4-29) have been changed simultaneously. Old and new parts are incompatible.

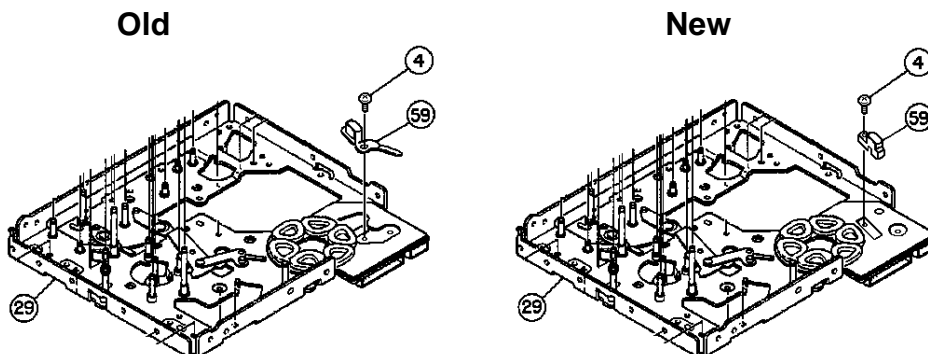

Ref No.	Description	Old	New
4-4	Screw	V000119-00A (M1.7 × 2.5)	V000560-00A (M1.2 × 4)
4-29	Chassis Base Block	V000124-00A(DA-30Mk2/R-9) V000326-00A (DA-P1)	V000124-00B (compatible for DA-30Mk2/R-9/DA-P1)
4-59	Sensor Block	V000148-00A	V000148-00B

2 Others

To improve manufacturing productivity, the following parts have been changed. (All are compatible.)

Ref No.	Description	Old	New
3-9	Motor Block	57618166-00	57618166-01
4-57-1	Loading Motor	V000256-00A	V000256-00B
4-62	Solenoid	V000185-00A	V000185-00B

TEAC TECHNICAL INFORMATION

9619

DA-30Mk2 / R-9 / DA-P1, Change of Tape Guide

28th June 1996

To improve a tape path on Reverse PLAY mode, Base INC IN and Base INC OUT have been changed as following:

DA-30Mk2/R-9 Products S/No. 260186 and up

	Old	New
Base INC IN (Ref 4-40)	V000143-00A	V000334-00A
Base INC OUT (Ref 4-41)	V000144-00A	V000144-00B

DA-P1 Products S/No. 100001 and up

	Old	New
Base INC OUT (Ref 4-41)	V000335-00A	V000144-00B

* Note: The new Base INC IN (V000334-00A) introduced on the DA-30Mk2/R-9 is the original part of the DA-P1.

Only the new Base INC OUT can be identified by observing a shape of base.

Old Base INC OUT
V000144-00A
V000335-00A

New Base INC OUT
V000144-00B

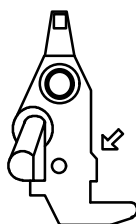
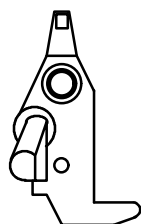

All improvements on the Technical Information No. 9520 and this information, No. 9619 have been incorporated on the following Mechanism Assy:

Mechanism Assy for DA-30Mk2/R-9, **P/No. M000191-00B**

Mechanism Assy for DA-P1, **P/No. M002619-00B**

TEAC TECHNICAL INFORMATION

9610

TASCAM DA-30Mk2/DA-P1, Swelling of Loading Belt

31st May 1996

Problem: Loading Belt (Ref 4-58) slips/comes off. Error 01 appears.

Cause: Swelling of Loading Belt. Grease applied to a loading worm gear affects the belt.

Solution: Material change of the Loading Belt.

Urethane made belt, P/No. **V000135-00B** has been newly introduced on the products:

DA-30Mk2 S/No. 290001 and up

DA-P1 S/No. 130001 and up

When servicing, follow the procedure below.

- 1 Remove and discard a swelled loading belt.
- 2 Remove and discard a washer fixing a loading worm gear.
- 3 Pull out the loading worm gear.
- 4 Fit a brand new loading worm gear (V000535-00A) which has been registered in spares.
(or original gear can be re-used if grease can be removed from the gear perfectly.)
- 5 Fix the loading worm gear by a brand new washer (V000114-00A).
- 6 Clean a motor pulley.
- 7 Fit a new loading belt (V000135-00B).

Mechanism Bottom View

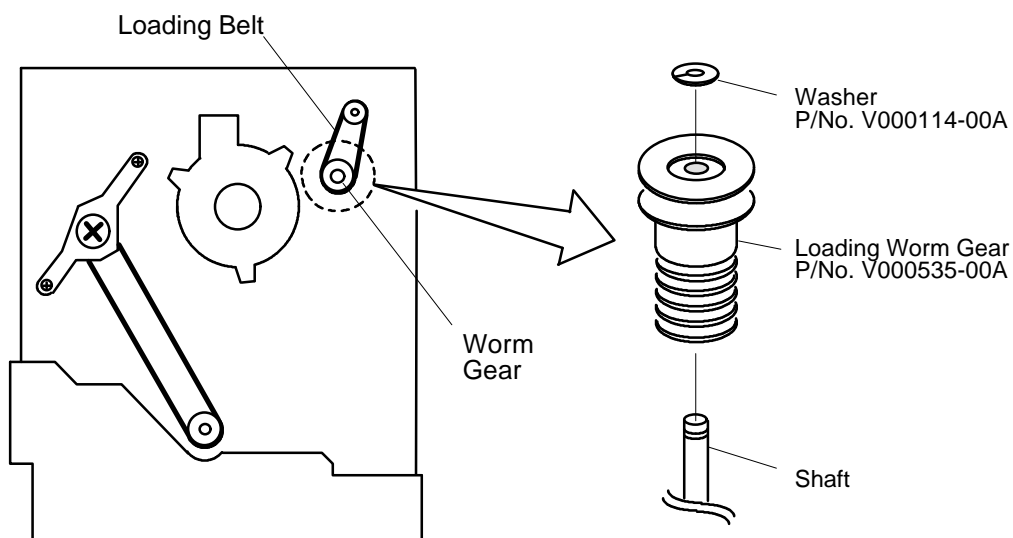

TEAC TECHNICAL INFORMATION

9607

TASCAM DA-P1, Improvement of Error Rate

17th May 1996

To improve the error rate, GND circuit on the Main PCB Assy has been changed on the products of S/No. 90001 and up.

- ① Cut of foil pattern.
- ② Jumper wire between C304 and C418.
- ③ Jumper wire between C23 and TP309
- ④ Removal of C34.

To locate the work point of ①, ② and ③, just remove the bottom cover.

C34 of ④ is mounted on the other side, then, Main PCB Assy should be removed/opened.

To facilitate the servicing, cut of the foil pattern shown as ④ is recommended. This is equivalent to removing C34 of ④.

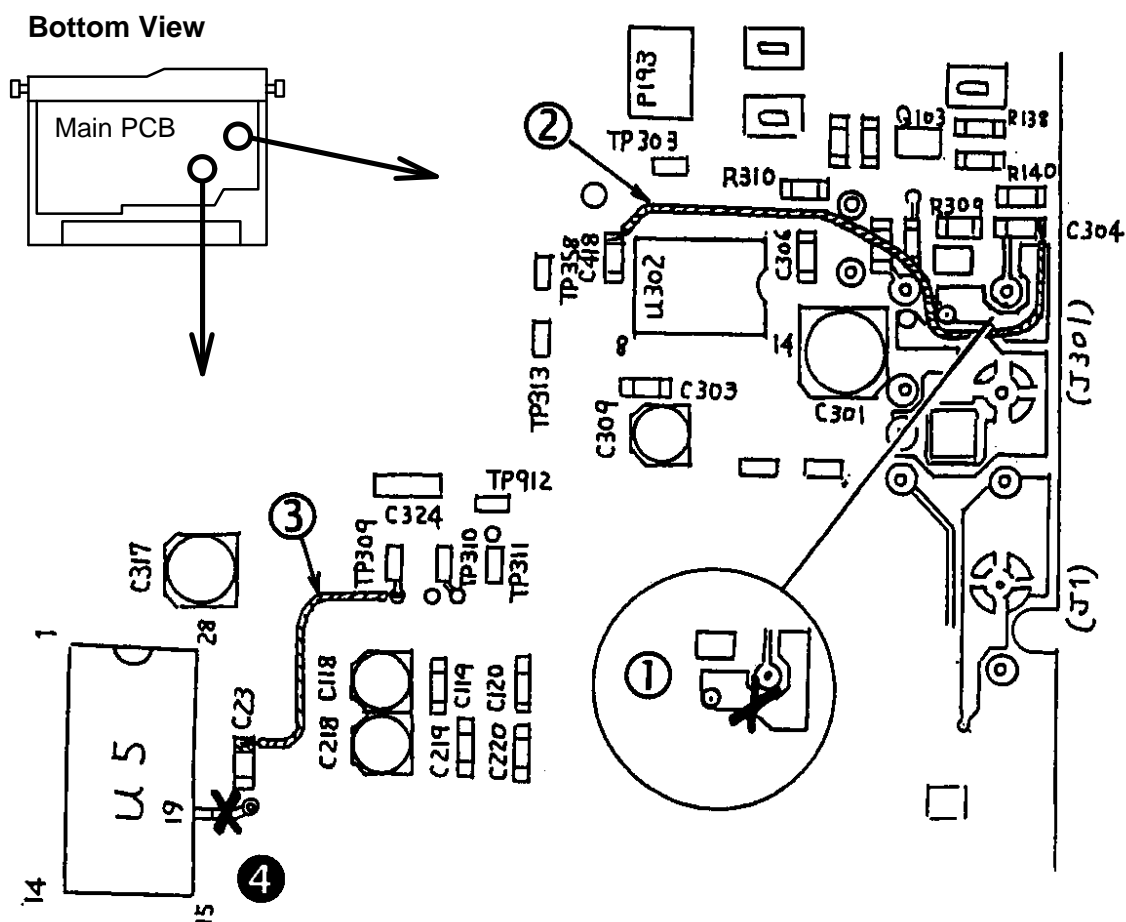

TEAC TECHNICAL INFORMATION

9606

TASCAM DA-P1, Main MPU Change

17th May 1996

Program of Main MPU, U320 on the Main PCB Assy has been changed from Version 1.03 to Version 1.05. It has been mounted on the products of S/No. 150001 and up.

Version	V1.03	V1.05
Part Number	S001857-00A	S001857-00B
Print on IC	78054GC-156	78054GC-218

Feature added newly

With Version 1.05, END ID Short Cut function has been added newly. It works as following:
 When tape is running on record mode, hold REW then press REC. Deck records END ID for 9 seconds and rewinds to 2 seconds before END ID start point.

Improvement

With Version 1.05, following problems have been corrected.

- 1 Unit does not go into "Input Monitor" mode in case WRT START or WRT SKIP is selected.
- 2 PGM Time keeps counting even if PAUSE is pressed. This will occur on and after PGM Time **0H 00M 09S**.
- 3 For instance, tape is recorded as following condition:
 PGM No. 1, 2,, 10, END ID
 With this tape, operate F.FWD then unit will stop at END ID point automatically. And make START ID recording on this point. When such, START ID is recorded correctly, however, no PGM No. is recorded while "11" should be displayed and recorded.
- 4 If REW is pressed repeatedly while holding PLAY at unformatted portion, cassette is automatically ejected.
- 5 No digital and analog input signal connected. Turn the power on. Set Input Select switch to Digital. Press REC then goes to Input Monitor mode. When Input Select switch is set to Analog, in very rare occasion, signal level meter swings up to full scale.
- 6 Operate F.FWD/REW then STOP. After that, if REC/PAUSE is operated immediately, Input Monitor is unable.
- 7 Sometimes "EE" may not be displayed after END ID recording is finished.

TEAC TECHNICAL INFORMATION

9520

DA-30Mk2/R-9/DA-P1, Changes on Mechanism

22nd Decemmer 1995

Various changes have been made on the following products.

- DA-30Mk2/R-9 S/No. 260186 and up
- DA-P1 S/No. 100001 and up

To improve the error rate on Long Play mode, track width of head A/B is securely paired.
 To improve the tape path on Shuttle Reverse mode, shaft of TG-R (Tape Guide-R) is rectified.
 Simultaneously, reception hole of CYL Assy is changed.

Note: In case old CYL Assy mounted on old unit is replaced with new (-00B), old TG-R should also be replaced with new (-00B) at the same time.

CYL Assy for DA-30Mk2/R-9	V000150-00A	→	V000150-00B	} Difference is length of motor wire.
CYL Assy for DA-P1	V000336-00A	→	V000336-00B	
TG-R	V000160-00A	→	V000160-00B	

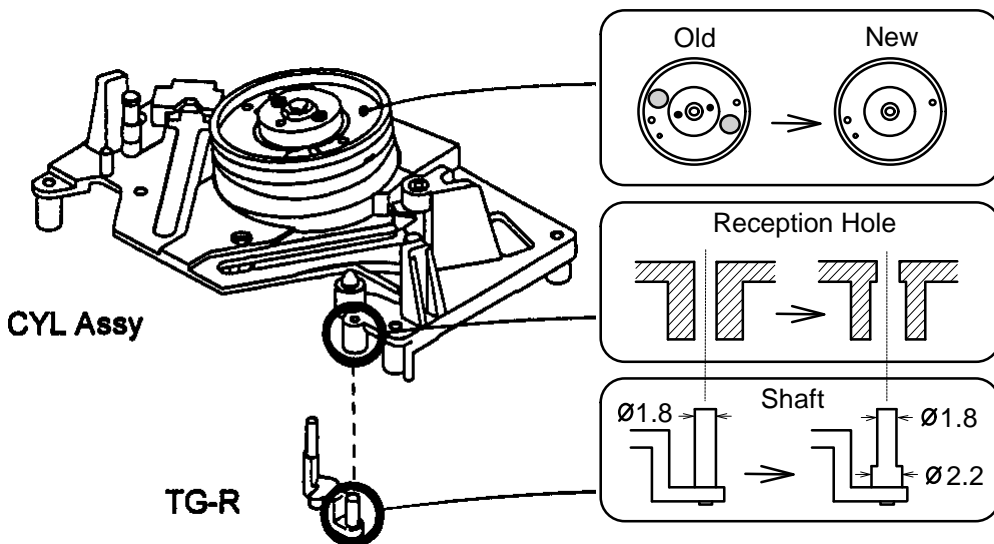

Same change (pairing of head A/B) of CYL Assy is made on CYL Head Assy introduced on Technical Information No. 9516.

CYL Head Assy	V000152-00A	→	V000152-00B
---------------	-------------	---	-------------

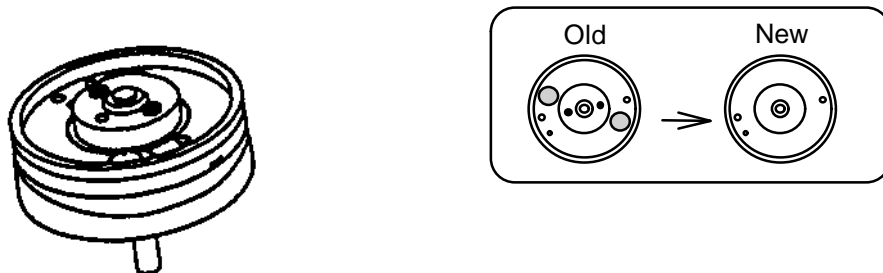

TEAC TECHNICAL INFORMATION

9519

TASCAM DA-P1, MIC IN Noise Suppression

1st December 1995

High pitched (9.2 kHz) noise could be recorded on right channel when recording is made with certain microphones. This occurs only on use of the BP-D1 battery pack.

When such is experienced, follow the procedure below.

* Parts required:

- | | | |
|-------|--------------------------|--|
| 1 pce | P/No. E002262-00A | GND Wire, L=150 mm, Lug Terminal ended |
| 2 pcs | P/No. 12908842 | Ceramic Capacitor, 0.1 μ f/50V |

* Number ① to ⑦ listed below correspond to that of drawings on page 2/3 and 3/3.

Top View on Page 2/3

- ① Make a short circuit by an appropriate jumper wire.
- ② Cut a foil pattern.
- ③ Solder the one end of GND wire to the TOP PCB Assy.
- ④ Lead the other end, Lug Terminal to bottom side.
- ⑤ Solder 0.1 μ f ceramic capacitor to both XLR connectors.

Bottom View on Page 3/3

- ⑥ Fix the Lug Terminal of the GND wire to the chassis by existing screw.
- ⑦ Cut a wire of P192-2(GND).
- ⑧ Remove C397(100 μ f/16 V) gently. Rough work could damage the foil pattern since lead wires crawl under the capacitor.

Products serial numbered 90601 and up have all work of ① to ⑦ performed.

