

**PARTS LIST
LISTE PIECES DETACHEES
ERSATZTEILLISTE
LISTA PARTI DI RICAMBIO
LISTA DE PIEZAS DE REPUESTO**

**THOMSON
AM1200
Chassis CRKD1281**

MODULES

MAIN	MAIN	R 35111560
KDB	DISPLAY/CONTROL	R 35110750
POWE	POWER	R 35111570
RCPB	CASSETTE	R 35110740



IC101	TA2132F FLAT	35094750
IC102	LA1833L	35094770
IC103	LM7000	10542690
IC201,202	TC4052BP	10403350
IC203	PT2256	35110910
IC301	LA4282	35112170
IC601	UPD753016AGC-E87 FLAT	35110860
IC602,603	HCF4094 FLAT	35045600
IC604	BU1923F	35094820
IC605	PST529D	35112340
IC701	AN7312	35057270
REM601	RPM6938-V4	35090120



Q102,116,309,403,603	2SA733P-T	10232490
Q103,104,105,106,107,108,109,111,112,113,114,115,201,202,203,204,205,206,207,208,209,210,304,306,310,311,314,601,602,604,701,702,703,704,705	2SC945P	35055330
Q110	9018G	10403270
Q303	9012G	10391290
Q305	KSA928-Y/2SA928-Y	10400140
Q307,308,313	2SD2012	10221820
Q312,402,706	JE8050D	10235170
Q401	2SC3330S/T TRANSISTOR	35024580



D101,102,103,106,107,112,201,302,303,304,305,306,307,310,311,312,313,314,316,601,602,603,606,607,608,609,610,611,612,613,614,615,617,647,701,702	1N4148	44009209
D104,105	SVC201SPA	35045740
D108,109,110,111	SVC321SPA-C-2	10390850
D312,405,406,407,408,409,411,412,413,414	1N4001	16008160
D401,402,403,404	1N5402S	35095400
D619	ELT-3143D LED	35094800
ZD101	BZX55C3V3	30948790
ZD102	BZX55C5V1/ZPD5V1	80444140
ZD103,106	BZX55C5V6/ZPD5V6	44025401
ZD301	BZX55C9V1	90578100
ZD302	ZPD10 2%	80444160
ZD304	BZX83C12V	30948800
ZD305	BZX55C6V2	20475410

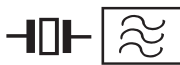

F101		35049070
F103	10M7HZ	35055340
F104	450K0HZ	35055350
F105	10MHZ7 FILTER	35033390
X101	7M2MHZ	35094790
X601	4M332HZ	35094830
X602	6M0HZ	35094840



T101		10390920
T102		10390910
T103		10390930

T104		35049060
T701		35023590



R319	2R2 OHM 5% 0,25W	△ 15009870
R326,502,503,504	10R0 OHM 5% 0,25W	△ 15009580



TC101,102	10POF	10390870
TC103	30POF	35035510



POWER		△ 35112070
TR401		△ 35112080

**OTHER PARTS
AUTRES PIECES
SONSTIGE TEILE
ALTRE PARTI
OTRAS PIEZAS**

	HEADPHONE SOCKET	35049160
	PRISE CASQUE	
	KOPFHOERERBUCHSE	
	PRESA JACK	
	TOMA JACK	
D621	DISPLAY LCD	35094630
	AFFICHEUR LCD	
	LCD-ANZEIGE	
	VISUALIZZATORE LCD	
	VISUALIZADOR LCD	
F401	5AT TIME-LAG FUSE	△ 35043570
	5AT FUSIBLE TEMPORISE	
	5AT SICHERUNG	
	5AT FUSIBILE	
	TEMPORIZZATO	
	5AT FUSIBLE TEMPORIZADO	
F402	2AT TIME-LAG FUSE	△ 48006900
	2AT FUSIBLE TEMPORISE	
	2AT SICHERUNG	
	2AT FUSIBILE TEMPORIZZATO	
	2AT FUSIBLE TEMPORIZADO	

R : RECYCLED PART
: **PIECE RECYCLEE**
: **AUSTAUSCHTEILE**
: **RICAMBIO RICICLATO**
: **MODULO REPROCESADO**

For any requests, please contact THOMSON multimedia after sales service area
Pour toutes précisions, contactez votre service apres vente local THOMSON multimedia
Für weitere Auskünfte, wenden Sie sich bitte an die THOMSON multimedia Kundendienstes
Per precisazioni, contattare l'assistenza tecnica THOMSON multimedia
Para cualquier pregunta, por favor contactar con el responsable de zona del servicio postventa de THOMSON multimedia

03 / 2000 **35112020**
REV. N° 0 00 / 00 **00000000**
1/4

LM 501,502,503	LAMP 12V AMPOULE 12V LAMPE 12V LAMPADA 12V LAMPARA 12V	35094850
RL 401	RELAY RELAIS RELAIS RELEE RELEE	△ 35111580
SPK 301	LOUDSPEAKER SOCKET PRISE HAUT PARLEUR LAUTSPRECHERBUCHSE PRESA ALTOPARLANTE TOMA HEMBRA ALTAVOZ	10494310
SW 600	SLIDE SWITCH COMMUTATEUR SCHALTER COMMUTATORE CONMUTADOR	35094860
SW 601,620	MICROSWITCH MICRO CONTACTEUR MIKROSCHALTER MICROINTERRUPTORE MICROCONTACTOR	10449940
SW 701	SWITCH COMMUTATEUR SCHALTER COMMUTATORE CONMUTADOR	10449930
EQUIPMENT/PRESENTATION EQUIPEMENT/PRESENTATION AUSSTATTUNG/GEHAEUSE PARTI VARIE EQUIPO/PRESENTACION		
AM1200 (REMOTE CONTROL) AM1200 (TELECOMMANDE) AM1200 (FERNBEDIENUNG) AM1200 (TELECOMANDO) AM1200 (TELEMANDO)		35111930
LOUDSPEAKER BOX RIGHT OR LEFT ENCEINTE ACOUSTIQUE GAUCHE OU DROITE LAUTSPRECHERBOX RECHTS ODER LINKS CASSA ACUSTICA SINISTRA O DESTRA CAJA ACUSTICA IZQUIERDA O DERECHA		35111940
FITTING DOWNER LEFT CALE INFERIEURE GAUCHE POLSTER UNTEN LINKS Distanziatore inferiore sinistra CALZO INFERIOR IZQUIERDA		35111920
FITTING DOWNER RIGHT CALE INFERIEURE DROITE POLSTER UNTEN RECHTS Distanziatore inferiore destra CALZO INFERIOR DERECHA		35111910
FITTING UPPER LEFT CALE SUPERIEURE GAUCHE POLSTER OBEN LINKS Distanziatore superiore sinistra CALZO SUPERIOR IZQUIERDA		35111900
FITTING UPPER RIGHT CALE SUPERIEURE DROITE POLSTER OBEN RECHTS Distanziatore superiore destra CALZO SUPERIOR DERECHA		35111890
FOLDING BOX EMBALLAGE CARTON KARTON IMBALLAGGIO CARTONE EMBALAJE CARTON		35111870
POWER SUPPLY LEAD CORDON D'ALIMENTATION NETZKABEL CAVO DI ALIMENTAZIONE CABLE DE ALIMENTACION		△ 10260820

MECHANISM MECANIQUE MECHANIK MECCANICA MECANISMO

CASSETTE MECHANISM MECANIQUE CASSETTE CASSETTENLAUFWERK MECCANICA CASSETTA MECANISMO CASSETTE		35110920
BUSH RUBBER CD REAR AMORTISSEUR CAOUTCHOUC CD ARRIERE DAEMPER GUMMI CD HINTEN AMMORTIZZATORE DI GOMMA CD POSTERIORE AMORTIGUADOR DE GOMA CD TRASERA		35055560
BUSH RUBBER CD FRONT AMORTISSEUR CAOUTCHOUC CD AVANT DAEMPER GUMMI CD VORN AMMORTIZZATORE DI GOMMA CD ANTERIORE AMORTIGUADOR DE GOMA CD DELANTERA		35051630
OPTICAL PLAYER TCM125-2 LECTEUR OPTIQUE TCM125-2 PICK-UP TCM125-2 ASSIEME OTTICA TCM125-2 MECANISMO OPTICO TCM125-2		10612760
EG530AD-2B MOTOR 12V EG-530AD-2B MOTEUR 12V EG530AD-2B MOTOR 12V EG530AD-2B MOTORE 12V EG530AD-2B MOTOR 12V		10218650

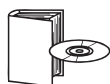

AM1200 UM TH AM1200 NU TH AM1200 BA TH AM1200 IU TH AM1200 IU TH		55062500
AM1200 PARTS LIST AM1200 LISTE DE PIECES DETACHEES AM1200 ERSATZTEILLISTE AM1200 LISTA PARTI DI RICAMBIO AM1200 LISTA DE PIEZAS DE REPUESTO		35112020
CRKD1281 SERVICE MANUAL CRKD1281 DOCUMENTATION TECHNIQUE CRKD1281 TECHNISCHE DOKUMENTATION CRKD1281 DOCUMENTAZIONE TECNICA CRKD1281 DOCUMENTACION TECNICA		35113140

CHASSIS AND PRESENTATION CHASSIS ET PRESENTATION CHASSIS UND GEHAEUSETEILE TELAIO E DI PRESENTAZIONE CHASIS Y PRESENTACION

001 CASSETTE FLAP WINDOW GLACE VOLET CASSETTE FENSTER CASSETTENKLAPPE VETRO SPORTELLO CASSETTA CRISTAL TAPA CASSETTE		35111750
002 CASSETTE FLAP DOOR VOLET CASSETTE CASSETTENKLAPPE SPORTELLO CASSETTA TAPA CASSETTE		35111850
003 CASSETTE HOLDER PORTE CASSETTE CASSETTENHALTER PORTACASSETTA PORTACASSETTE		35089060

004 SPRING TORSION HOLDER CASSETTE RESSORT A EPINGLE VOLET CASSETTE NADELFEDER CASSETTENKLAPPE MOLLA DI TORSIONE PORTACASSETTA RESORTE HORQUILLA PORTACASSETTE		35089070
007 VOLUME KNOB BOUTON VOLUME LAUTSTAERKEKNOPF ROTELLA DI PLASTICA VOLUME RUEDA PLASTICA MANDO VOLUMEN		35110580
008 MONO/STEREO SLIDE BUTTON MANETTE MONO/STEREO MONO/STEREO SCHIEBETASTE COMMANDO A CURSORE MONO/STEREO MANECILLA MONO/STEREO		35111780
009 DISPLAY WINDOW GLACE AFFICHEUR ANZEIGEFENSTER VETRO DEL VISUALIZZATORE CRISTAL DEL VISUALIZADOR		35111760
010 FRONT PANEL FACADE FRONTPLATTE PANNELLO FRONTALE PANEL FRONTAL		35111840
015 CASSETTE BUTTON ASSY ENSEMBLE DE TOUCHES CASSETTE TASTENEINHEIT CASSETTE ASSIEME TASTI CASSETTA CONJUNTO DE TECLAS CASSETTE		35111440
022 CASSETTE DOOR DAMPER GEAR ROUE DENTEE PORTE CASSETTE ZAHNRAD CASSETTENHALTER RUOTA DENTATA PORTACASSETTA RUEDA DENTADA PORTACASSETTE		35089190
023 GEAR WHEEL CASSETTE HOLDER SUPPORT ROUE DENTEE PORTE CASSETTE HALTER ZAHNRAD SUPPORTO RUOTA DENTATA PORTACASSETTA SOPORTE RUEDA DENTADA PORTACASSETTE		35089200
024 BUTTON STRIP CD CONTROL/PRESET BARRETTE DE TOUCHES 8T CD/ PRESET TASTENLEISTE CD CONTROL/PRESET PIATTINA TASTI 8T CD CONTROL/ PRESET PLACA DE TECLAS 8T CD CONTROL/ PRESET		35111790
025 TIME/MIX BUTTON BARRETTE DE TOUCHES 2T TIME/ MIX TASTENLEISTE TIME/MIX PIATTINA TASTI TIME/MIX PLACA DE TECLAS TIME/MIX		35110570
026 BUTTON STRIP POWER/PROGRAM BARRETTE DE TOUCHES 2T POWER/ PROGRAM TASTENLEISTE POWER/PROGRAM PIATTINA TASTI 2T POWER/ PROGRAM PLACA DE TECLAS 2T POWER/ PROGRAM		35110560
027 SUPPORT BUTTONS CD/TAPE/TUNER SUPPORT DE TOUCHES CD/TAPE/ TUNER HALTER KUNSTSTOFF CD/TAPE/ TUNER SUPPORTO TASTI CD/TAPE/TUNER SOPORTE TECLAS CD/TAPE/TUNER		35111770
028 CD BUTTON TOUCHE CD TASTE CD TASTO CD TECLA CD		35111800

029	TAPE BUTTON TOUCHE TAPE TASTE TAPE TASTO TAPE TECLA TAPE	35111830
030	TUNER BUTTON TOUCHE TUNER TASTE TUNER TASTO TUNER TECLA TUNER	35111820
031	BUTTON STRIP RDS/DISPLAY/TIME BARRETTE DE TOUCHES RDS/ DISPLAY/TIME TASTENLEISTE RDS/DISPLAY/TIME PIATTINA TASTI RDS/DISPLAY/ TIME PLACA DE TECLAS RDS/DISPLAY/ TIME	35110550
035	CASSETTE BOARD CASSETTE PLATINE CASSETTE PLATTE CASSETTE PIASTRA CASSETTE PLATINA	35094890
042	DISPLAY/CONTROL BOARD DISPLAY/CONTROL PLATINE DISPLAY/CONTROL PLATTE DISPLAY/CONTROL PIASTRA DISPLAY/CONTROL PLATINA	35110750
044	MAIN BOARD MAIN PLATINE MAIN PLATTE MAIN PIASTRA MAIN PLATINA	35111560
050	SWITCHED MODE TRANSFORMER Δ TRANSFORMATEUR D'ALIMENTATION TRAFO SCHALTNETZTEIL TRASFORMATORE D'ALIMENTAZIONE TRANSFORMADOR DE ALIMENTACION	35112070
052	POWER BOARD POWER PLATTE POWER PLATTE POWER PIASTRA POWER PLATINA	35111570
053	REAR PANEL Δ COFFRET ARRIERE RUECKWAND PANNELLO POSTERIORE TAPA POSTERIOR	35094940
065	COUNTER CENTRIRING PART CONTRE CENTREUR GEGENZENTRIERSTUECK CONTROCENTRATORE CONTRA ADAPTADOR	35090230
066	MAGNET CD AIMANT CD MAGNET CD MAGNETE CD IMAN CD	35051560
068	COUNTER CENTRIRING HOLDER SUPPORT CONTRE CENTREUR GEGENZENTRIERSTUECK HALTER SUPPORTO CONTROCENTRATORE SOPORTE CONTRA ADAPTADOR	35051520
070	CD LOCK MAGNET VERROU AIMANT CD RIEGEL MAGNET CD CHIUSURA MAGNETE CD CERROJO IMAN CD	35051550
071	CD DOOR VOLET CD CD Klappe SPORTELLO CD TAPA CD	35111860
072	LOOK CD DOOR VERROU VOLET CD RIEGEL CD Klappe CHIUSURA SPORTELLO CD CERROJO TAPA CD	35089250

074	CD OPEN LEVER LEVIER OUVERTURE VOLET CD HEBEL (DOOR CD) LEVA APERTURA SPORTELLO CD LEVA APERTURA TAPA CD	35090240
080	SPRING TORSION CD DOOR RESSORT A EPINGLE VOLET CD NADELFEDER CD Klappe MOLLA DI TORSIONE SPORTELLO CD RESSORTE HORQUILLA TAPA CD	35089260
081	SUPPORT CD MECHANISM SUPPORT MECANIQUE CD HALTER CD LAUFWERK SUPPORTO MECCANICA CD SOPORTE MECANISMO CD	35110690
082	CD DOOR DAMPER GEAR ROUE DENTEE VOLET CD ZAHNRAD CD HALTER RUOTA DENTATA SPORTELLO CD RUEDA DENTADA TAPA CD	35089280
083	GEAR WHEEL CD HOLDER SUPPORT ROUE DENTEE VOLET CD HALTER ZAHNRAD SUPPORTO RUOTA DENTADA SPORTELLO CD SOPORTE RUEDA DENTADA TAPA CD	35089290

--	--	--

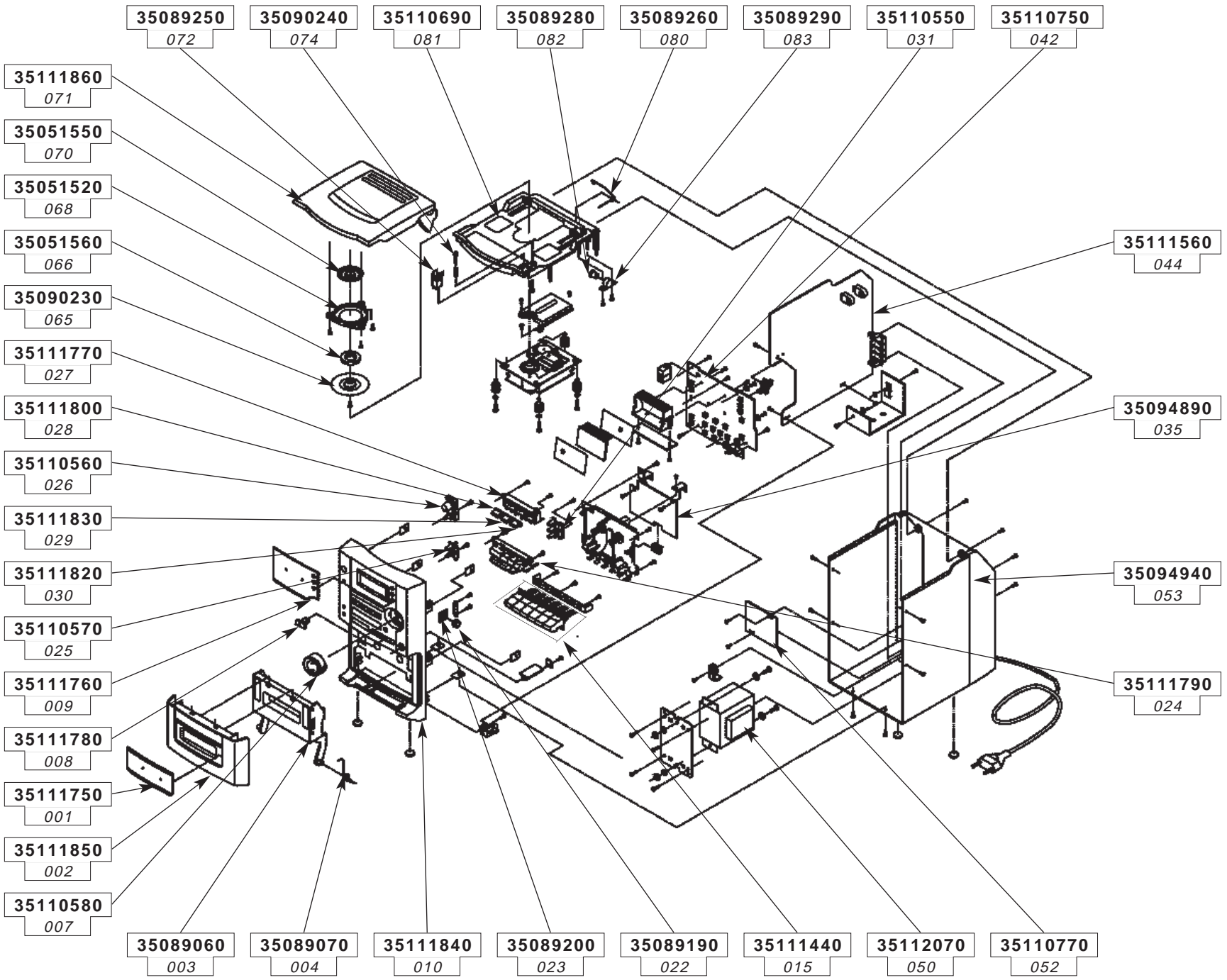

**CHASSIS AND PRESENTATION / CHASSIS ET PRESENTATION / CHASSIS UND GEHAEUSETEILE /
TELAIO E DI PRESENTAZIONE / CHASIS Y PRESENTACION**

AM1200

The description and characteristics given here are of informative significance only, and non committal. To keep up the high quality of our products, we reserve the right to make any changes or improvement without previous notice. • Les descriptions et caractéristiques figurant sur ce document sont données à titre d'information et non d'engagement. En effet, soucieux de la qualité de nos produits, nous nous réservons le droit d'effectuer, sans préavis, toute modification ou amélioration. • Die Beschreibungen und Daten in dieser Anleitung dienen nur zur Information und sind nicht bindend. Um die Qualität unserer Produkte ständig zu verbessern, behalten wir uns das Recht auf Änderungen vor. • Le descrittioni e le caratteristiche date su questo documento sono fornite a semplice titolo informativo e senza impegno. Ci riserviamo il diritto di eseguire, senza preavviso, qualsiasi modifica o miglioramento. • Las descripciones y características que figuran en este documento se dan a título de información y no de compromiso. En efecto, en bien de la calidad de nuestros productos, nos reservamos el derecho de efectuar, sin previo aviso, cualquier modificación o mejora.