



MODELS 6M292, 6M293  
 Chassis 5645  
 Alignment, Socket  
 Trimmers  
 MODEL 6M295, Ch. 5650  
 Alignment

ZENITH RADIO CORP.

MODELS 6-M-292, 6-M-293, 6-M-295

Operation	Connect Test Oscillator To	Dummy Antenna	Set Test Osc. To	Manual or Automatic Position	Set Gang Cond.	Adjust Trimmers	Purpose
1	1st Det. Grid	1/2 Mfd.	252.5	Manual	Max. Cap.	DEFG	I. F. Alignment
2	Rec. Ant. Lead	50 Mmfd.	1600	Manual	Min. Cap.	I	Trim Oscillator
3	Rec. Ant. Lead	50 Mmfd.	1400	Manual	1400	AH	Trim Ant. & R. F. Stage
4	Rec. Ant. Lead	50 Mmfd.	600	Manual	600	J	Rock Gang & Adjust Osc. Padder for Max. Output
5	Rec. Ant. Lead	50 Mmfd.	—	Manual	Tune To A Station Around 900 K. C. and Set Dial for Calibration		
6	Rec. Ant. Lead	50 Mmfd.	1000	Automatic	Range #2	Trim Ant. & R.F. of Automatic Unit — Trimmers "B" - "C"	
7	Connect Car Antenna to Set — Tune to Weak Station Around 1400 K. C. — Trim Antenna Trimmer "A" for Maximum Peak Output.						
8	Trim Automatic Antenna Trimmer "B" to Car Antenna on a Weak Station around 1000 K. C. on Range #2.						

See tube layouts for location of aligning trimmers

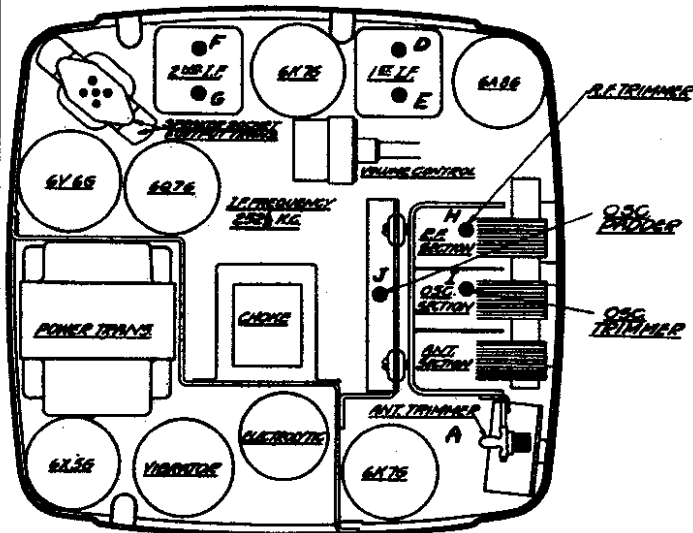

6-M-292, 6-M-293

Fig. 7

Tube Position

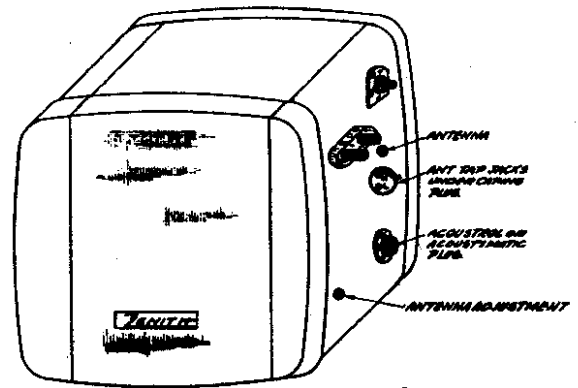

6-M-292, 6-M-293

Fig. 8

6-M-292, 6-M-293  
**ANTENNA ALIGNMENT**

Fig. 8 shows the location of the antenna tap jacks on the side of the receiver case. Remove the capping plug from over this jack assembly, and insert the antenna pin lead in the "H" or "L" position, depending on the capacity of the antenna being used. The "H" position must be used for antennas with a capacity in the range of from 100 to 500 mfd. The "L" connection must be used for low capacity antennas of from 0 to 125 mfd. Compare this listing with that given under the various antennas, and the proper position will easily be recognized. After selecting the position desired, place the capping plug back over the hole to prevent motor noise from entering into the antenna circuit of the receiver. Connect the antenna proper by means of the Delco-Remy connector shown in Fig. 8.